

LONGREACH ~~EASTERN HIGH SCHOOL~~

DOBBIN ROAD

SECTION 3, AREA 2

HOWARD COUNTY, MARYLAND

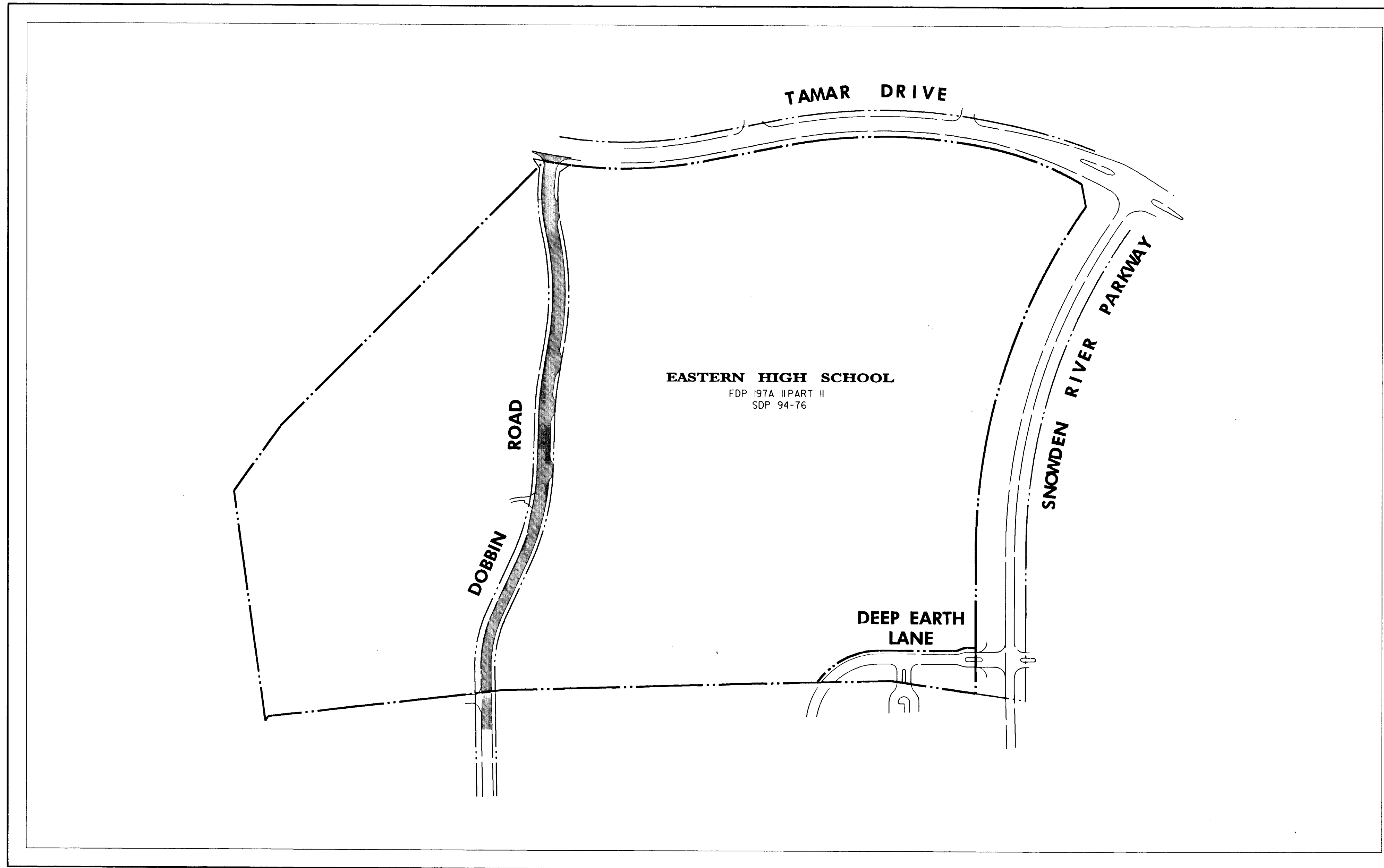

PLAN VIEW

SCALE: 1" = 200'

INDEX OF DRAWINGS

SHEET NO.	DESCRIPTION
1 OF 20	COVER SHEET
2 OF 20	DOBBIN RD. WIDENING & STORM DRAIN PLAN
3 OF 20	DOBBIN RD. WIDENING & STORM DRAIN PLAN
4 OF 20	DOBBIN ROAD-ROAD CONSTRUCTION DETAILS
5 OF 20	DOBBIN ROAD-ROAD CONSTRUCTION DETAILS
6 OF 20	DRAINAGE AREA MAP & STORM DRAIN PROFILES
7 OF 20	DOBBIN ROAD - NOTES & SEQUENCES
8 OF 20	DOBBIN ROAD - ROAD SECTIONS
9 OF 20	DOBBIN ROAD - ROAD SECTIONS
10 OF 20	DOBBIN ROAD - ROAD SECTIONS
11 OF 20	DOBBIN ROAD - ROAD SECTIONS
12 OF 20	TRAFFIC PLANS - SIGNING AND STRIPING PLAN
13 OF 20	TRAFFIC PLANS - TRAFFIC SIGNAL PLAN
14 OF 20	REF. DWG. - EASTERN HIGH SCHOOL SDP 1 OF 32
15 OF 20	REF. DWG. - EASTERN HIGH SCHOOL SDP 4 OF 32
16 OF 20	REF. DWG. - EASTERN HIGH SCHOOL SEC COMPOSITE GRADING PLAN 17 OF 32
17 OF 20	REF. DWG. - EASTERN HIGH SCHOOL SEC COMPOSITE GRADING PLAN 18 OF 32
18 OF 20	REF. DWG. - EASTERN HIGH SCHOOL SEC COMPOSITE GRADING PLAN 20 OF 32
19 OF 20	REF. DWG. - EASTERN HIGH SCHOOL SEC COMPOSITE GRADING PLAN 26 OF 32
20 OF 20	REF. DWG. - EASTERN HIGH SCHOOL SEC COMPOSITE GRADING PLAN 27 OF 32

GENERAL NOTES

- ALL CONSTRUCTION SHALL BE IN ACCORDANCE WITH THE LATEST STANDARDS AND SPECIFICATIONS OF HOWARD COUNTY PLUS MSHA STANDARDS AND SPECIFICATIONS, IF APPLICABLE.
- THE CONTRACTOR SHALL NOTIFY THE DEPARTMENT OF PUBLIC WORKS/BUREAU OF ENGINEERING/CONSTRUCTION INSPECTION DIVISION AT (410) 313-1880 AT LEAST FIVE (5) WORKING DAYS PRIOR TO THE START OF WORK.
- THE CONTRACTOR SHALL NOTIFY "MISS UTILITY" AT 1-800-257-7777 AT LEAST 48 HOURS PRIOR TO ANY EXCAVATION WORK.
- PROJECT BACKGROUND:
LOCATION: DOBBIN ROAD AT TAMAR DRIVE
TAX MAP: 36
PARCEL: PART OF PARCEL 371 AND PART OF PARCEL 657, LOT 89
ZONING: NEW TOWN PER 8/2/85 COMPREHENSIVE ZONING
ZB/BA REF: 918-M
ELECTION DISTRICT: 6TH
SECTION/AREA: SECTION 3, AREA 2
TOTAL TRACT AREA: 74,008 AC.
NUMBER OF PROPOSED LOTS: 0
FINAL DEVELOPMENT PLAN: FDP-197A II PART II
- TRAFFIC CONTROL DEVICES, MARKINGS, AND SIGNING SHALL BE IN ACCORDANCE WITH THE LATEST EDITION OF THE MANUAL ON UNIFORM TRAFFIC CONTROL DEVICES (MUTCD). ALL STREET & REGULATORY SIGNS SHALL BE IN PLACE PRIOR TO THE PLACEMENT OF ANY ASPHALT.
- TOPOGRAPHY SHOWN HEREON IS TAKEN FROM AERIAL DATA DATED 1992 PREPARED FOR THE HOWARD COUNTY PUBLIC SCHOOL SYSTEM BY PDS, INC., AND AS UPDATED BY FIELD SURVEY BY DMW PERFORMED IN OCT. 1993.
- HORIZONTAL DATUM: NAD 27, VERTICAL DATUM: NGVD 29
- LIGHT POLES AND FIXTURES FOR STREET LIGHTS SHALL BE IN ACCORDANCE WITH THE LATEST HOWARD COUNTY DESIGN MANUAL, VOLUME III, ROADS AND BRIDGES.
- THIS PROPERTY IS LOCATED WITHIN THE HOWARD COUNTY METROPOLITAN DISTRICT. PUBLIC WATER TO ON-SITE HYDRANTS. (CONTRACT NO. 44-3338-D). PRIVATE WATER AND SEWER HOUSE CONNECTIONS.
- WETLAND EVALUATION PREPARED BY DAFT - McCUNE - WALKER, INC. DECEMBER, 1992. DISTURBANCE WAIVER APPROVED BY MDNR ON MARCH 24, 1994.
- TRAFFIC STUDY PREPARED BY WELLS AND ASSOCIATES SEPTEMBER 27, 1993. SUBMITTED TO TRAFFIC ENGINEERING ON 2-18-94. APPROVED MARCH 31, 1994.
- EXISTING UTILITIES LOCATED BY DMW.
- OLD MONTGOMERY ROAD WAS ABANDONED PER RESOLUTION NO. 5 DATED APRIL 1988. THE ABANDONED OLD MONTGOMERY ROAD PAVING WILL BE REMOVED BY OTHERS.
- SEDIMENT & EROSION CONTROL MEASURES FOR THE PROPOSED DOBBIN ROAD IMPROVEMENTS ARE SHOWN SCHEMATICALLY ON SHEETS 2 AND 3 OF 20 AS PER THE HOWARD COUNTY SOIL CONSERVATION DISTRICT. SEDIMENT AND EROSION CONTROL DESIGN IS SHOWN IN SDP 94-76. THE GRADING PLANS, SEDIMENT CONTROL SHEETS AND DETAILS FROM SDP 94-76 ARE INCLUDED IN THIS PLAN FOR REFERENCE. SEE NOTATIONS AND SEQUENCE OF CONSTRUCTION ON THOSE SHEETS FOR COORDINATION WITH SDP IMPROVEMENTS.
- A FLOODPLAIN STUDY FOR THE MAIN DRAINAGE WAY THROUGH THE SITE WAS DONE BY PURDUM & JESCHKE IN DECEMBER, 1988. THIS STUDY WAS REVISED AND UPDATED BY A STUDY DONE BY DMW, INC. IN DECEMBER, 1993. FLOODPLAIN STUDY APPROVED BY DPW ON JANUARY 10, 1994.
- CBR TESTS SHALL BE PERFORMED PRIOR TO CONSTRUCTION TO VERIFY ADEQUACY OF PAVEMENT SECTION DESIGN AS PER DESIGN MANUAL VOLUME IV.
- NO NOISE STUDY IS REQUIRED FOR THIS PROJECT.

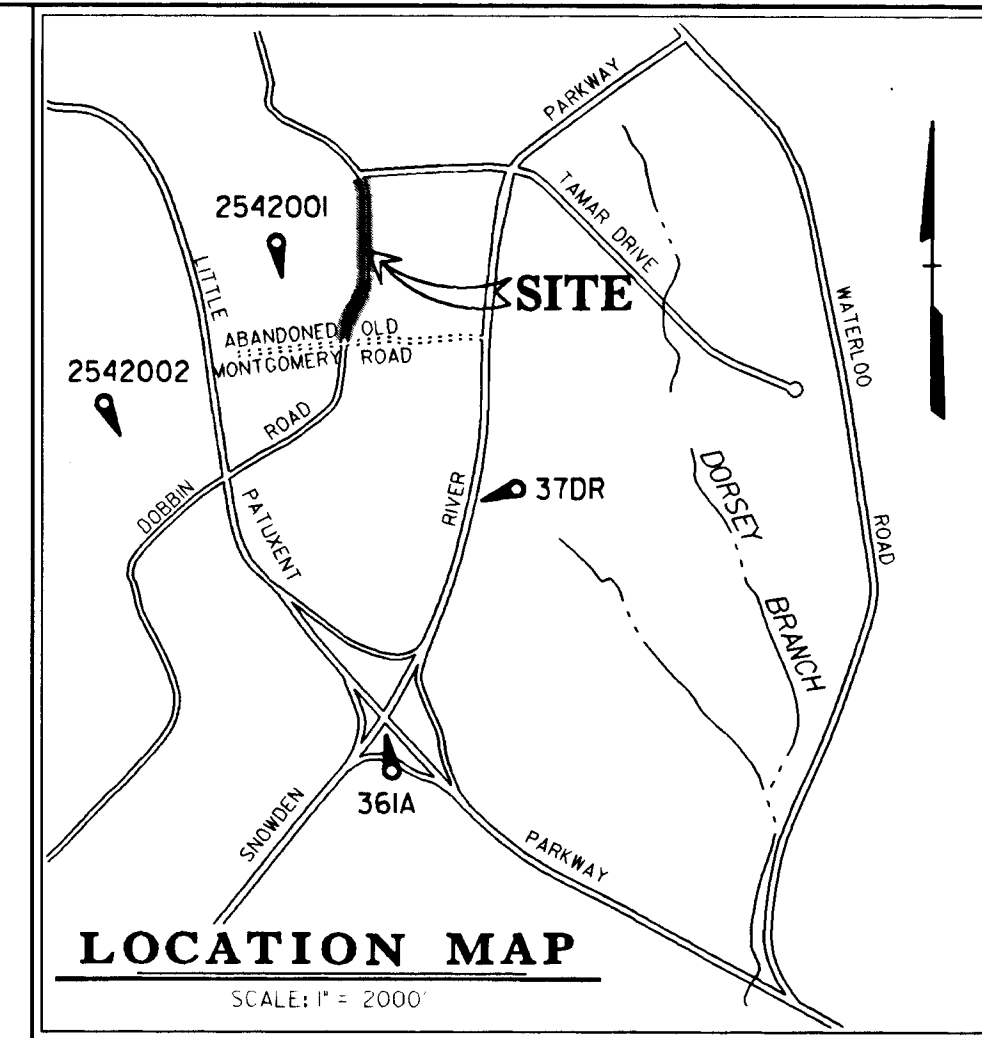

BENCHMARK

DESCRIPTION
STATION 2542001 (CONCRETE MONUMENT)
ELEV. 426.911 (FOR VERTICAL CONTROL ONLY)
STATION IS LOCATED ON BOBE TRANSMISSION LINES 1060' S.W. OF DOBBIN ROAD

BENCHMARK

DESCRIPTION
STATION 2542002 (CONCRETE MONUMENT)
ELEV. 363.638 (FOR VERTICAL CONTROL ONLY)
STATION IS LOCATED 1000' WEST OF RTE. 175 ON TRANSMISSION LINE AT G. & E. TOWER 19-E NEAR HANOVERS RESTAURANT ENTRANCE

BENCHMARK

DESCRIPTION
STATION 37DR (1/4" REBAR)
N69881794, E416566.7155 (FOR HORIZONTAL CONTROL ONLY)
STATION IS LOCATED 0.45+ MILES NORTH OF RTE. 175 AND 46+ EAST OF THE EAST CURB OF SNOWDEN RIVER PARKWAY

BENCHMARK

DESCRIPTION
STATION 361A (CONCRETE MONUMENT)
N469205.9263, E416315.5109 (FOR HORIZONTAL CONTROL ONLY)
STATION IS LOCATED AT THE SOUTHEAST CORNER OF THE INTERSECTION OF SNOWDEN RIVER PARKWAY AND RTE. 175 3+ FROM CURB AND 5.7+ FROM GUARDRAIL END

APPROVED: HOWARD COUNTY DEPT. OF PUBLIC WORKS

Richard M. Davelle 5-17-94
CHIEF, BUREAU OF HIGHWAYS HS DATE

Paul D. Jessom 5/23/94
CHIEF, BUREAU OF ENGINEERING DATE

Charles J. Deussen 5/24/94
CHIEF, LAND DEVELOPMENT DIVISION DATE

APPROVED: HOWARD COUNTY DEPT. OF PLANNING AND ZONING

Uma Swinman 5/31/94
CHIEF, DIVISION OF LAND DEVELOPMENT & RESEARCH DATE

Date	No.	Revision Description

LONGREACH - EASTERN HIGH SCHOOL
SECTION 3 AREA 2

OWNER /DEVELOPER:
HOWARD COUNTY PUBLIC SCHOOL SYSTEM
10910 RT.108
ELLCOTT CITY, MARYLAND 21042-6198

DMW
Daft · McCune · Walker, Inc.
A Team of Land Planners, 200 East Pennsylvania Avenue
Landscape Architects, Towson, Maryland 21286
Engineers, Surveyors & 410 236 3333
Environmental Professionals Fax 236 4705

AREA VILLAGE OF LONGREACH
SECTION 3 AREA 2
TAX MAP 36 PART OF PARCEL 371
6TH ELECTION DISTRICT OF HOWARD COUNTY, MARYLAND

TITLE DOBBIN ROAD
COVER SHEET

Des By MAT Scale AS SHOWN Proj. No. 92087-A

Drn By MAT Date 1-17-94

Chk By LWV Approved 1 OF 1

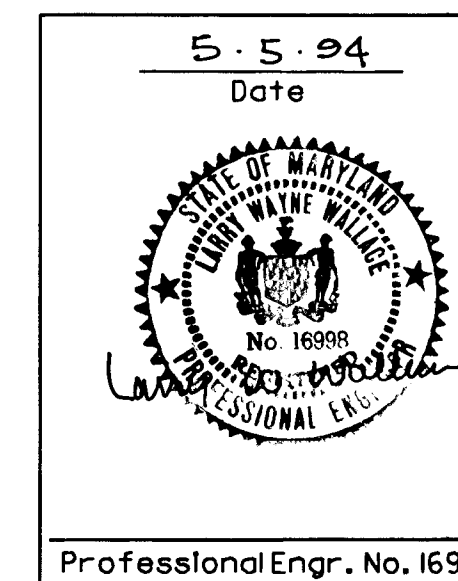

THE PURPOSE OF THIS PLAN IS TO PROVIDE CONSTRUCTION DETAILS FOR THE WIDENING OF DOBBIN ROAD FROM STATION 27+00 TO STATION 44+80.68

STREET TREE TABLE

SYMBOL	TYPE	SIZE	QUANTITY	REMARKS
1	ACER RUBRUM 'RED SUNSET' RED SUNSET RED MAPLE	2 1/2" - 3" CAL.	16	B & B
2	ACER RUBRUM 'AUTUMN FLAME' AUTUMN FLAME RED MAPLE	2 1/2" - 3" CAL.	19	B & B

- THE CONTRACTOR SHALL VERIFY LOCATIONS OF UNDERGROUND UTILITIES PRIOR TO PLANTING. LOCATION OF TREES MAY BE ADJUSTED SLIGHTLY TO MEET FIELD CONDITIONS.
- THE LOCATION, TYPE AND NUMBER OF TREES SHOWN ARE TENTATIVE AND ARE USED FOR BOND PURPOSES ONLY. THE FINAL LOCATION AND VARIETY OF TREES MAY VARY TO ACCOMMODATE FIELD CONDITIONS AND BUILDERS LANDSCAPE PROGRAM. BOND RELEASE IS CONTINGENT UPON SECTION 16.24 OF THE HOWARD COUNTY SUBDIVISION REGULATIONS AS APPROVED BY THE DEPARTMENT OF PLANNING AND ZONING.
- SEE SHEET 4 OF 20 FOR STREET TREE PLANTING DETAIL.
- NO TREES SHALL BE PLANTED WITHIN 20' OF ANY STREET LIGHT.

STREET LIGHT TABLE

STREET NAME	STATION	OFFSET	FIXTURE/POLE TYPE
DOBBIN ROAD	35+00	22' L	150 WATT HPS VAPOR PENDANT (BRONZE) MOUNTED ON A 30' BRONZE ALUMINUM POLE
DOBBIN ROAD	37+00	22' L	-
DOBBIN ROAD	38+85	22' R	-
DOBBIN ROAD	42+35	22' L	-
DOBBIN ROAD	44+10	22' L	-
TAMAR DRIVE	LOCATE ALONG SOUTH SIDE 65' EAST OF CENTERLINE OF DOBBIN ROAD		250 WATT HPS VAPOR PENDANT (BRONZE) MOUNTED ON A 30' BRONZE ALUMINUM POLE
TAMAR DRIVE	NORTH SIDE 60' WEST OF E DOBBIN ROAD		250 WATT HPS VAPOR PENDANT (BRONZE) MOUNTED ON A 30' BRONZE ALUMINUM POLE

- LEGEND**
- EX. PAVING AREAS TO BE MILLED FOR BIT. CONC. OVERLAY
 - EX. BIT. PAVING TO BE REMOVED
 - SEE STREET LIGHT LOCATION TABLE

CURVE DATA

CURVE NO.	DELTA	RADIUS	LENGTH	TANGENT	CHORD
3	07°36'40"	839.00'	111.45'	55.81'	N 05°35'09" E 111.37'
4	22°09'35"	899.00'	324.49'	164.30'	N 01°41'18" W 322.47'
5	22°39'23"	500.00'	197.71'	100.17'	N 01°26'24" W 196.43'

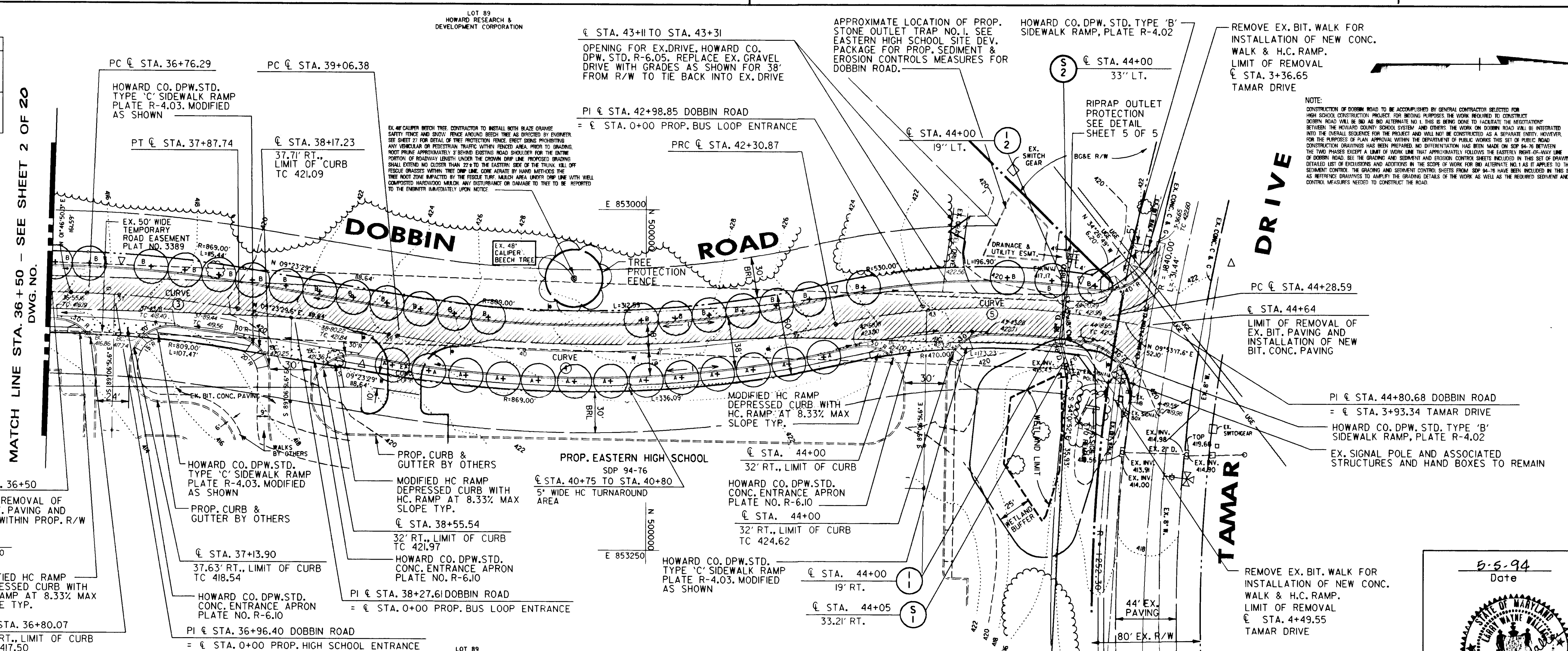

APPROVED: HOWARD COUNTY DEPT. OF PUBLIC WORKS
Andrew M. Paulek 5-17-94
 CHIEF, BUREAU OF HIGHWAYS
Paul S. Seaman 5/23/94
 CHIEF, BUREAU OF ENGINEERING
Paul S. Seaman 5/20/94
 CHIEF, LAND DEVELOPMENT DIVISION

APPROVED: HOWARD COUNTY DEPT. OF PLANNING AND ZONING
Jim Stramm 5/31/94
 CHIEF, DIVISION OF COMMUNITY PLANNING & LAND DEVELOPMENT

Date No. Revision Description
LONGREACH - EASTERN HIGH SCHOOL SECTION 3 AREA 2
 OWNER / DEVELOPER:
 HOWARD COUNTY PUBLIC SCHOOL SYSTEM
 10910 RT.108
 ELLICOTT CITY, MARYLAND 21042-6198

Daft · McCune · Walker, Inc.
 A Team of Land Planners, Landscape Architects, Engineers, Surveyors & Environmental Professionals
 200 East Pennsylvania Avenue
 Towson, Maryland 21286
 410-296-3333
 Fax 296-4705

AREA: **VILLAGE OF LONGREACH SECTION 3 AREA 2**
 TAX MAP 36 PARCEL 371
 6TH ELECTION DISTRICT OF HOWARD COUNTY, MARYLAND

TITLE: **DOBBIN RD. WIDENING & STORM DRAINS STA. 36+50 TO 44+80.68**

Des By	MAT	Scale	1" = 50'	Proj. No.	92087-A
Drn By	MAT	Date	1-17-94		13
Chk By	LWW	Approved			3 OF 3

Professional Engr. No. 16998

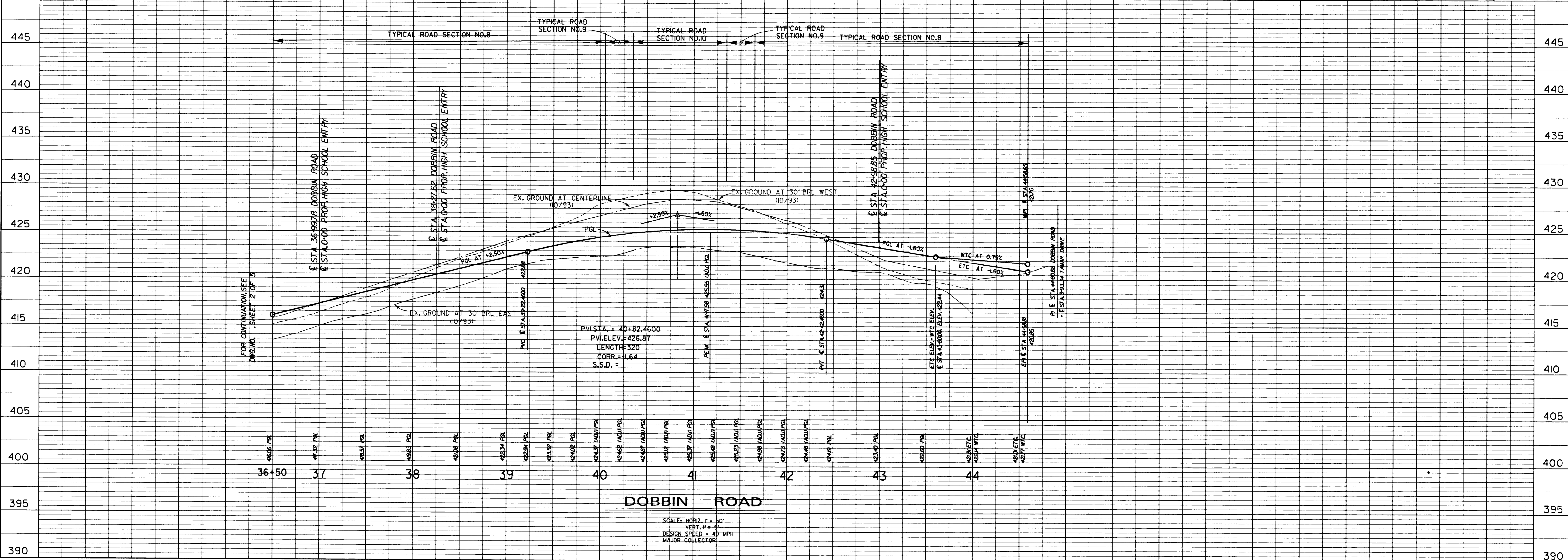
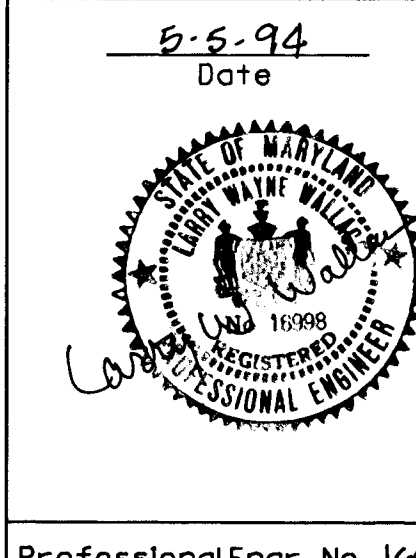

100

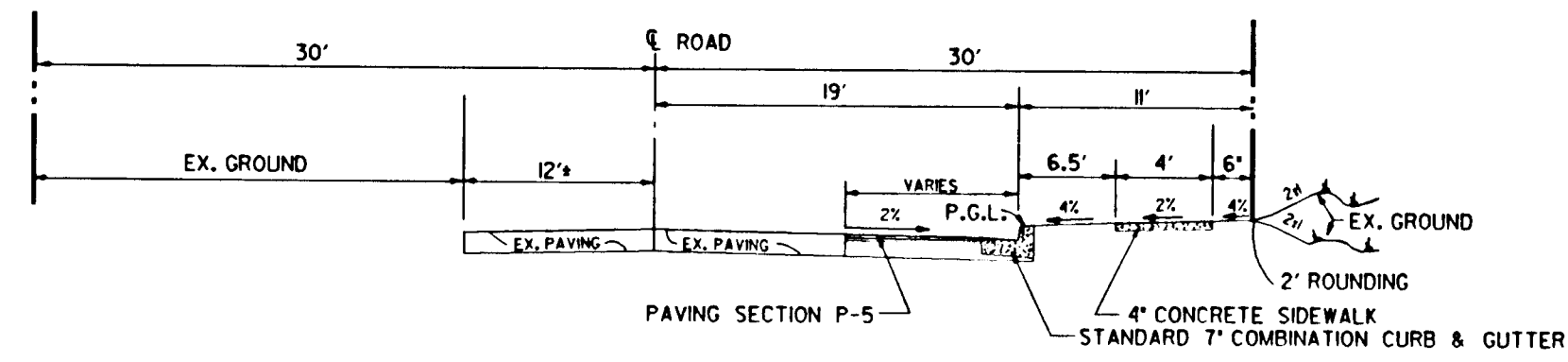

TYPICAL FULL SECTION NO. 1 - 60' R/W

DOBBIN ROAD: STA. 27+00 TO STA. 28+50

NOT TO SCALE
CLASSIFICATION: MAJOR COLLECTOR
DESIGN SPEED: 40 MPH
ZONING: NEW TOWN

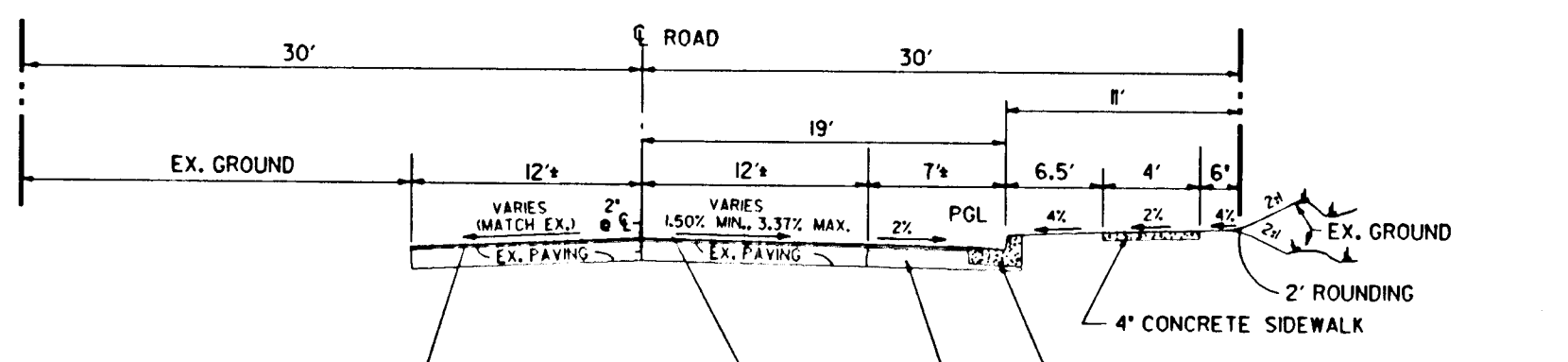

TYPICAL FULL SECTION NO. 2 - 60' R/W

DOBBIN ROAD: STA. 28+50 TO STA. 28+75 & STA. 30+00 TO 30+75

NOT TO SCALE
CLASSIFICATION: MAJOR COLLECTOR
DESIGN SPEED: 40 MPH
ZONING: NEW TOWN

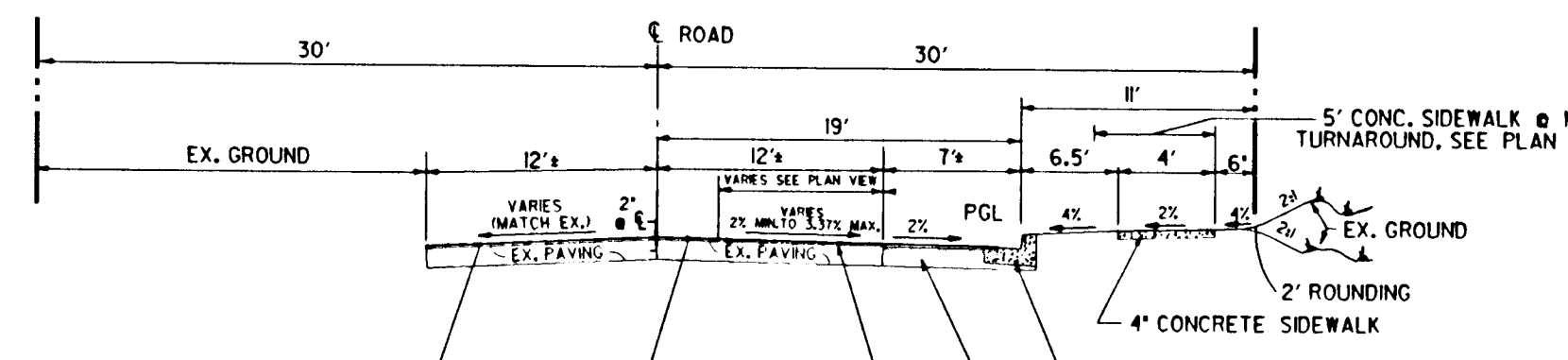

TYPICAL FULL SECTION NO. 3 - 60' R/W

DOBBIN ROAD: STA. 28+75 TO STA. 30+00

NOT TO SCALE
CLASSIFICATION: MAJOR COLLECTOR
DESIGN SPEED: 40 MPH
ZONING: NEW TOWN

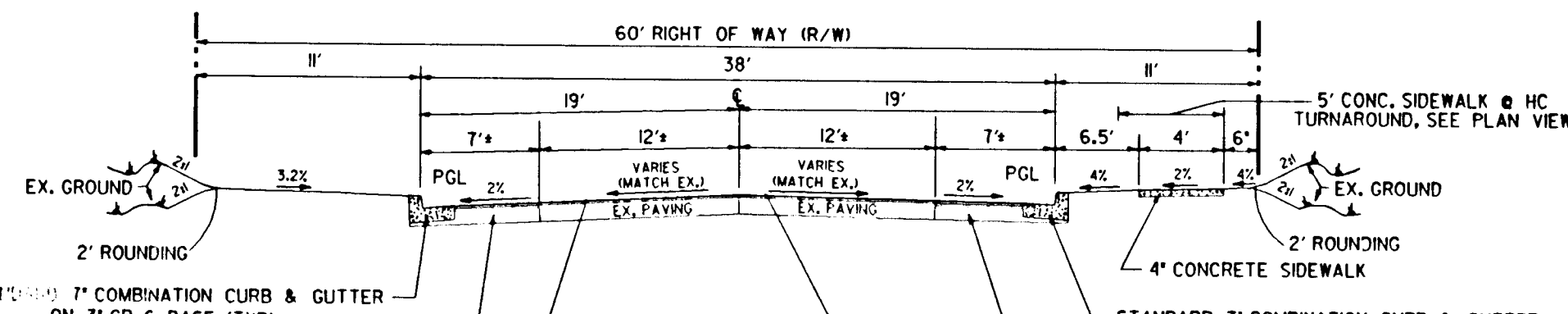

TYPICAL FULL SECTION NO. 4 - 60' R/W

DOBBIN ROAD: STA. 30+75 TO STA. 32+00

NOT TO SCALE
CLASSIFICATION: MAJOR COLLECTOR
DESIGN SPEED: 40 MPH
ZONING: NEW TOWN

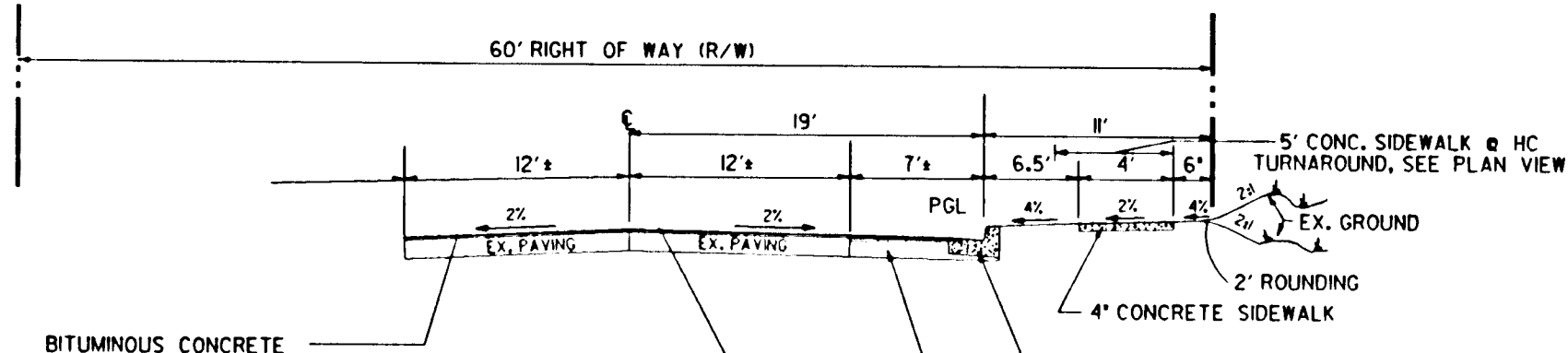

TYPICAL FULL SECTION NO. 5 - 60' R/W

DOBBIN ROAD: STA. 32+00 TO STA. 33+15

NOT TO SCALE
CLASSIFICATION: MAJOR COLLECTOR
DESIGN SPEED: 40 MPH
ZONING: NEW TOWN

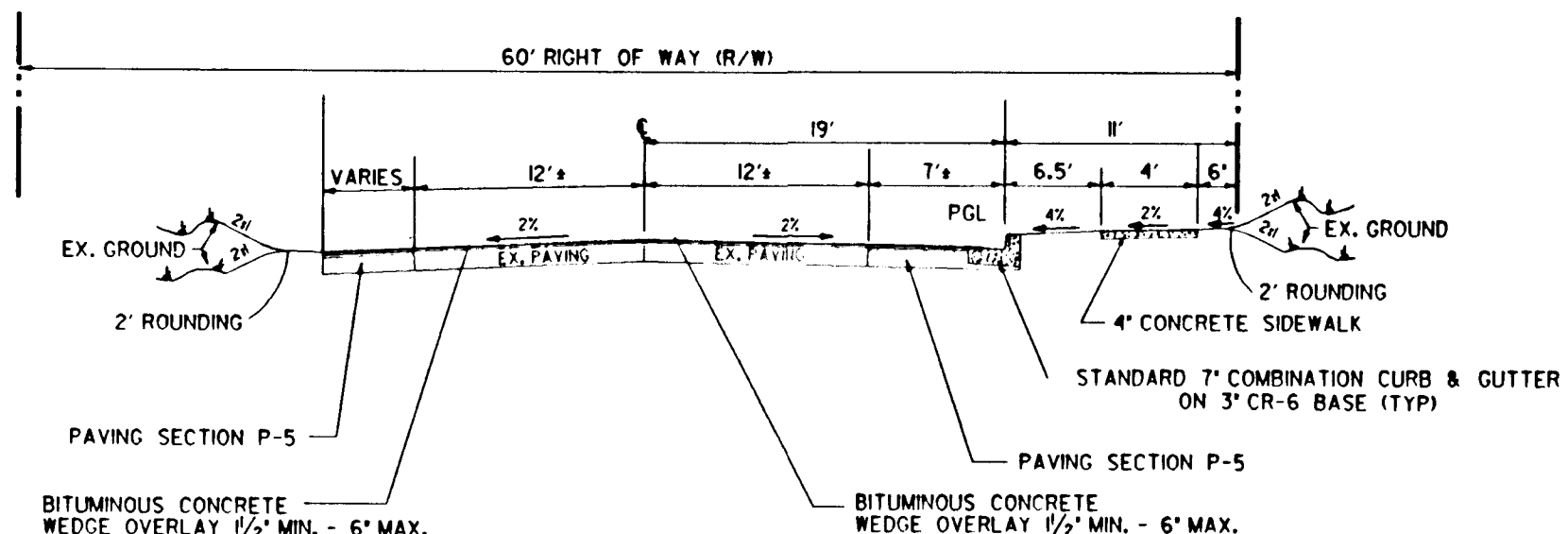

TYPICAL FULL SECTION NO. 6 - 60' R/W

DOBBIN ROAD: STA. 33+15 STA. 33+75

NOT TO SCALE
CLASSIFICATION: MAJOR COLLECTOR
DESIGN SPEED: 40 MPH
ZONING: NEW TOWN

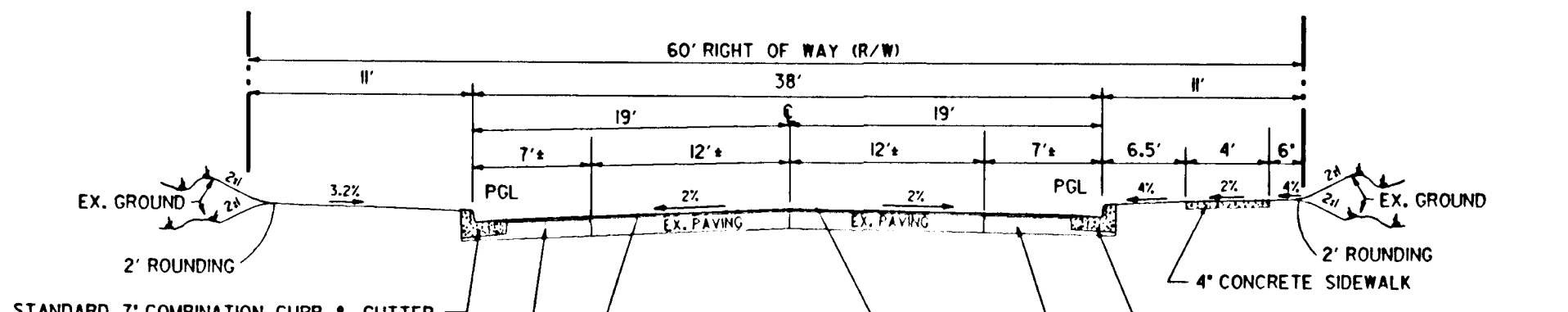

TYPICAL FULL SECTION NO. 7 - 60' R/W

DOBBIN ROAD: STA. 33+75 TO STA. 36+50

NOT TO SCALE
CLASSIFICATION: MAJOR COLLECTOR
DESIGN SPEED: 40 MPH
ZONING: NEW TOWN

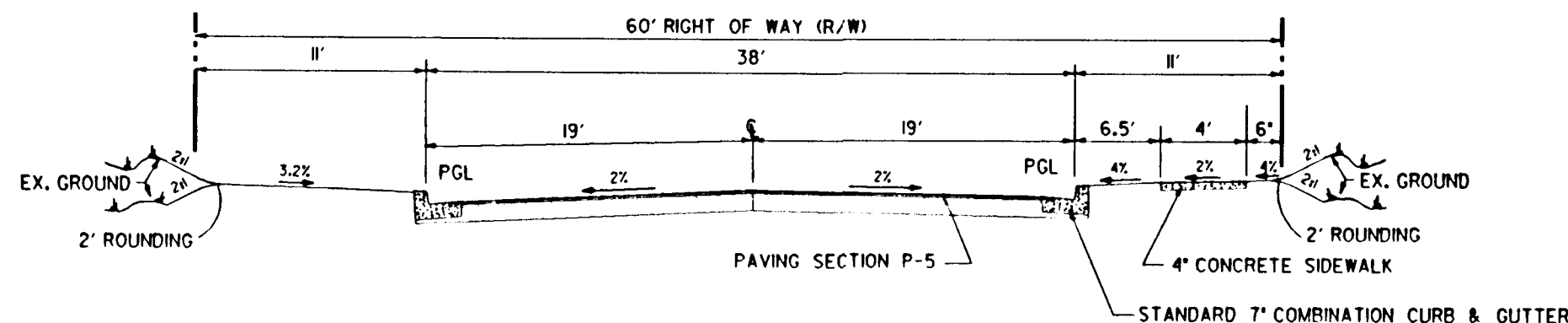

TYPICAL FULL SECTION NO. 8 - 60' R/W

DOBBIN ROAD: STA. 36+50 TO STA. 39+55 & STA. 41+05 TO STA. 44+58.81

NOT TO SCALE
CLASSIFICATION: MAJOR COLLECTOR
DESIGN SPEED: 40 MPH
ZONING: NEW TOWN

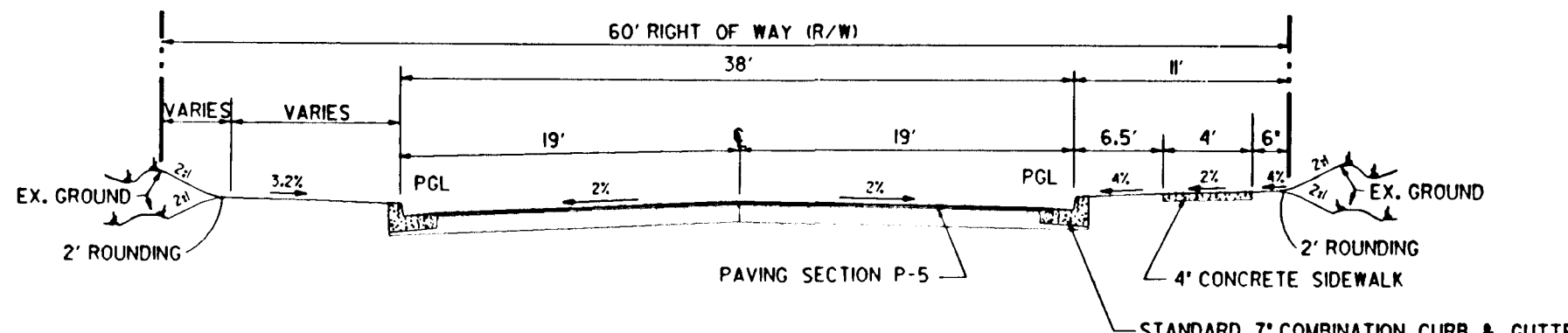

TYPICAL FULL SECTION NO. 9 - 60' R/W

DOBBIN ROAD: STA. 39+55 TO STA. 39+85 & STA. 40+85 TO STA. 41+05

NOT TO SCALE
CLASSIFICATION: MAJOR COLLECTOR
DESIGN SPEED: 40 MPH
ZONING: NEW TOWN

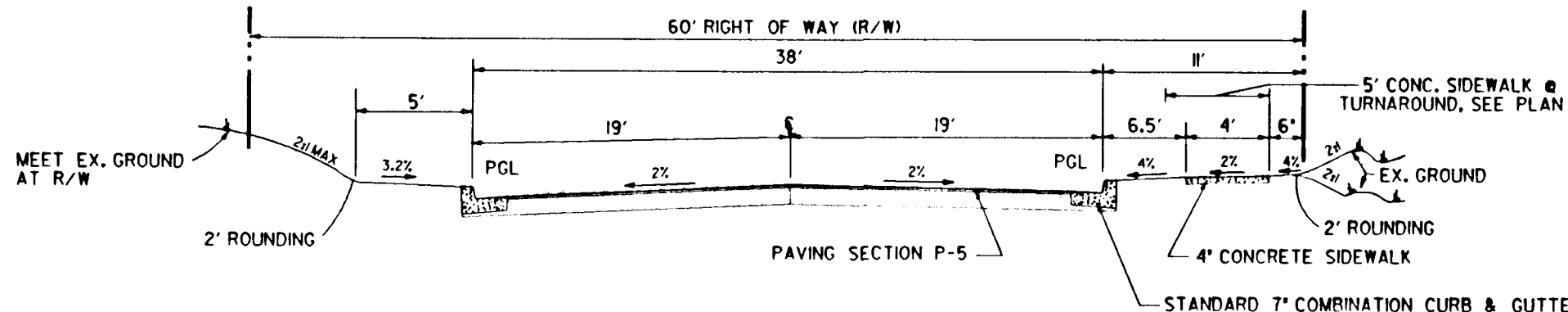

TYPICAL FULL SECTION NO. 10 - 60' R/W

DOBBIN ROAD: STA. 39+85 TO STA. 40+85

NOT TO SCALE
CLASSIFICATION: MAJOR COLLECTOR
DESIGN SPEED: 40 MPH
ZONING: NEW TOWN

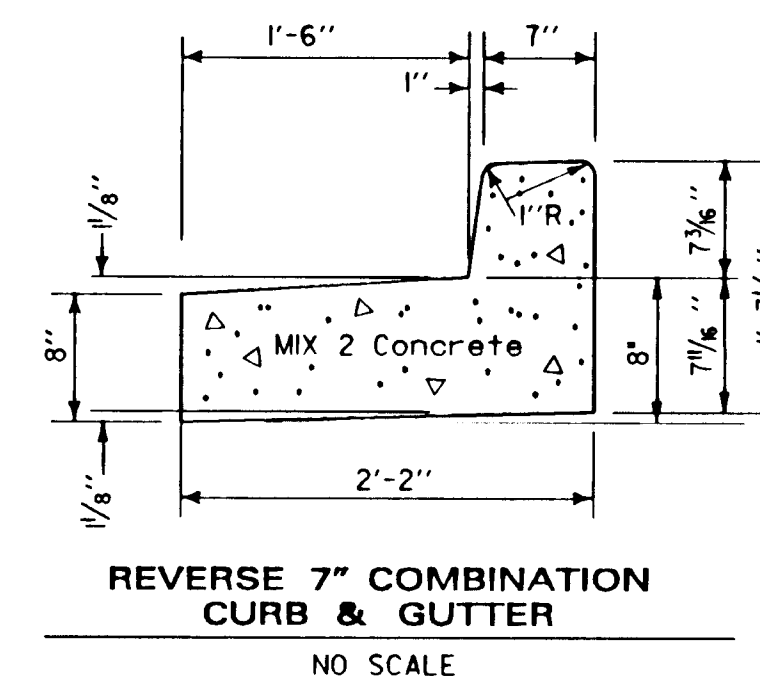

REVERSE 7" COMBINATION CURB & GUTTER

NO SCALE

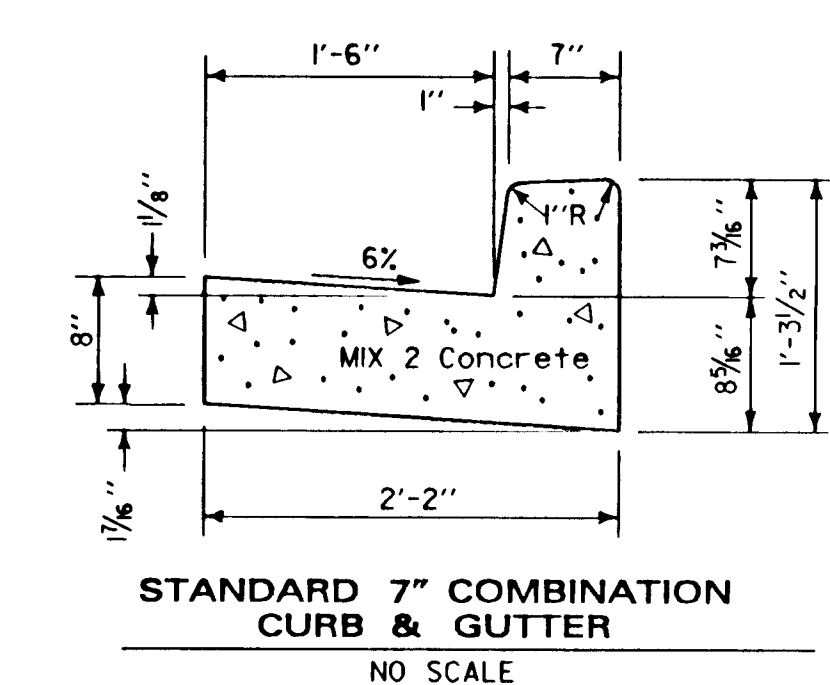

STANDARD 7" COMBINATION CURB & GUTTER

NO SCALE

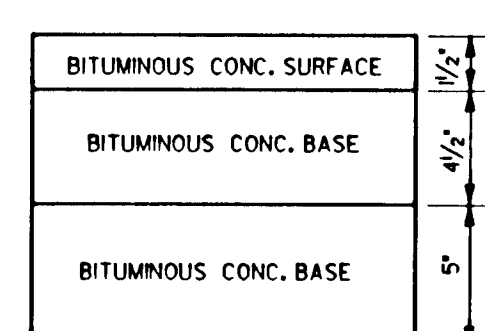

FULL DEPTH ALTERNATE

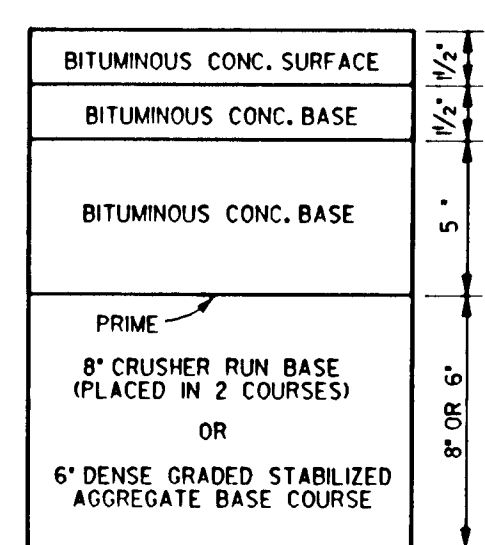

GRANULAR BASE ALTERNATE

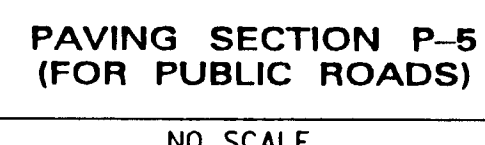

PAVING SECTION P-5 (FOR PUBLIC ROADS)

NO SCALE

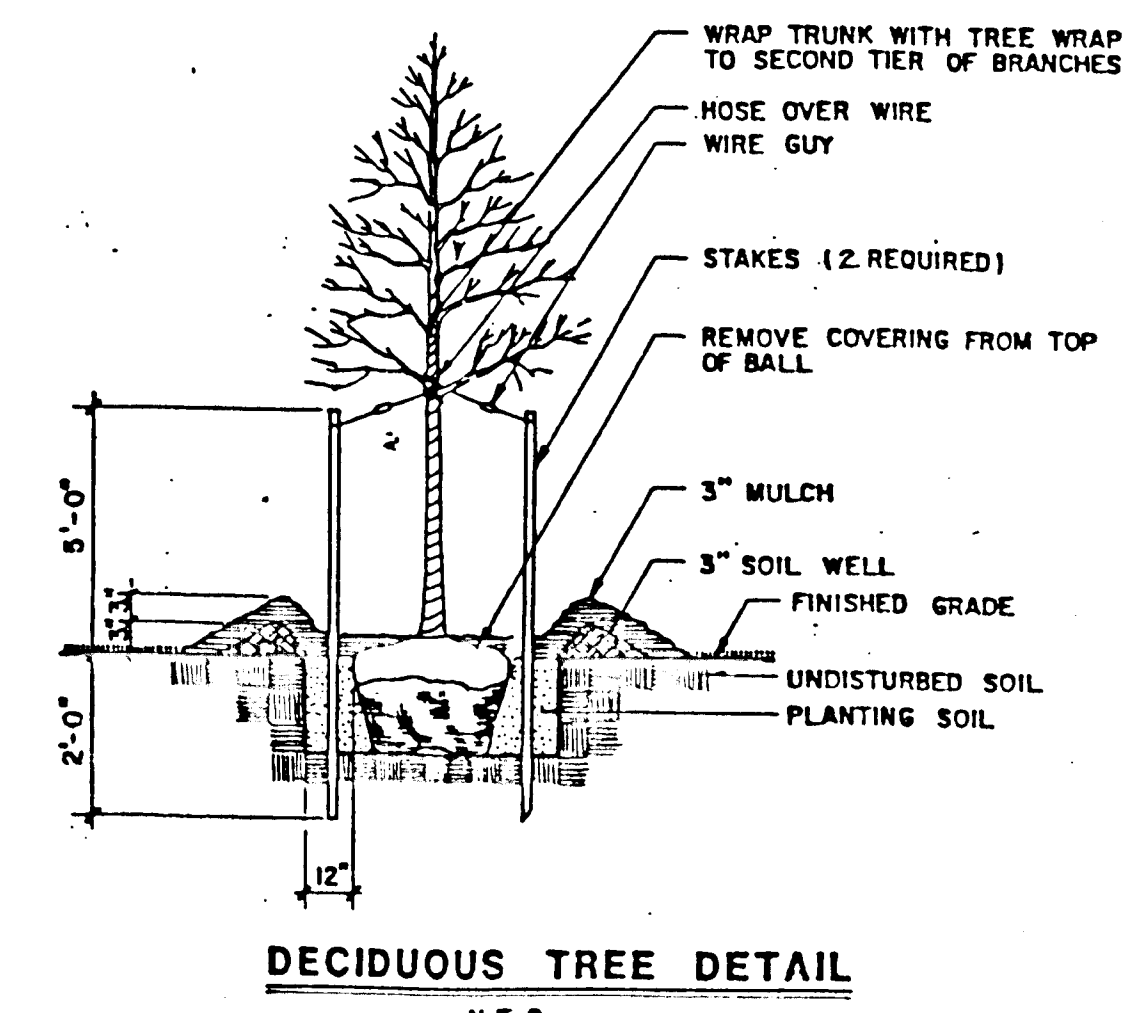

DECIDUOUS TREE DETAIL

N.T.S.

APPROVED: HOWARD COUNTY DEPT. OF PUBLIC WORKS
Andrew M. Daniels 5-17-94
 CHIEF, BUREAU OF HIGHWAYS HS DATE
Paul J. Sporn 5/23/94
 CHIEF, BUREAU OF ENGINEERING DATE
John J. ... 5/10/94
 CHIEF, LAND DEVELOPMENT DIVISION DATE
 APPROVED: HOWARD COUNTY DEPT. OF PLANNING AND ZONING
Dana ... 5/31/94
 CHIEF, LAND DEVELOPMENT AND RESEARCH DATE

LONGREACH - EASTERN HIGH SCHOOL
 SECTION 3 AREA 2
 OWNER /DEVELOPER:
 HOWARD COUNTY PUBLIC SCHOOL SYSTEM
 10910 RT.108
 ELLICOTT CITY, MARYLAND 21042-6198

DMW
 DeWitt-McCune-Walker, Inc.
 200 East Pennsylvania Avenue
 Towson, Maryland 21286
 (410) 294-3333
 Fax 294-4708
 A Team of Land Planners, Landscape Architects, Engineers, Surveyors & Environmental Professionals

5-5-94
 Date

 Professional Engr. No. 16998

AREA VLR-SECTION 3 AREA 2
 TAX MAP 36 PARCEL 2571
 6TH ELECTION DISTRICT OF HOWARD COUNTY, MARYLAND
 TITLE
DOBBIN ROAD ROAD CONSTRUCTION DETAILS
 Des By MAT Scale AS SHOWN Proj. No. 92087-A
 Dm By DMA Date 1-17-94
 Chk By LWW Approved 4 OF 10

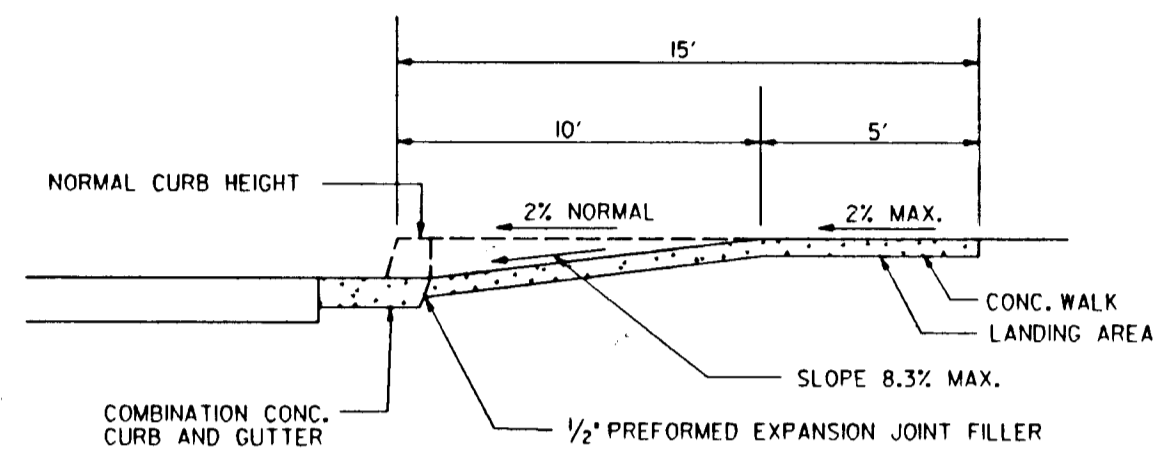
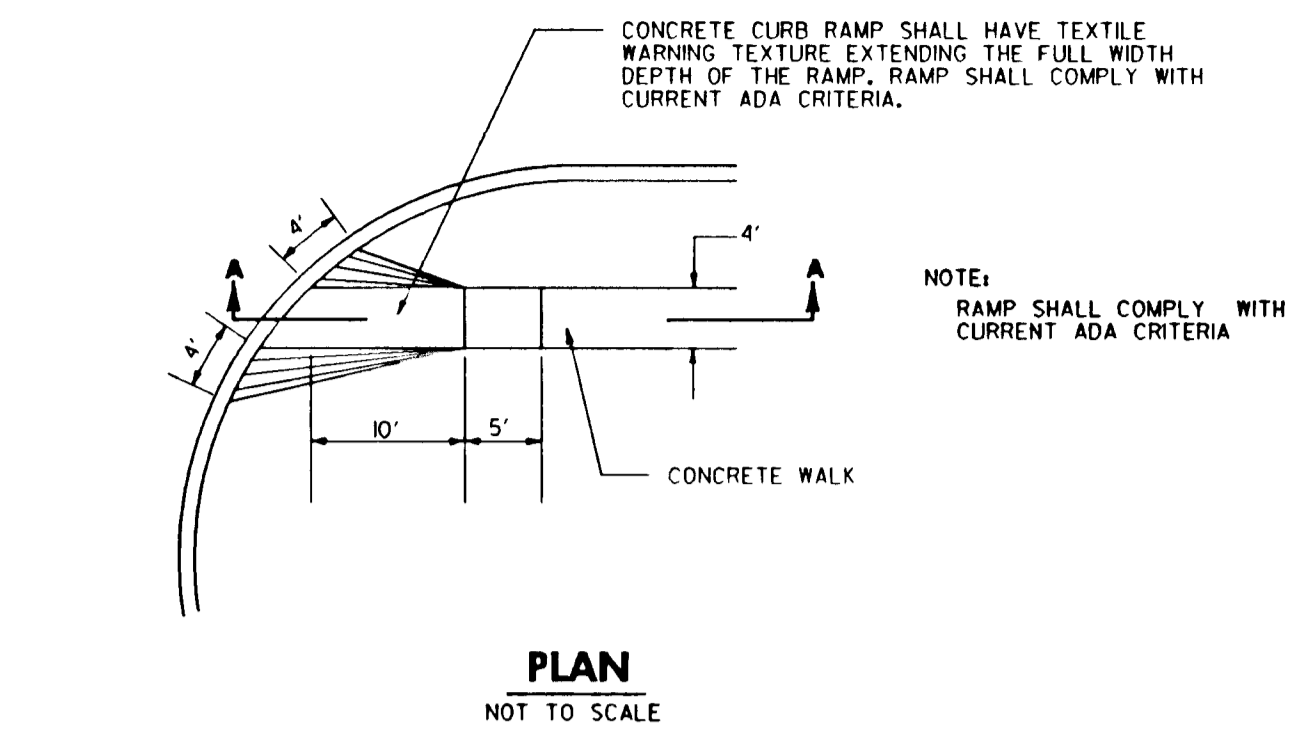

SURFACE TEXTURE OF CONCRETE RAMP SHALL BE COARSE BROOMING OR OTHER NON-SKID TYPE FINISH.

SECTION A-A
NOT TO SCALE

MODIFIED HANDICAPPED RAMP

RAMP SHALL COMPLY WITH ADA CRITERIA

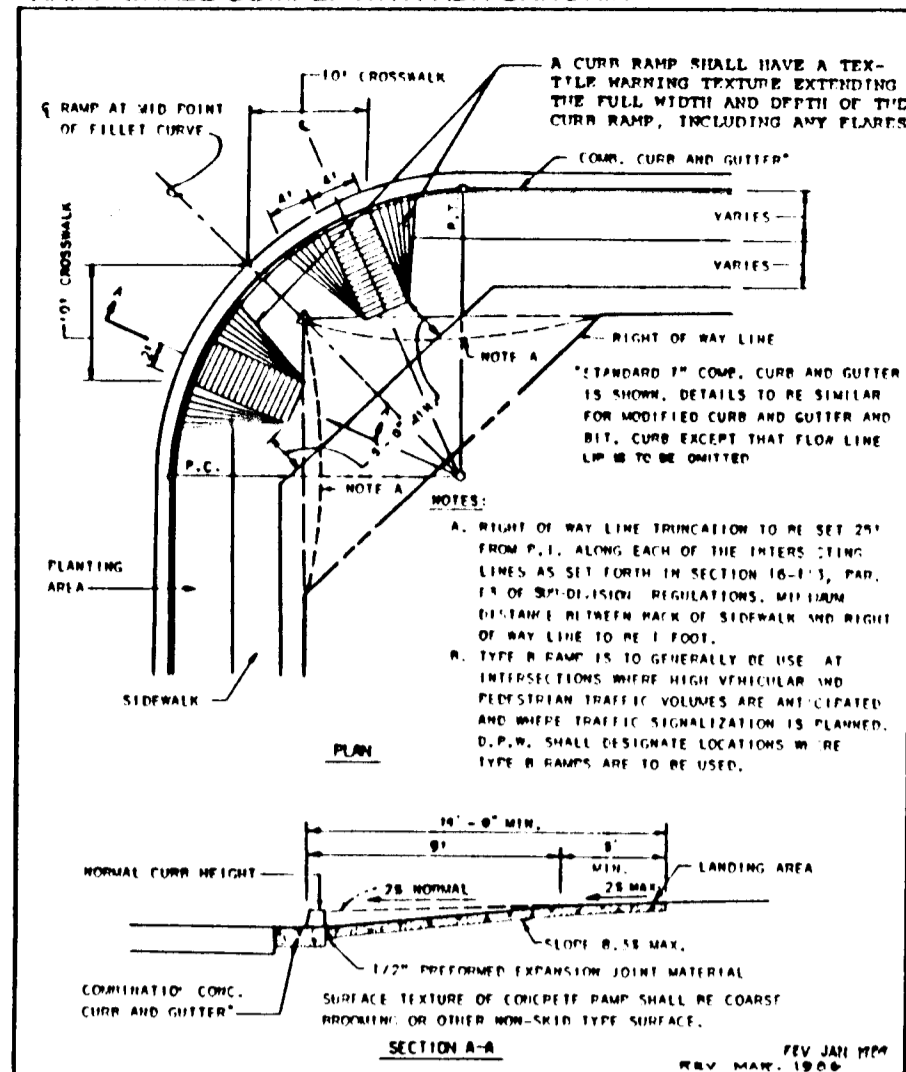

**HOWARD CO. STD. DETAIL R-4.02
TYPE B SIDEWALK RAMP**

NOT TO SCALE

RAMP SHALL COMPLY WITH ADA CRITERIA

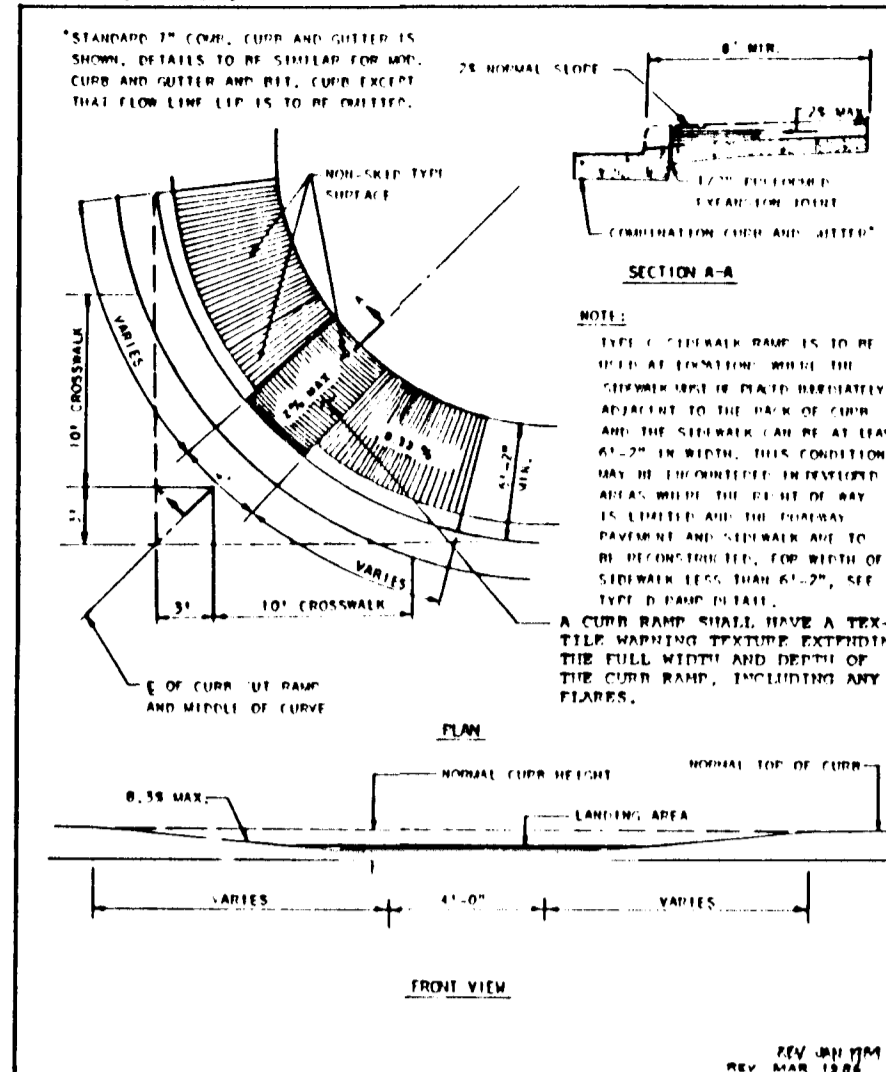

**HOWARD CO. STD. DETAIL R-4.03
TYPE C SIDEWALK RAMP**

NOT TO SCALE

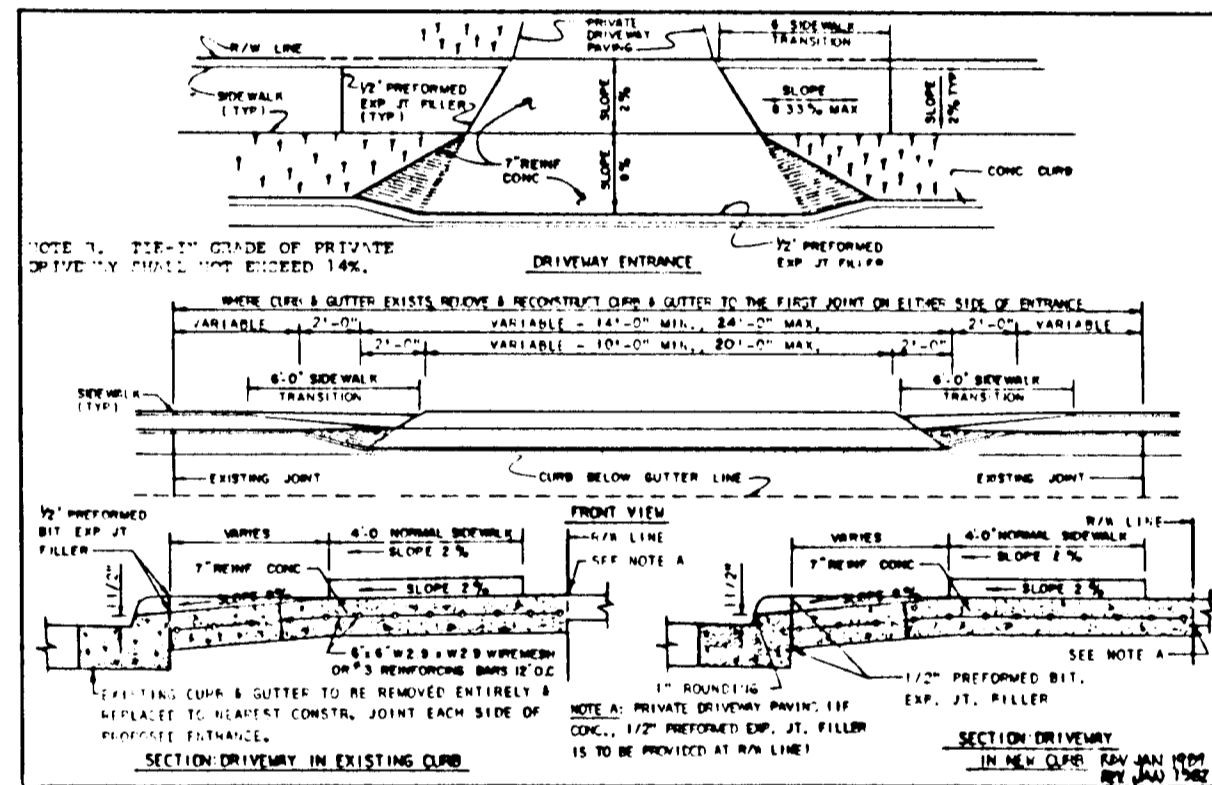

**HOWARD CO. STD. DETAIL R-6.01
DRIVEWAY ENTRANCE**

NOT TO SCALE

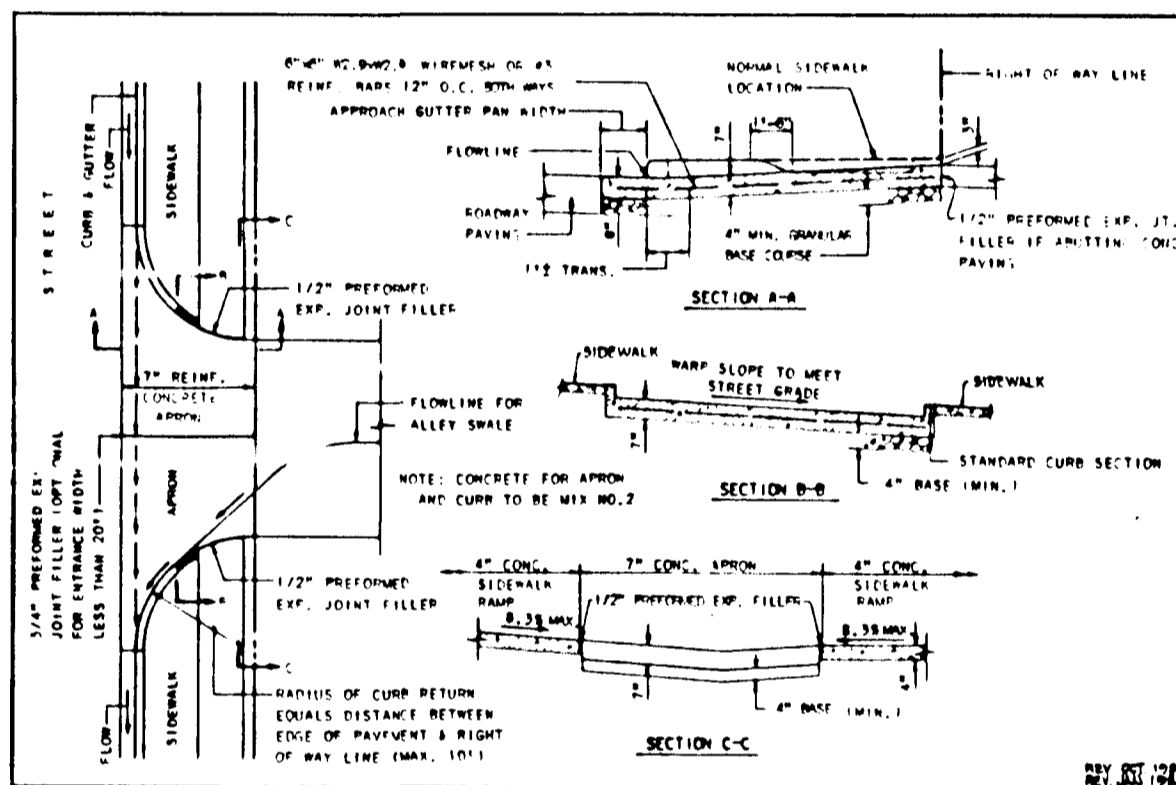

**HOWARD CO. STD. DETAIL R-6.10
CONC. APRON FOR COMMERCIAL ENTRANCE**

NOT TO SCALE

APPROVED: HOWARD COUNTY DEPT. OF PUBLIC WORKS
Andrew M. Conker 5-17-94
 CHIEF, BUREAU OF HIGHWAYS
Paul R. Brown 5/23/94
 CHIEF, BUREAU OF ENGINEERING
John P. Brown 5/20/94
 CHIEF, LAND DEVELOPMENT DIVISION

APPROVED: HOWARD COUNTY DEPT. OF PLANNING AND ZONING
Jim Summons 5/11/94
 CHIEF, DIVISION OF COMMUNITY PLANNING & LAND DEVELOPMENT

Date	No.	Revision Description

EASTERN HIGH SCHOOL

OWNER /DEVELOPER:
 HOWARD COUNTY PUBLIC SCHOOL SYSTEM
 10910 RT.108
 ELLICOTT CITY, MARYLAND 21042-6198

IDENTAT
 D. M. & C. W. WALKER, INC.
 200 East Pennsylvania Avenue
 Towson, Maryland 21286
 (410) 284-3333
 Fax 284-4708
 A Team of Land Planners,
 Landscape Architects,
 Engineers, Surveyors &
 Environmental Professionals

AREA
 SECTION 3 AREA 2
 TAX MAP 36 PARCEL 371
 8th ELECTION DISTRICT OF HOWARD COUNTY, MARYLAND
 TITLE
COBBIN ROAD
ROAD CONSTRUCTION DETAILS

Des By	MAT	Scale	AS SHOWN	Proj. No.	92087A
Dwn By	DMA	Date	1-12-94		
Chk By	LWW	Approved			5 OF 13

5-5-94
 Date

 Professional Engr. No. 16998

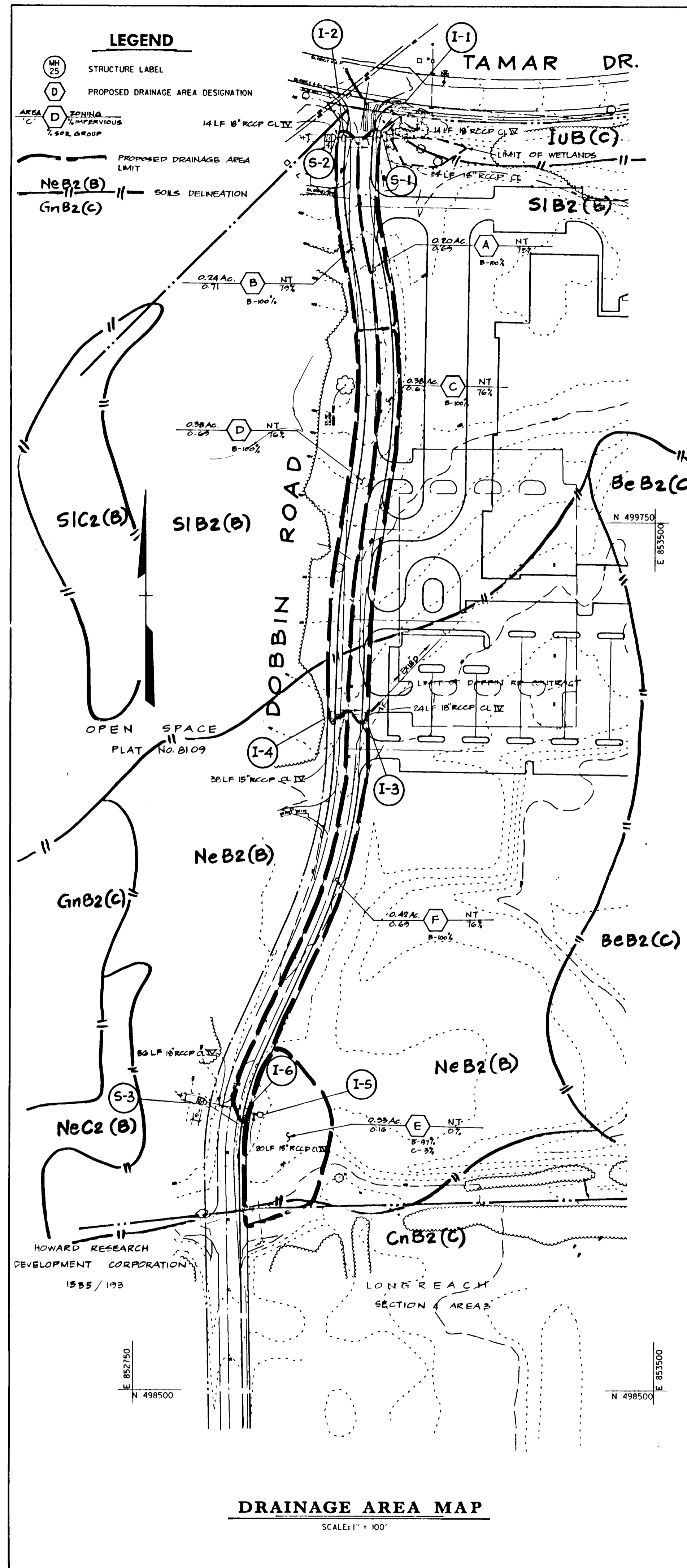

DRAINAGE AREA MAP
SCALE: 1" = 100'

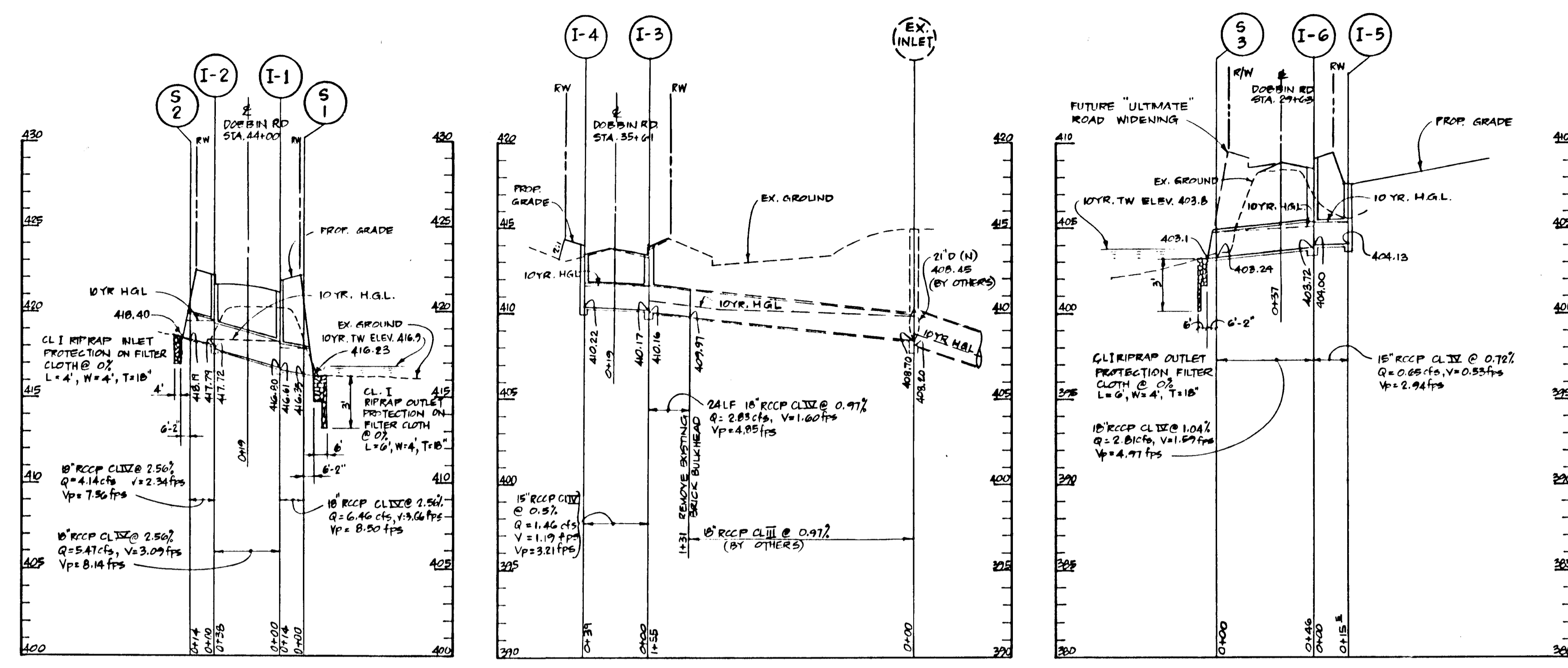

STORM DRAIN PROFILE
SCALE: HOR. 1" = 30'
VERT. 1" = 5'

INLET SCHEDULE

NO.	TYPE	INV. OUT.	TOP ELEV.	DETAIL NO.	LOCATION
1	A-5	412.61	421.71	HO. CO. SD 4.01	CL STA 44+00 13.0' RT
2	A-5	417.79	422.17	HO. CO. SD 4.01	CL STA 44+00 19.0' LT
3	A-10	410.16	414.10	HO. CO. SD 4.02	CL STA 55+61 19.0' RT
4	A-10	410.22	414.01	HO. CO. SD 4.02	CL STA 55+61 19.0' LT
5	YARD INLET	404.00	407.70	HO. CO. SD 4.14	CL STA 29+64 39.0' RT
6	A-5	403.78	408.58	HO. CO. SD 4.01	CL STA 29+63 19.0' RT

STRUCTURE SCHEDULE

NO.	TYPE	INV. OUT.	TOP ELEV.	DETAIL NO.	LOCATION
1	CONC. END SECTION	416.33	---	HO. CO. SD 5.51	CL STA 44+05 32' RT
2	CONC. END SECTION	418.40	---	HO. CO. SD 5.51	CL STA 44+00 33' LT
3	CONC. END SECTION	405.24	---	HO. CO. SD 5.51	CL STA 29+63 23' LT

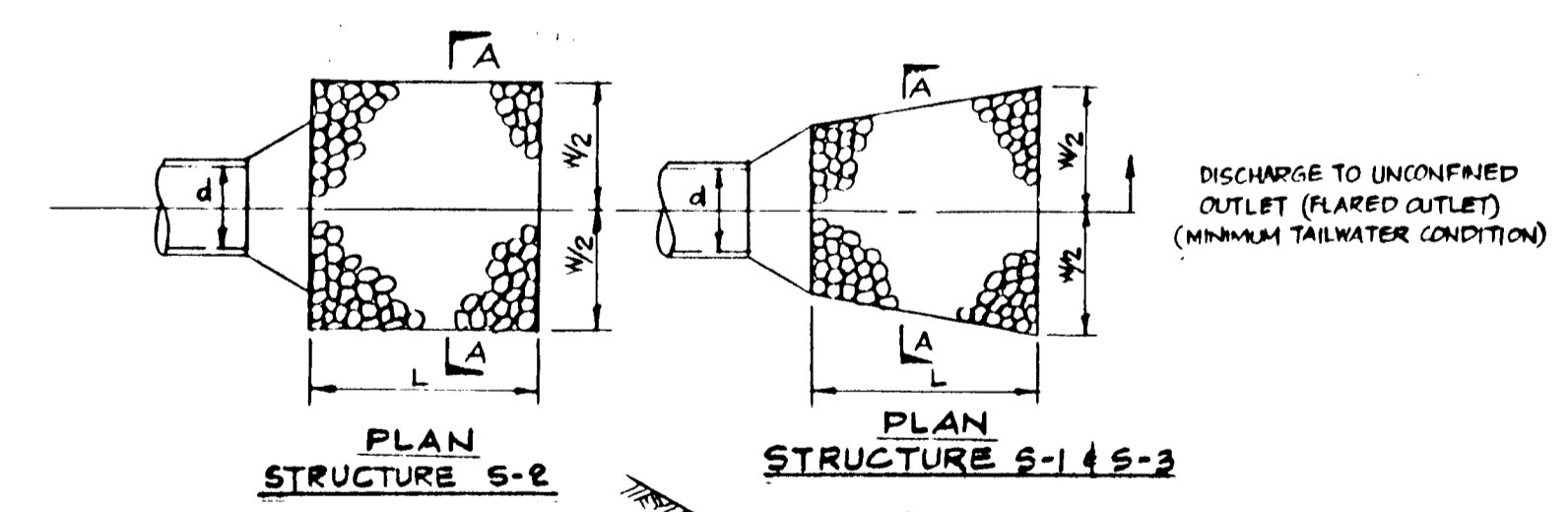

STRUCTURE No.	L (ft)	W (ft)	T (ft)
S-1	6	4	18
S-2	4	4	18
S-3	6	4	18

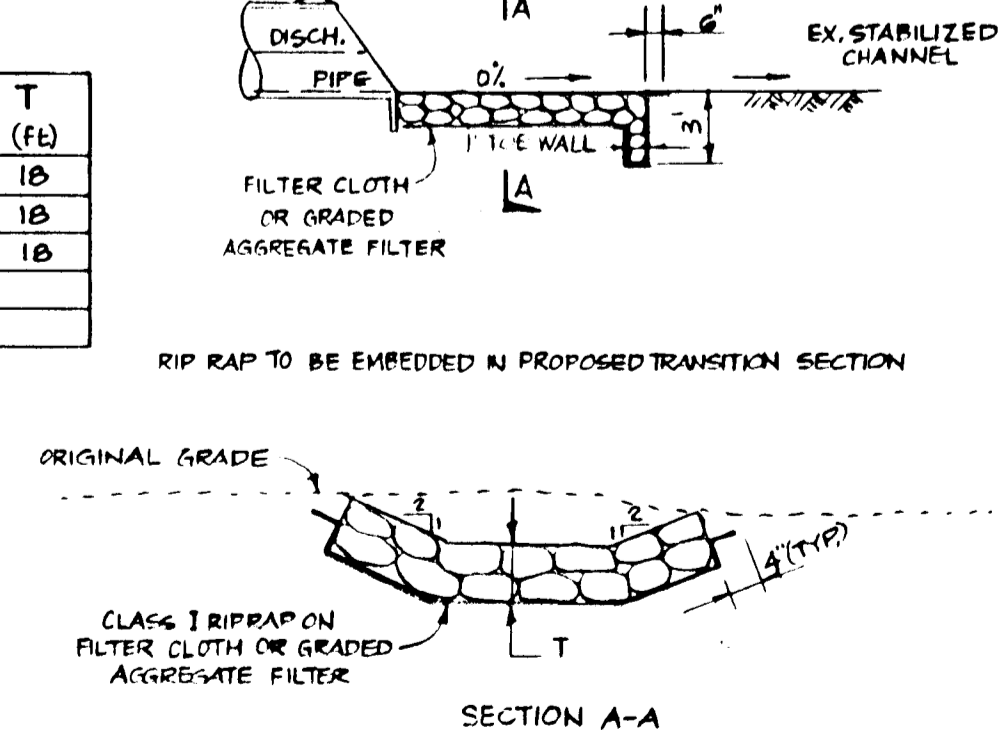

RIP RAP OUTLET PROTECTION
NO SCALE

APPROVED: HOWARD COUNTY DEPT. OF PUBLIC WORKS

Andrew M. Doucker 5/17/94
CHIEF, BUREAU OF HIGHWAYS HS DATE

Paul J. Eason 5/23/94
CHIEF, BUREAU OF ENGINEERING DATE

John Deane 5/18/94
CHIEF, LAND DEVELOPMENT DIVISION DATE

APPROVED: HOWARD COUNTY DEPT. OF PLANNING AND ZONING

Uma Strumant 5/31/94
CHIEF, DIVISION OF COMMUNITY PLANNING & LAND DEVELOPMENT DATE

Date	No.	Revision Description
5/24/94	1	REVISED STORM DRAIN PROFILE, INLET SCHEDULE, AND STRUCTURE SCHEDULE

LONGREACH - EASTERN HIGH SCHOOL SECTION 3 AREA 2

OWNER / DEVELOPER:
HOWARD COUNTY PUBLIC SCHOOL SYSTEM
10910 RT. 108
ELLICOTT CITY, MARYLAND 21042-6198

5.5.94
Date

Professional Engr. No. 16998

DMW
Daft · McCune · Walker, Inc.
A Team of Land Planners, Landscape Architects, Engineers, Surveyors & Environmental Professionals
200 East Pennsylvania Avenue
Towson, Maryland 21286
410.296.3333
Fax 296.4705

AREA: **VILLAGE OF LONGREACH SECTION 3 AREA 2**
TAX MAP 36 PARCEL 371
6th ELECTION DISTRICT OF HOWARD COUNTY, MARYLAND

TITLE: **DRAINAGE AREA MAP & STORM DRAIN PROFILES**

Des By *UJ/JG* Scale AS SHOWN Proj. No. 9208T-A
Drn By *DS* Date 1-17-94
Chk By *LW* Approved 6 OF 13

100

GENERAL SEQUENCE OF CONSTRUCTION

1. Obtain road construction permit
2. Install tree protection fences and complete recommended actions.
3. Construct perimeter sediment controls along western and eastern limits of work. This shall not interfere with traffic on road.
4. Any grading that can be done outside of roadway should be accomplished.
5. Signs should be installed along approach roadways several weeks prior to construction notifying commuters of disruption.
6. Barricades and traffic maintenance devices should be erected and road construction begins.
7. Begin grading of roadway.
8. Install storm drains and outlet protection. Stabilize those areas.
9. Begin installing subbase and curb and gutter construction.
10. Begin base paving.
11. Begin overlays at south end of roadway.
12. Install traffic signal detectors, crossing signalization and crosswalk improvements.
13. Fine grade shoulder areas along west side of roadway. Stabilize both shoulder areas.
14. Install stabilized construction entrances into school site.
15. Stripe roadway, install signage and open for traffic.
16. Install street lights as soon as feasible.
17. At completion of school construction, complete final paving and striping.
18. Remove sediment controls and tree protection.

TAMAR DRIVE

Existing 48 inch caliper beech tree is located in this vicinity. Contractor to install both blaze orange safety fence and snow fence around the tree perimeter as directed by the Engineer. See Sheet 20 of 20 for details of tree protection fence. Contractor shall erect signs, approved by Engineer, prohibiting any vehicular or pedestrian traffic within the fenced area of the tree protection zone. Prior to grading for the road improvements, contractor shall root prune approximately 3 feet behind (west of) the existing Dobbin Road shoulder for the entire length of the tree's crown that extends under the dripline. Proposed grading for Dobbin Road shall not extend closer than 22 feet from the eastern side of the trunk of the tree. Contractor shall eliminate the fescue grasses with the tree drip line and core aerate, by hand methods, the tree root zone impacted by the fescue turf. The area under the drip line shall then be mulched with well composted hardwood mulch. Contractor shall maintain tree protective measures and mulch during the entire contract period. Any disturbance or damage to the tree is to be reported immediately to the Engineer. All work performed on beech tree shall be done by tree experts licensed by the Maryland Department of Natural Resources.

Construction of Dobbin Road to be accomplished by contractor selected for high school construction project. For bidding purposes, the work required to construct Dobbin Road will be bid as Bid Alternate No. 1. This is being done to facilitate the negotiations between the Howard County Public School System and others. The work on Dobbin Road will be integrated into the overall sequence for the project and will not be constructed as a separate entity. However, for the purposes of plan approval within the Department of Public Works, a separate set of public road construction drawings has been prepared (County # F-94-74). No differentiation has been made on this site plan between the two phases except a Limit of Work line that approximately follows the easterly right-of-way line of Dobbin. See the sediment and erosion control sheets within this set of drawings for a detailed list of exclusions and additions in the scope of work for Bid Alternate No. 1 as it applies to the sediment control. The sediment control plans and other sheets of the SDP (F-94-76) set have been included in this public road plan as reference drawings. A sequence of construction is included within that set for the Dobbin Road construction.

Construction of improvements to Dobbin Road and Tamar Drive intersection shall be as shown on the Traffic Plan drawings included in this plan set. Modifications to the pedestrian crossing signalizations will be made as well as sidewalk improvements along Dobbin Road. Sidewalk will extend the full length of the Dobbin Road construction and will connect with the future improvements at the Village of Longreach to the south. The Traffic Plan shall also include the striping and maintenance of traffic plan for the roadway. Two existing gravel driveways on the west side of Dobbin will have improved entrance capabilities constructed under this contract. The allowable time period for closing of Dobbin Road shall be eight weeks. During that time the grading, subbase and base paving shall be accomplished. Curb and gutter construction as well as the cross culverts and closed conduit storm drain system must also be completed. Contractor shall complete all improvements necessary to insure the safe operation of the roadway at the end of the eight week period. Other improvements will be made at other times, such as sidewalk construction, street light installation, street trees and final seeding and stabilization.

Design and details of the storm drain system in Dobbin Road are included in these public road drawings (F-94-74). Notations on SDP 94-76 for connection of this system to Inlet # 17 presume construction of the on-site system before the road drainage system. Due to the sequencing of the project, Dobbin Road construction may precede the construction of the on-site system. See the sediment and erosion control plans within this set of drawings for the exclusions and additions in the scope of work that pertain to the storm drainage system. The quantities of materials in the Bid Alternate #1 will allow the construction of a stabilized outfall from the in-road drainage system to a point east of Dobbin Road. This pipe can then be abandoned and connected to Inlet #17 when that system is finalized. The two other cross-culverts shown as part of F-94-74 are stand alone structures and are shown on the SDP for clarity. Outfall structure S3 and End section S2 will require easements prior to construction. The construction of the outfall structure S1 will require a Letter of Exemption from MDE for work in a wetland buffer. A Notice of Intent (NOI) form has been submitted to Howard County DPW for processing with MDE/SSA.

Centerline profile grades between Stations 27+00 and 36+50 that are shown in profile are approximate due to intent to match existing grades in the overlay phase of the road reconstruction/construction. Because of the detail of the proposed and existing elevations given, no vertical curve information is shown.

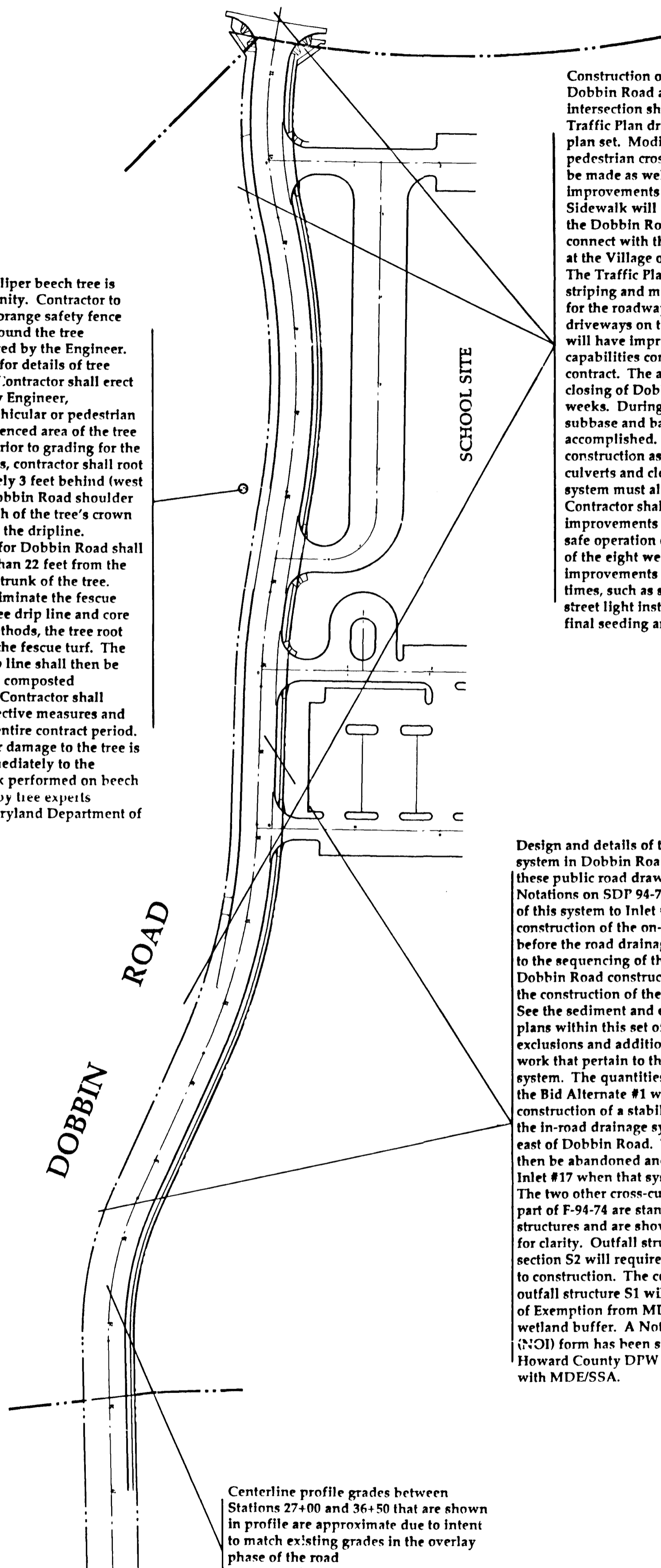

APPROVED: HOWARD COUNTY DEPT. OF PUBLIC WORKS	
<i>Andrew M. Conner</i> CHIEF, BUREAU OF HIGHWAYS	5-17-94 DATE
<i>Paul J. Ryan</i> CHIEF, BUREAU OF ENGINEERING	5/23/94 DATE
<i>John D. ...</i> CHIEF, LAND DEVELOPMENT DIVISION	5/23/94 DATE
APPROVED: HOWARD COUNTY DEPT. OF PLANNING AND ZONING	
<i>John ...</i> CHIEF, DIVISION OF LAND DEVELOPMENT & RESEARCH	5/23/94 DATE
Date	Revision Description
LONGREACH - EASTERN HIGH SCHOOL	
SECTION 3 AREA 2	
OWNER /DEVELOPER:	
HOWARD COUNTY PUBLIC SCHOOL SYSTEM	
10910 RT.108	
ELLCOTT CITY, MARYLAND 21042-6198	
Daft McCune Walker, Inc.	
A Team of Land Planners, Landscape Architects, Engineers, Surveyors & Environmental Professionals	
200 East Pennsylvania Avenue, Towson, Maryland 21286 410 296 3333 Fax: 296 4705	
AREA	VILLAGE OF LONGREACH
	SECTION 3 AREA 2
	TAX MAP 36 PARCEL 371
	6TH ELECTION DISTRICT OF HOWARD COUNTY, MARYLAND
TITLE	DOBBIAN ROAD - NOTES & SEQUENCES
Des By	MAT Scale AS SHOWN Proj. No. 92087-A
Drn By	MAT Date 1-17-94 13
Chk By	LWW Approved 7 OF 8

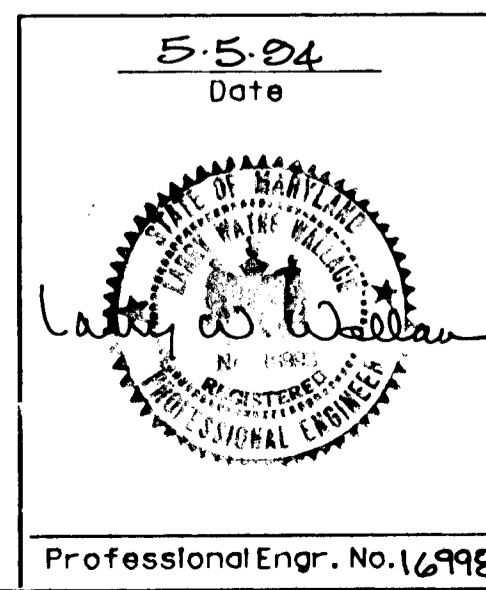

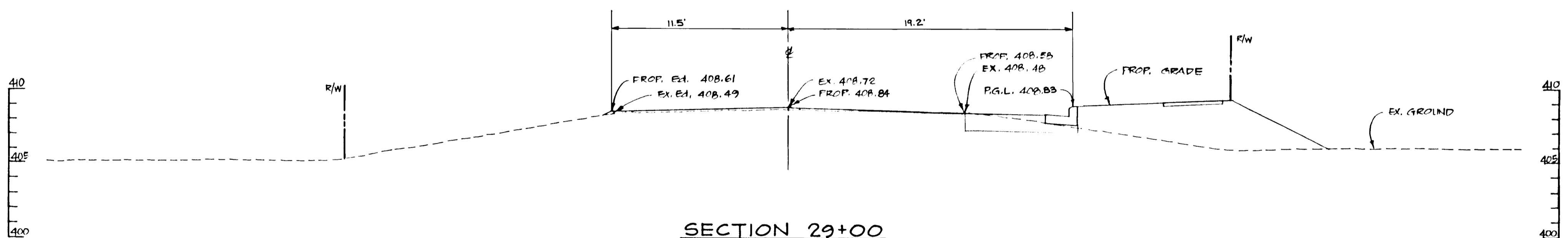
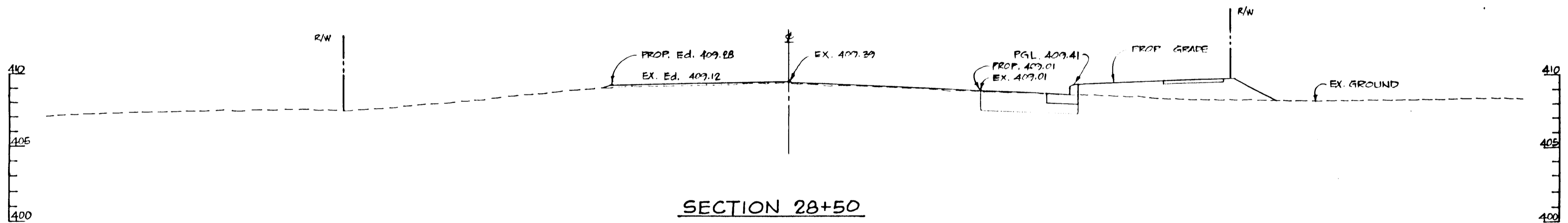
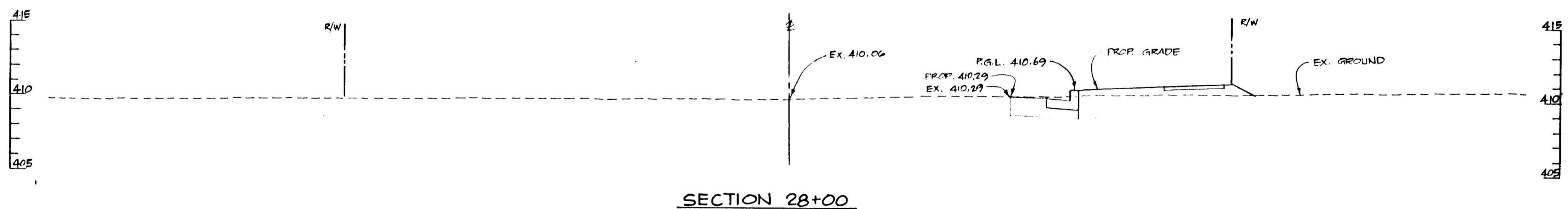
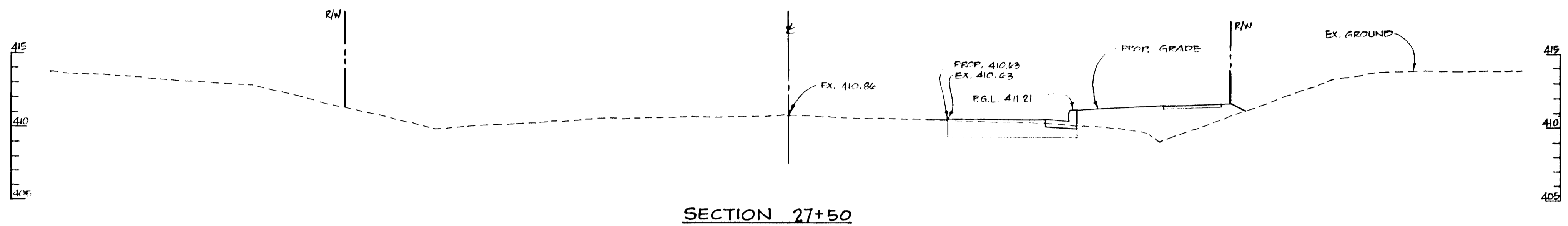

APPROVED: HOWARD COUNTY DEPT. OF PUBLIC WORKS
Richard M. Dunster 5-17-94
 CHIEF, BUREAU OF HIGHWAYS 1/2 DATE

Paul W. Brown 5/23/94
 CHIEF, BUREAU OF ENGINEERING DATE

John P. Brown 5/24/94
 CHIEF, LAND DEVELOPMENT DIVISION DATE

APPROVED: HOWARD COUNTY DEPT. OF PLANNING AND ZONING
Uma Swinney 5/31/94
 CHIEF, LAND DEVELOPMENT AND RESEARCH DATE

Date	No.	Revision Description
3/25/94	1	REVISED SECTION 29+00

LONGREACH - EASTERN HIGH SCHOOL
SECTION 3 AREA 2

OWNER /DEVELOPER:
 HOWARD COUNTY PUBLIC SCHOOL SYSTEM
 10910 RT.109
 ELLICOTT CITY, MARYLAND 21042-6198

DMW
 Deak McCune-Walker, Inc.
 200 East Pennsylvania Avenue
 Towson, Maryland 21286
 (410) 296-3225
 Fax 296-4706

A Team of Land Planners,
 Landscape Architects,
 Engineers, Surveyors &
 Environmental Professionals

5-5-94
 Date

Larry W. Walker

Professional Engr. No. 16998

AREA	VILLAGE OF LONGREACH SECTION 3 AREA 2 TAX MAP 36 PARCEL 371 6TH ELECTION DISTRICT OF HOWARD COUNTY, MARYLAND	
TITLE	DOBBIN ROAD ROAD CROSS SECTIONS	
Des By	M.A.T.	Scale : 1" = 5'
Drn By	D.B.S.	Date 02/24/94
Chk By	Approved	Prj. No. 82387-A
		8 OF 13

F94-74

100

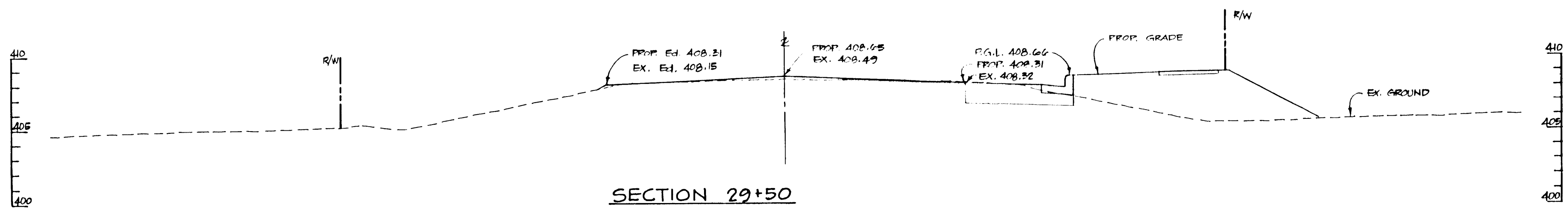

SECTION 29+50

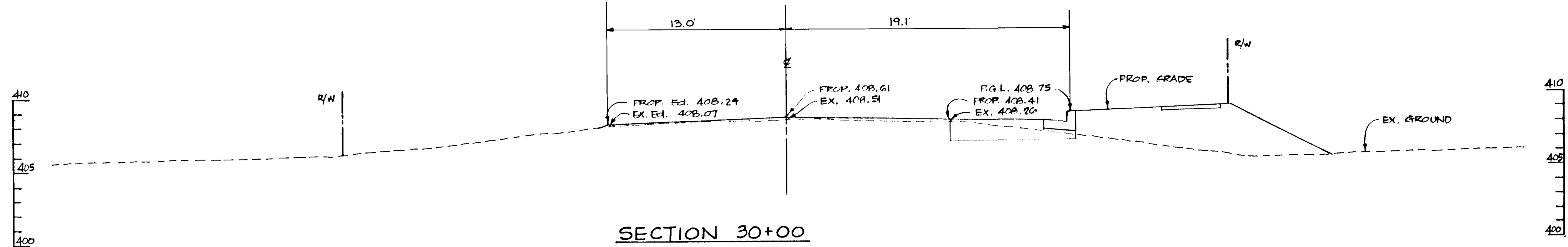

SECTION 30+00

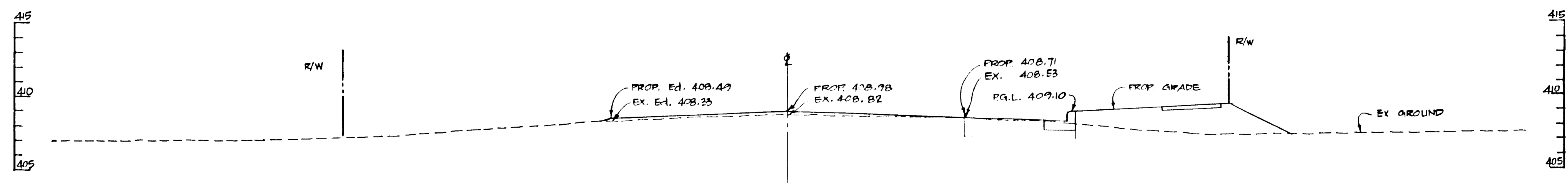

SECTION 30+50

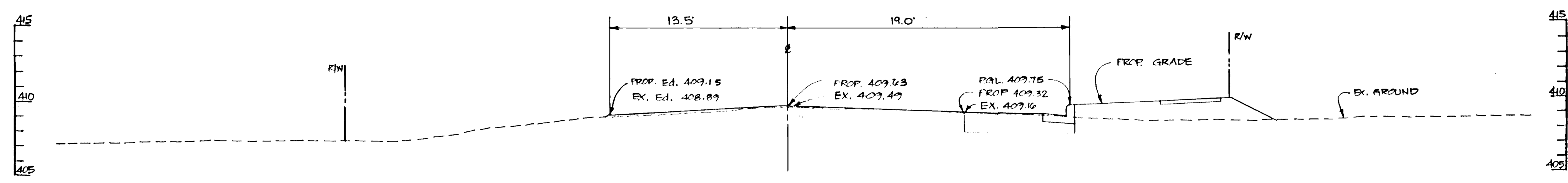

SECTION 31+00

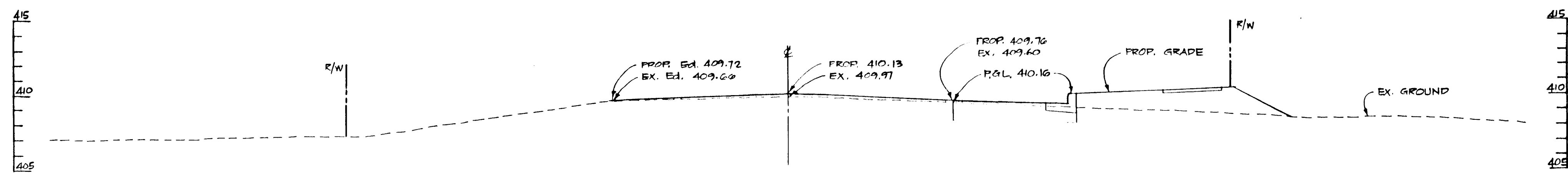

SECTION 31+50

APPROVED: HOWARD COUNTY DEPT. OF PUBLIC WORKS
Richard M. Daniels 5-17-94
 CHIEF, BUREAU OF HIGHWAYS H.S. DATE
Donald E. Spain 5/23/94
 CHIEF, BUREAU OF ENGINEERING DATE
Mark O'Connell 5/23/94
 CHIEF, LAND DEVELOPMENT DIVISION DATE

APPROVED: HOWARD COUNTY DEPT. OF PLANNING AND ZONING
Uma Drummond 5/23/94
 CHIEF, LAND DEVELOPMENT AND RESEARCH J.P. DATE

Date	No.	Revision Description
4/21/94	1	REVISED SECTIONS 30+00 AND 31+50

~~LONGREACH - EASTERN HIGH SCHOOL
 SECTION 3 AREA 2~~
 OWNER /DEVELOPER:
 HOWARD COUNTY PUBLIC SCHOOL SYSTEM
 10910 RT.108
 ELLICOTT CITY, MARYLAND 21042-8198

5-5-94
 Date

 Professional Engr. No. 16993

DMW
 Duff McCune Walker, Inc.
 200 East Pennsylvania Avenue
 Towson, Maryland 21286
 (410) 286-3333
 Fax 286-4705
 A Team of Land Planners,
 Landscape Architects,
 Engineers, Surveyors &
 Environmental Professionals

AREA **VILLAGE OF LONGREACH**
 SECTION 3 AREA 2
 TAX MAP 36 PARCEL 371
 8TH ELECTION DISTRICT OF HOWARD COUNTY, MARYLAND

TITLE **DOBBIN ROAD** 5/23/94
ROAD CROSS SECTIONS 31 MARCH 94

Des By	M.A.T.	Scale	1" = 5'	Proj. No.	92087-A
Dm By	D.B.S.	Date	02/24/94		9 OF 13
Chk By		Approved			

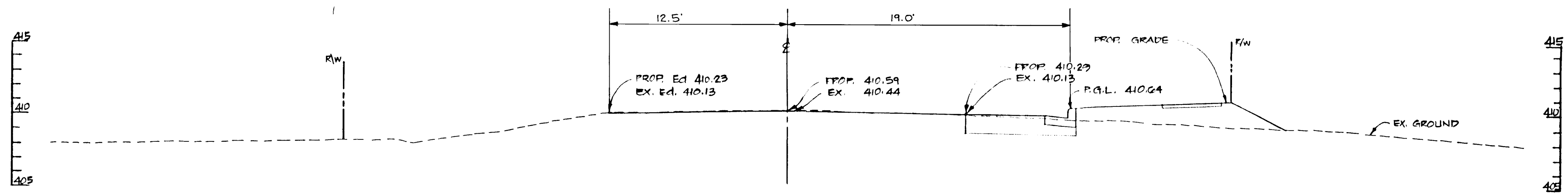

SECTION 32+00

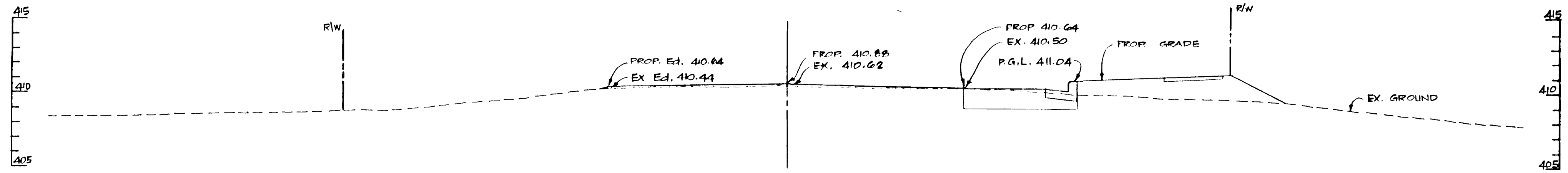

SECTION 32+50

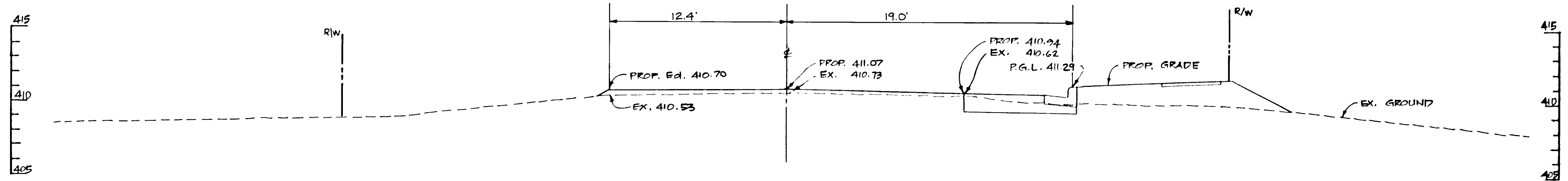

SECTION 33+00

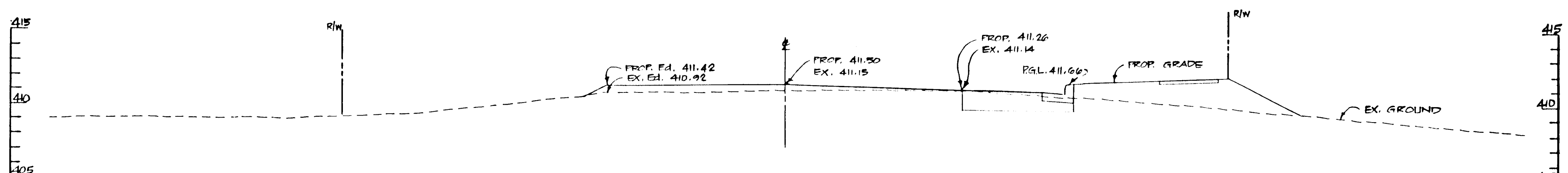

SECTION 33+50

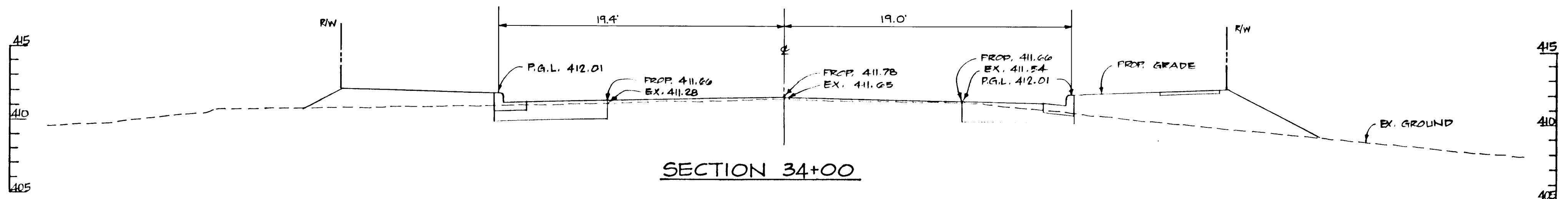

SECTION 34+00

APPROVED: HOWARD COUNTY DEPT. OF PUBLIC WORKS
Andrew M. Ouellet 5-17-94
 CHIEF, BUREAU OF HIGHWAYS 113 DATE
Paul M. Leppan 5/23/94
 CHIEF, BUREAU OF ENGINEERING DATE
John P. ... 5/20/94
 CHIEF, LAND DEVELOPMENT DIVISION DATE

APPROVED: HOWARD COUNTY DEPT. OF PLANNING AND ZONING
Dina ... 5/31/94
 CHIEF, LAND DEVELOPMENT AND RESEARCH DATE

4/24/95	1	REVISED SECTIONS 32+00, 33+00 AND 34+00
Date	No.	Revision Description

LONGREACH - EASTERN HIGH SCHOOL
SECTION 3 AREA 2
 OWNER / DEVELOPER:
 HOWARD COUNTY PUBLIC SCHOOL SYSTEM
 10910 RT. 108
 ELLICOTT CITY, MARYLAND 21042-8198

DMW
 Dan McCune Walker, Inc.
 200 East Pennsylvania Avenue
 Towson, Maryland 21286
 (410) 286-3333
 Fax 286-4705
 A Team of Land Planners,
 Landscape Architects,
 Engineers, Surveyors &
 Environmental Professionals

5-5-94
 Date
Larry E. Walker
 Professional Engr. No. 16998

AREA	VIUAGE OF LONGREACH SECTION 3 AREA 2 TAX MAP 36 PARCEL 371 8TH ELECTION DISTRICT OF HOWARD COUNTY, MARYLAND	
TITLE	DOBBIN ROAD ROAD CROSS SECTIONS	
Des By	M.A.T.	Scale: 1" = 5'
Dwn By	P.B.S.	Date: 02/24/94
Proj. No.	92087-A	
10 OF	13	

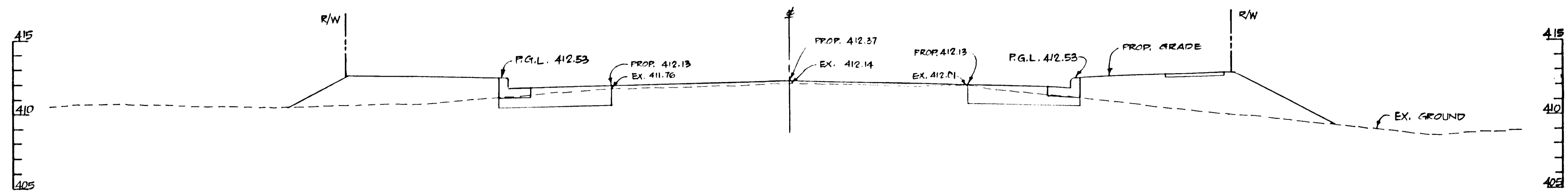

SECTION 34+50

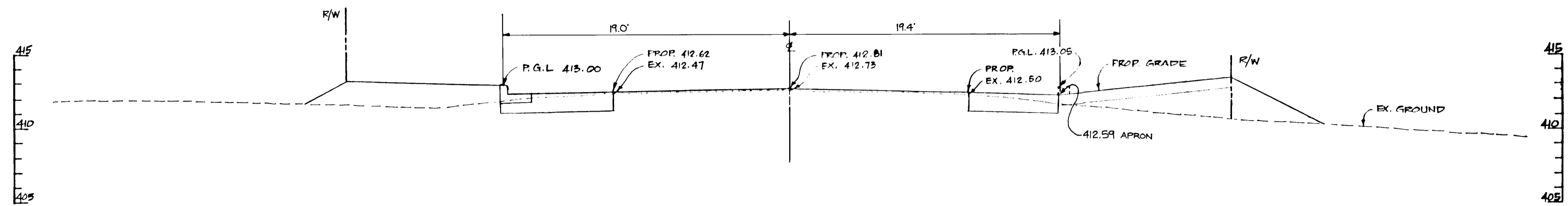

SECTION 35+00

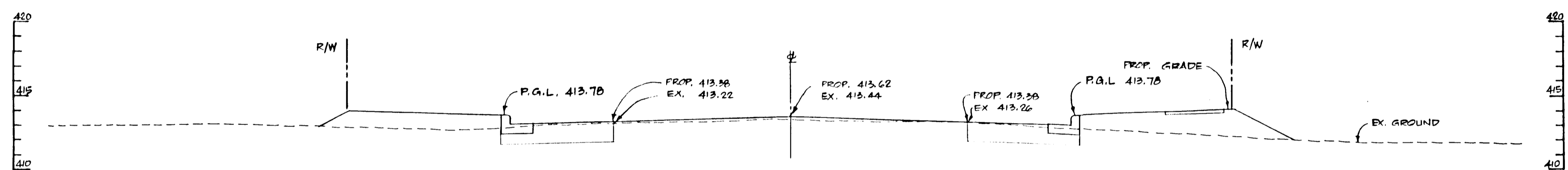

SECTION 35+50

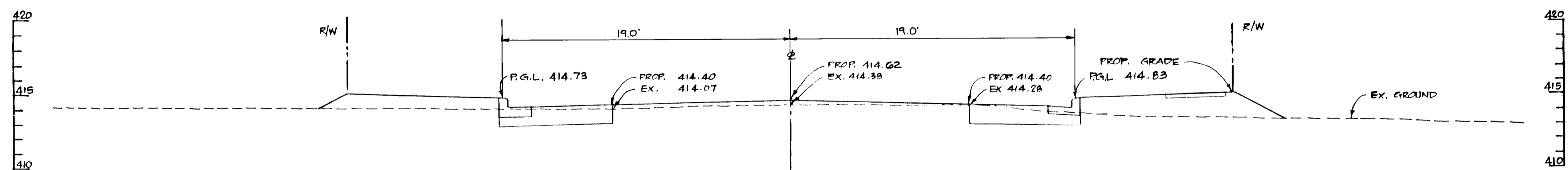

SECTION 36+00

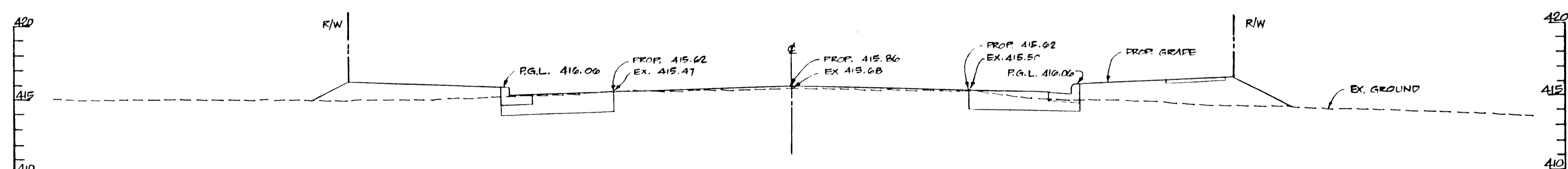

SECTION 36+50

APPROVED: HOWARD COUNTY DEPT. OF PUBLIC WORKS
Andrew M. Conner 5-17-94
 CHIEF, BUREAU OF HIGHWAYS 113 DATE

Paul D. Gannon 5/23/94
 CHIEF, BUREAU OF ENGINEERING DATE

John D. ... 5/20/94
 CHIEF, CIVIL DEVELOPMENT DIVISION DATE

APPROVED: HOWARD COUNTY DEPT. OF PLANNING AND ZONING
Uma Johnson 5/31/94
 CHIEF, LAND DEVELOPMENT AND RESEARCH DATE

Date	No.	Revision Description
9/24/93	1	REVISED SECTIONS 35+00 AND 36+00

LONGREACH - EASTERN HIGH SCHOOL
SECTION 3 AREA 2

OWNER /DEVELOPER:
 HOWARD COUNTY PUBLIC SCHOOL SYSTEM
 10910 RT.108
 ELLICOTT CITY, MARYLAND 21042-6198

DMW
 Dan McCune-Walker, Inc.
 200 East Pennsylvania Avenue
 Towson, Maryland 21286
 (410) 296-3333
 Fax 296-4705

A Team of Land Planners,
 Landscape Architects,
 Engineers, Surveyors &
 Environmental Professionals

5-5-94
 Date

Carroll W. Walker

Professional Eng. No. 16998

AREA	VILLAGE OF LONGREACH SECTION 3 AREA 2 TAX MAP 36 PARCEL 371 8TH ELECTION DISTRICT OF HOWARD COUNTY, MARYLAND		
TITLE	DOBBIN ROAD ROAD CROSS SECTIONS		
Des By	M.A.T.	Scale : 1" = 5'	Proj. No. 92087-A
Des By	D.B.S.	Date 02/24/94	11 OF 13
Chk By		Approved:	

100

SCALE 1"=40'

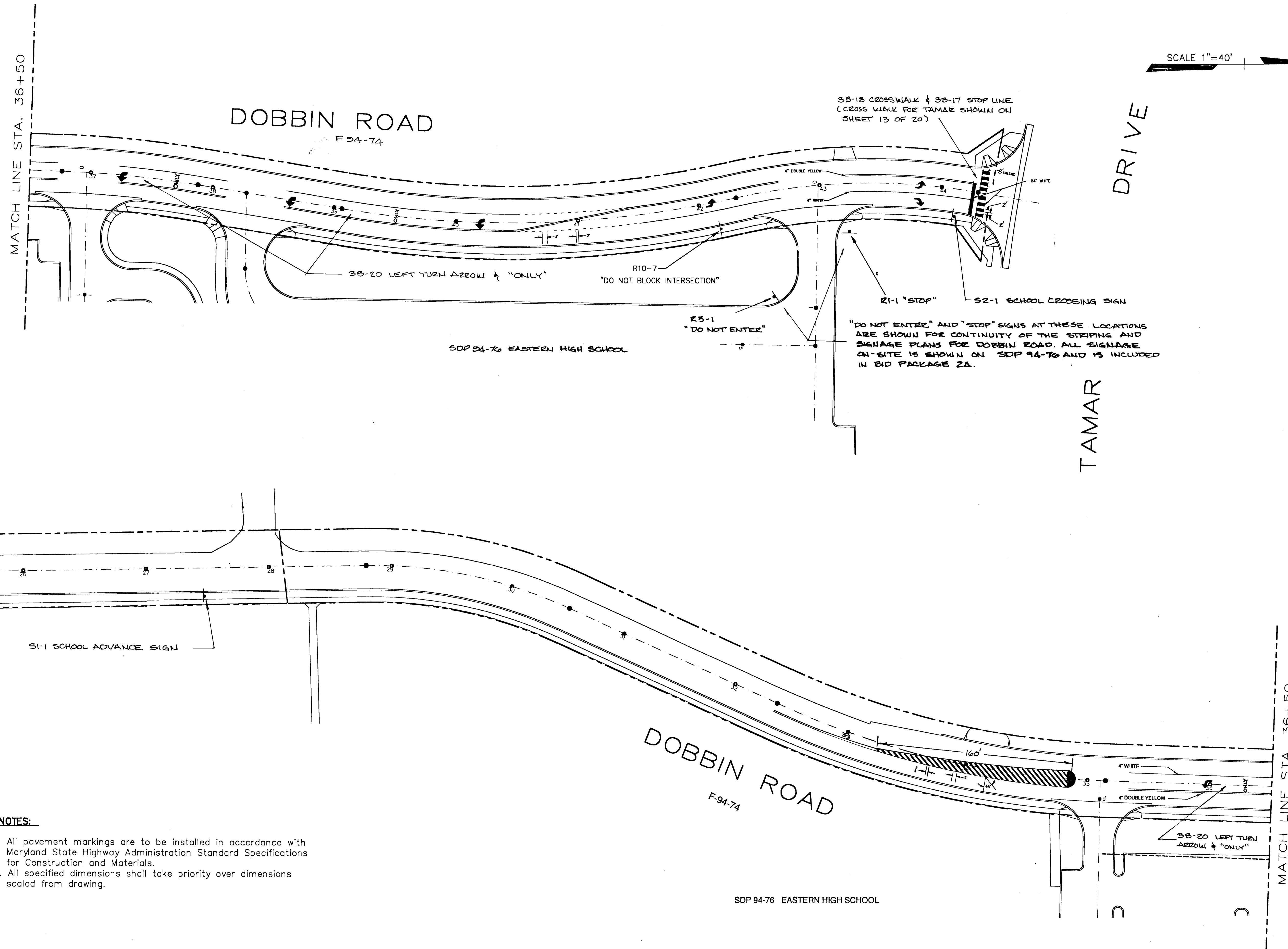

MATCH LINE STA. 36+50

MATCH LINE STA. 36+50

DOBBIN ROAD
F-94-74

DOBBIN ROAD
F-94-74

DRIVE

TAMAR

SDP 94-76 EASTERN HIGH SCHOOL

SDP 94-76 EASTERN HIGH SCHOOL

APPROVED: HOWARD COUNTY DEPT. OF PUBLIC WORKS
Andrew M. Paulk 5-17-99
 CHIEF, BUREAU OF HIGHWAYS HP DATE
Charles E. Span 5/23/94
 CHIEF, BUREAU OF ENGINEERING DATE
Mark D. ... 5/20/94
 CHIEF, LAND DEVELOPMENT DIVISION DATE M

APPROVED: HOWARD COUNTY DEPT. OF PLANNING AND ZONING
Nina J. ... 5/31/94
 CHIEF, DIVISION OF LAND DEVELOPMENT & RESEARCH DATE JN

- NOTES:**
1. All pavement markings are to be installed in accordance with Maryland State Highway Administration Standard Specifications for Construction and Materials.
 2. All specified dimensions shall take priority over dimensions scaled from drawing.

DATE	No.	REVISION DESCRIPTION
		LONGREACH ~ EASTERN HIGH SCHOOL SECTION 3 AREA 2

OWNER / DEVELOPER:
 HOWARD COUNTY PUBLIC SCHOOL SYSTEM
 10910 RT. 108
 ELLICOTT CITY, MARYLAND 21042

VILLAGE OF LONGREACH
 SECTION 3 AREA 2
 TAX MAP 26 PARCEL 371
 6TH ELECTION DISTRICT
 HOWARD COUNTY, MARYLAND

WELLS & ASSOCIATES, INC.
 TRAFFIC, TRANSPORTATION, and PARKING CONSULTANTS
 Suite 700, 2111 Wilson Blvd., Arlington, Virginia 22201
 Telephone: 703/351-5040 Facsimile: 703/522-7043

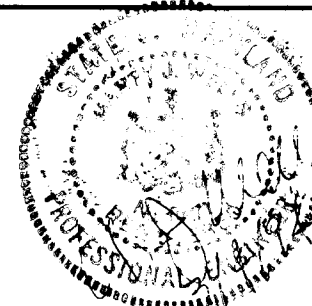

DES: LML					
DRN: LML (CADD)					
CHK: RTE					
DATE: 3MAR94	BY:	NO.	REVISION	DATE:	600' SCALE MAP NO. DATE:

SIGNING & STRIPING PLAN
 DOBBIN ROAD AT TAMAR DRIVE

SITING BIDDING
 31 MARCH 94

SCALE AS SHOWN
 SHEET 12 OF 13

100

F-94-74

