

ADDRESS CHART		
LOT #	STREET	ADDRESS
1		
2		
3		
4		
5		
6		

24C INV. AT PROPERTY LINE	
LOT #	ELEVATION
1	410.42
2	410.45
3	425.60
4	425.33
5	425.95
6	425.56

DEVELOPER'S CERTIFICATE
 I/WE CERTIFY THAT ALL DEVELOPMENT AND CONSTRUCTION WILL BE DONE ACCORDING TO THIS PLAN OF DEVELOPMENT AND PLAN FOR EROSION AND SEDIMENT CONTROL AND THAT ALL RESPONSIBLE PERSONNEL INVOLVED IN THE CONSTRUCTION PROJECT WILL HAVE A CERTIFICATE OF ATTENDANCE AT A DEPARTMENT OF THE ENVIRONMENT APPROVED TRAINING PROGRAM FOR THE CONTROL OF SEDIMENT AND EROSION BEFORE BEGINNING THE PROJECT. I ALSO AUTHORIZE PERIODIC ON-SITE INSPECTION BY THE HOWARD SOIL CONSERVATION DISTRICT OR THEIR AUTHORIZED AGENTS, AS ARE DEEMED NECESSARY.

Johr Brewer 11/18/91
 SIGNATURE OF DEVELOPER DATE

ENGINEER'S CERTIFICATE
 I HEREBY CERTIFY THAT THIS PLAN FOR EROSION AND SEDIMENT CONTROL REPRESENTS A PRACTICAL AND WORKABLE PLAN BASED ON MY PERSONAL KNOWLEDGE OF THE SITE CONDITIONS AND THAT IT WAS PREPARED IN ACCORDANCE WITH THE REQUIREMENTS OF THE HOWARD SOIL CONSERVATION DISTRICT.

Chad Ch... 10/24/91
 SIGNATURE OF ENGINEER DATE

APPROVED FOR HOWARD SOIL CONSERVATION DISTRICT AND ITS TECHNICAL REQUIREMENTS
John M. ... 12/3/91
 DISTRICT 1 APPROVED
John R. ... 12/2/91
 DISTRICT 1 APPROVED
 HOWARD SOIL CONSERVATION DISTRICT

- SEQUENCE OF CONSTRUCTION
- OBTAIN GRADING PERMIT.
 - INSTALL ALL SEDIMENT AND EROSION CONTROL DEVICES AS SHOWN ON PLAN.
 - INSTALL TEMPORARY SEEDING.
 - EXCAVATE FOR FOUNDATIONS AND ROUGH GRADE.
 - CONSTRUCT DWELLINGS AND PRIVATE ROAD.
 - FINAL GRADE AND INSTALL PERMANENT SEEDING.
 - REMOVE SEDIMENT AND EROSION CONTROL DEVICES AS PERMISSION IS GRANTED BY SEDIMENT CONTROL INSPECTOR.

APPROVED DEPARTMENT OF PUBLIC WORKS
Oliver M. ... 12/19/91
 CHIEF, LAND DEVELOPMENT DIVISION DATE

APPROVED DEPARTMENT OF PUBLIC WORKS
William S. ... 12-20-91
 CHIEF, BUREAU OF ENGINEERING DATE

APPROVED DEPARTMENT OF PLANNING AND ZONING
Anna ... 12/23/91
 CHIEF, DIVISION OF COMMUNITY PLANNING AND LAND DEVELOPMENT DATE

FISHER, COLLINS & CARTER, INC.
 CIVIL ENGINEERING CONSULTANTS & LAND SURVEYORS
 9171 BALTIMORE NATIONAL PIKE, SUITE 100
 ELICOTT CITY, MARYLAND 21042
 TELEPHONE: (301) 461-2855

1562

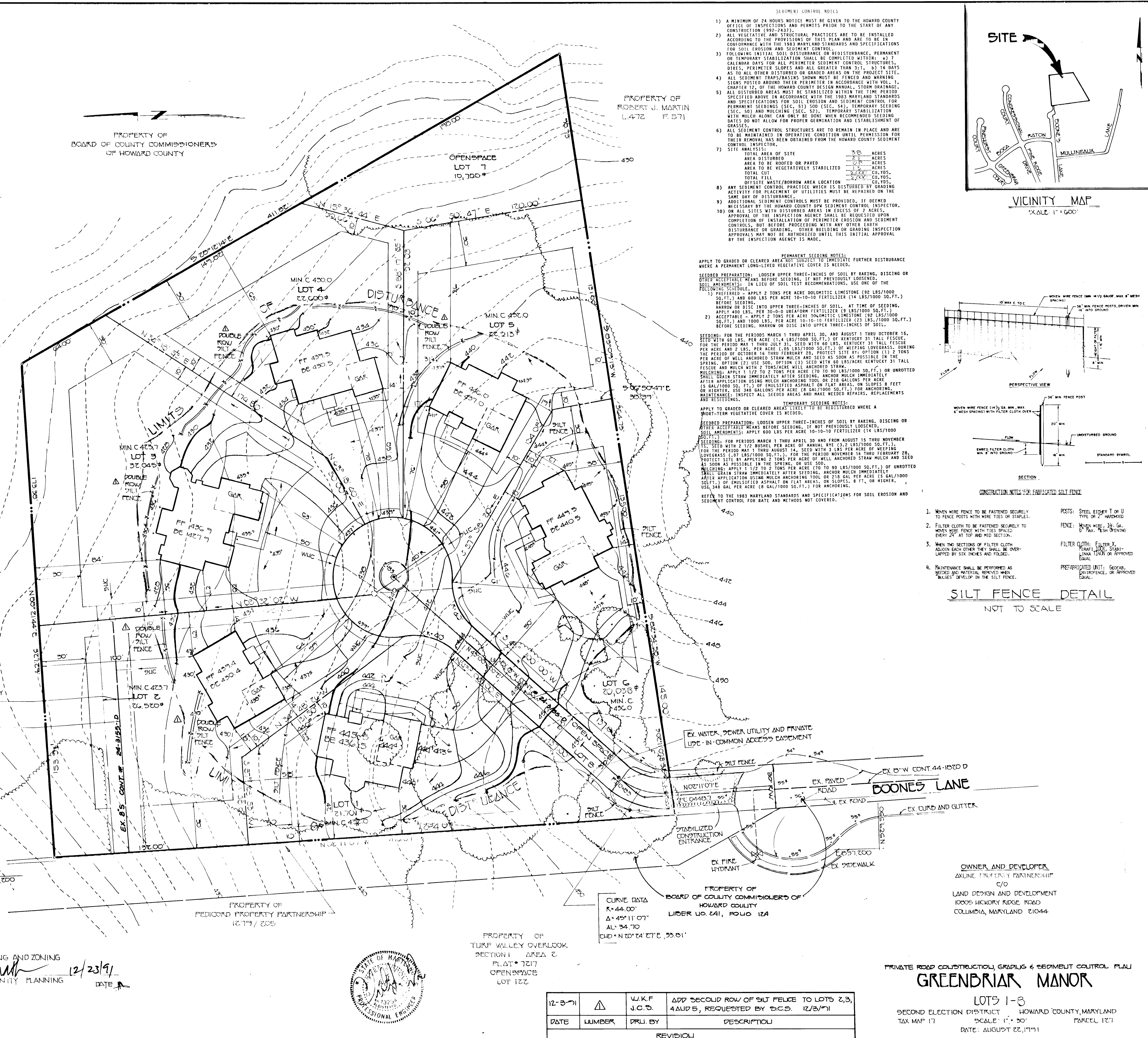

- SEEDING CONTROL NOTES
- A MINIMUM OF 24 HOURS NOTICE MUST BE GIVEN TO THE HOWARD COUNTY OFFICE OF INSPECTIONS AND PERMITS PRIOR TO THE START OF ANY CONSTRUCTION (092-2432).
 - ALL VEGETATIVE AND STRUCTURAL PRACTICES ARE TO BE INSTALLED ACCORDING TO THE PROVISIONS OF THIS PLAN AND ARE TO BE IN CONFORMANCE WITH THE 1983 MARYLAND STANDARDS AND SPECIFICATIONS FOR SOIL EROSION AND SEDIMENT CONTROL.
 - FOLLOWING INITIAL SOIL DISTURBANCE OR REDISTURBANCE, PERMANENT OR TEMPORARY STABILIZATION SHALL BE COMPLETED WITHIN 7 CALENDAR DAYS FOR ALL PERIMETER SEDIMENT CONTROL STRUCTURES, DICES, PERIMETER SLOPES AND ALL GREATER THAN 3:1, 8) 14 DAYS AS TO ALL OTHER DISTURBED OR GRADED AREAS ON THE PROJECT SITE.
 - ALL SEDIMENT TRAPS/BASINS SHOWN MUST BE FENCED AND WARNING SIGNS POSTED AROUND THEIR PERIMETER IN ACCORDANCE WITH VOL. 1, CHAPTER 12, OF THE HOWARD COUNTY DESIGN MANUAL, STORM DRAINAGE.
 - ALL DISTURBED AREAS MUST BE STABILIZED WITHIN THE TIME PERIOD SPECIFIED ABOVE IN ACCORDANCE WITH THE 1983 MARYLAND STANDARDS AND SPECIFICATIONS FOR SOIL EROSION AND SEDIMENT CONTROL FOR PERMANENT SEEDINGS (SEC. 51) SOIL (SEC. 54), TEMPORARY SEEDING (SEC. 50) AND MULCHING (SEC. 52). TEMPORARY STABILIZATION WITH MULCH ALONE CAN ONLY BE DONE WHEN RECOMMENDED SEEDING DATES DO NOT ALLOW FOR PROPER GERMINATION AND ESTABLISHMENT OF GRASSES.
 - ALL SEDIMENT CONTROL STRUCTURES ARE TO REMAIN IN PLACE AND ARE TO BE MAINTAINED IN OPERATIVE CONDITION UNTIL PERMISSION FOR THEIR REMOVAL HAS BEEN OBTAINED FROM THE HOWARD COUNTY SEDIMENT CONTROL INSPECTOR.
 - SITE ANALYSIS:
 - TOTAL AREA OF SITE: 3.0 ACRES
 - AREA TO BE ROOFED OR PAVED: 0.7 ACRES
 - AREA TO BE VEGETATIVELY STABILIZED: 2.3 ACRES
 - TOTAL CUT: 1,200 CU. YDS.
 - TOTAL FILL: 1,200 CU. YDS.
 - OFF-SITE WASTE/BORROW AREA LOCATION: 2.0 ACRES
 - ANY SEDIMENT CONTROL PRACTICE WHICH IS DISTURBED BY GRADING SHOULD BE REPAIRED TO ORIGINAL CONDITION OR BETTER.
 - ADDITIONAL SEDIMENT CONTROL STRUCTURES MUST BE PROVIDED, IF DEEMED NECESSARY BY THE HOWARD COUNTY DEPT. SEDIMENT CONTROL INSPECTOR. APPROVAL OF THE INSPECTION AGENCY SHALL BE REQUESTED UPON COMPLETION OF INSTALLATION OF PERIMETER EROSION AND SEDIMENT CONTROL, BUT BEFORE PROCEEDING WITH ANY OTHER EROSION DISTURBANCE OR GRADING. OTHER BUILDING OR GRADING INSPECTION APPROVALS MAY NOT BE AUTHORIZED UNTIL THIS INITIAL APPROVAL BY THE INSPECTION AGENCY IS MADE.

- PERMANENT SEEDING NOTES
- APPLY TO GRADED OR CLEARED AREAS LIKELY TO BE REDISTURBED WHERE A SHORT-TERM VEGETATIVE COVER IS NEEDED.
- SEEDING PREPARATION: LOOSEN UPPER THREE-INCHES OF SOIL BY RAKING, DISCING OR OTHER ACCEPTABLE MEANS BEFORE SEEDING. IF NOT PREVIOUSLY LOOSENED, SOIL AMENDMENTS: IN LIEU OF SOIL TEST RECOMMENDATIONS, USE ONE OF THE FOLLOWING SCHEDULE:
- PREFERRED - APPLY 2 TONS PER ACRE DOLOMITIC LIMESTONE (92 LBS/1000 SO. FT.) AND 600 LBS PER ACRE 10-10-10 FERTILIZER (23 LBS/1000 SO. FT.) BEFORE SEEDING.
 - ACCEPTABLE - APPLY 2 TONS PER ACRE DOLOMITIC LIMESTONE (92 LBS/1000 SO. FT.) AND 1000 LBS PER ACRE 10-10-10 FERTILIZER (23 LBS/1000 SO. FT.) BEFORE SEEDING.
 - UNACCEPTABLE - APPLY 2 TONS PER ACRE DOLOMITIC LIMESTONE (92 LBS/1000 SO. FT.) AND 1000 LBS PER ACRE 10-10-10 FERTILIZER (23 LBS/1000 SO. FT.) BEFORE SEEDING.
- SEEDING: FOR THE PERIODS MARCH 1 THRU APRIL 30, AND AUGUST 1 THRU OCTOBER 15, SEED WITH 60 LBS. PER ACRE (1.4 LBS/1000 SO. FT.) OF KENTUCKY 31 TALL FESCUE. FOR THE PERIOD MAY 1 THRU JULY 31, SEED WITH 3 LBS PER ACRE OF WHEAT. FOR THE PERIOD OCTOBER 16 THRU FEBRUARY 28, SEED WITH 80 LBS PER ACRE OF WHEAT. SEED AS SOON AS POSSIBLE IN THE SPRING. OPTION (2) USE 500. OPTION (3) SEED WITH 60 LBS/ACRE KENTUCKY 31 TALL FESCUE AND MULCH WITH 2 TONS/ACRE WELLS ANCHORED STRAW MULCH IMMEDIATELY AFTER SEEDING. MULCHING: APPLY 1 1/2 TO 2 TONS PER ACRE (70 TO 90 LBS/1000 SO. FT.) OF UNROOTED SHELL DRAIN STRAW IMMEDIATELY AFTER SEEDING. ANCHOR MULCH IMMEDIATELY AFTER APPLICATION USING MULCH ANCHORING TOOL OR 210 GALLONS PER ACRE (5 GAL/1000 SO. FT.) OF UNMULCHED ASPHALT ON FLAT AREAS, ON SLOPES 8 FEET OR HIGHER, USE 348 GALLONS PER ACRE (8 GAL/1000 SO. FT.) FOR ANCHORING. MAINTENANCE: INSPECT ALL SEEDING AREAS AND MAKE NEEDED REPAIRS, REPLACEMENTS AND RESEEDINGS.
- TEMPORARY SEEDING NOTES
- APPLY TO GRADED OR CLEARED AREAS LIKELY TO BE REDISTURBED WHERE A SHORT-TERM VEGETATIVE COVER IS NEEDED.
- SEEDING PREPARATION: LOOSEN UPPER THREE-INCHES OF SOIL BY RAKING, DISCING OR OTHER ACCEPTABLE MEANS BEFORE SEEDING. IF NOT PREVIOUSLY LOOSENED, SOIL AMENDMENTS: APPLY 600 LBS PER ACRE 10-10-10 FERTILIZER (14 LBS/1000 SO. FT.).
- SEEDING: FOR PERIODS MARCH 1 THRU APRIL 30 AND FROM AUGUST 15 THRU NOVEMBER 30, SEED WITH 2 1/2 BUSHEL PER ACRE OF ANNUAL RYE (3.2 LBS/1000 SO. FT.). FOR THE PERIOD MAY 1 THRU AUGUST 14, SEED WITH 3 LBS PER ACRE OF WHEAT. FOR THE PERIOD OCTOBER 16 THRU FEBRUARY 28, SEED WITH 80 LBS PER ACRE OF WHEAT. SEED AS SOON AS POSSIBLE IN THE SPRING, OR USE OPTION (2) OR (3) AS SOON AS POSSIBLE. OPTION (2) USE 500. OPTION (3) SEED WITH 60 LBS/ACRE KENTUCKY 31 TALL FESCUE AND MULCH WITH 2 TONS/ACRE WELLS ANCHORED STRAW MULCH IMMEDIATELY AFTER SEEDING. MULCHING: APPLY 1 1/2 TO 2 TONS PER ACRE (70 TO 90 LBS/1000 SO. FT.) OF UNROOTED SHELL DRAIN STRAW IMMEDIATELY AFTER SEEDING. ANCHOR MULCH IMMEDIATELY AFTER APPLICATION USING MULCH ANCHORING TOOL OR 210 GALLONS PER ACRE (5 GAL/1000 SO. FT.) OF UNMULCHED ASPHALT ON FLAT AREAS, ON SLOPES 8 FEET OR HIGHER, USE 348 GAL PER ACRE (8 GAL/1000 SO. FT.) FOR ANCHORING.
- REFER TO THE 1983 MARYLAND STANDARDS AND SPECIFICATIONS FOR SOIL EROSION AND SEDIMENT CONTROL FOR RATE AND METHODS NOT COVERED.

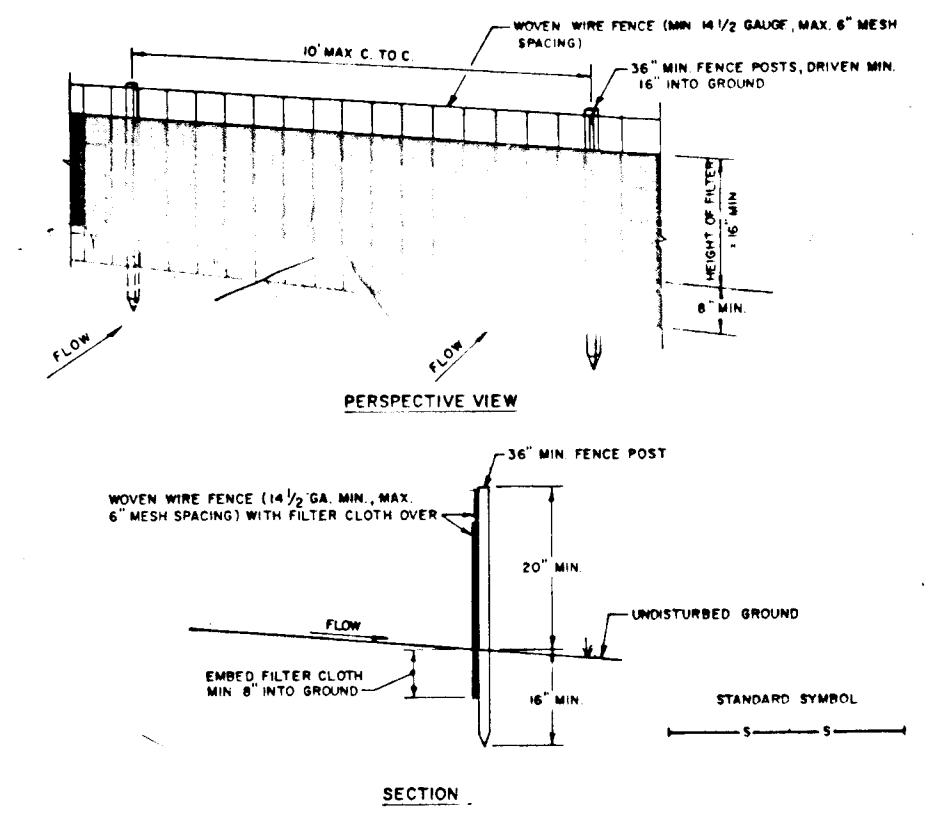
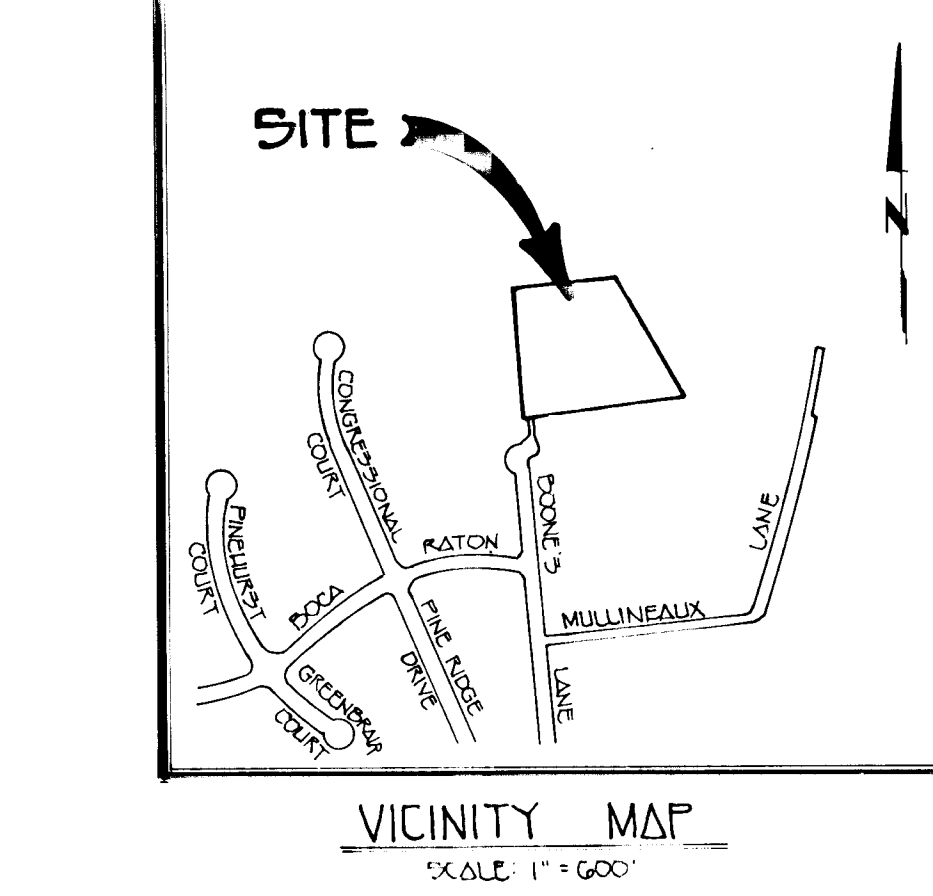

- CONSTRUCTION NOTES FOR FABRICATED SILT FENCE
- WOVEN WIRE FENCE TO BE FASTENED SECURELY TO FENCE POSTS WITH WIRE TIES OR STAPLES.
 - FILTER CLOTH TO BE FASTENED SECURELY TO WOVEN WIRE FENCE WITH TIES SPACED EVERY 24" AT TOP AND MID SECTION.
 - WHEN TWO SECTIONS OF FILTER CLOTH ADJOIN EACH OTHER THEY SHALL BE OVERLAPPED BY SIX INCHES AND FOLDED.
 - MAINTENANCE SHALL BE PERFORMED AS NEEDED AND MATERIAL REMOVED WHEN "BULGES" DEVELOP IN THE SILT FENCE.
- POSTS: STEEL EITHER T OR U TYPE OR 2" WOODS
 FENCE: WOVEN WIRE, 1/4" GAL. 6" XAV. MESH OPENING
 FILTER CLOTH: FILTER #1, 24" X 12" X 12" OR APPROVED EQUAL
 PREPARED UNIT: GEOTEX, POLYPROPYLENE, OR APPROVED EQUAL.



OWNER AND DEVELOPER
 BALINE PROPERTY PARTNERSHIP
 C/O
 LAND DESIGN AND DEVELOPMENT
 10005 HICKORY RIDGE ROAD
 COLUMBIA, MARYLAND 21044

PRIVATE ROAD CONSTRUCTION, GRADING & SEDIMENT CONTROL PLAN
GREENBRIAR MANOR
 LOTS 1-3
 SECOND ELECTION DISTRICT HOWARD COUNTY, MARYLAND
 TAX MAP 17 SCALE: 1" = 50' PARCEL 127
 DATE: AUGUST 27, 1991

DATE	NUMBER	DRN. BY	DESCRIPTION
12-3-91	1	W.K.F. J.C.S.	ADD SECOND ROW OF SILT FENCE TO LOTS 2,3, 4AUBS, REQUESTED BY S.C.S. 12/3/91

