

ENGINEER'S CERTIFICATE
 I certify that this plan for erosion and sediment control represents a practical and workable plan based on my personal knowledge of the site conditions and that it was prepared in accordance with the requirements of the Howard Soil Conservation District.
C. K. Kuttarow 7-17-90
 Date

THIS DEVELOPMENT PLAN IS APPROVED FOR SOIL EROSION AND SEDIMENT CONTROL BY THE HOWARD SOIL CONSERVATION DISTRICT.
Jeffrey H. ... 10/27/90
 Date
 Howard S.C.D.

DEVELOPER'S/BUILDER'S CERTIFICATE
 I/We certify that all development and/or construction will be done according to this plan, and that any responsible personnel involved in the construction project will have a Certificate of Attendance of a Department of the Environment Approved Training Program for the Control of Sediment and Erosion before beginning the project. I also authorize periodic on-site inspection by the HSCD.
Mark C. Clay 7-17-90
 Date
 Signature of Developer/Builder

These plans have been reviewed for the Howard Soil Conservation District and meet the technical requirements.
James M. Kelly 11/5/90
 Date
 U.S. Soil Conservation Service

Road Name	P.C. Sta.	P.T. Sta.	Arc	Radius	Δ	Tangent	Chord
Stratford Court	0+00.00	1+82.29	1+82.29	300.00	34°40'53"	94.00	N 13°31'10" E 179.50'

Pl. No.	Station	T.C. Elevation
1	5+28.04/19L	294.37
2	0+00.45/14R	294.31
3	1+02.29/165R	297.58
4	1+04.28/162R	298.02
5	2+36.28/162R	299.04
6	2+04.28/141R	299.92
7	2+06.28/162R	299.34
8	3+38.28/162R	299.60
9	3+39.25/165R	299.21
10	3+50.27/165R	299.37
11	3+52.49/162R	299.70
12	3+52.49/162R	299.70
13	3+52.49/162R	299.70
14	4+02.49/162R	294.80
15	4+04.29/165R	294.30
16	5+07.25/165R	299.08
17	5+09.25/162R	299.40
18	1+78.47/162R	297.70
19	1+78.47/165R	297.46
20	0+57.72/14L	294.97
21	4+57.02/19L	293.14
22	2+06.28/165L	291.63
23	3+20.42/14L	292.57
24	3+05.19/14R	294.57
25	3+05.19/165L	295.37
26	4+77.47/165L	295.22
27	4+00.47/165L	294.88
28	4+02.49/162L	294.98
29	3+20.42/162L	293.58
30	5+36.49/165L	293.16

Curb & Gutter Legend
 7" Std. Curb & Gutter
 Rev. Mountable Curb & Gutter
 6" Std. Curb & Gutter
 6" Rev. Curb & Gutter

Legend
 Stream Buffer
 Wetlands Buffer
 Wetlands Limit

Street Light Schedule

Location	Lamp Type	Mounting	Pole Type
St. Sta. 5+00.00 Stratford Ct. 10' Right	150 W. High Pressure Sodium Vapor	Post Top-Colonial	14' Gray-Fiberglass

Note: Street lights shall be provided at the locations shown in the schedule on this sheet. They shall be in accordance with Volume III of the Howard County Design Manual.



Approved Department of Public Works
... 10/1/90
 Chief, Land Development Division
Granville W. Weiland 10/30/90
 Chief, Bureau of Highways
 Approved Department of Public Works
... 11-1-90
 Chief, Bureau of Engineering
 Approved Department of Planning and Zoning
... 11/2/90
 Chief, Division of Community Planning and Land Development

RECOVERY SKETCH
 CONC. MON. #2666
 TIE FROM I-14' R.C. 10.00' L.P.C. 14.81' TIE FROM EX I-11' R.C. 38.40'

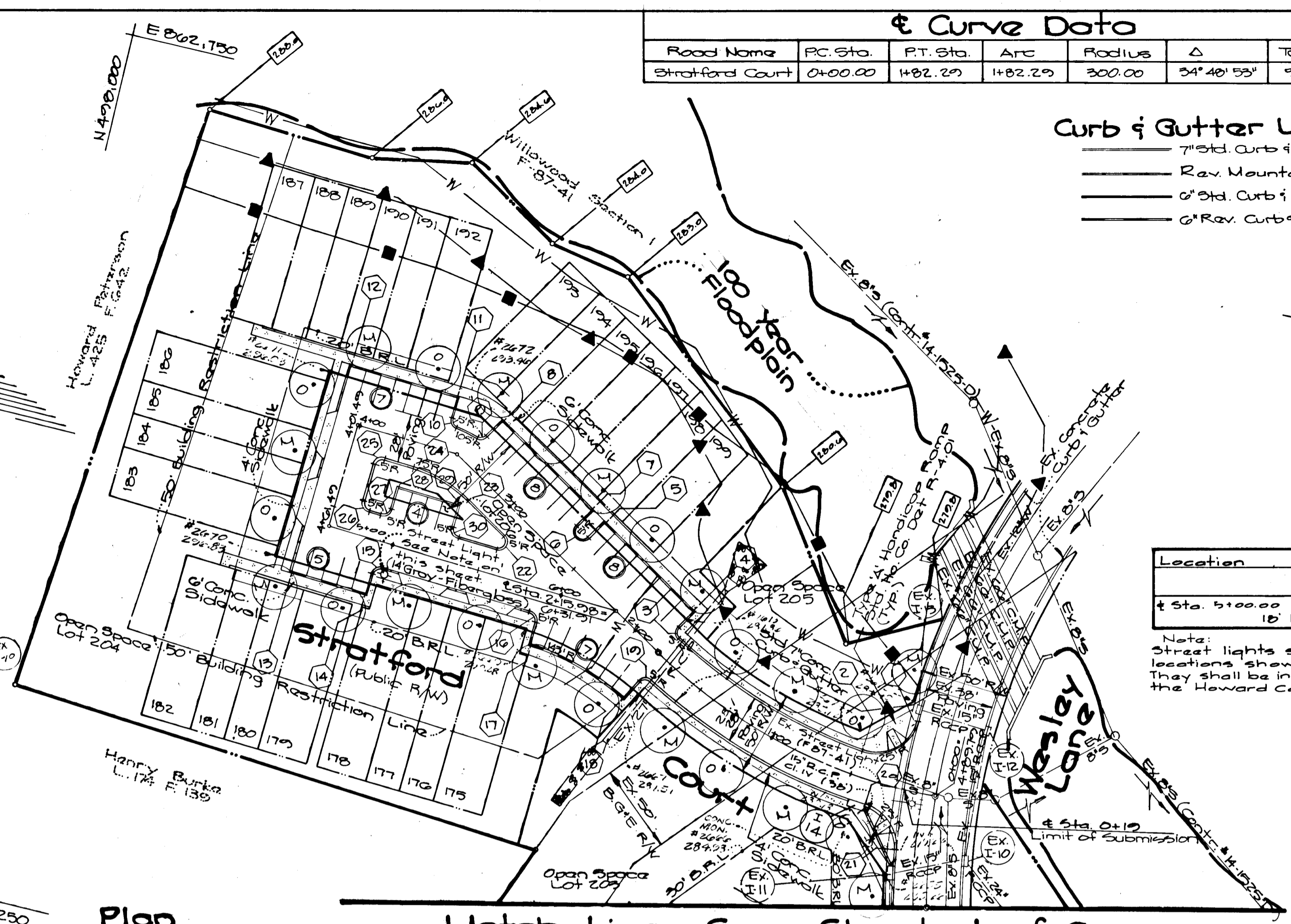

Ex. Conc. Curb & Gutter Between Pt. #1 & #2 to be removed within these limits.

Match Line See Sheet 1 of 6

G.W. GUTSCHICK LITTLE & WEBER, P.A.
 ENGINEERS, PLANNERS, SURVEYORS
 3909 NATIONAL DRIVE - SUITE 250 - BURTONSVILLE OFFICE PARK - BURTONSVILLE, MD 20886
 TEL.: (301) 421-4024

Willowood Section 2 Area 1
 Lots 153-207
 A Resubdivision of Lots 151 & 152
 First Election District
 Howard County, Maryland

Trafalgar House Residential Maryland Column Road Column, Maryland 21046 Phone: (301) 221-8151

DESIGNED DE.V.
 DRAWN M.C.F.
 CHECKED C.K.G.
 DATE 7/9/93 July 1993

SCALE 1" = 20' DRAWING 2 of 6
 JOB NO. 89-080

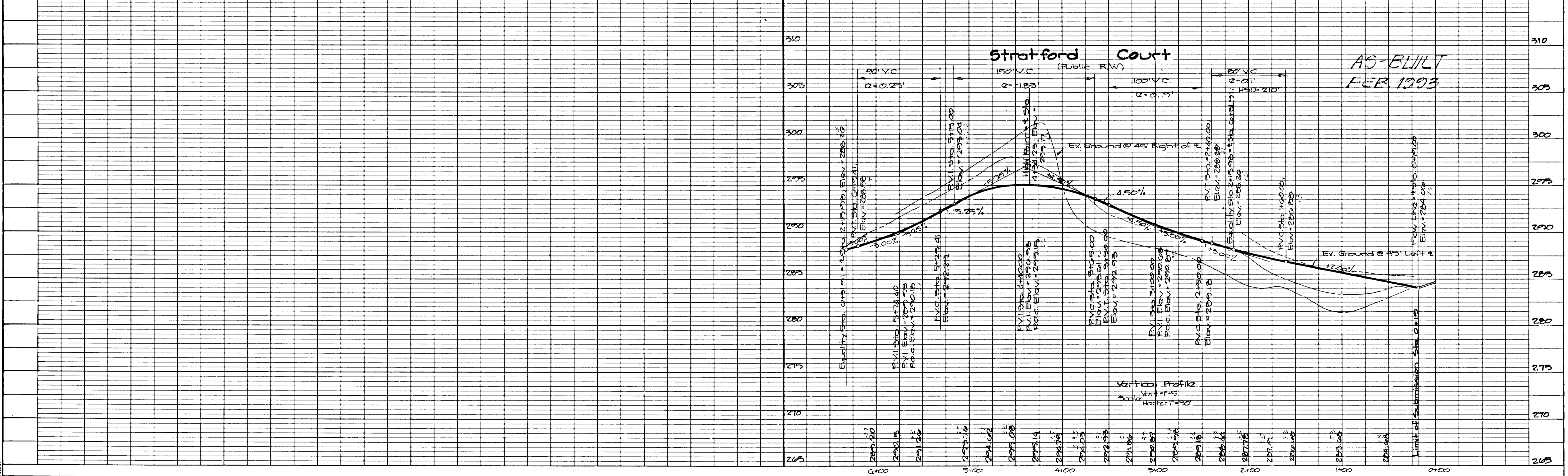

8721

General Notes

1. All Storm Drain & Paving shall be Constructed in Accordance with the latest edition and specifications of Howard County & MDSHA.
2. Types of Storm Drainage refer to the Standard Details of Howard County and MDSHA.
3. Trench Compacting for Storm Drains within Road or Street Right of Way Limits shall be in accordance with Howard County Design Manual Vol. II. (Close Trench Bedding to be used for all storm drains except where shown otherwise.)
4. Information concerning underground utilities was obtained from Available records, but the Contractor must determine the exact location and elevation of lines by digging test pits by hand, at all utility crossings, well in advance of construction.
5. All utility companies shall be notified 24 hours in Advance of Construction.
6. All traffic services, parking and signing to be done in Accordance with the "Manual of Uniform Traffic Control Devices," 1988 Edition.
7. Sag and Crest Vertical Curves were designed in Accordance with Howard County Design Manual Vol. III.
8. Provide Concrete Sidewalk ramps, Howard County Std. Type A, R-4.01 Where Shown in Plans.
9. The Contractor or developer shall contact the Construction Inspection/Survey Division 24 hours in Advance of Commencement of work. phone.
10. Design Speed: See Sheet 5 of 5 Zoning: R-3C
11. Storm Water Management Provided by Willowood Section one, F-87-41
12. Stopping Site Distances are not shown in Cul-de-sac areas since turning, parking and travel speed dictate the conditions for stopping rather than the standard stopping sight distance of a traveled way.

Curve Data

Road Name	Sta.	Length	Radius	Δ	Tan.	Chord
Briar Court	2+15.71	69.81'	25.50'	70°11'35"	273.94'	308'04'30"E 46.83'

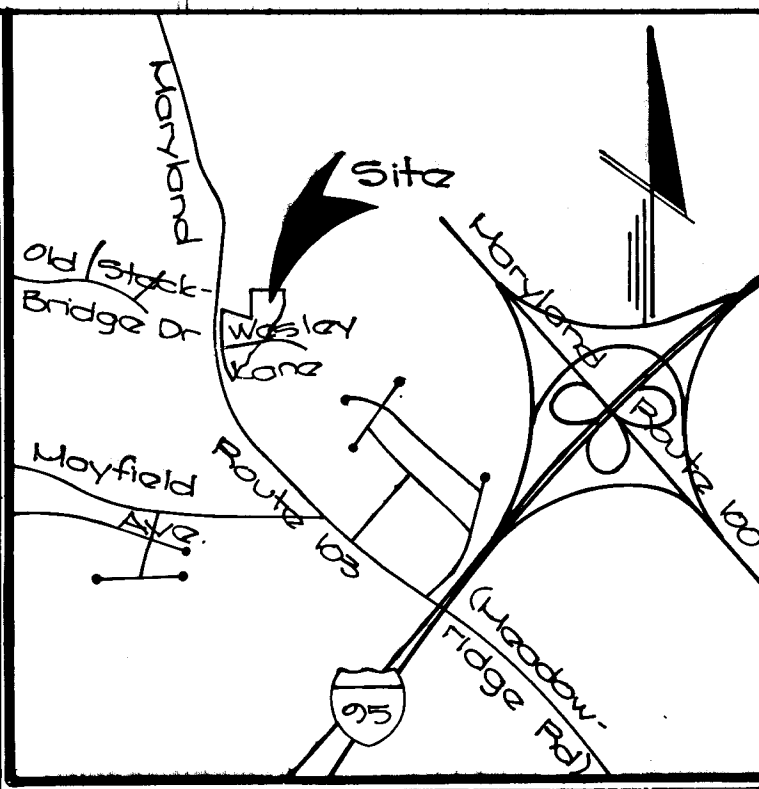
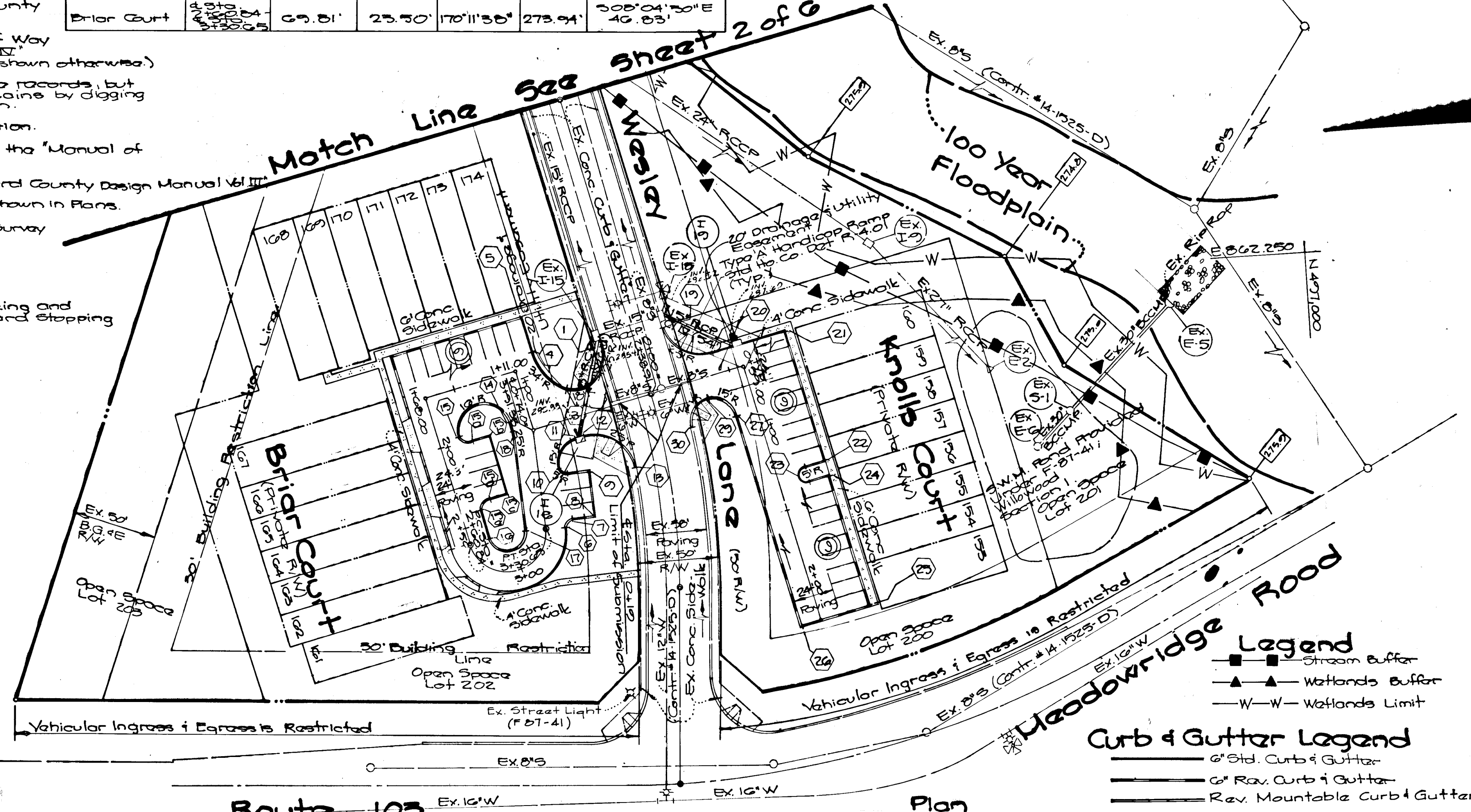

Vicinity Map Scale = 1" = 200'
Ex. Conc. Curb & Gutter Between P1*(1) & P2*(1) to be removed within those limits.

CK
10/21/90

ENGINEER'S CERTIFICATE
I certify that this plan for erosion and sediment control represents a practical and workable plan based on my personal knowledge of the site conditions and that it was prepared in accordance with the requirements of the Howard Soil Conservation District.
Date: 7-17-90

DEVELOPER'S/BUILDER'S CERTIFICATE
I/We certify that all development and/or construction will be done according to this plan, and that any responsible personnel involved in the construction project will have a Certificate of Attendance at a Department of the Environment Approved Training Program for the Control of Sediment and Erosion before beginning the project. I also authorize periodic on-site inspection by the HSD.
Date: 7-17-90

THIS DEVELOPMENT PLAN IS APPROVED FOR SOIL EROSION AND SEDIMENT CONTROL BY THE HOWARD SOIL CONSERVATION DISTRICT.
Date: 10/21/90

These plans have been reviewed for the Howard Soil Conservation District and meet the technical requirements.
Date: 10/21/90

Tree Schedule

Key	Tree Name & Symbol	Size	Quant	Remarks
(U)	Acer Saccharum - Green	2" - 2 1/2"	15	Heavywoods
(O)	Quercus Rubra - Northern Red Oak	2" - 2 1/2"	12	B.P.S. Heavywoods

GW GUTSCHICK LITTLE & WEBER, P.A.
ENGINEERS, PLANNERS, SURVEYORS
3909 NATIONAL DRIVE - SUITE 250 - BURTONSVILLE OFFICE PARK - BURTONSVILLE, MD. 20866
TEL: (301) 421-4024

Willowood Section 2 Area 1
Lots 153-207
A Resubdivision of Lots 151 & 152
First Election District
Howard County, Maryland

DESIGNED DEV: [Signature]
DRAWN MCF
CHECKED CKG
DATE: Feb. 1993
JOB NO. 09080

SCALE: As Shown
DRAWING: 1 of 6

Top of Curb Elevation Chart:
Pt. No. Station T.C. Elevation
1 2+15.71/19L 291.00
3 0+48.5/17R 292.00
4 0+22.00/17L 293.33
5 0+22.00/17R 293.33
6 3+30.05/21R 297.01
7 3+35.48/17R 296.90
8 3+35.48/30L 296.76
9 3+22.48/20R 295.80
10 3+22.48/17R 295.85
11 0+51.21/12L 293.40
12 0+45.93/12L 293.30
13 1+07.21/10L 293.83
14 0+22.5/12L 293.80
15 1+06.5/12L 293.90
16 2+00.04/12L 293.02
17 3+50.47/12L 297.00
18 3+08.18/12L 294.90
19 2+15.91/19R 291.00
20 0+44.00/12L 291.91
21 0+22.00/12L 290.75
22 1+20.00/30L 291.97
23 1+30.00/12L 291.00
24 1+30.00/30L 292.12
25 2+20.00/30L 293.33
26 2+20.00/12R 293.33
27 0+24.5/12R 290.82
29 0+30.00/12R 291.45
30 2+44.01/17R 293.74
15a 2+01.50/17L 293.08
15b 2+01.50/30L 293.28
15c 2+37.00/30L 293.80
15d 2+37.00/17L 293.78
15e 2+42.00/12L 293.77

- Approved Department of Public Works
Chief, Land Development Division Date: 10/21/90
- Approved Department of Public Works
Chief, Bureau of Engineering Date: 11-1-90
- Approved Department of Public Works
Chief, Bureau of Engineering Date: 10/30/90
- Approved Department of Planning and Zoning
Chief, Division of Community Planning and Land Development Date: 11/23/90

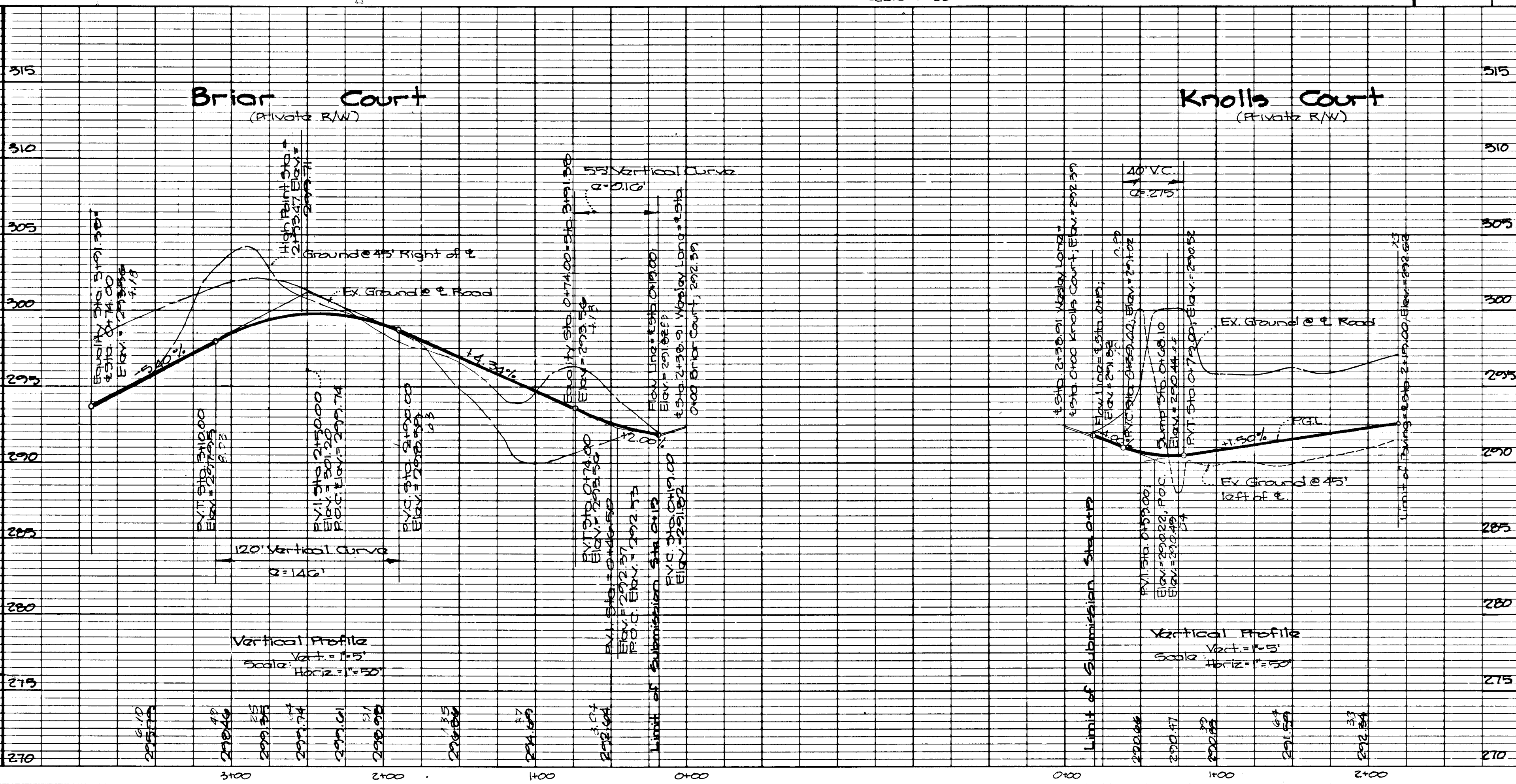

AS-BUILT
FEB. 1993

1248
8421

I certify that this plan for erosion and sediment control represents a practical and workable plan based on my personal knowledge of the site conditions and that it was prepared in accordance with the requirements of the Howard Soil Conservation District.

CK Johnson 7-17-90
Date

DEVELOPER'S/BUILDER'S CERTIFICATE

I/We certify that all development and/or construction will be done according to this plan, and that any responsible personnel involved in the construction project will have a Certificate of Attendance of a Department of the Environment Approved Training Program for the Control of Sediment and Erosion before beginning the project. I also authorize periodic on-site inspection by the HSCD.

Michael D. Clay 7-17-90
Signature of Developer/Builder Date

THIS DEVELOPMENT PLAN IS APPROVED FOR SOIL EROSION AND SEDIMENT CONTROL BY THE HOWARD SOIL CONSERVATION DISTRICT.

J. H. Smith 11/1/90
Howard S.C.D. Date

These plans have been reviewed for the Howard Soil Conservation District and meet the technical requirements.

James M. DeLeon 11/1/90
U.S. Soil Conservation Service Date

Benchmarks

B.M. #1 Elev. = 313.42
Railroad Spike in B&E Pole # 149652
East side of Paving on Meadowridge Road
2600' ± North of Mayfield Avenue

B.M. #2 Elev. = 287.06
N 427,942.53 E 862,770.00
Iron Pin at Property Corner
800' ± East of Meadowridge Road
2950' ± North of Mayfield Avenue

Approved Department of Public Works

John A. Thompson 11/1/90
Chief, Land Development Division Date

Francis W. Wetland 10/30/90
Chief, Bureau of Highways Date

Approved Department of Public Works

William S. Remy 11-1-90
Chief, Bureau of Engineering Date

Approved Department of Planning and Zoning

Mark L. Campbell 11/2/90
Chief, Division of Community Planning and Land Development Date

G&W GUTSCHICK LITTLE & WEBER, P.A.
ENGINEERS, PLANNERS, SURVEYORS

3909 NATIONAL DRIVE - SUITE 250 - BURTONSVILLE OFFICE PARK - BURTONSVILLE, MD. 20886

TELEPHONE: (301) 421-4024

DES. DE.V. DRN. G.A.W. CHK. C.K.G.

DATE

REVISION

BY

APP'R.

PREPARED FOR:
Trafalgar House
Residential Maryland
8065 Guilford Road
Columbia, Maryland
21046
Phone (301) 621-8131

Mass Grading Plan

Willowood

Section 2 Area 1
Lots 153-207
A Resubdivision of Lots 151 & 152

First Election District

Howard County, Maryland

AS-BUILT

NOTE: NO AS-BUILT INFORMATION IS SHOWN ON THIS SHEET.

SCALE As Shown	ZONING R-3C	G.L.W. FILE NO. 809-080
DATE Feb. '93 July '90	TAX MAP NO. 37	SHEET 5 of 6

SEDIMENT BASIN DATA	
DRAINAGE AREA =	5.88 AC ±
STORAGE REQUIRED =	10,580 C.F.
STORAGE PROVIDED =	15,800 C.F.
RIBER GREST ELEVATION =	276.8
EMERGENCY SPILLWAY ELEVATION =	277.2
EMERGENCY SPILLWAY WIDTH =	10'
BOTTOM ELEVATION =	270.5
OLEANDIT ELEVATION =	273.3
BOTTOM DIMENSIONS =	20' X 170'

1248

CK Johnson

Approved Department of Public Works
 Chief, Land Development Division
 Date 10/2/90
 Approved Department of Public Works
 Chief, Bureau of Engineering
 Date 11-1-90
 Approved Department of Planning and Zoning
 Chief, Division of Community Planning and Land Development
 Date 11/22/90

Structure Schedule					
Struct.	Type	Inverts	Top Elev.	Remarks	± Road Sta.
I-14	A-10	---	279.77	H.C. Std. 4.02	± Sta. 0+43.22 Stratford Ct. 14.85' Lt.
I-16	A5/deflectors	---	280.10	H.C. Std. 4.01±20.48	± Sta. 0+49.00 Briar Court 12.85' Lt.
I-19	A5	---	282.21	H.C. Std. 4.01	± Sta. 0+59.00 Knolls Court 12.85' Lt.

THIS DEVELOPMENT PLAN IS APPROVED FOR SOIL EROSION AND SEDIMENT CONTROL BY THE HOWARD SOIL CONSERVATION DISTRICT.

ENGINEER'S CERTIFICATE
 I certify that this plan for erosion and sediment control represents a practical and workable plan based on my personal knowledge of the site conditions and that it was prepared in accordance with the requirements of the Howard Soil Conservation District.

Signature: CK Johnson
 Date: 7-17-90

Signature: Jeff R. Selig
 Date: 10/24/90
 Howard S.C.D.

These plans have been reviewed for the Howard Soil Conservation District and meet the technical requirements.

DEVELOPER'S/BUILDER'S CERTIFICATE

I/We certify that all development and/or construction will be done according to this plan, and that any responsible personnel involved in the construction project will have a Certificate of Attendance at a Department of the Environment Approved Train Program for the Control of Sediment and Erosion before beginning the project. I also authorize periodic on-site inspection by the HSCD.

Signature: Michael J. Clay
 Date: 7-17-90

Signature: Dennis W. Risher
 Date: 11-1-90
 U.S. Soil Conservation Service

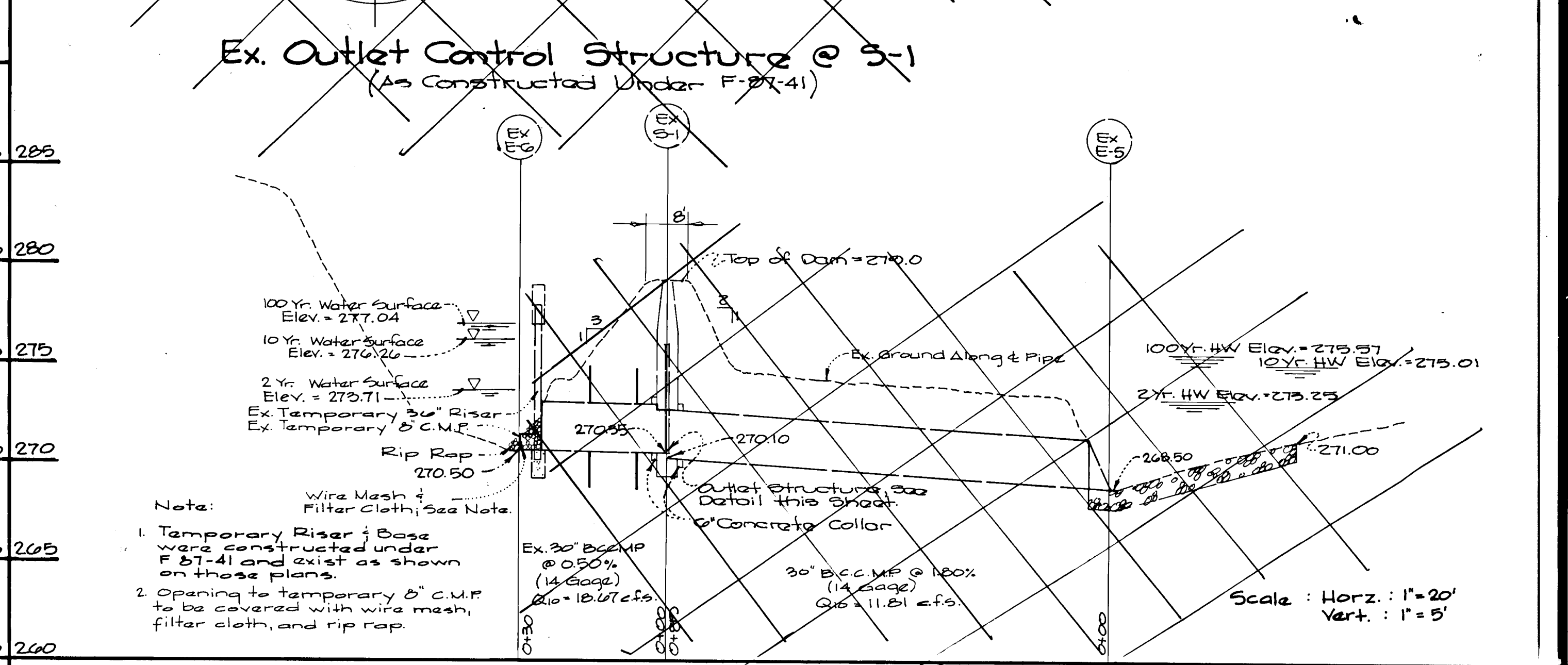
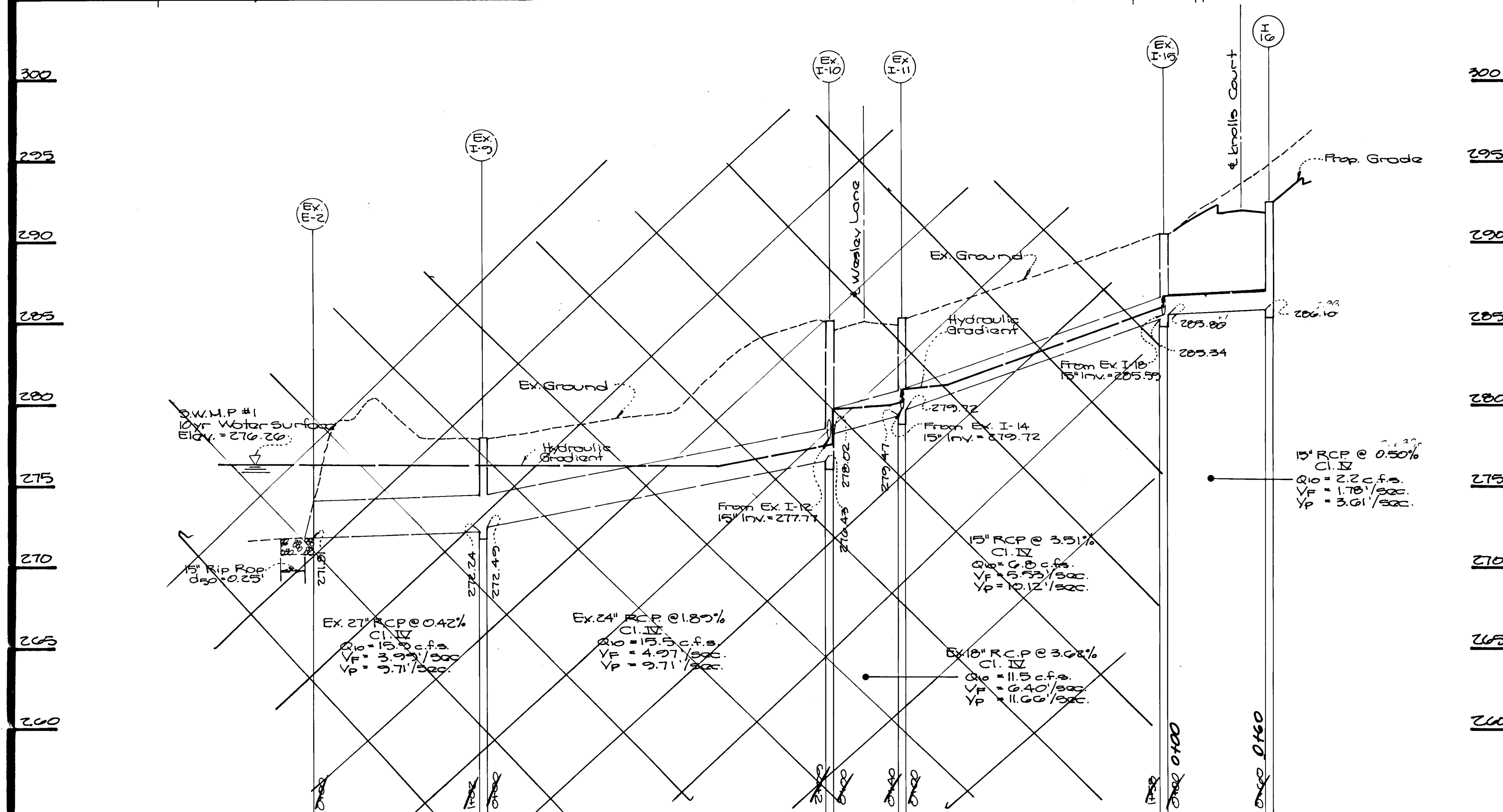
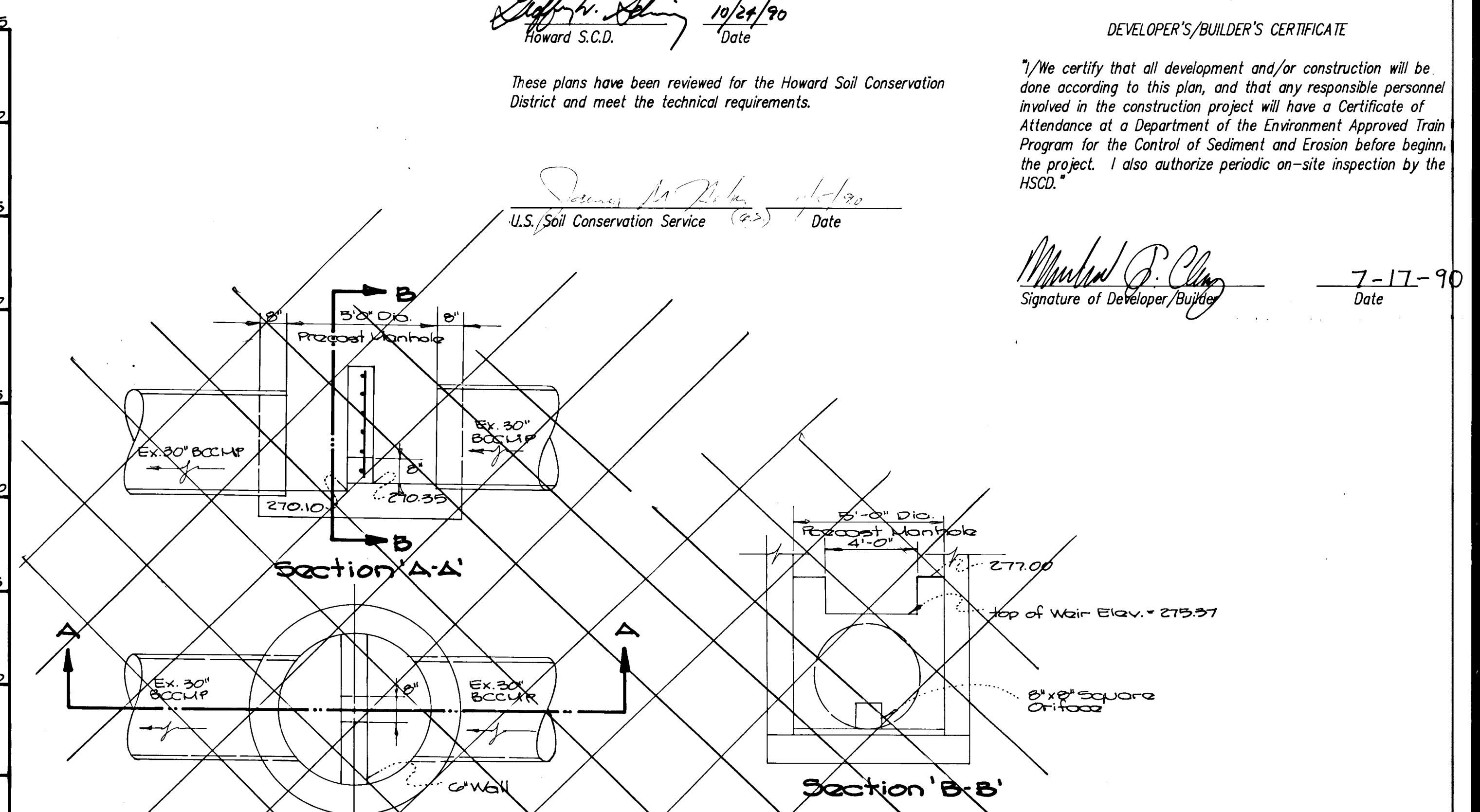
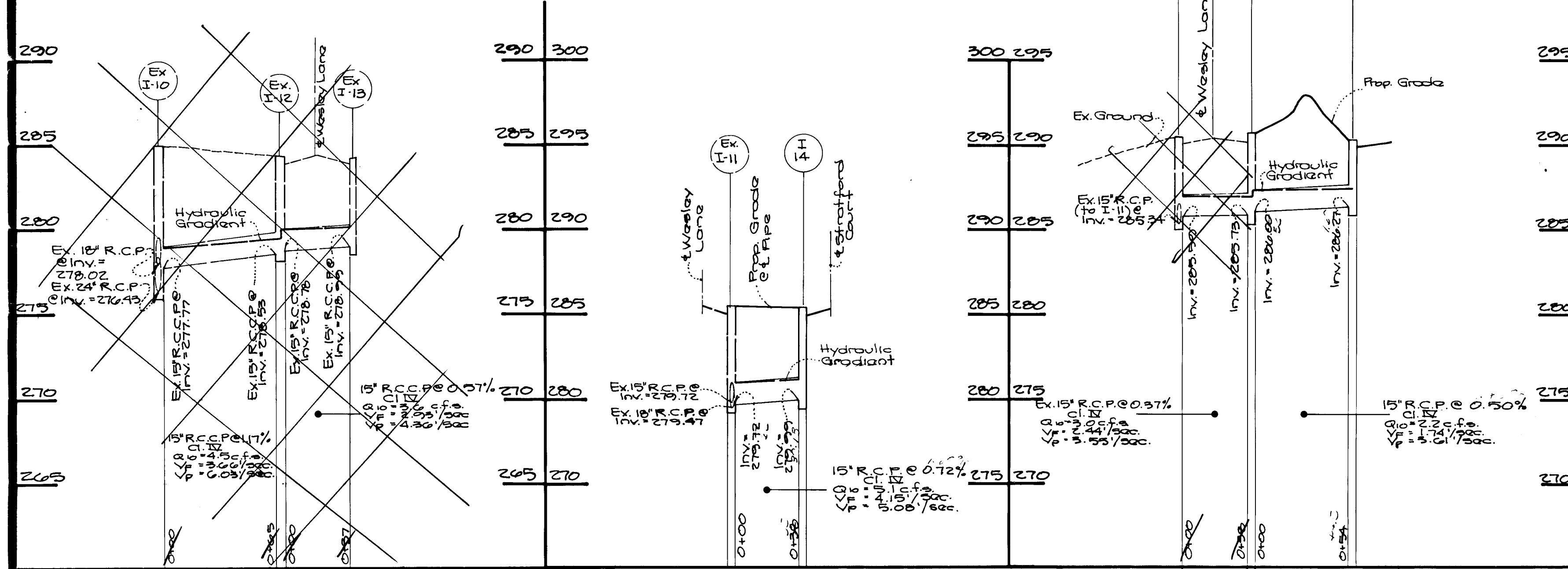

Ex. Approved S.W.M. Facility #1 Outfall Profile
 (Approved Under F 87-41)

AS-BUILT
 Storm Drain Profiles
 Willowood
 Section 2 Area 1
 Lots 153-207
 A Resubdivision of Lots 151 & 152
 First Election District
 Howard County, Maryland

SCALE As Shown	ZONING R-30	G.L.W. FILE NO. 89-080
DATE Feb. 73 July 90	TAX MAP NO. 37	SHEET 4 of 6

GLW GUTSCHICK LITTLE & WEBER, P.A.
 ENGINEERS, PLANNERS, SURVEYORS
 3909 NATIONAL DRIVE - SUITE 250 - BURTONSVILLE OFFICE PARK - BURTONSVILLE, MD. 20866
 TELEPHONE: (301) 421-4024

DES. DEV.	DRN. M.C.F.	CHK. C.K.G.	DATE	REVISION	BY	APP'R.

PREPARED FOR:
 Trafalgar House
 Residential Maryland
 8923 Guilford Road
 Columbia, Maryland
 21046
 Phone: (301) 621-8151

12421

F-91-18

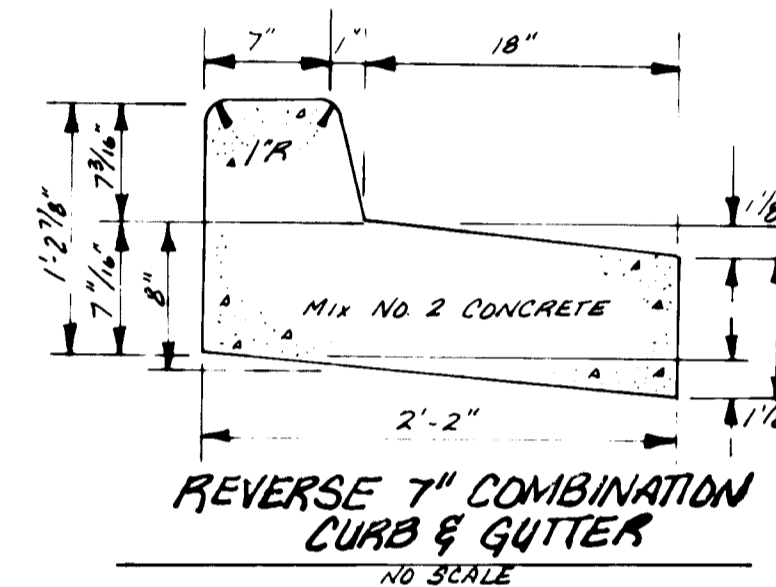
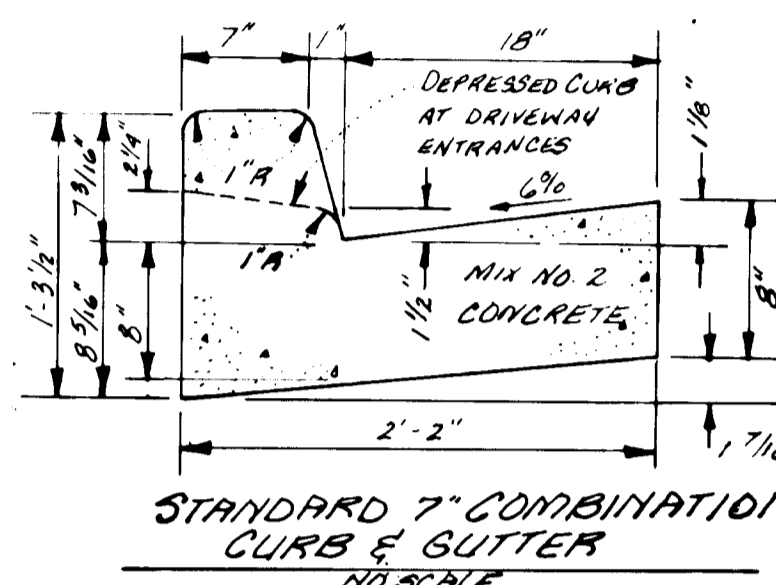
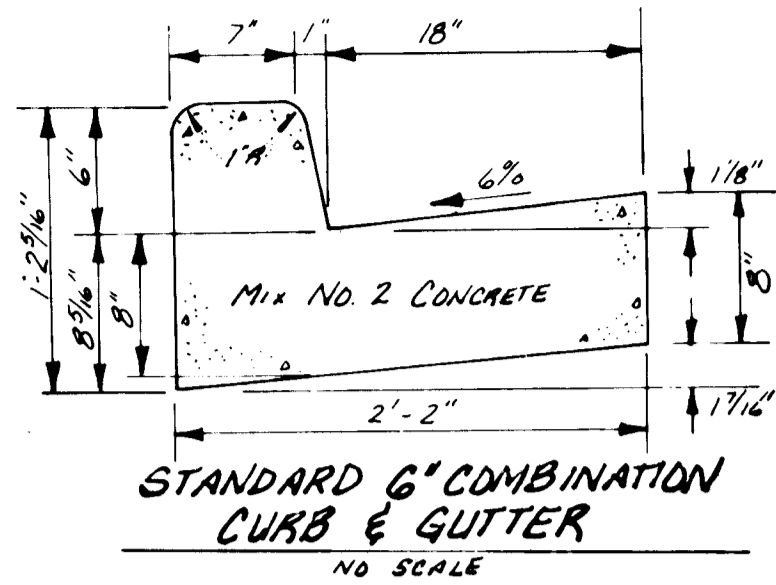

- Section 2
Construction Sequence
- Obtain grading permit.
 - Remove existing curb in Wesley Lane as directed on Sheets 1 and 2 of these drawings.
 - Install stone construction entrances as shown on these plans.
 - Contractor shall meet with inspector and make whatever repairs are necessary to the existing sediment basin on open space Lot 101.
 - Install silt fence/straw bale dikes and earth dikes as shown on these plans.
 - Begin grading and install utilities.
 - Repair stone construction entrances as needed after the installation of utilities.
 - Bring the grading up to subgrade and direct water to inlet openings.
 - Install curb and gutter, sidewalk and begin paving.
 - After paving is completed, stabilize all disturbed areas in accordance with the permanent seeding notes.
 - Upon approval of the Howard County Department of Public Works Sediment Control Inspector, remove all sediment control devices and convert temporary sediment basin at Lot 201 to stormwater management pond as follows:
 - Pump out the ponded water from the basin;
 - Remove all sediment from the basin and place it as per the directions of the Sediment Control Inspector;
 - Remove all temporary riser pipes and regrade the pond to form the grading shown on the approved construction drawings P-87-41;
 - Stabilize all remaining disturbed areas in accordance with the permanent seeding notes.

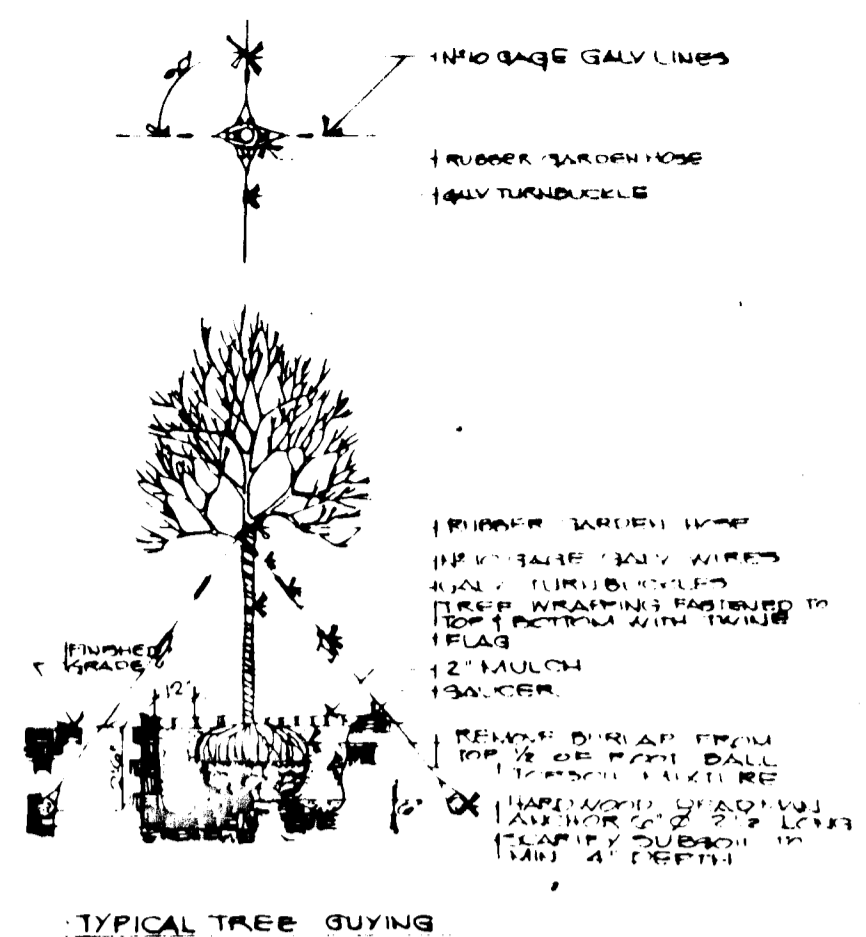

Note: Contractor shall verify location of underground utilities prior to digging. Final locations of trees may be adjusted slightly to accommodate field conditions. Planting procedures shall comply with Landscape Specifications for the Baltimore-Washington Metropolitan Area. Planting materials to be used shall be as specified, provided that the planting is in accordance with the Street Tree and Landscape Requirements as specified in Section 16.01 of the Howard County Subdivision Regulations.

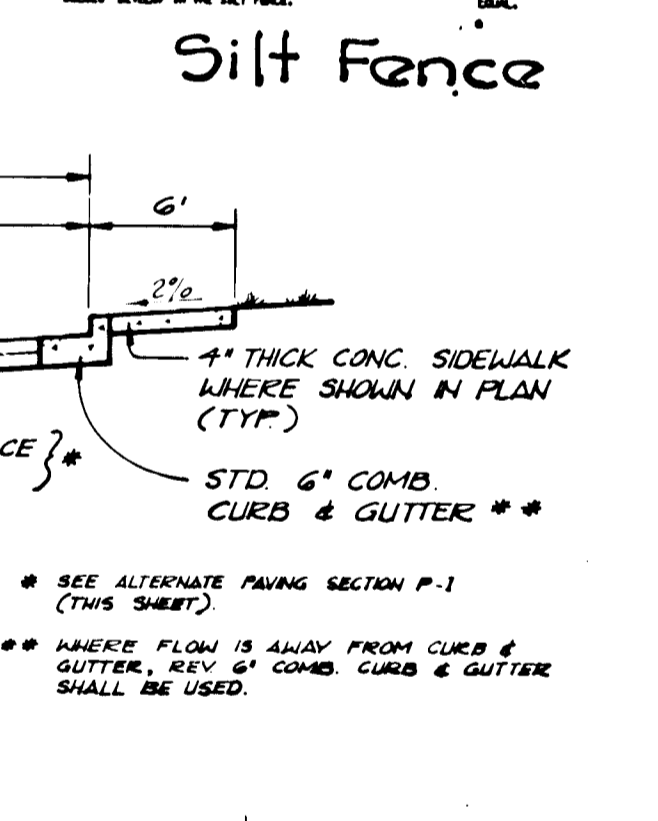
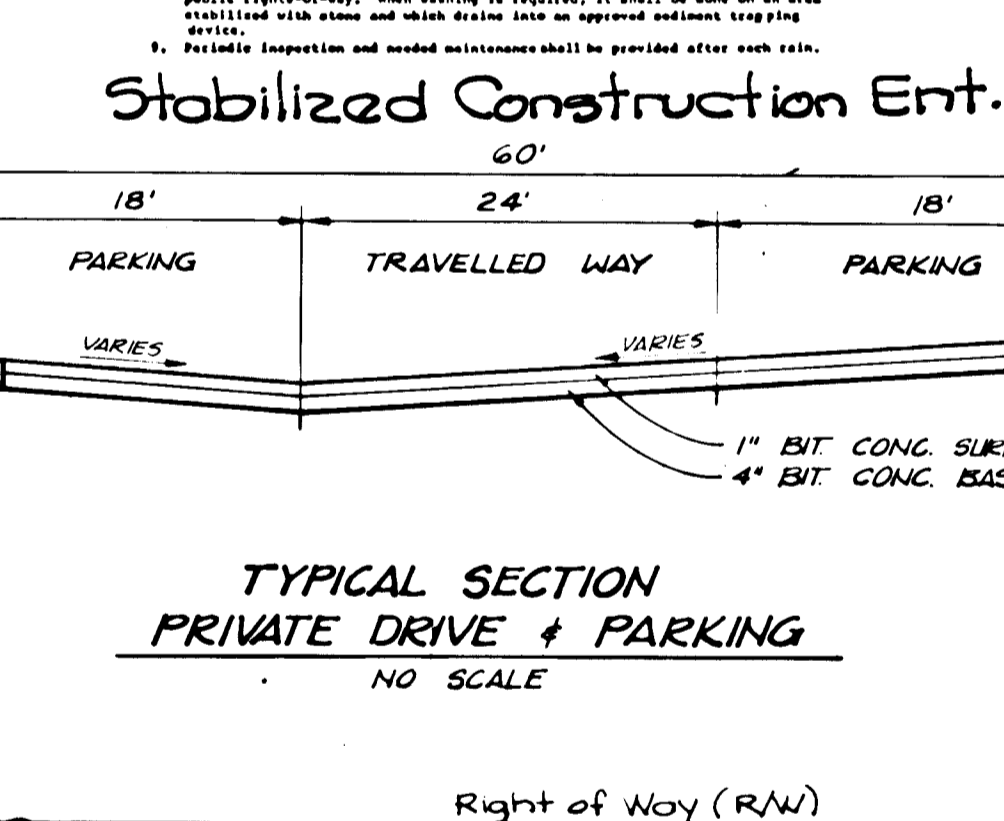
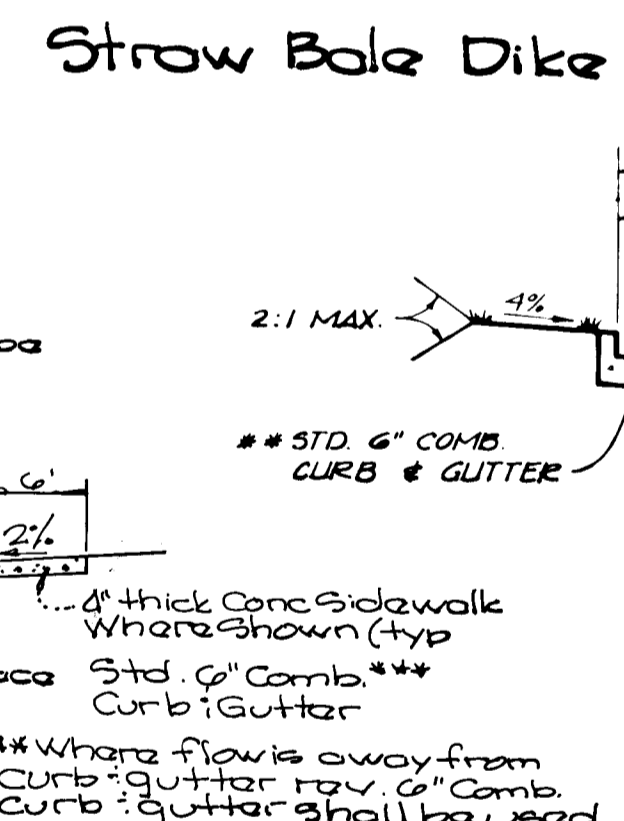
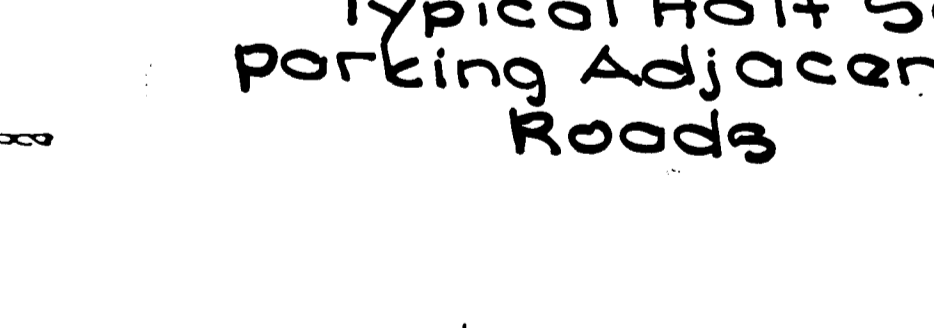
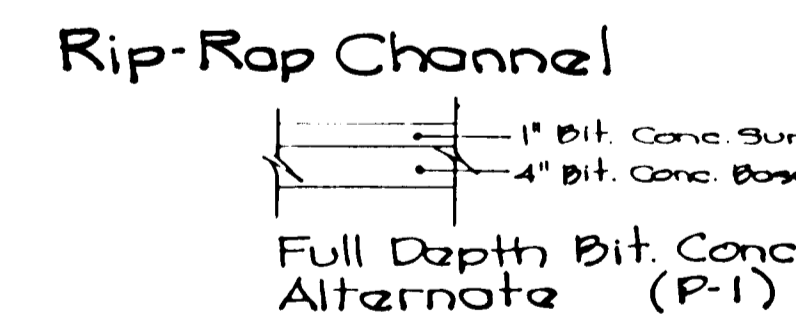
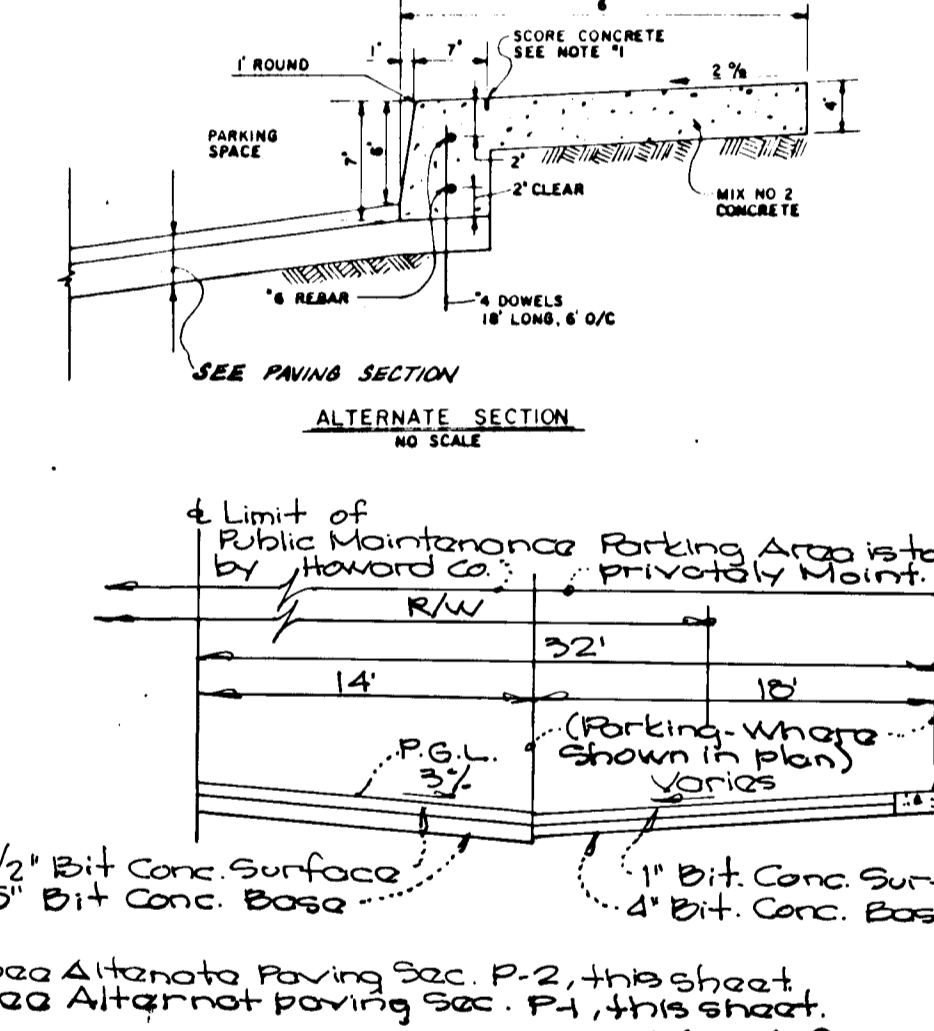
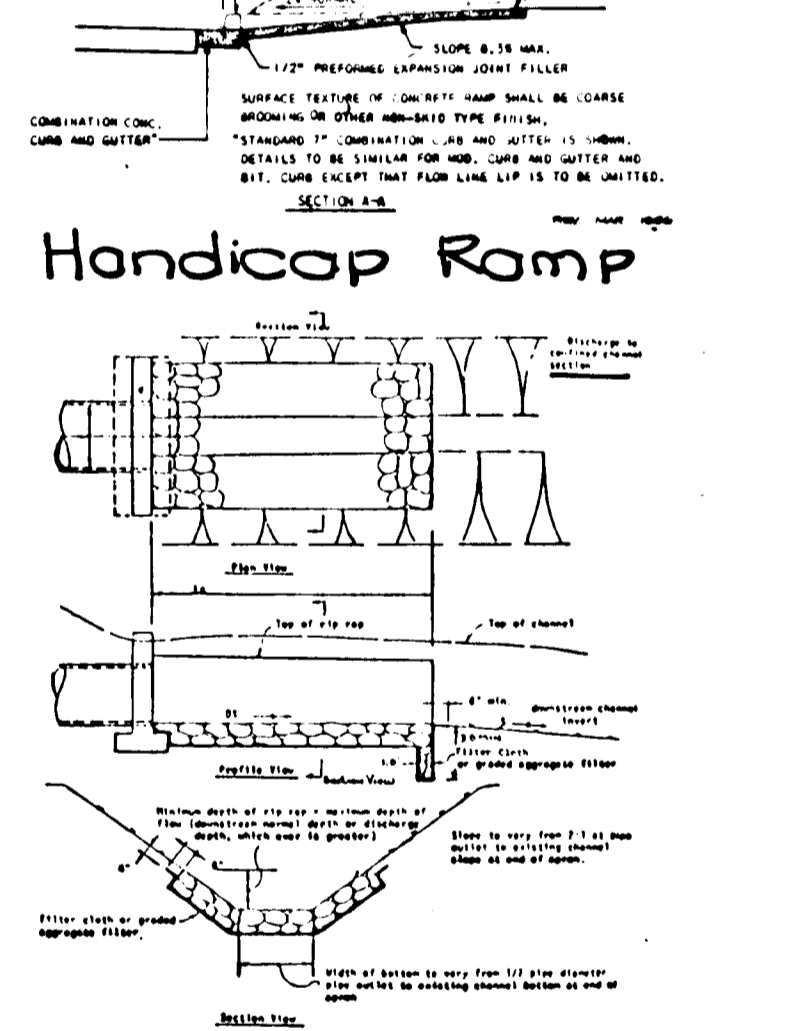
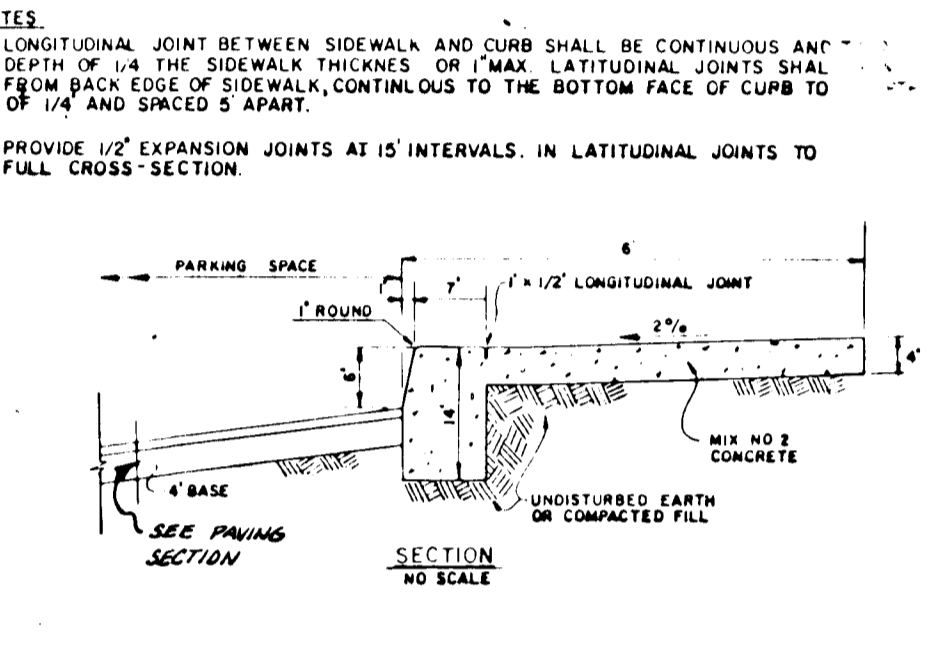
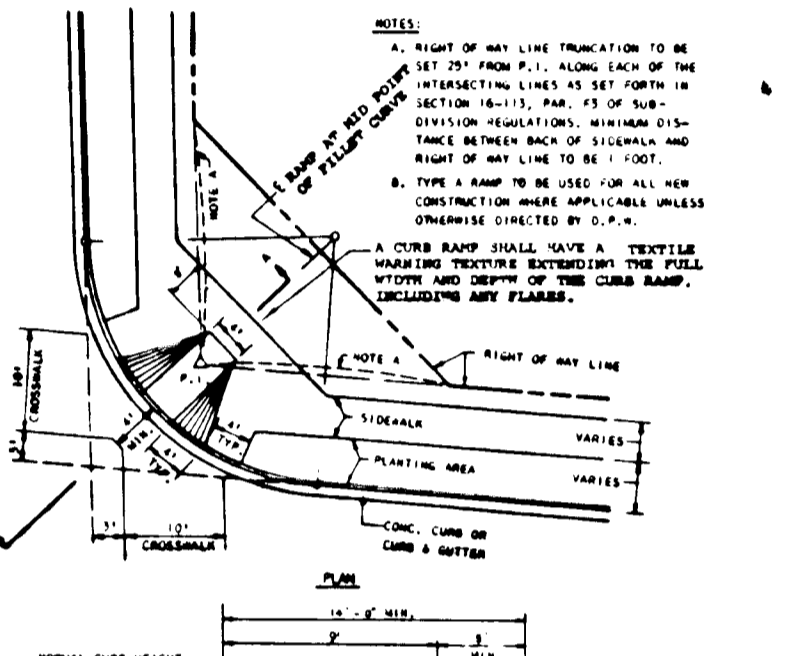
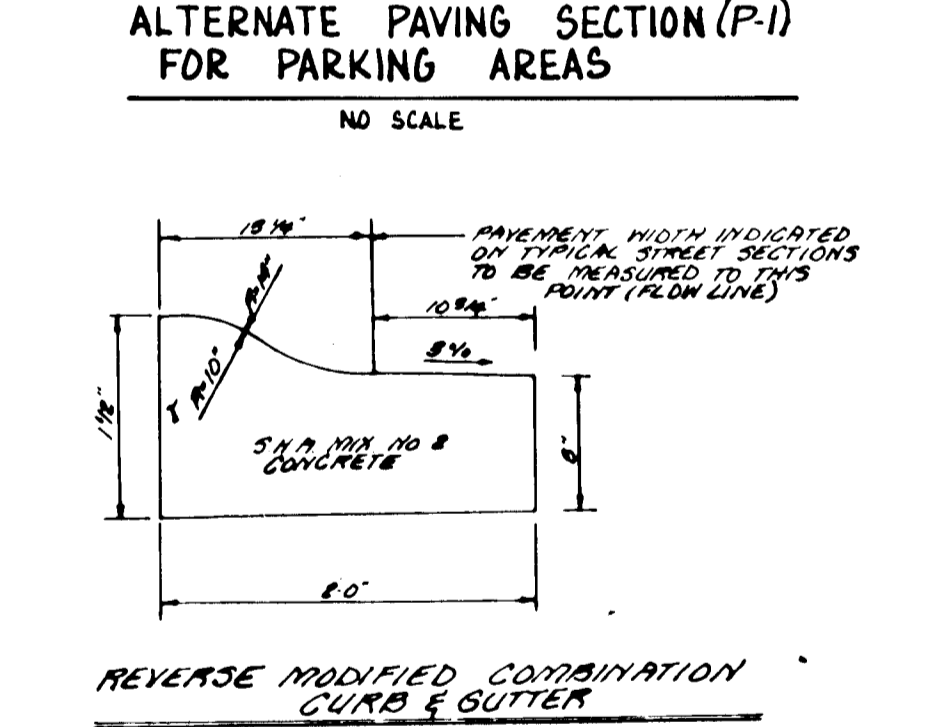
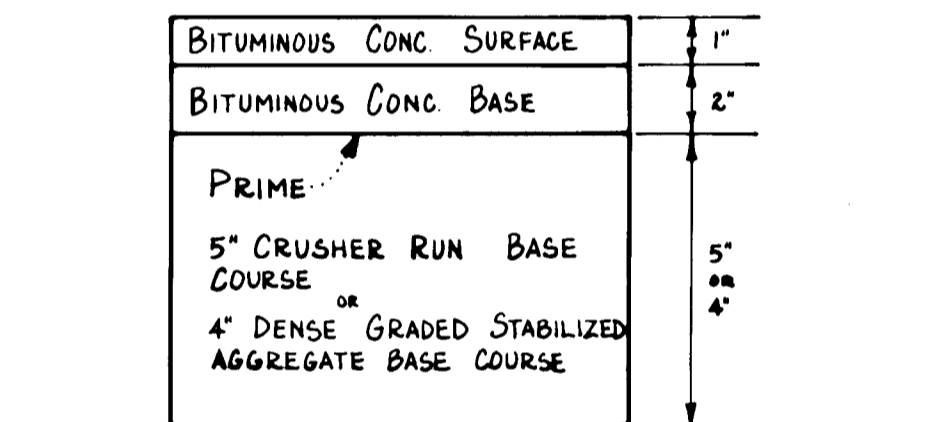
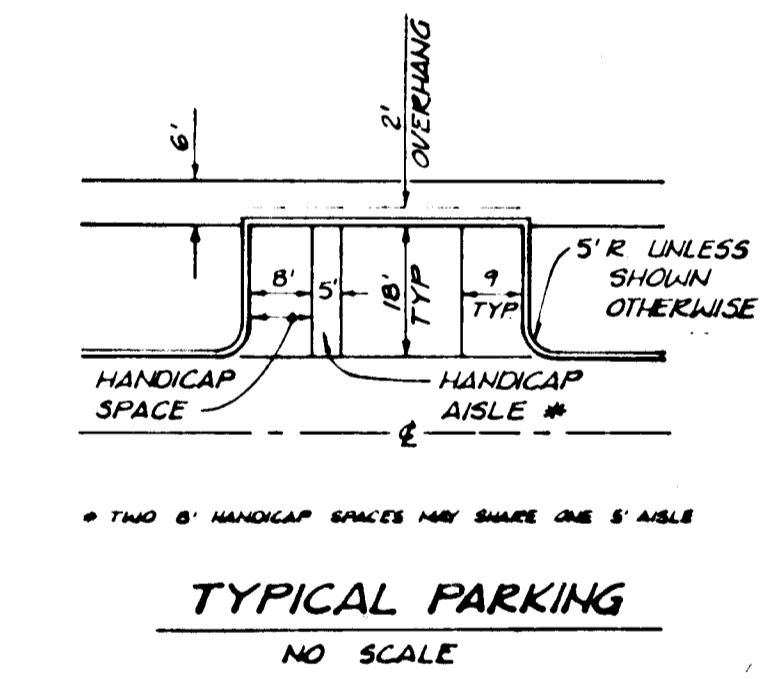

Approved
Department of Public Works
Chad Ferguson 10/24/90
Chief, Land Development Division
Date

Approved
Department of Public Works
William W. Weiland 10/30/90
Chief, Bureau of Highways
Date

Approved
Department of Planning and Zoning
David S. Dwyer 10/21/90
Chief, Division of Community Planning and Land Development
Date

ENGINEER'S CERTIFICATE
I certify that this plan for erosion and sediment control represents a practical and workable plan based on my personal knowledge of the site conditions and that it was prepared in accordance with the requirements of the Howard Soil Conservation District.

CK Gutter 7-17-90
Date

DEVELOPER'S/BUILDER'S CERTIFICATE
I certify that all development and/or construction will be done according to this plan, and that any responsible person named in the construction project will have a Certificate of Attendance of a Department of Environment Approved Training Program for the Control of Sediment and Erosion before beginning the project. I also authorize periodic on-site inspection by the HSCD.

Jeffrey H. Hill 10/24/90
Date

Michael G. Clay 7-17-90
Date

Full Depth Bit. Conc. Alternate (P-1)

Full Depth Bit. Conc. Alternate (P-2)

Granular Base Alternatives (P-2)

Notes and details for various paving sections and materials.

Street Name	Station	Type of Traffic	A	B	C	D	R/W	Zoning	E	Design Speed	Paving Section
Stratford Court		Local	28'	12'	4'	11'	50'	R-SC	10'	25 MPH	P-3
Briar Court		Private									
Knolls Court		Private									

NOTES AND DETAILS

WILLOWOOD
SECTION 2 AREA 1
LOTS 193-207
A RESUBDIVISION OF LOTS 191 & 192

Scale: 1/4" = 1'-0"

Date: 10/23/90

Tax Map No: 37

Zoning: R-SC

G.L.W. File No: 89-080

Sheet: 50FG

Street Name Station Type of Traffic A B C D R/W Zoning E Design Speed Paving Section

Stratford Court Local 28' 12' 4' 11' 50' R-SC 10' 25 MPH P-3

Briar Court Private

Knolls Court Private

GLW GUTSCHICK LITTLE & WEBER, P.A.
ENGINEERS, PLANNERS, SURVEYORS
3909 NATIONAL DRIVE SUITE 250 BURTONSVILLE OFFICE PARK BURTONSVILLE, MD 20886
TELEPHONE: (301) 421-4024

PREPARED FOR:
Trafalgar House
Residential Maryland
8965 Guilford Road
Columbia, Maryland
21046
Phone: (301) 621-8151

First Election District

Howard County, Maryland

3421

F-11-18

SEDIMENT CONTROL NOTES

1. A minimum of 24 hours notice must be given to the Howard County Office of Inspection and Permits prior to the start of any construction. (992-2437)
2. All vegetative and structural practices are to be installed according to the provisions of this plan and are to be in conformance with the 1983 MARYLAND STANDARDS AND SPECIFICATIONS FOR SOIL EROSION AND SEDIMENT CONTROL.
3. Following initial soil disturbance or redistribution, permanent or temporary stabilization shall be completed within: a) 7 calendar days for all perimeter sediment control structures, dikes and perimeter slopes and all slopes greater than 3:1, b) 14 days as to all other disturbed or graded areas on the project site.
4. All sediment traps/basins shown must be fenced and warning signs posted around their perimeter in accordance with Vol. 1, Chapter 12, of the HOWARD COUNTY DESIGN MANUAL, Storm Drainage.
5. All disturbed areas must be stabilized within the time period specified above in accordance with the 1983 MARYLAND STANDARDS AND SPECIFICATIONS FOR SOIL EROSIONS AND SEDIMENT CONTROL for permanent seedings (Sec. 51), sod (Sec. 54), temporary seedings (Sec. 50) and mulching (Sec. 52). Temporary stabilization, with mulch alone can only be done when recommended seeding dates do not allow for proper germination and establishment of grasses.
6. All sediment control structures are to remain in place and are to be maintained in operative condition until permission for their removal has been obtained from the Howard County Sediment Control Inspector.
7. Site Analysis:
 Total Area of Site: 28.47 Acres ±
 Area Disturbed: 4.79 Acres ±
 Area to be roofed or paved: 2.02 Acres ±
 Area to be vegetatively stabilized: 2.77 Acres ±
 Total Cut: 2617 Cu. Yds.
 Total Fill: 2225 Cu. Yds.
 Off-Site waste/barrow area location: WILLOWOOD 2/2
8. Any sediment control practice which is disturbed by grading activity for placement of utilities must be repaired on the same day of disturbance.
9. Additional sediment control must be provided, if deemed necessary by the Howard County DPW Sediment Control Inspector.
10. On all sites with disturbed areas in excess of 2 acres, approval of the inspection agency shall be requested upon completion of installation of perimeter erosion and sediment controls, but before proceeding with any other earth disturbance or grading. Other building or grading inspection approvals may not be authorized until this initial approval by the inspection agency is made.

PERMANENT SEEDING NOTES

Apply to graded or cleared area not subject to immediate further disturbance where a permanent long-lived vegetative cover is needed.

Seedbed Preparation: Loosen upper three inches of soil by raking, discing or other acceptable means before seeding (unless previously loosened).

Soil Amendments: In lieu of soil test recommendations, use one of the following schedules

- 1) Preferred - Apply 2 tons per acre dolomitic limestone (92 lbs/1000 square feet) and 600 lbs per acre 10-10-10 fertilizer (14 lbs/1000 sq ft) before seeding. Harrow or disc into upper three inches of soil. At time of seeding, apply 400 lbs per acre 30-0-0 ureaform fertilizer (9 lbs/1000 sq ft).
- 2) Acceptable - Apply 2 tons per acre dolomitic limestone (92 lbs/1000 sq ft) and 1000 lbs per acre 10-10-10 fertilizer (23 lbs/1000 sq ft) before seeding. Harrow or disc into upper three inches of soil.

Seeding: For the periods March 1 thru April 30, and August 1 thru October 15, seed with 60 lbs per acre (1.4 lbs/1000 sq ft) of Kentucky 31 Tall Fescue. For the period May 1 thru July 31, seed with 60 lbs Kentucky 31 Tall Fescue per acre and 2 lbs per acre (.05 lbs/1000 sq ft) of weeping lovegrass. During the period of October 16 thru February 28, protect site by: Option (1) 2 tons per acre of well anchored straw mulch and seed as soon as possible in the spring. Option (2) Use sod. Option (3) Seed with 60 lbs/acre Kentucky 31 Tall Fescue and mulch with 2 tons/acre well anchored straw.

Mulching: Apply 1-1/2 to 2 tons per acre (70 to 90 lbs/1000 sq ft) of unrotted small grain straw immediately after seeding. Anchor mulch immediately after application using mulch anchoring tool or 218 gallons per acre (5 gal/1000 sq ft) of emulsified asphalt on flat areas. On slopes 8 feet or higher, use 348 gallons per acre (8 gal/1000 sq ft) for anchoring.

Maintenance: Inspect all seeded areas and make needed repairs, replacements and reseeding.

TEMPORARY SEEDING NOTES

Apply to graded or cleared areas likely to be redisturbed where a short-term vegetative cover is needed.

Seedbed Preparation: Loosen upper three inches of soil by raking, discing or other acceptable means before seeding (unless previously loosened).

Soil Amendments: Apply 600 lbs per acre 10-10-10 fertilizer (14 lbs/1000 sq ft).

Seeding: For periods March 1 thru April 30 and from August 15 thru November 15, seed with 2-1/2 bushel per acre of annual rye (3.2 lbs./1000 sq ft.). For the period May 1 thru August 14, seed with 3 lbs per acre of weeping lovegrass (.07 lbs/1000 sq ft.). For the period November 16 thru February 28, protect site by applying 2 tons per acre of well anchored straw mulch and seed as soon as possible in the spring, or use sod.

Mulching: Apply 1-1/2 to 2 tons per acre (70 to 90 lbs/1000 sq ft) of unrotted small grain straw immediately after seeding. Anchor mulch immediately after application using mulch anchoring tool or 218 gal per acre (5 gal/1000 sq ft) of emulsified asphalt on flat areas. On slopes, 8 ft or higher, use 348 gal per acre (8 gal/1000 sq ft) for anchoring.

Refer to the 1983 MARYLAND STANDARDS AND SPECIFICATIONS FOR SOIL EROSION AND SEDIMENT CONTROL for rate and methods not covered.

DEVELOPER'S/BUILDER'S CERTIFICATE

"I/We certify that all development and/or construction will be done according to this plan, and that any responsible personnel involved in the construction project will have a Certificate of Attendance at a Department of the Environment Approved Training Program for the Control of Sediment and Erosion before beginning the project. I also authorize periodic on-site inspection by the HSCD."

Michael D. Clay
 Signature of Developer/Builder
 7-17-90
 Date

ENGINEER'S CERTIFICATE

"I certify that this plan for erosion and sediment control represents a practical and workable plan based on my personal knowledge of the site conditions and that it was prepared in accordance with the requirements of the Howard Soil Conservation District."

CK Hutcheson
 Signature of Engineer
 7-17-90
 Date

THIS DEVELOPMENT PLAN IS APPROVED FOR SOIL EROSION AND SEDIMENT CONTROL BY THE HOWARD SOIL CONSERVATION DISTRICT.

Jeff W. Shroyer
 Signature of HSCD
 10/24/90
 Date

These plans have been reviewed for the Howard Soil Conservation District and meet the technical requirements.

James M. Selva
 Signature of HSCD
 10/24/90
 Date

Approved Department of Public Works
John M. Ferguson 10/31/90
 Chief, Land Development Division / Date

Francisco W. Weiland 10/31/90
 Chief, Bureau of Highways / Date

William E. Kelly 11-1-90
 Chief, Bureau of Engineering / Date

Approved Department of Planning & Zoning
Mark L. Dwyer 11/23/90
 Chief, Division of Community Planning and Land Development / Date

GLW GUTSCHICK LITTLE & WEBER, P.A.
 ENGINEERS, PLANNERS, SURVEYORS

3909 NATIONAL DRIVE - SUITE 250 - BURTONSVILLE OFFICE PARK - BURTONSVILLE, MD 20866
 TELEPHONE: (301) 421-4024

DATE	REVISION	BY	APP'R.

PREPARED FOR:
 TRAFALGAR HOUSE
 RESIDENTIAL MARYLAND
 8268 GUILFORD ROAD
 COLUMBIA, MARYLAND
 21046
 PHONE: (301) 621-8151

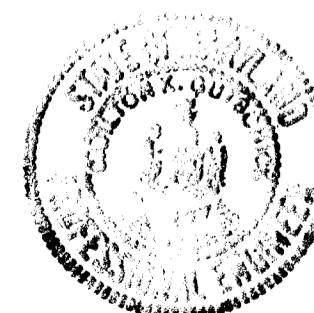

CK Hutcheson

AGREEMENT NOTING NO LIABILITY INFORMATION SHOWN ON THIS SHEET
SEDIMENT CONTROL AND SEEDING NOTES

WILLOWOOD
 SECTION 2 AREA 1
 LOTS 150-207
 A RESUBDIVISION OF LOTS 151 & 152

SCALE AS SHOWN	ZONING	G.L.W. FILE NO.
	R-50	89-080
DATE	TAX MAP NO.	SHEET
10/23/90 G.T. 1928	37	GDFG