

SHEET INDEX

NO.	DESCRIPTION
1	PLAN OF MILADY WAY, SQUIRES COURT, AND WOODSONG COURT
2	ROAD PROFILES AND DETAILS
3	GRADING AND SEDIMENT CONTROL PLAN
4	PLANTING PLAN, DRAINAGE AREA MAP AND STORM DRAIN PROFILES

PROPERTY OF  
BALTIMORE GAS AND ELECTRIC CO.  
572 / 707  
ZONED RSC

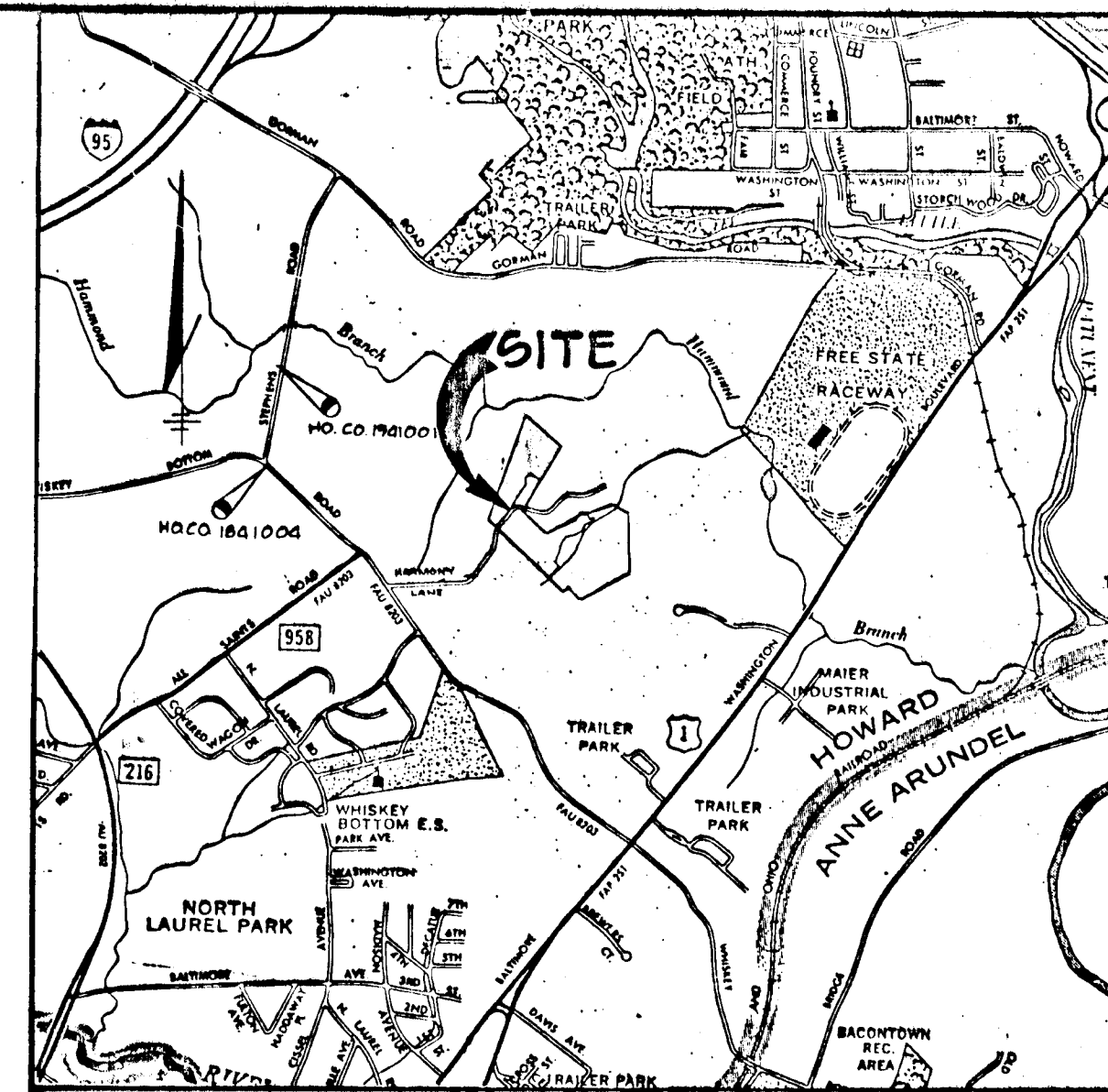

VICINITY MAP

SCALE: 1"=2000

BENCH MARKS

HO. CO. 1641004 ELEV. 295.392  
REBAR 'G': SOUTH OF SOUTH EDGE OF  
WHISKEY BOTTOM ROAD NEAR THE  
INTERSECTION OF STEPHENS ROAD  
N 471079.018 E 842657.878

HO. CO. 1641001 ELEV. 277.873  
REBAR 'A': WEST EDGE OF STEPHENS  
ROAD IN FRONT OF HOUSE N° 8820.03'  
BELOW SURFACE.  
N 472223.110 E 842797.549

- GENERAL NOTES**
- ALL WORK SHALL BE PERFORMED IN ACCORDANCE WITH THE HOWARD COUNTY DESIGN MANUAL, VOLUME IV, STANDARD SPECIFICATIONS AND DETAILS FOR ROAD CONSTRUCTION.
  - APPROXIMATE LOCATION OF EXISTING UTILITIES ARE SHOWN. THE CONTRACTOR SHALL TAKE ALL NECESSARY PRECAUTIONS TO PROTECT THE EXISTING UTILITIES AND MAINTAIN UNINTERRUPTED SERVICE. ANY DAMAGE INCURRED DUE TO CONTRACTOR'S OPERATION SHALL BE REPAIRED IMMEDIATELY AT THE CONTRACTOR'S EXPENSE.
  - THE CONTRACTOR SHALL TEST PIT EXISTING UTILITIES, WHERE DIRECTED BY THE ENGINEER, A MINIMUM OF TWO WEEKS IN ADVANCE OF CONSTRUCTION OPERATIONS.
  - CONTRACTOR TO NOTIFY THE FOLLOWING UTILITIES AT LEAST THREE DAYS BEFORE STARTING WORK SHOWN ON THESE DRAWINGS.
    - BELL TELEPHONE SYSTEM 393-3649
    - LONG DISTANCE CABLE DIVISION 393-3553 OR 3554
    - BALTIMORE GAS AND ELECTRIC 539-8000 EXT. 691
    - HOWARD COUNTY BUREAU OF UTILITIES 992-2366
    - HOWARD COUNTY CONSTRUCTION INSPECTION SURVEY DIVISION 992-2417 OR 2418
  - ALL INLETS SHALL BE CONSTRUCTED IN ACCORDANCE WITH HOWARD COUNTY STANDARDS.
  - ALL STREET CURB RETURNS SHALL HAVE 20.0' RADII UNLESS OTHERWISE NOTED.
  - STORM DRAIN TRENCHES WITHIN ROAD RIGHT OF WAY SHALL BE BACKFILLED AND COMPACTED IN ACCORDANCE WITH HOWARD COUNTY ROAD CODE.
  - INSTALLATION OF TRAFFIC CONTROL DEVICES, MARKING AND SIGNING SHALL BE IN ACCORDANCE WITH THE MANUAL OF UNIFORM TRAFFIC CONTROL DEVICES 1984 EDITION.
  - PIPE SHALL NOT BE INSTALLED BY THE CONTRACTOR UNTIL THE LENGTH CALLED FOR AT EACH STATION HAS BEEN APPROVED BY THE ENGINEER IN THE FIELD.
  - DESIGNED TRAFFIC SPEED IN ACCORDANCE WITH THE AMERICAN ASSOCIATION OF STATE HIGHWAY OFFICIAL STANDARDS:
    - ALL CUL-DE-SAC DESIGNED FOR 25 M.P.H., ALL LOCAL STREETS DESIGNED FOR 30 M.P.H.
    - ALL MINOR COLLECTORS DESIGNED FOR 35 M.P.H., ALL MAJOR COLLECTORS FOR 40 M.P.H.
  - ALL ELEVATIONS SHOWN ARE BASED ON U.S.C. AND G.S. MEAN SEA LEVEL DATUM 1929.
  - STORMWATER MANAGEMENT FOR THIS SITE IS PROVIDED UNDER KINGS WOODS SECTION 1, AREA 1 F-87-207.

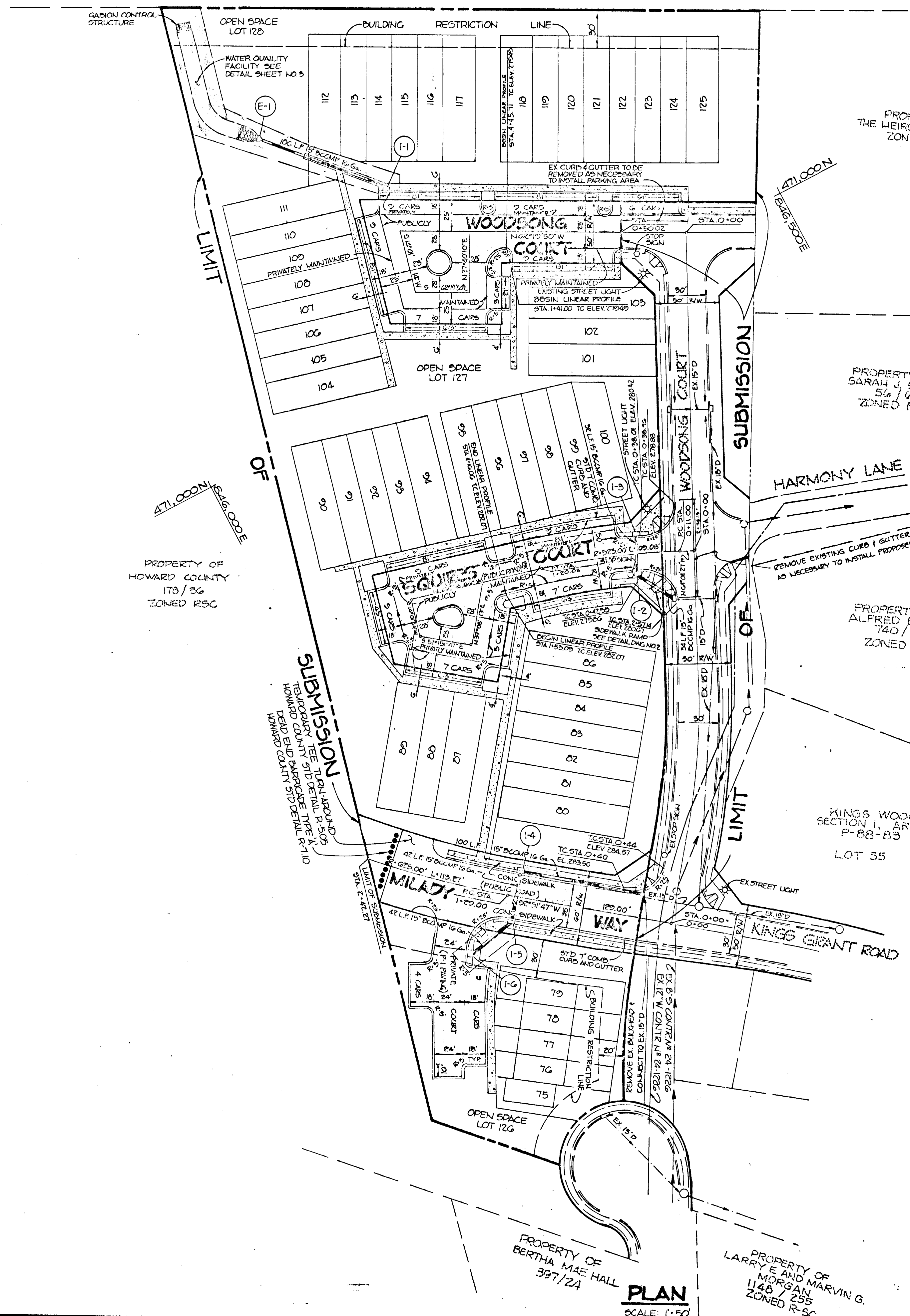

**STRUCTURE SCHEDULE**

NO.	TYPE	LOCATION	INV. IN	INV. OUT	TC ELEV.	REMARKS
I-1	A-5	19.92' LT L.P. STA 3+50 WOODSONG CT.	--	273.0	278.03	H.C. STD S.D. 4.01
I-2	A-5 W/DEFL	15.92' LT & STA 0+45 SQUIRES CT.	275.68	275.48	279.91	H.C. STD S.D. 4.01
I-3	A-5 W/DEFL	15.92' RT & STA 0+45 SQUIRES CT.	--	276.0	279.91	H.C. STD S.D. 4.01
I-4	A-5	20.92' RT & STA 1+22 MILADY WAY	274.71	274.51	281.04	H.C. STD S.D. 4.01
I-5	A-5	20.92' LT & STA 1+22 MILADY WAY	275.33	275.13	281.04	H.C. STD S.D. 4.01
I-6	A-5	SEE PLAN	--	275.75	279.68	H.C. STD S.D. 4.01
E-1	15" END SECTION	SEE PLAN	--	270.10	--	H.C. STD S.D. 5.16

APPROVED: HOWARD COUNTY DEPT. OF PLANNING AND ZONING.  
*Shirley S. Day* 9/19/89  
 CHIEF, DIVISION OF COMMUNITY PLANNING AND LAND DEVELOPMENT

APPROVED: HOWARD COUNTY DEPARTMENT OF PUBLIC WORKS  
*Paul R. Brown* 9/8/89  
 CHIEF, LAND DEVELOPMENT DIVISION

*Donville W. Wehland* 9/7/89  
 CHIEF, BUREAU OF HIGHWAYS

*William E. Day* 9-11-89  
 CHIEF, BUREAU OF ENGINEERING

**TRACY, SCHULTE & ASSOCIATES INC.**  
 planning • architecture • engineering

8480 Baltimore National Pike • Ellicott City, Maryland 21043 • (301) 465-6105

OWNER SECURITY DEVELOPMENT CORP P.O. BOX 417 ELLICOTT CITY, MARYLAND 2043	PROJECT <b>KINGS WOODS</b> SECTION 1, AREA 3
DEVELOPER SECURITY DEVELOPMENT CORP. P.O. BOX 417 ELLICOTT CITY, MARYLAND 2043	LOCATION TAX MAP NO. 47 PARCEL NO. 756 6TH ELECTION DISTRICT HOWARD COUNTY, MARYLAND
DES. D.A.M.	DRN. R.C./J.L.D.
DATE MAY 1, 1989 AUG 15, 1989	TITLE PLAN OF MILADY WAY, SQUIRES COURT AND WOODSONG COURT 9-00-30 P-89-24 F-00-210 PROJECT NO. 0165
SCALE 1"=50'	DRAWING 1 OF 4

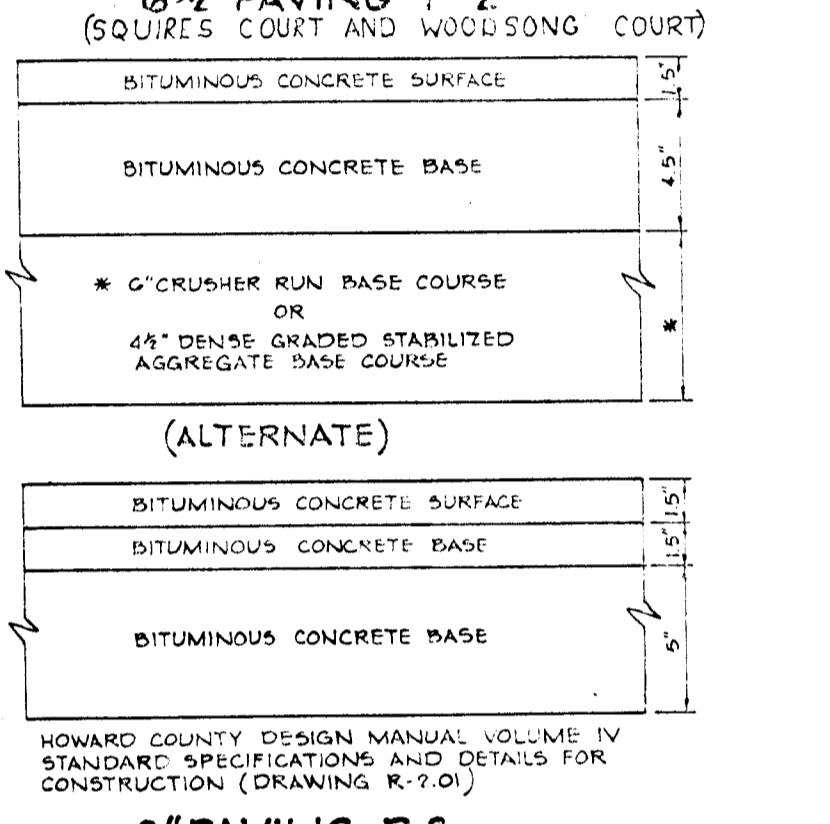
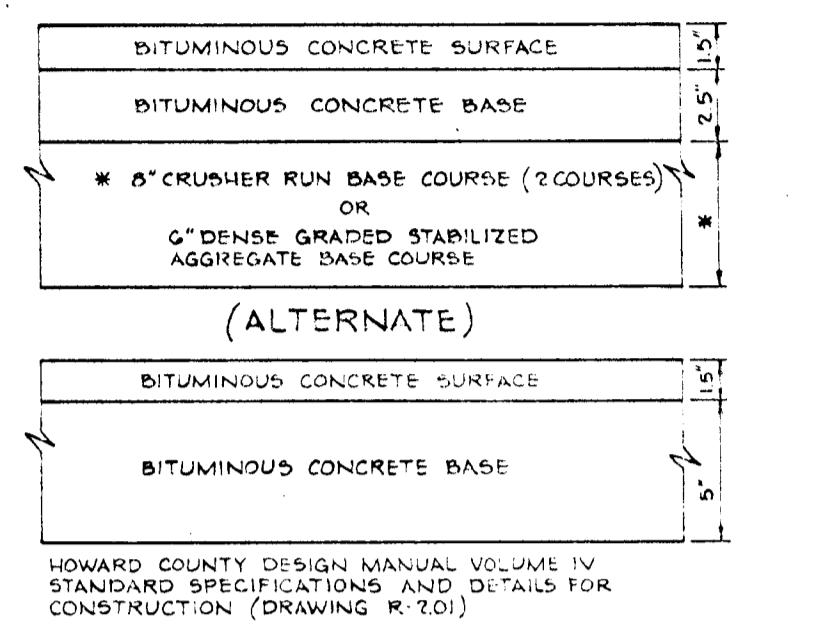
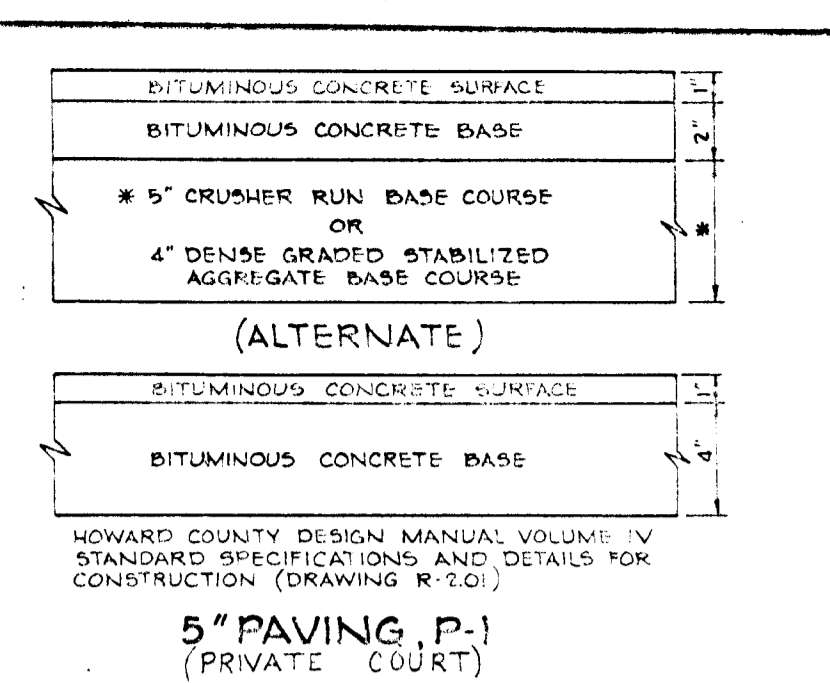
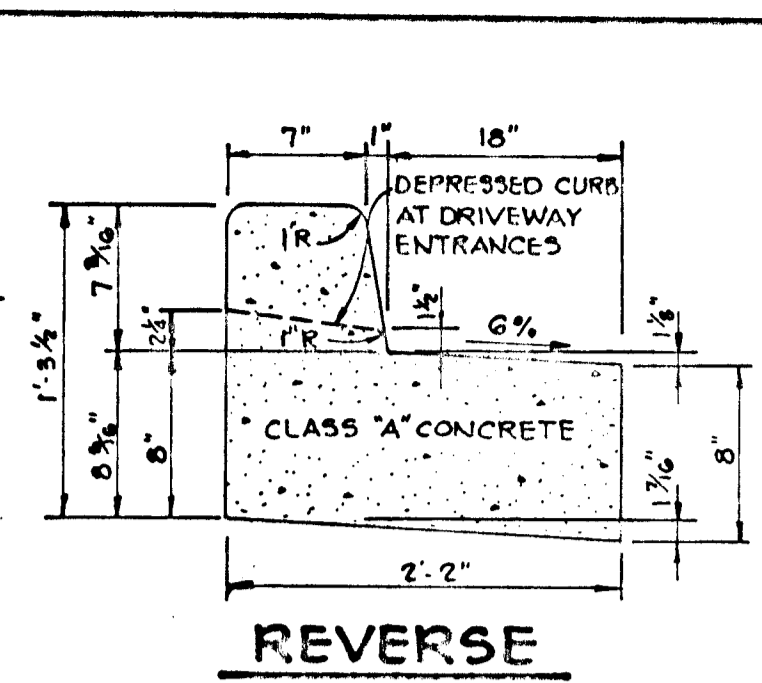
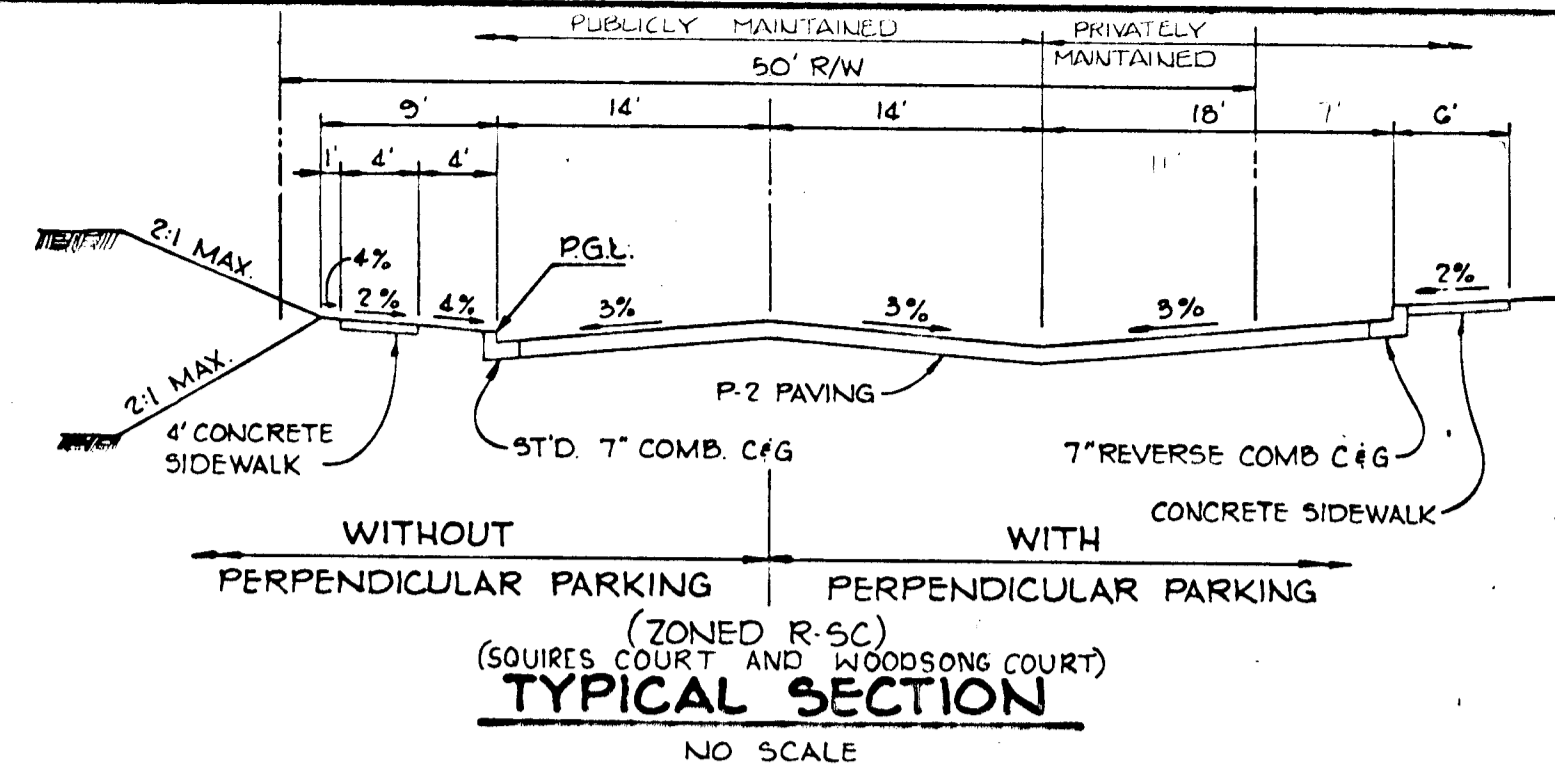
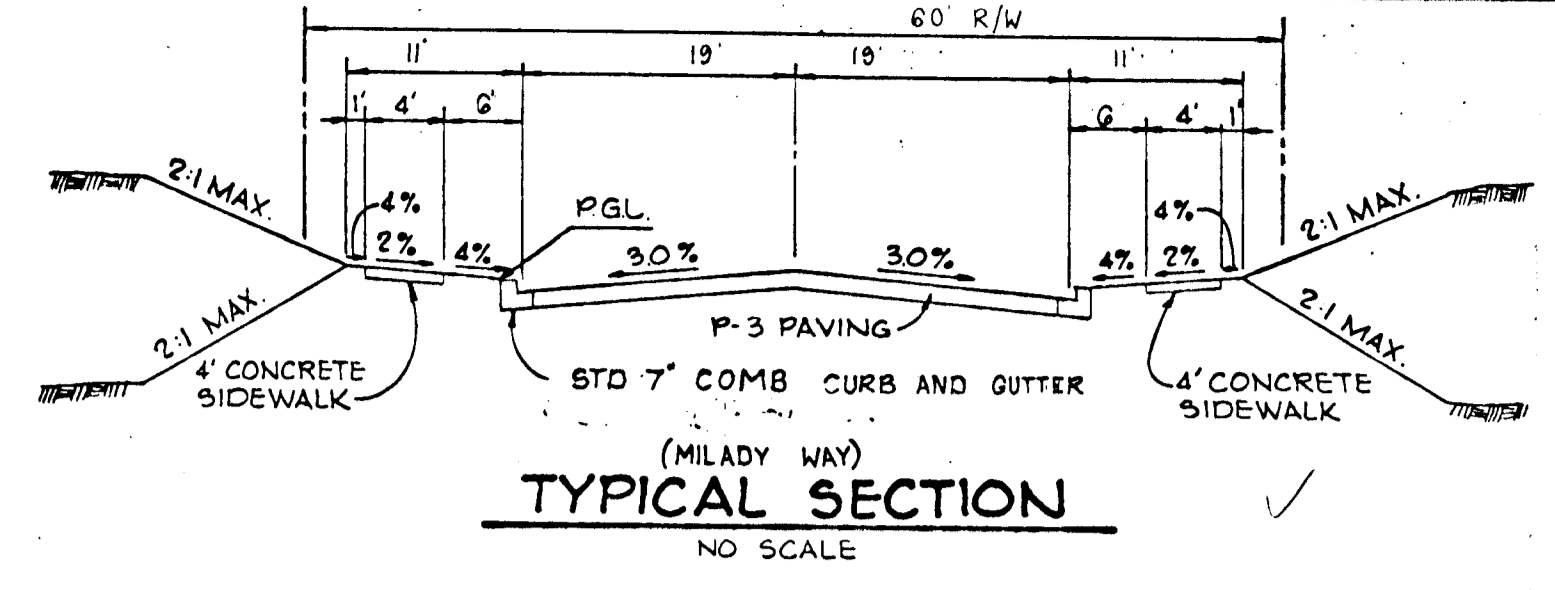
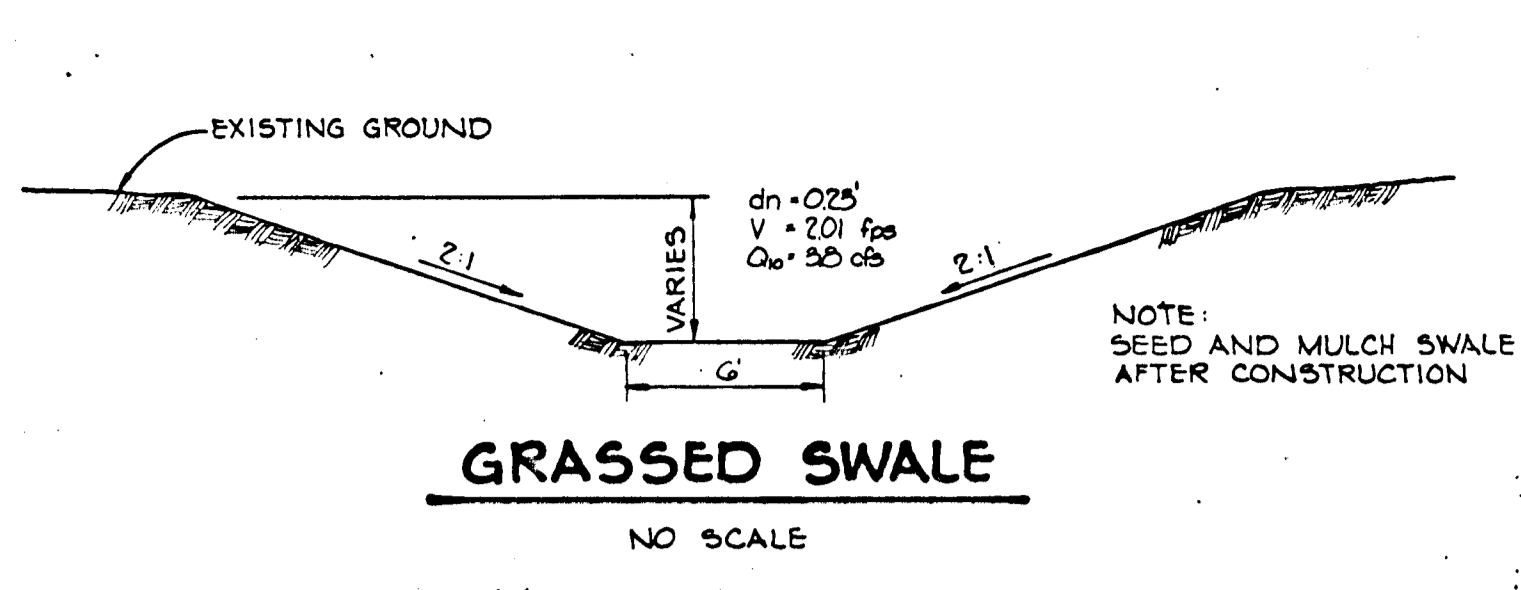

**TYPICAL PAVING SECTIONS**  
NO SCALE

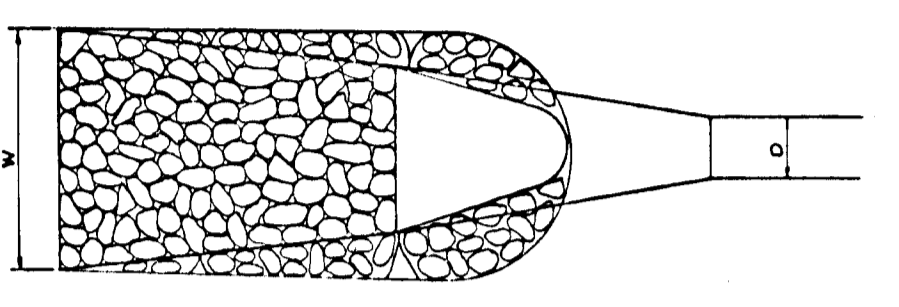
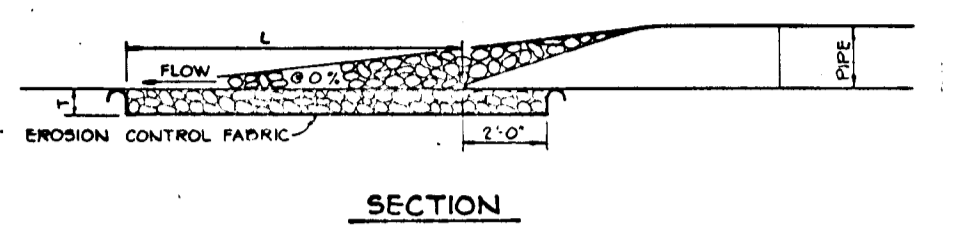
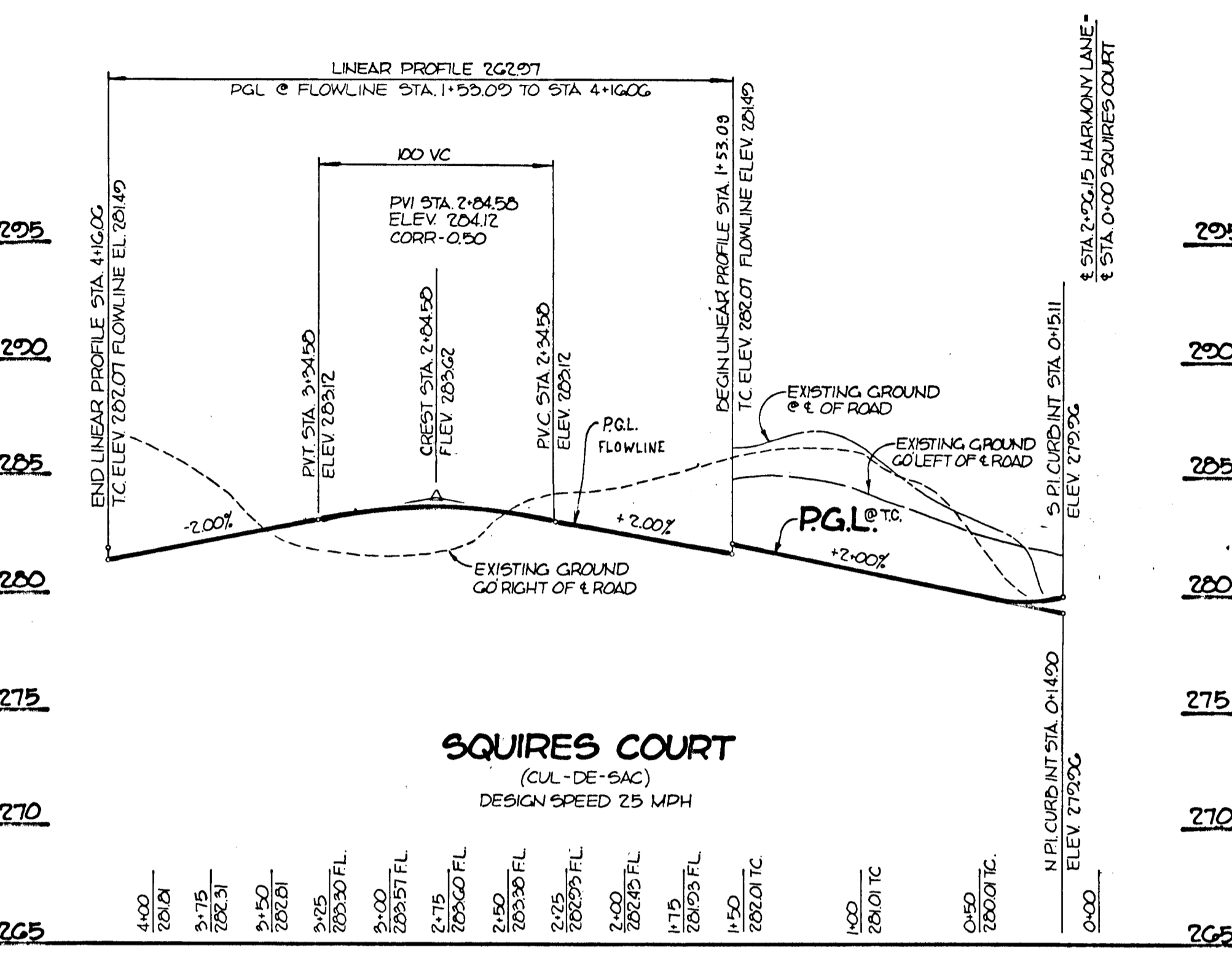

STRUCTURE	G.S.O.	LENGTH (L)	WIDTH (W)	THICKNESS (T)
E-1	0.5	10	10	1.18

**OUTLET PROTECTION**  
DETAIL  
NO SCALE

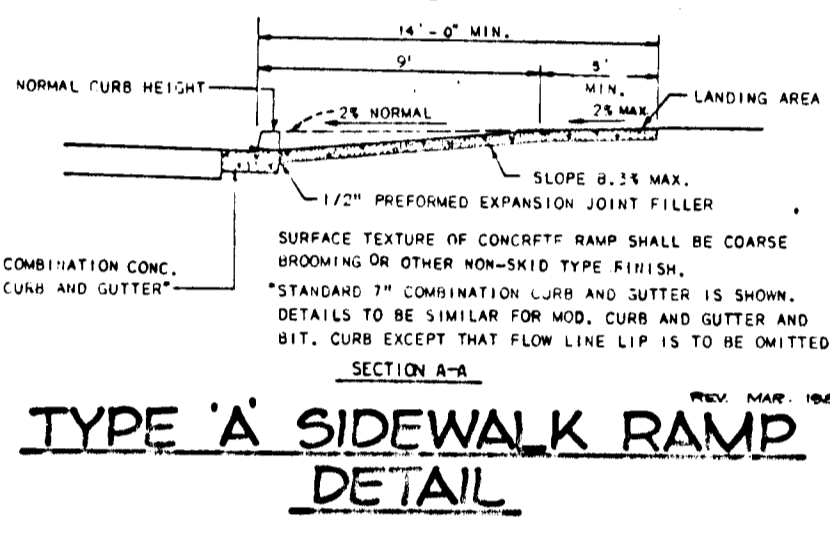
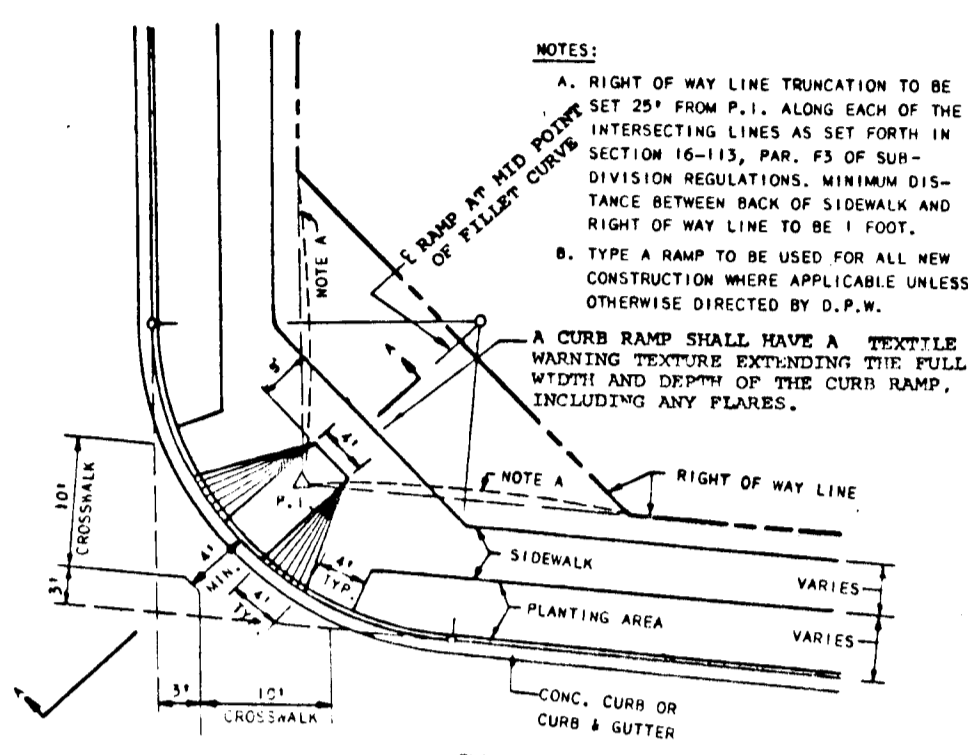
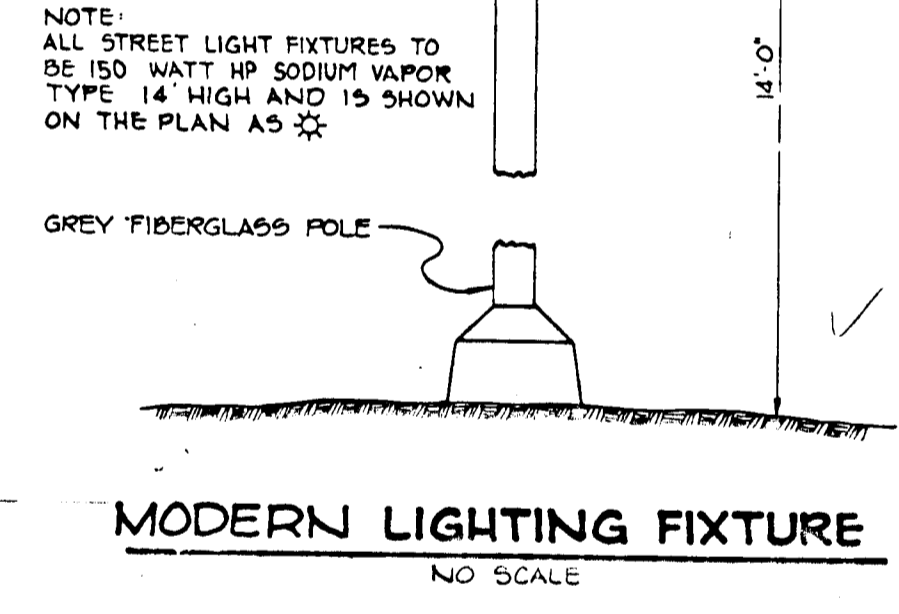
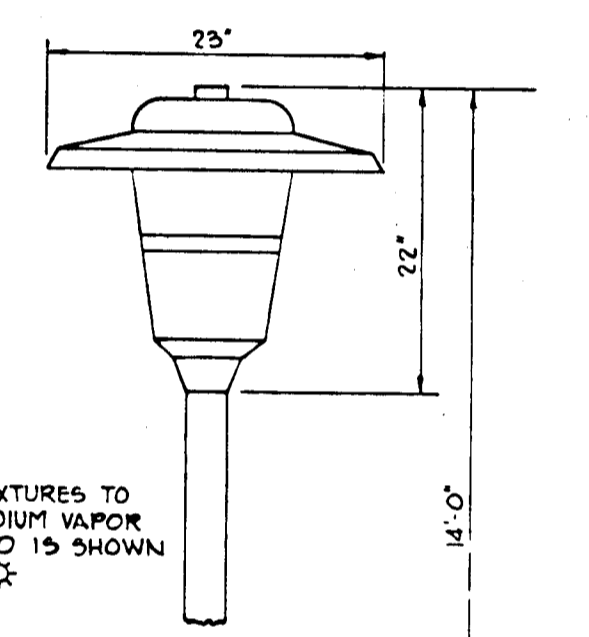

**STANDARD 7" COMBINATION CURB AND GUTTER**

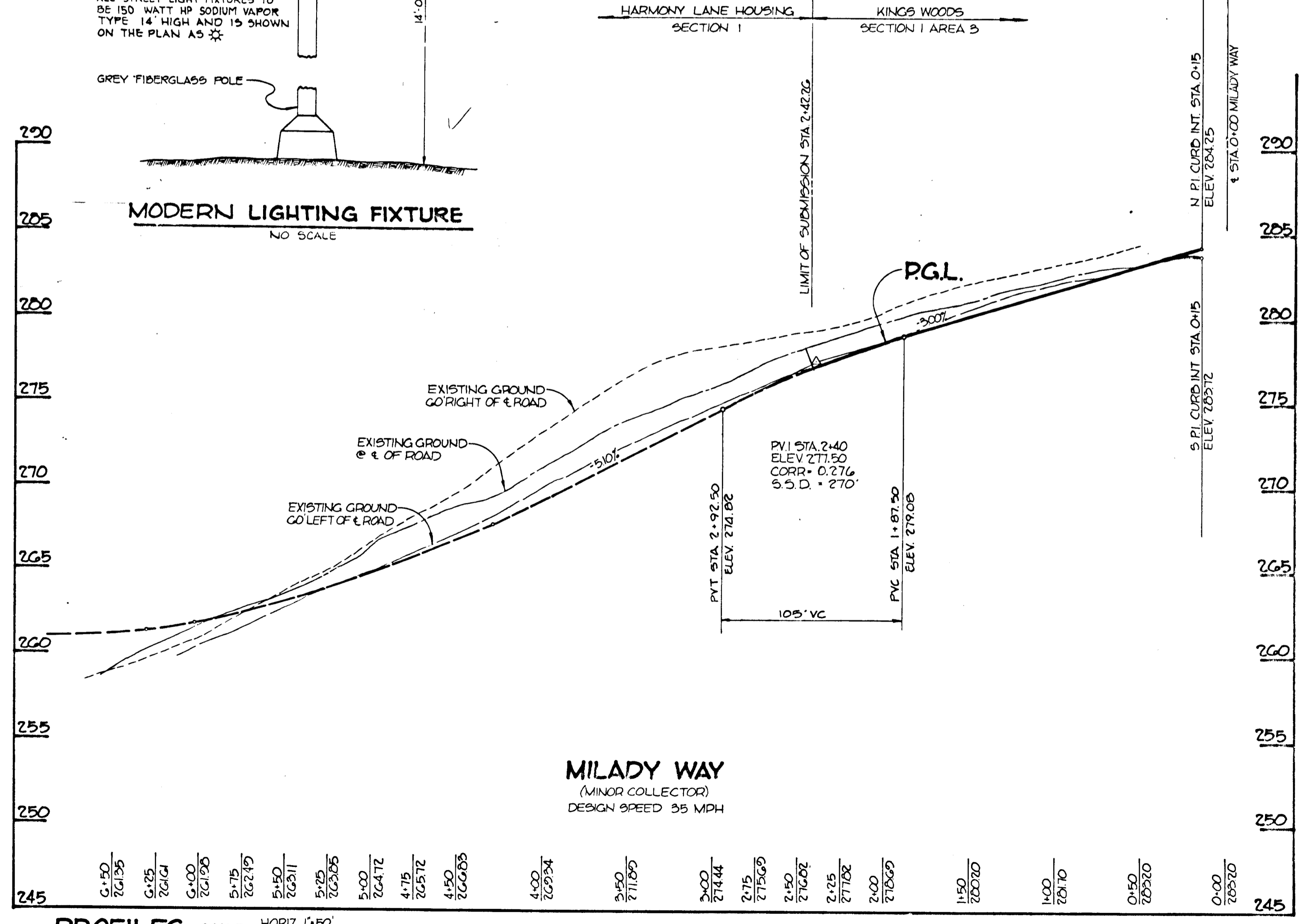
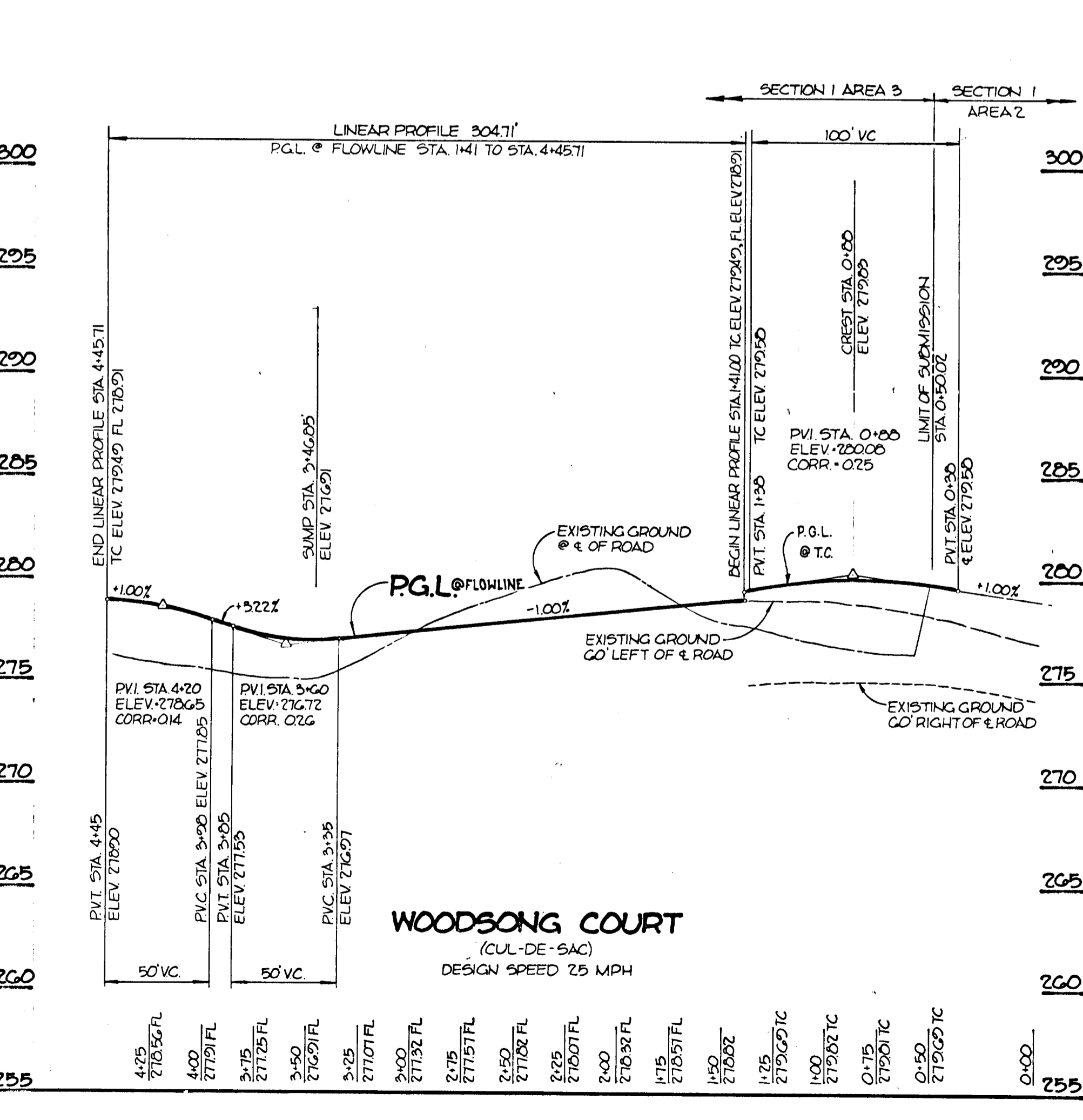
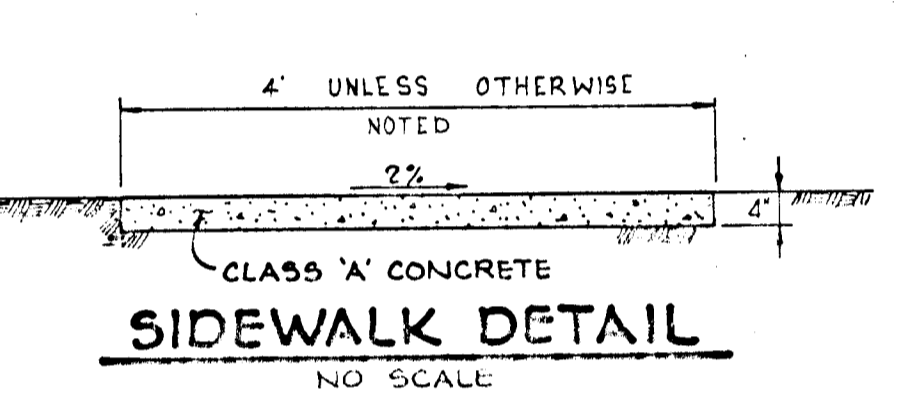

**PROFILES** SCALE: HORIZ. 1"=50' VERT. 1"=5'

APPROVED: HOWARD COUNTY DEPARTMENT OF PUBLIC WORKS  
*Paul W. Sapon* CHIEF, LAND DEVELOPMENT DIVISION DATE 9/8/09  
*Crawford W. Welles* CHIEF, BUREAU OF HIGHWAYS DATE 9/7/09  
*William S. Ray* CHIEF, BUREAU OF ENGINEERING DATE 9/11/09

APPROVED: HOWARD COUNTY DEPT. OF PLANNING AND ZONING  
*Mark J. D'Agostino* CHIEF, DIVISION OF COMMUNITY PLANNING AND LAND DEVELOPMENT DATE 9/15/09

NO. DATE REVISION

TRACY, SCHULTE & ASSOCIATES INC.  
 planning • architecture • engineering  
 8480 Baltimore National Pike • Ellicott City, Maryland 21043 • (301) 465-6105

OWNER: SECURITY DEVELOPMENT CORP  
 PO BOX 417  
 ELLICOTT CITY, MARYLAND 21043

PROJECT: **KINGS WOODS**  
 SECTION 1 AREA 3

LOCATION: TAX MAP NO. 47  
 PARCEL NO. 756  
 6TH ELECTION DISTRICT  
 HOWARD COUNTY, MARYLAND

DEVELOPER: SECURITY DEVELOPMENT CORP  
 PO BOX 417  
 ELLICOTT CITY, MARYLAND 21043

TITLE: **ROAD PROFILES AND DETAILS**  
 5-88-35 P-89-34 F-89-20  
 DATE: MAY 1, 1989  
 AUG 15, 1989 PROJECT NO. OIG5

DES. D.A.M. DRN. J.L.T. SCALE: AS SHOWN DRAWING 2 OF 4

**STONE OUTLET SEDIMENT TRAP No. 1**  
 DRAINAGE AREA 10 AC  
 VOLUME REQUIRED 2940 CU FT  
 VOLUME PROVIDED 5616 CU FT  
 CREST ELEVATION 270.0  
 BOTTOM ELEVATION 262.0  
 TOP ELEVATION 272.0  
 CLEANOUT ELEVATION 267.5  
 CREST WIDTH 50'  
 DEPTH 50'

**WATER QUALITY DATA**  
 VOLUME REQ 265 FT<sup>3</sup>  
 VOLUME PROVIDED 266 FT<sup>3</sup>  
 CREST ELEV 270.0  
 TOP ELEV 271.0

**STONE OUTLET SEDIMENT TRAP No. 2**  
 DRAINAGE AREA 0.2 AC  
 VOLUME REQUIRED 1000 CU FT  
 VOLUME PROVIDED 1400 CU FT  
 CREST ELEVATION 280.0  
 BOTTOM ELEVATION 281.0  
 TOP ELEVATION 281.0  
 CLEANOUT ELEVATION 277.5  
 CREST WIDTH 4'  
 BOTTOM DIMENSION 5'-25"  
 DEPTH 50'

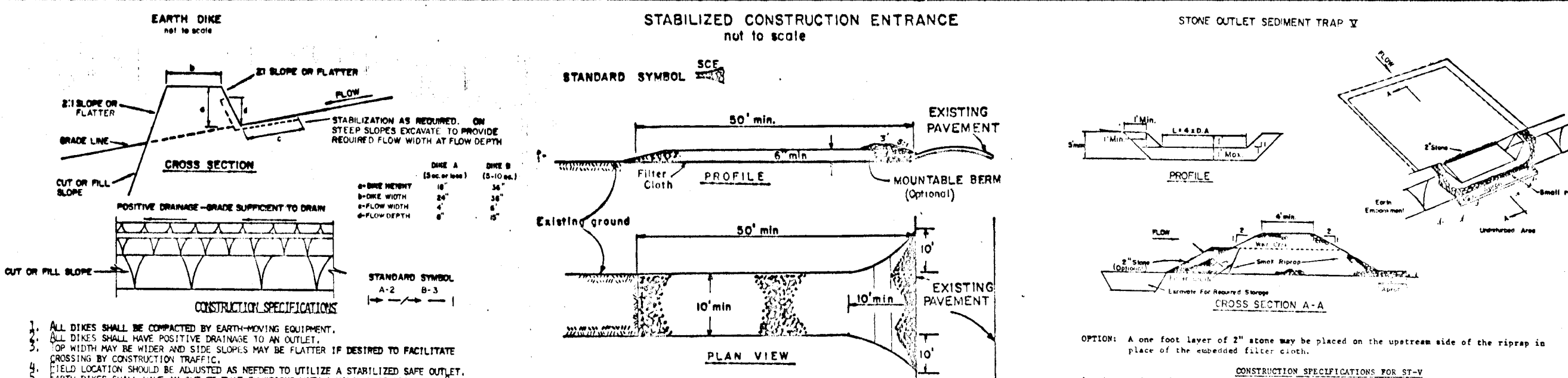

**CONSTRUCTION SPECIFICATIONS**

- All dike shall be constructed by earthmoving equipment.
- Dike shall have positive drainage to an outlet.
- Top width may be wider and side slopes may be flatter if desired to facilitate crossing by construction traffic.
- Field location shall be adjusted as needed to utilize a stabilized safe outlet.
- Earth dike shall have an outlet that flows through a minimum of 300 feet. Top shall be converted to a sediment trapping device such as a sediment trap or sediment basin where either the dike crosses or the drainage area above the dike are not separately stabilized.
- Stabilization shall be: (a) in accordance with standard specifications for seed and straw mulch or straw mulch if not in standard specification; (b) flow channel as per the dike below.

**LEGEND**

- DRAINAGE AREA DIVISION
- - - - - SILT FENCE
- ===== EARTH DIKE
- - - - - TEMPORARY SWALE
- LIMIT OF DISTURBANCE
- INLET PROTECTION

**PERMANENT SEEDBED PREPARATION**

SEEDBED PREPARATION: LOOSEN UPPER THREE INCHES OF SOIL BY BAKING, DISCING OR OTHER ACCEPTABLE MEANS BEFORE SEEDING, IF NOT PREVIOUSLY LOOSENED.

SOIL AMENDMENTS: IN LIEU OF SOIL TEST RECOMMENDATIONS, USE ONE OF THE FOLLOWING SCHEDULES:

- PREFERRED - APPLY 2 TONS PER ACRE IONOLITHIC LIMESTONE (92 1b/1000 so ft) AND 600 1b/acre (11.4 1b/1000 so ft) OF KENTUCKY 31 TALL FESCUE FOR THE PERIOD MAY 1 THRU AUGUST 14, SEED WITH 1.5 LBS PER ACRE OF KEEPING LOVEGRASS (1.07 1b/1000 so ft). FOR THE PERIOD NOVEMBER 1 THRU FEBRUARY 26, PROJECT SITE BY: OPTION (1) 2 TONS PER ACRE OF WELL ANCHORED STRAW MULCH AND SEED AS SOON AS POSSIBLE IN THE SPRING. OPTION (2) USE 500, OPTION (3) SEED WITH 60 LBS PER ACRE OF KENTUCKY TALL FESCUE AND MULCH WITH 2 TONS PER ACRE OF WELL ANCHORED STRAW.
- ACCEPTABLE - APPLY 2 TONS PER ACRE IONOLITHIC LIMESTONE (92 1b/1000 so ft) AND 1000 LBS PER ACRE 10-10-10 FERTILIZER (23 1b/1000 so ft) BEFORE SEEDING. HARROW OR DISC INTO UPPER THREE INCHES OF SOIL.

**TEMPORARY SEEDBED PREPARATION**

APPLY TO GRADED OR CLEARED AREAS LIKELY TO BE REDISTURBED WHERE A SHORT-TERM VEGETATIVE COVER IS NEEDED.

SEEDBED PREPARATION: LOOSEN UPPER THREE INCHES OF SOIL BY BAKING, DISCING OR OTHER ACCEPTABLE MEANS BEFORE SEEDING, IF NOT PREVIOUSLY LOOSENED.

SOIL AMENDMENTS: APPLY 600 LBS PER ACRE 10-10-10 FERTILIZER (14 1b/1000 so ft).

SEEDING: FOR PERIODS MARCH 1 THRU APRIL 30 AND AUGUST 1 THRU NOVEMBER 15, SEED WITH 2-1/2 BUSHELS PER ACRE OF RURAL RYE (3.2 1b/1000 so ft). FOR THE PERIOD MAY 1 THRU AUGUST 14, SEED WITH 1.5 LBS PER ACRE OF KEEPING LOVEGRASS (1.07 1b/1000 so ft). FOR THE PERIOD NOVEMBER 1 THRU FEBRUARY 26, PROJECT SITE BY: OPTION (1) 2 TONS PER ACRE OF WELL ANCHORED STRAW MULCH AND SEED AS SOON AS POSSIBLE IN THE SPRING, OR HIGHER, USE 348 GALLONS PER ACRE (8 9a/1000 so ft) FOR ANCHORING.

**MULCHING**: APPLY 1-1/2 TO 2 TONS PER ACRE (70 to 90 1b/1000 so ft) OF UNDRILLED SMALL GRAIN STRAW IMMEDIATELY AFTER SEEDING. ANCHOR MULCH IMMEDIATELY AFTER APPLICATION USING MULCH ANCHORING TOOL OR 210 GALLONS PER ACRE (5 9a/1000 so ft) OF UNDRILLED SMALL GRAIN STRAW OR FLAT AREAS. ON SLOPES 6 FEET OR HIGHER, USE 348 GALLONS PER ACRE (8 9a/1000 so ft) FOR ANCHORING.

**MAINTENANCE**: INSPECT ALL SEEDED AREAS AND MAKE REPAIRS, REPLACEMENTS AND RESEEDINGS.

**SECTION THROUGH SPILLWAY**  
 SCALE 1" = 50'

**WATER QUALITY DETAIL**  
 SCALE: HORIZ. 1" = 5' VERT. 1" = 5'

**SEEDING CONTROL NOTES**

- A minimum of 24 hours notice must be given to the HOWARD COUNTY OFFICE OF INSPECTION AND PERMITS PRIOR TO THE START OF ANY CONSTRUCTION (990-2437).
- ALL VEGETATIVE AND STRUCTURAL PRACTICES ARE TO BE INSTALLED ACCORDING TO THE PROVISIONS OF THIS PLAN AND ARE TO BE IN CONFORMANCE WITH THE 1983 MARYLAND STANDARDS AND SPECIFICATIONS FOR SOIL EROSION AND SEDIMENT CONTROL.
- FOLLOWING INITIAL SOIL DISTURBANCE OR REDISTURBANCE, PERMANENT OR TEMPORARY STABILIZATION SHALL BE COMPLETED WITHIN: a) 7 CALENDAR DAYS FOR ALL PERMANENT SEDIMENT CONTROL STRUCTURES, DIKES, PERENNIAL SLOPES AND ALL SLOPES GREATER THAN 3:1; b) 14 DAYS AS TO ALL OTHER DISTURBED OR GRADED AREAS ON THE PROJECT SITE.
- ALL SEDIMENT TRAPS/BASINS SHOWN MUST BE FENCED AND WARNING SIGNS POSTED AROUND THESE PERMITS IN ACCORDANCE WITH VOL. 1, CHAPTER 12, OF THE HOWARD COUNTY DESIGN MANUAL, STORM DRAINAGE.
- ALL DISTURBED AREAS MUST BE STABILIZED WITHIN THE TIME PERIOD SPECIFIED ABOVE IN ACCORDANCE WITH THE 1983 MARYLAND STANDARDS AND SPECIFICATIONS FOR SOIL EROSION AND SEDIMENT CONTROL FOR PERMANENT SEEDINGS (Sec. 51) AND TEMPORARY SEEDINGS (Sec. 52) AND MULCHING (Sec. 53). TEMPORARY STABILIZATION WITH MULCH ALONE CAN ONLY BE DONE WHEN RECOMMENDED SEEDING DATES DO NOT ALLOW FOR PROPER GERMINATION AND ESTABLISHMENT OF GRASSES.
- ALL SEDIMENT CONTROL STRUCTURES ARE TO REMAIN IN PLACE AND ARE TO BE MAINTAINED IN OPERATIVE CONDITION UNTIL PERMISSION FOR THEIR REMOVAL HAS BEEN OBTAINED FROM THE HOWARD COUNTY SEDIMENT CONTROL INSPECTOR.
- 7) SITE ANALYSIS: TOTAL AREA OF SITE 8.7 ACRES, AREA TO BE ROOFED OR PAVED 1.5 ACRES, AREA TO BE VEGETATIVELY STABILIZED 7.2 ACRES, TOTAL CUT 247,248 CU. YDS., TOTAL FILL 267,796 CU. YDS., OFFICE WASTE/SURROW AREA LOCATION.
- 8) ANY SEDIMENT CONTROL PRACTICE WHICH IS DISTURBED BY GRADING ACTIVITY FOR PLACEMENT OF UTILITIES MUST BE REPAIRED ON THE SAME DAY OF DISTURBANCE.
- ADDITIONAL SEDIMENT CONTROLS MUST BE PROVIDED, IF DEEMED NECESSARY BY THE HOWARD COUNTY SEDIMENT CONTROL INSPECTOR.
- ALL SEDIMENT TRAPS SHOWN MUST BE FENCED AND WARNING SIGNS POSTED AROUND THEIR PERIMETER IN ACCORDANCE WITH VOL. 1, CHAPTER 12, OF THE HOWARD COUNTY DESIGN MANUAL, STORM DRAINAGE.

PROPERTY OF BALTIMORE GAS AND ELECTRIC CO.  
 572 / 707  
 ZONED R3C

PROPERTY OF THE HEIRS OF BERTHA SNELL  
 ZONED R3C

PROPERTY OF SARAH J. SNELL  
 560 / 62  
 ZONED R3C

PROPERTY OF ALFRED E. HALL  
 740 / 05  
 ZONED R3C

KINGS WOODS SECTION AREA 2  
 P-03-03  
 LOT 55

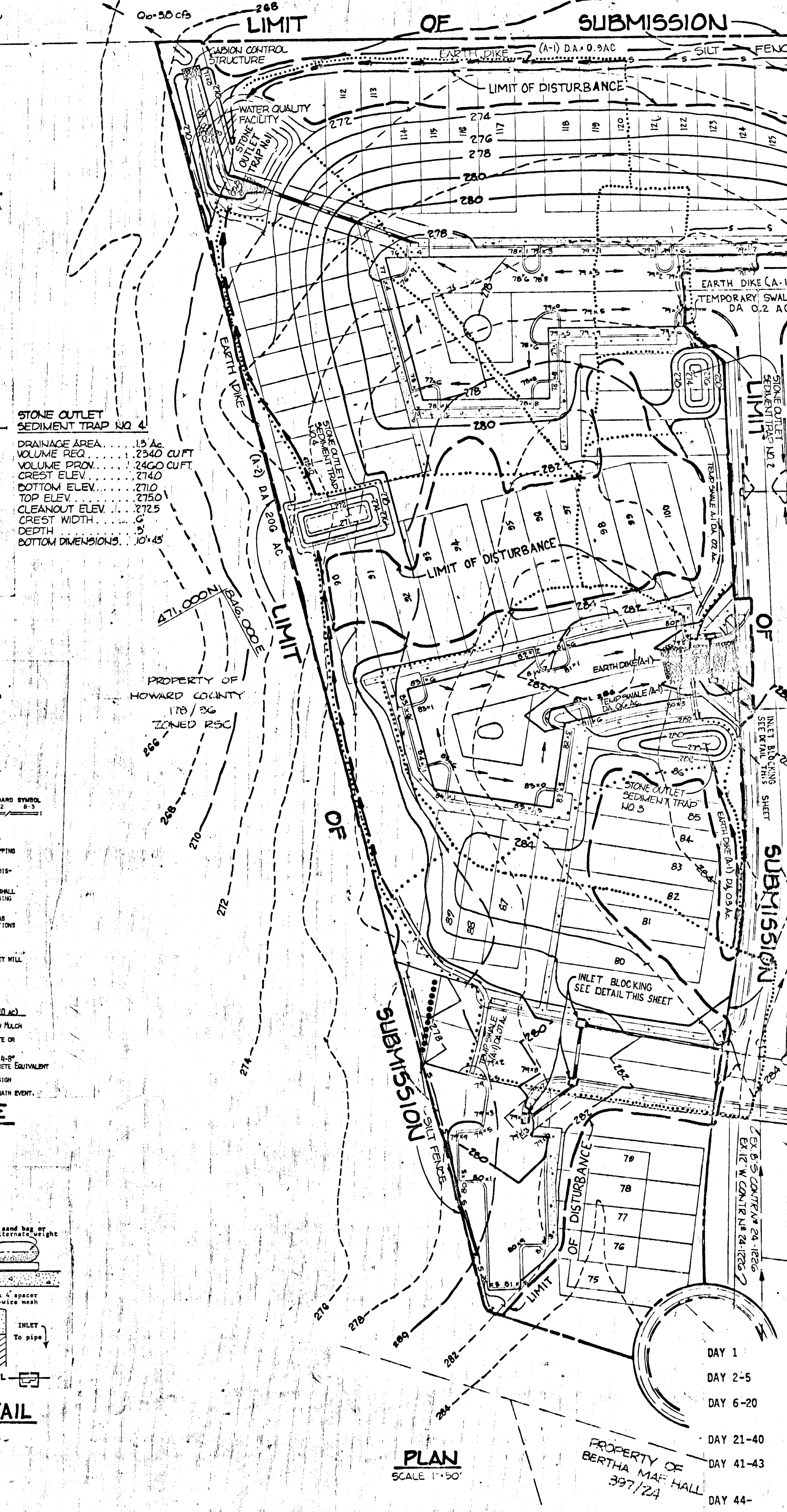
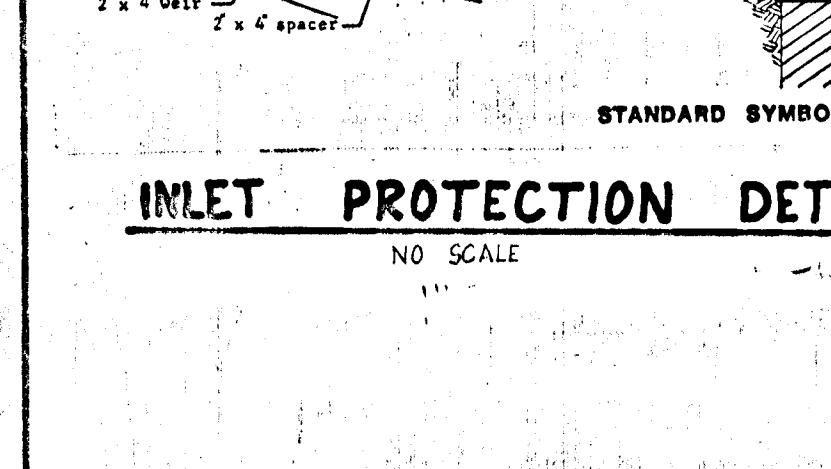
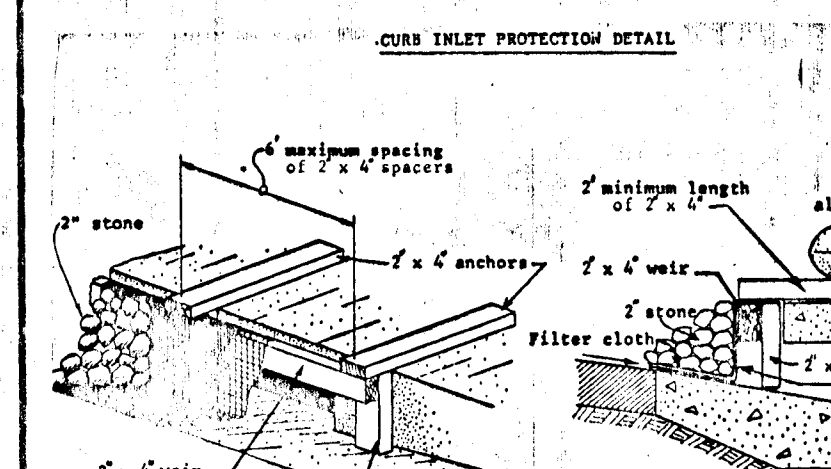
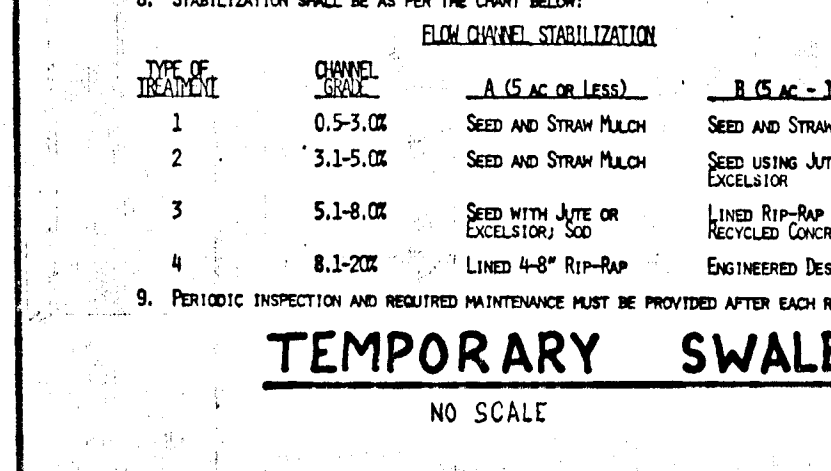
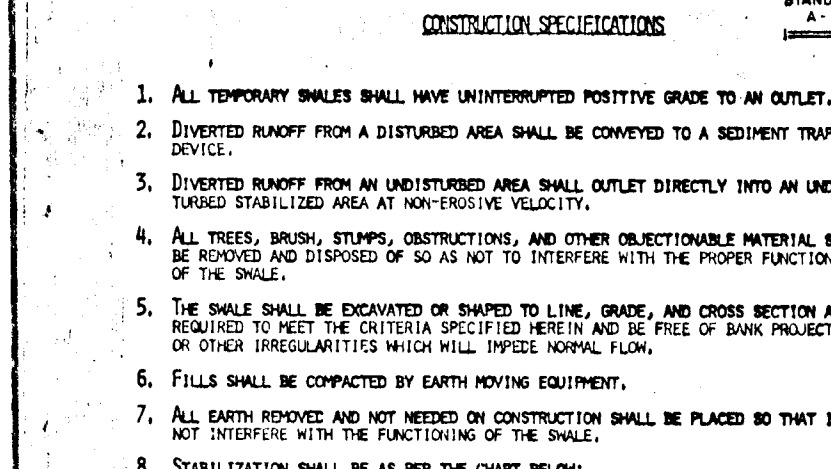
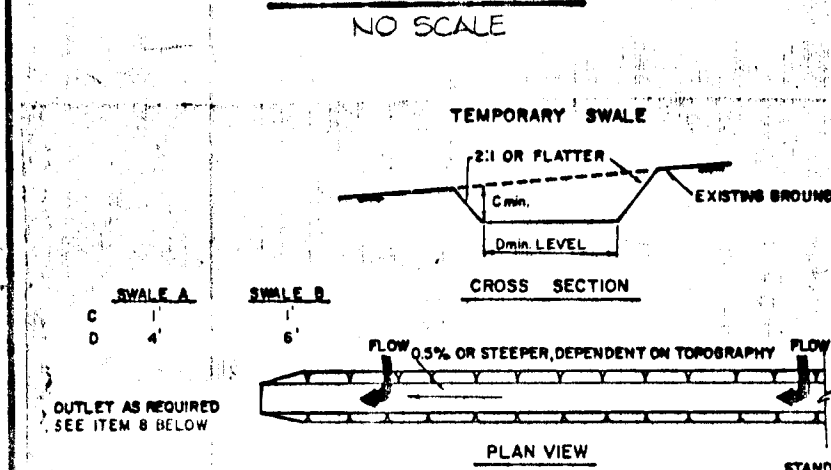
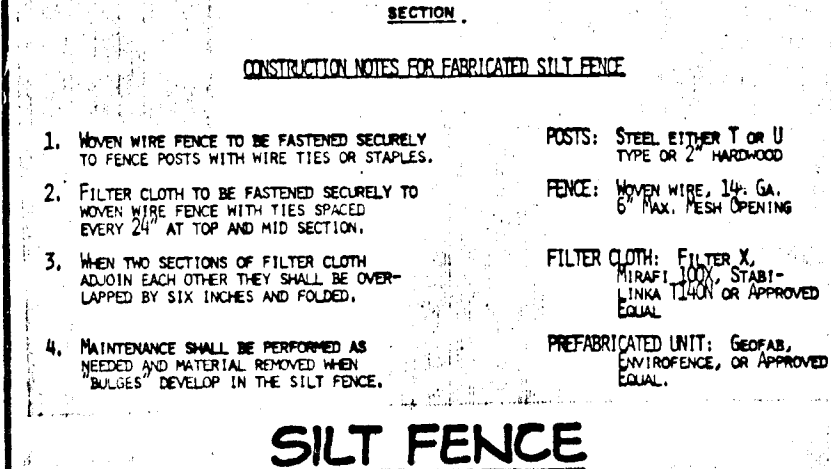
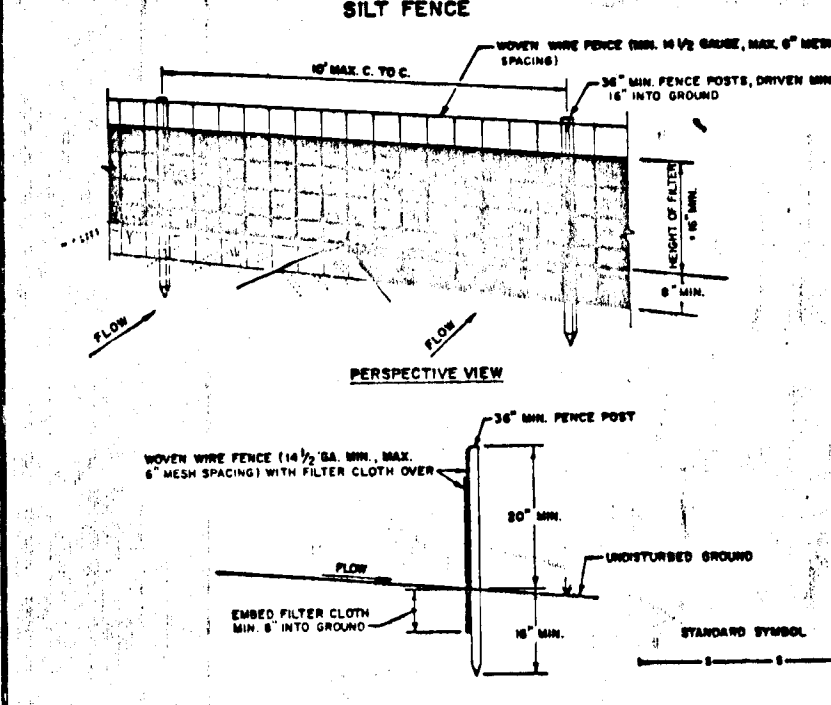
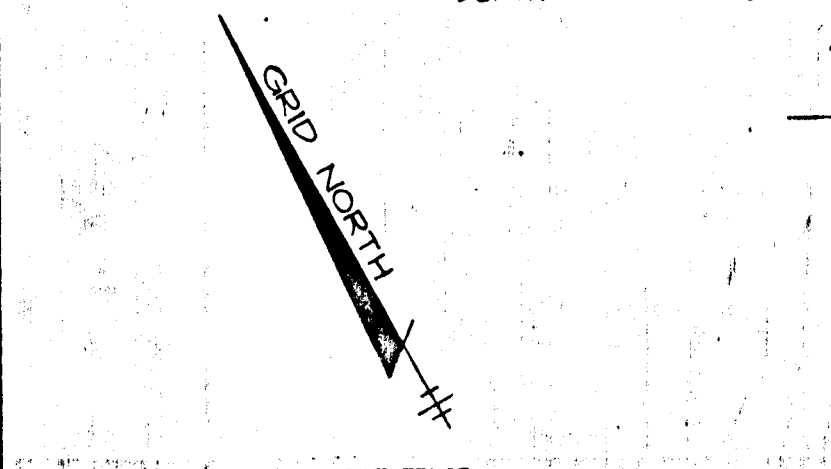

**STONE OUTLET SEDIMENT TRAP No. 4**  
 DRAINAGE AREA 1.5 AC  
 VOLUME REQ 2940 CU FT  
 VOLUME PROVIDED 5616 CU FT  
 CREST ELEV 271.0  
 BOTTOM ELEV 275.0  
 CLEANOUT ELEV 272.5  
 CREST WIDTH 5'  
 DEPTH 10'-45"  
 BOTTOM DIMENSIONS 10'-45"

**PROPERTY OF HOWARD COUNTY**  
 178 / 06  
 ZONED R3C

**TEMPORARY SWALE**  
 NO SCALE

**INLET PROTECTION DETAIL**  
 NO SCALE

**PLAN**  
 SCALE 1" = 50'

**SEQUENCE OF CONSTRUCTION**

- DAY 1 OBTAIN A GRADING PERMIT.
- DAY 2-5 INSTALL SEDIMENT CONTROL DEVICES.
- DAY 6-20 GRADE SITE TO SUBGRADE AND STABILIZE IN ACCORDANCE WITH TEMPORARY SEEDBED NOTES.
- DAY 21-40 INSTALL UTILITIES. CURB AND GUTTER AND PAVING.
- DAY 41-43 STABILIZE ALL DISTURBED AREAS IN ACCORDANCE WITH PERMANENT SEEDBED NOTES.
- DAY 44- UPON THE APPROVAL OF THE HOWARD COUNTY SEDIMENT CONTROL INSPECTOR REMOVE ALL SEDIMENT CONTROL DEVICES AND STABILIZE IN ACCORDANCE WITH PERMANENT SEEDBED NOTES.

BY THE ENGINEER:  
 "I CERTIFY THAT THIS PLAN FOR EROSION AND SEDIMENT CONTROL REPRESENTS A PRACTICAL AND WORKABLE PLAN BASED ON MY PERSONAL KNOWLEDGE OF THE SITE CONDITIONS AND THAT IT WAS PREPARED IN ACCORDANCE WITH THE REQUIREMENTS OF THE HOWARD SOIL CONSERVATION DISTRICT."  
 James K. Tracy  
 ENGINEER: JAMES K. TRACY, P.E.  
 5-1-89 DATE

BY THE DEVELOPER:  
 "I/WE CERTIFY THAT ALL DEVELOPMENT AND CONSTRUCTION WILL BE DONE ACCORDING TO THIS PLAN, AND THAT ANY RESPONSIBLE PERSONNEL INVOLVED IN THE CONSTRUCTION PROJECT WILL HAVE A CERTIFICATE OF ATTENDANCE AT A DEPARTMENT OF NATURAL RESOURCES APPROVED TRAINING PROGRAM FOR THE CONTROL OF SEDIMENT AND EROSION BEFORE BEGINNING THE PROJECT. I ALSO AUTHORIZE PERIODIC SITE INSPECTION BY THE HOWARD SOIL CONSERVATION DISTRICT."  
 James R. Mulvey, Jr.  
 DEVELOPER: JAMES R. MULVEY, JR.  
 SECURITY DEVELOPMENT CORPORATION - PRESIDENT  
 5-1-89 DATE

REVIEWED FOR HOWARD SOIL CONSERVATION DISTRICT AND MEETS TECHNICAL REQUIREMENTS  
 James M. Tolson / JMT  
 CHIEF, SOIL CONSERVATION DISTRICT  
 8/18/89 DATE

APPROVED: HOWARD COUNTY DEPT. OF PLANNING AND ZONING.  
 David J. Clayton  
 CHIEF, DIVISION OF COMMUNITY PLANNING AND LAND DEVELOPMENT  
 7/15/89 DATE

APPROVED: HOWARD COUNTY DEPARTMENT OF PUBLIC WORKS  
 Ronald L. Roper  
 CHIEF, LAND DEVELOPMENT DIVISION  
 9/10/89 DATE

APPROVED: HOWARD COUNTY DEPARTMENT OF PUBLIC WORKS  
 Lawrence W. Cleland  
 CHIEF, BUREAU OF HIGHWAYS  
 9/17/89 DATE

APPROVED: HOWARD COUNTY DEPARTMENT OF PUBLIC WORKS  
 William E. Ray  
 CHIEF, BUREAU OF ENGINEERING  
 9-11-89 DATE

OWNER: SECURITY DEVELOPMENT CORP.  
 P.O. BOX 417  
 ELLICOTT CITY, MARYLAND 21043

PROJECT: KINGS WOODS SECTION 1, AREA 3  
 TAX MAP NO. 27  
 PARCEL NO. 566  
 6TH ELECTION DISTRICT  
 HOWARD COUNTY, MARYLAND

DEVELOPER: SECURITY DEVELOPMENT CORP.  
 P.O. BOX 417  
 ELLICOTT CITY, MARYLAND 21043

TITLE: GRADING AND SEDIMENT CONTROL PLAN  
 5-88-35  
 DATE: MAY 1, 1989  
 AUG 10, 1989 PROJECT NO. 0165

DES D.A.M. DRN R.C. SCALE AS SHOWN DRAWING 3 OF 4

PROPERTY OF  
BALTIMORE GAS AND ELECTRIC CO.  
572 / 737  
ZONED R-5C

LIMIT OF SUBMISSION

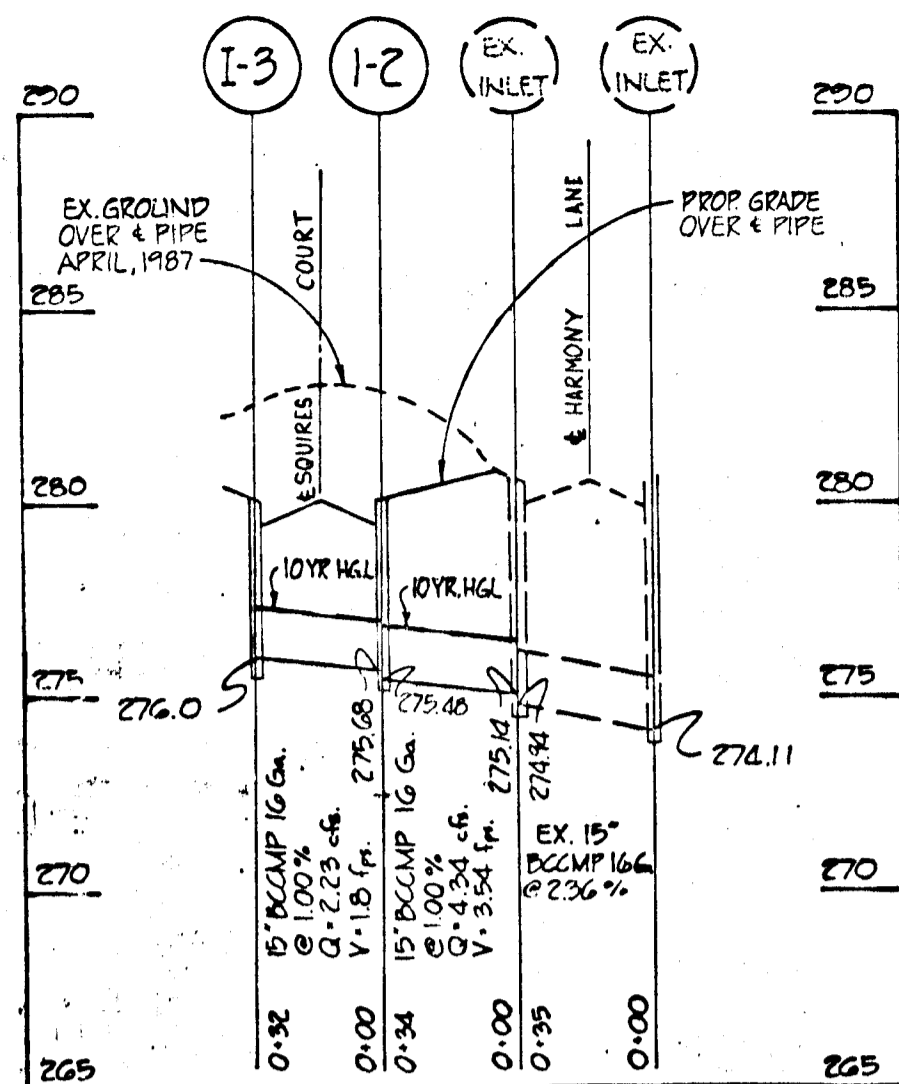
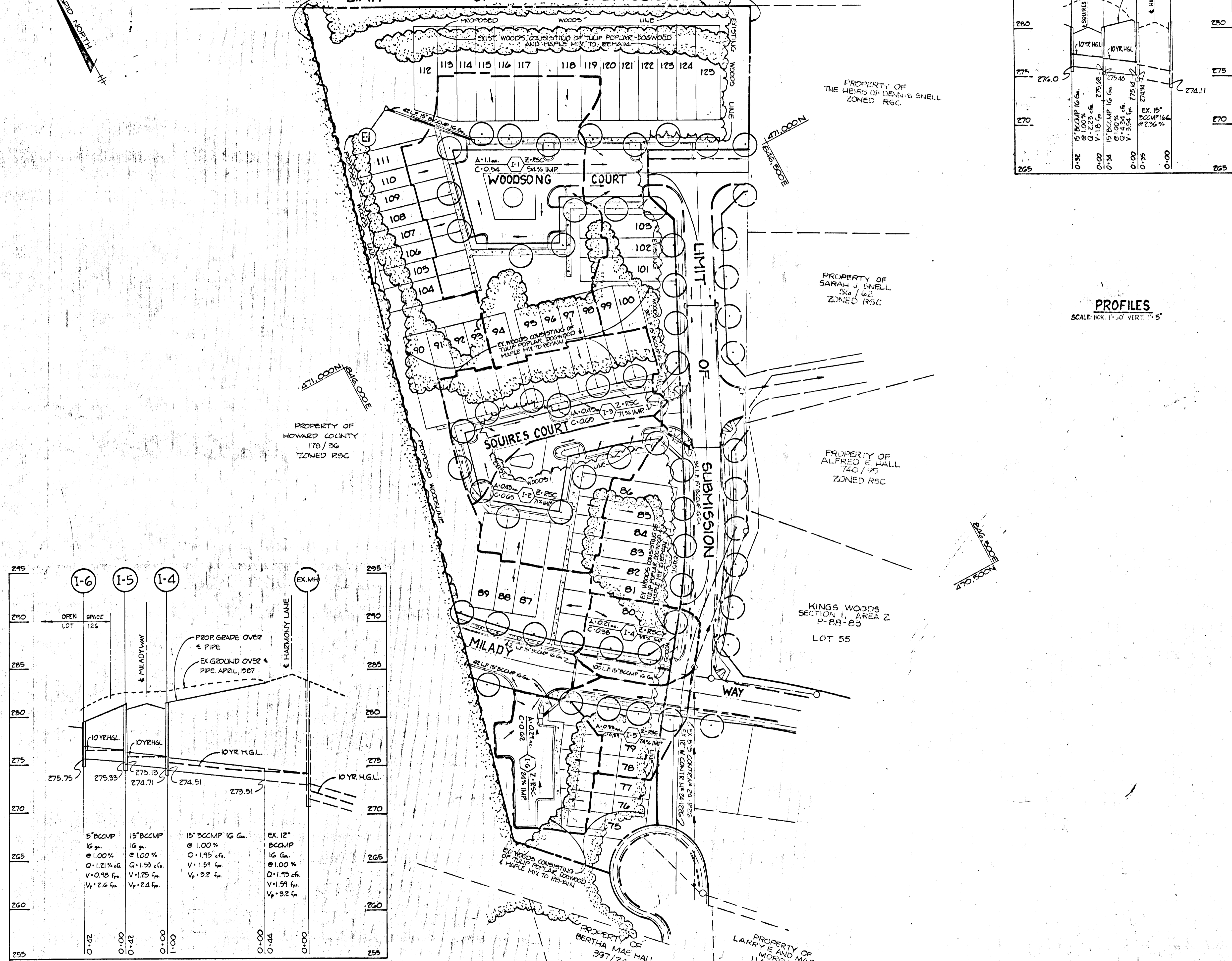
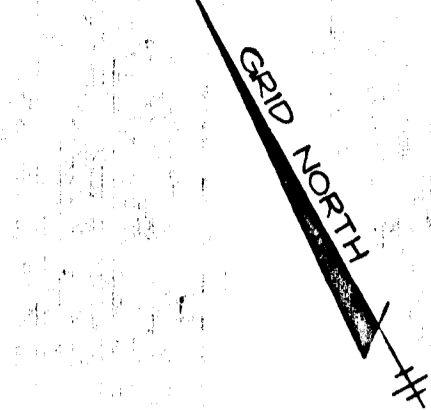

PLANT LIST			
SYMBOL	QUANTITY	NAME	REMARKS
(Symbol: Circle with dot)	48	ACER RUBRUM RED MAPLE	2 1/2 MIN. CAL. B & B FULL HEAD
(Symbol: Circle with dot)		EXISTING TREES INSTALLED UNDER F-89-103	

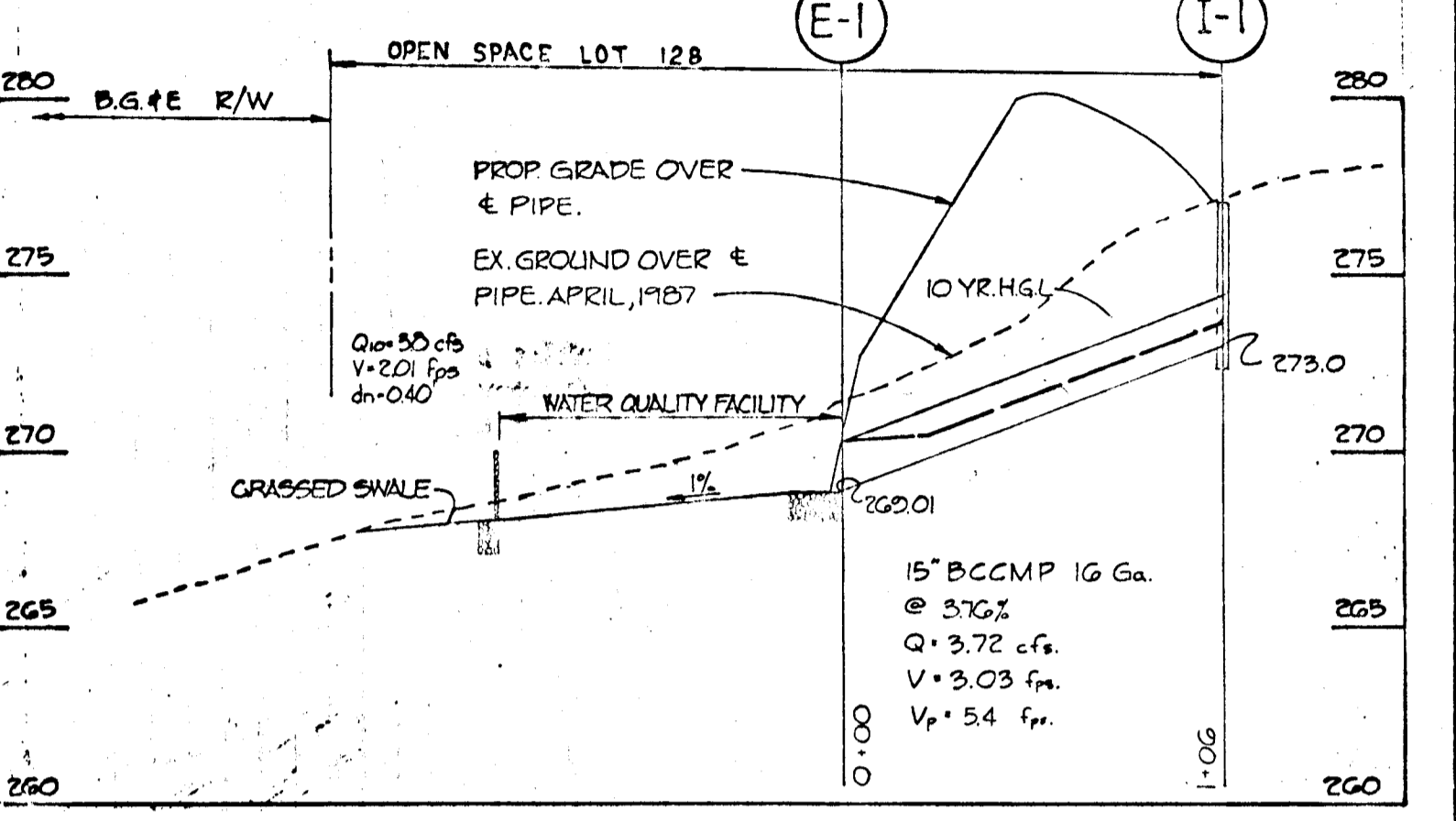

PROFILES  
SCALE: HOR. 1"=50' VERT. 1"=5'

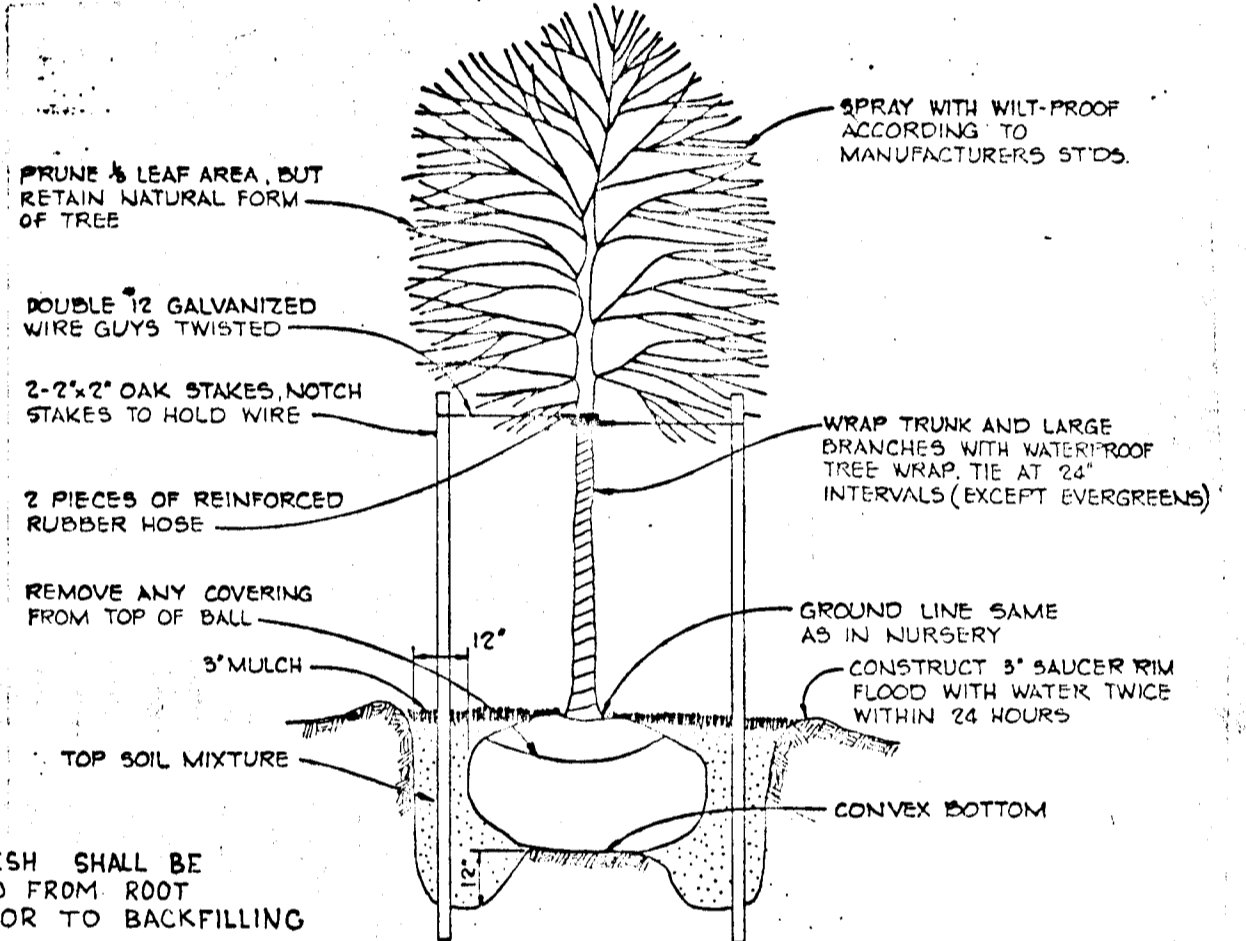

TREE PLANTING DETAIL  
NO SCALE

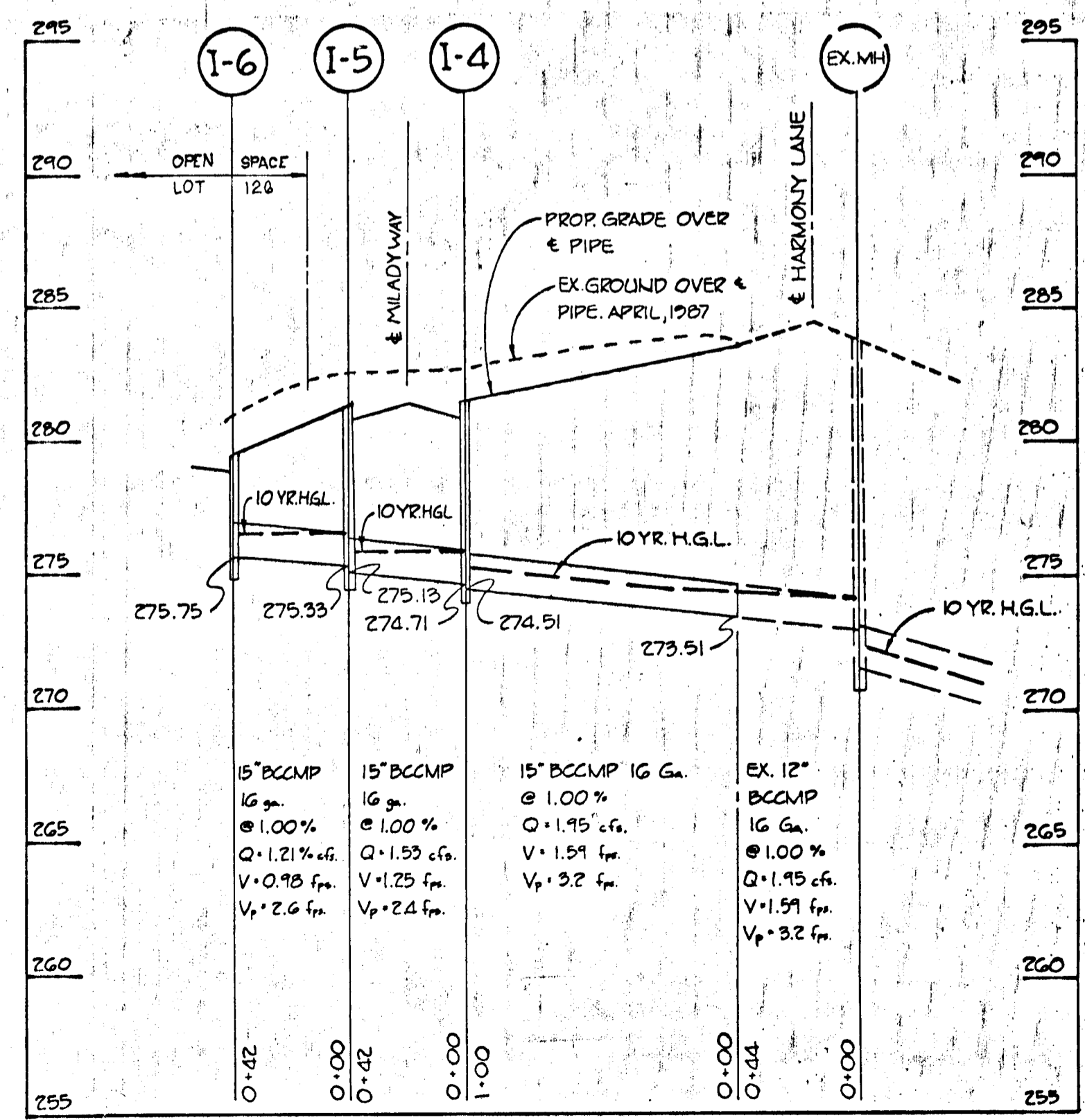

PROFILES  
SCALE: HOR. 1"=50' VERT. 1"=5'

PLAN  
SCALE 1"=50'

APPROVED: HOWARD COUNTY DEPT. OF PLANNING AND ZONING.  
*Mark J. D'Angelo* 9/15/89  
CHIEF, DIVISION OF COMMUNITY PLANNING & LAND DEVELOPMENT

APPROVED: HOWARD COUNTY DEPARTMENT OF PUBLIC WORKS  
*James W. Wallace* 9/17/89  
CHIEF, BUREAU OF HIGHWAYS

*William E. Peltz* 9-11-89  
CHIEF, BUREAU OF ENGINEERING

NO	DATE	REVISION

TRACY, SCHULTE & ASSOCIATES INC.  
planning • architecture • engineering  
8480 Baltimore National Pike • Ellicott City, Maryland 21043 • (301) 465-6105

OWNER	SECURITY DEVELOPMENT CORP P.O. BOX 417 ELLICOTT CITY, MARYLAND 21043	PROJECT	KINGS WOODS SECTION 1, AREA 3
DEVELOPER	SECURITY DEVELOPMENT CORP P.O. BOX 417 ELLICOTT CITY, MARYLAND 21043	LOCATION	TAX MAP NO 47 PARCEL NO 766 6TH ELECTION DISTRICT HOWARD COUNTY, MARYLAND
DES. D.A.M.	DRN R.C.	TITLE	PLANTING PLAN, DRAINAGE AREA MAP AND STORM DRAIN PROFILES
		DATE	MAY 1, 1989 AUG 15, 1989
		SCALE	AS SHOWN
		PROJECT NO	OIGS
		DRAWING	A OF 4