

CENTERLINE CURVE DATA				
STATIONING	CURVE	ARC	TAN	CHORD & BEARING
PC 0+72.20 PT 2+77.91	C-150	183.94 51'	205.72	122.73 184°10'N 73°58'30"E

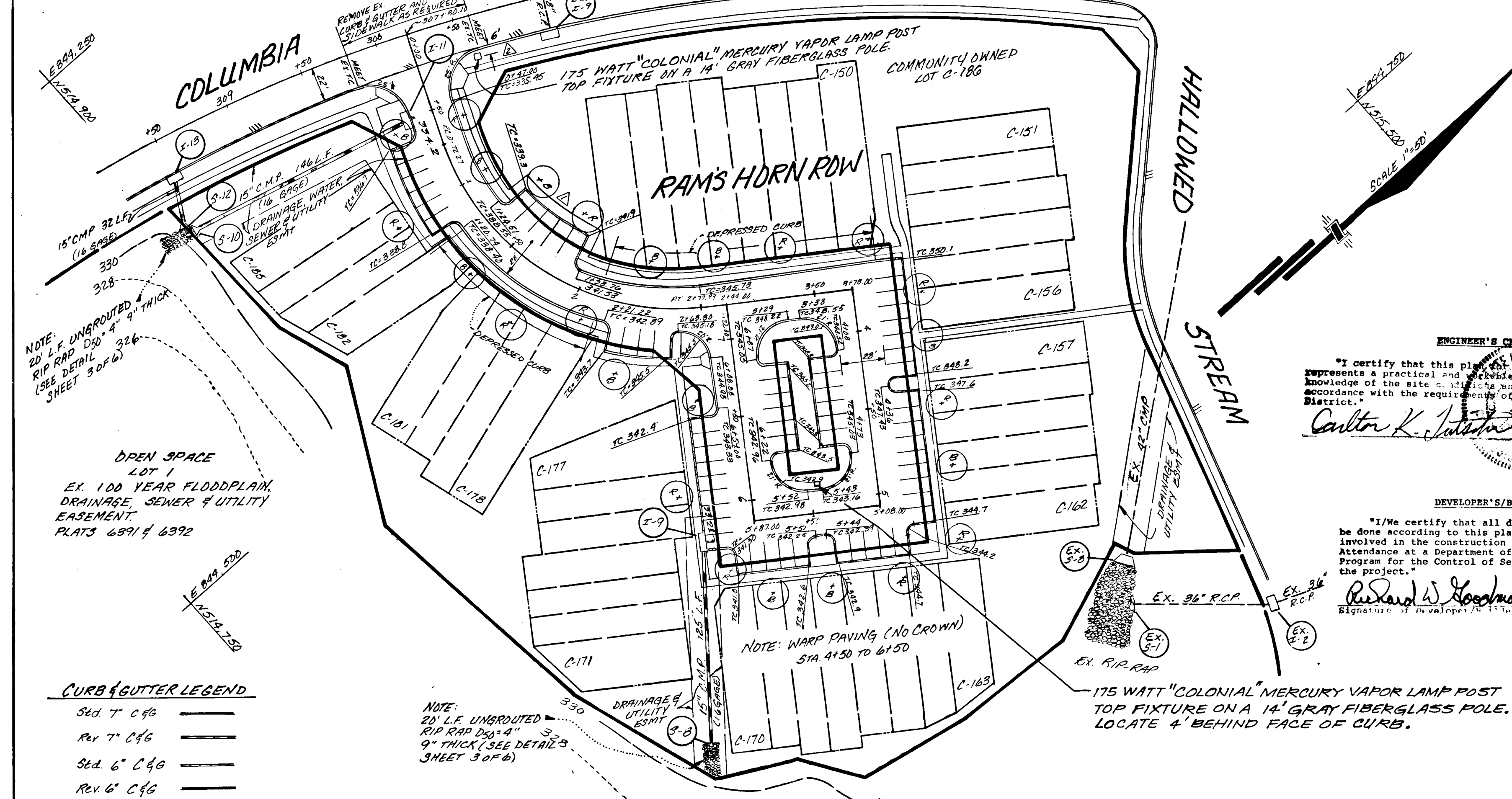

Reviewed for HOWARD S.C.D. and meets Technical Requirements.
 Date: 5-20-87
 Signature: [Signature]
 Title: [Title]

ENGINEER'S CERTIFICATE
 I certify that this plan for erosion and sediment control represents a practical and feasible plan based on my personal knowledge of the site conditions and that it was prepared in accordance with the requirements of the Howard Soil Conservation District.
 Date: 12-22-86
 Signature: [Signature]

DEVELOPER'S/BUILDER'S CERTIFICATE
 I/We certify that all development and construction will be done according to this plan, and that any responsible personnel involved in the construction project will have a Certificate of Attendance at a Department of Natural Resources Approved Training Program for the Control of Sediment and Erosion before beginning the project.
 Date: 12/22/86
 Signature: [Signature]

GENERAL NOTES

- All storm drain & paving shall be constructed in accordance with the latest edition and specifications of Howard County & MDSHA.
- Types of storm drainage, refer to the Standard Details of Howard County and MDSHA.
- Trench compacting for storm drains within road or street right of way limits shall be in accordance with "Howard County Design Manual, Vol. II" (Class A trench bedding to be used for all storm drains, except where shown otherwise).
- Information concerning underground utilities was obtained from available records but the contractor must determine the exact location and elevation of mains by digging test pits, by hand, at all utility crossings, well in advance of construction.
- All utility companies shall be notified 24 hours in advance of construction.
- All traffic services, parking and signing to be done in accordance with the "Manual of Uniform Traffic Control Devices," 1978 Edition.
- Sign and Crest Vertical curves were designed in accordance with Howard County Design Manual, Vol. III.
- Provide Concrete Sidewalk ramps. Howard County Std. Type A, R-4-61 where shown in plans.
- Design Speed: See table; Zoning: R3C
- The contractor or developer shall contact the Construction Inspection/Survey Division 24 hours in advance of commencement of work, Ph. 72-7272.
- Storm Water Management Provided in Central Facility in Dorsey Hall Section 2 Area 2 F-85-16.
- Stopping site distances are not shown in cut-de-soc area since curves, parking and other spaces dictate the conditions for stopping rather than the standard stopping sight distance of a traveled way.

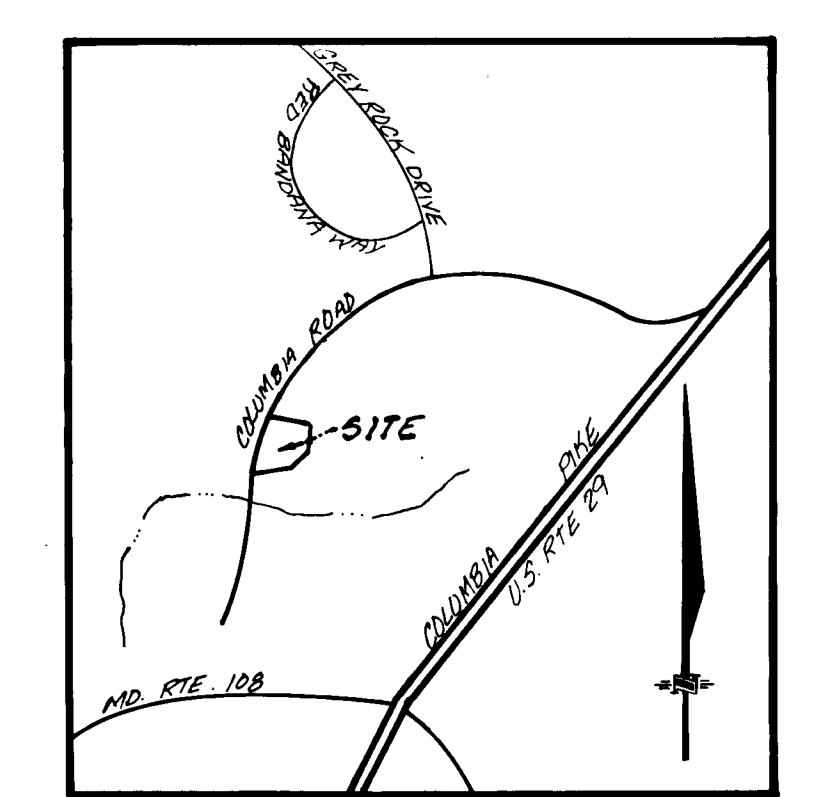

OWNER: CAPITAL HOMES, INC.
 8102 ASPENWOOD WAY
 JESSUP, MARYLAND, 20794

PLANT SCHEDULE				
KEY	PLANT NAME	SIZE	QUANT	REMARKS
1	ACER FRAXINUM 'RED SUNSET'	3" DBH	18	3/8" HEART HEADS
2	ACER SUNSET MAPLE	"	12	"
3	ACER SACCHARUM GREEN MOUNTAIN	"	12	"
4	ACER FRAXINUM 'RED SUNSET'	"	12	"

- NOTES:**
- Contractor shall verify location of underground utilities prior to digging.
 - Final location of trees may be adjusted slightly to accommodate field conditions.
 - Planting procedure shall comply with "Landscape Specs for Baltimore-Washington Metropolitan Area".
 - Substitution of one approved species may be permitted provided that the planting is in accordance with the street tree and landscape requirements as specified in Section 16.01 of the Howard County Subdivision Regulations.

APPROVED: DEPARTMENT OF PUBLIC WORKS
 Date: 5-26-87
 Signature: [Signature]

APPROVED: HOWARD COUNTY OFFICE OF PLANNING & ZONING
 Date: 5-20-87
 Signature: [Signature]

GTW GUTSCHICK LITTLE & WEBER, P.A.
 ENGINEERS, PLANNERS, SURVEYORS
 3909 NATIONAL DRIVE - SUITE 250 - BURTONSVILLE OFFICE PARK - BURTONSVILLE, MD 20886
 TEL: (301) 421-4024

DESIGNED: CKG
 DRAWN: LH
 CHECKED: CKG
 DATE: 5-14-87

ROAD CONSTRUCTION PLANS
 RAM'S HORN ROW
 DORSEY HALL
 SECTION 2 AREA 2
 2ND ELECTION DISTRICT
 HOWARD COUNTY, MARYLAND
 FOR: CAPITAL HOMES, INC.
 8102 ASPENWOOD WAY
 JESSUP, MARYLAND 20794

SCALE: As Shown
 DRAWING: 1 OF 5
 JOB NO: 86-016

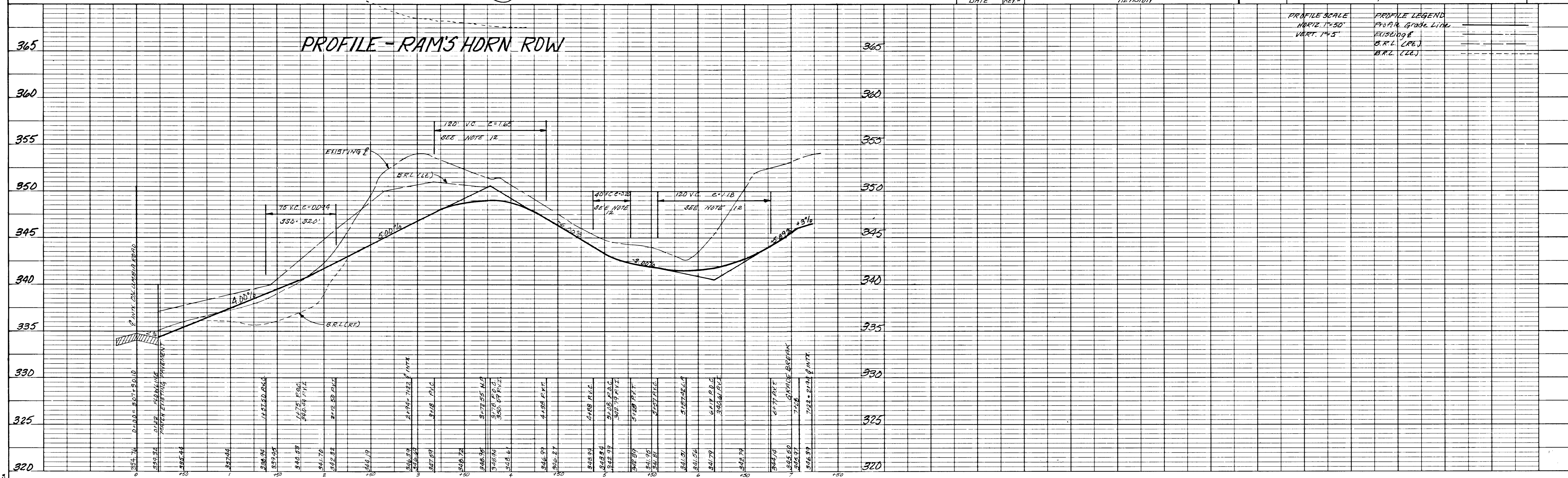

771

F-87-98

STRUCTURE SCHEDULE						
No.	Type	Invert	Top	No. Co.	Remarks	Location
		In	Out	Elev.	Stnd.	
M-1	Shallow Naphole	335.20	334.74	339.80	SD-05	see plan
S-2	B-Inlet	341.00	340.80	344.80	SD-1.13	opening to be placed on NE and SW sides of NE and SW sides
I-3	B-Inlet	341.00	341.65	344.80	SD-4.11	see plan
M-4	Manhole	342.92	352.28	360.70	G-5.12	see plan
I-5	B-Inlet	355.51	355.35	359.80	SD-4.11	opening to be placed on all four sides
M-6	A-10 Inlet	340.26	344.45	352.20	SD-4.09	see plan
I-7	A-10 Inlet	352.00	356.80	362.00	SD-4.02	see plan
S-8	Metal End Section	330.30	336.60	336.60	SD-5.61	15" Diameter see plan
I-9	A-10 Inlet	337.00	340.80	340.80	SD-4.02	see plan
S-10	Metal End Section	329.50	335.55	335.55	SD-5.61	15" Diameter see plan
I-11	A-10 Inlet	332.00	335.55	335.55	SD-4.02	see plan
S-12	Metal End Section	329.50	335.55	335.55	SD-5.61	15" Diameter see plan
I-13	A-5 Inlet	329.68	336.68	336.68	SD-4.01	see plan

PIPE SCHEDULE		
SIZE	TYPE	LENGTH
15"	CMP 16 Gage*	303 L.F.
18"	RCP CL IV	234 L.F.
24"	RCP CL IV	254 L.F.
21"	RCP CL IV	801 L.F.
24"	RCP CL IV	70 L.F.

* 2-2/3" x 1/2" Corrugations

NOTE: ALL INVERTS SHALL BE FULLY DEVELOPED.

** Centerline Structure Station 0+52 Ram's Horn Row 14' RL
*** Centerline Structure Station 309+50 Columbia Road 22' LL

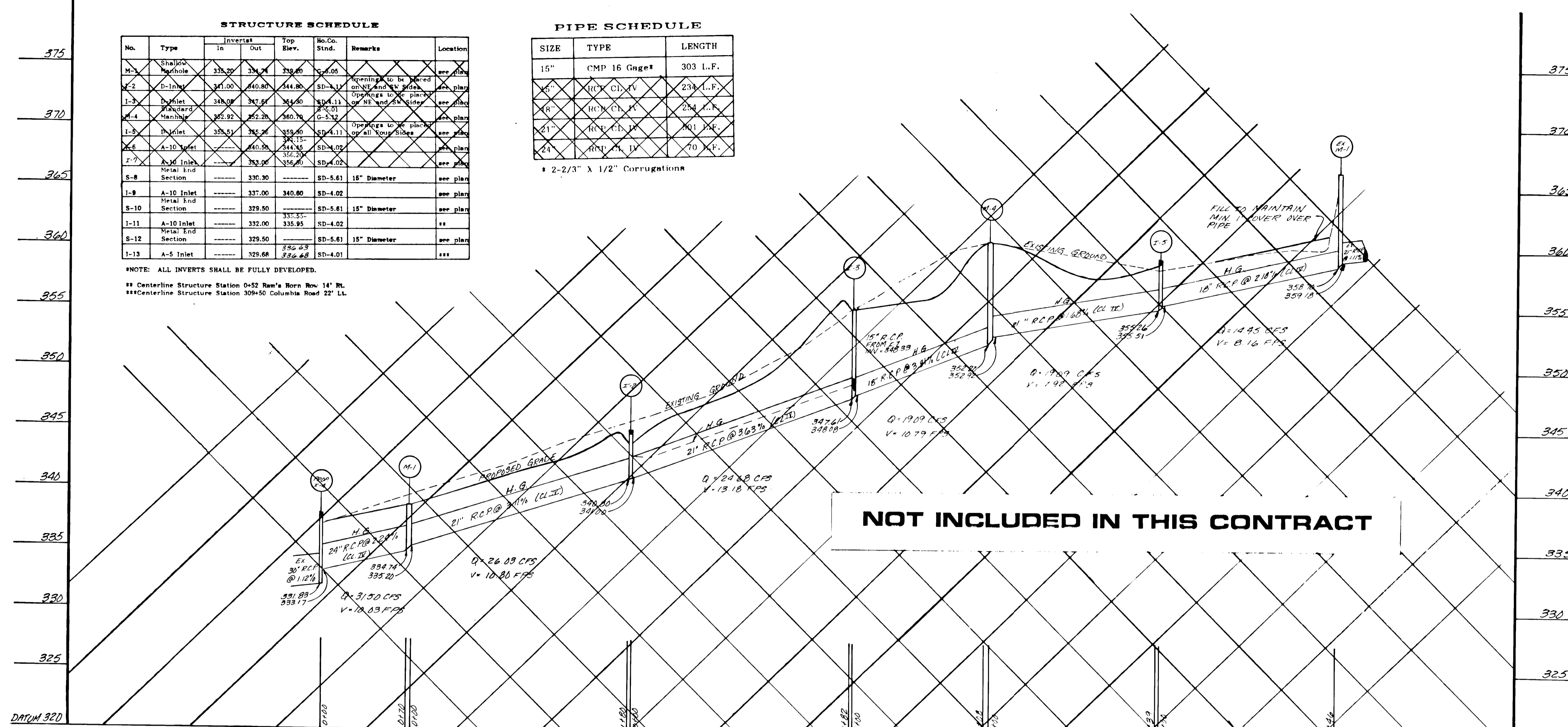

STORM DRAIN PROFILE

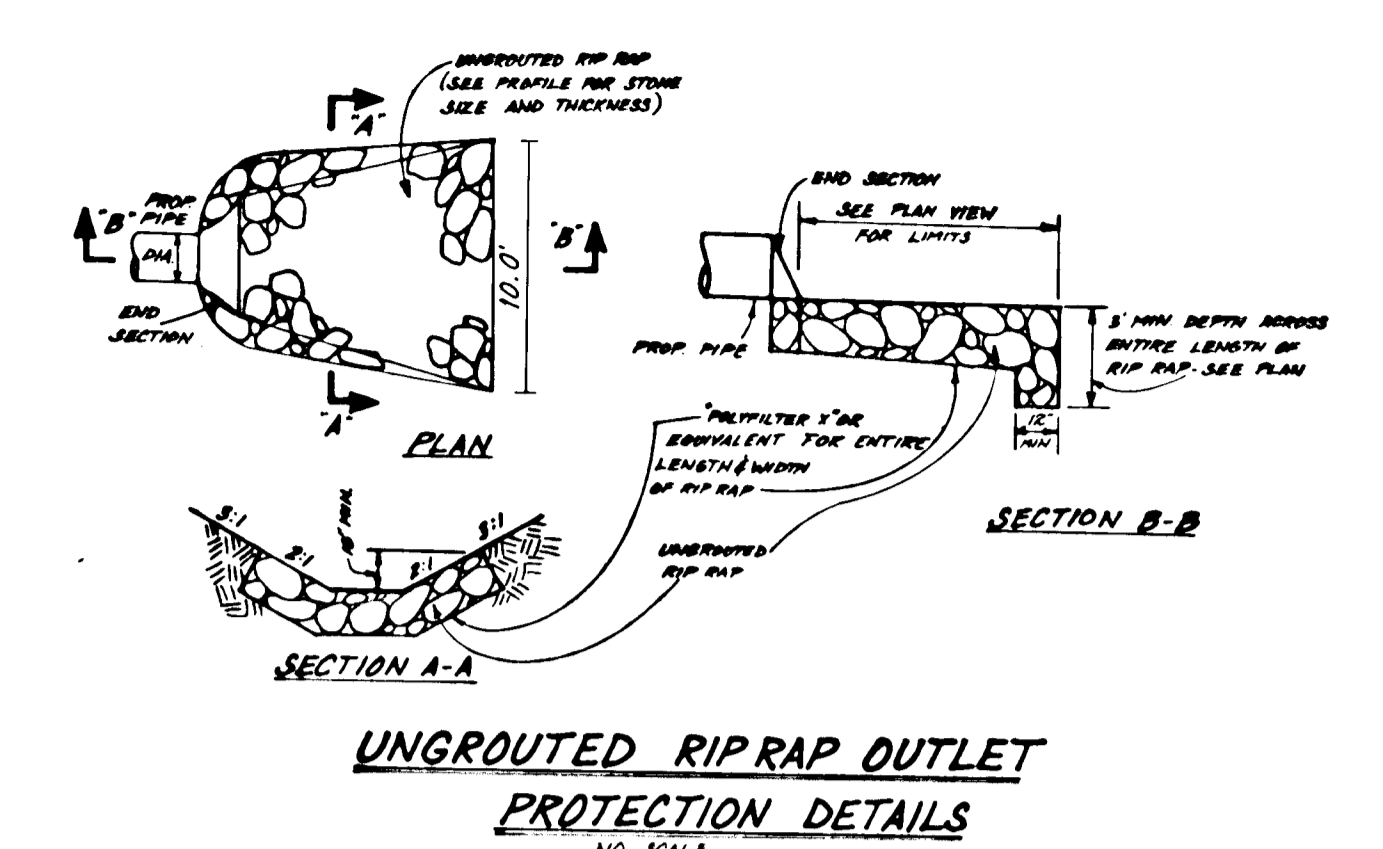

UNGROUTED RIPRAP OUTLET PROTECTION DETAILS
NO SCALE

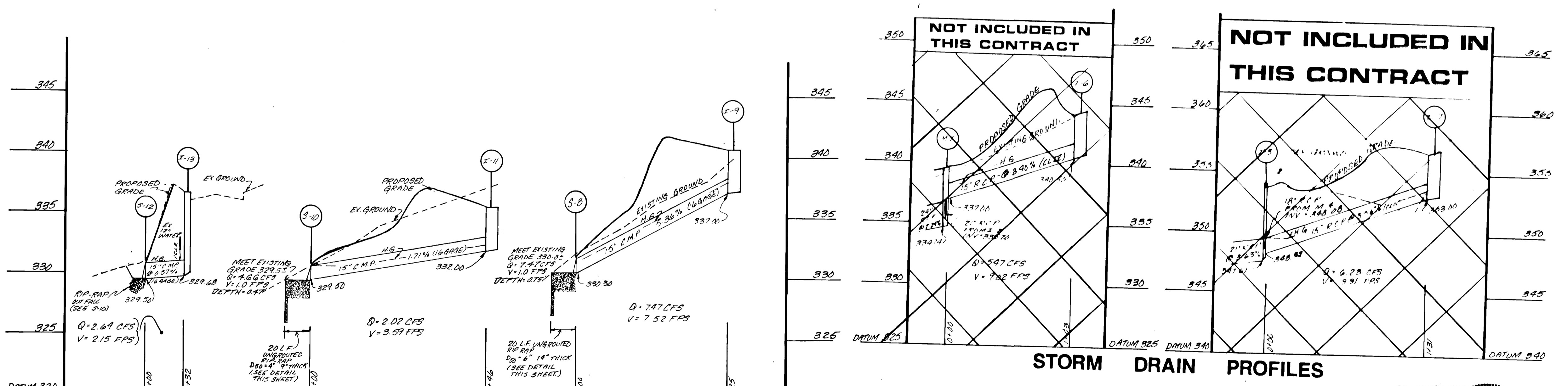

STORM DRAIN PROFILES

SCALES:
HORIZONTAL: 1"=50' VERTICAL: 1"=5'

DESIGNER'S CERTIFICATE
I/We certify that all development and construction will be done according to this plan, and that any responsible personnel involved in the construction project will have a Certificate of Attendance at a Department of Natural Resources Approved Training Program for the Control of Sediment and Erosion before beginning the project.
Richard W. Goodman 12/22/86

ENGINEER'S CERTIFICATE
I certify that this plan and its construction control represents a practical and workable plan based on my personal knowledge of the site conditions and drawings prepared in accordance with the requirements of the Howard County Conservation District.
C. K. Johnson 12-22-86

Reviewed for HOWARD COUNTY
Name: Howard County
and State Technical Requirements:
5-20-87
Date: 5/20/87

APPROVED: DEPARTMENT OF PUBLIC WORKS
5-20-87
CHIEF BUREAU OF ENGINEERING
APPROVED: HOWARD COUNTY OFFICE OF PLANNING & ZONING
5-20-87
CHIEF DIVISION OF LAND DEVELOPMENT AND ZONING ADMINISTRATION

GLW GUTSCHICK LITTLE & WEBER, P.A.
ENGINEERS, PLANNERS, SURVEYORS
3909 NATIONAL DRIVE - SUITE 250 - BURTONSVILLE OFFICE PARK - BURTONSVILLE, MD. 20866
TEL: (301) 421-4029

DES. TOC	DRN. #	CHK. TOC	DATE	REVISION	BY	APPR.

OWNER CAPITAL HOMES, INC.
8102 ASPENWOOD WAY
JESSUP, MARYLAND, 20794

ROAD CONSTRUCTION PLANS - STORM DRAINAGE PROFILES
DDRSEY HALL
SECTION 2 AREA 2
2ND ELECTION DISTRICT
HOWARD COUNTY, MARYLAND

SCALE	CONTOUR INTERVAL	G.L.W. FILE No.
AS SHOWN		86-016
DATE	TAX MAP No.	SHEET
5-14-87		2 OF 5

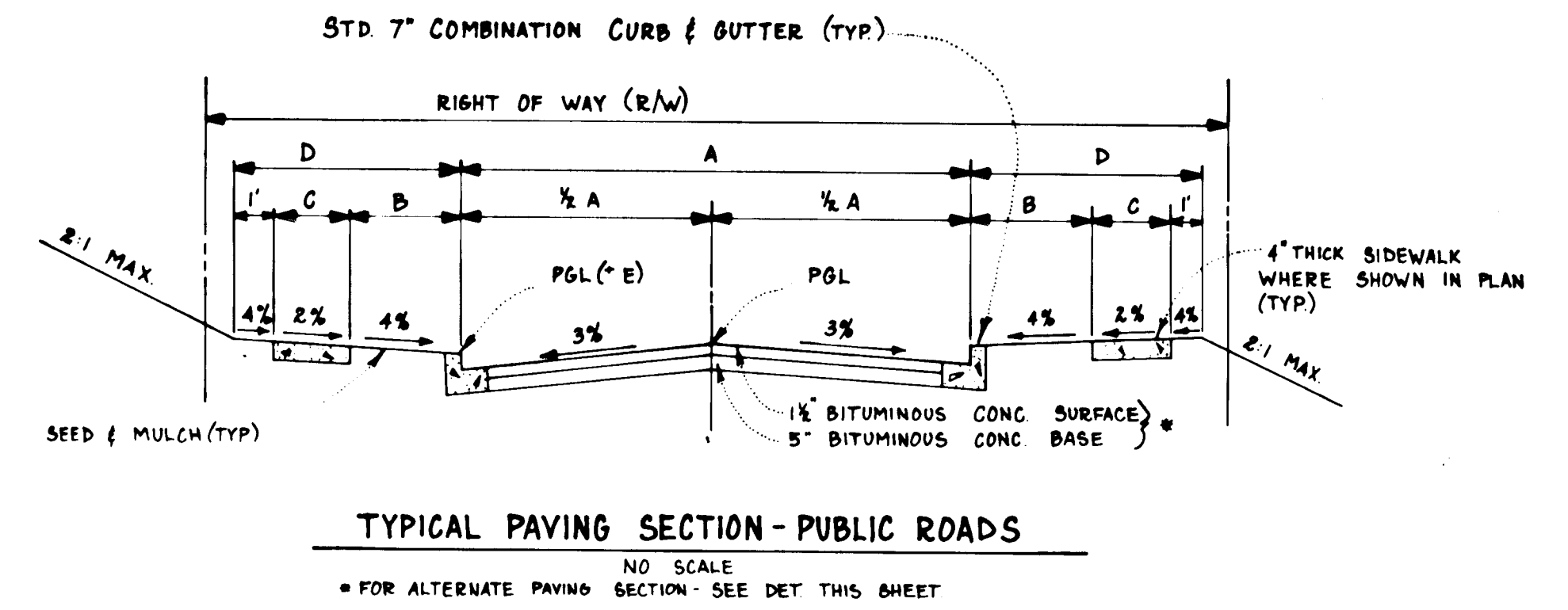
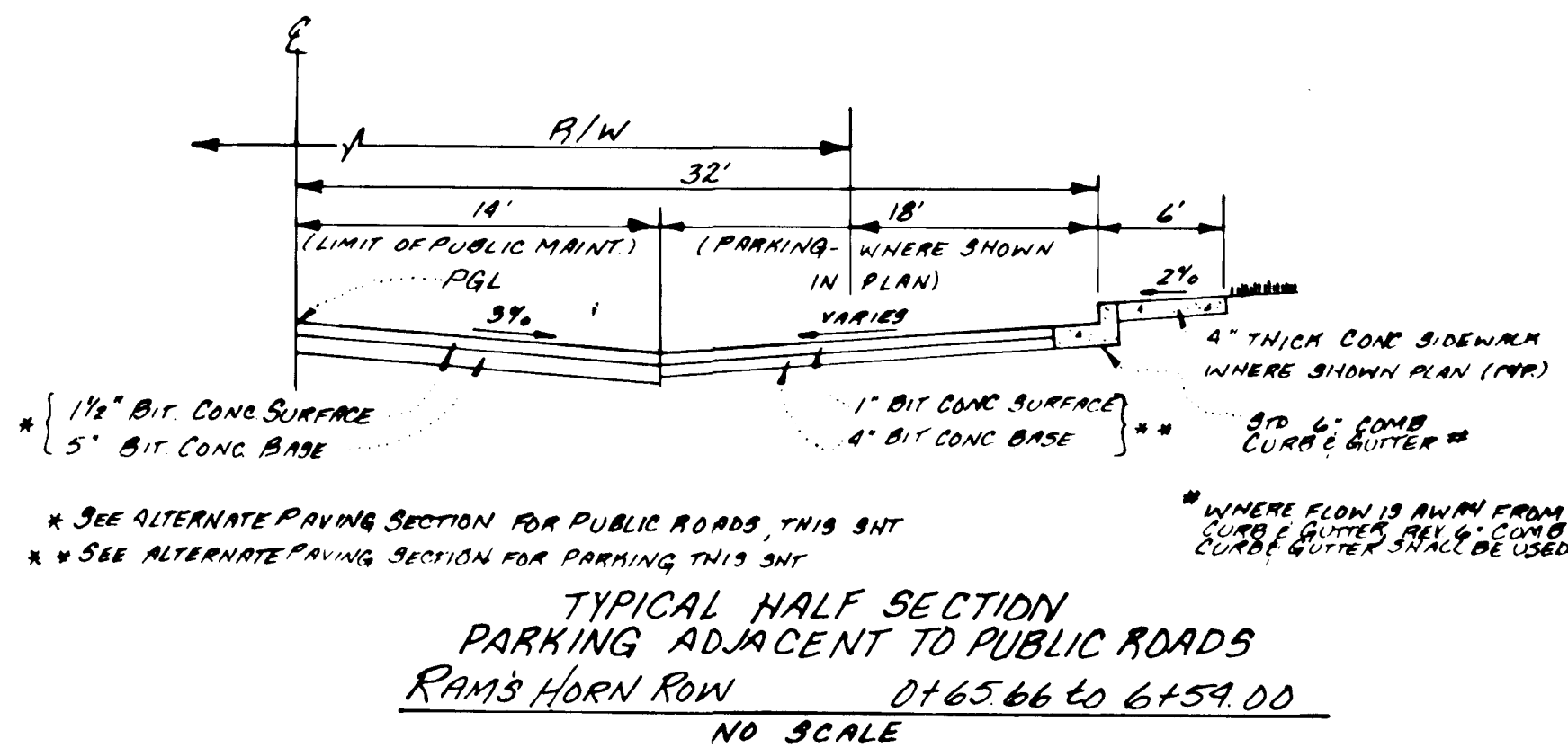
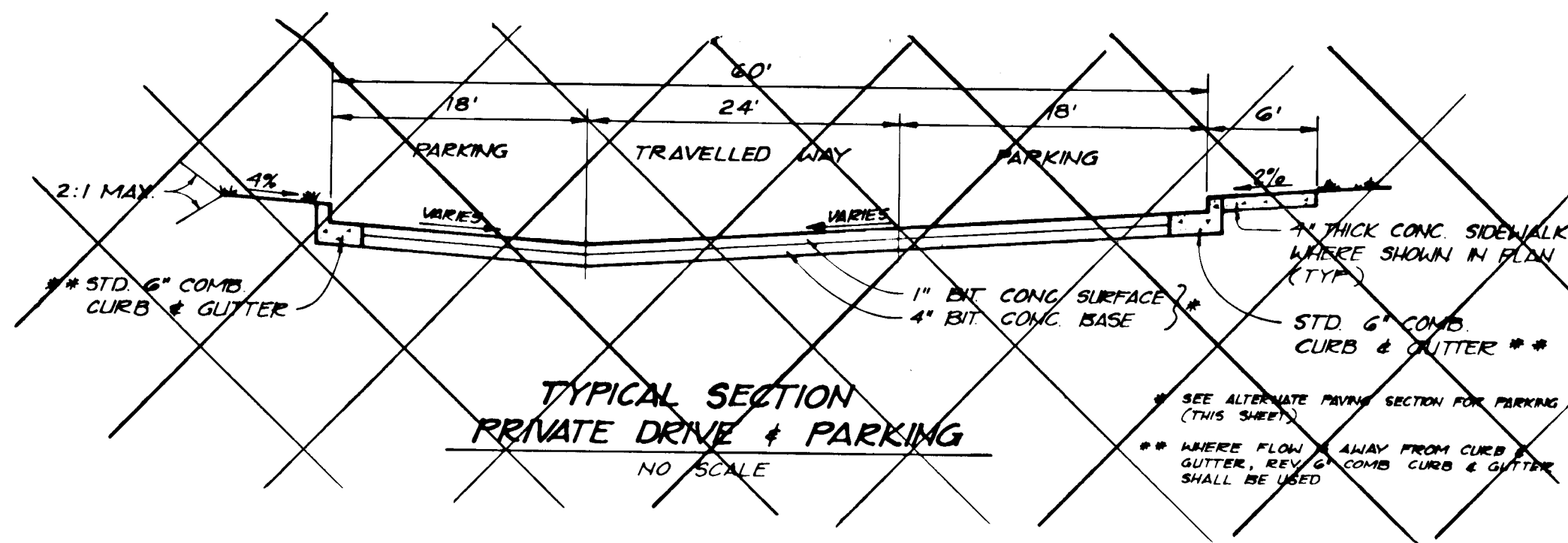

STREET NAME & STATION	TYPE OF TRAFFIC	A	B	C	D	R/W	ZONING	DESIGN SPEED	E
RAMS HORN ROW 0100 to 7122	CUL-DE-SAC	28'	4'	4'	9'	50'	R.S.C.	25 MPH	1A

- NOTES**
- LONGITUDINAL JOINT BETWEEN SIDEWALK AND CURB SHALL BE CONTINUOUS AND TO A DEPTH OF 1/4 THE SIDEWALK THICKNESS OR 1" MAX. LATITUDINAL JOINTS SHALL RUN FROM BACK EDGE OF SIDEWALK, CONTINUOUS TO THE BOTTOM FACE OF CURB TO A DEPTH OF 1/4 AND SPACED 5' APART.
 - PROVIDE 1/2" EXPANSION JOINTS AT 15' INTERVALS IN LATITUDINAL JOINTS TO FULL CROSS-SECTION.

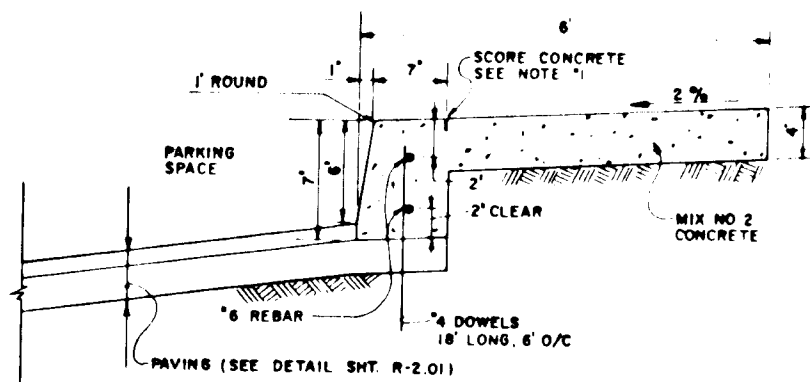
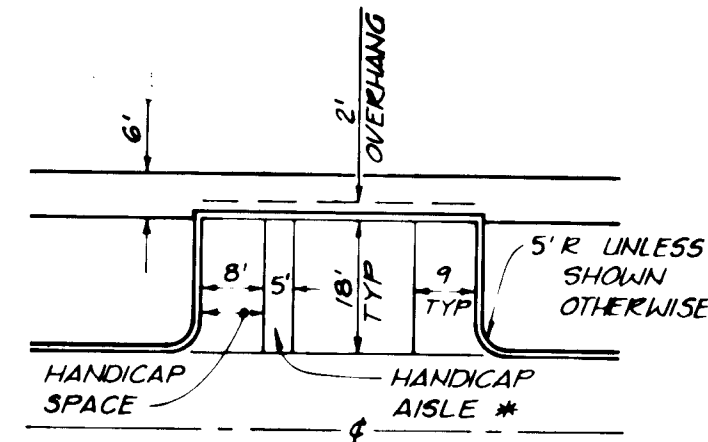
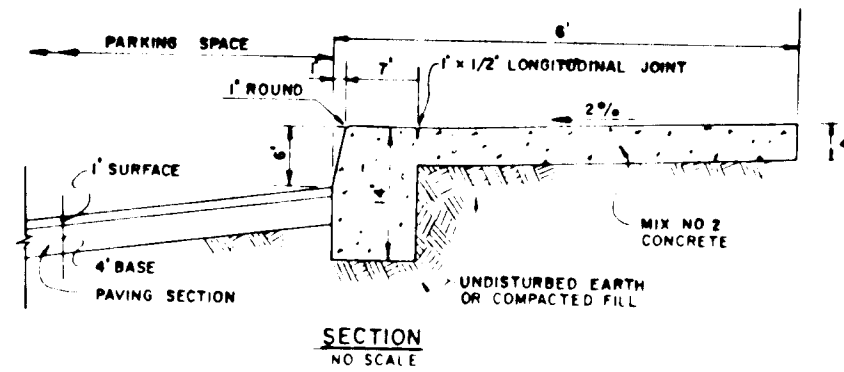

MONOLITHIC CURB & SIDEWALK
PRIVATE PARKING AREA

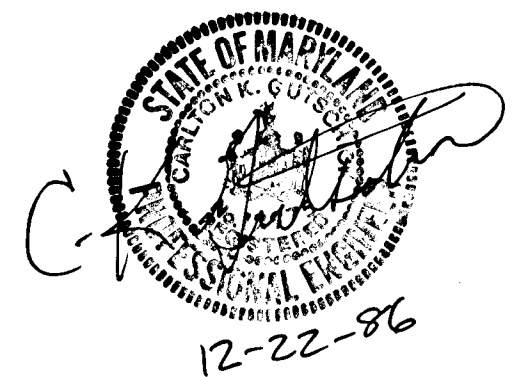
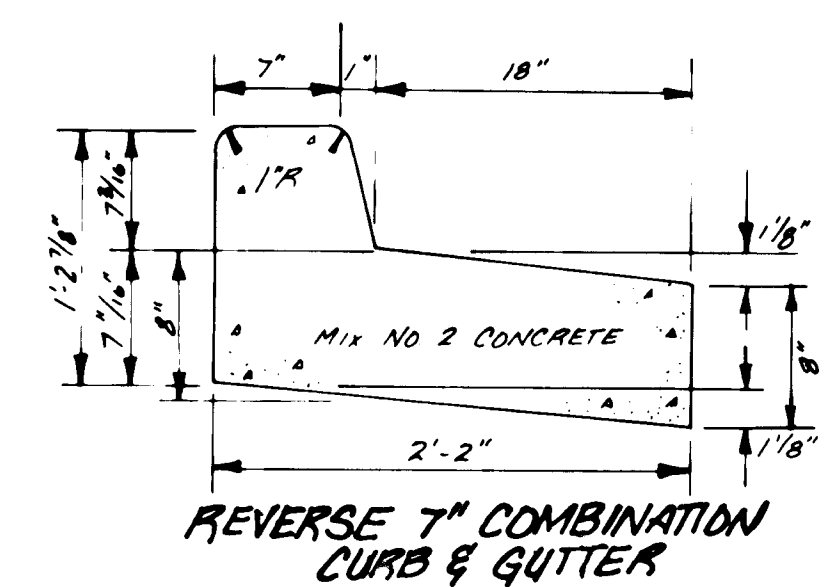
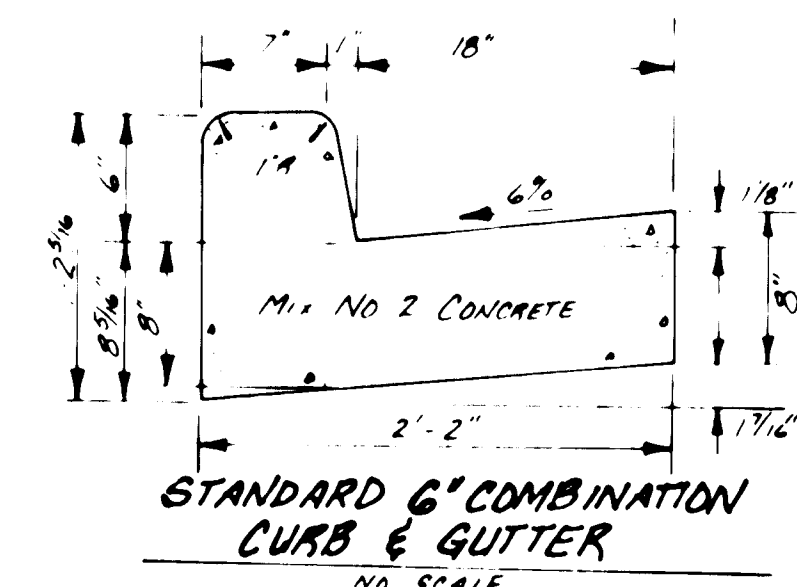
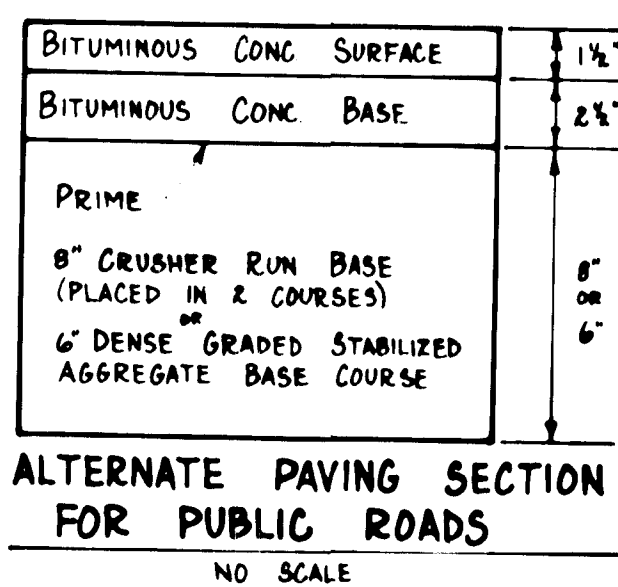
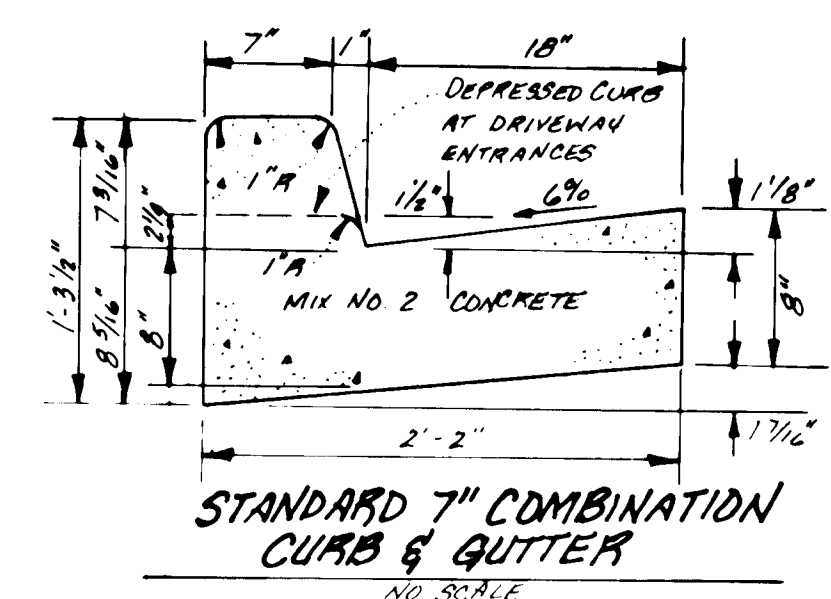
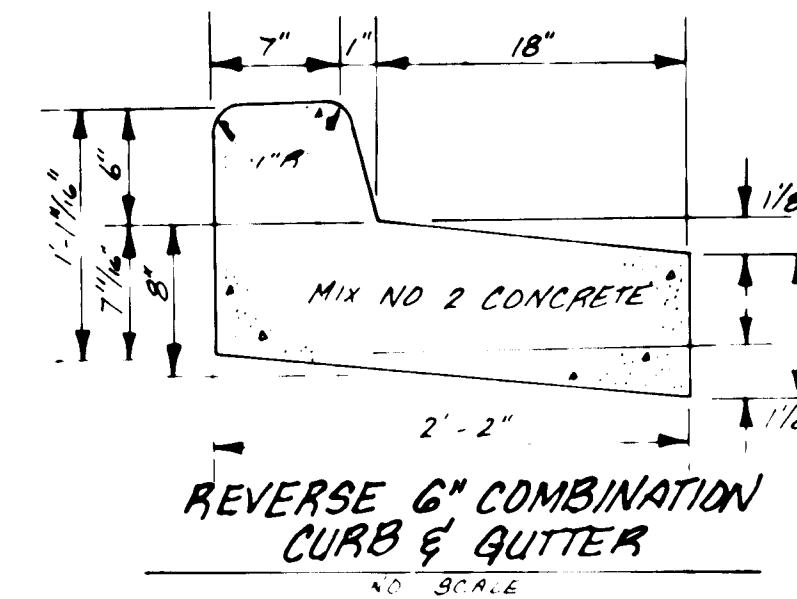
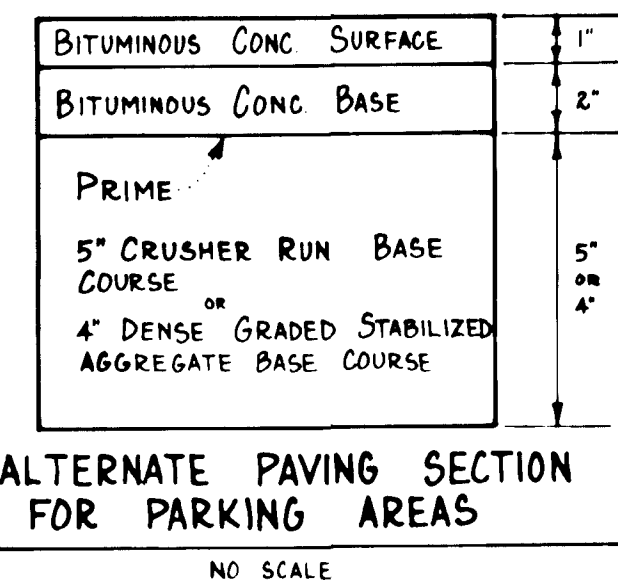

APPROVED: DEPARTMENT OF PUBLIC WORKS
Madeline J. Price 5-2-87
CHIEF, BUREAU OF ENGINEERING DATE

APPROVED: HOWARD COUNTY OFFICE OF PLANNING & ZONING
John W. M... .. 5-2-87
CHIEF, DIVISION OF LAND DEVELOPMENT AND ZONING ADMINISTRATION DATE

GLW GUTSCHICK LITTLE & WEBER, P.A.
ENGINEERS, PLANNERS, SURVEYORS
3909 NATIONAL DRIVE - SUITE 250 - BURTONSVILLE OFFICE PARK - BURTONSVILLE, MD. 20866
TEL: (301) 421-4024

DATE	REVISION	BY	APP'R.

OWNER: CAPITAL HOMES, INC.
8102 ASPENWOOD WAY
JESSUP, MARYLAND, 20794

ROAD CONSTRUCTION PLANS - PAVING DETAILS		SCALE	CONTOUR INTERVAL	G.L.W. FILE No.
DORSEY HALL SECTION 2 AREA 2 2 ND ELECTION DISTRICT		As Shown		86-016
		DATE	TAX MAP No.	SHEET
		5-14-86		3 OF 5

HOWARD COUNTY, MARYLAND

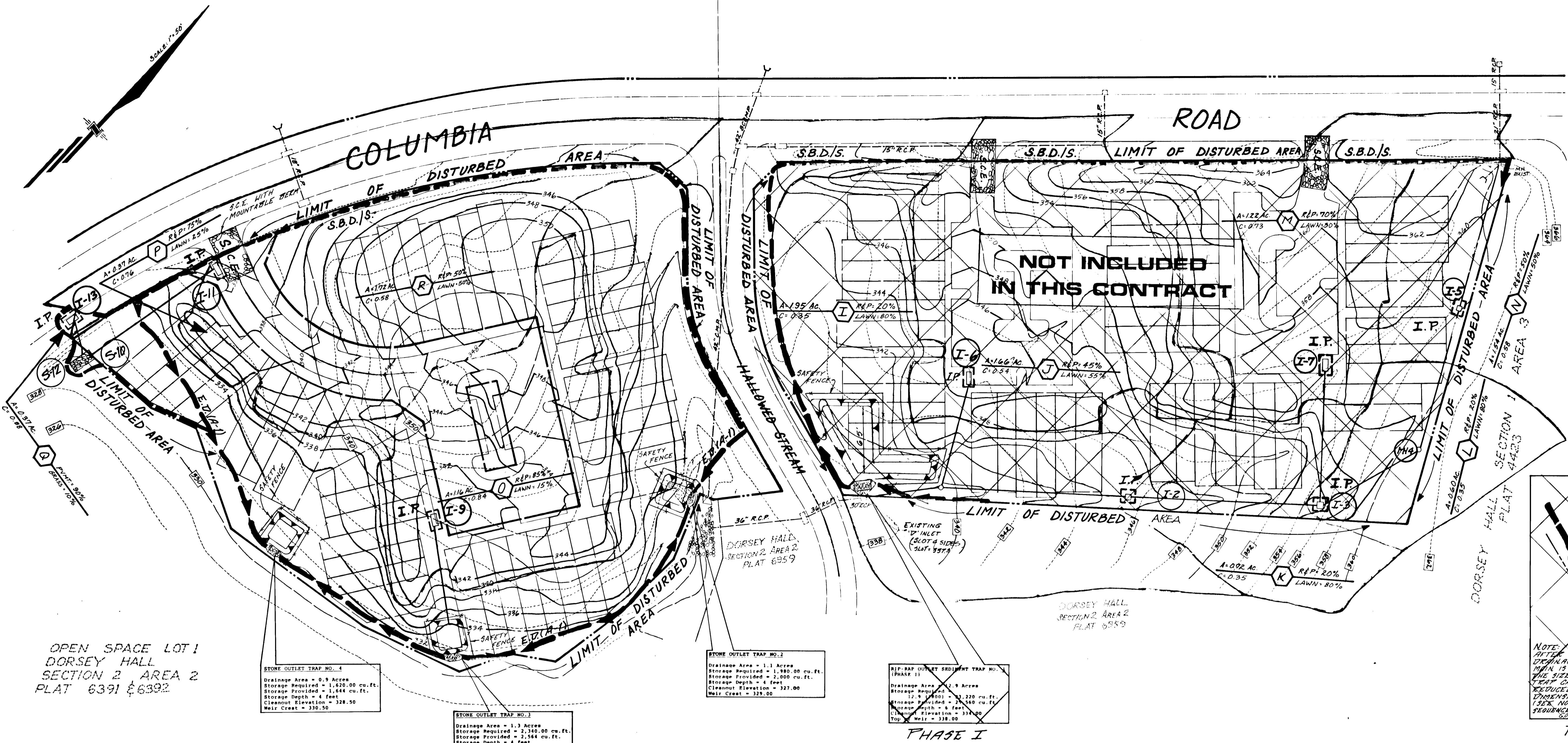

OPEN SPACE LOT 1
DORSEY HALL
SECTION 2 AREA 2
PLAT 6391 & 6392

STONE OUTLET TRAP NO. 4
Drainage Area = 0.9 Acres
Storage Required = 1,620.00 cu. ft.
Storage Provided = 1,644 cu. ft.
Storage Depth = 4 feet
Cleanout Elevation = 328.50
Weir Crest = 330.50

STONE OUTLET TRAP NO. 3
Drainage Area = 1.3 Acres
Storage Required = 2,340.00 cu. ft.
Storage Provided = 2,564 cu. ft.
Storage Depth = 4 feet
Cleanout Elevation = 328.30
Weir Crest = 330.30

STONE OUTLET TRAP NO. 2
Drainage Area = 1.1 Acres
Storage Required = 1,980.00 cu. ft.
Storage Provided = 2,000 cu. ft.
Storage Depth = 4 feet
Cleanout Elevation = 327.00
Weir Crest = 329.00

RIP-RAP OUTLET SEDIMENT TRAP NO. 1
(PHASE I)
Drainage Area = 1.3 Acres
Storage Required = 2,320 cu. ft.
Storage Provided = 2,380 cu. ft.
Storage Depth = 6 feet
Cleanout Elevation = 328.00
Top Weir = 338.00

RIP-RAP OUTLET SEDIMENT TRAP NO. 1
(PHASE II)
Drainage Area = 7.9 acres
Storage Required = 14,220 cu. ft.
Storage Provided = 14,354 cu. ft.
Storage Depth = 6 feet
Cleanout Elevation = 331.00
Top of Weir = 338.00
Depth of Channel = 2.0 feet
Length of Weir = 16.0 feet

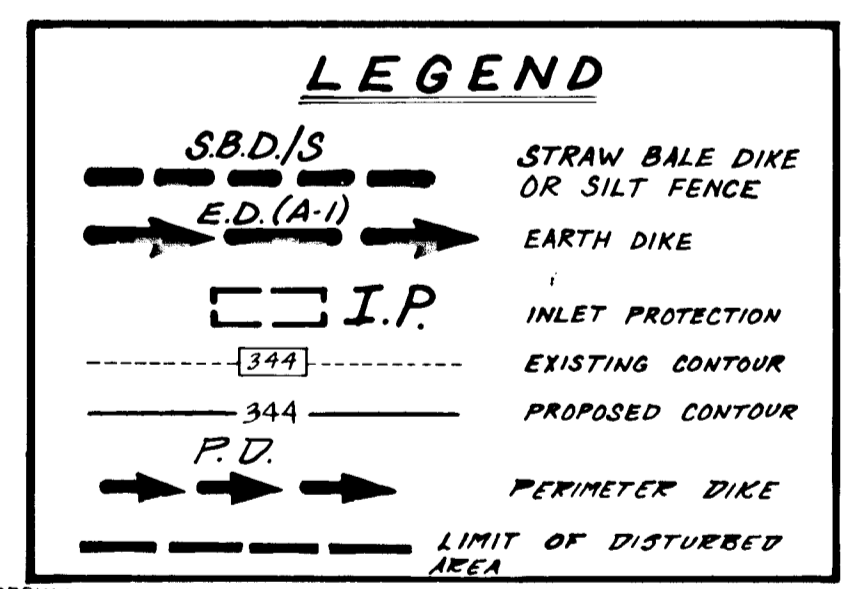

- SEQUENCE OF CONSTRUCTION
1. Obtain Grading Permit.
 2. Install stabilized construction entrances.
 3. Install perimeter dike/swale, earth dikes, sediment traps, and strawbale dikes/silt fences as shown on the plan.
 4. Clear and grade the site.
 5. Install utilities - *Note: After storm drainage trunk main from existing inlet 1-4 (P-86 219) to existing Manhole M-1 (P-85 16) is functional the size of the Rip-Rap Outlet Sediment Trap No. 1 can be reduced as shown on the plans.*
 6. Install inlet protection devices around all the inlets as soon as they are completed.
 7. Stabilize the site with buildings, paving and seeding/sodding per the Site Plan.
 8. Remove sediment traps and other sediment control measures only after those areas which are served by these measures have been stabilized AND permission has been granted by the Sediment Control Inspector.

ENGINEER'S CERTIFICATE
"I certify that this plan for erosion and sediment control represents a practical and workable plan based on my personal knowledge of the site conditions and the site work prepared in accordance with the requirements of the Howard Soil Conservation District."
Stephen L. Hulce 12/22/86

THIS DEVELOPMENT PLAN IS APPROVED FOR SOIL EROSION AND SEDIMENT CONTROL BY THE HOWARD SOIL CONSERVATION DISTRICT
Stephen L. Hulce 5/20/87

DEVELOPER'S/BUILDER'S CERTIFICATE
"I/We certify that all development and construction will be done according to this plan, and that any responsible personnel involved in the construction project shall have a Certificate of Attendance at a Department of Natural Resources Approved Training Program for the Control of Sediment and Erosion before beginning the project."
Richard Woodman 12/22/86

Reviewed for HOWARD S.C.D.
and
John M. Sch 5-20-87

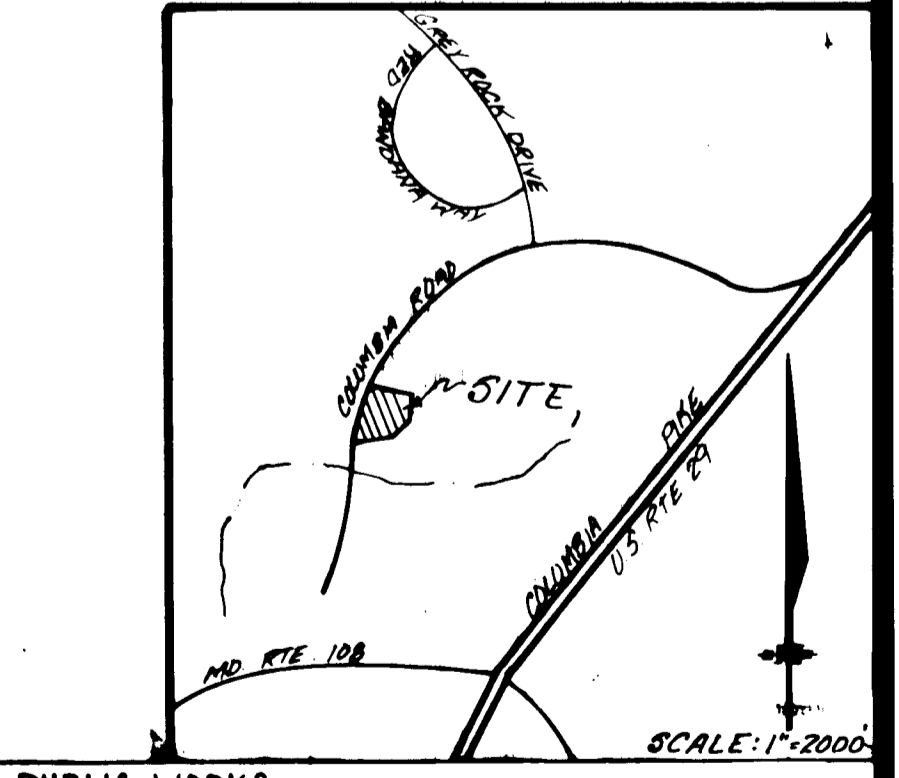

APPROVED DEPARTMENT OF PUBLIC WORKS
William J. ... 5-20-87
CHIEF, BUREAU OF ENGINEERING
APPROVED: HOWARD COUNTY OFFICE OF PLANNING & ZONING
John W. ... 5-20-87
CHIEF, DIVISION OF LAND DEVELOPMENT AND ZONING ADMINISTRATION

GW GUTSCHICK LITTLE & WEBER, P.A.
ENGINEERS, PLANNERS, SURVEYORS
3909 NATIONAL DRIVE · SUITE 250 · BURTONSVILLE OFFICE PARK · BURTONSVILLE, MD. 20866
TELEPHONE: (301) 421-4024

DES.	DRN.	CHK.	DATE	REVISION	BY	APP'R.
MJT	FK	MJT				

OWNER: CAPITAL HOMES, INC.
8102 ASPENWOOD WAY
JESSUP, MARYLAND, 20794

ROAD CONSTRUCTION PLANS - SEDIMENT & EROSION CONTROL PLAN & DRAINAGE AREA MAP
DORSEY HALL
SECTION 2 AREA 2
2ND ELECTION DISTRICT
HOWARD COUNTY, MARYLAND

SCALE 1" = 50'	CONTOUR INTERVAL 2 FT.	G.L.W. FILE NO. 86-016
DATE 5-14-86	TAX MAP NO.	SHEET 4 OF 5

F-87-98

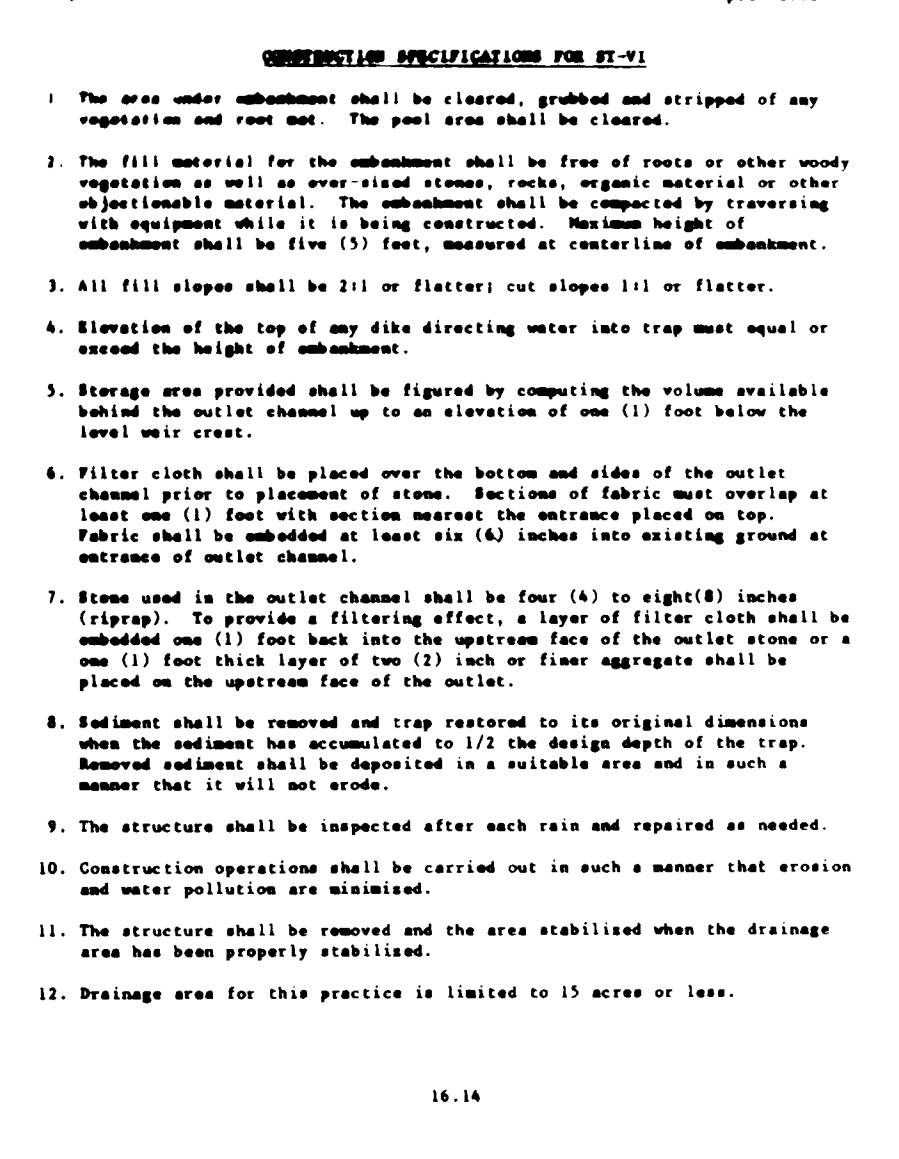
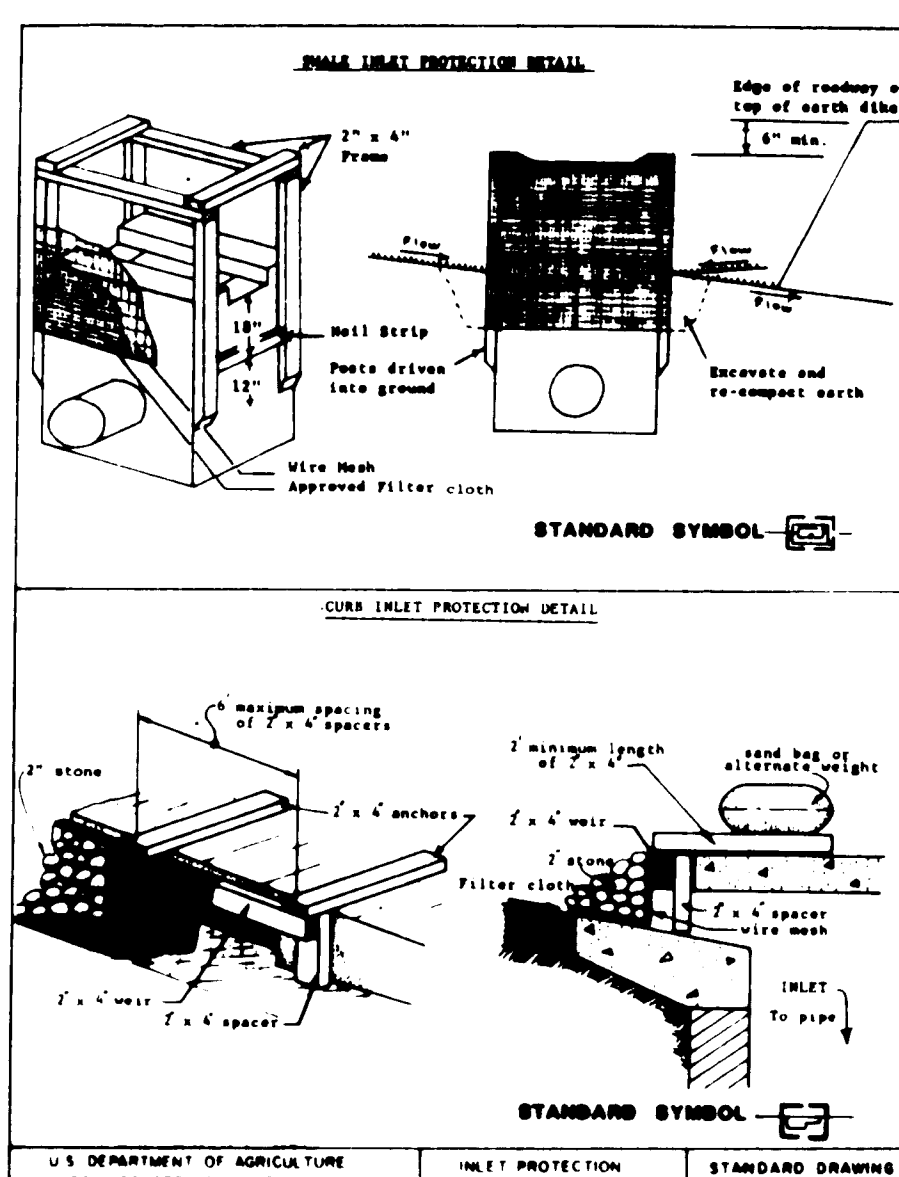
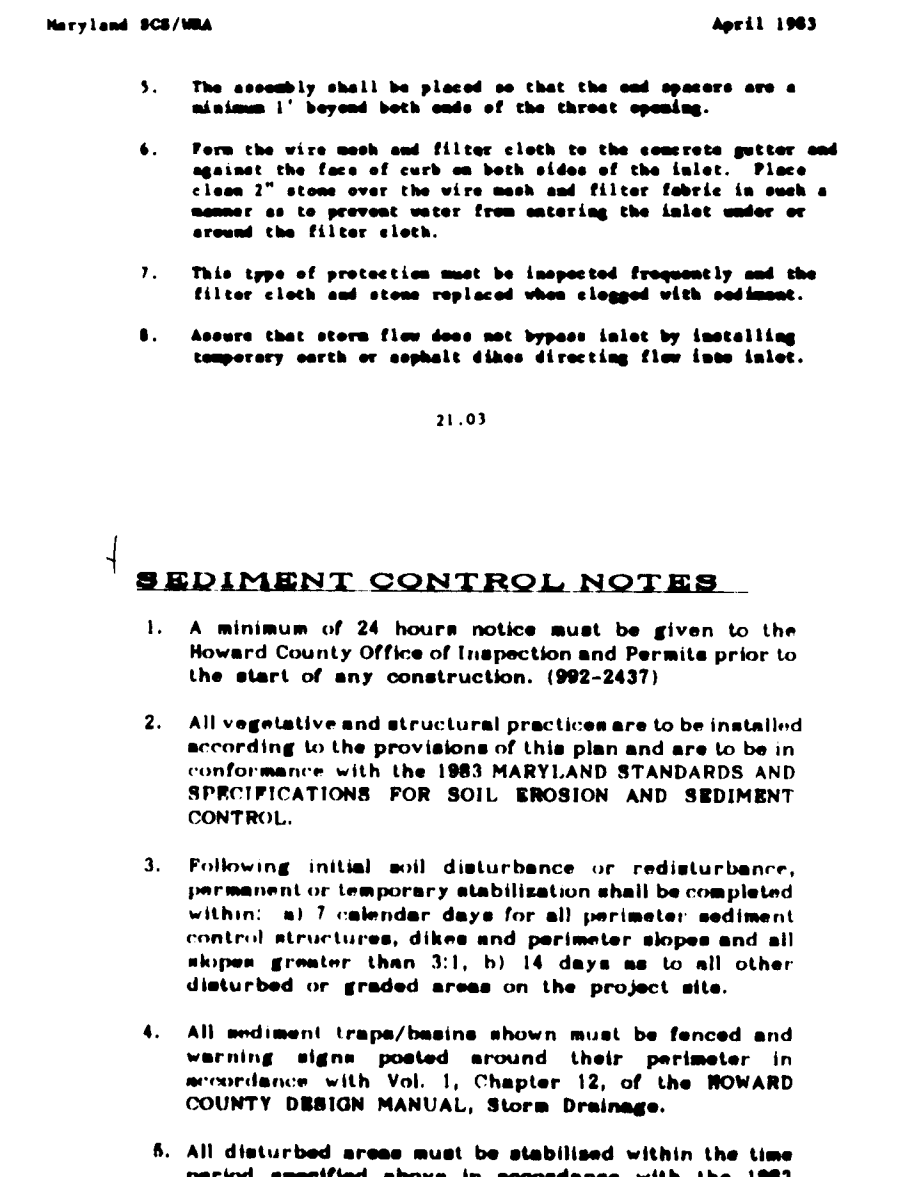
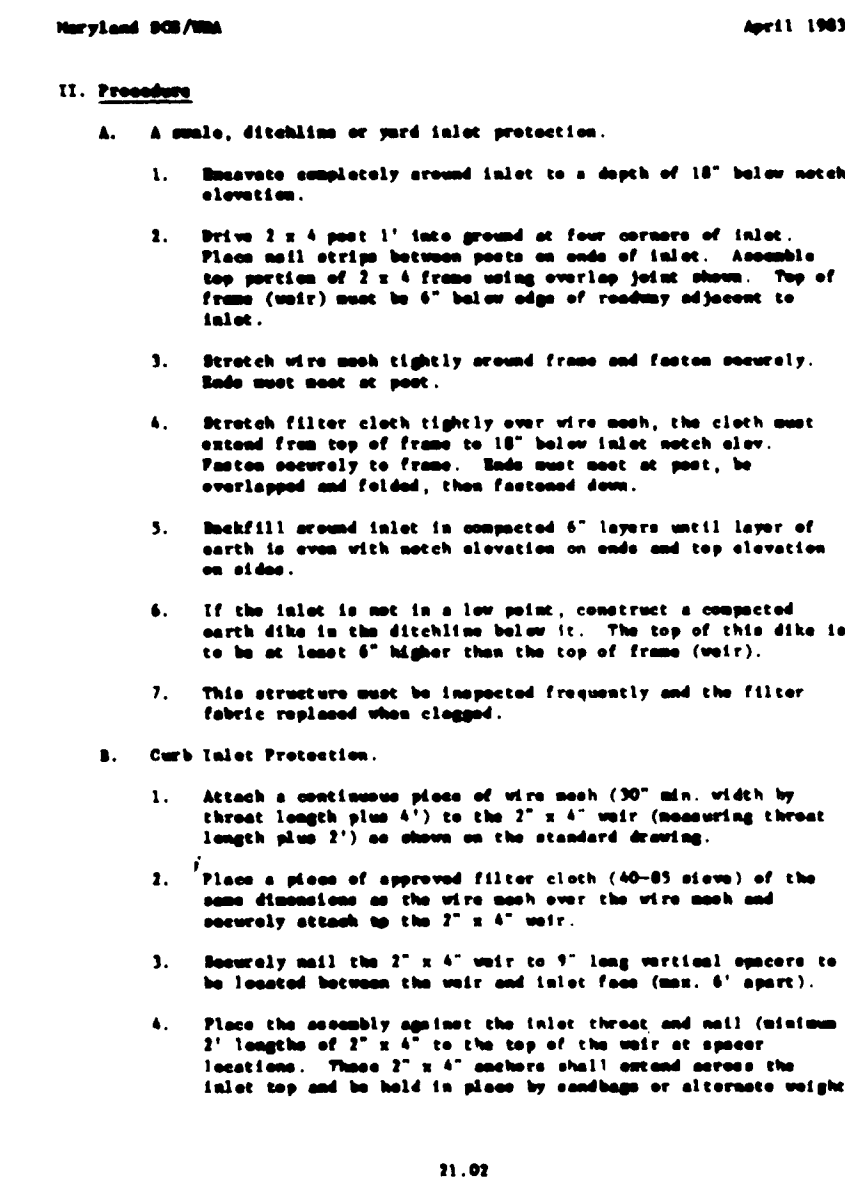
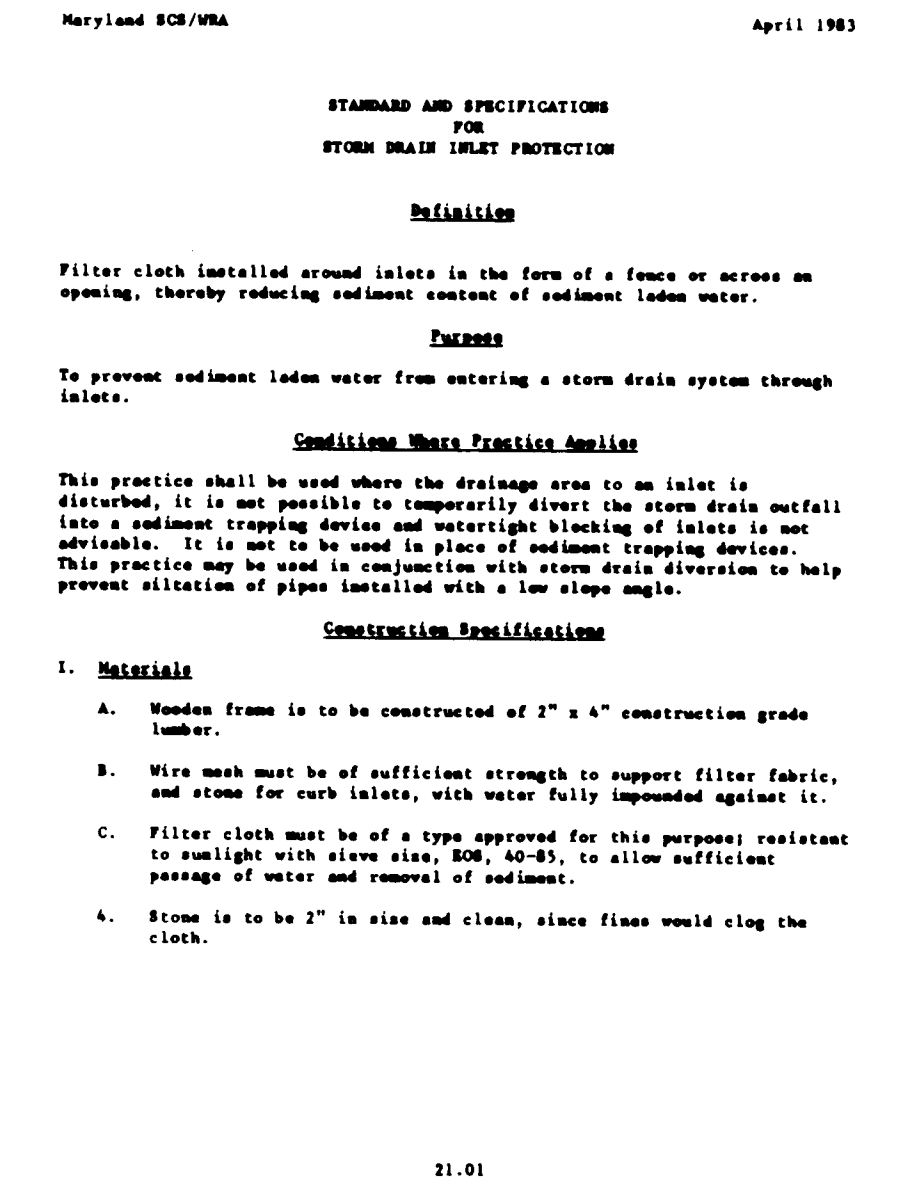
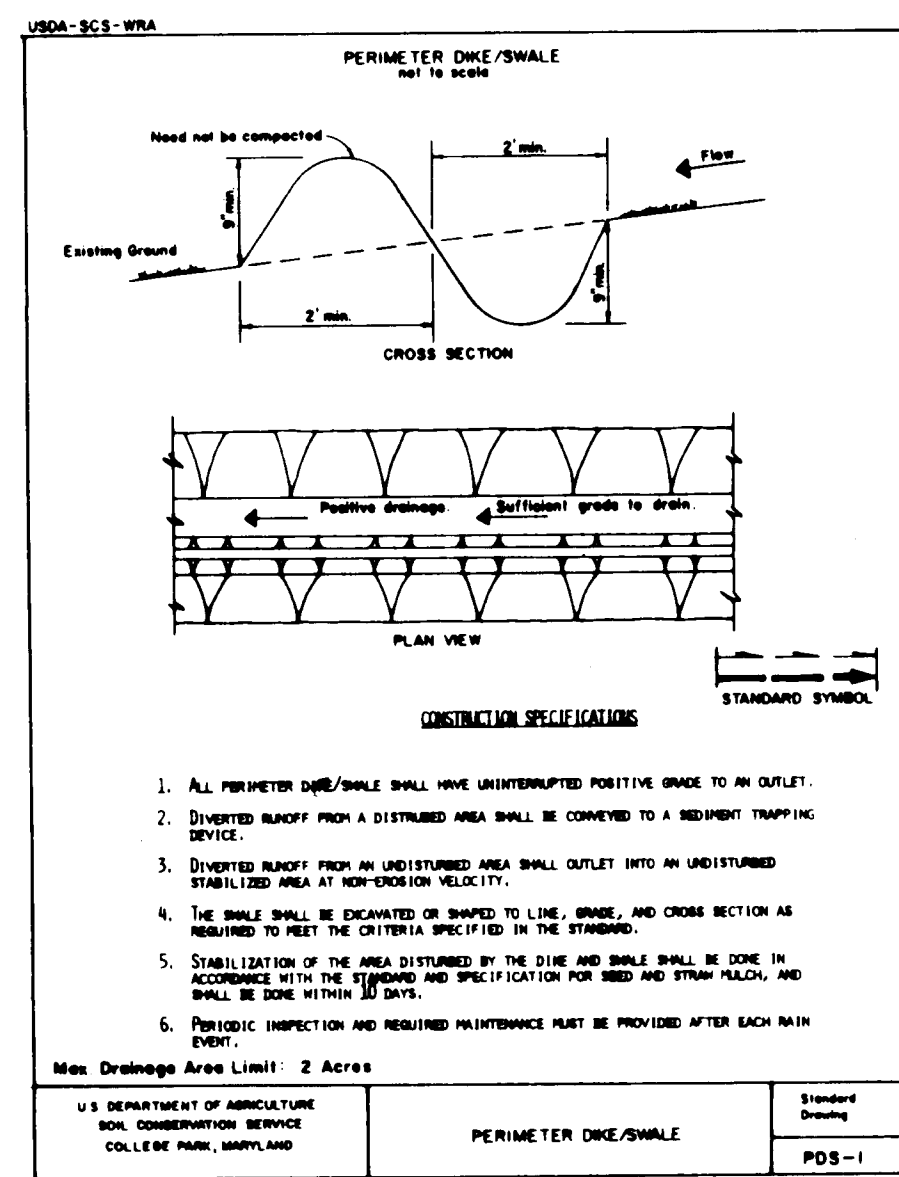
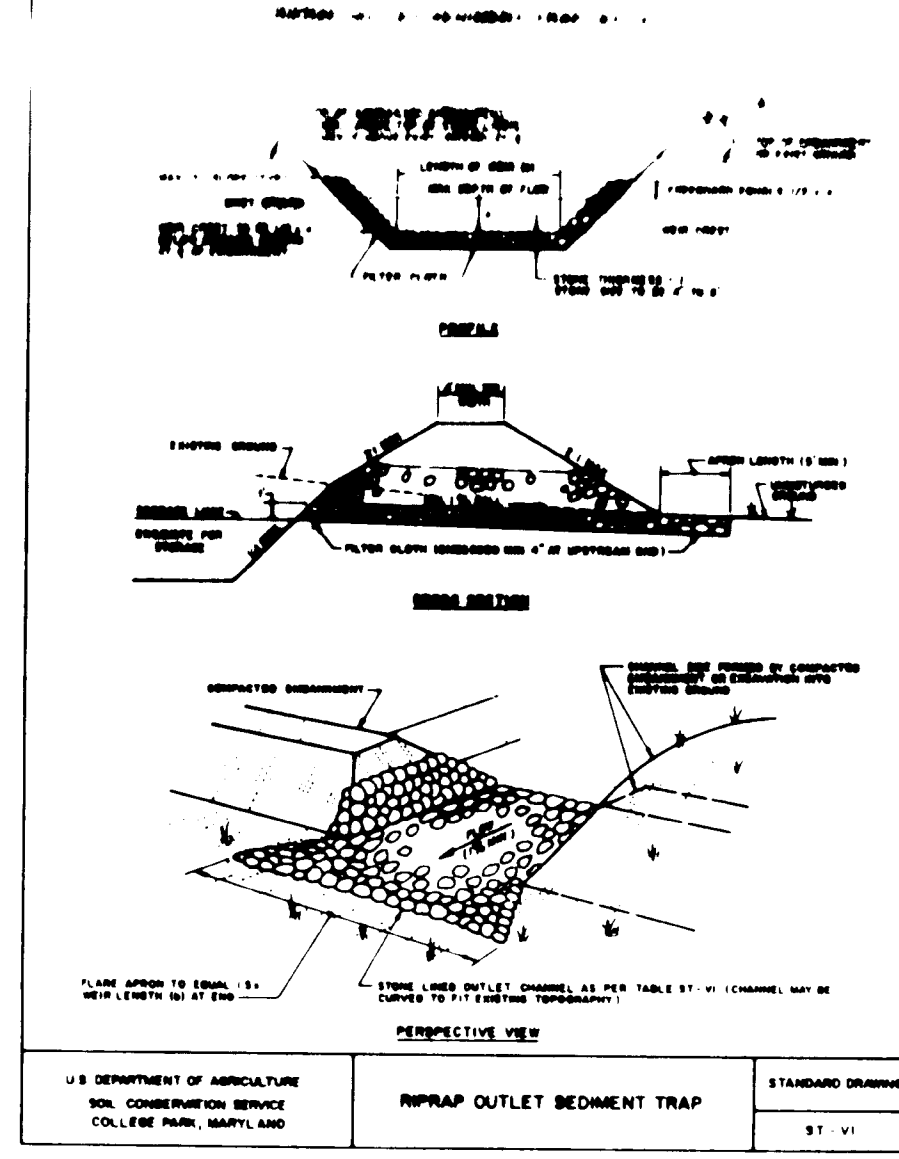
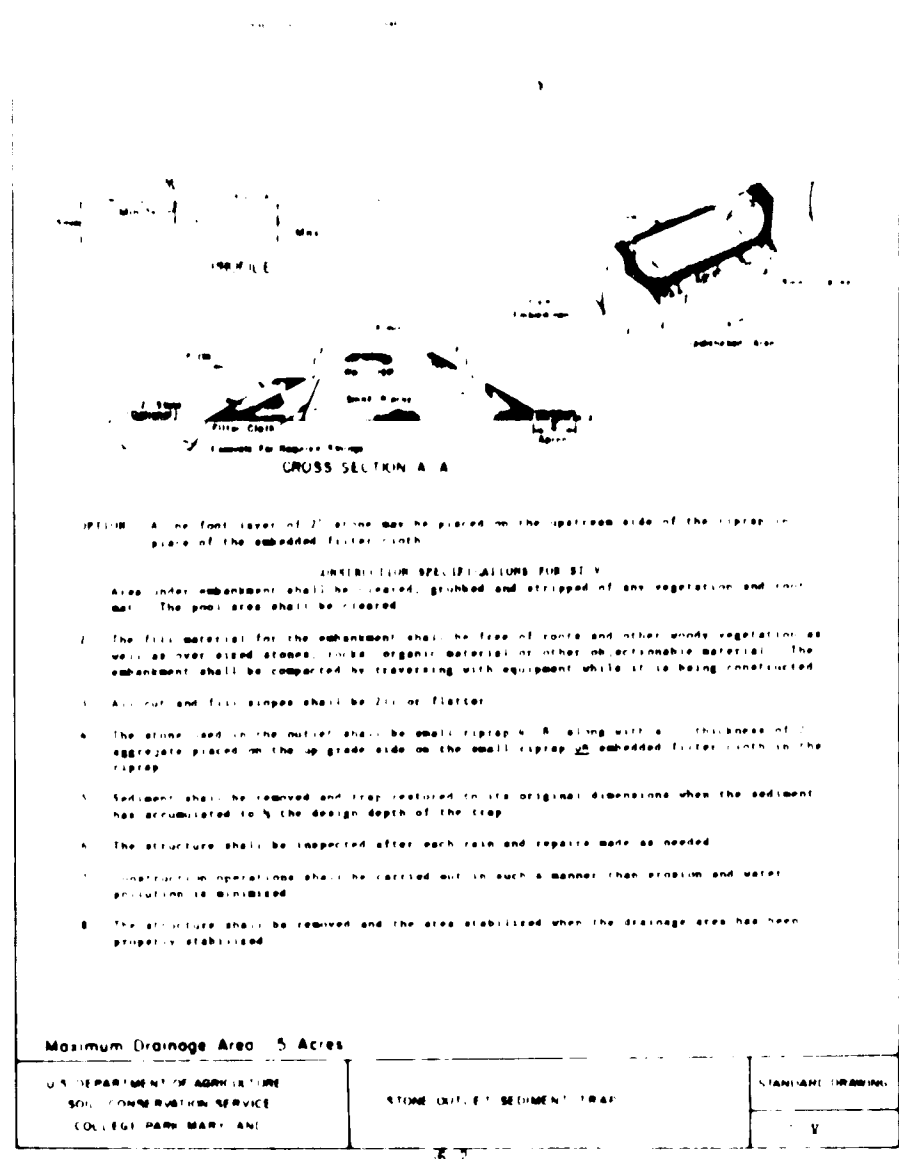
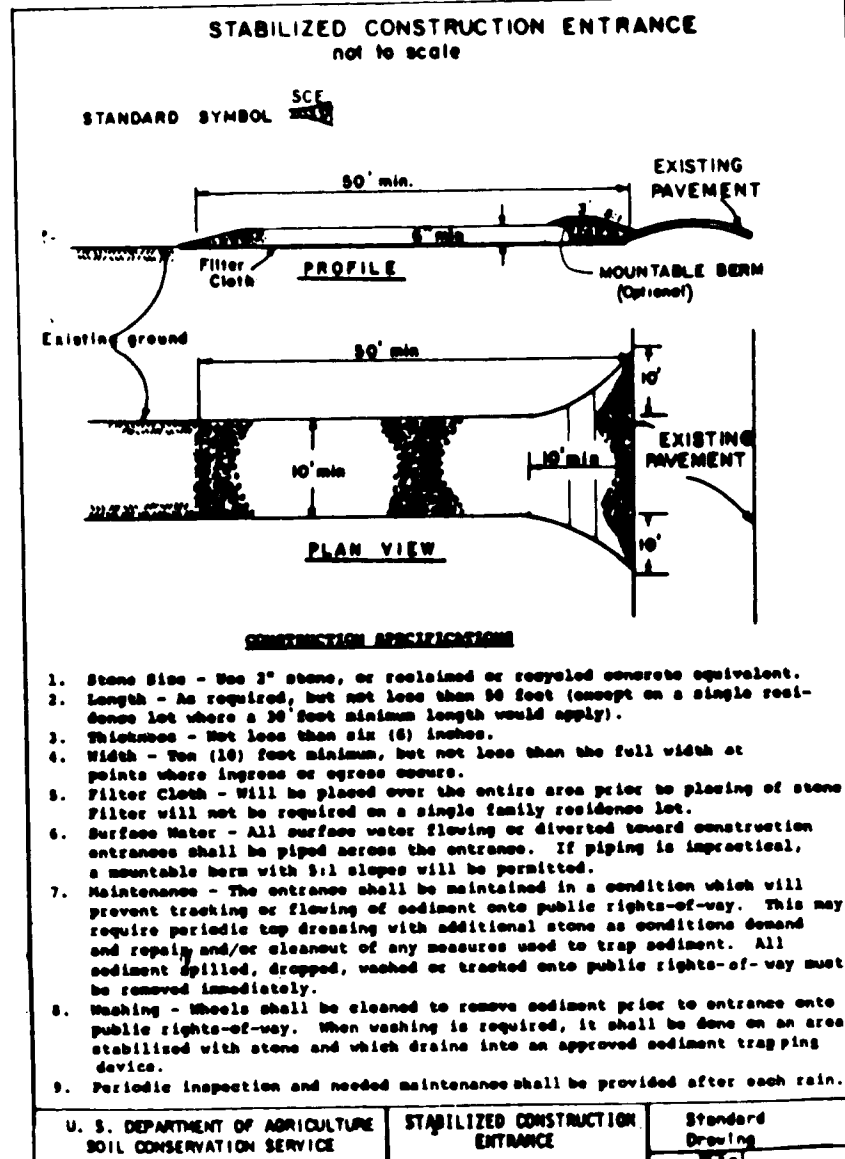
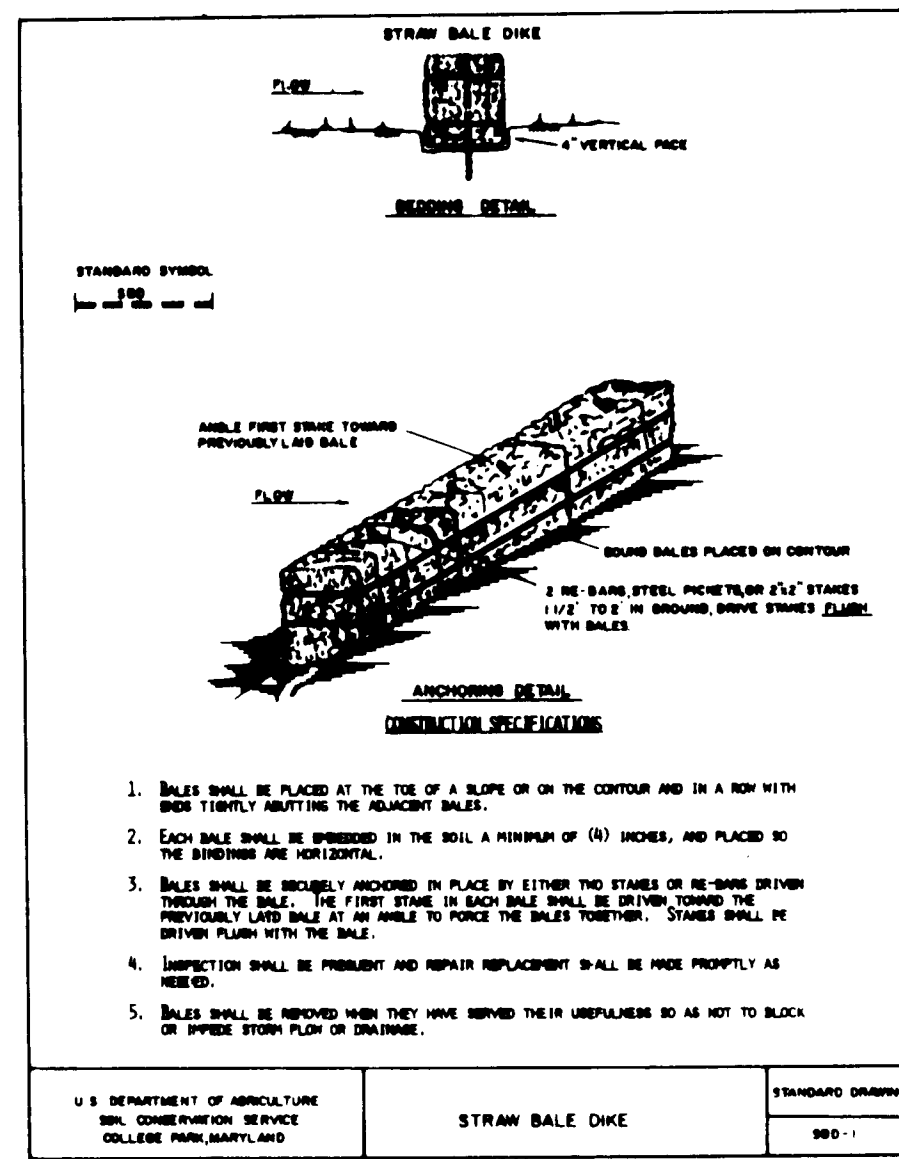
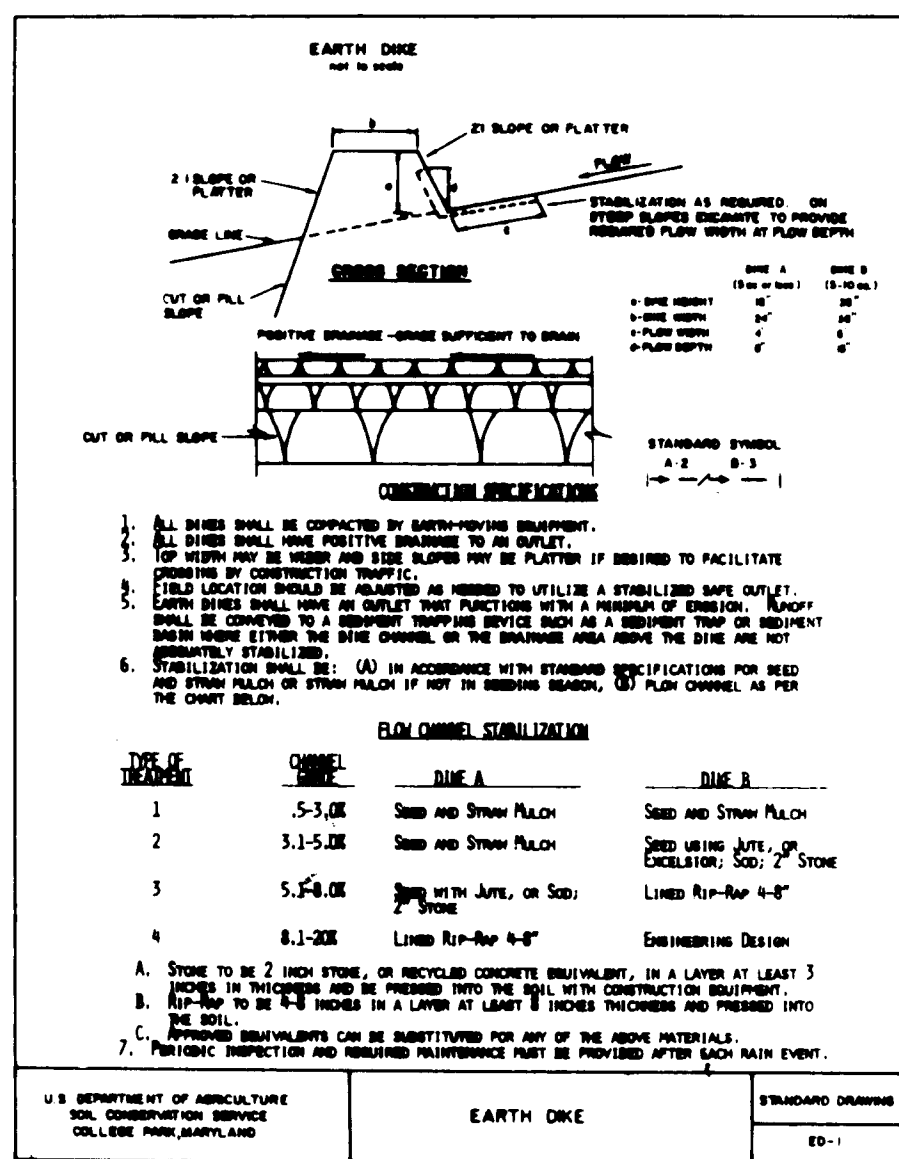

TEMPORARY SEEDING NOTES

Apply to graded or cleared areas likely to be redistributed where a short-term vegetative cover is needed.

Seedbed Preparation: Loosen upper three inches of soil by raking, dicing or other acceptable means before seeding.

Soil Amendments: Apply 600 lbs per acre 10-10-10 fertilizer (14 lbs/1000 sq ft).

Seeding: For periods March 1 thru April 30 and from August 15 thru November 15, seed with 2-1/2 bushels per acre of annual ryegrass (3.2 lbs/1000 sq ft). For the period May 1 thru August 14, seed with 3 lbs per acre of weeping lovegrass (.07 lbs/1000 sq ft). For the period November 16 thru February 28, protect site by applying 2 lbs per acre of well anchored straw mulch and seed as soon as possible in the spring, or use sod.

Mulching: Apply 1-1/2 to 2 tons per acre (70 to 90 lbs/1000 sq ft) of unrotted small grain straw immediately after seeding. Anchor mulch immediately after application using mulch anchoring tool or 218 gal per acre (5 gal/1000 sq ft) of emulsified asphalt on flat areas. On slopes, 8 ft or higher, use 348 gal per acre (8 gal/1000 sq ft) for anchoring.

Refer to the 1983 MARYLAND STANDARDS AND SPECIFICATIONS FOR SOIL EROSION AND SEDIMENT CONTROL for rate and methods not covered.

PERMANENT SEEDING NOTES

Apply to graded or cleared areas not subject to immediate further disturbance where a permanent long-lived vegetative cover is needed.

Seedbed Preparation: Loosen upper three inches of soil by raking, dicing or other acceptable means before seeding.

Soil Amendments: In lieu of soil test recommendations, use one of the following schedules:

- Preferred - Apply 2 tons per acre dolomitic limestone (92 lbs/1000 square feet) and 800 lbs per acre 10-10-10 fertilizer (14 lbs/1000 sq ft) before seeding. Narrow or disc into upper three inches of soil.
- Acceptable - Apply 2 tons per acre dolomitic limestone (92 lbs/1000 sq ft) and 1000 lbs per acre 10-10-10 fertilizer (23 lbs/1000 sq ft) before seeding. Narrow or disc into upper three inches of soil.

Seeding: For the periods March 1 thru April 30, and August 1 thru October 15, seed with 80 lbs per acre (1.4 lbs/1000 sq ft) of Kentucky 31 Tall Fescue. For the period May 1 thru July 31, seed with 80 lbs Kentucky 31 Tall Fescue per acre and 2 lbs per acre (.05 lbs/1000 sq ft) of weeping lovegrass. During the period of October 16 thru February 28, protect site by: Option (1) 2 tons per acre of well anchored straw mulch and seed as soon as possible in the spring; Option (2) Use sod; Option (3) Seed with 80 lbs/acre Kentucky 31 Tall Fescue and mulch with 2 tons/acre well anchored straw.

Mulching: Apply 1-1/2 to 2 tons per acre (70 to 90 lbs/1000 sq ft) of unrotted small grain straw immediately after seeding. Anchor mulch immediately after application using mulch anchoring tool or 218 gallons per acre (5 gal/1000 sq ft) of emulsified asphalt on flat areas. On slopes, 8 ft or higher, use 348 gallons per acre (8 gal/1000 sq ft) for anchoring.

Maintenance: Inspect all seeded areas and make needed repairs, replacements and reseedings.

II. Procedures

A. A silt, ditching or yard inlet protection.

- Excavate completely around inlet to a depth of 18" below catch elevation.
- Drive 2 x 4 post 1' into ground at four corners of inlet. Place nail strips between posts on ends of inlet. Assemble top portion of 2 x 4 frame using overlap joint shown. Top of frame (center) must be 4" below edge of roadway adjacent to inlet.
- Stretch wire mesh tightly around frame and fasten securely. Ends must meet at post.
- Stretch filter cloth tightly over wire mesh, the cloth must extend from top of frame to 18" below inlet, mesh also. Fasten securely to frame. Ends must meet at post, be overlapped and folded, then fastened down.
- Backfill around inlet to compacted 3" layers until layer of earth is even with catch elevation on ends and top elevation on side.
- If the inlet is not in a low point, construct a compacted earth dike to the ditching below it. The top of this dike to be at least 6" higher than the top of frame (center).
- This structure must be inspected frequently and the filter fabric replaced when clogged.

B. Curb Inlet Protection.

- Attach a continuous piece of wire mesh (30" min. width by throat length plus 4") to the 2" x 4" curb (connecting throat length plus 2") as shown on the standard drawing.
- Place a piece of approved filter cloth (40-80 mesh) of the same dimensions as the wire mesh over the wire mesh and securely attach to the 2" x 4" curb.
- Securely nail the 2" x 4" curb to a long vertical spacer to be located between the curb and inlet face (min. 6" apart).
- Place the assembly against the inlet throat and nail (minimum 2" length of 2" x 4" curb) to the top of the curb at spacer locations. Place 2" x 4" curb over the curb and across the inlet top and be held in place by curbage or alternate weight.

SEDIMENT CONTROL NOTES

- A minimum of 24 hours notice must be given to the Howard County Office of Inspection and Permits prior to the start of any construction. (992-2437)
- All vegetative and structural practices are to be installed according to the provisions of this plan and are to be in conformance with the 1983 MARYLAND STANDARDS AND SPECIFICATIONS FOR SOIL EROSION AND SEDIMENT CONTROL.
- Following initial soil disturbance or redistribution, permanent or temporary stabilization shall be completed within: a) 7 calendar days for all perimeter sediment control structures, dikes and perimeter slopes and all slopes greater than 3:1; b) 14 days for all other disturbed or graded areas on the project site.
- All sediment traps/beams shown must be fenced and warning signs posted around their perimeter in accordance with Vol. 1, Chapter 12, of the HOWARD COUNTY DESIGN MANUAL, Storm Drainage.
- All disturbed areas must be stabilized within the time period specified above in accordance with the 1983 MARYLAND STANDARDS AND SPECIFICATIONS FOR SOIL EROSION AND SEDIMENT CONTROL for permanent seedings (Sec. 81) and sod (Sec. 84), temporary seedings (Sec. 80) and mulching (Sec. 83). Temporary stabilization with mulch alone can only be done when recommended seeding dates do not allow for proper germination and establishment of grasses.
- All sediment control structures are to remain in place and are to be maintained in operative condition until permission for their removal has been obtained from the Howard County Sediment Control Inspector.
- Site Analysis:

Total Area of Site:	9.7	Acres
Area Disturbed:	4.6	Acres
Area to be roofed or paved:	1.6	Acres
Area to be vegetatively stabilized:	3.0	Acres
Total Cut:	7,200	Cu. Yds.
Total Fill:	7,200	Cu. Yds.

 Offsite water/borrow area location N/A
- Any sediment control practice which is disturbed by grading activity for placement of utility perimeter to be repaired on the same day of disturbance.
- Additional sediment control must be provided, if deemed necessary by the Howard County DPM sediment control inspector.
- On all sites with disturbed areas in excess of 2 acres, approval of the inspection agency shall be requested upon completion of installation of perimeter erosion and sediment controls, but before proceeding with any other earth disturbance or grading. Other building or grading inspection approvals may not be authorized until this initial approval by the inspection agency is made.
- If houses are to be constructed on "As-Built" basis at random, Single Lot Sediment Control as shown below shall be implemented.
- All papers to be checked at the end of each day (see detail below).
- The total amount of straw bale dikes/silt fences equals 1.7.

ENGINEER'S CERTIFICATE

"I certify that this plan for sediment control represents a practical and workable plan and that the knowledge of the site conditions and what has been prepared in accordance with the regulations of the Howard County Department of Conservation District."

Stephen C. Fisher 5/20/87
Professional Engineer
12-22-86
Date

BUILDER'S/DEVELOPER'S CERTIFICATE

"I certify that the development shown on this plan will be done according to the plan and that the responsible personnel involved in the construction of this project are Certified in Attendance at a Department of Natural Resources Approved Training Program for the Control of Sediment and Erosion before beginning the project."

Richard W. Goodman 12/22/86
Signature of Developer/Builder
Date

APPROVED: DEPARTMENT OF PUBLIC WORKS

William V. F.
CHIEF BUREAU OF ENGINEERING
DATE: 5/20/87

APPROVED: HOWARD COUNTY OFFICE OF PLANNING & ZONING

John W. Murchison
CHIEF DIVISION OF LAND DEVELOPMENT AND ZONING ADMINISTRATION
DATE: 5/20/87

DATE	REVISION	BY	APPR.

SEDIMENT & EROSION CONTROL DETAILS

DORSEY HALL
SECTION 2 AREA 2
2ND ELECTION DISTRICT

SCALE	CONTOUR INTERVAL	GL.W. FILE NO.
		86-016
DATE	TAX MAP No.	SHEET
5-14-87		5 of 5

OWNER: CAPITAL HOMES, INC.
8102 ASPENWOOD WAY
JESSIE, MARYLAND 20794

GLW GUTSCHICK LITTLE & WEBER, P.A.
ENGINEERS, PLANNERS, SURVEYORS
3909 NATIONAL DRIVE SUITE 250 - BURTONSVILLE OFFICE PARK - BURTONSVILLE, MD. 20886
TELEPHONE: (301) 421-4024

DATE	REVISION	BY	APPR.

DES. DRN. CHK.

HOWARD COUNTY, MARYLAND