

SHEET INDEX	
NO.	DESCRIPTION
1	TITLE SHEET
2	PLAN OF ROADWAYS
3	DRAINAGE AREA MAP AND STORM DRAIN PROFILES
4	GRADING AND SEDIMENT CONTROL PLAN
5	DETAILS
6	PROFILES MAYFIELD AVENUE AND GREEN TREE DR.
7	PROFILES MORNING BREEZE DRIVE, SUNRISE LANE AND FOREVER GREEN COURT
8	SEDIMENT CONTROL NOTES AND DETAILS
9	STREET TREE PLAN

ROADWAY & STORM DRAINS

THOMPSONS PURCHASE

SECTION 4, AREA 2

1ST ELECTION DISTRICT

HOWARD COUNTY, MARYLAND

GENERAL NOTES

- ALL WORK SHALL BE PERFORMED IN ACCORDANCE WITH THE HOWARD COUNTY DESIGN MANUAL, VOLUME IV, STANDARD SPECIFICATIONS AND DETAILS FOR ROAD CONSTRUCTION.
- APPROXIMATE LOCATION OF EXISTING UTILITIES ARE SHOWN. THE CONTRACTOR SHALL TAKE ALL NECESSARY PRECAUTIONS TO PROTECT THE EXISTING UTILITIES AND MAINTAIN UNINTERRUPTED SERVICE. ANY DAMAGE INCURRED DUE TO CONTRACTOR'S OPERATION SHALL BE REPAIRED IMMEDIATELY AT THE CONTRACTOR'S EXPENSE.
- THE CONTRACTOR SHALL TEST PIT EXISTING UTILITIES, WHERE DIRECTED BY THE ENGINEER, A MINIMUM OF TWO WEEKS IN ADVANCE OF CONSTRUCTION OPERATIONS.
- CONTRACTOR TO NOTIFY THE FOLLOWING UTILITIES AT LEAST THREE DAYS BEFORE STARTING WORK SHOWN ON THESE DRAWINGS.

BELL TELEPHONE SYSTEM	393-3649
LONG DISTANCE CABLE DIVISION	393-3553 OR 3554
BALTIMORE GAS AND ELECTRIC	539-8000 EXT. 691
HOWARD COUNTY BUREAU OF UTILITIES	992-2366
HOWARD COUNTY CONSTRUCTION INSPECTION SURVEY DIVISION	992-2417/2418
- ALL INLETS SHALL BE CONSTRUCTED IN ACCORDANCE WITH HOWARD COUNTY STANDARDS.
- ALL STREET CURB RETURNS SHALL HAVE 20.0' RADII UNLESS OTHERWISE NOTED.
- STORM DRAIN TRENCHES WITHIN ROAD RIGHT OF WAY SHALL BE BACKFILLED AND COMPACTED IN ACCORDANCE WITH HOWARD COUNTY ROAD CODE.
- INSTALLATION OF TRAFFIC CONTROL DEVICES, MARKING AND SIGNING SHALL BE IN ACCORDANCE WITH THE MANUAL OF UNIFORM TRAFFIC CONTROL DEVICES 1971 EDITION.
- PIPE SHALL NOT BE INSTALLED BY THE CONTRACTOR UNTIL THE LENGTH CALLED FOR AT EACH STATION HAS BEEN APPROVED BY THE ENGINEER IN THE FIELD.
- DESIGNED TRAFFIC SPEED IN ACCORDANCE WITH THE AMERICAN ASSOCIATION OF STATE HIGHWAY OFFICIAL STANDARDS:
ALL CUL-DE-SAC DESIGNED FOR 30 M.P.H., ALL LOCAL STREETS DESIGNED FOR 30 M.P.H.
- ALL ELEVATIONS SHOWN ARE BASED ON U.S.C. AND G.S. MEAN SEA LEVEL DATUM 1929.
- ALL FILL AREAS WITHIN ROADWAYS AND UNDER STRUCTURES TO BE COMPACTED TO A MINIMUM 95% OF MAXIMUM OBTAINABLE DENSITY DETERMINED BY MARSHALL PROCTOR.
- ALL PIPE ELEVATIONS SHOWN ARE INVERT ELEVATIONS.
- PROFILE STATIONS SHALL BE ADJUSTED AS NECESSARY TO CONFORM TO PLAN DIMENSIONS.
- SUBJECT PROPERTY ZONED R-SC PER 10-3-77 COMPREHENSIVE ZONING PLAN.

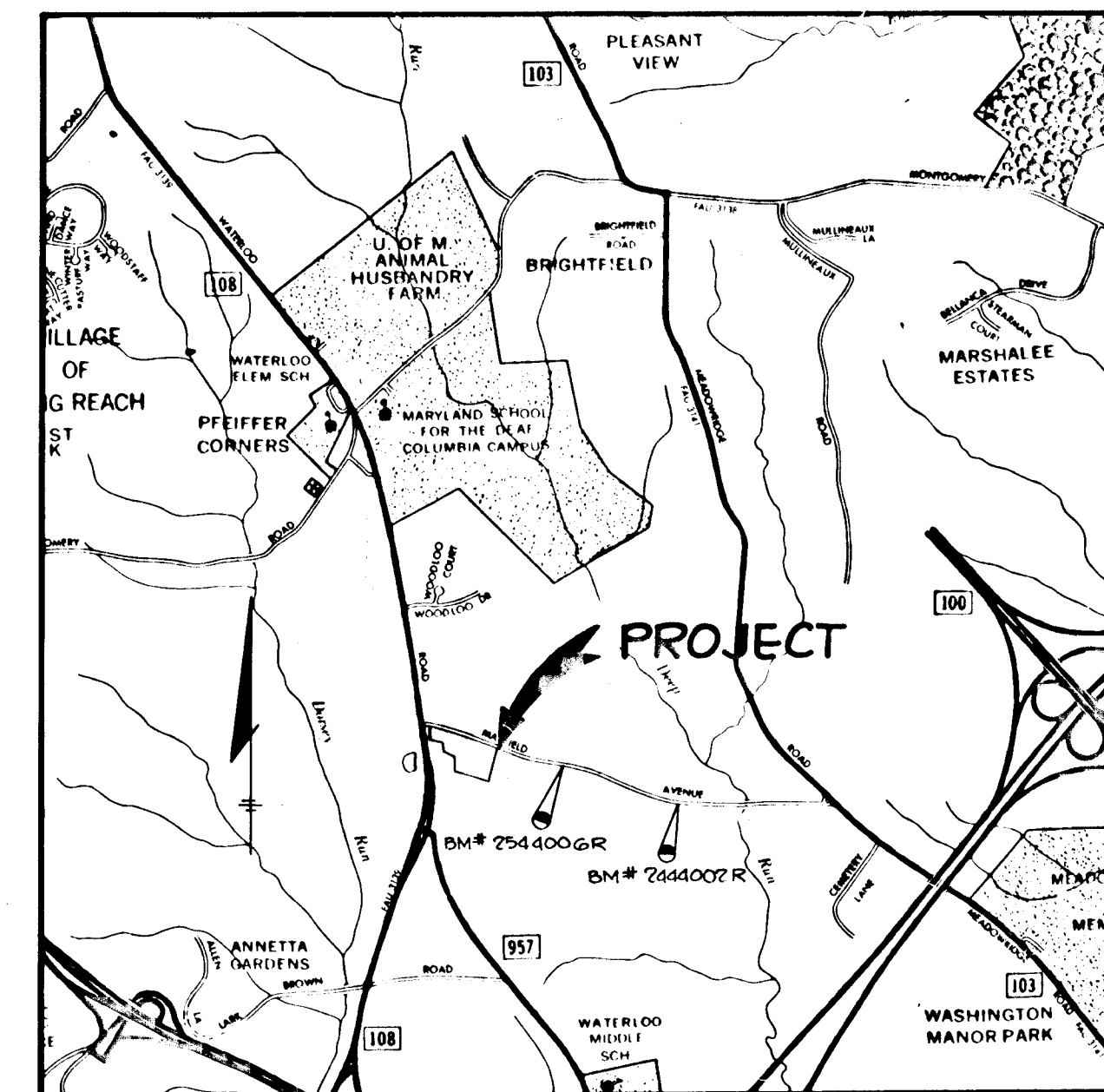

VICINITY MAP
SCALE: 1" = 2000'

BENCH MARKS

BM #1 ELEV. = 302.76 HC BM # 2444007 R ELEV 783474
TOP OF IRON PIPE 0.4 R B 0'3" BELOW SURFACE

BM #2 ELEV. = 316.66 HC BM # 2544006 R ELEV 303923
TOP OF IRON PIPE 0.5 R B 0'2" BELOW SURFACE

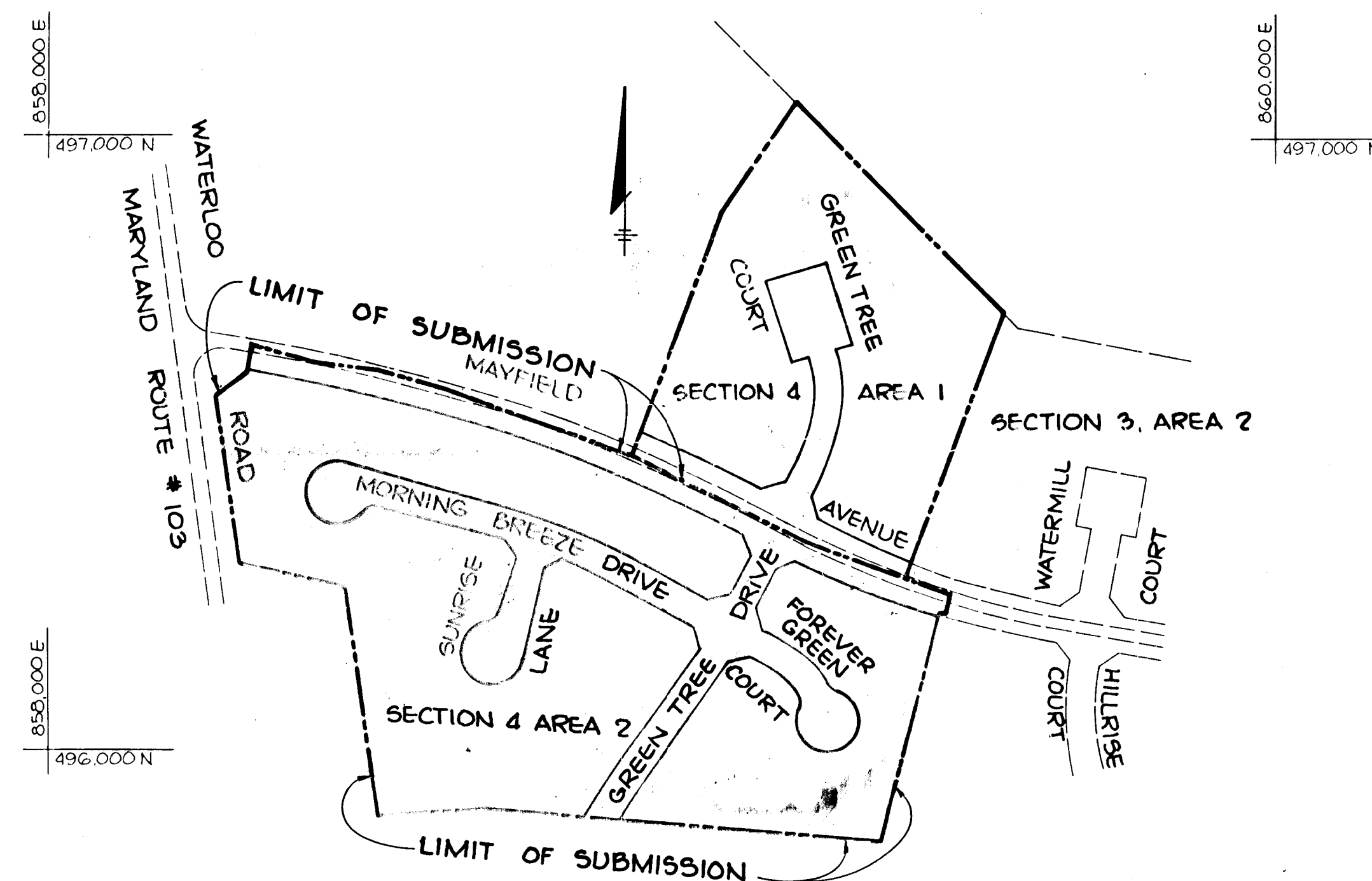

PLAN
SCALE: 1" = 700'

As-BUILT SURVEY 8/5/1987

Charles Schultze
SHANBERGER & LANE
8726 Town & Country Blvd
SUITE 203
ELICOTT CITY, MD 21043

APPROVED: HOWARD COUNTY DEPARTMENT OF PUBLIC WORKS	
<i>Tracy Schulte</i>	7-1-85
CHIEF, BUREAU OF ENGINEERING	DATE
APPROVED: HOWARD COUNTY OFFICE OF PLANNING AND ZONING	
<i>John W. Muschman</i>	6-14-85
CHIEF, DIVISION OF LAND DEVELOPMENT AND ZONING ADMINISTRATION	DATE
NO. DATE REVISION	

TRACY, SCHULTE & ASSOCIATES INC.
planning • architecture • engineering

8450 Baltimore National Pike • Suite 34 • Ellicott City, Maryland 21043 • (301) 465-6105

OWNER	PROJECT
SECURITY DEVELOPMENT CORP 8450 BALTIMORE NATIONAL PIKE ELICOTT CITY, MD 21043	THOMPSONS PURCHASE SECTION 4, AREA 2 LOTS 108 THRU 156
DEVELOPER	LOCATION TAX MAP 37 PARCELS 50, 146, 151, 152 & 459 1ST ELECTION DISTRICT HOWARD COUNTY, MARYLAND
SECURITY DEVELOPMENT CORP 8450 BALTIMORE NATIONAL PIKE ELICOTT CITY, MD 21043	TITLE TITLE SHEET
DES. RJW	DATE NOV. 9, 1984
DRN. KAM	PROJECT NO. 0683 RSD
	SCALE 1" = 200'
	DRAWING 1 OF 9

AS-BUILT SURVEY CERTIFIED BY JAMES KENNETH TRACY
REG. P.E. NO. 9566 ON AUG. 5, 1987

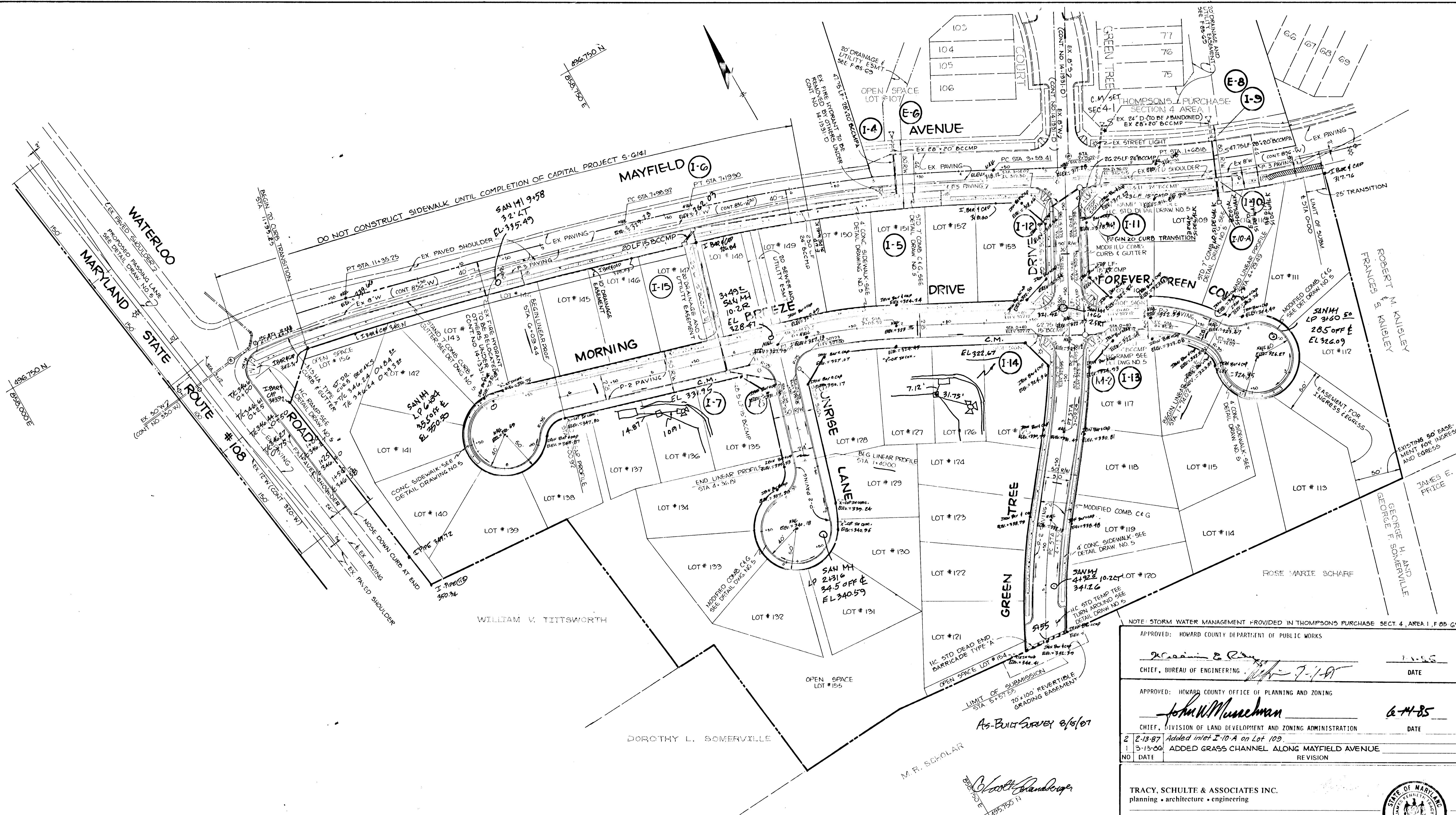

Curve Data	Curve Data	Curve Data	Curve Data	Curve Data	Curve Data
MORNING BREEZE DRIVE STA 2+03.32 TO STA 3+09.23 Δ = 11° 33' 34" R = 525.00' L = 105.92' T = 53.14' D = 10° 54' 49" Chd = N 67° 53' 54" W, 105.74'	MAYFIELD AVENUE STA 3+53.41 TO STA 7+19.90 Δ = 11° 09' 53" R = 1850.00 L = 360.49 T = 180.82 D = 03° 05' 49" Chd = N 67° 42' 03" W, 359.92'	MAYFIELD AVENUE STA 1+58.10 TO STA 11+35.25 Δ = 04° 16' 56" R = 4500.00 L = 336.33 T = 168.24 D = 01° 16' 24" Chd = N 75° 42' 44" W, 336.25'	FOREVER GREEN COURT STA 0+55.41 TO STA 1+14.02 Δ = 30° 56' 39" R = 145.55' L = 78.61 T = 40.29 D = 39° 21' 56" Chd = S 46° 38' 48" E, 77.66'	GREEN TREE DRIVE STA 2+03.10 TO STA 5+51.58 Δ = 11° 24' 43" R = 723.45' L = 144.10 T = 72.29 D = 07° 55' 10" Chd = S 32° 3' 53" W, 143.87'	GREEN TREE DRIVE STA 7+03.10 TO STA 3+09.24 Δ = 09° 53' 21" R = 603.94 L = 104.24 T = 52.25 D = 09° 29' 13" Chd = S 32° 49' 34" W, 104.11'

APPROVED: HOWARD COUNTY DEPARTMENT OF PUBLIC WORKS
 Chief, Bureau of Engineering: *John E. Ryan* DATE: 7-1-85

APPROVED: HOWARD COUNTY OFFICE OF PLANNING AND ZONING
 Chief, Division of Land Development and Zoning Administration: *John W. Muschman* DATE: 6-11-85

2-13-87 Added inlet I-10-A on Lot 109
 3-13-00 ADDED GRASS CHANNEL ALONG MAYFIELD AVENUE
 NO DATE REVISION

TRACY, SCHULTE & ASSOCIATES INC.
 planning • architecture • engineering
 8450 Baltimore National Pike • Suite 34 • Ellicott City, Maryland 21043 • (301) 465-6105

STATE OF MARYLAND
 PROFESSIONAL ENGINEER
James E. Price

OWNER: SECURITY DEVELOPMENT CORP
 8450 BALTIMORE NATIONAL PIKE
 ELLICOTT CITY, MD 21043

PROJECT: THOMPSON'S PURCHASE
 SECTION 4, AREA 2 LOTS 103 THRU 156
 LOCATION: TAX MAP NO 37
 PARCELS 50, 146, 151, 152, 145D
 1ST ELECTION DISTRICT
 HOWARD COUNTY, MARYLAND

DEVELOPER: SECURITY DEVELOPMENT CORP
 8450 BALTIMORE NATIONAL PIKE
 ELLICOTT CITY, MD 21043

TITLE PLAN OF MAYFIELD AVENUE, FOREVER GREEN COURT, MORNING BREEZE DRIVE, GREEN TREE DRIVE & SUNRISE LANE

DATE NOV 9, 1984 PROJECT NO. 0683 R5D
 DES: RJW DRN: KAM SCALE 1" = 50' DRAWING 2 OF 3

AS-BUILT SURVEY CERTIFIED BY JAMES KENNETH TRACY
 REG. P.E. 10,9566 ON AUG. 5, 1987

AS-BUILT SURVEY 8/6/87

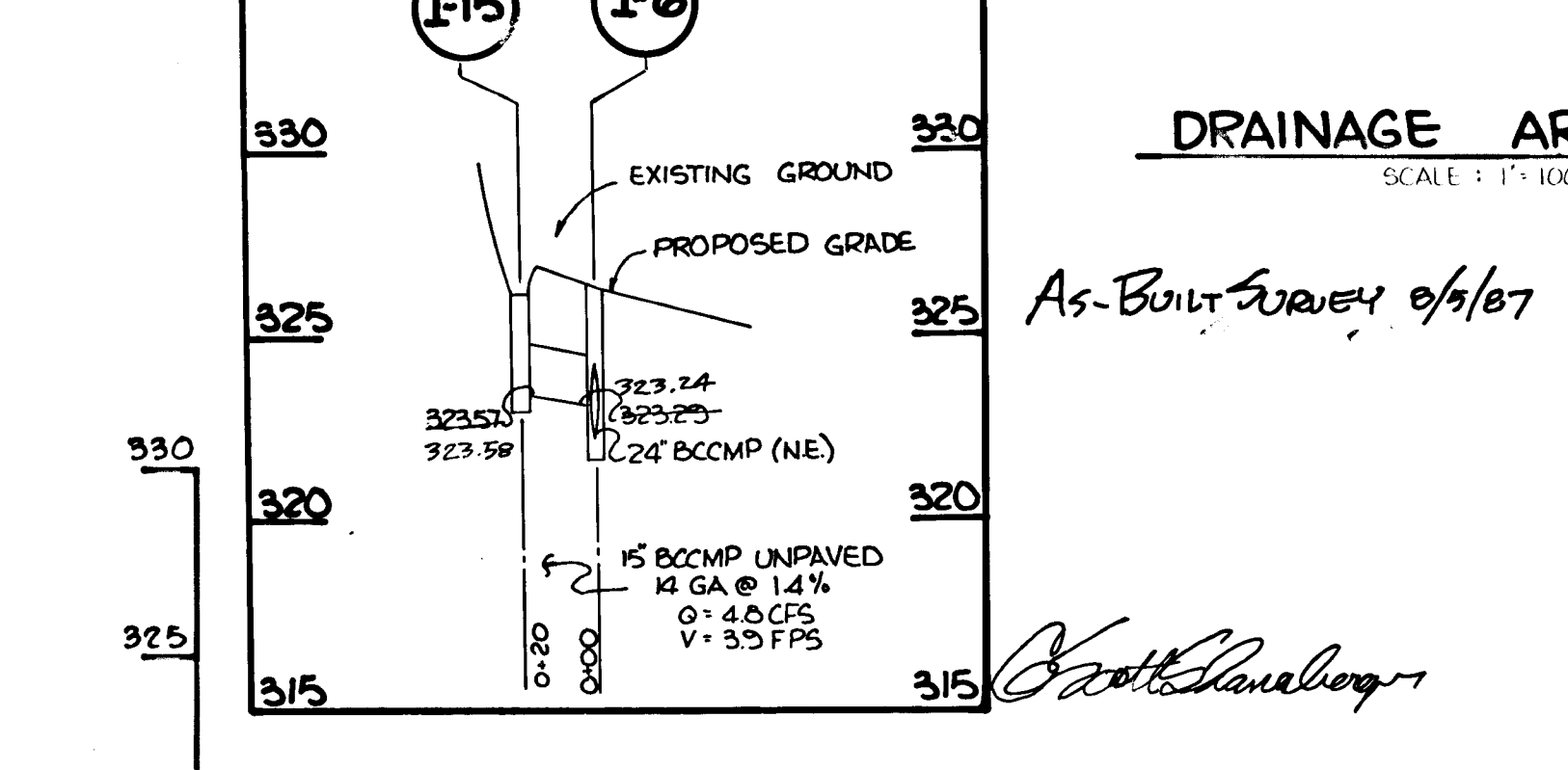
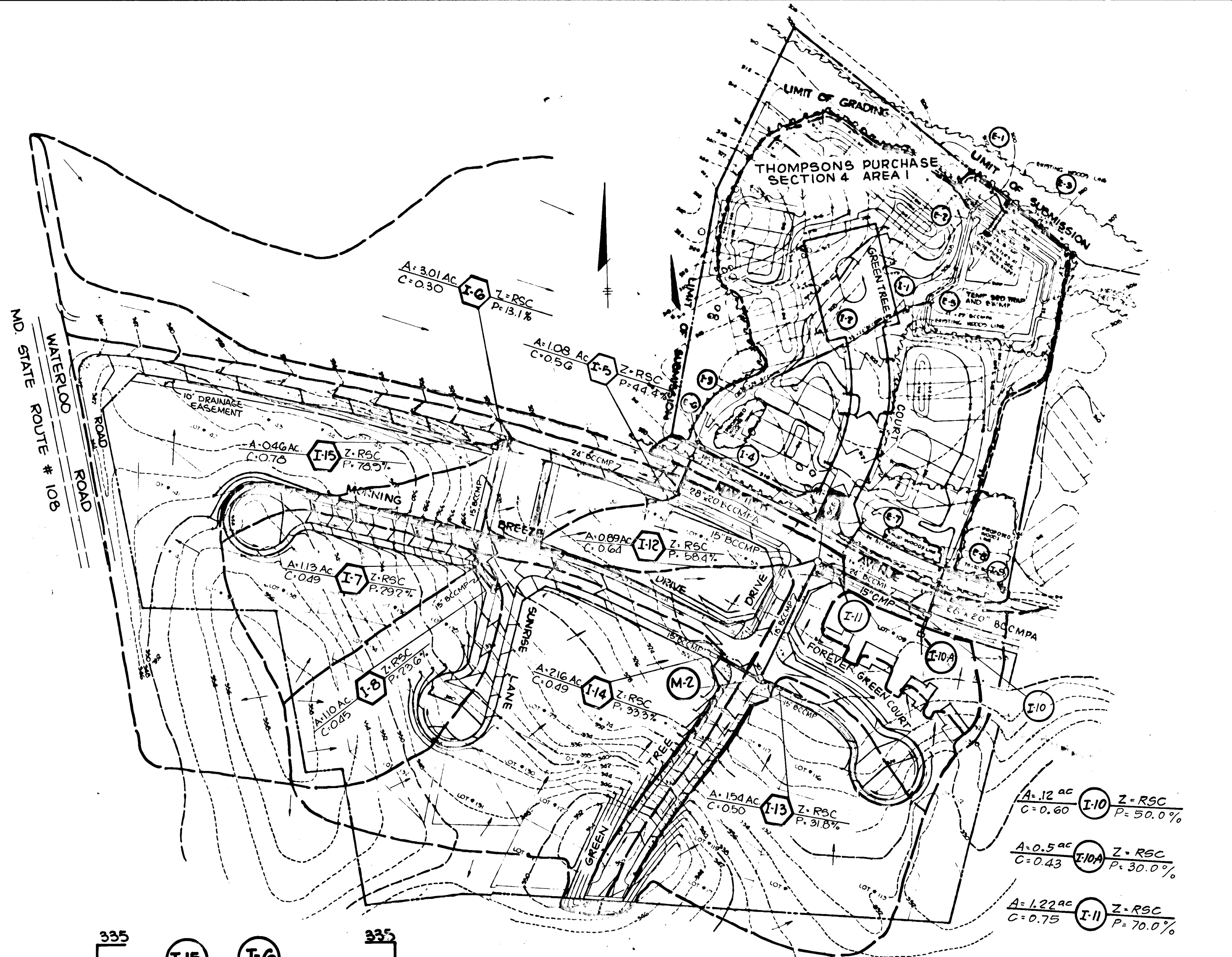
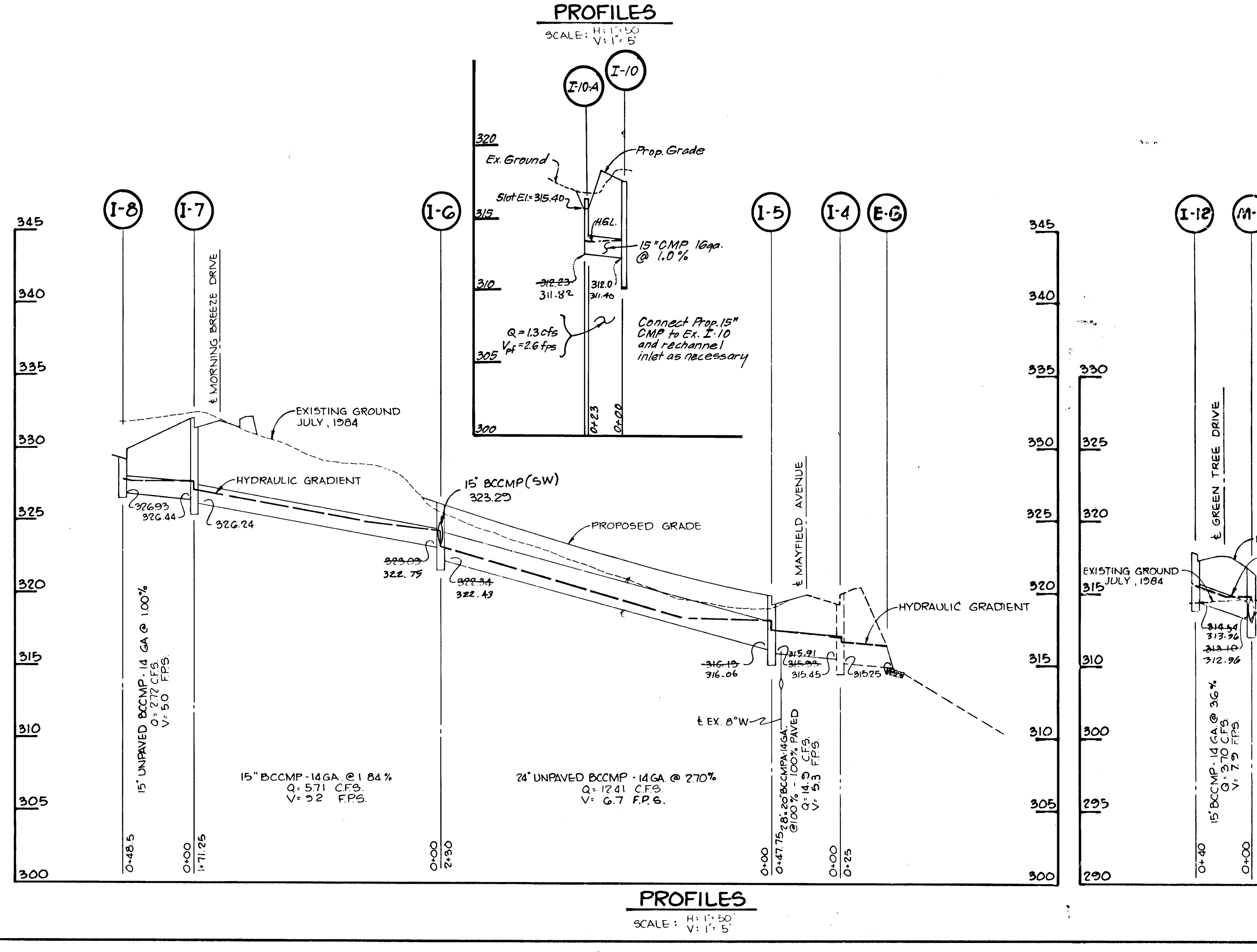
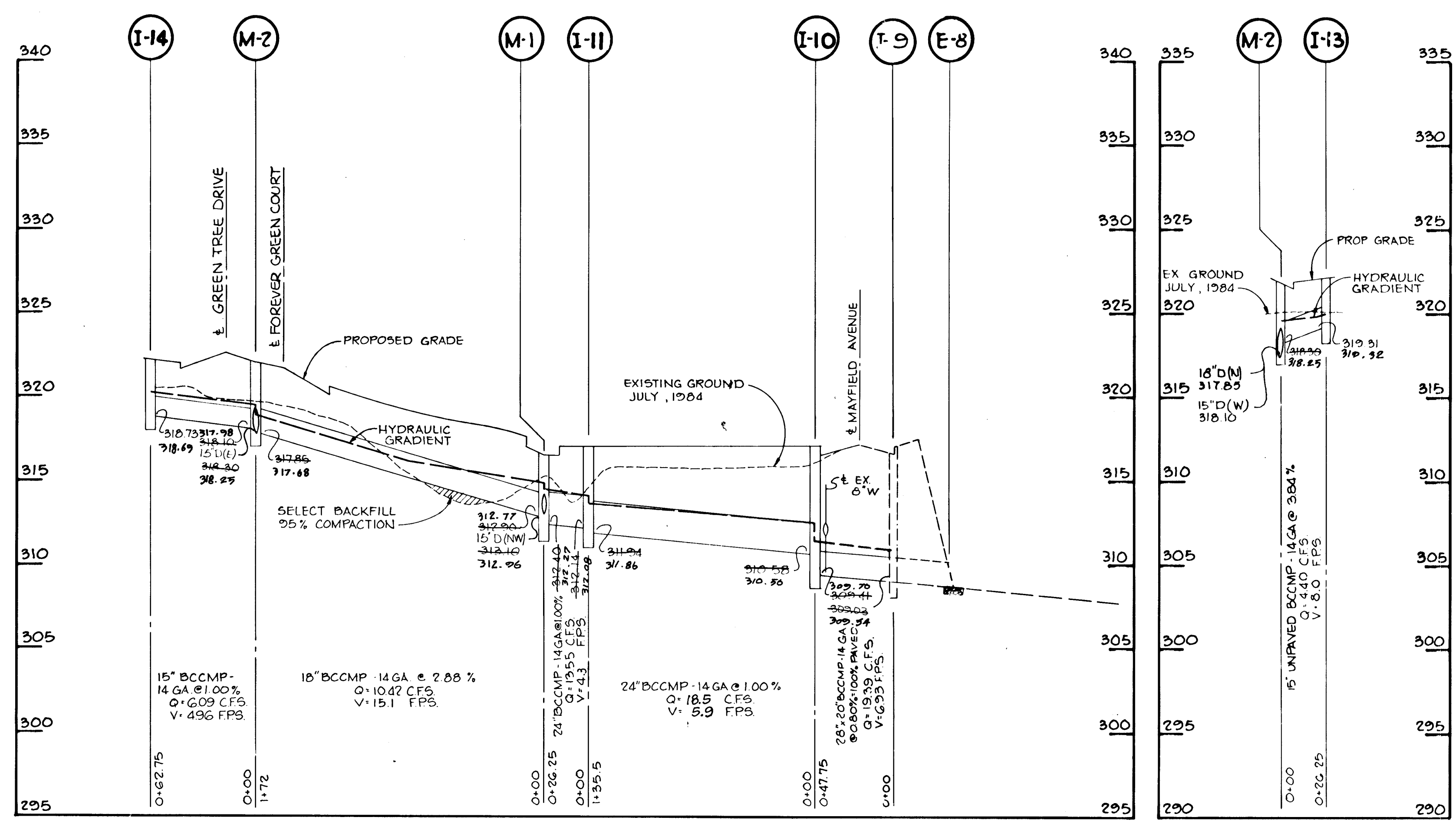

STORM DRAIN STRUCTURE SCHEDULE

NO.	TYPE	LOCATION	INV IN	INV OUT	TOP ELEV	REMARKS
I-10A	D	See Plan	312.23	312.23	312.23	H.C. STD S.D. 4.11
M-1	STD MH	16.7' LT OF E STA 0+24 GREEN TREE DRIVE	312.22	312.40	321.44	H.C. STD G 5.01
M-2	STD MH	16.7' LT OF E STA 1+96 GREEN TREE DRIVE	312.22	312.86	323.46	H.C. STD G 5.01
I-15	S	40' RT OF STA 7+25.00 MAYFIELD AVENUE	312.25	312.25	312.25	H.C. STD S.D. 4.22
I-5	A-10	22' LT OF E STA 4+74.97 MAYFIELD AVENUE	312.43	312.58	322.41	H.C. STD S.D. 4.02
I-6	A-10 W/ DEFLECTORS	22' RT OF E STA 7+19.90 MAYFIELD AVENUE	312.43	312.43	322.43	H.C. STD S.D. 4.02
I-7	A-5 W/ DEFLECTORS	14' RT OF E STA 4+10 MORNING BREEZE DRIVE	312.43	312.43	322.43	H.C. STD S.D. 4.01
I-8	A-5 W/ DEFLECTORS	12' RT OF E STA 0+39 SUNRISE LANE	312.43	312.43	322.43	H.C. STD S.D. 4.01
I-10	A-5	22' LT OF E STA 1+00 MAYFIELD AVENUE	312.43	312.43	322.43	H.C. STD S.D. 4.01
I-11	A-5	22' LT OF E STA 2+36.02 MAYFIELD AVENUE	312.43	312.43	322.43	H.C. STD S.D. 4.01
I-12	A-10	15' RT OF E STA 0+47 GREEN TREE DRIVE	312.43	312.43	322.43	H.C. STD S.D. 4.02
I-13	A-10	14' RT OF E STA 0+40 FOREVER GREEN COURT	312.43	312.43	322.43	H.C. STD S.D. 4.02
I-14	A-10	14' LT OF E STA 0+40 MORNING BREEZE DRIVE	312.43	312.43	322.43	H.C. STD S.D. 4.02

NOTE: ALL STORM DRAIN PIPE BEDDING SHALL BE CLASS C UNLESS OTHERWISE NOTED.
ALL STORM DRAIN PIPE SHALL BE 100% PAVED UNLESS OTHERWISE NOTED.

DRAINAGE AREA MAP
SCALE: 1" = 100'

AS BUILT SURVEY CERTIFIED BY JAMES KENNETH TRACY P.E. REG.-P.E. NO. 9566 ON AUG. 5, 1987

NOTE: STORM WATER MANAGEMENT PROVIDED IN THOMPSON'S PURCHASE SECTION 4, AREA 1, F-85-G9

APPROVED: HOWARD COUNTY DEPARTMENT OF PUBLIC WORKS
James K. Tracy 7-1-85
 CHIEF, BUREAU OF ENGINEERING DATE

APPROVED: HOWARD COUNTY DEPARTMENT OF PLANNING AND ZONING
John W. Murchman 6-14-85
 CHIEF, DIVISION OF LAND DEVELOPMENT AND ZONING ADMINISTRATION DATE

2-13-87 Added inlet I-10-A to Drainage Map & also profile.
 1-13-86 ADDED GRASS CHANNEL ALONG MAYFIELD AVENUE REVISION

TRACY, SCHULTE & ASSOCIATES INC.
 planning • architecture • engineering
 8450 Baltimore National Pike • Suite 34 • Ellicott City, Maryland 21043 • (301) 465-6105

OWNER: SECURITY DEVELOPMENT CORP
 8450 BALTIMORE NATIONAL PIKE
 ELLICOTT CITY, MD 21043

PROJECT: THOMPSON'S PURCHASE
 SECTION 4, AREA 2 LOTS 108 THRU 156

LOCATION: TAX MAP NO. 37
 PARCELS 50, 146, 151, 152 & 459
 1ST ELECTION DISTRICT
 HOWARD COUNTY, MARYLAND

TITLE: DRAINAGE AREA MAP AND STORM DRAIN PROFILES

DATE NOV. 9, 1984 PROJECT NO 0683 RSD
 DES RJW DRN KAM SCALE AS SHOWN DRAWING 3 OF 9

STATE OF MARYLAND
 JAMES K. TRACY
 PROFESSIONAL ENGINEER

AS BUILT 3/4/88 F-85-72 JUN 5, 1985

SITE DATA
 DISTURBED AREA 4.93 Ac.
 IMPERVIOUS AREA 2.05 Ac.
 AREA TO BE REVEGETATED 2.88 Ac.
 TOTAL AREA OF SITE 13.47 Ac.

CUT/FILL ANALYSIS
 PROPOSED CUT 8621 CY
 PROPOSED FILL 8094 CY

NOTE: GRADING ALONG MAYFIELD AVENUE TO BE DONE AND TEMPORARILY STABILIZED WITH SEED AND MULCH ON THE SAME DAY GRADED

LIMIT OF GRADING

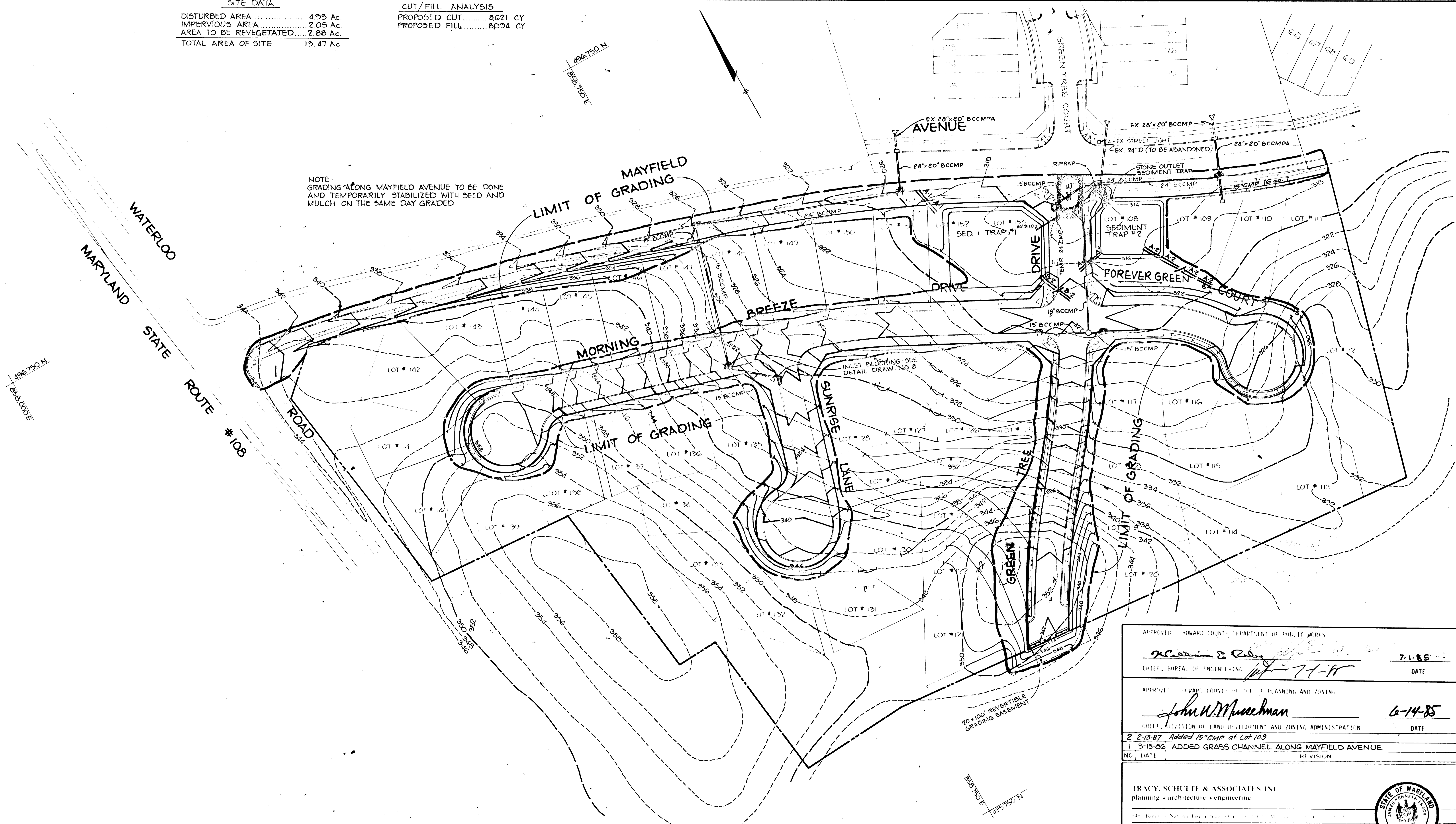

SEDIMENT TRAP NO. 1

DRAINAGE AREA	10.31 Ac.
DISTURBED AREA	3.35 Ac.
STORAGE VOLUME REQUIRED	720 CY.
STORAGE VOLUME PROVIDED	698 CY.
CREST ELEVATION	317.0
BOTTOM ELEVATION	314.0
CLEANOUT ELEVATION	316.0
TRAP DIMENSIONS	120' x 100' x 3.0'

SEDIMENT TRAP NO. 2

DRAINAGE AREA	2.89 Ac.
DISTURBED AREA	1.04 Ac.
STORAGE VOLUME REQUIRED	203 CY.
STORAGE VOLUME PROVIDED	260 CY.
CREST ELEVATION	315.50
BOTTOM ELEVATION	312.0
CLEANOUT ELEVATION	313.78
TRAP DIMENSIONS	90' x 75' x 3.5'

THIS DEVELOPMENT IS APPROVED FOR SOIL EROSION AND SEDIMENT CONTROL BY THE HOWARD SOIL CONSERVATION DISTRICT

BY THE DEVELOPER: Stephen L. Hill DATE 4/14/85
HOWARD S.C.D.

"I/WE CERTIFY THAT ALL DEVELOPMENT AND CONSTRUCTION WILL BE DONE ACCORDING TO THIS PLAN, AND THAT ANY RESPONSIBLE PERSONNEL INVOLVED IN THE CONSTRUCTION PROJECT WILL HAVE A CERTIFICATE OF ATTENDANCE AT A DEPARTMENT OF NATURAL RESOURCES APPROVED TRAINING PROGRAM FOR THE CONTROL OF SEDIMENT AND EROSION BEFORE BEGINNING THE PROJECT."

DEVELOPER: James R. Moxley Jr. DATE 11-5-84
JAMES R. MOXLEY

REVIEWED FOR HOWARD S.C.D.

AND MEETS TECHNICAL REQUIREMENTS
James M. Hehn DATE 6/14/85
U.S. SOIL CONSERVATION SERVICE

BY THE ENGINEER:
 "I CERTIFY THAT THIS PLAN FOR EROSION AND SEDIMENT CONTROL REPRESENTS A PRACTICAL AND WORKABLE PLAN BASED ON MY PERSONAL KNOWLEDGE OF THE SITE CONDITIONS AND THAT IT WAS PREPARED IN ACCORDANCE WITH THE REQUIREMENTS OF THE HOWARD SOIL CONSERVATION DISTRICT."

ENGINEER: James K. Tracy DATE 11-5-84
JAMES K. TRACY, P.E.

APPROVED: HOWARD COUNTY DEPARTMENT OF PUBLIC WORKS
William S. Ryan DATE 7-1-85
CHIEF, BUREAU OF ENGINEERING

APPROVED: HOWARD COUNTY DEPARTMENT OF PLANNING AND ZONING
John W. Muechman DATE 6-14-85
CHIEF, DIVISION OF LAND DEVELOPMENT AND ZONING ADMINISTRATION

2-2-87 Added 15" CMP at Lot 109.
 1-3-88 ADDED GRASS CHANNEL ALONG MAYFIELD AVENUE
NO. DATE REVISION

TRACY, SCHULTE & ASSOCIATES INC.
 planning • architecture • engineering
 5450 Reisterstown Pike • Suite 314 • Reisterstown, Md. 21116
 STATE OF MARYLAND REGISTERED PROFESSIONAL ENGINEER
James K. Tracy

OWNER: SECURITY DEVELOPMENT CORP
 8450 BALTIMORE NATIONAL PIKE
 ELLICOTT CITY, MD 21043

PROJECT: **THOMPSONS PURCHASE**
 SECTION 4, AREA 2 LOTS 108 THRU 156
 LOCATION: TAX MAP NO 37
 PARCEL 50, 146, 151, 152 & 459
 1ST ELECTION DISTRICT
 HOWARD COUNTY, MARYLAND

DEVELOPER: SECURITY DEVELOPMENT CORP
 8450 BALTIMORE NATIONAL PIKE
 ELLICOTT CITY, MD 21043

TITLE: **GRADING AND SEDIMENT CONTROL PLAN**

DATE NOV. 3, 1984 PROJECT NO 0683 RSD
 DES: RJW DRN: KAM SCALE 1" = 50' DRAWING 4 OF 9
 3/4/88 F-85-72 JUNE 5, 1985

AS-BUILT

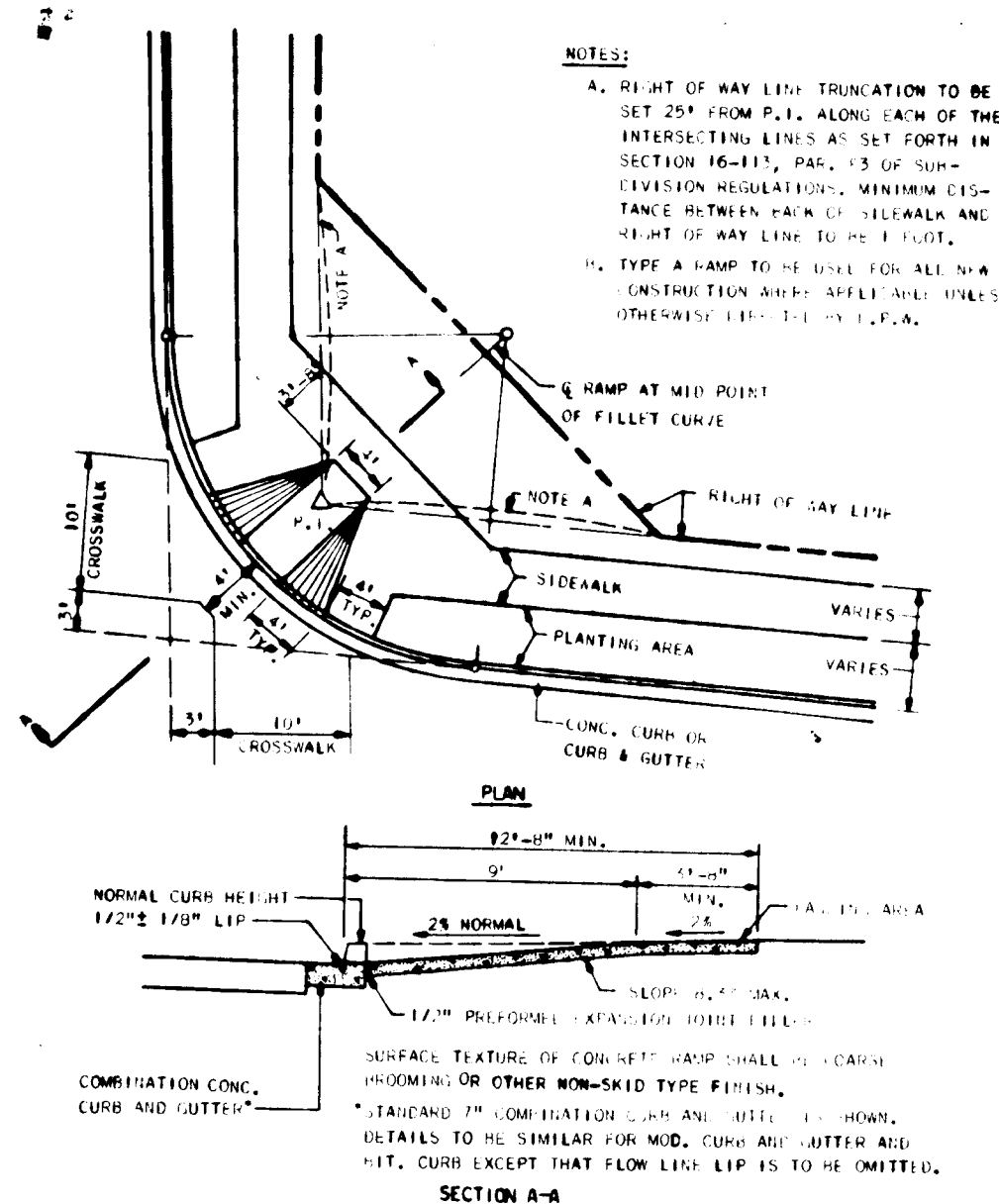

SIDEWALK RAMP
NO SCALE

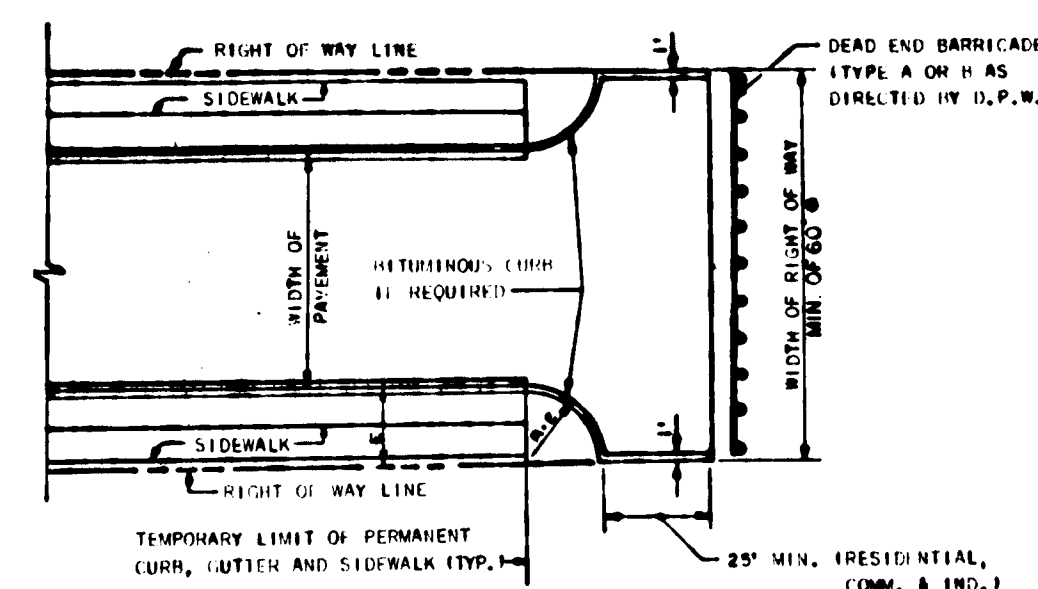

TEE TURN AROUND DETAIL
NO SCALE

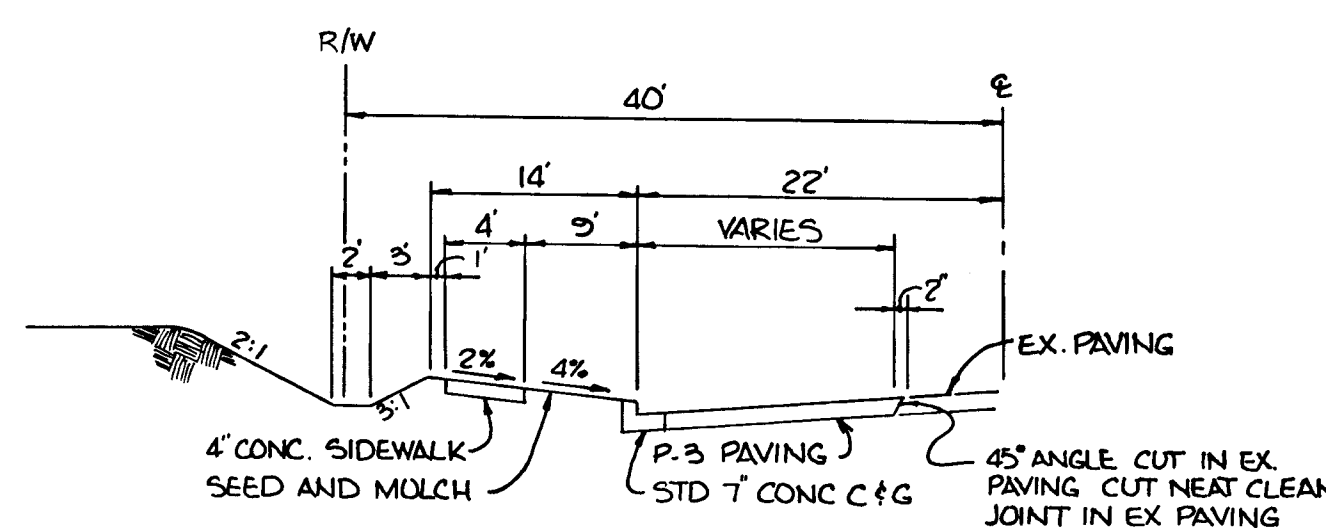

TYPICAL SECTION
NO SCALE

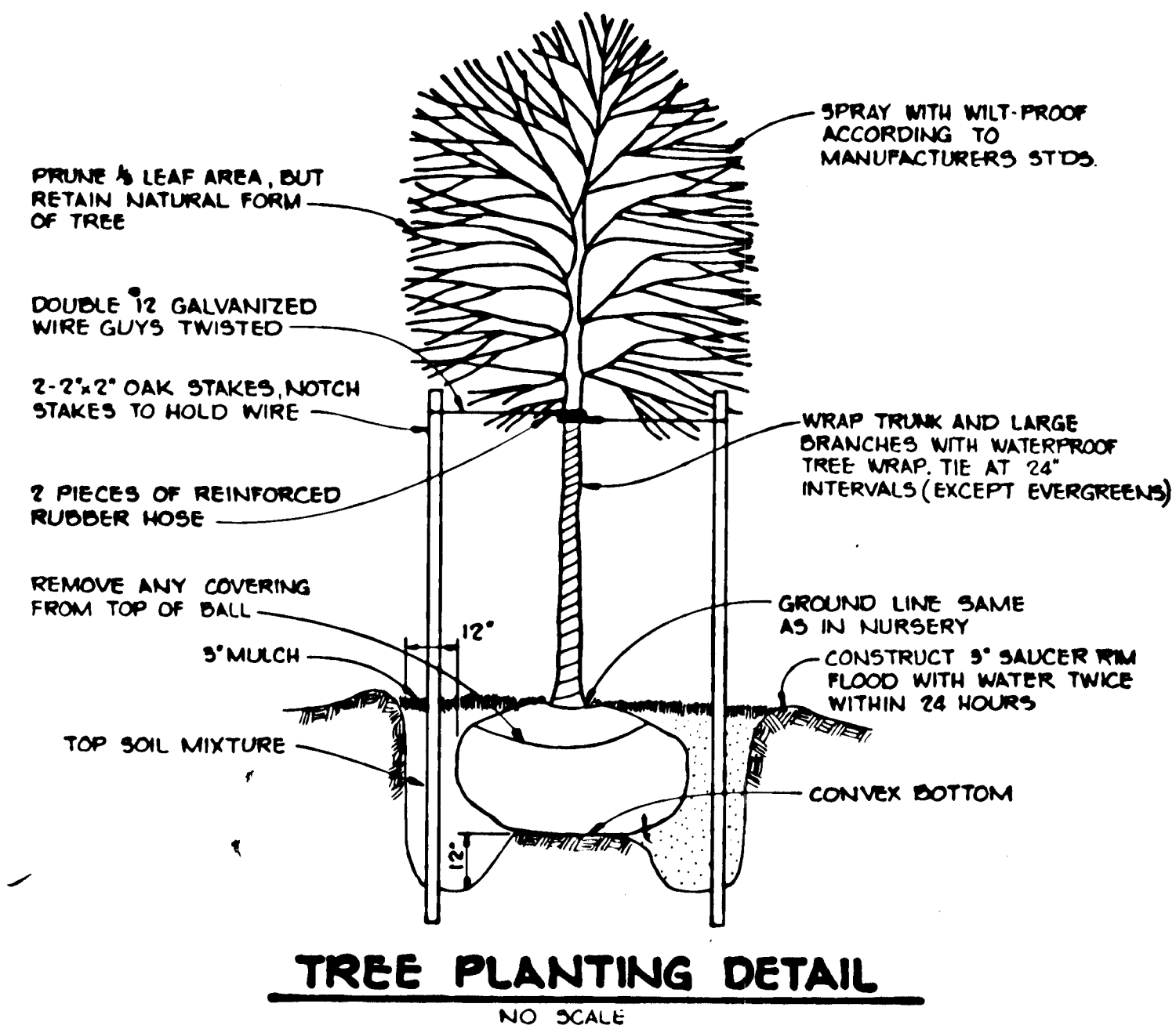

TREE PLANTING DETAIL
NO SCALE

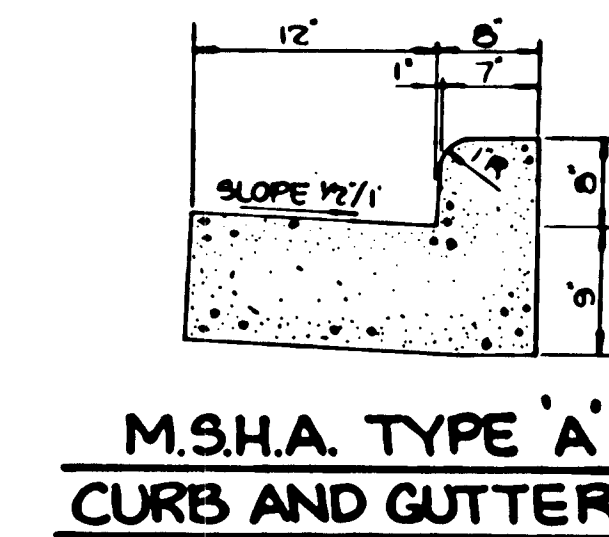

M.S.H.A. TYPE 'A' CURB AND GUTTER
NO SCALE

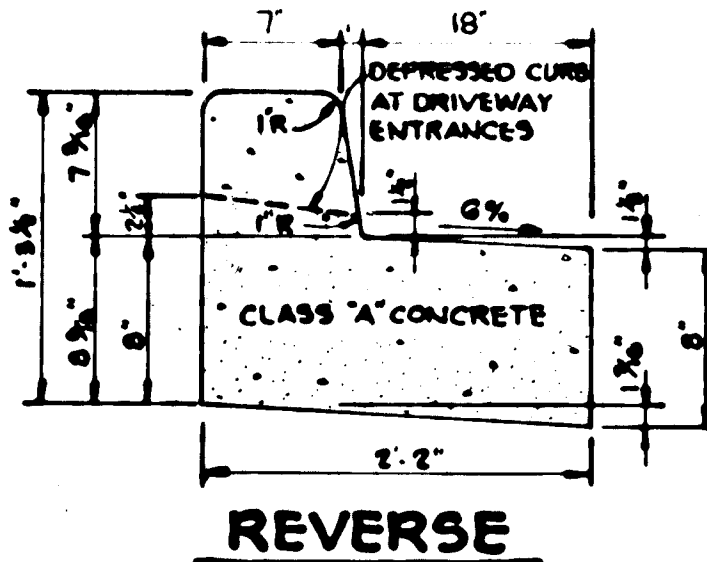

REVERSE
NO SCALE

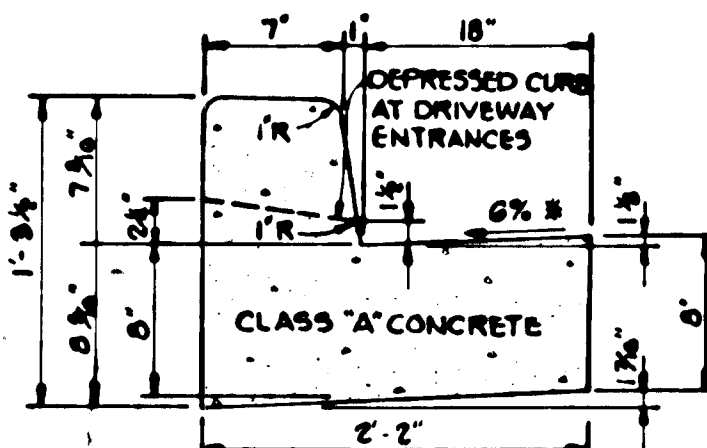

STANDARD 7" COMBINATION CURB AND GUTTER
NO SCALE

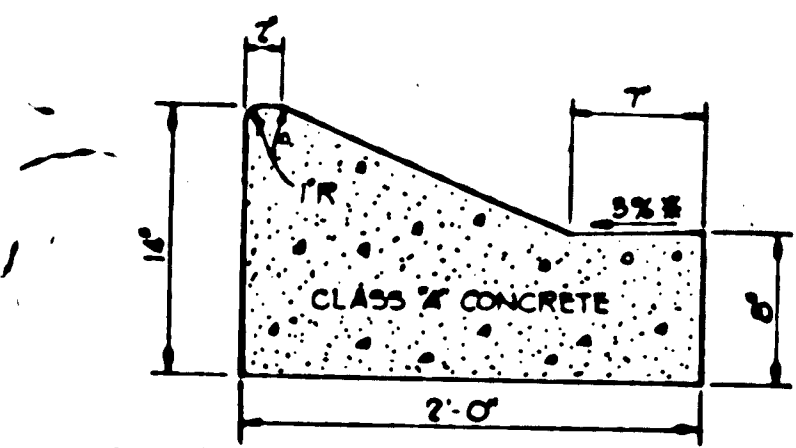

MODIFIED COMBINATION CURB AND GUTTER
NO SCALE

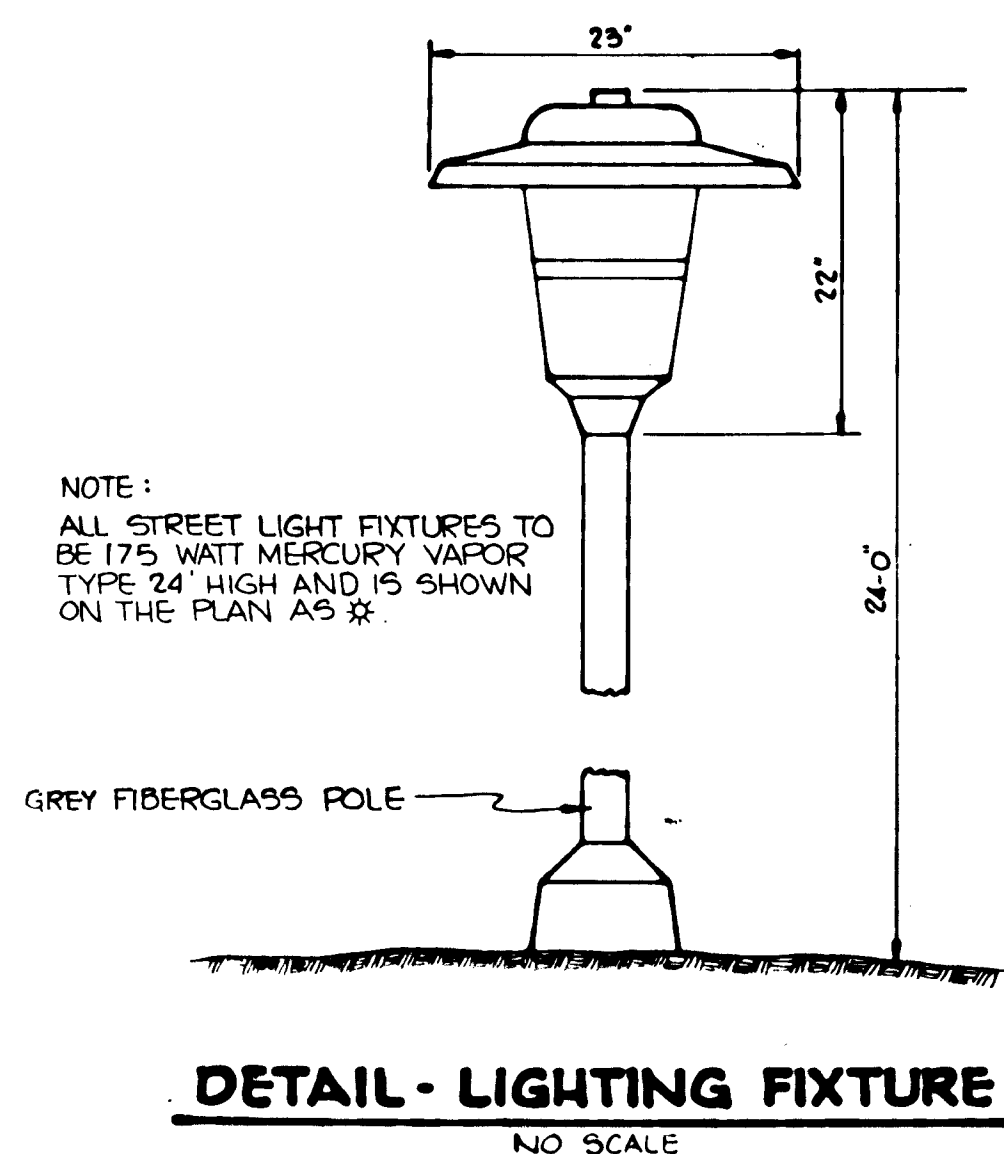

DETAIL - LIGHTING FIXTURE
NO SCALE

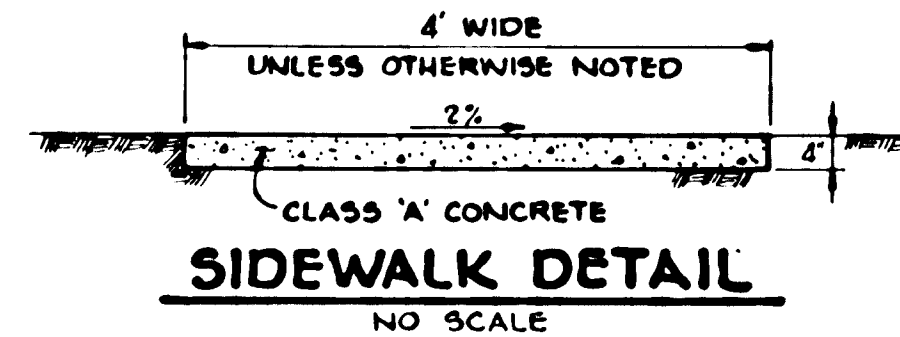

SIDEWALK DETAIL
NO SCALE

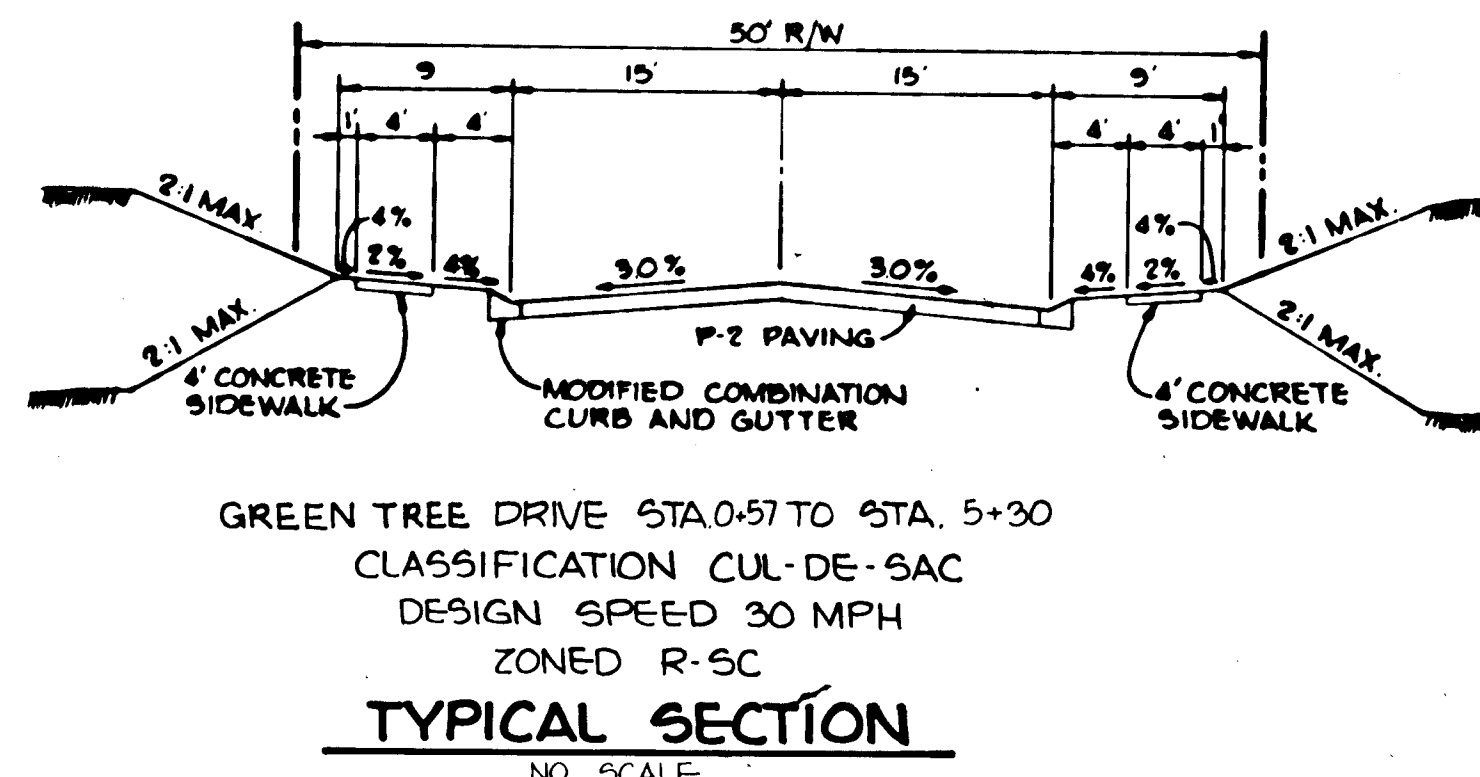

TYPICAL SECTION
NO SCALE

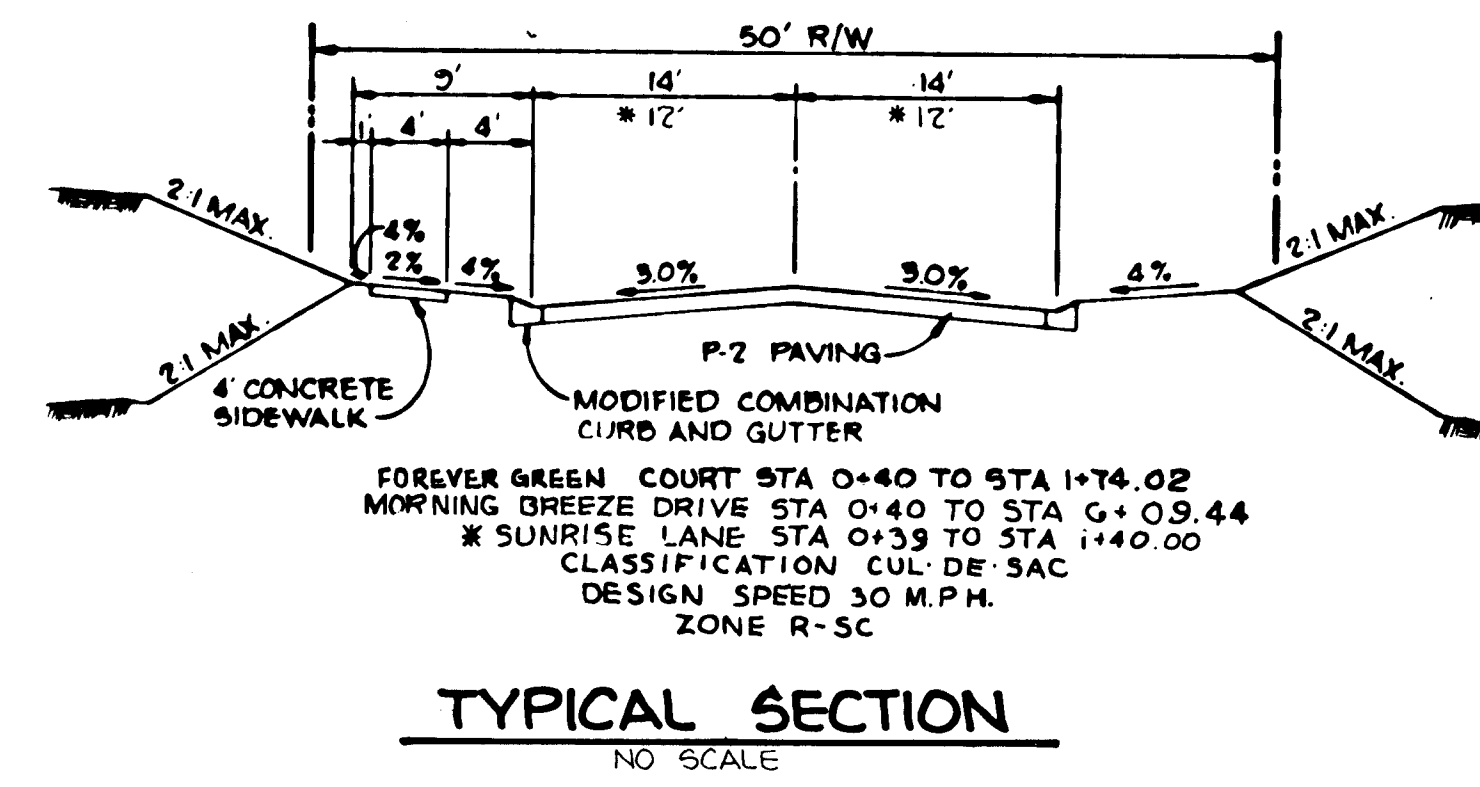

TYPICAL SECTION
NO SCALE

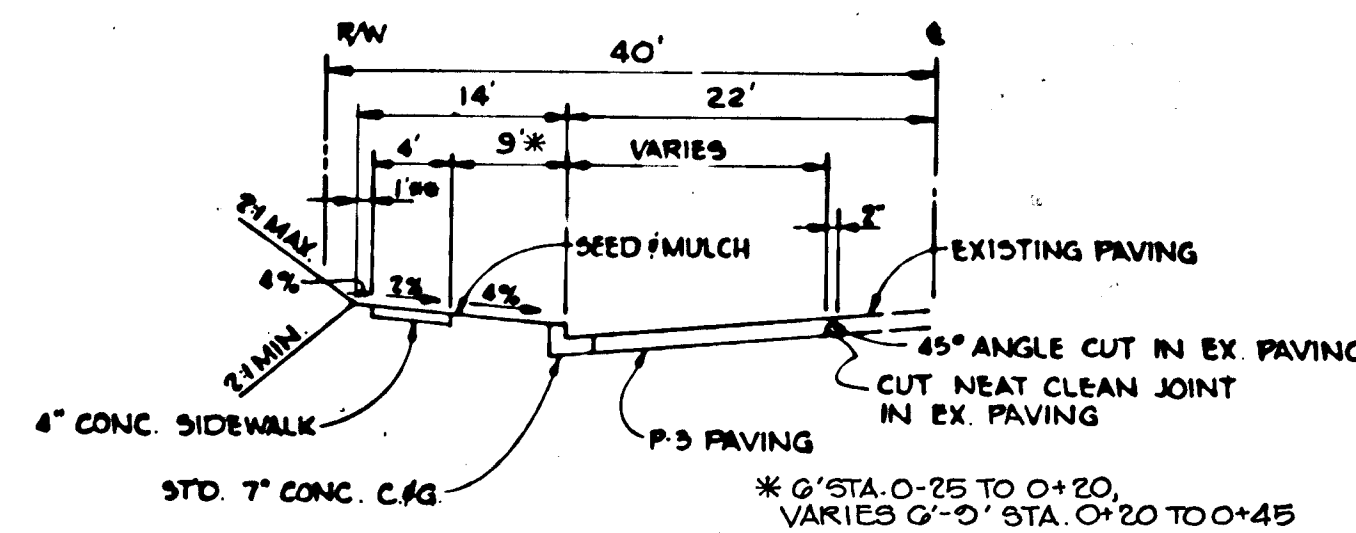

TYPICAL SECTION
NO SCALE

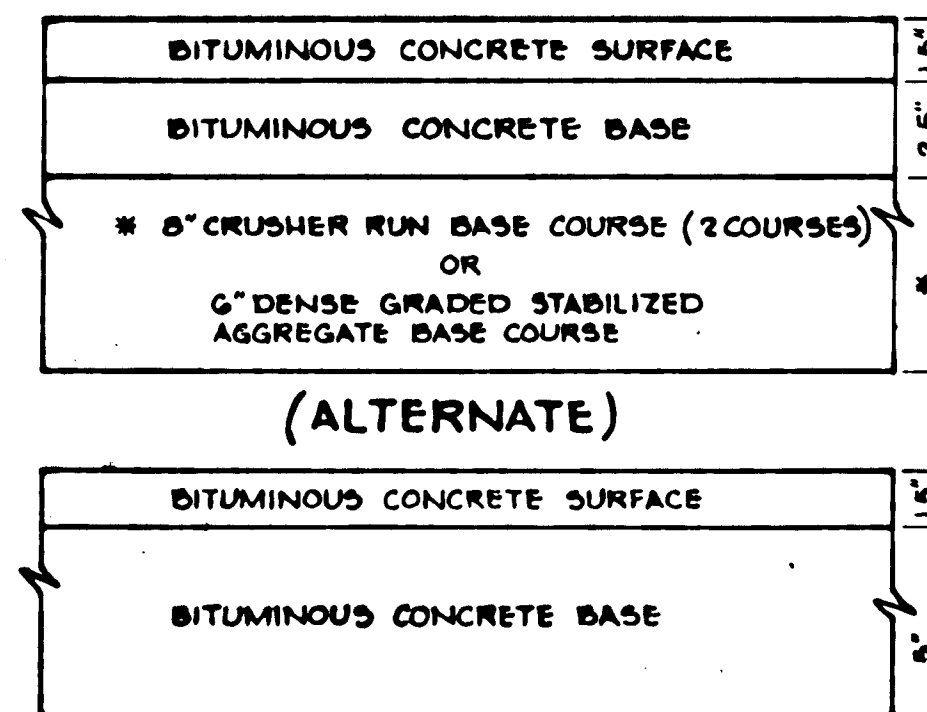

HOWARD COUNTY DESIGN MANUAL VOLUME IV
STANDARD SPECIFICATIONS AND DETAILS FOR
CONSTRUCTION (DRAWING R-2.01)

6" PAVING, P-2
GREEN TREE DRIVE
MORNING BREEZE DRIVE
SUNRISE LANE
FOREVER GREEN COURT

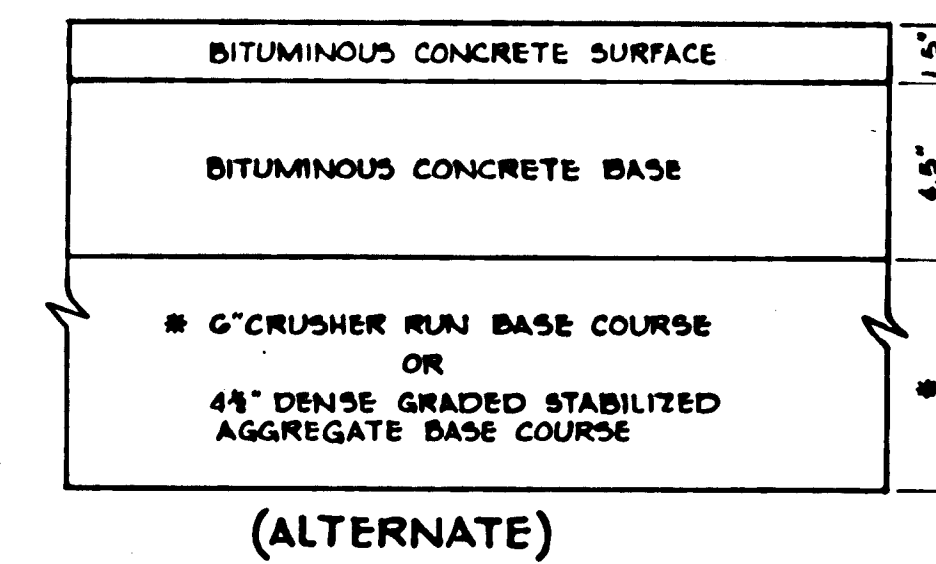

(ALTERNATE)

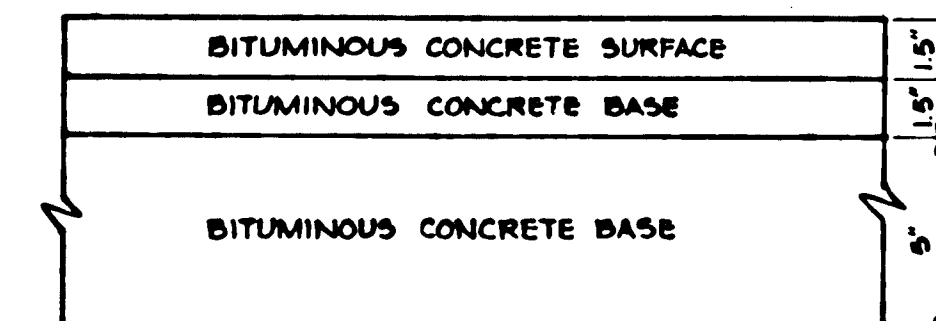

HOWARD COUNTY DESIGN MANUAL VOLUME IV
STANDARD SPECIFICATIONS AND DETAILS FOR
CONSTRUCTION (DRAWING R-2.01)

8" PAVING, P-3
MAYFIELD AVENUE

TYPICAL PAVING SECTIONS
NO SCALE

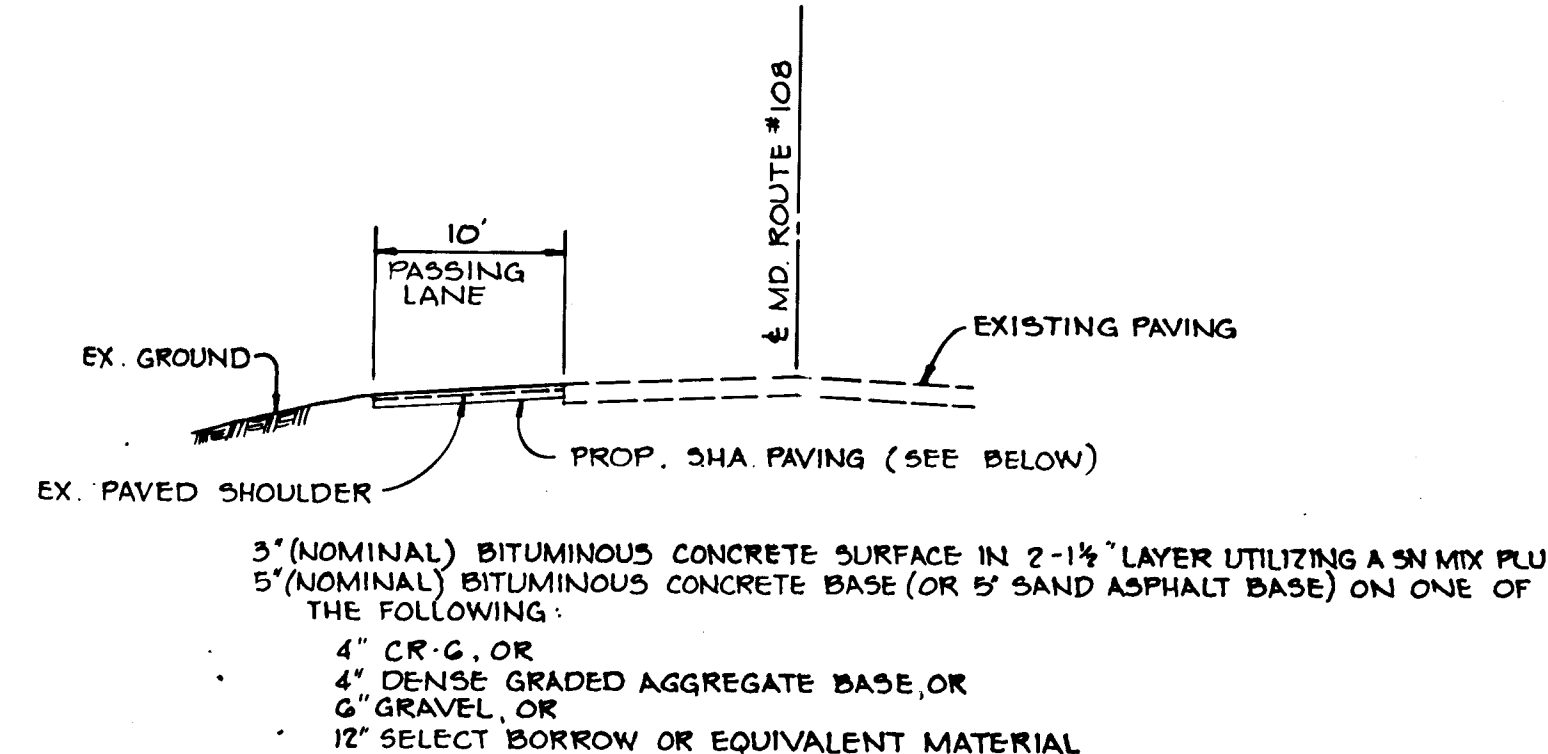

TYPICAL SECTION-MD. ROUTE #108
NO SCALE

APPROVED: HOWARD COUNTY DEPARTMENT OF PUBLIC WORKS	
CHIEF, BUREAU OF ENGINEERING	7-1-85
APPROVED: HOWARD COUNTY OFFICE OF PLANNING AND ZONING	
CHIEF, DIVISION OF LAND DEVELOPMENT AND ZONING ADMINISTRATION	6-14-85
NO. DATE	REVISION
1 3-13-86	ADDED GRASS CHANNEL ALONG MAYFIELD AVENUE

TRACY, SCHULTE & ASSOCIATES INC.
planning • architecture • engineering
8450 Baltimore National Pike • Suite 34 • Ellicott City, Maryland 21043 • (301) 465-6105

OWNER SECURITY DEVELOPMENT CORP 8450 BALTIMORE NATIONAL PIKE ELLICOTT CITY, MD 21043	PROJECT THOMPSON'S PURCHASE SECTION 4, AREA 2 LOTS 108 THRU 156
DEVELOPER SECURITY DEVELOPMENT CORP 8450 BALTIMORE NATIONAL PIKE ELLICOTT CITY, MD 21043	LOCATION - TAX MAP 57 PARCELS 50, 146, 151, 152 & 59 1ST ELECTION DISTRICT HOWARD COUNTY, MARYLAND
TITLE DETAILS	
DATE NOV. 9, 1984	PROJECT NO. 0683 R5D
DES. R.J.W.	DRN. K.A.M.
SCALE AS SHOWN	DRAWING 5 OF 9

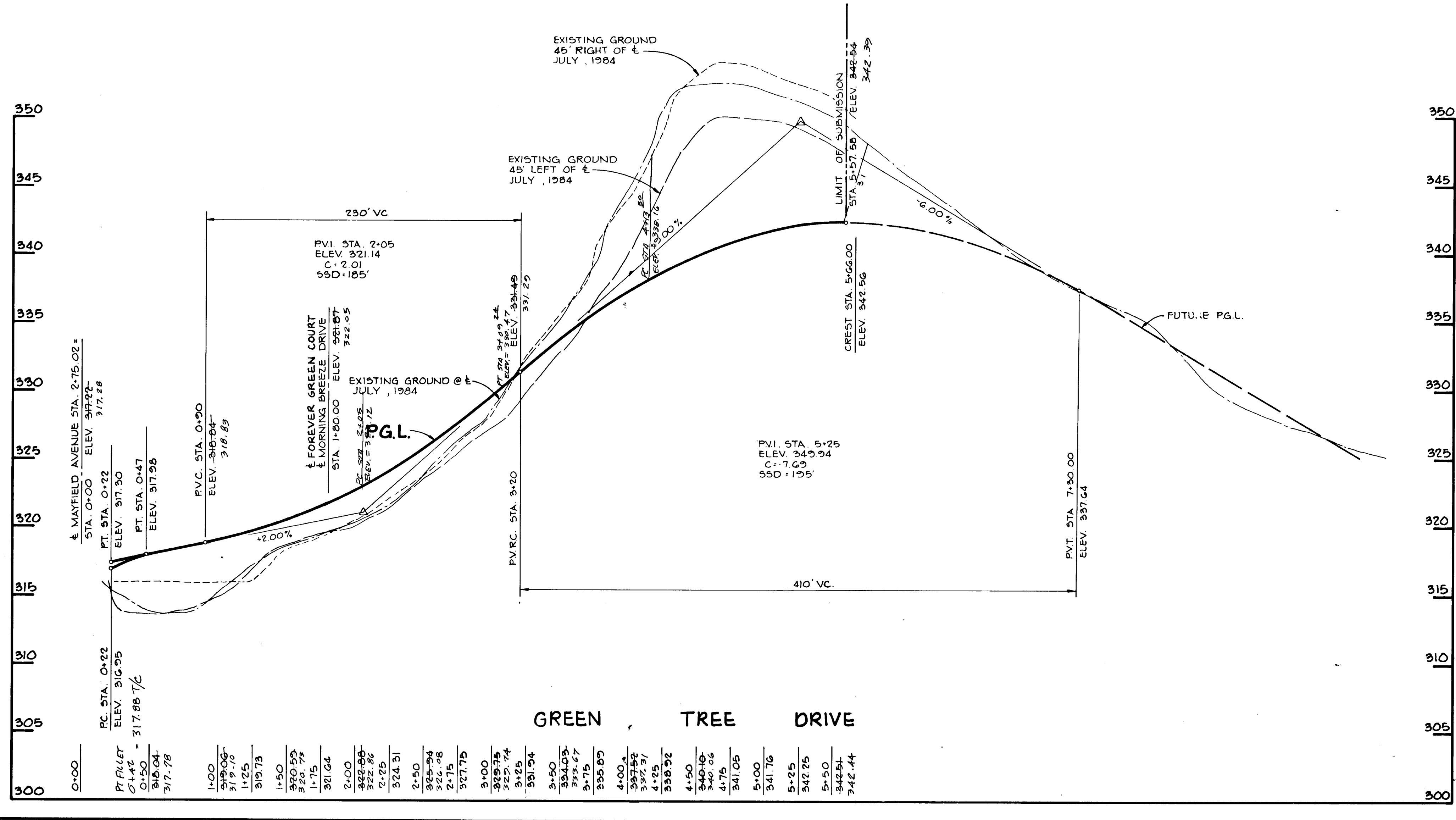
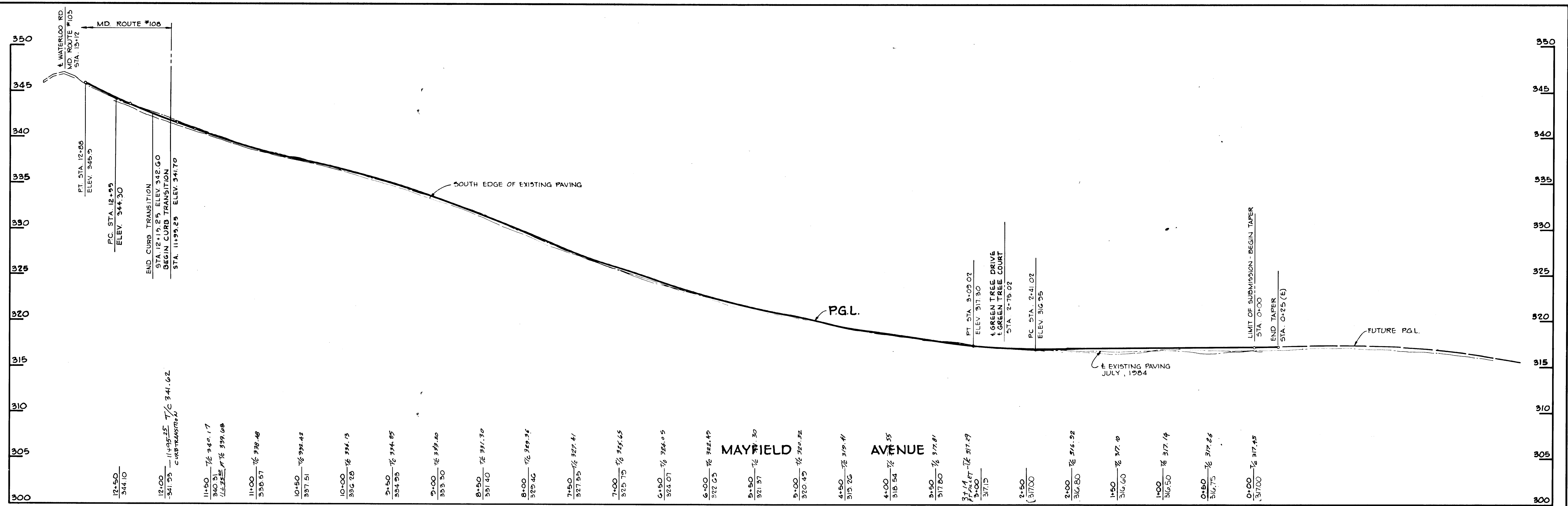

AS BUILT SURVEY CERTIFIED BY JAMES KENNETH TRACY
REG. P.E. NO. 9506 ON AUG. 5, 1987

APPROVED: HOWARD COUNTY DEPARTMENT OF PUBLIC WORKS	
<i>[Signature]</i>	7-1-85
CHIEF, BUREAU OF ENGINEERING	DATE
APPROVED: HOWARD COUNTY OFFICE OF PLANNING AND ZONING	
<i>[Signature]</i>	6-14-85
CHIEF, DIVISION OF LAND DEVELOPMENT AND ZONING ADMINISTRATION	DATE
NO DATE	REVISION

As-Built Survey 8/5/87
[Signature]

TRACY, SCHULTE & ASSOCIATES INC.
planning • architecture • engineering
8450 Baltimore National Pike • Suite 34 • Ellicott City, Maryland 21043 • (301) 465-6105

[Signature]

OWNER SECURITY DEVELOPMENT CORP 8450 BALTIMORE NATIONAL PIKE ELLICOTT CITY, MD 21043	PROJECT THOMPSONS PURCHASE SECTION 4, AREA 2 LOTS 108 THRU 156
DEVELOPER SECURITY DEVELOPMENT CORP 8450 BALTIMORE NATIONAL PIKE ELLICOTT CITY, MD 21043	LOCATION TAX MAP NO 37 PARCELS 50, 146, 151, 152 & 459 1ST ELECTION DISTRICT HOWARD COUNTY, MARYLAND
TITLE PROFILES OF MAYFIELD AVENUE AND GREEN TREE DRIVE	
DATE NOV. 9, 1984	PROJECT NO. 0683 RSD
DES. RJW	DRN. KAM
SCALE: H: 1"=50' V: 1"=5'	DRAWING 6 OF 9

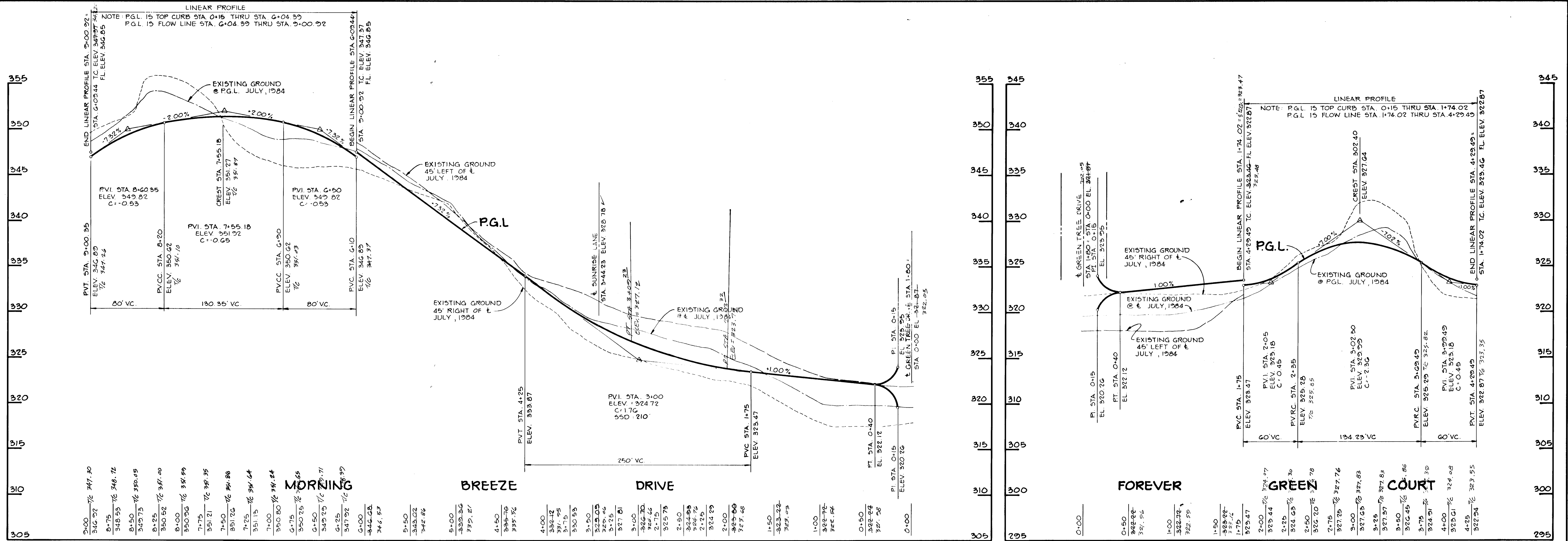

AS BUILT SURVEY 8/5/87

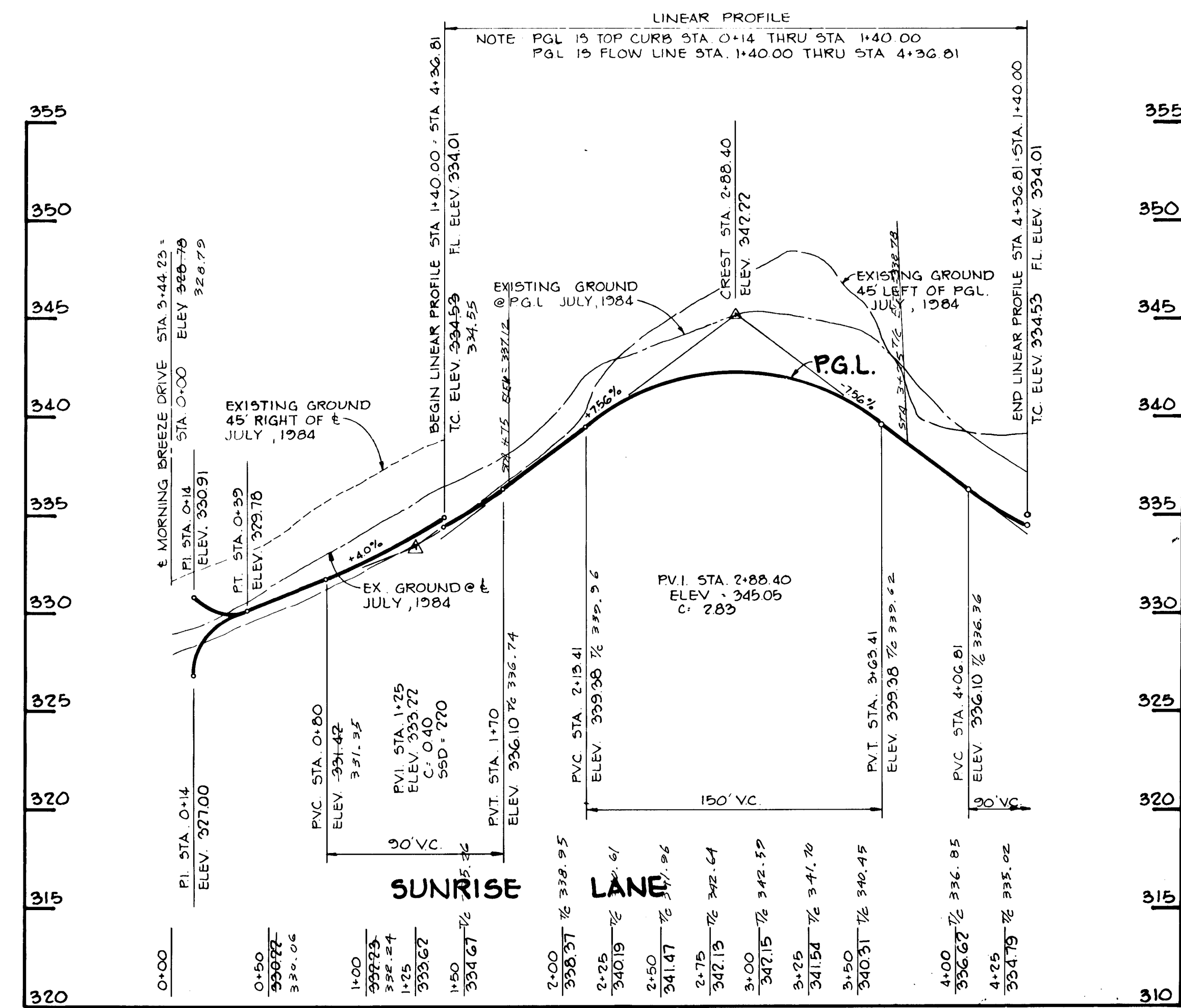

APPROVED: HOWARD COUNTY DEPARTMENT OF PUBLIC WORKS	
CHIEF, BUREAU OF ENGINEERING	DATE 7-1-85
APPROVED: HOWARD COUNTY OFFICE OF PLANNING AND ZONING	
CHIEF, DIVISION OF LAND DEVELOPMENT AND ZONING ADMINISTRATION	DATE 6-14-85
NO DATE	REVISION
TRACY, SCHULTE & ASSOCIATES INC. planning • architecture • engineering 8450 Baltimore National Pike • Suite 34 • Ellicott City, Maryland 21043 • (301) 465-6105	
OWNER	PROJECT
SECURITY DEVELOPMENT CORP. 8450 BALTIMORE NATIONAL PIKE ELLICOTT CITY, MD 21043	THOMPSONS PURCHASE SECTION 4, AREA 2 LOTS 108 THRU 156
DEVELOPER	LOCATION
SECURITY DEVELOPMENT CORP. 8450 BALTIMORE NATIONAL PIKE ELLICOTT CITY, MD 21043	TAX MAP NO. 37 PARCELS 50, 146, 151, 152 & 459 1ST ELECTION DISTRICT HOWARD COUNTY, MARYLAND
TITLE	DATE
PROFILES OF MORNING BREEZE DRIVE, FOREVER GREEN COURT, SUNRISE LANE	NOV. 9, 1984
DES. RJW	DRN. KAM
SCALE: H: 1"=50' V: 1"=5'	PROJECT NO. 0683 RSD
	DRAWING 7 OF 9

AS BUILT SURVEY CONDUCTED BY JAMES K. TRACY
 0254-325, No. 15,66 (D) Aug. 5, 1987

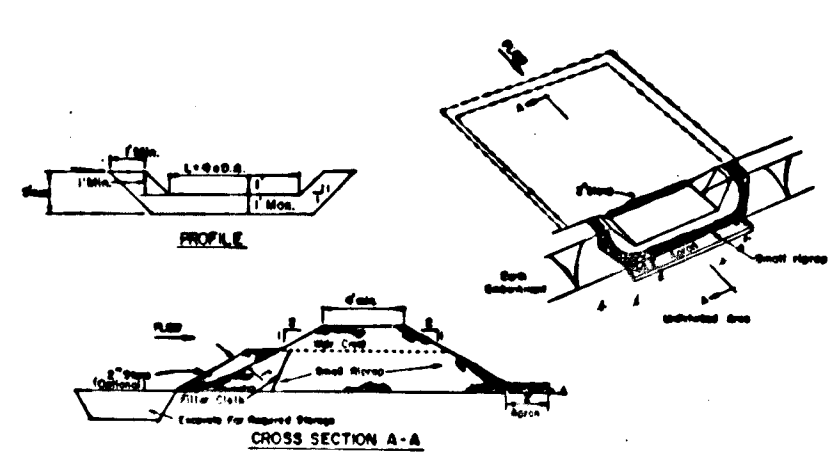

STONE OUTLET SEDIMENT TRAP
NO SCALE

OPTION: A one foot layer of 2" stone may be placed on the upstream side of the trap in place of the standard filter cloth.

CONSTRUCTION SPECIFICATIONS FOR STONE

- Stone shall be washed and free of dirt, oil, and other organic material.
- The fill material for the embankment shall be free of rocks and other organic material as well as untreated lime, rocks, organic material or other objectionable material. The embankment shall be compacted by hand or machine while it is being constructed.
- All cut and fill slopes shall be 2:1 or flatter.
- The stone used in the outlet shall be small stones 4" to 8" along with a 2" thickness of 2" aggregate placed on the upstream side of the small trap; 2" washed filter cloth in the trap.
- Rebar shall be removed and trap returned to its original dimensions when the outlet has been completed on the entire site of the trap.
- The structure shall be inspected after each rain and repairs made as needed.
- Construction operation shall be carried out in such a manner that erosion and water pollution is minimized.
- The structure shall be removed and the area stabilized when the drainage area has been properly stabilized.

Maximum Drainage Area: 5 Acres

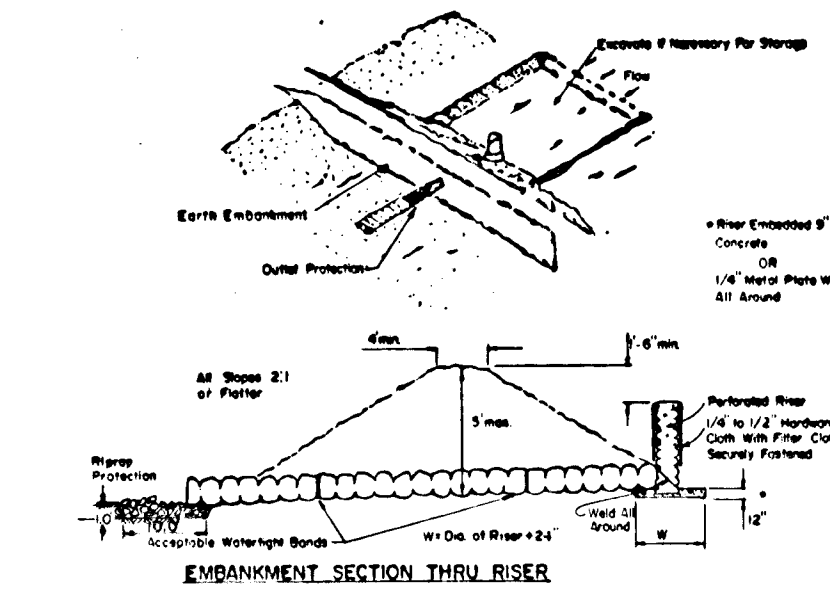

PIPE OUTLET SEDIMENT TRAP
NO SCALE

CONSTRUCTION SPECIFICATIONS FOR PIPE

- Area under embankment shall be cleared, graded and stripped of any vegetation and rock.
- The fill material for the embankment shall be free of rocks and other organic material as well as untreated lime, rocks, organic material or other objectionable material. The embankment shall be compacted by hand or machine while it is being constructed.
- All cut and fill slopes shall be 2:1 or flatter.
- The stone used in the outlet shall be small stones 4" to 8" along with a 2" thickness of 2" aggregate placed on the upstream side of the small trap; 2" washed filter cloth in the trap.
- Rebar shall be removed and trap returned to its original dimensions when the outlet has been completed on the entire site of the trap.
- The structure shall be inspected after each rain and repairs made as needed.
- Construction operation shall be carried out in such a manner that erosion and water pollution is minimized.
- The structure shall be removed and the area stabilized when the drainage area has been properly stabilized.

Maximum Drainage Area: 5 Acres

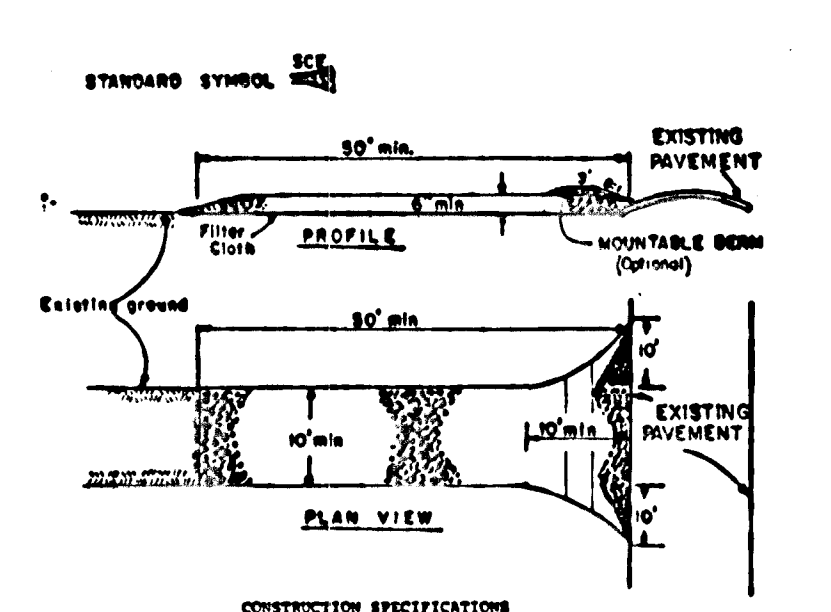

STABILIZED CONSTRUCTION ENTRANCE
NO SCALE

CONSTRUCTION SPECIFICATIONS

- Stone Size - 2 to 3" stone, or crushed concrete equivalent.
- Length - As required, but not less than 10 feet (except on a single entrance less than 10 feet minimum length would apply).
- Thickness - Not less than 18" (6" inches).
- Width - 18" (6" inches) minimum, but not less than the full width of the inlet where ingress or egress occurs.
- Filter Cloth - Will be placed over the entire area prior to placing of stone. Filter will not be applied on a single family residential lot.
- Surface Water - All surface water flowing or diverted toward construction entrance shall be piped across the entrance. If possible to improve, a portable beam with 4:1 slope will be permitted.
- Maintenance - The entrance shall be maintained in a condition which will prevent tracking or flowing of sediment onto public rights-of-way. This may require periodic top dressing with additional stone as conditions demand and repair and/or removal of any material used to trap sediment. All sediment spilled, dropped, washed or tracked onto public rights-of-way must be removed immediately.
- Warning - Signs shall be placed to advise sediment prior to entrance onto public rights-of-way. When washing is required, it shall be done on an area stabilized with stone and which drains into an approved sediment trapping device.
- Periodic inspection and needed maintenance shall be provided after each rain.

STONE OUTLET SEDIMENT TRAP
NO SCALE

PIPE OUTLET SEDIMENT TRAP
NO SCALE

STABILIZED CONSTRUCTION ENTRANCE
NO SCALE

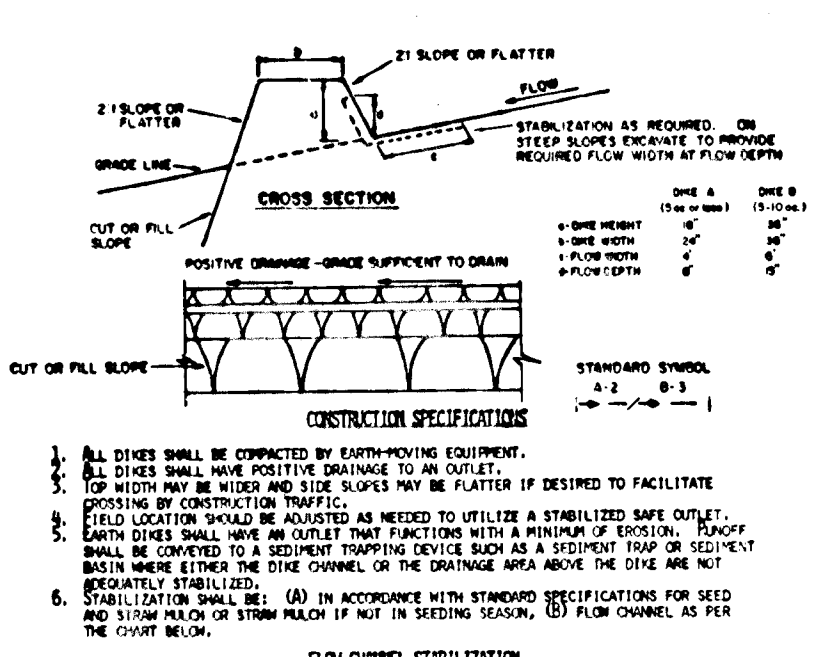

EARTH DIKE
NO SCALE

CONSTRUCTION SPECIFICATIONS

- All dikes shall be constructed by earthmoving equipment.
- All dikes shall have positive drainage to outlet.
- Top width may be wider and side slopes may be flatter if desired to facilitate crossing by construction traffic.
- Field location shall be adjusted as needed to utilize a stabilized safe outlet.
- Earth dikes shall have an outlet that functions with a minimum of erosion. The outlet shall be covered to a sediment trapping device such as a streamer trap or silt trap.
- Stabilization shall be: (A) in accordance with standard specifications for seed and straw mulch or straw mulch if not in seeding season; (B) flow channel, as per the chart below.

TYPE OF TREATMENT	CHANNEL STABILIZATION	DIKE A	DIKE B
1	5-15.00	Seed and Straw Mulch	Seed and Straw Mulch
2	5-15.00	Seed and Straw Mulch	Seed and Straw Mulch
3	5-15.00	Seed with Lime or Sod	Lime or Sod
4	8-12.00	Lime or Sod	Engineered Design

A. Stone to be 2 inch stone, or recycled concrete equivalent, in a layer at least 3 inches in thickness and be placed into the soil with construction equipment. B. Top top to be 18 inches in a layer at least 3 inches thickness and placed into the soil. C. Approved equivalent can be substituted for any of the above materials. D. Periodic inspection and required maintenance must be provided after each rain event.

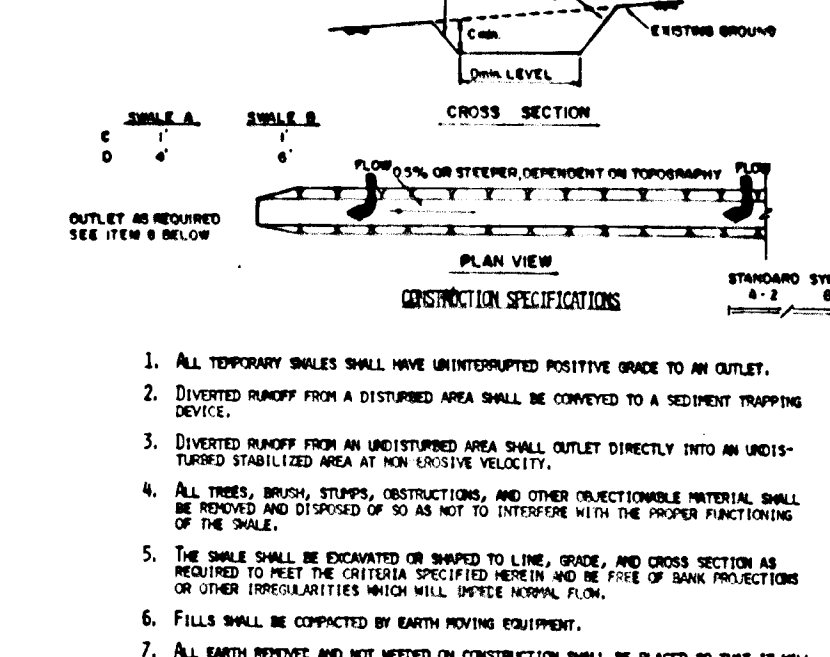

TEMPORARY SWALE
NO SCALE

CONSTRUCTION SPECIFICATIONS

- All temporary swales shall have uninterrupted positive grade to an outlet.
- Diverted runoff from a disturbed area shall be conveyed to a sediment trapping device.
- Diverted runoff from an undisturbed area shall outlet directly into an undisturbed stabilized area at non-erosive velocity.
- All trees, shrubs, stumps, obstructions, and other objectionable material shall be removed and disposed of so as not to interfere with the proper functioning of the swale.
- The swale shall be excavated or shaped to line, grade, and cross section as required to meet the criteria specified herein and be free of bank projection or other irregularities which will impede normal flow.
- Fills shall be compacted by earth moving equipment.
- All earth removal and not needed in construction shall be placed so that it will not interfere with the functioning of the swale.
- Stabilization shall be as per the chart below:

TYPE OF TREATMENT	CHANNEL STABILIZATION	DIKE A	DIKE B
1	0.5-1.00	Seed and Straw Mulch	Seed and Straw Mulch
2	3.15-5.00	Seed and Straw Mulch	Seed and Straw Mulch
3	5.1-8.00	Seed with Lime or Excelsior	Lime or Sod
4	8.1-12.00	Lime or Sod	Engineered Design

9. Periodic inspection and required maintenance must be provided after each rain event.

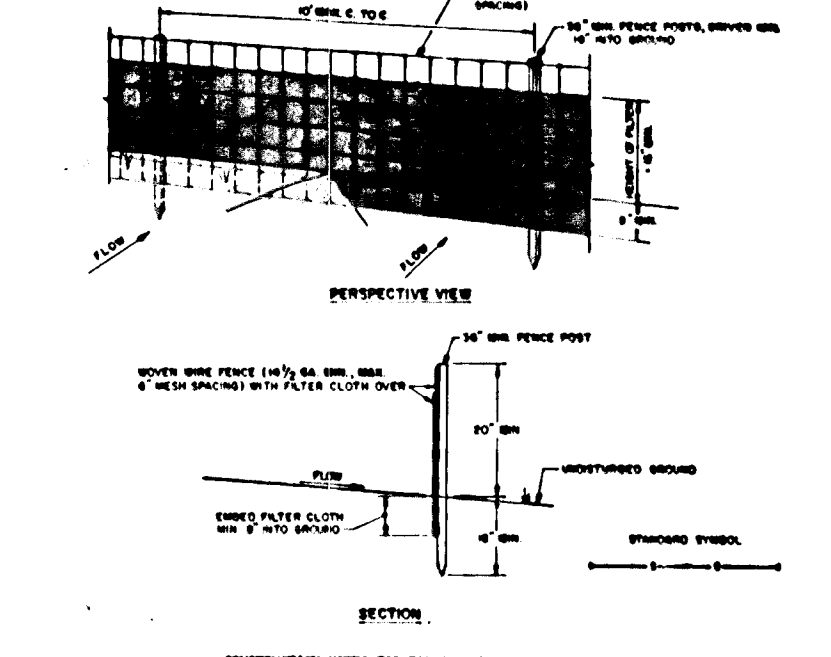

SILT FENCE
NO SCALE

CONSTRUCTION NOTES FOR FERTILIZED SILT FENCE

- When wire fence to be fastened securely to fence posts with wire ties of staples.
- Filter cloth to be fastened securely to stone with fence wire ties, staples every 2' at top and mid section.
- When two sections of filter cloth abut each other they shall be overlapped by six inches and fastened.
- Maintenance shall be provided as needed and material removed when necessary to develop in the silt fence.

PERMANENT SEEDING NOTES

SEEDBED PREPARATION: LOOSEN UPPER THREE INCHES OF SOIL BY RAKING, DISCING OR OTHER ACCEPTABLE MEANS BEFORE SEEDING.

SOIL AMENDMENTS: IN LIEU OF SOIL TEST RECOMMENDATIONS, USE ONE OF THE FOLLOWING SCHEDULES:

- PREFERRED -** APPLY 2 TONS PER ACRE DOLOMITIC LIMESTONE (92 lbs/1000 sq ft) AND 600 LBS PER ACRE 10-10-10 FERTILIZER (14 lbs/1000 sq ft) BEFORE SEEDING. HARROW OR DISC INTO UPPER THREE INCHES OF SOIL. AT TIME OF SEEDING, APPLY 400 LBS PER ACRE 30-0-0 UREA-FORM FERTILIZER (9 lbs/1000 sq ft).
- ACCEPTABLE -** APPLY 2 TONS PER ACRE DOLOMITIC LIMESTONE (92 lbs/1000 sq ft) AND 1000 LBS PER ACRE 10-10-10 FERTILIZER (23 lbs/1000 sq ft) BEFORE SEEDING. HARROW OR DISC INTO UPPER THREE INCHES OF SOIL.

SEEDING - FOR THE PERIODS MARCH 1 THRU APRIL 30, AND AUGUST 1 THRU OCTOBER 15, SEED WITH 60 LBS PER ACRE (1.4 lbs/1000 sq ft) OF KENTUCKY 31 TALL FESCUE. FOR THE PERIOD MAY 1 THRU JULY 31, SEED WITH 60 LBS KENTUCKY 31 TALL FESCUE PER ACRE AND 2 LBS PER ACRE (.05 lbs/1000 sq ft) OF WEEPING LOVEGRASS. DURING THE PERIOD OF OCTOBER 16 THRU FEBRUARY 28, PROTECT SITE BY: OPTION (1) 2 TONS PER ACRE OF WELL ANCHORED STRAW MULCH AND SEED AS SOON AS POSSIBLE IN THE SPRING. OPTION (2) USE SOD. OPTION (3) SEED WITH 60 LBS/ACRE KENTUCKY 31 TALL FESCUE AND MULCH WITH 2 TONS/ACRE WELL ANCHORED STRAW.

MULCHING - APPLY 1 1/2 TO 2 TONS PER ACRE (70 TO 90 lbs/1000 sq ft) OF UNROTTED SMALL GRAIN STRAW IMMEDIATELY AFTER SEEDING. ANCHOR MULCH IMMEDIATELY AFTER APPLICATION USING MULCH ANCHORING TOOL, OR 218 GALLONS PER ACRE (5 gal/1000 sq ft) OF EMULSIFIED ASPHALT ON FLAT AREAS. ON SLOPES 8 FEET OR HIGHER, USE 348 GALLONS PER ACRE (8 gal/1000 sq ft) FOR ANCHORING.

MAINTENANCE - INSPECT ALL SEEDED AREAS AND MAKE NEEDED REPAIRS, REPLACEMENTS AND RESEEDINGS.

TEMPORARY SEEDING NOTES

APPLY TO GRADED OR CLEARED AREAS LIKELY TO BE REDISTURBED WHERE A SHORT-TERM VEGETATIVE COVER IS NEEDED.

SEEDBED PREPARATION: LOOSEN UPPER THREE INCHES OF SOIL BY RAKING, DISCING OR OTHER ACCEPTABLE MEANS BEFORE SEEDING.

SOIL AMENDMENTS: APPLY 600 LBS PER ACRE 10-10-10 FERTILIZER (14 lbs/1000 sq ft)

SEEDING: FOR PERIODS MARCH 1 THRU APRIL 30 AND FROM AUGUST 15 THRU NOVEMBER 15, SEED WITH 2 1/2 BUSHEL PER ACRE OF ANNUAL RYE (3.2 lbs/1000 sq ft). FOR THE PERIOD MAY 1 THRU AUGUST 14, SEED WITH 3 LBS PER ACRE OF WEEPING LOVEGRASS (.07 lbs/1000 sq ft). FOR THE PERIOD NOVEMBER 16 THRU FEBRUARY 28, PROTECT SITE BY APPLYING 2 TONS PER ACRE OF WELL ANCHORED STRAW MULCH AND SEED AS SOON AS POSSIBLE IN THE SPRING, OR USE SOD.

MULCHING: APPLY 1 1/2 TO 2 TONS PER ACRE (70 TO 90 lbs/1000 sq ft) OF UNROTTED SMALL GRAIN STRAW IMMEDIATELY AFTER SEEDING. ANCHOR MULCH IMMEDIATELY AFTER APPLICATION USING MULCH ANCHORING TOOL, OR 218 GAL. PER ACRE (5 gal/1000 sq ft) OF EMULSIFIED ASPHALT ON FLAT AREAS. ON SLOPES, 8 FT OR HIGHER, USE 348 GAL. PER ACRE (8 gal/1000 sq ft) FOR ANCHORING.

REFER TO THE 1983 MARYLAND STANDARDS AND SPECIFICATIONS FOR SOIL EROSION AND SEDIMENT CONTROL FOR RATE AND METHODS NOT COVERED.

EARTH DIKE
NO SCALE

TEMPORARY SWALE
NO SCALE

SILT FENCE
NO SCALE

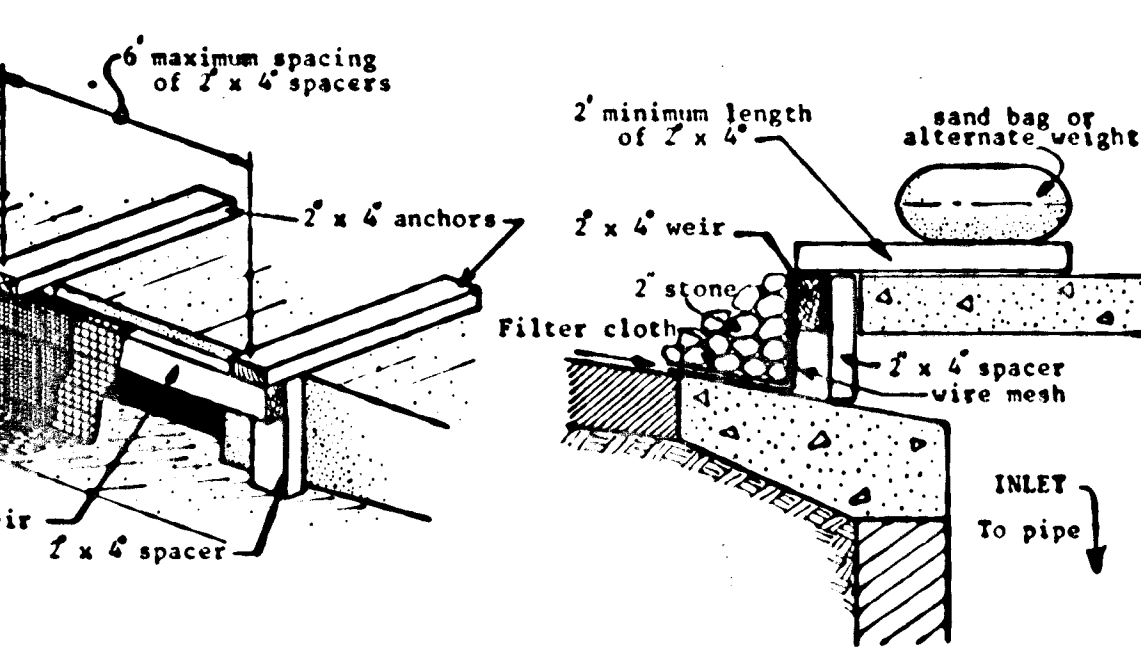

INLET BLOCKING DETAIL
NO SCALE

SEDIMENT CONTROL NOTES

- A MINIMUM OF 24 HOURS NOTICE MUST BE GIVEN TO THE HOWARD COUNTY OFFICE OF INSPECTIONS AND PERMITS PRIOR TO THE START OF ANY CONSTRUCTION (992-2437).
- ALL VEGETATIVE AND STRUCTURAL PRACTICES ARE TO BE INSTALLED ACCORDING TO THE PROVISIONS OF THIS PLAN AND ARE TO BE IN CONFORMANCE WITH THE 1983 MARYLAND STANDARDS AND SPECIFICATIONS FOR SOIL EROSION AND SEDIMENT CONTROL.
- FOLLOWING INITIAL SOIL DISTURBANCE OR REDISTURBANCE, PERMANENT OR TEMPORARY STABILIZATION SHALL BE COMPLETED WITHIN: a) 7 CALENDAR DAYS FOR ALL PERIMETER SEDIMENT CONTROL STRUCTURES, DIKES, PERIMETER SLOPES AND ALL SLOPES GREATER THAN 3:1, b) 14 DAYS AS TO ALL OTHER DISTURBED OR GRADED AREAS ON THE PROJECT SITE.
- ALL SEDIMENT TRAPS/BASINS SHOWN MUST BE FENCED AND WARNING SIGNS POSTED AROUND THEIR PERIMETER IN ACCORDANCE WITH VOL. 1, CHAPTER 12, OF THE HOWARD COUNTY DESIGN MANUAL, STORM DRAINAGE.
- ALL DISTURBED AREAS MUST BE STABILIZED WITHIN THE TIME PERIOD SPECIFIED ABOVE IN ACCORDANCE WITH THE 1983 MARYLAND STANDARDS AND SPECIFICATIONS FOR SOIL EROSION AND SEDIMENT CONTROL FOR PERMANENT SEEDINGS (Sec. 51) SOD (Sec. 54), TEMPORARY SEEDING (Sec. 50) AND MULCHING (Sec. 52). TEMPORARY STABILIZATION WITH MULCH ALONE CAN ONLY BE DONE WHEN RECOMMENDED SEEDING DATES DO NOT ALLOW FOR PROPER GERMINATION AND ESTABLISHMENT OF GRASSES.
- ALL SEDIMENT CONTROL STRUCTURES ARE TO REMAIN IN PLACE AND ARE TO BE MAINTAINED IN OPERATIVE CONDITION UNTIL PERMISSION FOR THEIR REMOVAL HAS BEEN OBTAINED FROM THE HOWARD COUNTY SEDIMENT CONTROL INSPECTOR.
- SITE ANALYSIS:**
TOTAL AREA OF SITE: 19.47 ACRES
AREA DISTURBED: 4.93 ACRES
AREA TO BE ROOFED OR PAVED: 2.05 ACRES
AREA TO BE VEGETATIVELY STABILIZED: 2.88 ACRES
TOTAL CUT: 8.021 CU YDS
TOTAL FILL: 8.094 CU YDS
OFFSITE WASTE/BORROW AREA LOCATION: N/A
- ANY SEDIMENT CONTROL PRACTICE WHICH IS DISTURBED BY GRADING ACTIVITY FOR PLACEMENT OF UTILITIES MUST BE REPAIRED ON THE SAME DAY OF DISTURBANCE.
- ADDITIONAL SEDIMENT CONTROLS MUST BE PROVIDED, IF DEFINED NECESSARY BY THE HOWARD COUNTY DPW SEDIMENT CONTROL INSPECTOR.
- ALL SEDIMENT TRAPS SHOWN MUST BE FENCED AND WARNING SIGNS POSTED AROUND THEIR PERIMETER IN ACCORDANCE WITH VOL. 1, CHAPTER 12, OF THE HOWARD COUNTY DESIGN MANUAL, STORM DRAINAGE.
- ADDITIONAL SEDIMENT CONTROLS MUST BE PROVIDED DURING SITE DEVELOPMENT PLAN GRADING.

PERMANENT SEEDING NOTES

SEEDBED PREPARATION: LOOSEN UPPER THREE INCHES OF SOIL BY RAKING, DISCING OR OTHER ACCEPTABLE MEANS BEFORE SEEDING.

SOIL AMENDMENTS: IN LIEU OF SOIL TEST RECOMMENDATIONS, USE ONE OF THE FOLLOWING SCHEDULES:

- PREFERRED -** APPLY 2 TONS PER ACRE DOLOMITIC LIMESTONE (92 lbs/1000 sq ft) AND 600 LBS PER ACRE 10-10-10 FERTILIZER (14 lbs/1000 sq ft) BEFORE SEEDING. HARROW OR DISC INTO UPPER THREE INCHES OF SOIL. AT TIME OF SEEDING, APPLY 400 LBS PER ACRE 30-0-0 UREA-FORM FERTILIZER (9 lbs/1000 sq ft).
- ACCEPTABLE -** APPLY 2 TONS PER ACRE DOLOMITIC LIMESTONE (92 lbs/1000 sq ft) AND 1000 LBS PER ACRE 10-10-10 FERTILIZER (23 lbs/1000 sq ft) BEFORE SEEDING. HARROW OR DISC INTO UPPER THREE INCHES OF SOIL.

SEEDING - FOR THE PERIODS MARCH 1 THRU APRIL 30, AND AUGUST 1 THRU OCTOBER 15, SEED WITH 60 LBS PER ACRE (1.4 lbs/1000 sq ft) OF KENTUCKY 31 TALL FESCUE. FOR THE PERIOD MAY 1 THRU JULY 31, SEED WITH 60 LBS KENTUCKY 31 TALL FESCUE PER ACRE AND 2 LBS PER ACRE (.05 lbs/1000 sq ft) OF WEEPING LOVEGRASS. DURING THE PERIOD OF OCTOBER 16 THRU FEBRUARY 28, PROTECT SITE BY: OPTION (1) 2 TONS PER ACRE OF WELL ANCHORED STRAW MULCH AND SEED AS SOON AS POSSIBLE IN THE SPRING. OPTION (2) USE SOD. OPTION (3) SEED WITH 60 LBS/ACRE KENTUCKY 31 TALL FESCUE AND MULCH WITH 2 TONS/ACRE WELL ANCHORED STRAW.

MULCHING - APPLY 1 1/2 TO 2 TONS PER ACRE (70 TO 90 lbs/1000 sq ft) OF UNROTTED SMALL GRAIN STRAW IMMEDIATELY AFTER SEEDING. ANCHOR MULCH IMMEDIATELY AFTER APPLICATION USING MULCH ANCHORING TOOL, OR 218 GALLONS PER ACRE (5 gal/1000 sq ft) OF EMULSIFIED ASPHALT ON FLAT AREAS. ON SLOPES 8 FEET OR HIGHER, USE 348 GALLONS PER ACRE (8 gal/1000 sq ft) FOR ANCHORING.

MAINTENANCE - INSPECT ALL SEEDED AREAS AND MAKE NEEDED REPAIRS, REPLACEMENTS AND RESEEDINGS.

TEMPORARY SEEDING NOTES

APPLY TO GRADED OR CLEARED AREAS LIKELY TO BE REDISTURBED WHERE A SHORT-TERM VEGETATIVE COVER IS NEEDED.

SEEDBED PREPARATION: LOOSEN UPPER THREE INCHES OF SOIL BY RAKING, DISCING OR OTHER ACCEPTABLE MEANS BEFORE SEEDING.

SOIL AMENDMENTS: APPLY 600 LBS PER ACRE 10-10-10 FERTILIZER (14 lbs/1000 sq ft)

SEEDING: FOR PERIODS MARCH 1 THRU APRIL 30 AND FROM AUGUST 15 THRU NOVEMBER 15, SEED WITH 2 1/2 BUSHEL PER ACRE OF ANNUAL RYE (3.2 lbs/1000 sq ft). FOR THE PERIOD MAY 1 THRU AUGUST 14, SEED WITH 3 LBS PER ACRE OF WEEPING LOVEGRASS (.07 lbs/1000 sq ft). FOR THE PERIOD NOVEMBER 16 THRU FEBRUARY 28, PROTECT SITE BY APPLYING 2 TONS PER ACRE OF WELL ANCHORED STRAW MULCH AND SEED AS SOON AS POSSIBLE IN THE SPRING, OR USE SOD.

MULCHING: APPLY 1 1/2 TO 2 TONS PER ACRE (70 TO 90 lbs/1000 sq ft) OF UNROTTED SMALL GRAIN STRAW IMMEDIATELY AFTER SEEDING. ANCHOR MULCH IMMEDIATELY AFTER APPLICATION USING MULCH ANCHORING TOOL, OR 218 GAL. PER ACRE (5 gal/1000 sq ft) OF EMULSIFIED ASPHALT ON FLAT AREAS. ON SLOPES, 8 FT OR HIGHER, USE 348 GAL. PER ACRE (8 gal/1000 sq ft) FOR ANCHORING.

REFER TO THE 1983 MARYLAND STANDARDS AND SPECIFICATIONS FOR SOIL EROSION AND SEDIMENT CONTROL FOR RATE AND METHODS NOT COVERED.

TEMPORARY SEEDING NOTES

APPLY TO GRADED OR CLEARED AREAS LIKELY TO BE REDISTURBED WHERE A SHORT-TERM VEGETATIVE COVER IS NEEDED.

SEEDBED PREPARATION: LOOSEN UPPER THREE INCHES OF SOIL BY RAKING, DISCING OR OTHER ACCEPTABLE MEANS BEFORE SEEDING.

SOIL AMENDMENTS: APPLY 600 LBS PER ACRE 10-10-10 FERTILIZER (14 lbs/1000 sq ft)

SEEDING: FOR PERIODS MARCH 1 THRU APRIL 30 AND FROM AUGUST 15 THRU NOVEMBER 15, SEED WITH 2 1/2 BUSHEL PER ACRE OF ANNUAL RYE (3.2 lbs/1000 sq ft). FOR THE PERIOD MAY 1 THRU AUGUST 14, SEED WITH 3 LBS PER ACRE OF WEEPING LOVEGRASS (.07 lbs/1000 sq ft). FOR THE PERIOD NOVEMBER 16 THRU FEBRUARY 28, PROTECT SITE BY APPLYING 2 TONS PER ACRE OF WELL ANCHORED STRAW MULCH AND SEED AS SOON AS POSSIBLE IN THE SPRING, OR USE SOD.

MULCHING: APPLY 1 1/2 TO 2 TONS PER ACRE (70 TO 90 lbs/1000 sq ft) OF UNROTTED SMALL GRAIN STRAW IMMEDIATELY AFTER SEEDING. ANCHOR MULCH IMMEDIATELY AFTER APPLICATION USING MULCH ANCHORING TOOL, OR 218 GAL. PER ACRE (5 gal/1000 sq ft) OF EMULSIFIED ASPHALT ON FLAT AREAS. ON SLOPES, 8 FT OR HIGHER, USE 348 GAL. PER ACRE (8 gal/1000 sq ft) FOR ANCHORING.

REFER TO THE 1983 MARYLAND STANDARDS AND SPECIFICATIONS FOR SOIL EROSION AND SEDIMENT CONTROL FOR RATE AND METHODS NOT COVERED.

SEQUENCE OF CONSTRUCTION

- OBTAIN A GRADING PERMIT.
- CLEAR AND GRUB AREA FOR AND INSTALL STABILIZED CONSTRUCTION ENTRANCE SCE.
- CLEAR AND GRUB REMAINING AREAS FOR SEDIMENT CONTROL DEVICE INSTALLATION.
- INSTALL SEDIMENT TRAPS 1 AND 2 AND STABILIZE IN ACCORDANCE WITH TEMPORARY SEEDING NOTES.
- INSTALL TEMPORARY 24" CMP OUTLET PIPE.
- INSTALL REMAINDER OF SEDIMENT CONTROL DEVICES AND STABILIZE IN ACCORDANCE WITH TEMPORARY SEEDING NOTES.
- CLEAR AND GRUB REMAINDER OF SITE.
- GRADE SITE.
- INSTALL UTILITIES (WATER, SEWER, AND STORM DRAINS).
- STABILIZE ALL SLOPES IN ACCORDANCE WITH PERMANENT SEEDING NOTES.
- COMPLETE ALL ROADWAY CONSTRUCTION AND STABILIZE ALL DISTURBED AREAS IN ACCORDANCE WITH PERMANENT SEEDING NOTES.
- THE 24" DISCHARGE PIPE FROM SEDIMENT TRAP #1 WILL REMAIN IN PLACE UNTIL I-12 AND THE DOWNSTREAM PIPE SYSTEM IS CONSTRUCTED. THE 24" PIPE SHALL BE CUT APPROXIMATELY 15' FROM THE 317' INVERT. SO THAT DISCHARGE CAN FLOW INTO THE OPEN BACK OF INLET 12. THE REMAINING 60' OF 24" PIPE SHALL BE ABANDONED SO THAT FURTHER CONSTRUCTION OF THE UPSTREAM STORM DRAIN SYSTEM FROM M-1 TO M-2 CAN CONTINUE. UPON APPROVAL OF SEDIMENT CONTROL INSPECTION, REMOVE ALL SEDIMENT CONTROL DEVICES AND SEED DISTURBED AREAS IN ACCORDANCE WITH PERMANENT SEEDING NOTES.

BY THE DEVELOPER:

"I/WE CERTIFY THAT ALL DEVELOPMENT AND CONSTRUCTION WILL BE DONE ACCORDING TO THIS PLAN, AND THAT ANY RESPONSIBLE PERSONNEL INVOLVED IN THE CONSTRUCTION PROJECT WILL HAVE A CERTIFICATE OF ATTENDANCE AT A DEPARTMENT OF NATURAL RESOURCES APPROVED TRAINING PROGRAM FOR THE CONTROL OF SEDIMENT AND EROSION BEFORE BEGINNING THE PROJECT."

James R. Moxley, Jr.
DEVELOPER: JAMES R. MOXLEY, JR. 11-5-84 DATE

BY THE ENGINEER:

"I CERTIFY THAT THIS PLAN FOR EROSION AND SEDIMENT CONTROL REPRESENTS A PRACTICAL AND WORKABLE PLAN BASED ON MY PERSONAL KNOWLEDGE OF THE SITE CONDITIONS AND THAT IT WAS PREPARED IN ACCORDANCE WITH THE REQUIREMENTS OF THE HOWARD SOIL CONSERVATION DISTRICT."

James K. Tracy, P.E. 11-5-84 DATE

REVIEWED FOR: 11/24/84 S.C.D.

AND MEETS TECHNICAL REQUIREMENTS

U.S. SOIL CONSERVATION SERVICE 6/11/85 DATE

THIS DEVELOPMENT IS APPROVED FOR SOIL EROSION AND SEDIMENT CONTROL BY THE HOWARD SOIL CONSERVATION DISTRICT

Howard S.C.D. 6/11/85 DATE

APPROVED: HOWARD COUNTY DEPARTMENT OF PLANNING AND ZONING

John W. Neenan 6-11-85 DATE

CHIEF, DIVISION OF LAND DEVELOPMENT AND ZONING ADMINISTRATION

APPROVED: HOWARD COUNTY DEPARTMENT OF PUBLIC WORKS

William B. P. 1-1-86 DATE

CHIEF, BUREAU OF ENGINEERING

NO	DATE	REVISION

TRACY, SCHULTE & ASSOCIATES INC.
planning • architecture • engineering

8450 Baltimore National Pike • Suite 34 • Ellicott City, Maryland 21043 • (301) 465 6105

OWNER: SECURITY DEVELOPMENT CORP
8450 BALTIMORE NATIONAL PIKE
ELLCOTT CITY, MD 21043

PROJECT: THOMPSONS PURCHASE
SECTION 4, AREA 2 LOTS 108 THRU 156

LOCATION: TAX MAP NO 87
PARCELS 50 146 151 152 & 159
1ST ELECTION DISTRICT
HOWARD COUNTY, MARYLAND

DEVELOPER: SECURITY DEVELOPMENT CORP
8450 BALTIMORE NATIONAL PIKE
ELLCOTT CITY, MD 21043

TITLE: SEDIMENT CONTROL NOTES AND DETAILS

DATE NOV. 9, 1984 PROJECT NO 0683 R3D

DES RJW DRN KAM SCALE AS SHOWN DRAWING 8 OF 9

314188 F-85-72 JUNE 5, 1985

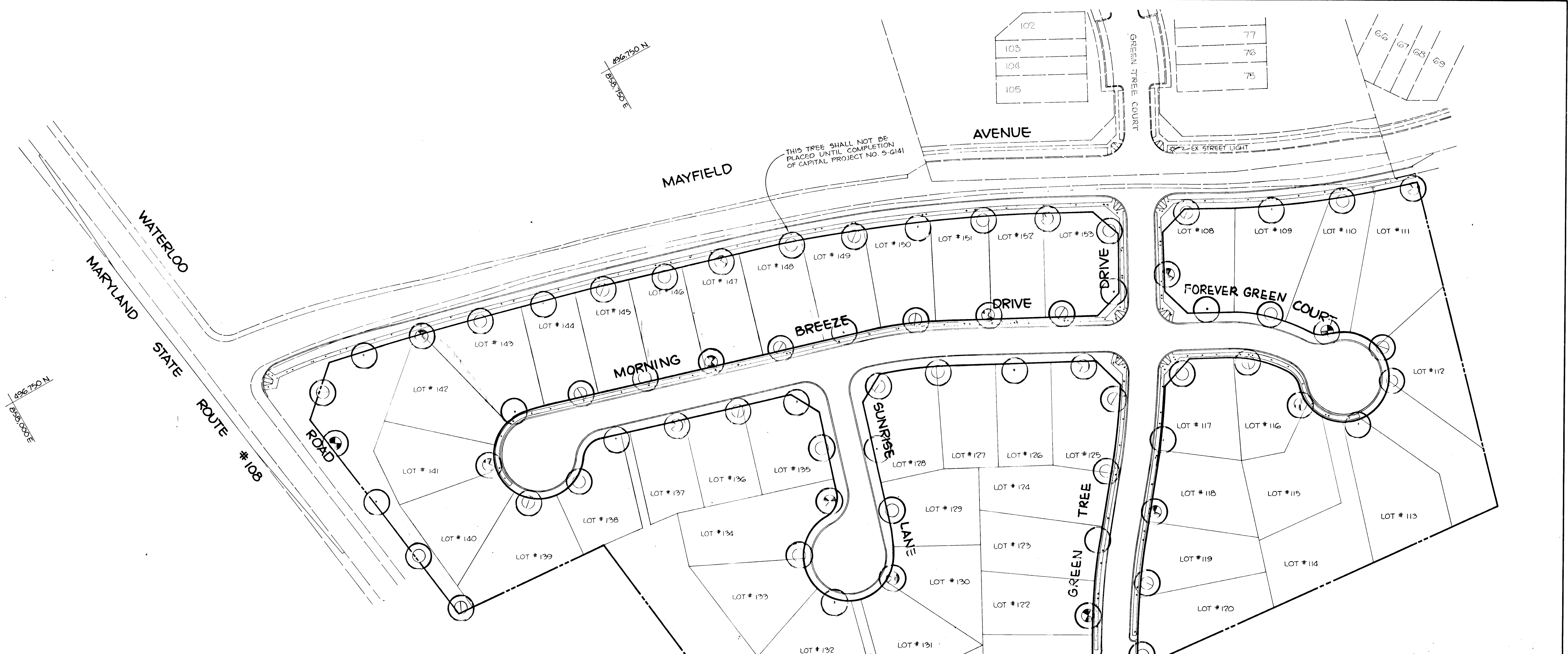

PLANT LIST

SYMBOL	QUANTITY	NAME	REMARKS
	34	ACER RUBRUM Red Maple	2 1/2 Min Cal. B & B Full Head
	35	ACER SACCHARUM Sugar Maple	
TOTAL	69		

LENGTH OF PROPOSED ROADS = 1483 LF ÷ 40 = 37.1
 LENGTH OF LINEAR PROFILES
 AND MAYFIELD AVENUE = 2526 ÷ 80 = 31.6
 TOTAL REQUIRED 68.7
 TOTAL PROVIDED 69

APPROVED: HOWARD COUNTY DEPARTMENT OF PUBLIC WORKS
William E. Riley 7-1-85
 CHIEF, BUREAU OF ENGINEERING DATE

APPROVED: HOWARD COUNTY OFFICE OF PLANNING AND ZONING
John W. Mueschman 6-11-85
 CHIEF, DIVISION OF LAND DEVELOPMENT AND ZONING ADMINISTRATION DATE

NO	DATE	REVISION

TRACY, SCHULTE & ASSOCIATES INC.
 planning • architecture • engineering
 8450 Baltimore National Pike • Suite 34 • Ellicott City, Maryland 21043 • (301) 465-4100

OWNER SECURITY DEVELOPMENT CORP 8450 BALTIMORE NATIONAL PIKE ELLICOTT CITY, MD 21043	PROJECT THOMPSONS PURCHASE SECTION 4, AREA 2 LOTS 108 THRU 156
DEVELOPER SECURITY DEVELOPMENT CORP 8450 BALTIMORE NATIONAL PIKE ELLICOTT CITY, MD 21043	LOCATION TAX MAP NO 37 PARCELS 50, 146, 151, 152, & 459 1 ST ELECTION DISTRICT HOWARD COUNTY, MARYLAND
TITLE STREET TREE PLAN	
DATE: NOV 9, 1984 DES: RJW DRN: KAM	PROJECT NO: 0683 RSD SCALE: 1" = 50' DRAWING: 9 OF 9