

**ENGINEER'S CERTIFICATE**  
 I HEREBY CERTIFY THAT THIS PLAN FOR EROSION AND SEDIMENT CONTROL REPRESENTS A PRACTICAL AND WORKABLE PLAN BASED ON MY PERSONAL KNOWLEDGE OF THE SITE CONDITIONS AND THAT IT WAS PREPARED IN ACCORDANCE WITH THE REQUIREMENTS OF THE HOWARD SOIL CONSERVATION DISTRICT.

CHARLES J. CROVO, SR.  
 DATE 7/14/84

**DEVELOPER'S CERTIFICATE**  
 I/WE CERTIFY THAT ALL DEVELOPMENT AND CONSTRUCTION WILL BE DONE ACCORDING TO THIS PLAN OF DEVELOPMENT AND PLAN FOR EROSION AND SEDIMENT CONTROL AND THAT ALL RESPONSIBLE PERSONNEL INVOLVED IN THE CONSTRUCTION PROJECT WILL HAVE A CERTIFICATE OF ATTENDANCE AT A DEPARTMENT OF NATURAL RESOURCES APPROVED TRAINING PROGRAM FOR THE CONTROL OF EROSION AND SEDIMENT BEFORE BEGINNING THE PROJECT. I ALSO AUTHORIZE PERIODIC ON-SITE INSPECTION BY THE HOWARD COUNTY SOIL CONSERVATION DISTRICT OR THEIR AUTHORIZED AGENTS AS ARE DEEMED NECESSARY.

STEVEN N. STORCH  
 DATE 7/12/84

REVIEWED FOR HOWARD COUNTY SOIL CONSERVATION DISTRICT AND MEETS TECHNICAL REQUIREMENTS.

*Jonathan Stelm*  
 District Engineer, USDA-SES DATE 9-5-84  
 THIS DEVELOPMENT PLAN IS APPROVED FOR EROSION AND SEDIMENT CONTROL BY THE HOWARD COUNTY SOIL CONSERVATION DISTRICT.

*Robert Zichem*  
 DATE 9-5-84  
 HOWARD COUNTY SOIL CONSERVATION DISTRICT

- GENERAL NOTES**
- 1) ALL WORK SHALL BE DONE IN ACCORDANCE WITH HOWARD COUNTY STANDARDS, SPECIFICATIONS AND DETAILS FOR CONSTRUCTION.
  - 2) ALL UTILITY COMPANIES MUST BE NOTIFIED 24 HRS. IN ADVANCE OF ANY CONSTRUCTION.
  - 3) STORM DRAINAGE TRENCHES WITHIN ROAD RIGHTS-OF-WAYS SHALL BE BACKFILLED AND COMPACTED IN ACCORDANCE WITH HOWARD COUNTY ROAD CODE.
  - 4) ANY DAMAGE TO PUBLIC RIGHTS-OF-WAYS OR PAVING WILL BE CORRECTED AT THE CONTRACTOR'S EXPENSE.
  - 5) CONTRACTOR TO NOTIFY THE HOWARD COUNTY INSPECTION AND SURVEY DIVISION AT LEAST 3 DAYS BEFORE STARTING WORK SHOWN ON THESE DRAWINGS - TELEPHONE: 786-7272

APPROVED  
 DEPARTMENT OF PUBLIC WORKS

*William E. O'Connell*  
 DATE 9-10-84  
 CHIEF, BUREAU OF ENGINEERING

APPROVED  
 OFFICE OF PLANNING AND ZONING

*John W. Buchanan*  
 DATE 9-1-84  
 CHIEF, DIVISION OF LAND DEVELOPMENT AND ZONING ADMINISTRATION

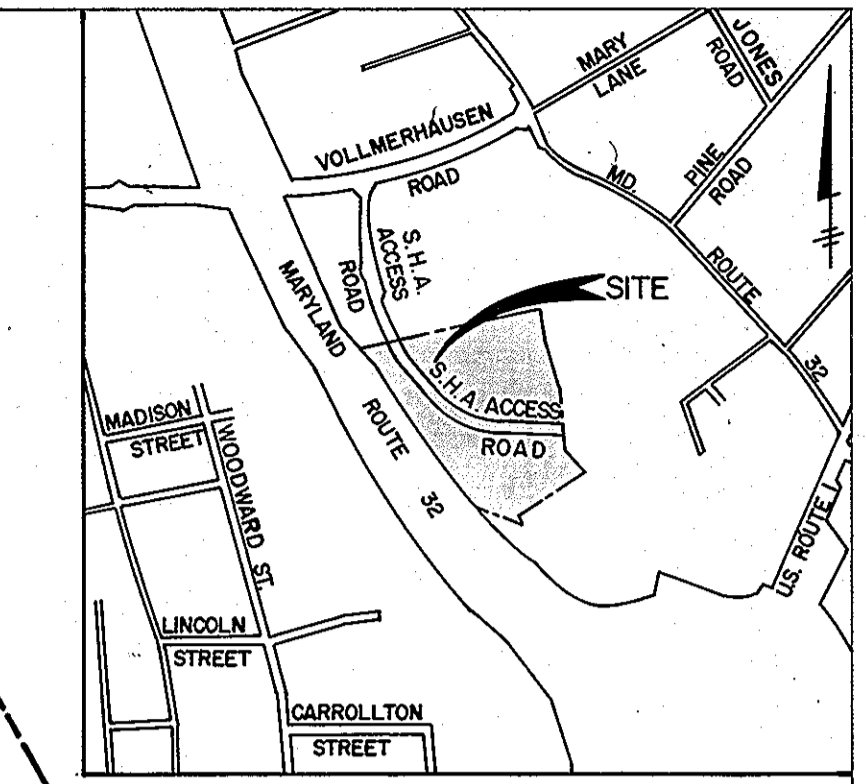
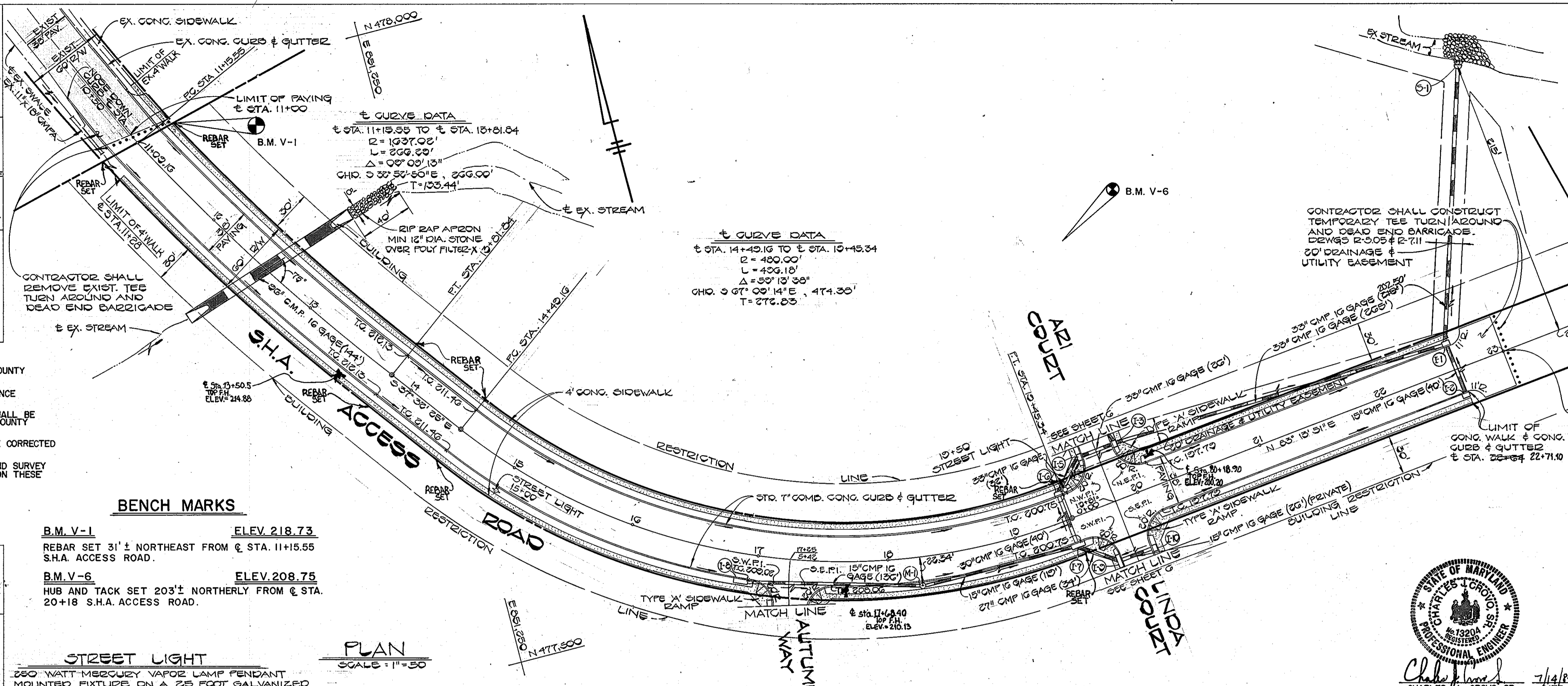

**AUTUMN WOODS**  
 SIXTH ELECTION DISTRICT  
 HOWARD COUNTY, MARYLAND

**S.H.A. ACCESS ROAD**  
 PLAN AND PROFILE

OWNER AND DEVELOPER  
**AUTUMN WOODS LIMITED PARTNERSHIP**  
 8930 BALTIMORE STREET  
 SAVAGE, MARYLAND 20863

SCALE AS SHOWN DATE 7/11/84 DWG. NO. 1 OF 6  
 DES. C. CROVO DRN. D.S.P. CHK. R. B. CARTER

**FISHER, COLLINS AND CARTER, INC.**  
 CIVIL ENGINEERS AND LAND SURVEYORS  
 8388 COURT AVE. ELLICOTT CITY, MARYLAND 21043

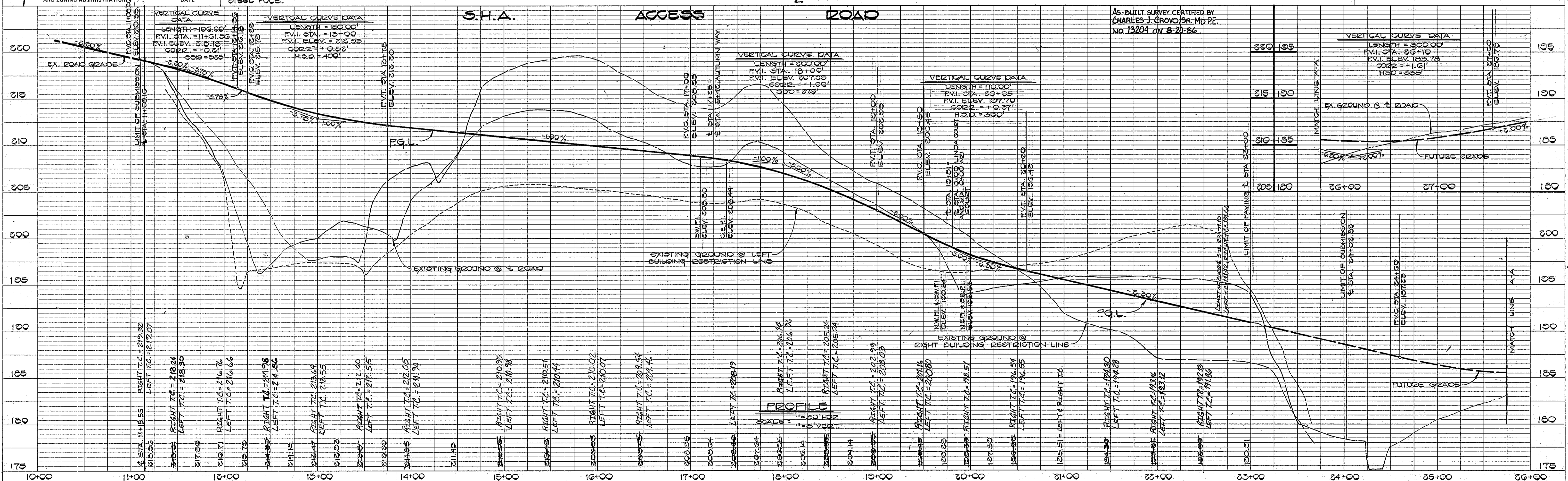

DATE \_\_\_\_\_  
 BY \_\_\_\_\_  
 SURVEYED \_\_\_\_\_  
 PLOTTED \_\_\_\_\_  
 NOTE BOOK \_\_\_\_\_  
 CHECKED \_\_\_\_\_  
 REV. OF WAY CHECKED \_\_\_\_\_

DATE \_\_\_\_\_  
 BY \_\_\_\_\_  
 SURVEYED \_\_\_\_\_  
 PLOTTED \_\_\_\_\_  
 NOTE BOOK \_\_\_\_\_  
 CHECKED \_\_\_\_\_  
 STRUCTURE NOTATION CHFD \_\_\_\_\_

1083



DATE  
BY  
SURVEYED  
PLOTTED  
NOTE BOOK NO.  
CHECKED  
BY  
CHECKED  
BY

DATE  
BY  
SURVEYED  
PLOTTED  
NOTE BOOK NO.  
CHECKED  
BY  
CHECKED  
BY

**S.H.A. ACCESS ROAD**

± STA. 11+55 TO ± STA. 23+00

TYPE OF TRAFFICWAY  
MINOR COLLECTOR

DESIGN SPEED  
35 M.P.H.

ZONED  
RSA

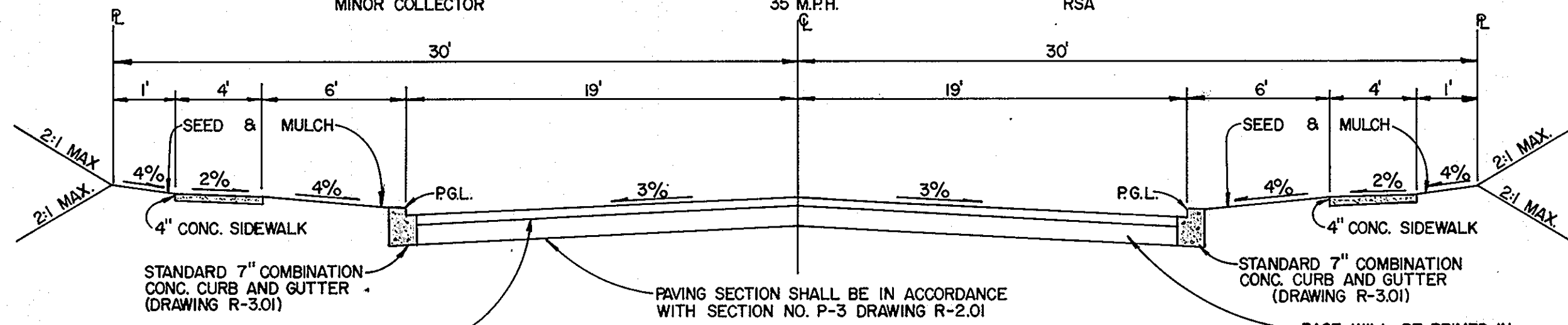

TACK COAT IN ACCORDANCE WITH HOWARD CO. DESIGN MANUAL VOLUME IV.

NOTE: ALL MATERIALS AND CONSTRUCTION SHALL BE IN ACCORDANCE WITH THE HOWARD COUNTY DESIGN MANUAL-VOLUME IV-STANDARD SPECIFICATIONS AND DETAILS FOR CONSTRUCTION.

BASE WILL BE PRIMED IN ACCORDANCE WITH HOWARD COUNTY DESIGN MANUAL VOLUME IV.

**TYPICAL SECTION**

NO SCALE

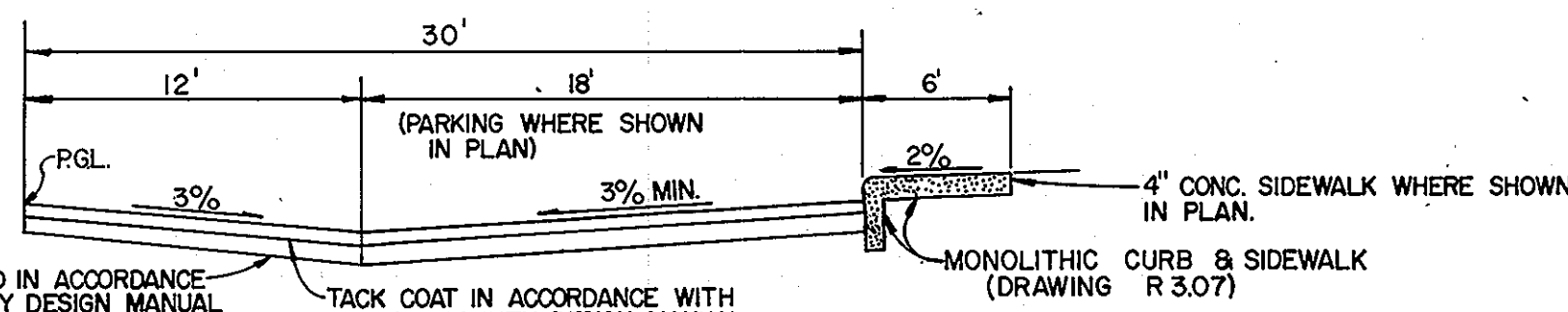

BASE WILL BE PRIMED IN ACCORDANCE WITH HOWARD COUNTY DESIGN MANUAL VOLUME IV.

TACK COAT IN ACCORDANCE WITH HOWARD COUNTY DESIGN MANUAL VOLUME IV.

PAVING SECTION SHALL BE IN ACCORDANCE WITH SECTION NUMBER P-1 DRWG R-2.01

**TYPICAL HALF SECTION-PARKING ADJACENT TO PRIVATE ROAD**

NO SCALE

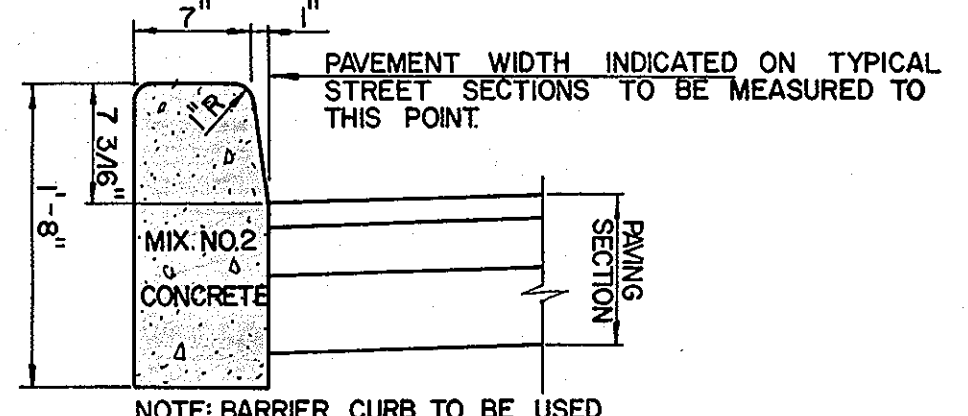

**STANDARD BARRIER CURB**

NO SCALE

NOTE: LONGITUDINAL JOINT BETWEEN SIDEWALK AND CURB SHALL BE CONTINUOUS AND TO A DEPTH OF 1/4" THE SIDEWALK THICKNESS OR 1" MAX LATTITUDINAL JOINTS SHALL RUN FROM BACK EDGE OF SIDEWALK CONTINUOUS TO THE BOTTOM FACE OF CURB TO A DEPTH OF 1/4" AND SPACED 5' APART.

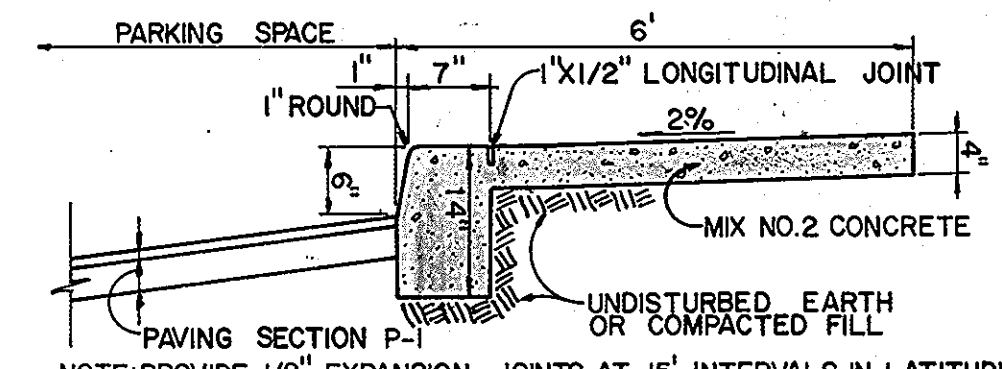

**MONOLITHIC CURB & SIDEWALK PRIVATE PARKING AREA**

NO SCALE

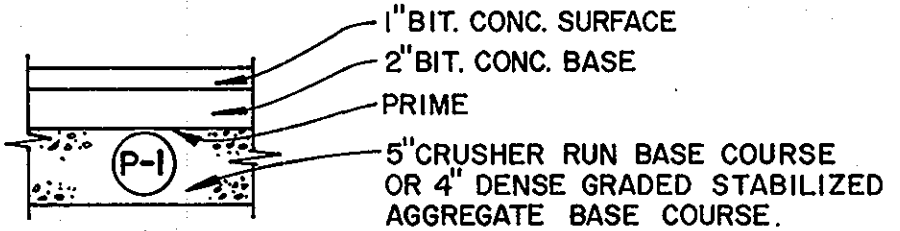

**PAVING SECTION P-1**

NO SCALE

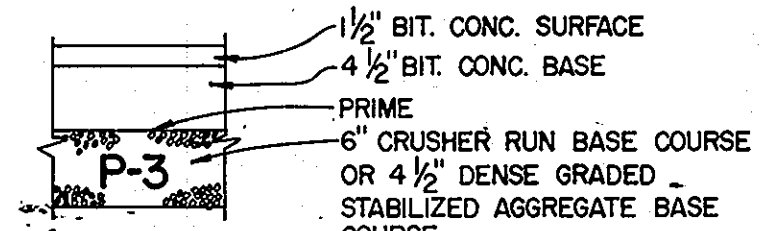

**PAVING SECTION P-3**

NO SCALE



Charles J. Crovo, Sr. 7/14/84  
DATE

**AUTUMN WOODS**

SIXTH ELECTION DISTRICT  
HOWARD COUNTY, MARYLAND

LINDA COURT & AUTUMN WAY PROFILES

TYPICAL ROAD SECTIONS AND DETAILS

OWNER AND DEVELOPER  
AUTUMN WOODS LIMITED PARTNERSHIP  
8930 BALTIMORE STREET  
SAVAGE, MARYLAND 20863

SCALE AS SHOWN DATE 7/11/84 DWG. NO. 2 OF 6  
DES. C. GROVO DRN. D. S. P CHK. R.B. CARTER

FISHER, COLLINS AND CARTER, INC.  
CIVIL ENGINEERS AND LAND SURVEYORS  
8388 COURT AVE. ELLICOTT CITY, MARYLAND 21043

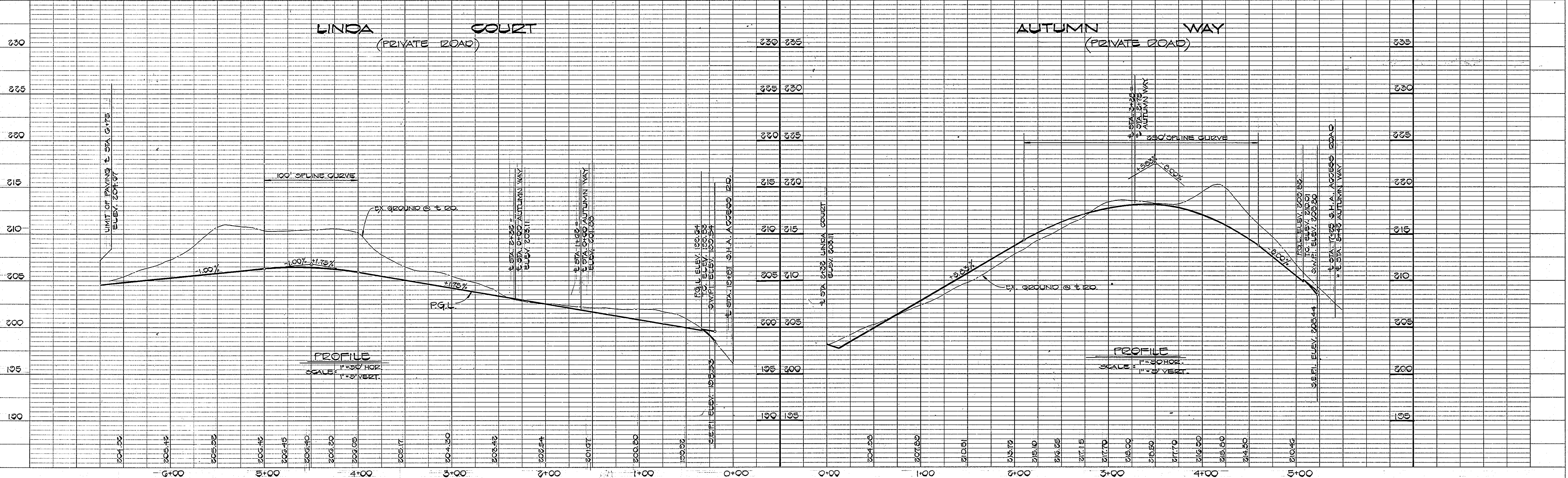

**PROFILE**

SCALE: 1"=30' HORZ  
1"=5' VERT.

**PROFILE**

SCALE: 1"=30' HORZ  
1"=5' VERT.

#1083

PLAN	SURVEYED	DATE
NOTE BOOK	PLOTTED	BY
NO.	FILED	
	NO. OF SHEETS	
	NO. CHECKED	
	NO. OF WORK CHECKED	

APPROVED  
DEPARTMENT OF PUBLIC WORKS  
*William E. Ryan* 9-10-84  
CHIEF, BUREAU OF ENGINEERS DATE

APPROVED  
OFFICE OF PLANNING AND ZONING  
*John W. Murchman* 9-4-84  
CHIEF, DIVISION OF LAND DEVELOPMENT AND ZONING ADMINISTRATION DATE

**AUTUMN WOODS**  
SIXTH ELECTION DISTRICT  
HOWARD COUNTY, MARYLAND

**ARI COURT & AUTUMN WAY**

PROFILES

OWNER AND DEVELOPER  
AUTUMN WOODS LIMITED PARTNERSHIP  
8930 BALTIMORE STREET  
SAVAGE, MARYLAND 20863

SCALE AS SHOWN DATE 7/11/84 DWG. NO. 3 OF 6  
DES. C. GROVO DRW. G.S.P. CHK. R.B. CARTER

FISHER, COLLINS AND CARTER, INC.  
CIVIL ENGINEERS AND LAND SURVEYORS  
8388 COURT AVE. ELLICOTT CITY, MARYLAND 21043



PROFILE	SURVEYED	DATE
NOTE BOOK	PLOTTED	BY
NO.	FILED	
	NO. OF SHEETS	
	NO. CHECKED	
	NO. OF WORK CHECKED	

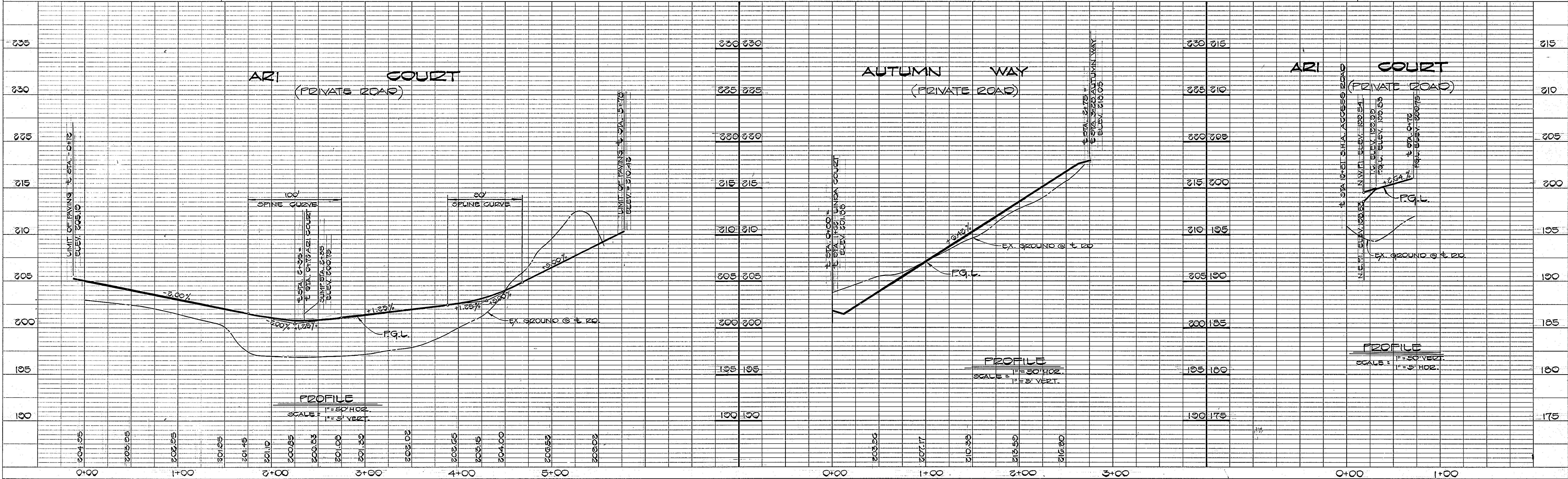

#1083



STRUCTURE SCHEDULE

NO.	TYPE	INVERT IN	INVERT OUT	¢ TOP ELEV.	¢ STATION	REMARKS
I-1	A-5 WITH DEFLECTORS	186.86.55	184.74.62	191.74.53	22+440 S.H.A. ACCESS RD.	DRWGS. SD. 4.01 & SD. 4.83
I-2	A-5 WITH DEFLECTORS	—	187.86.45	191.74.72	22+614 S.H.A. ACCESS RD.	DRWGS. SD. 4.01 & SD. 4.83
I-3	A-5 WITH DEFLECTORS	192.80.27	189.74.14	200.75.04	0+42 ARI COURT	DRWGS. SD. 4.01 & SD. 4.83
I-4	A-5	—	196.75	200.94	2+35 ARI COURT	DRWG. SD. 4.01
I-5	A-5 WITH DEFLECTORS	191.97.15	190.85.29	200.75.00	0+42 ARI COURT	DRWGS. SD. 4.01 & SD. 4.83
I-6	A-5 WITH DEFLECTORS	191.83.68	191.77.52	200.75.00	19+435 S.H.A. ACCESS RD.	DRWGS. SD. 4.01 & SD. 4.83
I-7	A-10 WITH DEFLECTORS	194.56.25	192.52.21	200.75.00	19+435 S.H.A. ACCESS RD.	DRWGS. SD. 4.02 & SD. 4.83
I-8	A-10	—	204.75.53	200.07	16+875 S.H.A. ACCESS RD.	DRWG. SD. 4.02
I-9	A-10	195.76	194.79.91	200.01	0+4450 LINDA COURT	DRWG. SD. 4.02
I-10	A-5 WITH DEFLECTORS	—	195.93	200.01	0+4450 LINDA COURT	DRWGS. SD. 4.01 & SD. 4.83
I-11	A-5 WITH DEFLECTORS	197.01	196.70	202.23	1+8200 LINDA COURT	DRWGS. SD. 4.01 & SD. 4.83
I-12	A-10 WITH DEFLECTORS	198.66	198.16	203.57	0+2250 AUTUMN WAY	DRWGS. SD. 4.02 & SD. 4.83
I-13	A-10	199.39	198.89	203.69	2+5450 LINDA COURT	DRWG. SD. 4.02
I-14	D *	—	201.42	205.00	—	DRWG. SD. 4.11
I-15	A-5	—	199.50	204.30	—	DRWG. SD. 4.01
M-1	STANDARD MANHOLE	199.76.22	199.24.11	206.37.40	18+2200 S.H.A. ACCESS RD.	DRWG. 6 5.01
S-1	STANDARD METAL END SECTION	—	78.93	181.68	—	DRWG. SD. 5.61
S-2	STANDARD METAL END SECTION	—	174.75	176.00	—	DRWG. SD. 5.61

\* INLET I-14 TO HAVE OPENINGS ON ALL 4 SIDES

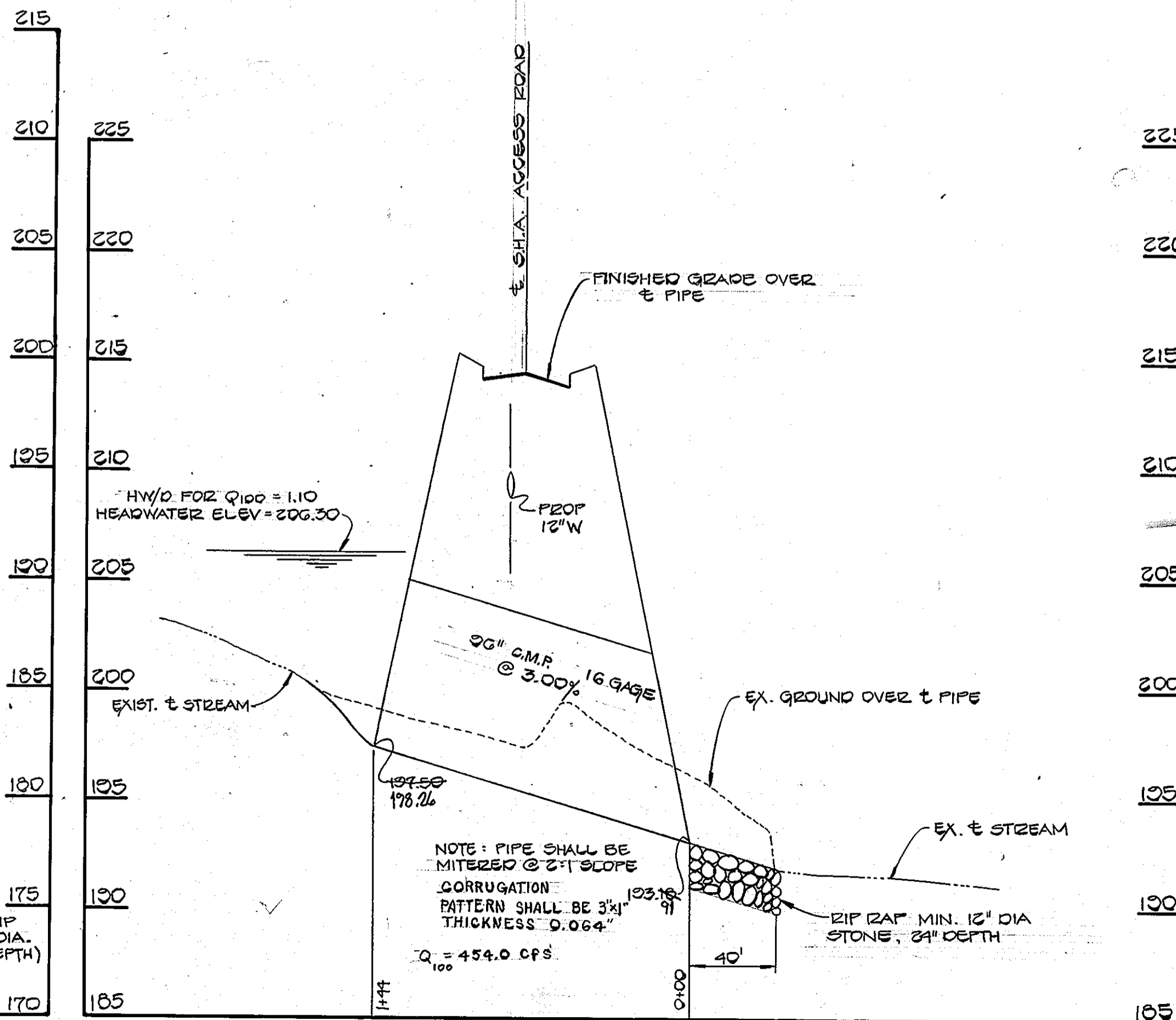
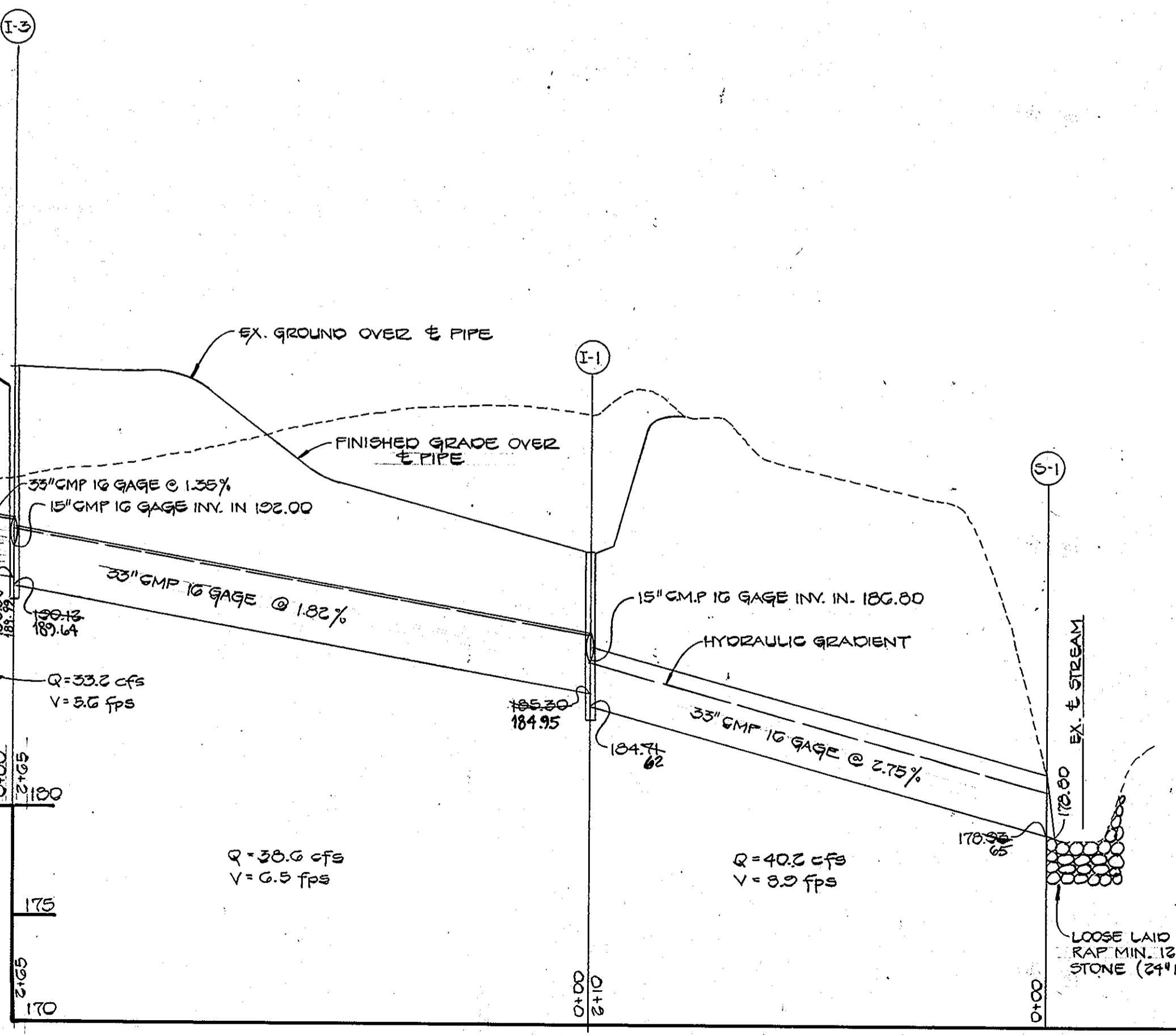
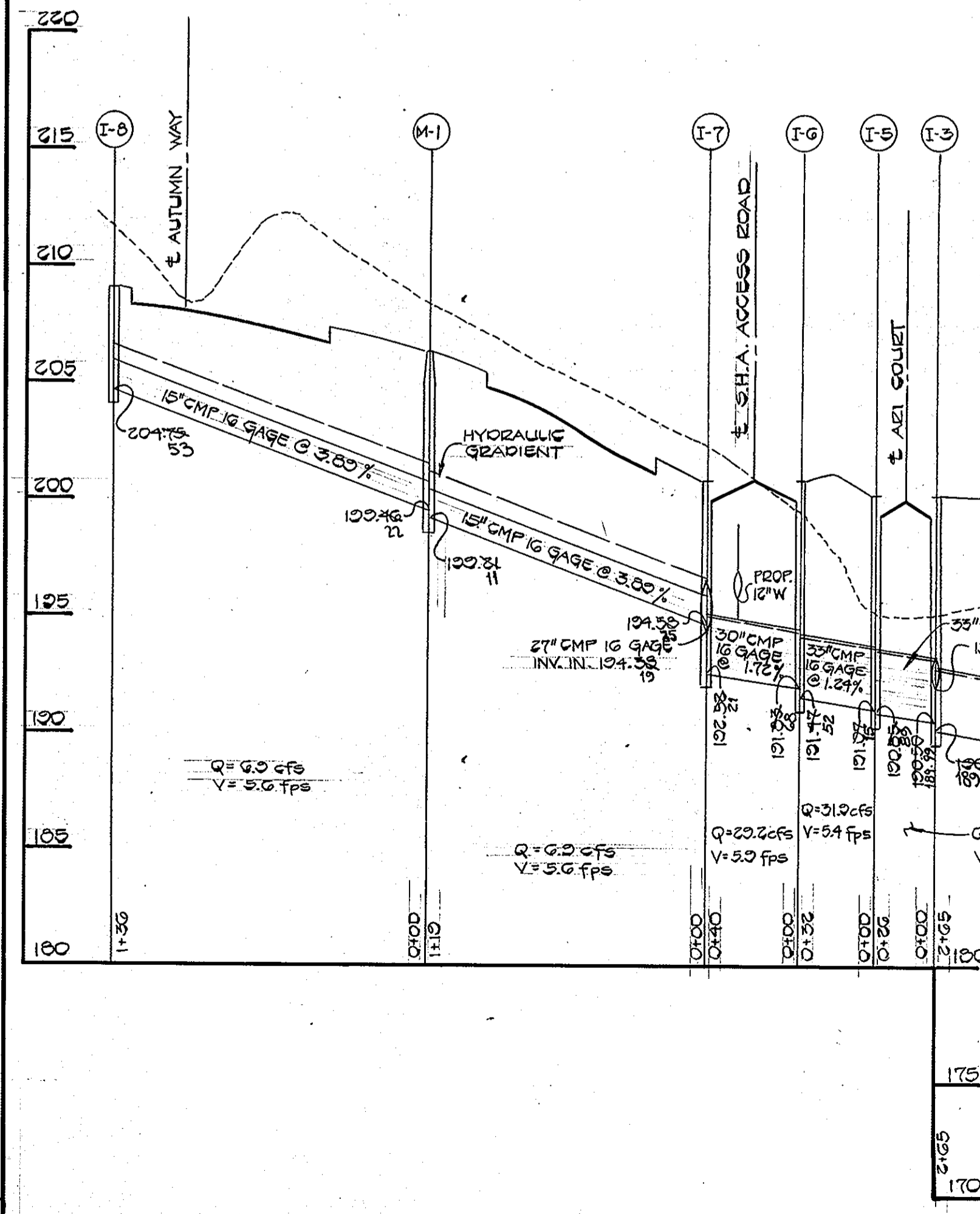
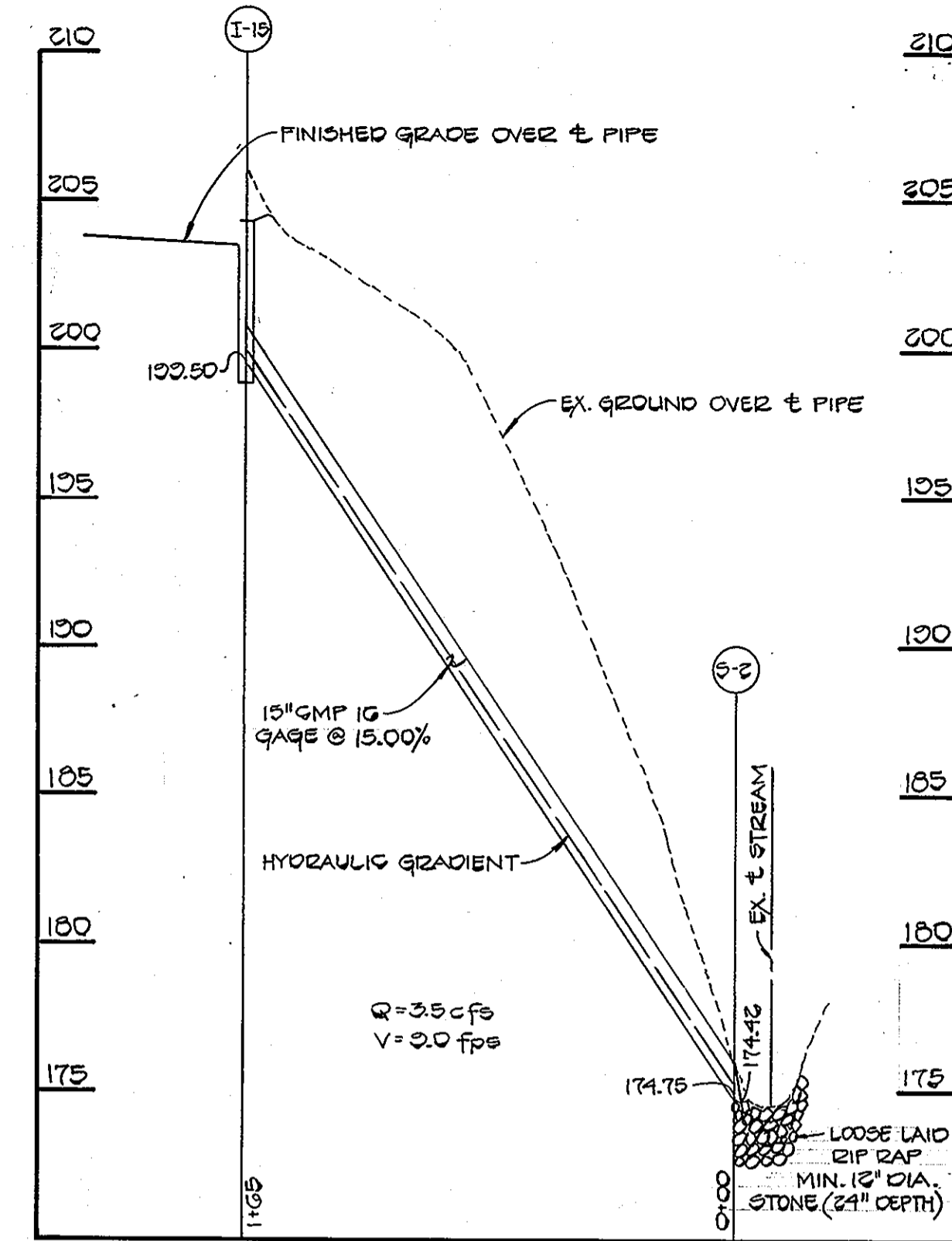
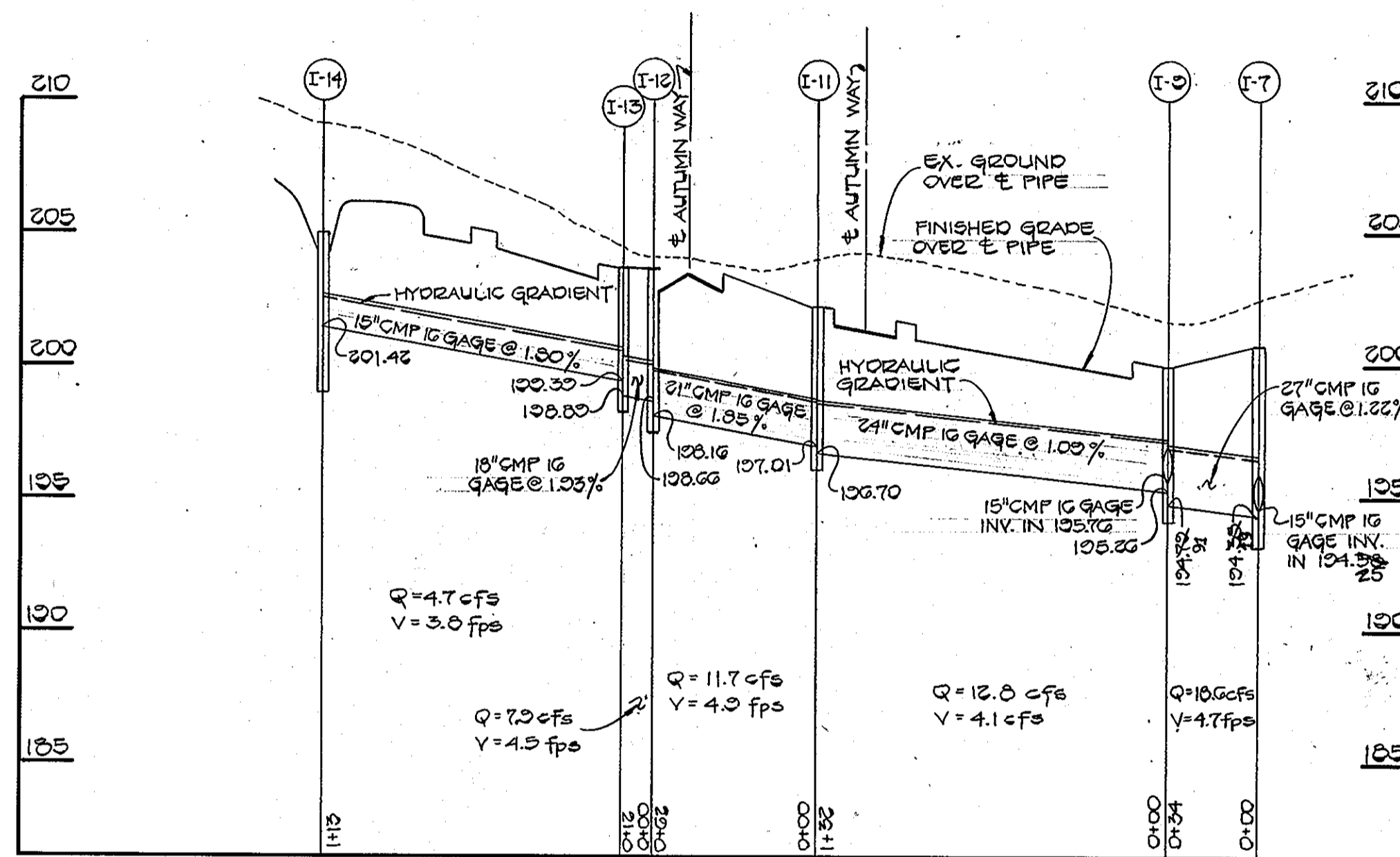
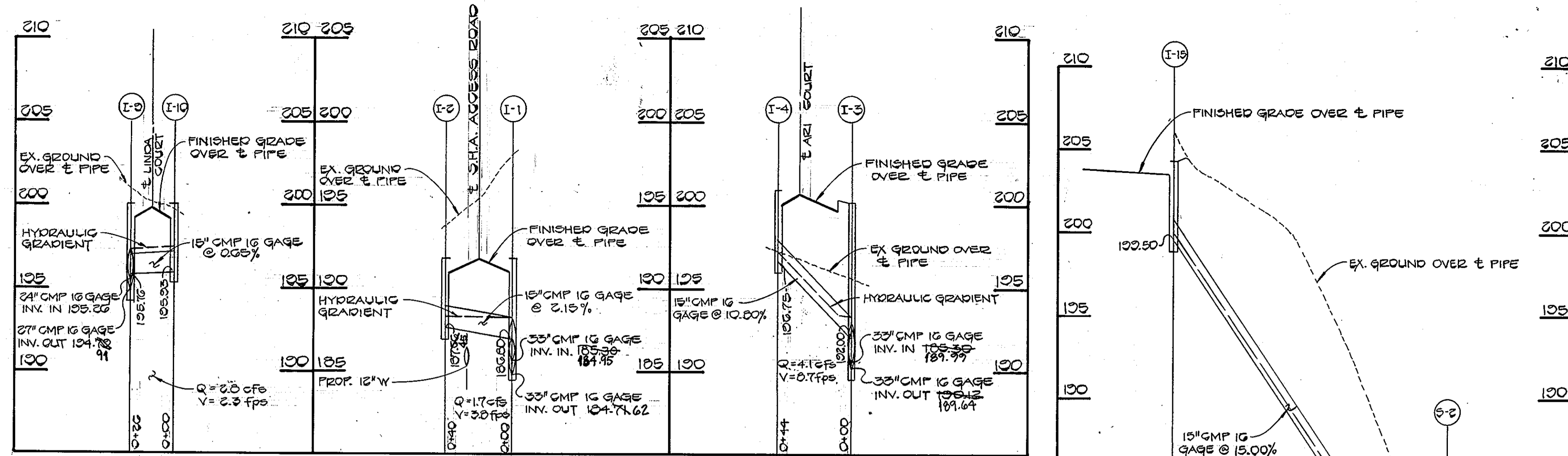

APPROVED  
DEPARTMENT OF PUBLIC WORKS  
*Charles J. Crovo, Sr.* 9-16-84  
CHIEF, BUREAU OF ENGINEERING DATE

APPROVED  
OFFICE OF PLANNING AND ZONING  
*John W. Muehman* 9-14-84  
CHIEF, DIVISION OF LAND DEVELOPMENT AND ZONING ADMINISTRATION DATE

AS-BUILT SURVEY CERTIFIED BY  
CHARLES J. CROVO, SR., M.D. P.E.  
NO. 13204 ON 8-20-86.

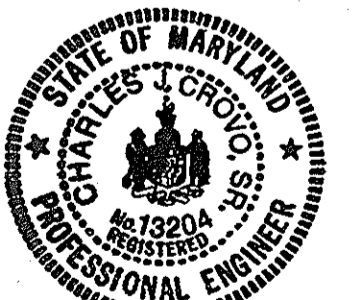

*Charles J. Crovo, Sr.* 7/14/84  
CHARLES J. CROVO, SR. DATE

OWNER AND DEVELOPER  
AUTUMN WOODS LIMITED PARTNERSHIP  
8930 BALTIMORE STREET  
SAVAGE, MARYLAND 20863

STORM DRAIN PROFILES  
AUTUMN WOODS  
SIXTH ELECTION DISTRICT  
HOWARD COUNTY, MARYLAND

SCALE: AS SHOWN JULY 11, 1984  
TAX MAP 47 SHEET 4 OF 6 PARCEL 493

FISHER, COLLINS, AND CARTER, INC.  
CONSULTING ENGINEERS AND LAND SURVEYORS  
8388 COURT AVENUE  
ELLIOTT CITY, MARYLAND 21043  
TELEPHONE: (301) 461-2855

PROFILES  
SCALE: 1" = 50' HORIZ  
1" = 5' VERT

REV. 10-30-84.

AS-BUILT 8-20-86

F85-19



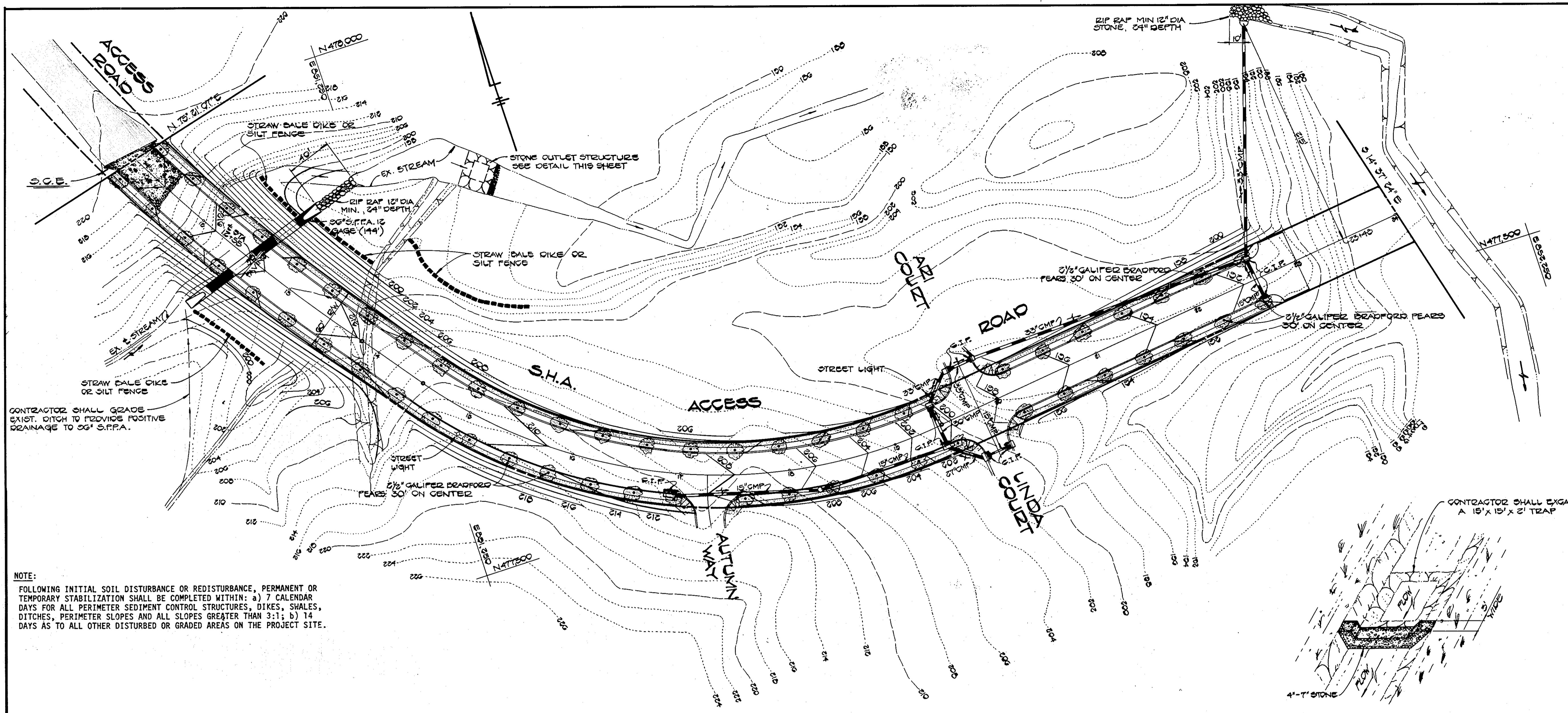

**NOTE:**  
 FOLLOWING INITIAL SOIL DISTURBANCE OR REDISTURBANCE, PERMANENT OR TEMPORARY STABILIZATION SHALL BE COMPLETED WITHIN: a) 7 CALENDAR DAYS FOR ALL PERIMETER SEDIMENT CONTROL STRUCTURES, DIKES, SHALES, DITCHES, PERIMETER SLOPES AND ALL SLOPES GREATER THAN 3:1; b) 14 DAYS AS TO ALL OTHER DISTURBED OR GRADED AREAS ON THE PROJECT SITE.

FISHER, COLLINS, AND CARTER, INC.  
 CONSULTING ENGINEERS AND LAND SURVEYORS  
 8388 COURT AVENUE  
 ELLICOTT CITY, MARYLAND 21043  
 TELEPHONE: (301) 461-2855

- SEDIMENT CONTROL NOTES**
- SPECIFICATIONS FOR THE SEDIMENT CONTROL DETAILS INCLUDED IN THE U.S.D.A. SOIL CONSERVATION SERVICE "STANDARDS AND SPECIFICATIONS FOR SOIL EROSION AND SEDIMENT CONTROL IN DEVELOPING AREAS."
  - THE DEVELOPER SHALL NOTIFY THE HOWARD COUNTY OFFICE OF INSPECTION AND PERMITS AT LEAST 24 HOURS PRIOR TO BEGINNING ANY CONSTRUCTION SHOWN HEREON.
  - SEDIMENT CONTROL STRUCTURES TO BE CONSTRUCTED PRIOR TO ANY ON-SITE GRADING OR DISTURBANCE TO ANY EXISTING SURFACE MATERIAL, AND ARE TO BE STABILIZED AS SOON AS CONSTRUCTED.
  - ALL SEDIMENT CONTROL STRUCTURES TO REMAIN IN PLACE UNTIL PERMISSION FOR THEIR REMOVAL HAS BEEN OBTAINED FROM THE HOWARD COUNTY OFFICE OF INSPECTION AND PERMITS.
  - ALL GRADED AREAS NOT TO BE SODDED SHALL BE STABILIZED BY SEEDING AND MULCHING IN ACCORDANCE WITH THE FOLLOWING:
    - SITE PREPARATION
      - HARROW OR DISC IN AREAS PROPOSED TO BE SEEDING THE FOLLOWING MATERIALS:
        - PULVERIZED LIMESTONE AT 2 TONS/ACRE.
        - COMMERCIAL FERTILIZER 10-10-10 AT 3/4 TONS/ACRE.
        - SUPER PHOSPHATE AT 600 LBS./ACRE.
    - SEEDING
      - SOW THE FOLLOWING SEED MIXTURE AT THE RATE OF 200 LBS./ACRE WITH A MECHANICAL SPREADER:
        - TEMPORARY: ITALIAN OR PERENNIAL RYE GRASS
        - PERMANENT: 40% MARION BLUE GRASS, 40% DAKOTA BLUE GRASS AND 20% PENN LAWN CREEPING FESCUE.
      - THE SEEDING AREA SHALL THEN BE RAKED WITH A YORK RATE (A MINIMUM OF 2 PASSES) COVERED AND COMPACTED WITH CULTIPACKER OR OTHER APPROVED METHOD.
    - MULCHING
      - SEEDING AREAS SHALL BE UNIFORMLY MULCHED IMMEDIATELY AFTER SEEDING WITH UNWEATHERED SMALL GRAIN STRAW AT THE RATE OF 1 1/2-2 TONS/ACRE.
      - TIE MULCH DOWN WITH LIQUID ASPHALT AT 0.1 GAL./S.Y. OR EMULSIFIED ASPHALT AT 0.04 GAL./S.Y. OR MULCH NETTING.
  - A GRADING PLAN MUST BE DEVELOPED BY THE BUILDER AND APPROVED BEFORE BEGINNING CONSTRUCTION OF DWELLINGS.

**PLAN**  
 SCALE: 1" = 50'

**STABILIZED CONSTRUCTION ENTRANCE**  
 not to scale

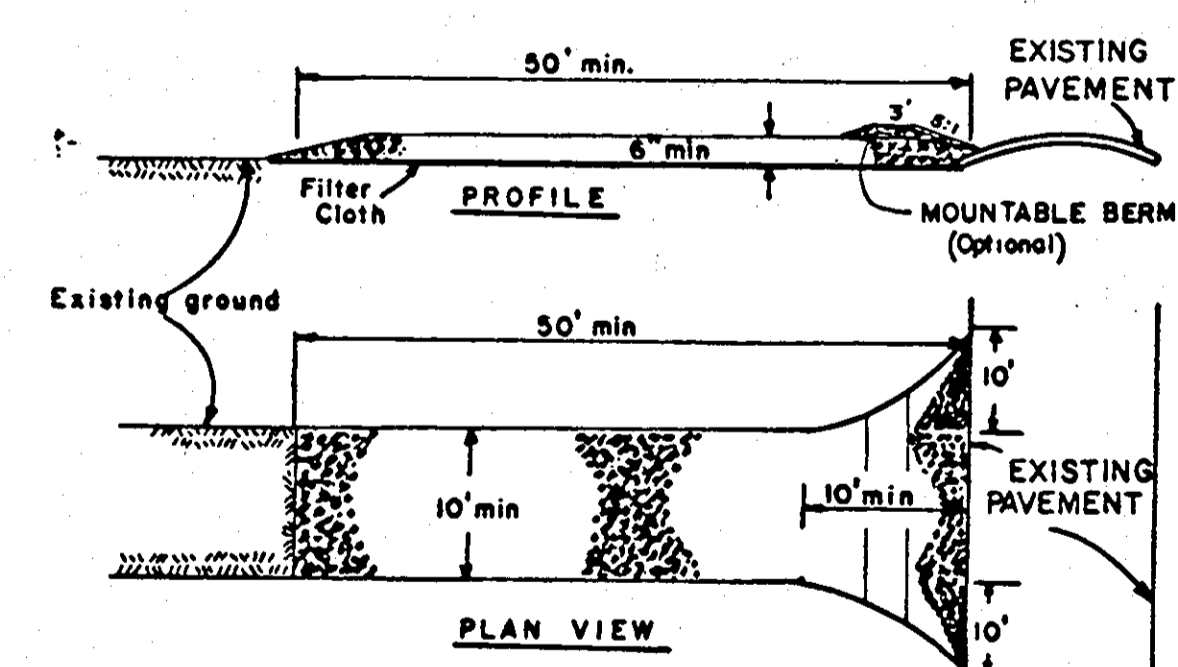

**CURB INLET PROTECTION DETAIL**

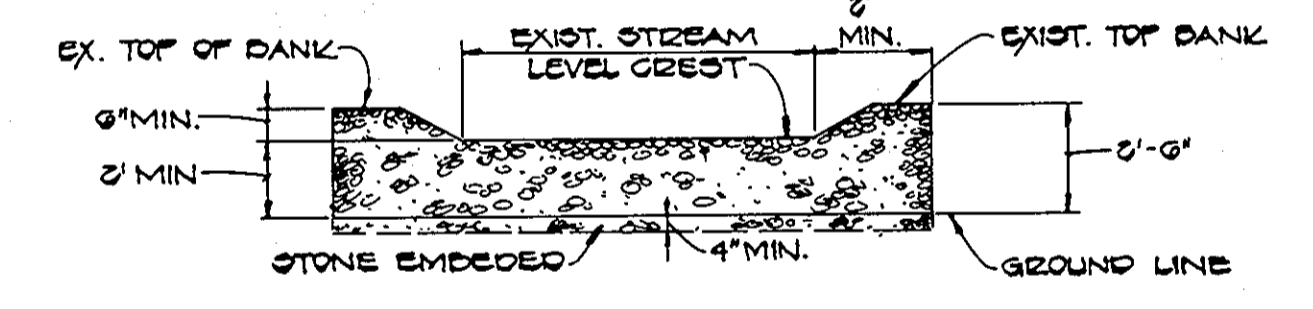
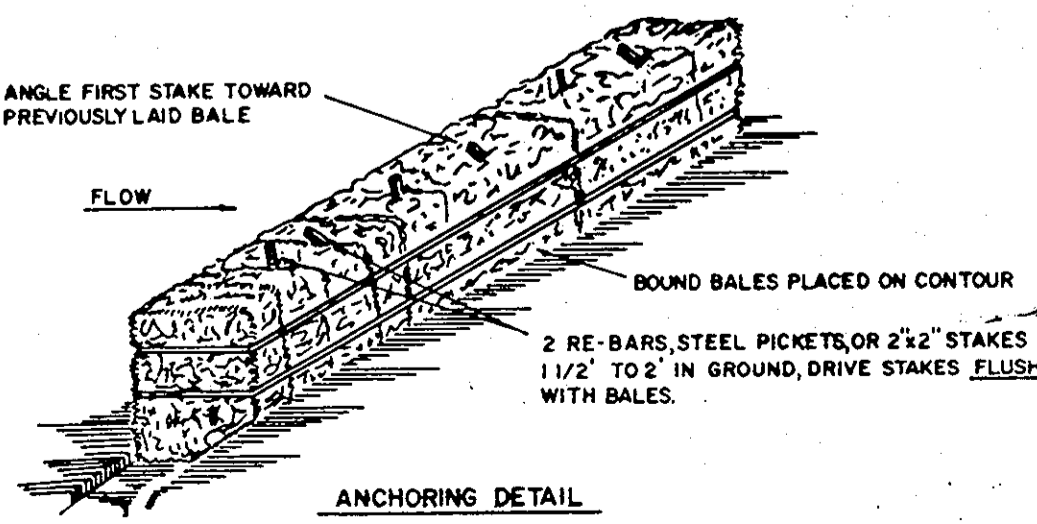
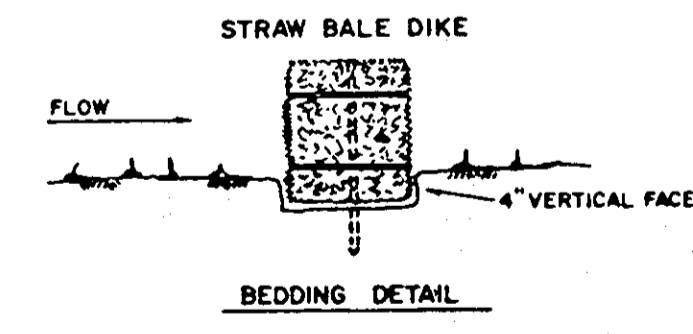
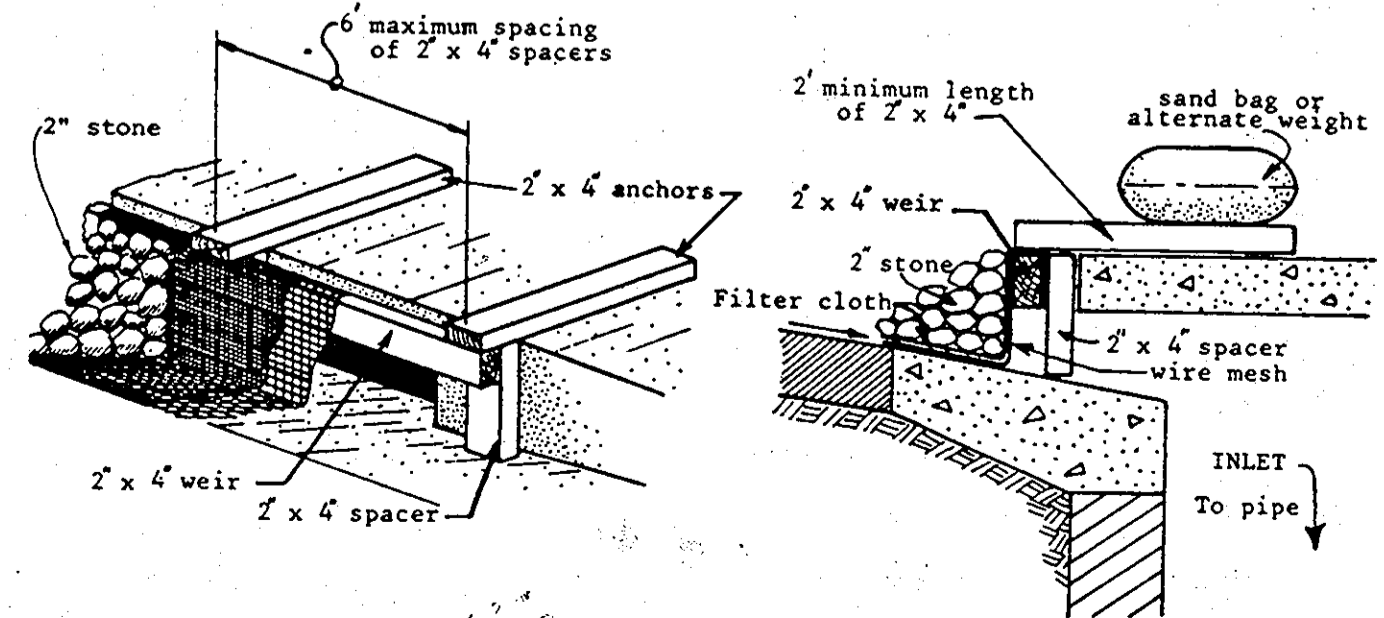

**STONE OUTLET STRUCTURE DETAIL**  
 NO SCALE

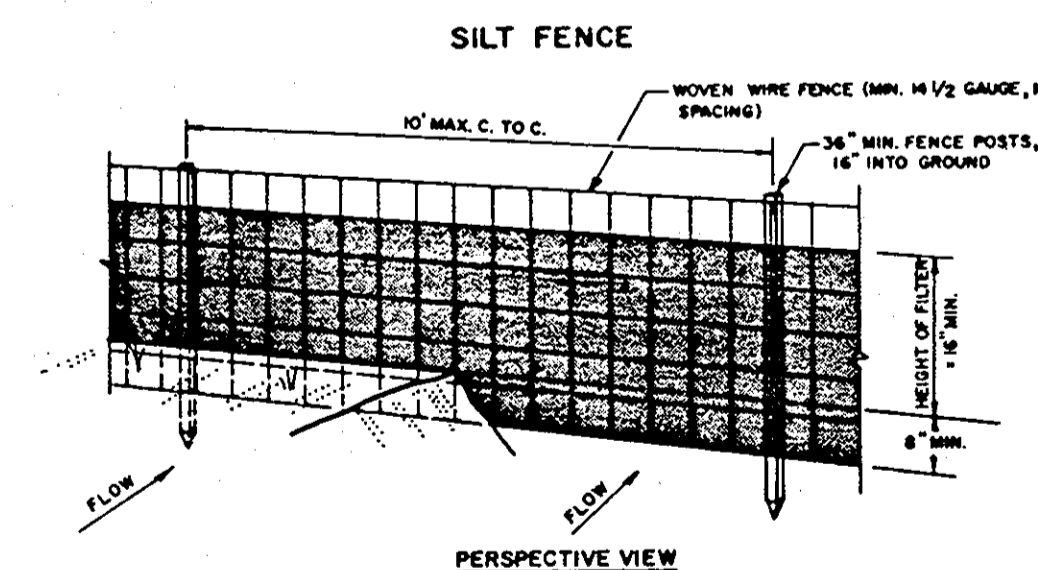

**PERSPECTIVE VIEW**

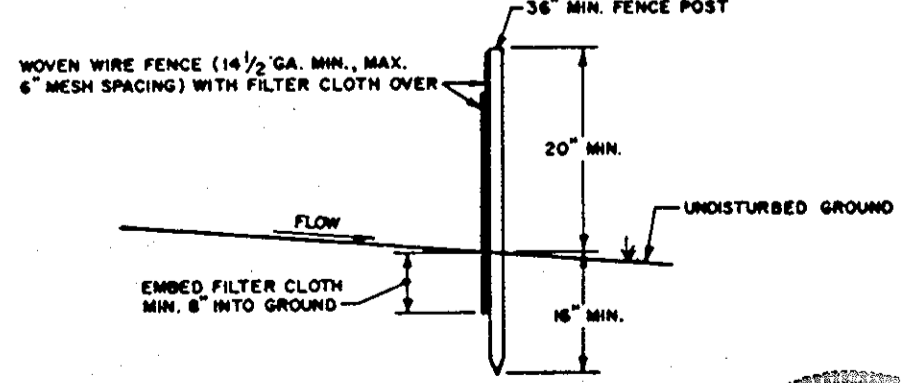

**SECTION**

**ENGINEER'S CERTIFICATE**  
 I HEREBY CERTIFY THAT THIS PLAN FOR EROSION AND SEDIMENT CONTROL REPRESENTS A PRACTICAL AND WORKABLE PLAN BASED ON MY PERSONAL KNOWLEDGE OF THE SITE CONDITIONS AND THAT IT WAS PREPARED IN ACCORDANCE WITH THE REQUIREMENTS OF THE HOWARD SOIL CONSERVATION DISTRICT.  
 SIGNATURE: *Charles J. Crovi, Sr.* DATE: 7/14/84

**DEVELOPER'S CERTIFICATE**  
 I/WE CERTIFY THAT ALL DEVELOPMENT AND CONSTRUCTION WILL BE DONE ACCORDING TO THIS PLAN OF DEVELOPMENT AND PLAN FOR EROSION AND SEDIMENT CONTROL AND THAT ALL RESPONSIBLE PERSONNEL INVOLVED IN THE CONSTRUCTION PROJECT WILL HAVE A CERTIFICATE OF ATTENDANCE AT A DEPARTMENT OF NATURAL RESOURCES APPROVED TRAINING PROGRAM FOR THE CONTROL OF SEDIMENT AND EROSION BEFORE BEGINNING THE PROJECT. I ALSO AUTHORIZE PERIODIC ON-SITE INSPECTION BY THE HOWARD SOIL CONSERVATION DISTRICT OR THEIR AUTHORIZED AGENTS, AS ARE DEEMED NECESSARY.  
 SIGNATURE OF DEVELOPER: *Robert W. Zichus* DATE: 9-5-84  
 REVIEWED FOR HOWARD COUNTY SOIL CONSERVATION DISTRICT AND MEETS TECHNICAL REQUIREMENTS.  
 SIGNATURE: *John M. Decker* DATE: 9-5-84  
 I, B. SOIL CONSERVATION SERVICE DATE: 9-5-84  
 THIS DEVELOPMENT IS APPROVED FOR EROSION AND SEDIMENT CONTROL BY THE HOWARD SOIL CONSERVATION DISTRICT.  
 APPROVED: *Robert W. Zichus* DATE: 9-5-84  
 DISTRICT: HOWARD SOIL CONSERVATION DISTRICT  
 APPROVED: DEPARTMENT OF PUBLIC WORKS FOR PUBLIC WATER AND SEWER AND STORM DRAINAGE SYSTEMS AND ROADS.  
 SIGNATURE: *John M. Decker* DATE: 9-10-84  
 CHIEF, BUREAU OF ENGINEERING  
 APPROVED: OFFICE OF PLANNING AND ZONING  
 SIGNATURE: *John M. Decker* DATE: 9-4-84  
 CHIEF, DIVISION OF LAND DEVELOPMENT AND ZONING ADMINISTRATION

**OWNER AND DEVELOPER**  
 AUTUMN WOODS LIMITED PARTNERSHIP  
 8930 BALTIMORE STREET  
 SAVAGE, MARYLAND 20863

**STREET TREE, GRADING, AND SEDIMENT CONTROL PLAN**  
 AUTUMN WOODS  
 SIXTH ELECTION DISTRICT  
 HOWARD COUNTY, MARYLAND



SCALE: 1" = 50'  
 TAX MAP 47 SHEET 5 OF 6 PARCEL 493  
 JULY 11, 1984



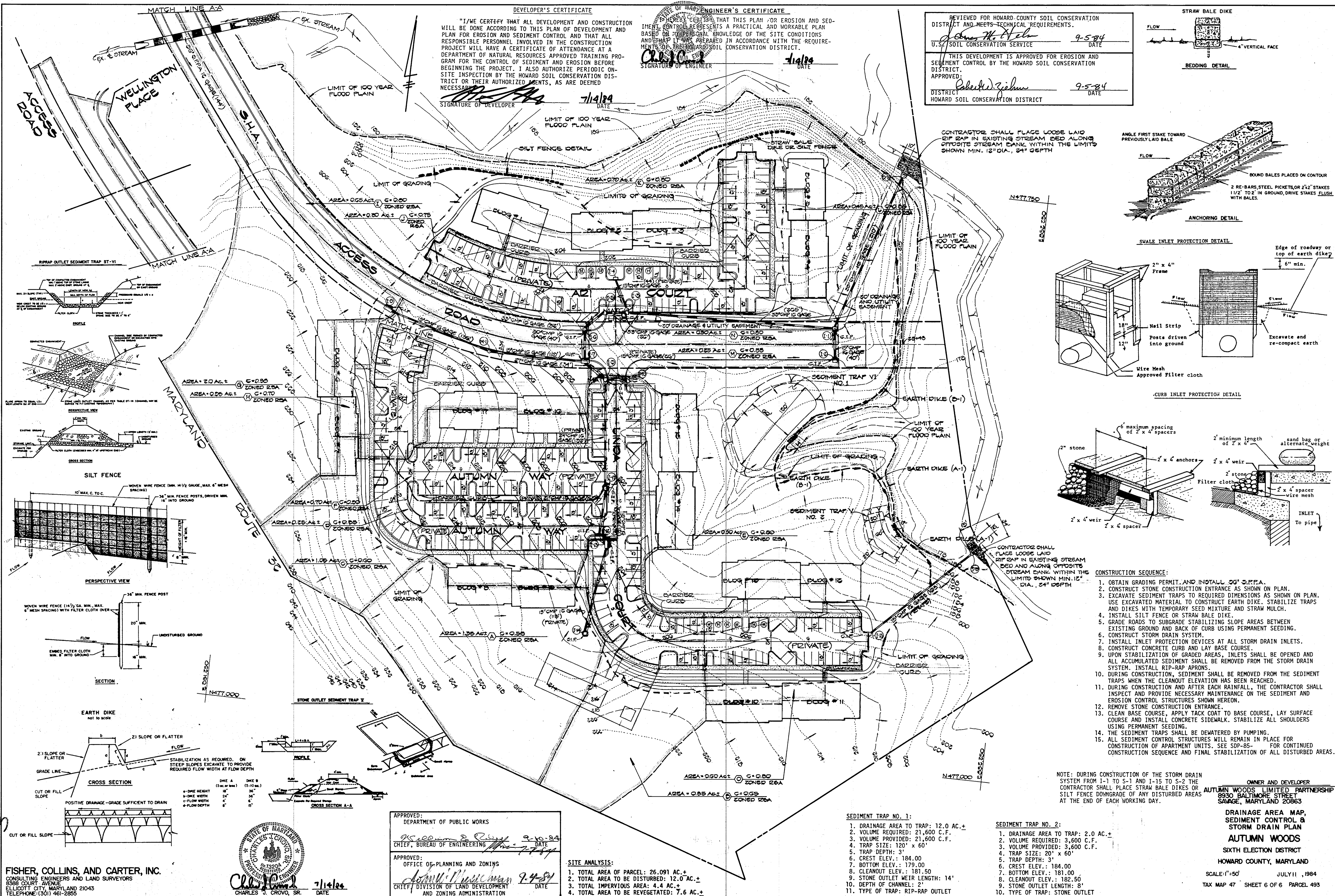

**DEVELOPER'S CERTIFICATE**  
 "I/WE CERTIFY THAT ALL DEVELOPMENT AND CONSTRUCTION WILL BE DONE ACCORDING TO THIS PLAN OF DEVELOPMENT AND PLAN FOR EROSION AND SEDIMENT CONTROL AND THAT ALL RESPONSIBLE PERSONNEL INVOLVED IN THE CONSTRUCTION PROJECT WILL HAVE A CERTIFICATE OF ATTENDANCE AT A DEPARTMENT OF NATURAL RESOURCES APPROVED TRAINING PROGRAM FOR THE CONTROL OF SEDIMENT AND EROSION BEFORE BEGINNING THE PROJECT. I ALSO AUTHORIZE PERIODIC ON-SITE INSPECTION BY THE HOWARD SOIL CONSERVATION DISTRICT OR THEIR AUTHORIZED AGENTS, AS ARE DEEMED NECESSARY."  
 SIGNATURE OF DEVELOPER: *[Signature]* DATE: 7/14/84

**ENGINEER'S CERTIFICATE**  
 "I HEREBY CERTIFY THAT THIS PLAN FOR EROSION AND SEDIMENT CONTROL REPRESENTS A PRACTICAL AND WORKABLE PLAN BASED ON MY PERSONAL KNOWLEDGE OF THE SITE CONDITIONS AND THAT IT WAS PREPARED IN ACCORDANCE WITH THE REQUIREMENTS OF THE HOWARD SOIL CONSERVATION DISTRICT."  
 SIGNATURE OF ENGINEER: *[Signature]* DATE: 7/14/84

REVIEWED FOR HOWARD COUNTY SOIL CONSERVATION DISTRICT AND MEETS TECHNICAL REQUIREMENTS.  
 SIGNATURE: *[Signature]* DATE: 9-5-84  
 U.S. SOIL CONSERVATION SERVICE  
 THIS DEVELOPMENT IS APPROVED FOR EROSION AND SEDIMENT CONTROL BY THE HOWARD SOIL CONSERVATION DISTRICT.  
 SIGNATURE: *[Signature]* DATE: 9-5-84  
 DISTRICT HOWARD SOIL CONSERVATION DISTRICT

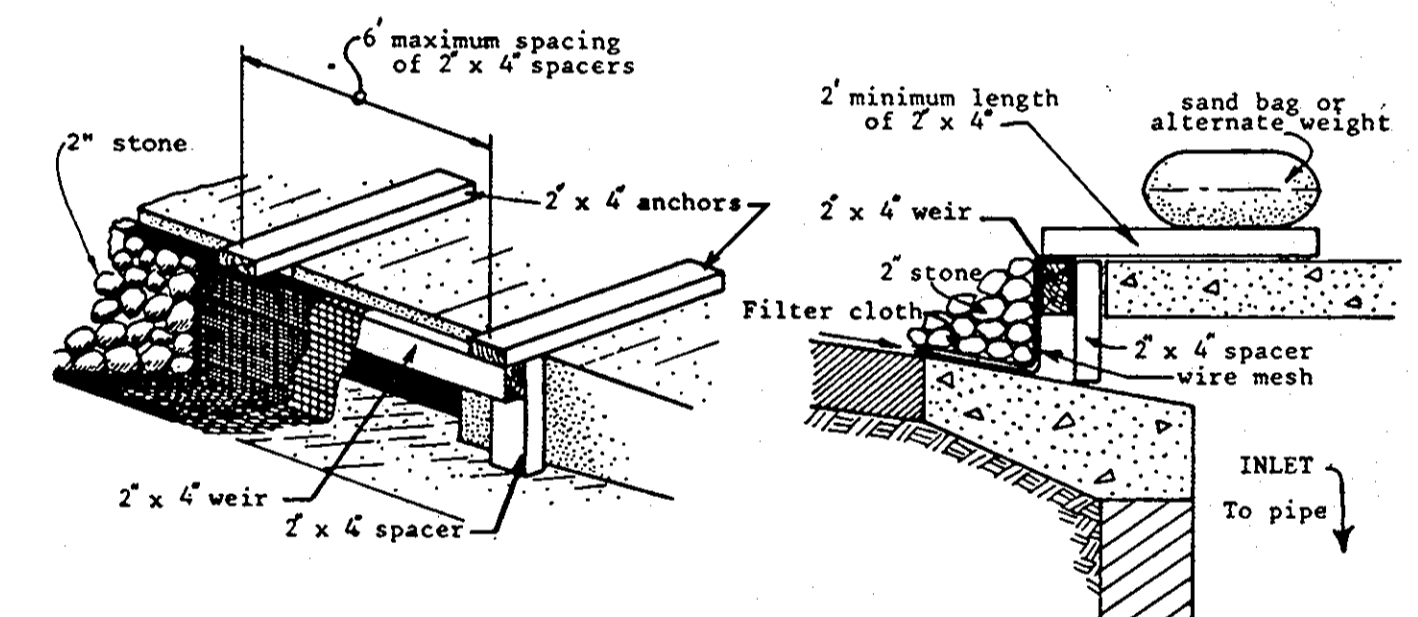
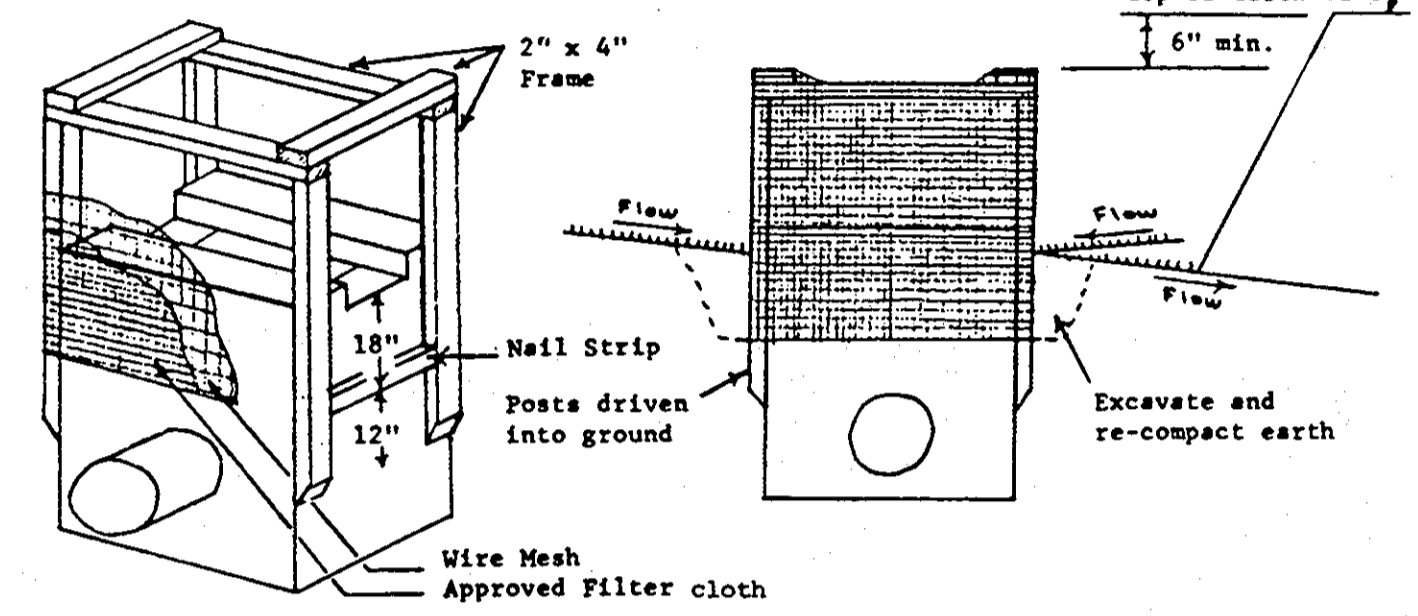
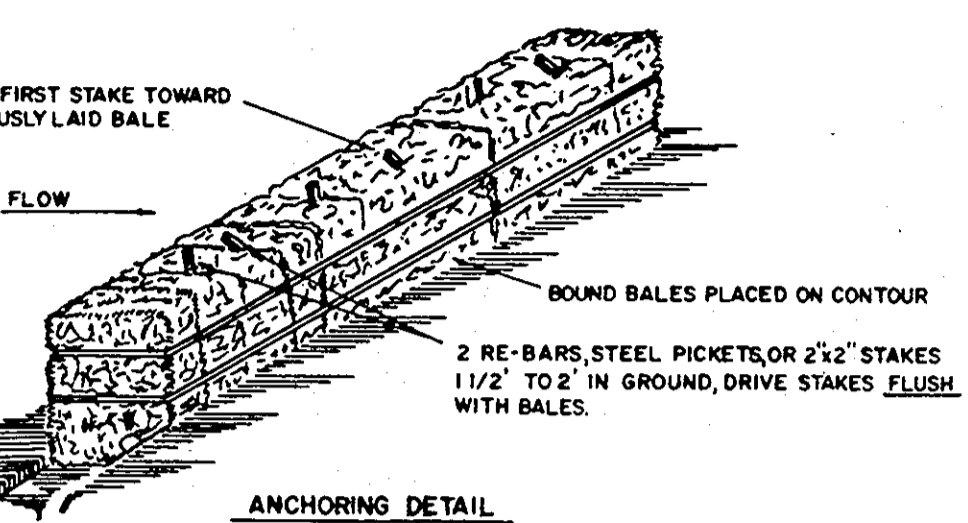
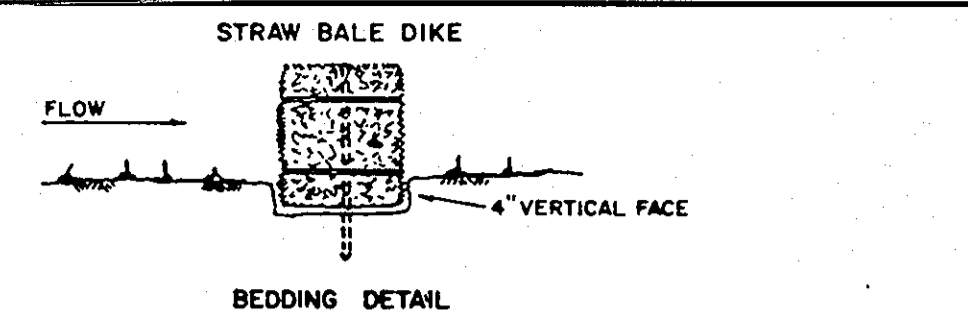

- CONSTRUCTION SEQUENCE:**
- OBTAIN GRADING PERMIT AND INSTALL 36" O.P.P.A.
  - CONSTRUCT STONE CONSTRUCTION ENTRANCE AS SHOWN ON PLAN.
  - EXCAVATE SEDIMENT TRAPS TO REQUIRED DIMENSIONS AS SHOWN ON PLAN. USE EXCAVATED MATERIAL TO CONSTRUCT EARTH DIKE. STABILIZE TRAPS AND DIKES WITH TEMPORARY SEED MIXTURE AND STRAW MULCH.
  - INSTALL SILT FENCE OR STRAW BALE DIKE.
  - GRADE SLOPS TO SUBGRADE STABILIZING SLOPE AREAS BETWEEN EXISTING GROUND AND BACK OF CURB USING PERMANENT SEEDING.
  - CONSTRUCT STORM DRAIN SYSTEM.
  - INSTALL INLET PROTECTION DEVICES AT ALL STORM DRAIN INLETS.
  - CONSTRUCT CONCRETE CURB AND LAY BASE COURSE.
  - UPON STABILIZATION OF GRADED AREAS, INLETS SHALL BE OPENED AND ALL ACCUMULATED SEDIMENT SHALL BE REMOVED FROM THE STORM DRAIN SYSTEM. INSTALL RIP-RAP APRONS.
  - DURING CONSTRUCTION, SEDIMENT SHALL BE REMOVED FROM THE SEDIMENT TRAPS WHEN THE CLEANOUT ELEVATION HAS BEEN REACHED.
  - DURING CONSTRUCTION AND AFTER EACH RAINFALL, THE CONTRACTOR SHALL INSPECT AND PROVIDE NECESSARY MAINTENANCE ON THE SEDIMENT AND EROSION CONTROL STRUCTURES SHOWN HEREON.
  - REMOVE STONE CONSTRUCTION ENTRANCE.
  - CLEAN BASE COURSE, APPLY TACK COAT TO BASE COURSE, LAY SURFACE COURSE AND INSTALL CONCRETE SIDEWALK. STABILIZE ALL SHOULDERS USING PERMANENT SEEDING.
  - THE SEDIMENT TRAPS SHALL BE DETERIATED BY PUMPING.
  - ALL SEDIMENT CONTROL STRUCTURES WILL REMAIN IN PLACE FOR CONSTRUCTION OF APARTMENT UNITS. SEE SDP-85- FOR CONTINUED CONSTRUCTION SEQUENCE AND FINAL STABILIZATION OF ALL DISTURBED AREAS.

NOTE: DURING CONSTRUCTION OF THE STORM DRAIN SYSTEM FROM I-1 TO S-1 AND I-15 TO S-2 THE CONTRACTOR SHALL PLACE STRAW BALE DIKES OR SILT FENCE DOWNGRADE OF ANY DISTURBED AREAS AT THE END OF EACH WORKING DAY.

**OWNER AND DEVELOPER**  
 AUTUMN WOODS LIMITED PARTNERSHIP  
 8930 BALTIMORE STREET  
 SAUGE, MARYLAND 20863  
**DRAINAGE AREA MAP, SEDIMENT CONTROL & STORM DRAIN PLAN**  
**AUTUMN WOODS**  
 SIXTH ELECTION DISTRICT  
 HOWARD COUNTY, MARYLAND  
 SCALE: 1" = 50' JULY 11, 1984  
 TAX MAP 47 SHEET 6 OF 6 PARCEL 493

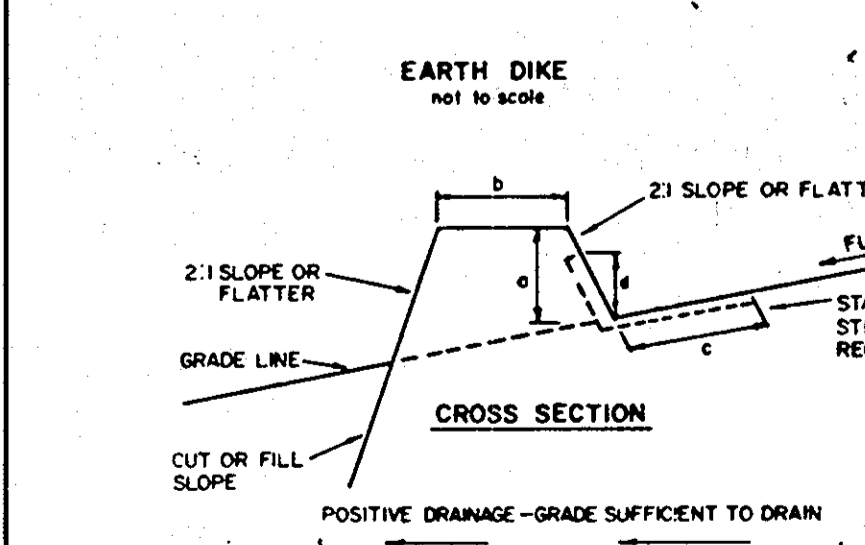
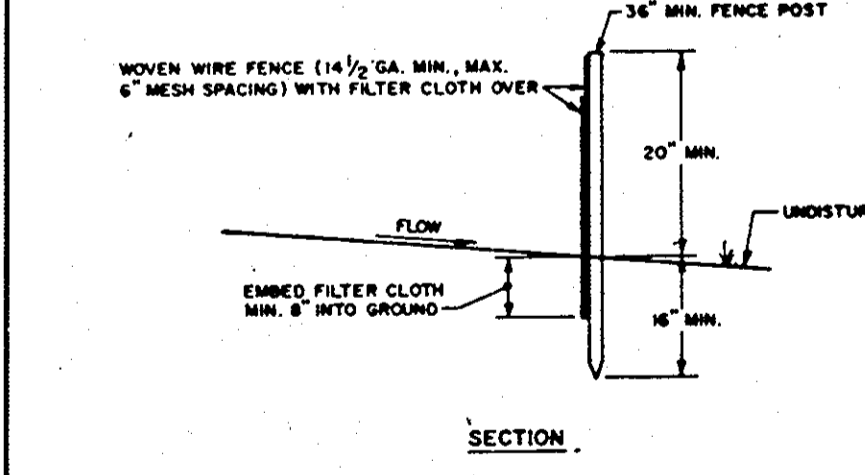
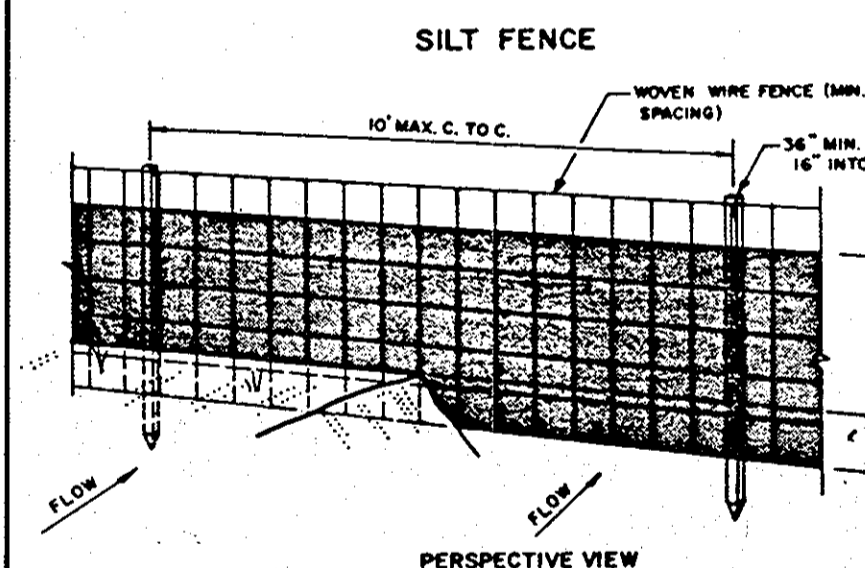
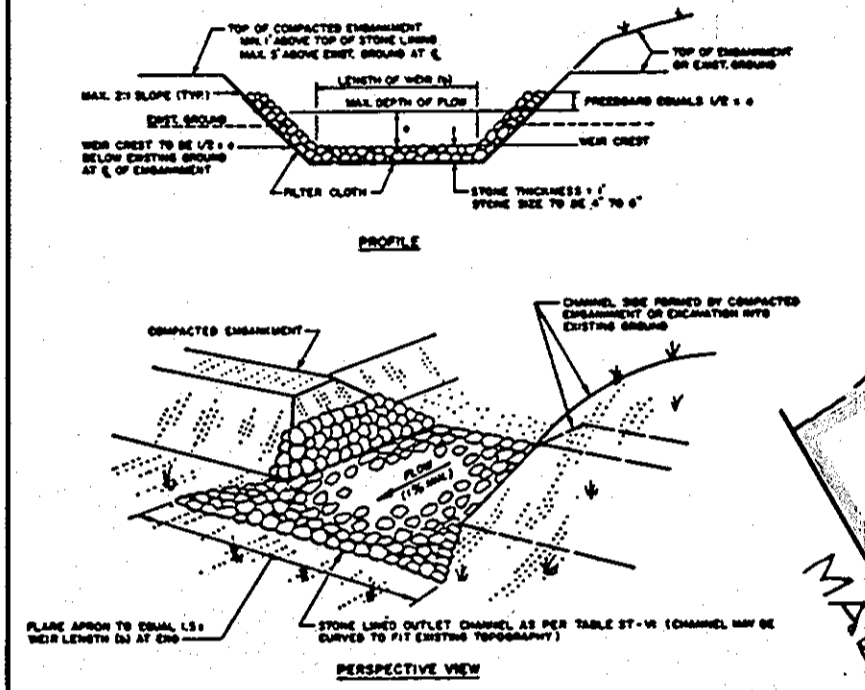

**FISHER, COLLINS, AND CARTER, INC.**  
 CONSULTING ENGINEERS AND LAND SURVEYORS  
 6888 COURT AVENUE  
 ELLICOTT CITY, MARYLAND 21043  
 TELEPHONE: (301) 461-2855

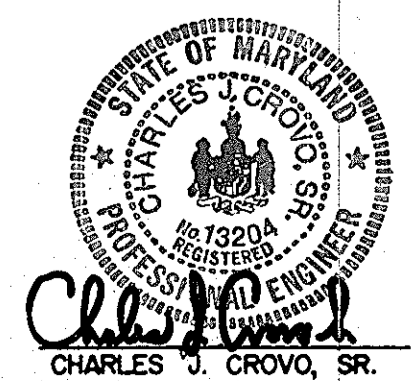

APPROVED:  
 DEPARTMENT OF PUBLIC WORKS  
 SIGNATURE: *[Signature]* DATE: 9-10-84  
 CHIEF, BUREAU OF ENGINEERING  
 APPROVED:  
 OFFICE OF PLANNING AND ZONING  
 SIGNATURE: *[Signature]* DATE: 7-15-84  
 CHIEF, DIVISION OF LAND DEVELOPMENT AND ZONING ADMINISTRATION

**SITE ANALYSIS:**  
 1. TOTAL AREA OF PARCEL: 26.091 AC. +  
 2. TOTAL AREA TO BE DISTURBED: 12.0 AC. +  
 3. TOTAL IMPERVIOUS AREA: 4.4 AC. +  
 4. TOTAL AREA TO BE REVEGETATED: 7.6 AC. +

**SEDIMENT TRAP NO. 1:**  
 1. DRAINAGE AREA TO TRAP: 12.0 AC. +  
 2. VOLUME REQUIRED: 21,600 C.F.  
 3. VOLUME PROVIDED: 21,600 C.F.  
 4. TRAP SIZE: 120' x 60'  
 5. TRAP DEPTH: 3'  
 6. CREST ELEV.: 184.00  
 7. BOTTOM ELEV.: 179.00  
 8. CLEANOUT ELEV.: 181.50  
 9. STONE OUTLET WEIR LENGTH: 14'  
 10. DEPTH OF CHANNEL: 2'  
 11. TYPE OF TRAP: RIP-RAP OUTLET

**SEDIMENT TRAP NO. 2:**  
 1. DRAINAGE AREA TO TRAP: 2.0 AC. +  
 2. VOLUME REQUIRED: 3,600 C.F.  
 3. VOLUME PROVIDED: 3,600 C.F.  
 4. TRAP SIZE: 20' x 60'  
 5. TRAP DEPTH: 3'  
 6. CREST ELEV.: 184.00  
 7. BOTTOM ELEV.: 181.00  
 8. CLEANOUT ELEV.: 182.50  
 9. STONE OUTLET LENGTH: 8'  
 10. TYPE OF TRAP: STONE OUTLET