

TYPICAL SECTION

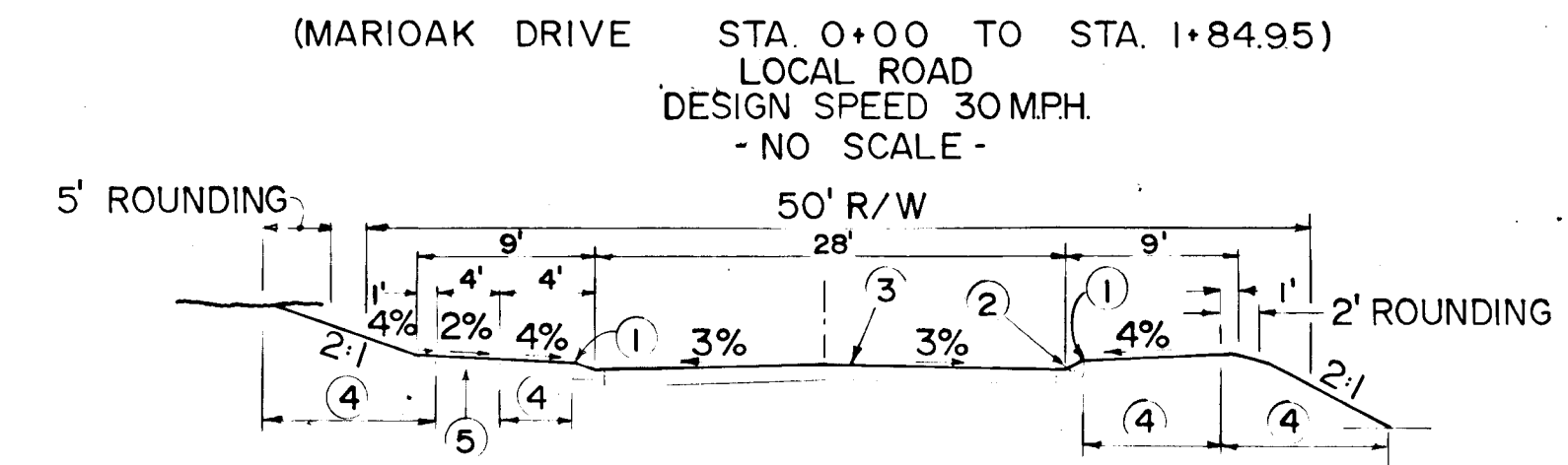

GENERAL NOTES

- Construction shown hereon shall be in accordance with the Howard County Standard Specifications and Details.
- Page and Drawing Nos referenced hereon are taken from the "Standard Specifications & Details."
- Elevations shown hereon are based on the Howard County Vertical Control Datum.
- See sheet 2 of 2 for Sediment Control Plan & Details
- The location of existing utilities shown on the drawing are based on the latest available information. The contractor shall however determine the exact locations and shall notify "Miss Utility" at least three(3) days prior to beginning work.
- The developer shall notify the Howard County Office of Inspection and Permits at least 24 hours prior to beginning any construction hereon. (992-2435 or 992-2436)
- Storm Water Management Facility for this development was provided in Sec. 1, Area 1
- Provide street trees at 40' interval and shall have a min. trunk diameter of 1 1/2". Trees shall be hardwood variety and indigenous to the area.

ROAD TYPICAL KEY:

- Profile Grade Line (P.G.L.)
- Modified Concrete Curb & Gutter (R-301)
- Howard Co. Standard Paving Section P2 (R-201)
- Place 2" Topsoil, Seed & Mulch (R-3.05)
- 4" Concrete Sidewalk (See Plan for Location)

DATE	DESCRIPTION	BY
9-21-83	STRUCTURE SCHEDULE	Δ
9-21-83	STORM DRAIN PROFILE	Δ
3-22-84	STRUCTURE SCHEDULE	P5

BENCH MARKS

BM. NO. 1 ELEV. 317.30
Railroad spike in G. & E. pole # 371424 right of & Mayfield Avenue at Sta. 0+18.

BM. NO. 2 ELEV. 290.09
Railroad spike in G. & E. pole # 147131 left of & Mayfield Avenue at Sta. 12+61.

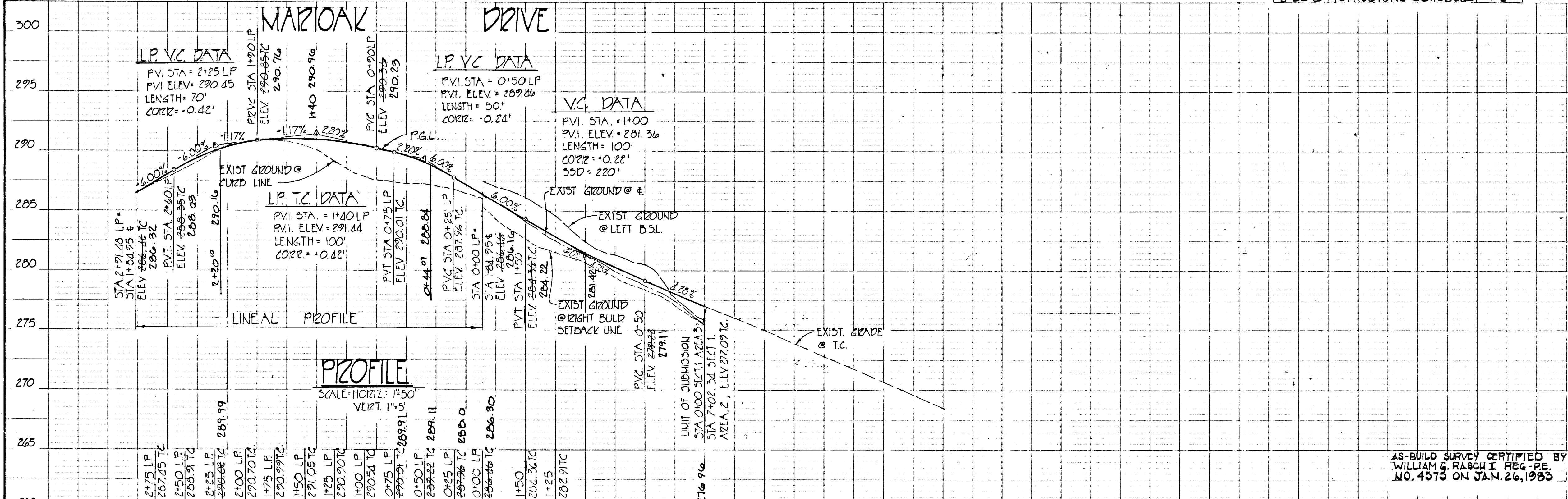

STORM DRAIN PROFILE

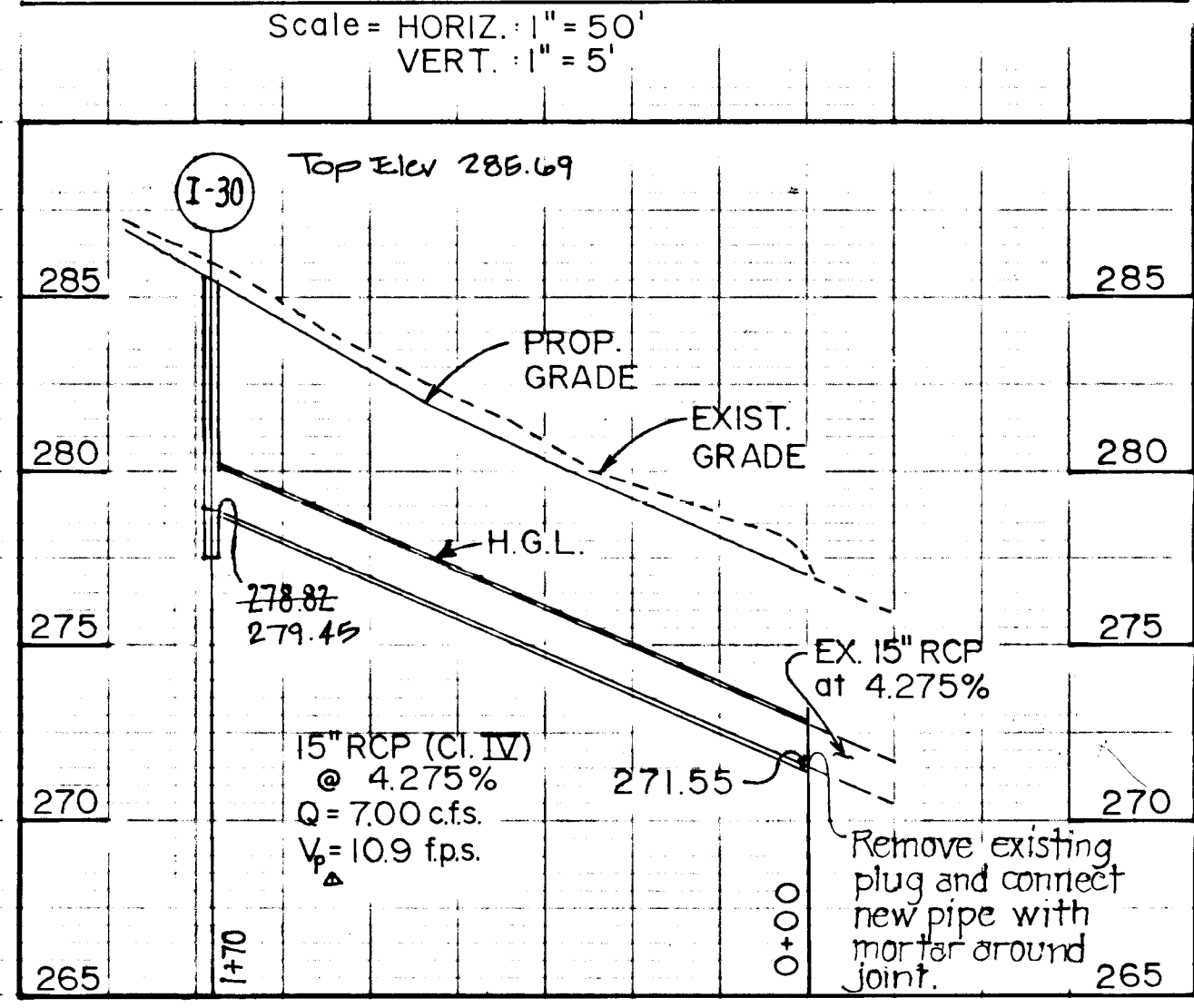

AS-BUILT SURVEY CERTIFIED BY
WILLIAM G. RASCH II REG. P.E.
NO. 4575 ON JAN. 26, 1985

STRUCTURE SCHEDULE

NO.	TYPE	INV. IN	INV. OUT	TOP ELEV.	STD. NO.	RD. STA.
I-30	A-5 W/DEFL.	-	278.82	285.769	SD-402	1473.90 15' R

THIS DEVELOPMENT PLAN IS APPROVED FOR SOIL EROSION AND SEDIMENT CONTROL BY THE HOWARD SOIL CONSERVATION DISTRICT.

APPROVED: *[Signature]* DATE: 6/24/83
HOWARD SOIL CONSERVATION DISTRICT

REVIEWED FOR HOWARD COUNTY DEPARTMENT OF PUBLIC WORKS.

APPROVED: *[Signature]* DATE: 6/28/83
U.S. SOIL CONSERVATION DIST.

PURDUM & JESCHKE
CONSULTING ENGINEERS
LAND SURVEYORS
1023 North Calvert Street
Baltimore, Maryland 21202 301/837-0184

APPROVED: HOWARD COUNTY DEPARTMENT OF PUBLIC WORKS.

APPROVED: *[Signature]* DATE: 6/28/83
CHIEF BUREAU OF ENGINEERING

APPROVED: HOWARD COUNTY OFFICE OF PLANNING AND ZONING

APPROVED: *[Signature]* DATE: 6/28/83
CHIEF DIVISION OF LAND DEVELOPMENT AND ZONING ADMINISTRATION

DEVELOPER'S CERTIFICATION

I certify that all development and construction will be done according to this plan and any responsible personnel involve in the construction project will have a certificate of attendance at the Dept. of Natural Resources approved training program for the control of any sediment erosion before beginning the project.

[Signature] DATE: 1/25/83

ENGINEER'S CERTIFICATION:

I CERTIFY THAT THIS PLAN FOR EROSION AND SEDIMENT CONTROL REPRESENTS A PRACTICAL AND WORKABLE PLAN BASED ON MY PERSONAL KNOWLEDGE OF THE SITE CONDITIONS AND THAT IT WAS PREPARED IN ACCORDANCE WITH THE REQUIREMENTS OF THE HOWARD SOIL CONSERVATION DISTRICT.

[Signature] DATE: 1/26/83
WILLIAM G. RASCH II



ROAD & STORM DRAIN PLANS & PROFILES
MARIOAK DRIVE
MAYFIELD MANOR
SECTION ONE, AREA THREE
FIRST ELEC. DIST HOWARD CO. WAREHOUSING PARCEL 162
DATE: JAN. 25, 1985 SCALE: AS NOTED

SHEET 1 OF 2
DES: S.I.R.B.
CHK: W.G.P.

1/26/83 AS-BUILT F-83424

SITE ANALYSIS

1. Total Area of Site: 5.048 Ac.
2. Area to be disturbed: 0.42 Ac.
3. Area to be paved: 0.31 Ac.
4. Area to be revegetated: 0.11 Ac.

- SEDIMENT CONTROL NOTES**
1. Specifications for the Sediment Control Details shown herein are included in the U.S.D.A. Soil Conservation Service "Standards and Specifications for Soil Erosion and Sediment Control in Developing Areas."
 2. The developer shall notify the Howard County Office of Inspection and Permits at least 24 hours prior to beginning any construction shown herein (992-2433 or 992-2434).
 3. All sediment control structures to remain in place until permission for their removal has been obtained from the Howard County Office of Inspection and Permits (992-2433 or 992-2434).
 4. All graded areas shall be stabilized in accordance with the following requirements:
 - A. Site Preparation:**
 - (1) Mow or disc the area to be seeded with the following materials at the specified rate to a depth of 2":
 - (a) Fertilized limestone at 10 tons/acre.
 - (b) Commercial fertilizer 10-10-10 or 3/4 tons/acre.
 - (c) Super phosphate at 600 lbs./acre.
 - B. Seeding:**
 - (1) Sow the following seed mixture at the specified rate with a mechanical spreader:
 - (a) Temporary - Italian or Perennial Ryegrass (1 lb./1000 sq. ft.)
 - (b) Permanent - (Slopes flatter than 3:1) - Common Kentucky Bluegrass 40%, Hard Fescue 20%, Red Fescue 20% (1 lb./1000 sq. ft.)
 - (c) Slopes steeper than 3:1 - Ground cover
 - (2) The seed shall be covered to a depth of 1/2 inch and the area connected with a cultipacker at other approved method.
 - C. Mulching:**
 - (1) Seeded areas shall be uniformly mulched immediately after seeding with unweathered small grain straw at the rate of 14 to 2 tons/acre.
 - (2) The mulch shall be covered with liquid asphalt at 0.1 gal./sq. y. or unoxidized asphalt at 0.04 gal./sq. y.
 - D. Seeding:**
 - (1) Apply 10-10-10 fertilizer at 1000 lbs./acre. (25 lbs./1000 sq. ft.)
 - (2) Apply ground agricultural limestone at 2000 lbs./acre. (50 lbs./1000 sq. ft.)
 - (3) Incorporate both lime and fertilizer into soil by disking. Firm up after incorporation.
 - (4) Lay sod to a tight fit. Roll to insure contact with underlying soil. Water as necessary for first two weeks (in summer) to insure establishment.
 - E. Ground Cover:**
 - (1) Crown sedge (unmowed) at 15 lbs./acre, and Kentucky 31 Tall Fescue (certified) at 40 lbs./acre. (2) Maximum slope
 5. The contractor shall place plywood braced with sand bags at the inlet and of unfinished drain pipes at the end of each work day.
 6. All structures shall be protected with straw bale dikes, silt fences, or other approved sediment control devices.
 7. Specific control measures shown on this plan may be altered, with previous approval of the Sediment Control Inspector, in location or extent as required to fit changed conditions encountered at the site.

- CONSTRUCTION REQUIREMENTS**
1. Obtain grading permit.
 2. Clear and grub for sediment control structures.
 3. Install temporary diversion ditches, 4:1 slope, Stabilized Const. Entrance as indicated. Stabilize diversion ditches with temporary seeding.
 4. Clear and grade roads to subgrade.
 5. Install water, sewer, and storm drains. Repair sediment control devices as required.
 6. Seed all disturbed areas outside limits of streets as grading is completed.
 7. Install curb and gutter.
 8. Pave roadway.
 9. Remove temporary sediment control devices upon approval of Sediment Control Inspector after areas are stabilized.

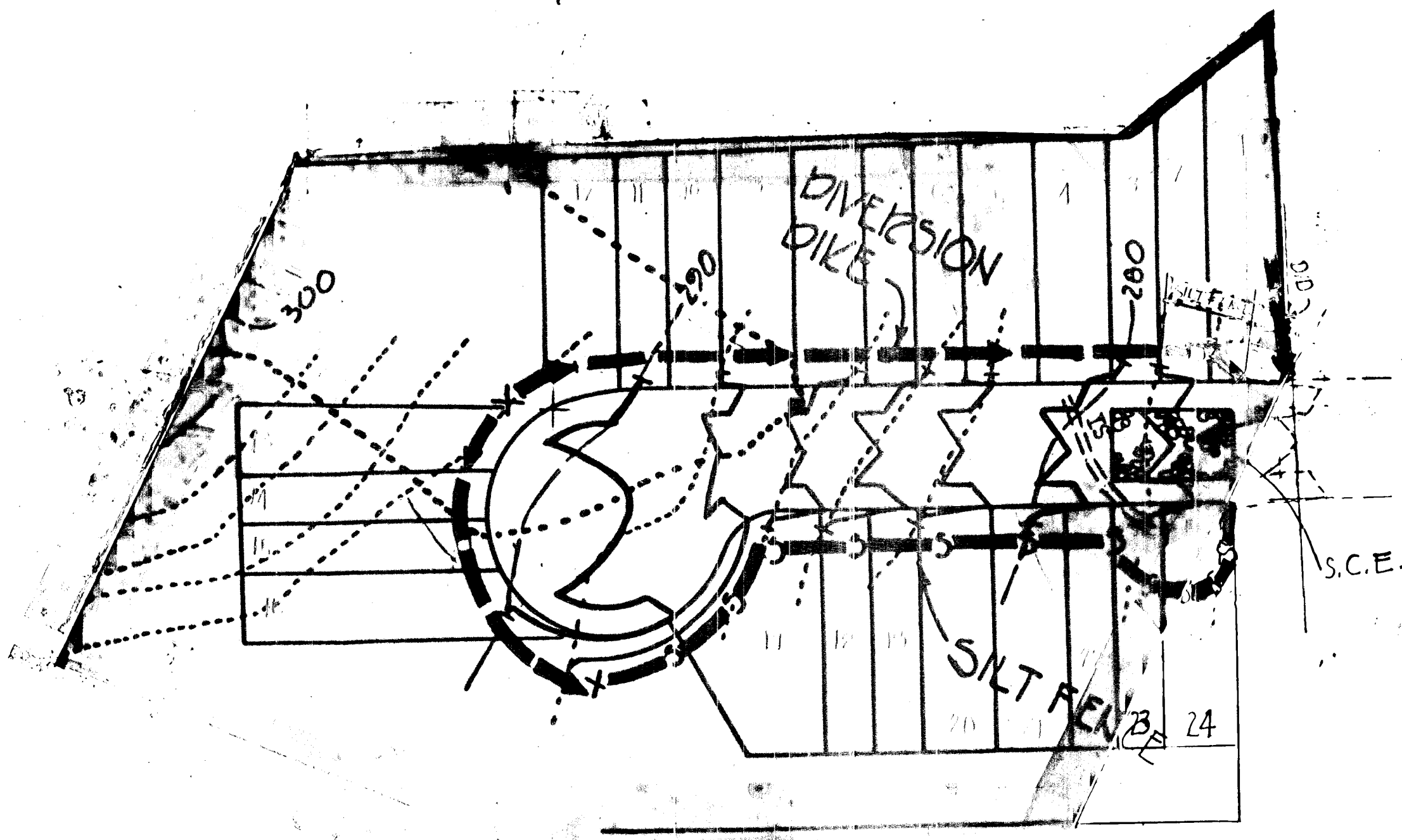

PLAN
1" = 50'

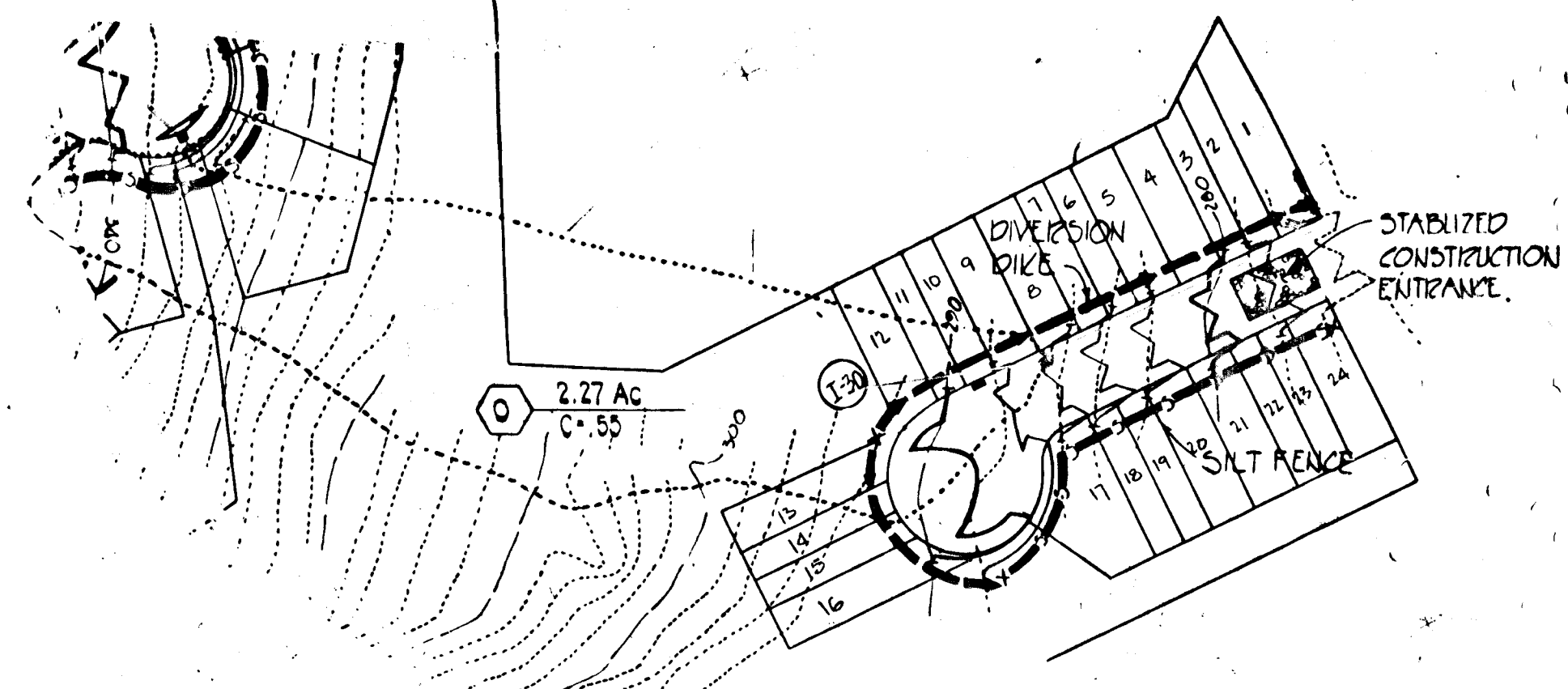

DRAINAGE AREA MAP
SCALE 1" = 100'

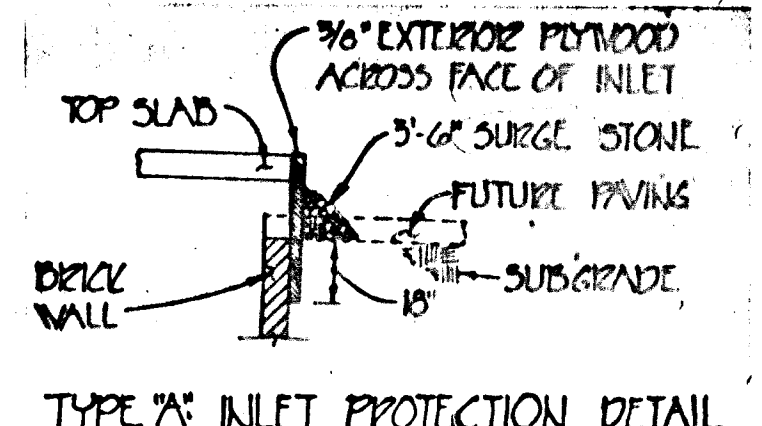

TYPE 'A' INLET PROTECTION DETAIL

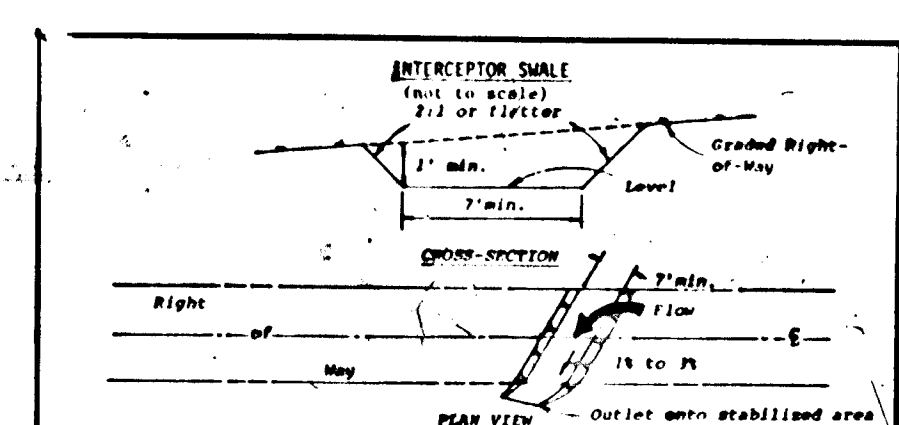

- CONSTRUCTION SPECIFICATIONS**
1. All stone, brush, stems, obstructions, and other objectionable material shall be removed and disposed of so as not to interfere with the proper functioning of the walls.
 2. The walls shall be excavated or abraded to live, grade, and cross section as required to meet the criteria specified herein and be free of bank projections or other irregularities which will impede normal flow.
 3. Fills shall be compacted as needed to prevent unequal settlement that would cause damage in the complete walls.
 4. All silt fences removed and not needed in construction shall be spread or disposed of so that it will not interfere with the functioning of the walls.
 5. Interceptor walls shall have a minimum grade of one percent and the bottom shall be level.
 6. An interceptor wall shall have an outlet that functions with a minimum of restriction.
 7. Runoff shall be conveyed to a sediment trapping device such as a sediment trap or sediment basin.
 8. Stabilization shall be: (1) in accordance with the Standard and Specifications for Grassed Motorway; or (2) by lining the flow area with stone that meets MMS size No. 2 or ASTM No. 2 size No. 2 or 24 in a layer at least 3 inches in thickness and graded into the soil. The lining shall extend across the bottom and up both sides of the channel a height of at least 8 inches vertically above the bottom.
 10. Periodic inspection and required maintenance shall be provided.

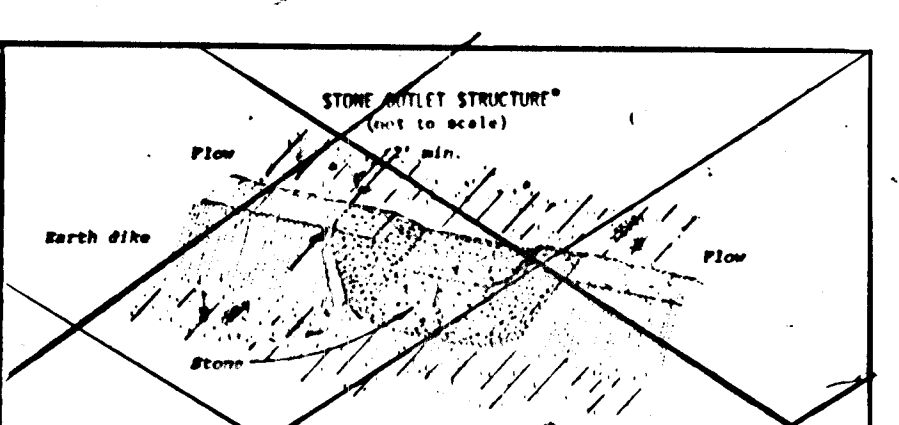

- CONSTRUCTION SPECIFICATIONS**
1. Area under construction shall be protected, marked and striped of any vegetation and other material that may be present.
 2. The fill material for the structure shall be free of roots or other organic material and shall be compacted by tamping with equipment while it is being placed.
 3. Sediment shall be removed from the structure immediately upon the completion of the structure to prevent the structure from becoming a sediment trap.
 4. The structure shall be inspected for such defects and repairs made as needed.
 5. The structure shall be removed and the stabilized area shall be revegetated as soon as possible.
 6. The structure shall be 24\"/>

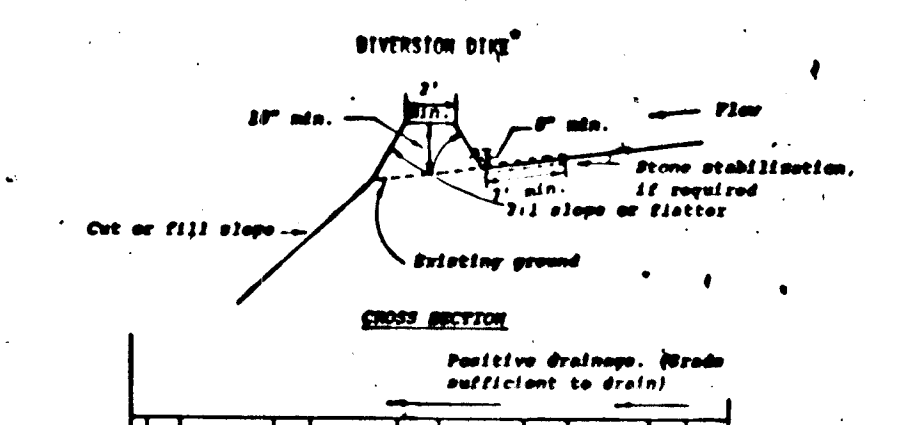

- CONSTRUCTION SPECIFICATIONS**
1. All dikes shall be machine compacted.
 2. All diversion dikes shall have positive drainage to an outlet.
 3. A diverted runoff from a protected or stabilized area shall outlet directly to an undisturbed stabilized area or into a local spreader or grade stabilization structure.
 4. Diverted runoff from a disturbed or exposed upland area shall be conveyed to a sediment trapping device such as a sediment trap or a sediment basin or to an area protected by any of these practices.
 5. Stabilization, as specified by the plans, shall be: (1) in accordance with Standard and Specifications for Grassed Motorway; and the area of the flow shall be lined with stone that meets MMS size No. 2 or ASTM No. 2 size No. 2 or 24 which is placed in a 3 inch ditch layer and graded into the soil. The area covered by the stone shall be as shown on the drawing above.
 6. Periodic inspection and required maintenance shall be provided.

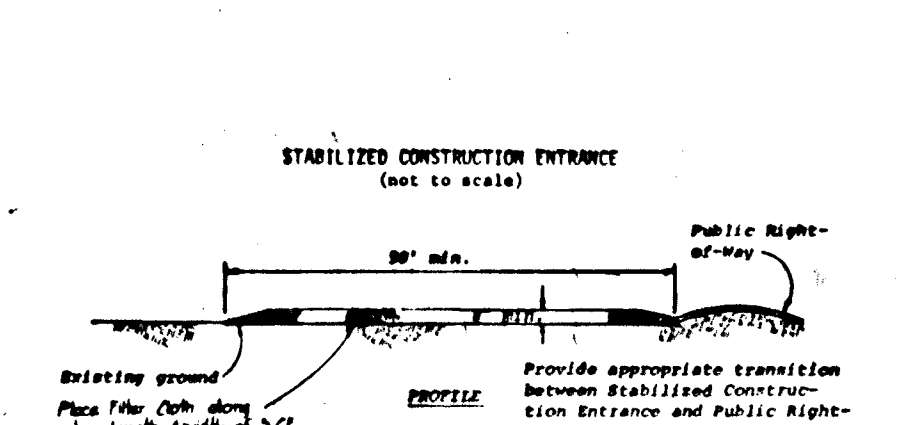

- CONSTRUCTION SPECIFICATIONS**
1. Stone size - The MMS size No. 2 (3-1/2\"/>

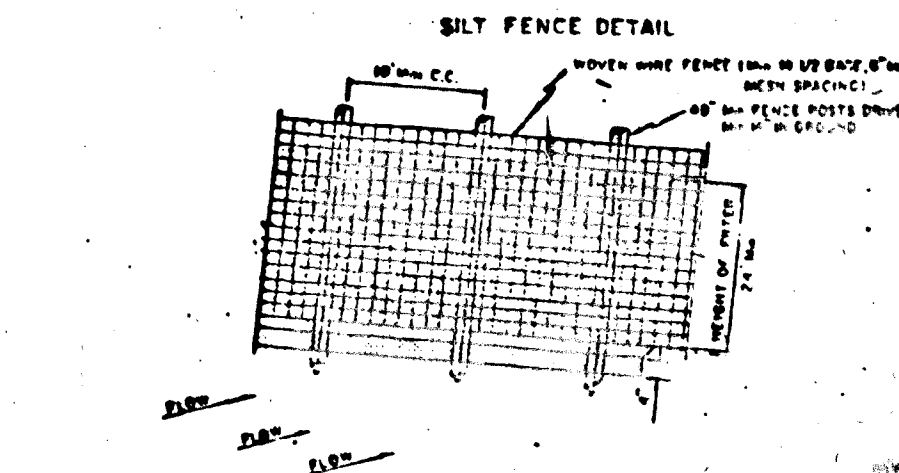

- CONSTRUCTION NOTES**
1. Silt fences shall be installed in accordance with the Standard and Specifications for Grassed Motorway.
 2. Filter cloth shall be fastened securely to wooden silt fence with staples spaced every 12\"/>

THIS DEVELOPMENT PLAN IS APPROVED FOR SOIL EROSION AND SEDIMENT CONTROL BY THE HOWARD SOIL CONSERVATION DISTRICT.

APPROVED: *[Signature]* 6/24/83
HOWARD SOIL CONSERVATION DISTRICT DATE

REVIEWED FOR HOWARD SOIL CONSERVATION DISTRICT AND MEETS TECHNICAL REQUIREMENTS.

[Signature] 6/24/83
SIGNATURE DATE
U.S. SOIL CONSERVATION DIST.

PURDUM & JESCHKE
CONSULTING ENGINEERS
LAND SURVEYORS
1023 North Calvert Street
Baltimore, Maryland 21202 301/837-0194

APPROVED: HOWARD COUNTY DEPARTMENT OF PUBLIC WORKS

[Signature] 6/27/83
CHIEF BUREAU OF ENGINEERING DATE

APPROVED: HOWARD COUNTY OFFICE OF PLANNING AND ZONING

[Signature]
CHIEF DIVISION OF LAND DEVELOPMENT AND ZONING ADMINISTRATION DATE

DEVELOPER'S CERTIFICATION

I certify that all development and construction will be done according to this plan and any responsible personnel involved in the construction project will have a certificate of attendance at the Dept. of Natural Resources approved training program for the control of any sediment erosion before beginning the project.

[Signature] 9/20/83
DATE

ENGINEER'S CERTIFICATION:

I CERTIFY THAT THIS PLAN FOR EROSION AND SEDIMENT CONTROL REPRESENTS A PRACTICAL AND WORKABLE PLAN BASED ON MY PERSONAL KNOWLEDGE OF THE SITE CONDITIONS AND THAT IT WAS PREPARED IN ACCORDANCE WITH THE REQUIREMENTS OF THE HOWARD SOIL CONSERVATION DISTRICT.

[Signature] 9/20/83
WILLIAM J. JESCHKE II DATE

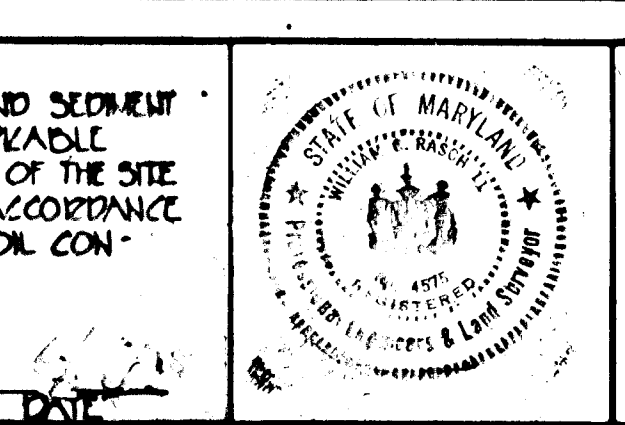

SEDIMENT & EROSION CONTROL PLAN & DETAILS

MAYFIELD MANOR
SECTION ONE, AREA THREE

NEXT EJECT. DIST. HOWARD CO. MARYLAND
TAX MAP 37 PARCEL 162
DATE: JAN. 25, 1983 SCALE: AS NOTED

SHEET 2 OF 2
DES: SKB
CHK: WGB