

DATE
BY
CHECKED
REVISION
NO.

REVIEWED FOR HOWARD COUNTY SOIL CONSERVATION DISTRICT AND MEETS TECHNICAL REQUIREMENTS.
Joseph K. Baker 3-26-82
 U.S. SOIL CONSERVATION SERVICE DATE

THIS DEVELOPMENT PLAN IS APPROVED FOR EROSION AND SEDIMENT CONTROL BY THE HOWARD SOIL CONSERVATION DISTRICT.
Henry R. Rouse 3-26-82
 DISTRICT SUPERVISOR HOWARD SOIL CONSERVATION DISTRICT DATE

APPROVED DEPARTMENT OF PUBLIC WORKS
William E. Kelly 4-11-82
 CHIEF BUREAU OF ENGINEERING DATE
 APPROVED OFFICE OF PLANNING AND ZONING
Shirley Woodman 3-29-82
 ZONING ADMINISTRATOR DATE

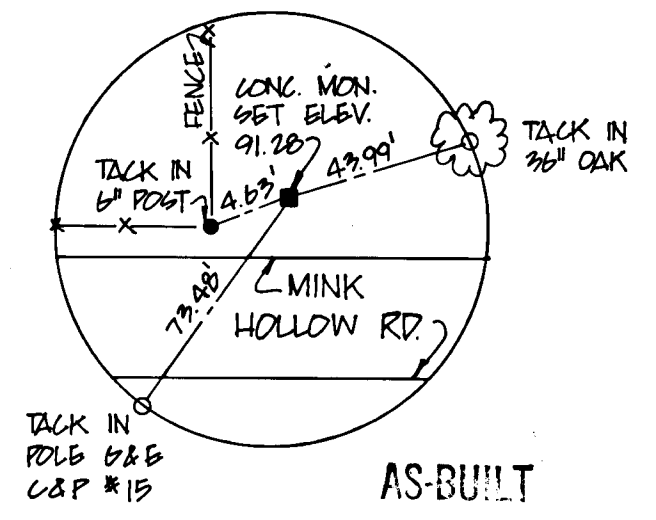

DEVELOPER'S CERTIFICATE
 "I/WE CERTIFY THAT ALL DEVELOPMENT AND CONSTRUCTION WILL BE DONE ACCORDING TO THIS PLAN OF DEVELOPMENT AND PLAN FOR EROSION AND SEDIMENT CONTROL AND THAT ALL RESPONSIBLE PERSONNEL INVOLVED IN THE CONSTRUCTION PROJECT WILL HAVE A CERTIFICATE OF ATTENDANCE AT A DEPARTMENT OF NATURAL RESOURCES APPROVED TRAINING PROGRAM FOR THE CONTROL OF SEDIMENT AND EROSION BEFORE BEGINNING THE PROJECT. I ALSO AUTHORIZE PERIODIC QRSITE INSPECTION BY THE HOWARD SOIL CONSERVATION DISTRICT OR THEIR AUTHORIZED AGENTS, AS ARE DEEMED NECESSARY."
Richard J. Demmitt 2-10-82
 DATE

ENGINEER'S CERTIFICATE
 I CERTIFY THAT THIS PLAN FOR EROSION AND SEDIMENT CONTROL REPRESENTS A PRACTICAL AND WORKABLE PLAN BASED ON MY PERSONAL KNOWLEDGE OF THE SITE CONDITIONS AND THAT IT WAS PREPARED IN ACCORDANCE WITH THE REQUIREMENTS OF THE HOWARD SOIL CONSERVATION DISTRICT.
Ronald B. Carter 3/22/1982
 RONALD B. CARTER DATE

PLAN
 SCALE: 1" = 30'

BY	NO.	REVISION	DATE
	1	12' PAVEMENT FROM E OF MINK HOLLOW ROAD	1-3-84

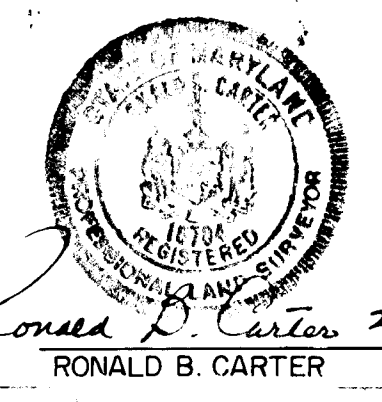

JOCELYN ACRES
 SECTION ONE, AREA ONE
 5TH ELECTION DISTRICT
 HOWARD COUNTY, MARYLAND

MINK HOLLOW ROAD
 PLAN AND PROFILE

OWNER AND DEVELOPER
 WILLIAM L. KAPLAN AND PAUL J. DEMMIT
 9966 MARYLAND ROUTE 99
 ELLICOTT CITY, MARYLAND 21043

SCALE: AS SHOWN DATE: DEC 31, 1981 DWG. NO. 1 OF 2
 DES.: C. CROVO DRN.: A. BOGDAN CHK.: R.B. CARTER

FISHER, COLLINS AND CARTER, INC.
 CIVIL ENGINEERS AND LAND SURVEYORS
 8388 COURT AVE. ELLICOTT CITY, MARYLAND 21043

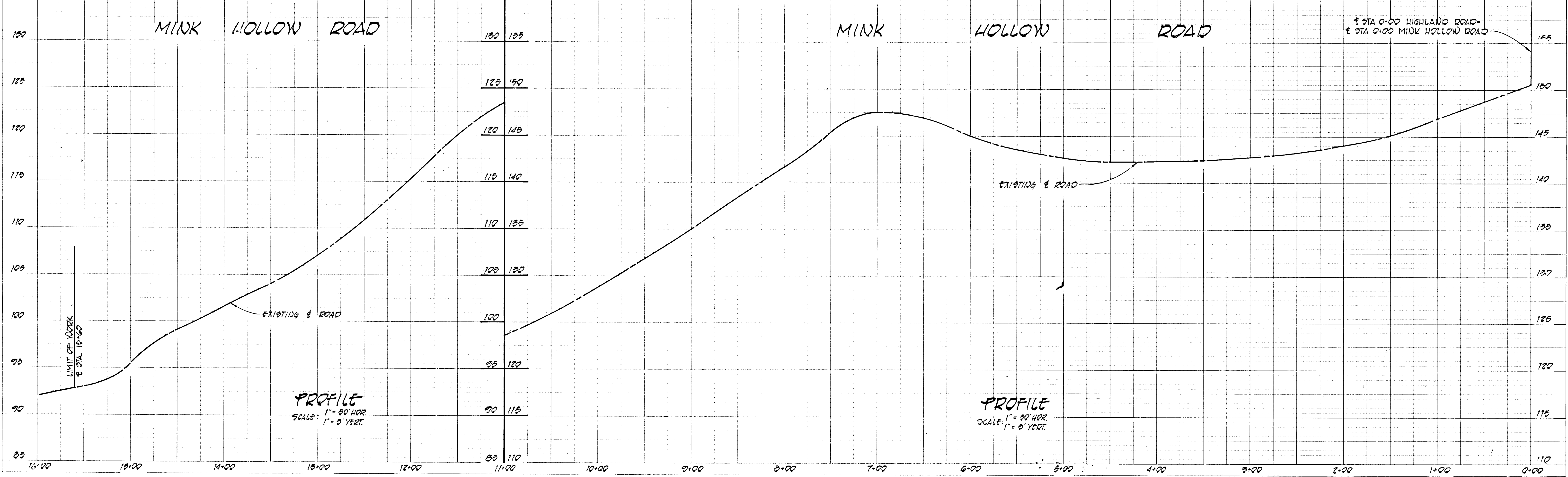

#941

SITE PREPARATION NOTES
 A. HARROW OR DISC IN AREAS PROPOSED TO BE SEEDING THE FOLLOWING MATERIALS
 1) TULVERIZED LIMESTONE AT 2 TONS/ACRE
 2) COMMERCIAL FERTILIZER 10-10-10 AT 3/4 TONS/ACRES
 3) SUPER PHOSPHATE AT 600 LBS./ACRE
SEEDING
 A. SOW THE FOLLOWING SEED MIXTURE AT THE RATE OF 200 LBS./ACRE WITH A MECHANICAL SPREADER
 1) TEMPORARY: ITALIAN OR PERENNIAL RYE GRASS
 2) PERMANENT: 40% MEDIUM BLUE GRASS, 40% SOUTH DAKOTA BLUE GRASS AND 20% PENN LAWN GETTING FESCUE
 B. THE SEEDING AREA SHALL THEN BE BAIKED WITH A YORK BAKE (A MINIMUM OF 2" PASSES) COVERED AND COMPACTED WITH CULTIPACKED OR OTHER APPROVED METHOD
MULCHING
 A. SEEDING AREAS SHALL BE UNIFORMLY MULCHED IMMEDIATELY AFTER SEEDING WITH UNWEATHERED SMALL GRAIN STRAW AT THE RATE OF 1-1/2 - 2 TONS/ACRE
 B. THE MULCH SHALL THEN BE BAIKED WITH A YORK BAKE (A MINIMUM OF 2" PASSES) COVERED AND COMPACTED WITH CULTIPACKED OR OTHER APPROVED METHOD
NOTE:
 THE EXISTING QUADRY WILL BE UTILIZED AS A SEDIMENT TRAP DURING CONSTRUCTION FOR THE WIDENING ALONG MINK HOLLOW ROAD AND HIGHLAND ROAD.

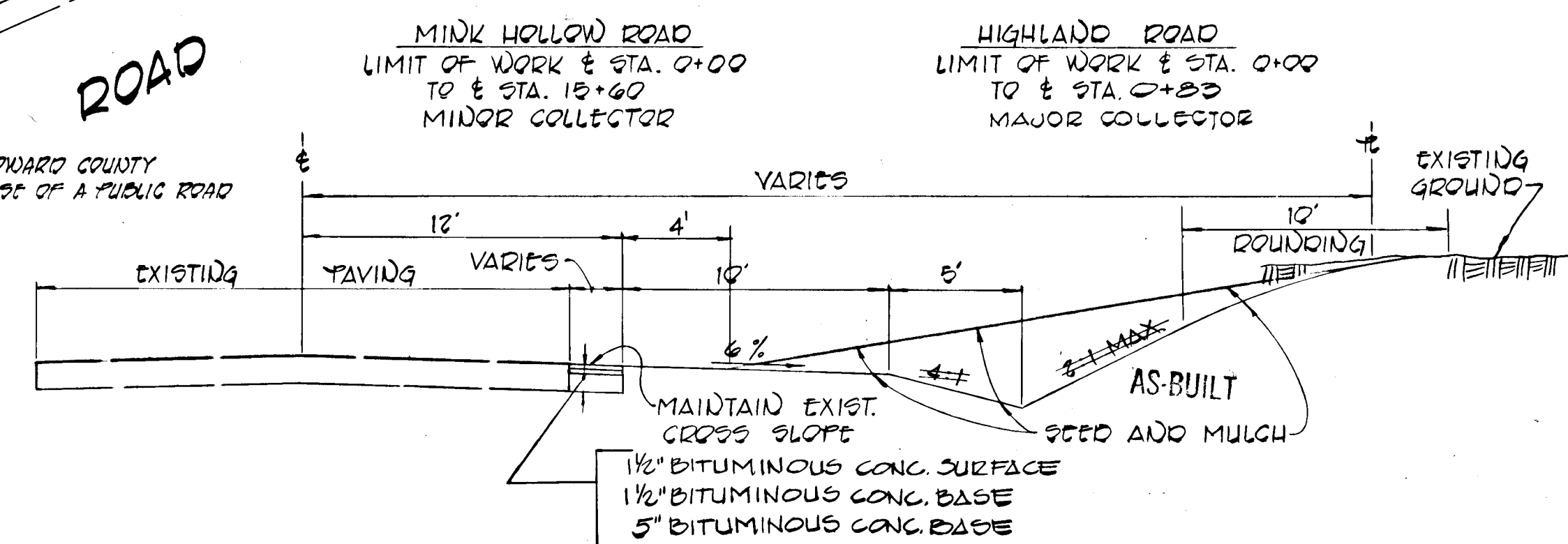
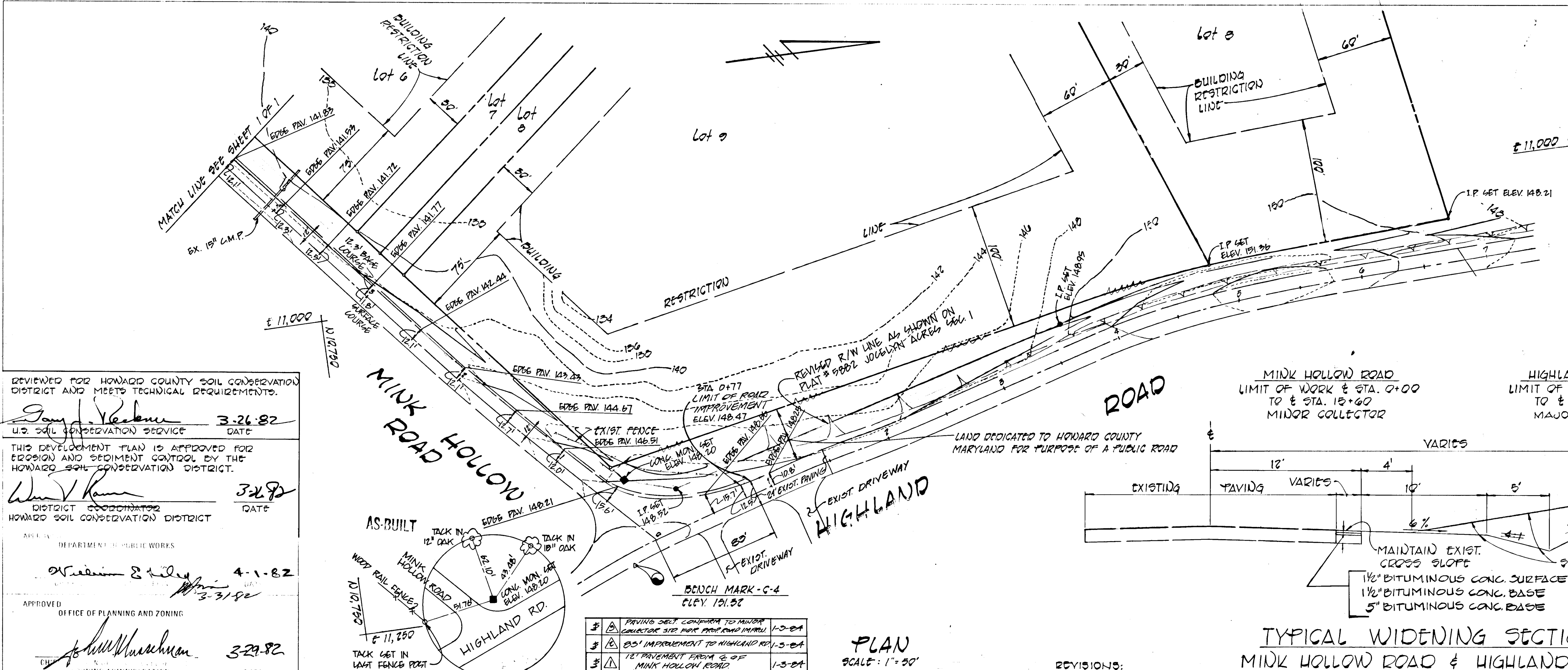

REVIEWED FOR HOWARD COUNTY SOIL CONSERVATION DISTRICT AND MEETS TECHNICAL REQUIREMENTS.
James J. Keenan 3-26-82
 U.S. SOIL CONSERVATION SERVICE DATE
 THIS DEVELOPMENT PLAN IS APPROVED FOR EROSION AND SEDIMENT CONTROL BY THE HOWARD SOIL CONSERVATION DISTRICT.
Walter R. Korman 3-26-82
 DISTRICT COORDINATOR DATE
 HOWARD SOIL CONSERVATION DISTRICT
 DEPARTMENT OF PUBLIC WORKS
William E. Steyer 4-1-82
 APPROVED DATE
 OFFICE OF PLANNING AND ZONING
John W. Murchison 3-29-82
 PLANNING ADMINISTRATION DATE

SEAL OF HOWARD COUNTY, MARYLAND
Ronald B. Carter 2/2/82
 RONALD B. CARTER DATE
JOCELYN ACRES
 SECTION ONE, AREA ONE
 5TH ELECTION DISTRICT
 HOWARD COUNTY, MARYLAND
 MINK HOLLOW ROAD PLAN
 HIGHLAND ROAD PLAN AND PROFILE
 OWNER AND DEVELOPER
 WILLIAM L. KAPLAN AND PAUL J. DEMMIT
 9966 MARYLAND ROUTE 99
 ELLICOTT CITY, MARYLAND 21043
 SCALE: AS SHOWN DATE: DEC. 31, 1981 DWG. NO. 2 OF 2
 DES.: C. CROVO DRN.: A. BOGDAN CHK.: R. B. CARTER
 FISHER, COLLINS AND CARTER, INC.
 CIVIL ENGINEERS AND LAND SURVEYORS
 8388 COURT AVE. ELLICOTT CITY, MARYLAND 21043

BY	NO.	REVISION	DATE
#	1	PAVING DET. COMPARED TO MINOR COLLECTOR 310 FROM PROFILE AND PLAN	1-3-84
#	2	60' IMPROVEMENT TO HIGHLAND RD.	1-3-84
#	3	12' IMPROVEMENT FROM E. OF MINK HOLLOW ROAD	1-3-84
BY	NO.	REVISION	DATE

PLAN
 SCALE: 1" = 50'
 MARCH 18, 1985

REVISIONS:
 ROAD CLASSIFICATION OF HIGHLAND ROAD
 PAVING SECTION FOR ROAD WIDENING
 MINK HOLLOW ROAD & HIGHLAND ROAD
 NO SCALE

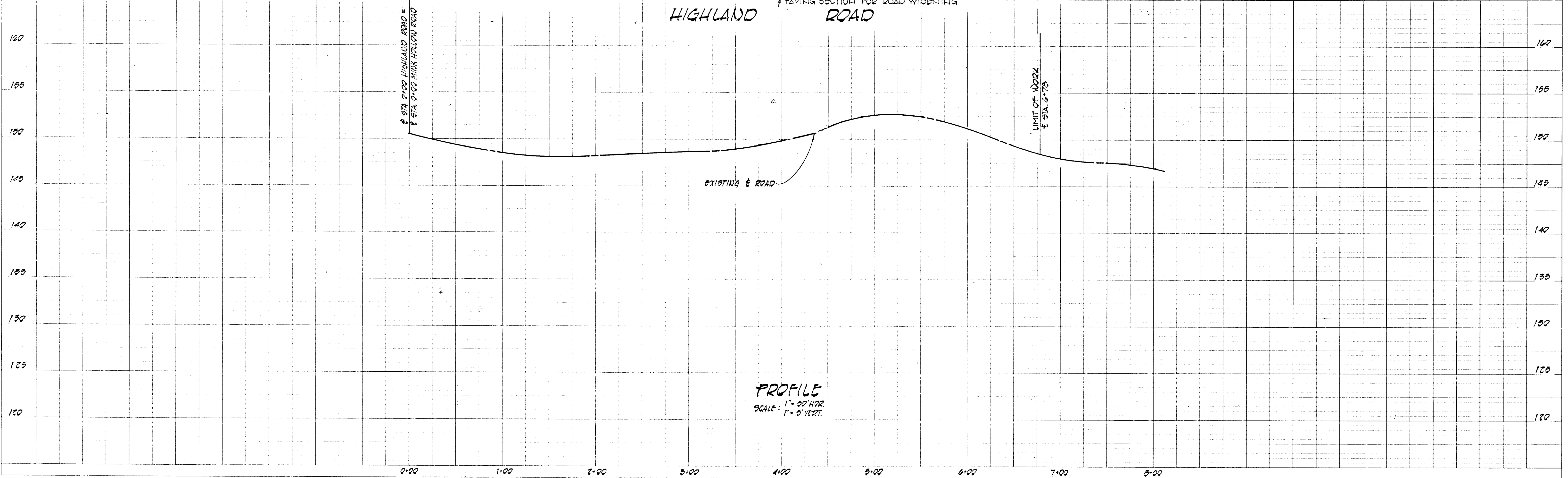

PROFILE
 SCALE: 1" = 20' HOR.
 1" = 5' VERT.