

PLAN	SURVEYED	DATE
	PLOTTED	BY
	ALIGNMENT CHECKED	
	NOTE BOOK NO.	

PROFILE	SURVEYED	DATE
	PLOTTED	BY
	GRADES CHECKED	
	STRUCTURE NOTATIONS CHKD	
	NOTE BOOK NO.	

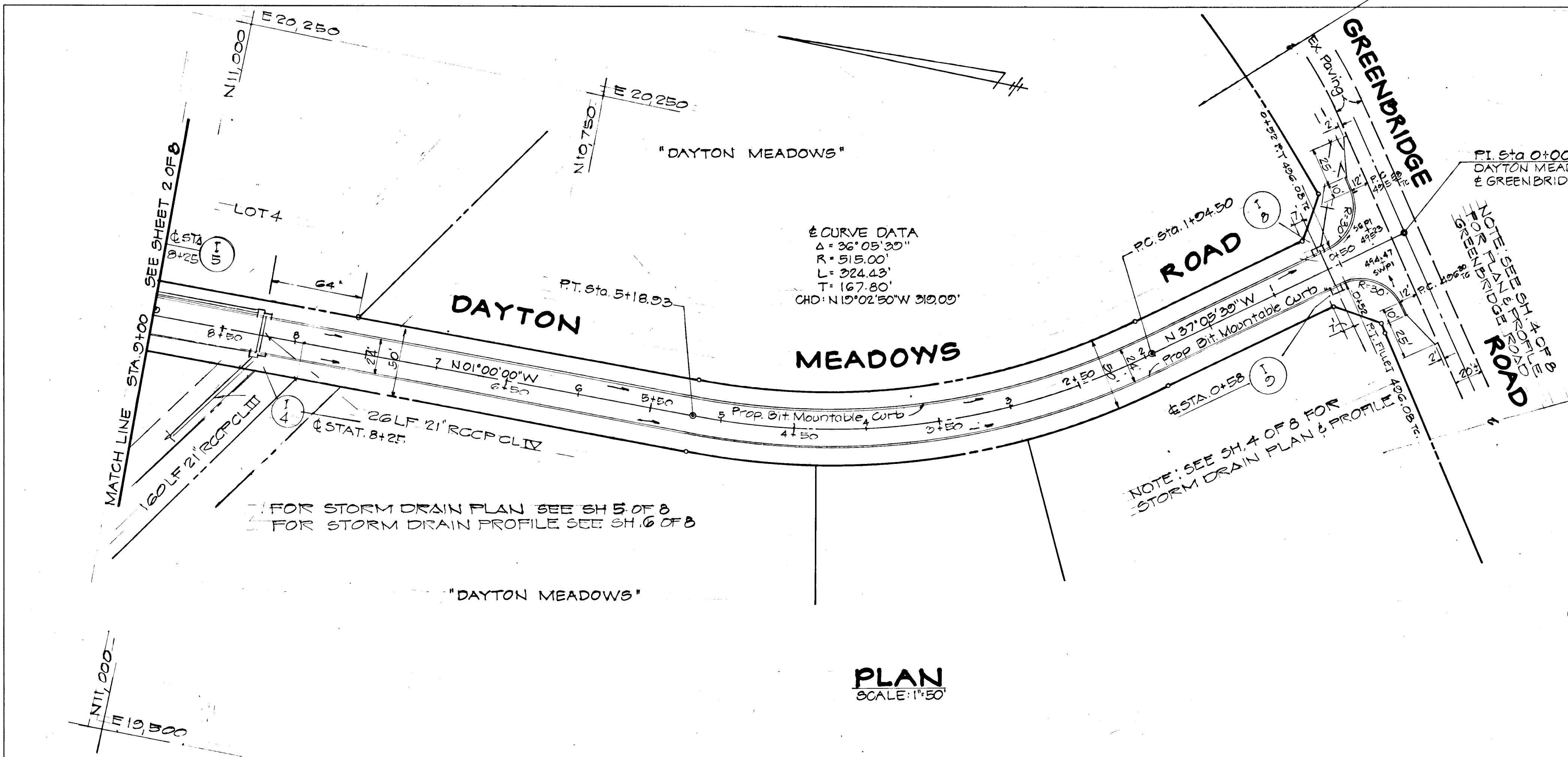

PLAN  
SCALE: 1"=50'

**DEVELOPER'S CERTIFICATE**  
 I certify that all development and/or construction will be done according to this plan of development and plan for Erosion and Sediment Control, and I also authorize periodic on-site inspection by the Howard Soil Conservation District or their authorized agents as deemed necessary. Deviation from this plan will not be made unless authorized by the Howard Soil Conservation District.  
 Signature: *Paul Kottig* Date: *July 14, 1979*

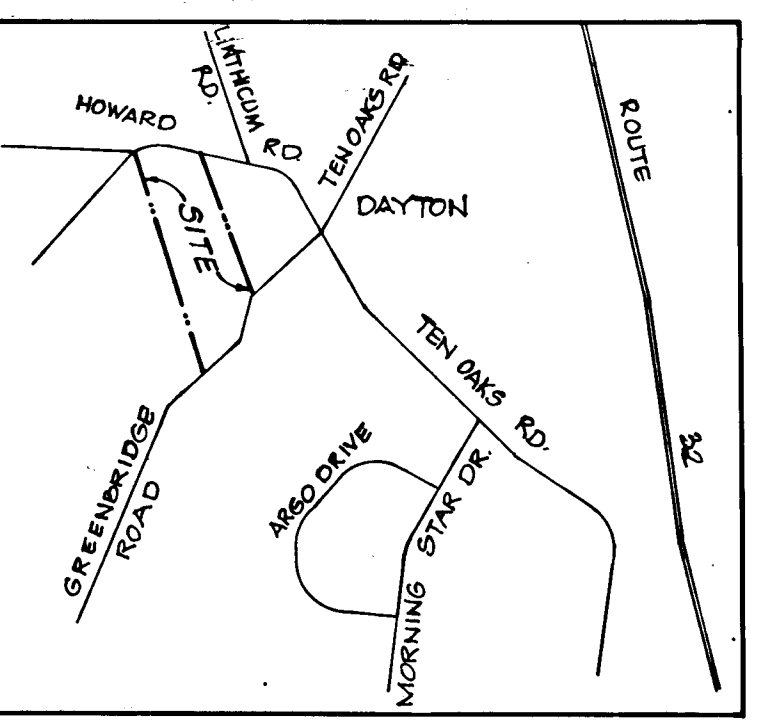

VICINITY MAP  
SCALE: 1"=2000'

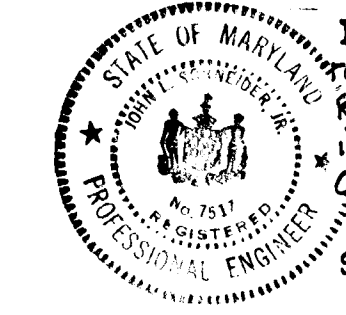

**ENGINEER'S CERTIFICATE**  
 I hereby certify that this plan for Erosion and Sediment Control represents a practical and workable plan based on my personal knowledge of the site conditions and that it was prepared in accordance with the requirements of the Howard Soil Conservation District.  
 Signature: *John L. Schneider* Date: *6-7-79*

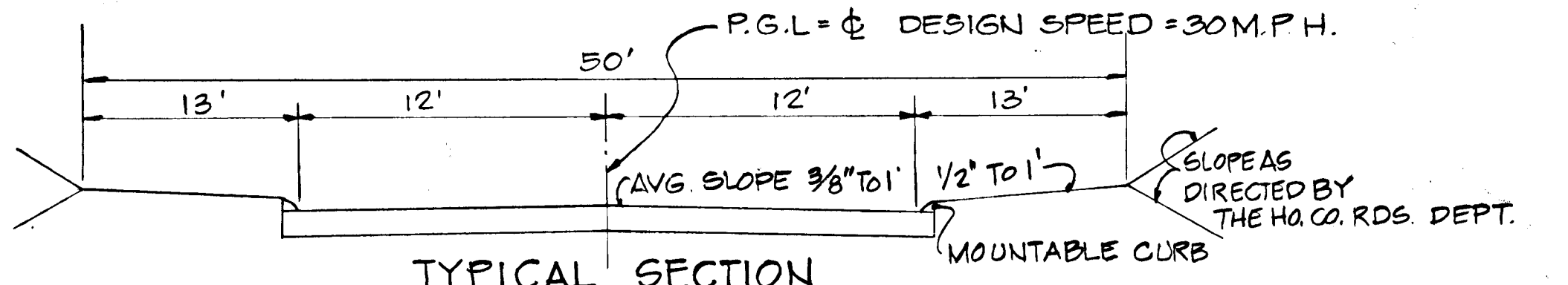

**TYPICAL PAVING SECTION**  
 DRWG. D-4 NO SCALE PAGE 80  
 DAYTON MEADOWS ROAD STAT. 0+00 TO STAT. 22+78.31 & DAYTON GREEN COURT STAT. 0+00 TO STAT. 7+65

BITUMINOUS CONC SURFACE	1"
BITUMINOUS CONC BINDER	2 1/2"
CRUSHER RUN BASE	7"

PRIME BASE IN ACCORDANCE WITH SECTION C-30-3 AS PROVIDED IN THE HOWARD COUNTY ROAD CONSTRUCTION CODE AND STANDARD SPECIFICATIONS.  
 TACK COAT REQUIRED IN ACCORDANCE WITH SECTION C-31-4 OF THE HOWARD COUNTY ROAD CONSTRUCTION CODE AND STANDARD SPECIFICATIONS.

CLEARING AND GRADING: ARTICLE C-1  
 SUBGRADE: ARTICLE C-2  
 BASE COURSE: ARTICLE C-25  
 BINDER COURSE: ARTICLE C-31 OR C-33  
 SURFACE COURSE: ARTICLE C-31

TO BE CONSTRUCTED IN ACCORDANCE WITH THE HOWARD COUNTY ROAD CONSTRUCTION CODE AND SPECIFICATIONS.

ABOVE SECTION  
 LOCAL RESIDENTIAL TRAFFIC WAY  
 ZONED 'R'

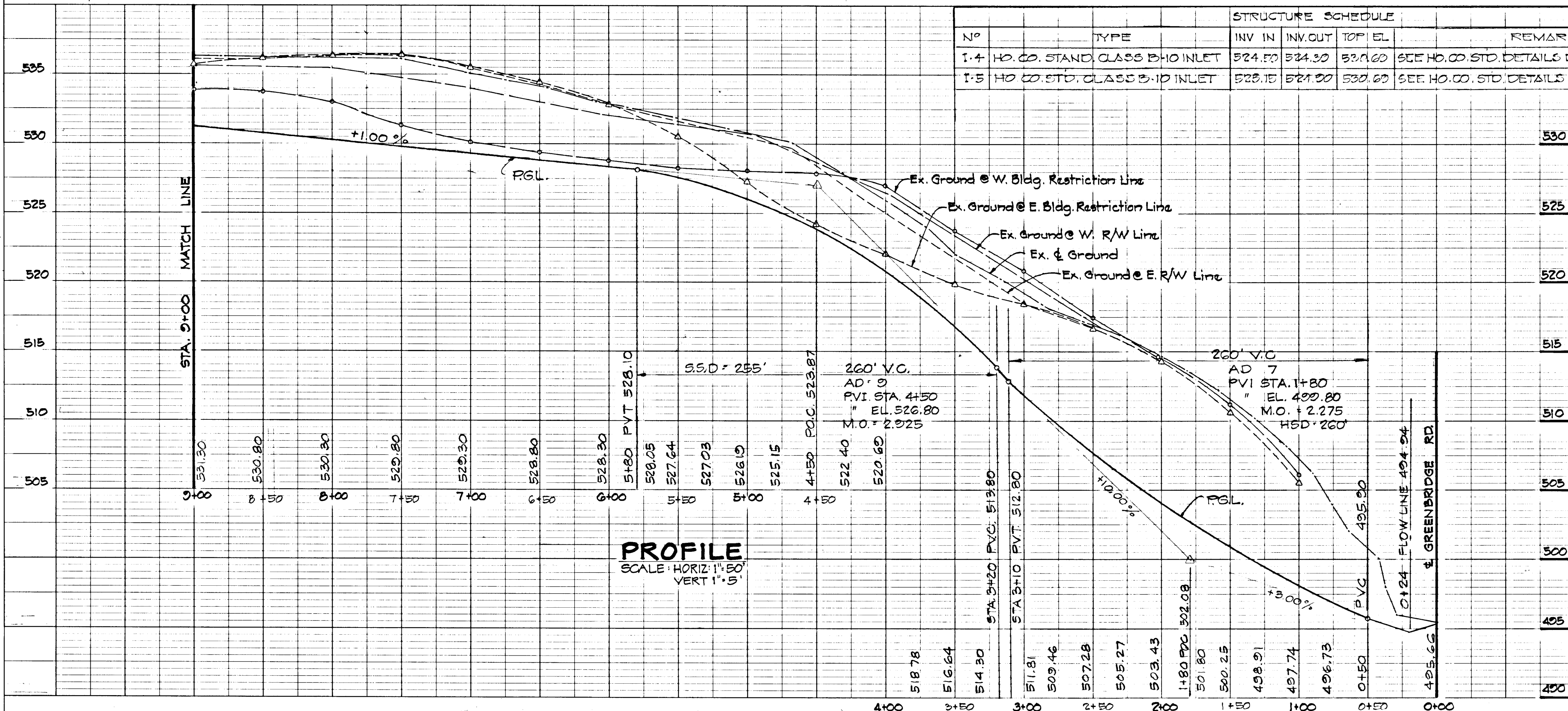

PROFILE  
SCALE: HORIZ. 1"=50' VERT. 1"=5'

DEPARTMENT OF PUBLIC WORKS  
*Wolcott* 9-6-79  
 CHIEF, BUREAU OF ENGINEERING DATE: \_\_\_\_\_

OFFICE OF PLANNING AND ZONING  
*John M. ...*  
 CHIEF, DIVISION OF LAND DEVELOPMENT DATE: *8-20-79*

ROAD CONSTRUCTION PLAN & PROFILE  
**DAYTON MEADOWS**  
 5TH. DISTRICT  
 SCALE: AS SHOWN  
 NO. CO. MD.  
 JUNE 5, 1979  
 OWNED: PAUL KOTTIG  
 1015 GADSDEN AVE.  
 SILVER SPRING, MD. 20904

ENGINEERS: LAND DEVELOPMENT CONSULTANTS  
 HUDKINS ASSOCIATES, INC.  
 231 JOSEPH SQUARE  
 COLUMBIA, MD. 21044  
 180-9080

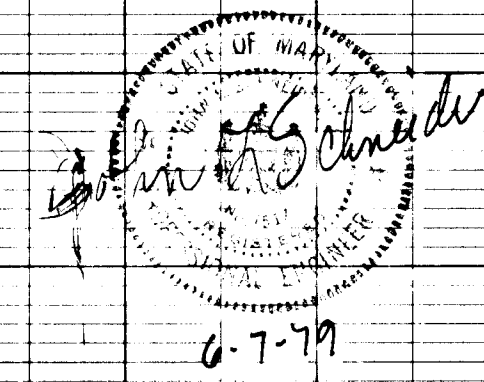













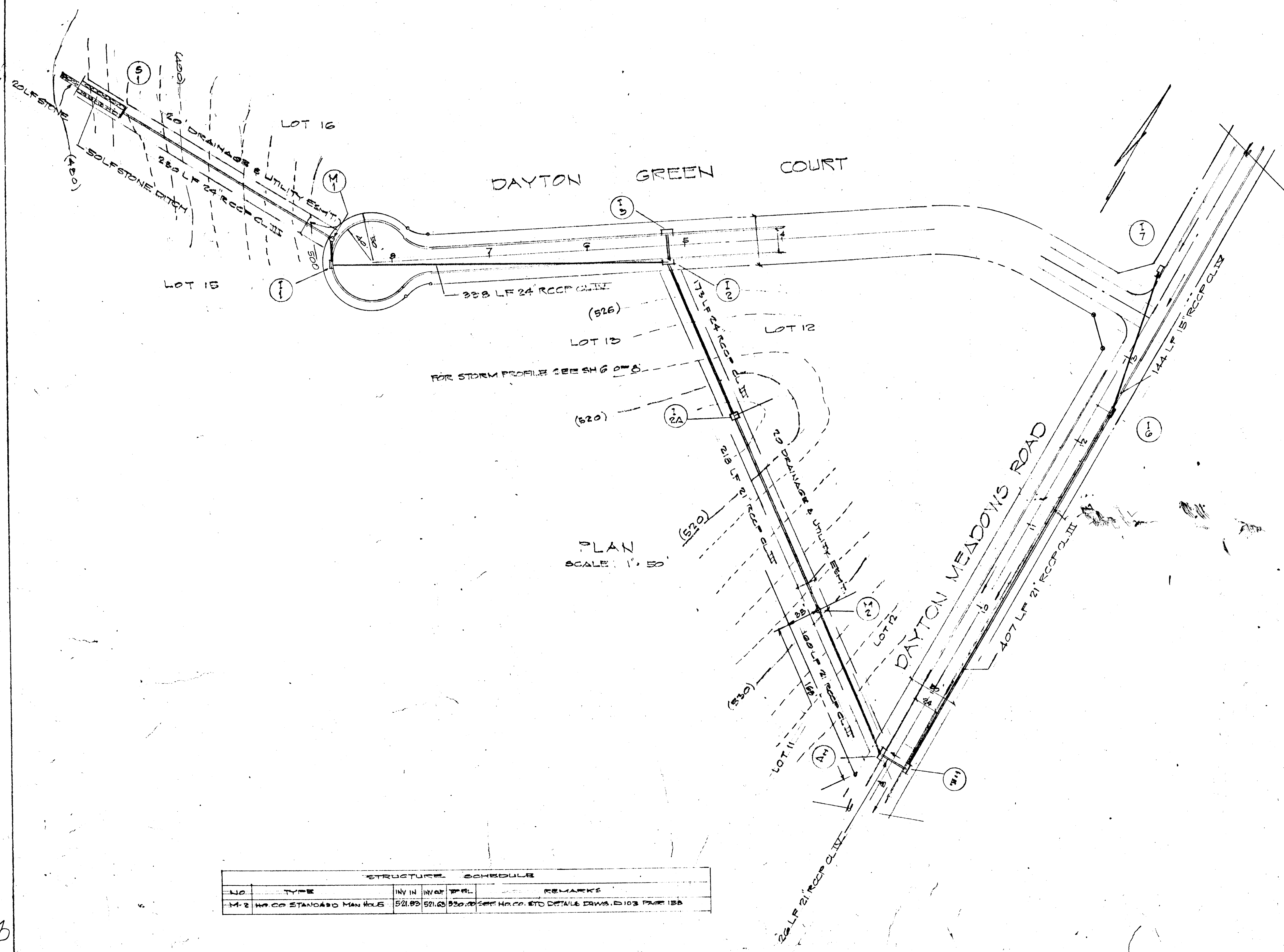

PLAN  
SCALE: 1" = 50'

STRUCTURE SCHEDULE					
NO.	TYPE	INV. IN	INV. OUT	SP. IN	REMARKS
M-2	MANHOLE	521.00	521.00	530.00	SEE HO. CO. STD. DETAILS D.W.S. 1103 PAGE 138

DEPARTMENT OF PUBLIC WORKS  
W. O. Fallick 9-6-79  
 CHIEF BUREAU OF ENGINEERING DATE

OFFICE OF PLANNING AND ZONING  
J. W. Musselman 8-7-79  
 CHIEF DIVISION OF LAND DEVELOPMENT DATE

STORM DRAIN PLAN  
 DAYTON MEADOWS  
 5TH. DISTR. HO. CO. MD.  
 SCALE: AS SHOWN JUNE 6, 1979

ENGINEERS' LAND DEVELOPMENT CONSULTANTS  
 HUDKINS ASSOC.  
 231 JOSEPH SQUARE  
 COLUMBIA MD 21044

*John H. Schaefer*  
 6-7-79  
 [Professional Engineer Seal]



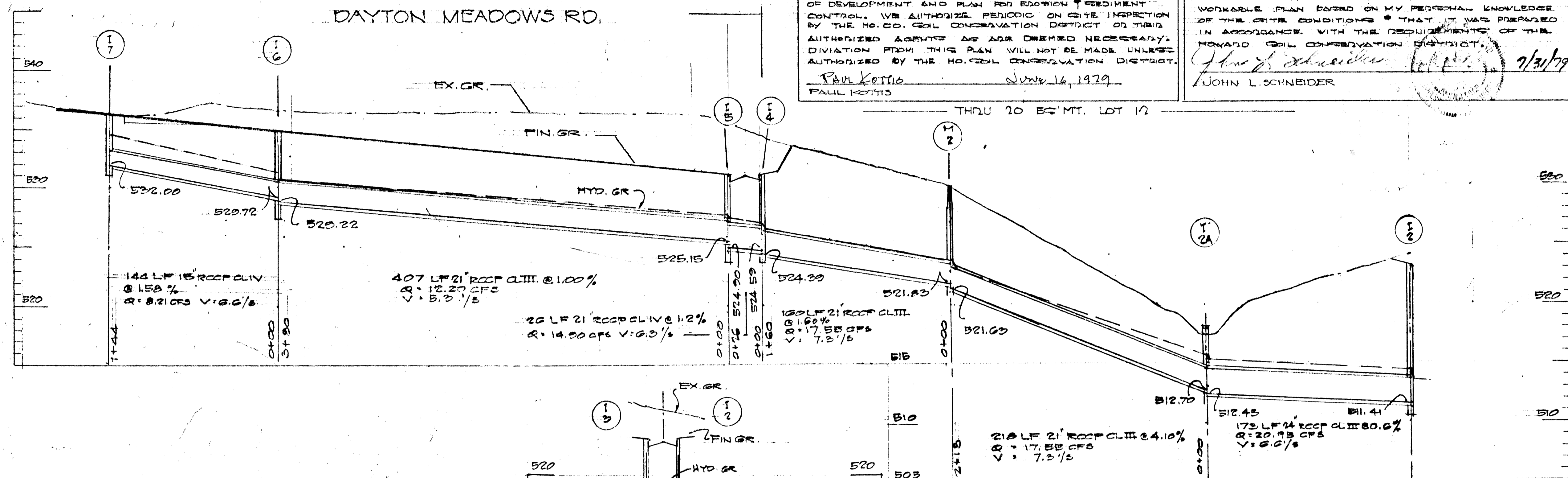

**DEVELOPER'S CERTIFICATE:**  
 I HEREBY CERTIFY THAT ALL DEVELOPMENT AND/OR CONSTRUCTION WILL BE DONE ACCORDING TO THE PLAN OF DEVELOPMENT AND PLAN FOR EROSION & SEDIMENT CONTROL. WE AUTHORIZE PERIODIC ON SITE INSPECTION BY THE HO. CO. SOIL CONSERVATION DISTRICT OR THEIR AUTHORIZED AGENTS AS AND WHEN NECESSARY. DIVISION FROM THIS PLAN WILL NOT BE MADE UNLESS AUTHORIZED BY THE HO. CO. CONSERVATION DISTRICT.  
 PAUL KOTTIS  
 JUNE 16, 1979

**ENGINEER'S CERTIFICATE:**  
 I HEREBY CERTIFY THAT THIS PLAN FOR EROSION & SEDIMENT CONTROL REPRESENTS A PRACTICAL & WORKABLE PLAN BASED ON MY PERSONAL KNOWLEDGE OF THE SITE CONDITIONS & THAT IT WAS PREPARED IN ACCORDANCE WITH THE REQUIREMENTS OF THE HOWARD SOIL CONSERVATION DISTRICT.  
 JOHN L. SCHNEIDER  
 7/31/79

**SEDIMENT CONTROL NOTES:**

- OBTAIN GRADING PERMIT.
  - THE HO. CO. BUREAU OF LICENCES, INSPECTIONS & PERMITS SHALL BE GIVEN 24 HRS NOTICE PRIOR TO ANY GRADING.
  - ALL SEDIMENT CONTROL MEASURES SHOWN ON THIS PLAN UNLESS OTHERWISE SPECIFIED SHALL BE INSTALLED ACCORDING TO NOTE #3.
  - ALL SLOPES MAX. 5:1
  - FOLLOWING THE DETAILIZATION OF ALL AREAS SEDIMENT CONTROL MEASURES MAY BE REMOVED & GRADED TO THE FINAL GRADES SHOWN & STABILIZED IMMEDIATELY.
  - IN THE EVENT OF EXCESS MATERIAL, EXCESS MATERIAL SHALL BE RETAINED PILED WITH A MAX. 5:1 SLOPE IN AN AREA CLEARED FOR THIS PURPOSE. ON-SITE, STABILIZE STOCK PILE IN ACCORDANCE WITH NOTE #3.
  - SEDIMENT CONTROL MEASURES SHALL NOT BE REMOVED UNTIL APPROVAL IS OBTAINED FROM THE HO. CO. BUREAU OF LICENCES, PERMITS & INSPECTIONS.
  - PERMANENT STABILIZATION.  
 APPLY:  
 2000 LBS. PER AC. OF PULVERIZED DOLOMITIC LIMESTONE.  
 700 LBS. PER AC. OF 0-20-0 SUPER PHOSPHATE.  
 1000 LBS. PER AC. OF 16-10-10 FERTILIZER  
 25 LBS. PER AC. OF KENTUCKY 51 TALL FESCUE & 25 LBS. OF ANNUAL RYE GRASS.
- NOTES:  
 SEED BETWEEN MARCH 1ST/MAY 1ST OR AUG 1ST/OCT 1ST ONLY.  
 MULCH: 4 TONS PER AC. OF UNWEATHERED WHEATSTRAW, TIE DOWN MULCH WITH 400 GAL. PER AC. LIQUID ANCHOR.

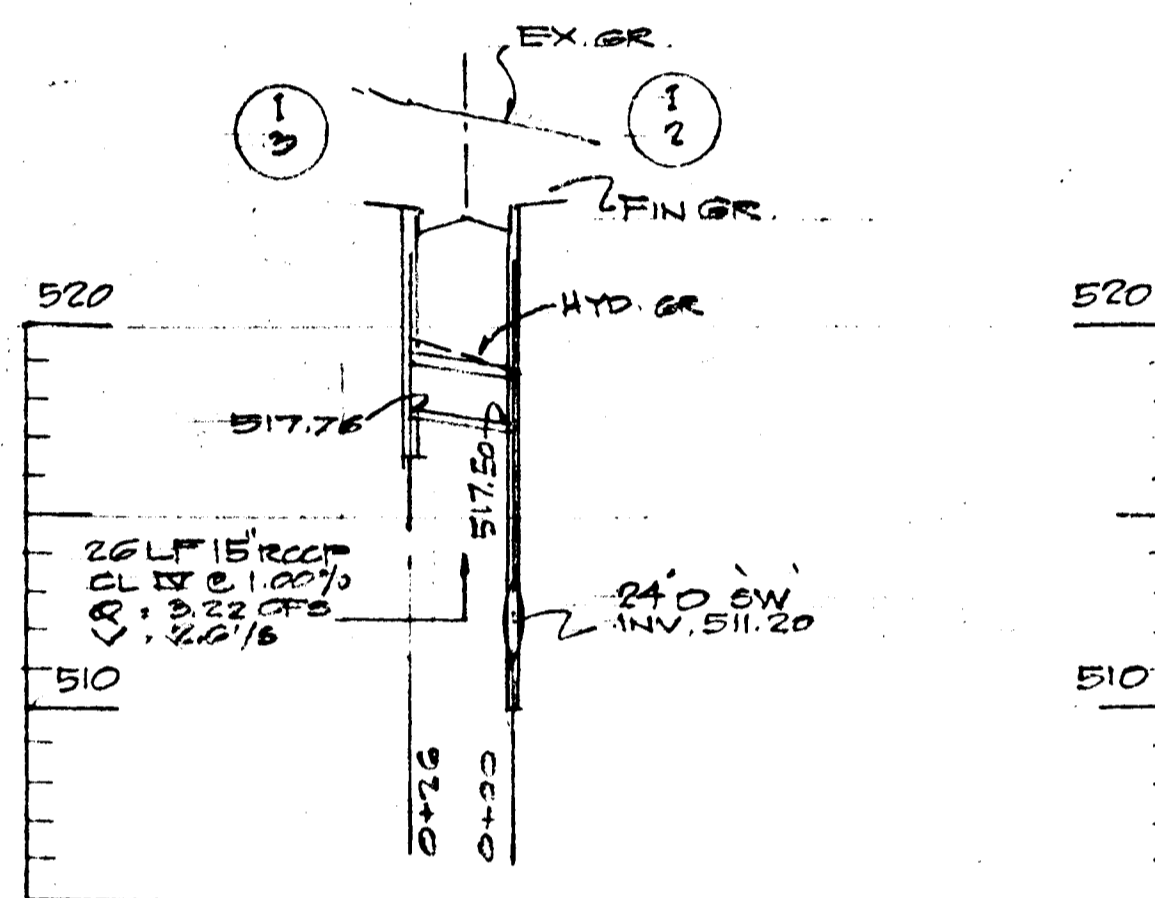
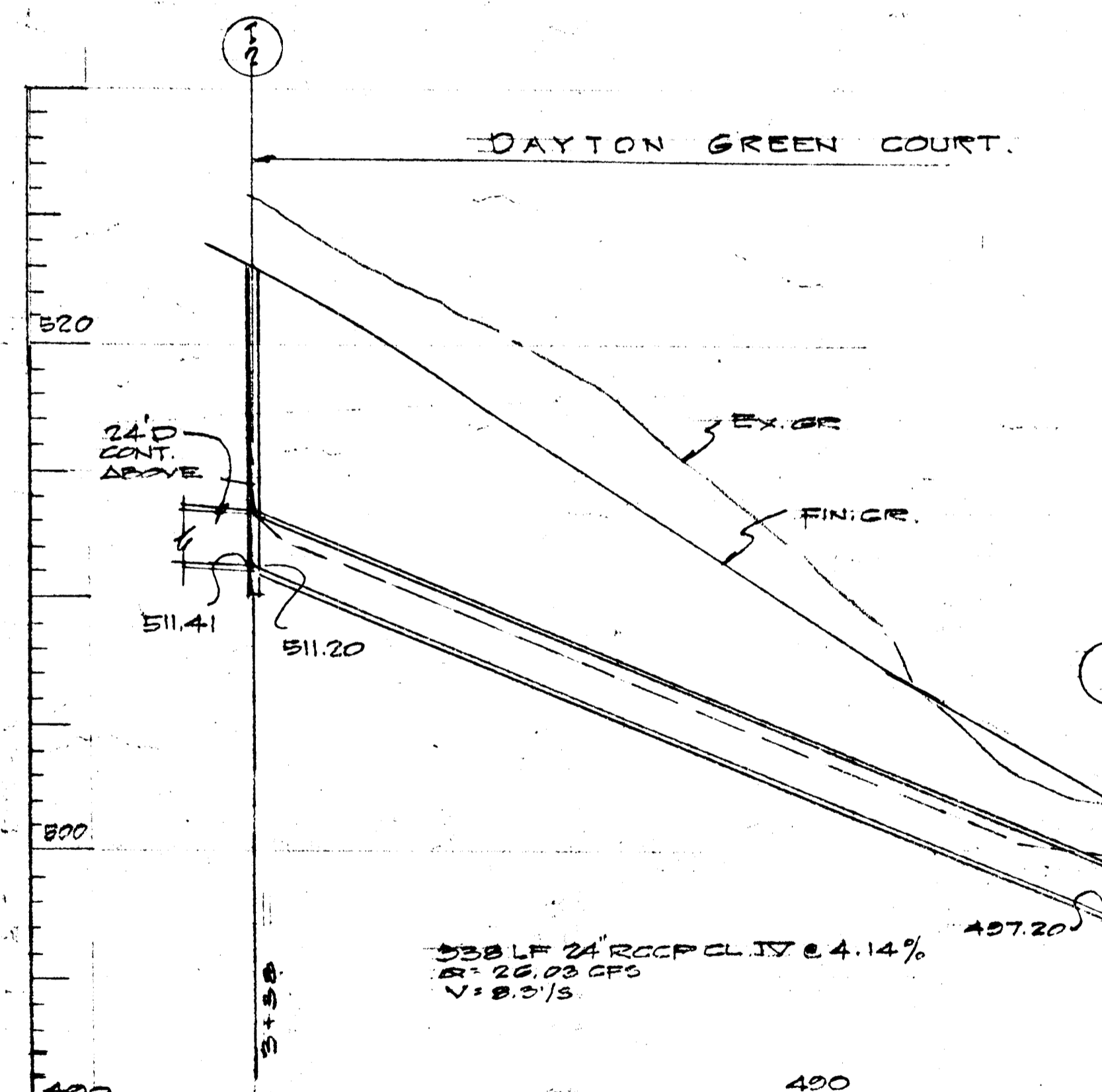

**PROFILE**  
 SCALE: HOR. 1"=20'  
 VERT. 1"=5'  
 THRU 20 ESMT BETWEEN LOT 15 & 16

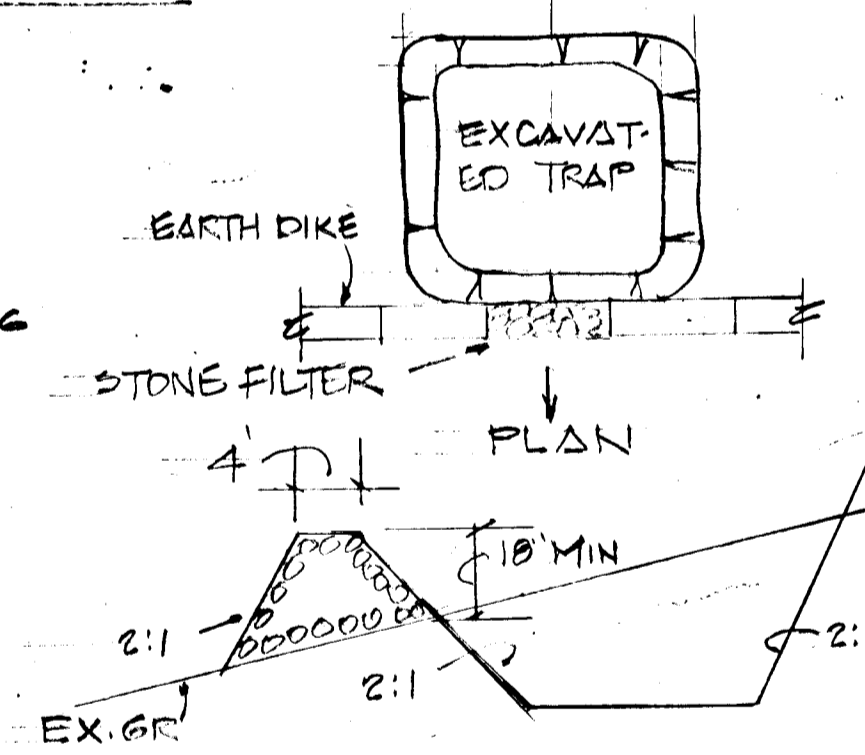

**SECTION**  
 TEMP. EXCAVATED TRAP & STONE FILTER  
 NO SCALE

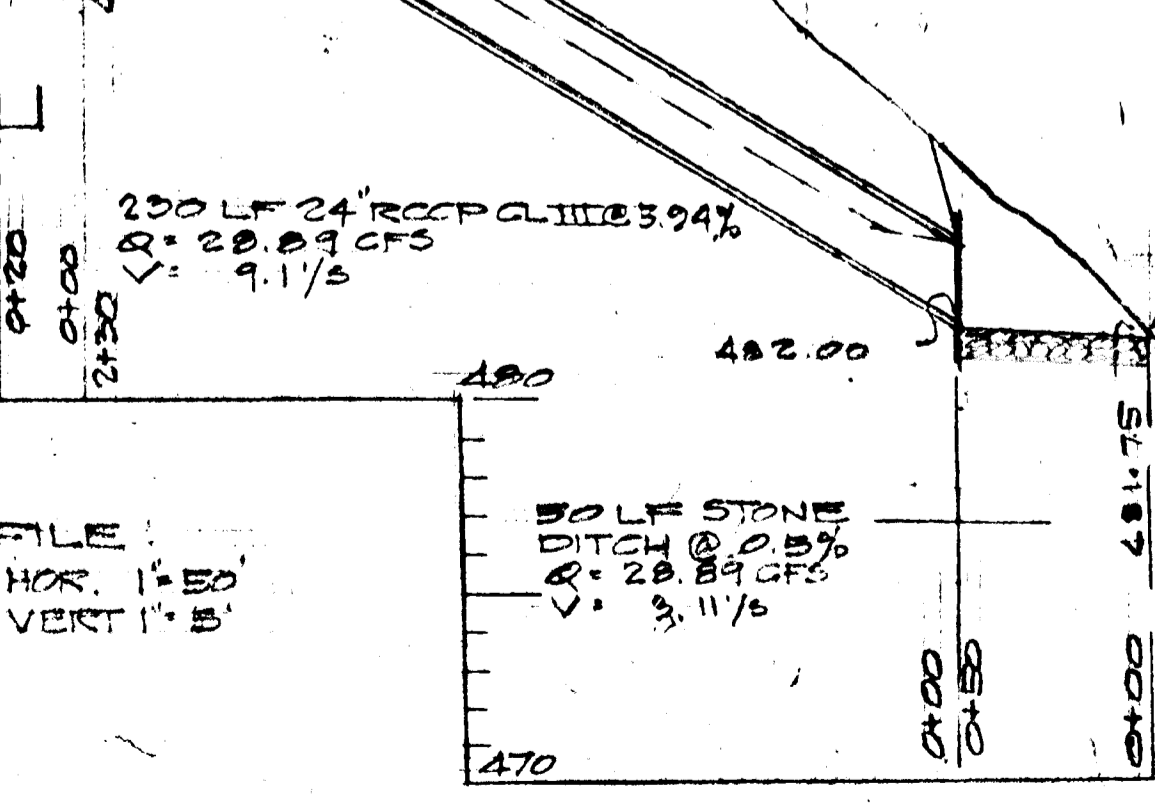
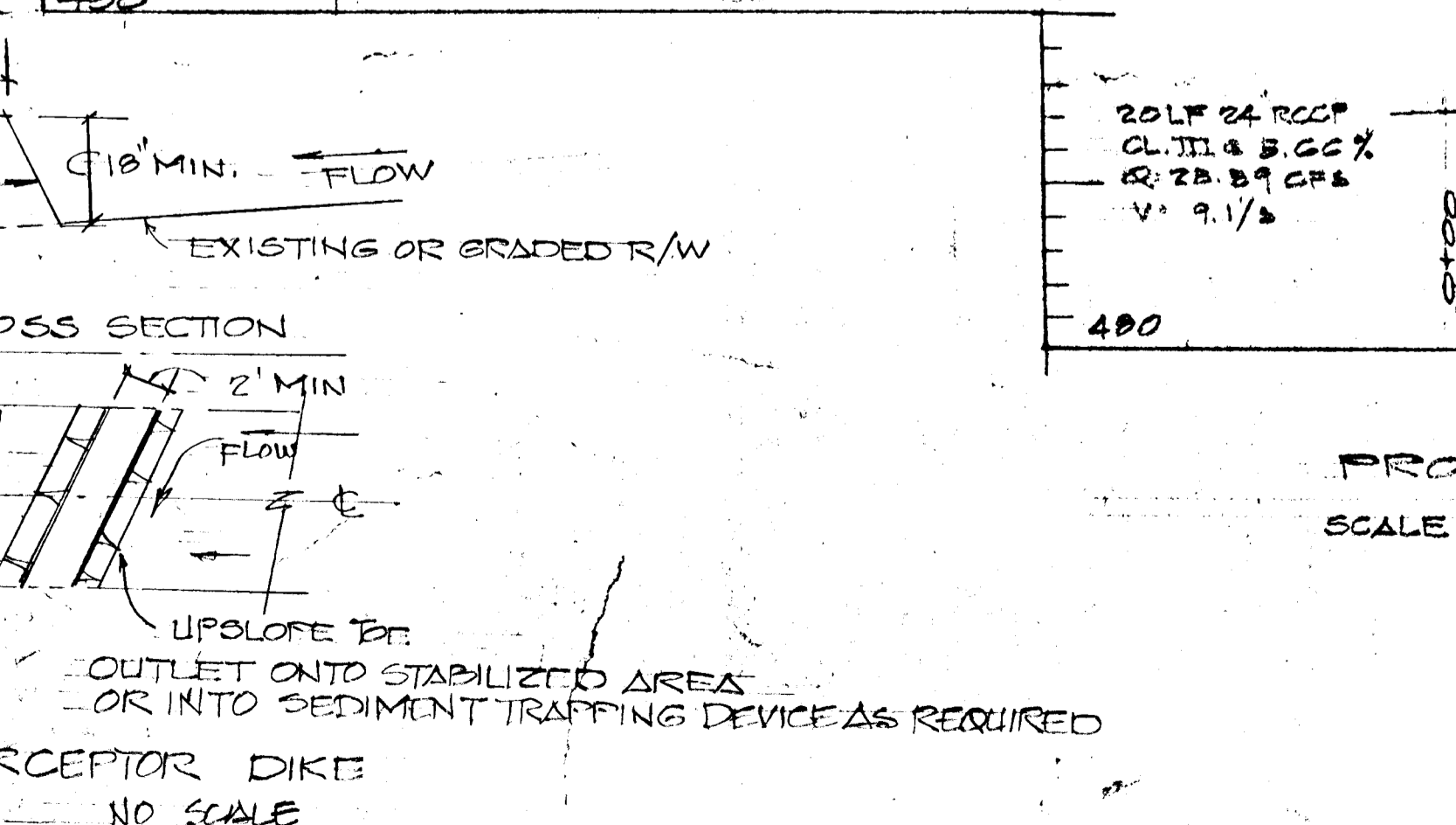

**PROFILE**  
 SCALE: HOR. 1"=50'  
 VERT. 1"=5'

THIS DEVELOPMENT PLAN IS APPROVED FOR SOIL EROSION AND SEDIMENT CONTROL BY THE HOWARD SOIL CONSERVATION DISTRICT.  
 APPROVED: *Robert Zehn* DATE: 6-15-79  
 HOWARD S.C.D.  
 REVIEWED FOR HOWARD S.C.D. AND MEETS TECHNICAL REQUIREMENTS.  
*Winston Bennett* DATE: 8-15-79  
 U.S. SOIL CONSERVATION SERVICE

DEPARTMENT OF PUBLIC WORKS  
*Wolabus* 9-6-79  
 CHIEF, BUREAU OF ENGINEERING  
 OFFICE OF PLANNING AND ZONING  
*John M. Mumman*  
 CHIEF, DIVISION OF LAND DEVELOPMENT DATE: 8-20-79

**STORM DRAIN PROFILES & DETAILS**  
 DAYTON MEADOWS

5TH DISTRICT HO. CO., MD.  
 SCALE: AS SHOWN JUNE 5 1979  
 OWNED: PAUL KOTTIS  
 1015 GARDEN AVE  
 SILVER SPRING, MD. 20904

ENGINEERS: LAND DEVELOPMENT CONSULTANTS  
 HUDKINS ASSOCIATES, INC.  
 231 JOSEPH SQUARE  
 COLUMBIA, MD. 21044  
 780-9080

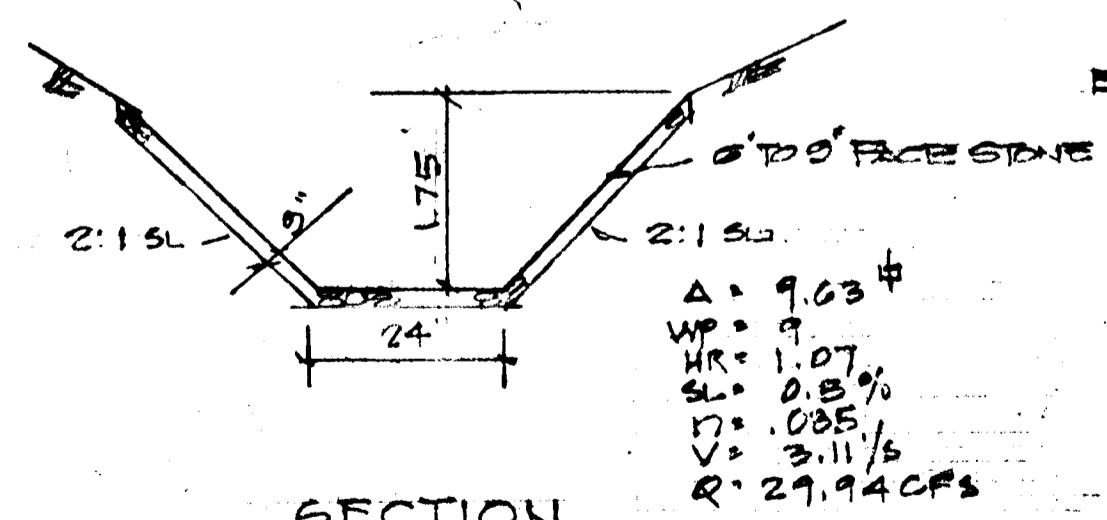

**SECTION**  
 STONE OUTFALL DITCH S-1  
 NO SCALE

*John L. Schneider* 7/31/79  
*John L. Schneider* 6-7-79

**STORM DRAIN PROFILES & DETAILS**

SCALE	APPROVED BY	DRAWN BY
DATE	REVIS	REVIS
<b>DAYTON MEADOWS</b>		
DRAWING NUMBER		



PERCOLATION TEST DATA		
LOT NO	AVERAGE PERCOLATION TIME IN MINUTES FOR SECOND INCH	MAX. DEPTH PERMITTED FOR EFFLUENT PIPES TO ENTER SEWERAGE DISPOSAL AREA AT ITS HIGHEST ELEVATION WITH REFERENCE TO EXISTING GRADE AT TIME OF PERC. TEST.
1	8 MINUTES	3 FEET
2	9 MIN.	3 FT.
3	8 MIN.	3 FT.
4	14 MIN.	4 FT.
5	14 MIN.	4 FT.
6	NON BUILDABLE EX DWELLING	-
7	12 MIN.	4 FT.
8	20 MIN.	4 FT.
9	NON BUILD.	4 FT.
10	20 MIN.	4 FT.
11	12 MIN.	4 FT.
12	12 MIN.	4 FT.
13	11 MIN.	4 FT.
14	10 MIN.	4 FT.
15	10 MIN.	4 FT.
16	10 MIN.	4 FT.
17	10 MIN.	4 FT.
18	10 MIN.	4 FT.
19	10 MIN.	4 FT.
20	10 MIN.	4 FT.
21	10 MIN.	4 FT.
22	10 MIN.	4 FT.
23	10 MIN.	4 FT.
24	10 MIN.	4 FT.
25	10 MIN.	4 FT.
26	10 MIN.	4 FT.
27	10 MIN.	4 FT.
28	10 MIN.	4 FT.
29	10 MIN.	4 FT.
30	10 MIN.	4 FT.
31	10 MIN.	4 FT.
32	10 MIN.	4 FT.
33	10 MIN.	4 FT.
34	10 MIN.	4 FT.
35	10 MIN.	4 FT.
36	10 MIN.	4 FT.
37	10 MIN.	4 FT.
38	10 MIN.	4 FT.
39	10 MIN.	4 FT.
40	10 MIN.	4 FT.
41	10 MIN.	4 FT.
42	10 MIN.	4 FT.
43	10 MIN.	4 FT.
44	10 MIN.	4 FT.
45	10 MIN.	4 FT.
46	10 MIN.	4 FT.
47	10 MIN.	4 FT.
48	10 MIN.	4 FT.
49	10 MIN.	4 FT.
50	10 MIN.	4 FT.
51	10 MIN.	4 FT.
52	10 MIN.	4 FT.
53	10 MIN.	4 FT.
54	10 MIN.	4 FT.
55	10 MIN.	4 FT.
56	10 MIN.	4 FT.
57	10 MIN.	4 FT.
58	10 MIN.	4 FT.
59	10 MIN.	4 FT.
60	10 MIN.	4 FT.
61	10 MIN.	4 FT.
62	10 MIN.	4 FT.
63	10 MIN.	4 FT.
64	10 MIN.	4 FT.
65	10 MIN.	4 FT.
66	10 MIN.	4 FT.
67	10 MIN.	4 FT.
68	10 MIN.	4 FT.
69	10 MIN.	4 FT.
70	10 MIN.	4 FT.
71	10 MIN.	4 FT.
72	10 MIN.	4 FT.
73	10 MIN.	4 FT.
74	10 MIN.	4 FT.
75	10 MIN.	4 FT.
76	10 MIN.	4 FT.
77	10 MIN.	4 FT.
78	10 MIN.	4 FT.
79	10 MIN.	4 FT.
80	10 MIN.	4 FT.
81	10 MIN.	4 FT.
82	10 MIN.	4 FT.
83	10 MIN.	4 FT.
84	10 MIN.	4 FT.
85	10 MIN.	4 FT.
86	10 MIN.	4 FT.
87	10 MIN.	4 FT.
88	10 MIN.	4 FT.
89	10 MIN.	4 FT.
90	10 MIN.	4 FT.
91	10 MIN.	4 FT.
92	10 MIN.	4 FT.
93	10 MIN.	4 FT.
94	10 MIN.	4 FT.
95	10 MIN.	4 FT.
96	10 MIN.	4 FT.
97	10 MIN.	4 FT.
98	10 MIN.	4 FT.
99	10 MIN.	4 FT.
100	10 MIN.	4 FT.

DEPARTMENT OF PUBLIC WORKS

*W.O. Roberts* 9-6-79  
CHIEF, BUREAU OF ENGINEERING DATE

OFFICE OF PLANNING & ZONING

*Shirley M. Woodman* 9-20-79  
CHIEF, DIVISION OF LAND DEVELOPMENT DATE

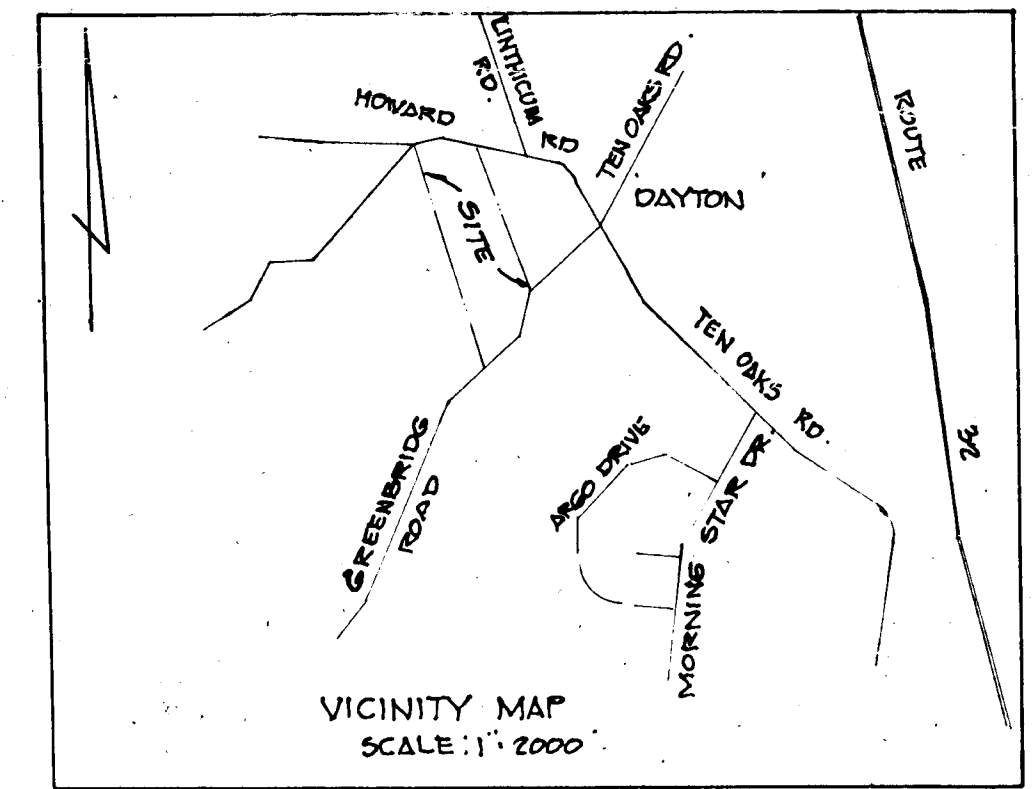

DENSITY TABULATIONS  
TOTAL NO. OF LOTS = 22  
AREA OF LOTS = 73.53 AC  
AREA OF PUBLIC R/W'S = 4.93 AC  
TOTAL AREA = 78.46 AC

- GENERAL NOTES:
1. AREA OF PARCELS = 78.46 AC.
  2. TOTAL NO. OF LOTS = 22.
  3. ZONING CLASSIFICATION = R-10.
  4. LOT AREA = 73.53 AC.
  5. AREA OF PUBLIC R/W'S = 4.93 AC.
  6. OWNER: WILLIAM C. MITCHELL.
  7. DATED: 9-1-79.
  8. ENGINEER: W.C. MITCHELL.

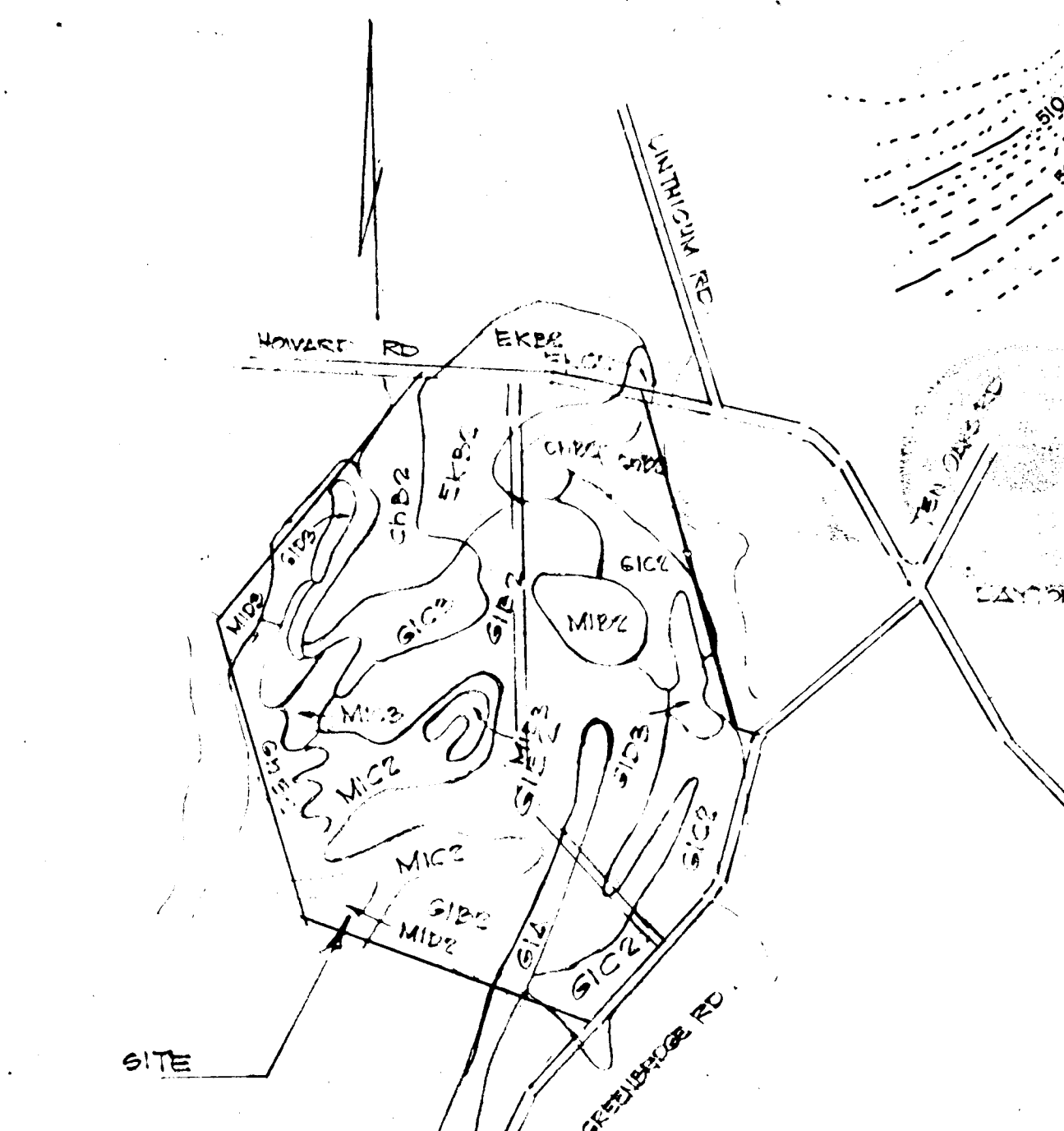

SOILS MAP  
SCALE 1" = 600'  
MAP 17

PROPOSED 30" DITCH  
SEE SECTION PRELIMINARY  
ROAD DETAILS SH. 2 OF 2.

CONTRACTOR: *W.C. Mitchell*  
DATE: 9-1-79

ENGINEER: WILLIAM C. MITCHELL  
9088-D TOWN & COUNTRY BLVD  
EAST RICHMOND, MO. 63024  
618-9198

DRAINAGE AREA MAP

PRELIMINARY PLAN  
DAYTON MEADOWS  
FORMERLY

WILLIAM C. MITCHELL PROPERTY  
- 78 AC PARCEL  
GREENBRIDGE ROAD

5TH DISTRICT  
SCALE 1" = 100'

HC CO. MO.  
OCT. 9, 1978

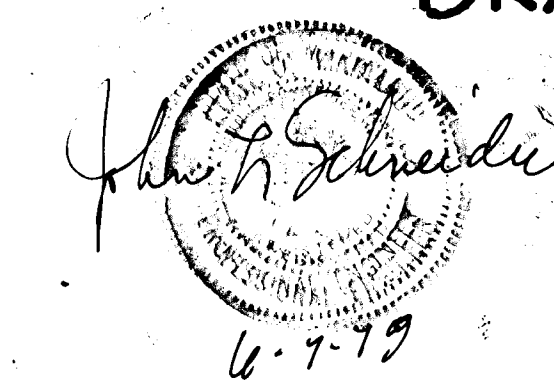

DRAINAGE AREA MAP

P. 79-23



W. J. P. [Signature] 9-6-79  
CHIEF, BUREAU OF ENGINEERING DATE

OFFICE OF PLANNING AND ZONING  
John W. M... [Signature] 8-20-79  
CHIEF, DIVISION OF LAND DEVELOPMENT DATE

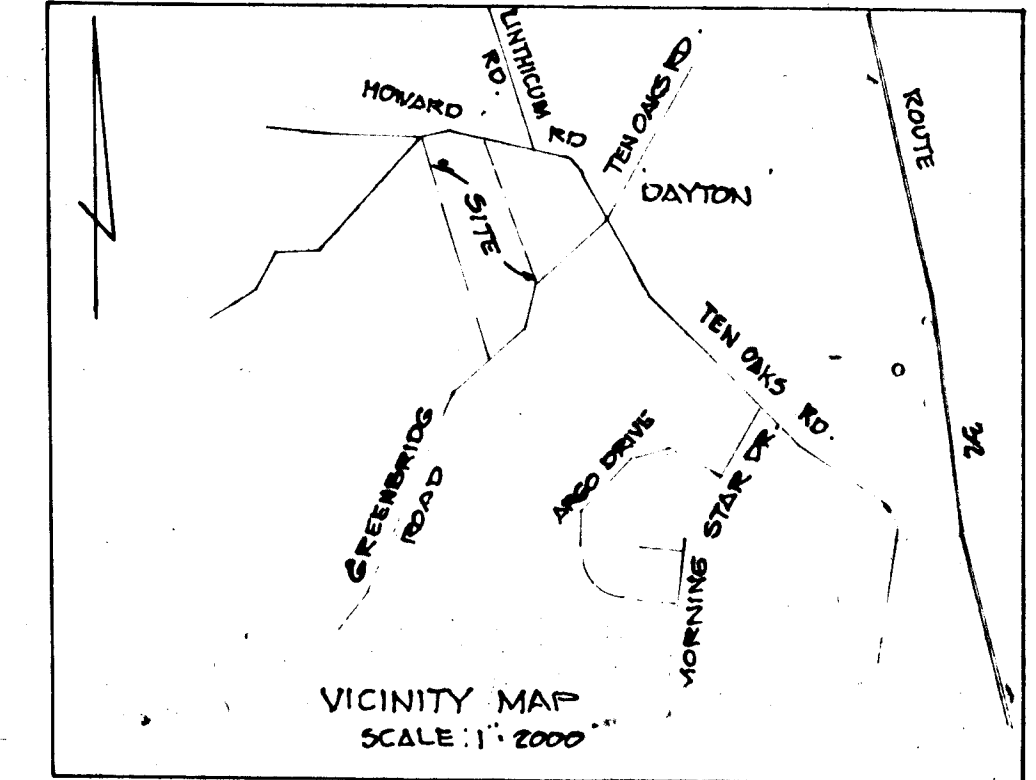

- TEMP. EXCAVATED TRAP #1  
DRAINAGE AREA = 1.70 AC  
DISTURBED AREA = 1.60 AC  
VOL. REQUIRED STORAGE = 118 CU YDS  
PROP. TRAP 40' X 40' X 3' DEEP = 178 CU YDS  
WIDTH STONE FILTER = 12'
- TEMP. EXCAVATED TRAP #2  
DRAINAGE AREA = 2.02 AC  
DISTURBED AREA = 2.02 AC  
VOL. REQUIRED STORAGE = 136 CU YDS  
PROP. TRAP 40' X 40' X 3' DEEP = 178 CU YDS  
WIDTH STONE FILTER = 14'
- TEMP. EXCAVATED TRAP #3  
DRAINAGE AREA = 1.84 AC  
DISTURBED AREA = 1.84 AC  
VOL. REQUIRED STORAGE = 124 CU YDS  
PROP. TRAP 40' X 40' X 3' DEEP = 178 CU YDS  
WIDTH STONE FILTER = 11.04'
- TEMP. EXCAVATED TRAP #4  
DRAINAGE AREA = 1.83 AC  
DISTURBED AREA = 1.8 AC  
VOL. REQUIRED STORAGE = 123 CU YDS  
PROP. TRAP 40' X 40' X 3' DEEP = 178 CU YDS  
WIDTH STONE FILTER = 11.1'

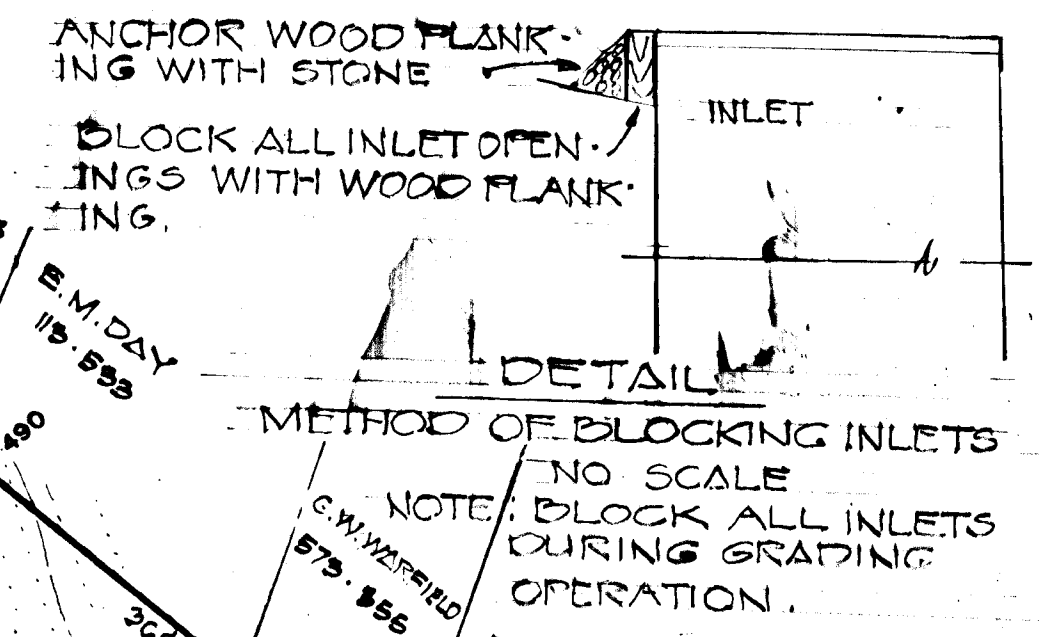

MINUTE	MINUTE	MINUTE	MINUTE
1	1.5	2	2.5
2	3	3	4
3	4.5	4	5.5
4	6	5	7
5	7.5	6	8.5
6	9	7	10
7	10.5	8	11.5
8	12	9	13
9	13.5	10	14.5
10	15	11	16
11	16.5	12	17.5
12	18	13	19
13	19.5	14	20.5
14	21	15	22
15	22.5	16	23.5
16	24	17	25
17	25.5	18	26.5
18	27	19	28
19	28.5	20	29.5
20	30	21	31

TEMP. EXCAVATED TRAP #5  
DRAINAGE AREA = 4.15 AC  
VOL. REQUIRED STORAGE = 332 CU YDS  
PROP. TRAP 60' X 40' X 4' DEEP = 355 CU YDS  
WIDTH STONE OUTLET = 30'

John M. Bongus 6-8-79

CHECK THE MEASUREMENTS FOR THE SEWAGE DISPOSAL AREA FOR THE LOT AREA AS SHOWN.

THIS AREA [Hatched] INDICATES A PRIVATE EASEMENT OF APPROXIMATELY 10,000 SQUARE FEET AS REQUIRED BY THE MARYLAND STATE DEPARTMENT OF HEALTH AND MENTAL HYGIENE FOR INDIVIDUAL DISPOSAL. IMPROVEMENTS SPANNING THIS AREA IS RESTRICTED. PUBLIC SERVICE IS AVAILABLE AND SERVICES ANY RESIDENTIAL STRUCTURES CONSTRUCTED IN THIS SITE. THIS EASEMENT SHALL BECOME null and void upon completion of the public sewage system.

Water Par 5/18/79

THE LOTS SHOWN HEREON COMPLY WITH THE MINIMUM OWNERSHIP WIDTH AND LOT AREAS AS REQUIRED BY THE MARYLAND STATE DEPT. OF HEALTH AND MENTAL HYGIENE.

Robert W. Zilmer 8-18-79  
APPROVED HO. S.C.D. DATE

REVIEWED FOR HOWARD S.C.D. AND MEETS TECHNICAL REQUIREMENTS.  
Wm. B. [Signature] 8/10/79  
U.S. SOIL CONSERVATION SERVICE DATE

DEVELOPERS CERTIFICATE: I HEREBY CERTIFY THAT ALL DEVELOPMENT AND/OR CONSTRUCTION WILL BE DONE ACCORDING TO THIS PLAN OF DEVELOPMENT AND PLAN FOR EROSION AND SEDIMENT CONTROL. WE AUTHORIZE PERIODIC ON SITE INSPECTION BY THE HO. SOIL CONSERVATION DISTRICT OR THEIR AUTHORIZED AGENTS AS ARE DEEMED NECESSARY. DIVIATION FROM THIS PLAN WILL NOT BE MADE UNLESS AUTHORIZED BY THE HO. SOIL CONSERVATION DISTRICT.

Paul Kottis 7/31/79  
PAUL KOTTIS DATE

ENGINEERS CERTIFICATE: I HEREBY CERTIFY THAT THIS PLAN FOR EROSION AND SEDIMENT CONTROL REPRESENTS A PRACTICAL & WORKABLE PLAN BASED ON MY PERSONAL KNOWLEDGE OF THE SITE CONDITIONS AND THAT IT WAS PREPARED IN ACCORDANCE WITH REQUIREMENTS OF THE HOWARD SOIL CONSERVATION DISTRICT.

John L. Schneider 7/31/79  
JOHN L. SCHNEIDER DATE

GEN. ENG. MASS. 1000  
SCALE 1" = 1000'

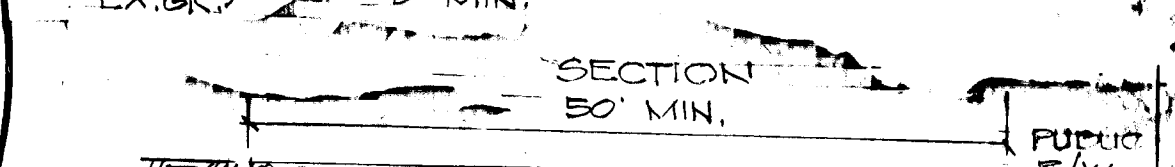
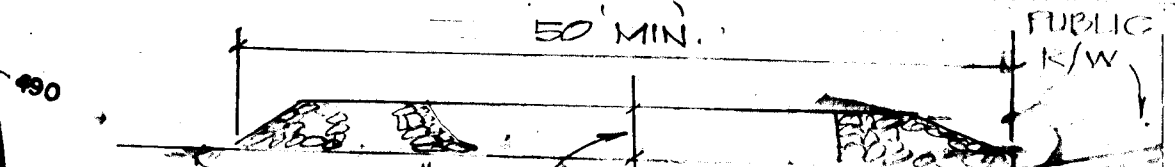
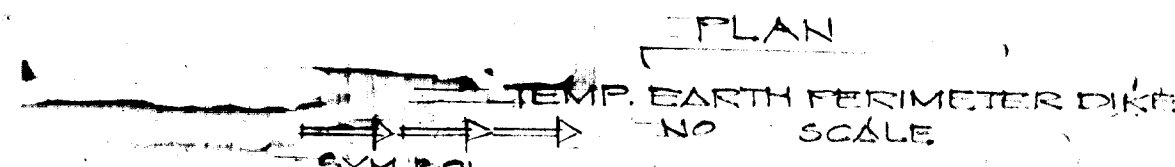
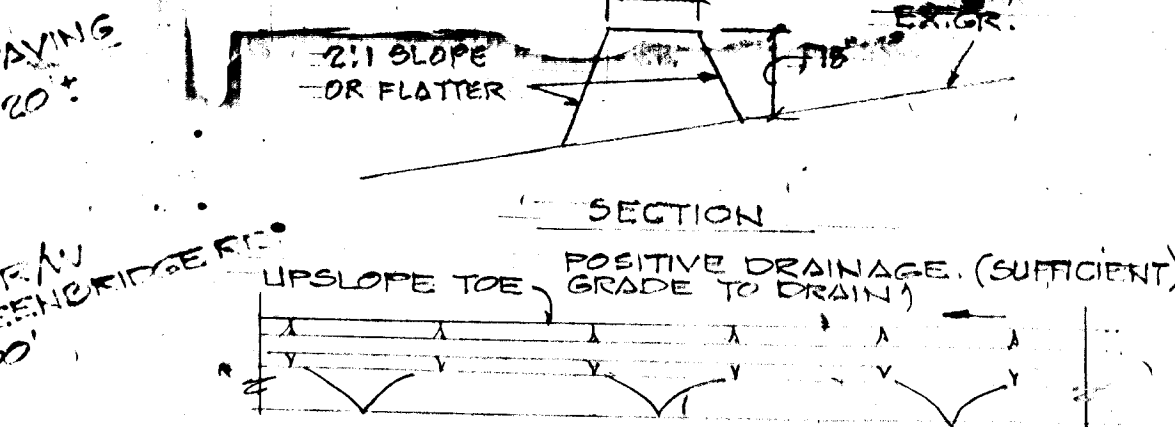
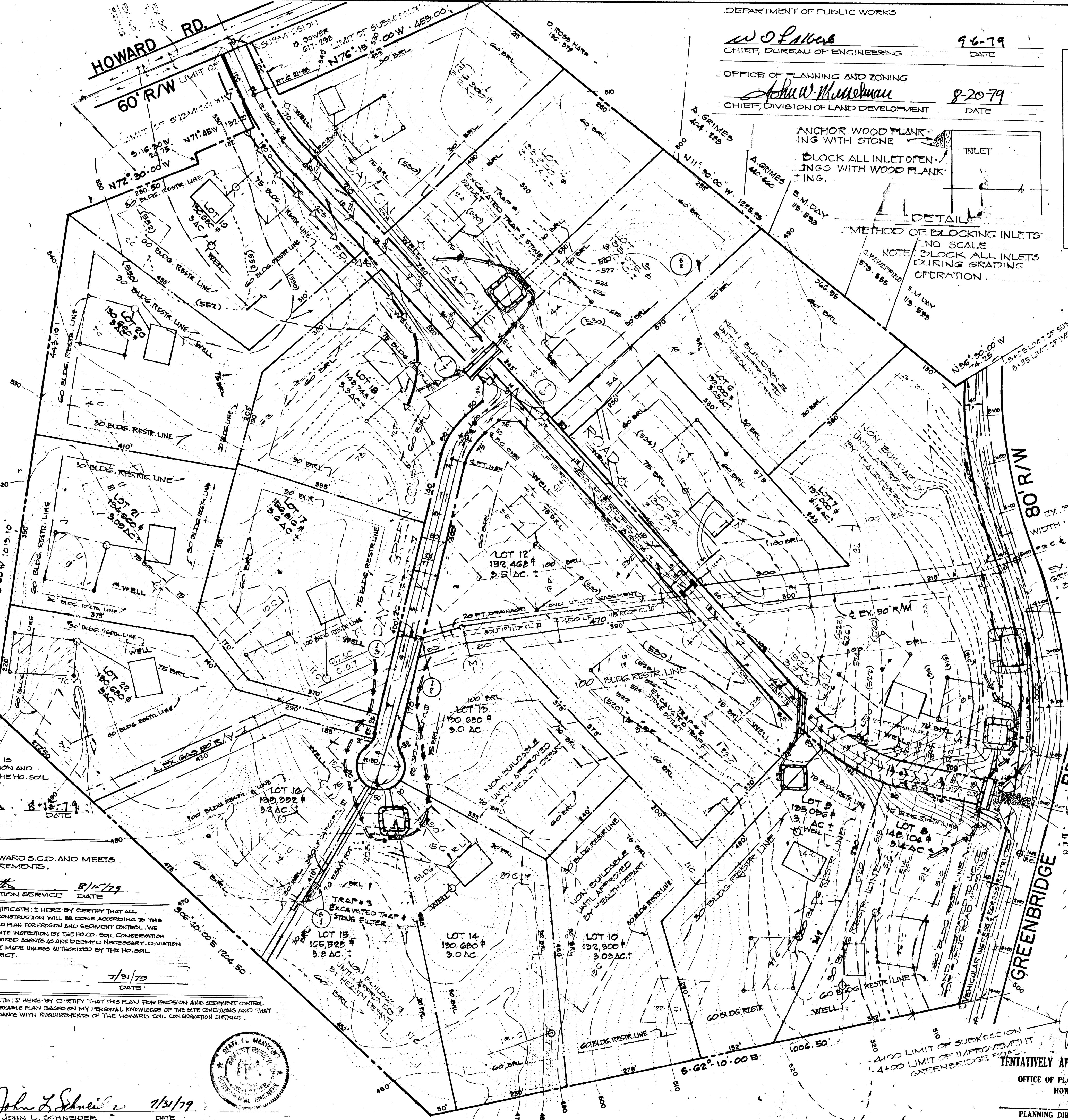

PROVIDE APPROPRIATE TRANSITION BETWEEN STABILIZED CONSTRUCTION ENTRANCE & PUBLIC RIGHT OF WAY.

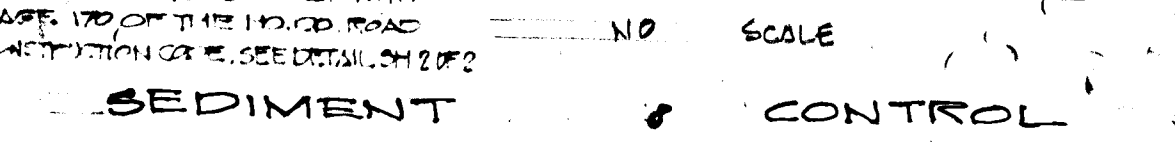

SEDIMENT CONTROL

DAYTON MEADOWS FORMERLY WILLIAM G. MITCHELL ESTATE

78 AC. [Signature] 7/18/79

APPROVED ON APRIL 6, 1979  
OFFICE OF PLANNING AND ZONING OF HOWARD COUNTY

PLANNING DIRECTOR DATE P-79-23

F-79-176 SHEET 80F B