

DEVELOPER'S CERTIFICATE

I certify that all development and/or construction will be done according to this plan of development and plan for Erosion and Sediment Control, and I also authorize periodic on-site inspection by the Howard Soil Conservation District or their authorized agents as are deemed necessary. Deviation from this plan will not be made unless authorized by the Howard Soil Conservation District.

Walter Park
Signature
9/17/78
Date

GENERAL NOTES

1. All Storm Drain & Paving shall be constructed in accordance with the latest details and specifications of Howard Co. & Md. S.H.A.
2. Types of storm drain structures refer to the Standard Details of Howard County & Maryland State Highway Administration.
3. Trench Compaction for Storm Drains within Road or Street right of Way limits shall be in accordance with the latest Howard Co. Road Code.
4. Information concerning underground utilities was obtained from available records, but the Contractor must determine the exact location and elevation of the mains by digging test pits by hand at all utility crossings, well in advance of construction.
5. All utility companies shall be notified 24 hrs. in advance of construction.
6. All traffic control services, parking, and signing to be done in accordance with the Manual of Uniform Traffic Control Devices, 1971 Edition.
7. Sag and Crest Vertical Curves were designed in accordance with "A Policy on Geometric Design of Rural Highways, 1965, by AAS.H.O.
8. Provide Concrete sidewalk Ramps in curbs (Max 12:1 Slope; 4 ft. wide) where shown in plan. See det. sht 309G.
9. Minimum Cover of 2' shall be provided over storm drain pipes in all areas not being final graded by these plans.
10. Design Speed: 25 mph



VICINITY MAP
Scale: 1"=2000'

Reviewed for HOWARD S.C.D. and meets Technical Requirements
Signature: [Signature]
Date: 9-21-78
U.S. Soil Conservation Service

THIS DEVELOPMENT PLAN IS APPROVED FOR SOIL EROSION AND SEDIMENT CONTROL BY THE HOWARD SOIL CONSERVATION DISTRICT.

WES FARR Approved
Date: 9-21-78

LEGEND FOR CURB & GUTTER:
Standard 7" Combination Curb & Gutter
Reverse 7" Combination Curb & Gutter
Mod. Combination Curb & Gutter Reversed
Mod. Combination Curb & Gutter

ENGINEER'S CERTIFICATE

I hereby certify that this plan for Erosion and Sediment Control represents a practical and workable plan based on my personal knowledge of the site conditions and that it was prepared in accordance with the requirements of the Howard Soil Conservation District.

G. Nelson Clark
Signature
Date: 8-3-78
Original Paper As-Built Print signed and sealed by Walter Park R.L.S. No. 5539.



APPROVED: DEPARTMENT OF PUBLIC WORKS		9-28-78-78 Date	
W.P. [Signature] CHIEF, Bureau of Engineering			
APPROVED: HOWARD COUNTY OFFICE OF PLANNING & ZONING		10-9-78 Date	
John W. [Signature] CHIEF, Division of Land Development			
CLARK • FINEFROCK & SACKETT ENGINEERS • PLANNERS • SURVEYORS 11315 LOCKWOOD DRIVE • SILVER SPRING, MARYLAND (301) 593-3400			
DESIGNED	R.O.S.	ROAD CONSTRUCTION PLANS A RESUBDIVISION OF PARCEL A-1 CARRIED STONE	SCALE As Shown
DRAWN	K.I.W.	COLUMBIA VILLAGE OF OWEN BROWN SECTION 2 AREA 1 6TH ELECTION DISTRICT HOWARD COUNTY, MARYLAND	DRAWING 1 of 8
CHECKED	R.U.S.	FOR: HOWARD RESEARCH & DEVELOPMENT CORP. The Rouse Company Building Columbia, Maryland 21044	FILE NO. 1241-D
DATE	July, 1978		

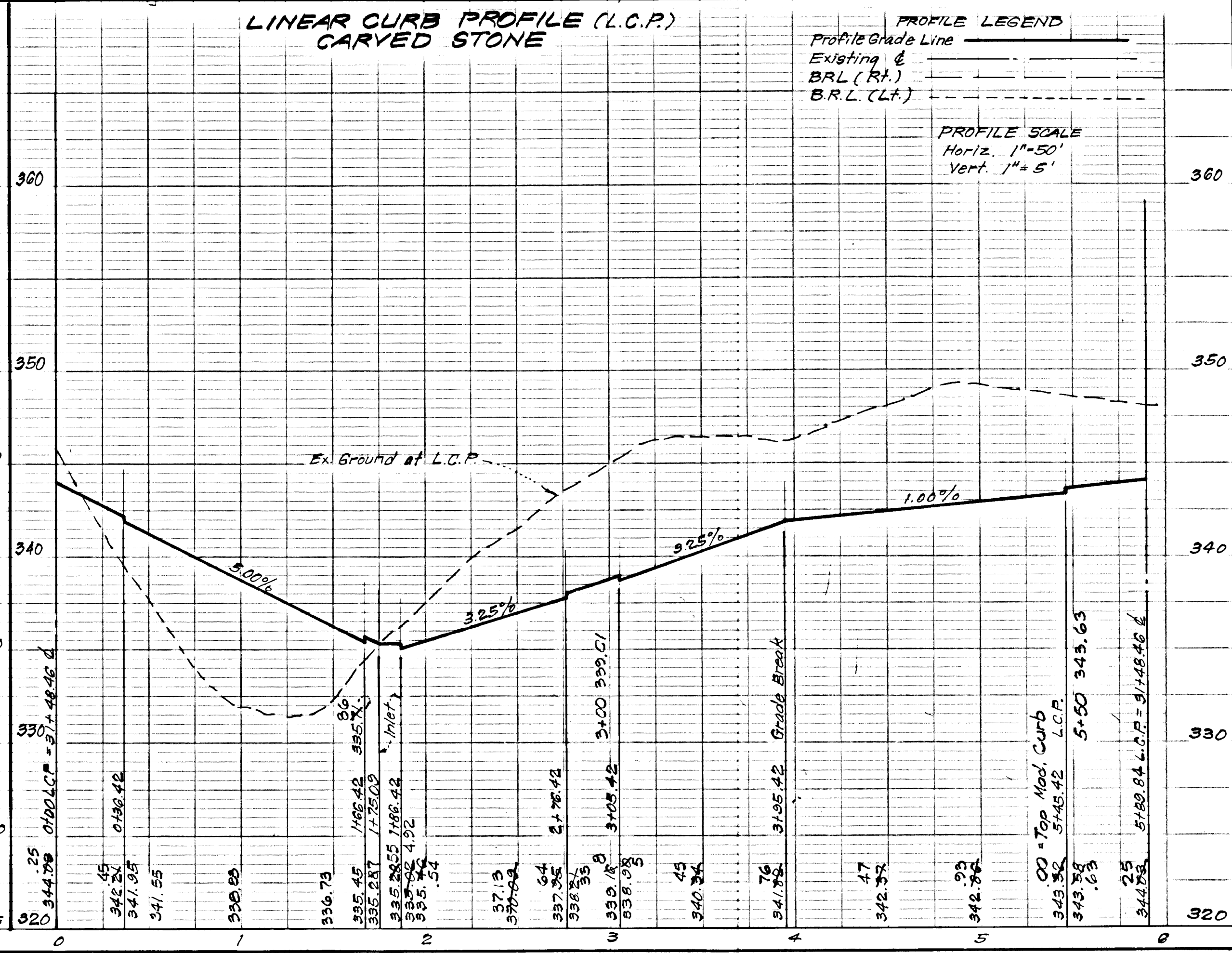
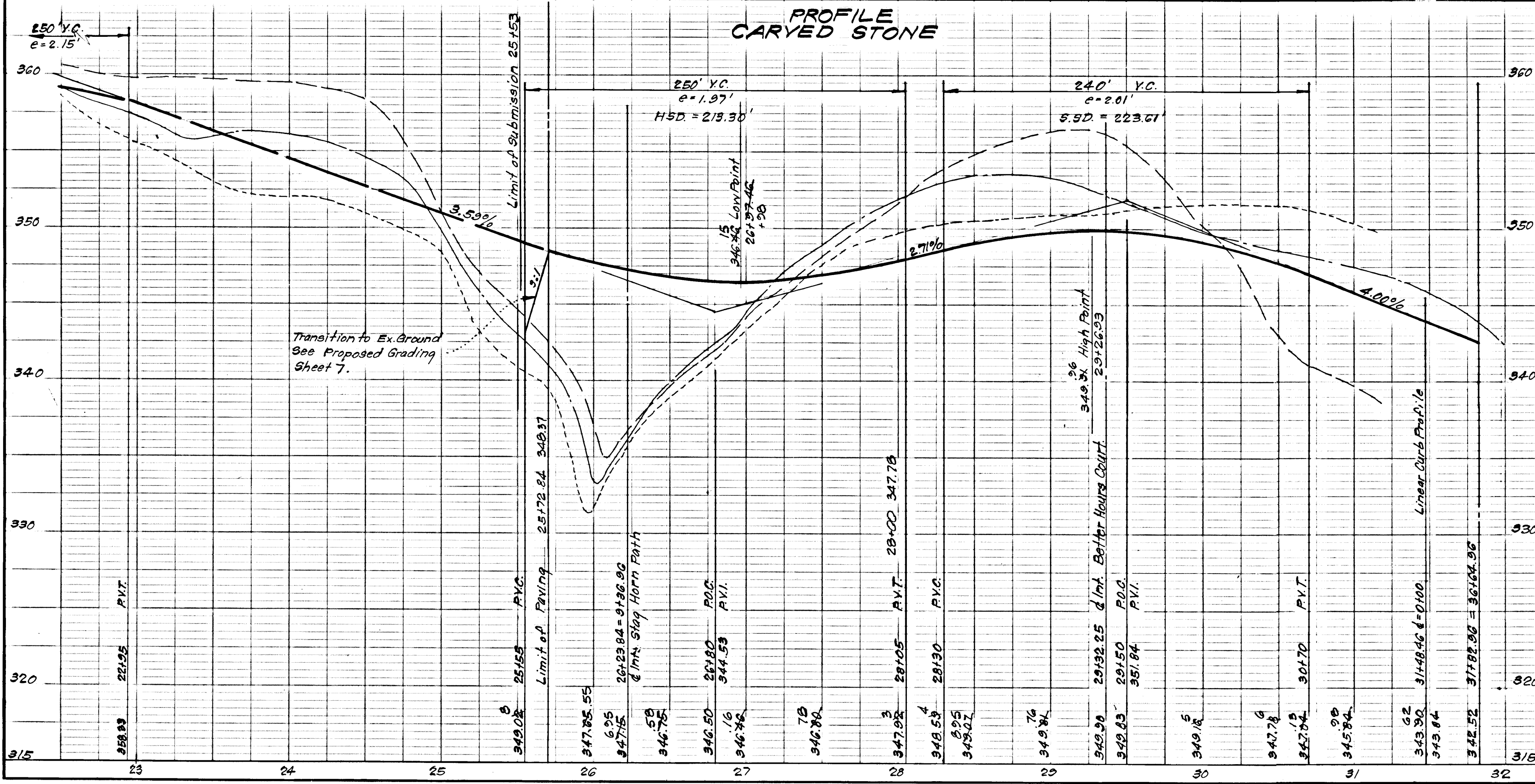

F-79-20c AS BUILT M.W. 4/28/82

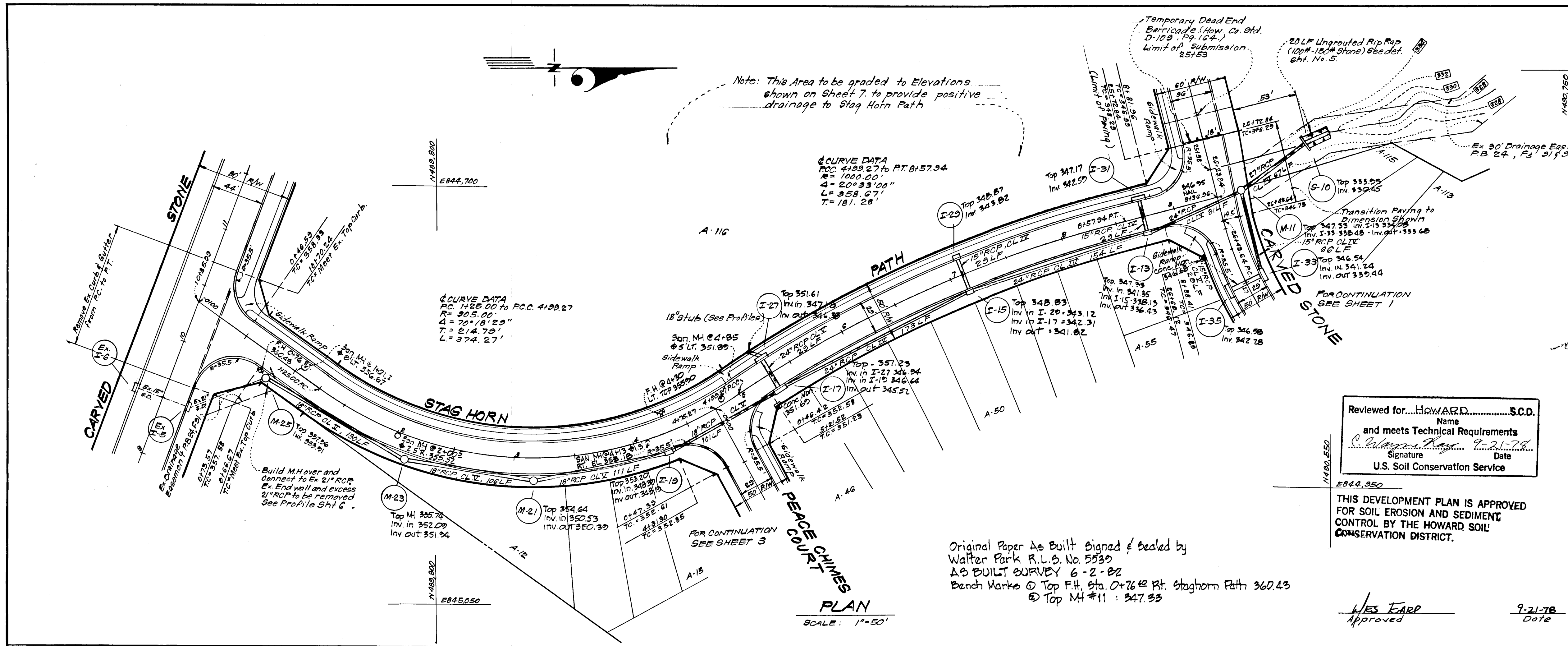

Note: This Area to be graded to Elevations shown on Sheet 7, to provide positive drainage to Stag Horn Path

Curve Data
 P.C. 4199.27 to P.T. 8157.94
 R = 1000.00'
 Δ = 20° 33' 00"
 L = 353.07'
 T = 181.28'

Curve Data
 P.C. 4125.00 to P.C.C. 4199.27
 R = 305.00'
 Δ = 70° 18' 23"
 L = 214.73'
 T = 374.27'

Original Paper As Built Signed & Sealed by
 Walter Park R.L.S. No 5539
 AS BUILT SURVEY 6-2-82
 Bench Marks @ Top F.H. Sta. 0+76 @ Pt. Staghorn Path 360.43
 @ Top M#11 : 347.33

Reviewed for... HOWARD... S.C.D.
 Name
 and meets Technical Requirements
 Signature
 U.S. Soil Conservation Service

THIS DEVELOPMENT PLAN IS APPROVED FOR SOIL EROSION AND SEDIMENT CONTROL BY THE HOWARD SOIL CONSERVATION DISTRICT.

Approved
 Date

DEVELOPER'S CERTIFICATE
 I certify that all development and/or construction will be done according to this plan of development and plan for Erosion and Sediment Control, and I also authorize periodic on-site inspection by the Howard Soil Conservation District or their authorized agents as are deemed necessary. Deviation from this plan will not be made unless authorized by the Howard Soil Conservation District.

Signature
 Date

ENGINEER'S CERTIFICATE
 I hereby certify that this plan for Erosion and Sediment Control represents a practical and workable plan based on my personal knowledge of the site conditions and that it was prepared in accordance with the requirements of the Howard Soil Conservation District.



Approved: DEPARTMENT OF PUBLIC WORKS
 Chief, Bureau of Engineering
 Date

Approved: HOWARD COUNTY OFFICE OF PLANNING & ZONING
 Chief, Division of Land Development
 Date

CLARK • FINEFROCK & SACKETT
 ENGINEERS • PLANNERS • SURVEYORS
 11315 LOCKWOOD DRIVE • SILVER SPRING, MARYLAND • (301) 593-3400

DESIGNED R.J.S.	ROAD CONSTRUCTION PLANS A RESUBDIVISION OF PARCEL A-1 STAG HORN PATH	SCALE As Shown
DRAWN K.I.W.	COLUMBIA VILLAGE OF OWEN BROWN SECTION 2 6th ELECTION DISTRICT HOWARD COUNTY, MARYLAND	DRAWING 2 of 8
CHECKED R.J.S.	FOR: HOWARD RESEARCH & DEVELOPMENT CORP. The Rouse Company Building Columbia, Maryland 21044	FILE NO. 1241-D
DATE July, 1978		

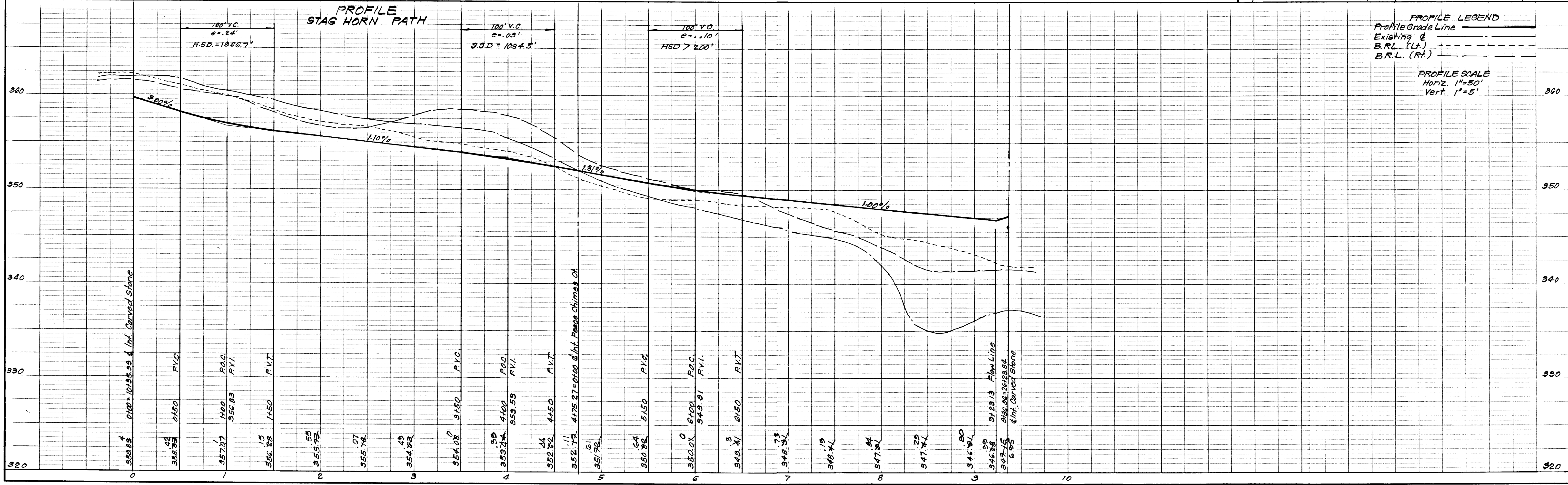

AS BUILT
 F-79-20c 4-30-82 MW

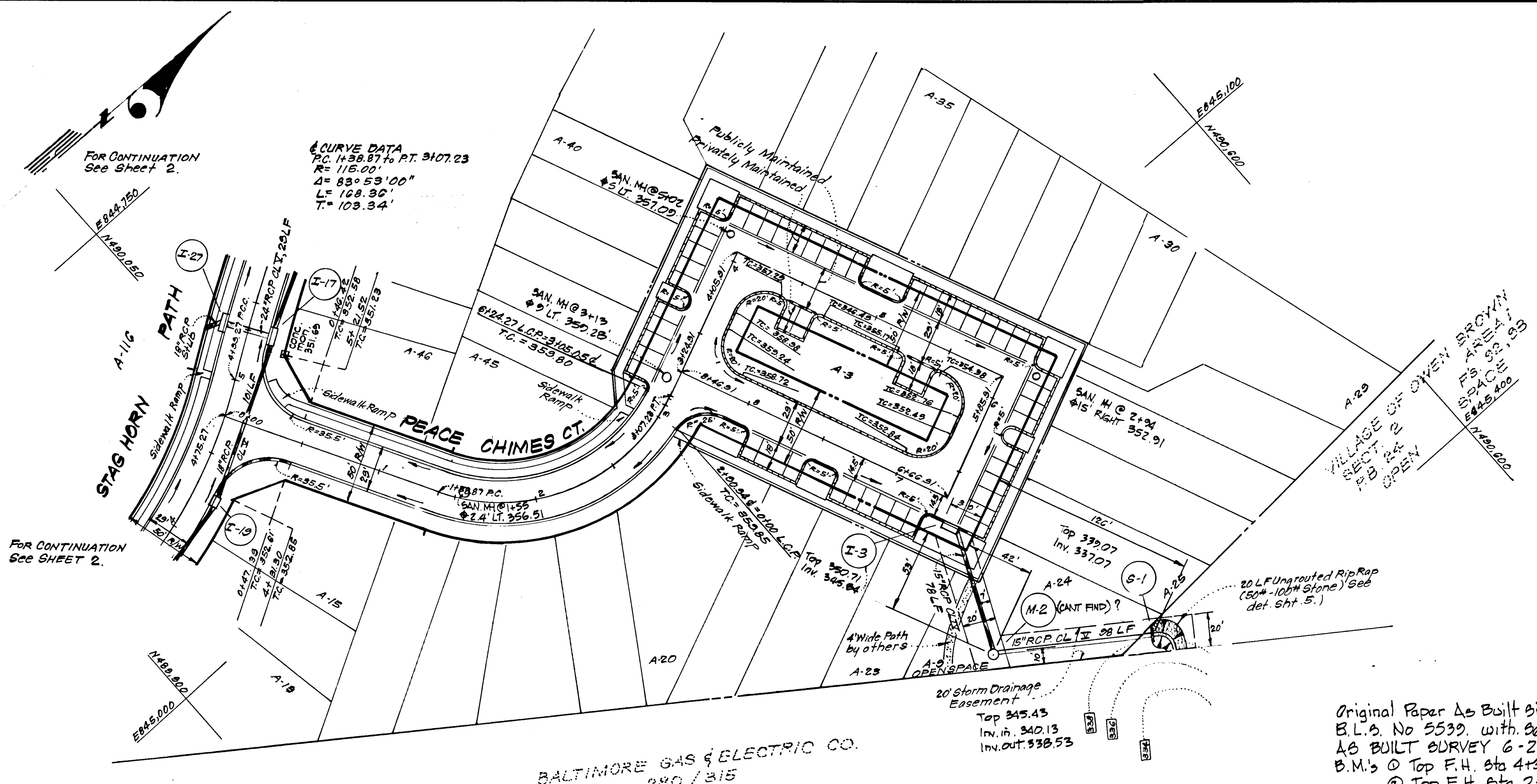

Reviewed for HOWARD S.C.D.
 Name
 and meets Technical Requirements
 Signature Walter Park
 Date
 U.S. Soil Conservation Service

DEVELOPER'S CERTIFICATE
 I certify that all development and/or construction will be done according to this plan of development and plan for Erosion and Sediment Control, and I authorize periodic on-site inspection by the Howard Soil Conservation District or their authorized agents as are deemed necessary. Deviation from this plan will not be made unless authorized by the Howard Soil Conservation District.

THIS DEVELOPMENT PLAN IS APPROVED FOR SOIL EROSION AND SEDIMENT CONTROL BY THE HOWARD SOIL CONSERVATION DISTRICT.

Wes FARR Approved Date 9-21-78
Walter Park Signature Date 9/21/78

ENGINEER'S CERTIFICATE
 I hereby certify that this plan for Erosion and Sediment Control represents a practical and workable plan based on my personal knowledge of the site conditions and that it was prepared in accordance with the requirements of the Howard Soil Conservation District.

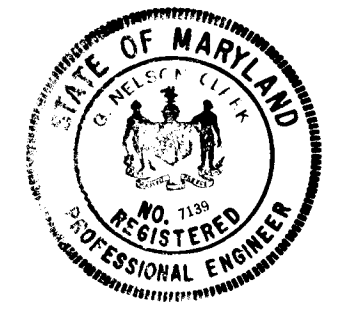

G. Nelson Clark Signature Date 8-3-78
 G. Nelson Clark

APPROVED: DEPARTMENT OF PUBLIC WORKS
W.O. Falber Signature Date 9-28-78
 Chief, Bureau of Engineering
 APPROVED: HOWARD COUNTY OFFICE OF PLANNING & ZONING
John W. McWhorter Signature Date 10-9-78
 Chief, Division of Land Development

CLARK • FINEFROCK & SACKETT ENGINEERS • PLANNERS • SURVEYORS 11315 LOCKWOOD DRIVE • SILVER SPRING, MARYLAND • (301) 593-3400		
DESIGNED	R.O.S.	SCALE
DRAWN	R.O.S.	As Shown
CHECKED	K.I.W.	DRAWING
DATE	R.O.S.	3 of 8
July 1978	FOR: HOWARD RESEARCH & DEVELOPMENT CORP. The Rouse Company Building Columbia, Maryland 21044	FILE NO. 1241-D

Original Paper As Built Signed by Walter Park
 E.L.S. No. 5539, with Seal.
 AS BUILT CURVEY 6-2-80
 B.M.'s @ Top F.H. Sta 4+30 Left Stag Horn Path 355.90
 @ Top F.H. Sta 2+61 Left Peace Chimes Ct. 362.31

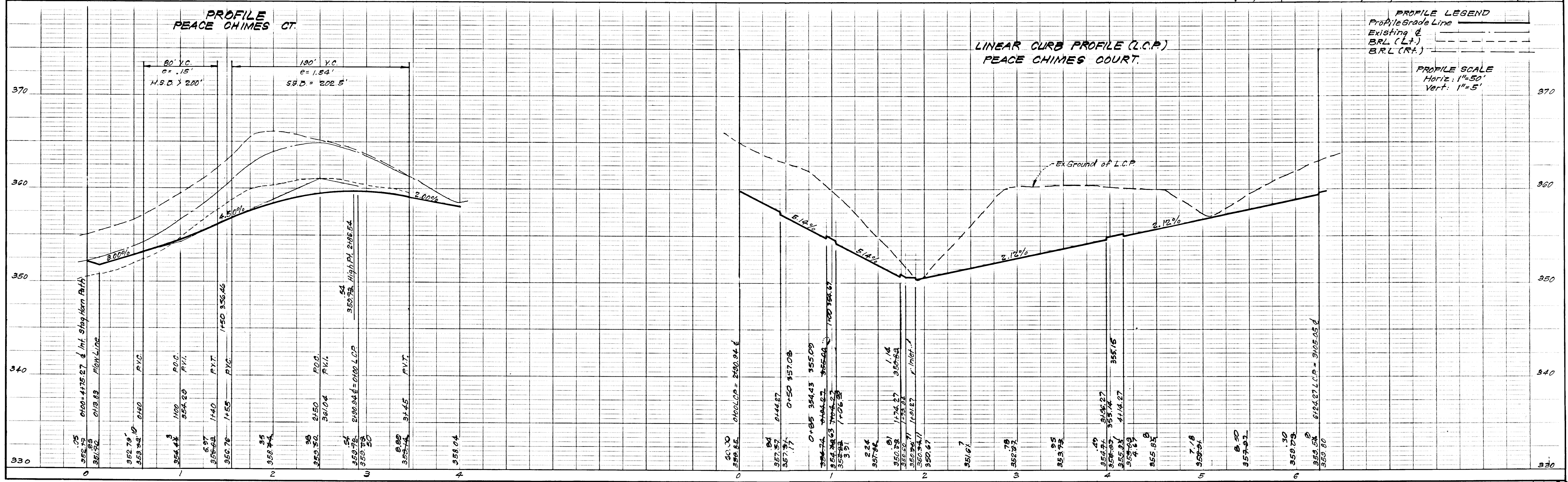

F-79-20c AS BUILT 4-30-82 MW

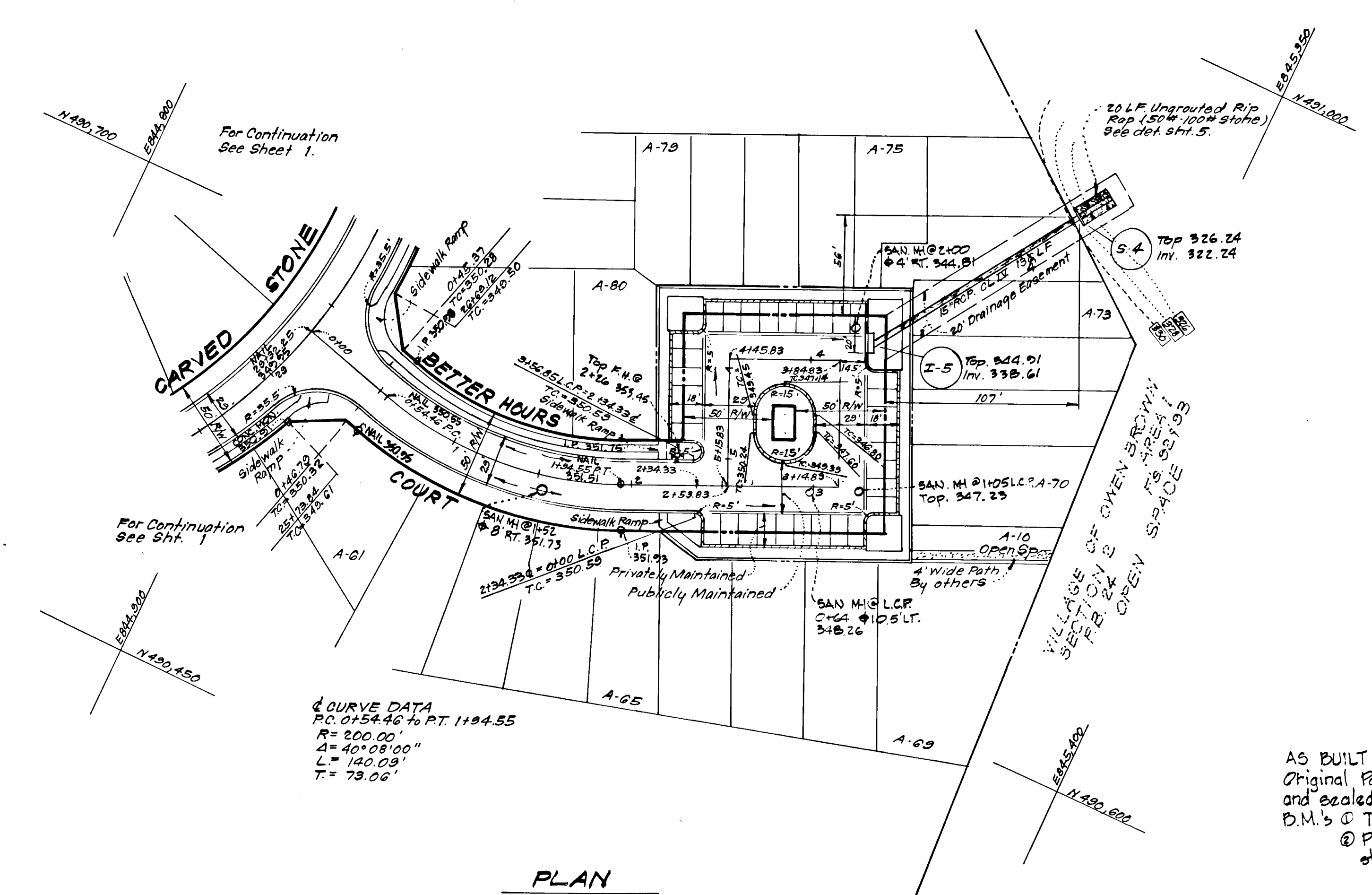
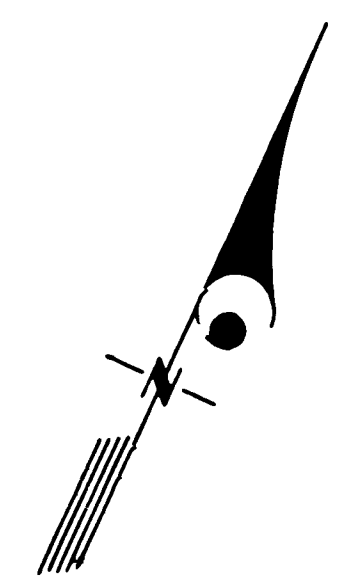

4 CURVE DATA
 P.C. 2154.46 to P.T. 1194.55
 R = 200.00'
 Δ = 40° 08' 00"
 L = 140.09'
 T = 73.06'

PLAN
 Scale: 1" = 50'

AS BUILT SURVEY 6-2-80
 Original Paper As Built Print signed
 and sealed by Walter Park R.L.S. No. 5539
 D.M.'s @ Top F.H. sta. 2+26 Left - 553.45
 @ PK. Nail sta. 0+00 Better Hours Ct. =
 sta. 29+32.35 Carved Stone - 349.95

Reviewed for... HOWARD... S.C.D.
 and meets Technical Requirements
 Name: Walter Park 7-21-78
 Signature: _____
 U.S. Soil Conservation Service

THIS DEVELOPMENT PLAN IS APPROVED
 FOR SOIL EROSION AND SEDIMENT
 CONTROL BY THE HOWARD SOIL
 CONSERVATION DISTRICT.

DEVELOPER'S CERTIFICATE
 I certify that all development and/or construction
 will be done according to this plan of development
 and plan for Erosion and Sediment Control, and I also
 authorize periodic on-site inspection by the Howard
 Soil Conservation District or their authorized agents
 as are deemed necessary. Deviation from this plan
 will not be made unless authorized by the Howard
 Soil Conservation District.

Approved: Walter Park 9-21-78
 Date: _____ Signature: _____ Date: _____

ENGINEER'S CERTIFICATE
 I hereby certify that this plan for Erosion and
 Sediment Control represents a practical and workable
 plan based on my personal knowledge of the site
 conditions and that it was prepared in accordance
 with the requirements of the Howard Soil Conserva-
 tion District.

Approved: G. Nelson Clark 8-3-78
 Date: _____ Signature: _____ Date: _____



APPROVED: DEPARTMENT OF PUBLIC WORKS		
<u>W. O. Lambert</u>	9-28-78	Date
Chief, Bureau of Engineering		
APPROVED: HOWARD COUNTY OFFICE OF PLANNING & ZONING		
<u>Richard W. ...</u>	10-9-78	Date
Chief, Division of Land Development		
CLARK • FINEFROCK & SACKETT		
ENGINEERS • PLANNERS • SURVEYORS		
11515 LOCKWOOD DRIVE • SILVER SPRING, MARYLAND • (301) 593-3400		
DESIGNED	R.O.S.	SCALE As Shown
DRAWN	K.I.W.	DRAWING 4 of 8
CHECKED	R.O.S.	
DATE	July, 1978	FILE NO. 1241-D
ROAD CONSTRUCTION PLANS A RESUBDIVISION OF PARCEL A-1 BETTER HOURS COURT COLUMBIA VILLAGE OF OWEN BROWN SECTION 2 AREA 1 6th ELECTION DISTRICT HOWARD COUNTY, MARYLAND FOR: HOWARD RESEARCH & DEVELOPMENT CORP. The Rouse Company Building Columbia, Maryland 21044		

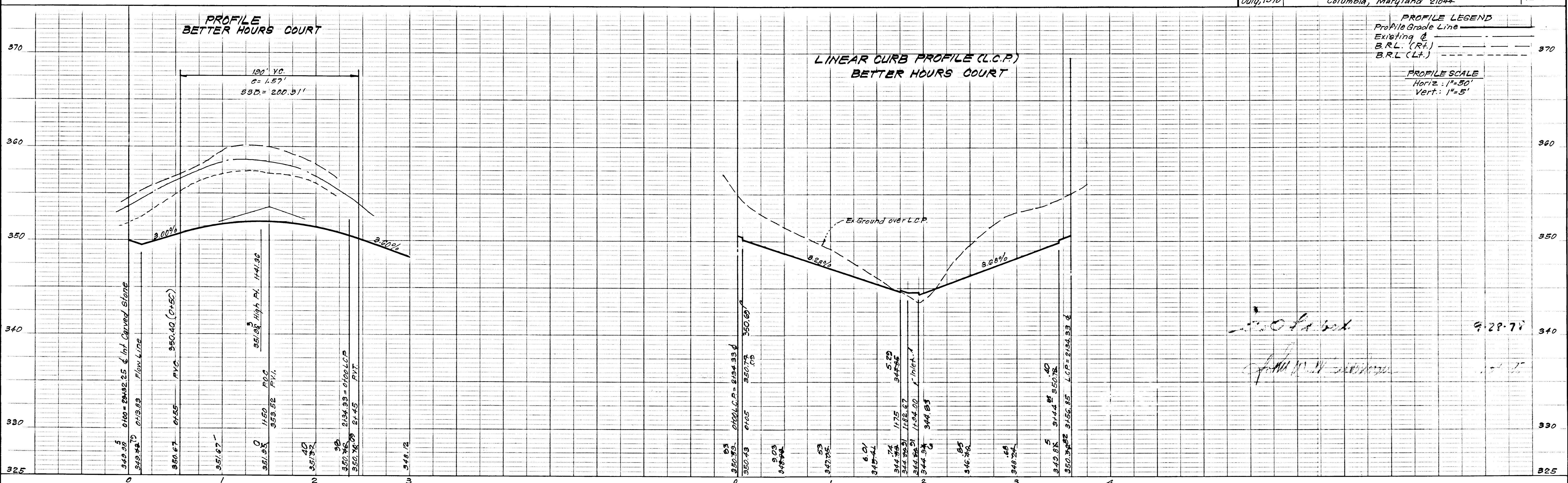

PROFILE LEGEND
 Profile Grade Line _____
 Existing G. _____
 B.R.L. (Rt.) _____
 B.R.L. (Lt.) _____

PROFILE SCALE
 Horiz.: 1" = 50'
 Vert.: 1" = 5'

Approved: W. O. Lambert 9-28-78
 Date: _____ Signature: _____ Date: _____

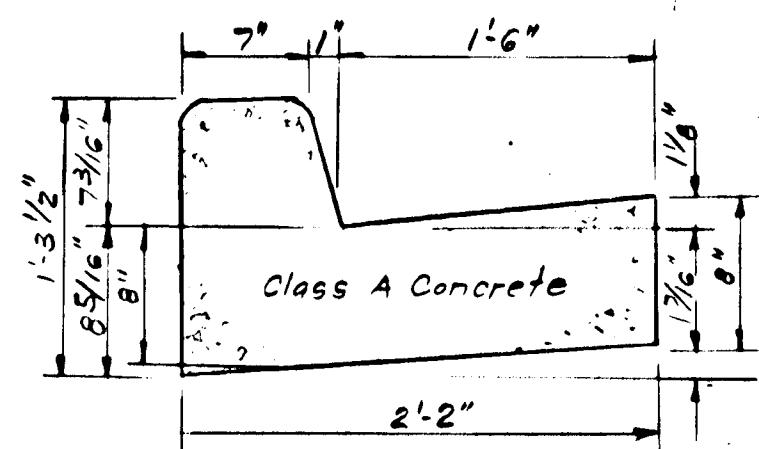

STANDARD 7" COMBINATION CURB & GUTTER
No Scale

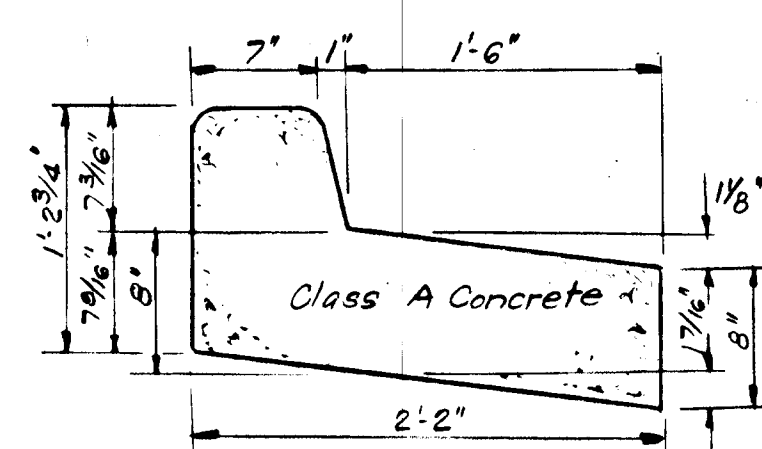

REVERSE 7" COMBINATION CURB & GUTTER
No Scale

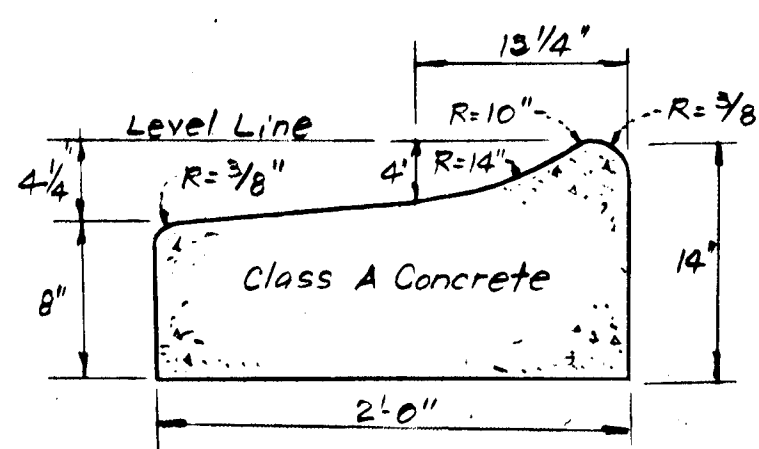

MODIFIED COMBINATION CURB & GUTTER (REVERSED)
No Scale

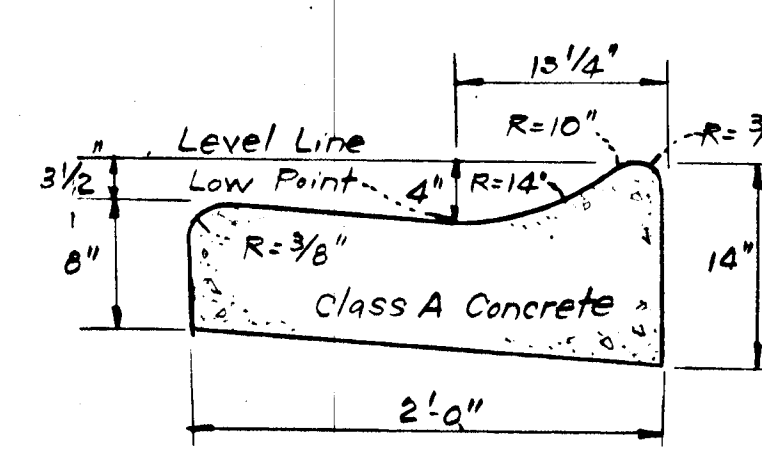

MODIFIED COMBINATION CURB & GUTTER
No Scale

Note: Various Curb & Gutter sections to be used where shown in plan view. See legend sheet 1.

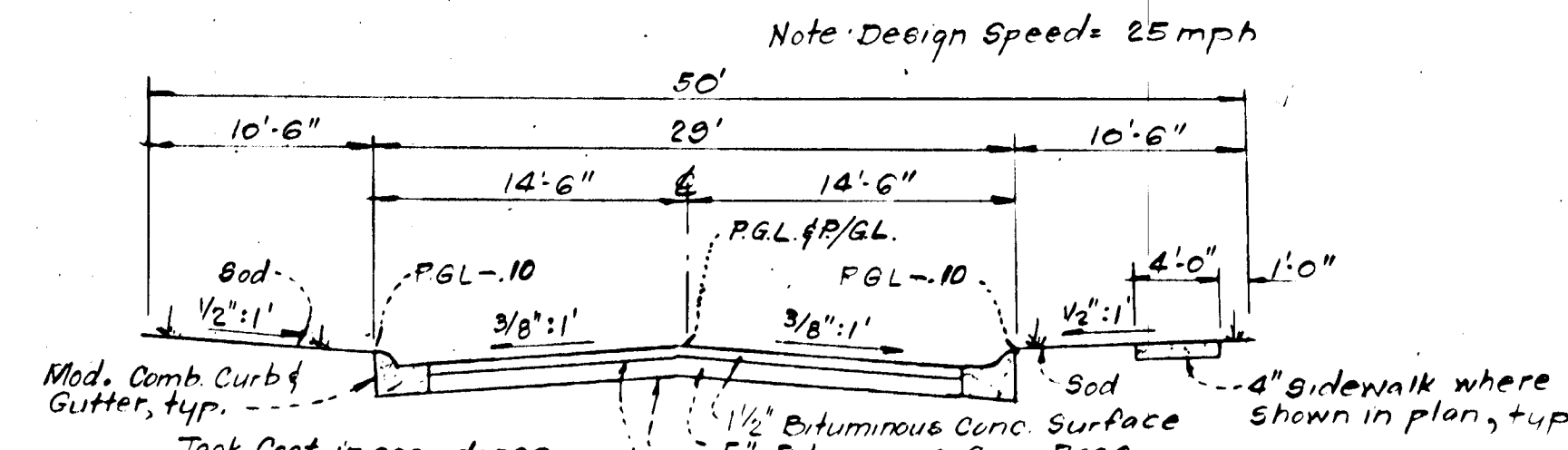

Note: Design Speed = 25 mph

Tack Coat in accordance with Howard Co Specs C-31-4.

1/2" Bituminous Conc. Surface
5" Bituminous Conc. Base
Prime Coat in accordance with Howard Co Specs C-30-3.

Type of Zoning: New Town - Single Family-Attached.

TYPICAL PAVING SECTION

CARVED STONE (Sta 25+72.84 to 31+48.46)
STAG HORN PATH (Sta 0+73.57 to Sta 8+88.41)
PEACE CHIMES COURT (Sta 0+46.42 to Sta 2+90.94)
BETTER HOURS COURT (Sta 0+45.37 to Sta 2+34.33)

No Scale

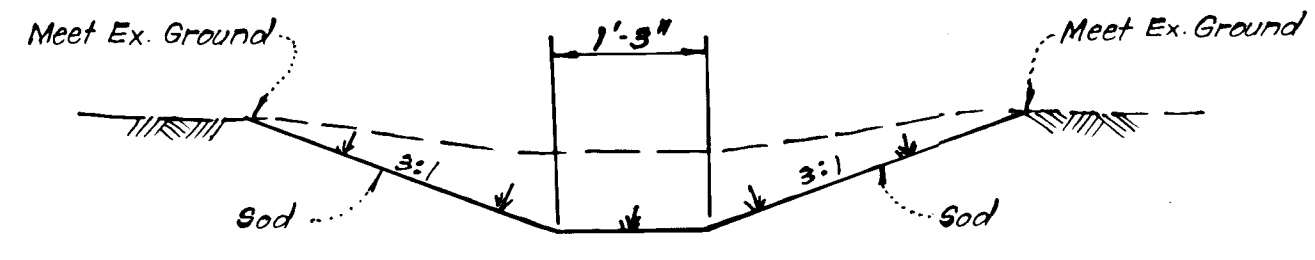

SODDED DITCH DETAIL
No Scale

GENERAL SODDING NOTES

1. Apply 10-10-10 Fertilizer @ 1000# per acre (25#/1000#).
2. Apply Ground Agricultural Limestone @ 2000# per acre (50#/1000#).
3. Incorporate both Lime & Fertilizer into soil by discing (Firm up after incorporation).
4. Lay sod to a tight fit. Roll to insure contact with underlying soil.
5. Water as necessary for 1st two weeks (in summer) to ensure establishment.

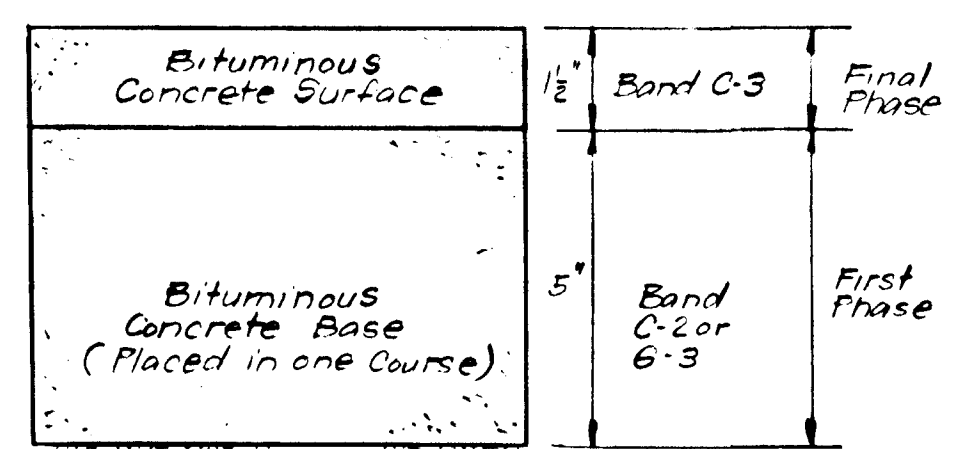

Clearing and Grading Article C-1
Subgrade Article C-2
Base Course Article C-31 or C-33
Surface Course Article C-31

To be constructed in accordance with the Howard County Road Construction Code and Specifications.

PAVING SECTION FOR PUBLIC ROADS AND ENTRANCES TO PUBLIC ROADS
No Scale

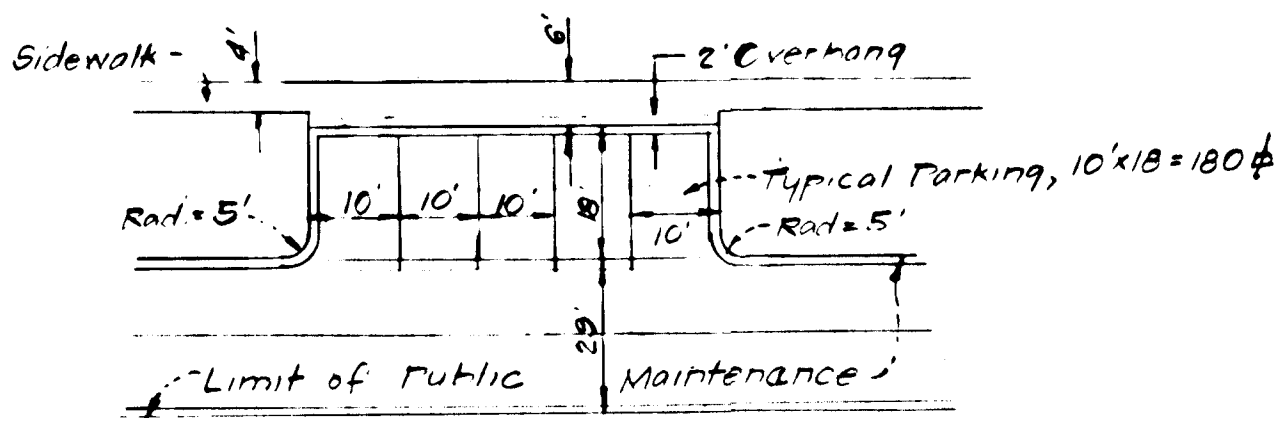

TYPICAL PARKING ADJACENT TO PUBLIC ROADS
No Scale

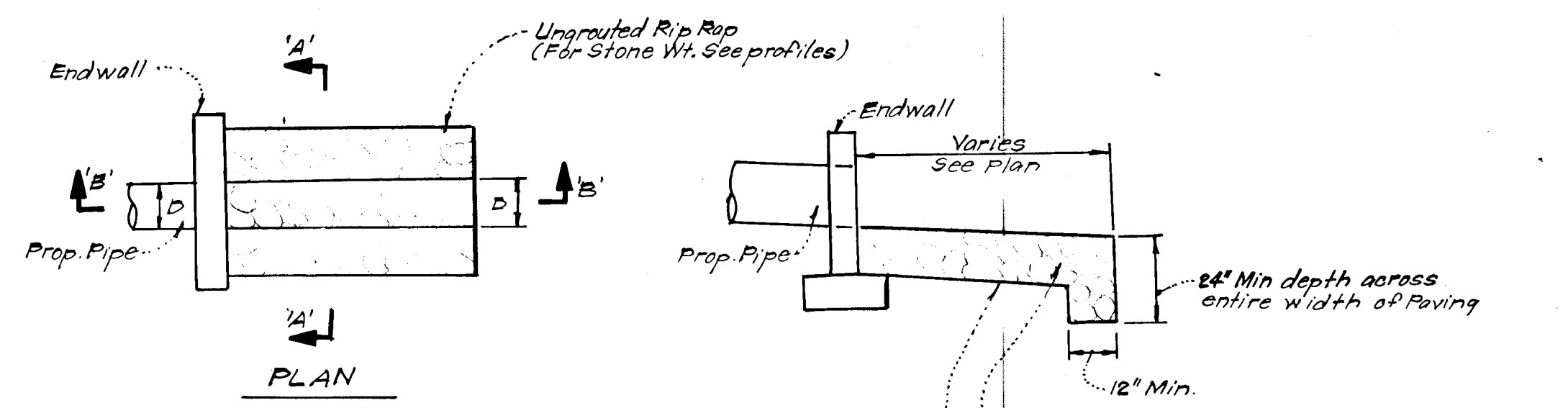

** Transition Side Slopes from 2:1 @ Endwall to 3:1 at end of Rip Rap.

12" Min Thickness
Ungrouted Rip Rap (For Stone Wt. See Profiles)

12" Min. depth across entire width of Paving
Ungrouted Rip Rap, For Stone Wt. See Profiles.
Poly Filter Xer Laurel Erosion Control Cloth for Entire Length of Rip Rap.

RIP RAP PAVING DETAILS
No Scale

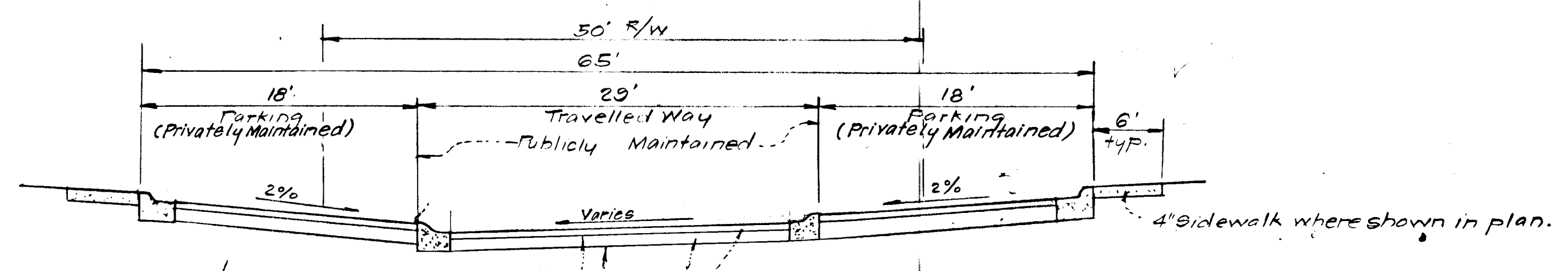

Tack Coat in accordance with Howard Co. Std. Spec. C-31-4.
Prime Coat in accordance with Howard Co. Std. Spec. C-30-3.

1/2" Bituminous Conc. Surface
5" Bituminous Conc. Base.

Note: For Types of Curb & Gutter used see plan sheets 1-4.

TYPICAL PAVING SECTION - PUBLIC DRIVE AND PRIVATE PARKING
No Scale

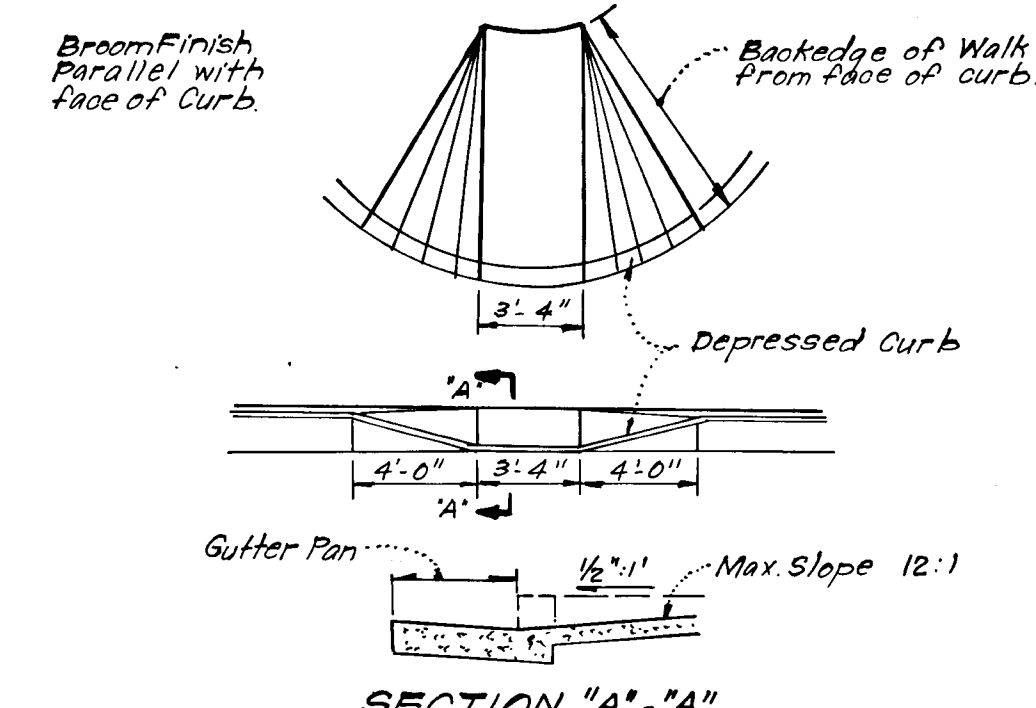

SIDEWALK RAMP DETAILS
No Scale

Reviewed for.....Howard.....S.C.D.
Name
and meets Technical Requirements
Signature Date
U.S. Soil Conservation Service

THIS DEVELOPMENT PLAN IS APPROVED FOR SOIL EROSION AND SEDIMENT CONTROL BY THE HOWARD SOIL CONSERVATION DISTRICT.

DEVELOPER'S CERTIFICATE

I certify that all development and/or construction will be done according to this plan of development and plan for Erosion and Sediment Control, and I also authorize periodic on-site inspection by the Howard Soil Conservation District or their authorized agents as are deemed necessary. Deviation from this plan will not be made unless authorized by the Howard Soil Conservation District.

ENGINEER'S CERTIFICATE

I hereby certify that this plan for Erosion and Sediment Control represents a practical and workable plan based on my personal knowledge of the site conditions and that it was prepared in accordance with the requirements of the Howard Soil Conservation District.



APPROVED: DEPARTMENT OF PUBLIC WORKS
[Signature] 9-28-78
Chief, Bureau of Engineering Date

APPROVED: HOWARD COUNTY OFFICE OF PLANNING & ZONING
[Signature] 10-9-78
Chief, Division of Land Development Date

CLARK • FINEFROCK & SACKETT
ENGINEERS • PLANNERS • SURVEYORS
11315 LOCKWOOD DRIVE SILVER SPRING, MARYLAND 20904 (301) 593-3400

DESIGNED R.J.S.
DRAWN R.J.S.
CHECKED K.I.W.
R.J.S.
DATE July, 1978

SCALE As Shown
DRAWING 5 of 8
JOB NO.
FILE NO. 1241-D

ROAD CONSTRUCTION PLANS
A RESUBDIVISION OF PARCEL A-1
STORM DRAINAGE AND PAVING DETAILS
COLUMBIA
VILLAGE OF OWEN BROWN
SECTION 2 AREA 1
6TH ELECTION DISTRICT
HOWARD COUNTY, MARYLAND
FOR: HOWARD RESEARCH & DEVELOPMENT
The Rouse Company Building
Columbia, Maryland 21044

10/2/78

STAG HORN PATH

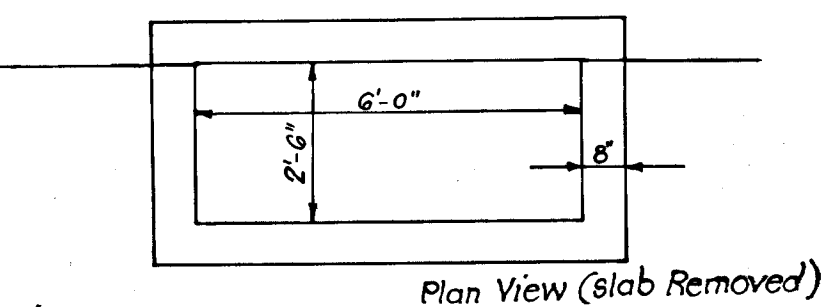
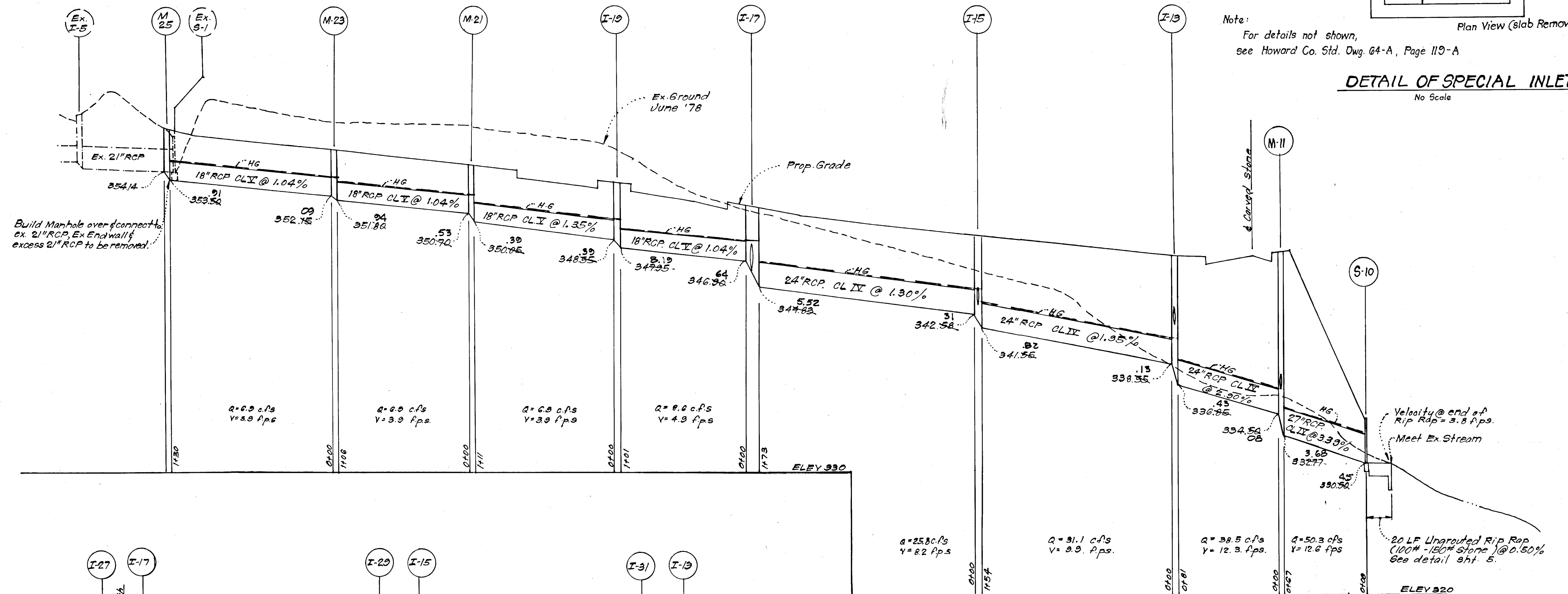

DETAIL OF SPECIAL INLET I-31
No Scale

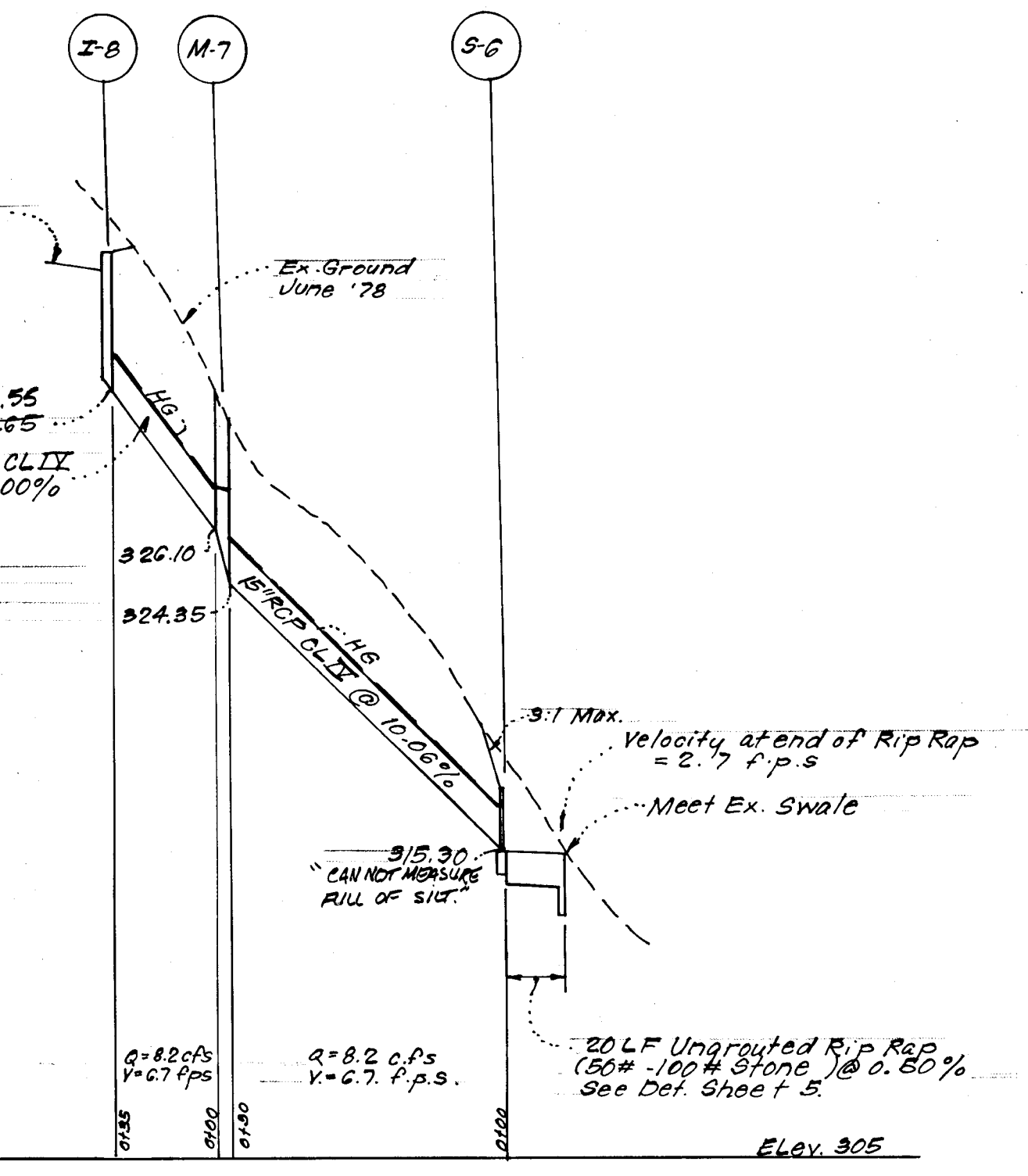
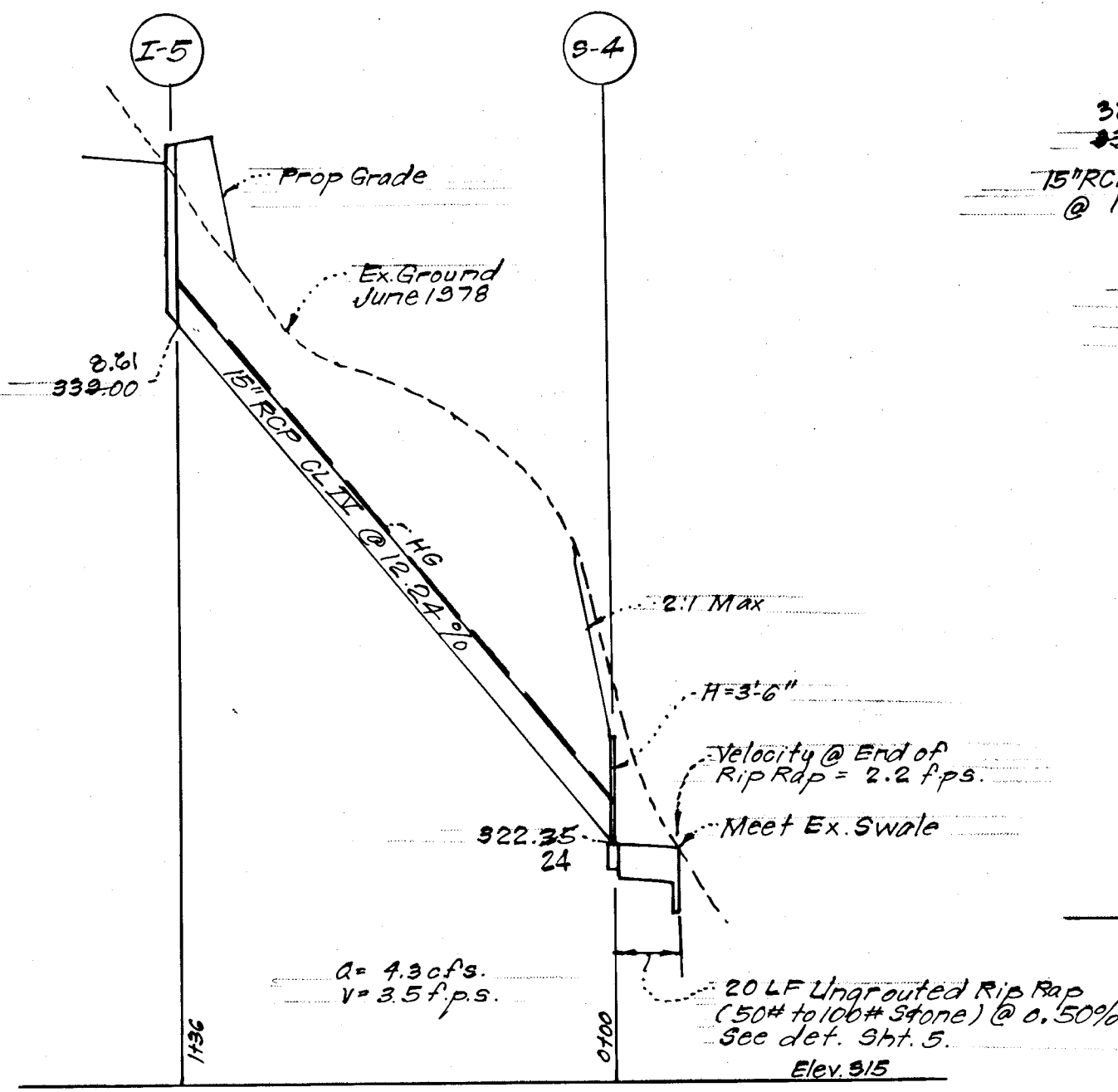
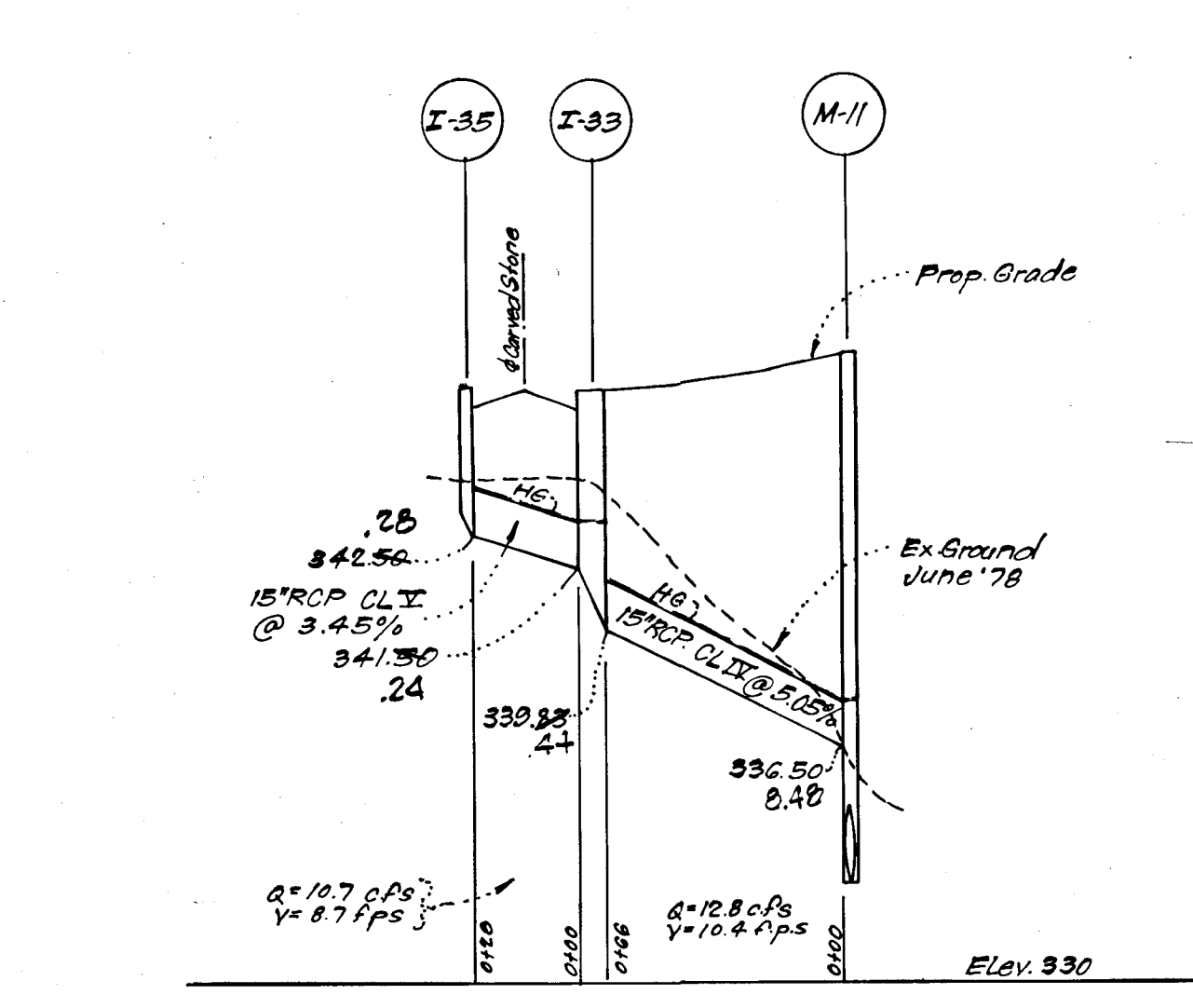
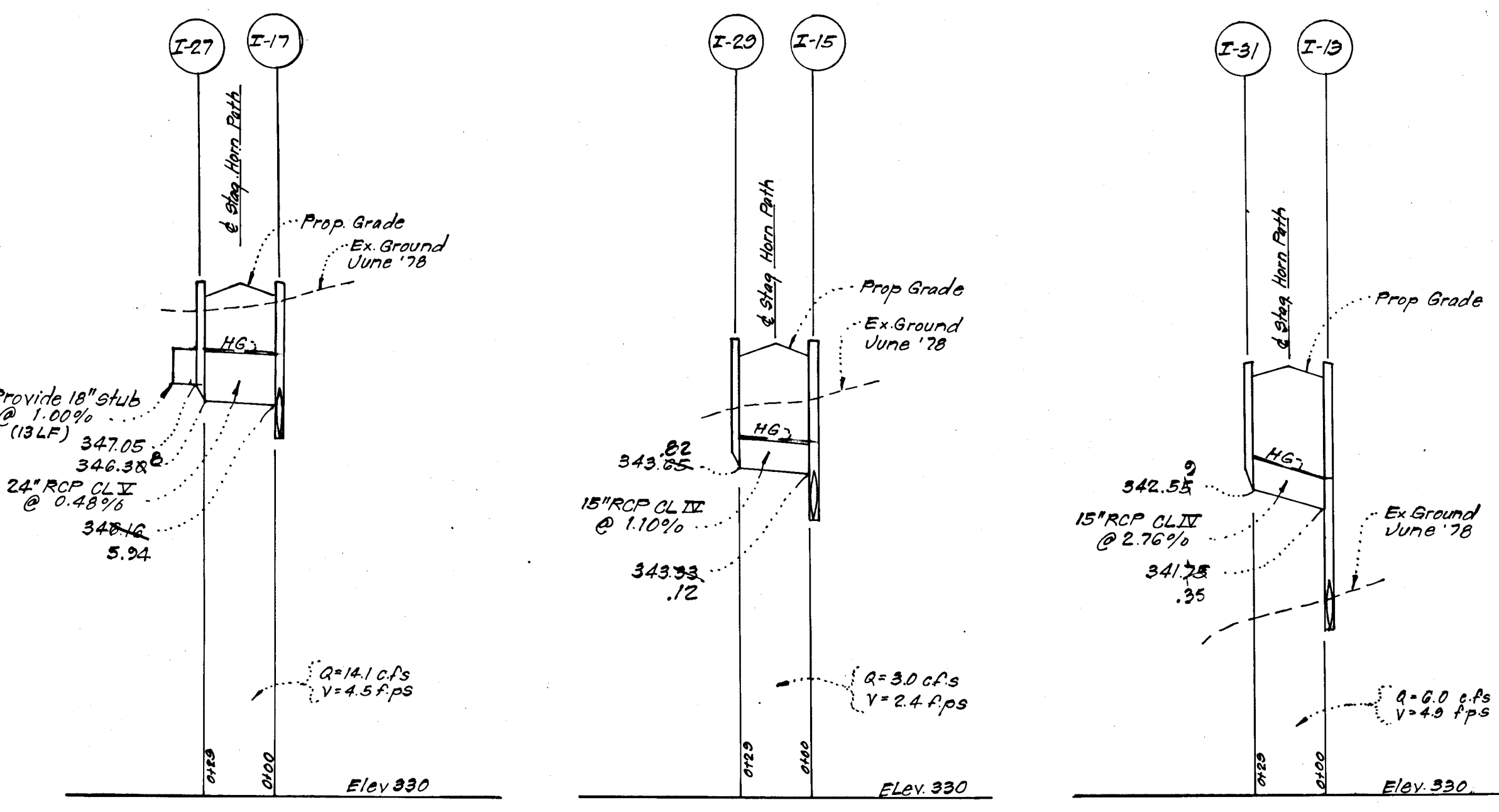
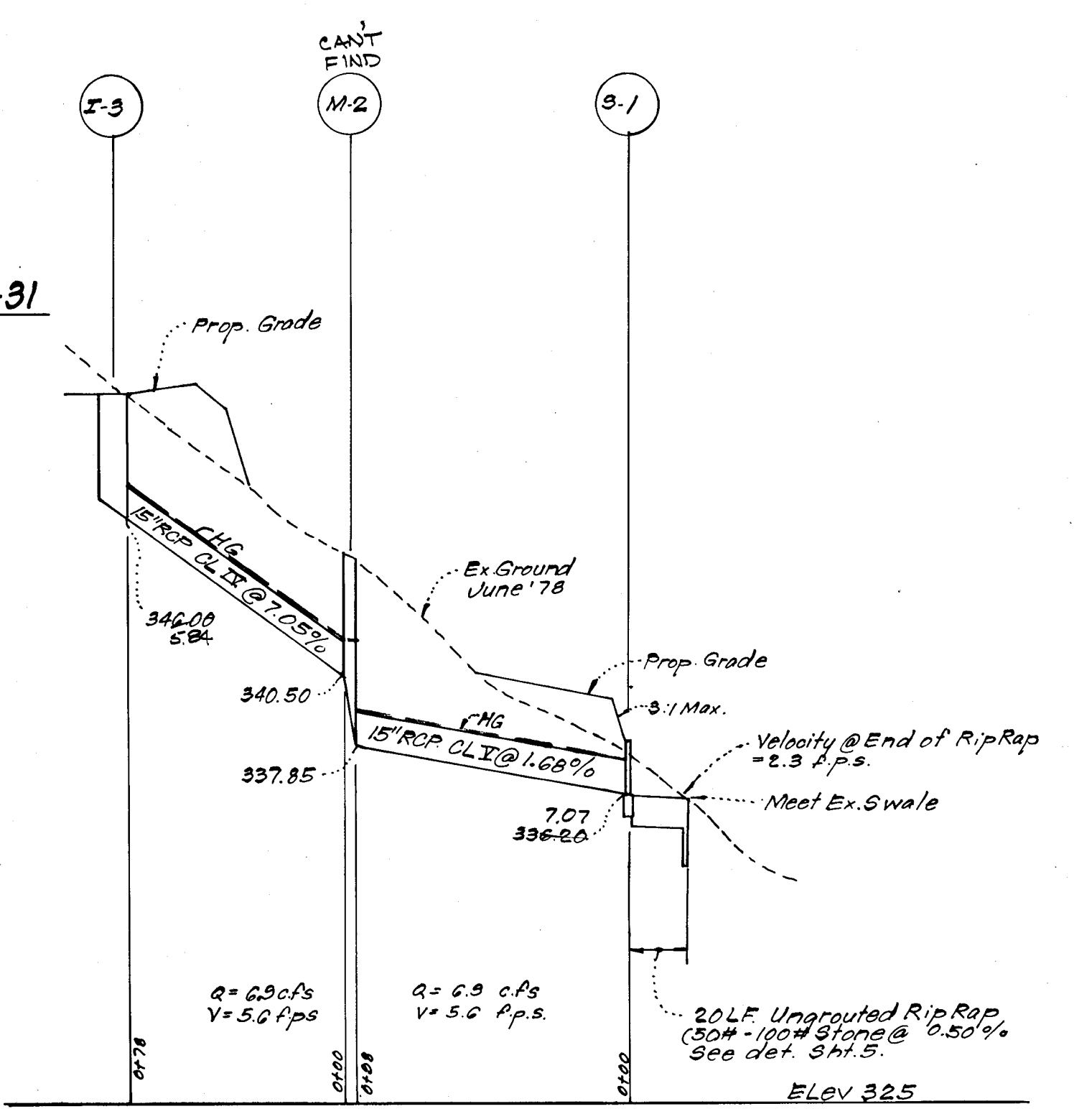

No.	TYPE	INV. IN.		TOP ELEVATION		REMARKS	LOCATION
		UPPER	LOWER	UPPER	LOWER		
S-1	"C" Endwall	336.20	—	—	—	How. Co. Std. Fig. 5.21 Dia=15"	See Plan
M-2	"B" Manhole	340.50	337.85	Ex. Ground	—	Fig. 3.03 48" Sq.	See Plan
I-3	A-10 Inlet	—	346.00	350.60	—	Fig. 4.02 W=3'-6"	"
S-4	"C" Endwall	322.35	—	—	—	Fig. 5.21 Dia=18"	"
I-5	A-10 Inlet	—	339.00	344.60	—	Fig. 4.02 W=2'-6"	"
S-6	"C" Endwall	315.30	—	—	—	Fig. 5.21 Dia=15"	"
M-7	"B" Manhole	326.10	324.35	Ex. Ground	—	Fig. 3.03 48" Sq.	"
I-8	A-10 Inlet	—	330.65	335.28	—	Fig. 4.02 W=2'-6"	"
S-10	"C" Endwall	330.50	—	—	—	Fig. 5.21 Dia=15"	"
M-11	"A-1" Manhole	334.55	332.77	347.15	—	Fig. 3.01 Dia=48"	4'x26'x23, 22' LT.
I-13	A-5 Inlet	333.55	336.85	347.11	347.05	Fig. 4.01 W=2'-6"	4'x73.30, 13.83' RT.
I-15	A-5 Inlet	333.75	341.55	348.72	348.66	Fig. 4.01 W=2'-6"	4'x72, 13.83' RT.
I-17	A-10 Inlet	332.75	344.83	351.18	350.97	Fig. 4.02 W=2'-6"	4'x73.30, 13.83' RT.
I-19	A-5 Inlet	342.55	347.95	353.08	352.89	Fig. 4.01 W=2'-6"	4'x72.50, 13.83' RT.
M-21	"B" Manhole	350.70	350.05	354.97	—	Fig. 3.03 48" Sq.	4'x15, 20.00' RT.
M-23	"B" Manhole	352.15	351.80	355.70	—	Fig. 3.03 48" Sq.	4'x212, 20.00' RT.
M-25	"B" Manhole	354.14	353.50	357.55	—	Fig. 3.03 48" Sq.	4'x222.57, 20.00' RT.
I-27	A-10 Inlet	344.30	346.30	351.18	350.97	Fig. 4.02 W=2'-6"	4'x73.30, 13.83' RT.
I-29	A-5 Inlet	343.65	348.72	348.66	—	Fig. 4.01 W=2'-6"	4'x72, 13.83' RT.
I-31	Special Inlet	—	348.55	347.00	347.03	See Detail This Sheet	"
I-33	A-10 Inlet	341.50	339.83	346.30	—	Fig. 4.02 W=2'-6"	4'x73.30, 13.83' RT.
I-35	A-10 Inlet	—	342.50	346.30	—	Fig. 4.02 W=2'-6"	4'x73.70, 13.83' RT.

SIZE	TYPE	LENGTH
18"	R.C.P. CL. I	127 LF
18"	R.C.P. CL. IV	463 LF
18"	R.C.P. CL. V	48 LF
24"	R.C.P. CL. I	29 LF
24"	R.C.P. CL. IV	402 LF
27"	R.C.P. CL. IV	67 LF

Reviewed for... HOWARD... S.C.D. Name and meets Technical Requirements
Signature: [Signature] Date: 9-2-78
U.S. Soil Conservation Service
THIS DEVELOPMENT PLAN IS APPROVED FOR SOIL EROSION AND SEDIMENT CONTROL BY THE HOWARD SOIL CONSERVATION DISTRICT.
Approved: [Signature] Date: [Blank]

DEVELOPER'S CERTIFICATE
I certify that all development and/or construction will be done according to this plan of development and plan for Erosion and Sediment Control, and I also authorize periodic on-site inspection by the Howard Soil Conservation District or their authorized agents as are deemed necessary. Deviation from this plan will not be made unless authorized by the Howard Soil Conservation District.
Signature: [Signature] Date: 9/2/78

ENGINEERS CERTIFICATE
I hereby certify that this plan for Erosion and Sediment Control represents a practical and workable plan based on my personal knowledge of the site conditions and that it was prepared in accordance with the requirements of the Howard Soil Conservation District.
Signature: [Signature] Date: 8-3-78

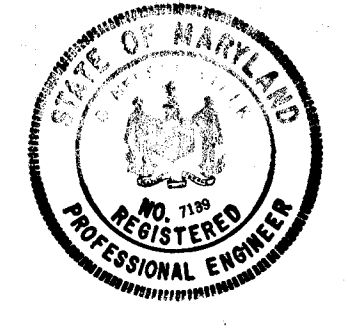

NO.	REVISIONS	Date
1	Changed Structure Sched. Note Added Special Inlet I-31	9-15-80

APPROVED: DEPARTMENT OF PUBLIC WORKS
W. O. Albert, Chief, Bureau of Engineering, 9-28-78
APPROVED: HOWARD COUNTY OFFICE OF PLANNING & ZONING
John W. Muschman, Chief, Division of Land Development, 10-9-78

CLARK • FINEFROCK & SACKETT
ENGINEERS • PLANNERS • SURVEYORS
11315 LOCKWOOD DRIVE • SILVER SPRING, MARYLAND 20904 • (301) 593-3400

DESIGNED RJS	ROAD CONSTRUCTION PLANS A RESUBDIVISION OF PARCEL A-1 STORM DRAINAGE PROFILES	SCALE As Shown
DRAWN		DRAWING 6 of 8
CHECKED K.I.W.	VILLAGE OF OWEN BROWN SECTION 2 AREA 1 6TH ELECTION DISTRICT HOWARD COUNTY, MARYLAND	JOB NO.
DATE July, 1978		FILE NO. 1241-D

FOR: HOWARD RESEARCH & DEVELOPMENT CORP
The Rouse Company Building
Columbia, Maryland 21044

3/21/80
3-2-81

F-79-20c 4-30-82

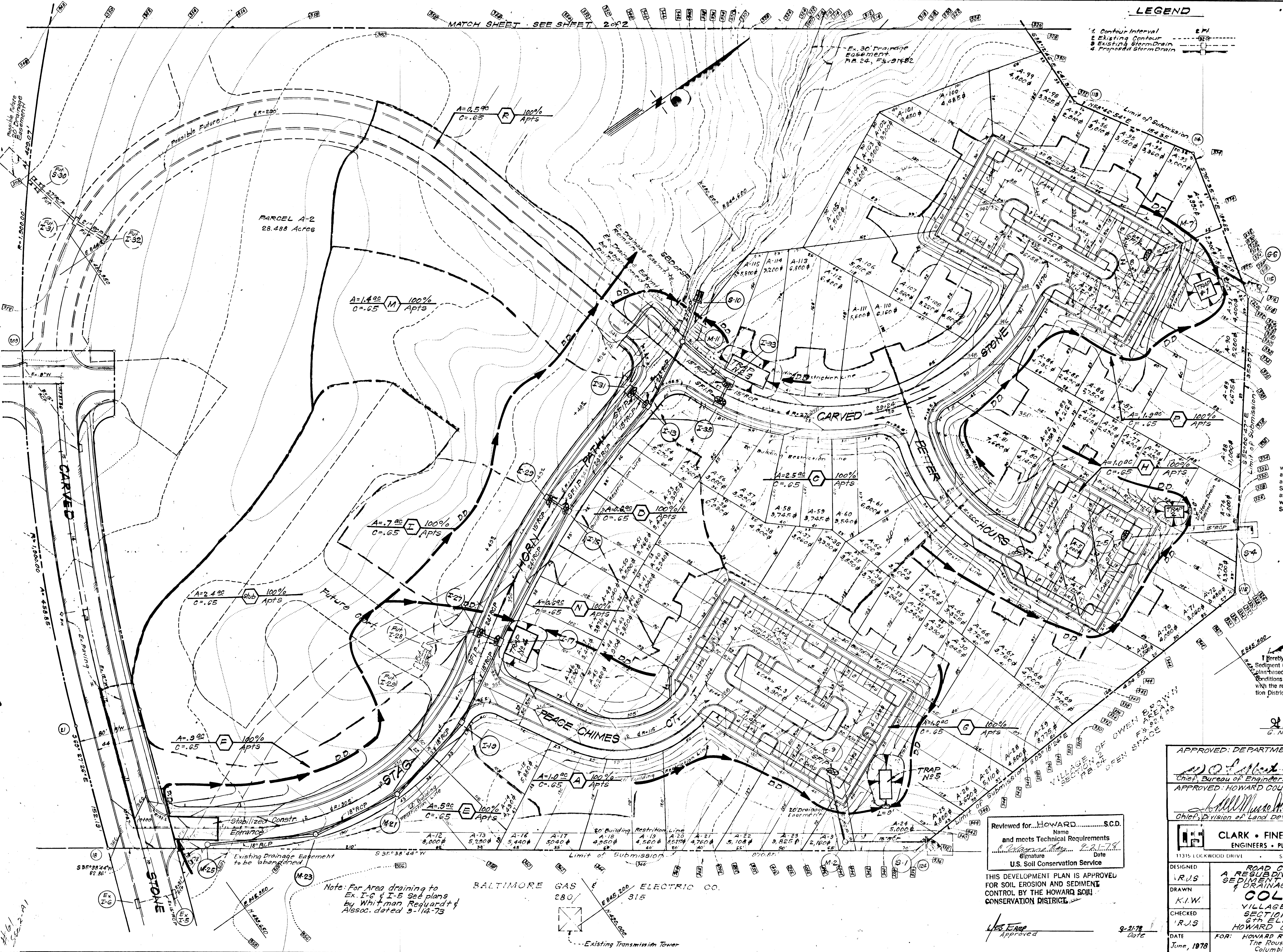

LEGEND

- 1. Contour Interval
- 2. Existing Contour
- 3. Existing Storm Drain
- 4. Proposed Storm Drain

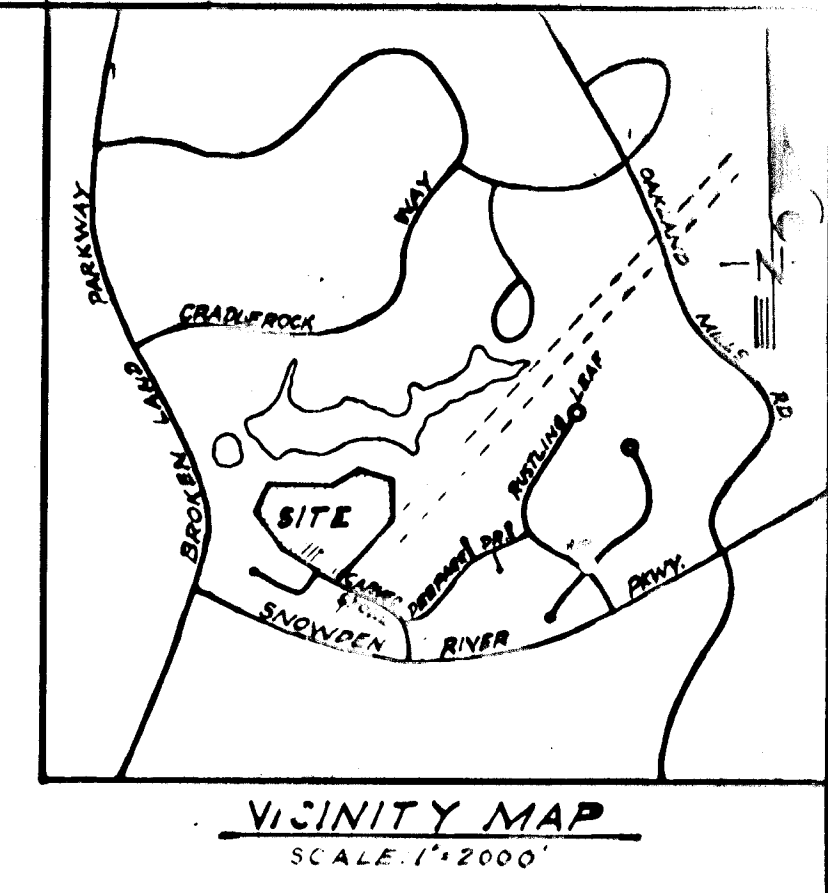

LEGEND

- 1. Diversion Dike
- 2. 6' H Fence or Straw Bale Dike
- 3. Stone Filter Inlet Protection
- 4. Sediment Trap
- 5. Stabilized Construction Entrance

DEVELOPER'S CERTIFICATE

I certify that all development and/or construction will be done according to this plan of development and plan for Erosion and Sediment Control, and I also authorize periodic on-site inspection by the Howard Soil Conservation District or their authorized agents as are deemed necessary. Deviation from this plan will not be made unless authorized by the Howard Soil Conservation District.

Signature Date

STATE OF MARYLAND
REGISTERED PROFESSIONAL ENGINEER

ENGINEER'S CERTIFICATE

I hereby certify that this plan for Erosion and Sediment Control represents a practical and workable plan based on my personal knowledge of the site conditions and that it was prepared in accordance with the requirements of the Howard Soil Conservation District.

Signature Date

Reviewed for... HOWARD... S.C.D. Name and meets Technical Requirements
Signature Date
U.S. Soil Conservation Service

THIS DEVELOPMENT PLAN IS APPROVED FOR SOIL EROSION AND SEDIMENT CONTROL BY THE HOWARD SOIL CONSERVATION DISTRICT.

Signature Date

Note: For Area draining to Ex. I-6 & I-5 See plans by Whitman Requardt & Assoc. dated 3-11-73

APPROVED: DEPARTMENT OF PUBLIC WORKS		
<i>Signature</i>	Chief, Bureau of Engineering	9-28-78 Date
APPROVED: HOWARD COUNTY OFFICE OF PLANNING & ZONING		
<i>Signature</i>	Chief, Division of Land Development	10-9-78 Date
CLARK • FINEFROCK & SACKETT ENGINEERS • PLANNERS • SURVEYORS		
11315 LICKWOOD DRIVE SILVER SPRING, MARYLAND 20904 (301) 583-3400		
DESIGNED	IRJS	SCALE 1"=50'
DRAWN	K.I.W.	DRAWING 7-9-B
CHECKED	IRJS	JOB NO.
DATE	June, 1978	1241-D

BALTIMORE GAS & ELECTRIC CO. 280 315

Existing Transmission Tower

GENERAL NOTES

- Grading Permits shall be obtained prior to installation of Sediment Control or Grading.
- All Sediment and Erosion Control Measures will be installed and stabilized according to this plan prior to any other grading, clearing or disturbance of the existing surface of the site. See Note #5 for stabilization except that the seed mixture will be annual rye applied at a rate of 1.4 lbs/1000 s.f.
- Notify the Bureau of Inspections and Permits at least 24 hours before starting any work.
- All Sediment Control Practices to conform to the "Standards and Specifications for Soil Erosion and Sediment Control in Developing Areas" and shall be adjusted to meet actual field conditions.
- Stabilization of Disturbed Ground to be done as soon after construction as possible.
- All Grading shall be treated in accordance with the following Specifications:
 - Seed - certified 85% germination applied at the rate of 3 lbs/1000 s.f. mixture - 40% Kentucky Blue, 20% Chewy Fescue, 20% Kentucky 31, and 20% annual rye.
 - Fertilizer - 10-10-10 applied at the rate of 23 lbs/1000 sq. ft. Ground Agricultural Lime or Dolomitic Lime applied at the rate of 46 lbs/1000 s.f.
 - Mulch - weed free grain straw applied at the rate of 70 lbs/1000 s.f. Mulch shall be secured to the ground by any approved method i.e. asphalt tacks, chemical binder, wood chips, etc.
- All Structural Sediment Control Measures are to remain in place until permission for their removal has been obtained from the Bureau of Inspections and Permits.
- On Site Inspection and Maintenance of all Sediment Control Measures clean out of sediment traps and dikes, and proper establishment of all planned vegetative measures will be the responsibility of the Developer or his representative on the site, on a continuing day to day basis.
- Protection of stabilized area from sediment runoff shall be provided by the use of an approved Sediment Control Device, i.e. straw bale, diversion dike, etc.
- The Contractor shall keep all public roads free of sediment deposits left from traffic leaving construction site.
- Upstream Ends of all Storm Drain Pipes shall be blocked at the end of each working day, see det. this sheet.
- SITE ANALYSIS:**
 - Total Area = 10.200 Acres
 - Area to be Roofed = 0 Acres
 - Area to be Paved = 3.264 Acres
 - Area to be Seeded = 4.301 Acres
 - Area Undisturbed = 2.635 Acres
- CONSTRUCTION SEQUENCE:**
 - Install all Sediment & Erosion Control.
 - Grade Streets & Parking Areas, Install Storm Drainage & block inlets with S.F.I.P.'s
 - Construct Paving.
 - Stabilize all disturbed areas in accordance with General Note #5.
 - Sediment Control Devices to be removed only after areas draining to these devices have been stabilized.
- A complete site grading plan must be developed and approved before building permits can be issued.
- It will be the developers responsibility to provide additional Sediment & Erosion Control Devices to protect stabilized areas during construction.

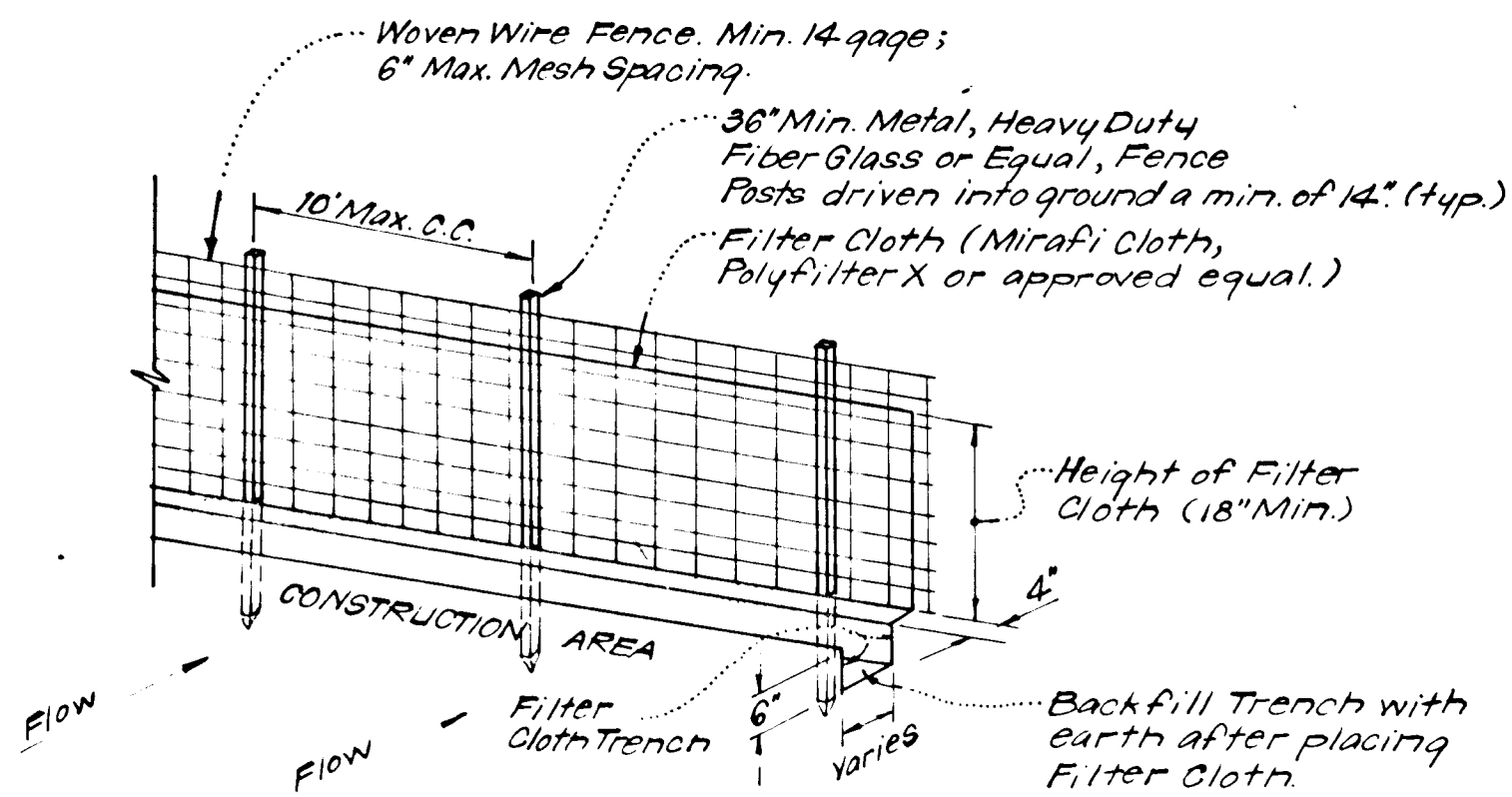

- NOTES:**
- Woven Wire Fence to be fastened securely to fence posts by use of wire ties.
 - Filter Cloth to be fastened securely to woven wire fence by use of wire ties spaced every 24" x 24".

SILT FENCE DETAIL (S.F.)
No Scale

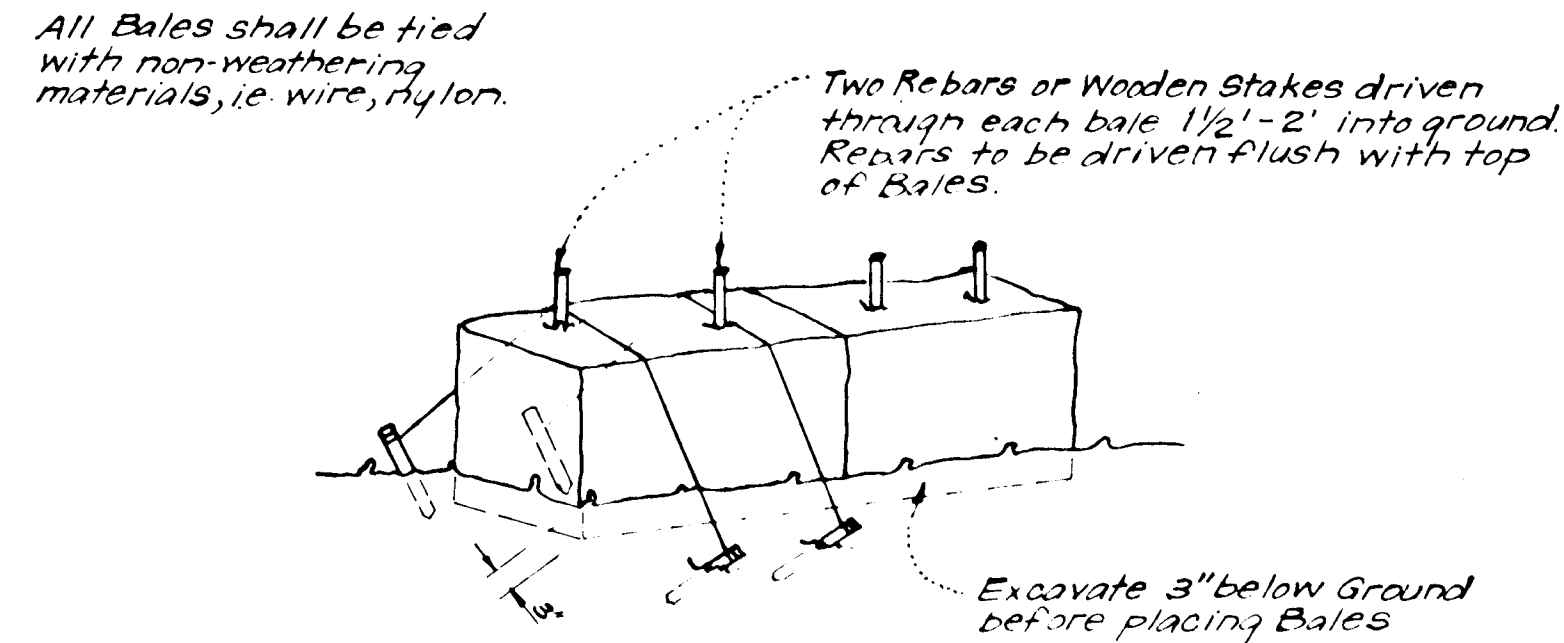

- NOTE:**
- In lieu of the use of rebar each Straw Bale may be fastened to ground with pegs (4 per bale and wire or nylon as shown above).

TYPICAL STRAW BALE DETAIL (S.B.D.)
No Scale

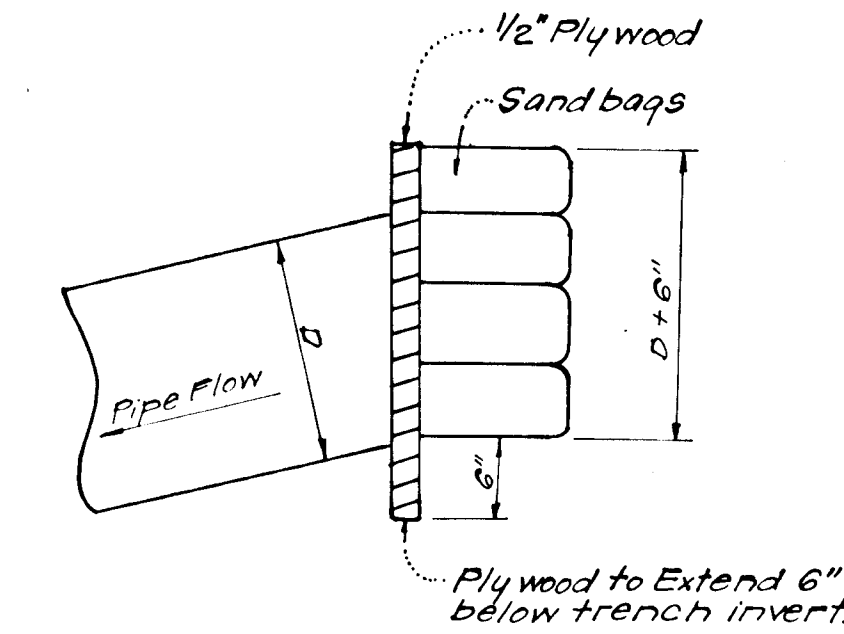

PIPE BLOCKING DETAIL
No Scale

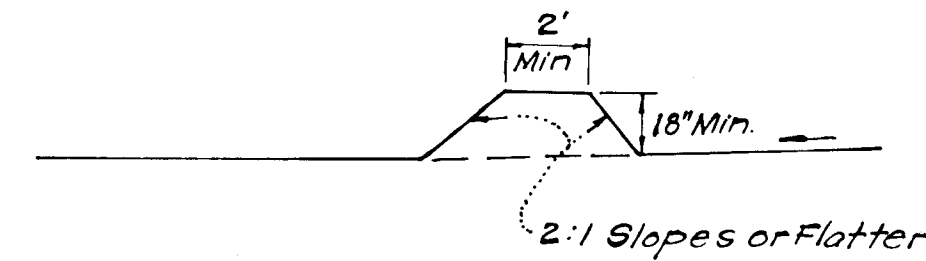

CROSS SECTION

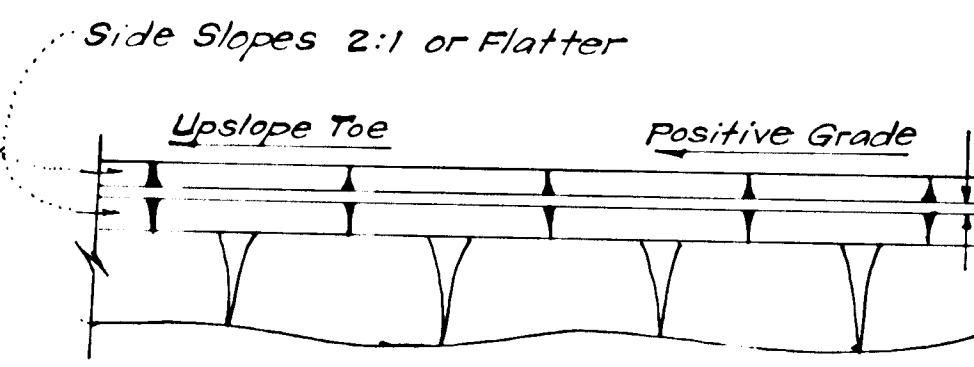

PLAN VIEW
DIVERSION DIKE (D.D.)
No Scale

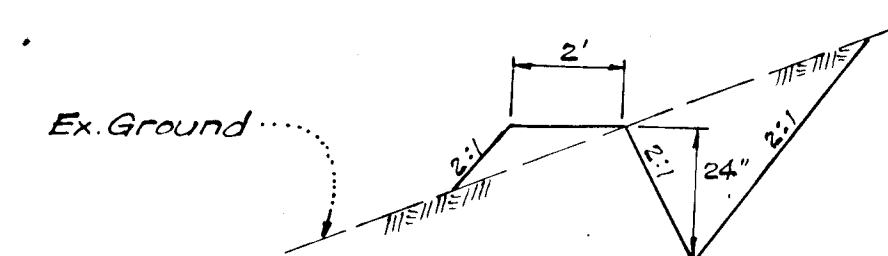

CUT DIVERSION DIKE
No Scale

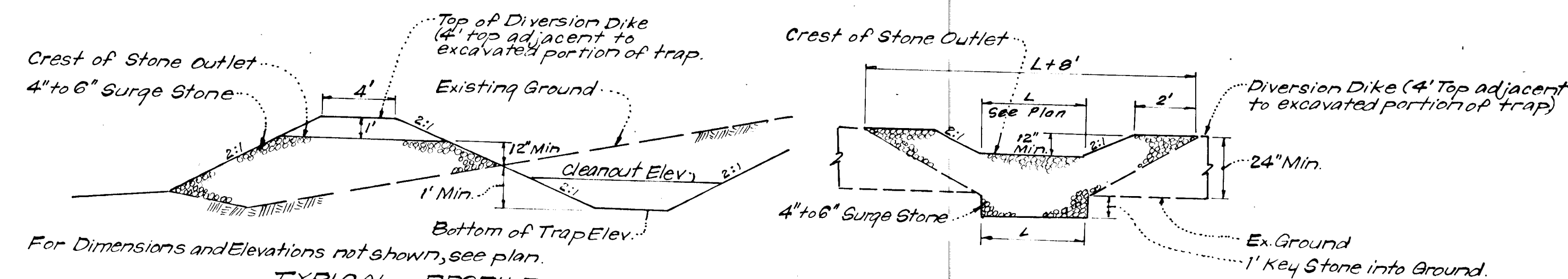

DETAILS OF STONE FILTER OUTLET
(FOR STONE OUTLET SEDIMENT TRAP)
No Scale

STONE FILTER OUTLET NOTES:

- Sediment Trap to be cleaned out when sediment reaches a level of 1 ft below the Crest of Stone Outlet.
- Bottom of Sediment Trap to be level and constructed to the dimensions shown on plan.
- Stone Outlet to be constructed through diversion dike adjacent to excavated portion of Sediment Trap.

SEDIMENT TRAP TABLE AND DIMENSIONS											
TYPE #	PAGE NO.	DWG. NO.	L.	W.	D.	Bottom Elev.	D.A. Acres	Required Volume	Provided Volume	Top Elev.	Spillway Crest
S.O.S.T. #1	20.07	ST-3	22'	21'	4'	321.0	1.9	3420	3480	326.0	325.0
S.O.S.T. #2	20.07	ST-3	24'	14'	3'	325.0	1.0	1800	1800	339.0	338.0
S.I.S.T. #3	20.08	ST-4	52'	21'	4'	341.0	3.8	6840	6960	345.6	345.0
S.I.S.T. #4	20.08	ST-4	36'	30'	3'	347.3	2.1	3760	4536	351.3	350.3
S.O.S.T. #5	20.07	ST-3	34'	15'	3'	344.0	1.4	2520	2520	348.0	347.0

Note: Clean Out Sediment when it reaches 1' below outfall crest.

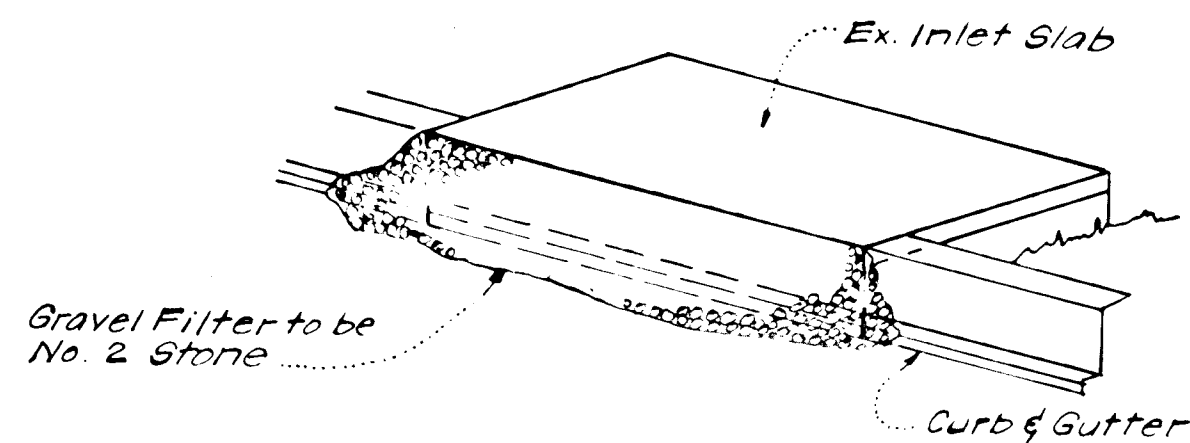

ISOMETRIC VIEW

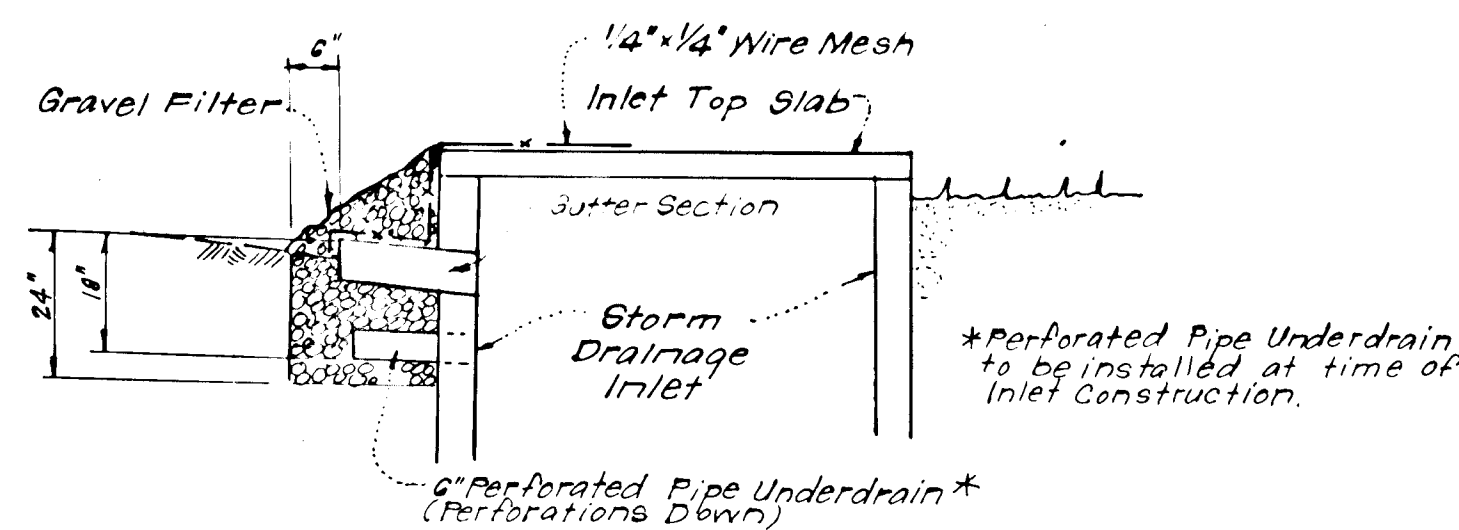

SECTION VIEW

STONE FILTER INLET PROTECTION
DETAIL (S.F.I.P.)
No Scale

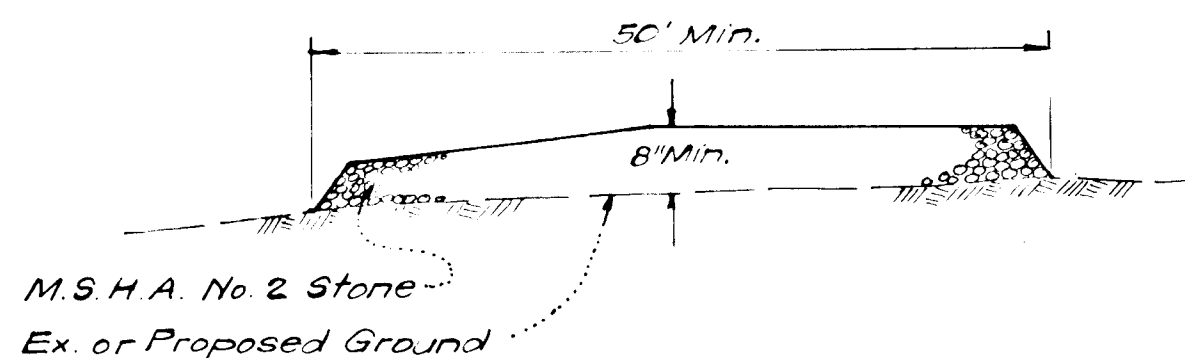

SECTION VIEW
STABILIZED CONSTRUCTION ENTRANCE
No Scale

Reviewed for: **HOWARD** S.C.D.
Name
and meets Technical Requirements
[Signature]
Signature Date
U.S. Soil Conservation Service

THIS DEVELOPMENT PLAN IS APPROVED FOR SOIL EROSION AND SEDIMENT CONTROL BY THE HOWARD SOIL CONSERVATION DISTRICT.

[Signature] Approved 9-21-78 Date

DEVELOPER'S CERTIFICATE

I certify that all development and/or construction will be done according to this plan of development and plan for Erosion and Sediment Control, and I also authorize periodic on-site inspection by the Howard Soil Conservation District or their authorized agents as are deemed necessary. Deviation from this plan will not be made unless authorized by the Howard Soil Conservation District.

[Signature] 9/17/78 Date

ENGINEER'S CERTIFICATE

I hereby certify that this plan for Erosion and Sediment Control represents a practical and workable plan based on my personal knowledge of the site conditions and that it was prepared in accordance with the requirements of the Howard Soil Conservation District.

[Signature] 9-3-78 Date

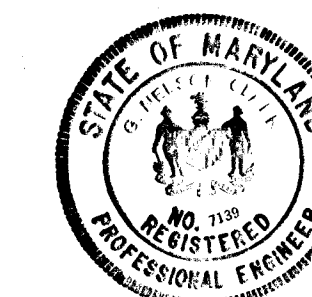

APPROVED: DEPARTMENT OF PUBLIC WORKS

[Signature] 9-22-78 DATE

APPROVED: HOWARD COUNTY OF PLANNING & ZONING

[Signature] 10-9-78 DATE

CLARK • FINEROCK & SACKETT
ENGINEERS • PLANNERS • SURVEYORS

11315 LOCKWOOD DRIVE SILVER SPRING, MARYLAND 20904 (301) 593-3400

DESIGNED	R.O.S.	ROAD CONSTRUCTION PLANS A RESUBDIVISION OF PARCEL A-1 SEDIMENT & EROSION CONTROL DETAILS	SCALE	As Shown
DRAWN	K.I.W.	COLUMBIA	DRAWING	8 of 8
CHECKED	R.U.S.	VILLAGE OF OWEN BROWN SECTION 2 AREA 1 6th ELECTION DISTRICT HOWARD COUNTY, MARYLAND	JOB NO.	
DATE	July, 1978	FOR: HOWARD Research & Development Corp. The Rouse Company Bldg. Columbia, Maryland 21044	FILE NO.	1241-D

#6/ 5/20-2-91

19-79-20e