

SITE ANALYSIS
 TOTAL AREA OF SITE: 3.36 Ac.
 DISTURBED AREA: 3.36 Ac.
 PAVED AREA: 2.33 Ac.
 BEVEGETATED AREA: 1.03 Ac.
 UNDISTURBED AREA: 0 Ac.

DRAINAGE MAP
 Scale: 1" = 200'

INLET SCHEDULE

No	Type	Invert Out	Top Elevation	Q (c.f.s.)	Remarks
I-65	15" Comb. Inlet	233.86	238.64	4.70	See Ho. Co. Details
I-66	5" Comb. Inlet	234.69	238.88	2.30	See Ho. Co. Details
I-67	S.H.A. Standard W2	239.25	243.69	2.20	See S.H.A. Details
I-68	S.H.A. Standard W2	239.68	243.61	3.54	See S.H.A. Details
I-75A	S.H.A. Single W2	217.00	220.65	2.65	See S.H.A. Details
I-75	S.H.A. Single W2	216.62	220.75	2.34	See S.H.A. Details
I-76	S.H.A. Single W2	225.50	228.60	2.05	See S.H.A. Details

MANHOLE SCHEDULE

No	Type	Size	Invert Out	Top Elevation	Remarks
M-19	Type B Manhole	48" x 48"	233.04	239.52	See Ho. Co. Details
M-20	S.H.A. Std. Manhole TYPE 'B'	48" x 48"	238.64	242.72	See S.H.A. Details
			237.93	243.05	Ho. Co. Details

STRUCTURE SCHEDULE

No	Type	Size	Invert Out	Top Elevation	Remarks
E-7	Std. End Support Wall	15"	223.70	Set In Field	See S.H.A. Details
E-8	Std. 'C' Headwall	18"	240.00	Set In Field	See S.H.A. Details

STORM DRAIN DESIGN COMPUTATIONS

Location	From	To	Area	Acres	C'	CA	E	CA	Time Conc. - Min	Inlet	Drain	Total	Inten	Q*	Q2*	Q3*	% Inter.	Q" Inter.	Pipe Size	Slope %	Vel.	Loth. Ft.	Time In Pipe	Remarks	
I-65	I-68	124	0.9	0.57	0.52				5	5	5	7.0	3.64	3.64	80%	2.91	18"	0.14	1.05	2.0	135	1.1	S.H.A. Inlet		
I-66	M-20	124	0.9	0.95	0.29	0.52			5	5	5	7.0	3.64	3.64	20%	1.83	18"	0.14	1.05	2.0	135	1.1	S.H.A. Inlet		
I-67	M-20	123	0.3	0.29	0.81	0.29			5	5	5	7.0	2.03	2.03			18"	0.045	1.40	1.18	72	1.0	Ho. Co. Inlet		
I-68	M-19	123 & 124	1.2	0.95	0.29	0.81			5	5	5	7.0	2.03	2.03			18"	0.2	1.26	3.0	322	1.8	Ho. Co. Inlet		
I-65	I-65	103	0.4	0.95	0.38	2.92			5	5	5	7.0	2.66	2.66	86%	2.46	24"	0.7	1.00	5.5	6	-	Ho. Co. Inlet		
I-65	M-19	103 & 98	3.2	0.80	2.56	2.92			5	5	5	7.0	17.92	17.92			24"	0.92	2.68	6.4	34	-	Ho. Co. Inlet		
I-66	I-66	104	0.4	0.95	0.38	2.92			5	5	5	7.0	2.66	2.66	87%	2.31	15"	0.19	1.41	2.1	34	-	Ho. Co. Inlet		
I-66	M-19	104	0.4	0.95	0.38	2.92			5	5	5	7.0	2.66	2.66			15"	0.27	3.02	6.8	32	-	Conn. to Ex. 27		
M-19	Ex. 27	123, 124 & 98	5.2	4.13	1.0	6.65			5	5	5	6.65	27.46	27.46			27"								
I-75A	I-75A	120A	0.4	0.85	0.34	0.34			5	5	5	5.3	Q2 = 1.80*						15"	0.22	0.30	2.5	42	0.28	S.H.A. Design
I-75	I-75	120A	0.4	0.63	0.81	1.15			5	5	5	2.0	Q2 = 2.1*						15"						S.H.A. Design
I-75	End Wall	120 & 120A	1.68	1.68	1.15	8.5			5	5	5	4.4	Q2 = 3.58*					18"	10.12	3.1	10			S.H.A. Design	
I-77	I-77	122	0.3	0.85	0.26	0.26			5	5	5	5.3	Q2 = 1.38*						15"	0.15	1.38	1.9	42	0.54	S.H.A. Design
E-8	E-8	125	1.27	0.52	0.66	7			7	7	7	8.2	Q2 = 5.4*						18"	Hw/D = 0.50	Hw = 1.35'				x-culvert

NOTE: 10 YEAR STORM FREQUENCY EXCEPT AS DENOTED * PIPE: N=0.14 Ho. Co. Design
 N=0.13 S.H.A. Design

SCHEDULE OF CONSTRUCTION FOR EROSION CONTROL

- CONTRACTOR TO NOTIFY THE HOWARD SOIL CONSERVATION DISTRICT OFFICE (445-3180) 24 HRS. PRIOR TO BEGINNING CONSTRUCTION.
- CONTRACTOR TO INSTALL EROSION CONTROL MEASURES BEFORE THE START OF ANY GRADING.
- ALL PROPOSED PAVED AREAS ARE TO HAVE BASE COURSE APPLIED AS SOON AS POSSIBLE AFTER GRADING OPERATION.
- STORM DRAINAGE SYSTEMS ARE TO BE INSTALLED IMMEDIATELY AFTER GRADING OPERATION. AT THE CESSATION OF EACH DAY'S CONSTRUCTION, THE UPSTREAM END OF EACH STORM DRAIN SYSTEM SHALL BE SECURELY CAPPED TO PREVENT INFILTRATION OF SEDIMENT INTO THE SYSTEM.
- ALL SLOPES 3:1 OR STEEPER ARE TO BE SEEDDED IMMEDIATELY AFTER THE COMPLETION OF GRADING OPERATION USING A SEED MIX OF KENTUCKY 31 FESCUE APPLIED AT THE RATE OF 40*/ACRE AND CROWN VETCH APPLIED AT THE RATE OF 15*/AC. (CROWN VETCH TO BE SCARIFIED AND INOCULATED CERTIFIED SEED)
 SURFACE PREPARATION TO INCLUDE GROUND LIMESTONE OVER TOPSOIL AT THE RATE OF 1/4 Ton/Ac. (60*/1000 S.F.), COMMERCIAL FERTILIZER (10-10-10) AT THE RATE OF 3/4 Ton/Ac. (35*/1000 S.F.) AND SUPER PHOSPHATE AT THE RATE OF 600*/Ac. (15*/1000 S.F.)
 IMMEDIATELY AFTER SEEDING, MULCH AREA UNIFORMLY WITH UNWEATHERED SMALL GRAIN STRAW (PREFERABLY WHEAT) AT THE RATE OF 1/2 T/AC. ANCHOR WITH ASPHALT BINDER SHA DESIGNATION AE-3 OR AE-4 AT THE RATE OF 0.1 GAL/S.F.
- ALL REMAINING UNPAVED AREAS ARE TO BE STABILIZED IMMEDIATELY AFTER THE COMPLETION OF GRADING USING A SEED MIXTURE OF KENTUCKY 31 FESCUE APPLIED AT THE RATE OF 200*/AC. SURFACE PREPARATION TO BE AS NOTED IN 5) ABOVE.

DEVELOPER'S CERTIFICATION

I Certify That All Development And/Or Construction Will Be Done According To This Plan Of Development And Plan For Erosion And Sediment Control, And I Also Authorize Periodic On-Site Inspection By The Howard Soil Conservation District Or Their Authorized Agents As Are Deemed Necessary.

Executive Director: *[Signature]* Date: 4/11/76

ENGINEER'S CERTIFICATION

I Certify That This Plan For Erosion And Sediment Control Represents A Practical And Workable Plan Based On My Personal Knowledge On The Site Conditions And That It Was Prepared In Accordance With The Requirements Of The Howard Soil Conservation District.

Engineer: *[Signature]* Date: 4/11/76
 Reg. # 5043

Reviewed for HOWARD S.C.D. And Meets Technical Requirements.
 U.S. Soil Conservation Service: *[Signature]* Date: 5/26/76

This Development Plan Is Approved For Soil Erosion And Sediment Control By The Howard Soil Conservation District.

Approved: *[Signature]* Date: 5-26-76
 HOWARD S.C.D.

APPROVED
 DIVISION OF LAND DEVELOPMENT
 AND TRANSPORTATION PLANNING
 HOWARD COUNTY, MARYLAND
 DATE: MAY 4, 1976
[Signature]

DWG. NO.	
PROJECT NO.	
DATE:	
SHEET NO.	1 OF 5
DRAWING NO.	
CONTRACT NO.	
FILE	

DESIGNED: J.H.N.	ENGINEER: G.W. STEPHENS, JR. & ASSOC.	OWNER & DEVELOPER: MARYLAND WHOLESALE FOOD CENTER AUTHORITY	OFFICE OF PLANNING & ZONING: CHIEF DIVISION OF LAND DEVELOPMENT OF TRANSPORTATION PLANNING	DEPARTMENT OF PUBLIC WORKS: CHIEF, BUREAU OF HIGHWAYS	HOWARD COUNTY DEPARTMENT OF PUBLIC WORKS BUREAU OF ENGINEERING: GREATER BALTIMORE CONSOLIDATED WHOLESALE FOOD MARKET
DRAWN: S.P.Z.	ENGINEER: George W. Stephens, Jr. & Associates, Inc. 303 ALLEGHENY AVENUE TOWSON, MARYLAND 21204	201 W. PRESTON ST. BALTIMORE, MD. 21201	<i>[Signature]</i> 5/25/76	<i>[Signature]</i> 5/27/76	MD. RTE. 175 & POCOMOKE AVE. JESSUP, MARYLAND HOWARD CO., ELECTION DISTRICT NO. 6
CHECKED: J.H.N.	DATE: 5/19/76				As-Built July, 1978

#28

CONSTRUCTION NOTES

- 1) Removal of Existing Curbs To Be Included in Cost of other Items Bid.
- 2) All C&P And G&E. Poles To Be Relocated by others.
- 3) Station 7+00 To 11+00, Bound Portions of Existing Road And Shoulder Under Prop. Median Area To Be Removed. This Work To Be Part of Class & Excavation Item.

NOTE: MD. ROUTE 175 Contractor to maintain traffic in both directions @ all times. And All work in the right-of-way shall be done in accordance with the State Highway Administration Permit No.

GENERAL NOTES

1) Vehicular Ingress & Egress To Md. Route 175 Is Restricted Except At Points Of Access Approved By The Howard Co. Office Of Planning & Zoning.

BENCH MARK # 203 ELEV 253.04 State Highway Administration Brass Marker Set In Concrete On East Side of Md. Route 175, 45' From Edge of Chief Concrete Paving & 30' From The South Curb of the North Entrance To Patuxent Institute

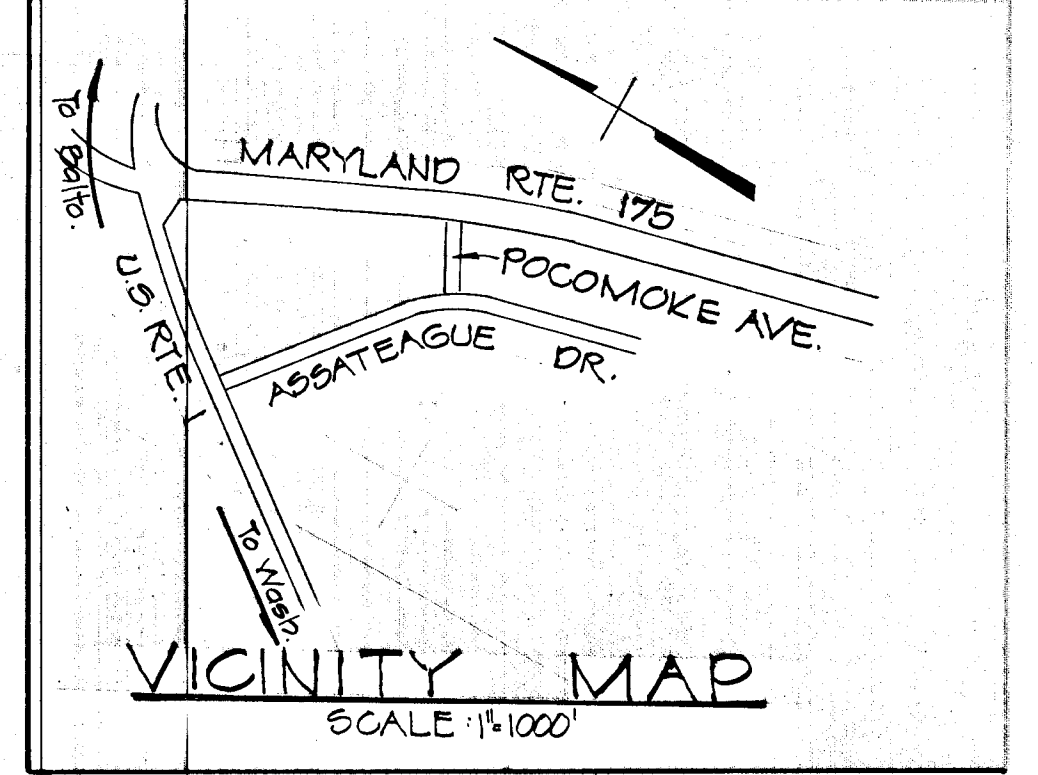

MD. ROUTE 175

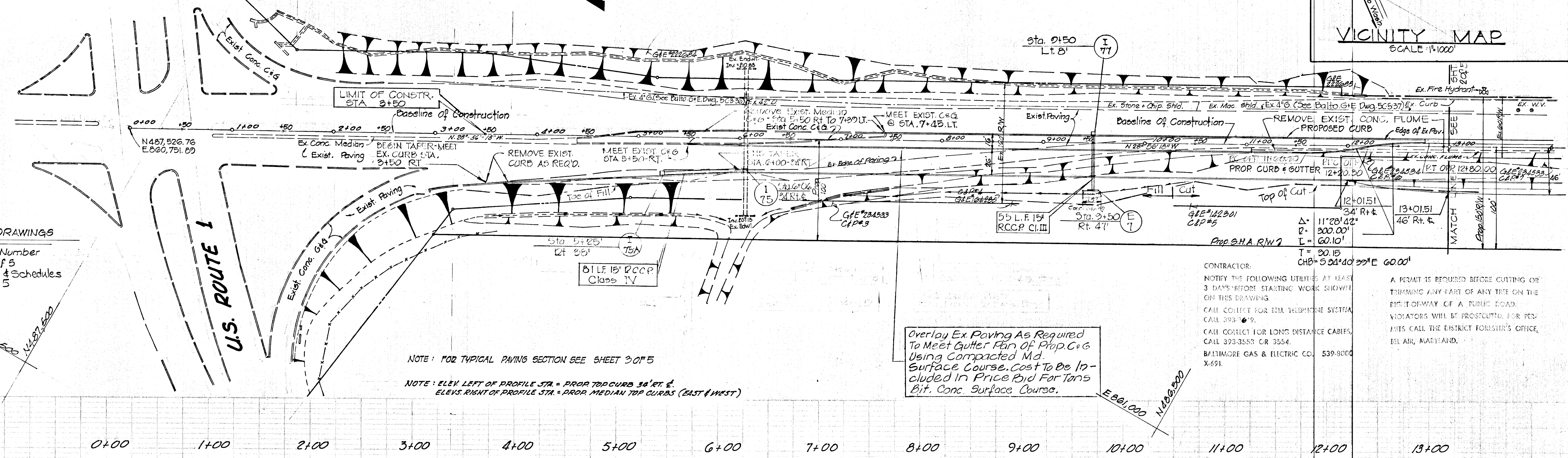

REFERENCE DRAWINGS

- Drain Profiles: Drawing Number Sht. 5 of 5
- Sediment Control Notes & Schedules Sht. 1 of 5

NOTE: FOR TYPICAL PAVING SECTION SEE SHEET 3 OF 5
 NOTE: ELEV. LEFT OF PROFILE STA. = PRIOR TO CURB 38" RT. & ELEV. RIGHT OF PROFILE STA. = PRIOR MEDIAN TOP CURBS (EAST & WEST)

Overlay Ex. Paving As Required To Meet Gutter Pan Of Prop. C&G Using Compacted Md. Surface Course. Cost To Be Included In Price Bid For Tens Bit. Conc. Surface Course.

CONTRACTOR: NOTIFY THE FOLLOWING UTILITIES AT LEAST 3 DAYS BEFORE STARTING WORK SHOWN ON THIS DRAWING.
 CALL COLLECT FOR BELL TELEPHONE SYSTEM, CALL 393-6699.
 CALL COLLECT FOR LONG DISTANCE CABLES, CALL 393-3555 OR 3554.
 BALTIMORE GAS & ELECTRIC CO., 539-9000 X-691.

A PERMIT IS REQUIRED BEFORE CUTTING OR TRIMMING ANY PART OF ANY TREE ON THE RIGHT-OF-WAY OF A PUBLIC ROAD. VIOLATORS WILL BE PROSECUTED. FOR PERMITS CALL THE DISTRICT FORESTER'S OFFICE, BEL AIR, MARYLAND.

DEVELOPER'S CERTIFICATION

"I Certify That All Development And/Or Construction Will Be Done According To This Plan Of Development And Plan For Erosion And Sediment Control, And I Also Authorize Periodic On-site Inspection By The Howard Soil Conservation District or Their Authorized Agents, As And Deemed Necessary."

J. Roy Yee
 EXECUTIVE DIRECTOR
 Date: 4/1/76

ENGINEER'S CERTIFICATION

"I Certify That This Plan For Erosion And Sediment Control Represents A Practical And Workable Plan Based On My Personal Knowledge Of The Site Conditions And That It Was Prepared In Accordance With The Requirements Of The HOWARD SOIL CONSERVATION DISTRICT."

Charles E. Fiala
 P.E. Reg. # 5048
 Date: 4/1/76

REVIEWED FOR HOWARD SOIL CONSERVATION DISTRICT AND MEETS TECHNICAL REQUIREMENTS.

Eric U. Hansen
 U.S. SOIL CONSERVATION SERVICE
 DATE: 5/20/76

This Development Plan Is Approved For Soil Erosion And Sediment Control By The Howard Soil Conservation Dist.

APPROVED: *Howard S. G.*
 HOWARD SOIL CONSERVATION DISTRICT
 DATE: 5-20-76

240
235
230
225
220

240
235
230
225
220

APPROVED
 DIVISION OF LAND DEVELOPMENT AND TRANSPORTATION PLANNING
 HOWARD COUNTY, MARYLAND
 DATE: MAY 4, 1976
J. K.



HOWARD COUNTY - DEPARTMENT OF PUBLIC WORKS - BUREAU OF ENGINEERING

MD. ROUTE 175

HOWARD CO. MD. ELECT. DIST. SIX

Des. J.H.N.	G.W. Stephens, Jr. & Assoc.	Department of General Services	Department of Public Works	Office of Planning & Zoning	Owner & Developer	Date	Revision	By	Scale	JESSUP	Dwg. Completed	SHA/Permit No.	Contract No.	Drawing No.	Sheet No.
Chk. J.H.N.	Engr. Stephen H. Nease	SE ME EE CE LA	Chief, Bureau of Highways	Chief, Division of Land Development	201 W. Preston Street, Baltimore, Maryland, 21201	5/21/76			Plan: 1"=50' Profile: 1"=5'						2 OF 5

'As Built' July, 1978

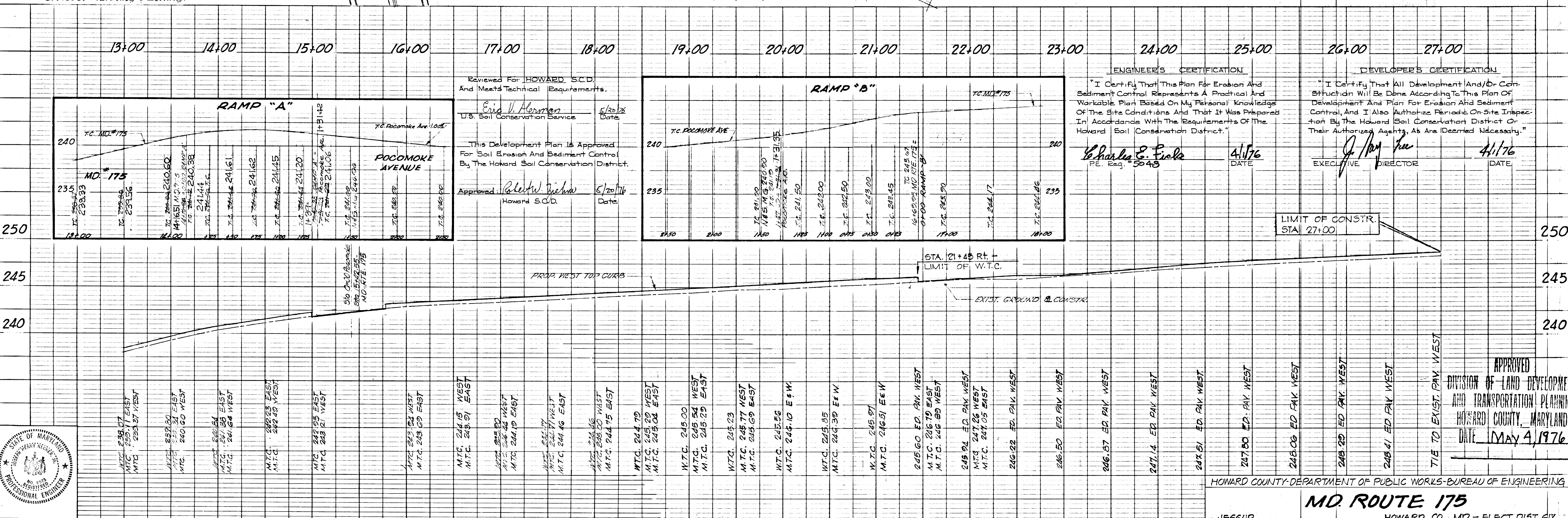
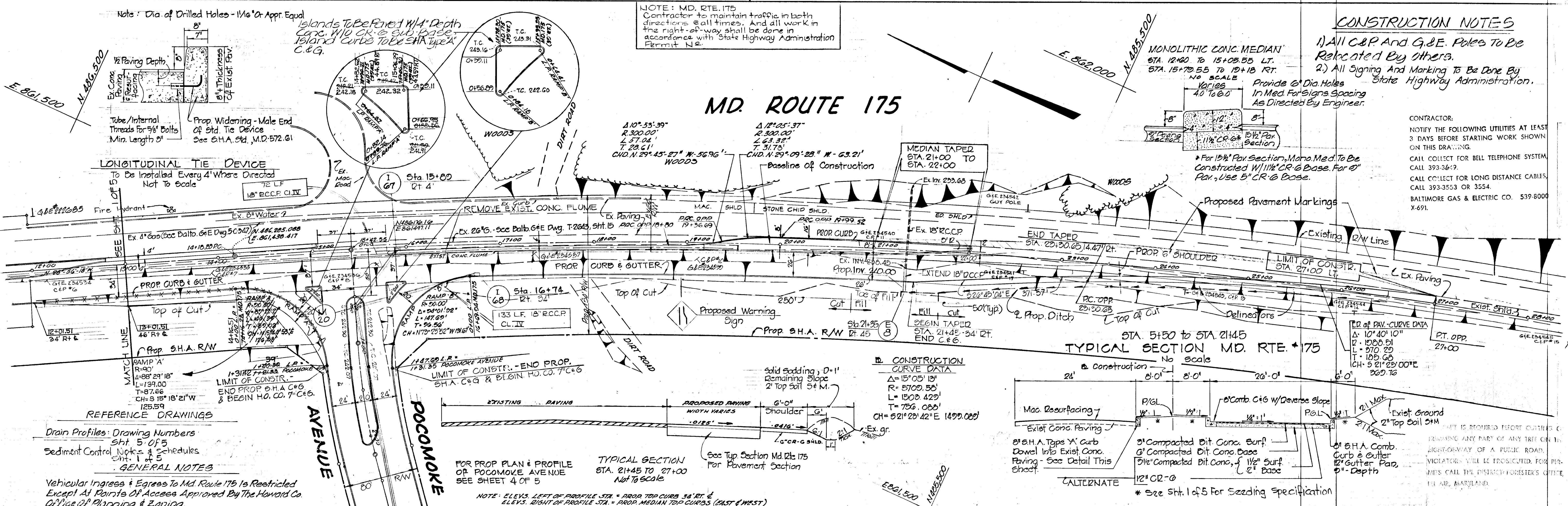

Des. J.H.N. G.W. Stephens, Jr. & Assoc.	Department Of General Services	Department Of Public Works	Office Of Planning & Zoning	Owner & Developer	Date	Revision	By	Scale	Dwg Completed	S.H.A. Permit No.	Contract No.	Drawing No.	Sheet No.
Drn. B.P.C. Engr. J.H.N. Neek	SE M.E. EE CE LA Director	Chief, Bureau Of Highways	Chief, Division Of Land Development	Maryland Wholesale Food Center Authority	4/17/76		JESSUP	Plan: 1"=50'				60-0028	3 of 5
Chk. J.H.N. Lic. No. 0210 Date 2/10/76		Chief, Bureau Of Highways	Chief, Division Of Land Development	201 W. Preston Street Baltimore, Maryland 21201				Profile: Hor: 1"=50' Vert: 1"=5'					

APPROVED
 DIVISION OF LAND DEVELOPMENT AND TRANSPORTATION PLANNING
 HOWARD COUNTY, MARYLAND
 DATE: May 4, 1976

HOWARD COUNTY DEPARTMENT OF PUBLIC WORKS - BUREAU OF ENGINEERING

MD. ROUTE 175

HOWARD CO., MD. - ELECT. DIST. SIX

As-Built July, 1978

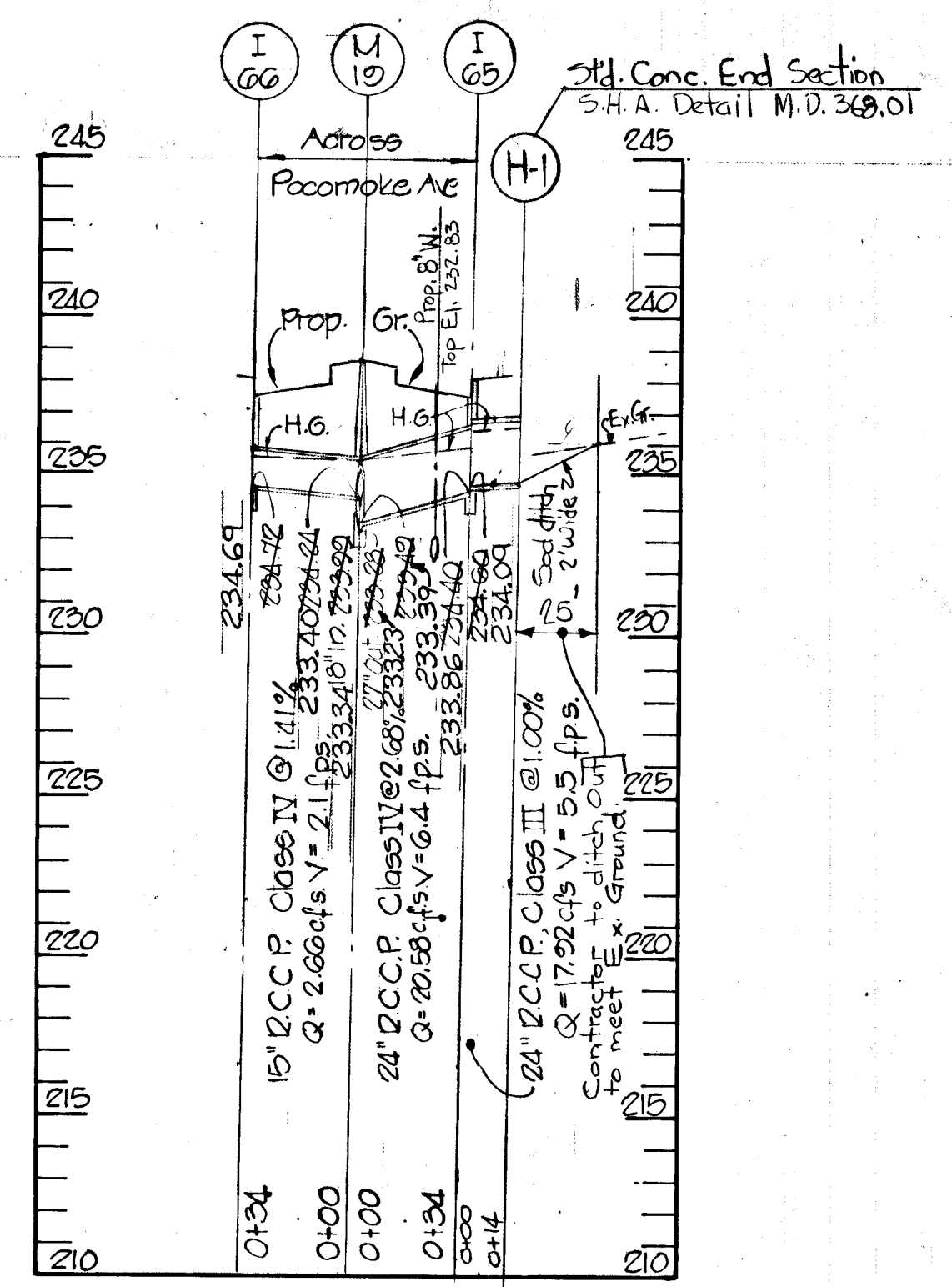
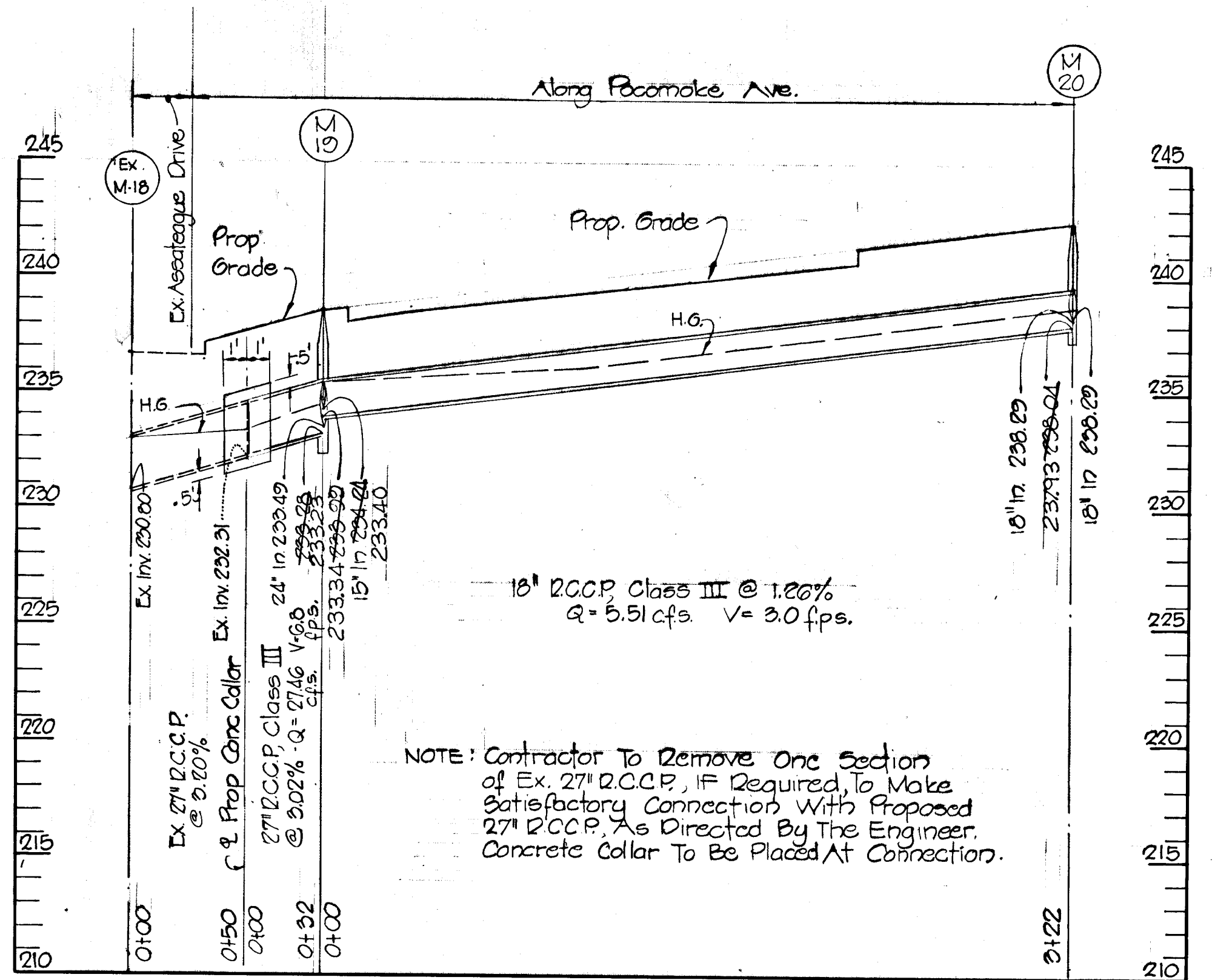
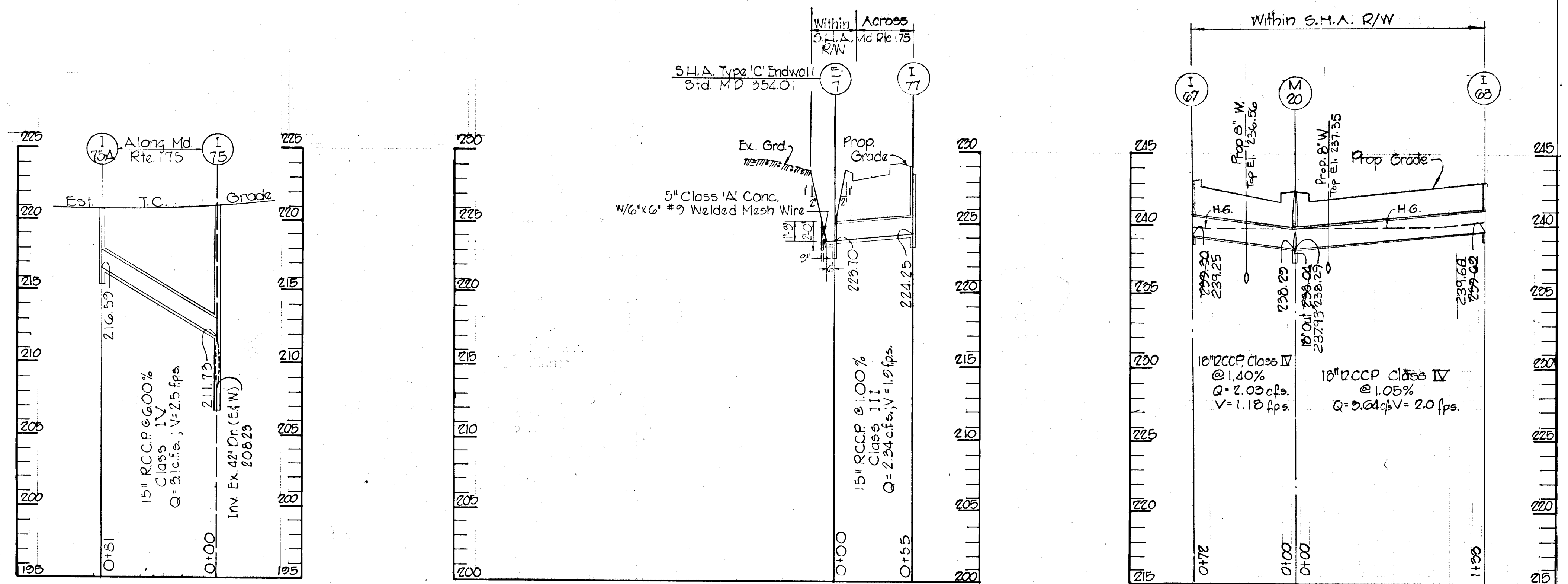

PROFILES
 SCALE: Horiz. 1" = 50'
 Vert. 1" = 5'

APPROVED
 DIVISION OF LAND DEVELOPMENT
 AND TRANSPORTATION PLANNING
 HOWARD COUNTY, MARYLAND
 DATE May 4, 1976

DESIGNED: J.H.N.		G.W. STEPHENS JR. & ASSOC. ENGINEER	OWNER & DEVELOPER	OFFICE OF PLANNING & ZONING	DEPARTMENT OF PUBLIC WORKS	HOWARD COUNTY DEPARTMENT OF PUBLIC WORKS BUREAU OF ENGINEERING	DATE	REVISIONS	BY	SHEET NO. 5 OF 5
DRAWN: S.P.Z.		Joseph H. Neck ENGINEER REG. NO. 8070	GEORGE W. STEPHENS JR. & ASSOC. 303 ALLEGHENY AVENUE TOWSON, MARYLAND, 21204	MARYLAND WHOLESALE FOOD CENTER AUTHORITY 201 WEST PRESTON ST. BALTIMORE, MD. 21201	CHIEF, DIVISION OF LAND DEVELOPMENT & TRANS- PORTATION PLANNING <i>J.H. Clawson</i> DATE: <u>5/25/76</u>	CHIEF, BUREAU OF HIGHWAYS <i>J.H. Meenan</i> DATE: <u>5/27/76</u>	GREATER BALTIMORE CONSOLIDATED WHOLESALE FOOD MARKET STORM DRAIN PROFILES MD. RTE. 175 & POCOMOKE AVE. JESSUP, MARYLAND HOWARD CO. ELECTION DISTRICT NO. 6			DRAWING NO.
CHECKED: J.H.N.		DATE: <u>5/13/75</u>								CONTRACT NO.
										FILE