

ROAD (EXIST.)

RIDGE

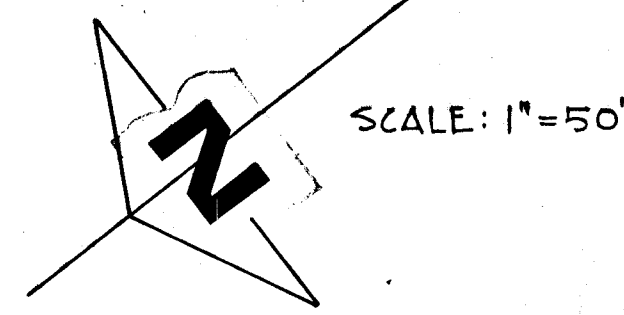

SCALE: 1"=50'

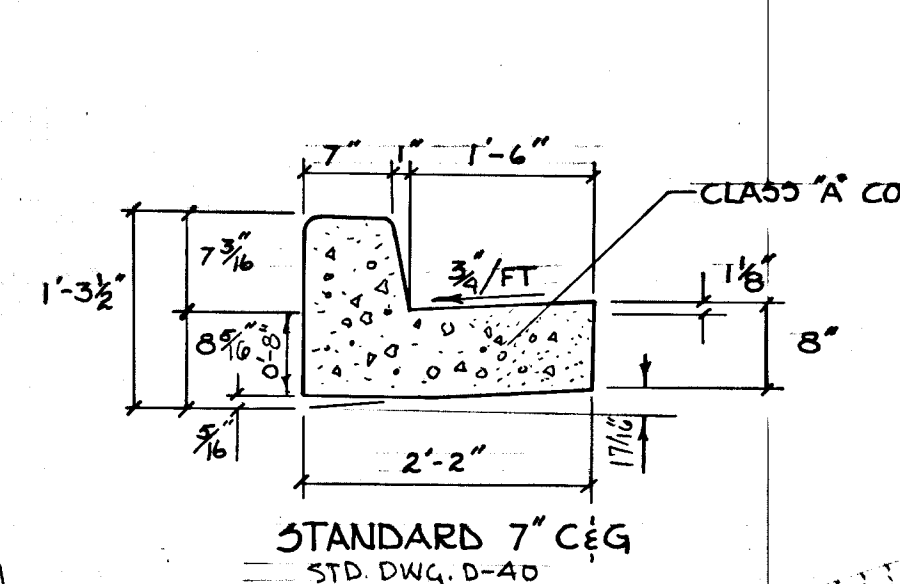

STANDARD 7" C&G  
STD DWG. D-40

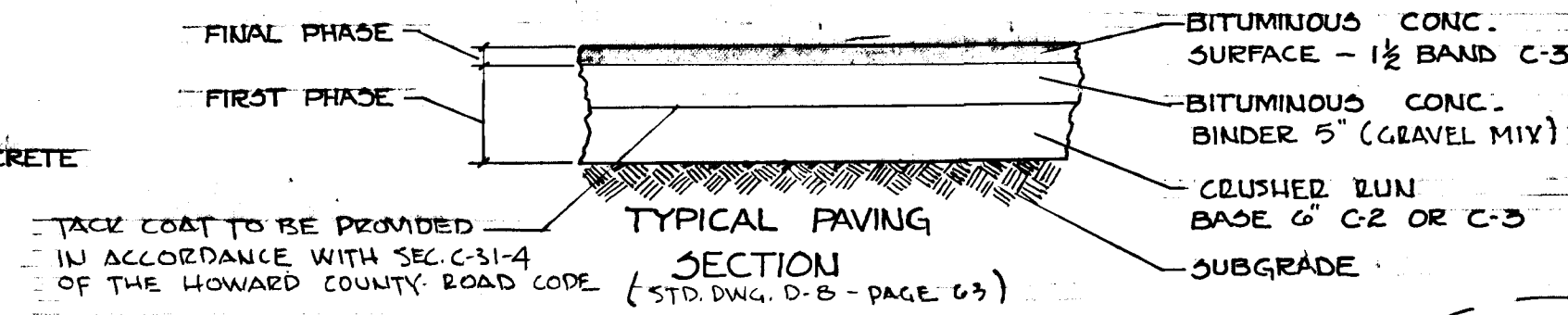

TYPICAL PAVING SECTION  
(STD DWG. D-8 - PAGE 03)

B.M.#1 - ELEV. 412.08  
NAIL IN G.E.E. POLE # 228205, 100 FT. W OF  
STA 4+20 RIDGE RD

B.M.#2 - ELEV. 414.05  
PK. NAIL IN ASPHALT OPPOSITE S. SIDE  
BRIDGE ABUTMENT ON RIDGE ROAD.

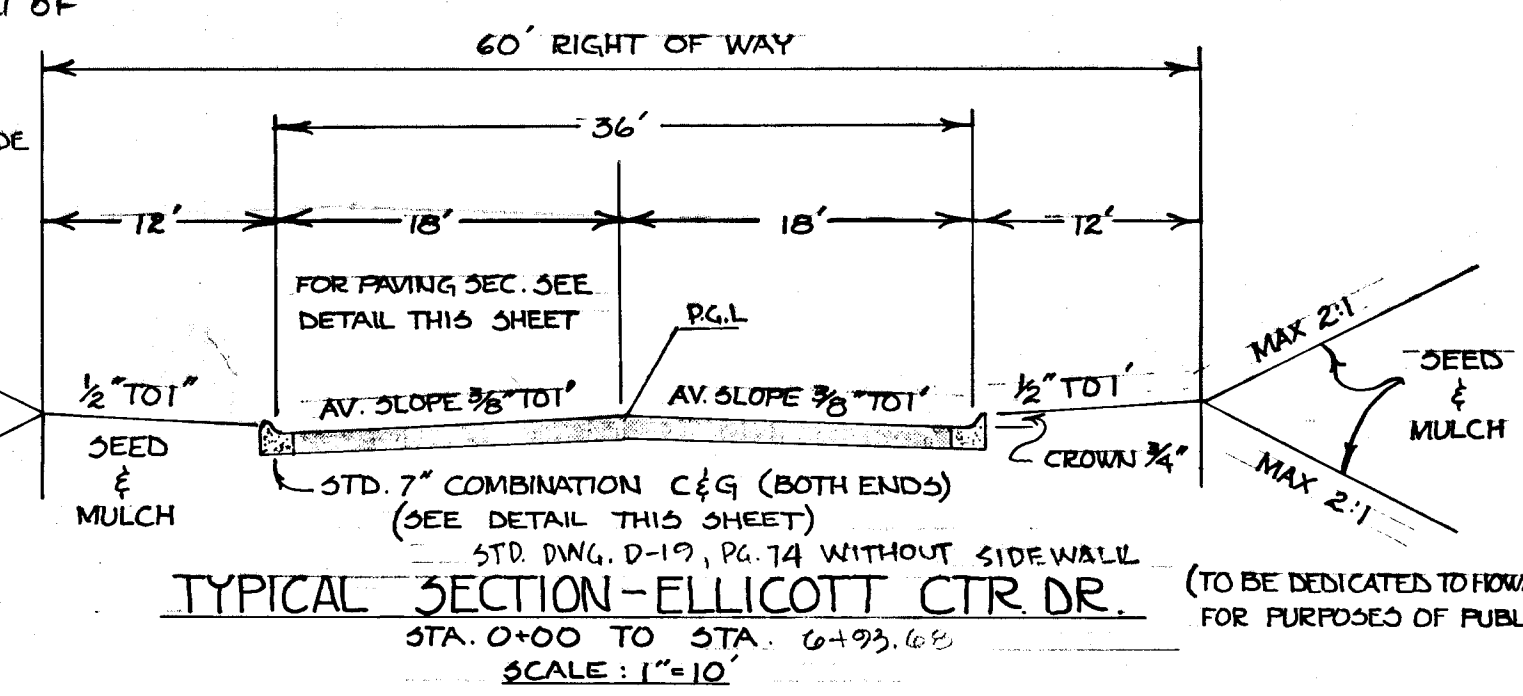

TYPICAL SECTION - ELLICOTT CTR DR.  
(TO BE DEDICATED TO HOWARD CO. FOR PURPOSES OF PUBLIC ROAD)  
STA. 0+00 TO STA. 6+93.65  
SCALE: 1"=10'

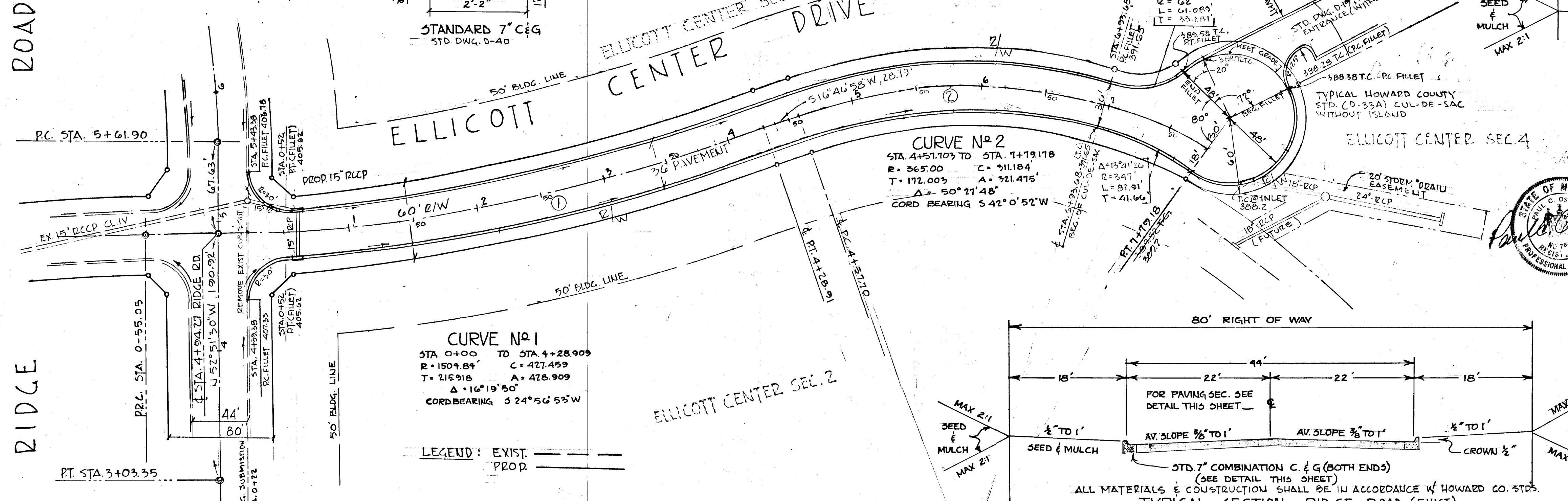

**CURVE No 1**  
STA. 0+00 TO STA. 4+28.909  
R = 1509.84' C = 427.453'  
T = 215.918 A = 428.909'  
Δ = 16°19'50"  
CORD BEARING = S 24°56'55"W

**CURVE No 2**  
STA. 4+51.703 TO STA. 7+19.178  
R = 365.00' C = 911.84'  
T = 112.003 A = 321.415'  
Δ = 50°21'48"  
CORD BEARING = S 42°0'52"W

LEGEND: EXIST. ---  
PROP. - - -

DESIGN SPEED 30 M.P.H.

FOR LIMITS OF GRADING SEE SHEET 11#2 OF 8

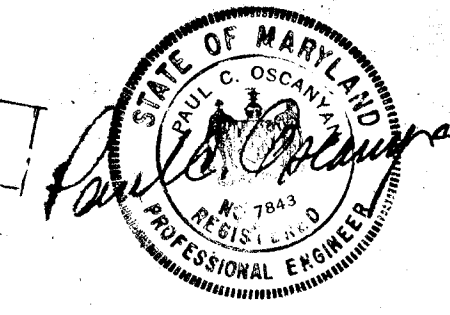

<b>SECTION TWO ELLICOTT CENTER</b>	
SECTION ELECTION DIST. HOWARD COUNTY, MD.	
PLAN & PROFILE: ELLICOTT CENTER DRIVE (STA. 0+00 TO STA. 7+79.18 - SOUTH OF RIDGE ROAD)	
OWNER & DEVELOPER: ELLICOTT CORPORATION 1901 N. FORT MEYER DRIVE ARLINGTON, VIRGINIA	
DEPT. OF PUBLIC WORKS CHIEF - BUREAU OF HIGHWAYS	4/7/75 DATE
OFFICE OF PLANNING & ZONING CHIEF - DIVISION OF LAND DEVELOPMENT & TRANSPORTATION PLANNING	DATE: 4/1/75
IPDS 850 BRAD AVENUE, SUITE 302 BELLEVUE SPRING, MARYLAND 20810 TELEPHONE: (301) 585-5448	DATE: 5-13-75 SCALE: AS SHOWN
SHEET 1 OF 3	

SIGNATURE OF APPROVAL ON ORIGINAL FINAL PLAN IS SUBJECT TO PAYMENT OF AN ENGR. FEE (COUNCIL BILL # 56)

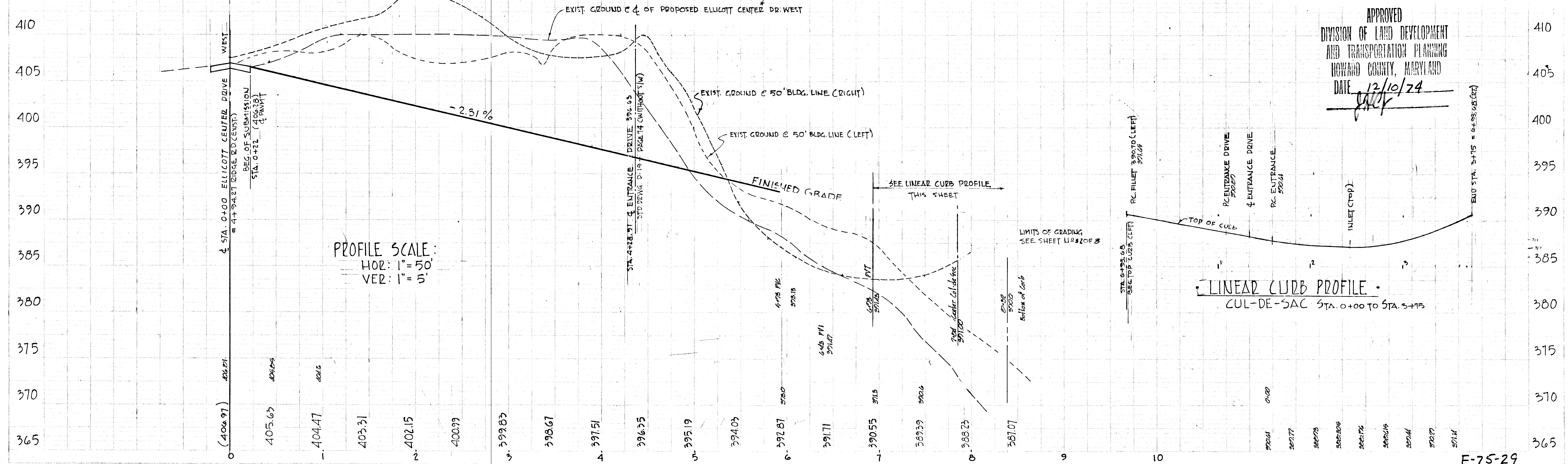

PROFILE SCALE:  
HOR: 1"=50'  
VER: 1"=5'

LINEAR CURB PROFILE  
CUL-DE-SAC STA. 0+00 TO STA. 3+175

APPROVED  
DIVISION OF LAND DEVELOPMENT  
AND TRANSPORTATION PLANNING  
HOWARD COUNTY, MARYLAND  
DATE: 12/10/74





B.M.#1 - ELEV. 412.08  
 NAIL IN G.E. POLE #228205, 100FT. W. OF  
 STA. 4+20 BRIDGE RD.

B.M.#2 - ELEV. 414.05  
 P.K. NAIL IN ASPHALT OPPOSITE S. SIDE  
 BRIDGE ABUTMENT ON RIDGE ROAD.

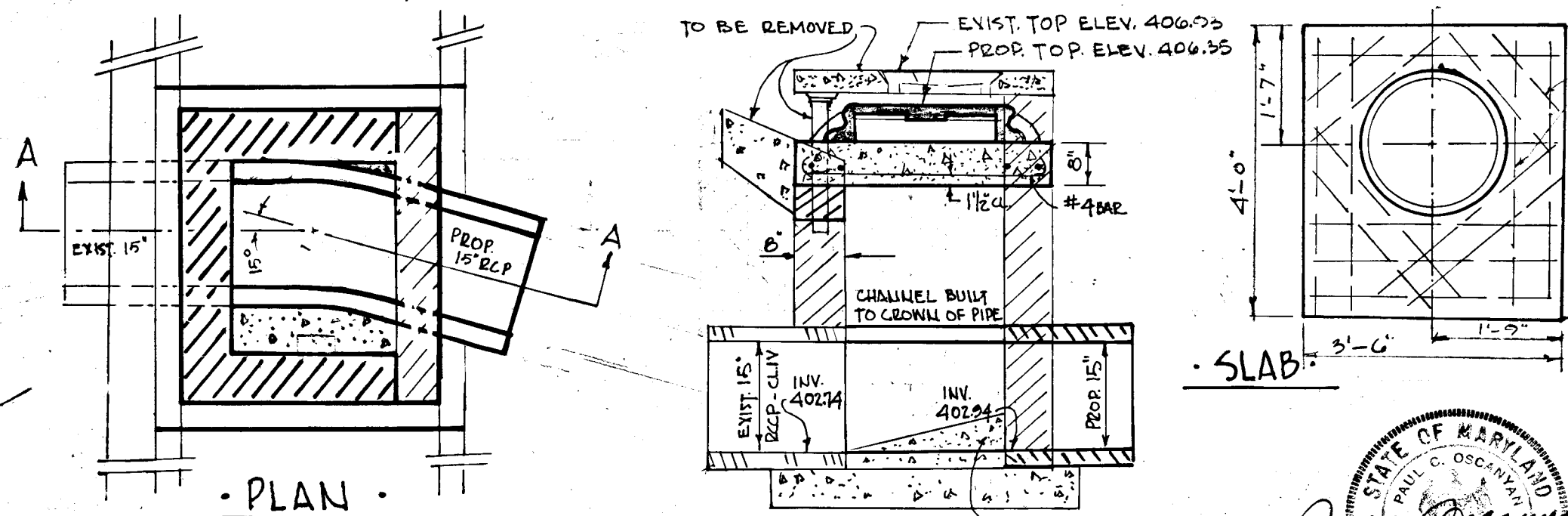

NOTE: CONVERT EXIST. A-5 TYPE INLET TO SHALLOW M.H. TYPE S-3  
 OF HOWARD COUNTY STD. SAN. SEWER DETAILS

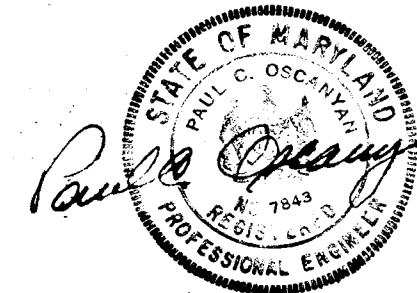

**ELICOTT CENTER SECTION-2**  
 SECOND ELECTION DIST. HOWARD CO. MD.

**STORM DRAIN: ELICOTT CENTER DRIVE**  
 STA. 0+00 TO STA. 1+19.18 - SOUTH OF RIDGE ROAD

**OWNER & DEVELOPER:**  
**ELICOTT CORPORATION**  
 1501 N. FORT MEYER DRIVE  
 ARLINGTON, VIRGINIA

**DEPT. OF PUBLIC WORKS**  
 CHIEF: Bureau of Highways *S. P. Newland* date: 4/7/75

**OFFICE OF PLANNING & ZONING**  
 CHIEF: DIVISION OF LAND DEVELOPMENT AND TRANSPORTATION PLANNING date: 4/1/75

**IPDC** 850 SILVER SPRING AVENUE SUITE 301 SILVER SPRING MARYLAND 20910  
 TELEPHONE (301) 585-3445  
 DATE: 3-13-75  
 AS NOTED

STRUCTURE SCHEDULE					
No	TYPE	INV. IN.	INV. OUT.	TOP ELEV.	REMARKS
MH-1	SHALLOW M.H. S-3	402.74	402.94	406.35	EXIST. INLET TO BE CONVERTED TO SHALLOW M.H. TYPE S-3 - SEE DETAIL THIS SHEET
I-1	TYPE S' COMB. INLET	403.29	403.09	406.0	DWG. NO. D-98, PG. 153
I-2	TYPE S' COMB. INLET	403.48	403.48	406.0	DWG. NO. D-98, PG. 153
I-3	TYPE A-10 INLET	383.48	382.5	381.0	DWG. NO. G4-A, PG. 119-A
MH-2	STD. MANHOLE	371.97	370.11	379.0	PAGE 158, 4' DIA. - DWG. D-103
S-1	STD. END SUPPORT WALL		381.50	370.75	C-E-W / PG. 107 - DWG. D-52
I-5	A-10 INLET		381.35	390.70	DWG. NO. G4-A, PG. 119-A

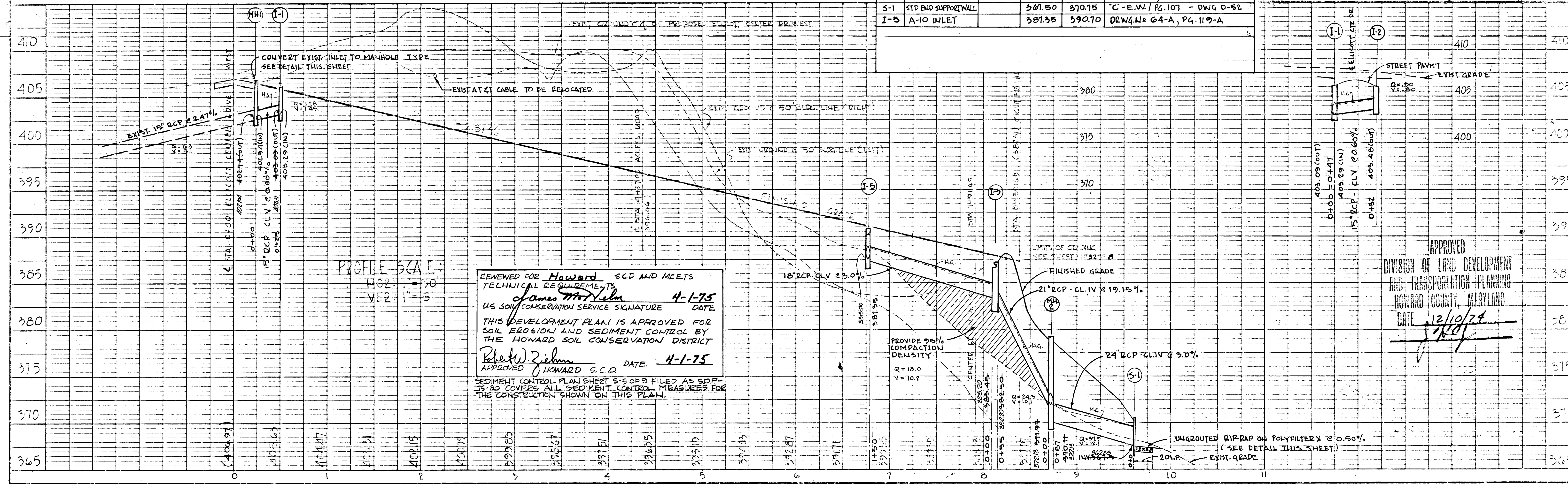
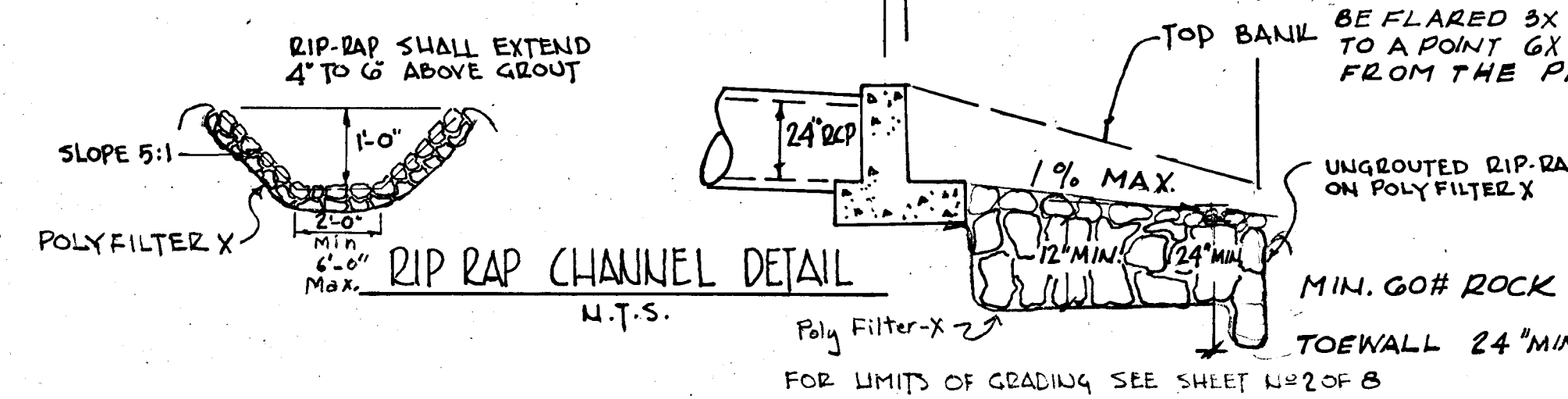

PROFILE SCALE  
 HORIZONTAL = 1" = 20'  
 VERTICAL = 1" = 5'

RENEWED FOR HOWARD S.C.D. AND MEETS TECHNICAL REQUIREMENTS  
*James M. Veln* 4-1-75  
 US SOIL CONSERVATION SERVICE SIGNATURE DATE  
 THIS DEVELOPMENT PLAN IS APPROVED FOR SOIL EROSION AND SEDIMENT CONTROL BY THE HOWARD SOIL CONSERVATION DISTRICT  
*Robert J. Ziehm* DATE 4-1-75  
 APPROVED HOWARD S.C.D.  
 SEDIMENT CONTROL PLAN SHEET S-5 OF 9 FILED AS SDP-15-30 COVERS ALL SEDIMENT CONTROL MEASURES FOR THE CONSTRUCTION SHOWN ON THIS PLAN.

APPROVED  
 DIVISION OF LAND DEVELOPMENT AND TRANSPORTATION PLANNING  
 HOWARD COUNTY, MARYLAND  
 DATE 12/10/74  
*J. K. O'Connell*



DPT. OF PUBLIC WORKS  
*B. W. Nelson*  
 CHIEF - BUREAU OF HIGHWAYS  
 DATE: 4/7/75

OFFICE OF PLANNING & ZONING  
*J. H. Lawson*  
 CHIEF - DIVISION OF LAND DEVELOPMENT & TRANSPORTATION PLANNING  
 DATE: 4/9/75

TOTAL Q INTO 36" & 18" PIPES AFTER DEVELOPMENT WILL BE 91.00 CFS. EXISTING CAPACITY OF PIPES TOTALS 95.0 CFS, LEAVING AN EXCESS CAPACITY OF 12.00 CFS.

TOTAL Q INTO 48" PIPE AFTER DEVELOPMENT WILL BE 17.83. EXISTING CAPACITY OF PIPE TOTALS 205 CFS LEAVING AN EXCESS CAPACITY OF 187.17 CFS.

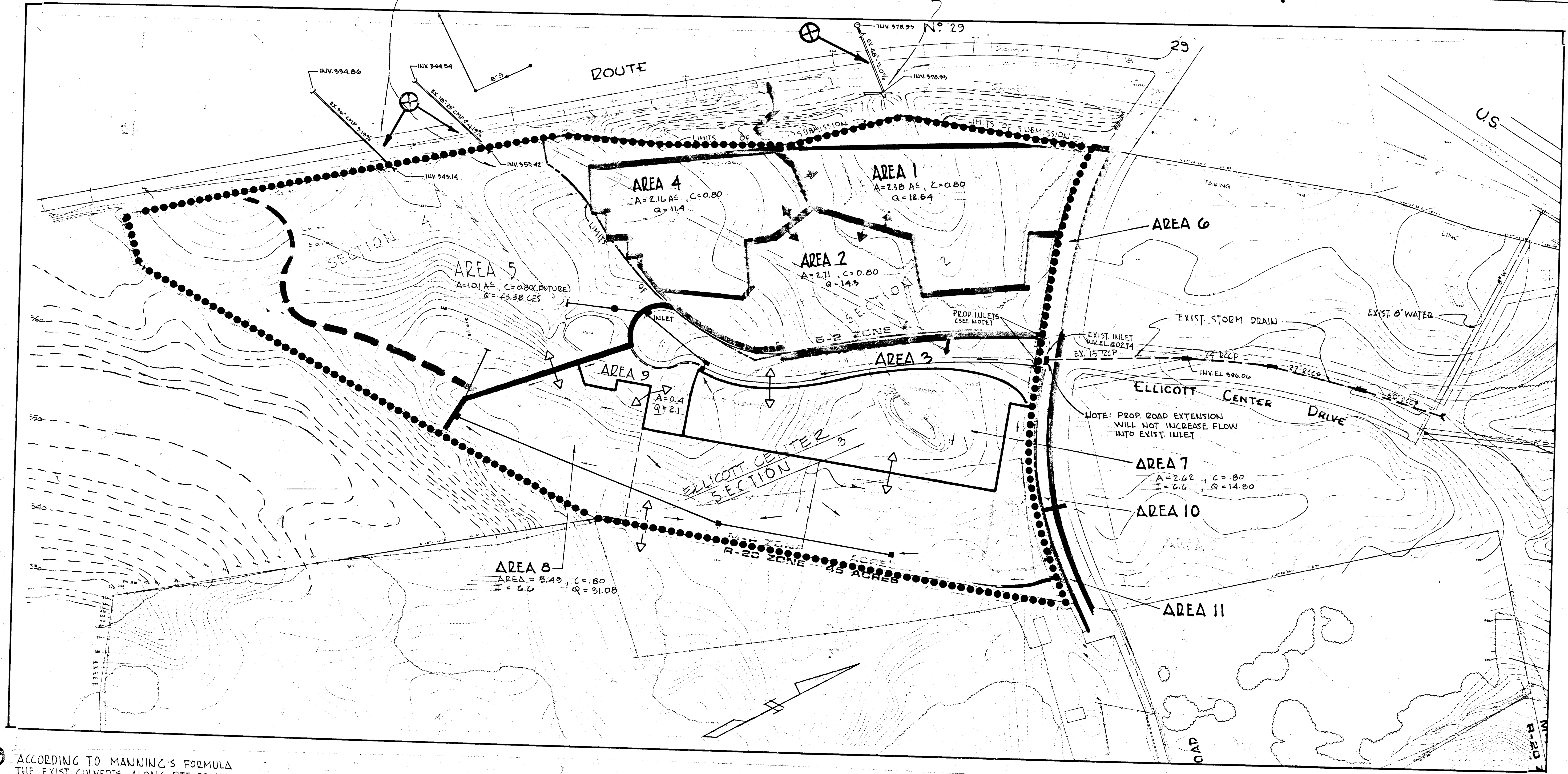

⊗ ACCORDING TO MANNING'S FORMULA THE EXIST. CULVERTS ALONG RTE. 29 WILL HANDLE THE FOLLOWING Q. (FLOWING FULL)

- 18"-23" CMP @ 4.19% - 25 CFS (N=0.019)
- 30" CMP @ 3.19% - 70 CFS (N=0.019)
- 48" RCP @ 5.0% - 205 CFS (N=0.017)

AREA#	ACRES	C	CA	I	Q=CIA
#2	2.71	0.80	2.17	0.67/HR	14.5
#3	1.50	0.80	1.20	0.67/HR	7.9
#4	2.16	0.80	1.73		11.4
OTHER	2.4	0.60	1.44		9.5
TOTAL Q					43.10

BASED ON DATA PROVIDED BY STATE OF MARYLAND STATE ROADS COMMISSION (U.S. RT 29 SHEET N# 34 OF 76) THE EXISTING 18" RCP @ 3.6% RCP CULVERTS SLOPE SUFFICIENT TO PROVIDE PROPOSED Q.

COMPUTATIONS FOR DRAINAGE AREA INTO 48" RCP

AREA#	ACRES	C	CA	I	Q=CIA
#7	2.38	0.8	1.90	0.67/HR	12.54
OTHER	1.3	0.6	1.08		7.13
TOTAL Q					19.67

BASED ON PRESENT DATA PROVIDED BY THE STATE OF MARYLAND STATE ROADS COMMISSION (U.S. RT 29 SHEET N# 34 OF 76) THE EXIST. 36" RCP CULVERT PIPE SLOPES 4.37%

NOTE: AREA FROM WHICH PARCEL IS TO BE SUBDIVIDED FROM IS SHOWN THUSLY. THIS AREA IS PART OF ELICOTT CTR. HOLDINGS - DAVID LAWSON & MARVIN F. WEISSBERG

ELICOTT CTR SECTION 3 - DRAINAGE AREA COMPUTATIONS

AREA#	ACRES	C	CA	I	Q=CIA
#7	2.02	0.80	1.62	0.67/HR	10.80
#8	5.49	0.80	4.39	0.67/HR	29.38
#9	0.40	0.80	0.32	0.67/HR	2.10
TOTAL Q (CFS)					42.28

NOTE: S.D. INLET TO BE CONSTRUCTED AT THE SE & SW CORNER OF EXIST. ELICOTT CENTER DR. @ S.D. TO FLOW INTO EXIST. STORM DRAIN SYSTEM. EXIST. S.D. INLET AT SE CORNER TO BE CONVERTED INTO M.H. TO PICK UP S.D. FROM PROPOSED INLETS. DRAINAGE AREA N# 6 & 10 WILL REMAIN UNCHANGED & WILL DRAIN INTO EXIST. STORM SYSTEM.

NOTE: THE "Q" FOR THE AREAS SHOWN ON THIS DRAINAGE AREA MAP IS BASED ON RUNOFF COMPUTATIONS FOR A FULL DEVELOPMENT, ACCORDING TO THE EXISTING ZONING. BASED ON THE SHA CRITERIA FOR GREATER CONCENTRATION OF FLOW TIME FOR AREA N# 5, STORM WATER MANAGEMENT DEVICES WILL BE CONSTRUCTED TO SATISFY DRAINAGE REQUIREMENTS.

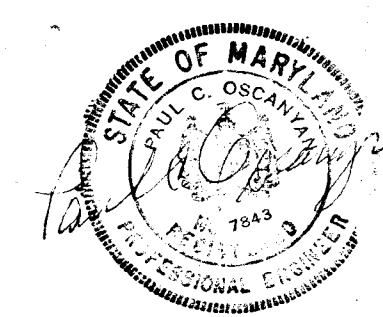
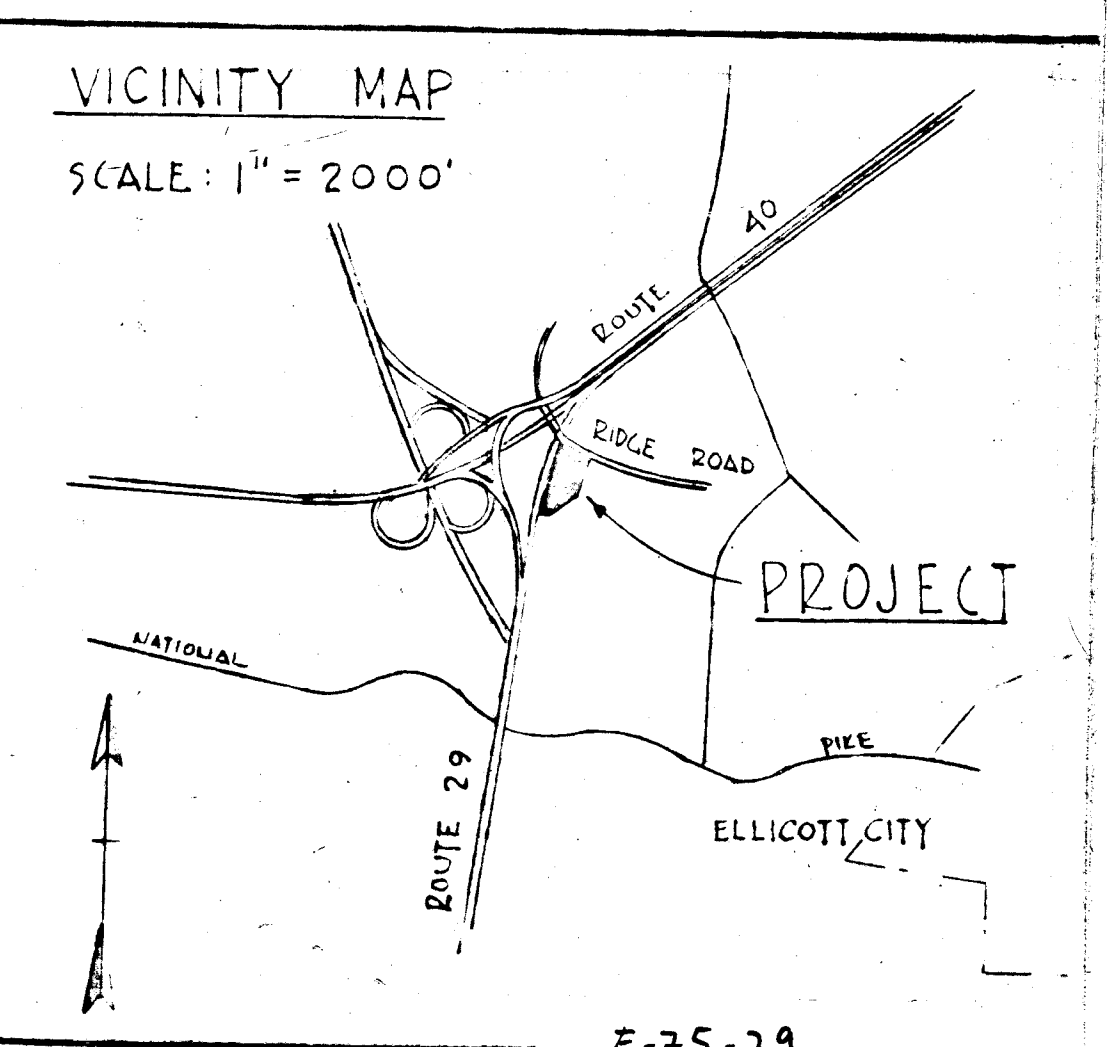

IPDS  
 DRAINAGE AREA MAP  
 ELICOTT CENTER SECTION 3  
 C. R. DANIELS PROPERTY  
 SECOND ELECTION DISTRICT, HOWARD COUNTY, MARYLAND  
 10/11/74  
 74001 C  
 3 OF 3