

APPROVED - HOWARD CO. OFFICE OF PLANNING & ZONING

J.H. Clawson 9/26/75
CHIEF, DIVISION OF LAND DEVELOPMENT & TRANSPORTATION PLANNING

DEPARTMENT OF PUBLIC WORKS

Michelle F. Jovin 10-16-75
CHIEF, BUREAU OF HIGHWAYS

STREET PLAN & PROFILE - WINDSTREAM COURT
VILLAGE OF WILDE LAKE
COLUMBIA, MD. - SEC. 6, AREA 5, LOT 3
HOWARD COUNTY, MARYLAND
SCALE: AS SHOWN

APPROVED
DIVISION OF LAND DEVELOPMENT AND TRANSPORTATION PLANNING
HOWARD COUNTY, MARYLAND
DATE 1-20-75
J.H. Clawson

SHEET OF 4
F-74-100C
AS-BUILT SEPT. 10, 1979

DATE	
BY	
NO.	
REVISION	
DATE	
BY	
NO.	
REVISION	
DATE	
BY	
NO.	
REVISION	
DATE	
BY	
NO.	

DATE	
BY	
NO.	
REVISION	
DATE	
BY	
NO.	
REVISION	
DATE	
BY	
NO.	

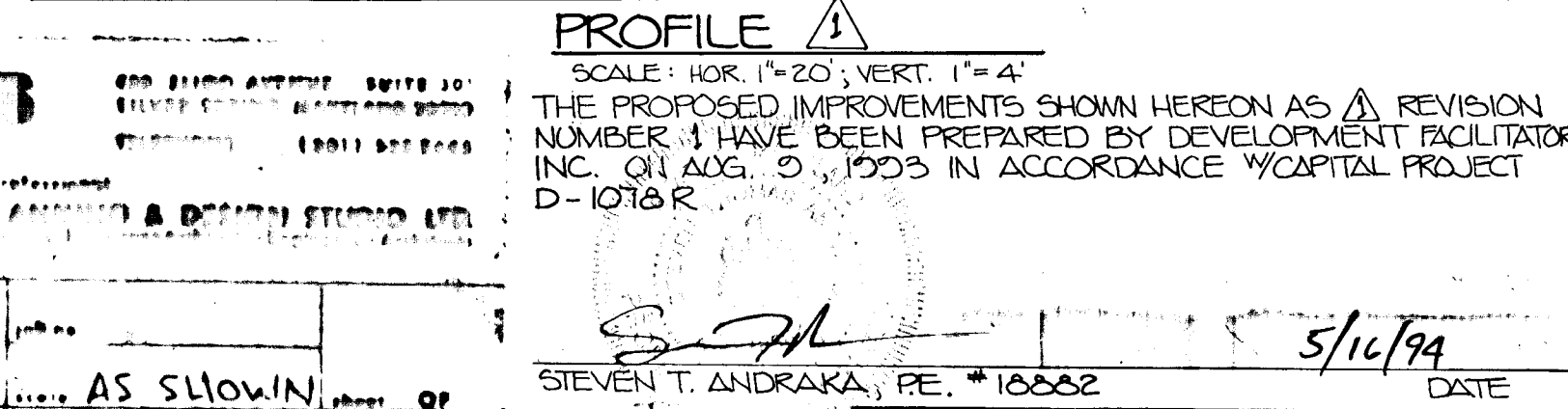
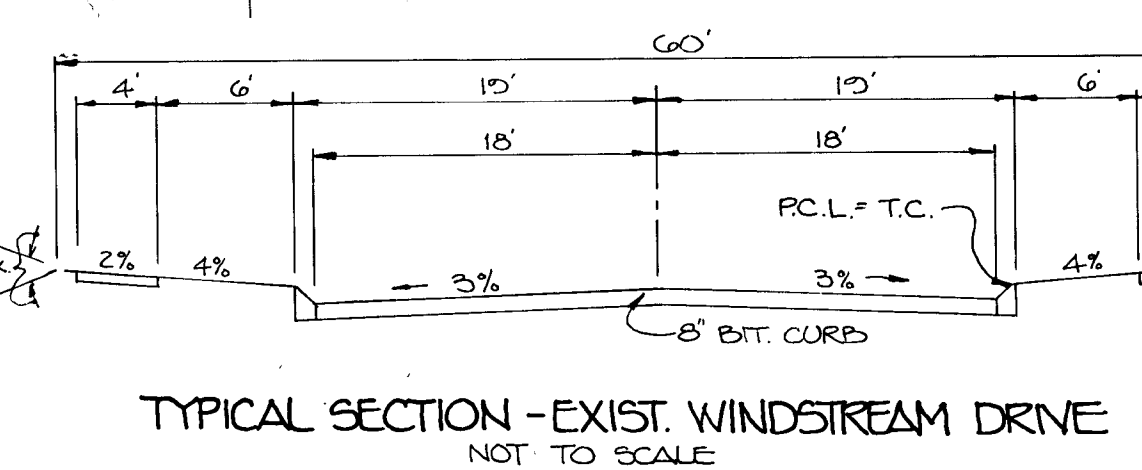
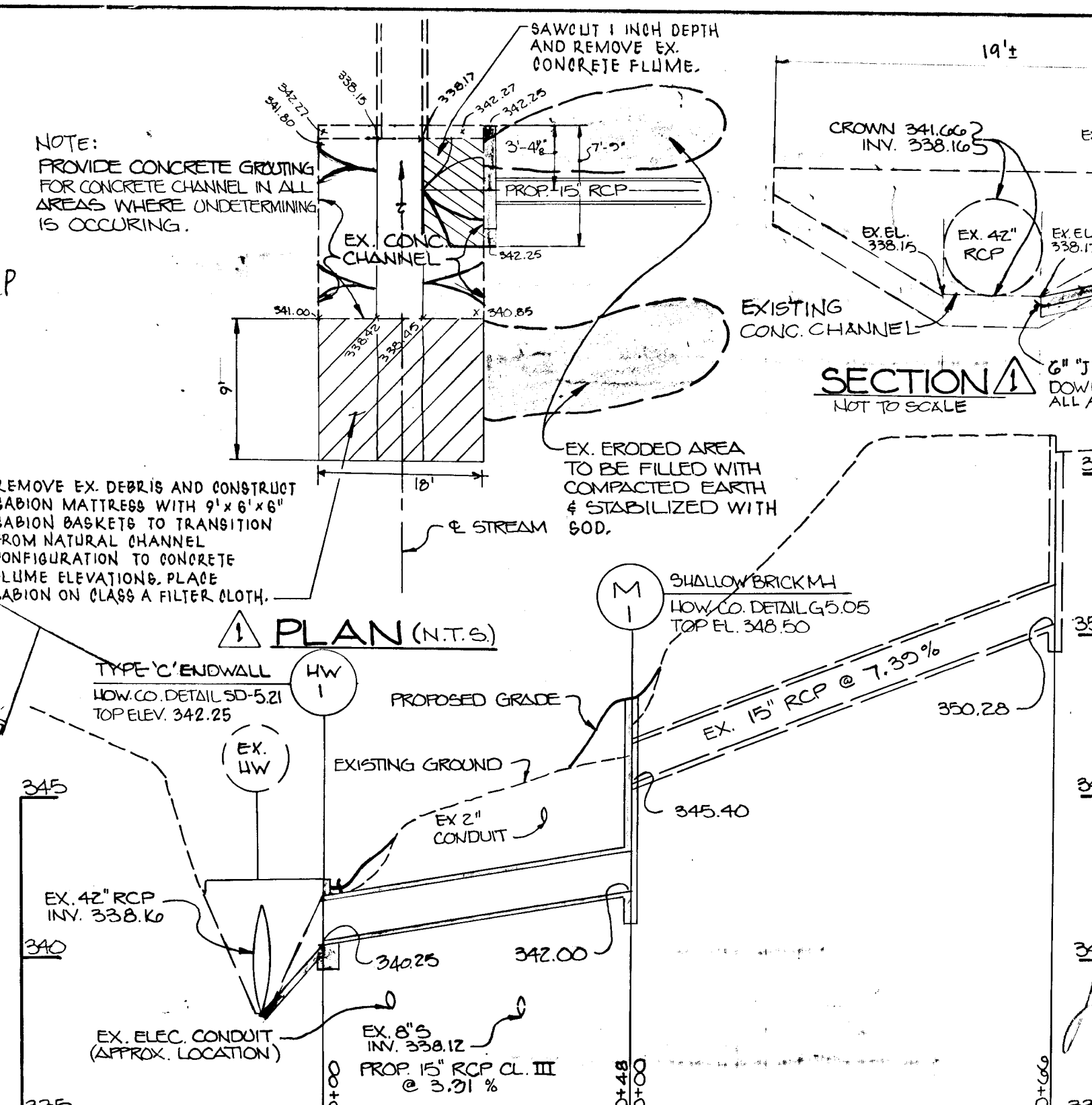
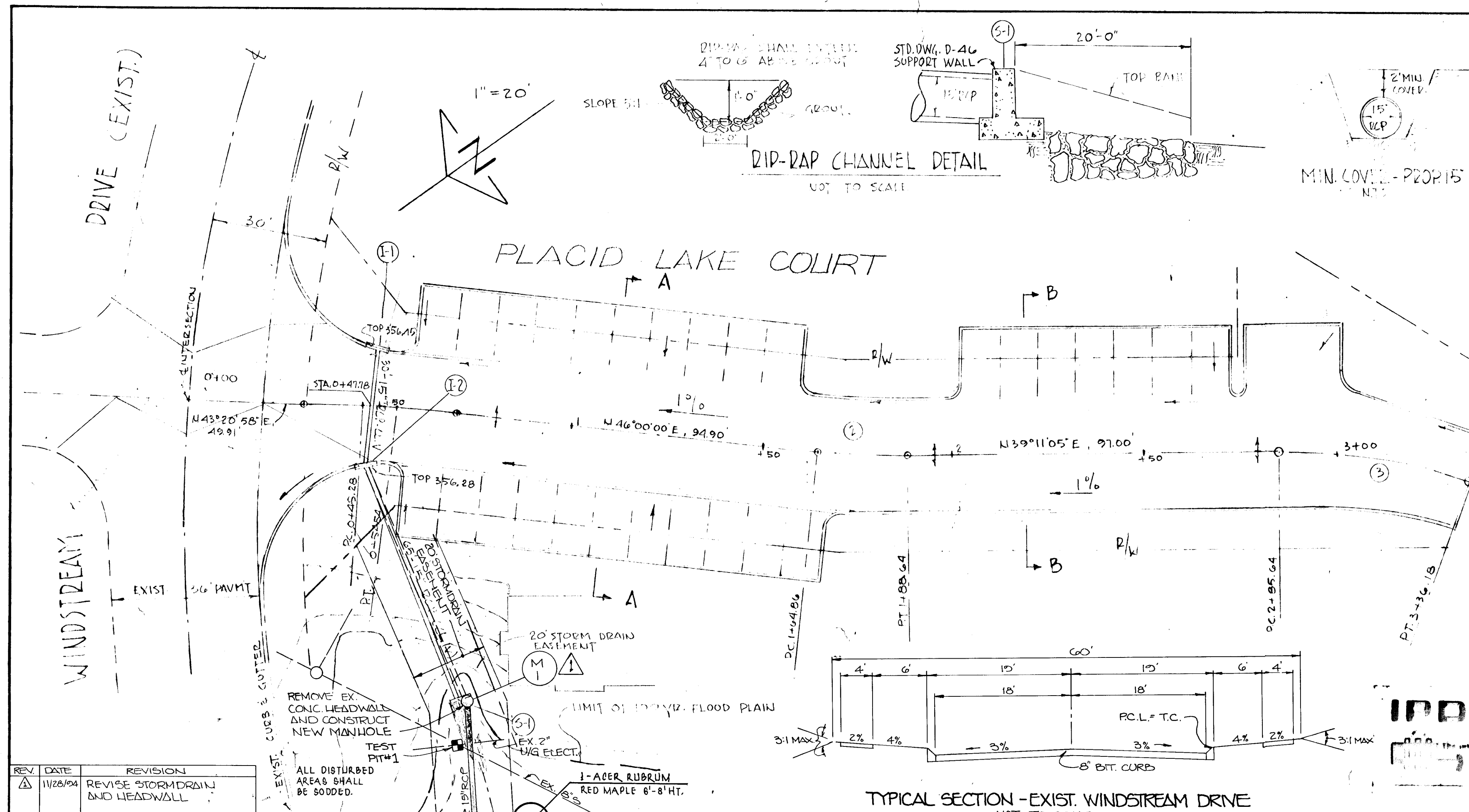

STRUCTURE SCHEDULE					
No	TYPE	INV. IN	INV. OUT	TOP ELEV.	REMARKS
1-1	CLASS B STORMING	337.50	337.50	356.40	HOWARD CO. DETAIL 110 64A
1-2	CLASS B STORMING	337.50	337.50	356.40	HOWARD CO. DETAIL 110 64A
S-1	SHALLOW BRICK WALL	345.40	342.00	348.50	20' DIA. (SEE DETAIL 104 W/CL. 110-40)
M-1	SHALLOW BRICK WALL	345.40	342.00	348.50	HOWARD CO. DETAIL 110 64A
HW-1	TYPE 'C' ENDWALL	340.25		342.25	HOWARD CO. DETAIL 5D 5 21

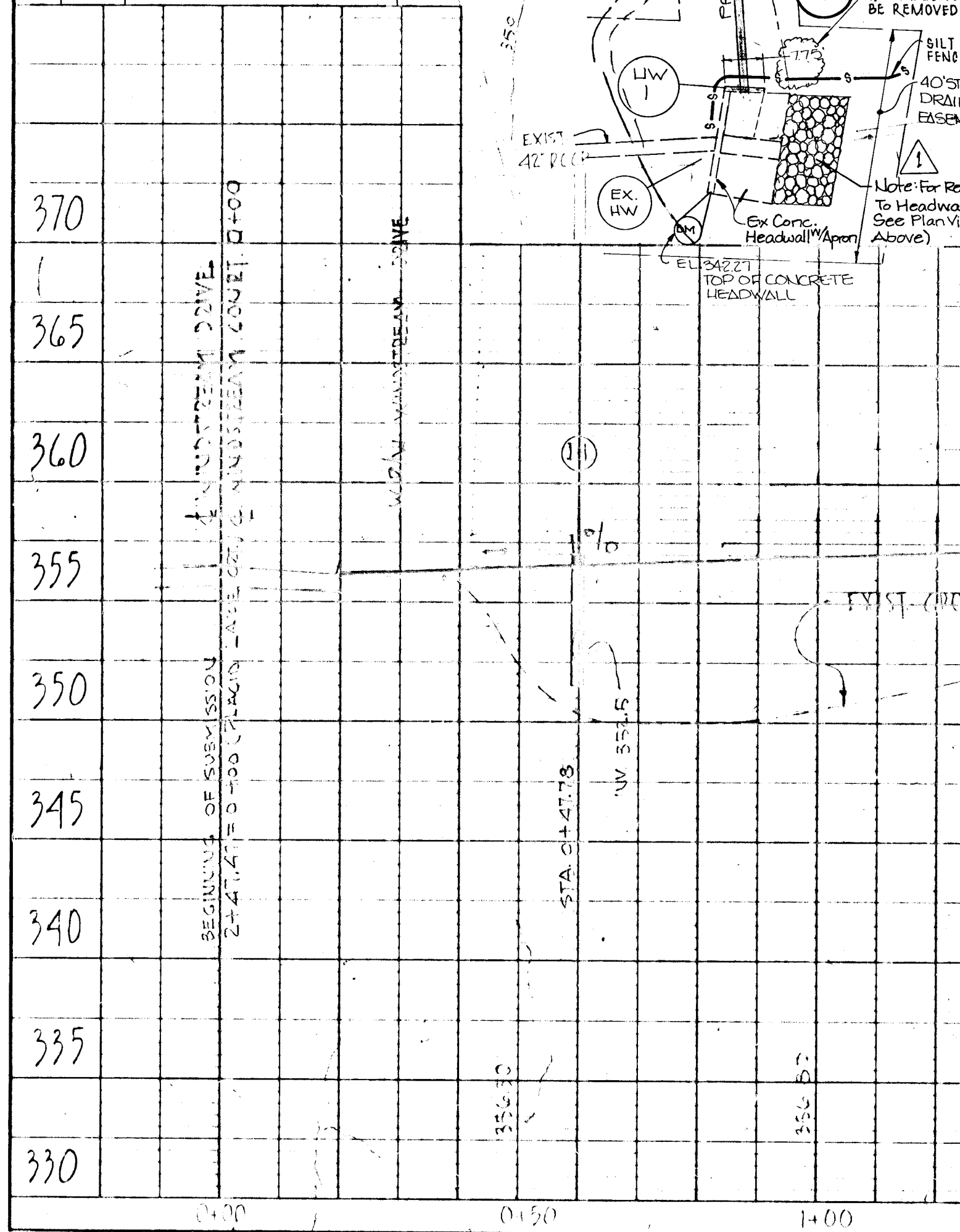

STATE OF MARYLAND
PAUL C. ANDRASKA
REGISTERED PROFESSIONAL ENGINEER

APPROVED - HOWARD CO. OFFICE OF PLANNING & ZONING
DATE: 1/26/75
J.H. Lawrence

DEPARTMENT OF PUBLIC WORKS
MIDDLE TOWN
DATE: 10-10-75

STORM DRAIN
PLAN & PROFILE - WINDSTREAM COURT
VILLAGE OF WILDE LAKE
COLUMBIA, MD. - SEC. 6, AREA 5, LOT 3
HOWARD COUNTY, MARYLAND
SCALE: AS SHOWN

CONSULTING ENGINEERS, SURVEYORS AND LAND PLANNERS
dfi
200 BALTIMORE / ANNAPOLIS BLVD.
P.O. BOX 984
SEVERNA PARK, MD 21148
PHONE (301) 347-2727

APPROVED
DIVISION OF LAND DEVELOPMENT
AND TRANSPORTATION PLANNING
DATE: 1/20/75
J. Wick

NOTE: FOR PLAN VIEW SEE THIS SHEET

FINISH GRADE
EXIST. GRAD
2" MIN. COVER
CONC. & PIPE

EXIST. STORM
20' OF GROUDED DIP-DAP, SEE DETAIL THIS SHEET

20' OF GROUDED DIP-DAP, SEE DETAIL THIS SHEET

EXCAVATED STONE TRAP DETAIL

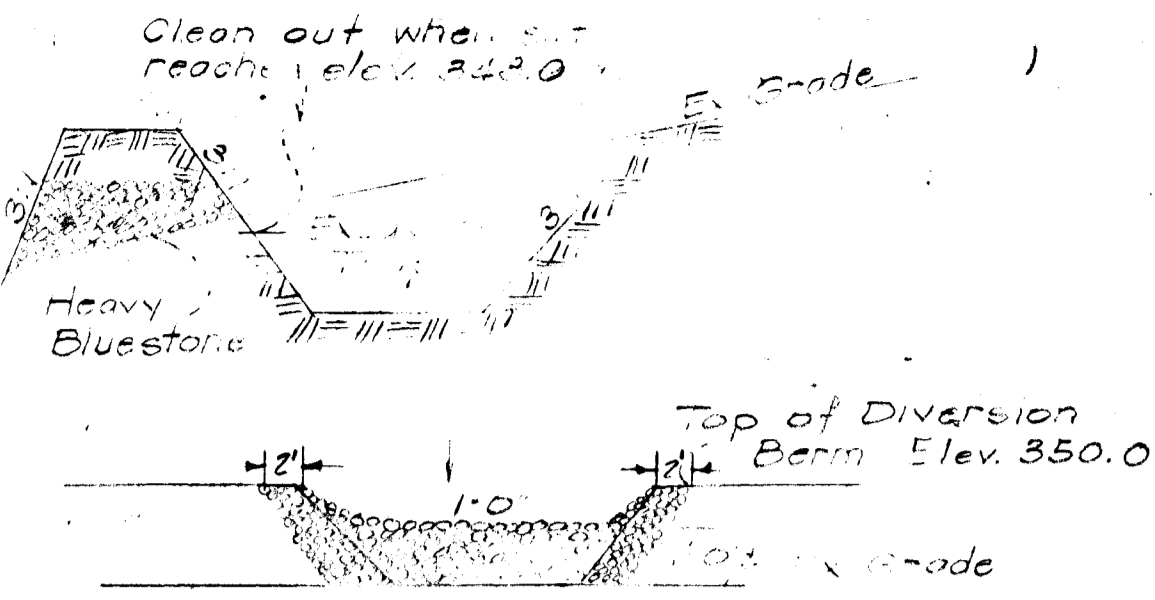

NOTES

1. Drawings shall be submitted to the Howard Co. S.C.D.
2. Stone to be placed in an area of 10' x 10' with a silt filter. Stone to be heavy blue stone of S.H.A. (see spec. for details) equal (4.6' x 4.6' x 2').
3. Silt must be removed from excavated area when silt level reaches elev. 348.0.
4. Excavated area to be designed with a capacity for 6" of silt per acre of drainage area.
5. Periodic inspection & maintenance must be provided for this structure.

NOTE A - STABILIZATION

TEMPORARY (See note G for applicable areas)
According to SCS Standards & Specifications for Soil Erosion & Sediment Control in Urbanizing Areas, Sec. 3000

1. Site preparation - So as to allow use of conventional seedbed preparation equipment.
2. Apply:
 - a. Dolomitic Limestone - 2000 lbs/ac
 - b. 10-10-10 fertilizer - 500-800 lbs/ac
3. Harrow to a depth of 2"
4. Seed with rye at rate of 24 bu/acre, etc. except in undrained areas use 35 lbs rye/ac.
5. Mow with straw or hay or 24 tons/acre. Incorporate after seeding & tack with a light

PERMANENT

- According to the above mentioned SCS Standards & Specifications for Soil Erosion & Sediment Control in Urbanizing Areas, Sec. 3000
1. certified Marion Kentucky Bluegrass @ 40#/AC.
 2. common Kentucky Bluegrass @ 40#/AC.
 3. Perennial Red Fescue @ 20#/AC.

HAY BALE DETAIL

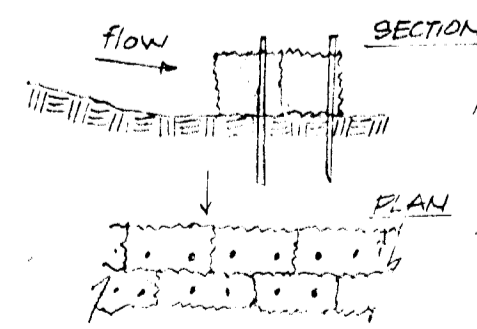

- NOTES: 1. All bales shall be tightly packed together.
2. Stakes shall be 2" x 2" x 4" and driven 18" into the ground through the bale.

REVIEWED FOR HOWARD CO. S.C.D. AND MEETS TECHNICAL REQUIREMENTS
Eric U. Harman 9/18/75
SIGNATURE DATE
U.S. SOIL CONSERVATION SERVICE

THIS DEVELOPMENT PLAN IS APPROVED FOR SOIL EROSION AND SEDIMENT CONTROL BY THE HOWARD SOIL CONSERVATION DISTRICT

APPROVED *Robert Zich* DATE 9-18-75
HOWARD CO. S.C.D.

GOVERNOR

WARFIELD

PARKWAY

SCHEDULE OF CONSTRUCTION

1. Installation and stabilization of all sediment control structures on site.
2. Grading of streets.
3. On site grading & excavation for buildings.
4. Start construction of buildings.
5. Installation of utilities.
6. Installation of curbs, gutters & sidewalks.
7. Installation of base course paving.
8. The exterior construction work is completed on building, yard area shall be fully graded & planted with slumbering sods over & bare to be seeded.
9. Complete building construction.
10. Apply fertilizer course to streets.
11. Remove sediment control structures & complete landscaping.

DEPARTMENT OF PUBLIC WORKS
M. L. F. ...
CHIEF, BUREAU OF HIGHWAYS
10-16-75
DATE

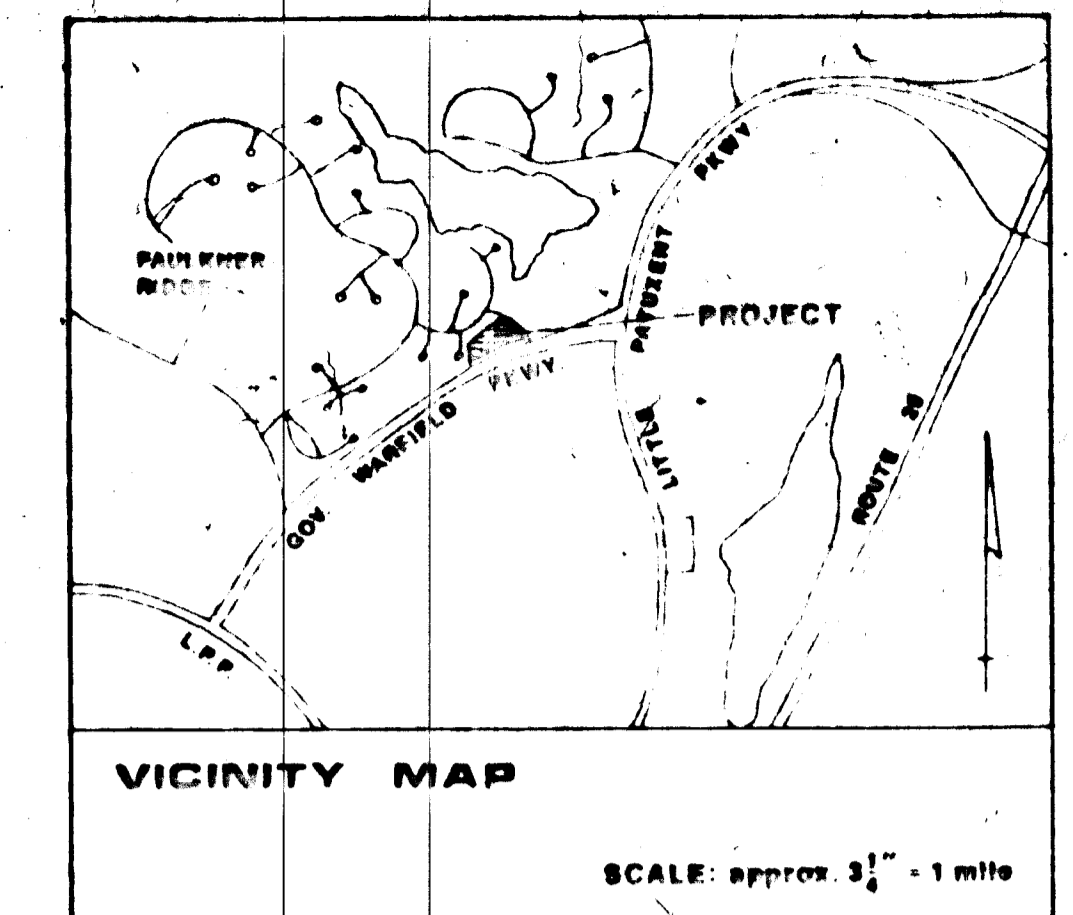

APPROVED - HOWARD CO. OFFICE OF PLANNING & ZONING
H. Clowork 9/16/75
CHIEF, DIVISION OF LAND DEVELOPMENT & TRANSPORTATION PLANNING

ACCESS DIKE - MOUNTABLE #2 STONE 18" HIGH 6:1 SLOPE

APPROVED
DIVISION OF LAND DEVELOPMENT AND TRANSPORTATION PLANNING
HOWARD COUNTY, MARYLAND
DATE 1/20/75

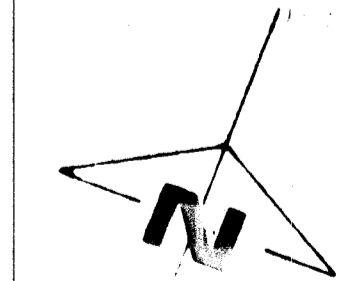

scale 1" = 20'



Paul ...
8 Feb. 1975

VILLAGE OF WILDE LAKE COLUMBIA MD.
AREA 5 SECTION 8 LOT 3
5TH ELECTION DISTRICT HOWARD COUNTY, MD.
SEDIMENT CONTROL PLAN

RETAINING WALL - GRAVITY TYPE

HEIGHT (FT.)	WEIGHT OF SOIL TYPE (P.C.F.)	EQUIVALENT UNIT FLUID WT. BEHIND WALL (P.C.F.)	EARTH PRESSURE PER. FT. LENGTH WALL	TOE PRESSURE (P.S.F.)	TOTAL LENGTH OF WALL (FT.)	COUL. TYPE B (C.Y.)
10	27	36	245	2300	45	8.74

DESIGN COMP. BASED ON FOLLOWING DATA:
 MAX. WEIGHT OF EARTH @ 100 P.C.F.
 MAX. ANGLE OF REPOSE @ 20° W/O SUBCHARGE.

SECTION A-A
 SCALE - 1" = 0' = 1/4"

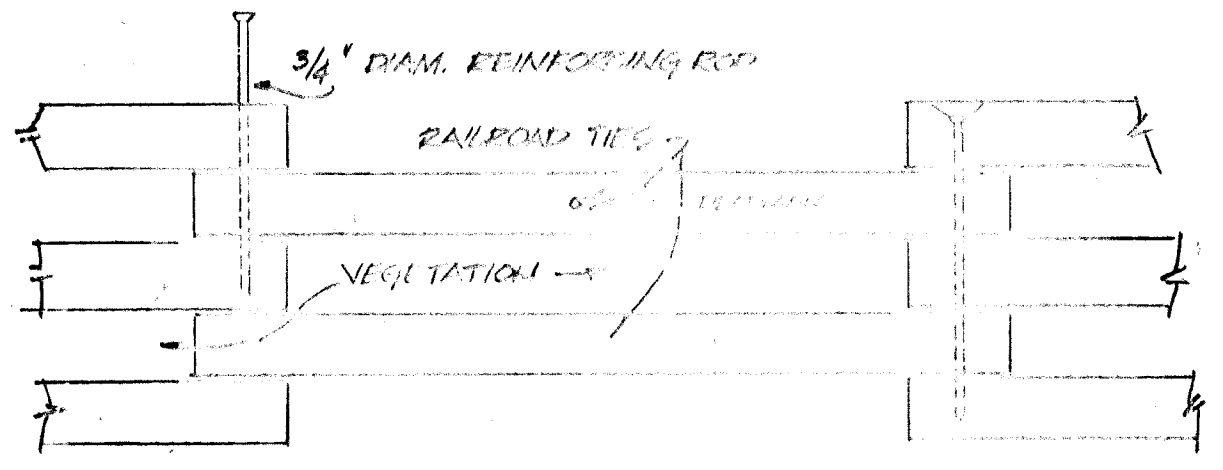
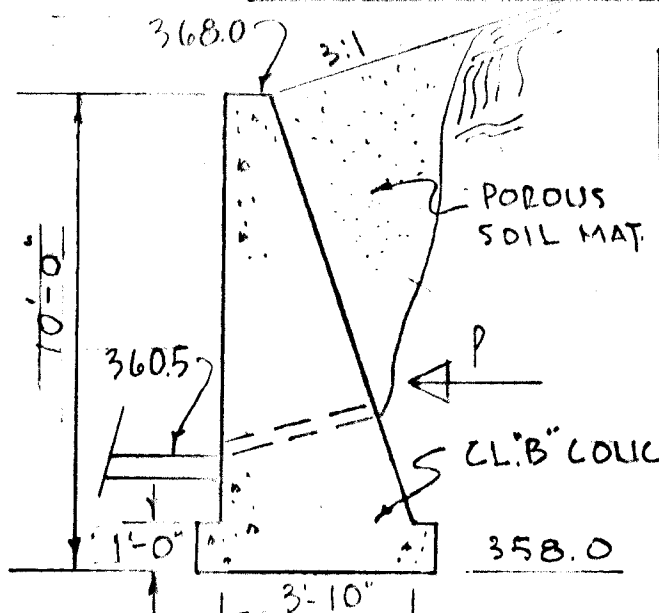

NOTE: DEADMEN CONSISTING OF A 2' LENGTH OF R.R. TIE FASTENED TO A REINFORCING BAR SHALL BE INSTALLED ON THE 2ND LEVEL TIE FROM TOP OF SLOTT. 706 EACH ANCHOR SHALL BE MIN. 3' LONG AND 2' BELOW GROUND.

MATERIALS
 REINFORCING - #4 X 20' STANDARD
 STEEL REINFORCING ROD - 3/4" DIA.
 PLANT MATERIAL - HEDERA HELIX 8" O.C.

POUROUS BASE
 R.R. TIE VERTICAL SUPPORT 3' MIN INTO EARTH 7' O.C.

CRIBBING DETAIL
 NO SCALE

SITE DATA

EXISTING ZONING: SFA ZONE
 AREA OF TRACT: 1854 AC.
 UNITS @ 10 DU/AC: 185.4
 PARKING PROVIDED: 2850
 OPEN SPACE PROPOSED (68%) 1260.7

NOTE: LOTS ARE DEFINED LINES ALONG OUTSIDE WALLS AND CENTERLINES OF INTERIOR WALLS

TRAFFIC CONTROL DEVICES, SIGNS & MARKINGS

INSTALLATION SHALL BE ACCORDING TO "MANUAL OF UNIFORM TRAFFIC DEVICES" 1971 ED.

ADJACENT OWNER: HOWARD RESEARCH & DEVELOPMENT CORP. VILLAGE OF CROSS KEYS BALTIMORE, MD.

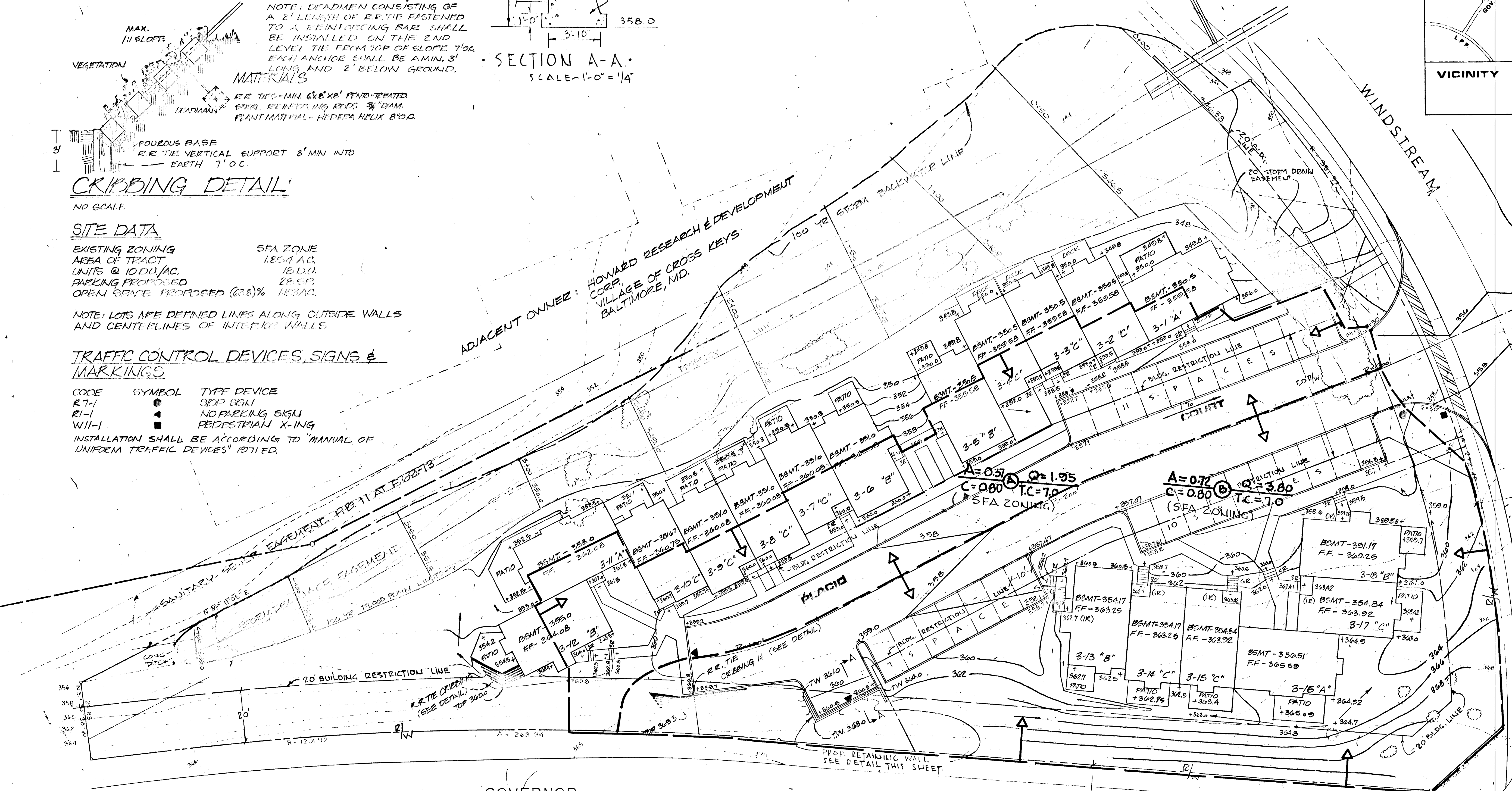
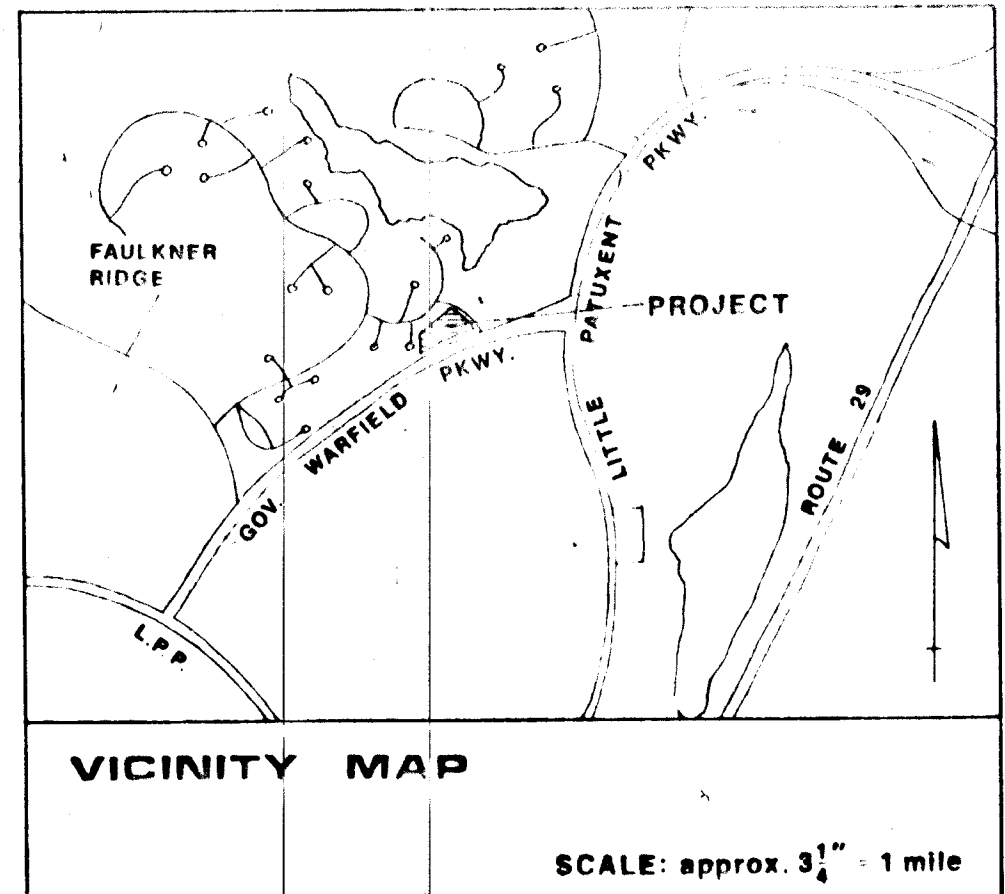

APPROVED
 DIVISION OF LAND DEVELOPMENT AND TRANSPORTATION PLANNING
 HOWARD COUNTY, MARYLAND
 DATE: 1-20-75



scale 1" = 20'



APPROVED HOWARD CO. OFFICE OF PLANNING & ZONING
 J. H. Clauson
 CHIEF, DIVISION OF LAND DEVELOPMENT & TRANSPORTATION PLANNING
 DATE: 9/26/75

APPROVED HOWARD COUNTY DEPARTMENT OF PUBLIC WORKS
 M. J. F. ...
 CHIEF, BUREAU OF HIGHWAYS
 DATE: 10-16-75

VILLAGE OF WILDE LAKE COLUMBIA MD.
 SECTION 5 AREA 5 LOT 3
 5TH ELECTION DISTRICT HOWARD COUNTY, MD.
 DRAINAGE AREA MAP