

LOCATION MAP
Scale 1" = 1000'

Bench Mark #203 Reset Elev. 253.31
State Roads Commission Brass Marker
Set In Concrete On East Side Of Md.
Route 175, 25' From Edge Of Existing
Concrete Paving, & 30' From The South
Curb Of The North Entrance To
Patuxent Institute.

Note: Warp Prop. Conc. Curb & Gutter @ 4+40
To Meet Rail. East Gutter @ Flowline = 225.30
West Gutter @ Flowline = 224.64
Delete Curb Each Side Sta. 4+35
To Sta. 4+45.

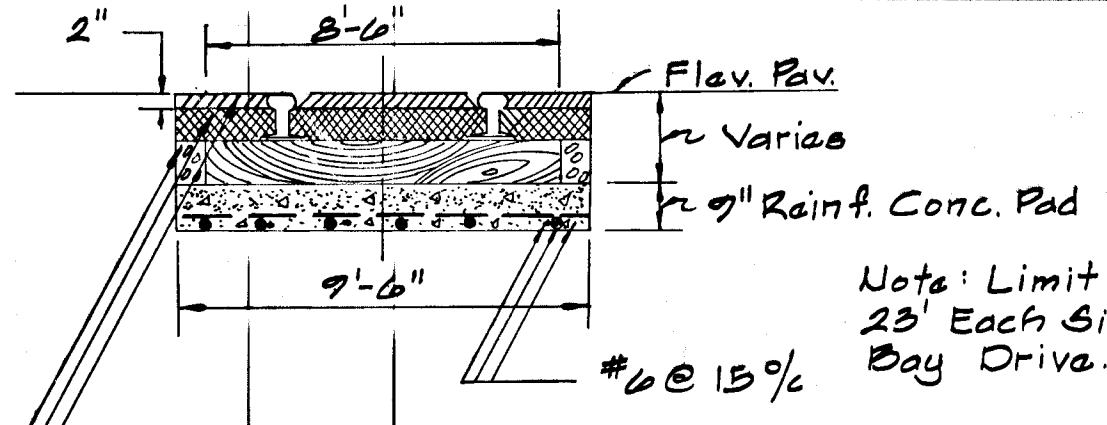

TYPICAL CROSSING
No Scale

Note: Limit Of Section
25' Each Side & Tar
Bay Drive.

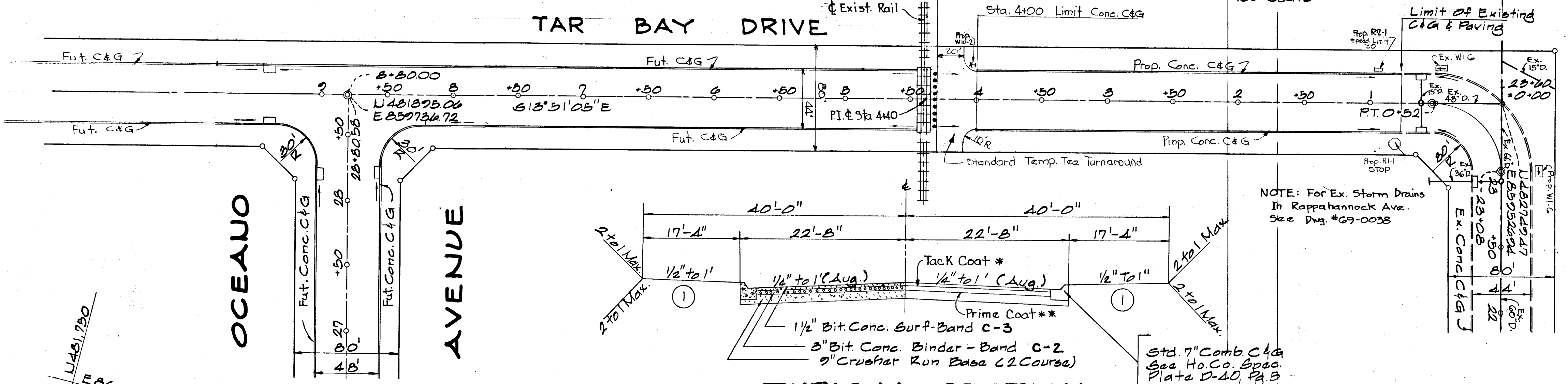

TYPICAL SECTION
24' Pav. On 80' R/W
No Scale

Note: 4" Topsoil, Seed And Mulch Shown Thusly: ①

* Tack Coat As Per Howard Co. Specs., Section C-31-4
** Prime Coat As Per Howard Co. Specs., Section C-30-3

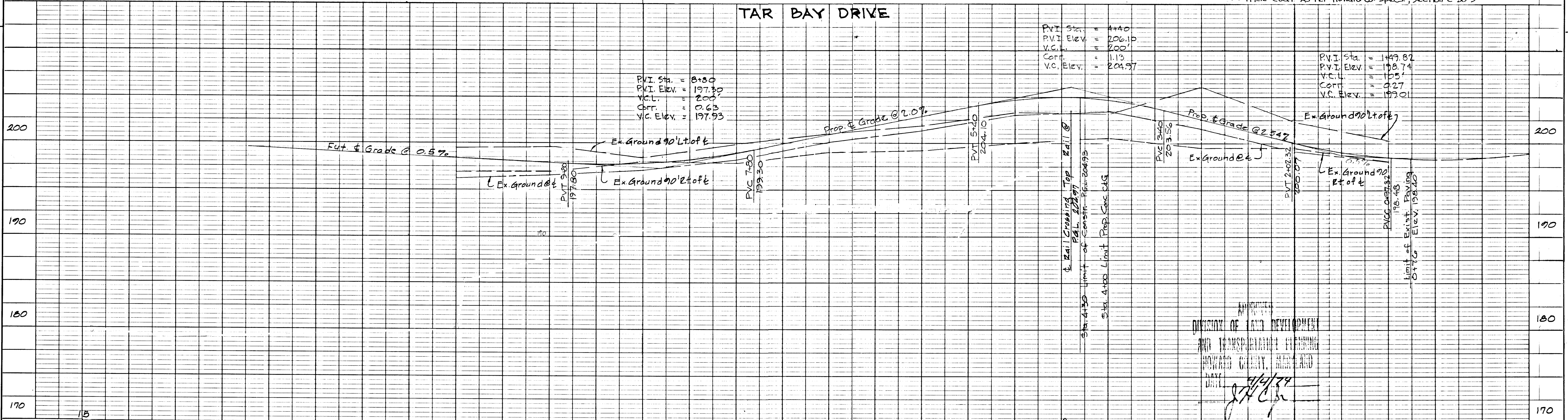

14	15	16	17	18	19	20	21	22	23	24	25	26	27	28	29	30	31	32	33	34	35	36	37	38	39	40	41	42	43	44	45	46	47	48	49	50	51	52	53	54	55	56	57	58	59	60	61	62	63	64	65	66	67	68	69	70	71	72	73	74	75	76	77	78	79	80	81	82	83	84	85	86	87	88	89	90	91	92	93	94	95	96	97	98	99	100
----	----	----	----	----	----	----	----	----	----	----	----	----	----	----	----	----	----	----	----	----	----	----	----	----	----	----	----	----	----	----	----	----	----	----	----	----	----	----	----	----	----	----	----	----	----	----	----	----	----	----	----	----	----	----	----	----	----	----	----	----	----	----	----	----	----	----	----	----	----	----	----	----	----	----	----	----	----	----	----	----	----	----	----	----	----	-----

Department of General Services

Department of Public Works

HOWARD COUNTY DEPARTMENT OF PUBLIC WORKS BUREAU OF ENGINEERING

TAR BAY DRIVE

EL DISTRICT NO. 51X

BALTIMORE COUNTY TYPE NUMBER

DATE REVISION BY

SCALE: PLAN: 1" = 50' PROFILE: HOR. 1" = 50' VERT. 1" = 5'

DESIGNED: H.F.S. G.W. Stephens Jr. & Assoc. Inc. Office of Planning & Zoning
DRAWN: G.R.G. ENGINEER: G.W. Stephens Jr. & Assoc. Inc. Chief, Division of Land Development
CHECKED: H.F.S. DATE: 5/21/74 LIC. NO. 3048

Contract No.