

PAVING DETAIL "A"
SCALE: 1 1/2" = 1"

NOTE: EXISTING INLETS ARE HOWARD COUNTY DOUBLE S GATE TYPE

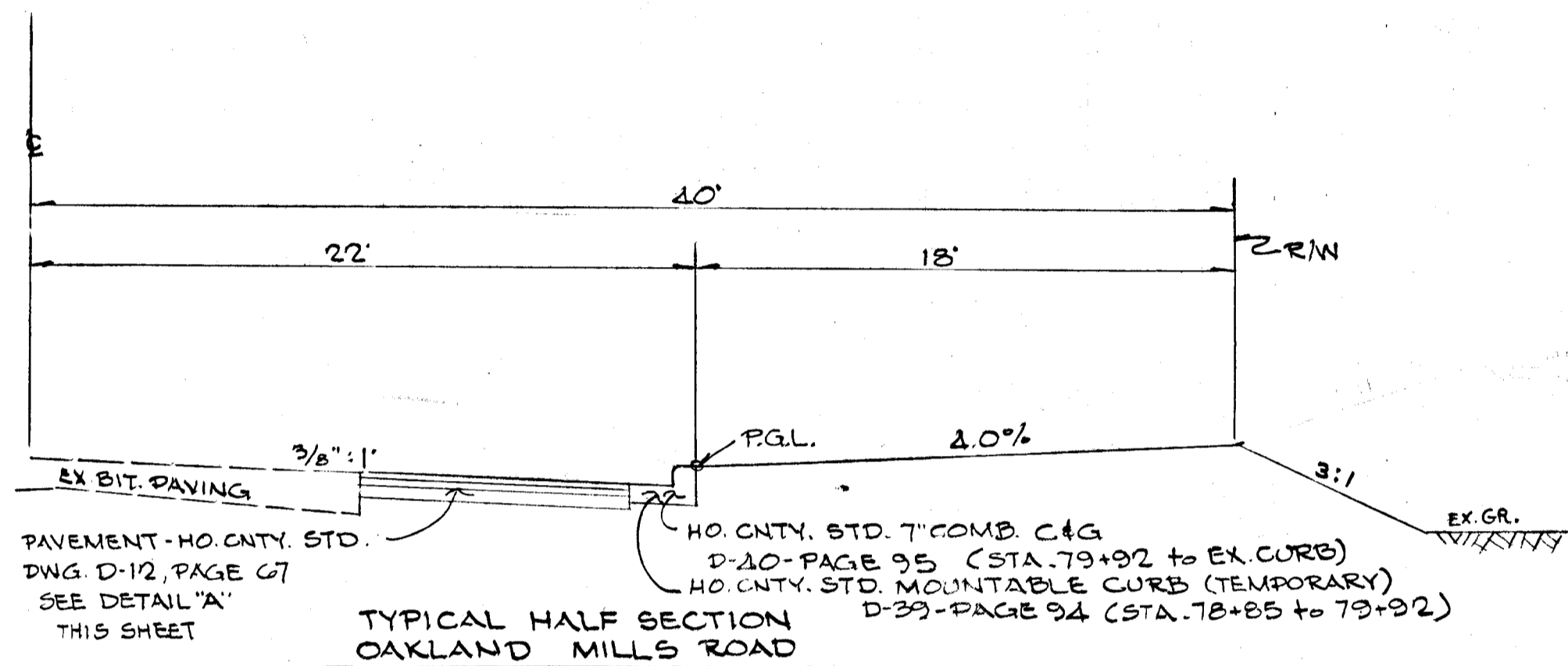

TYPICAL HALF SECTION OAKLAND MILLS ROAD
SCALE: 1" = 5'

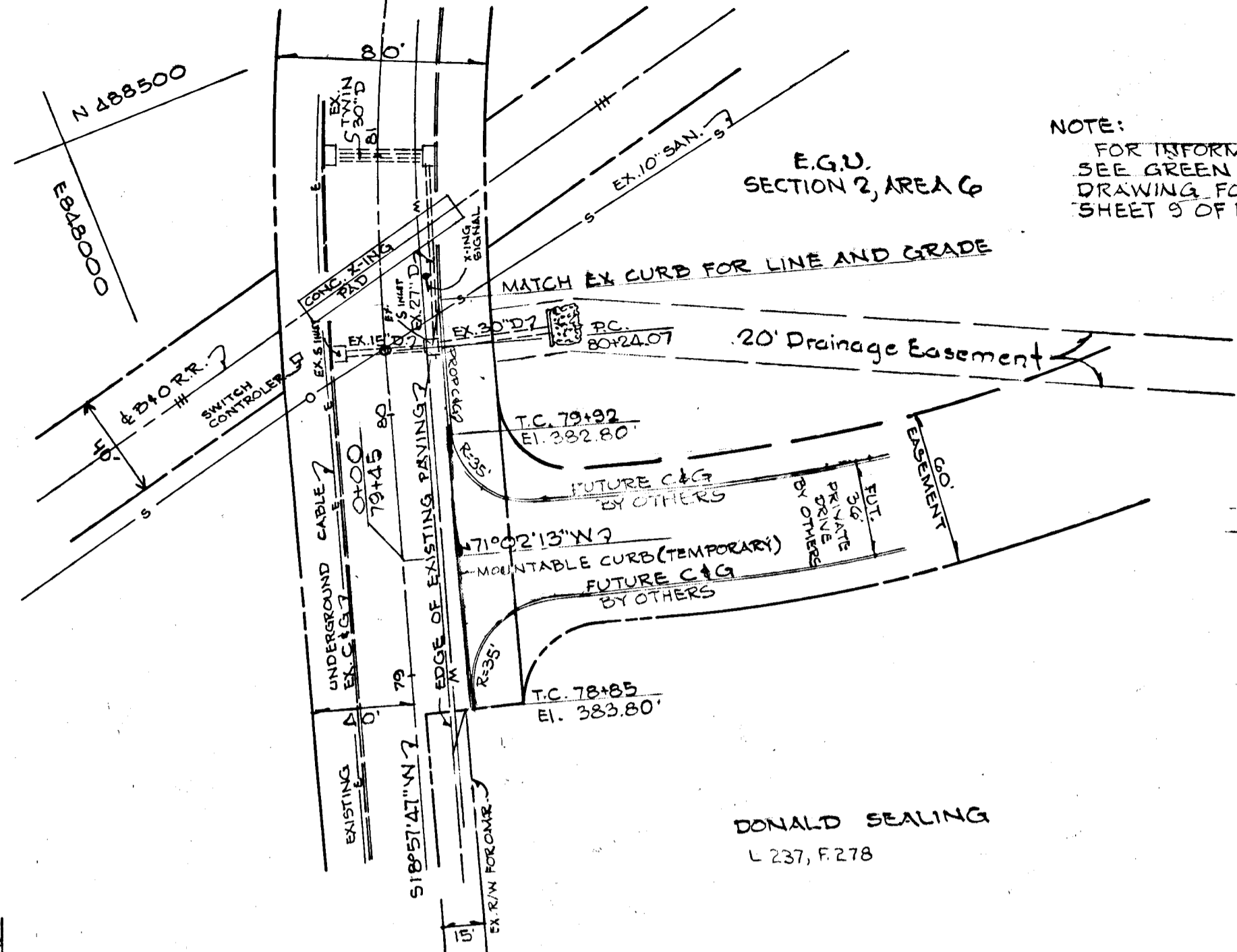

DONALD SEALING
L 237, F 278

PLAN
1" = 50'

NOTE:
FOR INFORMATION ON OAKLAND MILLS ROAD
SEE GREEN ASSOCIATES CONSTRUCTION
DRAWING FOR E.G.U. SECTION 2, AREA 3
SHEET 9 OF 11

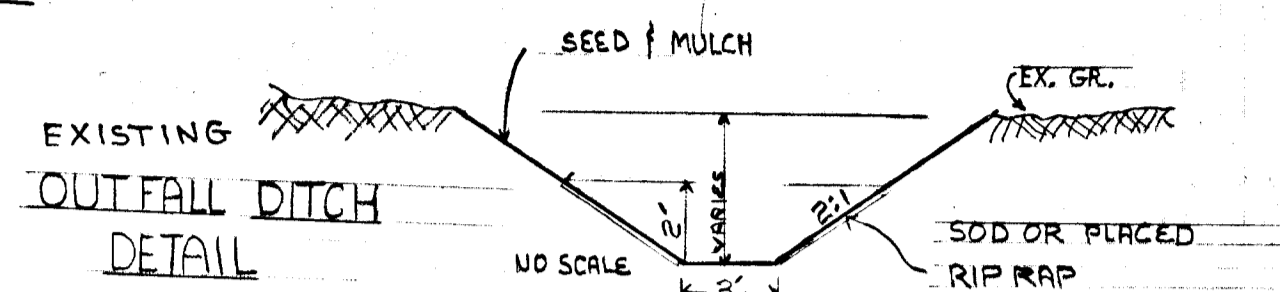

PROFILE
SCALE: 1" = 5' VERT.
1" = 50' HOR.

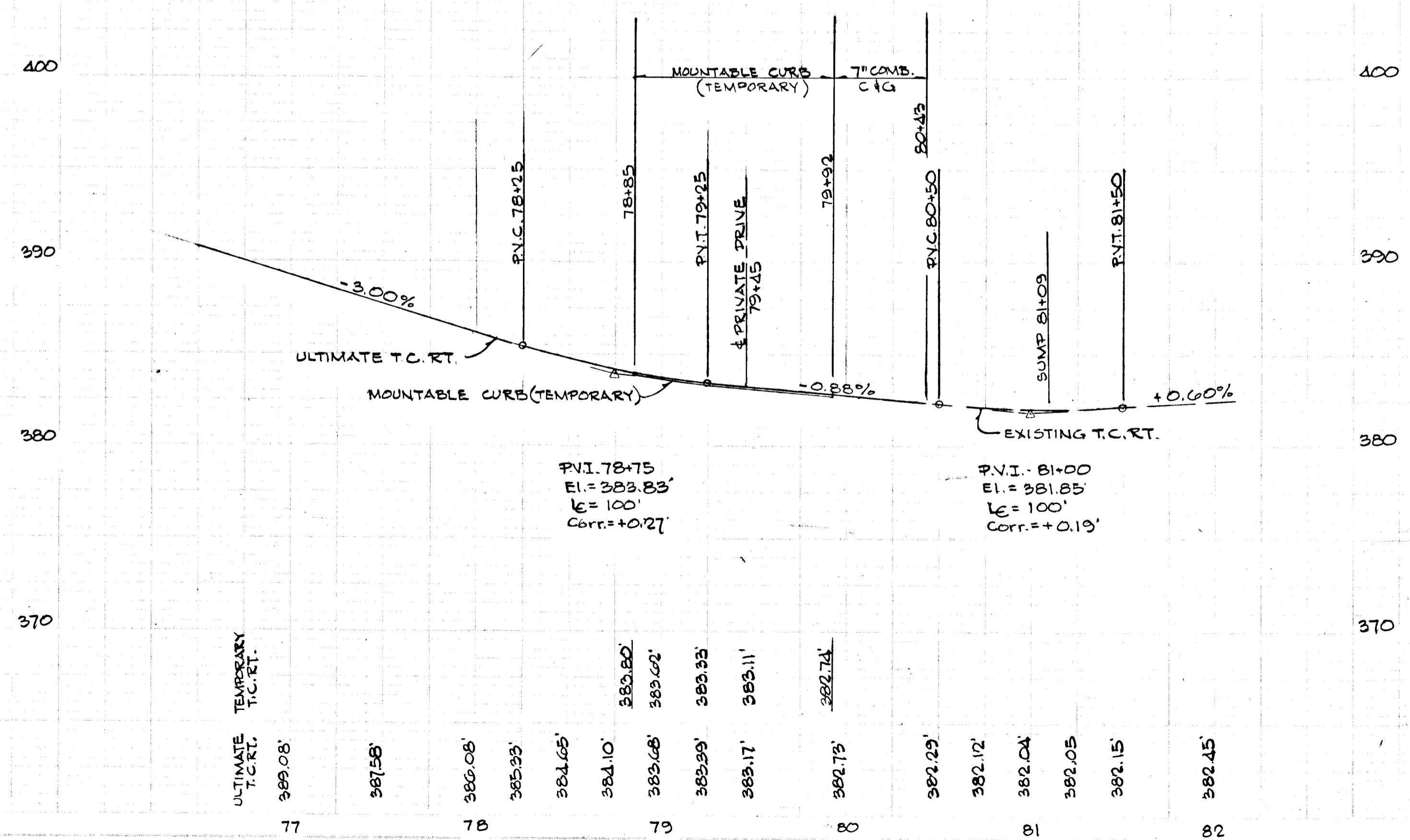

DEPARTMENT OF PUBLIC WORKS
W O Felbat
 CHIEF BUREAU OF HIGHWAYS
 DATE 5-31-73

OFFICE OF PLANNING AND ZONING
J. H. Clawson, Jr.
 CHIEF, DIVISION OF LAND DEVELOPMENT AND TRANSPORTATION PLANNING
 DATE 5/31/73

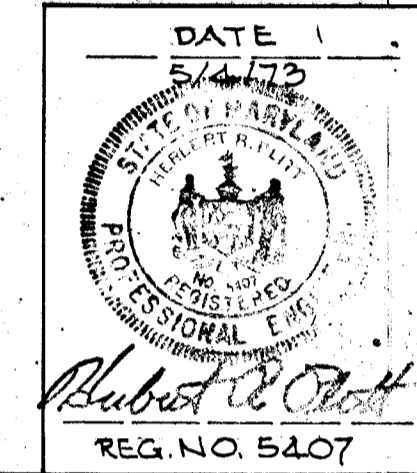

GREEN ASSOCIATES, INC.
 CONSULTING ENGINEERS
 TOWSON, MARYLAND

DATE 5/4/73
 REG. NO. 5407

Rev Date Rev No Revision Description

COLUMBIA
 MARYLAND
 ELECTION DISTRICT HOWARD COUNTY
 HOWARD RESEARCH AND DEVELOPMENT CORP.
 COLUMBIA, MARYLAND

PROJECT AREA
 E.G.U.
 SECTION 2, AREA 6

IMPROVEMENTS TO
 OAKLAND MILLS ROAD

Des. By: AWK Scale: 1" = 50' Draw No: 1 OF 1
 Dis. By: AWK Date: 5-2-73 C.C.F. No:
 Chk. By: J.T.J. Approved:

APPROVED
 DIVISION OF LAND DEVELOPMENT
 AND TRANSPORTATION PLANNING
 HOWARD COUNTY, MARYLAND
 DATE 5/30/73
J. H. Clawson, Jr.