

Curve Data
 $\Delta = 17^{\circ}19'23''$
 $TR = 1446.82'$
 $T = 437.44'$
 $LC = 220.40'$
 $Chd. = S45^{\circ}46'25''W 455.77'$

FUTURE SECTION TWO
 BALTO. WASH. INDUST. PARK

BALTIMORE WASHINGTON INDUSTRIAL PARK
 PARCEL C, BLOCK B
 83/48

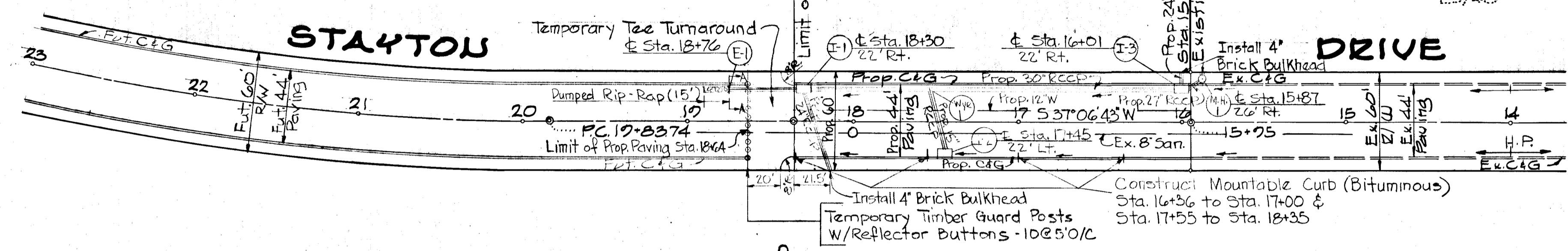

BALTIMORE WASHINGTON INDUSTRIAL PARK
 PATAPSCO PROPERTY, INC.
 W.H. 477 FOLIO 530

Reviewed For HOWARD S.C.D.
 Name
 And Make Technical Requirements
 Charles E. Null, Jr. Date 4/13/73
 Signature
 U.S. Soil Conservation Service

This Development Plan Is Approved
 For Soil Erosion And Sediment
 Control By The Howard Soil
 Conservation District.

Approved Robert W. Zehms Date 4/13/73
 Howard S.C.D.

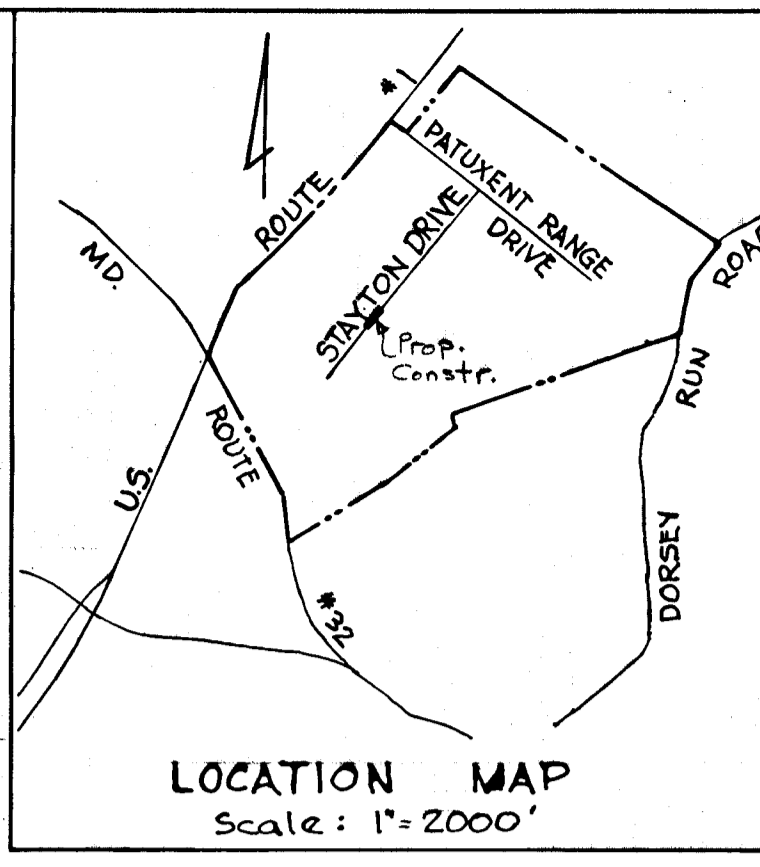

Developers Certification
 "I Certify That All Development And/Or Construction Will
 Be Done According To This Plan Of Development And Plan For
 Erosion And Sediment Control, And I Also Authorize
 Periodic On-Site Inspection By The Howard Soil Conservation
 District Or Their Authorized Agents, As Are Deemed Necessary,
 Deviation From This Plan Will Not Be Made Unless Authorized
 By The Howard Soil Conservation District."

Robert W. Zehms
 Signature Of Developer

3-26-73
 Date

Engineers Certification
 "I Certify That This Plan For Erosion And Sediment Control
 Represents A Practical And Workable Plan Based On My
 Personal Knowledge Of The Site Conditions And That It Was
 Prepared In Accordance With The Requirements Of The Howard
 Soil Conservation District."

Charles E. Null, Jr.
 Signature Of Engineer

3-23-73
 Date

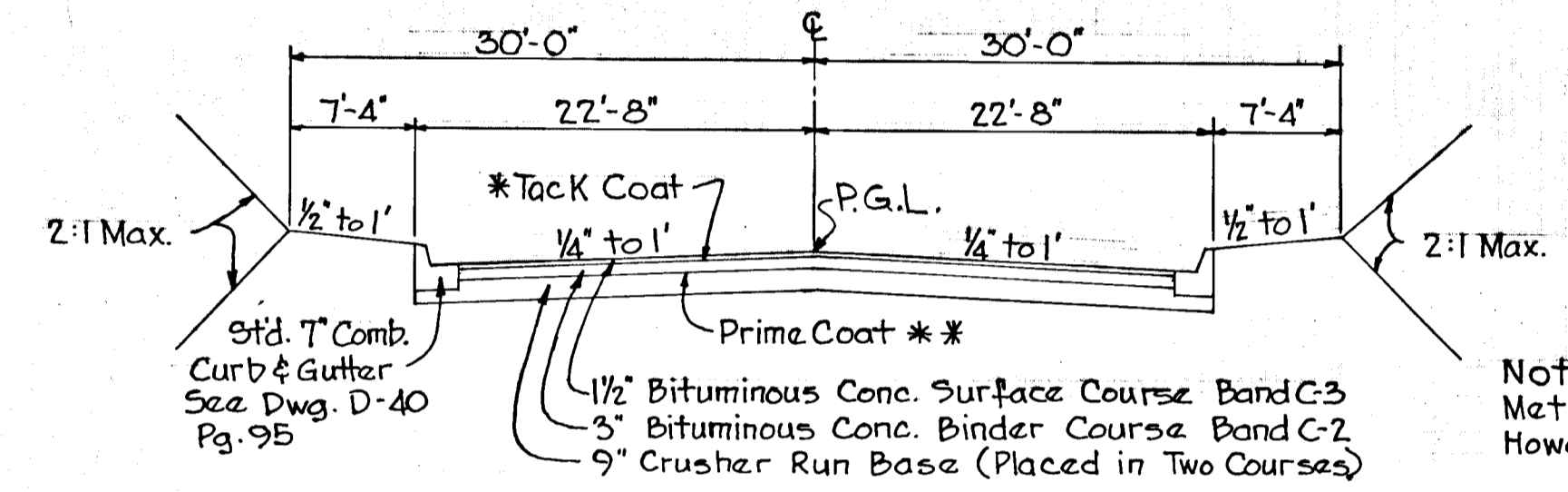

TYPICAL SECTION
 No Scale

Note: All Materials and Construction
 Methods Shall be in Accordance With
 Howard County Standards.

DEPARTMENT OF LAND DEVELOPMENT
 AND TRANSPORTATION PLANNING
 HOWARD COUNTY, MARYLAND
 DATE April 11, 1973
J.R.C.

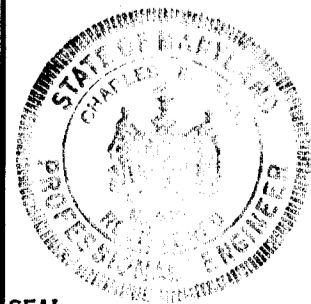
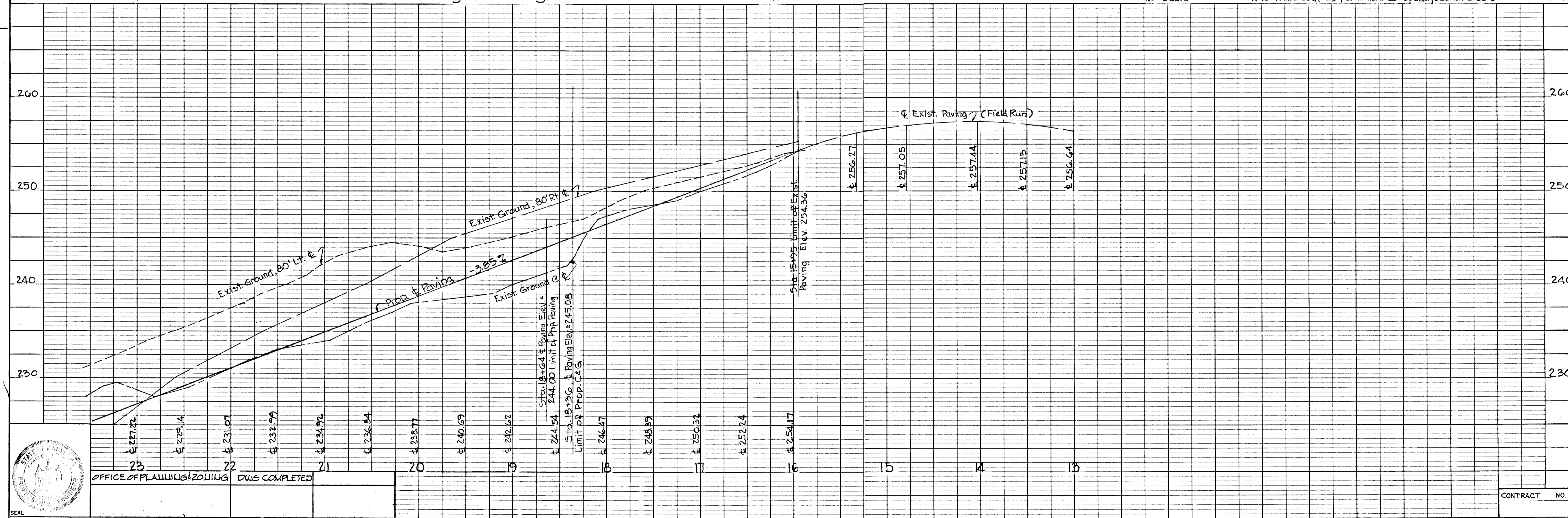

DESIGNED: H.F.S. G.W. STEPHENS JR. & ASSOC.
 DRAWN: G.R.G. ENGINEER: *Charles E. Null, Jr.*
 CHECKED: H.F.S. DATE: 11/14/72 LIC. NO. 5048

OFFICE OF PLANNING & ZONING
 DEPARTMENT OF PUBLIC WORKS
 CHIEF, BUREAU OF HIGHWAYS

OWJER & DEVELOPER
 PatapSCO Properties, Inc.
 501 St. Paul Place
 Baltimore, Maryland 21202

SCALE
 PLAN: 1" = 50'
 PROFILE: HOR. 1" = 50'
 VERT. 1" = 5'

HOWARD COUNTY DEPARTMENT OF PUBLIC WORKS BUREAU OF ENGINEERING
 BALTIMORE WASHINGTON INDUSTRIAL PARK
 STAYTON DRIVE
 Howard County, Maryland

CONTRACT NO.
 SHEET 1 OF 2
 DWG. NO.
 FILE:

INLET SCHEDULE				
No.	Type	Q	Inv. Out	Top Elev.
I-1	'5' Comb.	1.36 c.f.s.	239.61	245.45
I-2	'5' Comb.	1.42 c.f.s.	244.54	248.73
I-3	'5' Comb.	0.80 c.f.s.	246.71	254.27

MANHOLE SCHEDULE				
No.	Type	Size	Inv. Out	Top Elev.
M.H.-1	Standard Manhole	48"	247.02	254.89

STRUCTURE SCHEDULE				
No.	Type	Size	Inv. Out	Top Elev.
E-1	Std. End Support Wall	30"	237.58	239.33

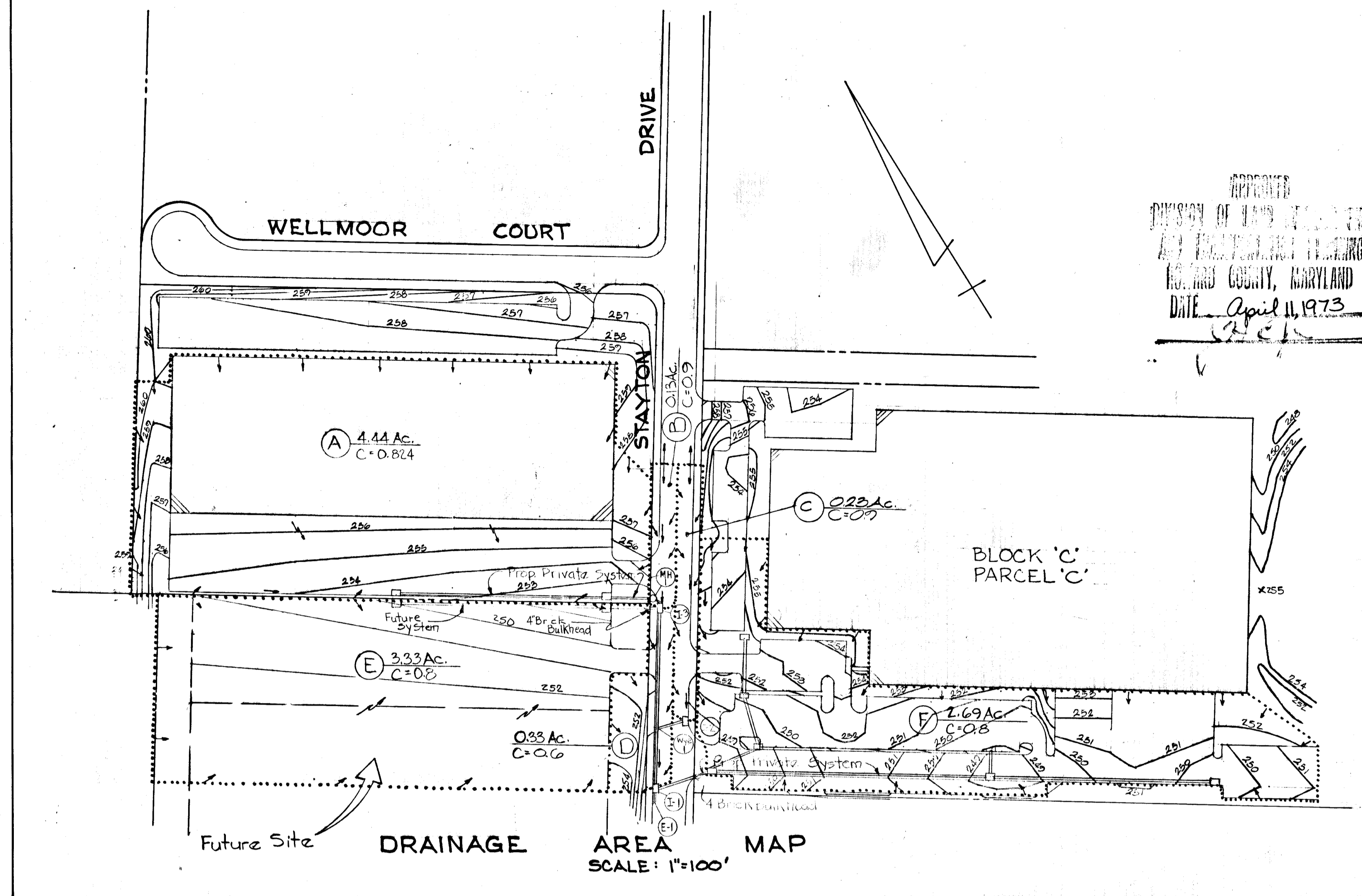

APPROVED
 DIVISION OF LAND DEVELOPMENT & TRANSPORTATION PLANNING
 HOWARD COUNTY, MARYLAND
 DATE April 11, 1973
[Signature]

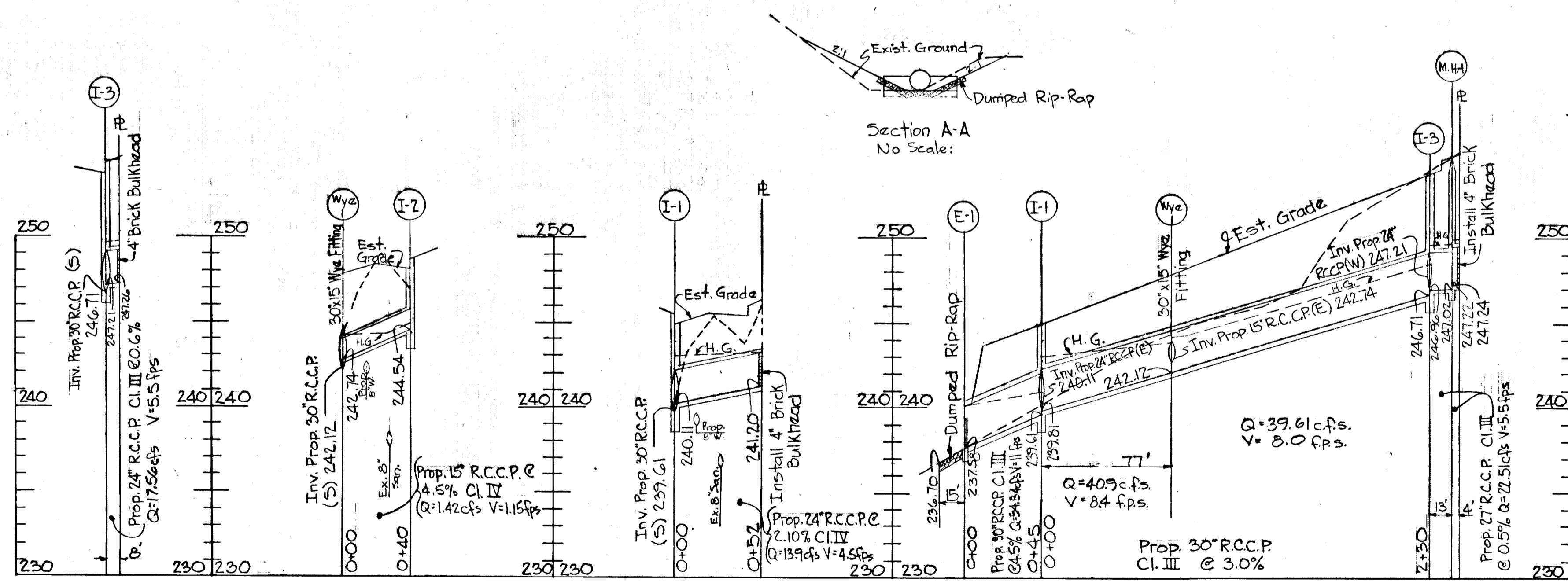

PROFILES scale: Hor. = 1"=50'
 Vert. = 1"=5'

Area No.	Remarks	Incr. Acres	Total Acres	C	C-A	Accum. C-A	Time Concn.	I in/hr	Q cfs	Pipe Size	Slope % Min. Act.	Vel. ft.	Length ft.	Time In Pipe
A	Prop Private Sys to I-3	4.44	—	3.66	—	9.5	6.15	22.51	27"	0.6	0.5	5.5	17	—
E	Fut. Sys. to I-3	3.33	—	.8	2.66	—	7.0	6.6	17.56	24"	0.67	0.6	5.5	8
B	I-3	0.13	—	.9	0.12	—	5.7	6.85	0.8	—	—	—	—	—
A,B,E	I-3 to Wye-1	—	7.90	—	6.44	—	9.5	6.15	39.61	30"	1.1	3.0	8.0	153
C	I-2 to Wye-1	0.23	—	.9	0.21	—	6.24	6.75	1.42	15"	.06	4.5	1.15	40
A,C,E	Wye-1 to I-1	—	8.13	—	6.65	—	9.82	6.15	40.90	30"	1.15	3.0	8.4	77
D	I-1	0.33	—	.9	0.20	—	6.0	6.8	1.36	—	—	—	—	—
F	Prop Private Sys. to I-1	2.69	—	2.14	—	—	7.5	6.5	13.9	24"	0.44	2.1	4.5	52
A-F	I-1 to Outfall	—	11.15	—	8.99	—	9.96	6.1	54.84	30"	2.1	4.5	11.0	45

STORM DRAIN DESIGN DATA

DESIGNED: H. F. S.		G. W. STEPHENS JR. & ASSOC.	ENGINEER	OWNER & DEVELOPER	OFFICE OF PLANNING & ZONING	DEPARTMENT OF PUBLIC WORKS	HOWARD COUNTY DEPARTMENT OF PUBLIC WORKS BUREAU OF ENGINEERING	SHEET NO. 2 OF 2 DRAWING NO. CONTRACT NO. FILE	
DRAWN: H. F. S.		ENGINEER: <i>Charles P. Lido</i> REG. NO. 5048	GEORGE W. STEPHENS JR. & ASSOC. 303 ALLEGHENY AVE. TOWSON, M.D. 21204	PATAPSCO PROPERTIES, INC. 501 ST. PAUL PLACE BALTIMORE, MD. 21202	CHIEF DIVISION OF LAND DEVELOPMENT & TRANSPORTATION PLANNING <i>[Signature]</i> DATE: <u>4/13/73</u>	CHIEF, BUREAU OF HIGHWAYS <i>[Signature]</i> DATE: <u>4/16/73</u>	BALTIMORE WASHINGTON INDUSTRIAL PARK STAYTON DRIVE STORM DRAINS JANUARY 26, 1973 HOWARD COUNTY, MARYLAND ELECT. DISTRICT #6		
CHECKED: C. E. F.		DATE: <u>MARCH 23, 1973</u>							DATE REVISIONS BY