

"I certify that all development and/or construction will be done according to this plan of development and plan for Erosion and Sediment Control, and I also authorize periodic on-site inspection by the Howard Soil Conservation District or their authorized agents, as are deemed necessary." Deviation from this plan will not be made unless authorized by the Howard Soil Conservation District.

Developer: Eugene S. Seybold Date: \_\_\_\_\_

I certify that this plan for Erosion and Sediment Control represents a practical and workable plan based on my personal knowledge of the site conditions and that it was prepared in accordance with the requirements of the Howard Soil Conservation District.

Engineer: [Signature] Date: 12/23/72

This development plan is approved for Soil Erosion and Sediment Control by the Howard Soil Conservation District.

Reviewed: [Signature] Date: 1/23/73  
District Conservationist

Approved: [Signature] Date: 2/23/73  
Howard Soil Conservation District

**GENERAL NOTES**

- All construction shown herein shall be in accordance with the Howard County "Road Construction Code and Standard Specifications" dated November 27, 1962 and revised August, 1967.
- Reference to drawing and page number refer to the above mentioned specifications.

STRUCTURE SCHEDULE						
NO.	TYPE	TOP ELEV.	IN.	IN.	OUT.	REMARKS
I-1	A-10 Inlet	373.50			370.04	Pg. 119-A Dwg. 64-A
S-1	Std. Type	368.95			366.70	Pg. 115 Dwg. D-60

Zoned R-20  
MINOR RESIDENTIAL  
Speed Limit 25 MPH.

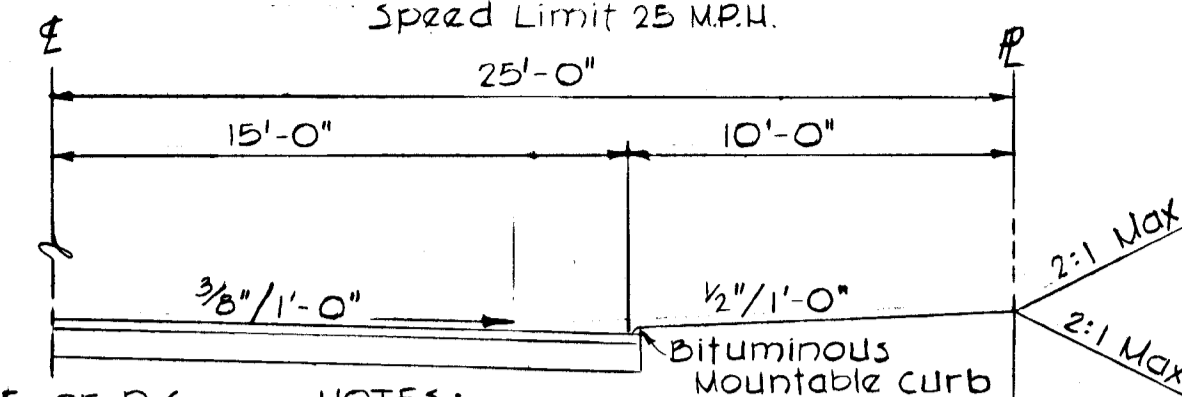

NOTES:  
1. Base to be primed in accordance with Article C-20-5 of the Howard Co. Road Construction Code and Standard Specifications.  
2. Tack Coat shall be applied in accordance with Article C-31-A of the Howard Co. Road Construction Code and Standard Specifications.

**TYPICAL HALF SECTION**  
Scale: 1" = 5'

**SEDIMENT CONTROL NOTES**

- The developer shall notify the Howard County Soil Conservation District at least 24 hours prior to beginning any construction shown hereon. (465-3180)
- Berms, sediment traps, etc., to be constructed prior to any onsite grading or disturbance to any existing surface material.
- All sediment control structures to remain in place until permission for their removal has been obtained from the Howard Soil Conservation District. (465-3180 or 465-5000 Ext. 291)
- All graded areas not to be sodded shall be stabilized by seeding and mulching in accordance with the following:
  - Site preparation:
    - Harrow or disc in areas proposed to be seeded the following materials at the specified rate, to a depth of 3":
      - Pulverized limestone 1 1/2 tons/acre.
      - Commercial fertilizer 5-10-10 1/4 tons/acre.
      - Super phosphate 600 lbs./acre.
  - Seeding:
    - Sow the following seed mixture the rate of 200 lbs./acre with a mechanical spreader:
      - 20% Annual Rye Grass
      - 80% Kentucky 31 Fescue (K-31)
    - The seeded area shall then be raked with a York Rake (minimum of 2 passes), covered and compacted with Cultipacker or other approved method.
  - Mulching:
    - Seeded areas shall be uniformly mulched immediately after seeding with unweathered small grain straw at the rate of 1 1/2 to 2 tons/acre.
    - Tie mulch down with liquid asphalt 0.1 gal./s.y. or emulsified asphalt 0.04 gal./s.y. or mulch netting.
- Developer shall seed and mulch graded areas within Rolling Ridge Court in accordance with item 4-3 (A&B) of the Sediment Control Notes, weather permitting. Should the weather prohibit seeding, these areas shall be mulched in accordance with item 4-3 (B) of the Sediment Control Notes.

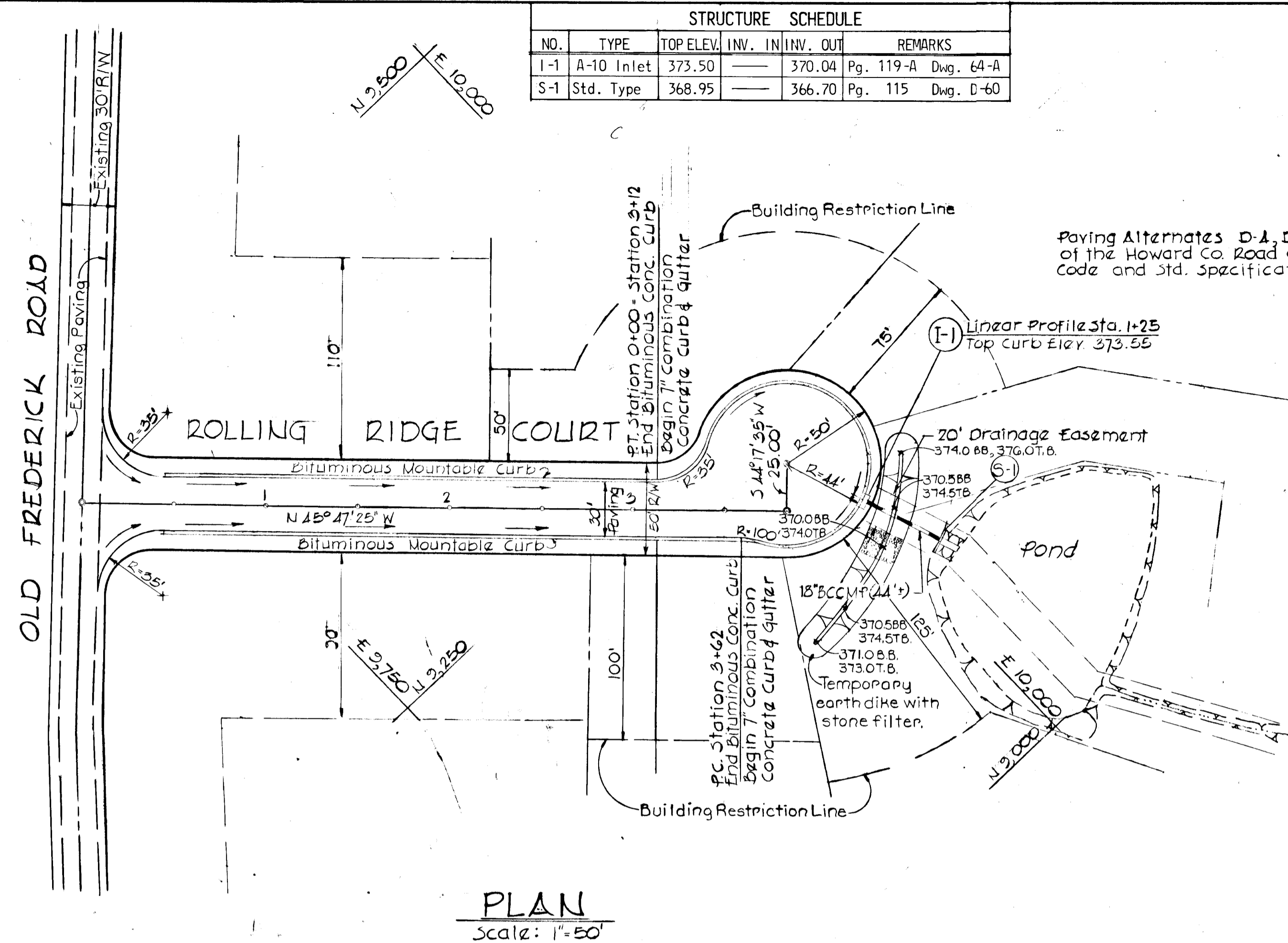

**PLAN**  
Scale: 1" = 50'

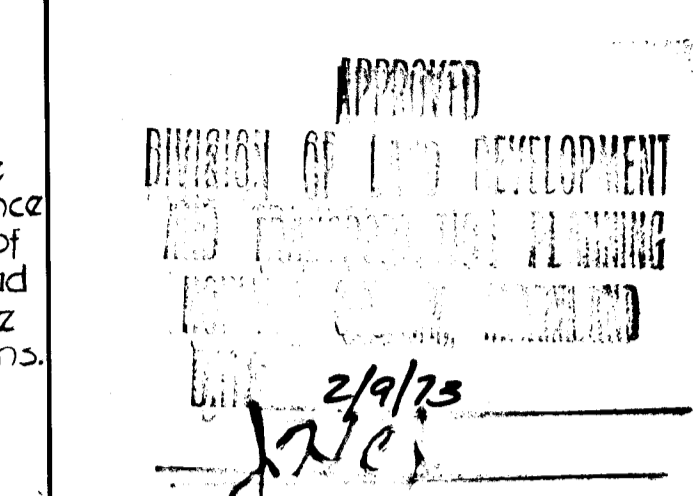

Revised	Date	OWNER & DEVELOPER EUGENE SEYBOLD 2204 Frederick Road Catonsville, Maryland
Drawing No.		PURDUM & JESCHKE CONSULTING ENGINEERS & LAND SURVEYORS 1023 N. Calvert Street Baltimore, Maryland 21202
Designed: C.J.C.		
Drawn: D.A.H.		
Checked: R.B.C.		

APPROVED: Department of Public Works  
[Signature] 3-5-73  
Chief, Bureau of Highways

APPROVED: Office of Planning and Zoning  
[Signature] 3/1/73  
Chief, Division of Land Development and Transportation Planning

PLAN & PROFILE ROLLING RIDGE COURT  
**ROLLING RIDGE**  
2nd ELECTION DISTRICT HOWARD COUNTY, MARYLAND  
September, 1972 Sheet of Scale: As Shown

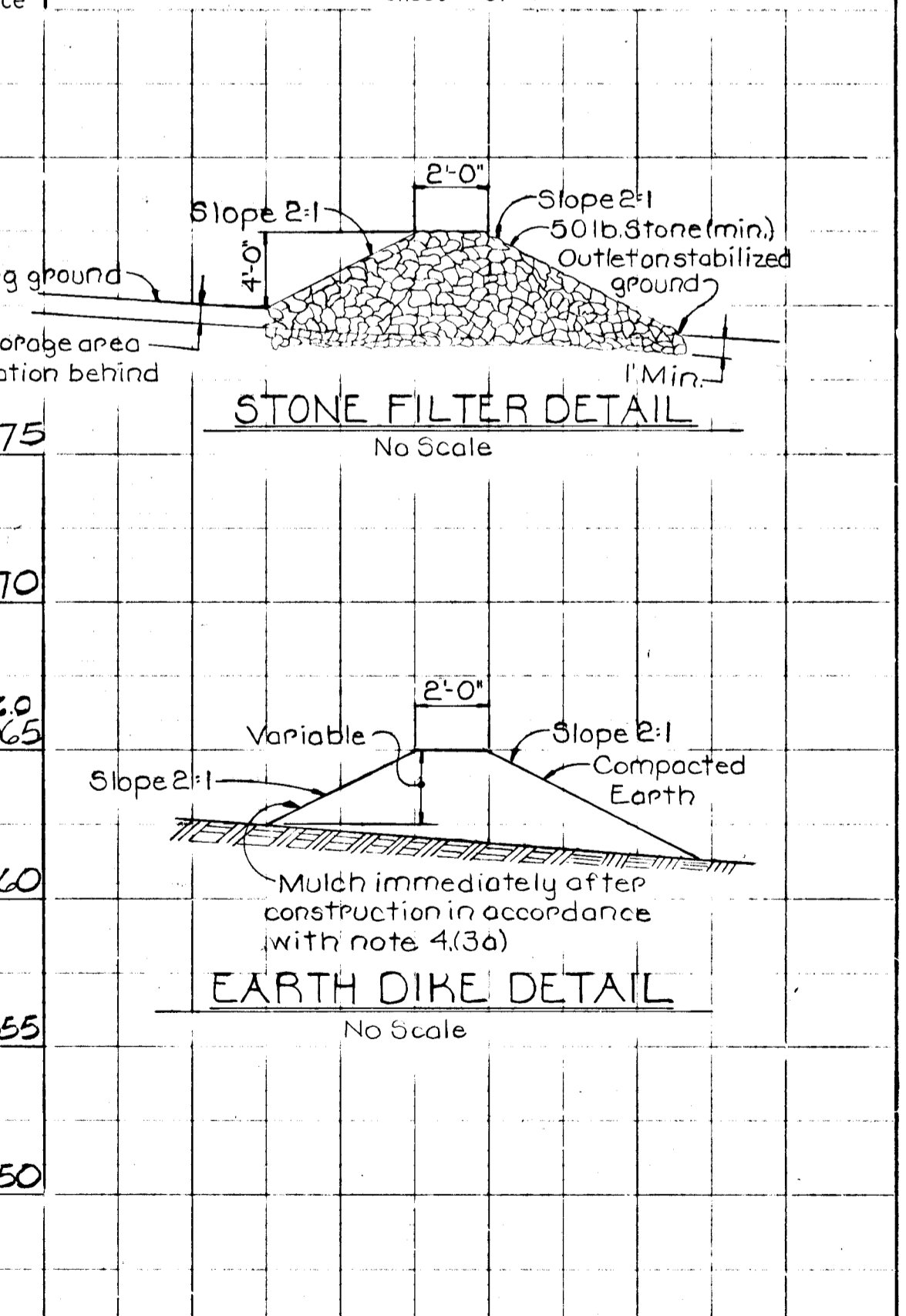
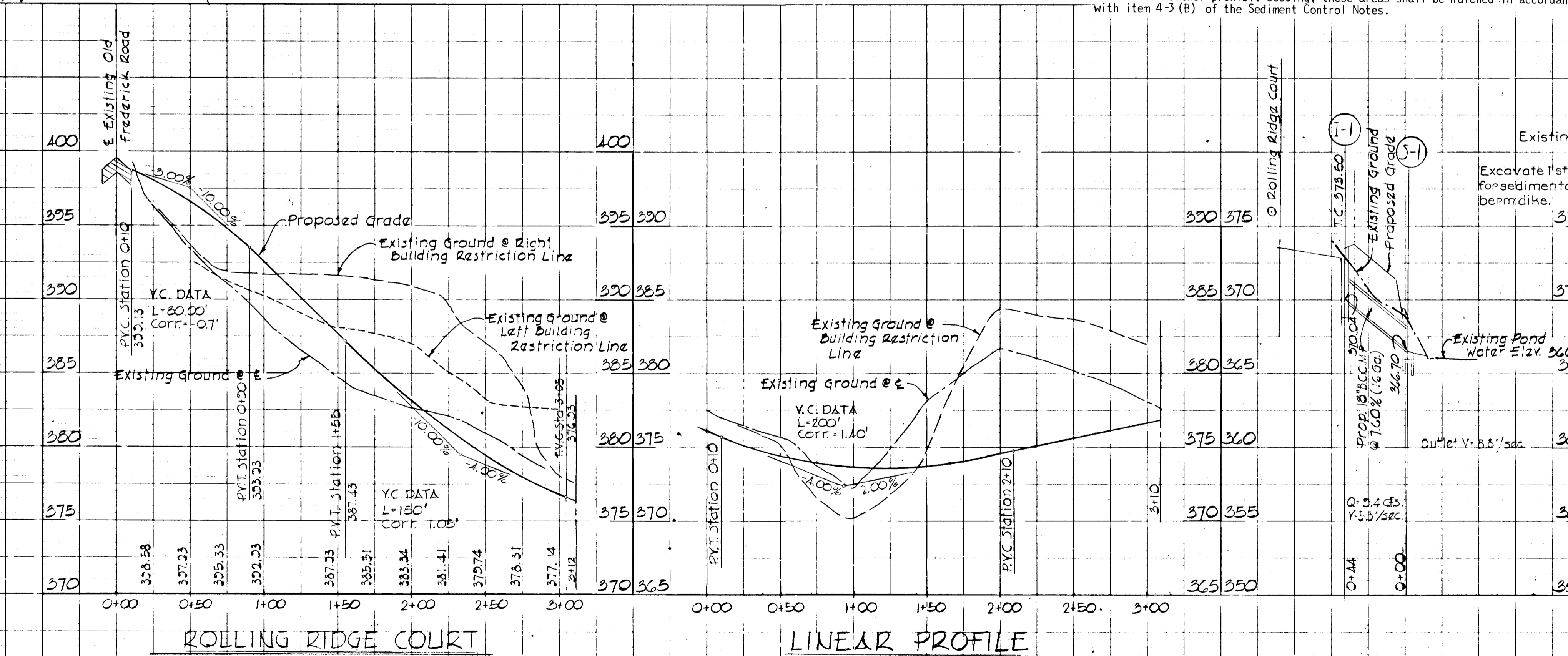

**ROLLING RIDGE COURT**  
**LINEAR PROFILE**