

FOR PLAN AND PROFILE OF ELK FOREST COURT SEE SHEET NO 2 OF 3

Note: Typical Paving Section To Be Constructed in Accordance with the Howard County Road Construction Code and Standard Specifications.

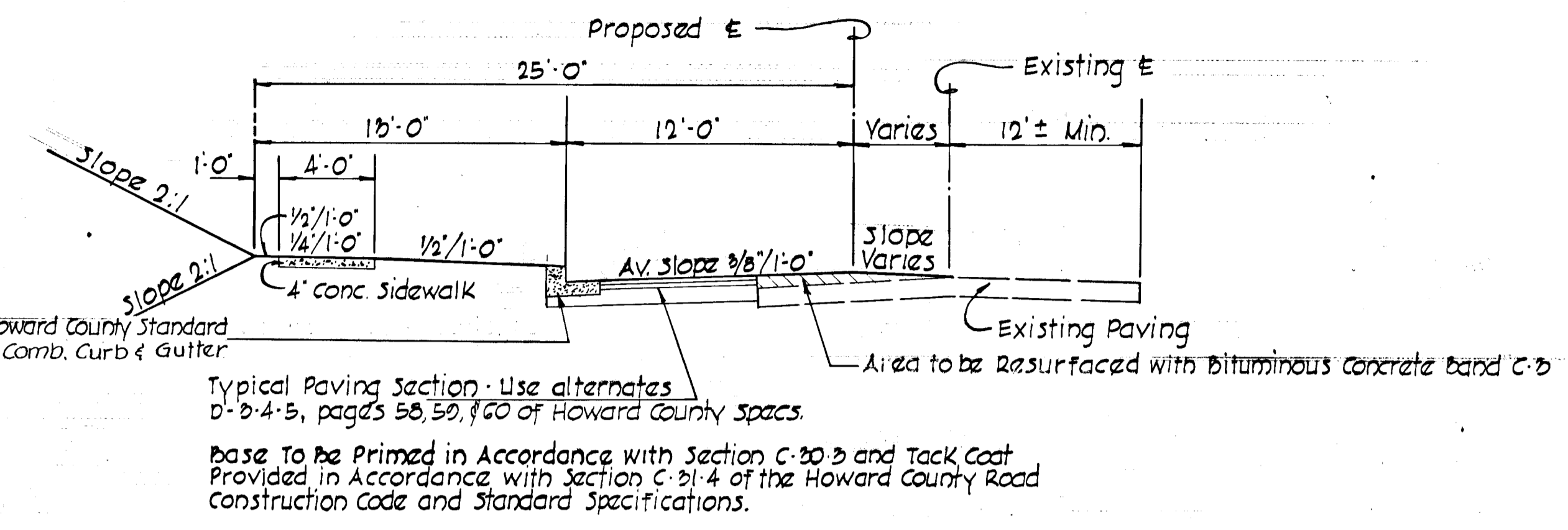

TYPICAL SECTION
SCALE: 1"=5'

BEUCH MARK
WEST FLANGE BOLT ON FIRE HYDRANT
20' RT. OF STA. 8+95 AUGUSTINE AVE.
ELEV. 177.74

APPROVED
DIVISION OF LAND DEVELOPMENT
AND TRANSPORTATION PLANNING
HOWARD COUNTY, MARYLAND
DATE 12/12/72

		ROAD PLAN AND PROFILE AUGUSTINE AVENUE MOUNT AUGUSTINE FIRST ELECTION DISTRICT HOWARD COUNTY, MARYLAND SCALE: PLAN: 1"=50' PROFILE: HOR: 1"=50' VERT: 1"=5' SHEET 1 of 3
		DEPARTMENT OF PUBLIC WORKS S. H. McCreland CHIEF BUREAU HIGHWAYS DATE 12/30/72
OWNER & DEVELOPER W.A. MARTIN ASSOCIATES, INC. 10 WARRINGTON DRIVE SILVER SPRING, MARYLAND		

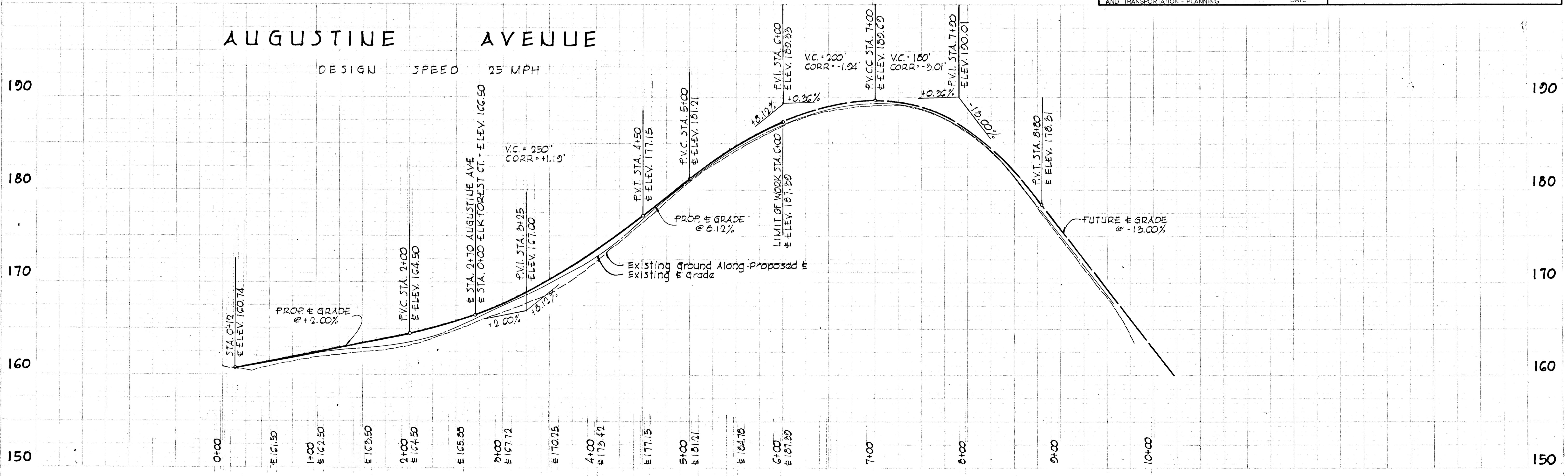

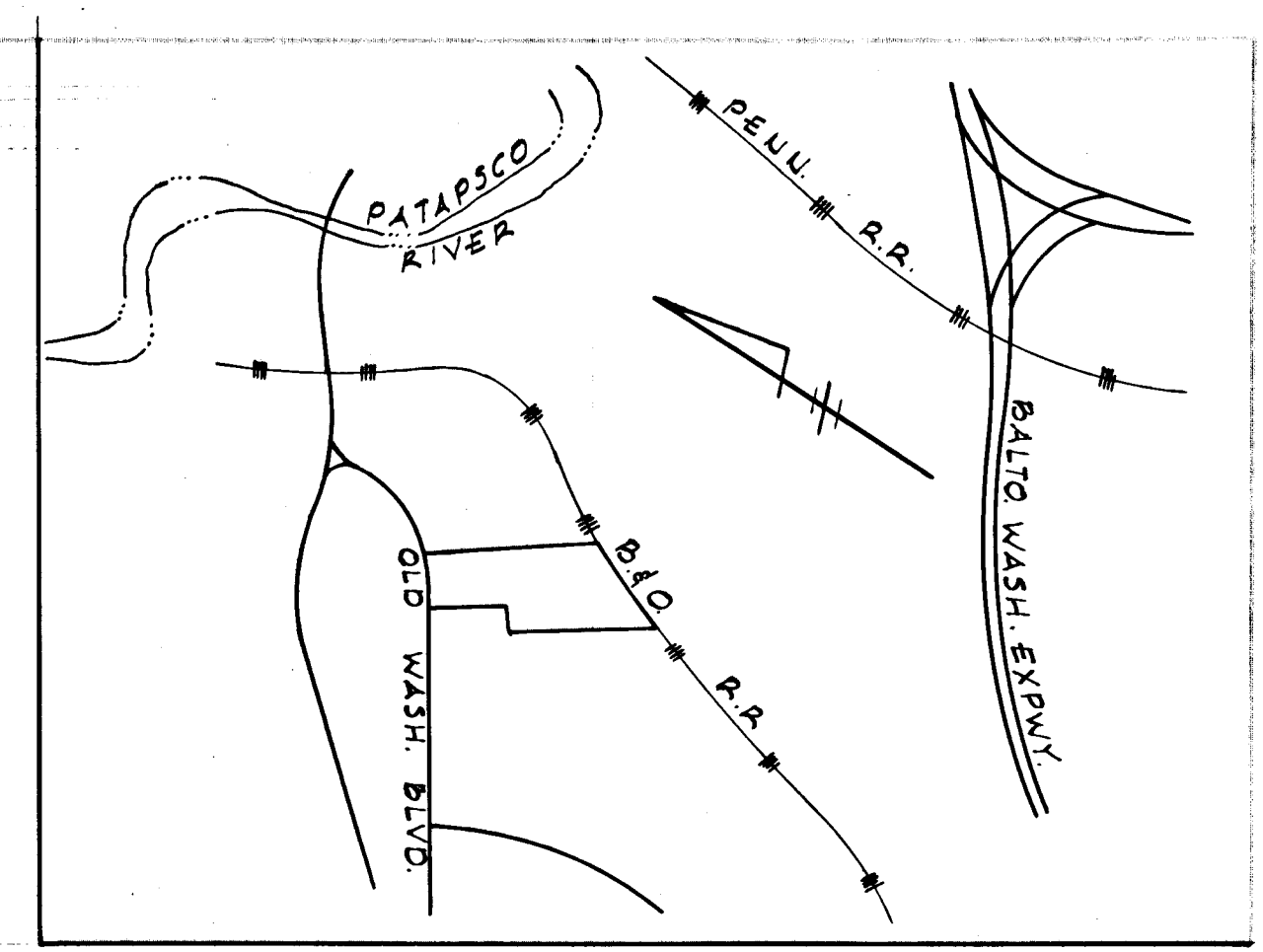
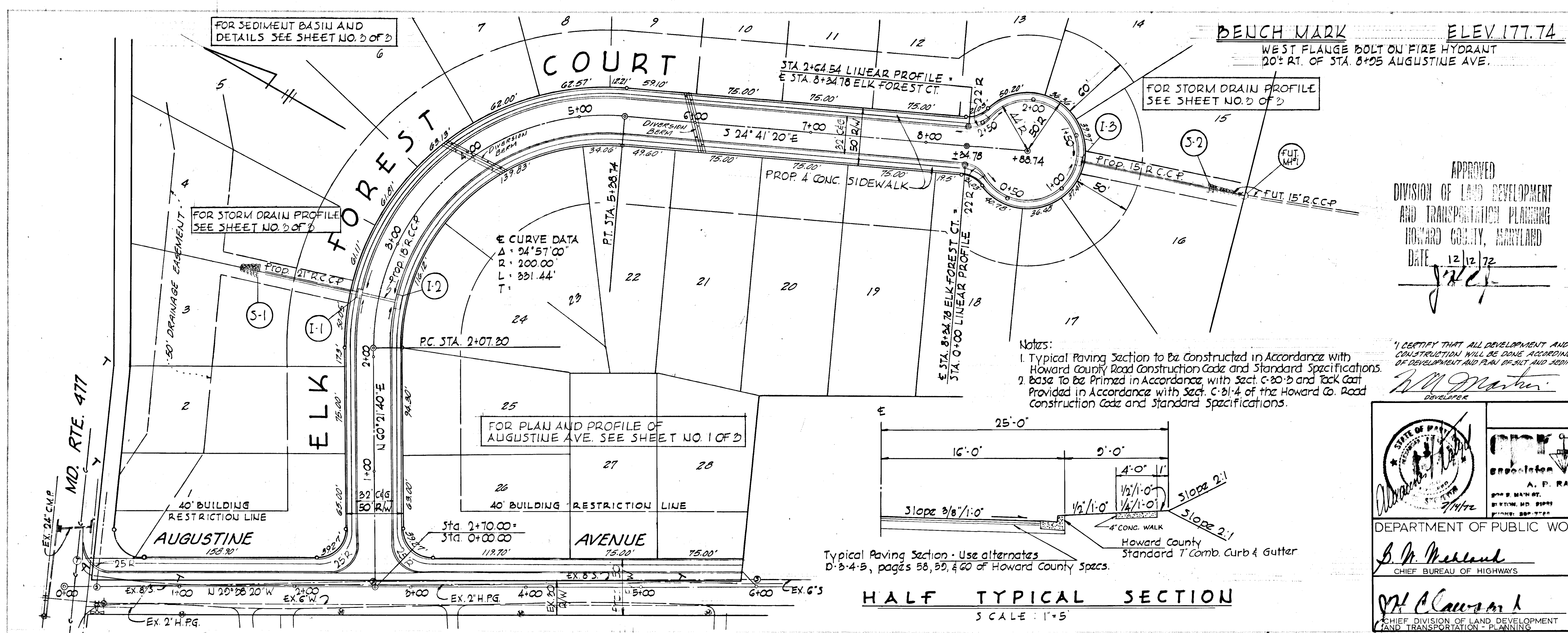

APPROVED
 DIVISION OF LAND DEVELOPMENT
 AND TRANSPORTATION PLANNING
 HOWARD COUNTY, MARYLAND
 DATE 12/12/72
J.P. Clavin

- Notes:
1. Typical Paving Section to be Constructed in Accordance with Howard County Road Construction Code and Standard Specifications.
 2. Base to be Primed in Accordance with Sect. C-20-B and Tack Coat Provided in Accordance with Sect. C-21-4 of the Howard Co. Road Construction Code and Standard Specifications.

I CERTIFY THAT ALL DEVELOPMENT AND/OR CONSTRUCTION WILL BE DONE ACCORDING TO THIS PLAN OF DEVELOPMENT AND PLAN OF SILT AND SEDIMENT CONTROL.
W.M. Martin 10-18-72
 DEVELOPER DATE

I CERTIFY THAT THE PLAN OF DEVELOPMENT AND THE PLAN FOR CONTROL OF SILT AND SEDIMENT MEETS THE REQUIREMENTS, STANDARDS AND SPECIFICATIONS OF THE HOWARD SOIL CONSERVATION DISTRICT.
ALBAUDEE P. RATYCH DATE

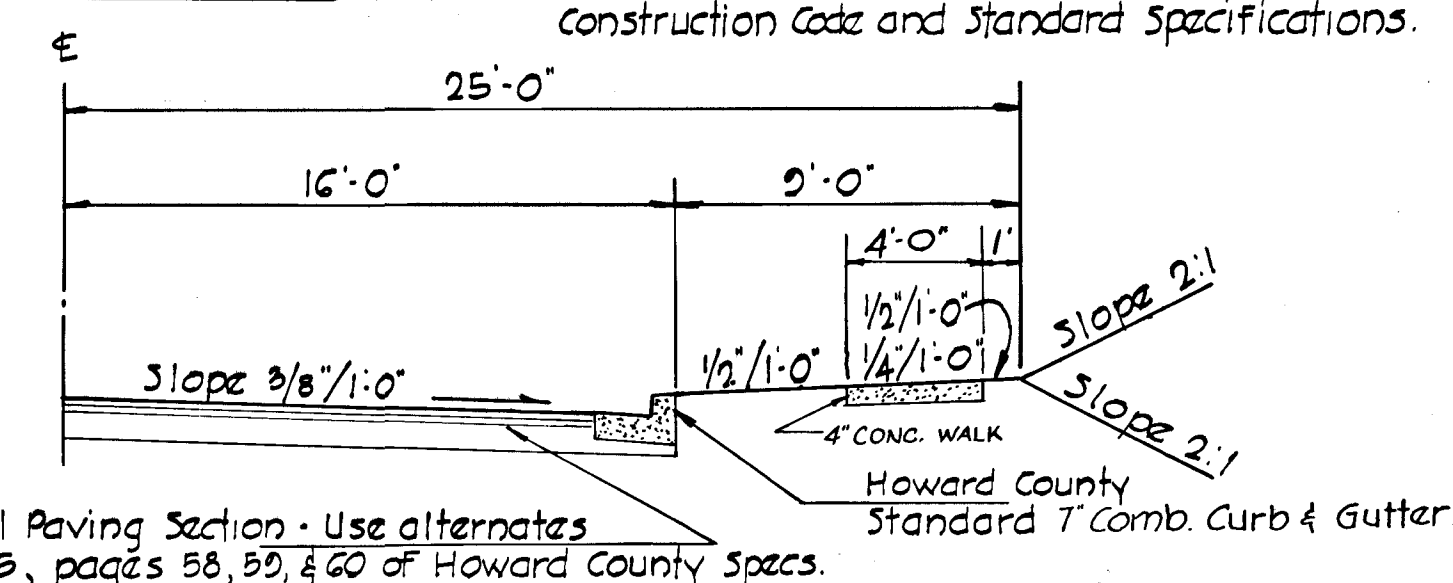

HALF TYPICAL SECTION
 SCALE: 1" = 5'

		ROAD PLAN, STORM DRAINS & PROFILES ELK FOREST COURT MOUNT AUGUSTINE FIRST ELECTION DISTRICT HOWARD COUNTY, MARYLAND SCALE: PLAN 1"=50' PROFILE HOR 1"=50' VERT 1"=5' SHEET 2 OF 3
	DEPARTMENT OF PUBLIC WORKS <i>B. H. Mesland</i> 12/30/72 CHIEF BUREAU OF HIGHWAYS DATE	OWNER & DEVELOPER W.A. MARTIN ASSOCIATES, INC. 10 WARRINGTON DRIVE SILVER SPRING, MARYLAND
DEPARTMENT OF LAND DEVELOPMENT AND TRANSPORTATION PLANNING <i>J.P. Clavin</i> 12/12/72 CHIEF DIVISION OF LAND DEVELOPMENT AND TRANSPORTATION PLANNING DATE		

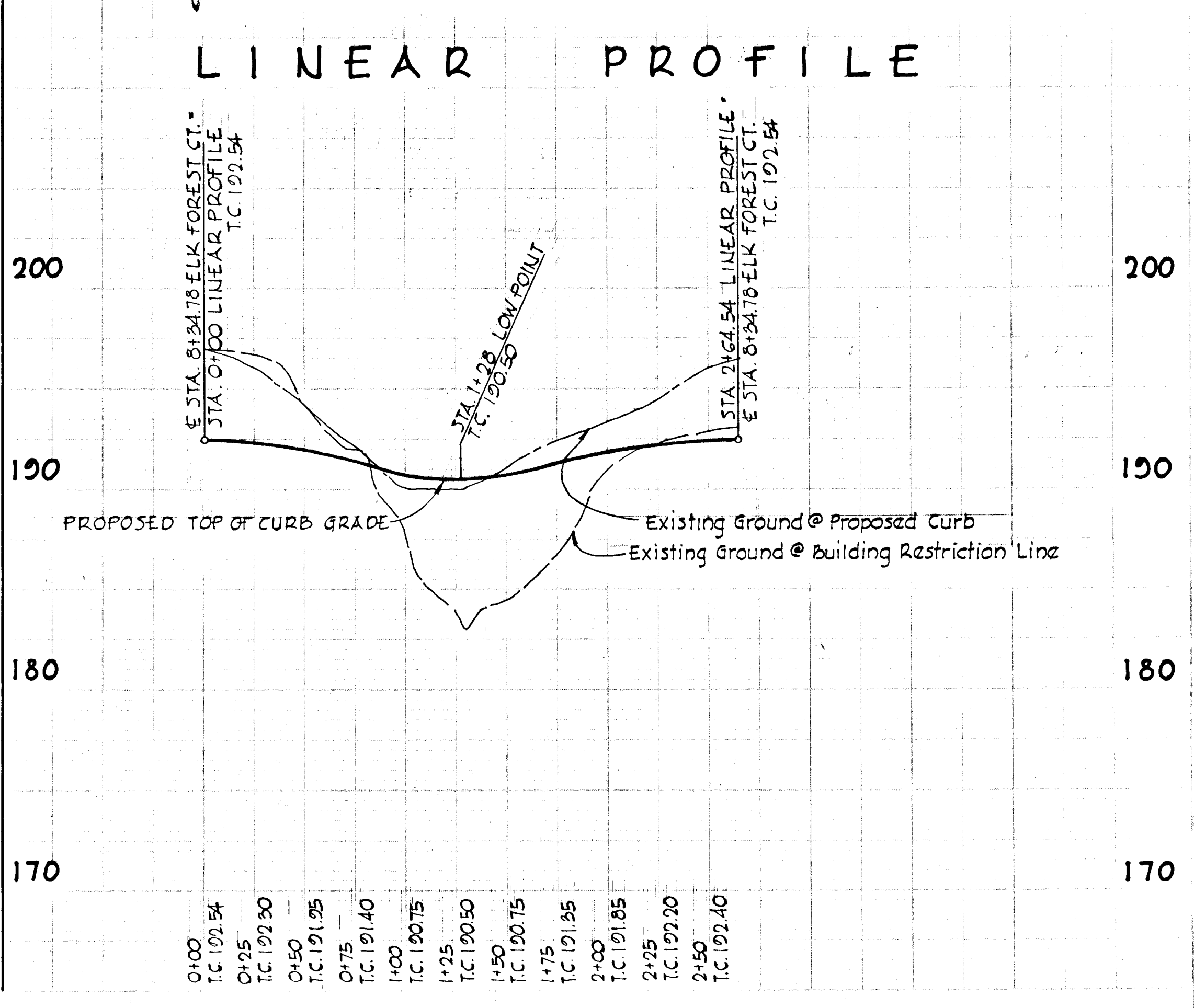
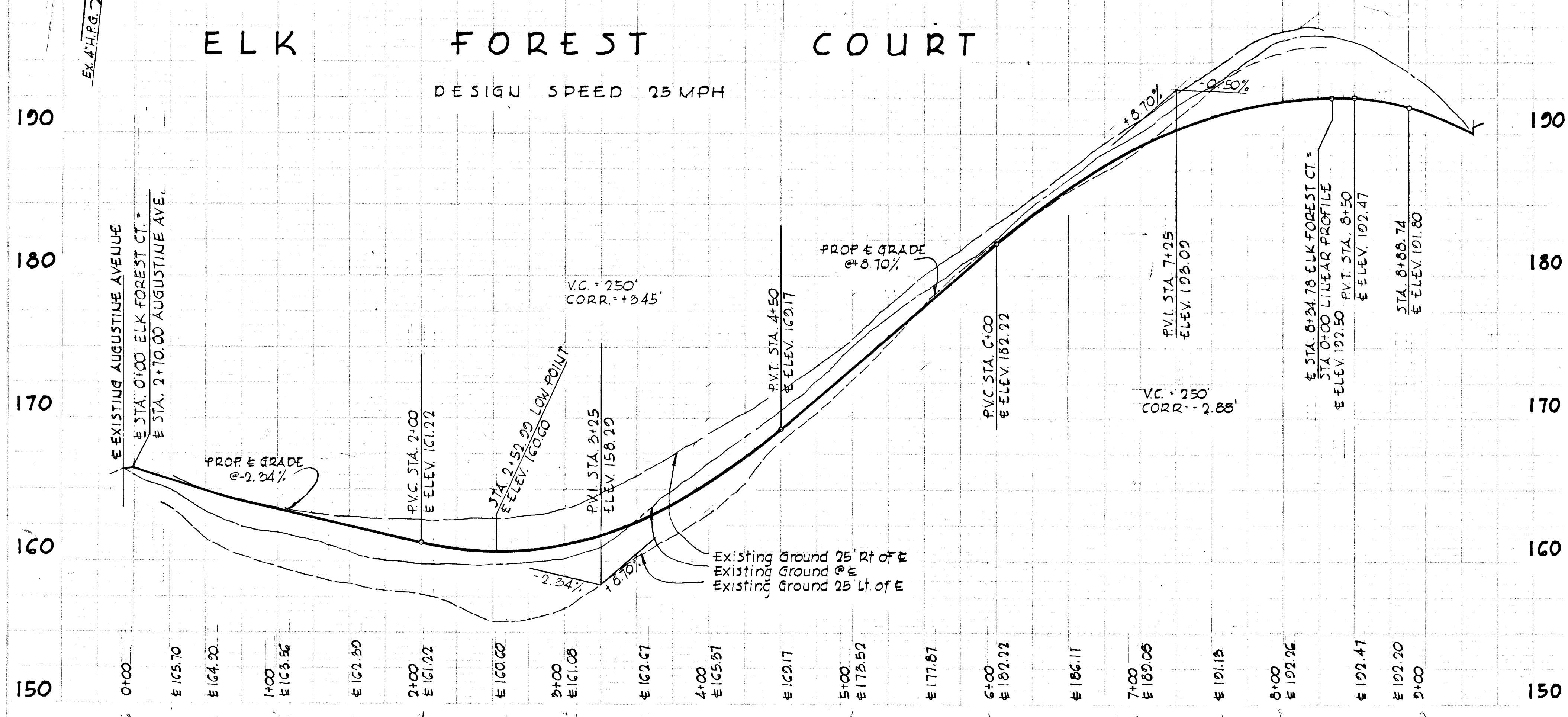

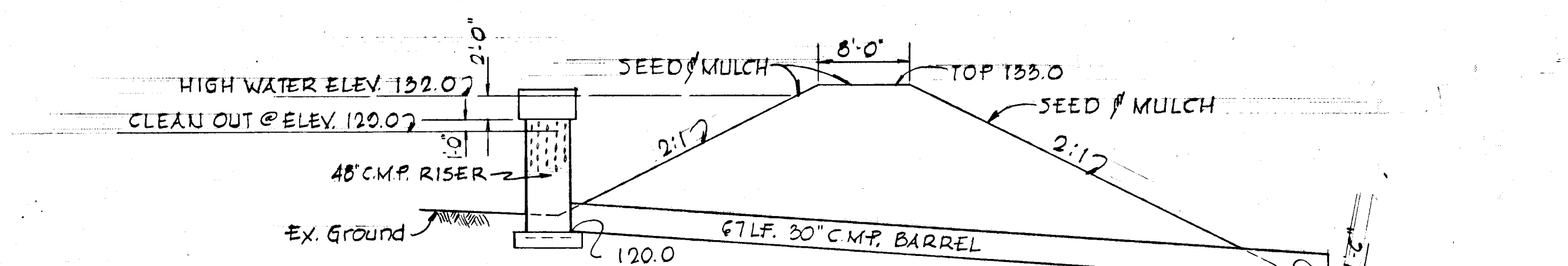

1. CLEAN OUT ELEVATION TO BE PAINTED ON RISER WITH WHITE PAINT.
 2. THE TOP 5\"/>

PIPE SPILLWAY DETAIL
 SCALE: 1\"/>

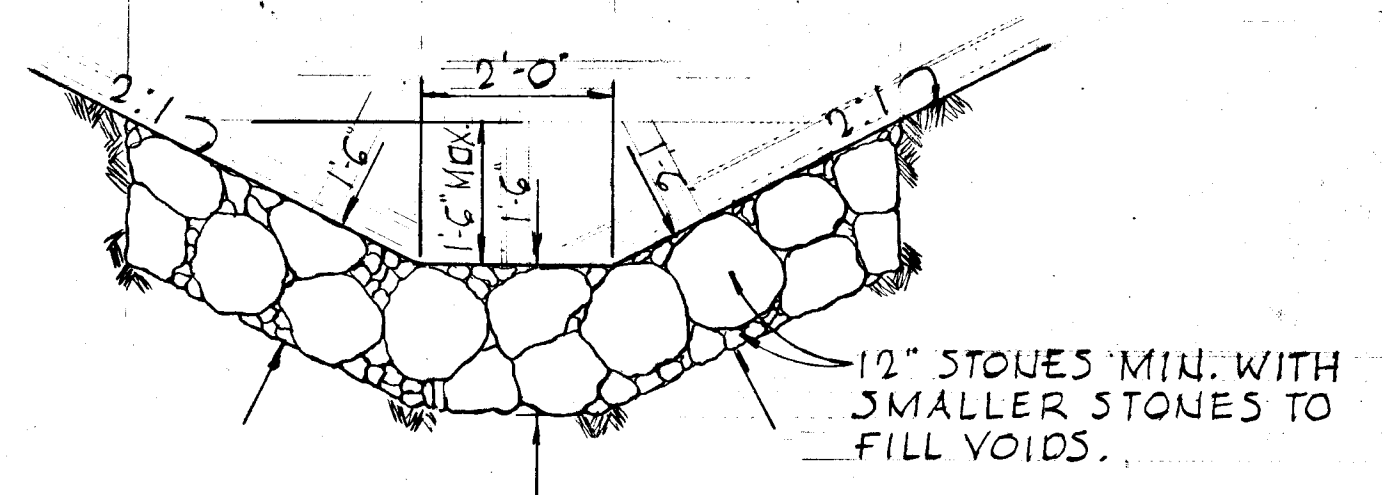

UNGRADED RIP RAP CHANNEL DETAIL
 SCALE: 1/2\"/>

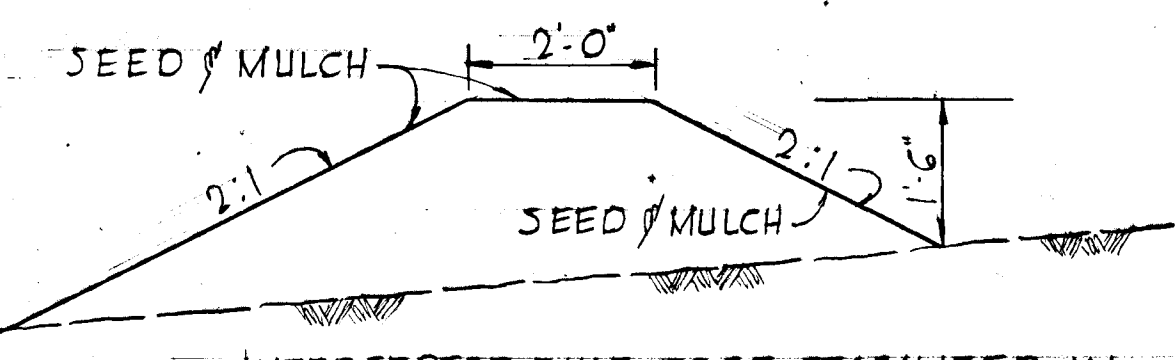

INTERCEPTOR DIKE TO BE STABILIZED IN ACCORDANCE WITH NOTE 2 OF THIS SHEET AND DIKE MUST REMAIN IN PLACE UNTIL ALL CONSTRUCTION IS COMPLETED.

INTERCEPTOR DIKE DETAIL
 SCALE: 1/2\"/>

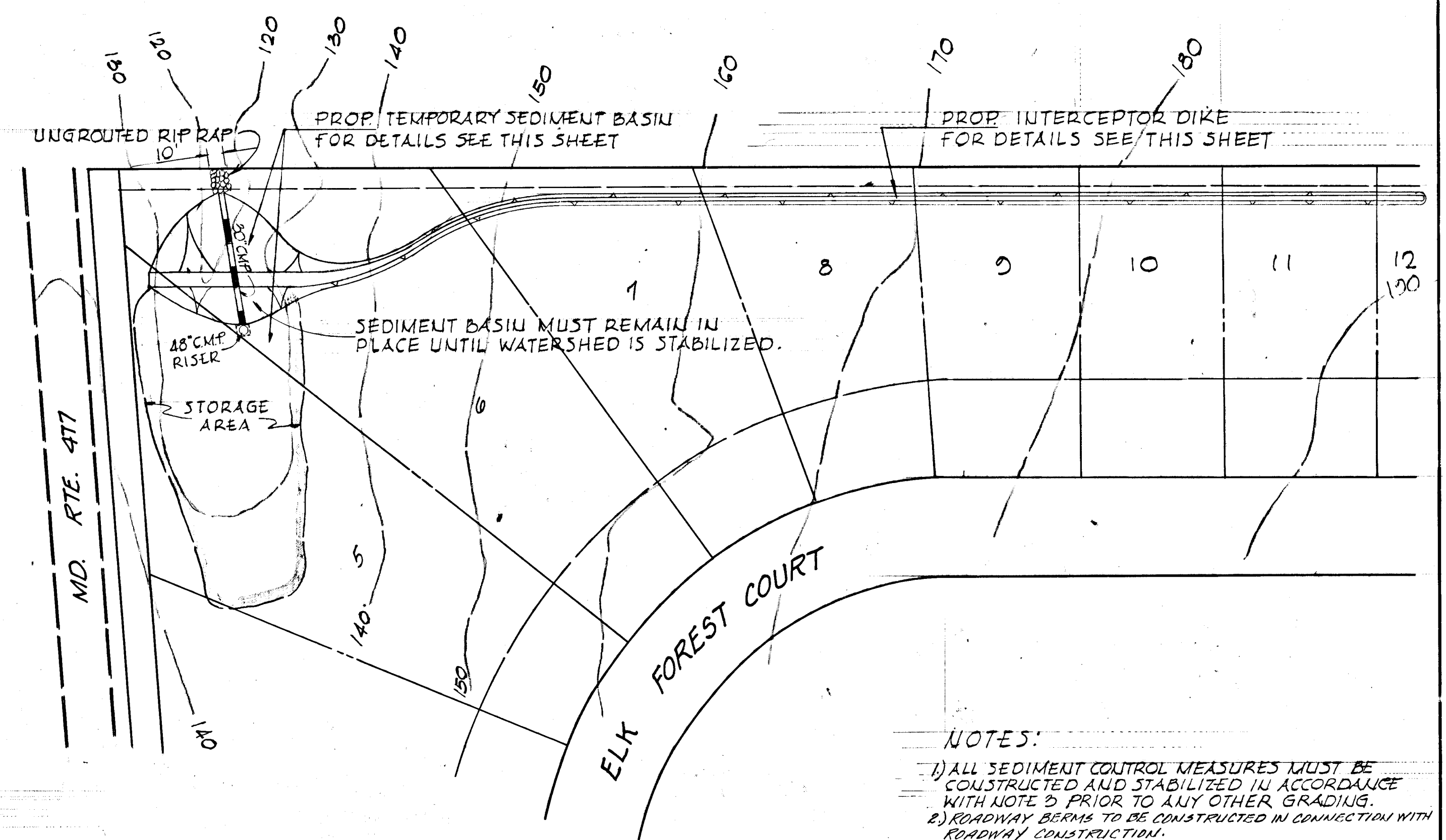

LOCATION OF TEMPORARY SEDIMENT BASIN
 SCALE: 1\"/>

- NOTES:
- 1) ALL SEDIMENT CONTROL MEASURES MUST BE CONSTRUCTED AND STABILIZED IN ACCORDANCE WITH NOTE 2 PRIOR TO ANY OTHER GRADING.
 - 2) ROADWAY BERMS TO BE CONSTRUCTED IN CONNECTION WITH ROADWAY CONSTRUCTION.
 - 3) GRADED AREAS SHALL BE PROTECTED FROM EROSION BY MEANS OF LONG TERM SEEDING IN ACCORDANCE WITH THE FOLLOWING:
 - a) 3\"/>
 - b) PULVERIZED LIMESTONE SHALL BE SPREAD AT 2,000 LBS./AC.
 - c) COMMERCIAL FERTILIZER OF 10-10-10 RATINGS OR EQUIVALENT SHALL BE SPREAD @ 1,000 LBS./AC.
 - d) UPON COMPLETION OF LIMING AND FERTILIZING OPERATION THE AREA SHALL BE DISCED TO A DEPTH OF 3\"/>
 - e) THE FOLLOWING SEED MIXTURE SHALL BE SPREAD NOT LESS THAN 5 LBS / 2,500 SQ. FT.
 - ANNUAL RYE GRASS 20% CREEPING RED FESCUE 40% KENTUCKY BLUE GRASS 30% CHENOPodium 10%
 - f) MULCH WITH SMALL GRASS SEEDS AT 1.5 TONS / AC. AND TIE DOWN WITH LIQUID ASPHALT 55-10 EMULSION / AC.

APPROVED
 DIVISION OF LAND DEVELOPMENT
 & TRANSPORTATION PLANNING
 HOWARD COUNTY, MARYLAND
 DATE 12/12/72
[Signature]

"THIS DEVELOPMENT PLAN IS APPROVED FOR SOIL EROSION AND SEDIMENT CONTROL BY THE HOWARD SOIL CONSERVATION DISTRICT."

REVIEWED *[Signature]* 10/19/72
 DISTRICT CONSERVATIONIST
 DATE
 APPROVED *[Signature]* 12/19/72
 HOWARD SOIL CONSERVATION DISTRICT
 DATE

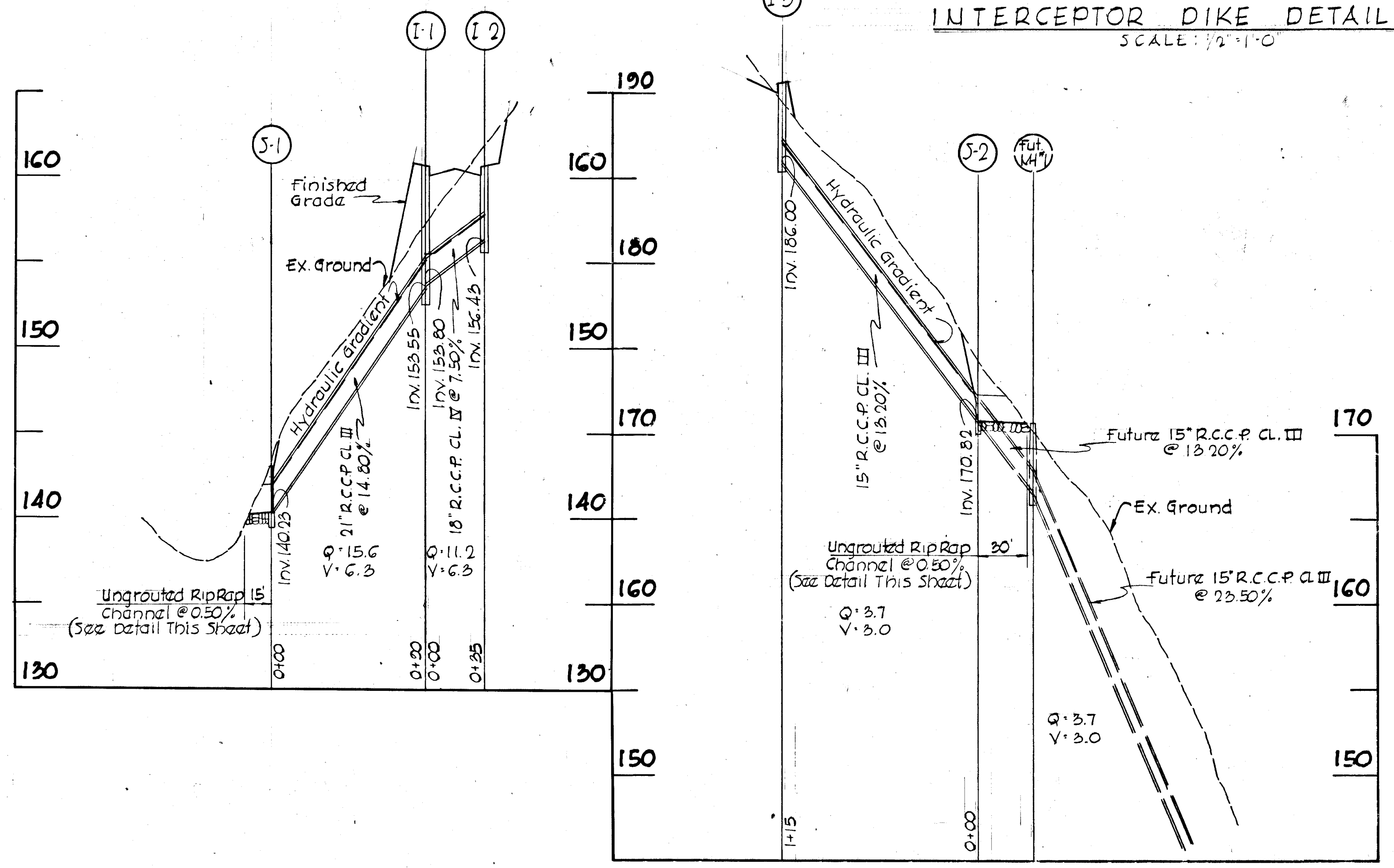

STRUCTURE		SCHEDULE				REMARKS
NO.	TYPE	INV. IN	INV. OUT	TOP ELEV.		
S-1	STD. C' ENDWALL		140.23	142.08	HO. CO. DWG. #52 PAGE #107	
S-2	STD. END SUPPORT W.		170.82	171.86	HO. CO. DWG. #46 PAGE #101	
I-1	STD. CL. A-5 INLET	153.80	153.55	160.64	HO. CO. DWG. #64A PAGE #110A	
I-2	STD. CL. A-10 INLET		156.43	160.64	HO. CO. DWG. #64A PAGE #110A	
I-3	STD. CL. A-5 INLET		186.00	190.50	HO. CO. DWG. #64A PAGE #110A	

"I certify that all development and/or construction will be done according to this plan of development and plan for Erosion and Sediment Control," and I also authorize periodic on-site inspection by the Howard Soil Conservation District or their authorized agents, as are deemed necessary."
[Signature]
 Developer
 10-18-72
 Date

"I certify that this plan for erosion and sediment control represents a practical and workable plan based on my personal knowledge of the site conditions and that it was prepared in accordance with the requirements of the Howard Soil Conservation District."
[Signature]
 Alexander P. Ratych
 10/3/72
 Date

DEPARTMENT OF PUBLIC WORKS
[Signature]
 CHIEF BUREAU OF HIGHWAYS
 12/30/72
 DATE

[Signature]
 CHIEF, DIVISION OF LAND DEVELOPMENT
 & TRANSPORTATION PLANNING
 12/20/72
 DATE

STORM DRAINS
 ELK FOREST COURT
 MOUNT AUGUSTINE
 FIRST ELECTION DISTRICT
 HOWARD COUNTY, MARYLAND

SCALE PLAN 1" = 50' PROFILE HOR. 1" = 50' VERT. 1" = 5'
 SHEET 3 OF 3

OWNER & DEVELOPER
 W.A. MARTIN ASSOCIATES, INC.
 10 WARRINGTON DRIVE
 SILVER SPRING, MARYLAND