

SHEET INDEX	
SHEET NO.	DESCRIPTION
1	LOCATION MAP
2	DAYSTAR COURT - Street Grades, Storm Drain & Paving Plan
3	NIGHTMIST COURT - Street Grades, Storm Drain & Paving Plan
4	PAVING DETAILS
5	STORM DRAIN PROFILES, DETAILS, STRUCTURE & PIPE SCHEDULES
6	DRAINAGE AREA MAP

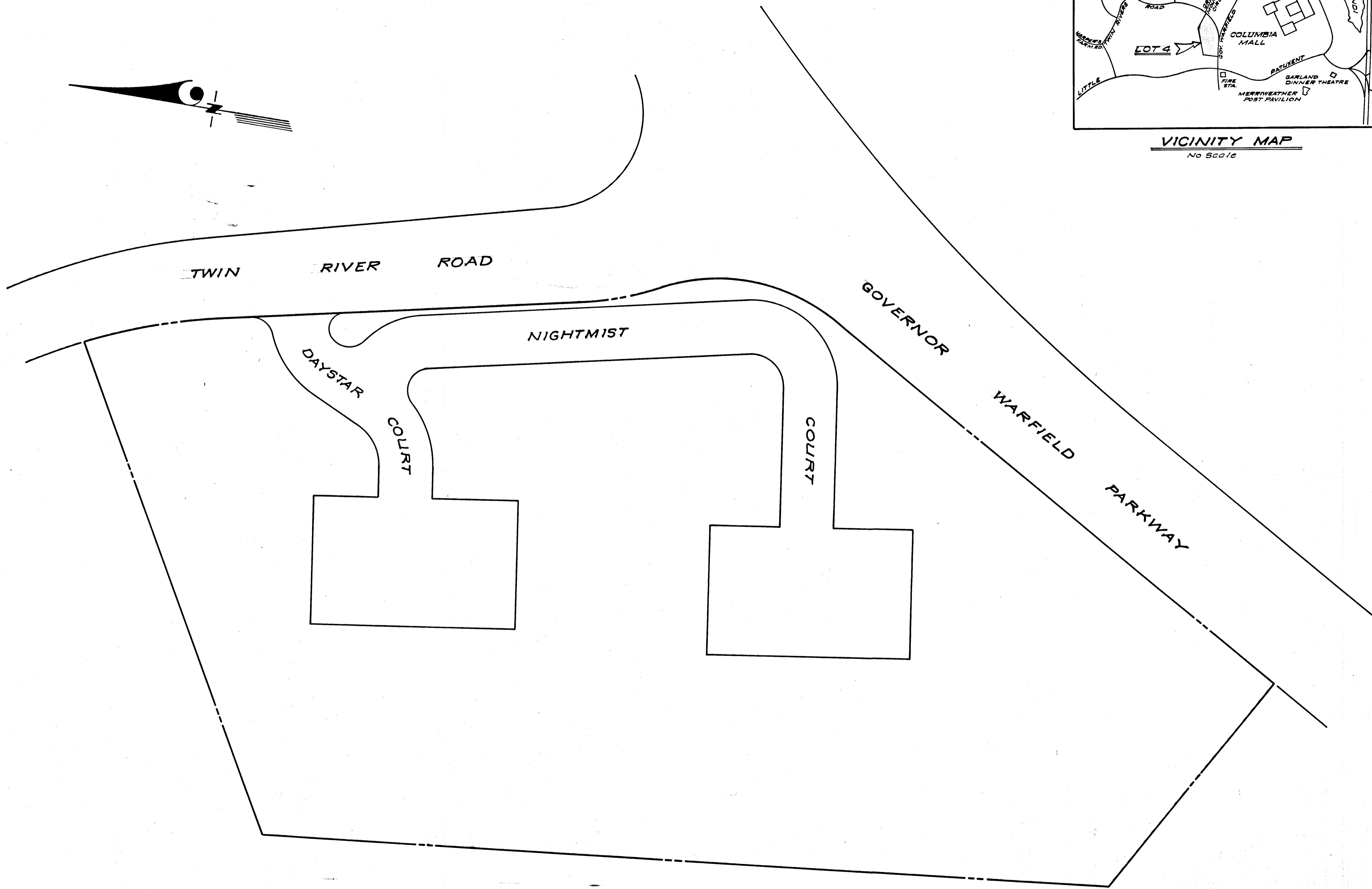

LOCATION PLAN
SCALE: 1" = 50'

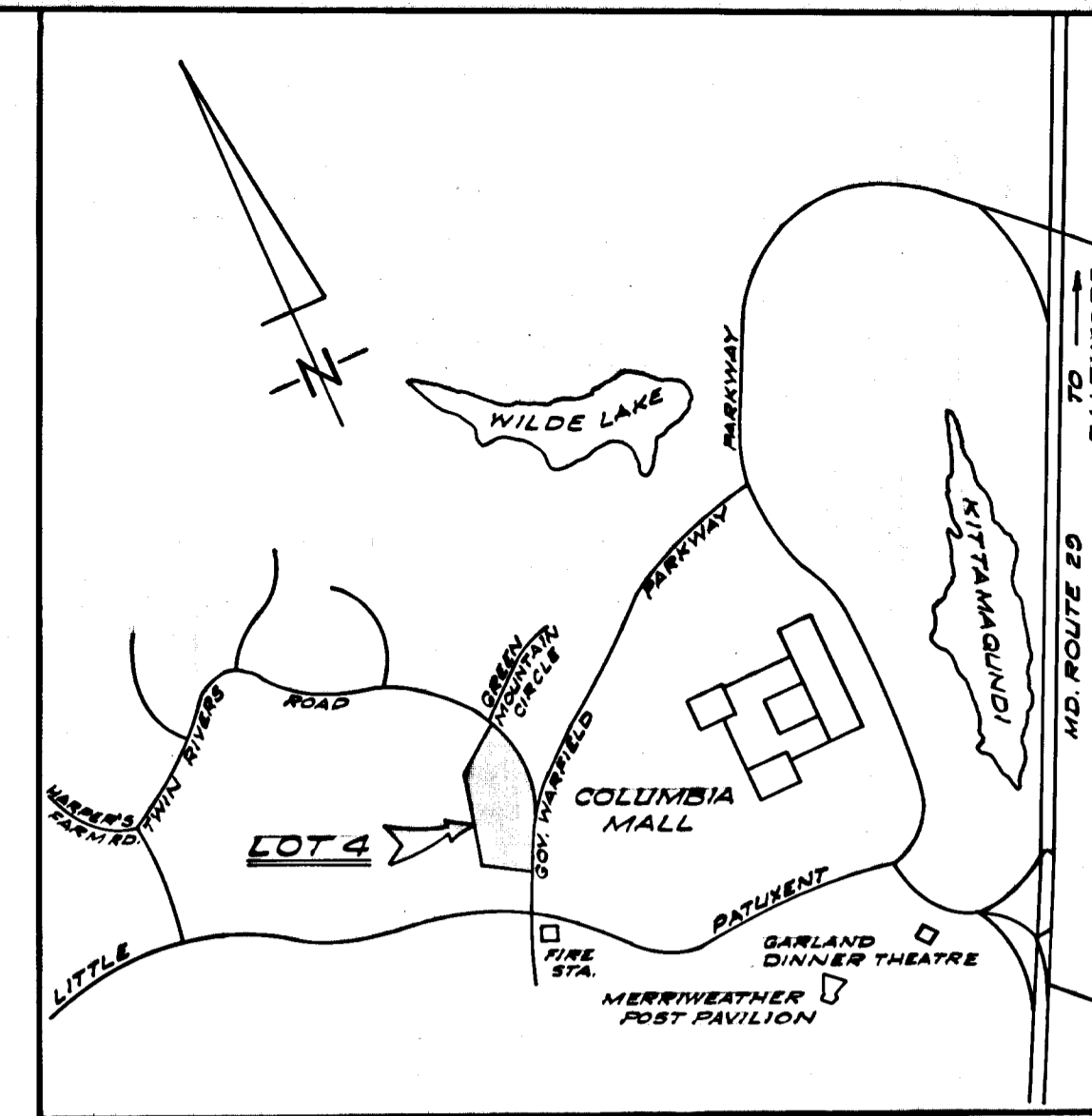

VICINITY MAP
No Scale

APPROVED: DEPARTMENT OF PUBLIC WORKS
S. M. McLeod 10/6/72
 Chief, Bureau of Highways DATE

APPROVED: HOWARD CO. OFFICE OF PLANNING & ZONING
J. H. Cleary 9/20/72
 CHIEF DIVISION OF LAND DEVELOPMENT AND TRANSPORTATION PLANNING DATE

COLUMBIA
 5TH ELECTION DISTRICT
 HOWARD COUNTY, MARYLAND
 OWNER AND DEVELOPER

RYLAND HOMES, COLUMBIA DIVISION
 Suite 200, V.O.M. Office Building
 Columbia, Maryland 20015

PROJECT: A Resubdivision of Lot No. 4
 VILLAGE OF WILDE LAKE
 SECTION 10 AREA 4

PROJECT TITLE: STORM DRAIN & PAVING PLAN
 LOCATION PLAN

Des. By: D.A.B.	Scale: As Shown	Dwg. No: 1 of 6
Drn. By: Suzan	Date: May, 1972	C.C.F. No:
Chk. By: G.N.C.	Approved	1065-D

CLARK • FINEROCK & SACKETT
 ENGINEERS • PLANNERS • SURVEYORS
 1151 NEW HAMPSHIRE AVENUE • SILVER SPRING, MARYLAND 20904

GENERAL NOTES

1. All storm drain and paving shall be constructed in accordance with the latest details and specifications of Howard County.
2. Types of Storm Drain Structures refer to the standard details of Howard County.
3. Trench compaction for storm drains within road or street right of way limits shall be in accordance with latest Howard County Road Code.
4. Information concerning underground utilities was obtained from available records, but the Contractor must determine the exact location and elevation of the mains by digging test pits by hand at all utility crossings, well in advance of construction.
5. All utility companies shall be notified 24 hours in advance of construction.
6. Design speed equals 25 m.p.h. on all streets.
7. All roof drains shall be connected to storm drainage system.

APPROVED
 DIVISION OF LAND DEVELOPMENT
 AND TRANSPORTATION PLANNING
 HOWARD COUNTY, MARYLAND
 DATE 9/7/72



S. Nelson Clark
 6-16-72

PLAN
 SURVEYED
 PLOTTED
 CHECKED
 DATE

PROFILE
 SURVEYED
 PLOTTED
 CHECKED
 DATE

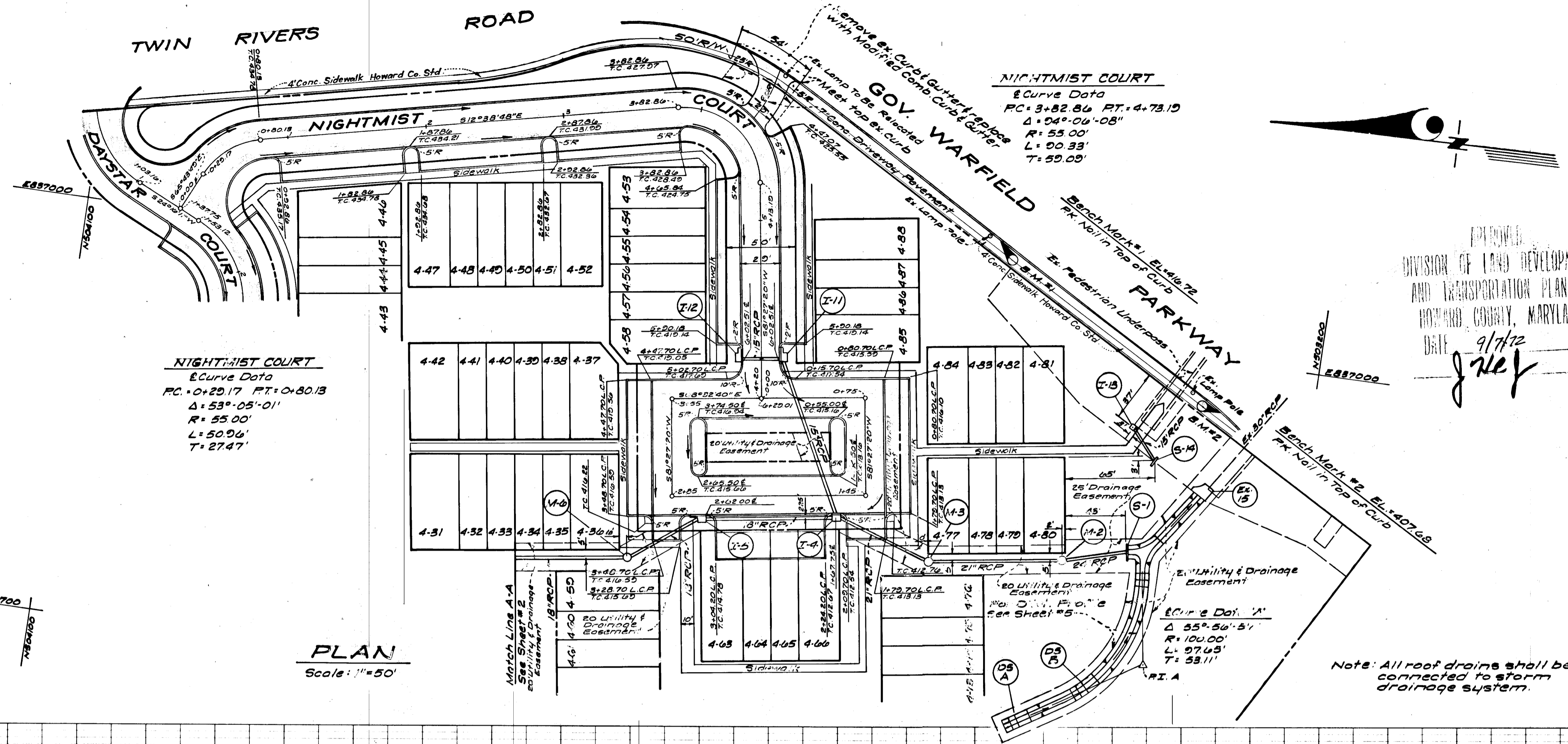

PLAN
 Scale: 1"=50'

Note: All roof drains shall be connected to storm drainage system.

APPROVED: DEPARTMENT OF PUBLIC WORKS
B. M. ... 10/6/72
 Chief, Bureau of Highways DATE

APPROVED: HOWARD CO. OFFICE OF PLANNING & ZONING

CHIEF DIVISION OF LAND DEVELOPMENT & TRANSPORTATION PLANNING DATE

COLUMBIA
 5TH ELECTION DISTRICT
 HOWARD COUNTY, MARYLAND
 OWNER AND DEVELOPER
 RYLAND HOMES, COLUMBIA DIVISION
 Suite 200, V.O.M. Office Building
 Columbia, Maryland 20015

PROJECT: A Resubdivision of Lot No. 4
 VILLAGE OF WILDE LAKE
 SECTION 10 AREA 4

PROJECT TITLE: STORM DRAIN & PAVING PLAN
 NIGHTMIST COURT

Des. By D.A.B.	Scale: As Shown	Dwg. No. 3 of 6
Drn. By Suzan	Date: May, 1972	C.C.F.N.?
Chk. By G.N.C.	Approved	1065-D

CLARK • FINEPROCK & SACKETT
 ENGINEERS • PLANNERS • SURVEYORS
 11161 NEW HAMPSHIRE AVENUE • SILVER SPRING, MARYLAND 20904

LEGEND

Existing ground @ 45' Left

Existing ground @ 45' Right

Proposed Profile grade

NIGHTMIST COURT

PROFILE

LINEAR CURB PROFILE

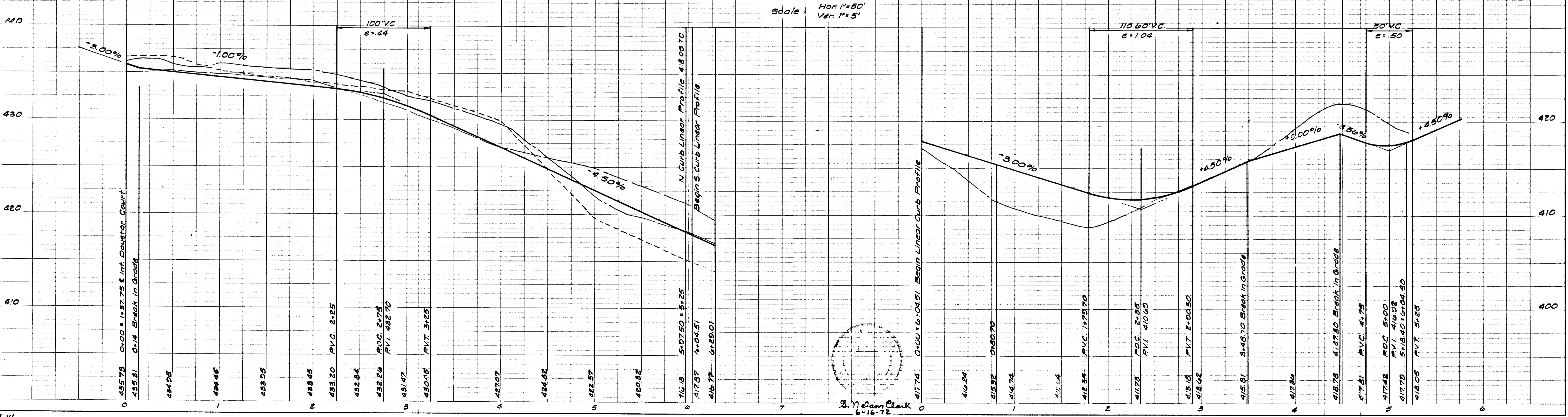

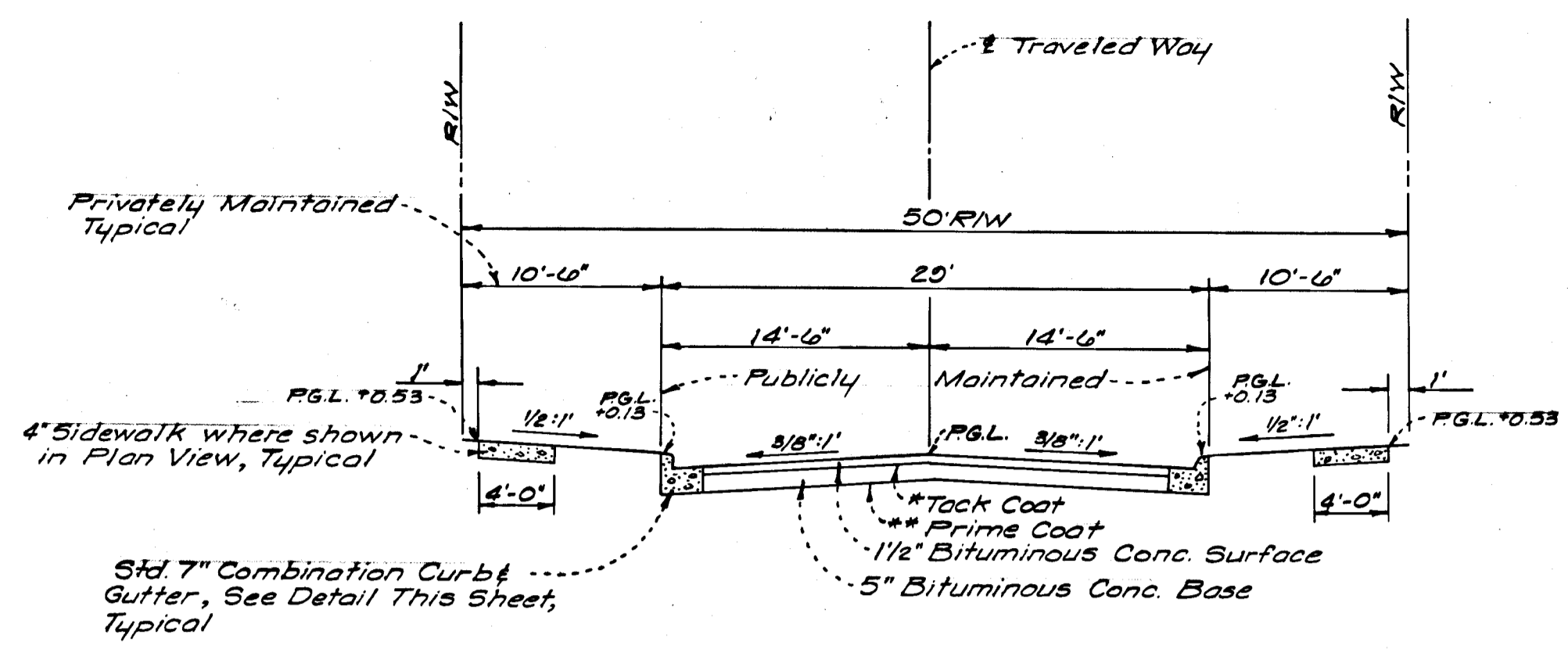

TYPICAL SECTION - 50' RIGHT OF WAY

NO PARKING

- *Tack Coat 5" Base Course in accordance with Howard County Std. Specs. Sect. C-31-4.
- **Prime Coat Ex. Subbase in accordance with Howard County Std. Specs. Sect. C-30-3.

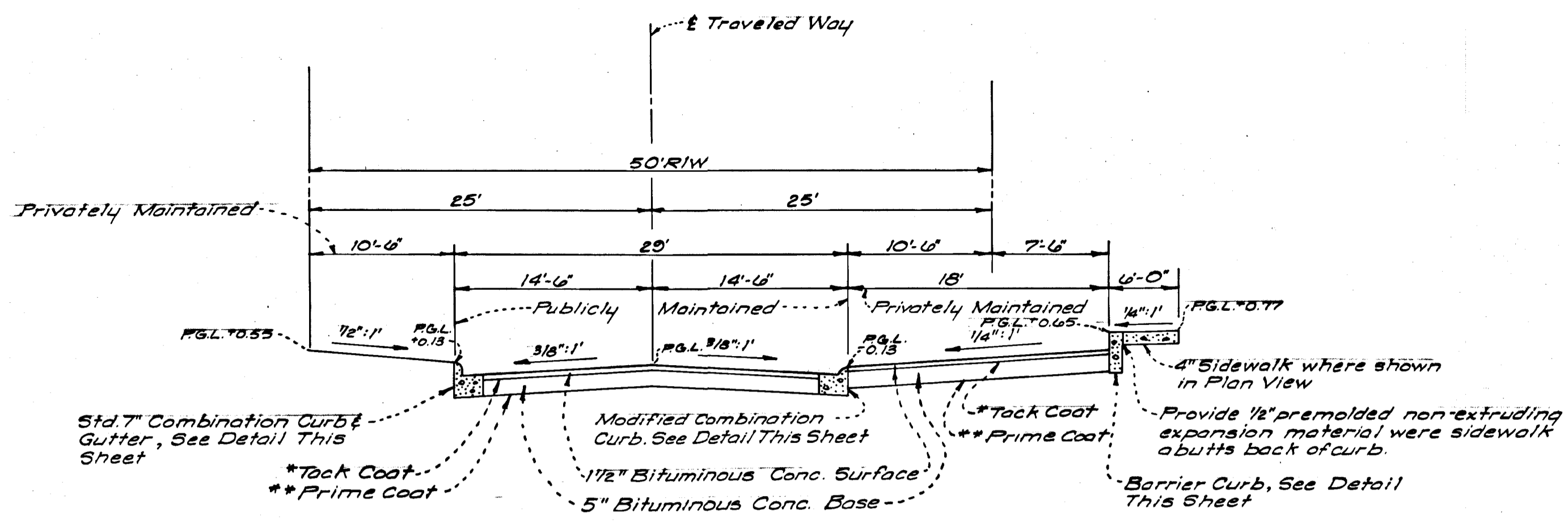

TYPICAL SECTION WITH PARKING AREAS

- *Tack Coat 5" Base Course in accordance with Howard County Std. Specs. Sect. C-31-4.
- **Prime Coat Ex. Subbase in accordance with Howard County Std. Specs. Sect. C-30-3.

NOTE: Where Barrier Curbs is used in conjunction with Modified Combination Curb & Gutter (at parking islands adjacent to street), total vertical distance from gutter to top of curb will equal 7 3/16" or 0.60'.

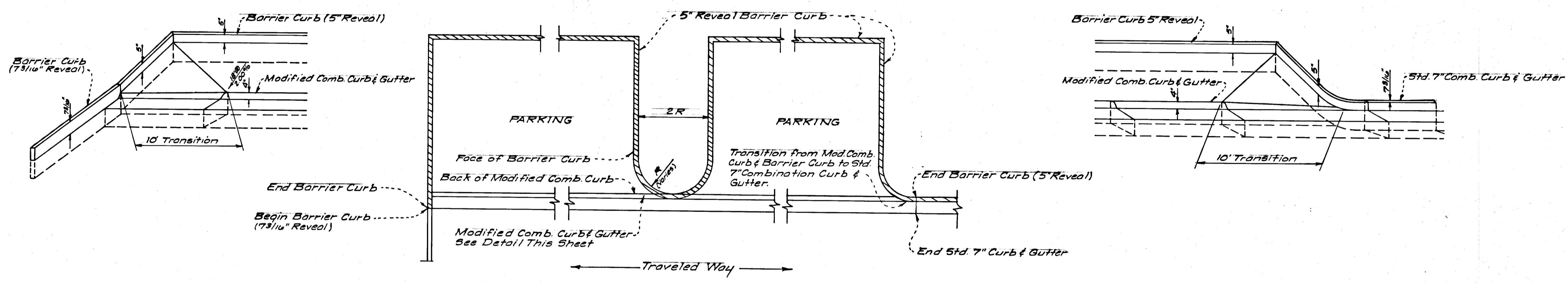

CURB & GUTTER DETAIL FOR PARKING AREAS

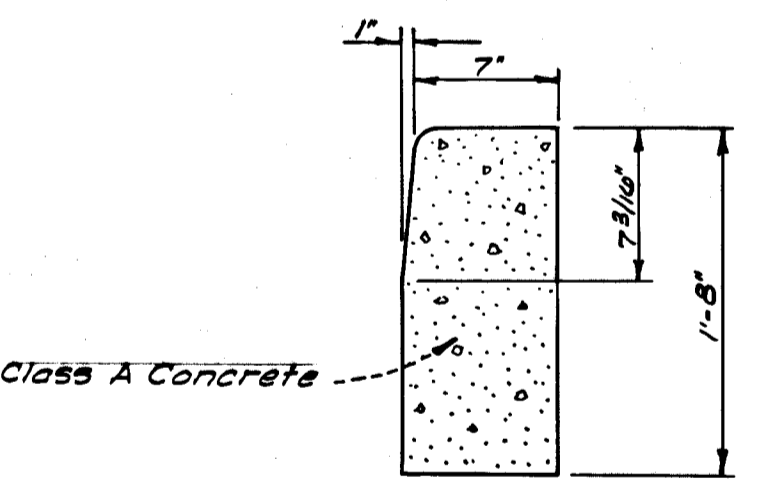

TYPICAL DETAIL BARRIER CURB (7 3/16" Reveal)

Howard Co. Std. Drawing #D-40 Pg. 05
Modify 5" Reveal to equal 7 3/16" Reveal.
No Scale

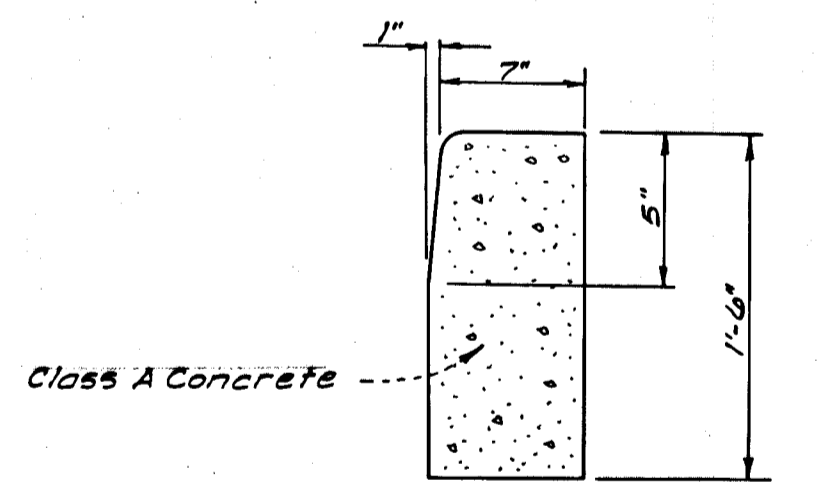

TYPICAL DETAIL BARRIER CURB (5" Reveal)

Howard Co. Std. Drawing #D-40 Pg. 05
No Scale

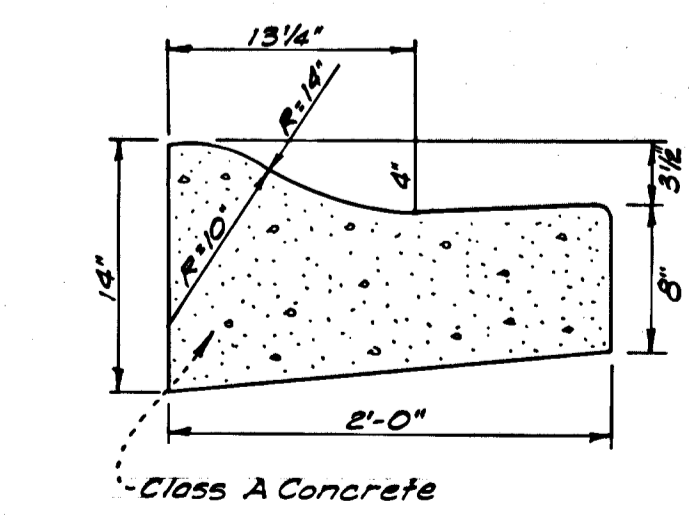

MODIFIED COMBINATION CURB & GUTTER

Howard Co. Std. Drawing #D-40 Pg. 05
No Scale

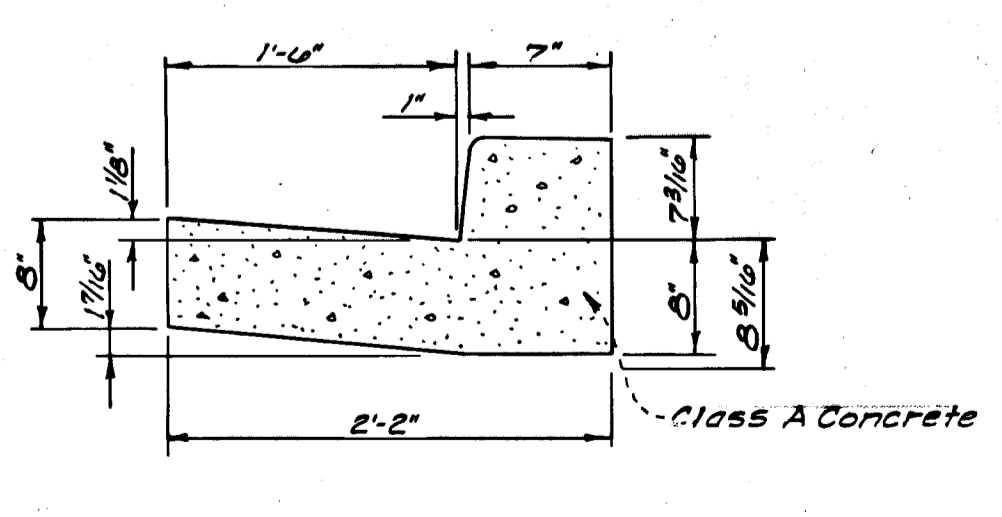

STD. 7" COMBINATION CURB & GUTTER

Howard Co. Std. Drawing #D-40 Pg. 05
No Scale

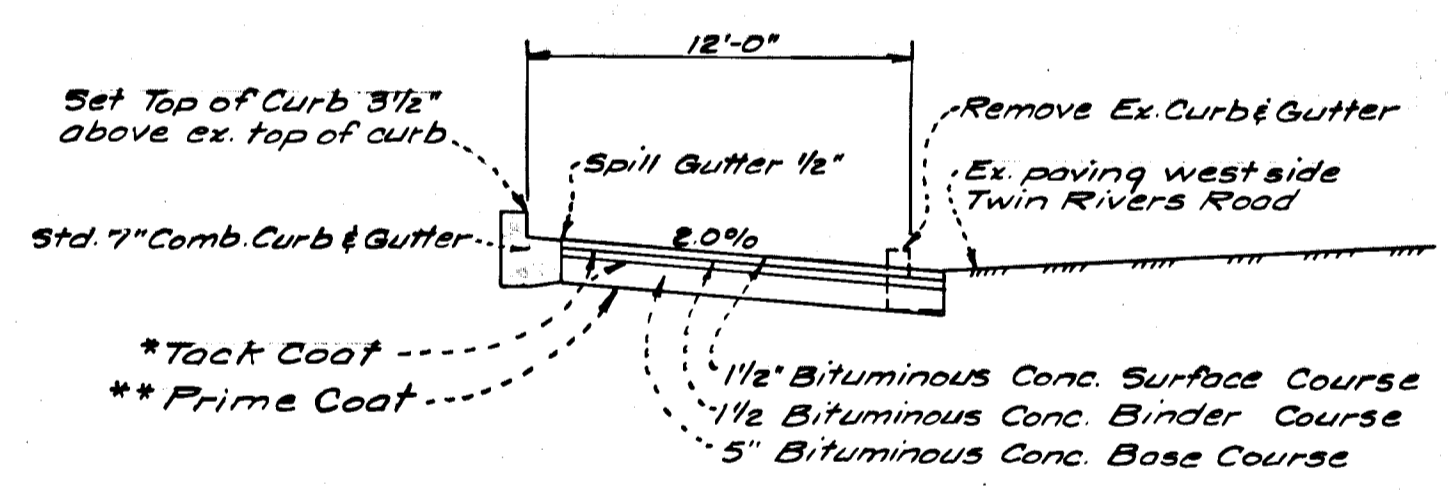

PAVING WIDENING SECTION AT DAYSTAR COURT & TWIN RIVERS ROAD

- *Tack Coat 5" Base & Binder Course in accordance with Howard County Std. Specs. Sect. C-31-4.
- **Prime Coat Ex. Subbase in accordance with Howard County Std. Specs. Sect. C-30-3.

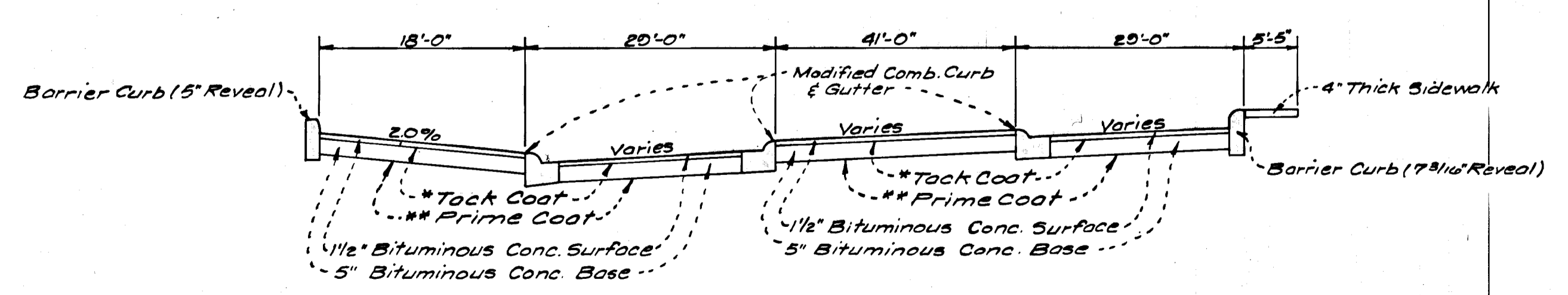

TYPICAL PAVING SECTION THRU COURT

- *Tack Coat 5" Base Course in accordance with Howard County Std. Specs. Sect. C-31-4.
- **Prime Coat Ex. Subbase in accordance with Howard County Std. Specs. Sect. C-30-3.

APPROVED: DEPARTMENT OF PUBLIC WORKS
S. M. Meheand 10/6/72
 Chief, Bureau of Highways DATE

APPROVED: HOWARD CO. OFFICE OF PLANNING & ZONING

CHIEF DIVISION OF LAND DEVELOPMENT & TRANSPORTATION PLANNING DATE

COLUMBIA
 5TH ELECTION DISTRICT
 HOWARD COUNTY, MARYLAND
 OWNER AND DEVELOPER
 RYLAND HOMES, COLUMBIA DIVISION
 Suite 200, V.O.M. Office Building
 Columbia, Maryland 20015

PROJECT: A Resubdivision of Lot No. 4
 VILLAGE OF WILDE LAKE
 SECTION 10 AREA 4

PROJECT TITLE: STORM DRAIN & PAVING PLAN
 DETAILS

Des. By D.A.B.	Scale: As Shown	Dwg. No. 4 of 6
Drn. By Suzan	Date: May, 1972	C.C.F.N. #
Chk. By G.N.C.	Approved	1065-D

CLARK • FINEROCK & SACKETT
 ENGINEERS • PLANNERS • SURVEYORS
 111 NEW HAMPSHIRE AVENUE • SILVER SPRING, MARYLAND 20910

APPROVED
 DIVISION OF LAND DEVELOPMENT
 AND TRANSPORTATION PLANNING
 HOWARD COUNTY, MARYLAND
 DATE 9/7/72
J. Noel

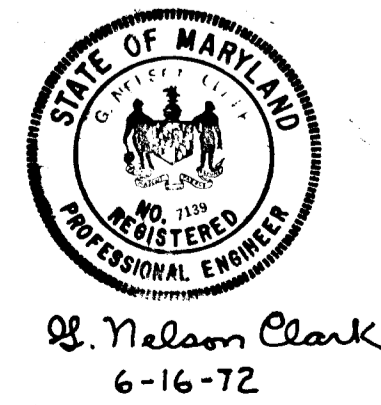

STRUCTURE SCHEDULE				
NO.	TYPE	TOP ELEV.		REMARKS
		UPPER	LOWER	
S-1	C-Endwall			See Sheet #5
M-2	A-Manhole	402.10		Howard Co. Std. 48" Round
M-3	A-Manhole	410.05		" " " "
I-4	A-5 Inlet	412.00	412.00	Howard Co. Std. W=4'-6"
I-5	B-10 Inlet	414.90	414.44	" " " " W=4'-6"
M-6	B-Manhole	417.10		Howard Co. Std. 4'x4'
M-7	B-Manhole	421.20		" " " " 4'x4'
I-8	A-5 Inlet	424.00	424.00	Howard Co. Std. W=4'-6"
I-9	S-Combination	425.70	425.40	" " " "
I-10	B-10 Inlet	428.50	428.00	Howard Co. Std. W=2'-6"
I-11	B-10 Inlet	418.50	418.12	" " " " W=4'-6"
I-12	B-10 Inlet	418.50	418.12	Howard Co. Std. W=2'-6"
I-13	S-Inlet	395.40		" " " " Single Gate
S-14	C-Endwall			" " " " Dia=15"

* Cast Manhole Frame in 8" top slab

APPROVED: DEPARTMENT OF PUBLIC WORKS
B. M. ... 10/6/72
 Chief, Bureau of Highways DATE
 APPROVED: HOWARD CO. OFFICE OF PLANNING & ZONING
 CHIEF DIVISION OF LAND DEVELOPMENT & TRANSPORTATION PLANNING DATE

COLUMBIA
 5TH ELECTION DISTRICT
 HOWARD COUNTY, MARYLAND
 OWNER AND DEVELOPER
 RYLAND HOMES, COLUMBIA DIVISION
 Suite 200, V.O.M. Office Building
 Columbia, Maryland 20015

PROJECT: A Resubdivision of Lot No. 4
 VILLAGE OF WILDE LAKE
 SECTION 10 AREA 4

PROJECT TITLE: STORM DRAIN & PAVING PLAN
 STORM DRAIN PROFILES & STRUCTURE & PIPE SCHEDULES

Des. By D.A.B. Scale: As Shown Dwg. No. 5 of 6
 Dwn. By Suzon Date: May, 1972 C.C.F.N.
 Chk. By G.N.C. Approved 1065-D

CLARK - HINEBROCK & SACKETT
 ENGINEERS - PLANNERS - SURVEYORS
 111 NEW HAMPSHIRE AVENUE SILVER SPRING, MARYLAND 20904

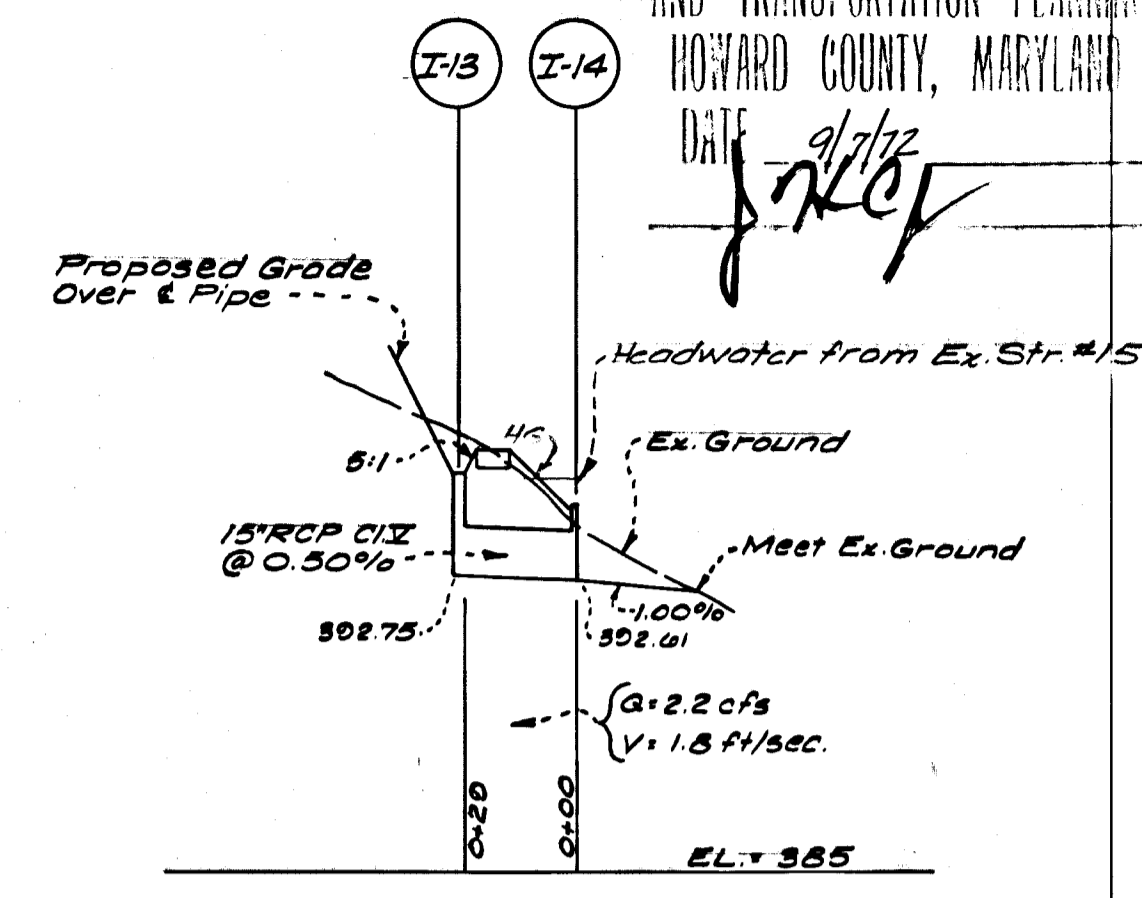
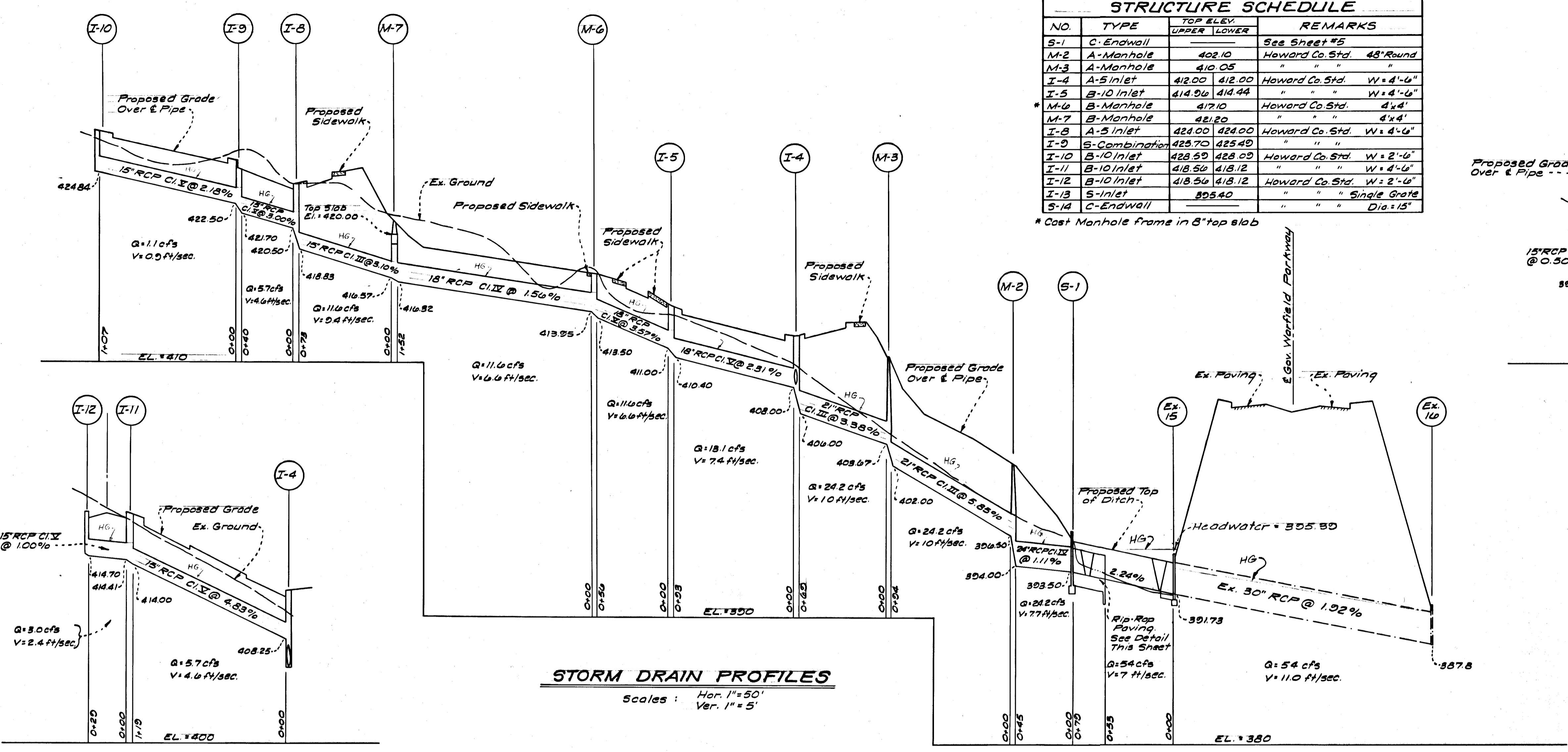

PIPE SCHEDULE		
SIZE	TYPE	LENGTH
15"	RCP CL. III	73'
15"	RCP CL. IV	324'
18"	RCP CL. IV	152'
18"	RCP CL. V	149'
2"	RCP CL. III	162'
24"	RCP CL. IV	45'

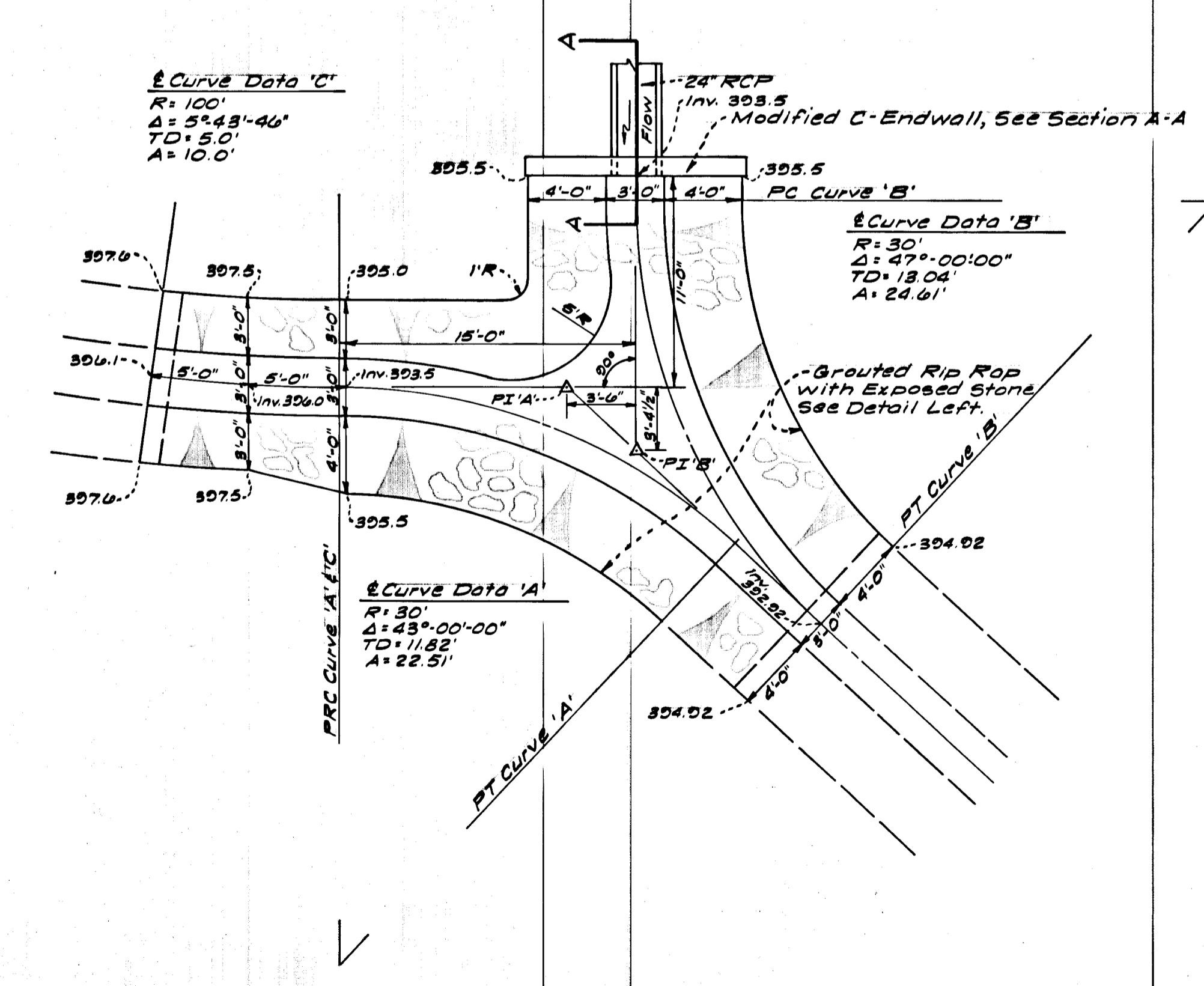
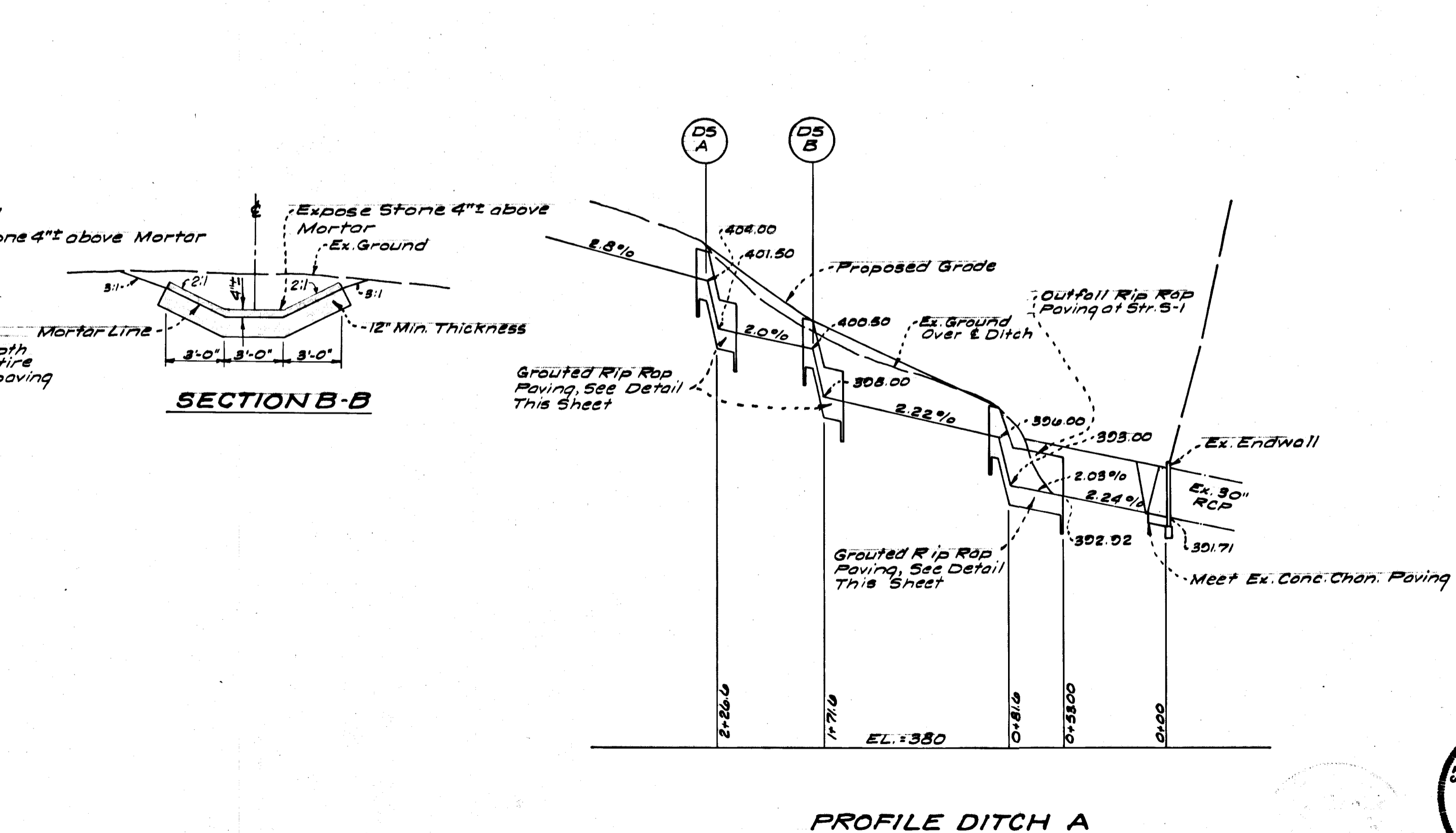
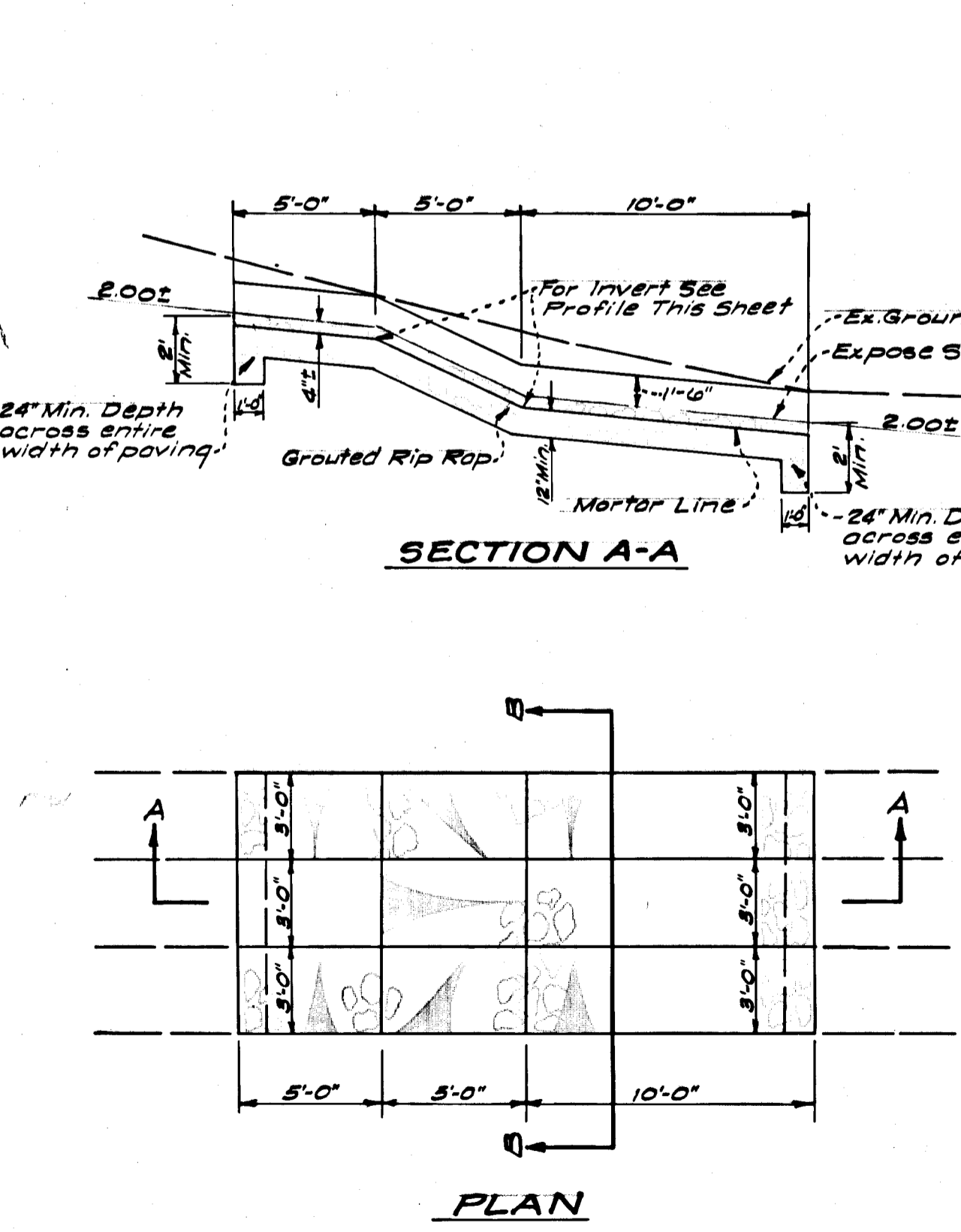

STATE OF MARYLAND
 REGISTERED PROFESSIONAL ENGINEER
 G. M. Clark
 6-16-72

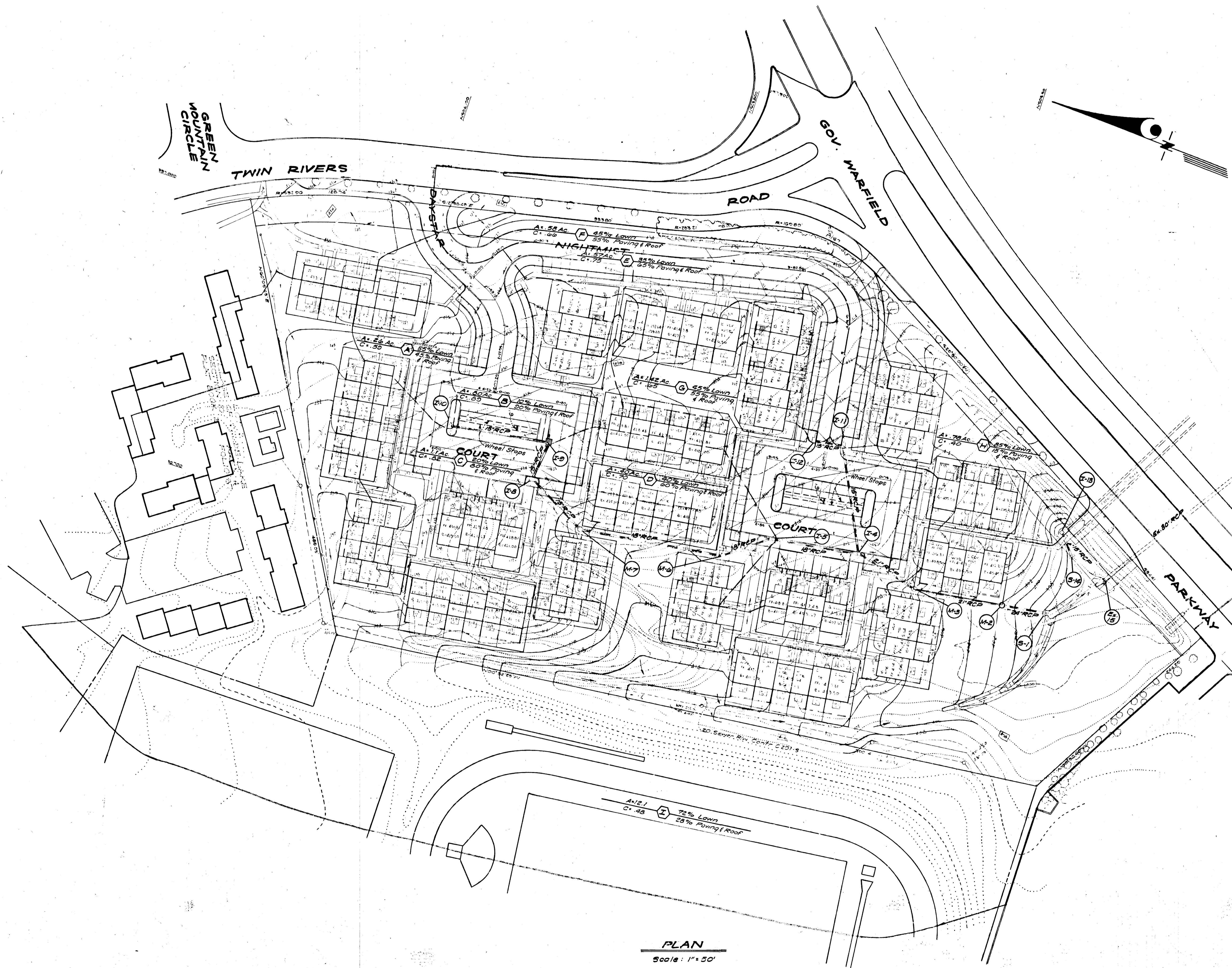

PLAN
Scale: 1" = 50'

APPROVED: DEPARTMENT OF PUBLIC WORKS
B. N. Melcand 10/6/72
 Chief, Bureau of Highways DATE

APPROVED: HOWARD CO. OFFICE OF PLANNING & ZONING
 CHIEF DIVISION OF LAND DEVELOPMENT & TRANSPORTATION PLANNING DATE

COLUMBIA
 5TH ELECTION DISTRICT
 HOWARD COUNTY, MARYLAND
 OWNER AND DEVELOPER
 RYLAND HOMES, COLUMBIA DIVISION
 Suite 200, V.O.M. Office Building
 Columbia, Maryland 20015
 PROJECT: A Resubdivision of Lot No. 4
 VILLAGE OF WILDE LAKE
 SECTION 10 AREA 4
 PROJECT TITLE: STORM DRAIN PAVING PLAN
 DRAINAGE AREA MAP

Des. By D.A.B.	Scale: As Shown	Dwg. No. of 6
Drn. By Suzan	Date: May, 1972	C.C.F. No.
Chk. By G.N.C.	Approved	1065-D

CLARK • FINEFROCK & SACKETT
 ENGINEERS • PLANNERS • SURVEYORS
 11161 NEW HAMPSHIRE AVENUE • SILVER SPRING, MARYLAND 20904

APPROVED
 DIVISION OF LAND DEVELOPMENT
 AND TRANSPORTATION PLANNING
 HOWARD COUNTY, MARYLAND
 DATE 9/7/72
[Signature]

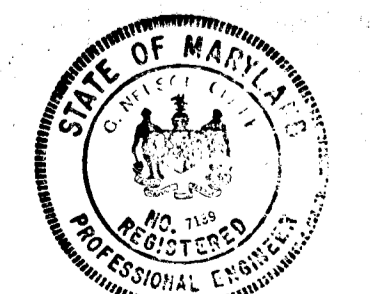

B. Nelson Clark
 6-16-72

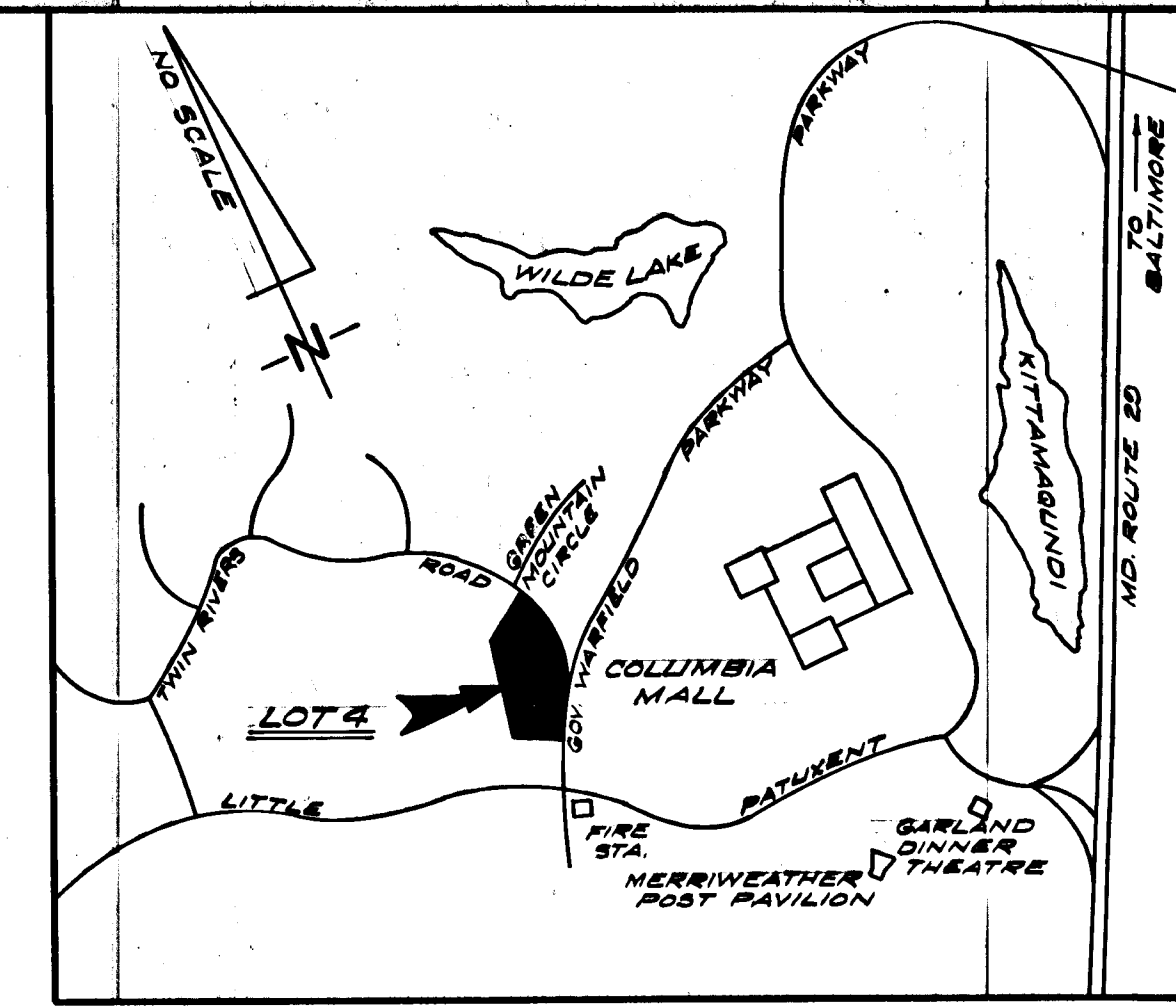

VICINITY MAP

GENERAL NOTES

1. Prior to any construction, sediment control practices will be installed & stabilized. See General Note #6.
2. Stabilization of disturbed ground to be done as soon after construction as possible.
3. All Sediment Control Practices to conform to the "Erosion & Sediment Control Technical Handbook" as published by the Howard Soil Conservation District. For details & dimensions not shown on this plan refer to this handbook.
4. Diversion Berms & Sediment Basins to be removed only after written approval from the Howard Conservation District has been obtained.
5. All Diversion Berms will be temporarily seeded with Rye Grass after installation.
6. All disturbed areas shall be finished graded to a slope of 3:1 or less; seed bed shall be prepared with 1 ton/ac. of ground agricultural limestone and 1/2 ton/ac. of 10-10-10 fertilizer; seeding shall be 3 lbs/1000 S.F. of 50-50 mixture of Kentucky Bluegrass and Creeping Red Fescue; and mulching shall be 1/2 tons/dc. of weed free grain straw.
7. Clean out of Sediment Basin shall be required when sediment reaches 6" below top of riser.

ENGINEER'S CERTIFICATE

I hereby certify that the plan of development and the plan for control of silt & erosion meet the requirements, standards and specifications of the Howard Soil Conservation District.

A. Nelson Clark
A. NELSON CLARK
6-20-72
Date



DEVELOPER'S CERTIFICATE

I hereby certify that all development and/or construction will be done according to this plan of development and plan of silt & sediment control.

Jack A. Call
Signature
6-20-72
Date

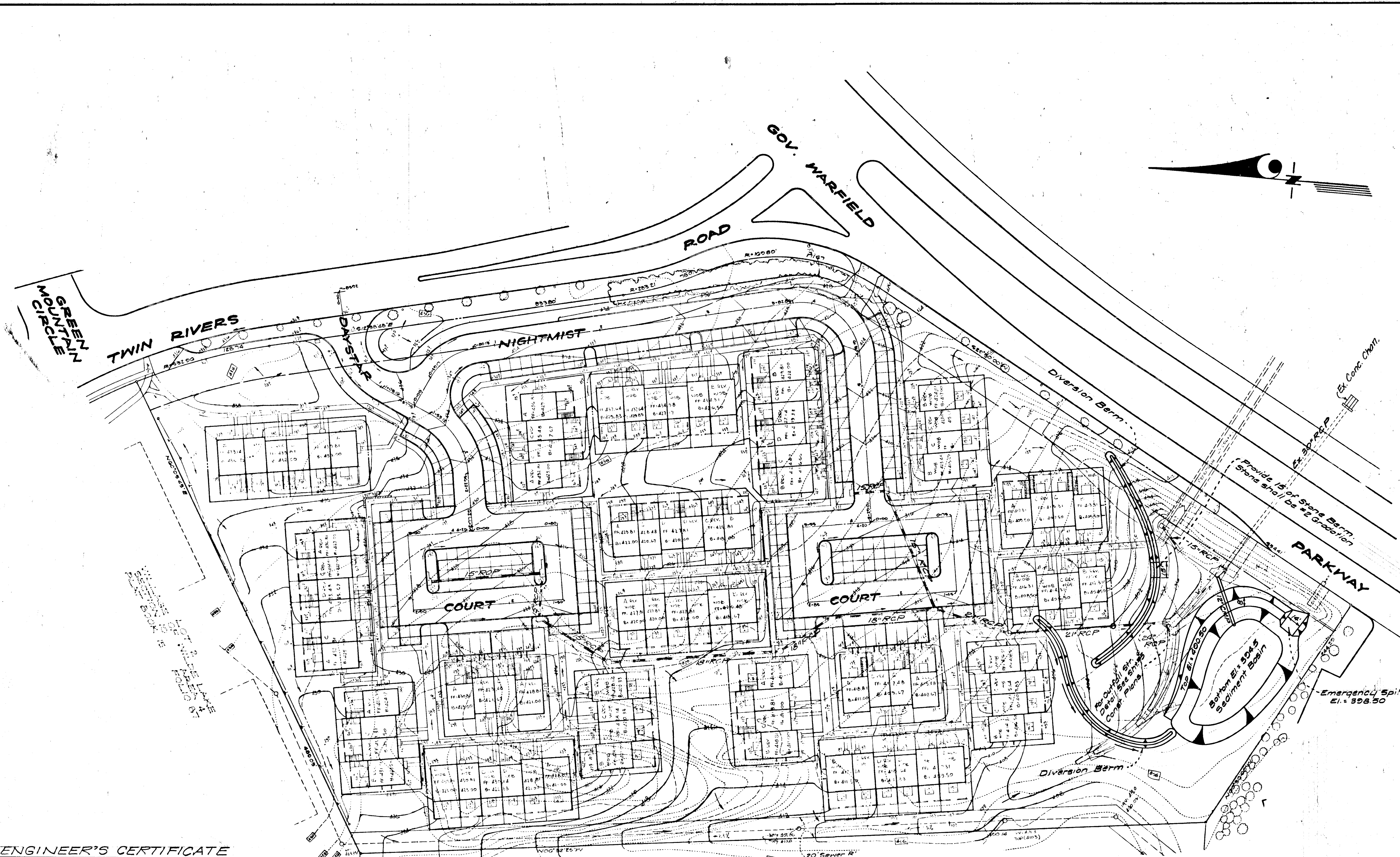

PLAN
Scale: 1" = 50'

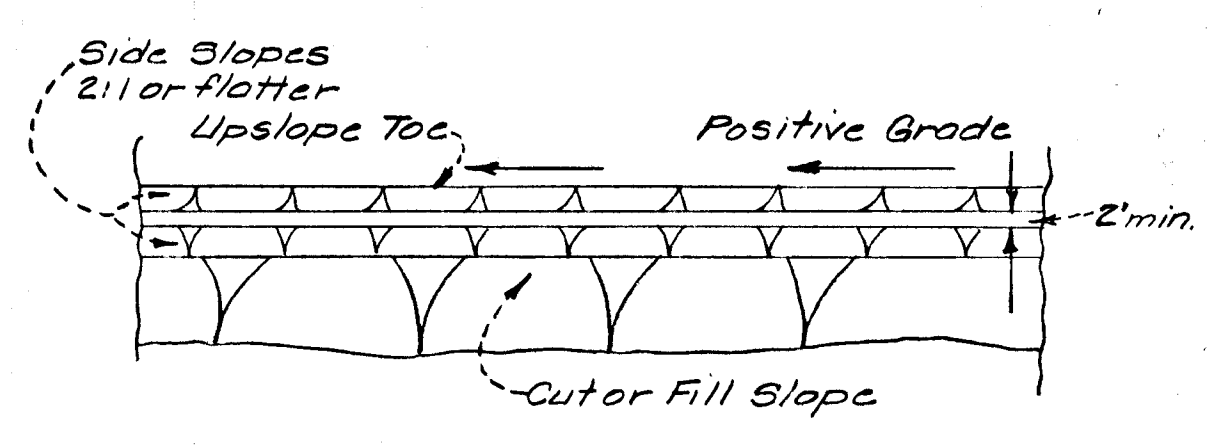
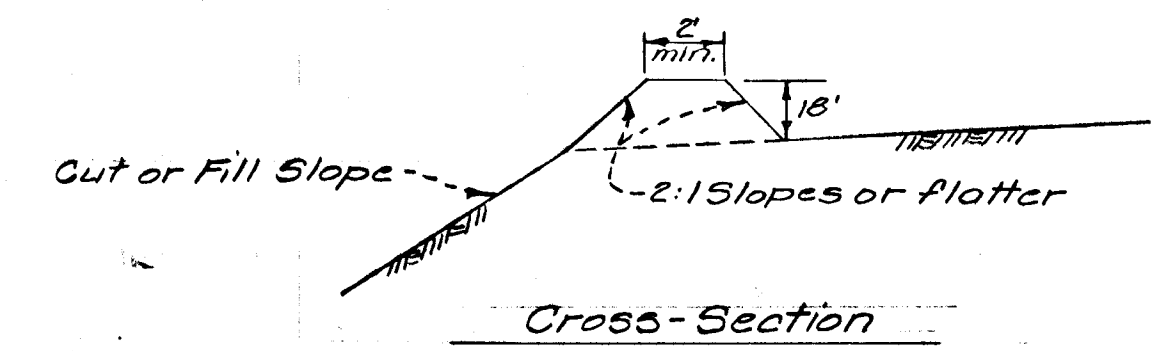

DIVERSION BERM
M.S.C.D. D.B.-1

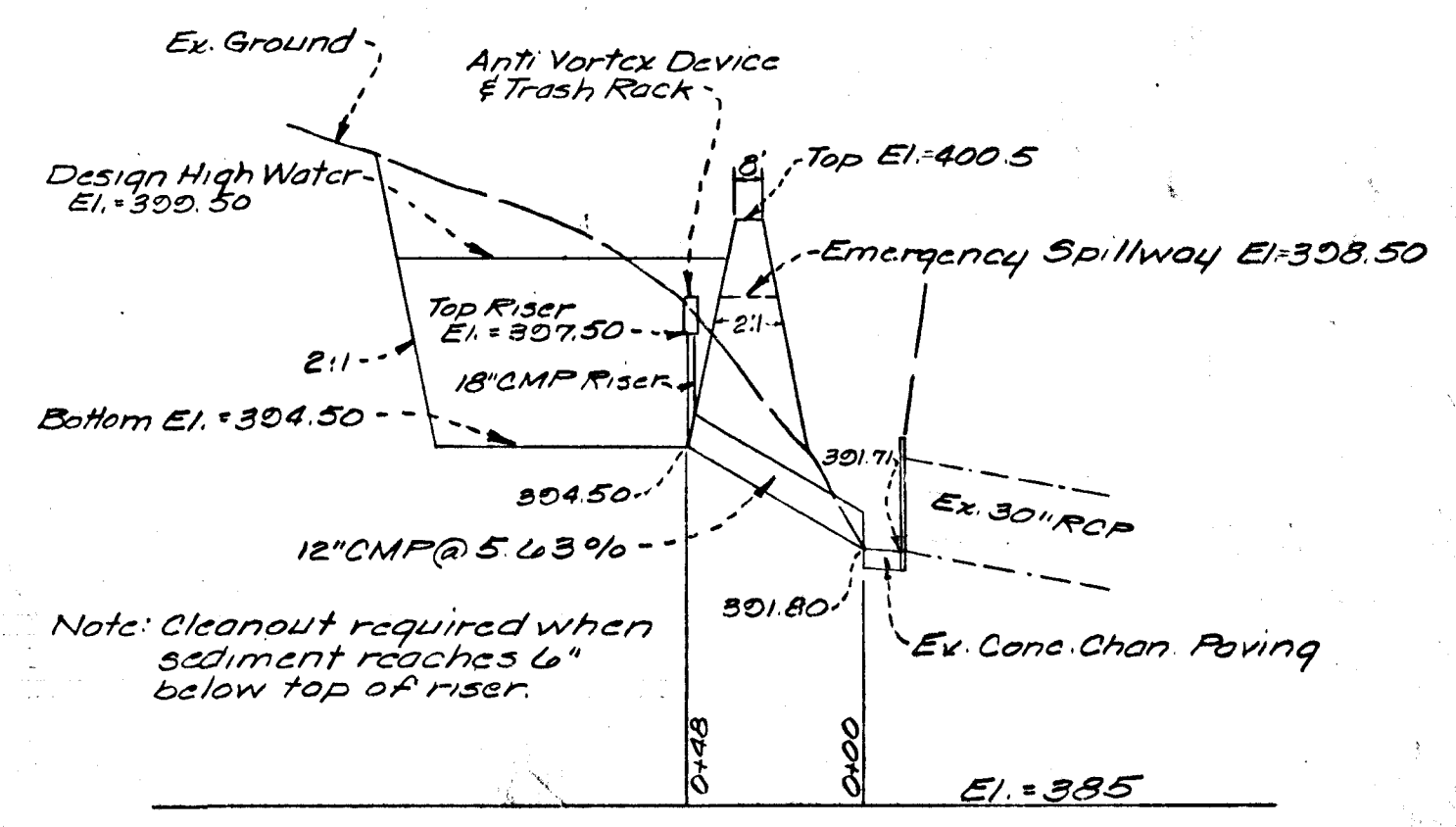

THIS DEVELOPMENT PLAN IS APPROVED FOR SOIL EROSION & SEDIMENT CONTROL BY THE HOWARD SOIL CONSERVATION DISTRICT

REVIEWED: *James M. Nelson* 9/28/72
DISTRICT CONSERVATIONIST DATE

APPROVED: *Robert W. Zichner* 9/28/72
HOWARD SOIL CONSERVATION DISTRICT DATE

CLARK • FINEFROCK & SACKETT ENGINEERS • PLANNERS • SURVEYORS 11161 NEW HAMPSHIRE AVENUE • SILVER SPRING, MARYLAND 20904 • (301) 593-3400		
DESIGNED D.A.B.	SEDIMENT & EROSION CONTROL PLAN A Resubdivision of Lot 4 COLUMBIA VILLAGE OF WILDE LAKE SECTION 10 AREA 4 5TH ELECTION DISTRICT HOWARD COUNTY, MARYLAND	SCALE As Shown DRAWING 10'1 JOB NO. 72-485
DRAWN SUZON		
CHECKED G.N.C.		
DATE June 1972	FOR: RYLAND HOMES COLUMBIA DIVISION Suite 200 W. 14th Office Building Columbia, Maryland 21048	FILE NO. 1003-D