

DATE

OWNER & DEVELOPER
ELLICOTT CORPORATION
 The Rosslyn Building
 1901 N. Fort Myer Drive
 Arlington, Va.

PURDUM & UESFKE
 ENGINEERS
 LAND SURVEYORS
 1023 N. CALVERT ST.
 BALTIMORE CITY
 MARYLAND

DEPARTMENT OF PUBLIC WORKS

B. A. Ireland 3/14/72
 Chief Bureau of Highway DATE

OFFICE OF PLANNING AND ZONING
J. H. Clavorn 3-10-72
 Chief, Division of Land Development and Transportation Planning DATE

PLAN & PROFILE RIDGE ROAD

SECTION 1
ELLICOTT CENTER

2ND ELECTION DISTRICT
 September 10, 1971
 HOWARD COUNTY, Md.
 SCALE AS SHOWN
 SHEET 2 OF 6

Key	Date	Revisions
▲	Oct. 10, 1971	Road Grade Revised

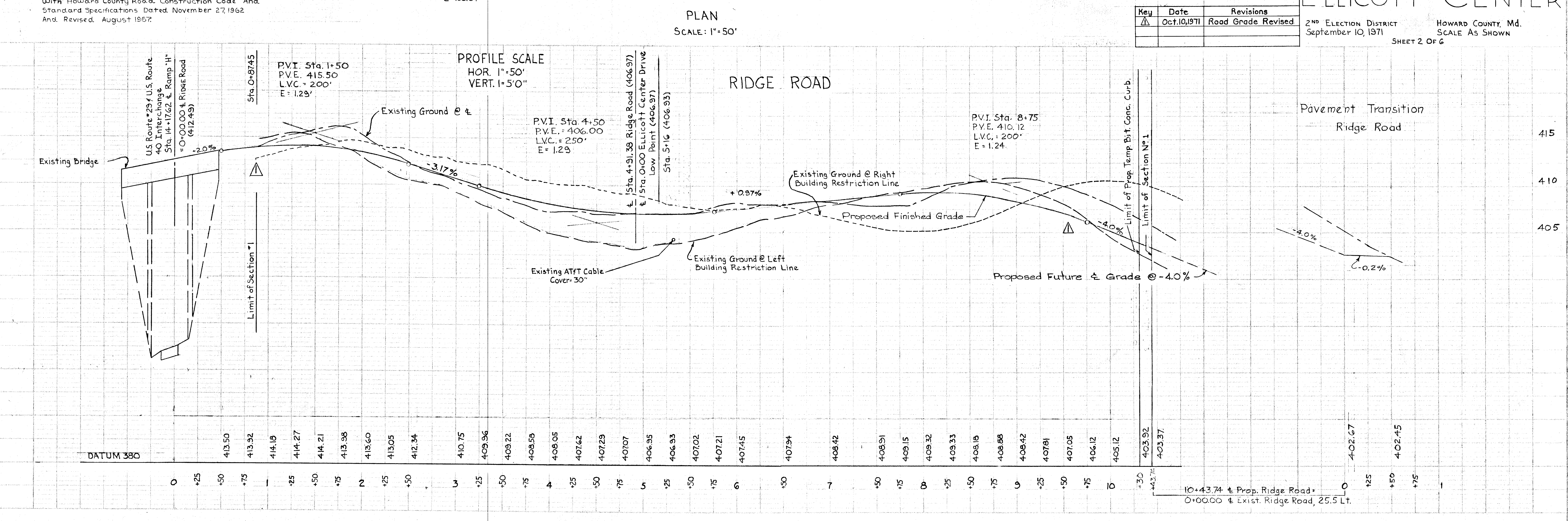
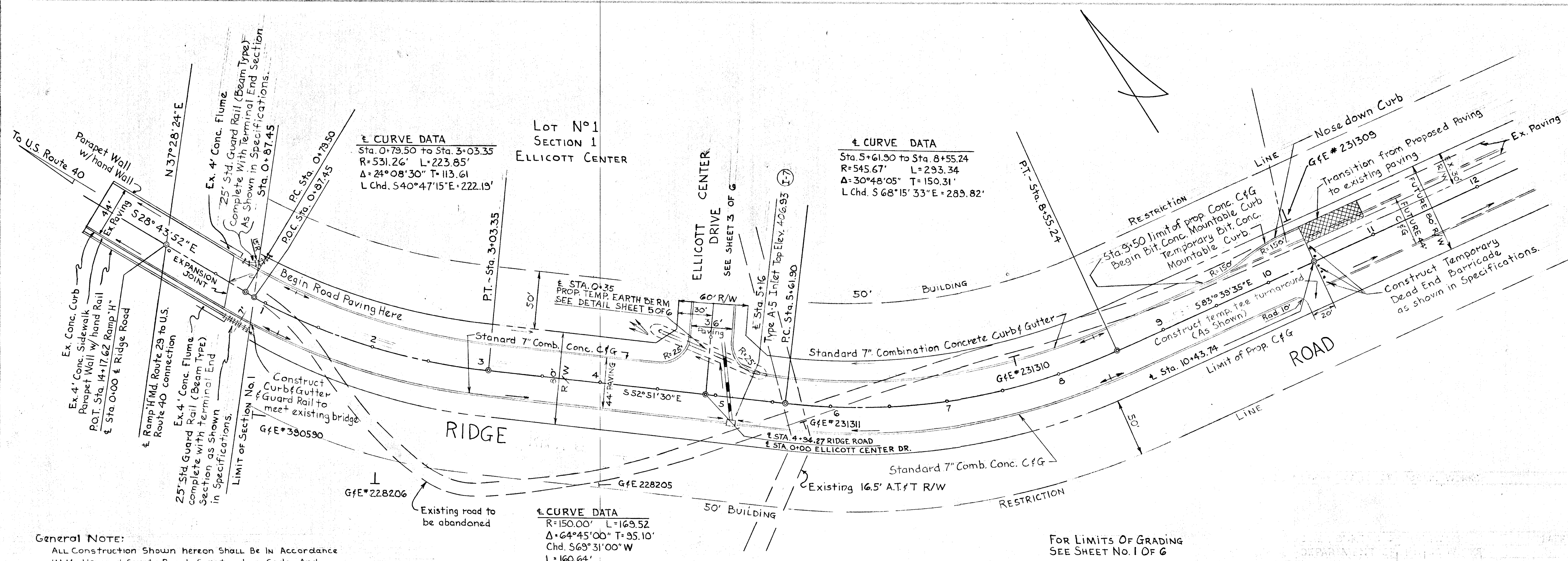

PLAN
 NOTE BOOK
 No. 10000

PROFILE
 NOTE BOOK
 No. 10000

RP250

F72-63

DEPARTMENT OF PUBLIC WORKS:
B. H. Mahand 3/14/72
 CHIEF, BUREAU OF HIGHWAYS DATE
 DEPARTMENT OF PUBLIC WORKS
 CHIEF, BUREAU OF WATER AND SEWER DATE:

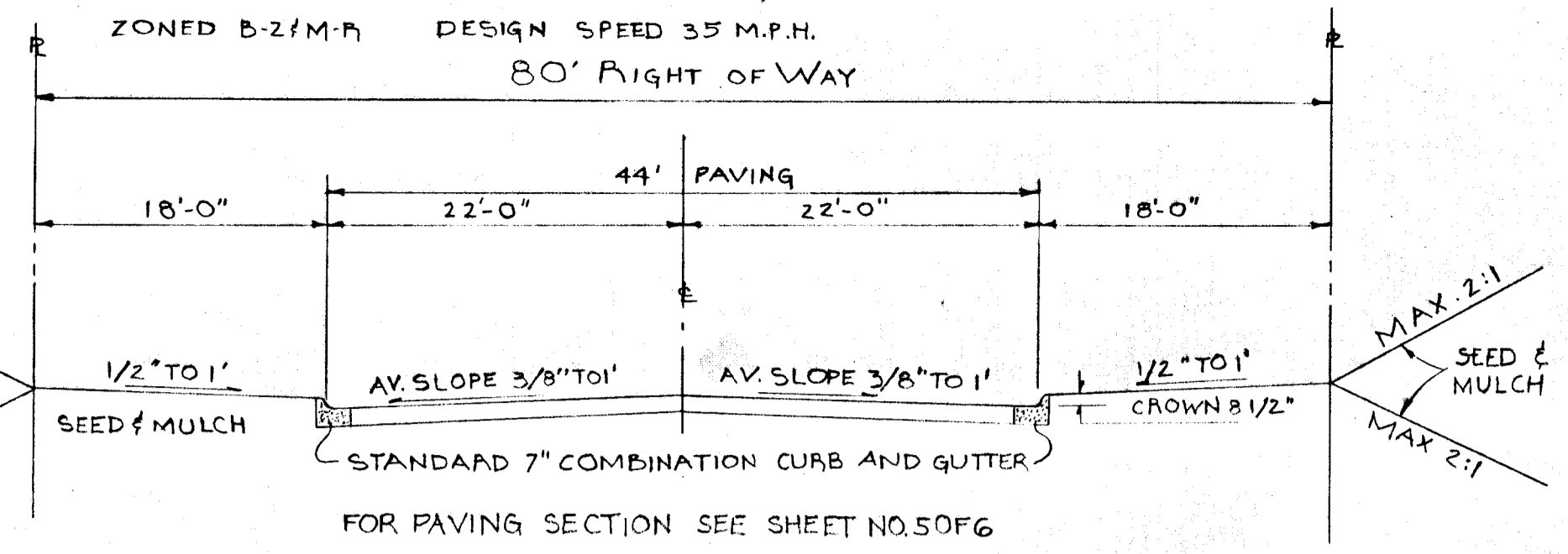

TYPICAL SECTION - 80' R/W WITH CURB AND GUTTER
 Sta. 0+00.00 to Sta. 10+43.74
 SCALE: 1"=10'

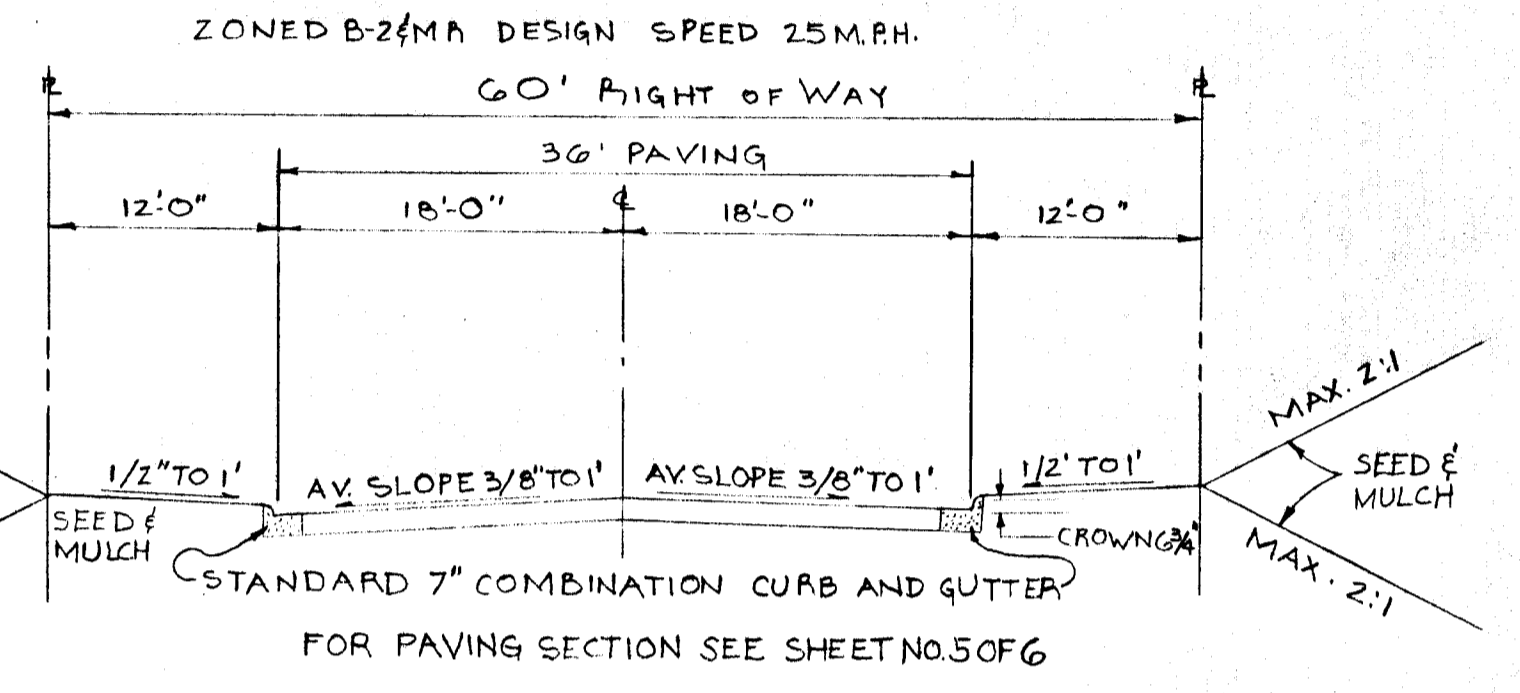

TYPICAL SECTION - 60' R/W WITH CURB AND GUTTER
 Sta. 0+00.00 to Sta. 7+24.47
 SCALE: 1"=10'

OWNER & DEVELOPER
 ELLICOTT CORPORATION
 THE HOSSLYN BUILDING
 1901 N. FORT MYER DRIVE
 ARLINGTON, VIRGINIA

PURDUM & JESCHKE ENGINEERS
 LAND SURVEYORS
 1023 N CALVERT STREET
 BALTIMORE MARYLAND

DEPARTMENT OF PUBLIC WORKS
B. H. Mahand 3/14/72
 Chief, Bureau of Highways
 OFFICE OF PLANNING AND ZONING

J. H. Clawson 3-10-72
 Chief, Division of Land Development and Transportation Planning
 Date

PLAN AND PROFILE ELLICOTT CENTER DRIVE

SECTION I
 ELLICOTT CENTER

2ND ELECTION DISTRICT HOWARD COUNTY, MD.
 SEPTEMBER 10, 1971 SCALE: AS SHOWN
 SHEET 3 OF 6

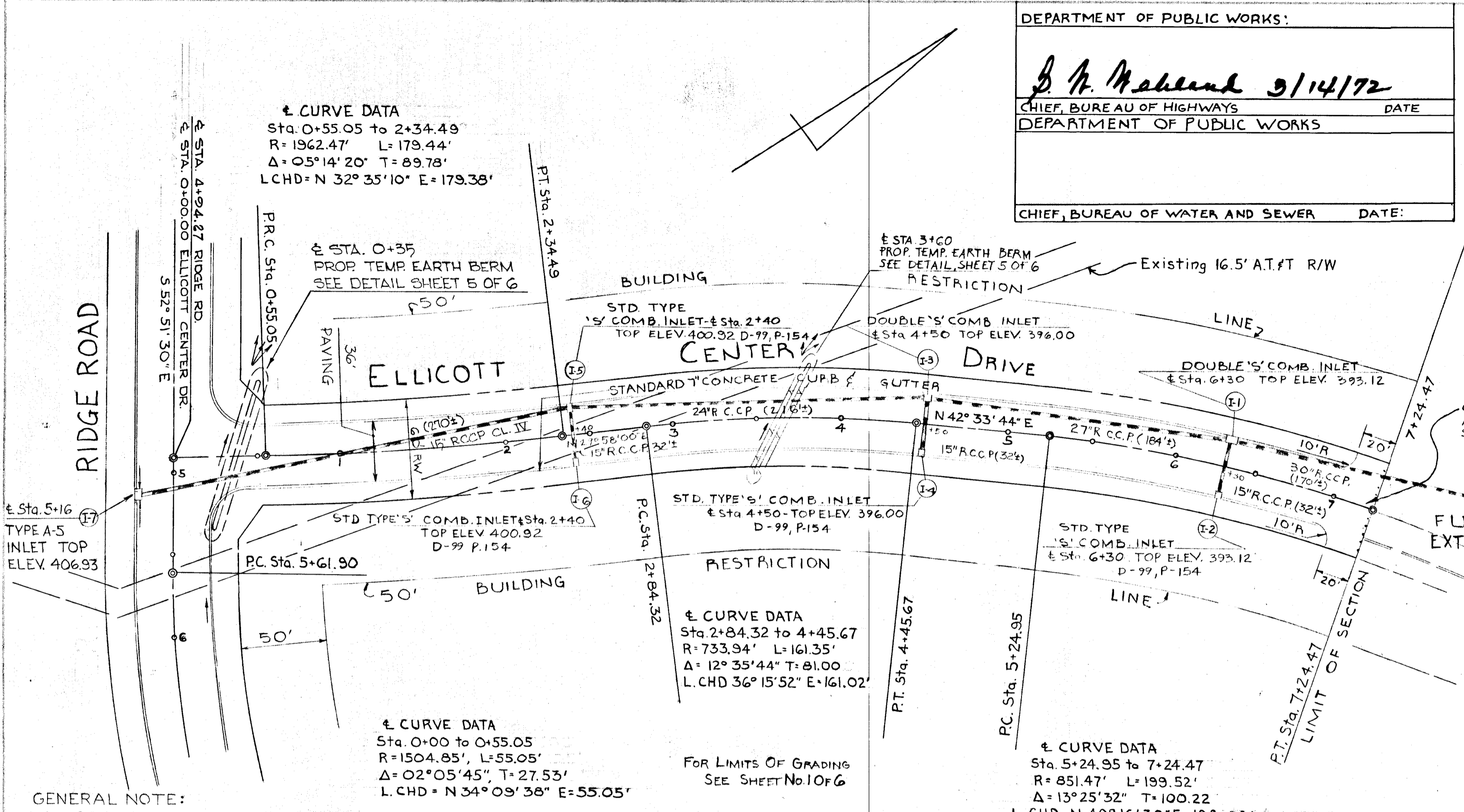

PLAN SCALE: 1"=50'

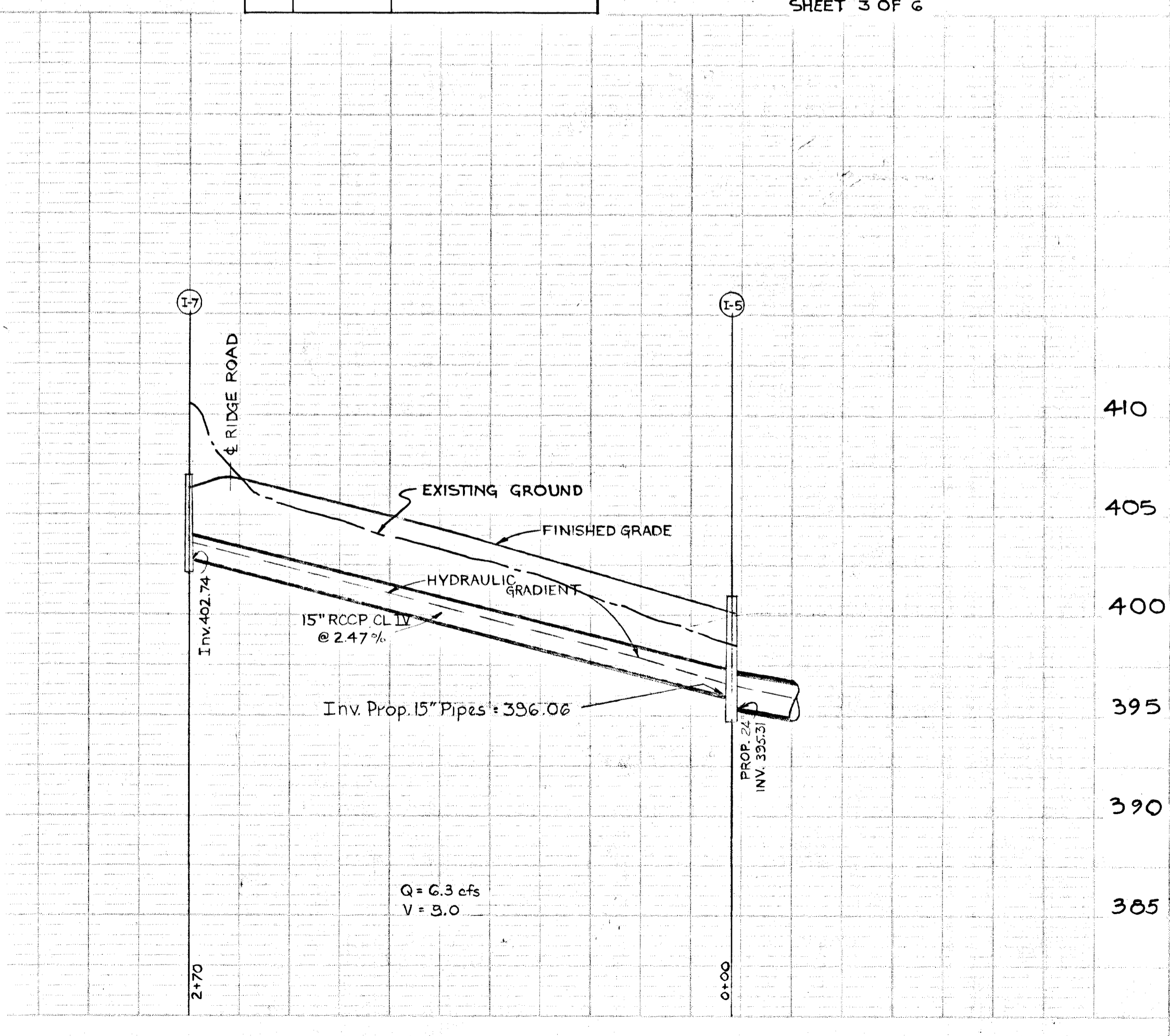
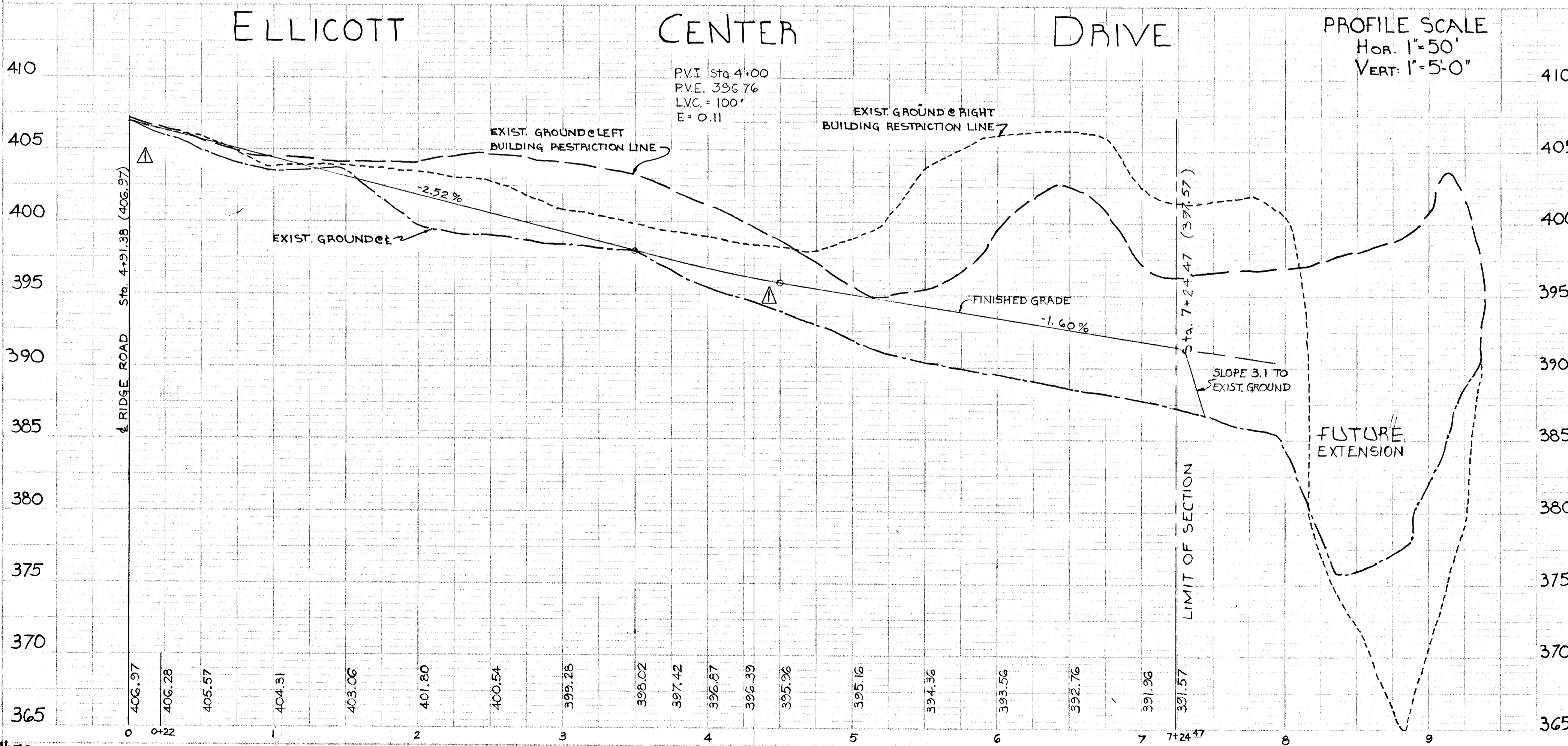

General Notes:
 ALL Construction Shown hereon Shall Be In Accordance
 With Howard County Road Construction Code And
 Standard Specifications Dated November 27, 1962 And
 Revised August 1967.

BENCH MARKS
 Bench Mark #31 Elev. 419.24
 Square Cut in Top North End of Concrete Curb
 Surrounding Grass Plot in Concrete Crossover
 105' W of E Intersection East Bound Lane Route 40
 Bench Mark #56 Elev. 551.88
 Northeast Bonnet Bolt Fire Hydrant Opposite
 #56 Rogers Avenue

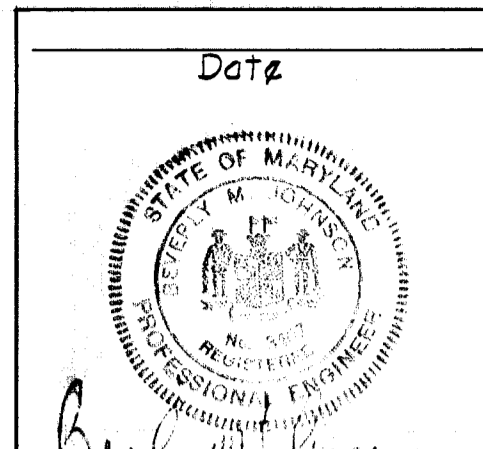

Owner & Developer
ELLICOTT CORPORATION
 The Rosslyn Building
 1901 N. Fort Myer Drive
 Arlington, Virginia

Engineer and Land Surveyors
PURDUM & JESCHKE
 1025 N. Calvert Street
 Baltimore, Maryland

DEPARTMENT OF PUBLIC WORKS

S. F. Wickham 3/14/72
 Chief, Bureau of Highways Date

J. H. Clavorn 3-10-72
 Chief, Division of Land Development and Transportation Planning Date

STORM DRAIN SHEET
 Section I
ELLICOTT CENTER
 2nd Election District Howard County, Maryland
 Scale As Shown Sheet No. 4 of 6

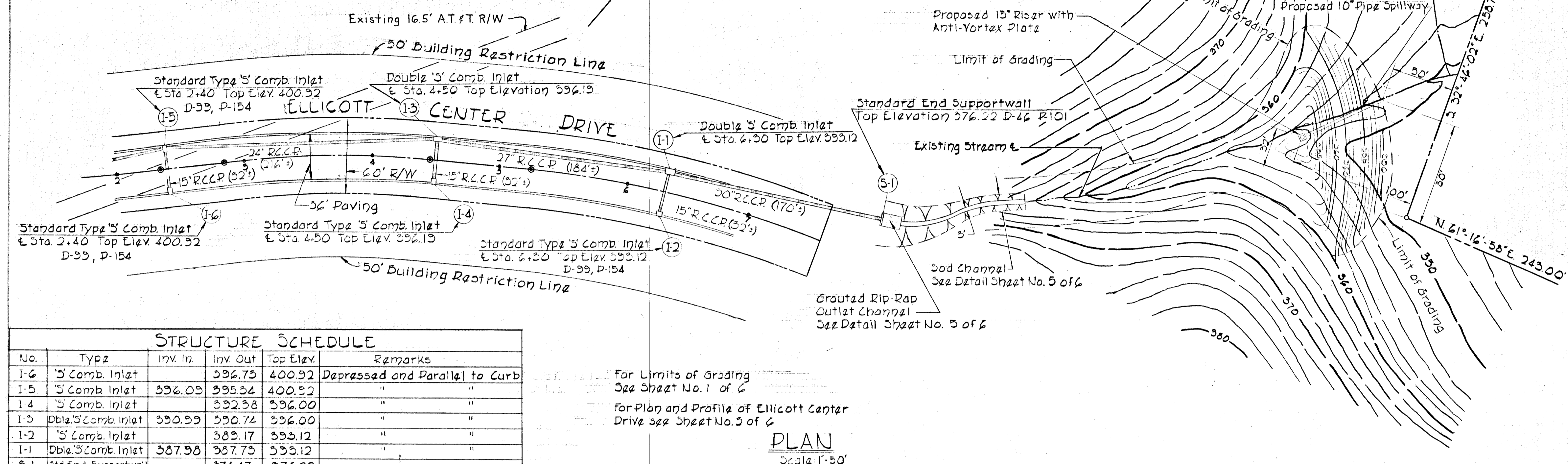

STRUCTURE SCHEDULE					
No.	Type	Invt. In.	Invt. Out.	Top Elev.	Remarks
I-6	'S Comb. Inlet	396.75	400.92	400.92	Depressed and Parallel to Curb
I-5	'S Comb. Inlet	396.09	395.34	400.92	"
I-4	'S Comb. Inlet	392.38	392.38	396.00	"
I-3	Dble.'S Comb. Inlet	390.99	390.74	396.00	"
I-2	'S Comb. Inlet	389.17	389.12	393.12	"
I-1	Dble.'S Comb. Inlet	387.98	387.73	393.12	"
S-1	Std. End Supportwall	374.47	376.22	376.22	"
I-7	Type A-E Inlet	402.74	406.95	406.95	"

For Limits of Grading
 See Sheet No. 1 of 6
 For Plan and Profile of Ellicott Center
 Drive see Sheet No. 5 of 6

PLAN
 Scale: 1"=50'

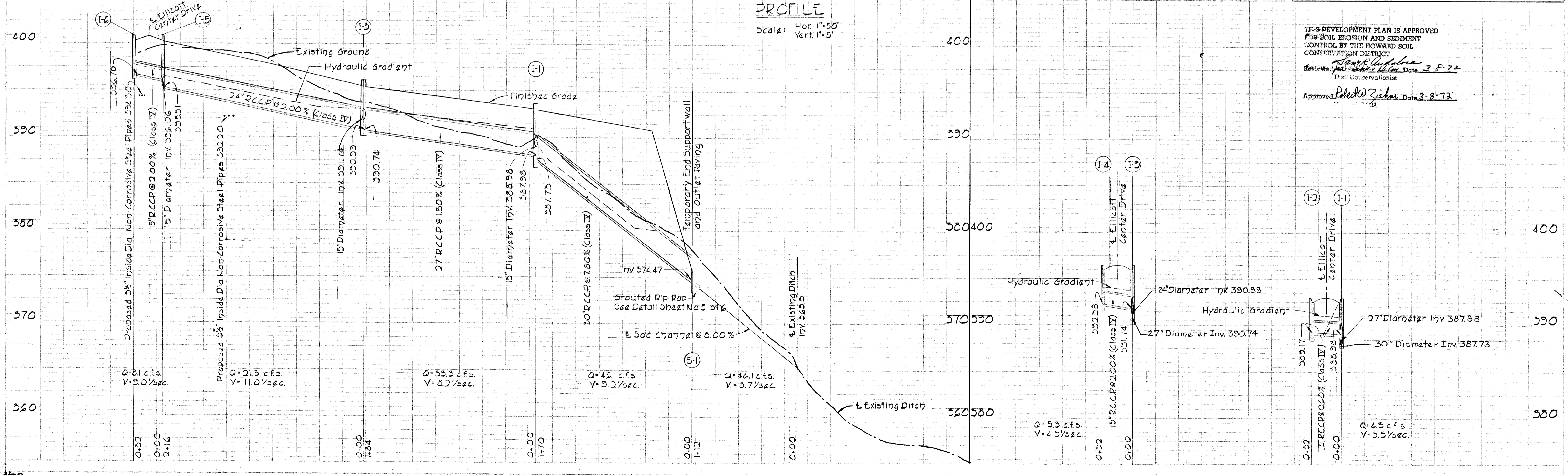

IF A DEVELOPMENT PLAN IS APPROVED
 FOR SOIL EROSION AND SEDIMENT
 CONTROL BY THE HOWARD SOIL
 CONSERVATION DISTRICT
 Approved: *Robert Ziehm* Date: 3-8-72
 District Conservationist

SEDIMENT CONTROL NOTES

1. The developer shall notify the Howard County Soil Conservation Service at least 24 hours prior to beginning any construction shown hereon.
2. Sediment control measure must be installed prior to grading operation.
3. All disturbed areas shall be stabilized by seeding and/or sodding in accordance with Standards and Specifications for Soil Erosion and Sediment Control in Urbanizing Areas for critical area stabilization immediately following earthwork operation.
4. The contractors shall provide temporary sediment control measures by means of earth berms and/or ditches along Ramp "H" sufficient to prevent sediment from reaching existing Storm Drainage Systems.
5. The contractor shall not begin any construction shown on these plans until an approved grading and sediment control plan has been placed on file with the Howard Soil Conservation District.

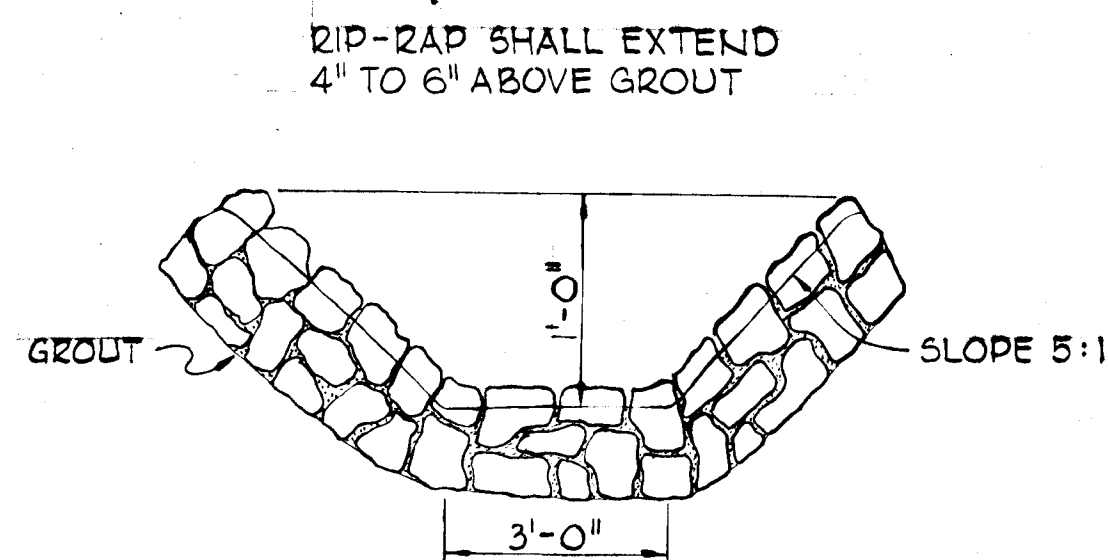

GRAOUTED RIP-RAP CHANNEL DETAIL

Not to Scale

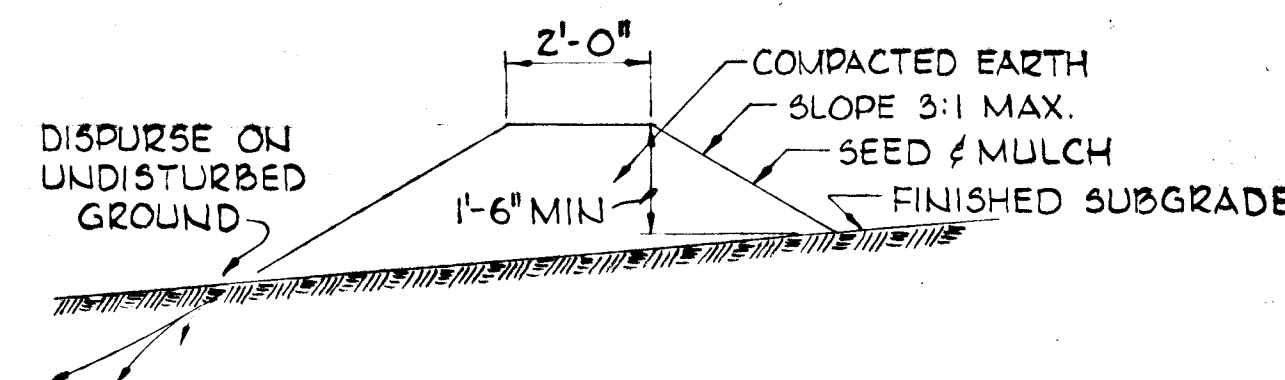
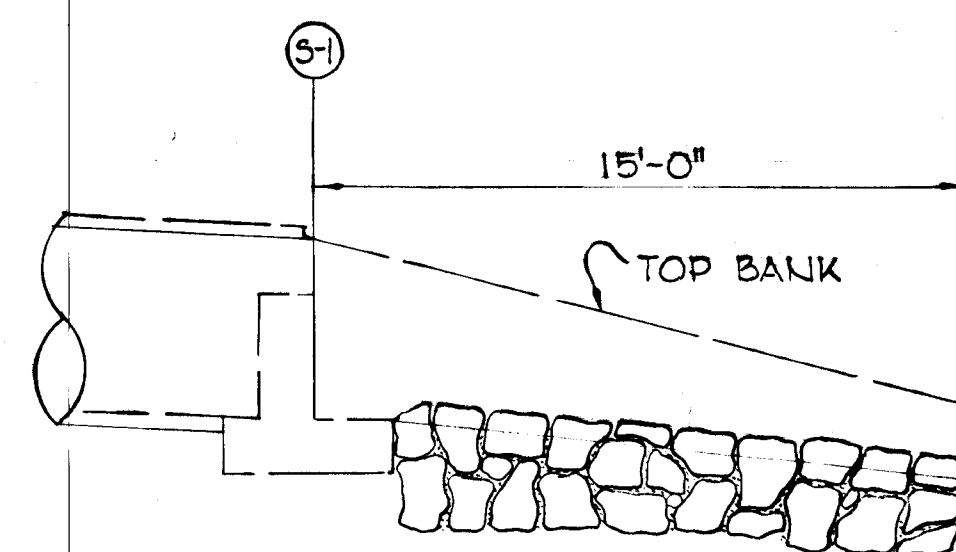

TEMPORARY EARTH BERM

Scale: 1/8" = 1'-0"

FUTURE E GRADE @ 4.0%

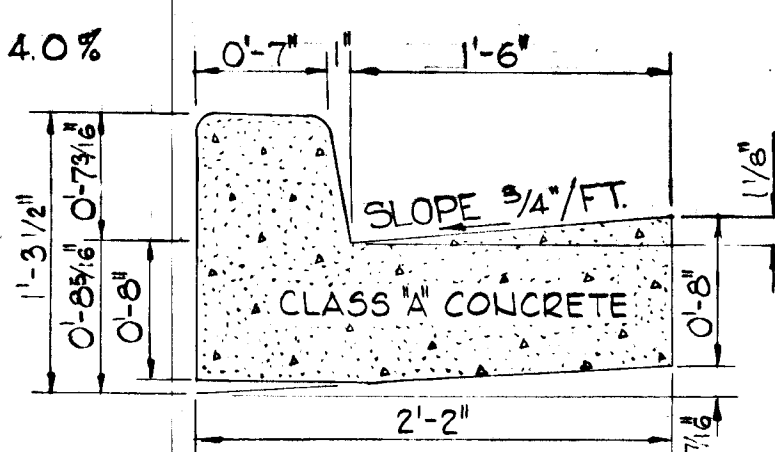

STANDARD 7" COMBINATION CURB & GUTTER

Not to Scale

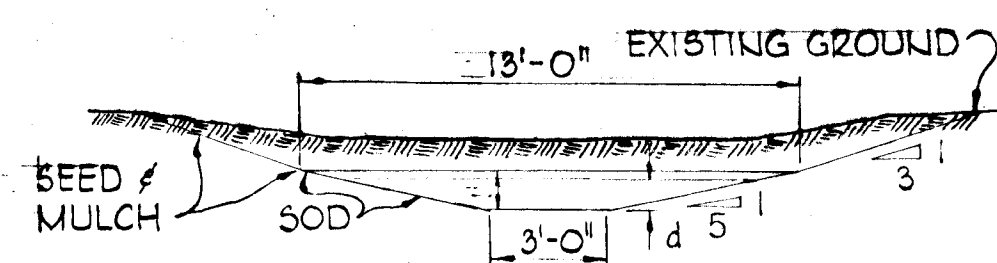

SOD CHANNEL DETAIL (AT 5-1)

Scale: 1" = 5'-0"

$A = 53.0'$
 $P = 10.72'$
 $R = 0.49'$
 $R^{2/3} = 0.622$
 $n = 0.03$
 $S = 0.08'/ft.$
 $S^{1/2} = 0.2828$
 $V = \frac{4.83}{0.03} \times 0.622 \times 0.2828 = 5.7'/sec.$
 $Q = 8.7 \times 5.3 = 46.1 CFS$
 $d = 0.77'$

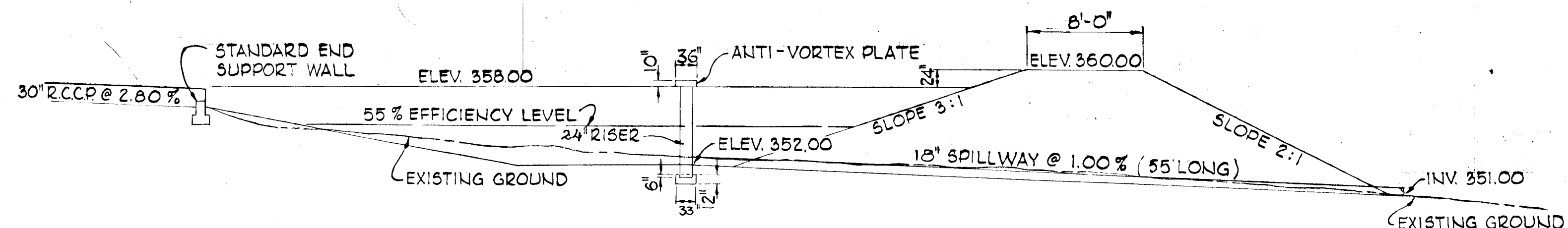

SEDIMENT BASIN DETAIL

Not to Scale

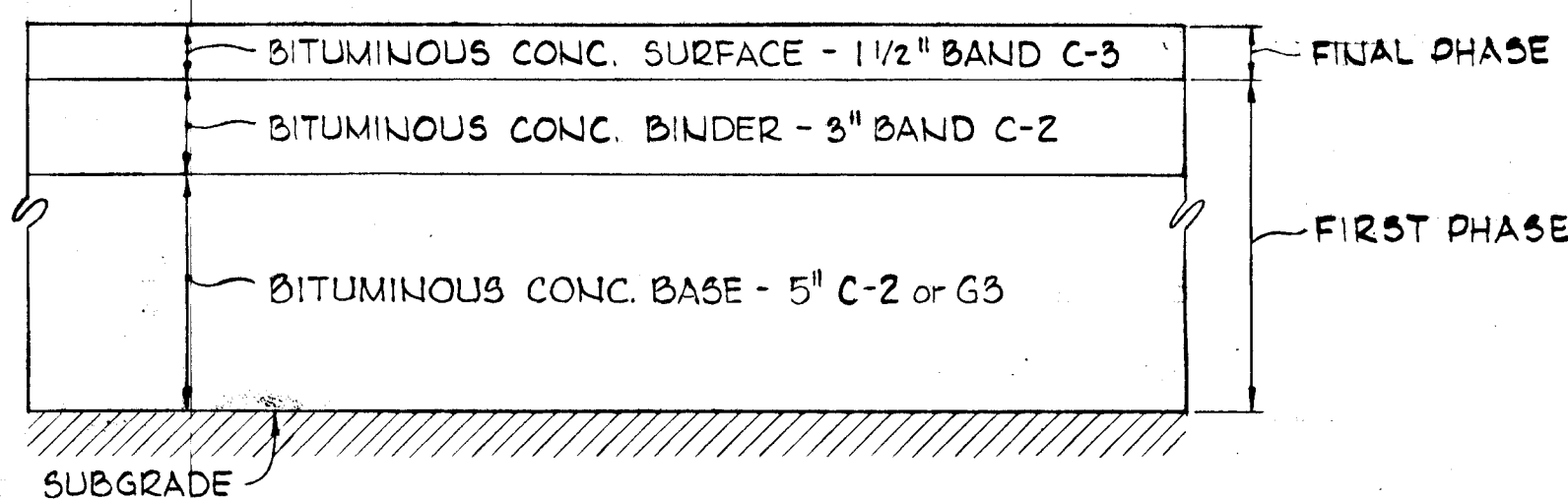

TYPICAL PAVING SECTION

Not to Scale

GENERAL NOTE:

ALL CONSTRUCTION SHOWN HEREON SHALL BE IN ACCORDANCE WITH HOWARD COUNTY ROAD CONSTRUCTION CODE AND STANDARD SPECIFICATIONS DATED NOVEMBER 27, 1962 AND REVISED AUGUST 1967.

I certify that the plan of development and the plan for control of silt and erosion meets the requirements, standards, and specifications of the Howard Soil Conservation District.

William J. Reed March 9, 1972
Date

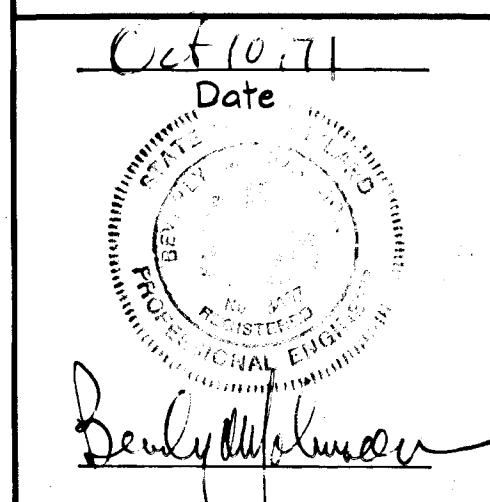

OWNER & DEVELOPER
 ELICOTT CORPORATION
 THE ROSSLYN BUILDING
 1901 N. FORT MEYER DR.
 ARLINGTON, VIRGINIA

PURDUM & JESCHKE ENGINEERS LAND SURVEYORS
 1023 N. CALVERT ST.
 BALTIMORE CITY
 MARYLAND

This development plan is approved for soil erosion sediment control by the Howard Soil Conservation District

Reviewed: *Sam R. Audel* 3-8-72
 District Conservationist Date

Approved: *Robert W. Zisk* 3-8-72
 Howard Soil Conservation District Date

We certify that all development and/or construction will be done according to this plan of development and plan of Silt and Sediment control.

M. F. Weissberg 3/13/71
 M. F. Weissberg Date

DEPARTMENT OF PUBLIC WORKS

D. M. McKeen 3/14/72
 CHIEF, BUREAU OF HIGHWAYS DATE

OFFICE OF PLANNING AND ZONING

J. H. Clawson 3-10-72
 CHIEF, DIVISION OF LAND DEVELOPMENT & TRANSPORTATION PLANNING DATE

DETAILS SECTION 1

ELICOTT CENTER

2ND ELECTION DISTRICT HOWARD COUNTY MD.
 SEPT. 13, 1971 SCALE: AS SHOWN

Sheet 5 of 6 -904