

DATE \_\_\_\_\_ BY \_\_\_\_\_  
 SURVEYED \_\_\_\_\_  
 PLOTTED \_\_\_\_\_  
 CHECKED \_\_\_\_\_  
 NOTE BOOK \_\_\_\_\_  
 NO. \_\_\_\_\_

DATE \_\_\_\_\_ BY \_\_\_\_\_  
 SURVEYED \_\_\_\_\_  
 PLOTTED \_\_\_\_\_  
 CHECKED \_\_\_\_\_  
 NOTE BOOK \_\_\_\_\_  
 NO. \_\_\_\_\_

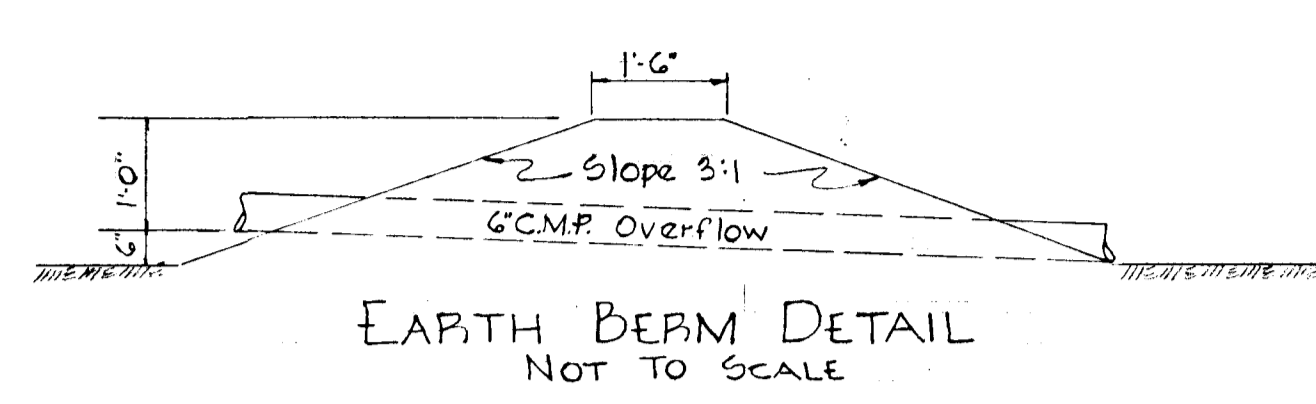
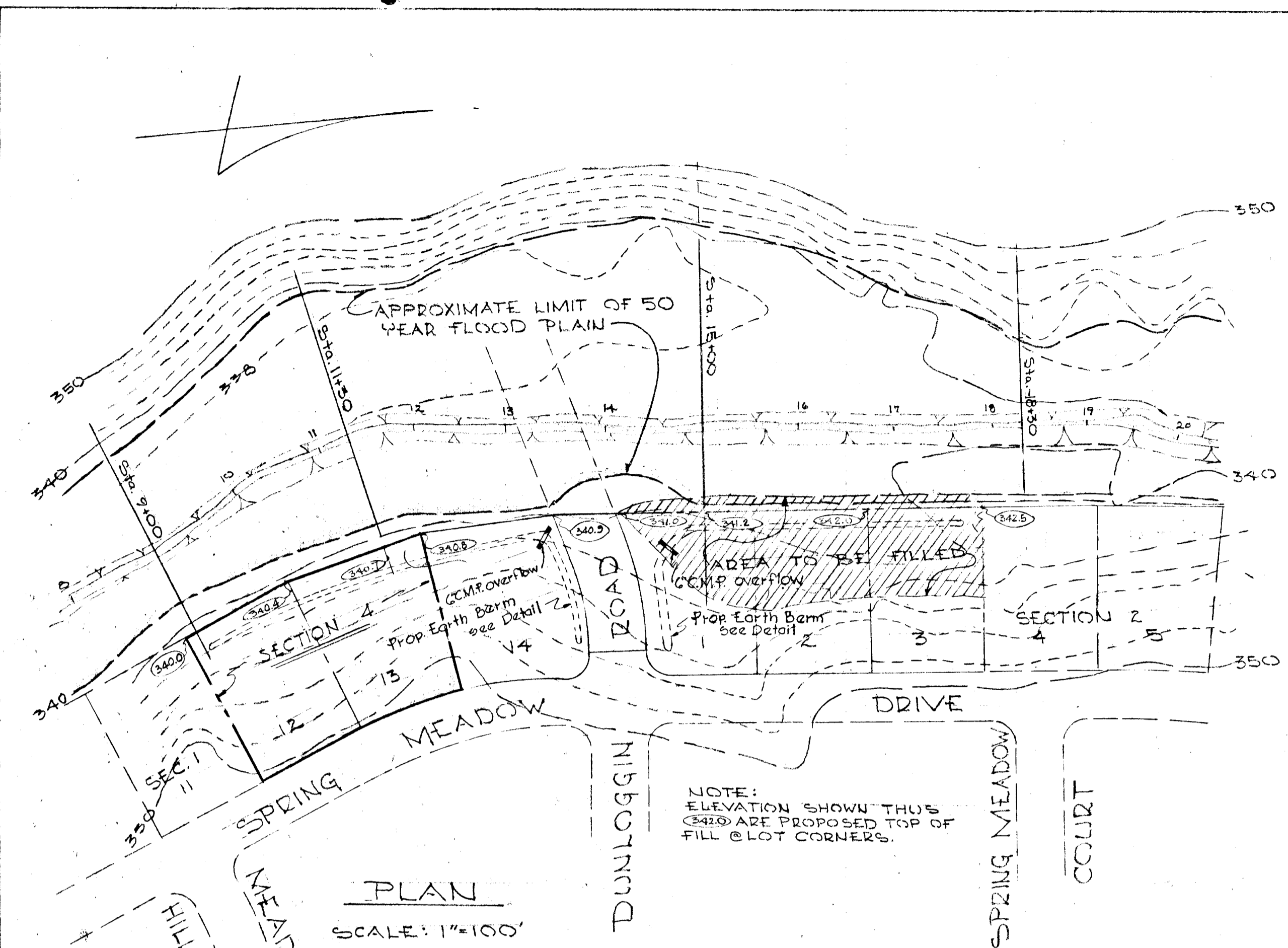

- SEEDING & FERTILIZER**
- 1) Graded Areas will be protected from erosion by means of long term seeding in accordance with the following:
    - a) 3" of Top Soil shall be spread over the disturbed area.
    - b) Pulverized Dolomitic Limestone shall be spread @ 2000 lbs./acre.
    - c) A commercial fertilizer of a 10-10-10 rating or equivalent shall be spread @ 600 lbs./acre.
    - d) Upon completion of liming & fertilizer operation the area shall be harrowed or disced to a depth of 3" to form a smooth seedbed.
    - e) A seed mix consisting of the following shall be spread @ not less than 11 lbs./2500 sq. ft. 50% Kentucky Bluegrass; 40% Creeping Red Fescue; 10% Chewings Fescue.
- CONSTRUCTION**
- 1) Earth Berm to be constructed prior to any lot grading.

**OWNER AND DEVELOPER**  
 The Dunloggin Corp. of Howard County  
 687 Baltimore National Pike  
 Ellicott City,  
 Maryland

I certify that the plan of development and the plan for control of silt and erosion meets the requirements, standards, and specifications of Howard Soil Conservation District.  
*William G. Jeschke* Jan 22, 1970  
 William G. Jeschke II Date

**PURDUM JESCHKE**  
 ENGINEERS  
 LAND SURVEYORS  
 3697 PARK AVENUE  
 ELLICOTT CITY,  
 MARYLAND  
 21043  
 Reg. No. 4575  
 DEPARTMENT OF PUBLIC WORKS

I certify that all development and/or construction will be done according to this plan of development and plan of silt and sediment control.  
*Robert W. Shady*  
 Robert W. Shady Date  
 This development plan is approved for soil erosion and sediment control by the Howard Soil Conservation District.  
*Edmund J. Sauer* 2/27/70  
 Edmund J. Sauer Date  
 District Conservationist  
*Martha E. Bickhoff* 2/27/70  
 Martha E. Bickhoff Date  
 Approved  
 Howard Soil Conservation District

*Drumville R. Wehland* 3-3-70  
 Drumville R. Wehland Date  
 Chief, Bureau of Highways  
 OFFICE OF PLANNING AND ZONING  
*J. H. Clewson* 3-2-70  
 J. H. Clewson Date  
 Chief Engineer  
 Division of Land Development

**FLOOD PLAIN PLAN AND DETAILS**  
**SEDIMENT CONTROL**  
**SECTION 4**  
**DUNLOGGIN II**  
 Second Election District  
 January 20, 1970  
 Howard County, Maryland  
 Scale: As Shown  
 Sheet 2 of 2

