

Note:  
 1. Invert and walls shall be 2\"/>

OWNER & DEVELOPER: ZENITH CONTRACTORS, 989 LONGVIEW DRIVE, ELLICOTT CITY, MARYLAND  
 ENGINEER: PURDUM & WESCHKE, 24 PARK AVE., ELLICOTT CITY, MARYLAND  
 APPROVED: DIVISION OF LAND DEVELOPMENT, FEBRUARY 25, 1969  
 Chief Engineer: J.H. Clawson, 3-19-69  
 APPROVED: HOWARD COUNTY BUREAU OF HIGHWAYS, GRANVILLE W. MARRIS, 3/14/69  
 Roads Superintendent  
 APPROVED: HOWARD CO. METROPOLITAN COMM., HADAMSON, 3-14-69  
 Chief Engineer  
 PLAN: PROFILE: FAWNWOOD DR; PLAN: CYPRESSMEDE DRIVE, SECTION NO. 3

**Curve Data - Sta. 4+47.16 to Sta. 6+24.69**  
 R = 400.00' L = 177.53'  
 Δ = 25° 25' 44" T = 90.25'  
 L.C. = N26° 19' 11" E - 176.07'

**Curve Data - Sta. 6+24.69 to Sta. 7+59.04**  
 R = 400.00' L = 130.35'  
 Δ = 18° 40' 18" T = 65.76'  
 L.C. = N22° 56' 28" E - 129.78'

PLAN SCALE: 1" = 50'  
 PROFILE SCALE: Hor: 1" = 50', Vert: 1" = 5'-0"

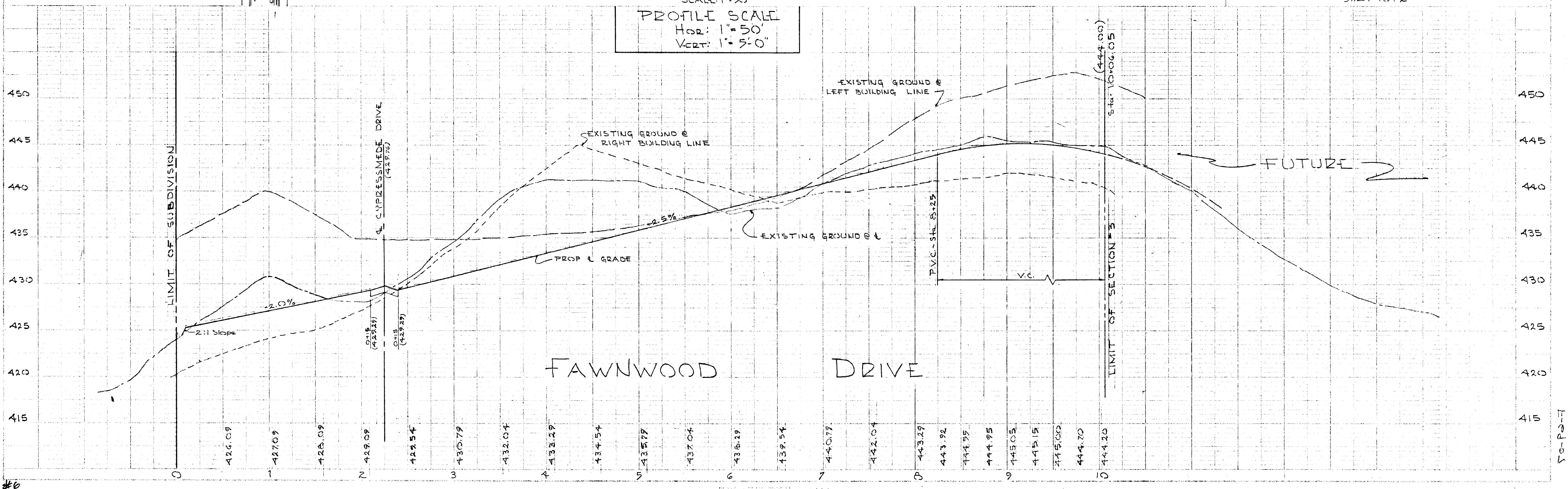

2<sup>ND</sup> ELECTION DISTRICT - HOWARD COUNTY, MARYLAND  
 FEBRUARY 24, 1969 SCALE: AS SHOWN  
 Sheet 1 of 2

DATE: 1-29-69  
 DRAWN BY: J. H. CLAWSON  
 CHECKED BY: J. H. CLAWSON  
 PROJECT: BETHWOOD

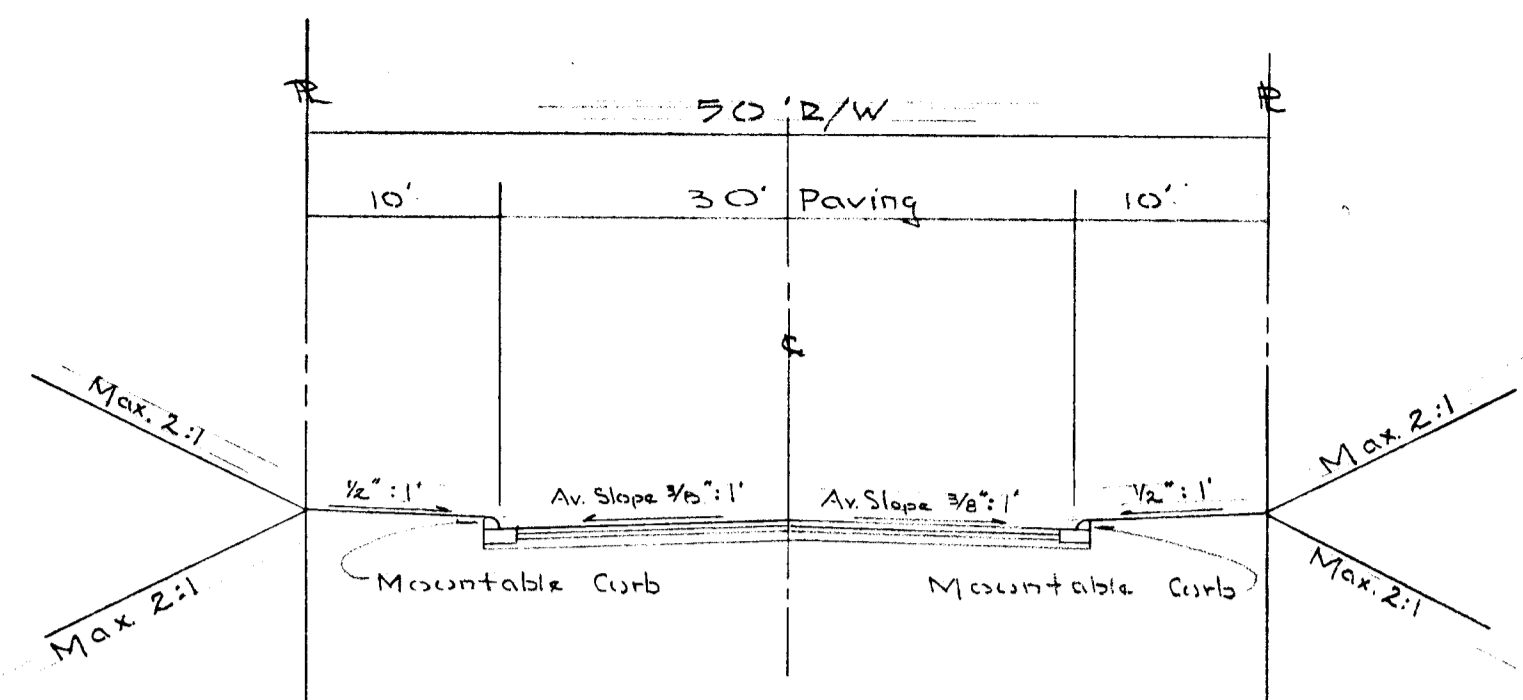

For Paving Section, see Howard County Road Specification dated Nov. 1962 (Revised Aug. 1968) - Alternates: Drwg. D-3, Page 58; Drwg. D-4, Page 59; Drwg. D-5, Page 60.

TYPICAL SECTION - 50' R/W - 30' PAVING WITH MOUNTABLE CURB  
 SCALE: 1"=10'

GENERAL NOTES

- 1) For details of Type 'X' Inlet see Drwg. 64-A page 119-A of Howard County Road Construction Code.
- 2) For details of Type 'E' Combinatory Inlet see Drwg. D-68 page 123 of the above mentioned specifications.
- 3) For details of Type 'S' Inlet see Drwg. D-100 page 155 of the above mentioned specifications.
- 4) For details of Standard Manhole see Drwg. D-103 page 158 of the above mentioned specifications.
- 5) For details of Temporary Dead End Barricade see Drwg. D-107 page 164 of the above mentioned specifications.
- 6) For details of Double Type 'E' Inlet, see detail sheet 1 of 2.
- 7) All inlets shall be depressed. For 'Inlet Depression Detail', see this sheet.

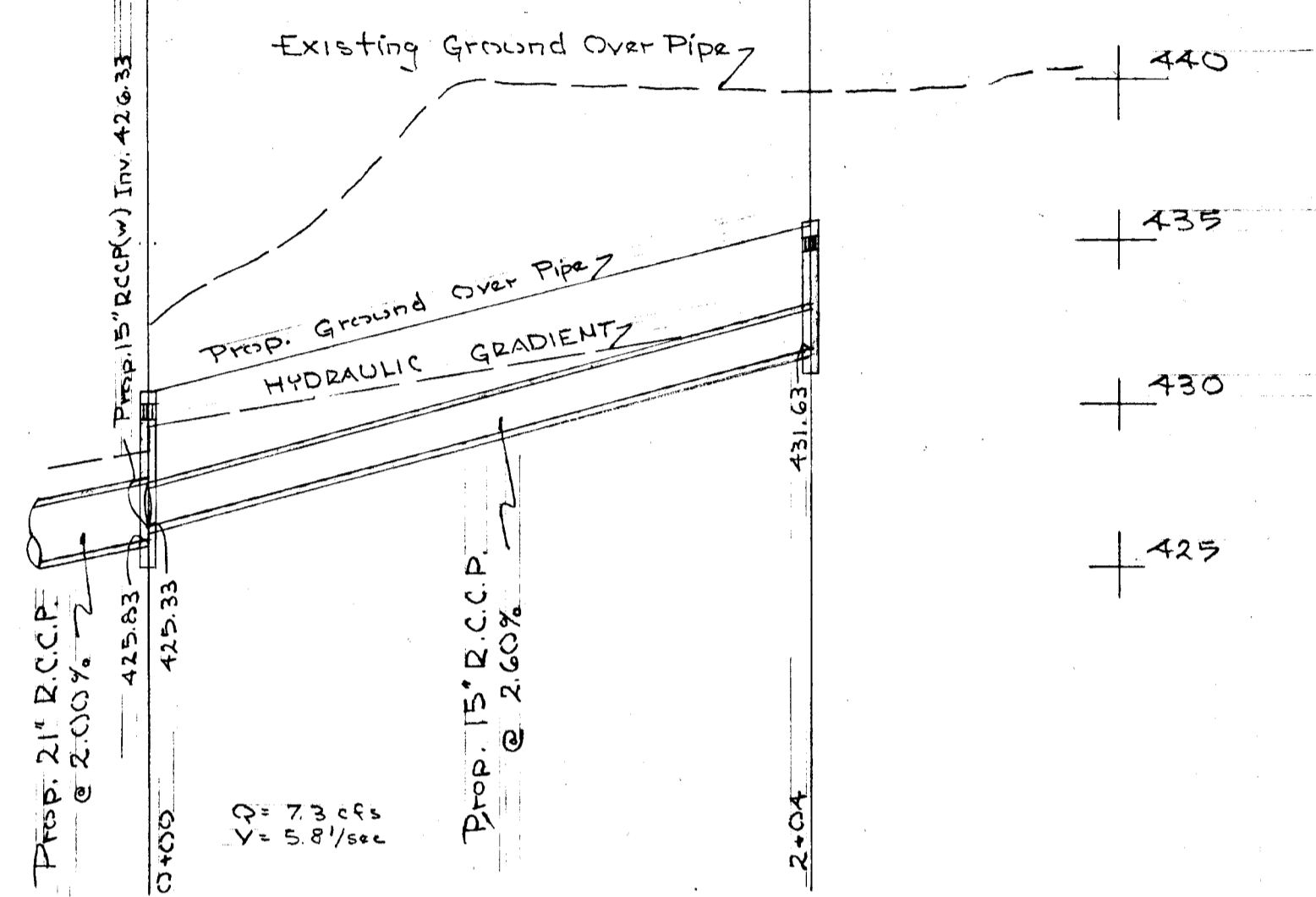
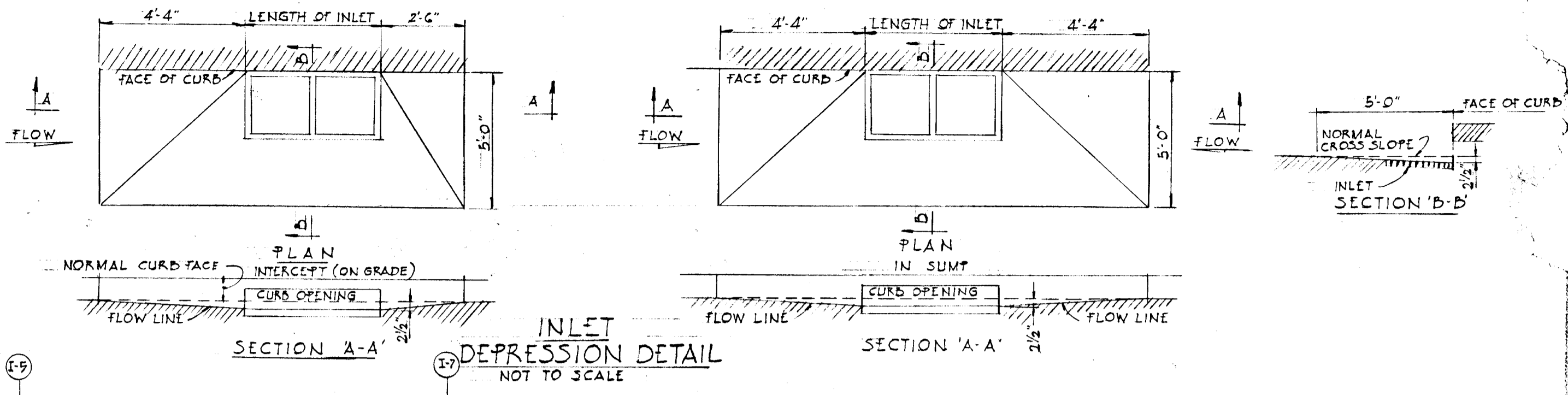

|  |  |
|--|--|
| OWNER & DEVELOPER  | ENGINEER   |
| ZOLITH CONTRACTORS<br>787 LONGVIEW DRIVE<br>ELICOTT CITY, MARYLAND | PURDUM & WESCHKE<br>24 PARK AVE.<br>ELICOTT CITY, MARYLAND |
| APPROVED: DIVISION OF LAND DEVELOPMENT                             | FEBRUARY 25, 1969<br>Date                                  |
| J. H. Clawson<br>Chief Engineer                                    | 3-19-69<br>Date  |
| APPROVED: ( ) HOWARD COUNTY BUREAU OF HIGHWAYS                     |  |
| Brian W. Noland<br>Roads Superintendent                            | 3/14/69<br>Date  |
| APPROVED: HOWARD CO. METROPOLITAN COMM.                            |  |
| H. H. Harns<br>Chief Engineer                                      | 3-14-69<br>Date  |
| PROFILE CYPRESSMEDE DRIVE - DETAIL SHEET<br>SECTION N° 3           |  |

BETHWOOD

2ND ELECTION DISTRICT ( ) HOWARD COUNTY, MARYLAND  
 FEBRUARY 24, 1969 SCALE: AS SHOWN

Sheet 2 of 2

|           |      |    |
|-----------|------|----|
| PLAN      | DATE | BY |
| PROFILE   |      |    |
| NOTE BOOK |      |    |
| NO.       |      |    |

|           |      |    |
|-----------|------|----|
| PROFILE   | DATE | BY |
| NOTE BOOK |      |    |
| NO.       |      |    |

