

TYPICAL CUL-DE-SAC HALF-SECTION
NO SCALE

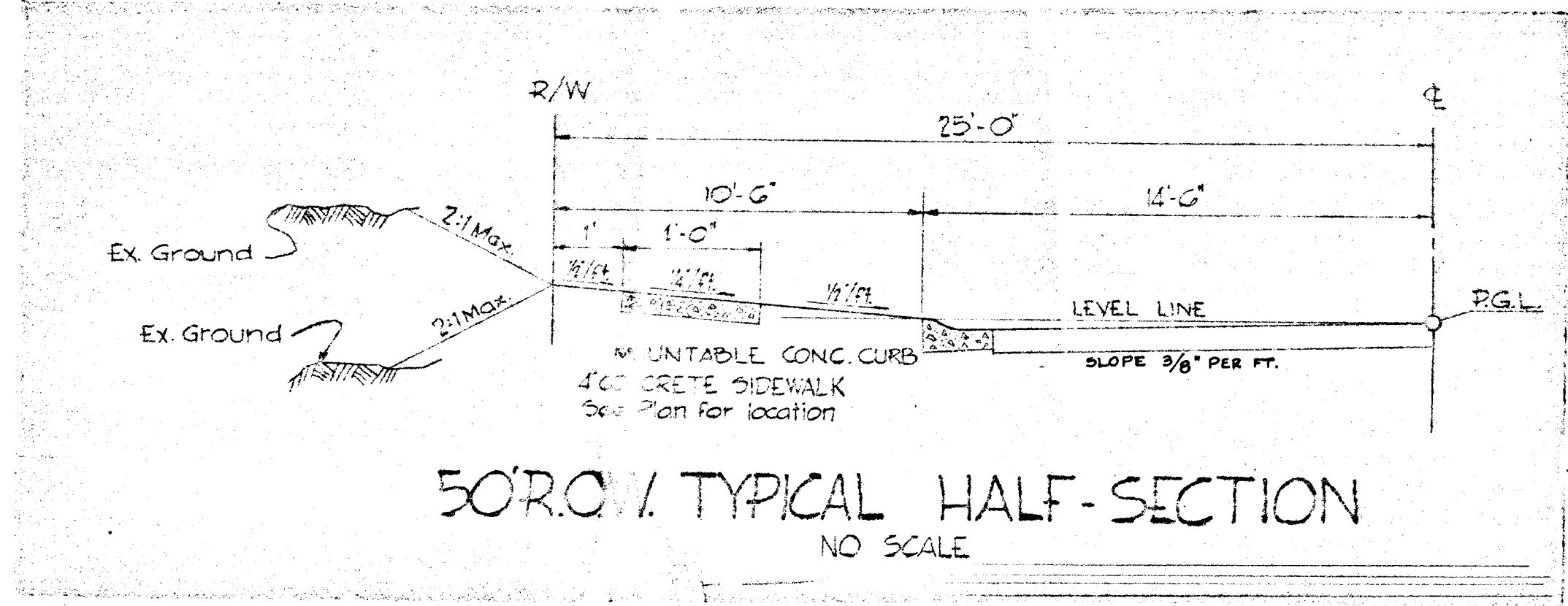

50' R.O.W. TYPICAL HALF-SECTION
NO SCALE

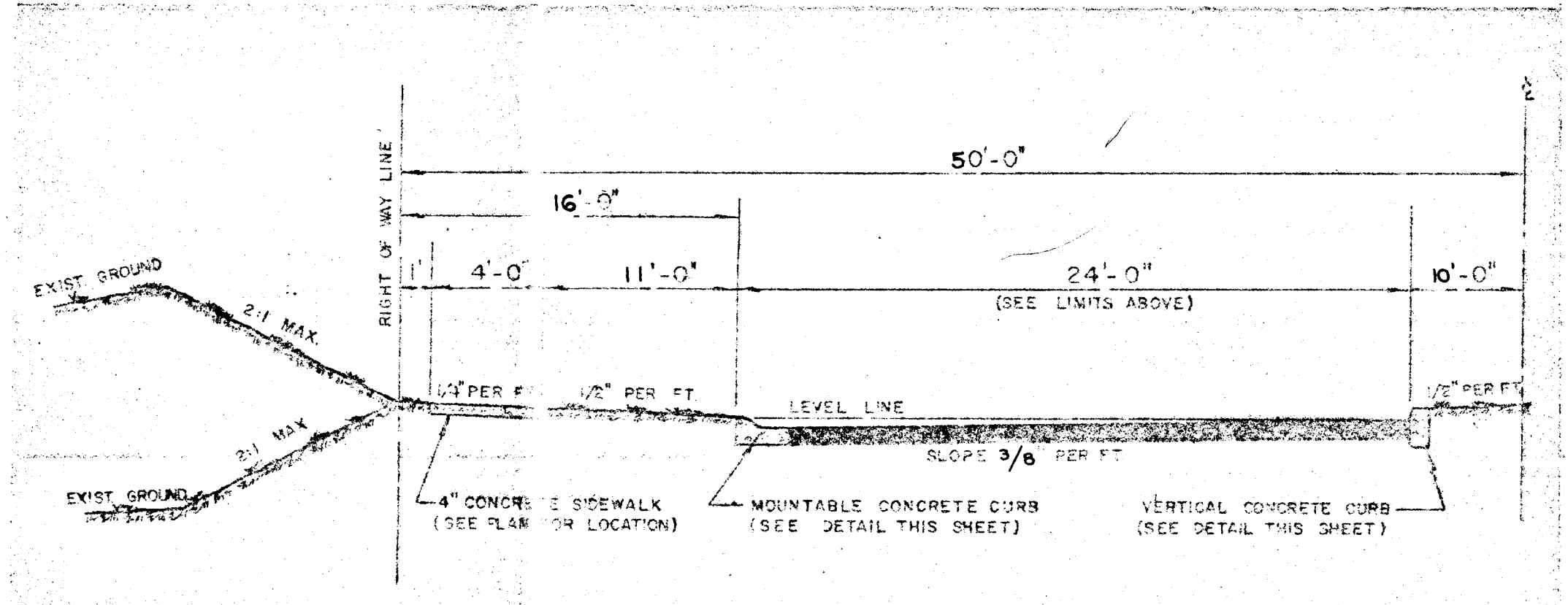

100' R.O.W. TYPICAL HALF-SECTION
NOT TO SCALE

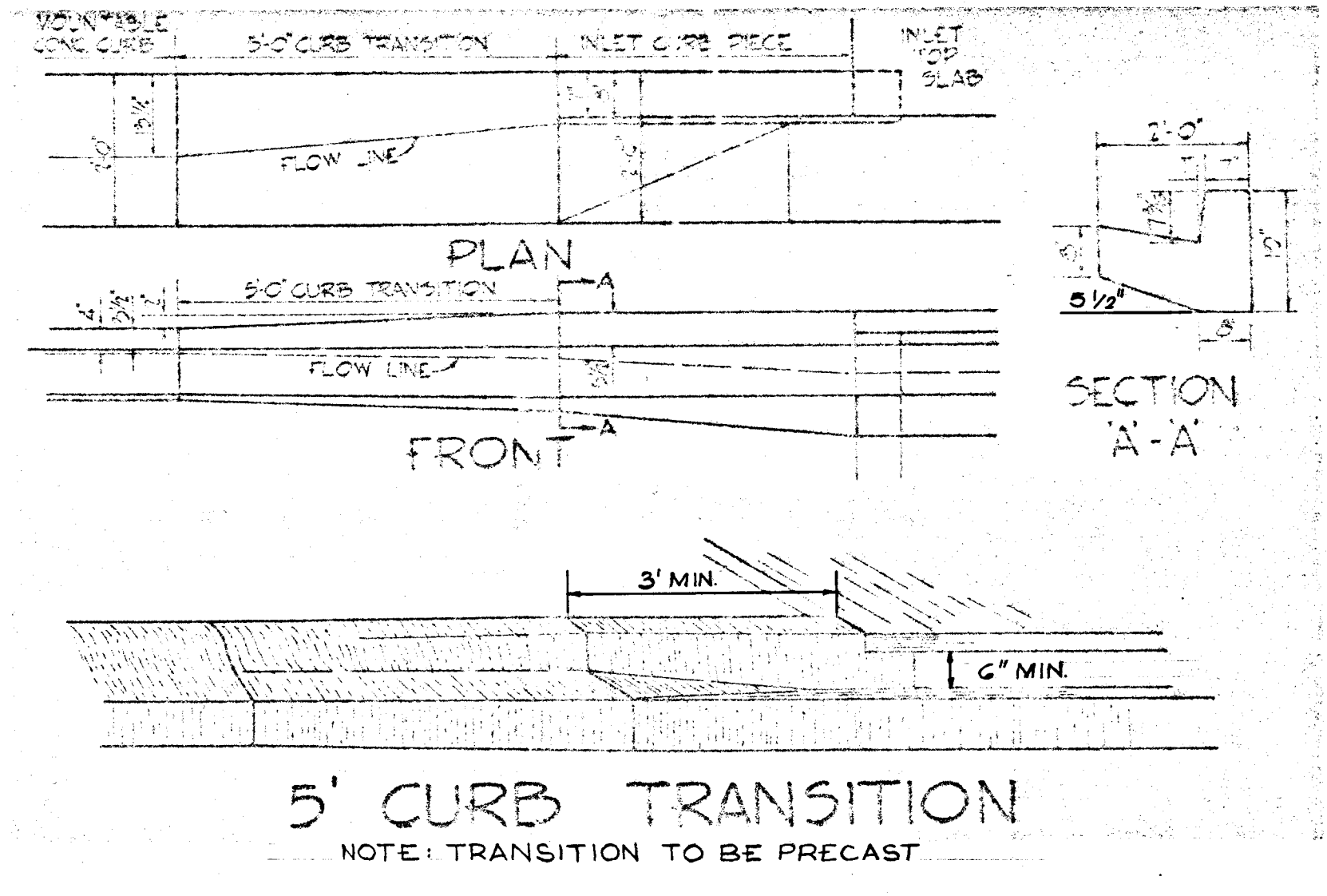

5' CURB TRANSITION
NOTE: TRANSITION TO BE PRECAST

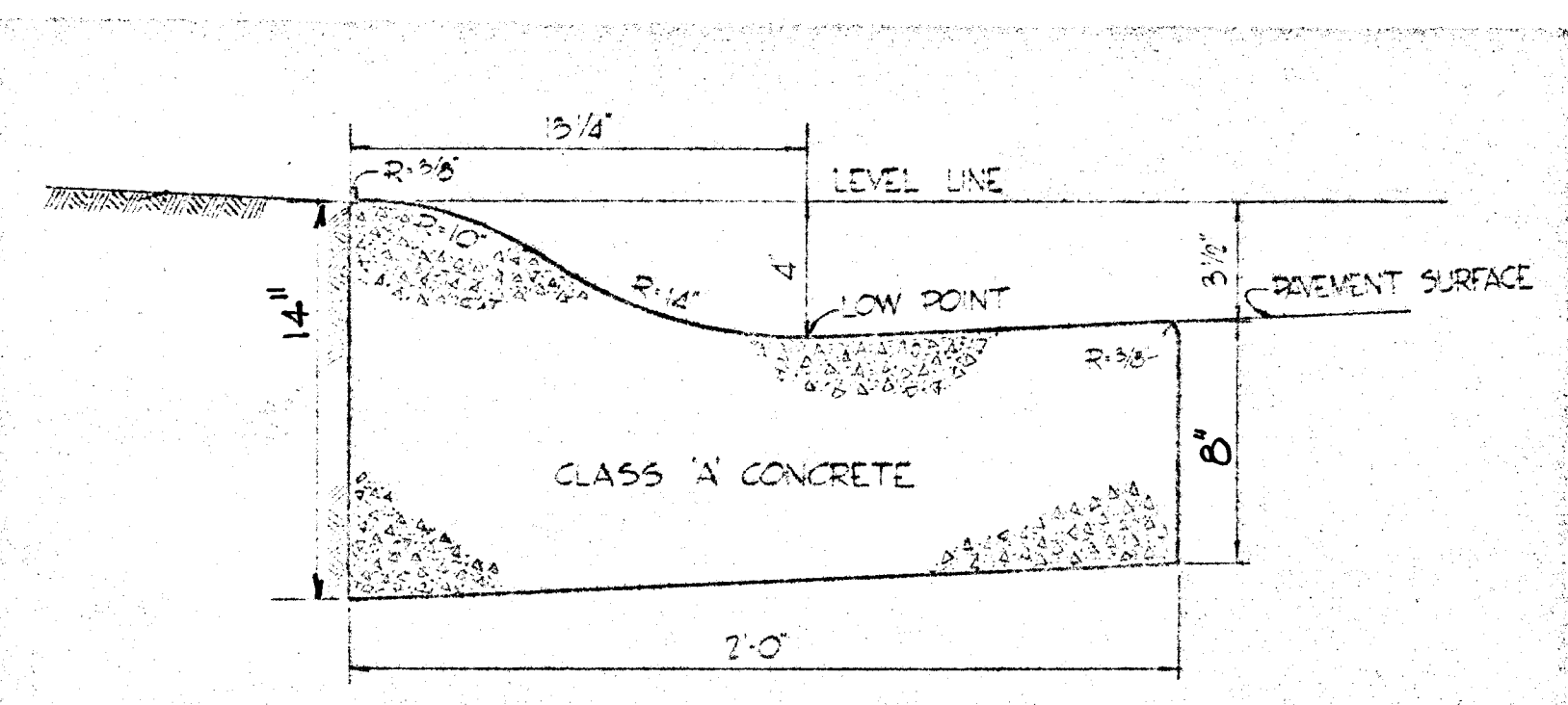

MOUNTABLE CONCRETE CURB
NO SCALE
DWG. D-40 PAGE 95 HO. CO. CONST. CODE

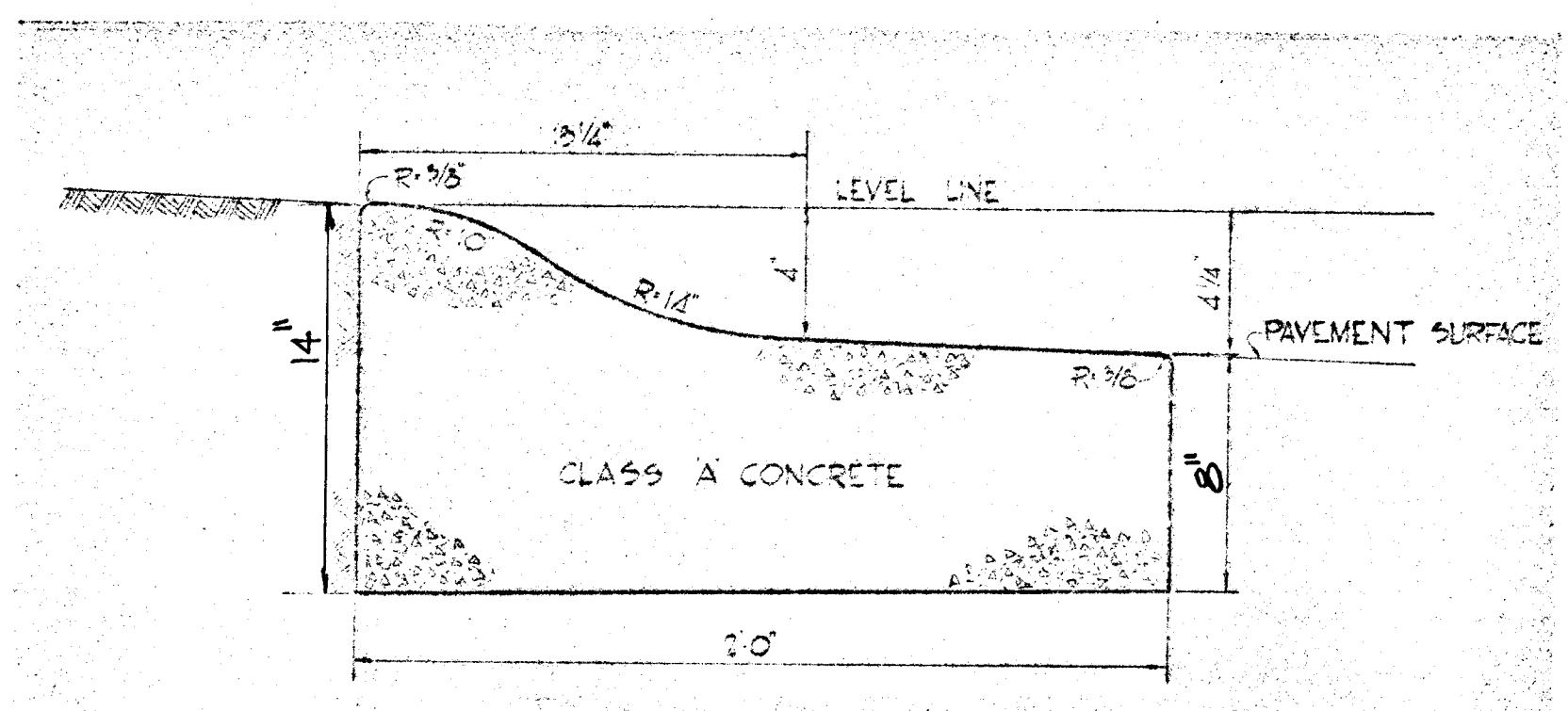

MOUNTABLE CONCRETE CURB FOR CUL-DE-SAC ISLANDS
NO SCALE
DWG. D-40 P95 HO. CO. CONST. CODE

BITUMINOUS CONCRETE SURFACE	BAND C-3 FINAL PHASE
BITUMINOUS CONCRETE BASE PLACED IN ONE COURSE	BAND C-2 OR C-3 FIRST PHASE

CLEARING AND GRADING
SUBGRADE
BASE COURSE
SURFACE COURSE

ARTICLE C-1
ARTICLE C-2
ARTICLE C-3 OR C-35
ARTICLE C-31

NOTE:
PAVEMENT TO BE CONSTRUCTED IN ACCORDANCE WITH THE HOWARD COUNTY ROAD CONSTRUCTION CODE AND SPECIFICATIONS DWG D-10 P-10-10

6 1/2" PAVEMENT DETAIL
NO SCALE

BITUMINOUS CONCRETE SURFACE	BAND C-3 FINAL PHASE
BITUMINOUS CONCRETE BINDER	BAND A-3
BITUMINOUS CONCRETE BASE PLACED IN ONE COURSE	BAND C-2 OR C-3 FIRST PHASE

CLEARING AND GRADING
SUBGRADE
BASE COURSE
BINDER COURSE
SURFACE COURSE

ARTICLE C-1
ARTICLE C-2
ARTICLE C-3 OR C-35
ARTICLE C-31

NOTE:
PAVEMENT TO BE CONSTRUCTED IN ACCORDANCE WITH THE HOWARD COUNTY ROAD CONSTRUCTION CODE AND SPECIFICATIONS DWG D-10 P-10-10

8" PAVEMENT DETAIL
NO SCALE

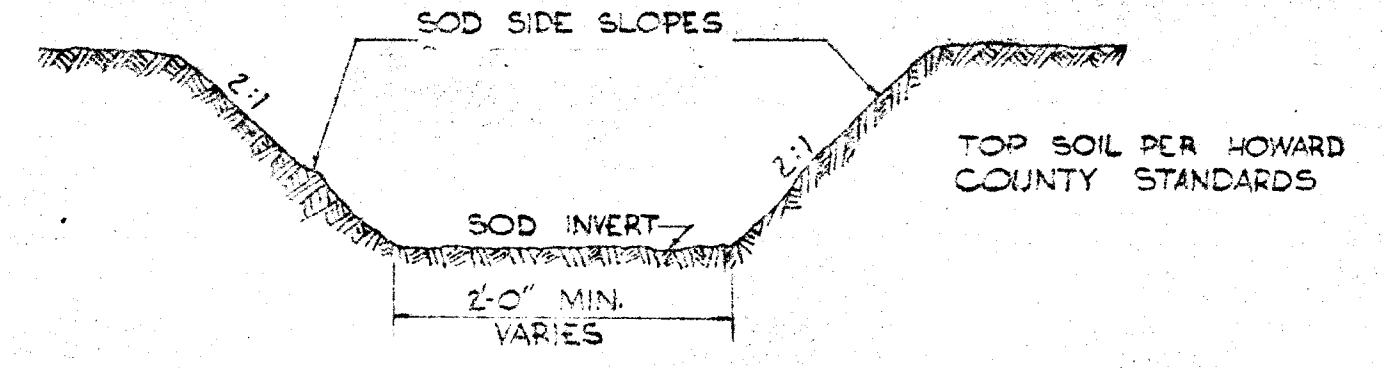

TYPICAL DRAINAGE DITCH
NO SCALE

APPROVED
DIVISION OF LAND DEVELOPMENT
OFFICE OF PLANNING AND ZONING
OF HOWARD COUNTY
DATE: MAY 1 1970

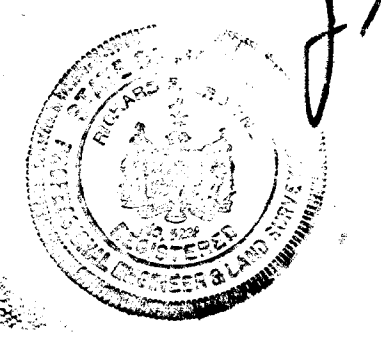

Richard P. Browne
RICHARD P. BROWNE 5235
DATE: 2-26-69

RICHARD P. BROWNE ASSOCIATES
CONSULTING ENGINEERS-PLANNERS
COLUMBIA, MARYLAND

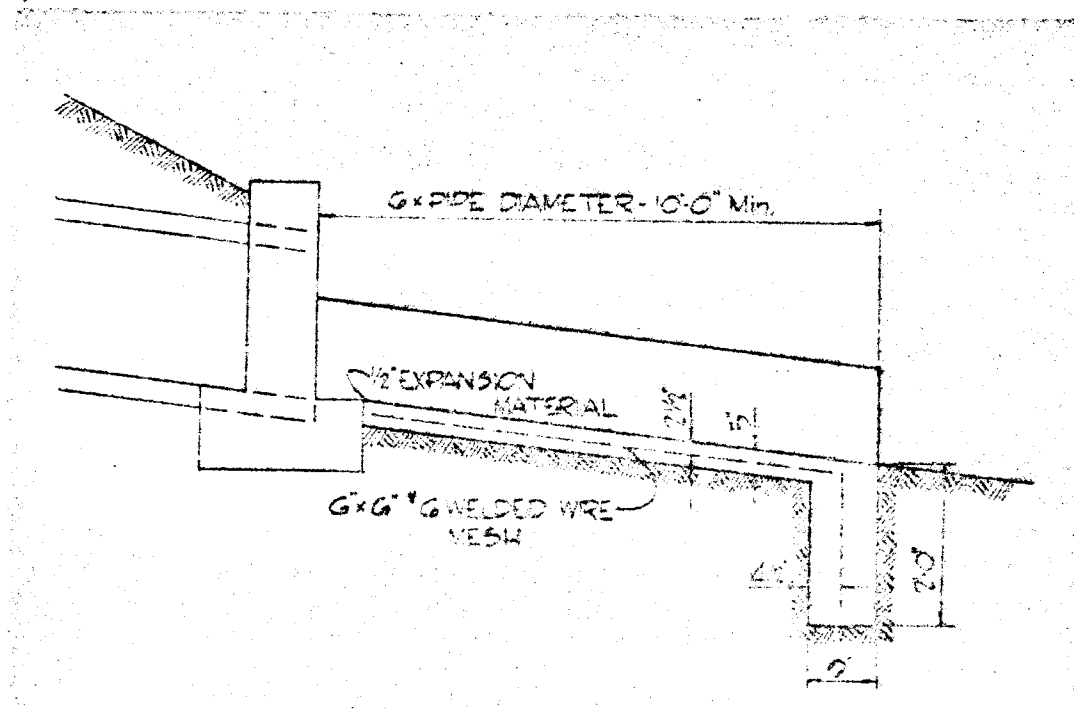

TYPICAL CONCRETE CHANNEL AND CUTOFF WALL
NO SCALE

Rev Date	Rev No	Revision Description
COLUMBIA		
MARYLAND DISTRICT OF HOWARD COUNTY		
OWNER AND DEVELOPER HOWARD RESEARCH AND DEVELOPMENT CORP. THE VILLAGE OF CROSS KEYS - BALTIMORE, MARYLAND 21210		
PROJECT AREA VILLAGE OF OAKLAND MILLS SEC. 1 THUNDER HILL AREA 4, PART A		
PROJECT TITLE ROADWAY DETAILS		
Des By T.S.	Scale AS SHOWN	Dwg No 6 of 7
Drn By B.P.	Date 23 FEB. 69	C.C.F. No
Chk By T.S.	Approved	

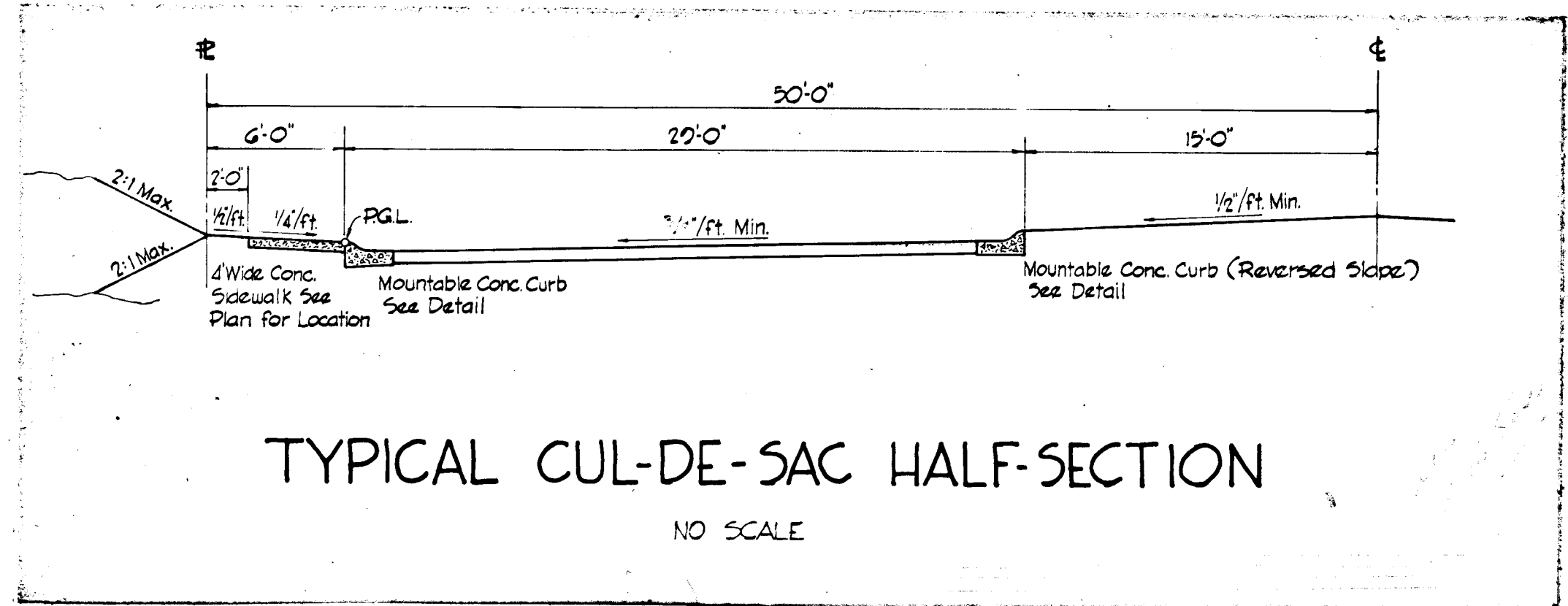

TYPICAL CUL-DE-SAC HALF-SECTION
NO SCALE

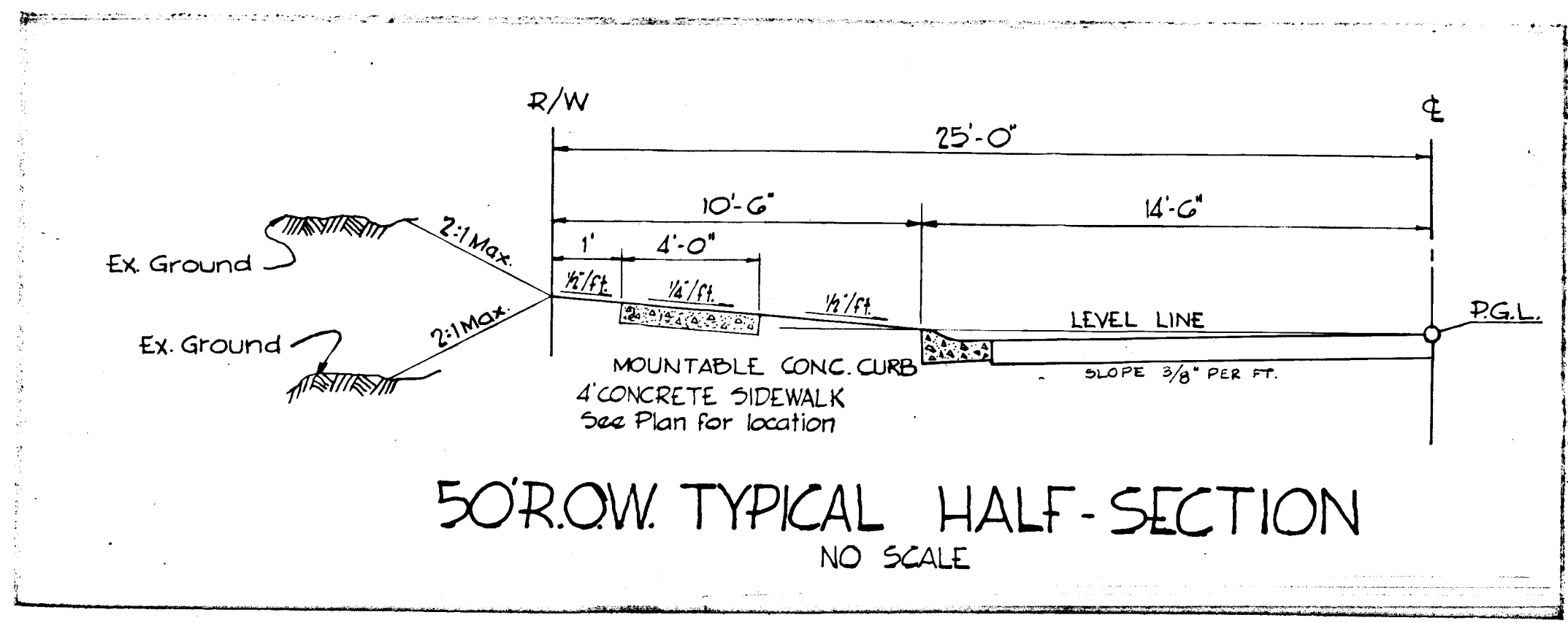

50' R.O.W. TYPICAL HALF-SECTION
NO SCALE

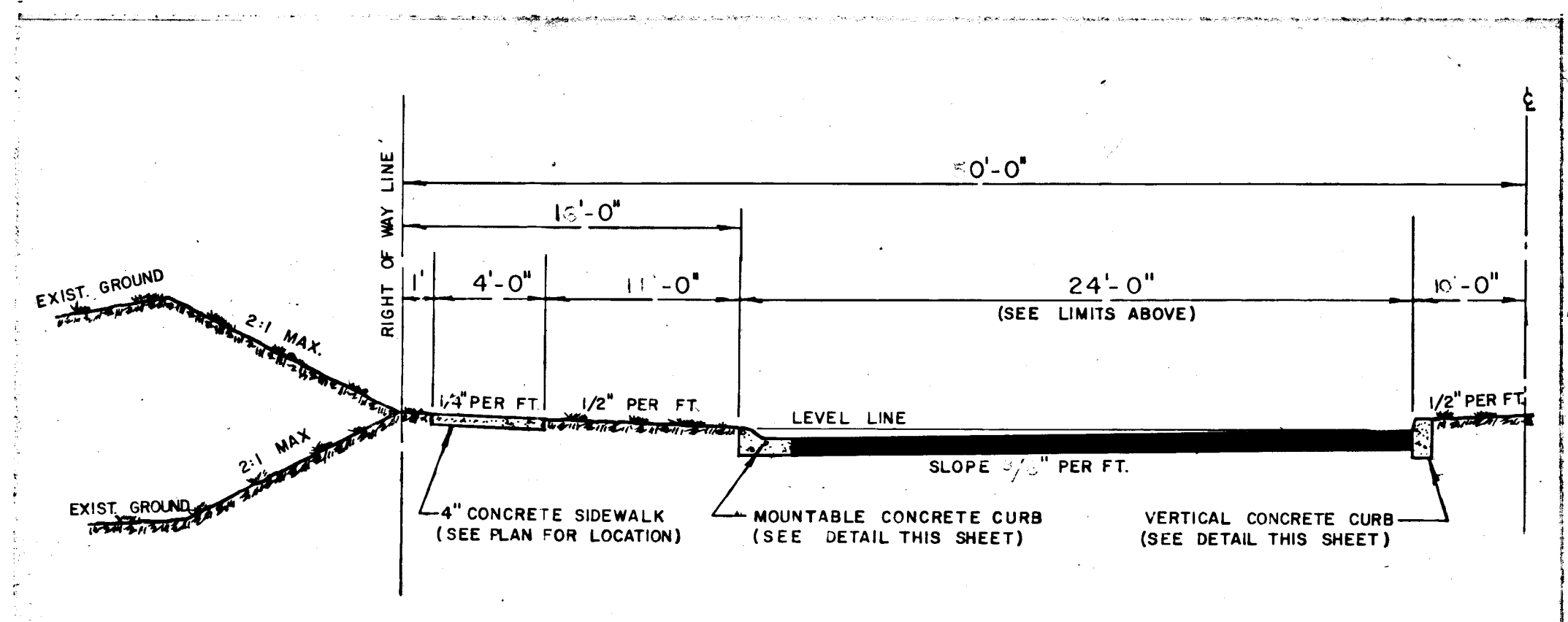

80' R.O.W. TYPICAL HALF-SECTION
NOT TO SCALE

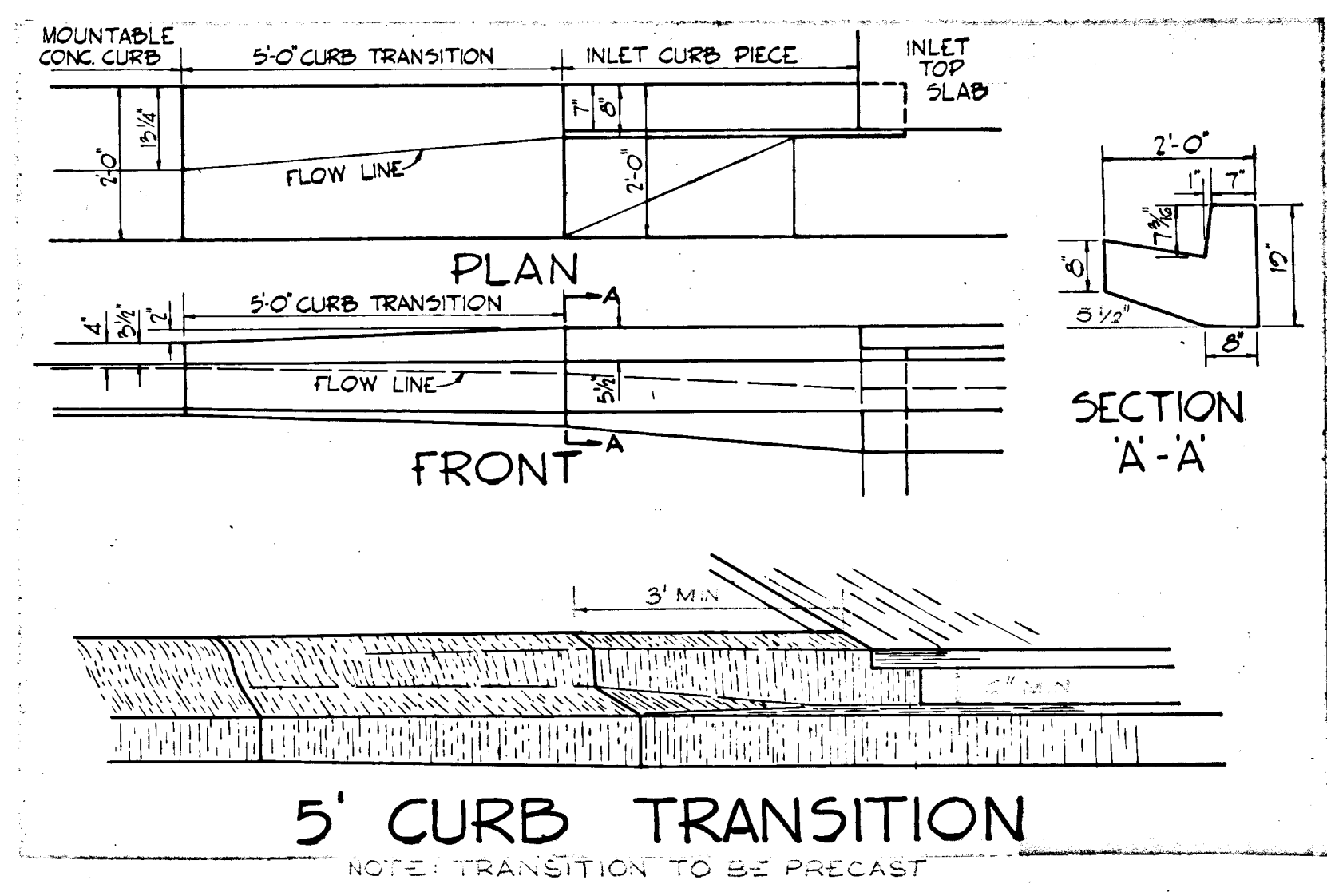

5' CURB TRANSITION
NOTE: TRANSITION TO BE PRECAST

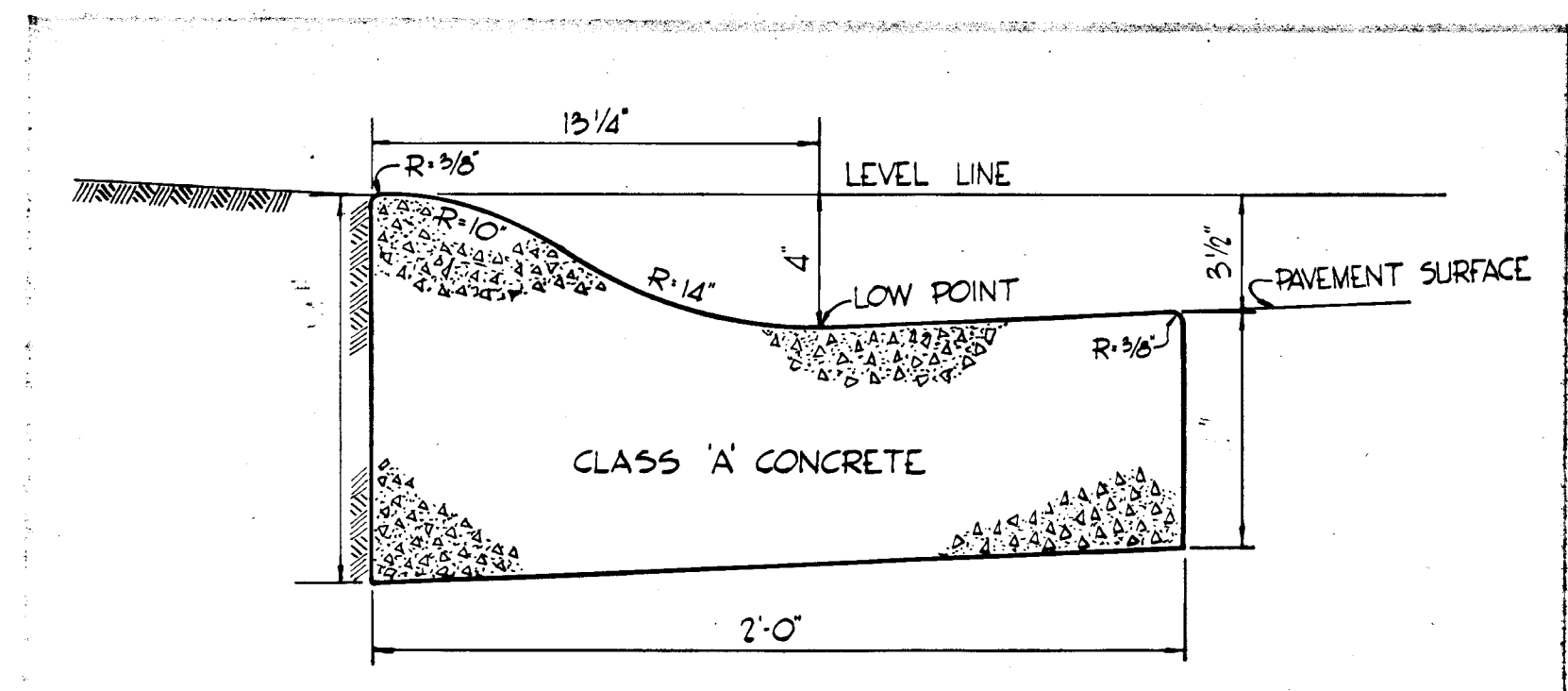

MOUNTABLE CONCRETE CURB
NO SCALE
DWG. D-40 PAGE 23 HO. CO. CONST. CODE

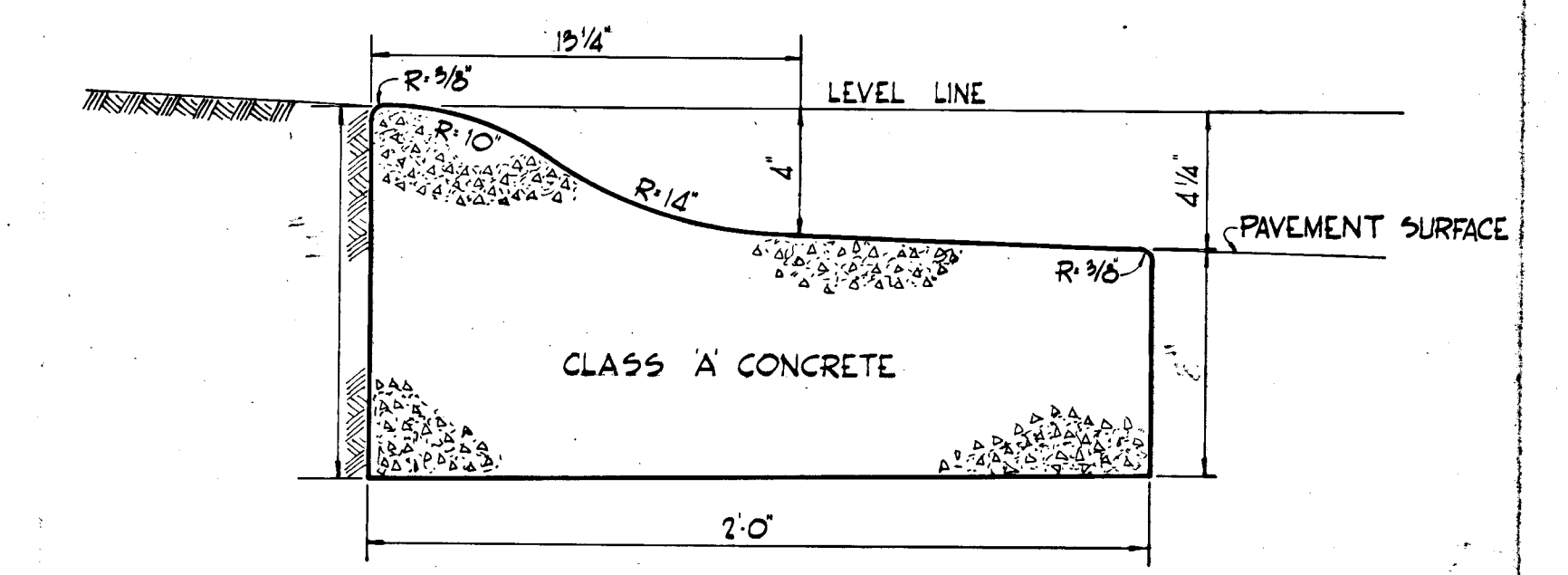

MOUNTABLE CONCRETE CURB FOR CUL-DE-SAC ISLANDS
NO SCALE
DWG. D-40 P. 25 HO. CO. CONST. CODE

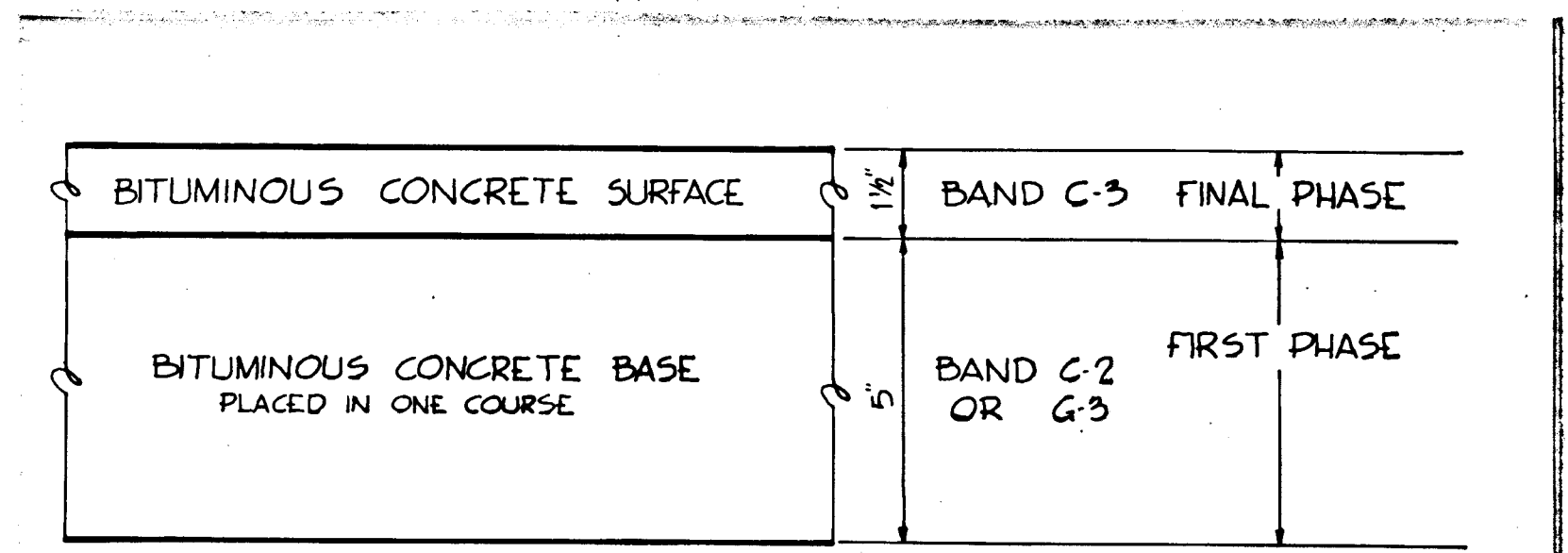

6 1/2\"/>

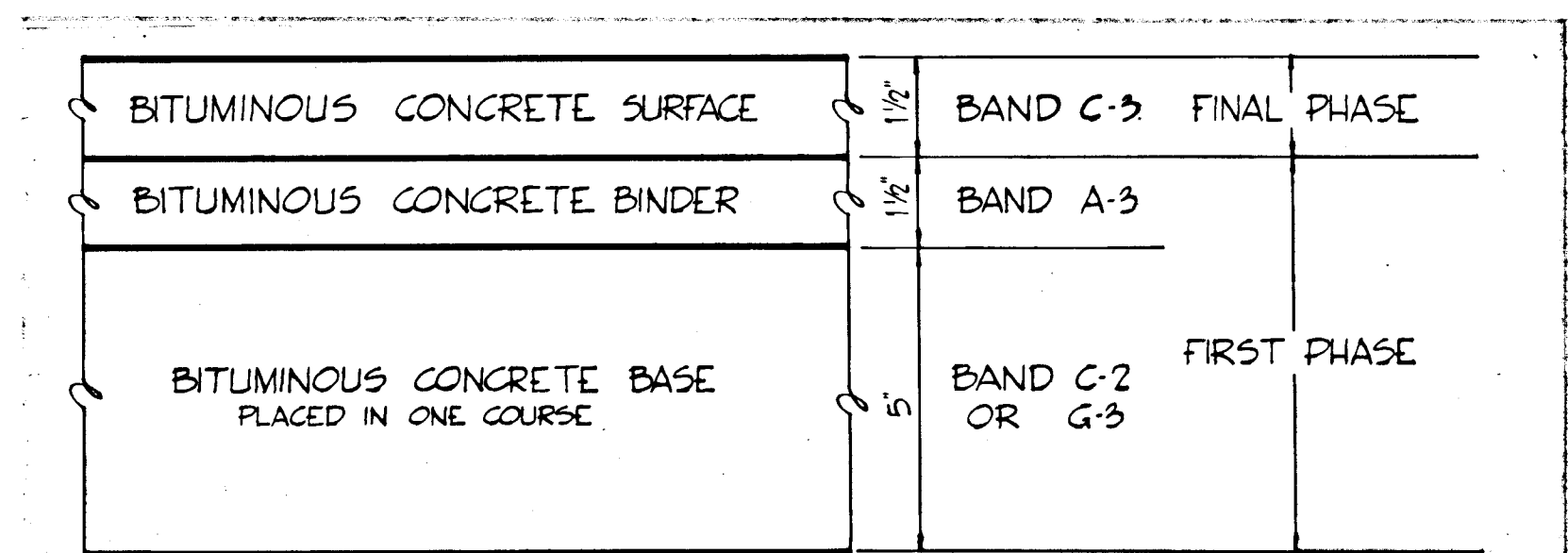

8\"/>

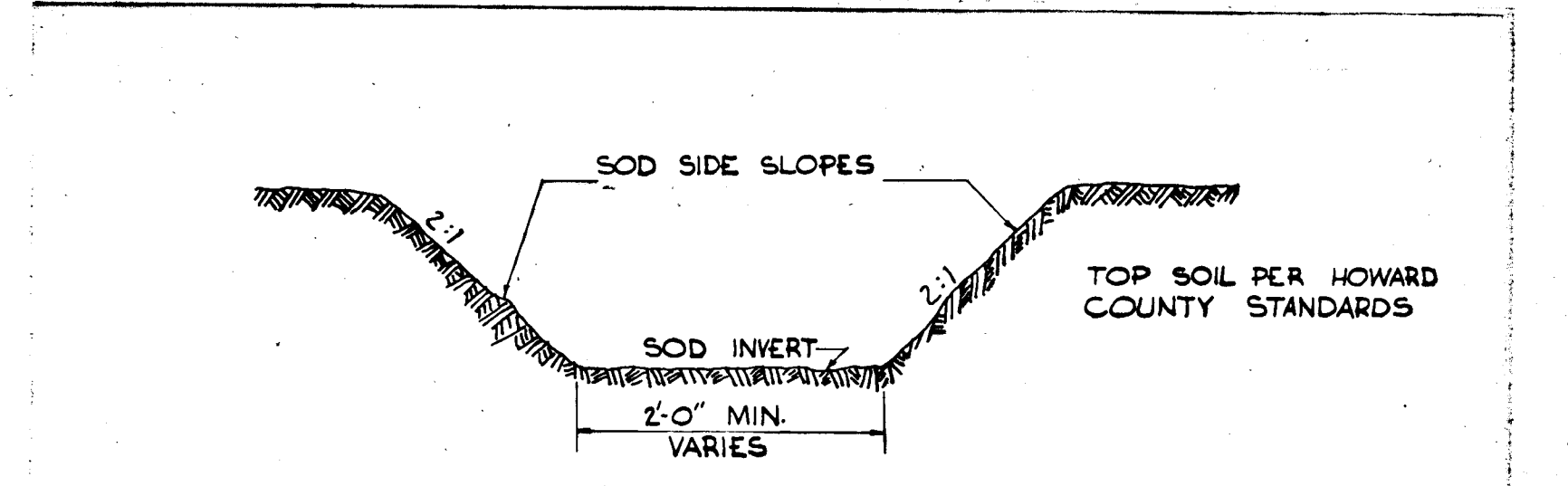

TYPICAL DRAINAGE DITCH
NO SCALE

NOTE: ALL EXISTING DITCHES APPROACHING PROPOSED ENDWALLS SHALL BE TRIMMED IN ACCORDANCE WITH ARTICLE C-6 OF THE HOWARD COUNTY ROAD CONSTRUCTION CODE AND STANDARD SPECIFICATIONS.

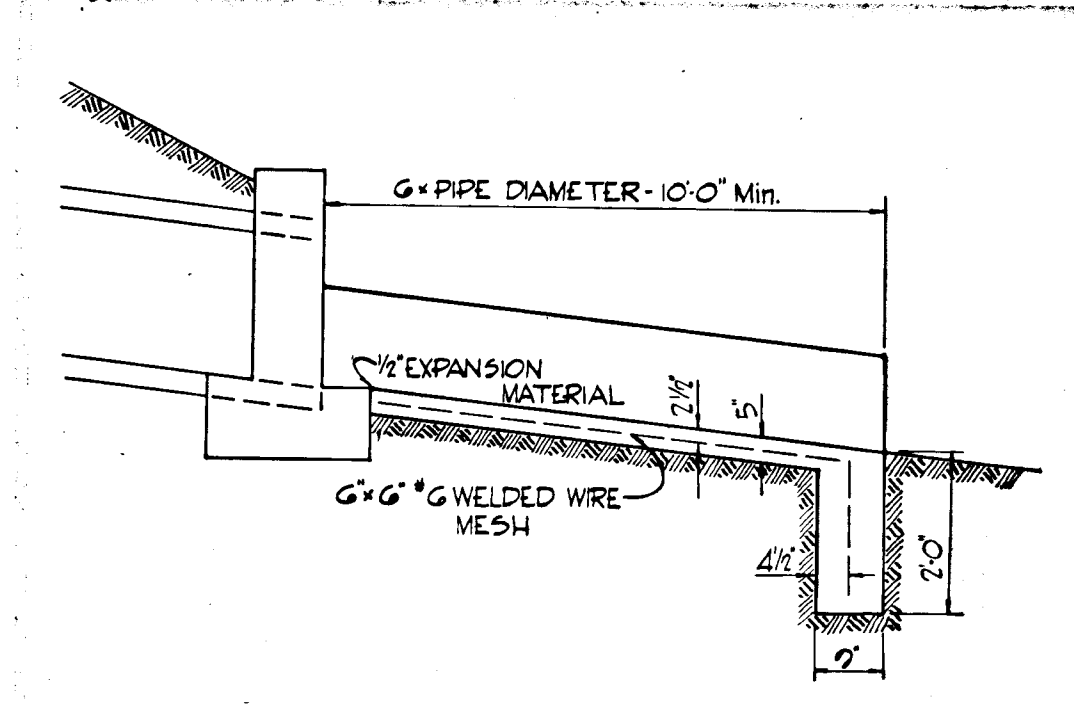

TYPICAL CONCRETE CHANNEL AND CUTOFF WALL
NO SCALE

APPROVED
DIVISION OF LAND DEVELOPMENT
OFFICE OF PLANNING AND ZONING
OF HOWARD COUNTY
DATE: MAY 1 1973

Richard P. Browne
RICHARD P. BROWNE 5235
DATE: 2-28-69

RICHARD P. BROWNE ASSOCIATES
CONSULTING ENGINEERS - PLANNERS
COLUMBIA, MARYLAND

Rev Date	Rev No	Revision Description

COLUMBIA
MARYLAND
6TH ELECTORAL DISTRICT - HOWARD COUNTY
OWNER AND DEVELOPER
HOWARD RESEARCH AND DEVELOPMENT CORP.
THE VILLAGE OF OAKLAND MILLS - BALTIMORE, MARYLAND 21210

PROJECT AREA
VILLAGE OF OAKLAND MILLS SEC. 1
TRUNDER HILL AREA 4 PART A

PROJECT TITLE
ROADWAY DETAILS

Des By	T.S.	Scale AS SHOWN	Dwg No	G 677
Drn By	B.P.	Date	25 FEB. 69	C.C.F. No
Chk By	T.S.	Approved		

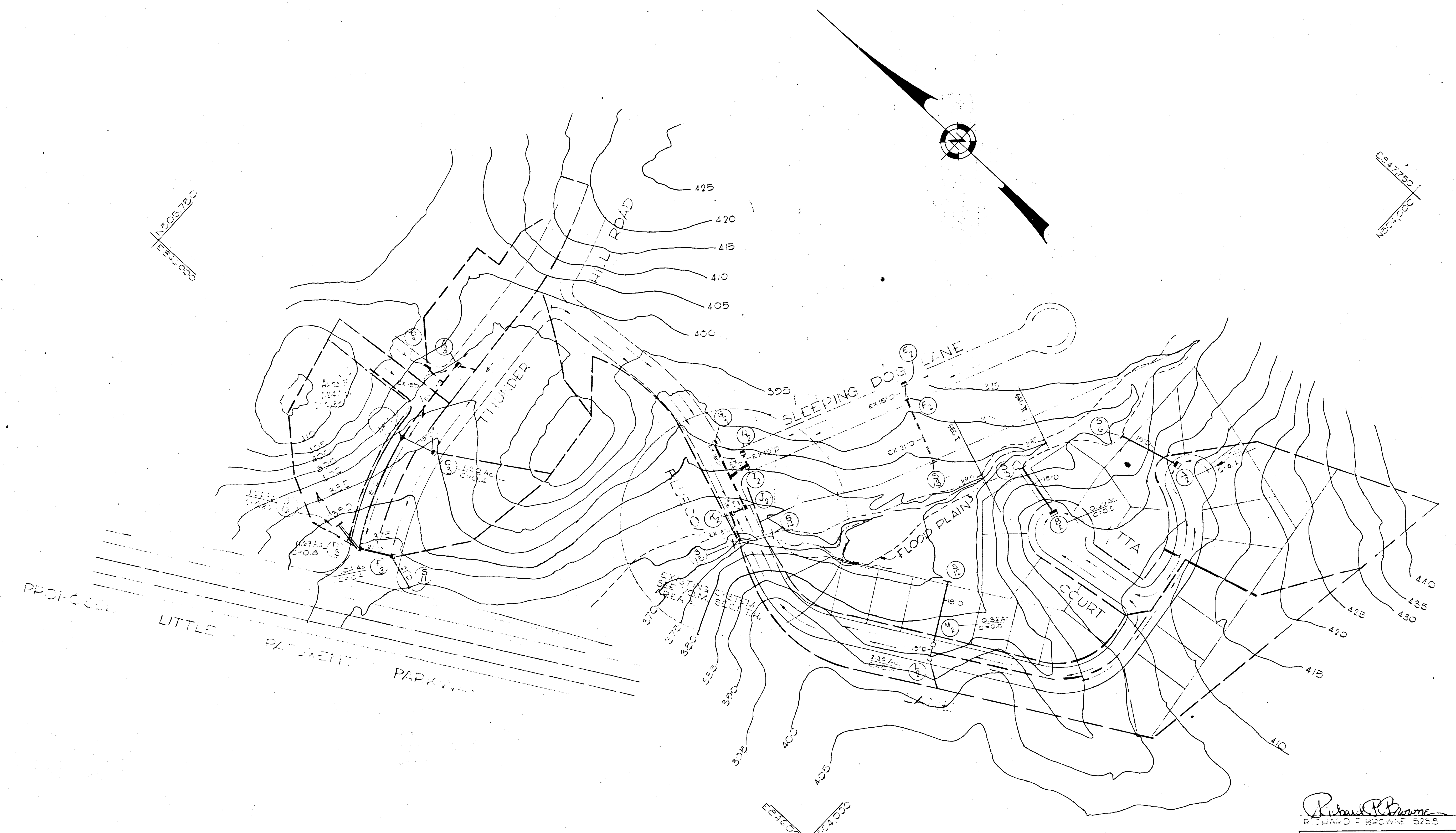

AP05730
157-000

ES-17250
150-1000

ES-17250
150-1000

APPROVED
DIVISION OF
LAND DEVELOPMENT
OFFICE OF
PLANNING AND ZONING
OF HOWARD COUNTY
DATE: 6-1-70
JNEF

Richard P. Browne
RICHARD P. BROWNE 3155
DATE

RICHARD P. BROWNE ASSOCIATES
CONSULTING ENGINEERS - PLANNERS
COLUMBIA, MARYLAND

Rev Date	Rev No	Revision Description

COLUMBIA
M A R Y L A N D
OWNER AND DEVELOPER

HOWARD RESEARCH AND DEVELOPMENT CORP.
THE VILLAGE OF CROSS KEY - BALTIMORE, MARYLAND 21212

PROJECT AREA
VILLAGE OF OAKLAND MILLS - 1501
THUNDER HILL AREA A - ARTA

PROJECT TITLE
DRAINAGE AREA MAP

Des By	Scale 1"=100'	Dwg No 70-1
Drn By	Date FEB 70	C.C.F. No
Chk By	Approved	