

26 APRIL 1968 APPROVED: HOWARD COUNTY PLANNING COM.
J. H. Clauson 5-23-68
 Senior Engineer Date
 APPROVED: HOWARD COUNTY ROADS DEPT.
B. W. McNamee 5-21-68
 Roads Superintendent Date
 APPROVED: HOWARD CO. METROPOLITAN COMM.
Carl H. Schuch 5-17-68
 Chief Engineer Date
PURDUM & JESCHKE
 ENGINEERS & LAND SURVEYORS
 24 PARK AVE
 ELLICOTT CITY, MARYLAND

DRAINAGE AREA MAP & STORM DRAIN
 DETAILS
 RESUBDIVISION LOT #5 - SEC #3 - AREA #2
 VILLAGE OF HARRERS CHOICE
 COLUMBIA
 5TH ELECTION DISTRICT 7 HOWARD COUNTY, MARYLAND
 30 MARCH 1968 SCALE: AS SHOWN
 REV: 5-17-68 SHEET No 2 of 2
 OWNER & DEVELOPER
 THE JAMES P. BEAN CO.
 10221 WINDGIPPS CIRCLE
 Columbia, Maryland

APPROVED
 PLANNING COMMISSION
 DATE _____

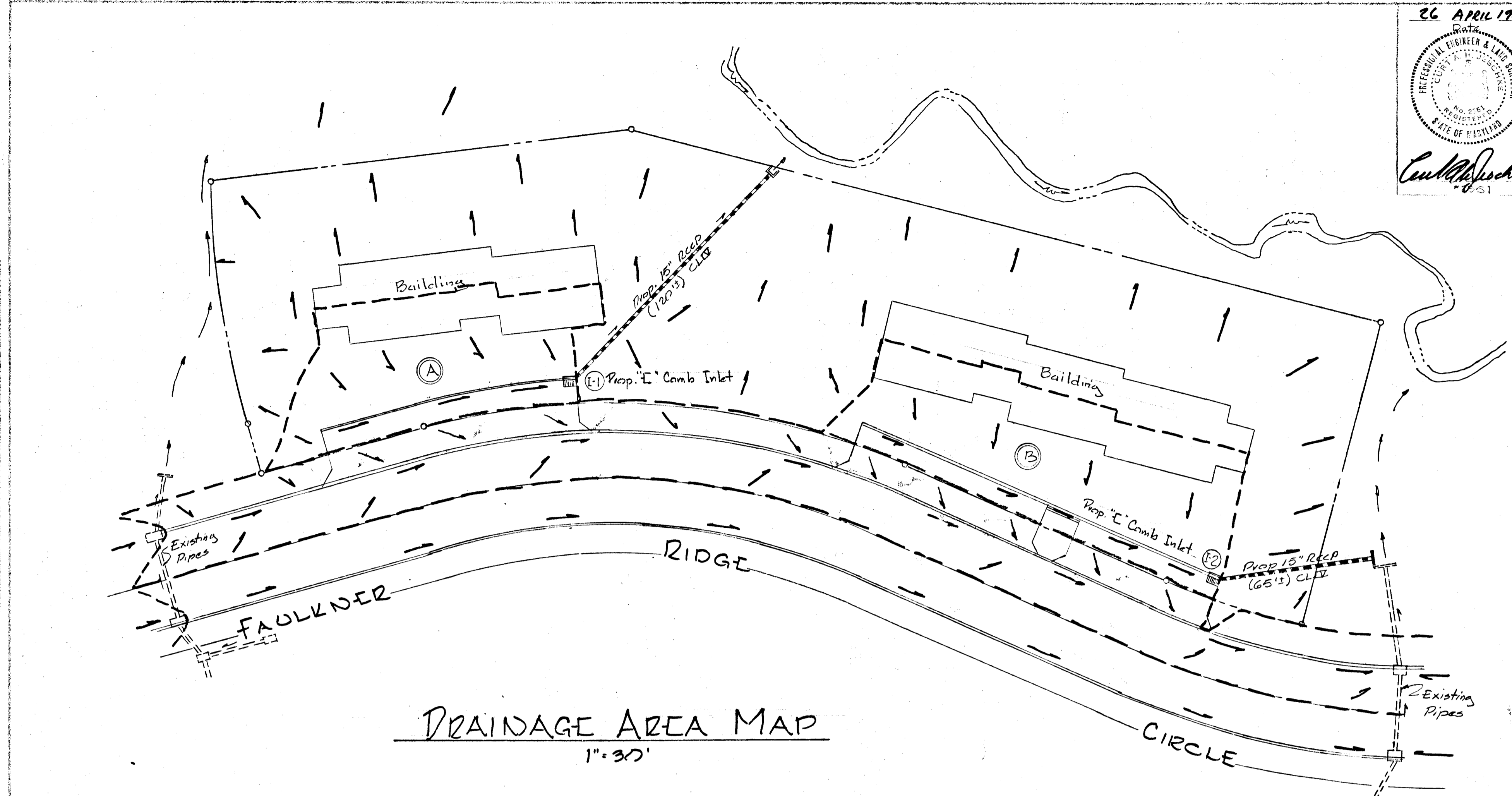

DRAINAGE AREA MAP
 1" = 30'

PROFILE SCALE
 Hor. 1" = 30'
 Vert. 1" = 5'-0"

DRAINAGE COMPUTATIONS

| AREA | ACRES | C" | T" | I" | Q | STREET SLOPE | INLET TYPE | CAP | SORCH. |
|------|-------|-----|----|-----|-----|--------------|------------|------|--------|
| "A" | 0.18 | 95% | 5 | 6.8 | 1.2 | Sump | "E" Comb | 10.0 | N/A |
| "B" | 0.24 | 95% | 5 | 6.8 | 1.6 | Sump | "E" Comb | 10.0 | N/A |

INLET DATA

| STRUCT. NO. | INVERTS | | HYP. GRAD. | | LH. IN. STRUCT. | PIPE | | | HYP. GRAD. SLOPE | |
|-------------|---------|--------|------------|-------|-----------------|---------|------|-----------|------------------|------|
| | IN | OUT | IN | OUT | | VEL. | SIZE | "L" SLOPE | | |
| I-1 | N/A | 392.80 | N/A | 394.6 | N/A | 7.0 fps | 15" | 120' | 6.6% | 4.8% |
| I-2 | N/A | 394.00 | N/A | 388.7 | N/A | 6.6 fps | 15" | 66' | 8.6% | 8.5% |

NOTES

- For Details of "E" Comb. Inlet see dwg. D-68, page 123 of The Howard County Local Constr. Code.
- For Details of type "C" Endwall see dwg. D-52, page 107 of said Code.
- For Details of type "G" Endwall see dwg. D-61, page 116 of said Code.
- For Details of Conc. Curbs see dwg. D-116, page 165 of said Code.

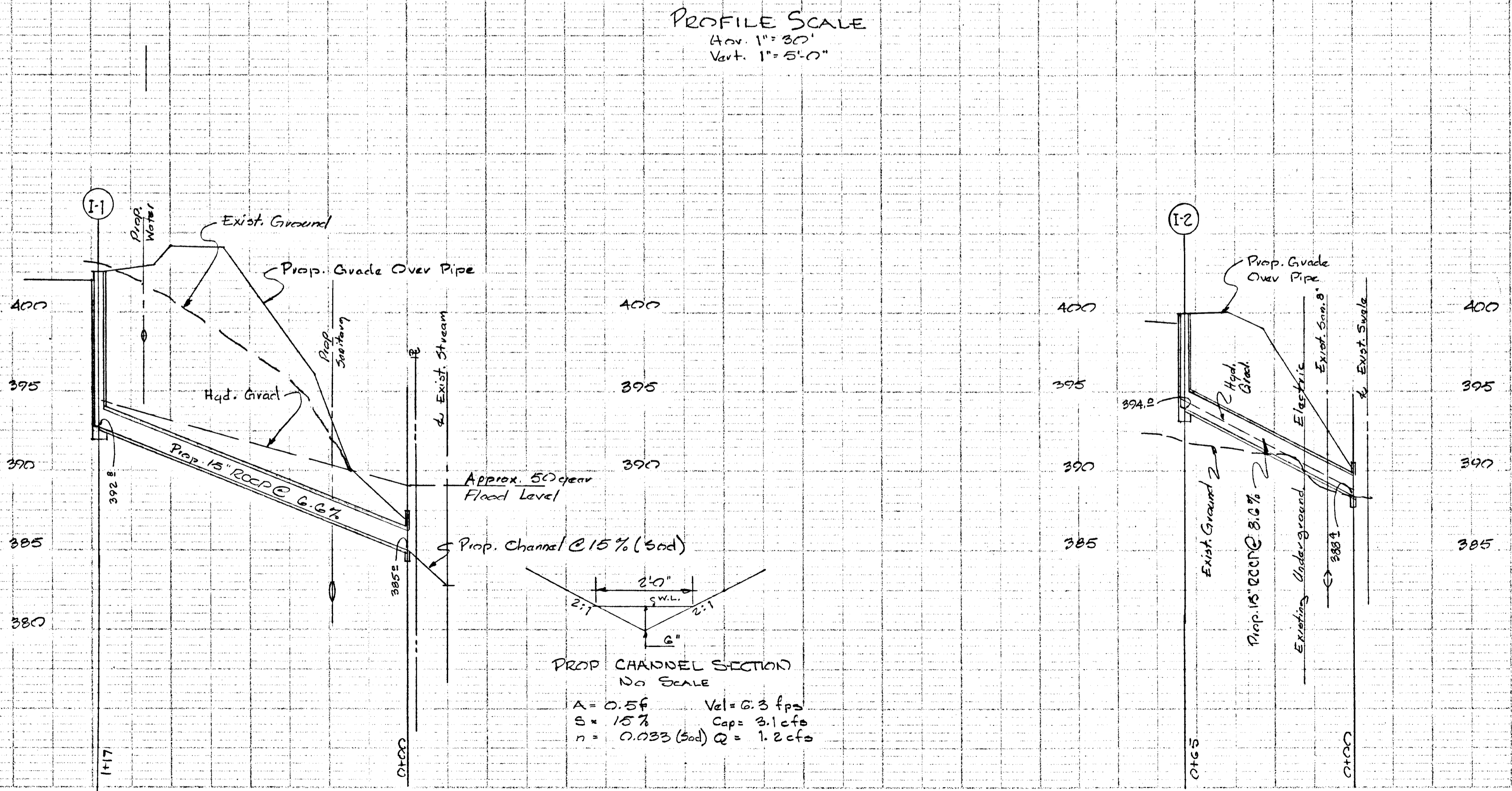

PROP. CHANNEL SECTION
 NO SCALE
 $A = 0.56$ Vel. = 0.3 fps
 $S = 15\%$ Cap. = 3.1 cfs
 $n = 0.033$ (Sod) $Q = 1.2 cfs$