

1/2 TYPICAL SECTION  
50' B/W  
SCALE: 1"=10'  
Minimum 7" compacted Bank Run Gravel  
M.S.R.C. Spec. 2 lbs. Calcium Chloride  
per Sq. Yd. - Leave 30 days.  
1-1/2" comp. spec. "B" Bit. Concrete Base course  
1" comp. spec. "B" Bit. Concrete Base course  
(This surface type to be constructed in accordance  
with Article C-31 Howard County Roads Spec.)

OWNER & DEVELOPER  
THE CHATHAM CORP. OF HOWARD CO.  
687 BALTIMORE NAT'L. PIKE  
ELLCOTT CITY, MARYLAND

ENGINEER:  
PURDUM & WESCHKE  
24 PARK AVENUE  
ELLCOTT CITY, MARYLAND

APPROVED: HOWARD COUNTY PLANNING COMM.  
*J. H. Clawson* 1-24-68  
Planning Engineer Date  
APPROVED: HOWARD COUNTY ROADS DEPT.  
*Thomas Scovell* 1-23-68  
Roads Superintendent Date  
APPROVED: HOWARD COUNTY METROPOLITAN COMM.  
*W. O. Albert* 1-23-67  
Chief Engineer Date

PLAN & PROFILE: JOEY DRIVE &  
RAMBLEWOOD ROAD  
SECTION N° 11  
Dec. 1, 1967  
Date

# CHATHAM

2<sup>ND</sup> ELECTION DIST. HOWARD COUNTY, MD.  
DECEMBER 1, 1967 SCALE: AS SHOWN

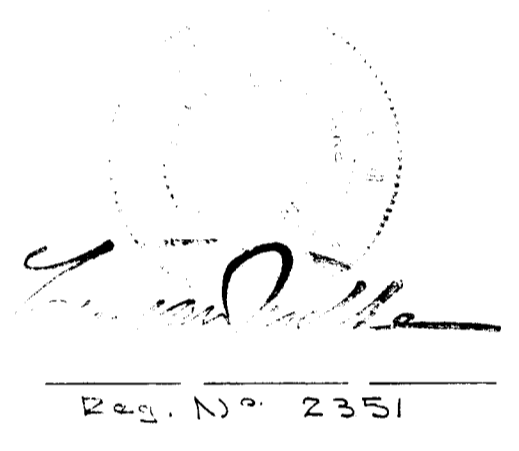

SHEET 1 OF 1

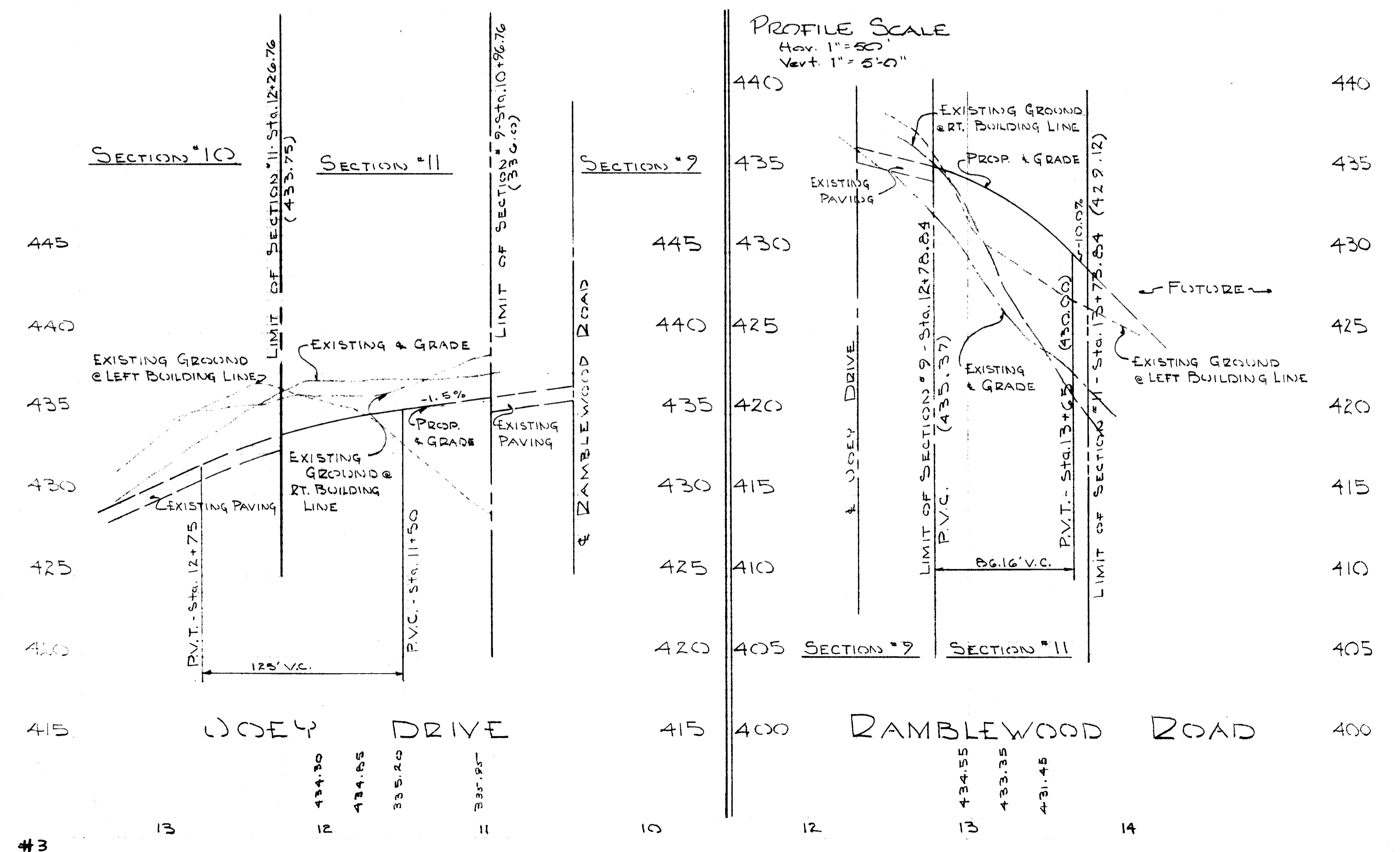

File-F-67-77