

APPROVED
 PLANNING COMMISSION
 OF HOWARD COUNTY
 DEC 20 1967

12/18/67	1	SHOW ULTIMATE WIDENING	JWA
Rev Date	Rev No	Revision Description	
COLUMBIA			
M A R Y L A N D			
HOWARD RESEARCH AND DEVELOPMENT CORP THE VILLAGE OF CROSS KEYS - BALTIMORE, MARYLAND 21210			
PROJECT TITLE: LITTLE PATUXENT PARKWAY STA. 67+00 TO STA. 73+00			
Des By	G.J.J.	Scale: 1"=50' Hor., 1"=5' Vert. Div. No. 2 of 3	
Dirn By	G.J.J.	Date: Sept. 28, 1967	C.C.F. No.
Chk By	E.J.P.	Approved	

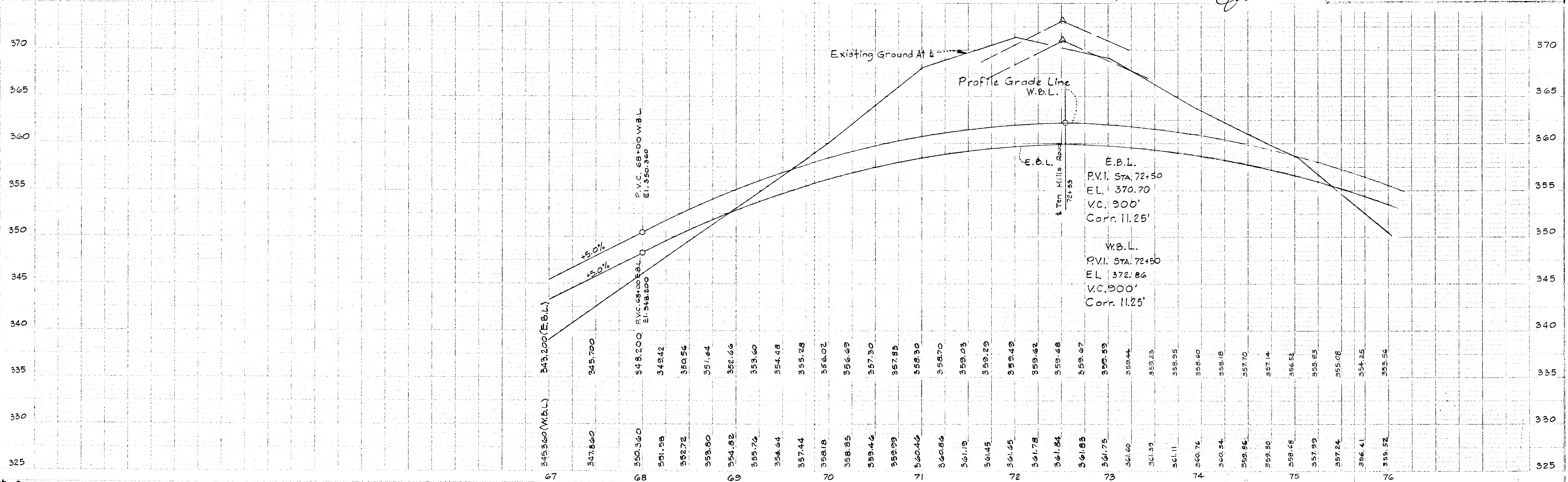
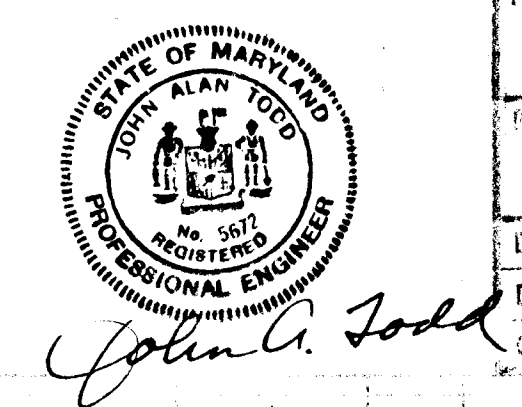

XXLI-67-002 F-67-64

Note: 4" Topsoil, Seed (Art. 36.04) & Mulch (Art. 36.05) To Be Placed On All Median Area, Construction Slopes & Ditches Unless Otherwise Noted On The Plans (Seeding and Mulching By Owner)

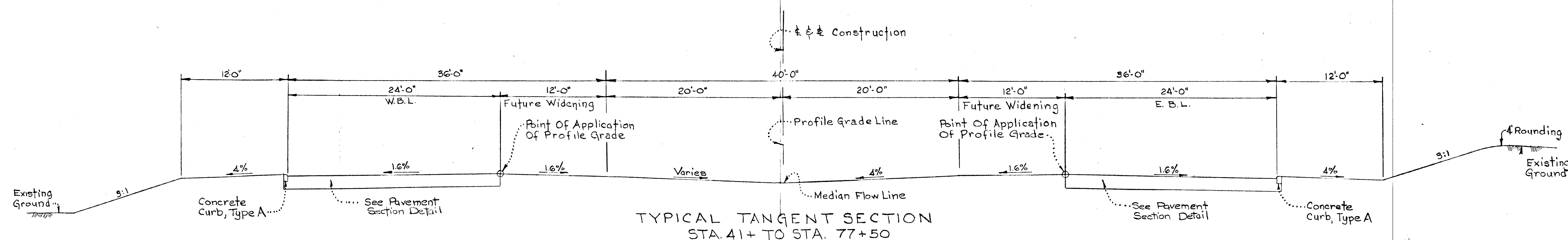

TYPICAL TANGENT SECTION
STA. 41+ TO STA. 77+50

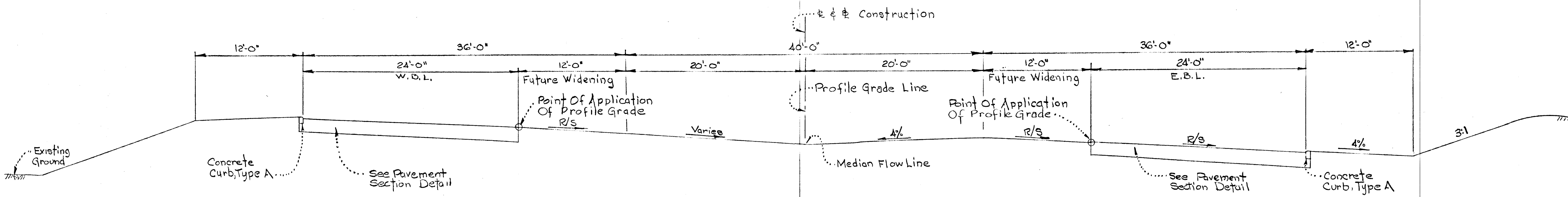

TYPICAL SUPERELEVATED SECTION
STA. 41+ TO STA. 77+50
SCALE 1" = 6'

BITUMINOUS CONCRETE SURFACE	BAND C-3	1.5"	FINAL PHASE
BITUMINOUS CONCRETE SURFACE	BAND C-3	1.5"	SECOND PHASE
BITUMINOUS CONCRETE BINDER	BAND A-3	2.5"	FIRST PHASE
BITUMINOUS CONCRETE BASE	BAND C-2 OR G-3	4"	
7" CRUSHER RUN SUB-BASE	CR-467	7"	

SUB-BASE COURSE: ARTICLE C-25-2(a)
 BASE COURSE: " C-31 OR C-33 } REFERS TO SECTION
 BINDER COURSE: " C-31 IN COUNTY SPECS.
 SURFACE COURSE: " C-31

TO BE CONSTRUCTED IN ACCORDANCE WITH THE HOWARD COUNTY ROAD CONSTRUCTION CODE AND SPECIFICATIONS

TYPICAL PAVEMENT MATERIAL SECTIONS
LITTLE PATUXENT PARKWAY

NO SCALE

APPROVED
PLANNING COMMISSION
OF HOWARD COUNTY
DEC 20 1967

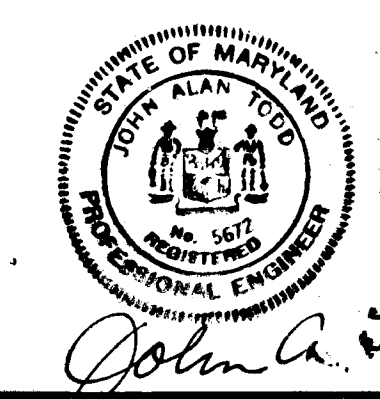

Rev Date	Rev No	Revision Description

COLUMBIA
MARYLAND

THE ROUSE COMPANY THE VILLAGE OF CROSS KEYS, BALTIMORE, MARYLAND 21210

PROJECT AREA: LITTLE PATUXENT PARKWAY
 PROJECT TITLE: TYPICAL SECTION & DETAIL

Des By	Scale AS SHOWN	Dwg No
Drn By EJR	Date 3-23-67	C.C.F. No
Chk By T.A.I.	Approved	

XX-67-003 E-57-64

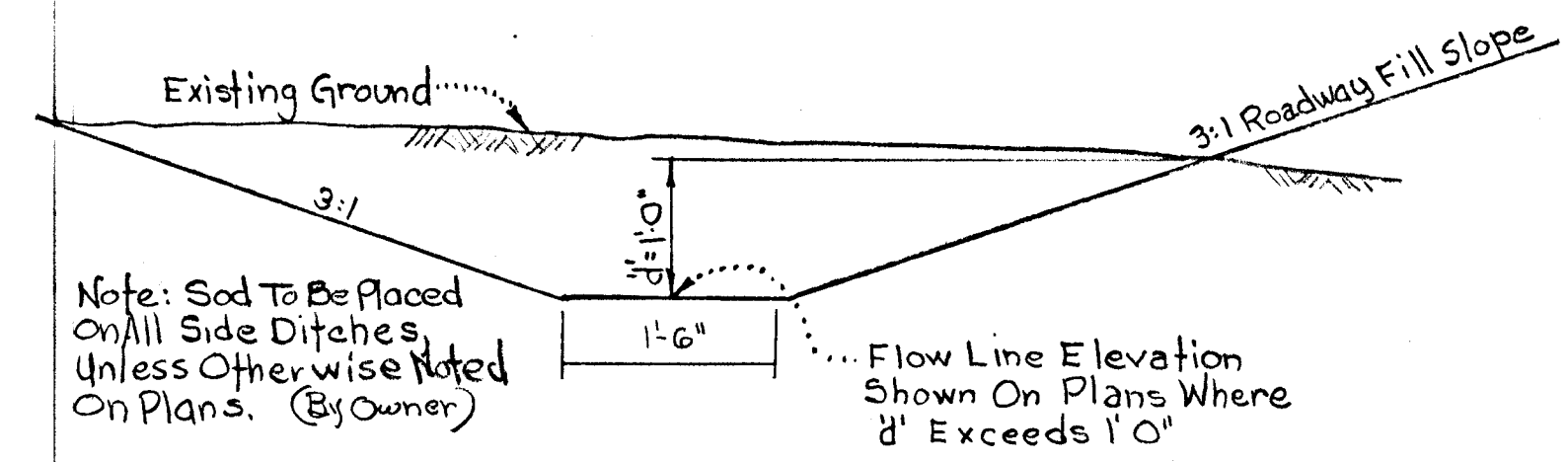

DETAIL
SIDE DITCH
Scale: 3/4" = 1'-0"

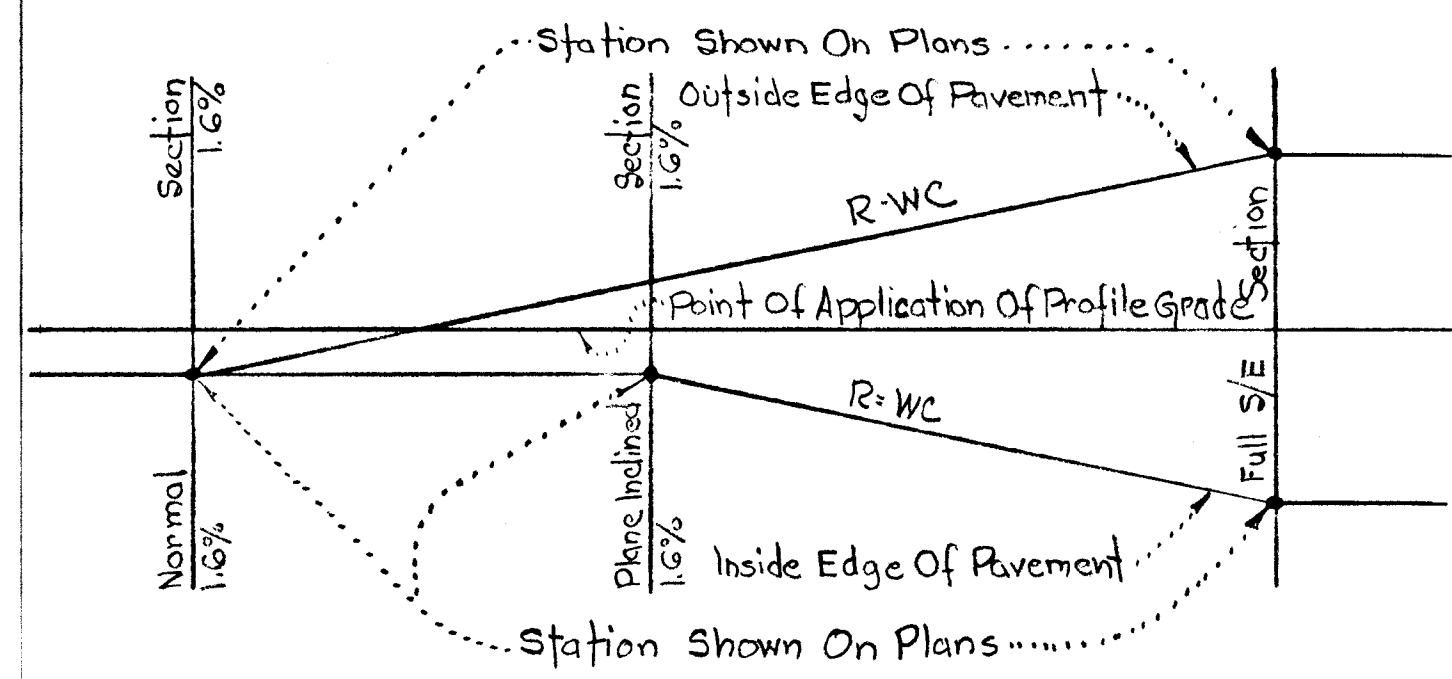

W: Width Of Pavement
 R: Rate Of Change Of A Given Point On The Pavement With Respect To The Point Of Application Of Profile Grade
 C: 0.0002 ft per ft. Except For The Transitions Between Station 28+35 And Station 43+21.67, Which Are 0.00015 ft. per ft.

DETAIL
SUPERELEVATION TRANSITION

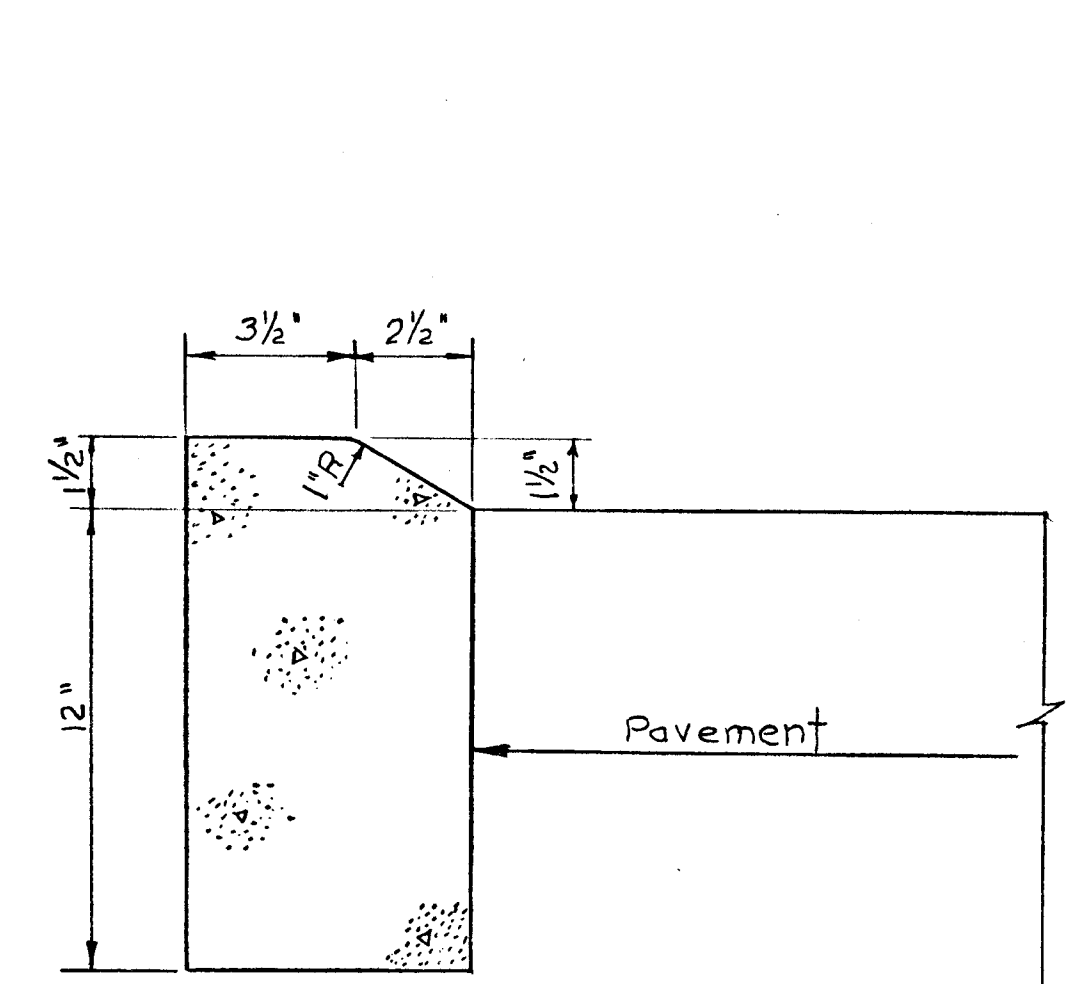

DETAIL
CONCRETE CURB - TYPE A
Scale: 3" = 1'-0"

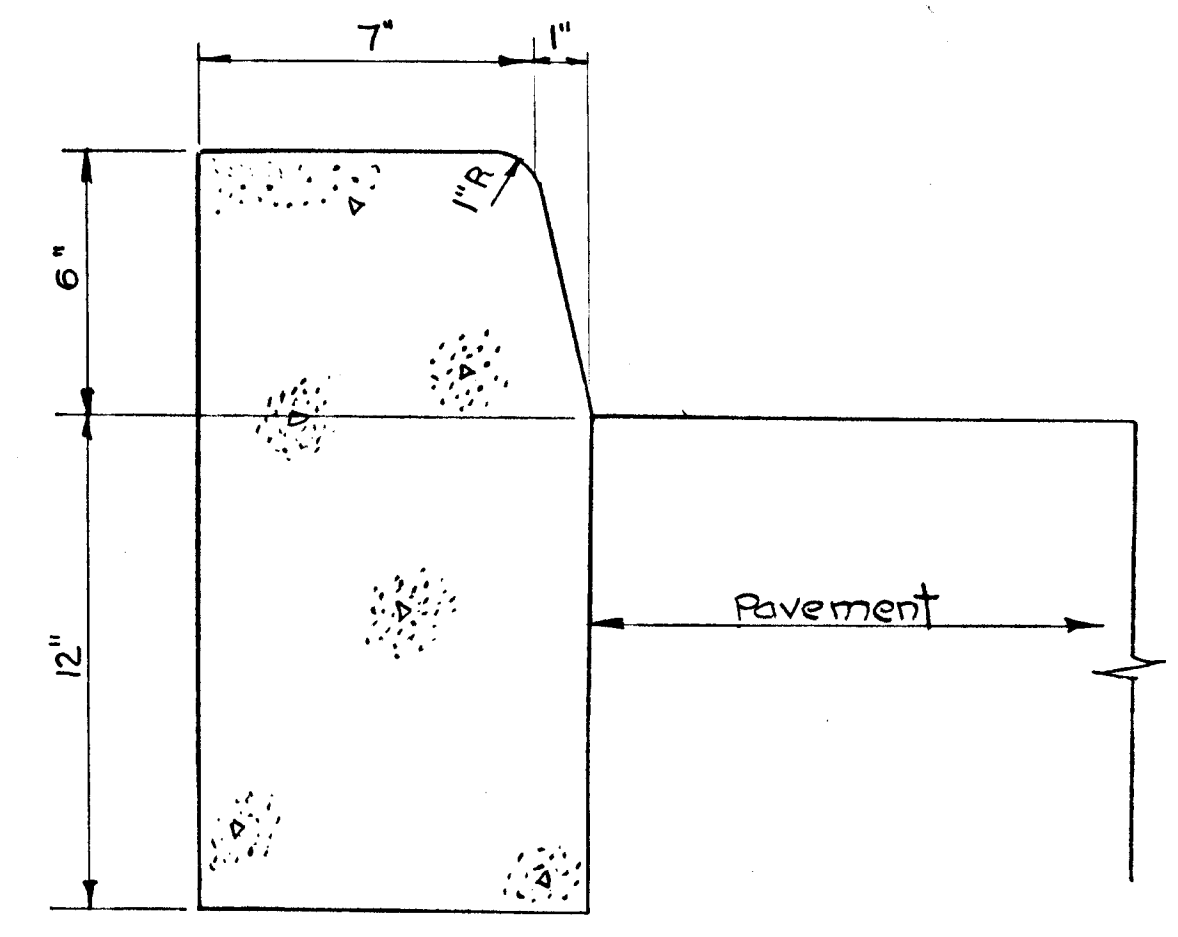

DETAIL
VERTICAL CONCRETE CURB
TYPE B
Scale: 3" = 1'-0"