

6 June 1966
 Date

PURDUM & JESCHKE
 ENGINEER & SURVEYORS
 24 PARK AVE.
 ELLICOTT CITY, MARYLAND

OWNED & DEVELOPED BY
AINTREE ESTATES, INC.
 617 1/2" STREET, N.W.
 WASHINGTON, D.C. 20001

APPROVED: HOWARD COUNTY PLANNING COMM.
J. H. Clawson 7-11-66
 Senior Engineer Date

APPROVED: HOWARD COUNTY ROADS DEPT.
Francis W. Madson June 6, 1966
 Roads Engineer Date

APPROVED: HOWARD CO. METROPOLITAN COMM.
W. O. Folbert 7-11-66
 Chief Engineer Date

APPROVED
 PLANNING COMMISSION
 OF HOWARD COUNTY

PLAN & PROFILE: LINKYTHORN LANE
 SECTION "1"
"AINTREE ESTATES"
 5th ELECTION DIST. - HOWARD COUNTY, MD.
 6 MAY 1966
 20 JUNE 1966
 SCALE: AS SHOWN
 Sheet 1 of 2

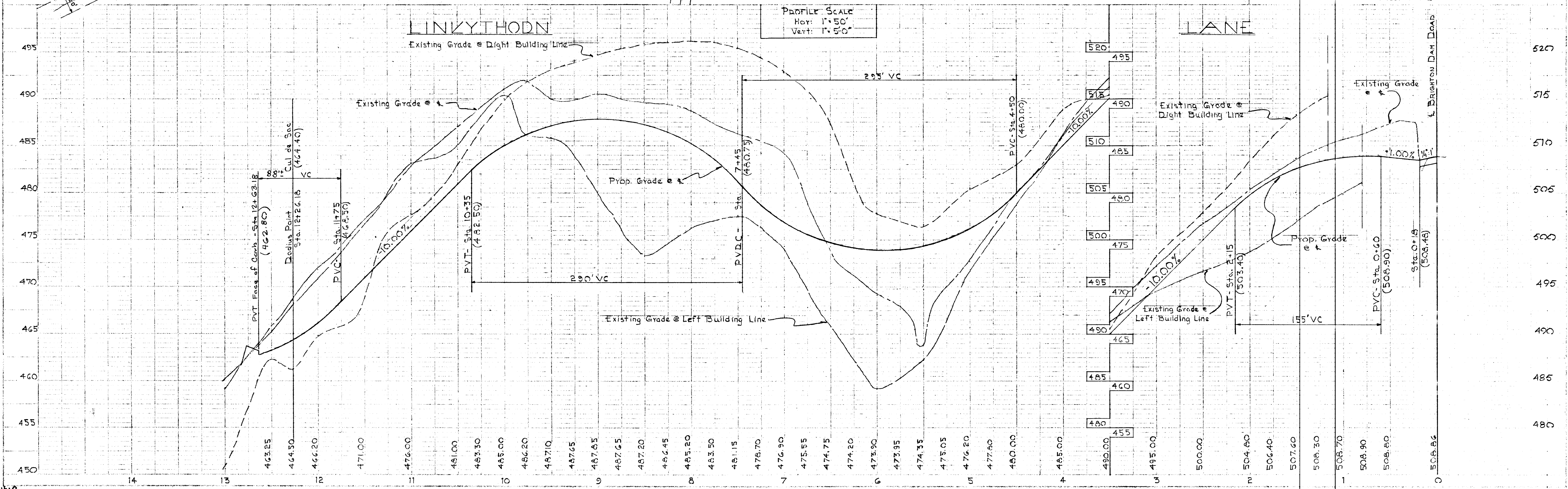

#18
 RP17A

F-66-27

GENERAL NOTES:

- 1) FOR DETAILS OF PAVING SECTION SEE DRAWING D-4, PAGE 59 OF THE HOWARD COUNTY ROAD BUILDING CODE & STANDARD SPECIFICATIONS.
- 2) FOR DETAILS OF TYPE 'C' ENDWALL SEE DRAWING D-52, PAGE 107 OF THE ABOVE MENTIONED SPECIFICATIONS.
- 3) FOR DETAILS OF TYPES A/B INLETS SEE ATTACHED DRAWINGS.

6 June 1966
Date

PODDUM &
JESCAKE
ENGINEERS &
SURVEYORS
24 PARK AVE.
ELLCOTT CITY, MARYLAND
Reg. No. 2351

Arthur J. Poddum
Date

OWNED & DEVELOPED BY
AINTREE ESTATES INC.
617 "K" STREET, N.W.
WASHINGTON, D.C. 20001

APPROVED: HOWARD COUNTY PLANNING COMM.
J. H. Clewson 7-11-66
Senior Engineer Date

APPROVED: HOWARD COUNTY ROADS DEPT.
Traville R. Steward June 6, 1966
Roads Engineer Date

APPROVED: HOWARD CO. METROPOLITAN COMM.
W. O. S. Hunt 7-11-66
Chief Engineer Date

APPROVED
PLANNING COMMISSION
OF HOWARD COUNTY

DETAIL SHEET
SECTION '1'

"AINTREE ESTATES"
5TH ELECTION DIST. ~ HOWARD COUNTY, MD.
6 MAY 1966
30 JUNE 1966
SCALE AS SHOWN
Sheet 2 of 2

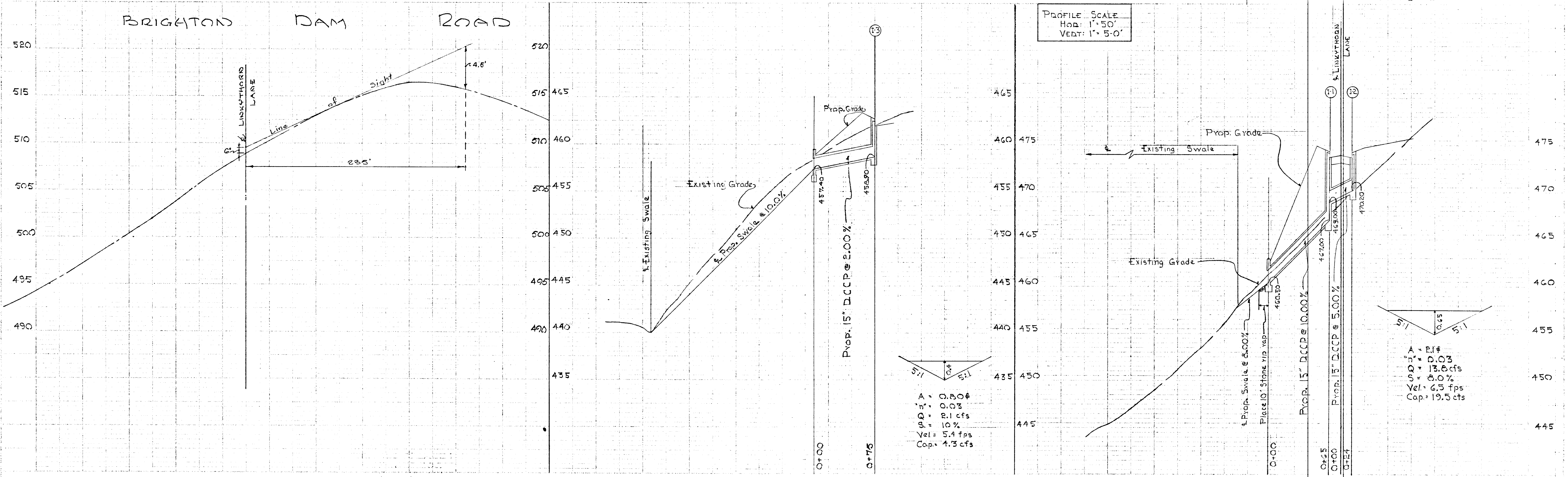

#18
RP174

F-66-27