

- PLANTING NOTES**
- CONTRACTOR SHALL BE RESPONSIBLE FOR NOTIFYING UTILITY COMPANIES, UTILITY CONTRACTORS AND ALL OTHER CONCERNED PARTIES 48 HOURS PRIOR TO BEGINNING WORK. CONTRACTOR SHALL BE RESPONSIBLE FOR DAMAGE TO UTILITIES DUE TO INCOORDINATED WORK. CONTRACTOR SHALL MAKE MINOR ADJUSTMENTS IN SPACING AND LOCATION OF PLANT MATERIAL TO AVOID CONFLICTS WITH UTILITIES.
 - PLANTS, RELATED MATERIAL AND OPERATIONS SHALL MEET THE DETAILED DESCRIPTION AS GIVEN ON THE PLANS AND AS DESCRIBED HEREIN.
 - PLANT MATERIAL, UNLESS OTHERWISE SPECIFIED, SHALL BE NURSERY-GROWN, UNIFORMLY BRANCHED AND HAVE A WOODROT RESISTANT ROOT SYSTEM. PLANT MATERIAL SHALL BE HEALTHY, WOODROT FREE FROM DEFECTS, DECAY, DISFIGURING ROOTS, SUNSCALD INJURIES, ABRASIONS OF THE BARK, PLANT DISEASE, INSECT BITE OR OTHER DEFECTS. INVESTIGATIONS OR OBJECTIONABLE DISFIGUREMENTS. PLANT MATERIAL THAT IS WEAK OR WHICH HAS BEEN CUT BACK FROM LARGER GRADES TO MEET SPECIFIED REQUIREMENTS WILL BE REJECTED. TREES WITH FORKED LEADERS WILL NOT BE ACCEPTED. PLANTS SHALL BE FRESHLY DUG, NO HELED-IN PLANTS OR PLANTS FROM COLD STORAGE WILL BE ACCEPTED.
 - UNLESS OTHERWISE SPECIFIED, PLANT MATERIAL SHALL CONFORM TO "AMERICAN STANDARD FOR NURSERY STOCK" AND Z61-1-1990, PUBLISHED BY THE AMERICAN ASSOCIATION OF NURSERYMEN, INCLUDING ALL ADDENDA.
 - UNLESS OTHERWISE SPECIFIED, GENERAL CONDITIONS, PLANTING OPERATIONS, DETAILS AND PLANTING SPECIFICATIONS SHALL CONFORM TO "LANDSCAPE SPECIFICATION GUIDELINES", (HEREINAFTER "LANDSCAPE GUIDELINES"), APPROVED BY THE LANDSCAPE CONTRACTORS ASSOCIATION OF METROPOLITAN WASHINGTON AND THE POTOMAC CHAPTER OF THE AMERICAN SOCIETY OF LANDSCAPE ARCHITECTS, LATEST EDITION, INCLUDING ALL ADDENDA.
 - CONTRACTOR SHALL BE REQUIRED TO GUARANTEE PLANT MATERIAL FOR A PERIOD OF TWO YEARS IN ACCORDANCE WITH THE LANDSCAPE GUIDELINES. CONTRACTOR'S ATTENTION IS DIRECTED TO THE MAINTENANCE REQUIREMENTS FOUND WITHIN THE SPECIFICATIONS INCLUDING WATERING AND REPLACEMENT OF SPECIFIED PLANT MATERIAL.
 - PLANTING BEDS SHALL BE MULCHED AS SPECIFIED TO THE LIMITS OF THE PLANTING BEDS AS SHOWN ON THE PLAN AND TO THE DEPTH AS SHOWN ON THE DETAIL.
 - PROTECTION OF EXISTING VEGETATION TO REMAIN SHALL BE ACCOMPLISHED BY THE TEMPORARY INSTALLATION OF 4' HIGH SNOW FENCE, LOCATIONS SHOWN ORANGE PLASTIC MESH OR OTHER APPROVED FENCING, IN LOCATIONS SHOWN ON THE PLAN, AT THE DRIP LINE.
 - CONTRACTOR IS RESPONSIBLE FOR INSTALLING PLANT MATERIAL IN THE PROPER PLANTING SEASON FOR EACH PLANT SPECIFIED.
 - PLANTING MIX SHALL BE AS FOLLOWS: DECIDUOUS PLANTS - TWO PARTS TOPSOIL, ONE PART WELL-ROTTED COW MANURE; ADD 3 LBS. OF STANDARD FERTILIZER PER CUBIC YARD OF PLANTING MIX. EVERGREEN PLANTS - TWO PARTS TOPSOIL, ONE PART HUMUS OR OTHER APPROVED ORGANIC MATERIAL; ADD 3 LBS. OF EVERGREEN (ACIDIC) FERTILIZER PER CUBIC YARD OF PLANTING MIX. TOPSOIL SHALL CONFORM TO THE LANDSCAPE GUIDELINES.
 - THIS PLAN IS INTENDED FOR LANDSCAPE USE ONLY. SEE OTHER PLAN SHEETS FOR MORE INFORMATION ON GRADING, SEDIMENT CONTROL, LAYOUT, ETC.

FOREST CONSERVATION WORKSHEET 2.1

Note: Use 0 for all negative numbers that result from the calculations.

Net Tract Area

A. Total Tract Area (Ac.) A= 9.49

B. Deductions (Area of Lot 1 plus road dedication) B= 5.92

C. Area to remain in agricultural production C= 0.00

D. Net Tract Area D= 2.57

Land Use Category: Residential - High Density

E. Afforestation Threshold (Net Tract Area (D) x 15%) E= 0.39

F. Conservation Threshold (Net Tract Area (D) x 20%) F= 0.51

Existing Forest Cover

G. Existing Forest Cover within the Net Tract Area G= 2.11

H. Area of Forest above Afforestation Threshold H= 1.72

I. Area of Forest Above Conservation Threshold I= 1.60

If the Existing Forest Cover (G) is greater than the Conservation Threshold (I), then I = G - F; Otherwise I = 0.

Break Even Point

J. Break Even Point (Amount of forest that must be retained so that no mitigation is required) J= 0.83

(1) If the area of forest above the Conservation Threshold (I) is greater than zero then H = (0.2 x the area of forest above Conservation Threshold (I)) + the Conservation Threshold (F)

K. Forest Clearing Permitted Without Mitigation

L. Existing Forest Cover (G) - Break even point (J) K= 1.28

Proposed Forest Clearing

L. Total Area of Forest to be Cleared L= 1.16

M. Total Area of Forest to be Retained M= 0.95

N. Total Reforestation Required R = N + P - Q

O. Net Reforestation Required R= 0.00

S. Total Afforestation Required S= 0.00

T. Total Planting Requirement T = R + S T= 0.00

U. Excess Forest Credit U= 0.15

* NOTE: THE AREA INDICATED IN B (6.92 ACRES) REPRESENTS THE AREA OF LOT 1 PLUS ROAD DEDICATION.

PERIMETER PLANT LIST

KEY	BOTANICAL NAME	COMMON NAME	SPACING	SIZE	REMARKS	QUANTITY
+	ACER RUBRUM	RED SUNSET RED	AS SHOWN	2.5"-3" CAL.	B&B	4

STREET TREE PLANT LIST

KEY	BOTANICAL NAME	COMMON NAME	SPACING	SIZE	REMARKS	QUANTITY
+	ACER RUBRUM	RED SUNSET RED	AS SHOWN	2.5"-3" CAL.	B&B	8

BIORETENTION PLANT LIST

KEY	BOTANICAL NAME	COMMON NAME	SPACING	SIZE	REMARKS	QUANTITY
AND	ASTER NOVAE-ANGLIAE	NEW ENGLAND ASTER	1.5 FEET	6"-8" HT.	CONT.	16
CAL	CLETHRA ALNFOLIA	SWEET PEPPERBUSH	6 FEET	2"-3" HT.	CONT.	6
LCA	LOBELIA CARDINALIS	CARDINAL FLOWER	1.5 FEET	6"-8" HT.	CONT.	58

SCHEDULE A : PERIMETER LANDSCAPED EDGE

CATEGORY	ADJ. TO PERIMETER PROPERTIES	PERIMETER 1 - TYPE A
LANDSCAPE TYPE	LINEAR FEET OF PERIMETER	583 LF
CREDIT FOR EXISTING VEGETATION (YES, NO, LINEAR FEET)	YES, 230 LF (233 LF REMAINING)	
CREDIT FOR WALL, FENCE, OR BERM (YES, NO, LINEAR FEET)	NO	
NUMBER OF PLANTS REQUIRED		
SHADE TREES	4 SHADE TREES	
EVERGREEN TREES	0 EVERGREEN TREES	
SHRUBS	0 SHRUBS	
NUMBER OF PLANTS PROVIDED		
SHADE TREES	4 SHADE TREES	
EVERGREEN TREES	0 EVERGREEN TREES	
OTHER TREES (2:1 SUBSTITUTION)	0 SUBSTITUTION TREES	
SHRUBS (10:1 SUBSTITUTION)	0 SHRUBS	

STREET TREE CALCULATIONS

HANOVER ROAD = 315 LF 40 = 8 TREES

TOTAL TREES REQUIRED = 8 TREES

TOTAL TREES PROVIDED = 8 TREES

MATERIALS SPECIFICATIONS FOR BIORETENTION FACILITIES

MATERIAL	SPECIFICATION	SIZE	NOTES
PLANTINGS	SEE PLANT LIST THIS SHEET	N/A	PLANTINGS ARE SITE-SPECIFIC. SEE PLANT LIST THIS SHEET.
PLANTING SOIL	SAND 35% - 60% SILT 0% - 25% GROUND COMPOST 40%-50%	N/A	
MULCH	SHREDDED HARDWOOD PEA GRAVEL: ASTM-D-448 ORNAMENTAL STONE: WASHED COBBLES	PEA GRAVEL: NO. 6 STONE: 2" TO 5"	AGED 6 MONTHS, MINIMUM
GEOTEXTILE	CLASS "SE" - APPARENT OPENING SIZE (ASTM-D-4751), GRAB TENSILE STRENGTH (ASTM-D-4832), PUNCTURE RESISTANCE (ASTM-D-4833)	N/A	TYPAR 3601, TREVA 1127 OR APPROVED EQUAL
UNDERDRAIN GRAVEL	ASHTO M-43	3" TO 8"	
UNDERDRAIN PIPING	6" 7.5' TYPE PS 28 OR ASHTO M-278	4" TO 6" RIGID SCHEDULE 40 PVC OR SDR35	FOR USE AS NECESSARY BENEATH UNDERDRAINS ONLY. 3/8" PER FOR 6" DIA CENTER. 4 HOLES PER ROW, MINIMUM OF 3" OF GRAVEL OVER PIPES, NOT NECESSARY UNDERDRAIN PIPES.

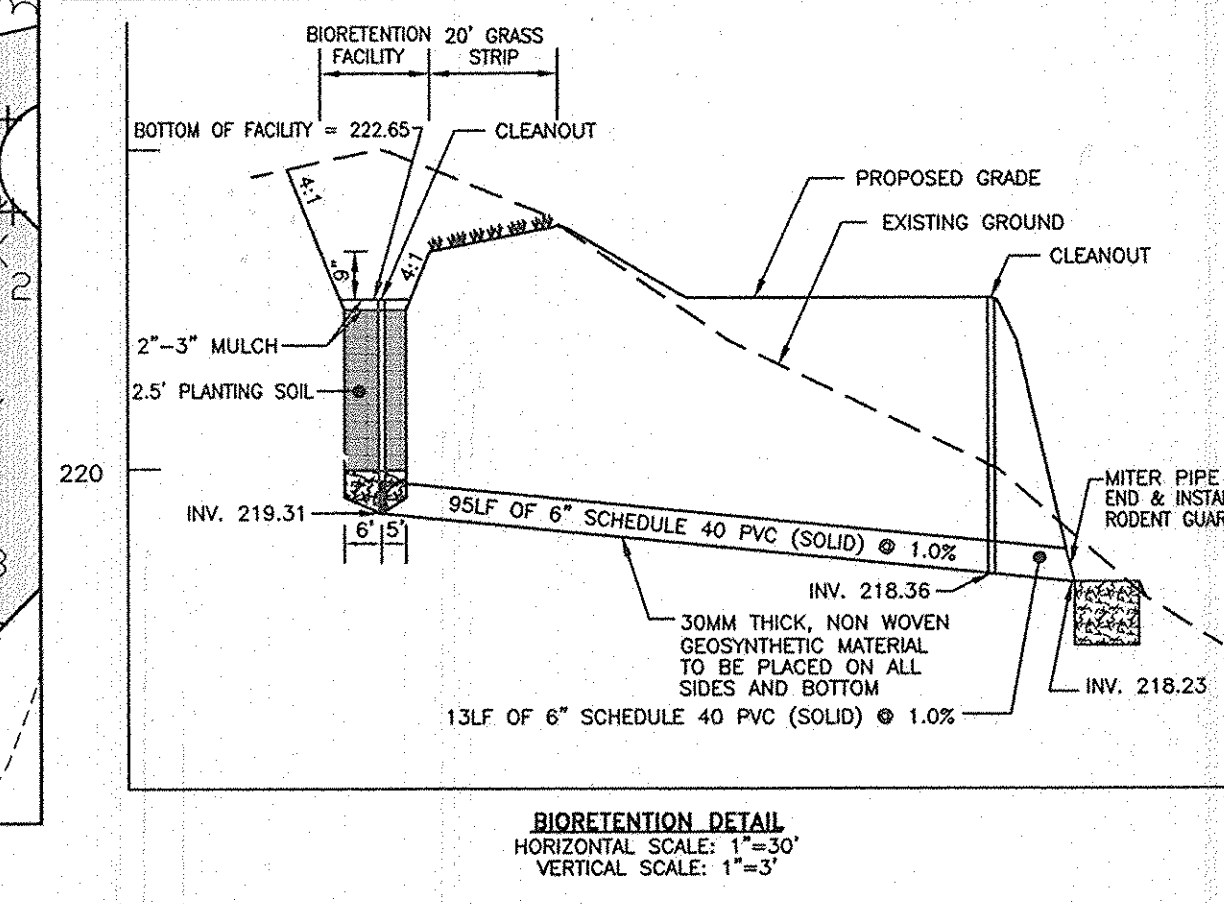
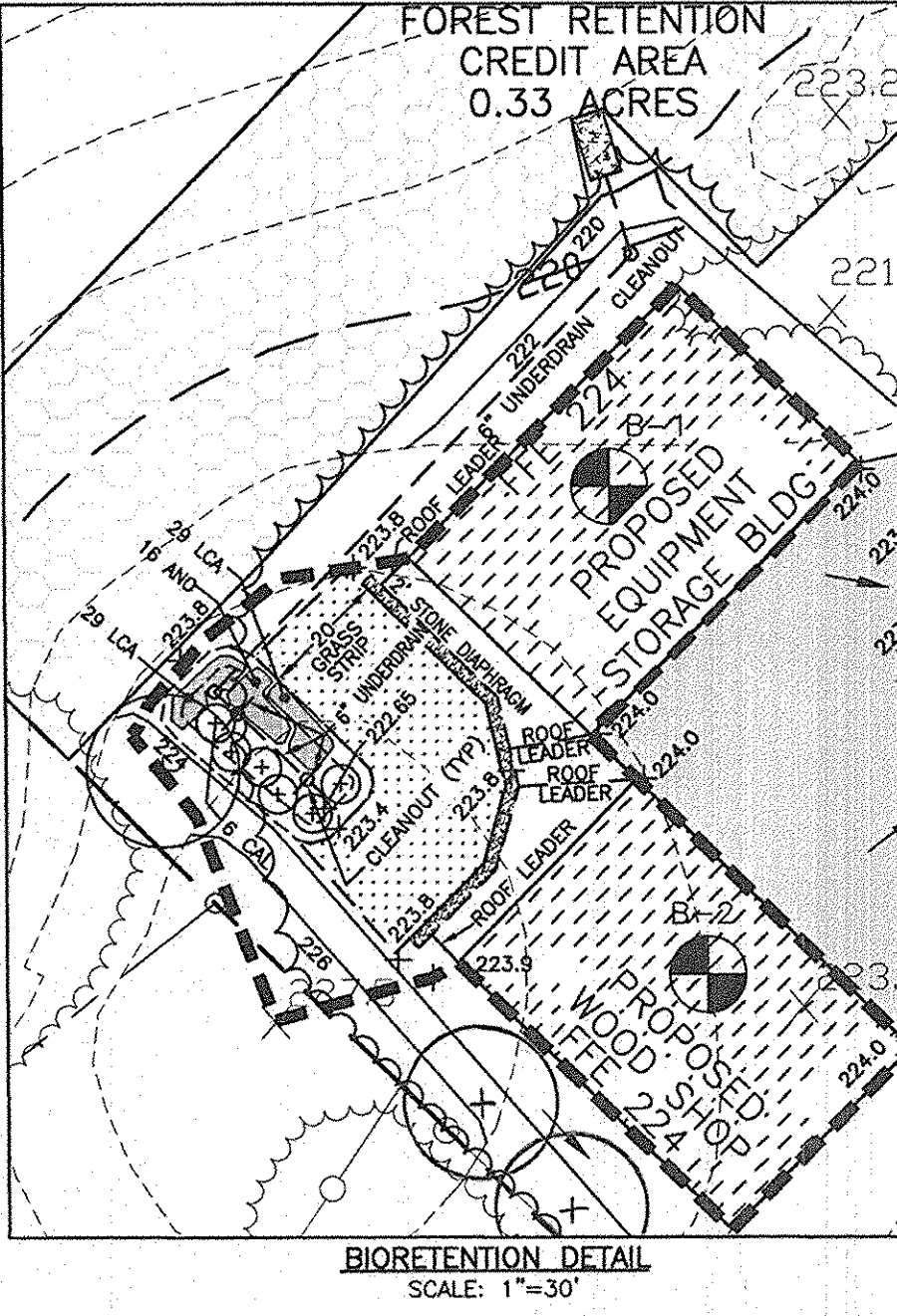

HARMS ENGINEERS - PLANNERS - SURVEYORS

41 EAST ALL SAINTS STREET, SUITE 210 HARWOOD, MARYLAND 21076
OFFICE: 301/881-8687 FAX: 301/881-8698

SUPPLEMENTAL, LANDSCAPE, & FOREST CONSERVATION PLAN

LEWIS PROPERTY

LOTS 1 & 2

Howard Election District No. 1 Tax Map 48, Parcel 494

Scale: 1"=50'

DESIGNED BY: *SJD*

DRAWN BY: *SJD*

CHECKED BY: *SJD*

DATE: JAN 2007

W.O. NO. 08-05-035A

APPROVED: DEPARTMENT OF PLANNING AND ZONING

Mama 3/7/07
CHIEF, DIVISION OF LAND DEVELOPMENT DATE

Yvonne Zimmerman 3/6/07
CHIEF, DEVELOPMENT ENGINEERING DIVISION DATE

1 OF 1

FOG-242