

LEGEND

- Forest Easement Signage
- Forest Conservation Easement
- Steep Slopes 15-24.9%
- Steep Slopes >25%
- Existing Contour 5
- Existing Contour 25
- Property Boundary Line
- Soils Division Line
- Fence Line
- Forest Stand Type Boundary
- Existing Stream
- Stream Buffer
- Tree Line
- Wetlands
- Wetlands Buffer

GENERAL NOTES

- Parcel 3 is an existing Howard County Agricultural Preservation Parcel HO-02-03-E with an existing house.
- Reference: L 6235, F 0054

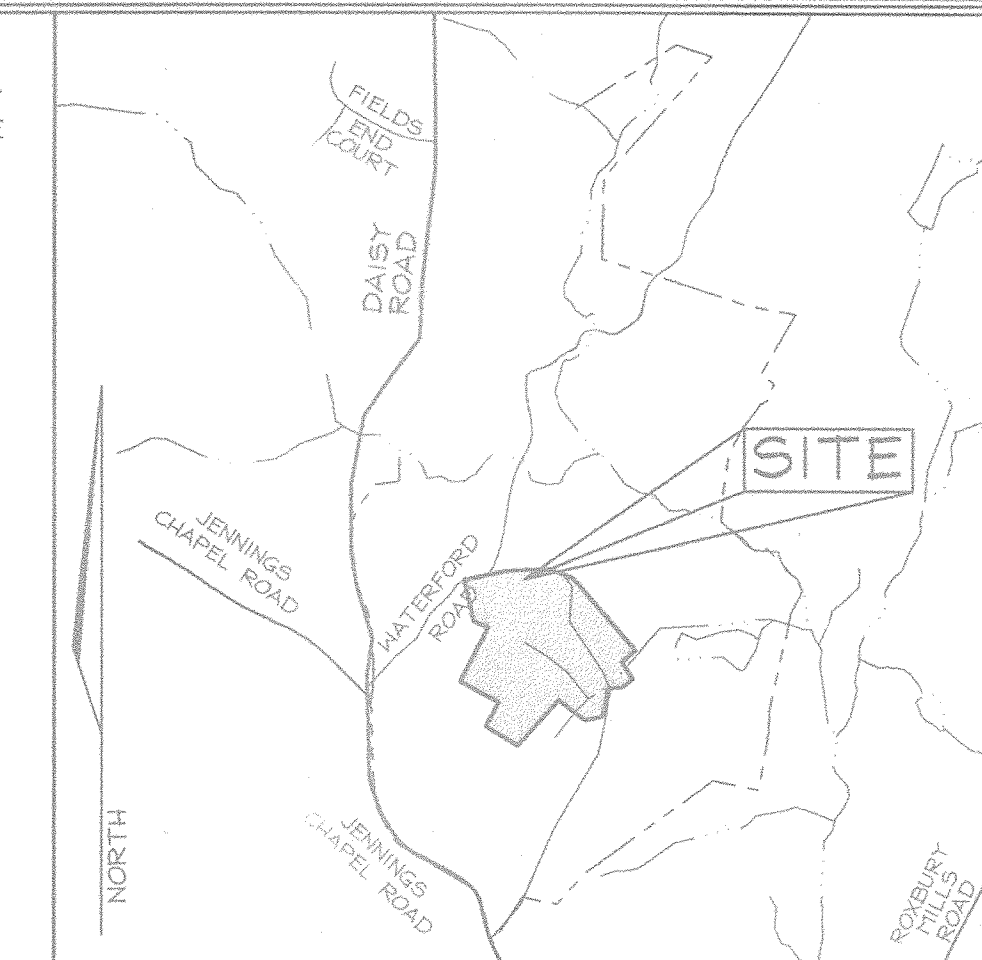

VICINITY MAP
SCALE: 1"=2000'

KEY	TYPE OF COMMUNITY	AREA Acres	SOIL INFORMATION			EXISTING VEGETATION (Type and approx. %)	STAND CHARACTERISTICS			FOREST AREA IN SENSITIVE ENVIRONMENTS
			SOIL TYPE	TYPICAL FOREST COVER	WOODLAND SUITABILITY INDEX		HABITAT VALUE	SIZE AVG. DIAM	AGE	
T-1	Tree Group	0.18	GIC2	Mixed Oak	N/A	N/A	N/A	N/A	N/A	N/A
T-2	Tree Group	0.19	GIB2	Mixed Oak	N/A	N/A	N/A	N/A	N/A	N/A
C-1	Crop Field	7.96	ChB2 GIB2 GIC2 GID2	N/A	N/A	N/A	N/A	N/A	N/A	N/A
C-2	Crop Field	4.63	ChB2 GIC2	N/A	N/A	N/A	N/A	N/A	N/A	N/A
C-3	Crop Field	13.09	ChB2 GIB2 GIC2 MIB2	N/A	N/A	N/A	N/A	N/A	N/A	N/A
C-4	Crop Field	2.39	ChB2 GIB2 GIC2	N/A	N/A	N/A	N/A	N/A	N/A	N/A
L-1	Lawn (Farm Stead)	4.74	ChB2 GIB2 GIC2 MID2	N/A	N/A	N/A	N/A	N/A	N/A	N/A
L-2	Lawn	3.55	ChB2 GIB2 GIC2	N/A	N/A	N/A	N/A	N/A	N/A	N/A
M-1	Meadow	13.38	Ba ChB2 GIB2 GnB2 Ha MIB2 MID2	N/A	N/A	N/A	N/A	N/A	N/A	N/A

Forest Stand Narrative

Total acreage of the site is 50.11 acres.
 T-1 This tree group is 0.18 Ac. in size and contains steep slopes. The canopy is dominated by black oak, *Quercus velutina* and red maple, *Acer rubrum*. The area is currently mowed and the understory is sparse, with steep slopes consisting of 0.14 Ac.
 T-2 This tree group is 0.19 Ac. in size. The canopy is dominated by black oak, *Quercus velutina*, red maple, *Acer rubrum*, shingle oak, *Quercus imbricaria*, and black cherry, *Prunus serotina*. Understory is consists of overstory saplings, scarlet oak, *Quercus coccinea* and black walnut, *Juglans nigra*.
 L-1 This 4.74 Ac. area surrounds an existing house and various farm out buildings. The area contains lawn, and ornamental tree plantings. The area contains 1.02 acres of environmentally sensitive areas, steep slopes are covered by L-1.
 L-2 This 3.55 Ac. area surrounds existing farm buildings located on the southeast corner of the property. This area contains lawn and various ornamental plantings. The area contains no environmentally sensitive areas.
 C-1 This 7.96 Ac. crop area is currently in active crop land production. The area contains 1.10 acres of environmentally sensitive areas, steep slopes covered by C-1.
 C-2 This 4.63 Ac. crop area is currently in active crop production. C-2 contains 0.53 acres of steep slopes.
 C-3 This 13.09 Ac. crop area is currently in active crop land production. The area contains 0.50 acres of steep slopes.
 C-4 This 2.39 Ac. crop area is currently in active crop production. The area does not contain any environmentally sensitive areas.
 M-1 This 13.38 Ac. open field area contains grazing pastures and open field. The area contains wetlands, streams and associated buffers, and steep slopes.

Planting Areas Description
 The proposed planting area was evaluated by Wesley Earp of the Howard Soil Conservation District for the purpose of determining eligibility for planting under the Agricultural Land Preservation Program guidelines and described in a memo dated July 8, 2005. The field evaluation performed by Mr. Earp included a wetland delineation and soil evaluation. Exploration Research Inc. Personnel conducted a field evaluation on July 22, 2005 and confirmed his findings. The wetland flags placed by Mr. Earp were then surveyed located and the stream channel was surveyed in order to establish the buffer areas on the plan. The proposed planting boundary of the steep slope area adjacent to the stream buffer south of the stream was also surveyed located.

For proposed Easement #2 (1.08 acres), the low-lying areas will be planted with a mix of species tolerant of high water table conditions such as red maple, pin oak, etc. while the upland areas will be planted to an appropriate mix of upland species. The few scattered existing trees along the stream and on the steep slope areas do not constitute forest and will not be credited to reduce the planting density.

The proposed planting Easement #3 (1.54 acres) is located on a steep slope adjacent to the existing house. It is presently vegetated in meadow grasses and scattered white pine, scotch pine and numerous scattered seedling to sapling size hardwoods. It was used as a Christmas tree plantation. The proposed plantings would include upland hardwoods such as white oak, red oak, black oak and yellow poplar. All of the remaining Scotch pines would be removed prior to the site planting. This site is located primarily on a steep slope mapped as Minor Loam MID2.

Surety in the amount of \$57,063.50 shall be posted as part of the Developer's Agreement for 2.62 ac/114,127 sq. ft.

FOREST CONSERVATION EASEMENT TABLE

EASEMENT	TYPE	AREA (ACRES)
2	Reforestation	1.08
3	Reforestation	1.54
TOTAL		2.62

SOILS LEGEND

SYMBOL	NAME / DESCRIPTION	SOIL GROUP
Ba	Baile silt loam	D
ChB2	Chester silt loam, 3 to 8 percent slopes, moderately eroded	B
GIB2	Glenelg loam, 3 to 8 percent slopes, moderately eroded	B
GIC2	Glenelg loam, 8 to 15 percent slopes, moderately eroded	B
GID2	Glenelg loam, 15 to 25 percent slopes, moderately eroded	B
GnB2	Glenville silt loam, 3 to 8 percent slopes, moderately eroded	C
MID2	Minor loam, 15 to 25 percent slopes, moderately eroded	B

LOCATION MAP
SCALE: 1"=100'

This property is encumbered with a Ho. Co. Agricultural Land Preservation Easement, HO-02-03-E, which is held by the Ho. Co. Agricultural Land Preservation Program.

APPROVED: HOWARD COUNTY DEPARTMENT OF PLANNING AND ZONING
 [Signature]
 CHIEF, DEVELOPMENT ENGINEERING DIVISION
 [Signature]
 CHIEF, DIVISION OF LAND DEVELOPMENT

Charles Sharp
 Licensed Landscape Architect
 4003 Jennings Chapel Road
 Brookville, MD 20833-2204
 (410)-484-4630

FSH Associates
 Engineers Planners Surveyors
 6339 Howard Lane, Elkridge, MD 21727
 Tel: 410-587-5200 Fax: 410-786-1582
 E-mail: info@fsh.net

OFFSITE FOREST MITIGATION PLAN for BLOUIN PROPERTY
 LOTS 1-4 (F-05-161) on Waterford Farm, Parcel 3

TAX MAP 20 GRID 12 4TH ELECTION DISTRICT PARCEL 3 HOWARD COUNTY, MARYLAND

DESIGN BY: RAB
 DRAWN BY: KSZ/MA
 CHECKED BY: SLH
 SCALE: 1"=100'
 DATE: July 24, 2006
 W.O. No.: 3082
 SHEET No. 3 OF 4

EXPLORATION RESEARCH, INC.
 ENVIRONMENTAL CONSULTANTS
 6339 HOWARD LANE
 ELK RIDGE, MARYLAND 21727
 TEL: (410) 587-5200 FAX: (410) 786-1582

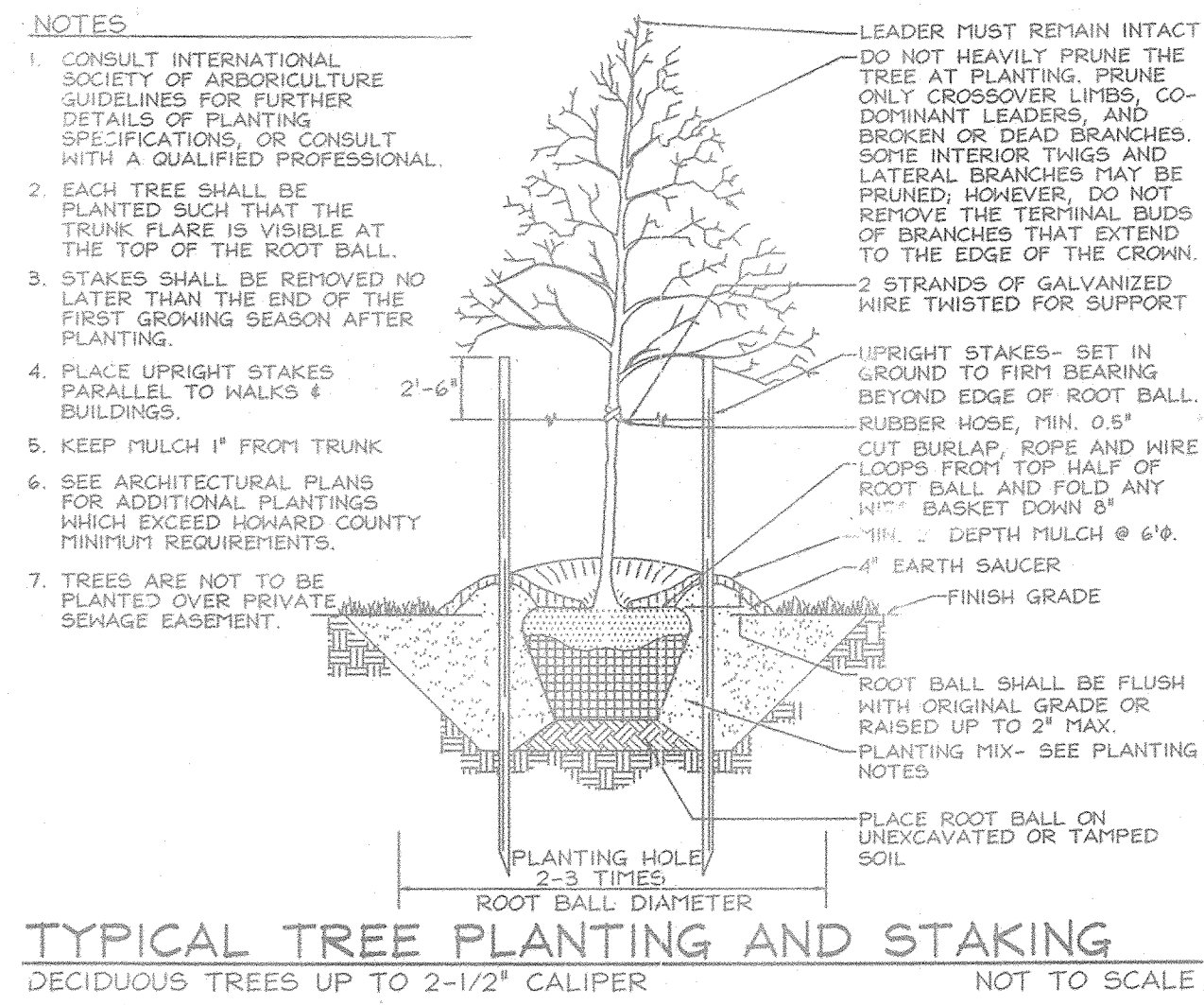

FCE #2 PLANTING AREA: 0.1 Ac. (200 TPA)

Qty	Botanical Name	Common Name	Min. Size	Spacing	Notes
29	Acer rubrum	Red Maple	1" cal.	15' o.c.	1" cal. Balled and Burlaped
29	Platanus occidentalis	Sycamore	1" cal.	15' o.c.	
29	Quercus alba	White Oak	1" cal.	15' o.c.	1" cal. Balled and Burlaped
29	Quercus palustris	Pin Oak	1" cal.	15' o.c.	
13	Salix nigra	Black Willow	1" cal.	15' o.c.	
29	Cercis canadensis	Redbud	1" cal.	15' o.c.	
29	Amelanchier canadensis	Service Berry	1" cal.	15' o.c.	
29	Pinus taeda	Loblolly Pine	1" cal.	15' o.c.	
216	Total Plantings				

FCE #3 PLANTING AREA: 1.54 Ac. (200 TPA)

Qty	Botanical Name	Common Name	Min. Size	Spacing	Notes
44	Acer rubrum	Red Maple	1" cal.	15' o.c.	1" cal. Balled and Burlaped
44	Liriodendron tulipifera	Yellow Poplar	1" cal.	15' o.c.	
44	Quercus alba	White Oak	1" cal.	15' o.c.	1" cal. Balled and Burlaped
44	Quercus velutina	Black Oak	1" cal.	15' o.c.	
44	Cercis canadensis	Redbud	1" cal.	15' o.c.	
44	C. pinus caroliniana	American Hornbeam	1" cal.	15' o.c.	
44	Cornus florida	White Dogwood	1" cal.	15' o.c.	
308	Total Plantings				

Plant Selection and Density Spacing Requirements.

Planting material size and density shall vary with a combination of planting stock, which will be determined at the time of planting. Planting quantity and spacing are based on square footage credit, which varies by material size. A total of 43,560 sq. ft. of planting credit must be fulfilled for each acre planted. This credit can be fulfilled with any combination of material size in accordance with the following chart.

Material Size	Spacing	TPA	Sq. Ft. Credit per plant	Comments
2" caliper trees	20' x 20'	100	435.6	B & B
1" caliper trees	15' x 15'	200	217.8	B & B
seedlings or whips	11' x 11'	350	125	Container 1-3 gal. w/tree shelters
seedlings	8' x 8'	700	62	Bare root or container grown

Plant Material Size Table *

COMMON NAME	SCIENTIFIC NAME
Black Gum	Nyssa sylvatica
Black Oak	Quercus velutina
Chestnut Oak	Quercus prinus
Northern Red Oak	Quercus rubra
Yellow Poplar	Liriodendron tulipifera
Virginia Pine	Pinus virginiana
Eastern Redcedar	Juniperus virginiana

Overstory Planting Alternate Species List #

Plant Selection
The planting area should contain a combination of approximately 80% overstory species and 20% understorey species, intermixed evenly through out. A minimum of three different species must be planted in the overstorey and a minimum of two different species must be planted in the understorey, to create a multi-species, multi-layered system.

COMMON NAME	SCIENTIFIC NAME
Service Berry	Carpinus caroliniana
Eastern Hornbeam	Ostrya virginiana
American holly	Ilex opaca
Boxelder	Acer negundo
Hackberry	Celtis occidentalis
American Dogwood	Cornus florida

Understorey Planting Alternate Species List #

* Size, species and quantities listed are suggested plantings and may be substituted, but only in conformance with the Howard County Forest Conservation Manual. The stream buffer and pond edge area will be planted with black willow, pin oak, sycamore, red maple, and serviceberry. Black willow will not be planted on upland areas.

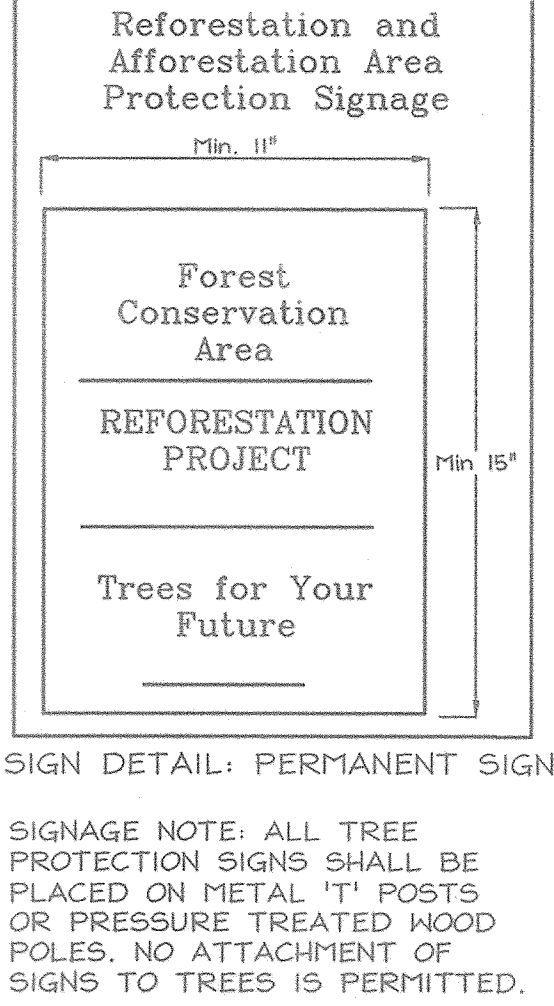
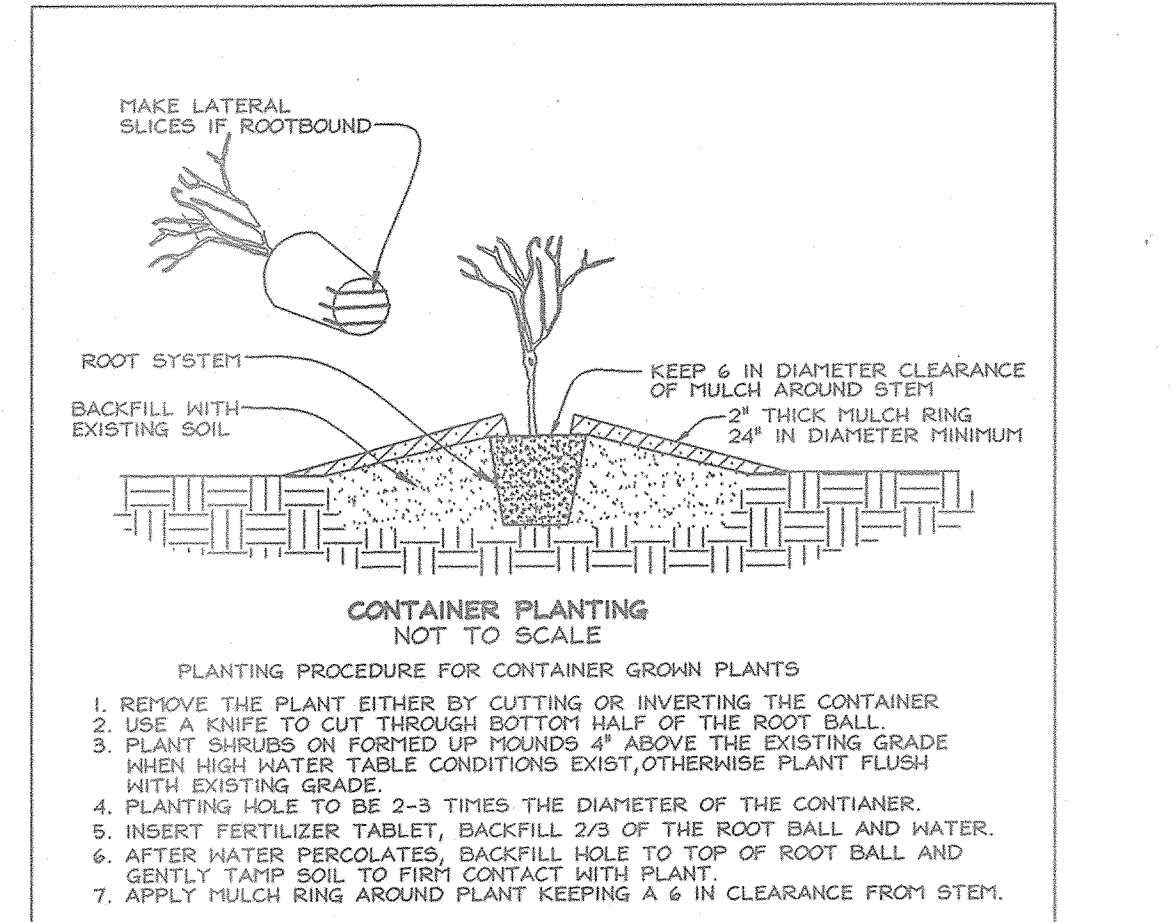
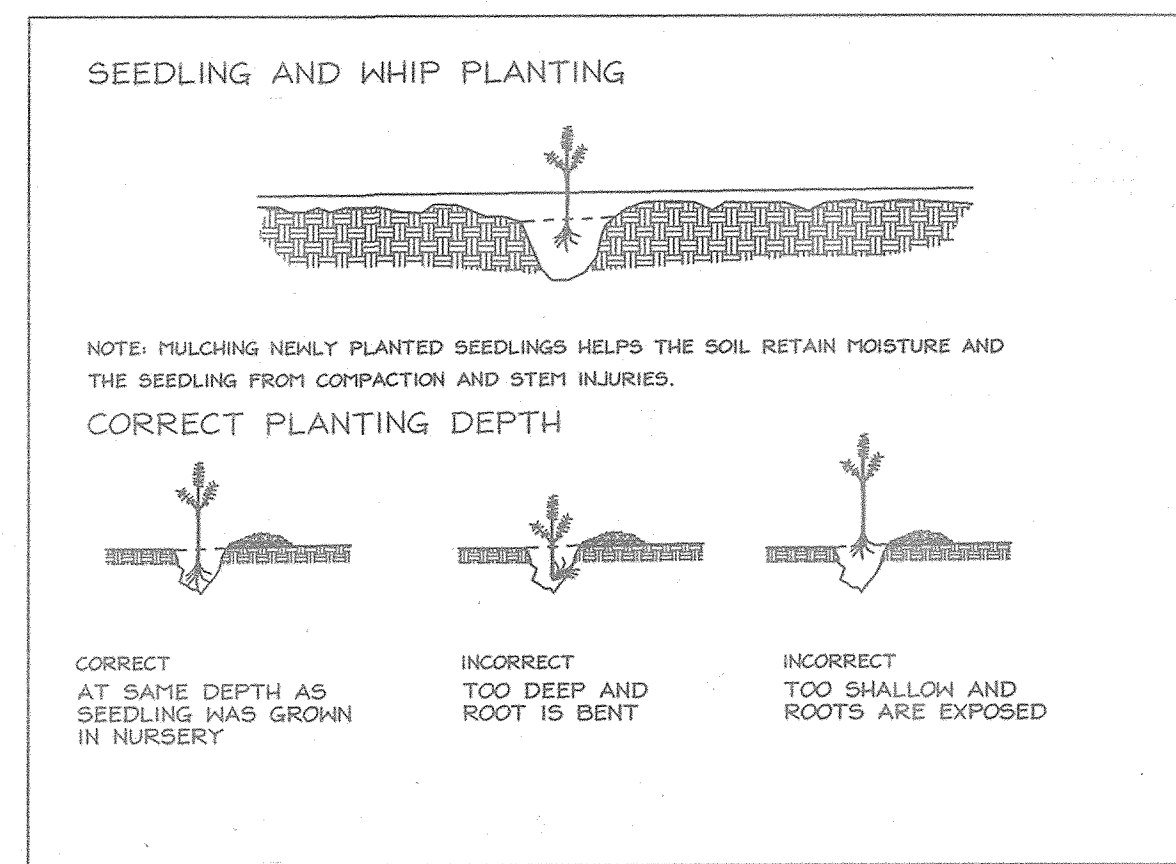

SIGN DETAIL: PERMANENT SIGN

SIGNAGE NOTE: ALL TREE PROTECTION SIGNS SHALL BE PLACED ON METAL 'T' POSTS OR PRESSURE TREATED WOOD POLES. NO ATTACHMENT OF SIGNS TO TREES IS PERMITTED.

- Reforestation Area Planting Notes**
- Initial planting inspection and certification required. Planting contractor to notify ERI qualified professional 24 hours in advance of planting.
 - Reforestation areas may be planted as soon as reasonable to do so. Late winter - early spring plantings are preferred. Earliest planting dates will vary from year to year but planting may generally begin as soon as the ground is no longer frozen. Alternate planting dates may be considered as conditions warrant.
 - Soil amendments and fertilization recommendations will be made based upon the results of soil analysis for nitrogen, phosphorus, potassium, organic matter content and pH. If required, fertilizer will be provided using a slow release, soluble 16-8-16 analysis designed to last 5-8 years contained in polyethylene perforated bags such as manufactured by ADCO Works, P.O. Box 310 Hollis, N.Y. 11423 or approved equal.
 - Plant materials shall be planted in accordance with the planting diagram, planting details and planting schedule.
 - Plant stock must be protected from desiccation at all times prior to planting. Materials held for planting shall be moistened and placed in cool shaded areas until ready for placement.
 - Planting materials shall be nursery grown and inspected prior to planting. Plants not conforming to the American Standards for Nursery Stock specifications for size, form, vigor, or roots, or due to trunk wounds, breakage, desiccation, insect or disease must be replaced.
 - Newly planted trees may require watering at least once per week during the first growing season depending on rainfall in order to get established. The initial planting operation should allow for watering during installation to completely soak backfill materials.
 - Mulch shall be applied in accordance with the diagram provided and shall consist of composted, shredded hardwood bark mulch, free of wood alcohol.
 - Planting holes should be excavated to a minimum diameter of 2.5 to 3 times the diameter of the root ball or container. Mechanical auguring is preferred with scarification of the sides of each hole.
 - All nursery stock may be sprayed with deer repellent containing Bitrex such as Repellex(TM). All nursery stock to be grown with deer repellent tablets in growing medium, such as Repellex Tablets.

- Reforestation Area Monitoring Notes**
- Monthly visits during the first growing season are to assess the success of the plantings and to determine if supplemental watering, pest control, invasive plant management, mowing or other actions are necessary. Early spring visits will document winter kill and autumn visits will document summer kill.
 - The minimum survival rate shall be 75% of the total number of trees planted per acre at the end of the two year maintenance period. Wild tree seedlings from natural regeneration on the planting site may be counted up to 50% toward the total survival number if they are healthy native species at least 12 inches tall.
 - Survival will be determined by a stratified random sample of the plantings. The species composition of the sample population should be proportionate to the amount of each species in the entire planting to be sampled.
 - Effective monitoring will assess plant survivability during the first growing season and make recommendations for reinforcement planting if required at that time.

- Forest Tree Protection and Management Notes**
- Any significant changes made to the Forest Conservation Plan shall be made with the prior approval of the Howard County Dept. Of Planning and Zoning.
 - Forest protection and management to be in accordance with a forest management plan. The plan shall be prepared by a MD. licensed forester to facilitate the landowners management objectives, such as wildlife enhancement, water quality, aesthetics, forest products, etc.
 - Future forest harvests may be conducted under a Howard County approved forest harvest plan, prepared by a MD. licensed forester.

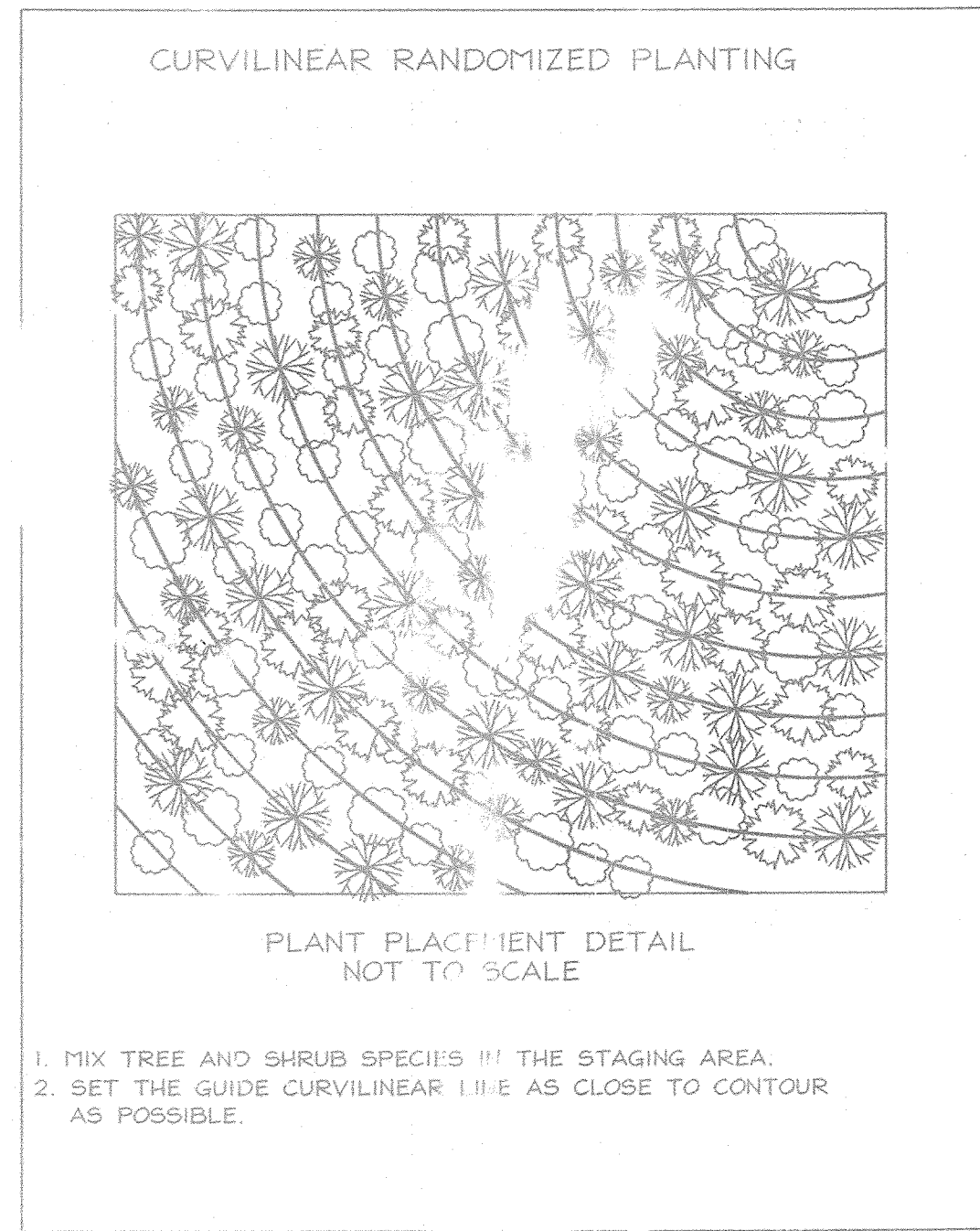

APPROVED: HOWARD COUNTY DEPARTMENT OF PLANNING AND ZONING

Charles Sharp
 Chief, Development Engineering Division
 9/19/06
 DATE

Cindy Kramer
 Chief, Division of Land Development
 9/19/06
 DATE

LICENSED LANDSCAPE ARCHITECT
 3169
 ROBERT ANDREW BERRY, JR.
 STATE OF MARYLAND
 Charles Sharp
 4003 Jennings Chapel Road
 Brookville, MD 20833-2204
 (410)-489-4630

FSH Associate
 Engineers Planners Surveyors
 6339 Howard Lane, Elkridge, MD 21075
 Tel: 410-587-6200 Fax: 410-796-1562
 E-mail: info@fshri.com

OFFSITE FOREST MITIGATION PLAN
for BLOIN PROPERTY
 LOTS 1-4 (F-05-161)
 on Waterford Farm, Parcel 3

TAX MAP 20 GRID 12
 4TH ELECTION DISTRICT

PARCEL 3
 HOWARD COUNTY, MARYLAND

EXPLORATION RESEARCH, INC.
 ENVIRONMENTAL CONSULTANTS
 LANDSCAPE ARCHITECTS

DESIGN BY: RAB
 DRAWN BY: RAB/MA
 CHECKED BY: SLH
 SCALE: As Shown
 DATE: July 24, 2006
 P.L.O. No.: 3205
 SHEET No.: 4 OF 4