

**STANDARD GENERAL NOTES AND APPLICATION SPECIFIC NOTES  
TREE CONSERVATION PLAN TYPE I**

- NO TREE CUTTING OR CLEARING SHALL TAKE PLACE ON THIS SITE WITHOUT THE EXPRESSED WRITTEN CONSENT OF HOWARD COUNTY PLANNING & ZONING, ITS DESIGNEE.
- PROSPECTIVE PURCHASERS OF THE PROPERTY SHALL BE NOTIFIED BY THE DEVELOPER, CONTRACTOR OR PROPERTY OWNER OF THE TCP FOR THE PROPERTY, AND THE ASSOCIATED FINES FOR UNAUTHORIZED DISTURBANCE TO THE WOODLAND CONSERVATION AREAS. UPON SALE OF THE PROPERTY THE OWNER OR DEVELOPER SHALL NOTIFY THE PURCHASER OF ANY WOODLAND CONSERVATION RESTRICTIONS AS SHOWN ON THIS TCP.
- PROPERTY OWNERS SHALL BE NOTIFIED BY THE DEVELOPER OR CONTRACTOR OF ANY WOODLAND CONSERVATION AREAS (TREE SAVE AREAS) LOCATED ON THEIR LOT AND ASSOCIATED WITH FINES FOR UNAUTHORIZED DISTURBANCE TO THESE AREAS.
- THIS RETENTION AREA IS CONTIGUOUS WITH ADJACENT THALER ESTATES RETENTION AND AFFORESTATION Easements.
- THESE RETENTION AREAS WILL BE CREDITED TOWARD MEETING THE FOREST CONSERVATION OBLIGATION FOR HEDGEROW ESTATES BECAUSE PROPOSED LOTS 2 & 4 ARE GREATER THAN 60,000 SF IN SIZE AND THESE FOREST AREAS WILL NOT BE CLEARED.

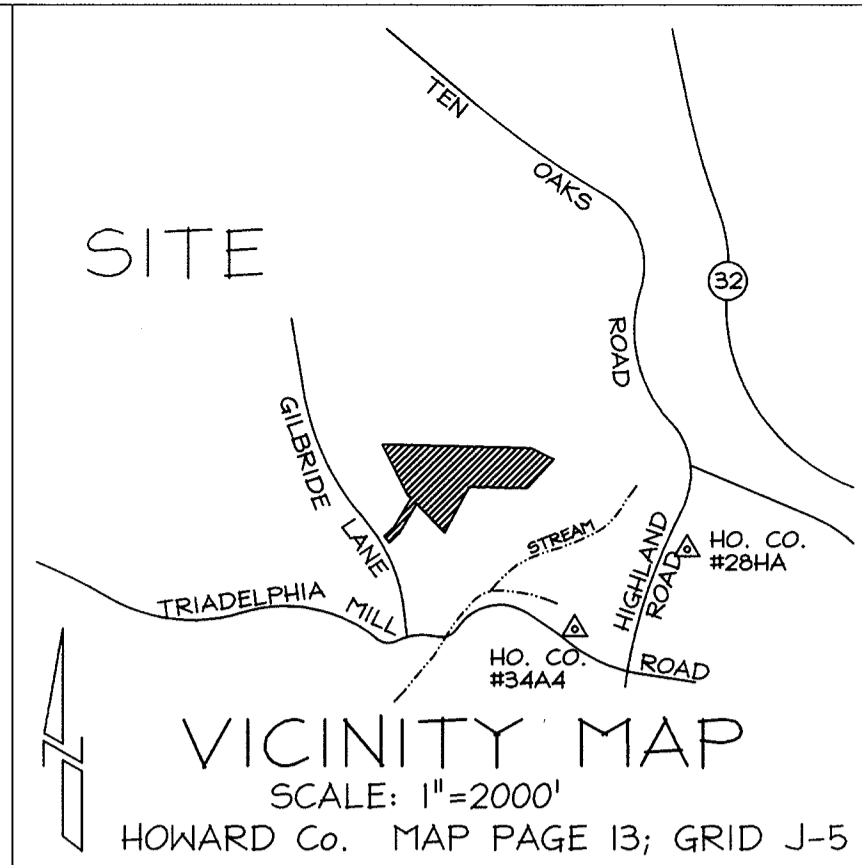

**LEGEND**

- \*\* [Hatched Box] AREA RETAINED FOR PURPOSES OF FOREST CONSERVATION WORKSHEET (NOT IN EASEMENT)\*\*
- [Hatched Box] AFFORESTATION (OFF SITE)

**FOREST CONSERVATION REQUIREMENTS**

FOREST RETENTION:	0.71 ACRES
AFFORESTATION REQUIRED:	3.26 ACRES
AFFORESTATION SHOWN:	0.00 ACRES
REFORESTATION REQUIRED:	0.00 ACRES
REFORESTATION SHOWN:	0.00 ACRES

**AFFORESTATION REQUIREMENTS:**

3.26 acres or 142,006 SF
2" Caliper trees @ 100 Trees per acre
1" Caliper trees @ 200 Trees per acre
Seedlings @ 300 whips per acre
Seedlings @ 700 seedlings per acre

**OFFSITE AFFORESTATION PROVIDED:**

3.26 acres or 142,006 sf	2" Caliper trees @ 100 Trees per acre
	1" Caliper trees @ 200 Trees per acre
	Seedlings @ 350 whips per acre
	Seedlings @ 1,981 @ 700 seedlings per acre

NOTE: AFFORESTATION REQUIREMENTS OF 3.26 ACRES WILL BE MET BY THE CREATION OF AFFORESTATION EASEMENTS ON THALER ESTATES DPZ PLAN F-00-59.

**SURETY NOTE**

Financial Surety for the required planting must be posted as part of the Grading Permit in the amount of \$42,601.80 for 3.26 acres of required reforestation. This will be posted with the Forest Conservation Developer Agreement.

**HOWARD COUNTY  
FOREST CONSERVATION WORKSHEET**

NET TRACT AREA:	ACRES	1/10					
A. TOTAL TRACT AREA	19.85 AC						
B. AREA WITHIN 100 YEAR FLOODPLAIN	0.00 AC						
C. AREA TO REMAIN IN AGRICULTURAL PRODUCTION	0.00 AC						
D. NET TRACT AREA	19.85 AC						
LAND USE CATEGORY (FROM TABLE 3.2.1, PAGE 40, MANUAL)							
INPUT THE NUMBER "1" UNDER THE APPROPRIATE LAND USE ZONING, AND LIMIT TO ONLY ONE ENTRY, RR ZONING							
	ARA	MDR	IDA	HDR	MPD	CIA	
	0	1	0	0	0	0	
E. AFFOREST THRESHOLD	20%	X	D				= 3.97 AC
F. CONSERVATION THRESHOLD	25%	X	D				= 4.96 AC
EXISTING FOREST COVER:							
G. EXISTING FOREST COVER (EXCLUDING FLOODPLAIN)							= 0.71 AC
H. AREA OF FOREST ABOVE AFFORESTATION THRESHOLD							= 0.00 AC
I. AREA OF FOREST ABOVE CONSERVATION THRESHOLD							= 0.00 AC
BREAK EVEN POINT:							
J. FOREST RETENTION ABOVE THRESHOLD WITH NO MITIGATION							= 0.00AC
K. CLEARING PERMITTED WITHOUT MITIGATION							= 0.00 AC
PROPOSED FOREST CLEARING:							
L. TOTAL AREA OF FOREST TO BE CLEARED							= 0.00AC
M. TOTAL AREA OF FOREST TO BE RETAINED							= 0.71AC
PLANTING REQUIREMENTS:							
N. REFORESTATION FOR CLEARING ABOVE CONSERVATION THRESHOLD							= 0.00AC
P. REFORESTATION FOR CLEARING BELOW CONSERVATION THRESHOLD							= 0.00AC
Q. CREDIT FOR RETENTION ABOVE CONSERVATION THRESHOLD							= 0.00AC
R. TOTAL REFORESTATION REQUIRED							= 0.00AC
S. TOTAL AFFORESTATION REQUIRED							= 3.26AC
T. TOTAL REFORESTATION AND AFFORESTATION REQUIRED							= 3.26AC

**OWNER \ DEVELOPER**  
Hedgerow Estates  
c/o Gregory B. Phillips  
ReMax Advantage Realty  
Suite 100  
8815 Centre Park Drive  
Columbia, Maryland 21045  
(410) 740-1200; Ext. 259

APPROVED: HOWARD COUNTY DEPARTMENT OF PLANNING AND ZONING  
CHIEF, DEVELOPMENT ENGINEERING DIVISION  
*Andy Hamilton*  
CHIEF, DIVISION OF LAND DEVELOPMENT

DATE: 8/10/10  
DATE: 8/10/10

MARK ALAN STORCH  
RLA No. 878

**FOREST CONSERVATION PLAN**  
FOR OFF-SITE PLANTING IN THE THALER ESTATES SUBDIVISION

HEDGEROW LOT 30  
AND  
HEDGEROW, SECTION 1, PLAT 8492)  
HEDGEROW ESTATES  
LOTS 1 - 4  
(A SUBDIVISION OF P/O PARCEL  
TAX MAP 28, GRID 20  
5th ELECTION DISTRICT - HOWARD COUNTY, MARYLAND

F-00-58

SCALE: 1"=100'  
06-16-00  
03-18-00

REVISIONS:  
10-19-99

DATE:  
JOB NUMBER:

FCP

SHEET 1 OF 1

FO058