

THE REQUIREMENTS § 3-100, THE REAL PROPERTY ARTICLE, ANNOTATED CODE OF MARYLAND, 1980 REPLACEMENT VOLUME, (AS SUPPLEMENTED AS FAR AS THEY RELATE TO THE MAKING OF THIS PLAT AND THE SETTING OF MARKERS HAVE BEEN COMPLIED WITH.)

Terrill A. Fisher 5/4/94
 TERRILL A. FISHER (SURVEYOR) DATE

Thomas Scrivener 5/2/94
 THOMAS SCRIVENER (OWNER) DATE

Mary S. Scrivener 5/2/94
 MARY S. SCRIVENER (OWNER) DATE

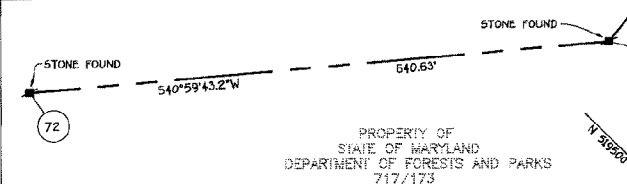

TOTAL AREA TABULATION

TOTAL NUMBER OF BUILDABLE LOTS TO BE RECORDED 1
 TOTAL NUMBER OF OPEN SPACE LOTS TO BE RECORDED 0
 TOTAL NUMBER OF LOTS TO BE RECORDED 1
 TOTAL AREA OF BUILDABLE LOTS TO BE RECORDED 1.000 AC.
 TOTAL AREA OF OPEN SPACE LOTS TO BE RECORDED 0.000 AC.
 TOTAL AREA OF LOTS TO BE RECORDED 1.000 AC.
 TOTAL AREA OF ROADWAY TO BE RECORDED 0.000 AC.
 TOTAL AREA TO BE RECORDED 1.000 AC.

COORDINATE TABLE

| PT | NORTH | EAST | PT | NORTH | EAST |
|-----|------------|------------|-----|------------|------------|
| 72 | 519091.094 | 779770.093 | 390 | 520310.329 | 779757.567 |
| 204 | 519912.542 | 780026.691 | 454 | 520243.230 | 779502.592 |
| 241 | 519575.339 | 780139.146 | 458 | 520331.943 | 779613.371 |
| 242 | 519673.143 | 780129.767 | 462 | 520380.598 | 779575.377 |
| 292 | 520475.276 | 780561.072 | | | |
| 293 | 520520.951 | 780560.593 | | | |
| 347 | 520908.946 | 780878.246 | | | |
| 387 | 520409.823 | 779576.125 | | | |
| 388 | 520449.118 | 779573.358 | | | |

APPROVED: FOR PRIVATE WATER AND PRIVATE SEWERAGE SYSTEMS, HOWARD COUNTY HEALTH DEPARTMENT.

Thomas Scrivener 7-27-94
 HOWARD COUNTY HEALTH OFFICER DATE

APPROVED: HOWARD COUNTY DEPARTMENT OF PLANNING AND ZONING.

Thomas Scrivener 8/16/94
 DIRECTOR DATE

APPROVED: FOR STORM DRAINAGE SYSTEMS, AND PUBLIC ROADS, HOWARD COUNTY DEPARTMENT OF PUBLIC WORKS.

Thomas Scrivener 8/3/94
 DIRECTOR DATE

OWNERS CERTIFICATE

J. THOMAS SCRIVENER AND MARY S. SCRIVENER, HIS WIFE, OWNERS OF THE PROPERTY SHOWN AND DESCRIBED HEREON, HEREBY ADOPT THIS PLAN OF SUBDIVISION, AND IN CONSIDERATION OF THE APPROVAL OF THIS FINAL PLAT BY THE DEPARTMENT OF PLANNING AND ZONING, ESTABLISH THE MINIMUM BUILDING RESTRICTION LINES AND GRANT UNTO HOWARD COUNTY, MARYLAND, ITS SUCCESSORS AND ASSIGNS, (1) THE RIGHT TO LAY, CONSTRUCT AND MAINTAIN SEWERS, DRAINS, WATER PIPES AND OTHER MUNICIPAL UTILITIES AND SERVICES IN AND UNDER ALL ROADS AND STREET RIGHTS-OF-WAY AND THE SPECIFIC EASEMENT AREAS SHOWN HEREON; (2) THE RIGHT TO REQUIRE DEDICATION FOR PUBLIC USE THE BEDS OF THE STREETS AND/OR ROADS AND FLOODPLAINS AND OPEN SPACE WHERE APPLICABLE AND FOR GOOD AND OTHER VALUABLE CONSIDERATION, HEREBY GRANT THE RIGHT AND OPTION TO HOWARD COUNTY TO ACQUIRE THE FEE SIMPLE TITLE TO THE BEDS OF THE STREETS AND/OR ROADS AND FLOODPLAINS, STORM DRAIN FACILITIES AND OPEN SPACE WHERE APPLICABLE; (3) THE RIGHT TO REQUIRE DEDICATION OF WATERWAYS AND DRAINAGE EASEMENTS FOR THE SPECIFIC PURPOSE OF THEIR CONSTRUCTION, REPAIR AND MAINTENANCE; AND (4) THAT NO BUILDING OR SIMILAR STRUCTURE OF ANY KIND SHALL BE ERRECTED ON OR OVER THE SAID EASEMENTS AND RIGHTS-OF-WAY. WITNESS OUR HANDS THIS 27th DAY OF July, 1994.

Thomas Scrivener
 J. THOMAS SCRIVENER
 WITNESS
Mary S. Scrivener
 MARY S. SCRIVENER
 WITNESS
Cynthia S. Drayton
 WITNESS
Cynthia S. Drayton
 WITNESS

SURVEYORS CERTIFICATE

I HEREBY CERTIFY THAT THE FINAL PLAT SHOWN HEREON IS CORRECT; THAT IT IS A SUBDIVISION COMPRISED OF A PART OF THE LANDS CONVEYED BY CHRISTINE BOCK PETERSON AND FREDERICK B. PETERSON, PERSONAL REPRESENTATIVE OF THE ESTATE OF FREDERICK CARL PETERSON, DECEASED, TO J. THOMAS SCRIVENER AND MARY S. SCRIVENER, HIS WIFE, BY DEED DATED MARCH 6, 1990 AND RECORDED AMONG THE LAND RECORDS OF HOWARD COUNTY, MARYLAND IN LIBER No. 2129 AT FOLIO No. 649, AND THAT ALL MONUMENTS ARE IN PLACE OR WILL BE IN PLACE PRIOR TO THE ACCEPTANCE OF THE STREETS IN THE SUBDIVISION BY HOWARD COUNTY AS SHOWN IN ACCORDANCE WITH THE ANNOTATED CODE OF MARYLAND, AS AMENDED AND MONUMENTATION IS IN ACCORDANCE WITH THE HOWARD COUNTY SUBDIVISION REGULATIONS.

Terrill A. Fisher
 TERRILL A. FISHER
 LAND SURVEYOR No. 10692
 DATE: May 4, 1994

RECORDED AS PLAT No. 1188 ON 9/20/94
 AMONG THE LAND RECORDS OF HOWARD COUNTY, MARYLAND.

SCRIVENER PROPERTY

LOT 1
 ZONING: 'RC-DEO'
 TAX MAP No. 20 PART OF PARCEL NO. 35
 FOURTH ELECTION DISTRICT
 HOWARD COUNTY, MARYLAND
 DATE: JUNE 17, 1994

SCALE: 1" = 100'
 SHEET 1 OF 1
 F-94-116