

COORDINATES table with columns NO., NORTH, EAST, NO., NORTH, EAST. Contains coordinate data for various points.

FLOOD PLAIN TABLE with columns ELEV., FROM, BEARING & DISTANCE, TO. Contains elevation and distance data for flood plain boundaries.

NOTES: 1. HORIZONTAL AND VERTICAL CONTROL SHOWN HEREON IS BASED UPON HOWARD COUNTY GEODETIC CONTROL STATION NO. 383003... 2. SUBJECT PROPERTY ZONE R-RURAL (3 ACRE/LOT MINIMUM) PER 8-02-85 COMPREHENSIVE ZONING PLAN...

CURVE TABLE with columns NO., RADIUS, ARC, DELTA, TAN, CHORD BEARING, CHORD DISTANCE. Contains curve data for the subdivision.

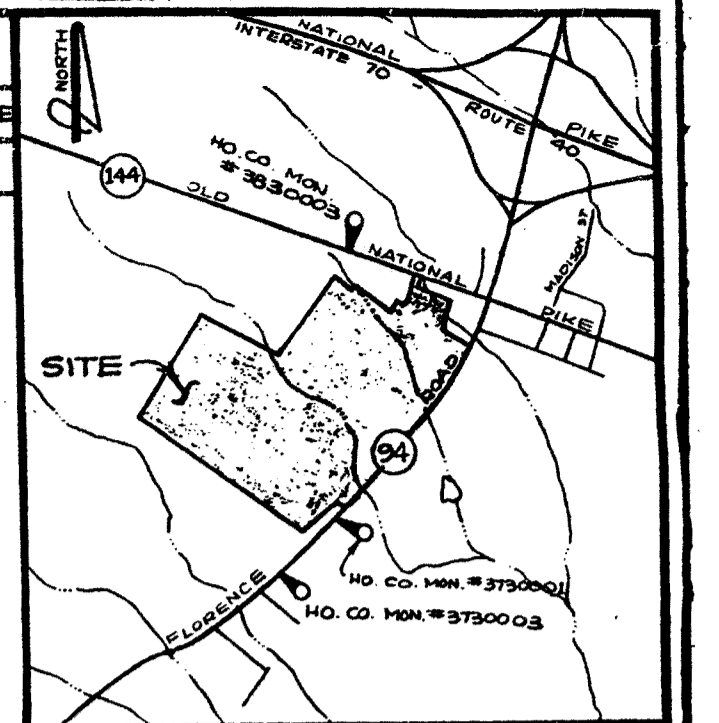

COORDINATES table (continued) with columns NO., NORTH, EAST, NO., NORTH, EAST. Contains coordinate data for various points.

FLOOD PLAIN TABLE (continued) with columns ELEV., FROM, BEARING & DISTANCE, TO. Contains elevation and distance data for flood plain boundaries.

NOTES (CONT.): 4. THIS PLAT IS BASED ON A FIELD RUN MONUMENTED BOUNDARY SURVEY PERFORMED ON OR ABOUT OCTOBER 1, 1987 BY GARY THURMAN, DEWBERRY & DAVIS AND ENTITLED "PENDLETON FARMS"...

CURVE TABLE (continued) with columns NO., RADIUS, ARC, DELTA, TAN, CHORD BEARING, CHORD DISTANCE. Contains curve data for the subdivision.

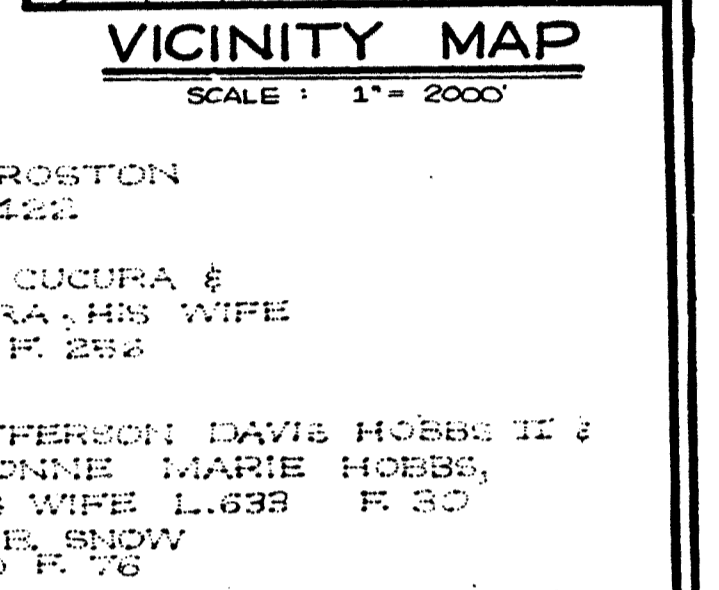

TABULATION: ENTIRE TRACT. TOTAL NUMBER OF BUILDABLE LOTS/PARCELS TO BE RECORDED... 2. TOTAL AREA OF BUILDABLE LOTS/PARCELS TO BE RECORDED... 119.9992 AC.

APPROVED: FOR PRIVATE WATER AND PRIVATE SEWERAGE SYSTEMS. IN CONFORMANCE WITH THE MASTER PLAN OF WATER AND SEWERAGE FOR HOWARD COUNTY. Signed by Howard County Health Officer.

APPROVED: HOWARD COUNTY DEPARTMENT PLANNING AND ZONING. Signed by Director.

APPROVED: FOR STORM DRAINAGE SYSTEMS AND ROADS. HOWARD COUNTY DEPARTMENT OF PUBLIC WORKS. Signed by Director.

STATE DEPT. OF ASSESSMENTS & TAXATION. HOWARD COUNTY. Signed by Bonnie East-Tree.

APPROVED: FOR STORM DRAINAGE SYSTEMS AND ROADS. HOWARD COUNTY DEPARTMENT OF PUBLIC WORKS. Signed by Director.

APPROVED: FOR STORM DRAINAGE SYSTEMS AND ROADS. HOWARD COUNTY DEPARTMENT OF PUBLIC WORKS. Signed by Director.

SURVEYOR'S CERTIFICATE: I HEREBY CERTIFY THAT THE FINAL PLAT SHOWN HEREON IS CORRECT; THAT IT IS A SUBDIVISION OF A PORTION OF THE LANDS CONVEYED BY JEFFREY A. KREW AND LAWRENCE S. RABER TO E. ALEXANDER ADAMS AND MARION HARLESS BY DEED DATED AUGUST 8, 1991...

OWNER'S CERTIFICATE: WE, E. ALEXANDER ADAMS AND MARION HARLESS, OWNERS OF THE PROPERTY SHOWN HEREON, HEREBY ADOPT THIS PLAN OF SUBDIVISION, IN CONSIDERATION OF THE APPROVAL OF THIS FINAL PLAT BY THE DEPT. OF PLANNING AND ZONING, ESTABLISH THE MINIMUM BUILDING RESTRICTION LINES AND GRANT UNTO HOWARD COUNTY, MARYLAND, ITS SUCCESSORS AND ASSIGNS...

RECORDED AS PLAT 10147 ON 10/14/91 AMONG THE LAND RECORDS OF HOWARD COUNTY, MARYLAND. E. ALEXANDER ADAMS AND MARION HARLESS PROPERTY. TAX MAP NO. 7 PARCEL 215. 4TH ELECTION DISTRICT HOWARD COUNTY, MARYLAND.

DEWBERRY & DAVIS ARCHITECTS-ENGINEERS-PLANNERS-SURVEYORS. 200 HARRY S. TRUMAN PARKWAY ANNAPOLIS, MARYLAND 21401. (301) 841-6811 (METRO) 261-8707.

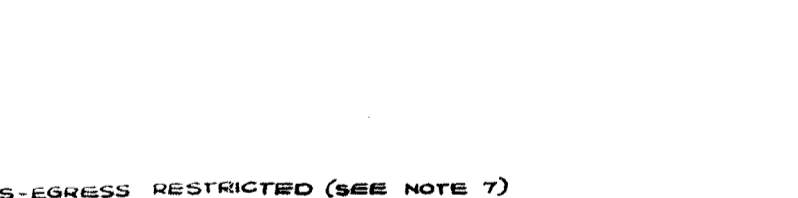

DEWBERRY & DAVIS ARCHITECTS-ENGINEERS-PLANNERS-SURVEYORS. 200 HARRY S. TRUMAN PARKWAY ANNAPOLIS, MARYLAND 21401. (301) 841-6811 (METRO) 261-8707.

RECORDED AS PLAT 10147 ON 10/14/91 AMONG THE LAND RECORDS OF HOWARD COUNTY, MARYLAND. E. ALEXANDER ADAMS AND MARION HARLESS PROPERTY. TAX MAP NO. 7 PARCEL 215. 4TH ELECTION DISTRICT HOWARD COUNTY, MARYLAND.

DEWBERRY & DAVIS ARCHITECTS-ENGINEERS-PLANNERS-SURVEYORS. 200 HARRY S. TRUMAN PARKWAY ANNAPOLIS, MARYLAND 21401. (301) 841-6811 (METRO) 261-8707.

RECORDED AS PLAT 10147 ON 10/14/91 AMONG THE LAND RECORDS OF HOWARD COUNTY, MARYLAND. E. ALEXANDER ADAMS AND MARION HARLESS PROPERTY. TAX MAP NO. 7 PARCEL 215. 4TH ELECTION DISTRICT HOWARD COUNTY, MARYLAND.

RECORDED AS PLAT 10147 ON 10/14/91 AMONG THE LAND RECORDS OF HOWARD COUNTY, MARYLAND. E. ALEXANDER ADAMS AND MARION HARLESS PROPERTY. TAX MAP NO. 7 PARCEL 215. 4TH ELECTION DISTRICT HOWARD COUNTY, MARYLAND.

RECORDED AS PLAT 10147 ON 10/14/91 AMONG THE LAND RECORDS OF HOWARD COUNTY, MARYLAND. E. ALEXANDER ADAMS AND MARION HARLESS PROPERTY. TAX MAP NO. 7 PARCEL 215. 4TH ELECTION DISTRICT HOWARD COUNTY, MARYLAND.

RECORDED AS PLAT 10147 ON 10/14/91 AMONG THE LAND RECORDS OF HOWARD COUNTY, MARYLAND. E. ALEXANDER ADAMS AND MARION HARLESS PROPERTY. TAX MAP NO. 7 PARCEL 215. 4TH ELECTION DISTRICT HOWARD COUNTY, MARYLAND.

Location Approval Request: B. ROBERT & JUDITH A. GIANGRANDI, 2886 ROSEMAR DRIVE, ELLICOTT CITY, MD 21043. 410-465-3114. Designates approximate home site (LDE) WAYNE WELLS is preparing a site survey, etc. which should be ready on or about May 19, 1997. THE AREA SELECTED IS IN A NATURAL/OLD CLEARING "IN THE WOODS" (THERE ARE 4 PARS PASSED WITH 5 WOOD AND PASSED).