

COORDINATES					
NO.	NORTH	EAST	NO.	NORTH	EAST
6	507,666.07	855,111.84	125	507,731.0280	854,948.6397
7	506,925.59	854,760.38	246	507,129.5771	854,580.6354
8	506,783.00	854,892.50	218	507,749.5874	854,902.0111
310	507,197.3823	854,490.6904	234	506,720.6182	854,798.1471
311	507,152.4295	854,423.9834	236	506,765.2189	854,865.6060
101	507,123.2409	854,643.6890	240	507,145.6638	854,598.9983
			243	507,082.1185	854,616.2167
			244	507,049.4862	854,616.1555
			247	507,127.3028	854,549.7817
			411	507,844.5191	854,663.5054
			412	507,816.6459	854,652.4111
			414	507,767.2160	854,776.5984

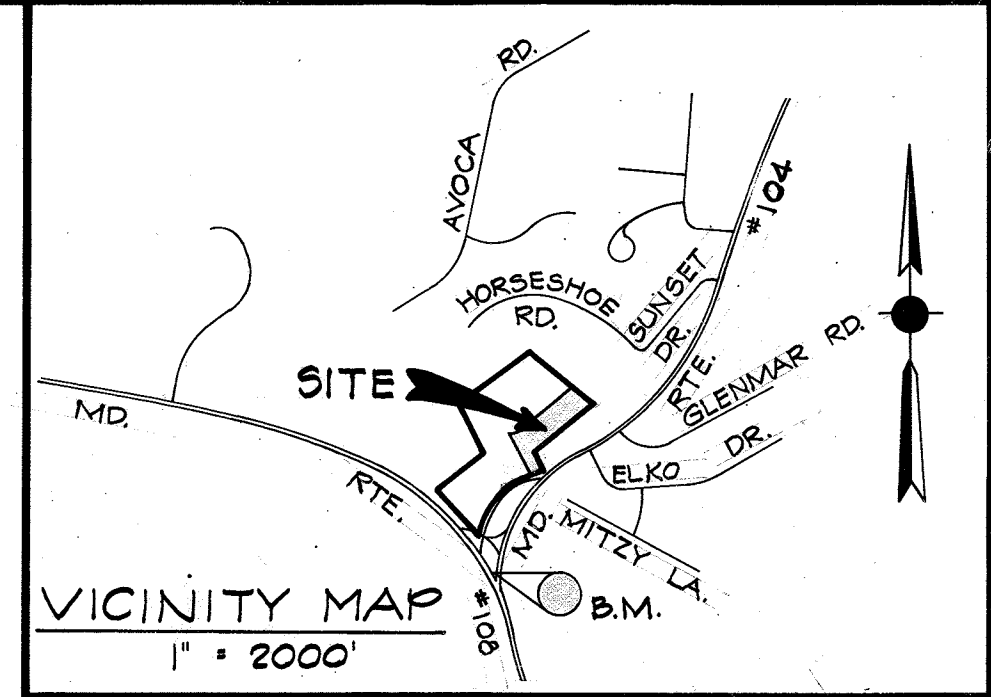

B.M.
 Station Designation 2743003 Elev. 506.285
 N505928.540 E854445.247 3/4" Rebar 0.5 below
 surface in island at intersection of Routes 104 & 108

DENSITY TABULATIONS	
DESCRIPTION	SECTION I AREA I
1. NUMBER OF LOTS RESIDENTIAL:	44
2. TOTAL NO. OF LOTS INCL. OPEN SPACE:	46
3. TOTAL AREA OF LOTS	160,234 # 3.678 Ac±
4. AREA OF ROADWAYS	83,409 # 1.915 Ac±
5. AREA OF SUBDIVISION	319,515 # 7.335 Ac±
6. AREA OF OPEN SPACE	75,872 # 1.742 Ac±

NOTE:
 All 4" Square Concrete Monuments shown Thusly-□

CURVE DATA					
NO.	DELTA	RADIUS	LENGTH	TAN.	CHORD
243-101	14-12-15	200.00	49.58	24.92	N 33°-44'-43" E 49.45'
246-240	7-06-32	150.00	18.63	9.32	N 30°-12'-07" E 18.61'
244-236	1-16-02	17,099.48	378.19	189.10	S 41°-16'-03" E 378.19'
311-234	1-54-20	17,179.48	571.36	285.71	S 40°-54'-32" E 571.33'
247-310	0-18-26	17,099.48	91.69	45.64	N 40°-08'-16" W 91.69'

APPROVED: For public water & public sewer systems. Howard County Health Dept.
Palmer F. Wine-Dryer, M.D. 11-6-79
 Director Date

APPROVED: Howard County Office of Planning & Zoning
Thomas H. Harris, Jr. 11-8-79
 Director Date

APPROVED: For Storm Drainage Systems, Public Roads, and Public Water & Public Sewer Systems. Howard County Department of Public Works
Paul F. Newman 11-8-79
 Director Date

SURVEYOR'S CERTIFICATE

I hereby certify that the Final Plat shown hereon is correct; that it is a subdivision of part of the lands conveyed by MARY T. SMITH to THE ARDWIN CO. deed dated NOV. 6, 1976 and recorded in the Land Records of Howard County, in Liber 794, Folio 671, and that all monuments are in place as shown, in accordance with the Annotated Code of Maryland as amended.

Albert L. Ligon, Jr.
 Registered Surveyor Md. # PLS 26

OWNERS DEDICATION

We, The Ardwin Company, a Maryland Corporation by, of BERNARD DACKMAN, President, SANDRA B. DACKMAN, Secretary, owners of the property shown and described hereon, hereby adopt this plan of subdivision, and in consideration of the approval of Final Plat by the Office of Planning and Zoning, establish the minimum building restriction lines and grant unto Howard County, Maryland, its successors and assigns, (1) the right to lay, construct and maintain sewers, drains, water pipes and other municipal utilities and services, in and under all roads and street right-of-ways and the specific easement areas shown hereon; (2) dedicate to public use the beds of the streets and/or roads and Floodplains and open space where applicable, and for One Dollar (\$1.00) consideration, hereby grant the right and option to acquire the Fee Simple title to the beds of the streets and/or roads and Floodplains and open space where applicable; (3) that no building or similar structure of any kind shall be erected on or over the said easements and right-of-ways; and (4) if it is further agreed that maintenance of all storm drains, drainage easements and/or Floodplains shown hereon are the responsibility of the property owner, its successors and assigns.

Witness our hands this 10th day of October 1978

James J. [Signature] Authorized Agent
Linda B. Dackman Secretary

TIMBER RUN VALLEY - SECTION I AREA I

LOTS 25 TO 68 AND LOTS 109 & 110
 2ND ELECTION DISTRICT
 HOWARD COUNTY, MARYLAND
 Scale: 1" = 50' September 1978

D. STHALER & ASSOC.
 3809 CLARKS LANE
 BALTIMORE, MARYLAND
 21215