

GENERAL NOTES:

- COORDINATES BASED ON NAD '83/91, MARYLAND COORDINATE SYSTEM AS PROJECTED BY HOWARD COUNTY, GEODETIC CONTROL STATION 0018 & 08CA.
0018 N 607697.308 E 1308424.309
08CA N 610521.236 E 1308742.172
- THIS PLAT IS BASED ON SHA PLAT 56363.
- BRL DENOTES BUILDING RESTRICTION LINE.
- DENOTES REBAR WITH CAP SET.
○ DENOTES IRON PIPE OR IRON BAR FOUND.
○ DENOTES ANGULAR CHANGE IN BEARING OF BOUNDARY OR RIGHT-OF-WAY.
□ DENOTES STONE OR MONUMENT FOUND.
- AREAS SHOWN HEREON ARE MORE OR LESS.
- THE SUBJECT PROPERTY IS ZONED RC-DEO PER THE OCT. 6, 2013 COMPREHENSIVE ZONING PLAN.
- THERE ARE NO EXISTING STRUCTURES ON SITE.
- APPLICABLE DPZ FILE NUMBERS: SHA PLAT 56363, SDP-19-006, SDP-19-006(FC).
- IN ACCORDANCE WITH CEMETERY INVENTORY MAP, NO CEMETERY EXISTS ON THE PROJECT SITE. ACCORDING TO THE HOWARD COUNTY DEPARTMENT OF PLANNING AND ZONING, CEMETERY IS LOCATED ON AN ADJACENT PARCEL THAT WAS PREVIOUSLY SUBDIVIDED FROM THIS PROPERTY.
- THERE ARE NO HISTORIC STRUCTURES FROM THIS PROPERTY.
- A WETLAND DELINEATION WAS NOT PREPARED FOR THIS FOREST BANK ESTABLISHMENT PLAT.
- NO GRADING, REMOVAL OF VEGETATIVE COVER OR TREES, PAVING AND NEW STRUCTURES SHALL BE PERMITTED WITHIN THE REQUIRED WETLANDS, STREAM(S) OR THEIR BUFFERS, FOREST CONSERVATION EASEMENT AREAS AND 100-YEAR FLOODPLAIN.
- THIS PROPERTY IS NOT WITHIN THE METROPOLITAN DISTRICT.
- THE FOREST CONSERVATION EASEMENT(S) HAS BEEN ESTABLISHED TO FULFILL THE REQUIREMENTS OF SECTION 16.1200 OF THE HOWARD COUNTY FOREST CONSERVATION ACT.
- NO CLEARING, GRADING OR CONSTRUCTION IS PERMITTED WITHIN THE FOREST CONSERVATION EASEMENT. HOWEVER, FOREST MANAGEMENT PRACTICES AS DEFINED IN THE DEED OF FOREST CONSERVATION EASEMENT ARE ALLOWED.
- THIS PLAN WILL CREATE 12,2642 ACRES OF FOREST BANK:
- FOREST CONSERVATION EASEMENT #1 RETENTION AREA EQUAL TO 8,9013 AC.
- FOREST CONSERVATION EASEMENT #2 REFORESTATION AREA EQUAL TO 3,3629 AC.
THERE ARE NO FINANCIAL SURETIES REQUIRED FOR THIS PROJECT.

BENCHMARKS

HOWARD COUNTY BENCHMARK 0018
N 607,697.308 E 1,308,424.309 ELEV. 626.856
LOCATION: 2' EAST OF ROUTE 97, 83.4' FROM
G&E #272935, 35.2' FROM C&P #79

HOWARD COUNTY BENCHMARK 08CA (CONC. MON.)
N 610,521.236 E 1,308,742.172 ELEV. 625.025
LOCATION: 33.5' FROM BGE #148701
175' FROM BGE #81505

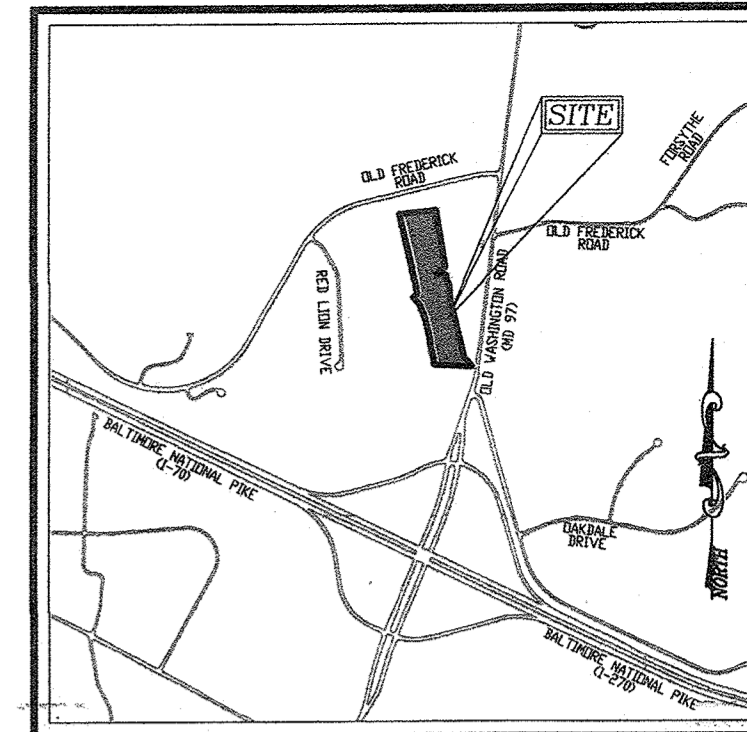

VICINITY MAP

SCALE 1" = 2000'
ADC MAP/GRID: B6

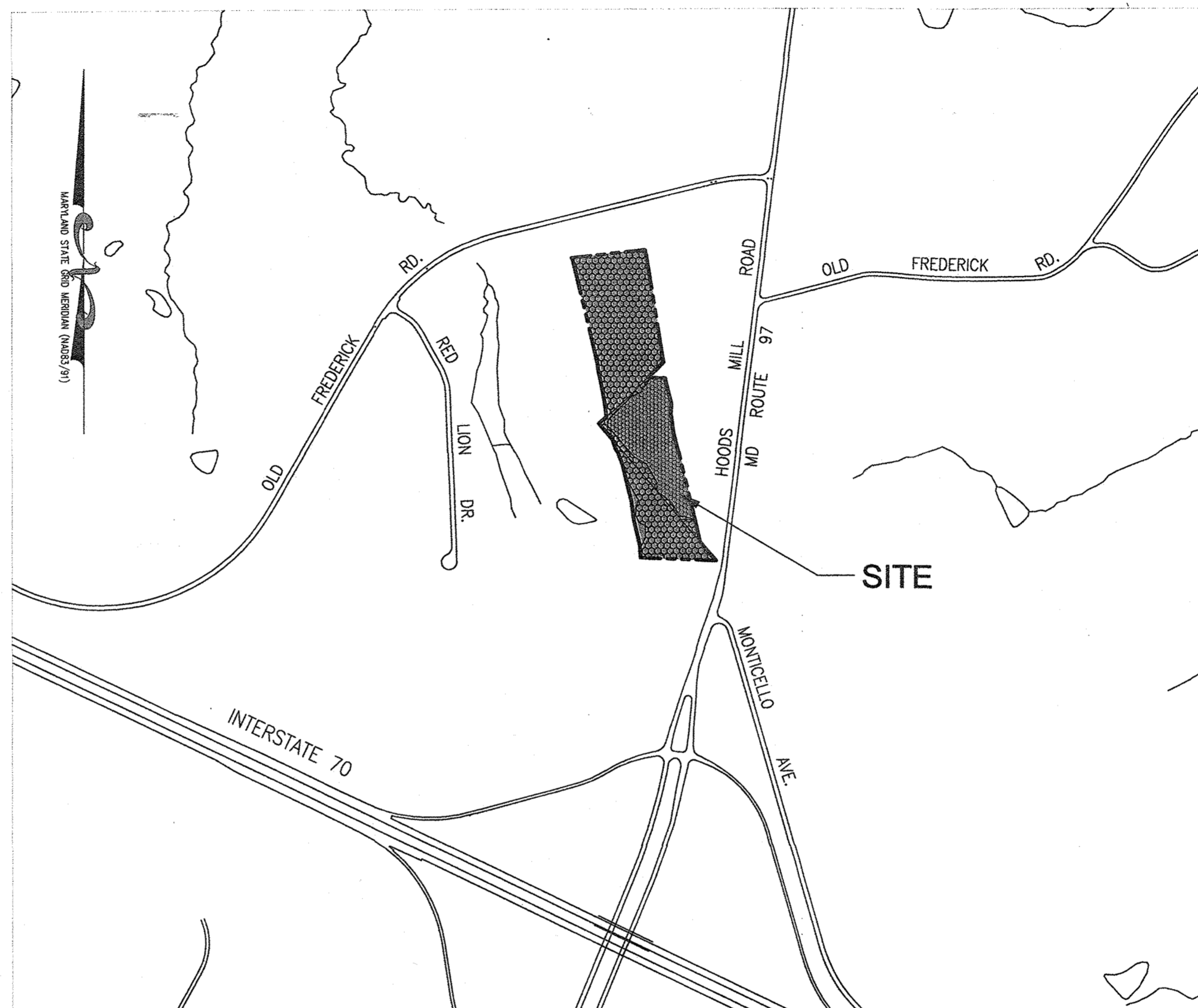

LOCATION MAP
SCALE 1"=600'

PUBLIC FOREST CONSERVATION EASEMENT TABULATION CHART

FCE DESIGNATION	FCE TYPE	FCE AREA
1	RETENTION	8,9013 AC.
2	REFORESTATION	3,3629 AC.
TOTAL		12,2642 AC.

AREA TABULATION

A. TOTAL NUMBER OF LOTS AND/OR PARCELS TO BE RECORDED	1
- BUILDABLE	0
- NON-BUILDABLE	1
- OPEN SPACE	0
- PRESERVATION PARCELS	0
B. TOTAL AREA OF LOTS AND/OR PARCELS	12.4933 AC
- BUILDABLE	0.0000 AC
- NON-BUILDABLE	12.4933 AC
- OPEN SPACE	0.0000 AC
- PRESERVATION PARCELS	0.0000 AC
C. TOTAL AREA OF ROADWAY TO BE RECORDED INCLUDING WIDENING STRIPS	0.0000 AC.
D. TOTAL AREA OF TO BE RECORDED	12.4933 AC.

OWNER

HOWARD COUNTY, MARYLAND
3430 COURT HOUSE DRIVE
ELLCOTT CITY, MD 21043
(410) 313-3260

APPROVED: HOWARD COUNTY DEPARTMENT OF PLANNING AND ZONING

K. J. [Signature]
DIRECTOR
6-10-19
DATE

OWNER'S CERTIFICATE

HOWARD COUNTY, MARYLAND, OWNER OF THE PROPERTY SHOWN AND DESCRIBED HEREON, HEREBY ADOPTS THIS PLAN IN CONSIDERATION OF THE APPROVAL OF THIS PLAT OF FOREST CONSERVATION EASEMENT BY THE DEPARTMENT OF PLANNING AND ZONING, TO ESTABLISH A FOREST CONSERVATION EASEMENT.

J. [Signature] 6/10/19
HOWARD COUNTY, MD
Shaney [Signature]
WITNESS

SURVEYOR'S CERTIFICATE

I HEREBY CERTIFY THAT THE FINAL EASEMENT PLAT SHOWN HEREON IS CORRECT; THAT IT DEFINES A FOREST CONSERVATION EASEMENT ON ALL OR A PORTION OF A PARCEL OF GROUND CONVEYED BY STATE HIGHWAY ADMINISTRATION OF THE MARYLAND DEPARTMENT OF TRANSPORTATION AND BOARD OF PUBLIC WORKS TO HOWARD COUNTY, MARYLAND BY DEED DATED JANUARY 6, 2012 AND RECORDED IN THE LAND RECORDS OF HOWARD COUNTY, MARYLAND IN LIBER 13844 AT FOLIO 432. ALL MONUMENTS ARE IN PLACE.

I HEREBY CERTIFY THAT THESE DOCUMENTS WERE PREPARED BY ME OR UNDER MY RESPONSIBLE CHARGE, AND THAT I AM A DULY LICENSED PROFESSIONAL LAND SURVEYOR UNDER THE LAWS OF THE STATE OF MARYLAND, LICENSE NO. 21639, EXPIRATION DATE JANUARY 03, 2020.

E. [Signature] 5/20/2019
ERIC DAVID SALMI
PROFESSIONAL LAND SURVEYOR, MD REG. NO. 21639



PURPOSE:

THE PURPOSE OF THIS PLAT IS TO REVISE THE PUBLIC FOREST CONSERVATION (REFORESTATION AND RETENTION) EASEMENTS.

RECORDED AS PLAT No. 25040 ON 6/13/19
AMONG THE LAND RECORDS OF HOWARD COUNTY, MARYLAND.

AMENDED PLAT OF REVISION FOREST CONSERVATION EASEMENT

DPW FOREST MITIGATION BANK

ZONED RC-DEO

TAX MAP 8, GRID 5, PARCEL 163
4TH ELECTION DISTRICT, HOWARD COUNTY, MARYLAND

SCALE: 1" = 600' MAY, 2019

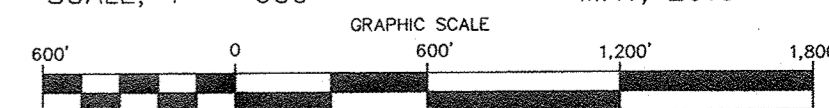

SHEET 1 OF 2

LEGEND

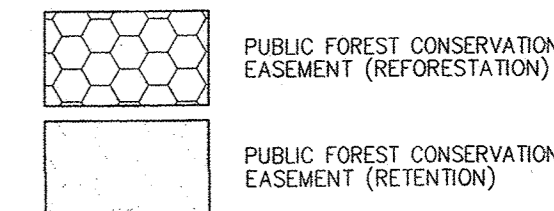

RELOCATED OLD FREDERICK ROAD
(VARIABLE WIDTH R/W)

HOODS MILL ROAD (ROUTE 97)
(VARIABLE WIDTH R/W)

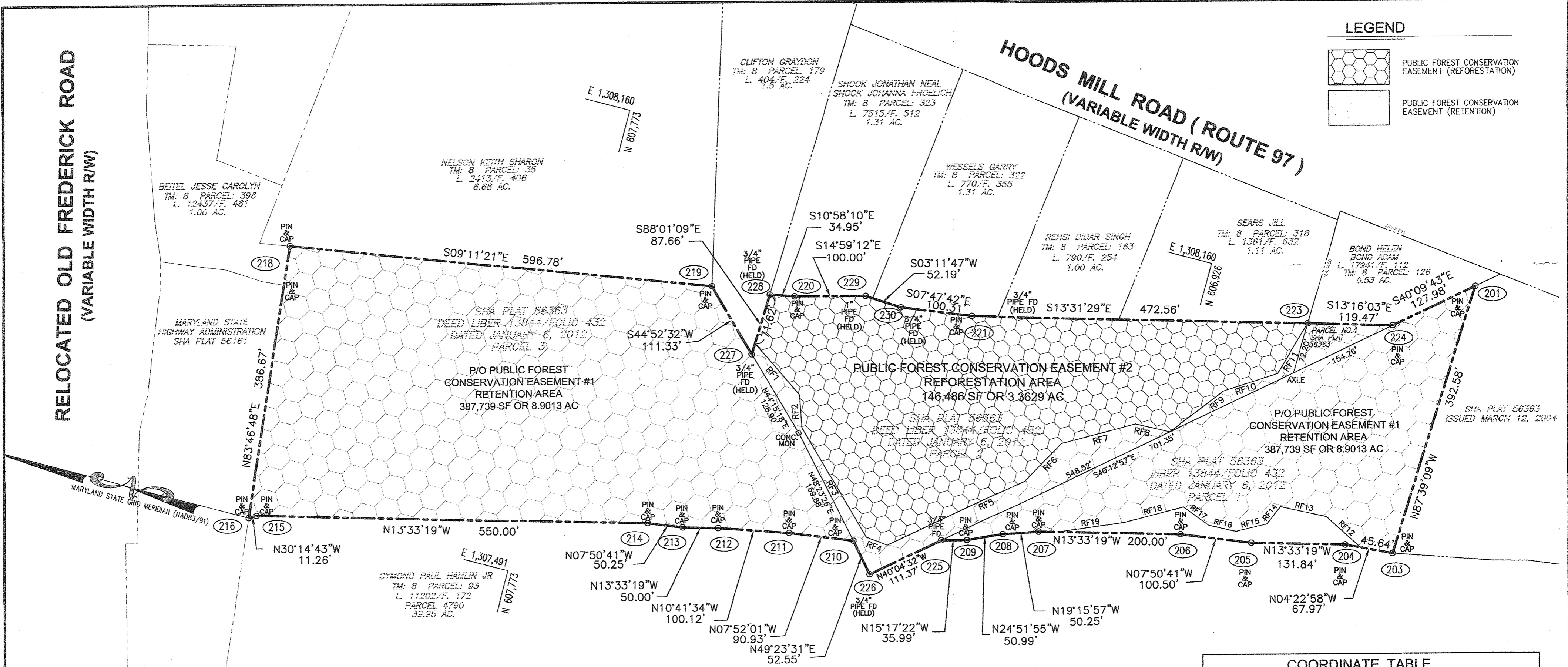

THE REQUIREMENTS OF § 3-108, THE REAL PROPERTY ARTICLE, ANNOTATED CODE OF MARYLAND, 1988 REPLACEMENT VOLUME, (AS SUPPLEMENTED) AS FAR AS THEY RELATE TO THE MAKING OF THIS PLAT AND THE SETTING OF MARKERS HAVE BEEN COMPLIED WITH.

Eric David Salmi 5/20/2019
ERIC DAVID SALMI DATE
PROFESSIONAL LAND SURVEYOR, MD REG. NO. 21639

James K... 6/10/19
HOWARD COUNTY, MARYLAND DATE

AREA TABULATION

A. TOTAL NUMBER OF LOTS AND/OR PARCELS TO BE RECORDED	1
- BUILDABLE	0
- NON-BUILDABLE	1
- OPEN SPACE	0
- PRESERVATION PARCELS	0
B. TOTAL AREA OF LOTS AND/OR PARCELS	12.4933 AC
- BUILDABLE	0.0000 AC
- NON-BUILDABLE	12.4933 AC
- OPEN SPACE	0.0000 AC
- PRESERVATION PARCELS	0.0000 AC
C. TOTAL AREA OF ROADWAY TO BE RECORDED INCLUDING WIDENING STRIPS	0.0000 AC
D. TOTAL AREA OF TO BE RECORDED	12.4933 AC

PUBLIC FOREST CONSERVATION EASEMENTS
LINE TABLE

LINE	LENGTH	BEARING
RF1	95.65	S34°23'25"W
RF2	46.40	S70°38'28"W
RF3	178.59	S44°48'14"W
RF4	31.44	S06°10'59"W
RF5	213.44	S39°57'16"E
RF6	73.48	S60°27'16"E
RF7	107.28	S29°30'22"E
RF8	50.28	S02°03'05"E
RF9	94.96	S51°56'35"E
RF10	80.02	S32°46'21"E
RF11	81.85	S73°51'08"E
RF12	65.07	N26°55'48"E
RF13	65.72	N02°17'19"W
RF14	30.92	N66°30'52"W
RF15	45.05	N27°58'10"W
RF16	39.61	N02°02'15"W
RF17	43.47	N21°26'19"E
RF18	86.46	N29°17'43"W
RF19	94.24	N22°43'29"W

COORDINATE TABLE

NO.	NORTH	EAST	NO.	NORTH	EAST
201	606559.4038	1308222.5997	216	608144.4967	1307470.1639
203	606575.4830	1307830.3514	217	608161.2369	1307623.7587
204	606643.2542	1307825.1572	218	608186.3917	1307854.5589
205	606771.4217	1307794.2561	219	607597.2900	1307949.8618
206	606870.9812	1307780.5389	220	607481.0386	1307965.5705
207	607065.4100	1307733.6623	221	607232.9471	1308002.1248
208	607112.8459	1307717.0822	223	606773.4922	1308112.6407
209	607159.1091	1307695.6416	224	606657.2087	1308140.0592
210	607313.2537	1307654.3447	225	607193.8300	1307686.1500
211	607403.3238	1307641.8994	226	607279.0500	1307614.4500
212	607501.7053	1307623.3229	227	607518.3800	1307871.3100
213	607550.3125	1307611.6037	228	607515.3500	1307958.9200
214	607600.0923	1307604.7452	229	607384.4400	1307991.4300
215	608134.7716	1307475.8343	230	607332.3300	1307332.3300

ROBERT H. VOGEL ENGINEERING, INC.
ENGINEERS • SURVEYORS • PLANNERS
3300 N. RIDGE ROAD, SUITE 110, ELLICOTT CITY, MD 21043
TEL: 410.461.7666 FAX: 410.461.8961

OWNER'S CERTIFICATE

HOWARD COUNTY, MARYLAND, OWNER OF THE PROPERTY SHOWN AND DESCRIBED HEREON, HEREBY ADOPTS THIS PLAN IN CONSIDERATION OF THE APPROVAL OF THIS PLAT OF FOREST CONSERVATION EASEMENT BY THE DEPARTMENT OF PLANNING AND ZONING, TO ESTABLISH A FOREST CONSERVATION EASEMENT.

James K... 6/10/19
HOWARD COUNTY, MD

Chancy...
WITNESS

SURVEYOR'S CERTIFICATE

I HEREBY CERTIFY THAT THE FINAL EASEMENT PLAT SHOWN HEREON IS CORRECT; THAT IT DEFINES A FOREST CONSERVATION EASEMENT ON ALL OR A PORTION OF A PARCEL OF GROUND CONVEYED BY STATE HIGHWAY ADMINISTRATION OF THE MARYLAND DEPARTMENT OF TRANSPORTATION AND BOARD OF PUBLIC WORKS TO HOWARD COUNTY, MARYLAND BY DEED DATED JANUARY 6, 2012 AND RECORDED IN THE LAND RECORDS OF HOWARD COUNTY, MARYLAND IN LIBER 13844 AT FOLIO 432. ALL MONUMENTS ARE IN PLACE.

I HEREBY CERTIFY THAT THESE DOCUMENTS WERE PREPARED BY ME OR UNDER MY RESPONSIBLE CHARGE, AND THAT I AM A DULY LICENSED PROFESSIONAL LAND SURVEYOR UNDER THE LAWS OF THE STATE OF MARYLAND, LICENSE NO. 21639, EXPIRATION DATE JANUARY 03, 2020.

Eric David Salmi 5/20/2019
ERIC DAVID SALMI DATE
PROFESSIONAL LAND SURVEYOR, MD REG. NO. 21639



APPROVED: HOWARD COUNTY DEPARTMENT OF PLANNING AND ZONING

Kent... 6/10/19
DIRECTOR DATE

RECORDED AS PLAT No. 25041 ON 6/13/19
AMONG THE LAND RECORDS OF HOWARD COUNTY, MARYLAND.

AMENDED PLAT OF REVISION
FOREST CONSERVATION EASEMENT
DPW FOREST MITIGATION BANK

ZONED RC-DEO

TAX MAP 8, GRID 5, PARCEL 163
4TH ELECTION DISTRICT, HOWARD COUNTY, MARYLAND

SCALE: 1" = 100' MAY 2019

SHEET 2 OF 2