

COORDINATE TABLE		
NO.	NORTHING	EASTING
1000	543415.6703	1364074.9331
1001	543631.2154	1363923.2966
1038	543214.4207	1363708.0671
1039	543227.6532	1363693.0704
1040	543233.2286	1363699.2899
1041	543290.9182	1363723.0736
1042	543356.9557	1363740.8183
1043	543439.9522	1363752.8216
1044	543503.9484	1363770.8238
1045	543529.9883	1363768.6550
1046	543649.9905	1363793.6614
1047	543724.9938	1363798.6653
1048	543749.6286	1363749.4014
1049	543721.4172	1363743.6086
1050	543767.3413	1363711.3008
1051	543786.1823	1363669.5337
1052	543827.4880	1363618.5581
1053	543909.7702	1363727.3325
1054	543576.0457	1363344.5543
1055	543617.9164	1363304.9285
1056	543632.6257	1363324.0183
1057	543662.6739	1363363.9821
1058	543781.8219	1363548.2463

CURVE DATA TABLE						
NO.	DELTA	TANGENT	ARC	RADIUS	CHORD	CHORD BEARING
C2	24° 06' 22"	4.27'	8.41'	20.00'	8.35'	N 48° 07' 31" E
C3	01° 21' 09"	12.05'	24.10'	1020.92'	24.10'	S 52° 23' 05" W

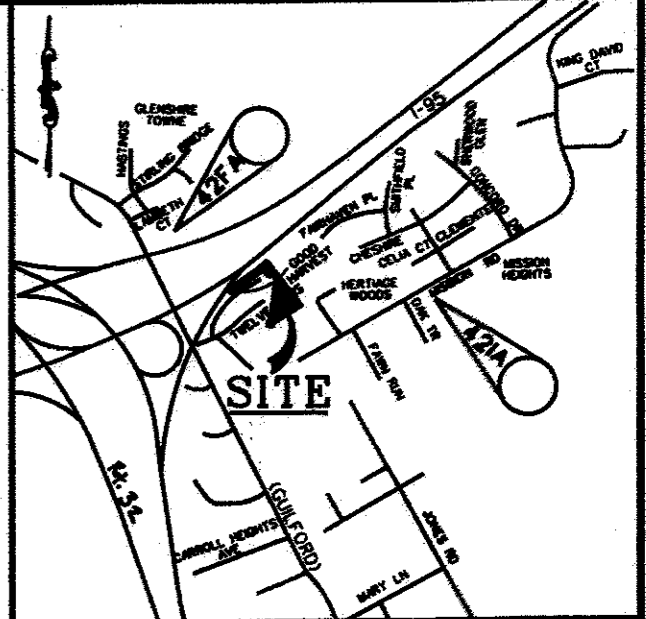

VICINITY MAP

ADC MAP 15.E6  
SCALE: 1" = 2000'

GENERAL NOTES

- COORDINATES BASED ON NAD '83/2007, MARYLAND COORDINATE SYSTEM AS PROJECTED BY HOWARD COUNTY, GEODETIC CONTROL STATIONS.  
42FA N 544412.814 E 1362179.335  
42IA N 543390.414 E 1364912.622
- THE SUBJECT PROPERTY IS ZONED R-MH IN ACCORDANCE WITH THE OCTOBER 6, 2013 COMPREHENSIVE ZONING REGULATIONS.
- NO GRADING, REMOVAL OF VEGETATIVE COVER OR TREES, PAVING AND NEW STRUCTURES SHALL BE PERMITTED WITHIN THE LIMITS OF WETLANDS, STREAMS, OR THEIR REQUIRED BUFFERS, FLOODPLAIN AND FOREST CONSERVATION EASEMENT AREAS.
- THE OUTLINES OF OPEN SPACE LOT 83 ARE BASED ON THE PROPERTY LINES SHOWN ON PLATS ENTITLED "SIGNAL HILL LOTS 1-84", RECORDED AMONG THE LAND RECORDS OF HOWARD COUNTY, MARYLAND AS PLAT NO. 7760, WITH BEARINGS REFERENCED TO THE DATUM SHOWN ABOVE REFER TO THE LOCATION MAP-THIS SHEET FOR AREA OF OPEN SPACE LOT 83 SHOWN ON THIS PLAT.
- PREVIOUS DPZ FILES: S-87-004, P-87-026, F-88-019
- THE ARTICLES OF INCORPORATION FOR MAINTENANCE OF THE OPEN SPACE ARE RECORDED IN RECEIPT NO. 73138556.
- THIS PLAT IS EXEMPT FROM THE REQUIREMENTS OF SECTION 16.124 OF THE HOWARD COUNTY CODE AND THE LANDSCAPE MANUAL BECAUSE IT IS A REVISION PLAT THAT DOES NOT CREATE ANY NEW LOTS/PARCEL DIVISIONS.
- THIS PLAT IS EXEMPT FROM THE FOREST CONSERVATION REQUIREMENTS BECAUSE IT IS A REVISION PLAT THAT DOES NOT CREATE A NEW LOTS IN ACCORDANCE WITH SECTION 16.1202(b)(1)(vii) OF HOWARD COUNTY CODE.

RESERVATION OF PUBLIC UTILITY AND FOREST CONSERVATION EASEMENTS

DEVELOPER RESERVES UNTO ITSELF, ITS SUCCESSORS AND ASSIGNS, ALL EASEMENTS SHOWN ON THIS PLAN FOR WATER, SEWER, STORM DRAINAGE, OTHER PUBLIC UTILITIES, LOCATED IN, ON, OVER AND THROUGH LOTS/PARCELS, ANY CONVEYANCES OF THE FORESAID LOTS/PARCELS SHALL BE SUBJECT TO THE EASEMENTS HEREIN RESERVED, WHETHER OR NOT EXPRESSLY STATED IN THE DEED(S) CONVEYING SAID LOT(S)/PARCELS. DEVELOPER SHALL EXECUTE AND DELIVER DEEDS FOR THE EASEMENTS HEREIN RESERVED TO HOWARD COUNTY, UPON COMPLETION OF THE PUBLIC UTILITIES AND THEIR ACCEPTANCE BY HOWARD COUNTY, THE COUNTY SHALL ACCEPT THE EASEMENTS AND RECORD THE DEED(S) OF EASEMENT IN THE LAND RECORDS OF HOWARD COUNTY.

AREA TABULATION CHART

- a. TOTAL NUMBER OF LOTS AND/OR PARCELS TO BE RECORDED
  - \* BUILDABLE 0
  - \* NON-BUILDABLE 0
  - \* OPEN SPACE 0
  - \* PRESERVATION PARCELS 0
- b. TOTAL AREA OF LOTS AND/OR PARCELS
  - \* BUILDABLE 0
  - \* NON-BUILDABLE 0
  - \* OPEN SPACE 6.64 ACRES
  - \* PRESERVATION PARCELS 0
- c. TOTAL AREA OF ROADWAY TO BE RECORDED INCLUDING WIDENING STRIPS 0
- d. TOTAL AREA OF SUBDIVISION TO BE RECORDED 6.64 ACRES

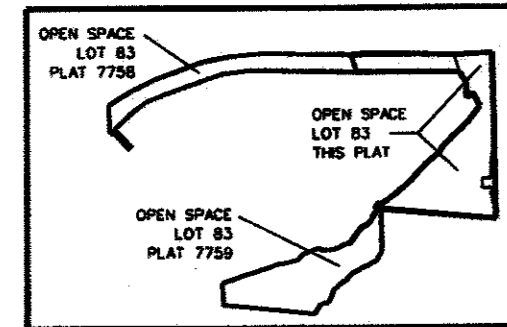

LOCATION MAP

SCALE: 1" = 1000'

APPROVED: FOR PUBLIC WATER AND PUBLIC SEWERAGE SYSTEMS HOWARD COUNTY HEALTH DEPARTMENT

APPROVED: HOWARD COUNTY DEPARTMENT OF PLANNING AND ZONING.

CHIEF, DEVELOPMENT ENGINEERING DIVISION  
DATE: 5-10-18

DIRECTOR  
DATE: 5-17-18

ENGINEERS  
PLANNERS  
SCIENTISTS  
CONSTRUCTION MANAGERS

**KCI** TECHNOLOGIES

936 RIDGEBROOK ROAD  
SHARPS, MARYLAND 21152  
TELEPHONE: (410) 316-7800  
FAX: (410) 316-7818

THE REQUIREMENT OF SECTION 3-108, THE REAL PROPERTY ARTICLE, ANNOTATED CODE OF MARYLAND, 1988 REPLACEMENT VOLUME, (AS SUPPLEMENTED) AS FAR AS THEY RELATE TO THE MAKING OF THIS PLAT AND THE SETTING OF MARKERS HAVE BEEN COMPLIED WITH.

CHARLES ALLEN PHILLIPS, L.S. MD. 463  
PRESIDENT  
SIGNAL HILL NEIGHBORHOOD ASSOCIATION, INC.

PROPERTY OWNER

SIGNAL HILL NEIGHBORHOOD ASSOC INC  
C/O JUDY SNYDER  
8957 TWELVE SONS CT  
JESSUP, MD 20794  
TERESA CADEN  
PH: (443)255-1806

OWNER'S CERTIFICATE

I, SIGNAL HILL HOMEOWNERS ASSOCIATION INC, OWNER OF THE PROPERTY SHOWN AND DESCRIBED HEREON, HEREBY ADOPT THIS PLAT OF REVISION; AND IN CONSIDERATION OF THE APPROVAL OF THIS PLAT OF REVISION BY THE DEPARTMENT OF PLANNING AND ZONING ESTABLISH AND GRANT UNTO HOWARD COUNTY, MARYLAND, ITS SUCCESSORS AND ASSIGNS (1) THE RIGHT TO LAY, CONSTRUCT AND MAINTAIN DRAINS IN THE SPECIFIC EASEMENT AREA SHOWN HEREON (2) THE RIGHT TO REQUIRE DEDICATION THE DRAINAGE EASEMENT FOR FOR THE SPECIFIC PURPOSE OF THEIR CONSTRUCTION REPAIR AND MAINTENANCE (3) THAT NO BUILDING OR SIMILAR STRUCTURE OF ANY KIND SHALL BE ERRECTED ON OR OVER THE SAID EASEMENTS AND RIGHT-OF-WAYS.

WITNESS MY HAND THIS 9th DAY OF April, 2018

Teresa E Cadden, PRESIDENT  
Armin Quwan, WITNESS

SURVEYOR'S CERTIFICATE

I HEREBY CERTIFY THAT THE FINAL PLAT SHOWN HEREON IS CORRECT; THAT IT IS A PLAT OF REVISION OF THE LANDS CONVEYED BY ETHAN GROSSMAN, TRUSTEE TO SIGNAL HILL NEIGHBORHOOD ASSOCIATION, INC BY DEED DATED DECEMBER 19, 1999 AND RECORDED IN THE LAND RECORDS OF HOWARD COUNTY, MARYLAND IN LIBER NO. 2100 AT FOLIO 351.

I HEREBY CERTIFY THAT THESE DOCUMENTS WERE PREPARED BY ME OR UNDER MY RESPONSIBLE CHARGE, AND THAT I AM A DULY LICENSED PROPERTY LINE SURVEYOR UNDER THE LAWS OF THE STATE OF MARYLAND, LICENSE NO. 463, EXPIRATION DATE DECEMBER 27, 2018.

CHARLES ALLEN PHILLIPS  
REGISTERED PROPERTY LINE SURVEYOR  
MARYLAND LICENSE NO. 463

4/3/18  
DATE

PURPOSE STATEMENT

THE PURPOSE OF THIS PLAT IS TO CREATE A PUBLIC DRAINAGE AND UTILITY EASEMENT OVER AND ACROSS A PORTION OF OPEN SPACE LOT 83.

RECORDED AS PLAT 24642 ON 5/24/18 AMONG THE LAND RECORDS OF HOWARD COUNTY, MD.

A PLAT OF REVISION OF LOT OPEN SPACE LOT 83  
PLAT No. 7760

SIGNAL HILL-  
OPEN SPACE LOT 83

ZONED R-MH  
TAX MAP 42 GRID 24 PARCEL 76  
SIXTH ELECTION DISTRICT HOWARD COUNTY, MD  
SCALE: 1"=50' OCTOBER 29, 2016

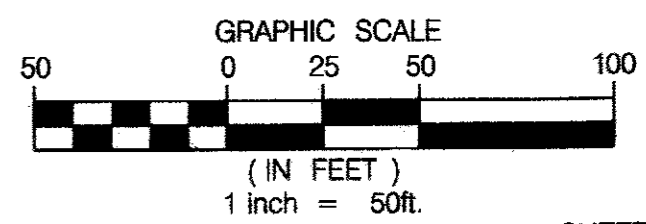

F 18-096