

COORDINATE LIST		
PT #	NORTHING	EASTING
1	563,058.4839	1,380,585.9287
2	563,042.5654	1,380,654.0811
3	563,051.7141	1,380,684.7872
4	563,046.7455	1,380,696.9948
5	563,110.4397	1,380,715.6794
6	563,137.5539	1,380,746.1223
7	563,199.1362	1,380,683.0626
8	563,191.1235	1,380,665.3178
9	563,094.2944	1,380,591.5436

LINE TABLE		
LINE	LENGTH	BEARING
L1	14.90	S25°01'43"E
L2	27.89	S65°09'56"W
L3	9.01	N89°10'10"W
L4	10.28	S20°48'21"E
L5	12.40	S86°10'47"W
L6	2.63	S20°58'58"W
L7	16.96	S41°08'17"E
L8	15.39	S20°29'55"W
L9	21.19	N79°39'55"W
L10	5.29	N71°07'13"W
F1	28.09	S52°55'37"E
F2	40.05	S45°40'38"E
F3	11.43	N68°36'08"W
F4	20.82	N53°56'08"W
F5	9.80	N64°29'12"W
F6	25.44	N82°43'35"W
F7	24.74	N88°34'34"E
F8	13.05	S11°28'56"W
F9	1.52	S82°15'03"W
F10	11.80	S08°24'04"W
F11	11.49	S41°38'07"W
F12	12.52	S04°58'30"E
F13	48.88	S71°32'05"W

CURVE TABLE						
CURVE	RADIUS	ARC LENGTH	DELTA ANGLE	TANGENT	CHORD BEARING	CHORD
C-1	128.00	9.74	4°21'33"	4.87	S11°05'27"W	9.74
C-2	128.00	117.12	52°25'35"	63.02	S39°29'00"W	113.08

NOTE: COORDINATES AND GRID TICS SHOWN HEREON ARE BASED ON NAD '83 AND ARE IN FEET. TO CONVERT TO METERS DIVIDE BY 3.28083333.

- LEGEND**
- EXISTING FOREST CONSERVATION EASEMENT (RETENTION)
  - EXISTING FOREST CONSERVATION EASEMENT (REFORESTATION)
  - EXISTING FOREST CONSERVATION EASEMENT TO BE REMOVED

**OWNERS**  
 HOWARD COUNTY, MARYLAND  
 3430 COURT HOUSE DRIVE.  
 ELLICOTT CITY, MD 21043  
 (410) 313-2330

THE REQUIREMENTS OF 3-108, THE REAL PROPERTY ARTICLE, ANNOTATED CODE OF MARYLAND, 1988 REPLACEMENT VOLUME (AS SUPPLEMENTED) AS FAR AS THEY RELATE TO THE MAKING OF THIS PLAT AND THE SETTING OF MARKERS HAVE BEEN COMPLIED WITH.

*Gary E. Lane* 10/12/16  
 GARY E. LANE, PROP. LINE SURVEYOR DATE

*James M. Irvin* 10/12/16  
 James M. Irvin, Director, Department of Public Works DATE

APPROVED: FOR PUBLIC WATER AND PUBLIC SEWERAGE SYSTEMS  
 HOWARD COUNTY HEALTH DEPARTMENT

*Maureen Robinson* 10/25/2016  
 HOWARD COUNTY HEALTH OFFICER DATE

APPROVED: HOWARD COUNTY DEPARTMENT OF PLANNING AND ZONING

*Chris Anderson* 10-27-16  
 CHIEF, DEVELOPMENT ENGINEERING DIVISION DATE

*Kathleen Duda* 10-31-16  
 DIRECTOR DATE

**OWNER'S STATEMENT**

WE, HOWARD COUNTY, MARYLAND, OWNERS OF THE PROPERTY SHOWN AND DESCRIBED HEREON, HEREBY ADOPT THIS PLAN OF SUBDIVISION AND IN CONSIDERATION OF THE APPROVAL OF THIS FINAL PLAT BY THE DEPARTMENT OF PLANNING AND ZONING, ESTABLISH THE MINIMUM BUILDING RESTRICTION LINES AND GRANT UNTO HOWARD COUNTY, MARYLAND, ITS SUCCESSORS AND ASSIGNS 1) THE RIGHT TO LAY, CONSTRUCT AND MAINTAIN SEWER, DRAIN, WATER PIPES AND OTHER MUNICIPAL UTILITIES AND SERVICES IN AND UNDER ALL ROADS AND STREET RIGHTS-OF-WAY AND THE SPECIFIC EASEMENTS SHOWN HEREON, 2) THE RIGHT TO REQUIRE DEDICATION FOR PUBLIC USE, THE BEDS OF THE STREETS AND/OR ROADS AND FLOODPLANS AND OPEN SPACE WHERE APPLICABLE, AND FOR GOOD AND OTHER VALUABLE CONSIDERATION, HEREBY GRANT THE RIGHT AND OPTION TO HOWARD COUNTY TO ACQUIRE THE FEE SIMPLE TITLE TO THE BEDS OF THE STREETS AND/OR ROADS AND FLOODPLANS, STORM DRAINAGE FACILITIES AND OPEN SPACE WHERE APPLICABLE, 3) THE RIGHT TO REQUIRE DEDICATION OF WATERWAY AND DRAINAGE EASEMENTS FOR THE SPECIFIC PURPOSE OF THEIR CONSTRUCTION, REPAIR AND MAINTENANCE, AND 4) THAT NO BUILDING OR SIMILAR STRUCTURE OF ANY KIND SHALL BE ERRECTED ON OR OVER THE SAID EASEMENT AND RIGHTS-OF-WAY.

WITNESS MY HAND THIS 12th DAY OF October, 2016.

*James M. Irvin*  
 James M. Irvin, Director, Department of Public Works

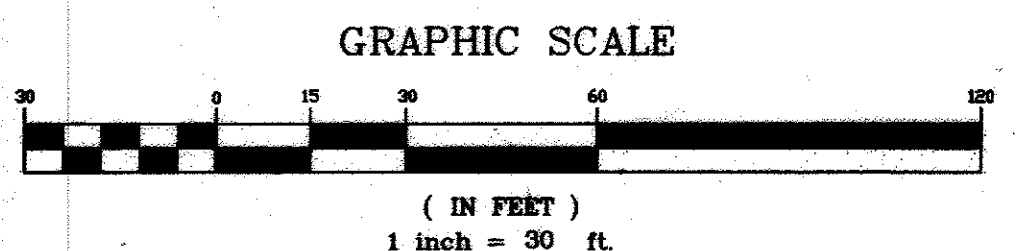

**SURVEYOR'S CERTIFICATE**

I HEREBY CERTIFY THIS DOCUMENT WAS PREPARED BY ME OR UNDER MY RESPONSIBLE CHARGE, AND THAT I AM A DULY LICENSED PROPERTY LINE SURVEYOR UNDER THE LAWS OF THE STATE OF MARYLAND AND THAT THE FINAL PLAT SHOWN HEREON IS CORRECT, THAT IT IS A REVISION TO PLAT# 21328-29 AND PART OF THAT LAND WHICH WAS CONVEYED BY HAWK'S WATCH, LLC, SANDY SPRING BANK, COOKE RE VENTURES TRUST, AND JAMES B. LARRIMORE TO HOWARD COUNTY, MARYLAND BY A DEED DATED OCTOBER 14, 2010 AND RECORDED IN THE LAND RECORDS OF HOWARD COUNTY MARYLAND IN LIBER 12833, FOLIO 183, AND THAT ALL MONUMENTS ARE IN PLACE OR WILL BE IN PLACE PRIOR TO THE ACCEPTANCE OF THE STREETS IN THE SUBDIVISION BY HOWARD COUNTY, AS SHOWN, IN ACCORDANCE WITH THE ANNOTATED CODE OF MARYLAND AS AMENDED.

*Gary E. Lane* 10/12/16  
 GARY E. LANE, PROPERTY LINE SURVEYOR No. 574, EXP. 03/21/2017 DATE

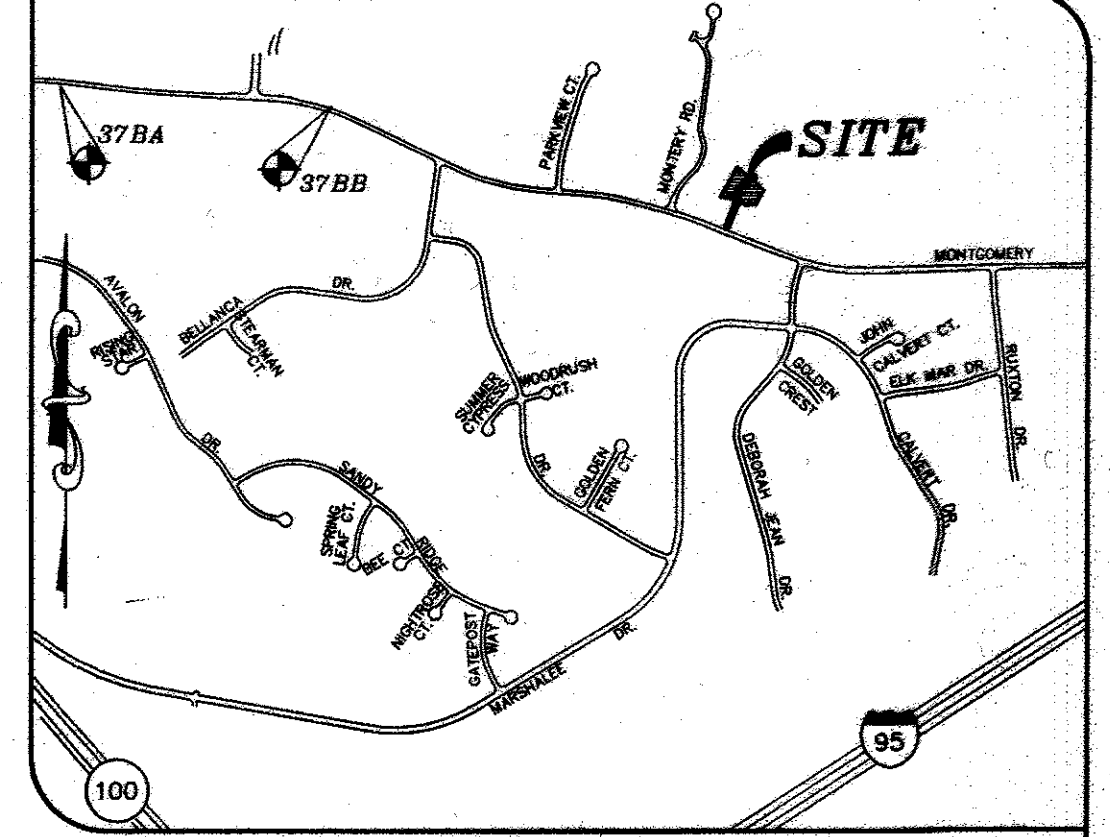
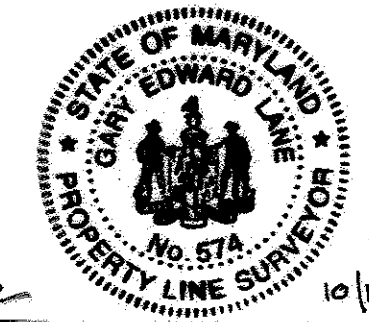

**VICINITY MAP**  
 SCALE: 1"=1000'  
 ADC MAP: 35-A-1

**GENERAL NOTES**

- SUBJECT PROPERTY ZONED "R-20" PER THE OCTOBER 10, 2010 COMPREHENSIVE ZONING PLAN.
- THIS PLAT IS BASED ON A FIELD RUN MONUMENTED BOUNDARY SURVEY PERFORMED ON OR ABOUT DECEMBER, 2002 BY GREENHORNE & O'MARA INC.
- HORIZONTAL AND VERTICAL DATUMS ARE RELATED TO THE MARYLAND NAD 83 (HORZ) AND NGVD29 (VERT) AS PROJECTED FROM HOWARD COUNTY CONTROL STATIONS NO. 378A & 378B.  
 STA. No. 378A: N 563,785.642 E 1,376,343.209 ELEV. 393.94  
 STA. No. 378B: N 563,663.449 E 1,378,040.506 ELEV. 373.01
- BRL DENOTES BUILDING RESTRICTION LINE.
- DENOTES AN IRON PIN, OR IRON PIPE FOUND.  
 ○ DENOTES ANGULAR CHANGE IN BEARING OF BOUNDARY OR RIGHT-OF-WAY.  
 □ DENOTES CONCRETE MONUMENT FOUND
- ALL AREAS ARE MORE OR LESS.
- THERE ARE NO HISTORIC DISTRICTS ADJACENT TO THE SITE.
- THE FOREST CONSERVATION EASEMENTS HAVE BEEN ESTABLISHED TO FULFILL THE REQUIREMENTS OF SECTION 16.1200 OF THE HOWARD COUNTY FOREST CONSERVATION ACT. NO CLEARING, GRADING OR CONSTRUCTION IS PERMITTED WITHIN THE FOREST CONSERVATION EASEMENT, EXCEPT AS SHOWN ON AN APPROVED ROAD CONSTRUCTION DRAWING OR SITE DEVELOPMENT PLAN. HOWEVER, FOREST MANAGEMENT PRACTICES AS DENIED IN THE DEED OF FOREST CONSERVATION EASEMENT ARE ALLOWED.
- THIS SUBDIVISION IS IN THE METROPOLITAN DISTRICT.
- SURVEY WORK AND DOCUMENTS HAVE BEEN PERFORMED IN CONFORMANCE WITH SUBTITLE 13, BOARD OF PROFESSIONAL LAND SURVEYORS, 09.13.06 STATE OF MARYLAND, MINIMUM STANDARDS OF PROFESSIONAL PRACTICE.
- FOREST CONSERVATION REQUIREMENTS HAVE BEEN SATISFIED BY PROVIDING TWO ON-SITE FOREST CONSERVATION EASEMENTS AND A PAYMENT OF FEE-IN-LIEU AS PART OF THE DEVELOPER'S AGREEMENT UNDER F-03-138.
- PAYMENT OF \$1.25 PER SQUARE FOOT FOR ABANDONMENT OF 1,761 SQUARE FEET OF THE EXISTING FOREST CONSERVATION EASEMENT IN THE AMOUNT OF \$2,202.00 HAS BEEN PAID.
- FOR ALL OTHER PERTINENT NOTES AND DETAILS, REFER TO PLAT# 21328-29.
- PREVIOUS DPZ FILE NUMBER: F-03-128, SDP-11-028.

THE PURPOSE OF THIS PLAT IS TO REMOVE PART OF THE EXISTING FOREST CONSERVATION AREA "C" FROM OPEN SPACE LOT 6, AS SHOWN ON PLAT# 21328-29.

RECORDED AS PLAT 23956 ON 11/4/16 AMONG THE LAND RECORDS OF HOWARD COUNTY, MD.

REVISION PLAT  
**HAWK'S WATCH**  
 OPEN SPACE LOT 6  
 A REVISION PLAT TO HAWK'S WATCH  
 LOTS 1 - 6 PLAT # 21328-9 SHEET 1 OF 1

TAX MAP 37 1ST ELECTION DISTRICT SCALE: 1"=30'  
 PARCEL 58 HOWARD COUNTY, MARYLAND DATE: OCT. 2016  
 GRID 5 EX. ZONING R-20  
 DPZ FILE#S: F-03-128, SDP-11-028

**MILDENBERG, BOENDER & ASSOC., INC.**  
 Engineers Planners Surveyors  
 7350-B Grace Drive, Columbia, Maryland 21044  
 (410) 997-0296 Tel. (410) 997-0298 Fax.