

MARYLAND STATE PLANE  
NAD 83/NSRS 2007  
SCALE: 1"=50'

CURVE TABLE

CURVE	RADIUS	ARC LENGTH	CHORD LENGTH	CHORD BEARING	DELTA ANGLE
C1	110.00'	21.02'	20.99'	N 30°34'35" E	10°58'57"

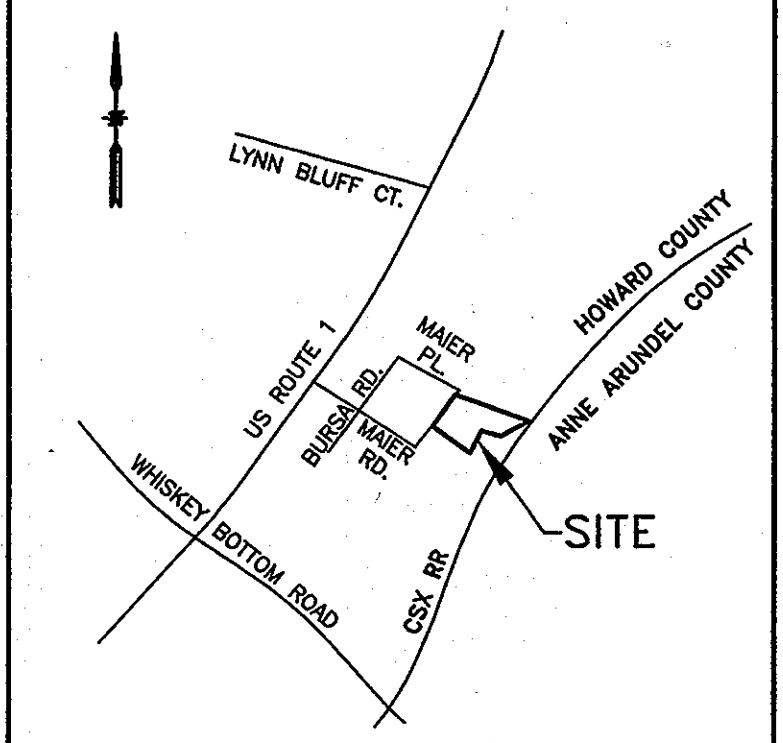

E 1,362,500  
N 529,250

PARCEL C-5  
SECTION ONE  
MAIER INDUSTRIAL PARK  
PLAT NO. 8439

MAIER ROAD  
80' R/W

PARCEL E-2  
SECTION ONE  
MAIER INDUSTRIAL PARK  
PLAT NO. 8439

REVISION PLAT  
SECTION ONE  
MAIER INDUSTRIAL PARK  
PLAT NO. 8439

PARCEL E-1  
70,861 s.f.  
1.6267 ac.

E 1,363,250  
N 529,250

VICINITY MAP

COORDINATES

600	529229.1699	1362723.5926
601	529375.8227	1362830.3413
602	529393.8933	1362841.0181
603	529253.3693	1363230.1407
604	529213.7885	1363144.7699
605	529176.4584	1363079.1213
606	529202.2300	1362976.5000
607	529087.7230	1362917.9142

COORDINATES BASED ON NAD 83/NSRS 2007, MARYLAND COORDINATE SYSTEM, AS PROJECTED BY NGS GEODETIC CONTROL STATIONS J0643 AND J0654.

AREA TABULATION CHART

a. TOTAL NUMBER OF LOTS AND/OR PARCELS TO BE RECORDED	
• BUILDABLE	1
• NON-BUILDABLE	0
• OPEN SPACE	0
• PRESERVATION PARCELS	0
b. TOTAL AREA OF LOTS AND/OR PARCELS	
• BUILDABLE	1.6267 ac.
• NON-BUILDABLE	0
• OPEN SPACE	0
• PRESERVATION PARCELS	0
c. TOTAL AREA OF ROADWAY TO BE RECORDED INCLUDING WIDENING STRIPS	0.00 ac.
d. TOTAL AREA OF SUBDIVISION TO BE RECORDED	1.6267 ac.

NOTES:

1. THE SUBJECT PROPERTY IS ZONED CE-CLI AS PER COMPREHENSIVE ZONING PLAN DATED 02/02/04.
2. NO GRADING, REMOVAL OF VEGETATIVE COVER OR TREES, PAVING AND NEW STRUCTURES SHALL BE PERMITTED WITHIN THE LIMITS OF WETLANDS, STREAMS, OR THEIR REQUIRED BUFFERS, FLOODPLAIN AND FOREST CONSERVATION EASEMENT AREAS.
3. THE FOREST CONSERVATION OBLIGATION OF 0.24 ACRES OF AFFORESTATION FOR THIS PLAN HAS BEEN MET BY FEE-IN-LIEU PAYMENT OF \$7,840.80 (0.24 AC. x 10,454.4 SQ FT. x \$0.75 PER SQ FT.) TO THE HOWARD COUNTY FOREST CONSERVATION FUND, UNDER SDP-09-028.
4. EXISTING PUBLIC WATER CONTRACT NO. 24-1536-D, LITTLE PATUXENT DRAINAGE AREA.
5. EXISTING PUBLIC SEWER CONTRACT NO. 382-A-S, LITTLE PATUXENT DRAINAGE AREA.
6. SUBJECT TO ALL NOTES, CONDITIONS AND RESTRICTIONS AS SHOWN ON "REVISION PLAT, SECTION ONE, MAIER INDUSTRIAL PARK, PARCEL C-5 & PARCELS E-1 THRU E-5" RECORDED AS PLAT NO. 8439.
7. SDP-09-028, MAIER INDUSTRIAL PARK, SECTION 1, PARCEL E-1; OPZ FILE NOS. S-85-17 & P-86-104; F-73-56, P.B. 25, F. 63; F-89-145.
8. THERE IS NO FLOODPLAIN ON THIS SITE.
9. THE UNDERGROUND STORMWATER MANAGEMENT FACILITY IS PRIVATE, UNDER SDP-09-028.
10. THE WETLANDS DELINEATION STUDY FOR THIS PROJECT WAS PREPARED BY MCCARTHY & ASSOCIATES, INC., DATED 9/4/2008 AND WAS APPROVED ON 11/14/2008.
11. THE TRAFFIC STUDY FOR THIS PROJECT WAS PREPARED BY THE TRAFFIC GROUP, DATED 9/26/2008 AND WAS APPROVED ON 11/14/2008.

OWNER:  
SKB, LLC  
12312 CONWAY ROAD  
BELTSVILLE, MARYLAND 20704

THE PURPOSE OF THIS REVISION PLAT IS TO ESTABLISH A PRIVATE INGRESS/EGRESS, ACCESS EASEMENT AND A PUBLIC WATER, SEWER AND UTILITY EASEMENT AS SHOWN HEREON.

LINE TABLE

LINE	LENGTH	BEARING
L1	2.34	N.66°54'09"E.
L2	33.90	N.81°47'00"E.
L3	12.93	S.66°26'03"E.
L4	16.91	S.43°30'22"N.
L5	11.90	S.45°17'02"W.

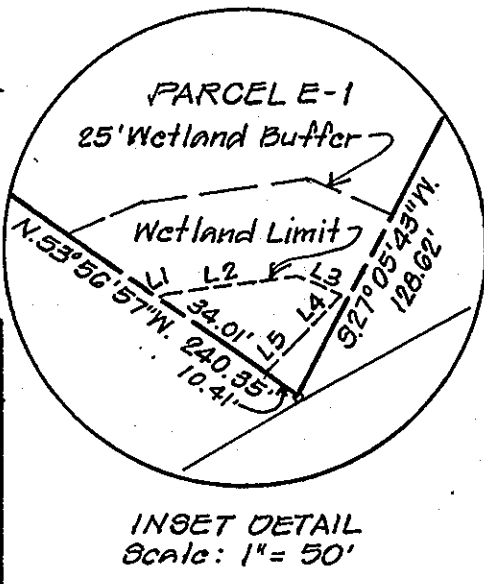

THE REQUIREMENTS OF 3-108, THE REAL PROPERTY ARTICLE, ANNOTATED CODE OF MARYLAND, 1988 REPLACEMENT VOLUME (AS SUPPLEMENTED) AS FAR AS THEY RELATE TO THE MAKING OF THIS PLAT AND THE SETTING OF THE MARKERS HAVE BEEN COMPLIED WITH.

*Steven P. Labuda* 8-21-09  
STEVEN P. LABUDA, SURVEYOR DATE

*Scott Bryan* 8-21-09  
SCOTT BRYAN, SOLE MEMBER DATE

APPROVED: FOR PUBLIC WATER AND PUBLIC SEWERAGE SYSTEMS  
HOWARD COUNTY HEALTH DEPARTMENT

*Bryon P. Steilenson* 9/11/2009  
HOWARD COUNTY HEALTH OFFICER DATE

APPROVED: HOWARD COUNTY DEPARTMENT OF PLANNING AND ZONING.

*Cheryl Hammit* 8/21/09  
CHIEF, DEVELOPMENT ENGINEERING DIVISION DATE

*Cindy Hammit* 9/30/09  
DIRECTOR DATE

SURVEYOR'S CERTIFICATE

I HEREBY CERTIFY THAT THE REVISION PLAT SHOWN HEREON IS CORRECT; THAT IT IS PART OF THE LAND CONVEYED BY DELMARC, LLC, A MARYLAND LIMITED LIABILITY COMPANY TO SKB, LLC, A MARYLAND LIMITED LIABILITY COMPANY, BY DEED DATED DECEMBER 1, 2008 AND RECORDED AMONG THE LAND RECORDS OF HOWARD COUNTY, MARYLAND IN LIBER 11441 AT FOLIO 506; AND ALSO BEING PARCEL E-1 AS SHOWN ON A PLAT OF SUBDIVISION ENTITLED "REVISION PLAT, SECTION ONE, MAIER INDUSTRIAL PARK, PARCELS C-5 & PARCELS E-1 THRU E-5" RECORDED AS PLAT NO. 8439; AND THAT ALL MONUMENTS ARE IN PLACE OR WILL BE IN PLACE IN ACCORDANCE WITH THE ANNOTATED CODE OF MARYLAND, AS AMENDED.

*Steven P. Labuda* 8-21-09  
STEVEN P. LABUDA  
PROPERTY LINE SURVEYOR  
MD REG. NO. 611 DATE

OWNER'S CERTIFICATE

SKB, LLC, OWNERS OF THE PROPERTY SHOWN AND DESCRIBED HEREON, HEREBY ADOPT THIS PLAN OF SUBDIVISION; AND IN CONSIDERATION OF THE APPROVAL OF THIS PLAT BY THE DEPARTMENT OF PLANNING AND ZONING, ESTABLISH THE MINIMUM BUILDING RESTRICTION LINES. ALL EASEMENTS OR RIGHTS OF WAY AFFECTING THE PROPERTY ARE INCLUDED IN THIS PLAN OF SUBDIVISION.

WITNESS MY/OUR HANDS THIS 21<sup>ST</sup> DAY OF August, 2009.

OWNERS:  
SKB, LLC (SEAL)

BY: SCOTT BRYAN, SOLE MEMBER

RECORDED AS PLAT NUMBER 20786 ON 10/21/09  
AMONG THE LAND RECORDS OF HOWARD COUNTY, MARYLAND.

REVISION PLAT  
SECTION ONE  
MAIER INDUSTRIAL PARK  
PARCEL E-1

6TH ELECTION DISTRICT HOWARD COUNTY, MARYLAND  
TAX MAP NO. 47, GRID 23 P/O TM PARCEL 873  
ZONED: CE-CLI  
SCALE: 1"=50' DATE: 4/01/09 SHEET 1 OF 1

GREENMAN-FEDERSEN, INC.  
ENGINEERS, PLANNERS, ARCHITECTS, CONSTRUCTION ENGINEERS & INSPECTORS  
10877 GULFORD ROAD, ANNAPOLIS JUNCTION, MD 20701  
WASH. (301) 470-2772 BALT. (410) 880-3055  
FAX (301) 460-2940 www.gfi.com