

GENERAL NOTES

1. THE LOTS SHOWN HEREON COMPLY WITH MINIMUM OWNERSHIP WIDTH AND LOT AREA AS REQUIRED BY THE MARYLAND STATE DEPARTMENT OF THE ENVIRONMENT.
2. SUBJECT PROPERTY ZONED M-2 PER 10/18/93 COMPREHENSIVE ZONING PLAN.
3. COORDINATES BASED ON NAD '83, MARYLAND COORDINATE SYSTEM AS PROJECTED BY HOWARD COUNTY, GEODETIC CONTROL STATIONS No. 48G4 AND 48G3
 48G4 N 531,519.241 E 1,371,653.842
 48G3 N 532,530.284 E 1,370,623.784
4. THIS PLAT IS BASED ON A FIELD RUN BOUNDARY SURVEY PERFORMED BY FREDERICK WARD ASSOCIATES, INC. IN MARCH 2001.
5. BRL DENOTES BUILDING RESTRICTION LINE.
6. Ⓢ DENOTES REBAR WITH FWA4 CAP SET.
7. Ⓢ DENOTES IRON PIPE OR IRON BAR FOUND.
8. Ⓢ DENOTES ANGULAR CHANGE IN BEARING OF BOUNDARY OR RIGHT-OF-WAY.
9. □ DENOTES STONE OR MONUMENT FOUND.
10. THE AREAS SHOWN HEREON ARE MORE OR LESS.

CURVE TABLE						
CURVE No.	RADIUS	TANGENT	LENGTH	DELTA	CHORD BEARING	CHORD DISTANCE
①	59.01'	58.72'	92.40'	89°43'38"	S 82°34'44"W	83.24'
②	59.00'	40.47'	70.94'	68°53'55"	N 72°09'45"E	66.75'

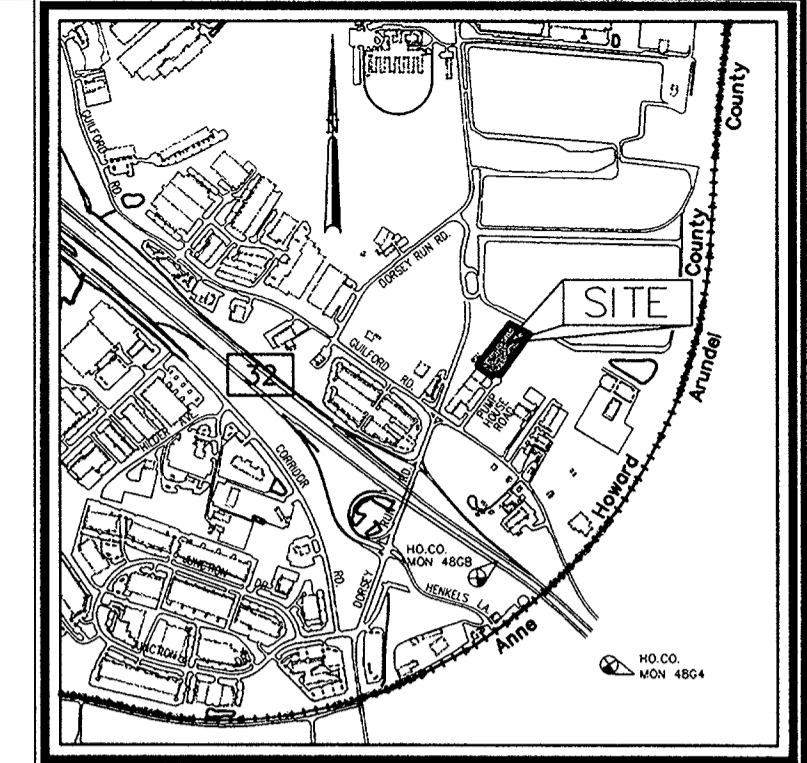

VICINITY MAP
1"=2000'

GRID NORTH - MARYLAND STATE COORDINATE SYSTEM (NAD 83/91)
AS PROJECTED ON PLAT No. 14442

DYNA AU LLC
L.3638 F.208
ZONED M-2
PARCEL 67

TSC/PUMPHOUSE ROAD LLC
L.5378 F.509
PARCEL A-2
AMENDED PLAT ONE
C-W & COMPANY
PLAT No. 14442
ZONED M-2
2.8000 ACRES
(121,969 SQUARE FEET)

PARCEL 128
BOARD OF PUBLIC WORKS OF
STATE OF MARYLAND
DEPARTMENT OF
CORRECTIONAL SERVICES
L.178 F.116
ZONED M-2

BEARING TABLE		
NUMBER	BEARING	DISTANCE
①	N 36°32'17"E	23.01'
②	N 52°59'58"W	4.81'
③	N 07°56'57"W	15.36'
④	N 53°33'52"W	4.51'
⑤	S 36°32'17"W	19.48'

COORDINATES		
No.	NORTH	EAST
51	533594.8926	1371150.7105
52	534005.9637	1371468.3273
53	533900.1801	1371671.6896
61	533452.8837	1371340.3736
69	533488.9773	1371293.7075
70	533499.7287	1371376.2506
84	533543.5633	1371382.5458
86	533527.9157	1371370.9511
87	533530.8078	1371367.1133
88	533546.0235	1371364.9886
89	533751.3609	1371520.0119
90	533763.9498	1371503.3367
91	533779.9118	1371515.3872
92	533755.2722	1371548.0246
93	533540.8873	1371386.1707

THE REQUIREMENTS § 3-108, THE REAL PROPERTY ARTICLE, ANNOTATED CODE OF MARYLAND, 1988 REPLACEMENT VOLUME, (AS SUPPLEMENTED) AS FAR AS THEY RELATE TO THE MAKING OF THIS PLAT BEEN COMPLIED WITH.

Joseph Jay Woodbridge 12/20/01
JOSEPH JAY WOODBRIDGE, PROF LS #11027 DATE
S. Bruce Jaffe 01/03/02
S. BRUCE JAFFE, MEMBER DATE
TSC/PUMPHOUSE ROAD LLC

NOTE: THE PURPOSE OF THIS PLAT IS TO ESTABLISH A 20 FOOT PUBLIC WATER AND UTILITY EASEMENT.

OWNER/DEVELOPER
TSC/PUMPHOUSE ROAD LLC
S. BRUCE JAFFE, MEMBER
11628 LOG JUMP TRAIL
ELLCOTT CITY, MARYLAND 21042

FREDERICK WARD ASSOCIATES, INC.
ENGINEERS 7125 Riverwood Drive Columbia, Maryland 21046-2354
ARCHITECTS Phone: 410-720-6900 or 410-209-9550 Fax: 410-720-6226
SURVEYORS Bel Air, Maryland Warrenton, Virginia

SYSTEMS IN CONFORMANCE WITH THE MASTER PLAN FOR HOWARD COUNTY, FOR PUBLIC WATER AND PUBLIC SEWERAGE.

Penny Borenstein M.D. 1/28/02
HOWARD COUNTY HEALTH OFFICER DATE

APPROVED: HOWARD COUNTY DEPARTMENT OF PLANNING AND ZONING

Chris Primm 1/22/02
CHIEF, DEVELOPMENT ENGINEERING DIVISION DATE

James H. H. H. 2/14/02
DIRECTOR DATE

OWNER'S CERTIFICATE

WE, TSC/PUMPHOUSE ROAD, LLC, OWNERS OF THE PROPERTY SHOWN AND DESCRIBED HEREON, ADOPT THIS FINAL PLAT OF SUBDIVISION, AND IN CONSIDERATION OF THE APPROVAL OF THIS FINAL PLAT BY THE DEPARTMENT OF PLANNING AND ZONING, ESTABLISH THE MINIMUM BUILDING RESTRICTION LINES AND GRANT UNTO HOWARD COUNTY, MARYLAND, ITS SUCCESSORS AND ASSIGNS; 1) THE RIGHT TO LAY, CONSTRUCT AND MAINTAIN SEWERS, DRAINS, WATER PIPES AND OTHER MUNICIPAL UTILITIES AND SERVICES IN AND UNDER ALL ROADS OR STREET RIGHTS-OF-WAYS AND THE SPECIFIC EASEMENT AREAS SHOWN HEREON; 2) THE RIGHT TO REQUIRE DEDICATION OF WATERWAYS AND DRAINAGE EASEMENTS FOR THE SPECIFIC PURPOSE OF THEIR CONSTRUCTION, REPAIR AND MAINTENANCE; 3) THAT NO BUILDING OR SIMILAR STRUCTURE OF ANY KIND SHALL BE ERRECTED ON OR OVER THE SAID EASEMENTS AND RIGHTS-OF-WAYS. WITNESS OUR HANDS THIS DAY OF , 2000.

S. Bruce Jaffe 01/03/02 DATE
S. BRUCE JAFFE, MEMBER
TSC/PUMPHOUSE ROAD, LLC

Megan C. Ruggieri WITNESS

SURVEYOR'S CERTIFICATE

I HEREBY CERTIFY THAT THE FINAL PLAT SHOWN HEREON IS CORRECT; THAT IT IS A RESUBDIVISION OF THE LAND CONVEYED BY C-W & COMPANY AND TSC/PUMPHOUSE ROAD, LLC, BY DEED DATED FEBRUARY 28, 2001 AND RECORDED IN LIBER 5378 AT FOLIO 509 OF THE LAND RECORDS OF HOWARD COUNTY, MARYLAND.

Joseph Jay Woodbridge 12/20/01
JOSEPH JAY WOODBRIDGE, PROFESSIONAL LAND SURVEYOR #11027 DATE

RECORDED AS PLAT No. 15212 ON 2/7/02
AMONG THE LAND RECORDS OF HOWARD COUNTY, MARYLAND.

PLAT OF REVISION
C-W AND COMPANY
PARCEL A-2

ZONED M-2
TAX MAP No. 48 GRID:14 P/O PARCEL No. 68
6TH ELECTION DISTRICT
HOWARD COUNTY, MARYLAND
DECEMBER 27, 2001

GRAPHIC SCALE
50' 0 50' 100' 150'

SCALE: 1" = 50' SHEET No. 1 OF 1
F-00-177