

7061

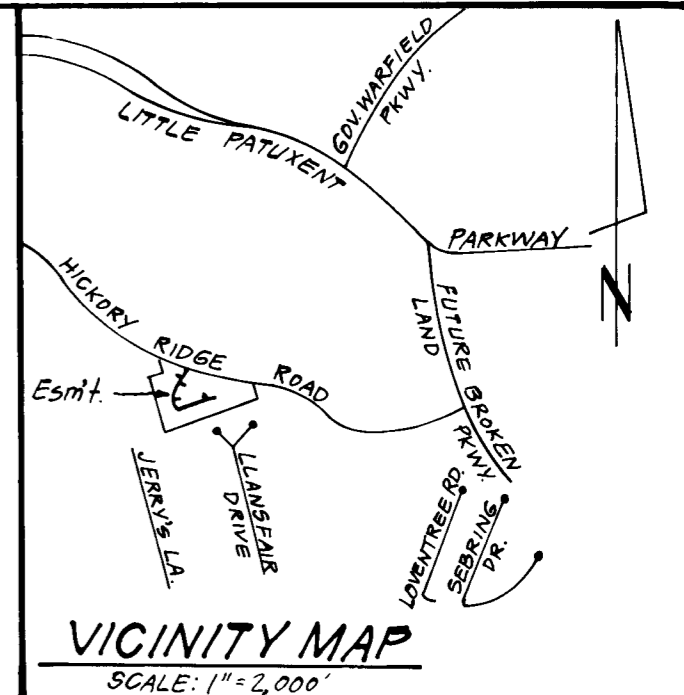

LOT 4
VILLAGE OF HICKORY RIDGE
SECTION 1 AREA 6
PLAT 4242

LOT 3 OPEN SPACE
VILLAGE OF HICKORY RIDGE
SECTION 5 AREA 2
PLAT _____

PARCEL "A"
VILLAGE OF HICKORY RIDGE
SECTION 5 AREA 2
PLAT _____

The undersigned owner of the property shown on this plat grants unto Howard County, Maryland, its successors and assigns the right to lay, construct and maintain water pipes, water house connections and utilities in and through the specific easement area and roads shown hereon. Where specific lots shall be burdened with the right of way shown hereon, it is agreed that no buildings or similar structures of any kind shall be erected in, on or over the said right of way by the grantor its successors and assigns, or Howard County, Maryland. The right to use additional strips or parcels of land adjacent, contiguous and parallel to all easement areas as shown on the plat are hereby granted unto Howard County, Maryland during the period of original construction only.

[Signature] Witness
[Signature] Samuel M. [unclear] Authorized Agent
8/24/85 Date

[Signature]
2/4/87

**PLAT FOR GRANT OF EASEMENT FOR
WATER, WATER HOUSE CONNECTIONS
AND UTILITIES
TO HOWARD CO. MARYLAND
COLUMBIA**

VILLAGE OF HICKORY RIDGE
SECTION 5 AREA 2
PARCEL "A"
5TH ELECTION DISTRICT
HOWARD COUNTY, MARYLAND

SCALE: 1"=50' AUGUST, 1985

EASEMENTS AND RIGHTS-OF-WAY APPROVED AND ACCEPTED BY
HOWARD COUNTY DEPARTMENT OF PUBLIC WORKS
BY: *[Signature]* Chief Bureau of Engineering
Department of Public Works Contract No. 44-1373-D
RECORDED IN PLAT ON AMONG THE
LAND RECORDS OF HOWARD COUNTY, MARYLAND.

Professional Land Surveyor
[Signature]
(By) Donald B. Sackett Reg. No. 6053
Clark, Finefrock & Sackett
11315 Lockwood Drive, Silver Spring, Md. 20904
Aug. 7, 1985
Date

