

COORDINATE SCHEDULE		
POINT	NORTH	EAST
1	468882.263	845740.273
2	469505.567	846187.951
3	469542.195	846232.866
4	469605.042	846352.510
5	469465.279	846562.007
6	468806.597	845909.599
7	468700.532	845907.254

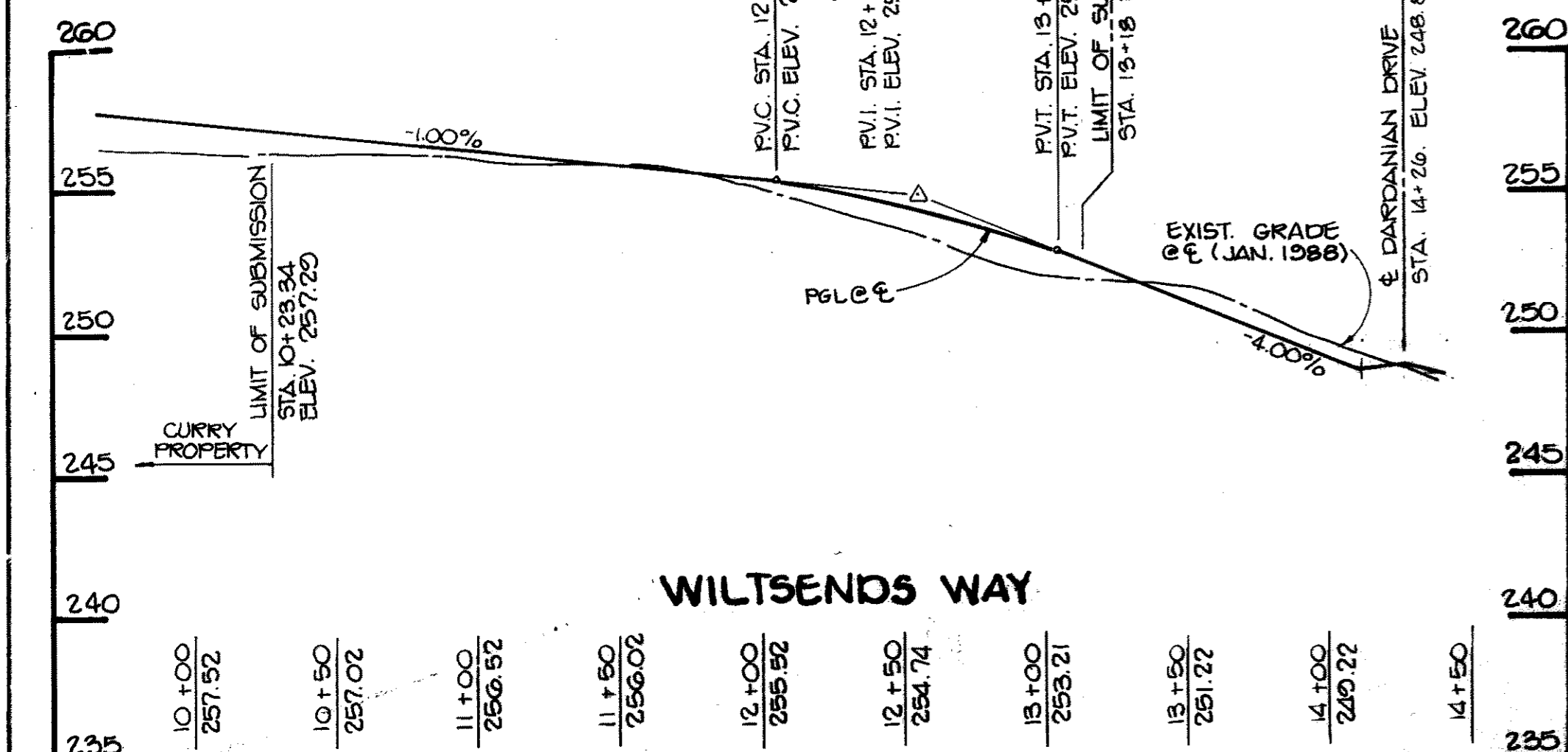

PROFILE
SCALE: HORIZ: 1"=50'
VERT: 1"=5'

DENSITY TABULATION	
1. GROSS AREA - SECTION-1	6.064 AC.
2. FLOODPLAIN	0.000 AC.
3. STEEP SLOPES	0.000 AC.
4. NET AREA	6.064 AC.
5. NO. OF D.U. ALLOWED (BASED ON NET AREA)	24,260 D.U.
6. TOTAL NO. OF D.U. PROPOSED	23,000 D.U.
7. DENSITY PER ACRE	3.790
8. OPEN SPACE REQUIRED PROVIDED	205 OR 1.210

OPEN SPACE TABULATION	
OPEN SPACE REQUIRED	1.210 AC.
DRY GROUND RECREATIONAL USE REQUIRED	0.610
STEEP SLOPES	0.000 AC.
SWMF	0.330 AC.
FLOODPLAIN	0.000 AC.
OPEN SPACE PROVIDED	1.210 AC.
TOTAL DRY GROUND OPEN SPACE PROVIDED	0.880 AC. OR 73%

SITE TABULATION	
EXISTING ZONING	R5C
GROSS AREA OF TRACT	6.064 AC.
AREA OF PROPOSED LOTS	4.84 AC.
AREA OF PROPOSED ROADS	1.22 AC.
NUMBER OF LOTS	23
BUILDABLE OPEN SPACE	2

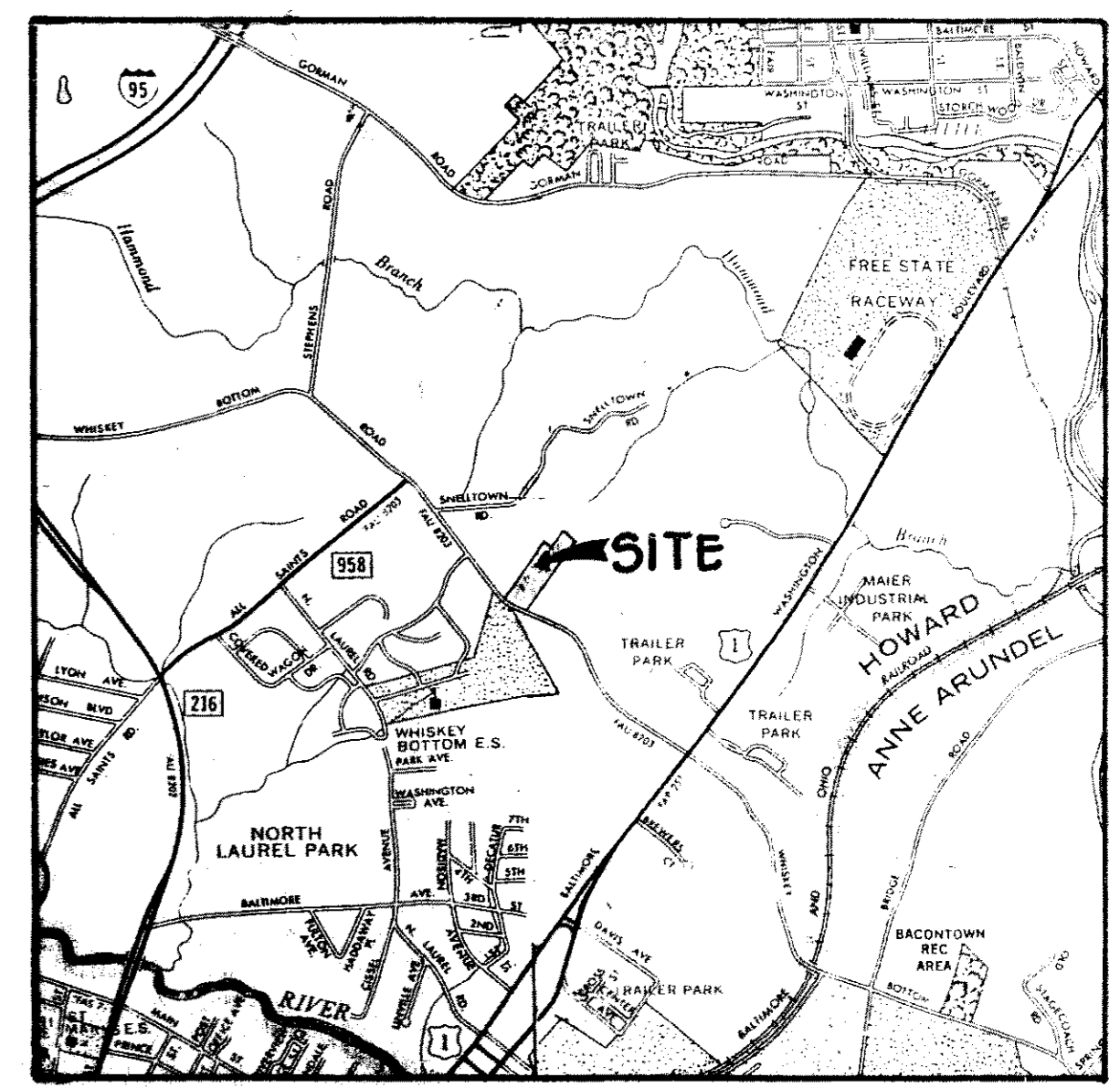

VICINITY MAP
SCALE: 1"=2000'

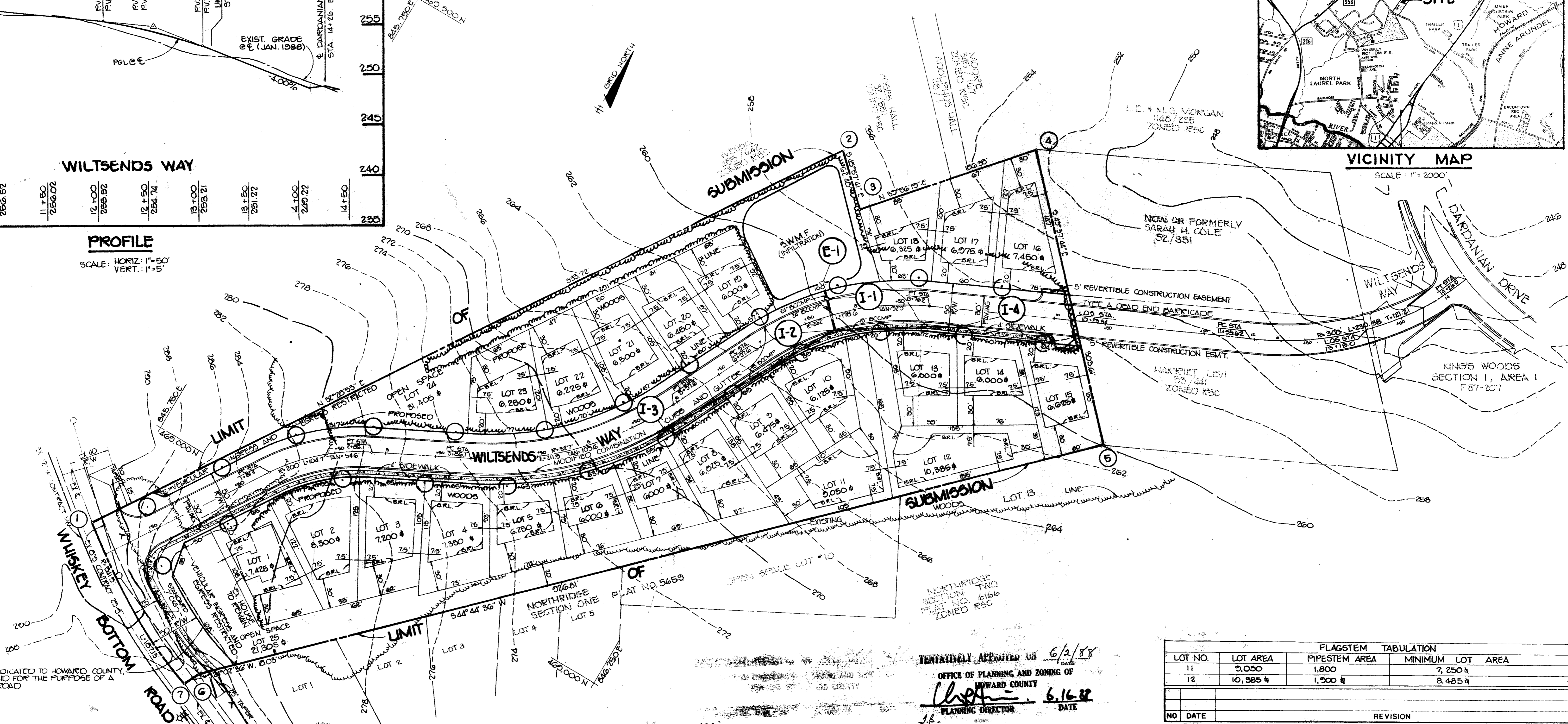

LAND DEDICATED TO HOWARD COUNTY, MARYLAND FOR THE PURPOSE OF A PUBLIC ROAD

TENTATIVELY APPROVED ON 6/2/88
OFFICE OF PLANNING AND ZONING OF HOWARD COUNTY
PLANNING DIRECTOR
DATE 6.16.88

FLAGSTEM TABULATION			
LOT NO.	LOT AREA	PIPESTEM AREA	MINIMUM LOT AREA
11	9,050	1,800	7,250
12	10,385	1,900	8,485

GENERAL NOTES

- PUBLIC WATER AND SANITARY SEWER EXTENSIONS SHALL BE MADE FOR THIS DEVELOPMENT.
- ROADWAYS SHALL BE IN ACCORDANCE WITH THE "HOWARD COUNTY DESIGN MANUAL - VOLUME III".
- STORM WATER MANAGEMENT AND SEDIMENT CONTROL SHALL BE PROVIDED FOR THIS DEVELOPMENT.
- STREET LIGHTS WILL BE PROVIDED IN ACCORDANCE WITH THE "HOWARD COUNTY DESIGN MANUAL".
- EXISTING ZONING R5C
- INDICATES STREET TREES

TRACY, SCHULTE & ASSOCIATES INC.
planning • architecture • engineering
8480 Baltimore National Pike • Ellicott City, Maryland 21043 • (301) 465-6105

Tracy Schulte

OWNER KENNETH A. CURRY & JEANNE H. CURRY 3440 WHISKEY BOTTOM ROAD LAUREL, MARYLAND 20707	PROJECT CURRY PROPERTY 87/304
DEVELOPER KENNETH A. CURRY & JEANNE H. CURRY 3440 WHISKEY BOTTOM ROAD LAUREL, MARYLAND 20707	LOCATION TAX MAP NO. 47 PARCEL NO. 173 6TH ELECTION DISTRICT HOWARD COUNTY, MARYLAND
TITLE PRELIMINARY PLAN	DATE MARCH 3, 1988
DES. SUB DRN KMN/JCA	PROJECT NO 0073
SCALE 1"=50'	DRAWING OF