

**GENERAL NOTES**

1. ALL PROPERTIES SHOWN HEREON ARE ZONED "R".
2. THIS AREA DESIGNATES A PRIVATE SEWAGE EASEMENT (MIN. 10,000<sup>gpd</sup>) AS REQUIRED BY THE MARYLAND STATE DEPARTMENT OF HEALTH AND MENTAL HYGIENE FOR INDIVIDUAL SEWAGE DISPOSAL IMPROVEMENTS OF ANY NATURE IN THIS AREA ARE RESTRICTED UNTIL PUBLIC CONNECTION IS AVAILABLE. THESE EASEMENTS SHALL BECOME NULL AND VOID UPON CONNECTION TO A PUBLIC SEWAGE SYSTEM. THE COUNTY HEALTH OFFICER SHALL HAVE THE AUTHORITY TO GRANT VARIANCES FOR ENCROACHMENTS INTO THE PRIVATE SEWAGE EASEMENT. RECORDATION OF A MODIFIED SEWAGE EASEMENT SHALL NOT BE NECESSARY.
3. THE LOTS SHOWN HEREON COMPLY WITH THE MINIMUM OWNERSHIP WIDTH AND LOT AREA AS REQUIRED BY THE MARYLAND STATE DEPARTMENT OF HEALTH AND MENTAL HYGIENE.
4. FOR FLAG OR PIPE STEM LOTS, REFUSE COLLECTION, SNOW REMOVAL, AND ROAD MAINTENANCE ARE PROVIDED TO THE JUNCTION OF THE FLAG OR PIPE STEM LOT DRIVEWAY.
5. SEE DA-86-04, VP 87-121, 587-17
6. TABULATION
 

TOTAL NUMBER OF LOTS	28
TOTAL AREA OF LOTS	84.3 AC.
TOTAL AREA OF PUBLIC ROADWAY	3.9 AC.
TOTAL AREA OF GOLF COURSE LOT	11.1 AC.
TOTAL AREA OF SUBDIVISION	109.3 AC.
7. PRIVATE WATER & SEWER SERVICE TO BE USED BY ALL LOTS.
8. TITLE DEED: 1561/713, 1686/624
9. SYMBOLS
 

	DESIGNATES 100 YEAR FLOOD PLAIN ELEVATION.
	DESIGNATES SUCCESSFUL PERC TEST.
	DESIGNATES FAILED PERC TEST.
	DESIGNATES WELL.

**PERCOLATION TEST RESULTS**

LOT No. (THIS PLAN)	PREVIOUS LOT No.	MEAN TIME (MIN.)	INLET DEPTH
1	1	5	3.0'
2	2	6	3.5'
3	3	5	3.5'
4	4	9	4.5'
5	5	10	4.5'
6	6	11	4.5'
7	7	10	4.5'
8	8	7	3.5'
9	9	15	3.0'
10	10	7	3.5'
11	11	9	3.0'
12	12	5	3.0'
13	13	11	3.0'
14	14	10	3.5'
15	15	5	4.0'
16	16	5	4.0'
17	17	6	3.0'
19	19	5	3.5'
20	20	3	3.0'
21	21	4	3.5'
22	22	8	3.0'
23	23	8	3.5'
24	24	5	3.5'
25	25	8	3.0'
26	26	5	3.0'
27	27	18	3.5'
28	28	9	4.0'
18	CLUBHOUSE	8	4.0'

**SHANABERGER & LANE**  
 8726 TOWN & COUNTRY BLVD.  
 SUITE 203  
 ELLICOTT CITY, MD 21043  
 (301) 461-9563



**PRELIMINARY PLAN**  
**WILLOW SPRINGS**  
 TAX MAP 9, PARCELS 151 & TAX MAP 15, PARCELS 11, 145  
 ZONING MAP 9 & 15, 3<sup>rd</sup> ELECTION DISTRICT  
 HOWARD COUNTY, MARYLAND

TENTATIVELY APPROVED ON Dec. 8, 1987  
 DATE  
 OFFICE OF PLANNING AND ZONING OF  
 HOWARD COUNTY  
  
 PLANNING DIRECTOR 3.9.88  
 DATE com

OWNER & DEVELOPER:  
 WILLOW SPRINGS I LIMITED  
 PARTNERSHIP  
 RES: 16801 WESLEY CHAPEL RD.  
 MOUNTON, MD 21111  
 (301) 347-8722

APPROVED:  
 FOR PRIVATE WATER & PRIVATE SEWER & SYSTEMS.  
 HOWARD COUNTY HEALTH DEPARTMENT.  
  
 COUNTY HEALTH OFFICER 1-29-88  
 DATE

SCALE: 1" = 200'  
**SHEET 1**  
**OF 4**



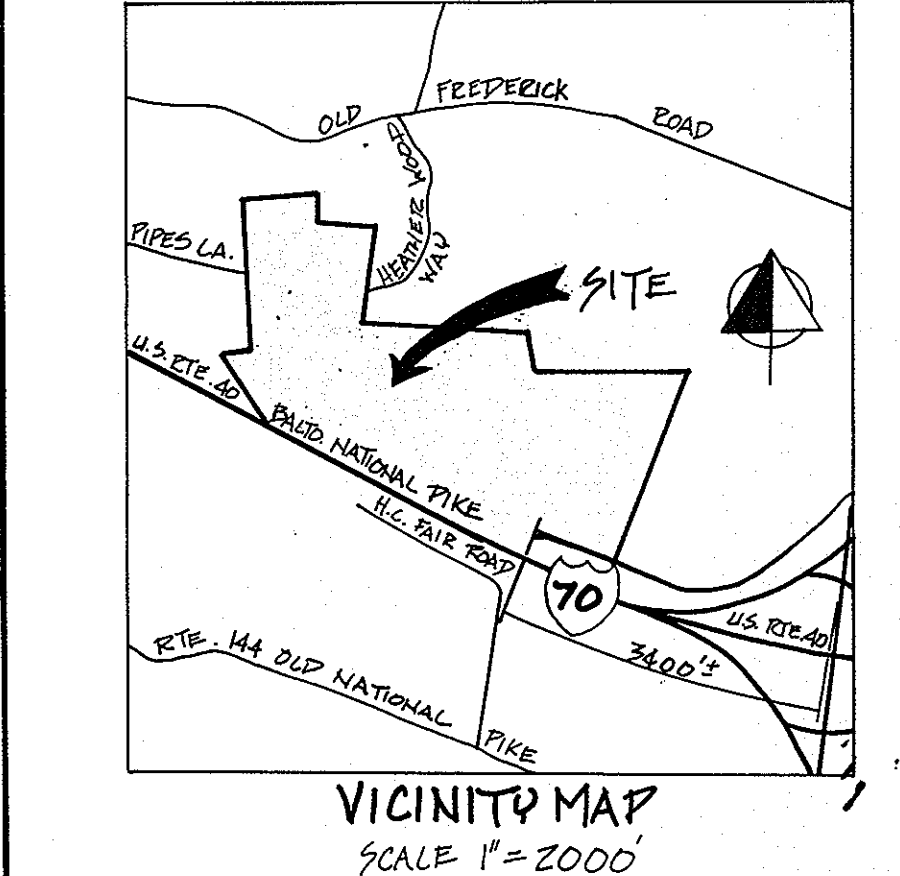



TENTATIVELY APPROVED ON Dec. 8, 1987  
 DATE  
 OFFICE OF PLANNING AND ZONING OF  
 HOWARD COUNTY  
  
 PLANNING DIRECTOR  
 DATE 3.9.88  
 COM

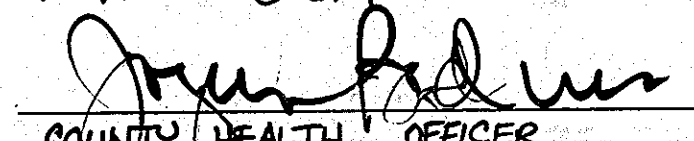

**NOTES:**  
 1. NO PAVED PATHWAYS ARE PROPOSED WITHIN THE GOLF COURSE.  
 2. DESIGN SPEED FOR PIPES LANE, HEATHERWOOD WAY, AND WILLOW SPRINGS DRIVE IS 30 M.P.H.

I - 70  
 (R/W VARIES)  
 SEE SRC PLAT # 42586

APPROVED: FOR PRIVATE WATER & PRIVATE SEWER & SYSTEMS. HOWARD COUNTY HEALTH DEPARTMENT.  COUNTY HEALTH OFFICER DATE <u>1-28-88</u>	<b>SHANABERGER &amp; LANE</b> 8726 TOWN & COUNTRY BLVD. SUITE 203 ELLICOTT CITY, MARYLAND 21043 (301) 461-9563		<table border="1"> <tr> <td>DESIGNED</td> <td>CHS</td> <td>(1) PER COUNTY COMMENTS</td> <td>10/1/87</td> </tr> <tr> <td>DRAWN</td> <td>KS</td> <td>PER COUNTY COMMENTS</td> <td>12/14/87</td> </tr> <tr> <td>CHECKED</td> <td>TE, LC</td> <td></td> <td></td> </tr> <tr> <td>DATE</td> <td></td> <td></td> <td></td> </tr> <tr> <td>BY NO.</td> <td></td> <td>REVISION</td> <td>DATE</td> </tr> </table>	DESIGNED	CHS	(1) PER COUNTY COMMENTS	10/1/87	DRAWN	KS	PER COUNTY COMMENTS	12/14/87	CHECKED	TE, LC			DATE				BY NO.		REVISION	DATE	OWNER & DEVELOPER: WILLOW SPRINGS I LIMITED PARTNERSHIP RES 10801 WESLEY CHAPEL RD MONKTON, MD 21111 (301) 347-8722	PRELIMINARY PLAN <b>WILLOW SPRINGS</b> TAX MAP 9, PARCEL 151; TAX MAP 15, PARCELS 11, 145 ZONING MAP 9-15, 3RD ELECTION DISTRICT HOWARD COUNTY, MARYLAND, 5-5-87	SCALE: 1" = 100' SHEET 2 OF 4
DESIGNED	CHS	(1) PER COUNTY COMMENTS	10/1/87																							
DRAWN	KS	PER COUNTY COMMENTS	12/14/87																							
CHECKED	TE, LC																									
DATE																										
BY NO.		REVISION	DATE																							



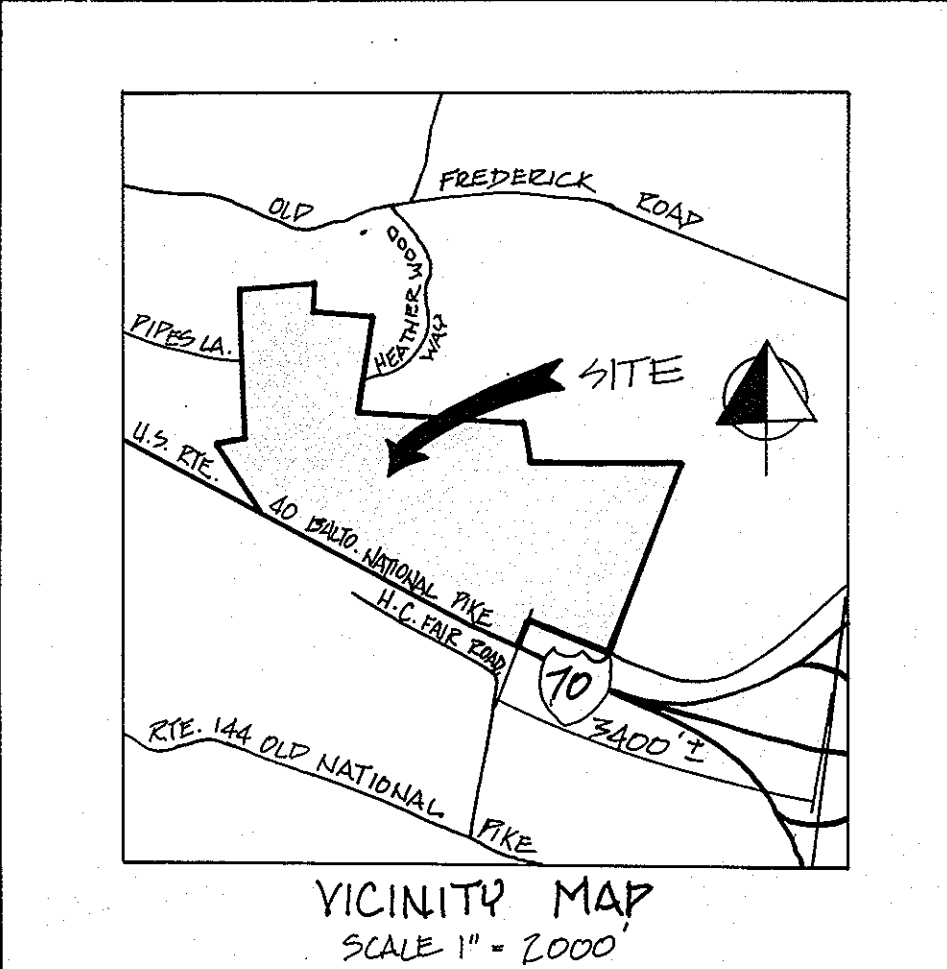

RHINE JR.  
1362/515

WILSON  
PROPERTY  
PLAT  
3797

HEATHERWOOD  
PLAT  
4401

- NOTES:
1. NO PAVED PATHWAYS ARE PROPOSED WITHIN THE GOLF COURSE.
  2. DESIGN SPEED FOR PINES LANE, HEATHERWOOD WAY, AND WILLOW SPRINGS DRIVE IS 30 M.P.H.

I-70 (RW VARIES)  
SEE SRC PLATS 42585, 42586, 43143, 43144, 44702

TERMINALLY APPROVED ON Dec 8 1987  
DATE  
OFFICE OF PLANNING AND ZONING OF  
HOWARD COUNTY  
*Ulster*  
PLANNING DIRECTOR  
3.9.88  
DATE com

APPROVED:  
FOR PRIVATE WATER & PRIVATE SEWER & SYSTEMS.  
HOWARD COUNTY HEALTH DEPARTMENT.  
*James Parker*  
COUNTY HEALTH OFFICER  
1-28-88  
DATE

SHANABERGER & LANE  
8726 TOWN& COUNTRY BLVD.  
SUITE 203  
ELICOTT CITY, MARYLAND 21043  
(301) 461-9563

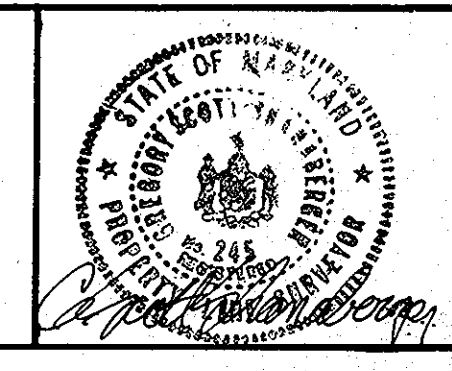

DESIGNED	GSS	DATE	10/1/87
DRAWN	TE	DATE	12/14/87
CHECKED	GSS	DATE	6/2/87
DATE	6/2/87	BY NO.	
REVISION		DATE	

OWNER & DEVELOPER:  
WILLOW SPRINGS I LIMITED  
PARTNERSHIP  
RES 16801 WESLEY CHAPEL RD.  
MONKTON, MD. 21111  
(301) 347-8722

PRELIMINARY PLAN  
WILLOW SPRINGS  
TAX MAP 9, PARCEL 151; TAX MAP 15, PARCELS 11, 145  
ZONING MAP 9 & 15, 3RD ELECTION DISTRICT  
HOWARD COUNTY, MARYLAND, 5-5-87

SCALE: 1" = 100'  
SHEET 3  
OF 4



