

**CURVE DATA**

NO.	RADIUS	Δ	ARC	TAN	CHORD	BEARING
1-2	690.00	32°50'26"	395.50	293.35	390.10	N 54°44'54"W
3-4	690.00	26°56'20"	324.42	165.27	321.44	N 84°38'17"W
5-6	690.00	19°46'00"	165.82	83.31	165.42	S 75°00'10"W
7-8	610.00	21°51'50"	264.54	134.38	262.47	S 84°31'51"W
9-10	690.00	24°16'22"	292.31	148.38	298.13	S 83°50'35"W
11-12	610.00	25°23'15"	270.29	137.48	268.08	S 81°23'32"W
13-14	2540.00	09°48'53"	435.10	218.48	434.57	S 89°18'42"W
15-16	2460.00	01°51'52"	48.05	40.03	80.05	S 85°12'12"W
17-18	2460.00	02°36'45"	112.17	56.09	112.16	S 87°26'31"W
19-20	1593.05	06°45'52"	177.47	88.04	177.30	S 87°52'18"W
21-22	2440.00	02°31'00"	350.94	182.71	350.94	S 84°31'00"W
30-31	1160.00	07°10'00"	145.10	72.64	145.00	S 89°55'46"E
32-33	2225.00	03°48'00"	147.57	73.81	147.54	S 85°35'14"E
34-35	1640.00	12°58'00"	371.15	186.37	370.36	S 89°49'46"E
36-37	780.00	22°22'00"	350.94	182.71	350.94	S 84°31'00"W
38-39	860.00	23°39'00"	354.98	180.06	352.47	S 82°06'44"E
40-41	780.00	12°41'32"	172.78	86.75	172.43	S 87°35'28"E
44-45	358.00	18°33'00"	64.97	32.58	64.87	S 81°06'15"E
46-47	375.00	35°00'00"	229.07	118.24	225.53	S 83°55'19"E
48-49	425.00	22°22'10"	165.93	84.03	164.88	S 89°45'46"E
51-52	800.00	19°30'19"	272.34	137.50	271.03	S 86°28'01"W
53-54	630.00	24°40'52"	189.42	94.72	189.42	S 84°31'00"W
55-56	620.00	07°34'40"	82.00	41.86	81.94	N 25°19'39"W
57-58	680.00	18°03'06"	119.30	59.89	119.14	N 34°09'32"W
59-60	580.00	17°07'07"	73.75	36.92	73.75	N 42°48'38"W
67-68	690.00	08°18'13"	198.08	58.09	195.91	S 39°56'40"E

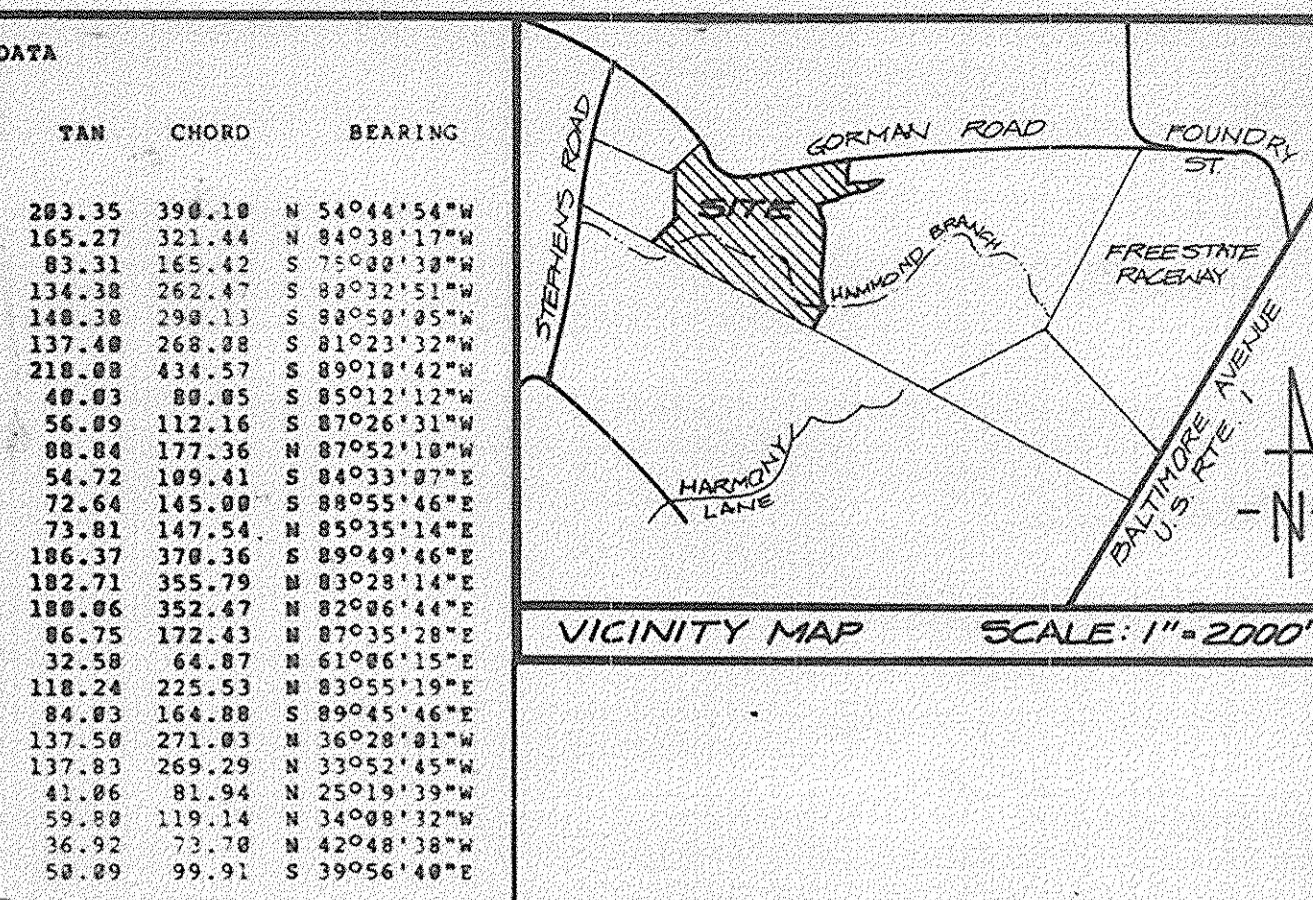

**COORDINATE TABLE**

NO.	NORTH	EAST	NO.	NORTH	EAST
1	73589.38	45892.15	35	73511.24	49885.41
2	73284.15	45418.72	36	73525.25	47965.78
3	73287.31	45468.10	37	73484.79	47612.38
4	73237.27	45788.13	38	73443.69	47497.61
5	73201.65	46091.69	39	73395.32	47148.47
6	73324.44	46251.47	40	73423.45	46739.87
7	73392.69	46421.23	41	73416.20	46567.59
8	73401.78	46488.13	42	73407.54	46504.26
9	73498.41	47205.94	43	72994.20	46749.26
10	73454.63	47492.36	44	72999.31	47800.57
11	73594.56	47628.44	45	72967.96	47823.77
12	73584.69	47895.51	46	72864.41	48746.51
13	73533.88	48366.78	47	72840.53	48562.24
14	73540.11	48471.31	48	72864.29	48444.62
15	73581.93	48599.53	49	72884.97	48279.75
16	73558.18	48849.18	50	72877.85	48244.83
17	73585.20	49076.93	51	72855.11	48257.57
18	73591.21	49188.98	52	72837.15	48418.66
19	73597.82	49275.82	53	72824.78	48431.55
20	73598.18	49547.76	54	72801.22	48581.67
21	73587.67	49625.54	55	72743.92	48643.75
22	73529.29	49714.09	56	72689.86	48678.08
23	73518.48	49819.76	57	72642.57	48626.28
24	73517.48	49846.87	58	72642.46	48633.57
25	73573.11	49859.18	59	72615.34	48771.83
26	73582.72	49868.18	60	72615.34	48771.83
27	73594.92	49861.32	61	72627.48	48822.91
28	73563.86	49851.42	62	72530.61	48990.26
29	73588.58	49847.76	63	72632.34	49143.69
30	73591.65	49849.13	64	72648.48	49175.80
31	73594.25	49865.16	65	72713.43	49485.93
32	73586.78	49849.61	66	73078.35	49790.50
33	73575.43	49845.43	67	73446.46	49756.86
34	73518.19	48455.76	68	73509.36	49509.91
			69	73529.30	49212.15

**SITE ANALYSIS:**

- Zoned . . . . . RSC
- Number of Units Proposed . . . . . 418
- Area Tabulation:  
 Lots J-1 thru K-6 and J-1 thru J-132 . . . . . 19.42 Acres  
 Public Roads . . . . . 18.43 Acres  
 Open Space Provided (16 Lots) . . . . . 35.15 Acres  
 Total . . . . . 56.88 Acres
- Parking Required (198 Units) . . . . . 396.88 Spaces
- Parking Provided . . . . . 399.89 Spaces
- Gross Area . . . . . 56.88 Acres

**GENERAL NOTES:**

- Topography was compiled from aerial topography.
- The area included in this submission is located on Tax Map 47.
- Installation of traffic control devices shall be in accordance with the latest edition of the manual of uniform control devices.
- Public water and sewer to be utilized.
- Sediment and erosion control measures to be provided with the submission of the Road Construction and Site Development Plans.
- All utilities shown as existing were compiled from available records and field survey.
- See Soils Map No. 34.
- Street trees shall be provided in accordance with Section 16.111 of the Howard County subdivision regulations.
- See Office of Planning and Zoning files: PB 196, S-86-57
- Final density computations to be based on final plan.
- 100-year flood plain elevations taken from Plat 86397.
- Sketch Plan approved per Planning Board Case No. 196.

**DENSITY TABULATION**

RSA-B ZONE	TOTAL	A	B	C	D	E	G	H	I
1. PARCEL AREA	77.5	15.6	19.8	8.6	10.9	8.1	2.1	1.3	11.9
2. OPEN SPACE AREA ALLOCATED	9.3	0.1	3.4	8.4	0.8	0.0	0.0	0.0	0.0
3. NET AREA	86.8	15.7	22.4	9.0	15.7	8.1	2.1	1.3	12.9
4. UNITS PERMITTED BASED ON NET AREA	694.4	125.6	179.2	72.8	125.6	64.8	16.8	10.4	132.0
5. FLOODPLAIN LOT ADJUSTMENT	81.6	14.6	21.1	8.4	14.7	7.5	2.2	1.2	11.9
6. MAXIMUM UNITS PERMITTED	776.0	140.2	200.3	88.4	148.3	72.3	19.0	11.6	111.9
7. UNITS PROPOSED	773.0	140.0	200.0	88.0	148.0	72.0	19.0	11.0	111.0

RSC ZONE	TOTAL	A	F	G	H	J	K	L
1. PARCEL AREA	64.6	1.4	6.8	18.3	1.8	20.0	12.1	10.9
2. OPEN SPACE AREA ALLOCATED	27.5	0.9	2.8	7.9	8.7	9.6	2.5	3.0
3. NET AREA	92.1	4.3	8.0	18.2	2.4	29.6	14.8	13.9
4. UNITS PERMITTED BASED ON NET AREA	368.4	17.2	35.2	72.8	19.8	118.4	59.2	55.6
5. FLOODPLAIN LOT ADJUSTMENT	42.3	2.0	4.0	8.4	1.1	13.6	6.8	6.4
6. MAXIMUM UNITS PERMITTED	410.7	19.2	39.2	81.2	11.1	132.0	66.8	62.0
7. UNITS PROPOSED	410.0	19.0	39.0	81.0	11.0	132.0	66.8	62.0

OWNER: GORMAN ROAD LIMITED PARTNERSHIP  
 40 JAMES F. KNOTT DEVELOPMENT CRP  
 110 WEST ROAD, SUITE 203  
 TOWSON, MARYLAND 21284  
 (301) 321-6436

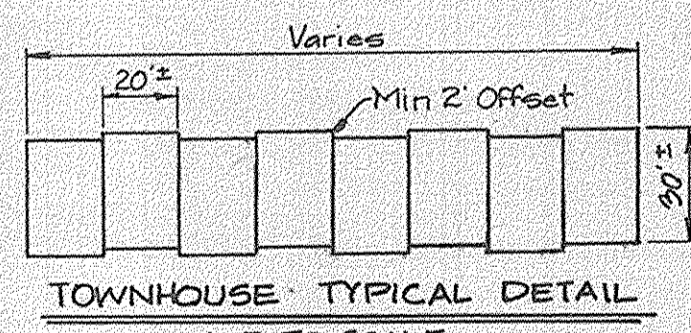

**SITE ANALYSIS**

	RSA-B	RSC	Total
1. Zone			
2. Gross Area	182.22	195.81	288.0
3. Floodplain	18.62	11.72	22.3
4. Steep Slopes (25%+)	4.82	2.02	7.8
5. Net Area	86.82	92.1	178.7
6. Units Permitted based on Net Area	694.4	368.8	1,063.2
7. Floodplain Lot Adjustment	81.6	42.3	124.1
8. Maximum Units Permitted	776	410	1,186
9. Units Proposed	774	410	1,184
10. Density Per Acre Proposed	7.59	3.88	5.69

NO.	DESCRIPTION	DATE	APPROVED	DATE

REVISION APPROVED BY: \_\_\_\_\_

**PRELIMINARY PLAN**  
 PARCEL K, LOTS K-1 THROUGH K-68  
 PARCEL J, LOTS J-1 THROUGH J-132  
 OPEN SPACE LOTS II-15

**Patton Harris Rust and Associates**  
 A Professional Corporation  
 Engineers, Surveyors, Planners and Landscape Architects  
 7609 Stardish Place, Rockville, Md. 20855 (301) 762-2220

**HAMMONDS LANDING**  
 LOT 2 PARCELS J, K & LOTS II-15  
 TAX MAP 47  
 SIXTH ELECTION DISTRICT PARCEL I41  
 HOWARD CO., MARYLAND

SURVEY	DATE
DESIGN	7/86
DRAWN PA, KU	SHEET
CHECKED	1 OF 1
SCALE 1" = 100'	FILE NO.
CL. 2"	2184-1-D