

PERCOLATION TEST DATA

LOT NUMBER	PREVIOUS LOT NUMBER	AVERAGE PERC. TIME IN MINUTES PER SECOND INCH	MAX. DEPTH PERMITTED FOR EFFLUENT PIPE TO ENTER SEWAGE DISPOSAL AREA AT ITS HIGHEST ELEVATION WITH REFERENCE TO EXISTING GRADE AT TIME OF PERCOLATION TEST
1	N/A	2.5 MIN.	3.5 FT.
2	N/A	2.1 MIN.	3.5 FT.
3	5A	14 MIN.	3.5 FT.
4	5B	20 MIN.	4 FT.
5	6D	9 MIN.	3.5 FT.
6	25C	9 MIN.	3.5 FT.
7	26C	12 MIN.	3 FT.
8	22C	16 MIN.	3.5 FT.
9	N/A	9 MIN.	3 FT.
10	1A	8 MIN.	3 FT.
11	3A	9 MIN.	3 FT.
12	4A	8 MIN.	3 FT.
13	CA	14 MIN.	4 FT.
14	4B	12 MIN.	3 FT.
15	N/A	6 MIN.	3.5 FT.
16	N/A	2 MIN.	4 FT.
17	13C	5 MIN.	3 FT.
18	11C	14 MIN.	3.5 FT.
19	7C	3 MIN.	5.0 FT.
20	5C	11 MIN.	4.5 FT.
21	2B	17 MIN.	4 FT.
22	5C	16 MIN.	3 FT.
23	1C	11 MIN.	3.5 FT.

APPROVED FOR PRIVATE WATER AND PRIVATE SEWERAGE SYSTEMS
HOWARD COUNTY HEALTH DEPARTMENT.

Joyce M. Payne
COUNTY HEALTH OFFICER

10-30-85
DATE

CLYDE H. BROWN & WIFE
275/335

ZONED 'R'

N 51° 27' 05" E
E 201' 00" 1.06

C.H. BROWN
164/335

ZONED 'R'

FISHER, COLLINS & CARTER, INC.
CONSULTING ENGINEERS AND LAND SURVEYORS
8388 COURT AVENUE
ELLCOTT CITY, MARYLAND 21043

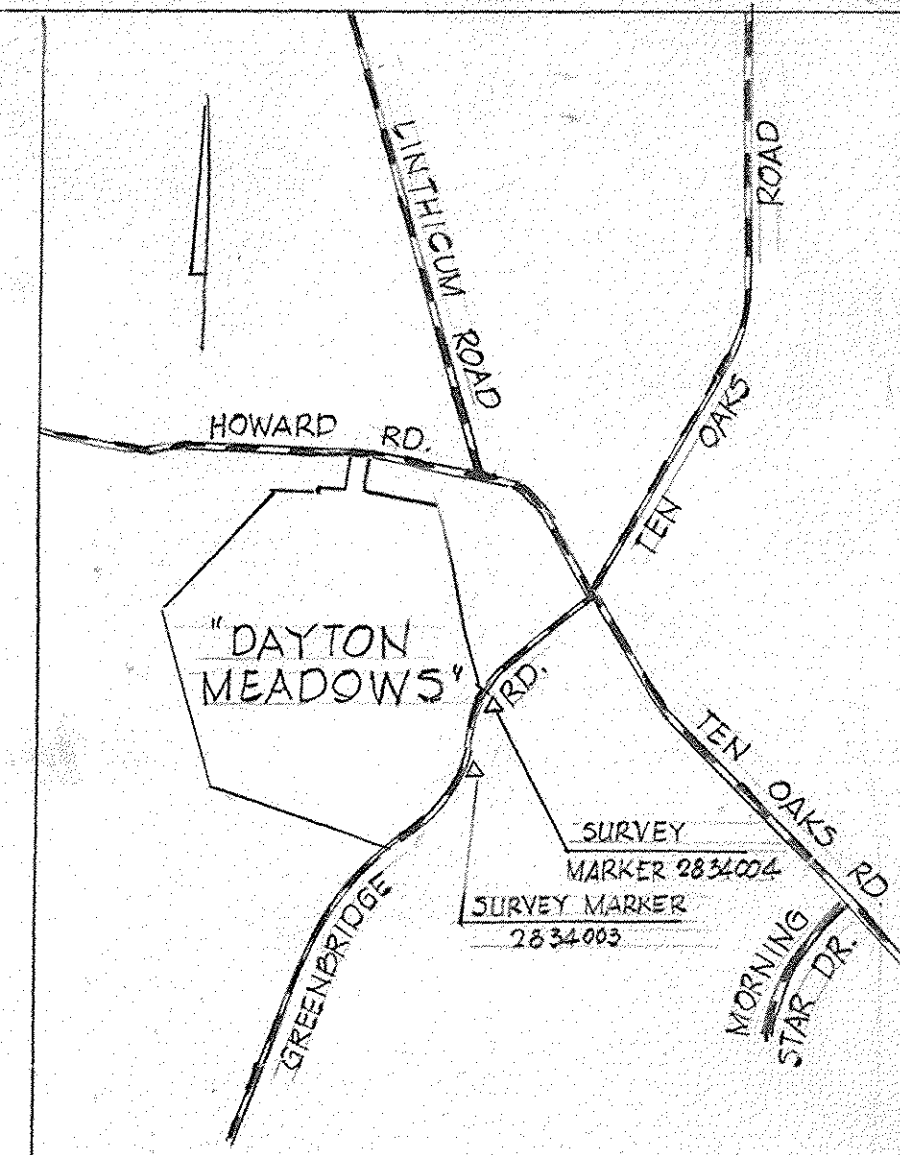

VICINITY MAP
SCALE: 1"=1200'

GENERAL NOTES

- TOTAL AREA = 77.623 AC.
- PRESENT ZONING = R (RURAL)
- NUMBER OF LOTS = 23
- PRIVATE WATER AND SEWER TO BE UTILIZED.
- DEED REFERENCE: 462/717
- AREA OF LOTS: 75.4 AC.
- AREA OF PROPOSED ROADS: 2.2 AC.
- COORDINATES SHOWN HEREON ARE REFERENCED TO THE MARYLAND STATE GRID SYSTEM.
- THIS AREA DESIGNATES A PRIVATE SEWAGE EASEMENT OF 10,000 SQ. FT. AS REQUIRED BY THE MARYLAND STATE DEPT. OF HEALTH AND MENTAL HYGIENE FOR INDIVIDUAL SEWAGE DISPOSAL.
- 10.0 - DENOTES PROP. WELL LOCATION.

OWNER:
WILLIAM C. MITCHEL, ETAL
56 CARMAN ASSOCIATES
P.O. BOX 122
ELLCOTT CITY, MARYLAND 21043

DEVELOPER:
CARMAN ASSOCIATES
P.O. BOX 122
ELLCOTT CITY, MARYLAND 21043

TENTATIVELY APPROVED ON Aug 2, 1985

OFFICE OF PLANNING AND ZONING OF
HOWARD COUNTY
Thomas J. Davis
PLANNING DIRECTOR 12-9-85
DATE

PRELIMINARY PLAN
DAYTON MEADOWS

5TH. ELECTION DIST. - HOWARD COUNTY, MD.
SCALE: 1"=100' JUNE 25, 1985

TAX MAP 28, PARCEL 14
PREVIOUS SUBMISSIONS: 579-20
P79-23
F79-126
385-42