

GENERAL NOTES

1. TOTAL AREA OF PROPERTY 26,091 AC.
2. PRESENT ZONING: RSA
3. PROPOSED USE: GARDEN APARTMENTS
4. DENSITY COMPUTATIONS:
  - A. GROSS AREA 26,091 AC.
  - B. AREA WITHIN FLOOD PLAIN AND SLOPES EXCEEDING 25% 3.5 AC.
  - C. NET AREA 22,591 AC.
  - D. GROSS ACREAGE x 8 = 208 UNITS
  - E. 10% FLOOD PLAIN LOT ADJUSTMENT = 20 UNITS
  - F. NET AREA x 8 = 180 UNITS
  - G. ALLOCABLE DENSITY 180 ÷ 20 = 200 UNITS
  - H. NUMBER OF UNITS SHOWN = 200 UNITS
  - I. NUMBER OF 2 BR. UNITS = 124
  - J. NUMBER OF 1 BR. UNITS = 76

5. PUBLIC WATER AND SEWER TO BE UTILIZED.  
 6. TITLE INFORMATION: PROPERTY OF: HOWARD HILLS GENERAL PARTNERSHIP - LIBER. 1144, FOLIO 221

7. PARKING DATA:  
 1. NUMBER OF SPACES REQ'D. 200 DWELLING UNITS x 1.5 = 300  
 2. NUMBER OF SPACES PROVIDED = 327

8. OPEN SPACE TO BE DEDICATED TO HOWARD CO. = 14.0 AC.  
 9. OPEN SPACE REQUIRED = 20% x 26,091 = 5,222 AC.  
 10. LOT COVERAGE FOR STRUCTURES = 7%  
 11. AREA WITHIN PUBLIC ROAD R/W = 1.2 AC.

OWNER AND DEVELOPER  
 HOWARD HILLS GENERAL PARTNERSHIP  
 8230 BALTIMORE STREET  
 SAVAGE, MARYLAND 20865

PREPARED BY:  
 FISHER, COLLINS & CARTER, INC.  
 CONSULTING ENGINEERS & LAND SURVEYORS  
 8388 COURT AVENUE  
 BELLGATE CITY, MARYLAND 21043  
 410-2855

PRELIMINARY PLAN  
**AUTUMN WOODS**  
 SIXTH ELECTION DISTRICT  
 HOWARD COUNTY, MARYLAND  
 SCALE: 1" = 50' MAY 16, 1984  
 TAX MAP 47 PARCEL 493

FRANCIS FLOGGER ET AL  
 224/258  
 ZONED R-12

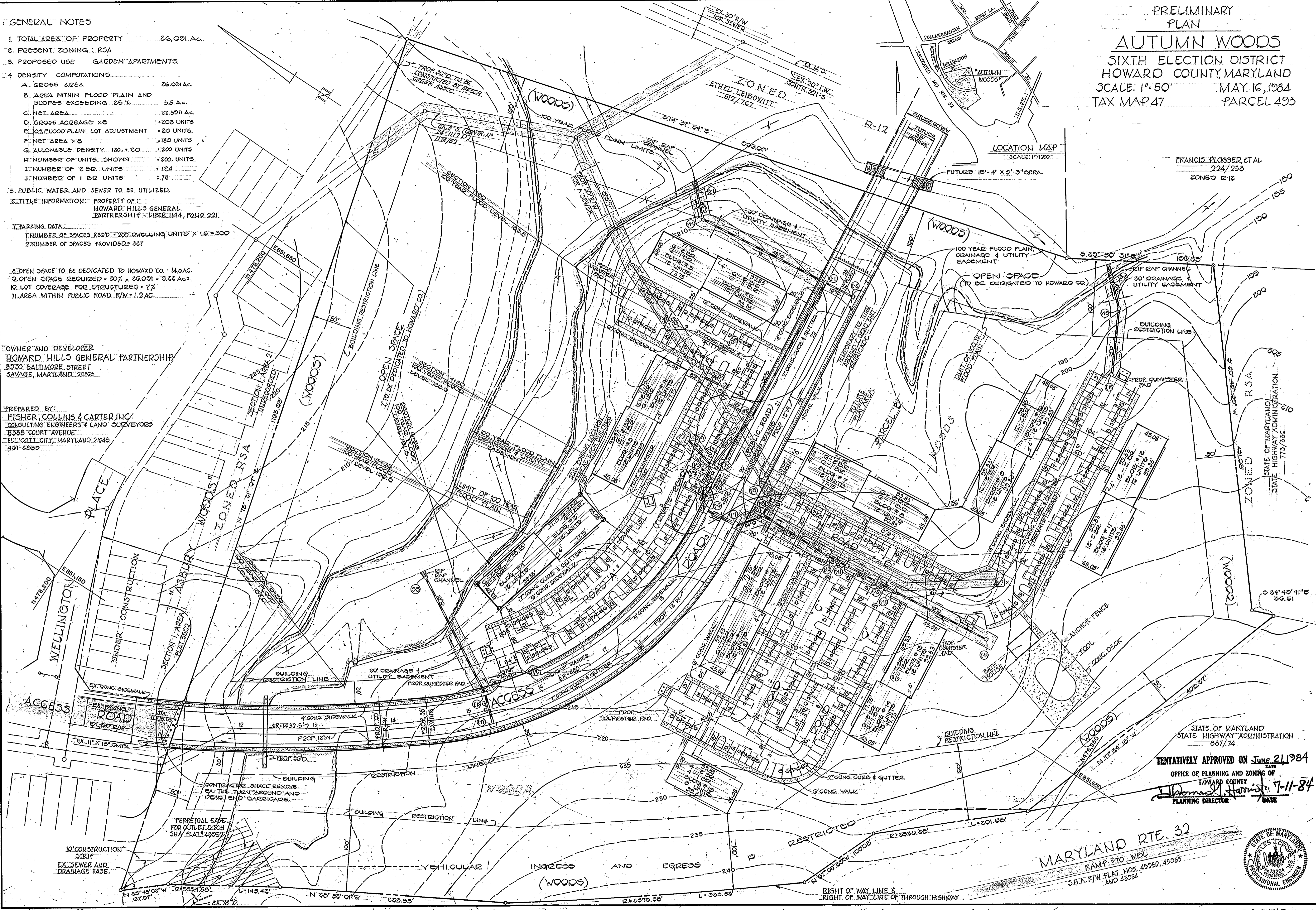

STATE OF MARYLAND  
 STATE HIGHWAY ADMINISTRATION  
 687/74  
**TENTATIVELY APPROVED ON JUNE 21, 1984**  
 OFFICE OF PLANNING AND ZONING OF  
 HOWARD COUNTY  
*James Harris* 7-11-84  
 PLANNING DIRECTOR DATE

MARYLAND RTE. 32  
 RAMP TO WBL  
 S.H.A. R/W PLAT NOS. 45052, 45055  
 AND 45054

