

VICINITY MAP
SCALE: 1" = 2000'

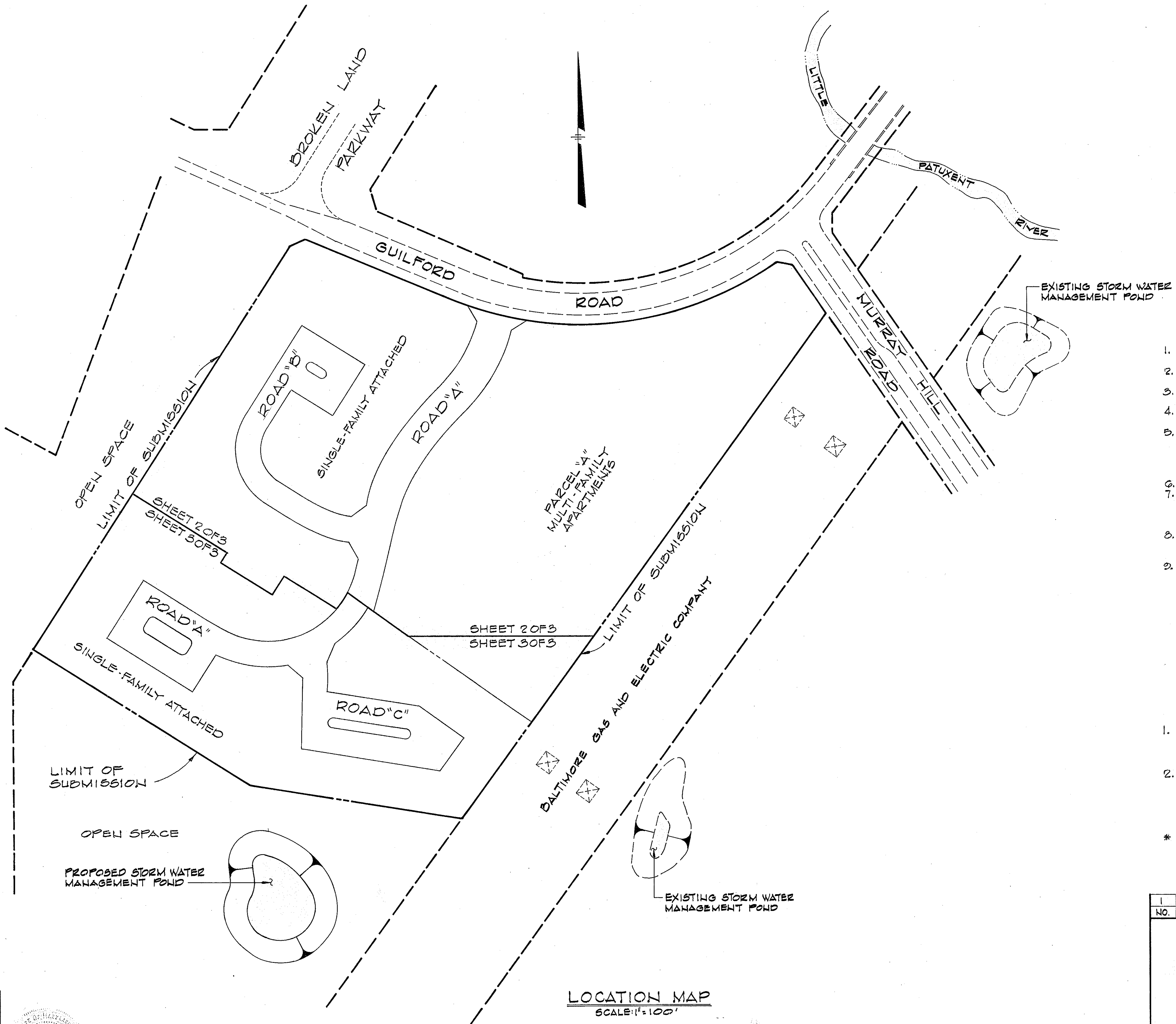

GENERAL NOTES

1. Zoning - New Town (Single Family Attached and Apartments).
2. Topography taken from aerial topo prepared by Maps, Incorporated.
3. Public water and sewer systems to be made available and utilized.
4. All building restriction lines shall be in accordance with Final Development Plan Criteria Phase 100A Part II.
5. The lots or parcels shown on these plans are subject to the supplemental sewer in-kind-of construction charge created by Section 20.31A of the Howard County Code, and the Executive Order No. 72-9.
6. All sidewalks shall be 4' wide unless otherwise shown.
7. Standard Symbols:
 - Proposed Headwalls - Proposed Pipes
 - Proposed Inlets - Proposed Concrete
 - Proposed Manholes - Sidewalks
 - Proposed Monholes - Sidewalks
8. Sediment and erosion control measures to be determined with the submission of Site Development Plan and Road Construction Drawings.
9. See S-83-03 and V.P.-83-23.

TENTATIVELY APPROVED ON Dec. 27 1982

OFFICE OF PLANNING AND ZONING OF
HOWARD COUNTY
Armanah Family 1-7-83
PLANNING DIRECTOR DATE

LOT AND AREA DATA

1. Total Number of Lots (Including Parcels) - 105
 - Single Family Attached Lots - 104*
 - Apartment Parcel - 1
2. Total Area - 23.2 Ac.
 - Area of Roads - 3.8 Ac.
 - Area of Single Family Attached Lots - 10.3 Ac.
 - Area of Apartment Parcel - 0.1 Ac.

* includes 4 Community Owned Lots

NO.	DATE	DESCRIPTION OF REVISION
1	1/4/83	As per Planning and DPW Comments

COLUMBIA
VILLAGE OF KINGS CONTRIVANCE
SECTION 3 AREA 2
PARCEL 'A' AND LOTS B-1 THRU B-104
PRELIMINARY PLAN
6TH ELECTION DISTRICT
OF HOWARD COUNTY MARYLAND
OWNERS AND DEVELOPERS
05-32 CORPORATION AND THE HOWARD RESEARCH
AND DEVELOPMENT CORPORATION
THE ROUSE BUILDING, COLUMBIA, MARYLAND 21044
TAX MAP NO. 42 PARCEL 300 SHEET 1 OF 3
DATE: DECEMBER 1, 1982 SCALE: AS SHOWN

LOCATION MAP
SCALE: 1" = 100'

WHITMAN, REQUARDT & ASSOCIATES
ENGINEERS
2915 ST. PAUL STREET
BALTIMORE, MARYLAND 21215
Kenneth A. McCord
KENNETH A. MCCORD P.E. NO. 1074



LEGEND

- 320 Existing Contour (5' Interval)
- Ⓟ Building Group Number
- ⑦ Number of Dwellings in Group
- B-16 Lot Number
- ▨ Concrete Walk
- ▭ Travelled Way (To Be Publicly Maintained)

NOTE:
THERE ARE NO 100 YEAR
FLOOD PLAINS ON OR ADJACENT
TO ANY OF THE SUBJECT LOTS
OR PARCEL SHOWN ON THIS PLAN

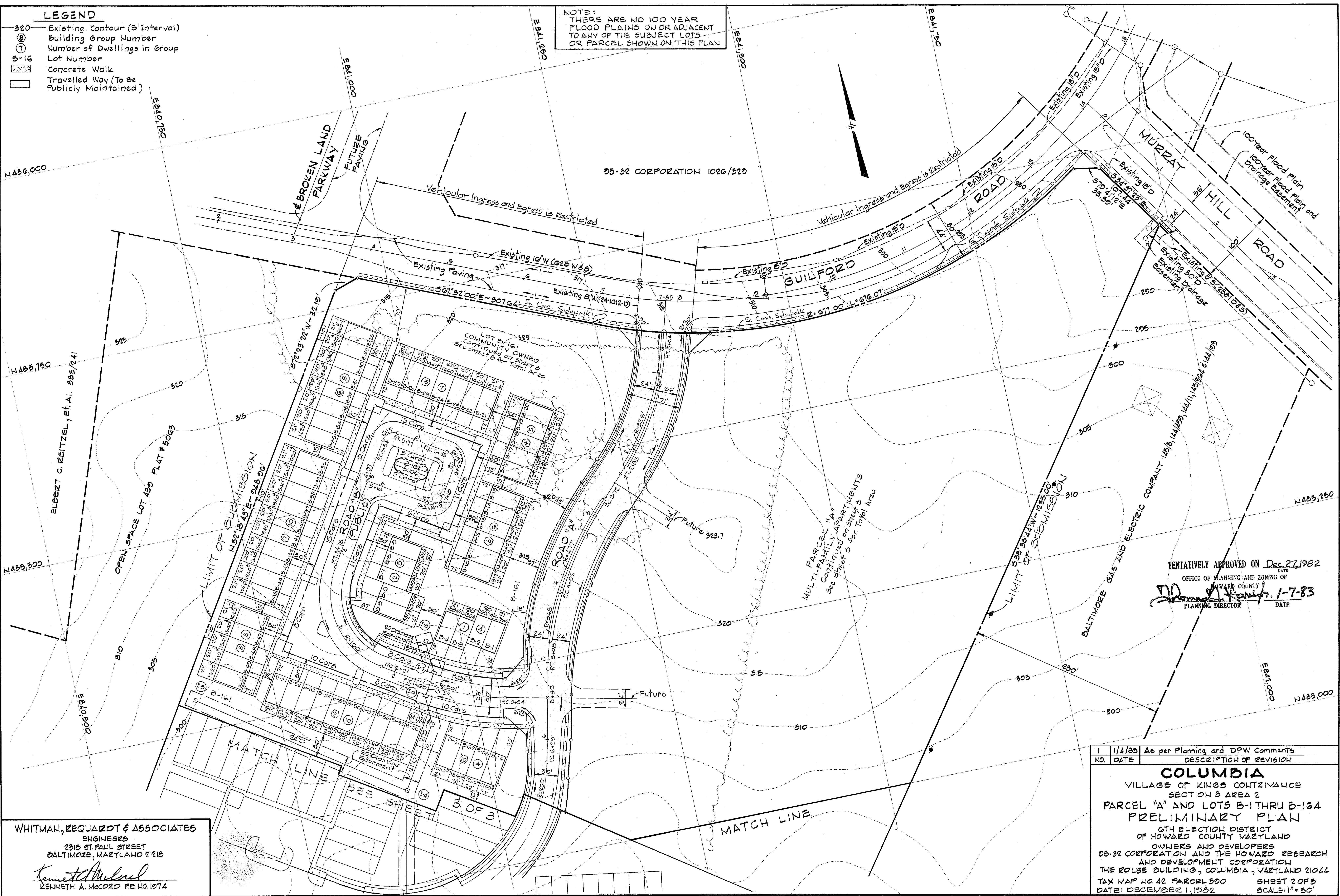

TENTATIVELY APPROVED ON Dec. 27, 1982
DATE
OFFICE OF PLANNING AND ZONING OF
HOWARD COUNTY
Thomas A. Hamilton 1-7-83
PLANNING DIRECTOR DATE

NO.	DATE	DESCRIPTION OF REVISION
1	1/4/83	As per Planning and DPW Comments

COLUMBIA
VILLAGE OF KINGS CONTRIVANCE
SECTION 3 AREA 2
PARCEL "A" AND LOTS B-1 THRU B-164
PRELIMINARY PLAN
6TH ELECTION DISTRICT
OF HOWARD COUNTY MARYLAND
OWNERS AND DEVELOPERS
05-32 CORPORATION AND THE HOWARD RESEARCH
AND DEVELOPMENT CORPORATION
THE ROUSE BUILDING, COLUMBIA, MARYLAND 21044
TAX MAP NO. 42 PARCEL 300 SHEET 2 OF 3
DATE: DECEMBER 1, 1982 SCALE: 1" = 50'

WHITMAN, REQUARDT & ASSOCIATES
ENGINEERS
2315 ST. PAUL STREET
BALTIMORE, MARYLAND 21218
Kenneth A. McCord
KENNETH A. MCCORD PE NO. 1074



- LEGEND**
- 320 — Existing Contour (5' Interval)
 - ⊙ Building Group Number
 - ⑦ Number of Dwellings in Group
 - B-16 Lot Number
 - ▨ Concrete Walk
 - ▭ Travelled Way (To Be Publicly Maintained)

TENTATIVELY APPROVED ON Dec. 27, 1982
 OFFICE OF PLANNING AND ZONING OF
 HOWARD COUNTY
Thomas J. Hurnst 1-7-83
 PLANNING DIRECTOR DATE

NO.	DATE	DESCRIPTION OF REVISION
1	1/4/83	As per Planning and DPW Comments

COLUMBIA
 VILLAGE OF KINGS CONTRIVANCE
 SECTION 3 AREA 2
 PARCEL "A" AND LOTS B-1 THRU B-164
 PRELIMINARY PLAN
 6TH ELECTION DISTRICT
 OF HOWARD COUNTY MARYLAND
 OWNERS AND DEVELOPERS
 95-32 CORPORATION AND THE HOWARD RESEARCH
 AND DEVELOPMENT CORPORATION
 THE ROUSE BUILDING, COLUMBIA, MARYLAND 21044
 TAX MAP NO. 42 PARCEL 300 SHEET 3 OF 3
 DATE: DECEMBER 1, 1982 SCALE: 1" = 50'

WHITMAN, REQUARDT & ASSOCIATES
 ENGINEERS
 2315 ST. PAUL STREET
 BALTIMORE, MARYLAND 21216
Kenneth A. McCord
 KENNETH A. MCCORD P.E. NO. 1074