

VICINITY MAP

SCALE: 1" = 2000'

TABULATION OF LAND USE

LAND USE	ACRES
EMPLOYMENT CENTER-INDUSTRIAL	41.4
ROADWAY	2.3
OPEN SPACE	41.3
CREDITED	
TOTAL	82.7

R-20
Preston Kennels, Inc.
450/268

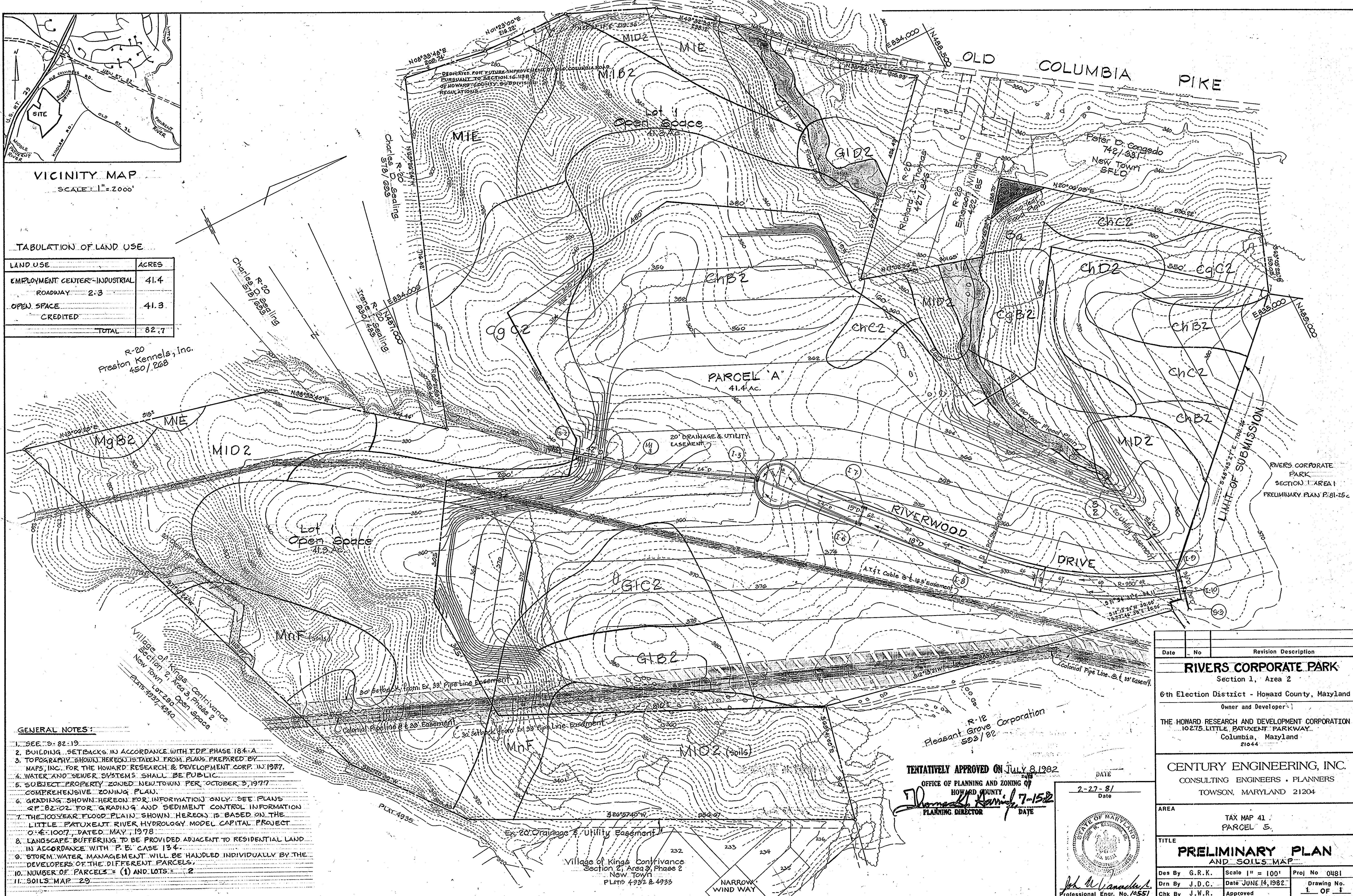

RIVERS CORPORATE PARK
SECTION 1, AREA 1
PRELIMINARY PLAN P-81-25

GENERAL NOTES:

- SEE P-82-19
- BUILDING SETBACKS IN ACCORDANCE WITH FDP PHASE 184-A
- TOPOGRAPHY SHOWN HEREON IS TAKEN FROM PLANS PREPARED BY MAPS, INC. FOR THE HOWARD RESEARCH & DEVELOPMENT CORP. IN 1977.
- WATER AND SEWER SYSTEMS SHALL BE PUBLIC.
- SUBJECT PROPERTY ZONED NEW TOWN PER OCTOBER 3, 1977 COMPREHENSIVE ZONING PLAN.
- GRADING SHOWN HEREON FOR INFORMATION ONLY. SEE PLANS P-82-02 FOR GRADING AND SEDIMENT CONTROL INFORMATION.
- THE 100-YEAR FLOOD PLAIN SHOWN HEREON IS BASED ON THE LITTLE PATUXENT RIVER HYDROLOGY MODEL CAPITAL PROJECT O-4-1007, DATED MAY, 1978.
- LANDSCAPE BUFFERING TO BE PROVIDED ADJACENT TO RESIDENTIAL LAND IN ACCORDANCE WITH P.E. CASE 134.
- STORM WATER MANAGEMENT WILL BE HANDLED INDIVIDUALLY BY THE DEVELOPERS OF THE DIFFERENT PARCELS.
- NUMBER OF PARCELS = (1) AND LOTS = 2
- SOILS MAP 29

TENTATIVELY APPROVED ON JULY 8, 1982

OFFICE OF PLANNING AND ZONING OF
HOWARD COUNTY
PLANNING DIRECTOR

DATE

2-27-81
Date

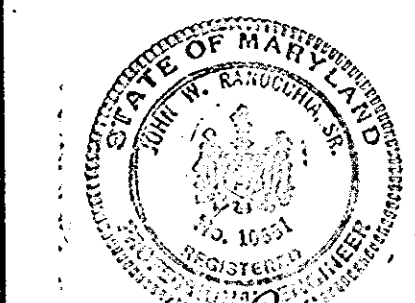

John W. Vanacker
Professional Engr. No. 10551

Date	No	Revision Description
RIVERS CORPORATE PARK		
Section 1, Area 2		
6th Election District - Howard County, Maryland		
Owner and Developer:		
THE HOWARD RESEARCH AND DEVELOPMENT CORPORATION 10275 LITTLE PATUXENT PARKWAY Columbia, Maryland 21044		
CENTURY ENGINEERING, INC. CONSULTING ENGINEERS - PLANNERS TOWSON, MARYLAND 21204		
AREA	TAX MAP 41 PARCEL 5	
TITLE	PRELIMINARY PLAN AND SOILS MAP	
Des By	G.R.K.	Scale 1" = 100' Proj No 0481
Drn By	J.D.C.	Date JUNE 14, 1982 Drawing No.
Chk By	J.W.R.	Approved 1 OF 1