

LEGEND:

1. Contour Interval: 2 Ft.
2. Existing Contour
3. Proposed Storm Drainage
4. Existing Sewer Line
5. Building Restriction Line: B.R.L.
6. Typical Townhouse Unit:

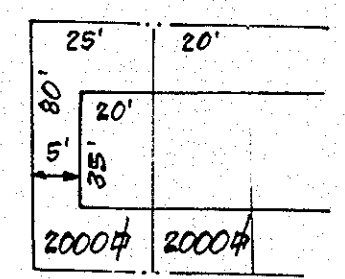

GENERAL NOTES:

1. Topography compiled from aerial surveys
2. Existing Zoning: R.S.C.
3. The area included in this submission is located on Tax Map No. 46 Parcel No. 3
4. Installation of Traffic Control Devices shall be in accordance with the latest edition of the Manual of Uniform Control Devices.
5. Public Water and Sewer to be Utilized.
6. Sediment and Erosion Control will be provided with the submission of the Rd. Contr. Plans and the Site Develop. Plan.
7. See Soils Map # 33
8. Recording Reference: 989/236 & 720/146
9. Coordinates shown hereon are in the Maryland State Plane Coordinate System and are based on Howard County Control Stations 204-002 & 204-003
10. See Office of Planning and Zoning Files S-81-01, P-81-27, P-81-28, F-81-143 & F-82-72.

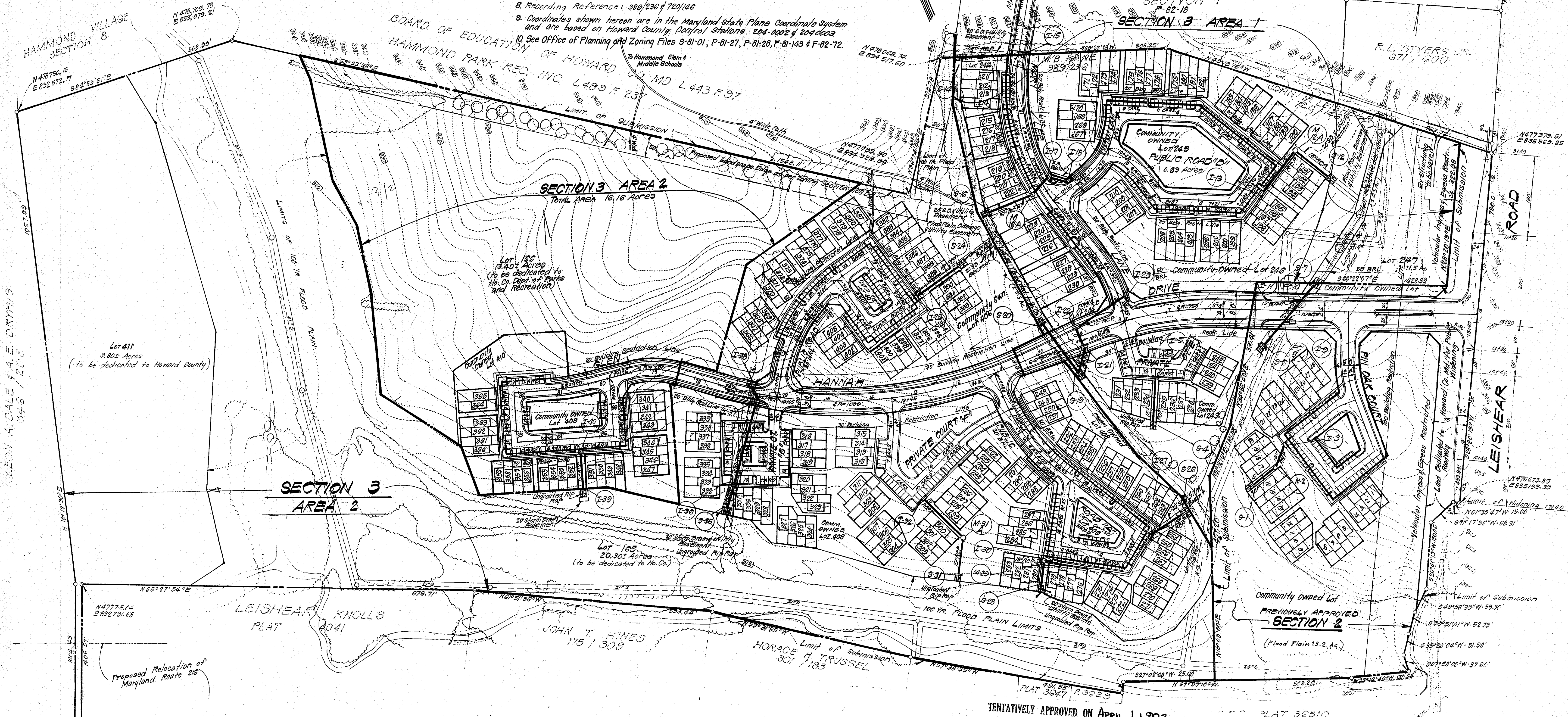

LEON A. DALE & A. E. DRYRUS
346 / 203

- (1) Section One Area includes open space Lots 165 & 166 - shown on this sheet.
- (2) Section Two is previously recorded on Plans 4996 & 4997.

SECTION	TOTAL AREA (AC)	NO. OF RESIDENTIAL LOTS RECORDED	DENSITY		TABULATION		TOTAL NET AREA (AC)	DENSITY UNITS/NET(AC)
			SPACE REQUIRED	OPEN SPACE REQUIRED	OPEN SPACE DEDICATION GRASS WITHIN FLOODPLAIN	(AC)		
ONE (1)	53.7	111	10.7 AC.	32.400	21.000	17.400	32.700	3.2
TWO (2)	11.029	23	2.206 AC.	3.174	3.174	0	7.856	3.56
THREES/ONE	15.5	77	3.1 AC.	1.600	1.600	0	13.900	5.5
THREES/TWO	28.5	139	5.7 AC.	3.800	0	3.800	28.500	5.5
TOTAL	108.7	374	21.7 AC.	52.974	25.774	27.200	82.956	4.5 #

Density Allowed: 83.014 = 332
 Flood Plain Adjustment = .10x 108.714 = 43.4
 Total Units allowed = 375 & Total Units Shown = 374

NOTE: FOR INFORMATION CONCERNING 100 YR. FLOOD PLAIN, See Previously Approved Study by Boender Associates.

NOTE: OPEN SPACE LOTS 165 & 166 SHOWN ON P-82-20. MURRAY HILL, SECTION 3 AREA 1 & 2 WILL BE RECORDED WITH SECTION ONE P-82-18

TENTATIVELY APPROVED ON APRIL 14 1982

OFFICE OF PLANNING AND ZONING OF HOWARD COUNTY
 PLANNING DIRECTOR



CLARK • FINEROCK & SACKETT
 ENGINEERS • PLANNERS • SURVEYORS
 11315 LOGWOOD DRIVE • VERMILION, MARYLAND 21084
 PHONE 593-1400

DESIGNED: JME
 DRAWN: KJW
 CHECKED: JME
 DATE: 3-15-82

PRELIMINARY PLAN
 LOTS 167 THRU 411
MURRAY HILL
 SECTION 3 AREAS 1 & 2
 6TH ELECTION DISTRICT
 HOWARD COUNTY, MARYLAND

FOR: BRANTLY ASSOCIATES
 Teachers Bldg., Suite 218
 Columbia, MD 21044

SCALE: 1" = 100'
 DRAWING: 10 of 1
 JOB NO: 81-006
 FILE NO: 81-006-P

P-82-20