

COORDINATES

NO.	NORTH	EAST	NO.	NORTH	EAST
116	517596.99	824437.92	220	517233.34	824407.90
147	514567.67	823564.84	221	517563.20	824770.98
158	514550.52	823534.89	222	517544.73	824790.73
150	514543.07	823641.15	223	513161.39	824634.87
151	514512.06	823655.99	224	518332.09	824646.04
153	515070.38	823839.65	225	518466.55	824206.84
154	515038.42	823852.35	226	518432.61	824138.84
156	514980.55	823798.87	227	517918.49	823935.25
157	514992.71	823882.07	228	517735.23	823998.19
159	515770.10	823463.15	229	517661.42	824012.54
160	515771.94	823428.86	230	517313.14	824412.38
162	515844.19	823400.37	231	517564.07	824721.01
163	515810.08	823396.55	232	517650.50	824731.06
165	515819.65	823526.49	233	518293.03	824619.66
166	515856.15	823528.25	234	518309.72	824601.34
168	515898.54	823459.64	235	518424.35	824230.20
169	515894.29	823495.93	236	518388.40	824162.20
171	516189.24	823257.11	237	517930.35	823982.56
172	516208.95	823227.76	238	517751.39	824045.50
174	516287.36	823237.82	239	517664.16	824064.46
175	516258.01	823218.11	240	514855.25	824128.46
177	516919.98	823421.50	241	514825.74	824265.71
178	516925.24	823457.37	242	514829.22	824340.74
180	517000.64	823484.82	243	515334.94	825062.03
181	516964.57	823488.25	244	515397.76	825090.28
183	517337.06	824006.70	245	514900.61	824140.50
184	517363.28	824028.92	246	514875.64	824282.56
186	517312.40	824103.79	247	514879.12	824337.58
187	517256.05	824078.84	248	515354.92	825016.20
194	516645.95	824428.90	251	515992.80	824290.51
202	514818.89	823730.14	251	516055.06	823951.54
203	514905.30	823763.97	252	515948.25	823559.60
204	515043.47	823329.95	253	515709.57	823277.35
205	515691.03	823677.13	254	515288.88	822968.33
206	515757.68	823594.47	255	515943.64	824287.37
207	514843.45	823654.00	256	516005.91	823952.70
208	514938.96	823691.39	257	515910.11	823591.93
209	515077.13	823755.47	258	515671.43	823310.27
210	515628.75	823626.91	259	515269.35	823014.36
211	515695.40	823544.26	260	516254.50	823200.27
212	516317.38	823293.07	261	516258.77	823157.18
215	517279.10	824176.93	262	516389.02	822841.78
216	516305.80	823234.20	263	516205.44	823209.92
217	516989.52	823396.48	264	516212.56	823138.10
218	517005.39	823411.34	265	516342.80	822822.70
219	517338.86	824182.31	266	516905.05	823483.08

NOTE: ALL COORDINATES BASED ON THE MARYLAND STATE GRID SYSTEM.

TOTAL TABULATION THIS SUBMISSION:	ACREAGE:
AREA OF LOTS .....	229.894
AREA OF RIGHT OF WAY .....	17.305
TOTAL AREA .....	269.732
AREA OF FLOODPLAIN .....	22.533
NUMBER OF LOTS .....	61

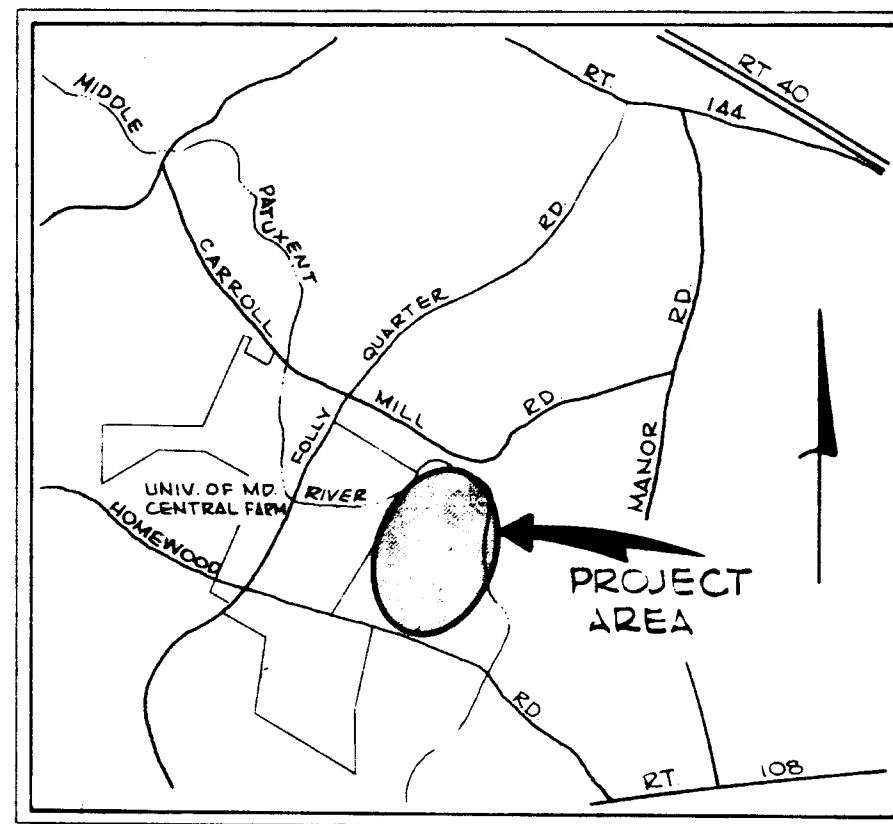

VICINITY MAP

Scale: 1" = 1 MILE

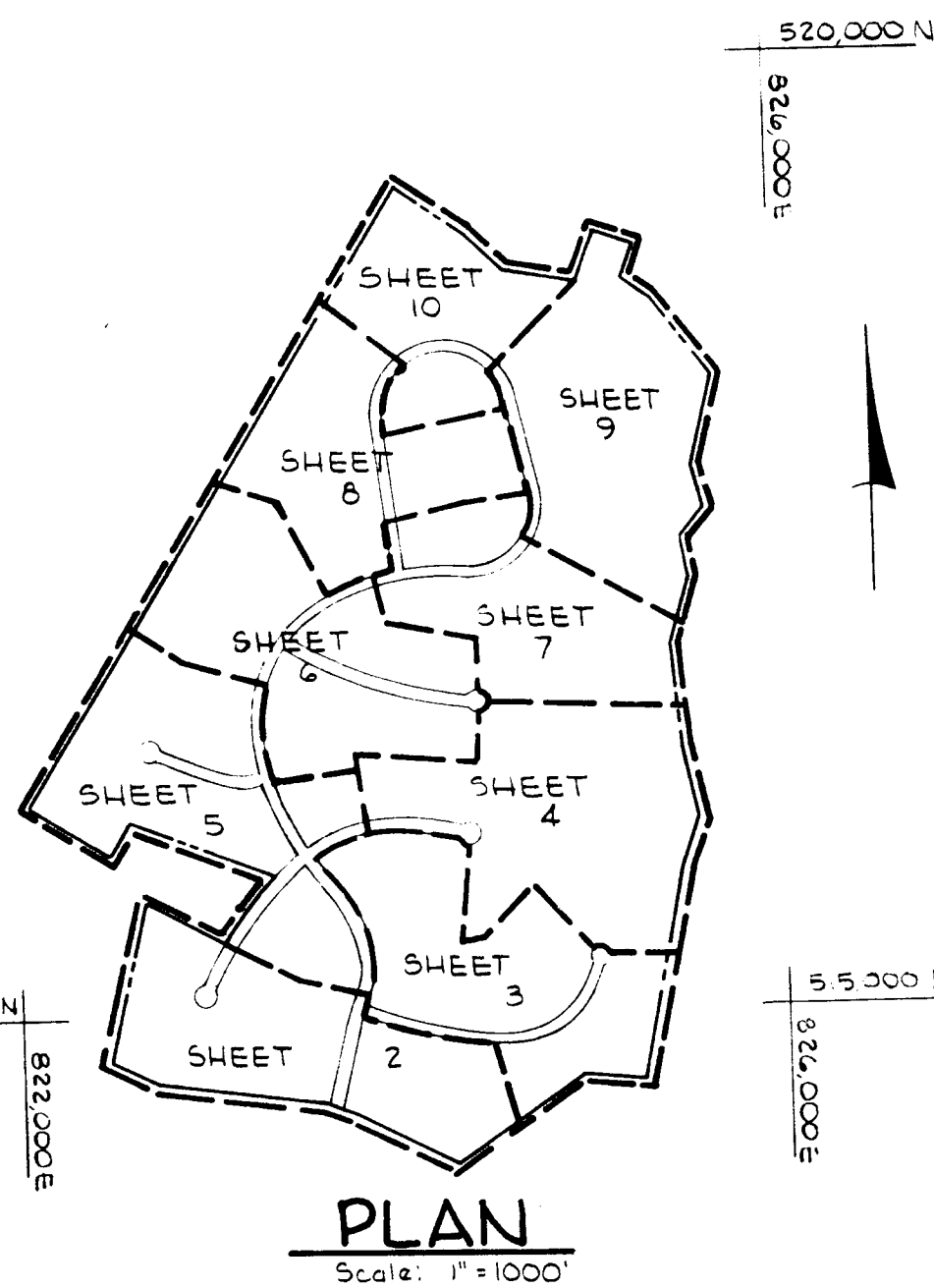

PLAN

Scale: 1" = 1000'

COORDINATES

NO.	NORTH	EAST	NO.	NORTH	EAST
257	515736.59	823817.10	381	515827.73	822460.38
268	516228.84	824128.59	382	515999.58	822558.72
269	515628.88	824322.96	386	515708.12	823276.23
270	516944.37	823513.96	387	515395.45	823020.29
271	516786.83	823829.92	397	515239.20	823388.41
272	516701.15	824141.41	398	515424.21	823096.41
273	516675.83	824325.27	404	515587.46	822652.75
275	515888.18	825010.33	406	518111.08	824399.91
277	515997.59	823816.43	407	518103.66	824669.19
279	515932.04	823604.27	408	517878.60	824002.05
291	515274.98	822953.38	409	517576.63	824067.27
283	515248.95	823014.76	410	516692.04	823310.92
285	516403.88	822827.74	411	517312.90	823877.50
287	516302.21	822802.29	412	518319.06	824069.34
288	516616.70	824211.13	413	517573.88	82417.35
291	516683.28	824344.27	500	516689.54	822047.16
292	516200.81	823315.98	501	519297.88	824080.99
304	514397.40	824535.89	502	519037.74	824441.47
305	514843.13	824449.03	503	518854.70	824331.13
309	515344.07	825375.82	504	518783.59	825004.02
313	515725.00	824745.00	505	519017.23	825007.45
314	515455.43	825003.43	506	518944.96	825293.42
316	515525.00	824450.00	507	518811.24	825239.95
321	515486.09	824259.23	508	518698.61	825390.14
322	515903.84	824337.86	509	518290.30	825688.63
327	516324.00	824415.07	510	517821.93	825368.88
328	516397.16	823819.62	511	517603.93	825627.17
329	516062.21	823841.52	512	517449.34	825499.28
330	516301.03	825825.90	513	517239.61	825534.46
334	516598.56	824385.34	514	516885.70	825431.34
335	516598.32	825455.66	515	516363.23	825475.56
337	516948.23	824575.26	516	515993.15	825545.14
338	516338.26	824379.17	517	515712.44	825447.67
340	517040.00	823950.00	518	515233.39	825354.23
341	517254.91	823892.91	519	514597.06	825215.82
344	517464.52	824745.61	520	514632.51	824883.82
345	517127.69	825504.76	521	514182.62	824217.95
350	518402.99	824536.29	522	514444.20	823710.48
355	518354.02	824033.59	523	514506.85	823549.93
356	518686.62	823693.50	524	514540.34	823369.01
367	517742.90	823095.26	525	514630.30	822670.28
368	517656.39	823383.78	526	514754.29	822428.18
371	517211.28	823641.30			
373	516982.13	822612.99			
374	516826.86	822857.92			
377	516709.15	822255.42			

\* FLOODPLAIN RESERVATION

THIS SUBDIVISION IS BEING RECORDED AND THE CONTIGUOUS FLOOD PLAIN OF THE MIDDLE PATUXENT RIVER IS BEING RESERVED FOR FUTURE PURCHASE BY HOWARD COUNTY, PURSUANT TO SECTION 16.117, (6), AND 16.139, (2), OF THE HOWARD COUNTY SUBDIVISION AND LAND DEVELOPMENT REGULATIONS OF FEBRUARY 7, 1976.

THIS AREA INDICATES A PRIVATE SEWAGE EASEMENT OF APPROXIMATELY 10,000 SQUARE FEET AS REQUIRED BY THE MARYLAND STATE DEPARTMENT OF HEALTH AND MENTAL HYGIENE FOR INDIVIDUAL DISPOSAL. IMPROVEMENTS OF ANY KIND IN THIS AREA ARE RESTRICTED UNTIL PUBLIC SEWAGE IS AVAILABLE AND SERVICING ANY RESIDENTIAL STRUCTURES CONSTRUCTED ON THIS SITE. THIS EASEMENT SHALL BECOME NULL AND VOID UPON CONNECTION TO A PUBLIC SEWAGE SYSTEM.

Ⓟ DENOTES HIGHEST PERCOLATION HOLE

APPROVED: FOR PRIVATE WATER AND PRIVATE SEWERAGE SYSTEMS, HOWARD COUNTY HEALTH DEPT.

*[Signature]* 10-8-79  
COUNTY HEALTH OFFICER DATE

APPROVED: HOWARD COUNTY OFFICE OF PLANNING AND ZONING.

*[Signature]* 10-10-79  
DIRECTOR DATE

APPROVED: STORM DRAINAGE SYSTEMS AND PUBLIC ROADS HOWARD COUNTY DEPT. OF PUBLIC WORKS

*[Signature]* 10-20-79  
DIRECTOR DATE

SURVEYOR'S CERTIFICATE

I HEREBY CERTIFY THAT THE FINAL PLAT SHOWN HEREON IS CORRECT; THAT IT IS A SUBDIVISION OF ALL OF THE LAND CONVEYED BY HARRY CARROLL POTTER, EDWARD HARMOND LASSOTOVITCH, JULIA RANDOL LASSOTOVITCH, ROBERT DUMBAR SNEDEKER, AND FRANCIS WILDA SNEDEKER TO WOODMARK, INC., DEED DATED OCTOBER 2, 1978 AND RECORDED IN THE LAND RECORDS OF HOWARD COUNTY LIBER 912, FOLIO 173 AND ALL OF THE LAND CONVEYED BY EDWARD HARMOND LASSOTOVITCH AND JULIA RANDOL LASSOTOVITCH TO WOODMARK, INC., DEED DATED OCTOBER 2, 1978 AND RECORDED IN THE LAND RECORDS OF HOWARD COUNTY LIBER 912, FOLIO 189 AND ALL MONUMENTS ARE IN PLACE AS SHOWN, IN ACCORDANCE WITH THE ANNOTATED CODE OF MARYLAND, AS AMENDED.

PROFESSIONAL LAND SURVEYOR:  
BY: *[Signature]*  
CENTURY ENGINEERING, INC.  
32 West Road  
TOWSON, MARYLAND 21284

OWNER'S CERTIFICATE

I, WOODMARK, INC., A MARYLAND CORPORATION BY MARK A. WAKEFIELD JR., PRESIDENT, OWNER OF THE PROPERTY SHOWN AND DESCRIBED HEREON, HEREBY ADOPT THIS PLAN OF SUBDIVISION, AND IN CONSIDERATION OF THE APPROVAL OF THIS FINAL PLAT BY THE OFFICE OF PLANNING AND ZONING, ESTABLISH THE MINIMUM BUILDING RESTRICTION LINES AND GRANT UNTO HOWARD COUNTY, MARYLAND, ITS SUCCESSORS AND ASSIGNS, (1) THE RIGHT TO LAY, CONSTRUCT AND MAINTAIN SEWERS, DRAINS, WATER PIPES AND OTHER MUNICIPAL UTILITIES AND SERVICES, IN AND UNDER ALL ROADS AND STREET RIGHTS-OF-WAY AND THE SPECIFIC DRAINAGE AND UTILITY EASEMENT; (2) DEDICATE TO PUBLIC USE THE BEDS OF THE STREET AND/OR ROADS AND FLOODPLAINS AND OPEN SPACE WHERE APPLICABLE, AND FOR ONE DOLLAR (\$1.00) CONSIDERATION, HEREBY GRANT THE RIGHT AND OPTION TO HOWARD COUNTY TO ACQUIRE THE FEE SIMPLE TITLE TO THE BEDS OF THE STREETS AND/OR ROADS "WHERE APPLICABLE"; (3) TO REMOVED OR TO REMOVE ANY STRUCTURE OF ANY KIND SHALL BE CREATED ON OR OVER THE SAID EASEMENT AND RIGHT-OF-WAY; AND (4) IT IS FURTHER AGREED THAT MAINTENANCE OF ALL WATERWAYS, DRAINAGE EASEMENTS AND/OR FLOODPLAINS SHOWN HEREON ARE THE RESPONSIBILITY OF THE PROPERTY OWNER, ITS SUCCESSORS AND ASSIGNS.

WITNESS MY/OUR HANDS THIS 1st. DAY OF JUNE, 1979.  
WOODMARK, INC.  
12150 Mount Albert Court  
ELLICOTT CITY, MARYLAND 21035  
*[Signature]*  
MARK A. WAKEFIELD JR., PRESIDENT  
ATTEST: *[Signature]* SEAL

RECORDED AS PLAT NUMBER 4405

ON Oct 11, 1979, AMONG THE LAND RECORDS OF HOWARD COUNTY, MARYLAND

FARSIDE

LOTS 1-61  
TAX MAPS 23&29

SHEET 1 OF 10  
3rd. ELECTION DISTRICT OF HOWARD COUNTY, MARYLAND  
SCALE: AS SHOWN  
DATE: 6-1-79

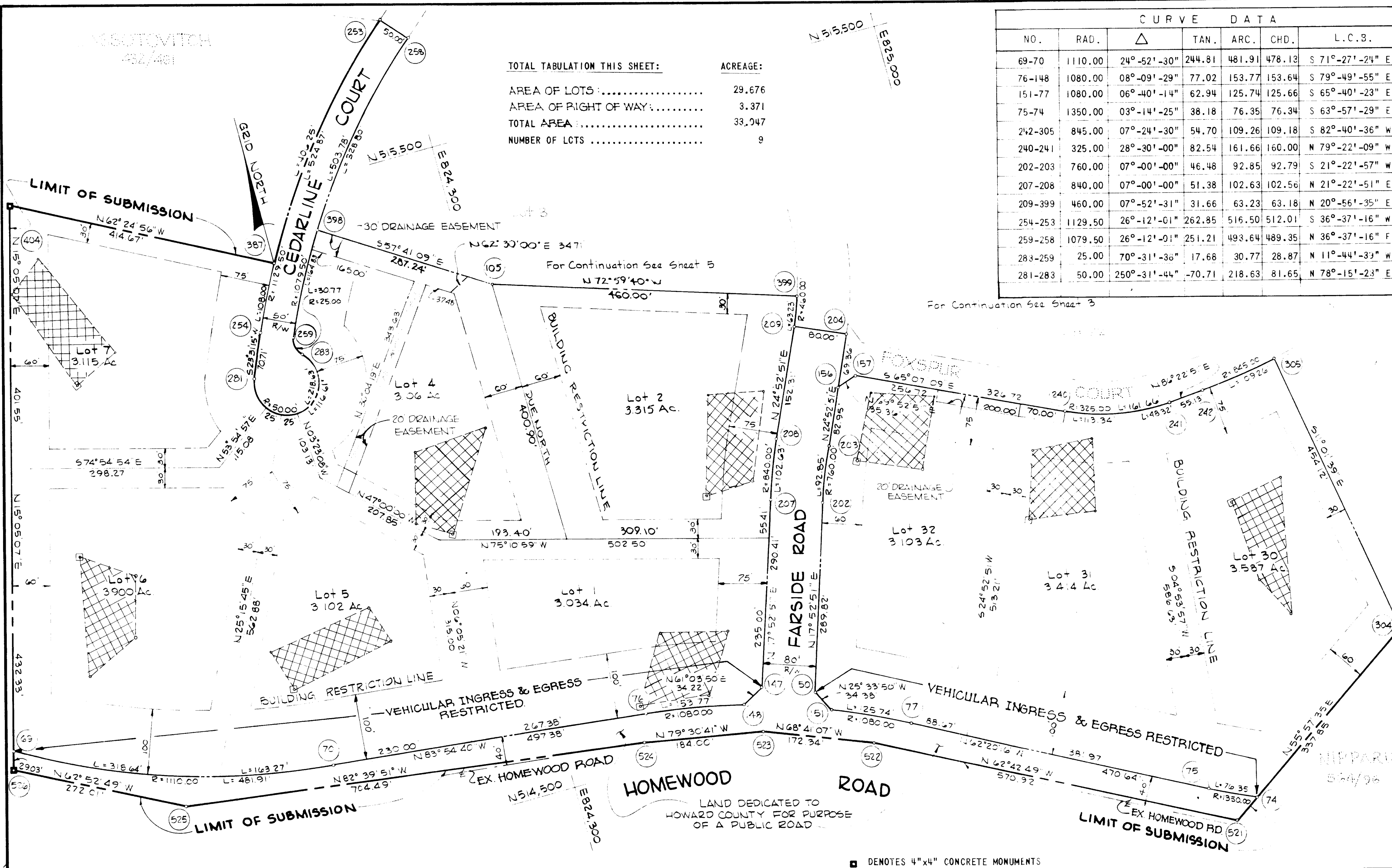

TOTAL TABULATION THIS SHEET:      ACREAGE:

AREA OF LOTS :.....      29.676

AREA OF RIGHT OF WAY :.....      3.371

TOTAL AREA :.....      33.047

NUMBER OF LOTS :.....      9

CURVE DATA						
NO.	RAD.	Δ	TAN.	ARC.	CHD.	L.C.S.
69-70	1110.00	24°-52'-30"	244.81	481.91	478.13	S 71°-27'-24" E
76-148	1080.00	08°-09'-29"	77.02	153.77	153.64	S 79°-49'-55" E
151-77	1080.00	06°-40'-14"	62.94	125.74	125.66	S 65°-40'-23" E
75-74	1350.00	03°-14'-25"	38.18	76.35	76.34	S 63°-57'-29" E
242-305	845.00	07°-24'-30"	54.70	109.26	109.18	S 82°-40'-36" W
240-241	325.00	28°-30'-00"	82.54	161.66	160.00	N 79°-22'-09" W
202-203	760.00	07°-00'-00"	46.48	92.85	92.79	S 21°-22'-57" W
207-208	840.00	07°-00'-00"	51.38	102.63	102.56	N 21°-22'-51" E
209-399	460.00	07°-52'-31"	31.66	63.23	63.18	N 20°-56'-35" E
254-253	1129.50	26°-12'-01"	262.85	516.50	512.01	S 36°-37'-16" W
259-258	1079.50	26°-12'-01"	251.21	493.64	489.35	N 36°-37'-16" F
283-259	25.00	70°-31'-36"	17.68	30.77	28.87	N 11°-44'-33" W
281-283	50.00	250°-31'-44"	-70.71	218.63	81.65	N 78°-15'-23" E

APPROVED: FOR PRIVATE WATER AND PRIVATE SEWERAGE SYSTEMS, HOWARD COUNTY HEALTH DEPT.

*[Signature]*      10-8-79  
 COUNTY HEALTH OFFICER      DATE

APPROVED: HOWARD COUNTY OFFICE OF PLANNING AND ZONING

*[Signature]*      10-10-79  
 DIRECTOR      DATE

APPROVED: STORM DRAINAGE SYSTEMS AND PUBLIC ROADS, HOWARD COUNTY DEPT. OF PUBLIC WORKS.

\_\_\_\_\_  
 DIRECTOR      DATE

SURVEYOR'S CERTIFICATE

I HEREBY CERTIFY THAT THE FINAL PLAT SHOWN HEREON IS CORRECT; THAT IT IS A SUBDIVISION OF ALL OF THE LAND CONVEYED BY MARY CARROLL POTTER, EDWARD HAMMOND LASSOTOVITCH, JULIA RANDOL LASSOTOVITCH, ROBERT DUNBAR SWEDEKER, AND FRANCIS HILDA SWEDEKER TO WOODMARK, INC., DEED DATED OCTOBER 2, 1978 AND RECORDED IN THE LAND RECORDS OF HOWARD COUNTY LIBER 912, FOLIO 173 AND ALL OF THE LAND CONVEYED BY EDWARD HAMMOND LASSOTOVITCH AND JULIA RANDOL LASSOTOVITCH TO WOODMARK, INC., DEED DATED OCTOBER 2, 1978 AND RECORDED IN THE LAND RECORDS OF HOWARD COUNTY LIBER 912, FOLIO 189 AND ALL MONUMENTS ARE IN PLACE AS SHOWN, IN ACCORDANCE WITH THE ANNOTATED CODE OF MARYLAND, AS AMENDED.

PROFESSIONAL LAND SURVEYOR:  
 (BY) *[Signature]*  
 CENTURY ENGINEERING, INC.  
 32 West Road  
 TOWSON, MARYLAND 21284

OWNER'S CERTIFICATE

I, WOODMARK, INC., A MARYLAND CORPORATION BY MARK A. WAKEFIELD JR., PRESIDENT, OWNER OF THE PROPERTY SHOWN AND DESCRIBED HEREON, HEREBY ADOPT THIS PLAN OF SUBDIVISION, AND IN CONSIDERATION OF THE APPROVAL OF THIS FINAL PLAT BY THE OFFICE OF PLANNING AND ZONING, ESTABLISH THE MINIMUM BUILDING RESTRICTION LINES AND GRANT UNTO HOWARD COUNTY, MARYLAND, ITS SUCCESSORS AND ASSIGNS, (1) THE RIGHT TO LAY, CONSTRUCT AND MAINTAIN SEWERS, DRAINS, WATER PIPES AND OTHER MUNICIPAL UTILITIES AND SERVICES, IN AND UNDER ALL ROADS AND STREET RIGHTS-OF-WAY AND THE SPECIFIC DRAINAGE AND UTILITY EASEMENTS; (2) DEDICATE TO PUBLIC USE THE BEDS OF THE STREET AND/OR ROADS AND FLOODPLAINS AND OPEN SPACE WHERE APPLICABLE, AND FOR ONE DOLLAR (\$1.00) CONSIDERATION, HEREBY GRANT THE RIGHT AND OPTION TO HOWARD COUNTY TO ACQUIRE THE FEE SIMPLE TITLE TO THE BEDS OF THE STREETS AND/OR ROADS WHERE APPLICABLE; (3) THAT NO BUILDING OR SIMILAR STRUCTURE OF ANY KIND SHALL BE ERRECTED ON OR OVER THE SAID EASEMENT AND RIGHT-OF-WAYS; AND (4) IT IS FURTHER AGREED THAT MAINTENANCE OF ALL WATERWAYS, DRAINAGE EASEMENTS AND/OR FLOODPLAINS SHOWN HEREON ARE THE RESPONSIBILITY OF THE PROPERTY OWNER, ITS SUCCESSORS AND ASSIGNS.

WITNESS MY/OUR HANDS THIS 1st. DAY OF JUNE, 1979.

WOODMARK, INC.  
 12150 Mount Albert Court  
 CLICOTT CITY, MARYLAND 21043

ATTEST: *[Signature]*      SEAL      *[Signature]*  
 MARK A. WAKEFIELD JR., PRESIDENT

RECORDED AS PLAT NUMBER **4406**  
 ON **Oct. 11, 1979**, AMONG THE  
 LAND RECORDS OF HOWARD COUNTY, MARYLAND.

**FARSIDE**  
 LOTS 1, 2, 4-7, & 30-32  
 TAX MAPS 23 & 29

SHEET 2 OF 10  
 3rd. ELECTION DISTRICT OF HOWARD COUNTY, MARYLAND  
 SCALE: 1" = 100'      DATE: 6-1-79



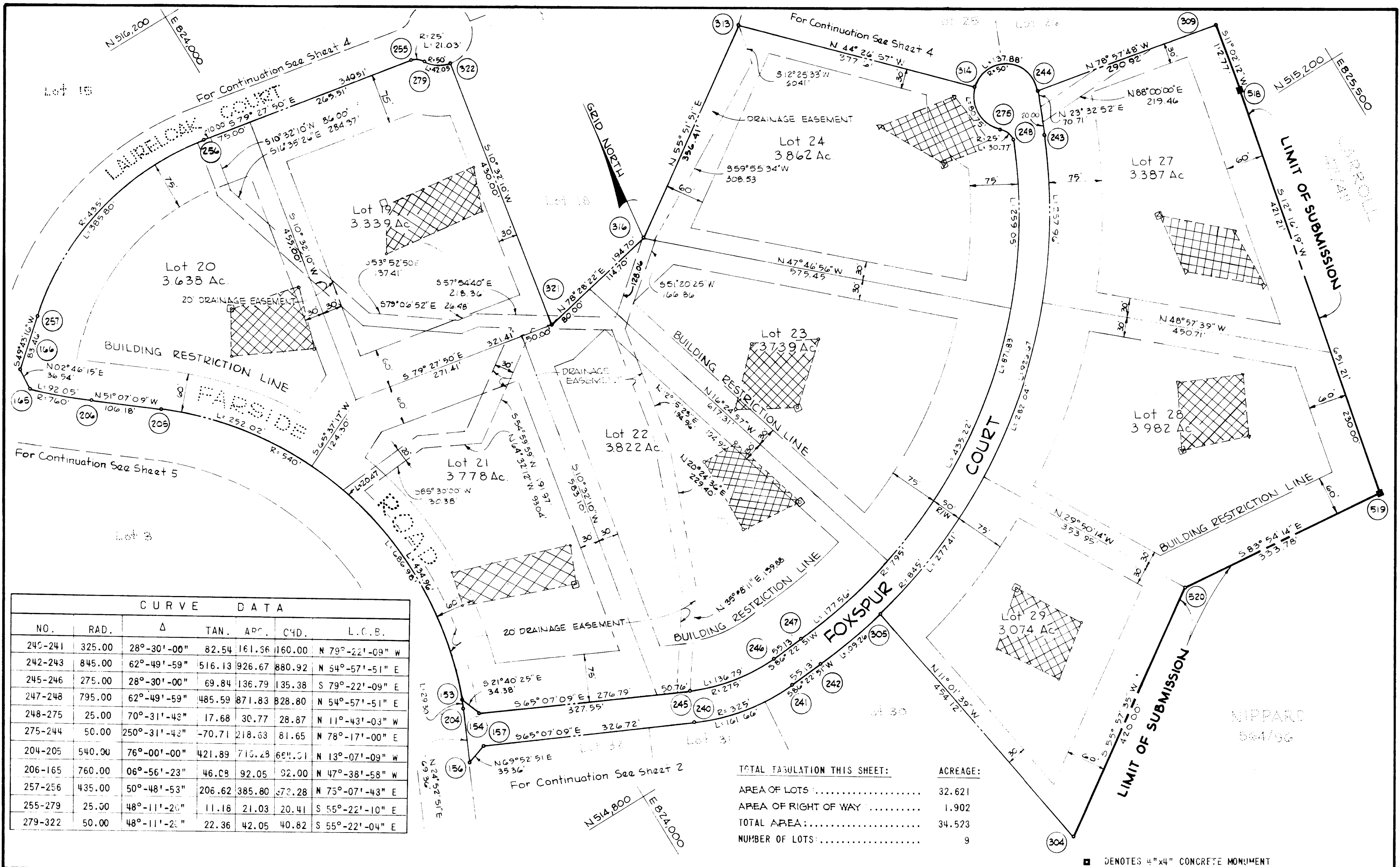

CURVE DATA						
NO.	RAD.	Δ	TAN.	ARC.	CHD.	L.C.B.
242-241	325.00	28°-30'-00"	82.54	161.56	160.00	N 79°-22'-09" W
242-243	845.00	62°-49'-59"	516.13	926.67	880.92	N 54°-57'-51" E
245-246	275.00	28°-30'-00"	69.84	136.79	135.38	S 79°-22'-09" E
247-248	795.00	62°-49'-59"	485.59	871.83	828.80	N 54°-57'-51" E
248-275	25.00	70°-31'-43"	17.68	30.77	28.87	N 11°-43'-03" W
275-244	50.00	250°-31'-43"	-70.71	218.63	81.65	N 78°-17'-00" E
204-205	540.00	76°-00'-00"	421.89	716.28	664.51	N 13°-07'-09" W
206-165	760.00	06°-56'-23"	46.08	92.05	92.00	N 47°-38'-58" W
257-256	435.00	50°-48'-53"	206.62	385.80	373.28	N 75°-07'-43" E
255-279	25.00	48°-11'-20"	11.18	21.03	20.41	S 55°-22'-10" E
279-322	50.00	48°-11'-20"	22.36	42.05	40.82	S 55°-22'-04" E

TOTAL TABULATION THIS SHEET:		ACREAGE:
AREA OF LOTS	.....	32.621
AREA OF RIGHT OF WAY	.....	1.902
TOTAL AREA	.....	34.523
NUMBER OF LOTS	.....	9

■ DENOTES 4"x4" CONCRETE MONUMENT

APPROVED: FOR PRIVATE WATER AND PRIVATE SEWERAGE SYSTEMS, HOWARD COUNTY HEALTH DEPT.  
*Joyce B. Jones* 10-8-79  
 COUNTY HEALTH OFFICER DATE

APPROVED: HOWARD COUNTY OFFICE OF PLANNING AND ZONING.  
 \_\_\_\_\_ 10-10-79  
 DIRECTOR DATE

APPROVED: STORM DRAINAGE SYSTEMS AND PUBLIC ROADS, HOWARD COUNTY DEPARTMENT OF PUBLIC WORKS.  
 \_\_\_\_\_  
 DIRECTOR DATE

**SURVEYOR'S CERTIFICATE**

I HEREBY CERTIFY THAT THE FINAL PLAT SHOWN HEREON IS CORRECT; THAT IT IS A SUBDIVISION OF ALL OF THE LAND CONVEYED BY MARY CARROLL POTTER, EDVARD HAMMOND LASSOTOVITCH, JULIA RANDOL LASSOTOVITCH, ROBERT DUNBAR SNEDEKER, AND FRANCIS HILDA SNEDEKER TO WOODMARK, INC., DEED DATED OCTOBER 2, 1978 AND RECORDED IN THE LAND RECORDS OF HOWARD COUNTY LIBER 912, FOLIO 172 AND ALL OF THE LAND CONVEYED BY EDWARD HAMMOND LASSOTOVITCH AND JULIA RANDOL LASSOTOVITCH TO WOODMARK, INC., DEED DATED OCTOBER 2, 1978 AND RECORDED IN THE LAND RECORDS OF HOWARD COUNTY LIBER 912, FOLIO 189 AND ALL MONUMENTS ARE IN PLACE AS SHOWN, IN ACCORDANCE WITH THE ANNOTATED CODE OF MARYLAND, AS AMENDED.

PROFESSIONAL LAND SURVEYOR:  
*Donald E. Jones*  
 CENTURY ENGINEERING, INC.  
 32 West Road  
 TOWSON, MARYLAND 21284

**OWNER'S CERTIFICATE**

I, WOODMARK, INC., A MARYLAND CORPORATION BY MARK A. WAKEFIELD JR., PRESIDENT, OWNER OF THE PROPERTY SHOWN AND DESCRIBED HEREON, HEREBY ADOPT THIS PLAN OF SUBDIVISION, AND IN CONSIDERATION OF THE APPROVAL OF THIS FINAL PLAT BY THE OFFICE OF PLANNING AND ZONING, ESTABLISH THE MINIMUM BUILDING RESTRICTION LINES AND GRANT UNTO HOWARD COUNTY, MARYLAND, ITS SUCCESSORS AND ASSIGNS, (1) THE RIGHT TO LAY, CONSTRUCT AND MAINTAIN SEWERS, DRAINS, WATER PIPES AND OTHER MUNICIPAL UTILITIES AND SERVICES, IN AND UNDER ALL ROADS AND STREET RIGHTS-OF-WAY AND THE SPECIFIC DRAINAGE AND UTILITY EASEMENTS; (2) DEDICATE TO PUBLIC USE THE BEDS OF THE STREET AND/OR ROADS AND FLOODPLAINS AND OPEN SPACE WHERE APPLICABLE; AND FOR ONE DOLLAR (\$1.00) CONSIDERATION, HEREBY GRANT THE RIGHT AND OPTION TO HOWARD COUNTY TO ACQUIRE THE FEE SIMPLE TITLE TO THE BEDS OF THE STREETS AND/OR ROADS "WHERE APPLICABLE"; (3) THAT NO BUILDING OR SIMILAR STRUCTURE OF ANY KIND SHALL BE ERRECTED ON OR OVER THE SAID EASEMENT AND RIGHT-OF-WAYS; AND (4) IT IS FURTHER AGREED THAT MAINTENANCE OF ALL WATERWAYS, DRAINAGE EASEMENTS AND/OR FLOODPLAINS SHOWN HEREON ARE THE RESPONSIBILITY OF THE PROPERTY OWNER, ITS SUCCESSORS AND ASSIGNS.

WITNESS MY/OUR HANDS THIS 1st. DAY OF JUNE, 1979.

WOODMARK, INC.  
 12150 Mount Albert Court  
 ELICOTT CITY, MARYLAND 21043

ATTEST: *W. Wakefield Jr.* SEAL *Mark A. Wakefield Jr.*  
 MARK A. WAKEFIELD JR., PRESIDENT

RECORDED AS PLAT NUMBER **4407**  
 ON Oct 11, 1979, AMONG THE  
 LAND RECORDS OF HOWARD COUNTY, MARYLAND

**FARISIDE**  
 LOTS 19-24, & 27-29  
 TAX MAPS 23 & 29

SHEET 3 OF 10  
 3rd. ELECTION DISTRICT OF HOWARD COUNTY, MARYLAND  
 SCALE: 1" = 100' DATE: 6-1-79

CURVE DATA						
NO.	RAD.	Δ	TAN.	ARC	CHD.	L.C.B.
255-279	25.00	48°-11'-20"	11.18	21.03	20.41	N 55°-22'-10" W
279-277	50.00	276°-22'-40"	-44.72	241.18	66.67	S 10°-32'-10" W
277-250	25.00	48°-11'-20"	11.18	21.03	20.41	N 76°-26'-30" E
251-329	485.00	14°-16'-36"	60.74	120.85	120.54	N 86°-36'-08" W
334-194	50.00	81°-09'-38"	42.83	70.83	65.05	N 43°-14'-19" E
314-244	50.00	157°-59'-49"	257.19	137.88	98.16	S 55°-27'-03"-E

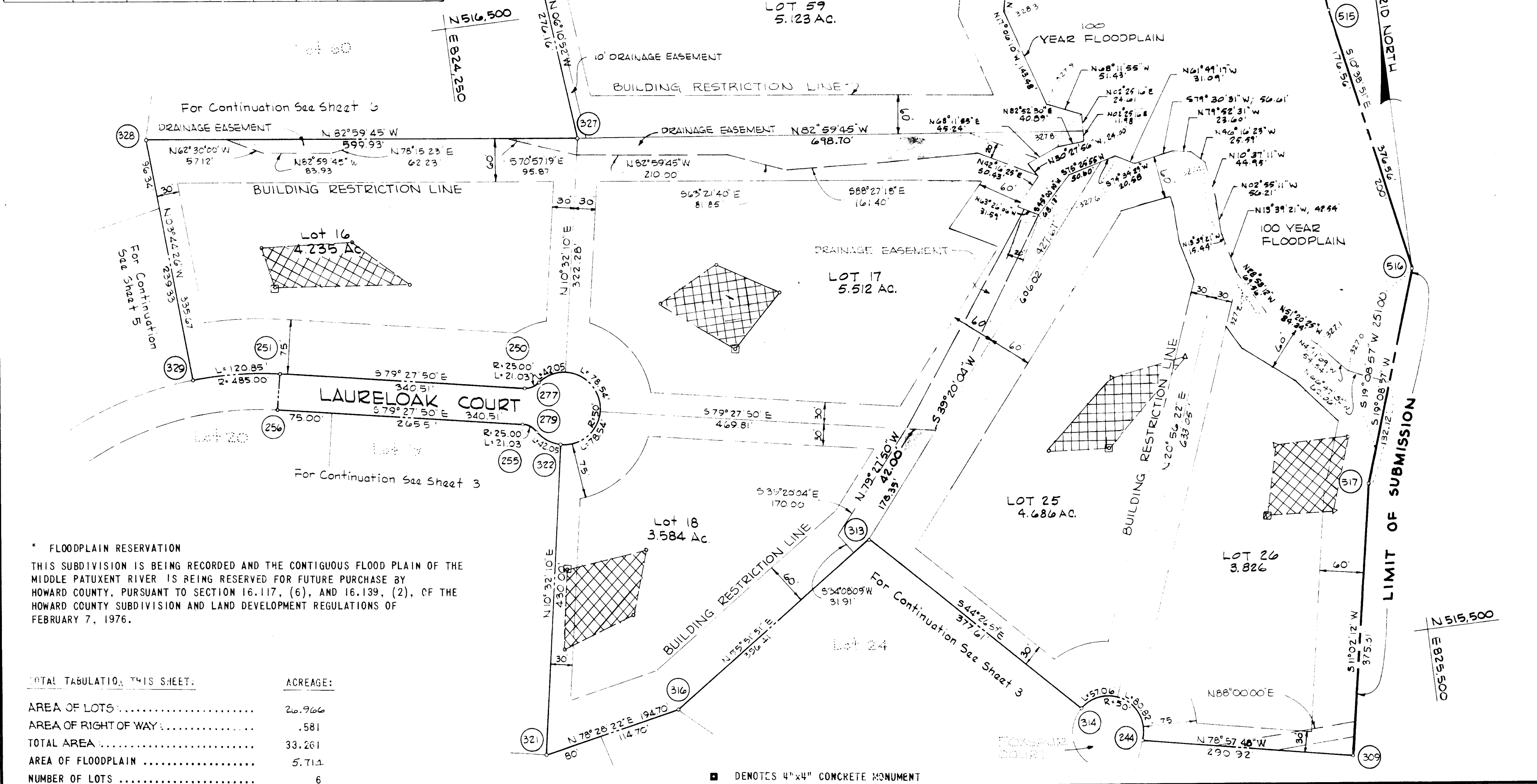

\* FLOODPLAIN RESERVATION  
 THIS SUBDIVISION IS BEING RECORDED AND THE CONTIGUOUS FLOOD PLAIN OF THE MIDDLE PATUXENT RIVER IS BEING RESERVED FOR FUTURE PURCHASE BY HOWARD COUNTY, PURSUANT TO SECTION 16.117, (6), AND 16.139, (2), OF THE HOWARD COUNTY SUBDIVISION AND LAND DEVELOPMENT REGULATIONS OF FEBRUARY 7, 1976.

TOTAL TABULATION, THIS SHEET:	ACREAGE:
AREA OF LOTS .....	26.966
AREA OF RIGHT OF WAY .....	.581
TOTAL AREA .....	33.261
AREA OF FLOODPLAIN .....	5.714
NUMBER OF LOTS .....	6

APPROVED: FOR PRIVATE WATER AND PRIVATE SEWERAGE SYSTEMS, HOWARD COUNTY HEALTH DEPT.  
*James M. Zepher* 10-8-77  
 COUNTY HEALTH OFFICER DATE

APPROVED: HOWARD COUNTY OFFICE OF PLANNING AND ZONING.  
*Thomas L. Hays* 10-10-77  
 DIRECTOR DATE

APPROVED: STORM DRAINAGE SYSTEMS AND PUBLIC ROADS, HOWARD COUNTY DEPARTMENT OF PUBLIC WORKS.  
 DIRECTOR DATE

SURVEYOR'S CERTIFICATE  
 I HEREBY CERTIFY THAT THE FINAL PLAT SHOWN HEREON IS CORRECT; THAT IT IS A SUBDIVISION OF ALL OF THE LAND CONVEYED BY MARY CARROLL POTTER, EDWARD HAMMOND LASSOTOVITCH, JULIA RANDOL LASSOTOVITCH, ROBERT DUNBAR SNEDEKER, AND FRANCIS HILDA SNEDEKER TO WOODMARK, INC., DEED DATED OCTOBER 2, 1978 AND RECORDED IN THE LAND RECORDS OF HOWARD COUNTY LIBER 912, FOLIO 173 AND ALL OF THE LAND CONVEYED BY EDWARD HAMMOND LASSOTOVITCH AND JULIA RANDOL LASSOTOVITCH TO WOODMARK, INC., DEED DATED OCTOBER 2, 1978 AND RECORDED IN THE LAND RECORDS OF HOWARD COUNTY LIBER 912, FOLIO 189 AND ALL MONUMENTS ARE IN PLACE AS SHOWN, IN ACCORDANCE WITH THE ANNOTATED CODE OF MARYLAND, AS AMENDED.

PROFESSIONAL LAND SURVEYOR:  
 (BY) *David E. Fine*  
 CENTURY ENGINEERING, INC.  
 32 West Road  
 TOWSON, MARYLAND 21286

OWNER'S CERTIFICATE  
 I, WOODMARK, INC., A MARYLAND CORPORATION BY MARK A. WAKEFIELD JR., PRESIDENT, OWNER OF THE PROPERTY SHOWN AND DESCRIBED HEREON, HEREBY ADOPT THIS PLAN OF SUBDIVISION, AND IN CONSIDERATION OF THE APPROVAL OF THIS FINAL PLAT BY THE OFFICE OF PLANNING AND ZONING, ESTABLISH THE MINIMUM BUILDING RESTRICTION LINES AND GRANT UNTO HOWARD COUNTY, MARYLAND, ITS SUCCESSORS AND ASSIGNS, (1) THE RIGHT TO LAY, CONSTRUCT AND MAINTAIN SEWERS, DRAINS, WATER PIPES AND OTHER MUNICIPAL UTILITIES AND SERVICES, IN AND UNDER ALL ROADS AND STREET RIGHTS-OF-WAY AND THE SPECIFIC DRAINAGE AND UTILITY EASEMENTS; (2) DEDICATE TO PUBLIC USE THE BEDS OF THE STREET AND/OR ROADS AND FLOODPLAINS AND OPEN SPACE WHERE APPLICABLE, AND FOR ONE DOLLAR (\$1.00) CONSIDERATION, HEREBY GRANT THE RIGHT AND OPTION TO HOWARD COUNTY TO ACQUIRE THE FEE SIMPLE TITLE TO THE BEDS OF THE STREETS AND/OR ROADS "WHERE APPLICABLE"; (3) THAT NO BUILDING OR SIMILAR STRUCTURE OF ANY KIND SHALL BE ERRECTED ON OR OVER THE SAID EASEMENT AND RIGHT-OF-WAYS, AND (4) IT IS FURTHER AGREED THAT MAINTENANCE OF ALL WATERWAYS, DRAINAGE EASEMENTS AND/OR FLOODPLAINS SHOWN HEREON ARE THE RESPONSIBILITY OF THE PROPERTY OWNER, ITS SUCCESSORS AND ASSIGNS.  
 WITNESS MY/OUR HANDS THIS 1st. DAY OF JUNE, 1979.

WOODMARK, INC.  
 12150 Mount Albert Court  
 ELLICOTT CITY, MARYLAND 21043  
*Mark A. Wakefield Jr.*  
 MARK A. WAKEFIELD JR., PRESIDENT

ATTEST: *U. G. Price* SEAL

RECORDED AS PLAT NUMBER 4408  
 ON OCT 11, 1979, AMONG THE  
 LAND RECORDS OF HOWARD COUNTY, MARYLAND.

**FARSIDE**  
 LOTS 16-18, 25, 26, & 59  
 TAX MAPS 23 & 29

SHEET 4 OF 10  
 3rd. ELECTION DISTRICT OF HOWARD COUNTY, MARYLAND  
 SCALE: 1" = 100'  
 DATE: 6-1-79

F-77-182 4:25  
 9:20

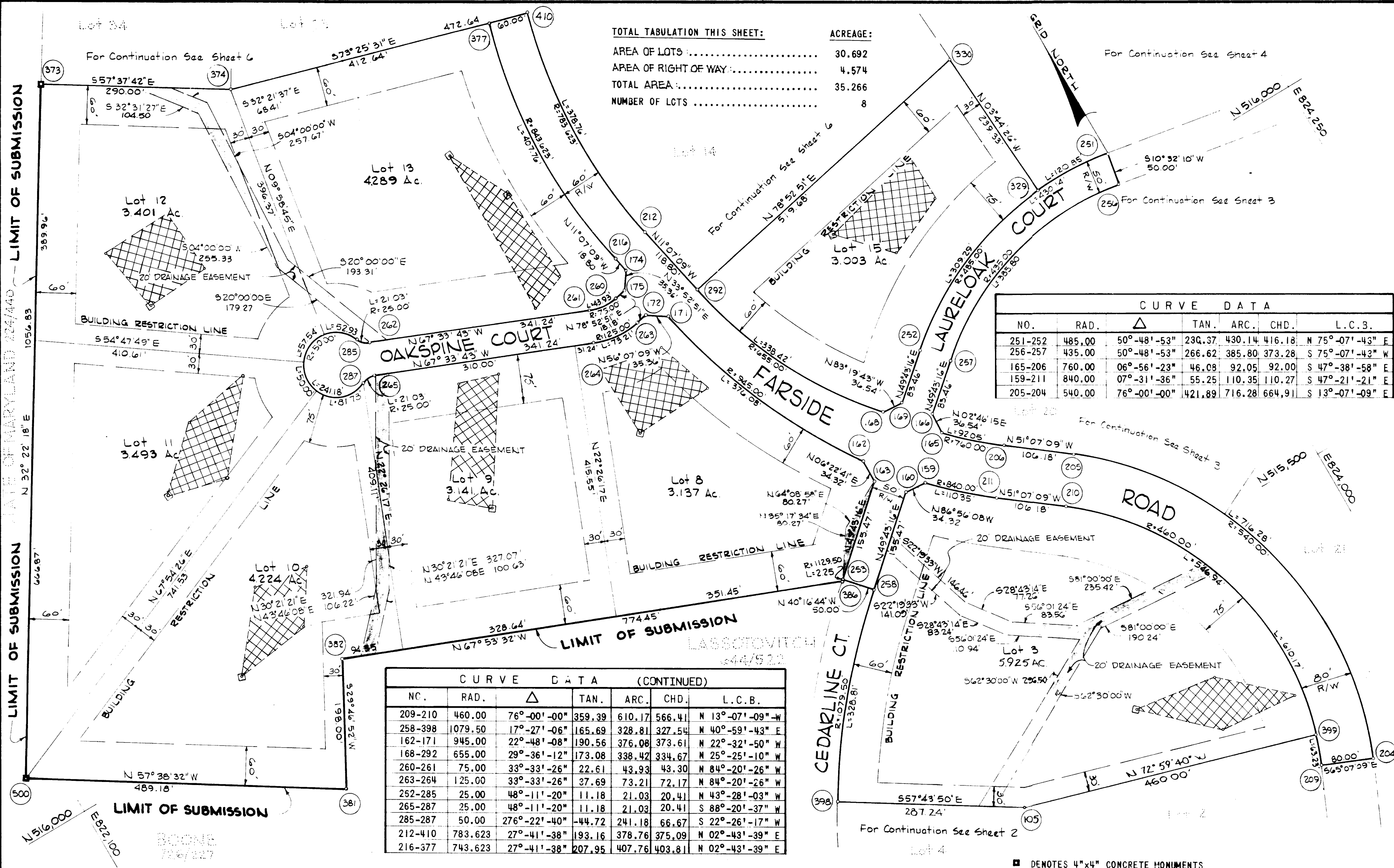

APPROVED: FOR PRIVATE WATER AND PRIVATE SEWERAGE SYSTEMS, HOWARD COUNTY HEALTH DEPT.

*Joseph J. ...* 10-8-79  
 COUNTY HEALTH OFFICER DATE

APPROVED: HOWARD COUNTY OFFICE OF PLANNING AND ZONING.

*...* 10-10-79  
 DIRECTOR DATE

APPROVED: STORM DRAINAGE SYSTEMS AND PUBLIC ROADS, HOWARD COUNTY DEPT. OF PUBLIC WORKS.

\_\_\_\_\_  
 DIRECTOR DATE

**SURVEYOR'S CERTIFICATE**

I HEREBY CERTIFY THAT THE FINAL PLAT SHOWN HEREON IS CORRECT; THAT IT IS A SUBDIVISION OF ALL OF THE LAND CONVEYED BY MARY CARROLL POTTER, EDWARD HAMMOND LASSOTOVITCH, JULIA RANDOL LASSOTOVITCH, ROBERT DUNBAR SWEDER, AND FRANCIS HILDA SNEDEK TO WOODMARK, INC., DEED DATED OCTOBER 2, 1978 AND RECORDED IN THE LAND RECORDS OF HOWARD COUNTY LIBER 912, FOLIO 173 AND ALL OF THE LAND CONVEYED BY EDWARD HAMMOND LASSOTOVITCH AND JULIA RANDOL LASSOTOVITCH TO WOODMARK, INC., DEED DATED OCTOBER 2, 1978 AND RECORDED IN THE LAND RECORDS OF HOWARD COUNTY LIBER 912, FOLIO 189 AND ALL MONUMENTS ARE IN PLACE AS SHOWN, IN ACCORDANCE WITH THE ANNOTATED CODE OF MARYLAND, AS AMENDED.

PROFESSIONAL LAND SURVEYOR:  
 (BY) *Donald E. Fine*  
 CENTURY ENGINEERING, INC.  
 32 West Road  
 TOWSON, MARYLAND 21284

**OWNER'S CERTIFICATE**

I, WOODMARK, INC., A MARYLAND CORPORATION BY MARK A. WAKEFIELD JR., PRESIDENT, OWNER OF THE PROPERTY SHOWN AND DESCRIBED HEREON, HEREBY ADOPT THIS PLAN OF SUBDIVISION, AND IN CONSIDERATION OF THE APPROVAL OF THIS FINAL PLAT BY THE OFFICE OF PLANNING AND ZONING, ESTABLISH THE MINIMUM BUILDING RESTRICTION LINES AND GRANT UNTO HOWARD COUNTY, MARYLAND, ITS SUCCESSORS AND ASSIGNS, (1) THE RIGHT TO LAY, CONSTRUCT AND MAINTAIN SEWERS, DRAINS, WATER PIPES AND OTHER MUNICIPAL UTILITIES AND SERVICES, IN AND UNDER ALL ROADS AND STREET RIGHTS-OF-WAY AND THE SPECIFIC DRAINAGE AND UTILITY EASEMENTS; (2) DEDICATE TO PUBLIC USE THE BEDS OF THE STREET AND/OR ROADS AND FLOODPLAINS AND OPEN SPACE WHERE APPLICABLE; AND FOR ONE DOLLAR (\$1.00) CONSIDERATION, HEREBY GRANT THE RIGHT AND OPTION TO HOWARD COUNTY TO ACQUIRE THE FEE SIMPLE TITLE TO THE BEDS OF THE STREETS AND/OR ROADS "WHERE APPLICABLE"; (3) THAT NO BUILDINGS OR SIMILAR STRUCTURE OF ANY KIND SHALL BE ERRECTED ON OR OVER THE SAID EASEMENT AND RIGHT-OF-WAYS; AND (4) IT IS FURTHER AGREED THAT THE MAINTENANCE OF ALL WATERWAYS, DRAINAGE EASEMENTS AND/OR FLOODPLAINS SHOWN HEREON ARE THE RESPONSIBILITY OF THE PROPERTY OWNER, ITS SUCCESSORS AND ASSIGNS.

WITNESS MY/OUR HANDS THIS 1st. DAY OF JUNE, 1979.

WOODMARK, INC.  
 12150 Mount Albert Court  
 ELLICOTT CITY, MARYLAND 21043

*Mark A. Wakefield Jr.*  
 MARK A. WAKEFIELD JR., PRESIDENT

ATTEST: *Ulpha* SEAL

RECORDED AS PLAT NUMBER 4409  
 ON Oct 11, 1979, AMONG THE  
 LAND RECORDS OF HOWARD COUNTY, MARYLAND

**FARSIDE**  
 LOTS 3, 8-13, & 15  
 TAX MAPS 23 & 29

SHEET 5 OF 10  
 3rd. ELECTION DISTRICT OF HOWARD COUNTY, MARYLAND  
 SCALE: 1" = 100' DATE: 6-1-79



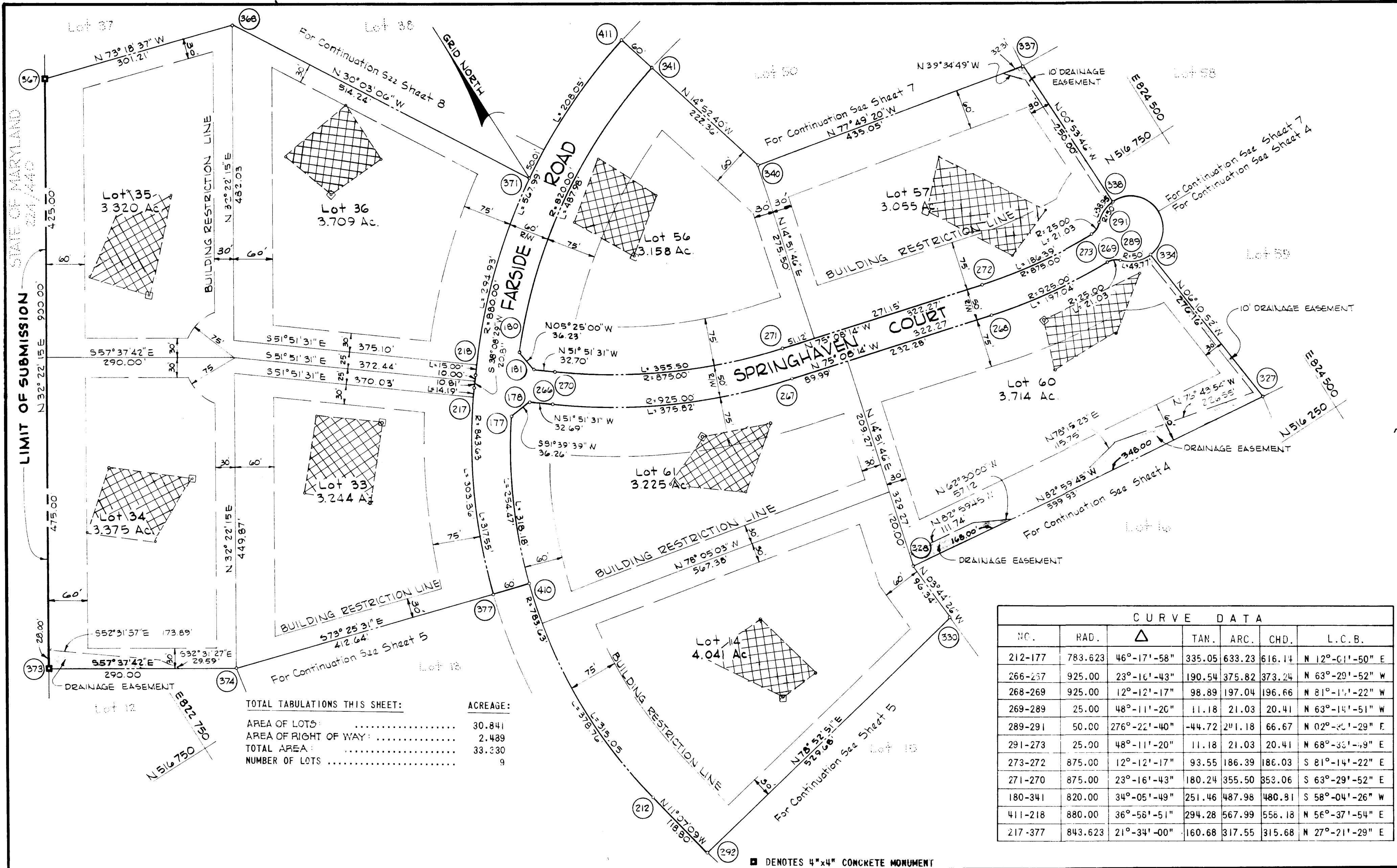

TOTAL TABULATIONS THIS SHEET: ..... ACREAGE:  
 AREA OF LOTS: ..... 30.841  
 AREA OF RIGHT OF WAY: ..... 2.489  
 TOTAL AREA: ..... 33.330  
 NUMBER OF LOTS: ..... 9

CURVE DATA						
NO.	RAD.	Δ	TAN.	ARC.	CHD.	L.C.B.
212-177	783.623	46°-17'-58"	335.05	633.23	616.14	N 12°-01'-50" E
266-267	925.00	23°-16'-43"	190.54	375.82	373.24	N 63°-29'-52" W
268-269	925.00	12°-12'-17"	98.89	197.04	196.66	N 81°-11'-22" W
269-289	25.00	48°-11'-20"	11.18	21.03	20.41	N 63°-14'-51" W
289-291	50.00	276°-22'-40"	-44.72	21.18	66.67	N 02°-20'-29" E
291-273	25.00	48°-11'-20"	11.18	21.03	20.41	N 68°-36'-19" E
273-272	875.00	12°-12'-17"	93.55	186.39	186.03	S 81°-14'-22" E
271-270	875.00	23°-16'-43"	180.24	355.50	353.06	S 63°-29'-52" E
180-341	820.00	34°-05'-49"	251.46	487.98	480.81	S 58°-04'-26" W
411-218	880.00	36°-58'-51"	294.28	567.99	556.18	N 56°-37'-54" E
217-377	843.623	21°-34'-00"	160.68	317.55	315.68	N 27°-21'-29" E

APPROVED: FOR PRIVATE WATER AND PRIVATE SEWERAGE SYSTEMS, HOWARD COUNTY HEALTH DEPT.  
*John J. [Signature]* 10-8-79  
 COUNTY HEALTH OFFICER DATE

APPROVED: HOWARD COUNTY OFFICE OF PLANNING AND ZONING.  
*[Signature]* 10-10-79  
 DIRECTOR DATE

APPROVED: STORM DRAINAGE SYSTEMS AND PUBLIC ROADS, HOWARD COUNTY DEPARTMENT OF PUBLIC WORKS.  
*[Signature]*  
 DIRECTOR DATE

**SURVEYOR'S CERTIFICATE**  
 I HEREBY CERTIFY THAT THE FINAL PLAT SHOWN HEREON IS CORRECT; THAT IT IS A SUBDIVISION OF ALL OF THE LAND CONVEYED BY MARY CARROLL POTTER, EDWARD HAMMOND LASSOTOVITCH, JULIA RANDOL LASSOTOVITCH, ROBERT DUMBAR SNEDEKER, AND FRANCIS HILDA SNEDEKER TO WOODMARK, INC., DEED DATED OCTOBER 2, 1978 AND RECORDED IN THE LAND RECORDS OF HOWARD COUNTY LIBER 912, FOLIO 173 AND ALL OF THE LAND CONVEYED BY EDWARD HAMMOND LASSOTOVITCH AND JULIA RANDOL LASSOTOVITCH TO WOODMARK, INC., DEED DATED OCTOBER 2, 1978 AND RECORDED IN THE LAND RECORDS OF HOWARD COUNTY LIBER 912, FOLIO 189 AND ALL MONUMENTS ARE IN PLACE AS SHOWN, IN ACCORDANCE WITH THE ANNOTATED CODE OF MARYLAND, AS AMENDED.

PROFESSIONAL LAND SURVEYOR:  
 (BY) *James E. [Signature]*  
 CENTURY ENGINEERING, INC.  
 32 West Road  
 TOWSON, MARYLAND 21286

**OWNER'S CERTIFICATE**  
 I, WOODMARK, INC., A MARYLAND CORPORATION BY MARK A. WAKEFIELD JR., PRESIDENT, OWNER OF THE PROPERTY SHOWN AND DESCRIBED HEREON, HEREBY ADOPT THIS PLAN OF SUBDIVISION, AND IN CONSIDERATION OF THE APPROVAL OF THIS FINAL PLAT BY THE OFFICE OF PLANNING AND ZONING, ESTABLISH THE MINIMUM BUILDING RESTRICTION LINES AND GRANT UNTO HOWARD COUNTY, MARYLAND, ITS SUCCESSORS AND ASSIGNS, (1) THE RIGHT TO LAY, CONSTRUCT AND MAINTAIN SEWERS, DRAINS, WATER PIPES AND OTHER MUNICIPAL UTILITIES AND SERVICES, IN AND UNDER ALL ROADS AND STREET RIGHTS-OF-WAYS AND THE SPECIFIC DRAINAGE AND UTILITY EASEMENTS; (2) DEDICATE TO PUBLIC USE THE BEDS OF THE STREETS AND/OR ROADS AND FLOODPLAINS AND OPEN SPACE WHERE APPLICABLE, AND FOR ONE DOLLAR (\$1.00) CONSIDERATION, HEREBY GRANT THE RIGHT AND OPTION TO HOWARD COUNTY TO ACQUIRE THE FEE SIMPLE TITLE TO THE BEDS OF THE STREETS AND/OR ROADS "WHERE APPLICABLE"; (3) THAT NO BUILDING OR SIMILAR STRUCTURE OF ANY KIND SHALL BE ERRECTED ON OR OVER THE SAID EASEMENT AND RIGHT-OF-WAYS, AND (4) IT IS FURTHER AGREED THAT MAINTENANCE OF ALL WATERWAYS, DRAINAGE EASEMENTS AND/OR FLOODPLAINS SHOWN HEREON ARE THE RESPONSIBILITY OF THE PROPERTY OWNER, ITS SUCCESSORS AND ASSIGNS.  
 WITNESS MY/OUR HANDS THIS 1st. DAY OF JUNE, 1979.

WOODMARK, INC.  
 12150 Mount Albert Court  
 ELLICOTT CITY, MARYLAND 21043

ATTEST: *[Signature]* SEAL  
 MARK A. WAKEFIELD JR., PRESIDENT

RECORDED AS PLAT NUMBER 4410  
 ON OCT 11, 1979, AMONG THE  
 LAND RECORDS OF HOWARD COUNTY, MARYLAND.

**FARSIDE**  
 LOTS 14, 33-36, 56, 57, 60, & 61  
 TAX MAPS 23 & 20

SHEET 3 OF 10  
 3rd. ELECTION DISTRICT OF HOWARD COUNTY, MARYLAND  
 SCALE: 1" = 100' DATE: 6-1-79

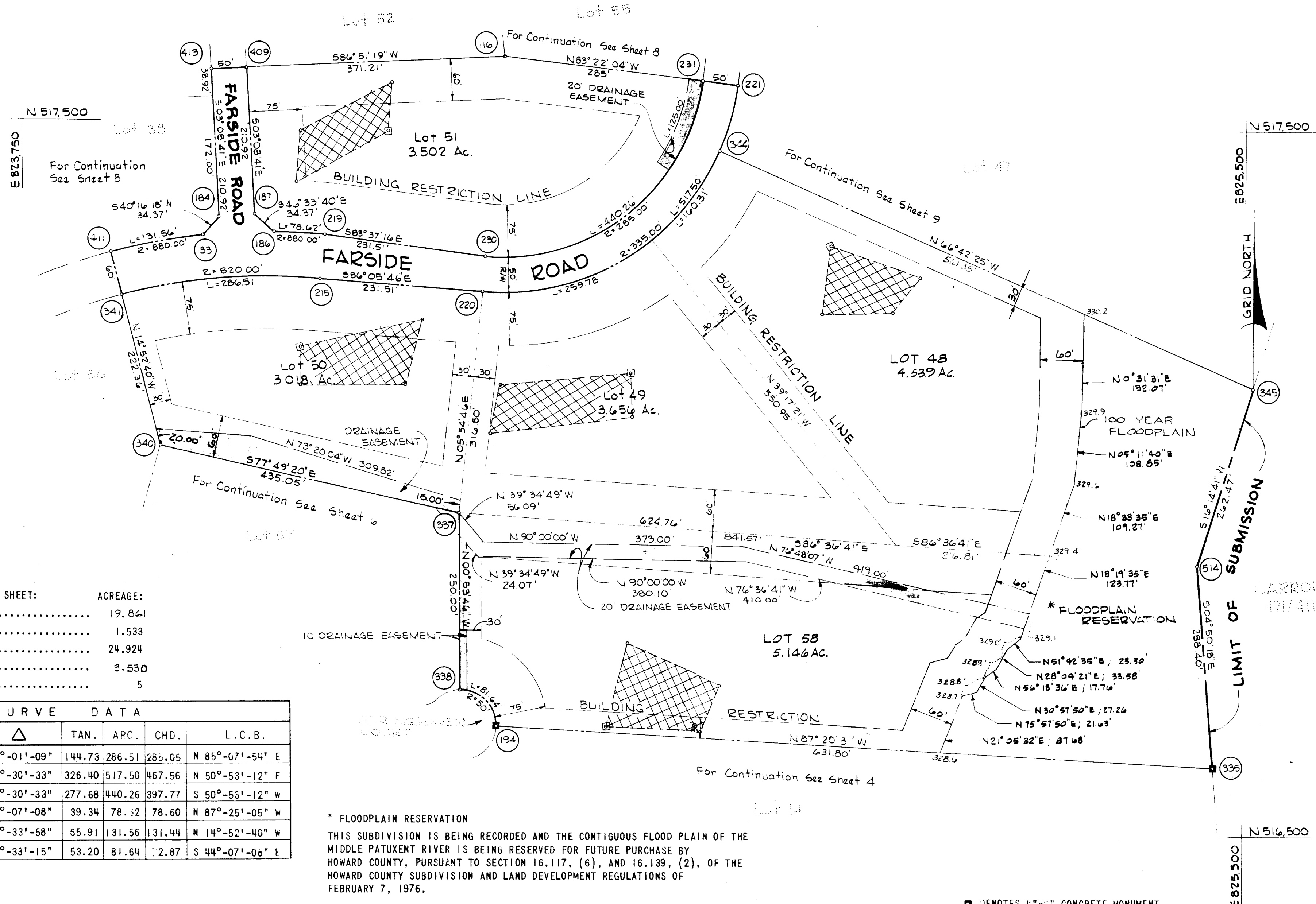

TOTAL TABULATION THIS SHEET: ACREAGE:

AREA OF LOTS .....	19.841
AREA OF RIGHT-OF-WAY .....	1.533
TOTAL AREA .....	24.924
AREA OF FLOODPLAIN .....	3.530
NUMBER OF LOTS .....	5

CURVE DATA						
NO.	RAD.	Δ	TAN.	ARC.	CHD.	L.C.B.
341-215	820.00	20°-01'-09"	144.73	286.51	283.65	N 85°-07'-54" E
220-221	335.00	88°-30'-33"	326.40	517.50	467.56	N 50°-53'-12" E
231-230	285.00	88°-30'-33"	277.68	440.26	397.77	S 50°-55'-12" W
219-186	880.00	05°-07'-08"	39.34	78.32	78.60	N 87°-25'-05" W
183-411	880.00	08°-33'-58"	55.91	131.56	131.44	N 14°-52'-40" W
338-194	50.00	93°-33'-15"	53.20	81.64	72.87	S 44°-07'-08" E

\* FLOODPLAIN RESERVATION  
 THIS SUBDIVISION IS BEING RECORDED AND THE CONTIGUOUS FLOOD PLAIN OF THE MIDDLE PATUXENT RIVER IS BEING RESERVED FOR FUTURE PURCHASE BY HOWARD COUNTY, PURSUANT TO SECTION 16.117, (6), AND 16.139, (2), OF THE HOWARD COUNTY SUBDIVISION AND LAND DEVELOPMENT REGULATIONS OF FEBRUARY 7, 1976.

■ DENOTES 4"x4" CONCRETE MONUMENT

APPROVED: FOR PRIVATE WATER AND PRIVATE SEWERAGE SYSTEMS, HOWARD COUNTY HEALTH DEPT.  
*[Signature]* 10-8-79  
 COUNTY HEALTH OFFICER DATE

APPROVED: HOWARD COUNTY OFFICE OF PLANNING AND ZONING.  
*[Signature]* 10-10-79  
 DIRECTOR DATE

APPROVED: STORM DRAINAGE SYSTEMS AND PUBLIC ROADS, HOWARD COUNTY DEPARTMENT OF PUBLIC WORKS.  
 DIRECTOR DATE

SURVEYOR'S CERTIFICATE  
 I HEREBY CERTIFY THAT THE FINAL PLAT SHOWN HEREON IS CORRECT; THAT IT IS A SUBDIVISION OF ALL OF THE LAND CONVEYED BY MARY CARROLL POTTER, EDWARD HAMMOND LASSOTOVITCH, JULIA RANDOL LASSOTOVITCH, ROBERT DUNBAR SNEDEKER, AND FRANCIS HILDA SNEDEKER TO WOODMARK, INC., DEED DATED OCTOBER 2, 1978 AND RECORDED IN THE LAND RECORDS OF HOWARD COUNTY LIBER 912, FOLIO 173 AND ALL OF THE LAND CONVEYED BY EDWARD HAMMOND LASSOTOVITCH AND JULIA RANDOL LASSOTOVITCH TO WOODMARK, INC., DEED DATED OCTOBER 2, 1978 AND RECORDED IN THE LAND RECORDS OF HOWARD COUNTY LIBER 912, FOLIO 189 AND ALL MONUMENTS ARE IN PLACE AS SHOWN, IN ACCORDANCE WITH THE ANNOTATED CODE OF MARYLAND, AS AMENDED.  
 PROFESSIONAL LAND SURVEYOR:  
 (BY) *[Signature]*  
 CENTURY ENGINEERING, INC.  
 32 West Road  
 TOWSON, MARYLAND 21284

OWNER'S CERTIFICATE  
 I, WOODMARK, INC., A MARYLAND CORPORATION BY MARK A. WAKEFIELD JR., PRESIDENT, OWNER OF THE PROPERTY SHOWN AND DESCRIBED HEREON, HEREBY ADOPT THIS PLAN OF SUBDIVISION, AND IN CONSIDERATION OF THE APPROVAL OF THIS FINAL PLAT BY THE OFFICE OF PLANNING AND ZONING, ESTABLISH THE MINIMUM BUILDING RESTRICTION LINES AND GRANT UNTO HOWARD COUNTY, MARYLAND, ITS SUCCESSORS AND ASSIGNS, (1) THE RIGHT TO LAY, CONSTRUCT AND MAINTAIN SEWERS, DRAINS, WATER PIPES AND OTHER MUNICIPAL UTILITIES AND SERVICES, IN AND UNDER ALL ROADS AND STREET RIGHT-OF-WAYS AND THE SPECIFIC DRAINAGE AND UTILITY EASEMENTS; (2) DEDICATE TO PUBLIC USE THE BEDS OF THE STREET AND/OR ROADS AND FLOODPLAINS AND OPEN SPACE WHERE APPLICABLE, AND FOR ONE DOLLAR (\$1.00) CONSIDERATION, HEREBY GRANT THE RIGHT AND OPTION TO HOWARD COUNTY TO ACQUIRE THE FEE SIMPLE TITLE TO THE BEDS OF THE STREETS AND/OR ROADS "WHERE APPLICABLE"; (3) THAT NO BUILDING OR SIMILAR STRUCTURE OF ANY KIND SHALL BE ERRECTED ON OR OVER THE SAID EASEMENT AND RIGHT-OF-WAYS; AND (4) IT IS FURTHER AGREED THAT MAINTENANCE OF ALL WATERWAYS, DRAINAGE EASEMENTS AND/OR FLOODPLAINS SHOWN HEREON ARE THE RESPONSIBILITY OF THE PROPERTY OWNER, ITS SUCCESSORS AND ASSIGNS.  
 WITNESS MY/OUR HANDS THIS 1st. DAY OF JUNE, 1979.  
 WOODMARK, INC.  
 12150 Mount Albert Court  
 ELLICOTT CITY, MARYLAND 21043  
*[Signature]*  
 MARK A. WAKEFIELD JR., PRESIDENT  
 ATTEST: *[Signature]* SEAL

RECORDED AS PLAT NUMBER 4411  
 ON OCT. 11, 1979, AMONG THE  
 LAND RECORDS OF HOWARD COUNTY, MARYLAND

**FARSIDE**  
 LOTS 48-51, & 58  
 TAX MAPS 23 & 29  
 SHEET 7 OF 10  
 3rd. ELECTION DISTRICT OF HOWARD COUNTY, MARYLAND  
 SCALE: 1" = 100'  
 DATE: 6-1-79

STATE OF MARYLAND  
724/440

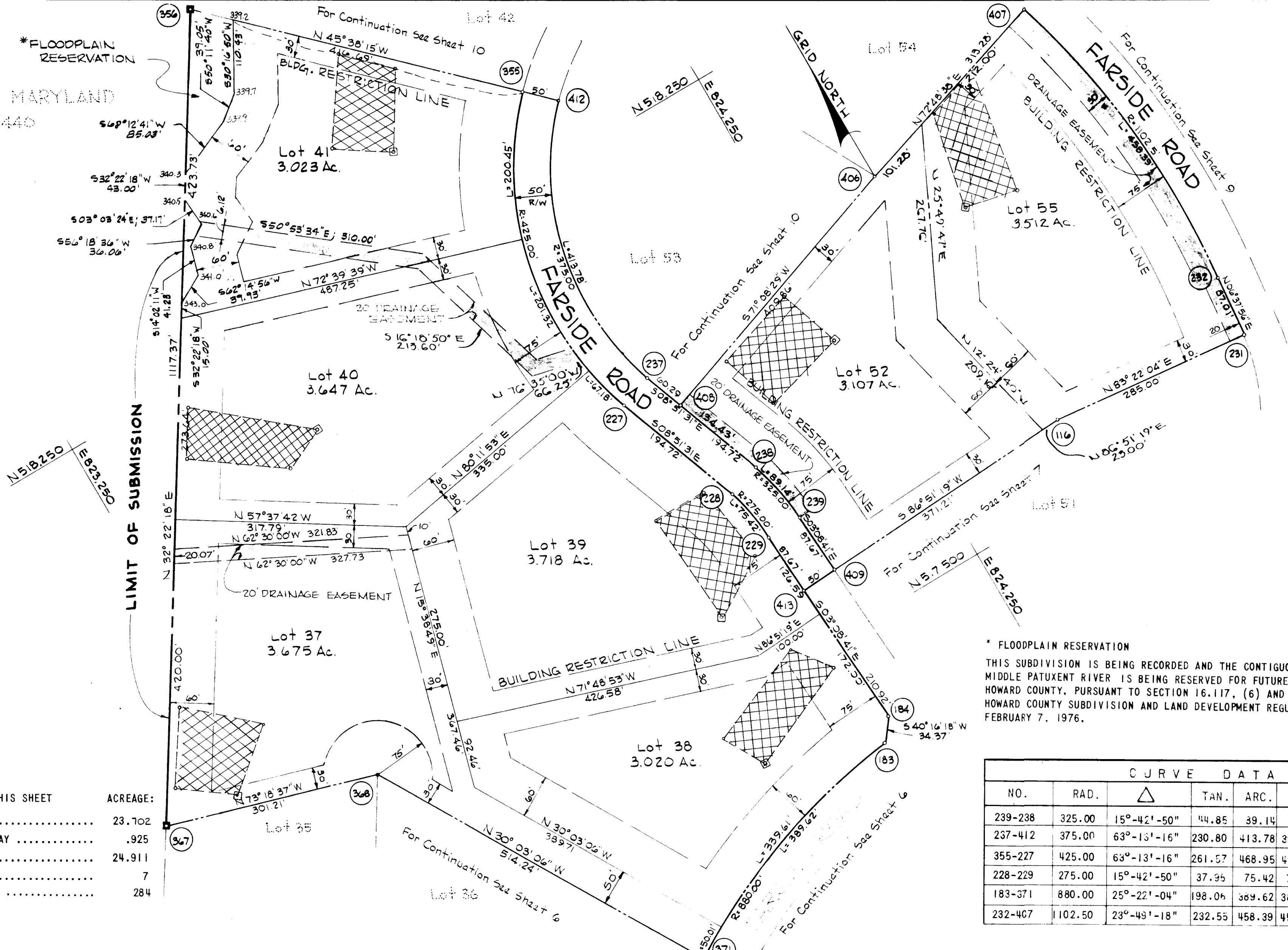

TOTAL TABULATION THIS SHEET	ACREAGE:
AREA OF LOTS .....	23.702
AREA OF RIGHT-OF-WAY .....	.925
TOTAL AREA .....	24.911
NUMBER OF LOTS .....	7
AREA OF FLOODPLAIN .....	284

\* FLOODPLAIN RESERVATION  
THIS SUBDIVISION IS BEING RECORDED AND THE CONTIGUOUS FLOOD PLAIN OF THE MIDDLE PATUXENT RIVER IS BEING RESERVED FOR FUTURE PURCHASE BY HOWARD COUNTY, PURSUANT TO SECTION 16.117, (6) AND 16.139, (2), OF THE HOWARD COUNTY SUBDIVISION AND LAND DEVELOPMENT REGULATIONS OF FEBRUARY 7, 1976.

CURVE DATA						
NO.	RAD.	Δ	TAN.	ARC.	CHD.	L.C.B.
239-238	325.00	15°-42'-50"	44.85	39.14	88.86	N 11°-00'-06" W
237-412	375.00	63°-13'-16"	230.80	413.78	393.11	N 12°-45'-07" E
355-227	425.00	63°-13'-16"	261.57	468.95	445.52	S 12°-45'-07" W
228-229	275.00	15°-42'-50"	37.95	75.42	75.19	S 11°-00'-06" E
183-371	880.00	25°-22'-04"	198.06	389.62	386.45	N 71°-00'-16" E
232-467	1102.50	23°-49'-18"	232.55	458.39	455.09	N 05°-16'-43" W

□ DENOTES 4"x4" CONCRETE MONUMENT

APPROVED: FOR PRIVATE WATER AND PRIVATE SEWERAGE SYSTEMS, HOWARD COUNTY HEALTH DEPT.  
*Joyce Boyd* 10-8-79  
COUNTY HEALTH OFFICER DATE

APPROVED: HOWARD COUNTY OFFICE OF PLANNING AND ZONING.  
*[Signature]* 10-20-79  
DIRECTOR DATE

APPROVED: STORM DRAINAGE SYSTEMS AND PUBLIC ROADS, HOWARD COUNTY DEPARTMENT OF PUBLIC WORKS.  
*[Signature]*  
DIRECTOR DATE

SURVEYOR'S CERTIFICATE  
I HEREBY CERTIFY THAT THE FINAL PLAT SHOWN HEREON IS CORRECT; THAT IT IS A SUBDIVISION OF ALL OF THE LAND CONVEYED BY MARY CARROLL POTTER, EDWARD HAMMOND LASSOTOVITCH, JULIA RANDOL LASSOTOVITCH, ROBERT DUMBAR SNEDEKER, AND FRANCIS HILDA SNEDEKER TO WOODMARK, INC., DEED DATED OCTOBER 2, 1978 AND ALL RECORDED IN THE LAND RECORDS OF HOWARD COUNTY LIBER 912, FOLIO 173 AND ALL OF THE LAND CONVEYED BY EDWARD HAMMOND LASSOTOVITCH AND JULIA RANDOL LASSOTOVITCH TO WOODMARK, INC., DEED DATED OCTOBER 2, 1978 AND RECORDED IN THE LAND RECORDS OF HOWARD COUNTY LIBER 912, FOLIO 189 AND ALL MONUMENTS ARE IN PLACE AS SHOWN, IN ACCORDANCE WITH THE ANNOTATED CODE OF MARYLAND, AS AMENDED.

PROFESSIONAL LAND SURVEYOR:  
(NY) *Donald E. Fine*  
CENTURY ENGINEERING, INC.  
32 West Road  
TOWSON, MARYLAND 21284

OWNER'S CERTIFICATE  
I, WOODMARK, INC., A MARYLAND CORPORATION BY MARK A. WAKEFIELD JR., PRESIDENT, OWNER OF THE PROPERTY SHOWN AND DESCRIBED HEREON, HEREBY ADOPT THIS PLAN OF SUBDIVISION, AND IN CONSIDERATION OF THE APPROVAL OF THIS FINAL PLAT BY THE OFFICE OF PLANNING AND ZONING, ESTABLISH THE MINIMUM BUILDING RESTRICTION LINES AND GRANT UNTO HOWARD COUNTY, MARYLAND, ITS SUCCESSORS AND ASSIGNS, (1) THE RIGHT TO LAY, CONSTRUCT AND MAINTAIN SEWERS, DRAINS, WATER PIPES AND OTHER MUNICIPAL UTILITIES AND SERVICES, IN AND UNDER ALL ROADS AND STREET RIGHTS-OF-WAY AND THE SPECIFIC DRAINAGE AND UTILITY EASEMENTS; (2) DEDICATE TO PUBLIC USE THE BEDS OF THE STREET AND/OR ROADS AND FLOODPLAINS AND OPEN SPACE WHERE APPLICABLE, AND FOR ONE DOLLAR (\$1.00) CONSIDERATION, HEREBY GRANT THE RIGHT AND OPTION TO HOWARD COUNTY TO ACQUIRE THE FEE SIMPLE TITLE TO THE BEDS OF THE STREETS AND/OR ROADS "WHERE APPLICABLE"; (3) THAT NO BUILDING OR SIMILAR STRUCTURE OF ANY KIND SHALL BE ERRECTED ON OR OVER THE SAID EASEMENT AND RIGHT-OF-WAYS; AND (4) IT IS FURTHER AGREED THAT MAINTENANCE OF ALL WATERWAYS, DRAINAGE EASEMENTS AND/OR FLOODPLAINS SHOWN HEREON ARE THE RESPONSIBILITY OF THE PROPERTY OWNER, ITS SUCCESSORS AND ASSIGNS.

WITNESS MY/OUR HANDS THIS 1st. DAY OF JUNE, 1979.

WOODMARK, INC.  
12150 Mount Albert Court  
ELLCOTT CITY, MARYLAND 21113

ATTEST: *[Signature]* SEAL *[Signature]*  
MARK A. WAKEFIELD JR., PRESIDENT

RECORDED AS PLAT NUMBER 4412  
ON Oct 11, 1979, AMONG THE  
LAND RECORDS OF HOWARD COUNTY, MARYLAND

**FAR SIDE**  
LOTS 37-41, 52, 55  
TAX MAPS 23 & 29

SHEET 8 OF 10  
3rd. ELECTION DISTRICT OF HOWARD COUNTY, MARYLAND  
SCALE: 1" = 100'  
DATE 6-1-79



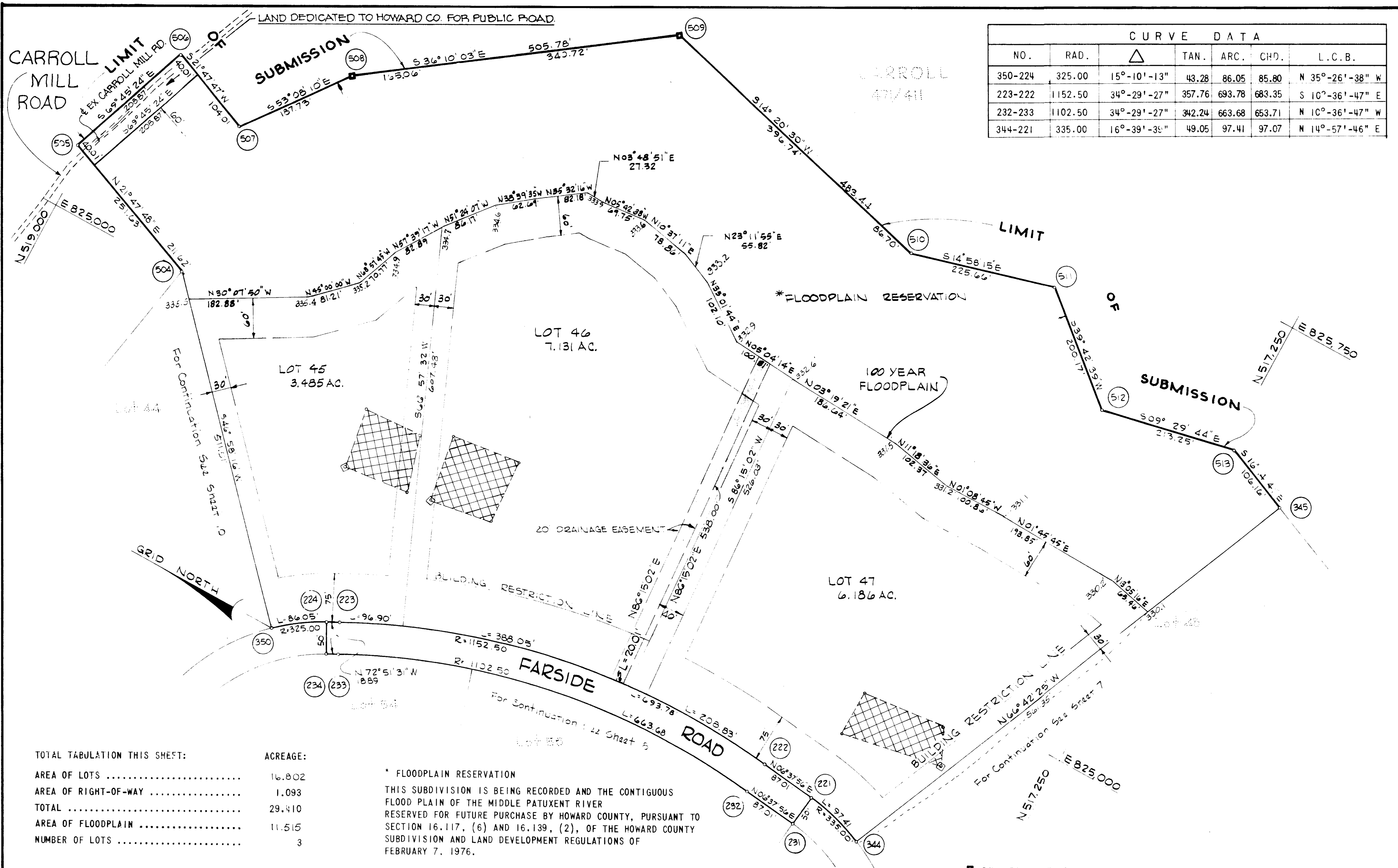

CURVE DATA						
NO.	RAD.	Δ	TAN.	ARC.	CHD.	L.C.B.
350-224	325.00	15°-10'-13"	43.28	86.05	85.80	N 35°-26'-38" W
223-222	1152.50	34°-29'-27"	357.76	693.78	683.35	S 10°-36'-47" E
232-233	1102.50	34°-29'-27"	342.24	663.68	653.71	N 10°-36'-47" W
344-221	335.00	16°-39'-34"	49.05	97.41	97.07	N 14°-57'-46" E

TOTAL TABULATION THIS SHEET:	ACREAGE:
AREA OF LOTS .....	16.802
AREA OF RIGHT-OF-WAY .....	1.093
TOTAL .....	29.410
AREA OF FLOODPLAIN .....	11.515
NUMBER OF LOTS .....	3

\* FLOODPLAIN RESERVATION  
 THIS SUBDIVISION IS BEING RECORDED AND THE CONTIGUOUS FLOOD PLAIN OF THE MIDDLE PATUXENT RIVER RESERVED FOR FUTURE PURCHASE BY HOWARD COUNTY, PURSUANT TO SECTION 16.117, (6) AND 16.139, (2), OF THE HOWARD COUNTY SUBDIVISION AND LAND DEVELOPMENT REGULATIONS OF FEBRUARY 7, 1976.

APPROVED: FOR PRIVATE WATER AND PRIVATE SEWERAGE SYSTEMS, HOWARD COUNTY HEALTH DEPT.  
*Joseph Bylles* 10-8-79  
 COUNTY HEALTH OFFICER DATE

APPROVED: HOWARD COUNTY OFFICE OF PLANNING AND ZONING.  
 \_\_\_\_\_ 10-10-79  
 DIRECTOR DATE

APPROVED: STORM DRAINAGE SYSTEMS AND PUBLIC ROADS, HOWARD COUNTY DEPARTMENT OF PUBLIC WORKS  
 \_\_\_\_\_  
 DIRECTOR DATE

**SURVEYOR'S CERTIFICATE**  
 I HEREBY CERTIFY THAT THE FINAL PLAT SHOWN HEREON IS CORRECT; THAT IT IS A SUBDIVISION OF ALL OF THE LAND CONVEYED BY MARY CARROLL POTTER, EDWARD HAMMOND LASSOTOVITCH, JULIA PANDOL LASSOTOVITCH, ROBERT DUNBAR SNEDEKER, AND FRANCIS HILDA SNEDEKER TO WOODMARK, INC., DEED DATED OCTOBER 2, 1978 AND RECORDED IN THE LAND RECORDS OF HOWARD COUNTY LIBER 912, FOLIO 173 AND ALL OF THE LAND CONVEYED BY EDWARD HAMMOND LASSOTOVITCH AND JULIA PANDOL LASSOTOVITCH TO WOODMARK, INC., DEED DATED OCTOBER 2, 1978 AND RECORDED IN THE LAND RECORDS OF HOWARD COUNTY LIBER 912, FOLIO 189 AND ALL MONUMENTS ARE IN PLACE AS SHOWN, IN ACCORDANCE WITH THE ANNOTATED CODE OF MARYLAND, AS AMENDED.  
 PROFESSIONAL LAND SURVEYOR:  
 (S) *Daniel E. [Signature]*  
 CENTURY ENGINEERING, INC.  
 32 West Road  
 TOWSON, MARYLAND 21284

**OWNER'S CERTIFICATE**  
 I, WOODMARK, INC., A MARYLAND CORPORATION BY MARK A. WAKEFIELD JR., PRESIDENT, OWNER OF THE PROPERTY SHOWN AND DESCRIBED HEREON, HEREBY ADOPT THIS PLAN OF SUBDIVISION, AND IN CONSIDERATION OF THE APPROVAL OF THIS FINAL PLAT BY THE OFFICE OF PLANNING AND ZONING, ESTABLISH THE MINIMUM BUILDING RESTRICTION LINES AND GRANT UNTO HOWARD COUNTY, MARYLAND, ITS SUCCESSORS AND ASSIGNS, (1) THE RIGHT TO LAY, CONSTRUCT AND MAINTAIN SEWERS, DRAINS, WATER PIPES AND OTHER MUNICIPAL UTILITIES AND SERVICES, IN AND UNDER ALL ROADS AND STREET RIGHT-OF-WAYS AND THE SPECIFIC DRAINAGE AND UTILITY EASEMENTS; (2) INDICATE TO PUBLIC USE THE BEDS OF THE STREET AND/OR ROADS AND FLOODPLAINS AND OPEN SPACE WHERE APPLICABLE, AND FOR ONE DOLLAR (\$1.00) CONSIDERATION, HEREBY GRANT THE RIGHT AND OPTION TO HOWARD COUNTY TO ACQUIRE THE FEE SIMPLE TITLE TO THE BEDS OF THE STREETS AND/OR ROADS "WHERE APPLICABLE"; (3) THAT NO BUILDING OR SIMILAR STRUCTURE OF ANY KIND SHALL BE ERRECTED ON OR OVER THE SAID EASEMENT AND RIGHT-OF-WAYS, AND (4) IT IS FURTHER AGREED THAT MAINTENANCE OF ALL WATERWAYS, DRAINAGE EASEMENTS AND/OR FLOODPLAINS SHOWN HEREON ARE THE RESPONSIBILITY OF THE PROPERTY OWNER, ITS SUCCESSORS AND ASSIGNS.  
 WITNESS MY/OUR HANDS THIS 1st. DAY OF JUNE, 1979.  
 WOODMARK, INC.  
 12150 Mount Albert Court  
 ELLICOTT CITY, MARYLAND 21033  
*Mark A. Wakefield Jr.*  
 MARK A. WAKEFIELD JR., PRESIDENT  
 ATTEST: \_\_\_\_\_ SEAL

RECORDED AS PLAT NUMBER 4413  
 ON Oct 11, 1979, AMONG THE  
 LAND RECORDS OF HOWARD COUNTY, MARYLAND.  
**FARSIDE**  
 LOTS 45, 46, & 47  
 TAX MAPS 23 & 29  
 SHEET 9 OF 10  
 3rd. ELECTION DISTRICT OF HOWARD COUNTY, MARYLAND  
 SCALE: 1" = 100' DATE: 6-1-79

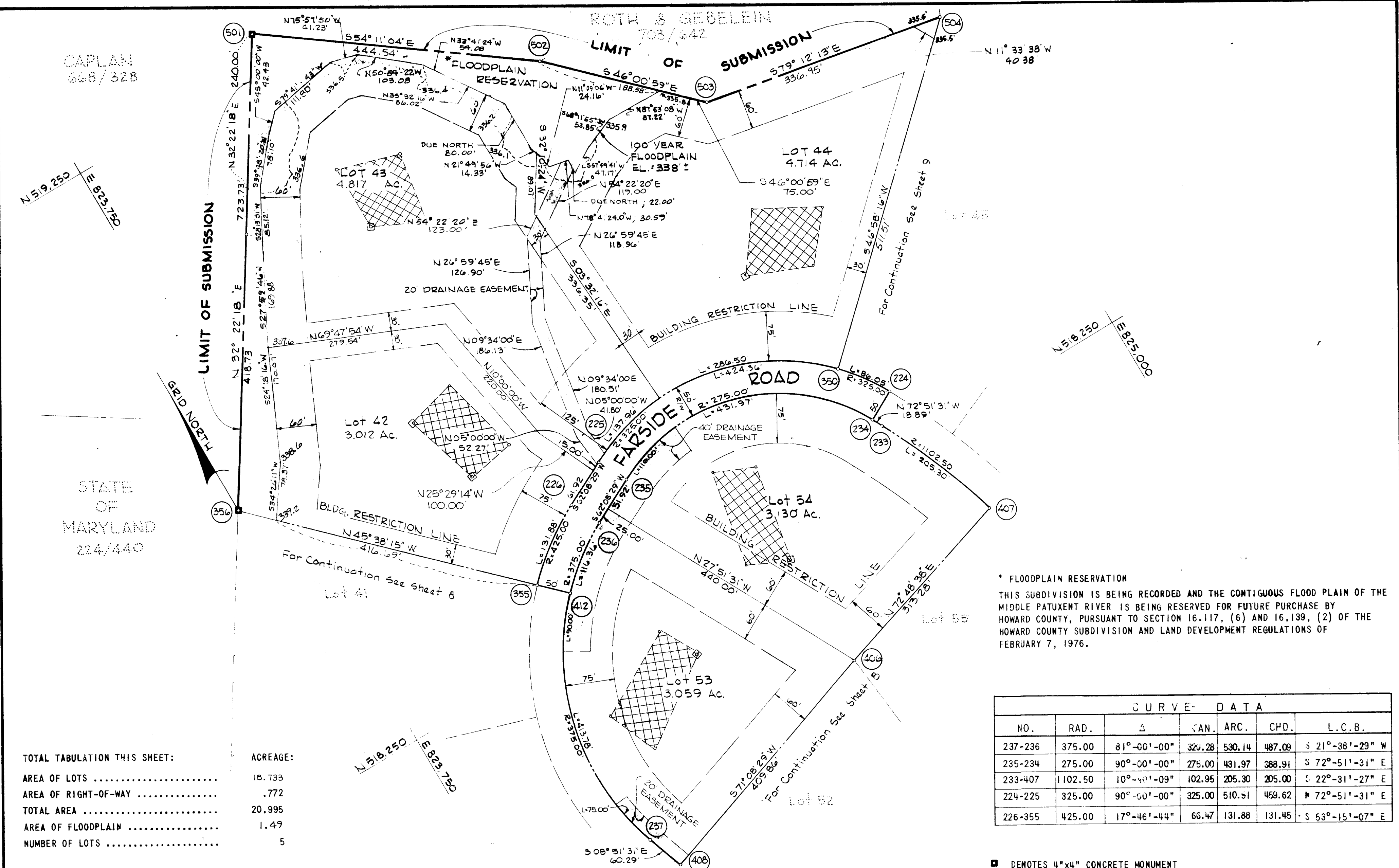

CAPLAN  
668/328

STATE OF  
MARYLAND  
224/440

ROTH & GEBELIN  
703/642

TOTAL TABULATION THIS SHEET:	ACREAGE:
AREA OF LOTS .....	18.733
AREA OF RIGHT-OF-WAY .....	.772
TOTAL AREA .....	20.995
AREA OF FLOODPLAIN .....	1.49
NUMBER OF LOTS .....	5

\* FLOODPLAIN RESERVATION  
THIS SUBDIVISION IS BEING RECORDED AND THE CONTIGUOUS FLOOD PLAIN OF THE MIDDLE PATUXENT RIVER IS BEING RESERVED FOR FUTURE PURCHASE BY HOWARD COUNTY, PURSUANT TO SECTION 16.117, (6) AND 16.139, (2) OF THE HOWARD COUNTY SUBDIVISION AND LAND DEVELOPMENT REGULATIONS OF FEBRUARY 7, 1976.

CURVE DATA						
NO.	RAD.	Δ	ΔAN.	ARC.	CPD.	L.C.B.
237-236	375.00	81°-00'-00"	326.28	530.14	487.09	S 21°-38'-29" W
235-234	275.00	90°-00'-00"	275.00	431.97	388.91	S 72°-51'-31" E
233-407	1102.50	10°-00'-09"	102.95	205.30	205.00	S 22°-31'-27" E
224-225	325.00	90°-00'-00"	325.00	510.51	459.62	N 72°-51'-31" E
226-355	425.00	17°-46'-44"	66.47	131.88	131.45	S 53°-15'-07" E

APPROVED: FOR PRIVATE WATER AND PRIVATE SEWERAGE SYSTEMS, HOWARD COUNTY HEALTH DEPT.  
*[Signature]* 10-8-79  
COUNTY HEALTH OFFICER DATE

APPROVED: HOWARD COUNTY OFFICE OF PLANNING AND ZONING.  
*[Signature]* 10-10-79  
DIRECTOR DATE

APPROVED: STORM DRAINAGE SYSTEMS AND PUBLIC ROADS, HOWARD COUNTY DEPARTMENT OF PUBLIC WORKS.  
*[Signature]*  
DIRECTOR DATE

SURVEYOR'S CERTIFICATE  
I HEREBY CERTIFY THAT THE FINAL PLAT SHOWN HEREON IS CORRECT; THAT IT IS A SUBDIVISION OF ALL OF THE LAND CONVEYED BY MARY CARROLL POTTER, EDWARD HAMMOND LASSOTOVITCH, JULIA RANDOL LASSOTOVITCH, ROBERT DUNBAR SNEDEKER, AND FRANCIS HILDA SNEDEKER TO WOODMARK, INC., DEED DATED OCTOBER 2, 1978 AND RECORDED IN THE LAND RECORDS OF HOWARD COUNTY LIBER 912, FOLIO 173 AND ALL OF THE LAND CONVEYED BY EDWARD HAMMOND LASSOTOVITCH AND JULIA RANDOL LASSOTOVITCH TO WOODMARK, INC., DEED DATED OCTOBER 2, 1978 AND RECORDED IN THE LAND RECORDS OF HOWARD COUNTY LIBER 912, FOLIO 189 AND ALL MONUMENTS ARE IN PLACE AS SHOWN, IN ACCORDANCE WITH THE ANNOTATED CODE OF MARYLAND, AS AMENDED.

PROFESSIONAL LAND SURVEYOR:  
*[Signature]*  
(BY) CENTURY ENGINEERING, INC.  
32 West Road  
TOWSON, MARYLAND 21284

OWNER'S CERTIFICATE  
I, WOODMARK, INC., A MARYLAND CORPORATION BY MARK A. WAKEFIELD Jr., PRESIDENT, OWNER OF THE PROPERTY SHOWN AND DESCRIBED HEREON, HEREBY ADOPT THIS PLAN OF SUBDIVISION, AND IN CONSIDERATION OF THE APPROVAL OF THIS FINAL PLAT BY THE OFFICE OF PLANNING AND ZONING, ESTABLISH THE MINIMUM BUILDING RESTRICTION LINES AND GRANT UNTO HOWARD COUNTY, MARYLAND, ITS SUCCESSORS AND ASSIGNS, (1) THE RIGHT TO LAY, CONSTRUCT AND MAINTAIN SEWERS, DRAINS, WATER PIPES AND OTHER MUNICIPAL UTILITIES AND SERVICES, IN AND UNDER ALL ROADS AND STREET RIGHT-OF-WAYS AND THE SPECIFIC CHAINAGE AND UTILITY EASEMENTS (2) DEDICATE TO PUBLIC USE THE BEDS OF THE STREET AND/OR ROADS AND FLOODPLAINS AND OPEN SPACE WHERE APPLICABLE, AND FOR ONE DOLLAR (\$1.00) CONSIDERATION, HEREBY GRANT THE RIGHT AND OPTION TO HOWARD COUNTY TO ACQUIRE THE FEE SIMPLE TITLE TO THE BEDS OF THE STREETS AND/OR ROADS "WHERE APPLICABLE"; (3) THAT NO BUILDING OR SIMILAR STRUCTURE OF ANY KIND SHALL BE ERRECTED ON OR OVER THE SAID EASEMENT AND RIGHT-OF-WAYS, AND (4) IT IS FURTHER AGREED THAT MAINTENANCE OF ALL WATERWAYS, DRAINAGE EASEMENTS AND/OR FLOODPLAINS SHOWN HEREON ARE THE RESPONSIBILITY OF THE PROPERTY OWNER, ITS SUCCESSORS AND ASSIGNS.

WITNESS MY/OUR HANDS THIS 1st. DAY OF JUNE, 1979.

WOODMARK, INC.  
12150 Mount Albert Court  
ELLICOTT CITY, MARYLAND 21043.  
*[Signature]*  
MARK A. WAKEFIELD Jr., PRESIDENT

ATTEST: *[Signature]* SEAL

RECORDED AS PLAT NUMBER: 4414  
ON OCT 11, 1979, AMONG THE  
LAND RECORD OF HOWARD COUNTY, MARYLAND

**FARISIDE**  
LOTS 42, 43, 44, 53, & 54  
TAX MAPS 23 & 25

SHEET 10 OF 10  
3rd. ELECTION DISTRICT OF HOWARD COUNTY, MARYLAND  
SCALE: 1" = 100'  
DATE: 6-1-79