

This Area Designates A Private Sewage Easement of Approximately 10,000 Square Feet As Required By The Maryland State Health Department For Individual Sewage Disposal. Improvements of Any Nature in This Area Are Restricted Until Public Sewerage Is Available And Servicing Any Residential Structure Constructed On These Building Sites. This Easement Shall Become Null And Void Upon Connection To A Public Sewerage System.

L. A. BAUMAN
421/300

H. EDWARD LEWIS & WIFE
492/29

RESERVED FOR FUTURE R/W OF SOUTH HANOVER ROAD AS SHOWN ON 1971 GENERAL PLAN OF HIGHWAYS OF HOWARD COUNTY.

Notes:

- The Lots Shown Hereon Comply With A Minimum Ownership Width And Lot Area As Required By The Maryland State Department Of Health Regulations.

HARRY V. COOK & WIFE
564/453

LOT No. 3
2.938 Ac.±
127871.599 Sq. ft.

LOT No. 2
3.727 Ac.±
162411.940 Sq. ft.

LOT No. 1
2.298 Ac.±
100114.032 Sq. ft.

N 49°24'04.45" E 87°00'00.29"

S 44°58'43"E - 804.60'

509.14'

N 49°00'34.18" E 87°00'49.71"

N 42°13'32"E - 423.50'

340.46'

80'

40'

40'

N 51°30'54"E - 425.22'

N 00°34'59"E - 142.99'

186.25'

554'

S 44°54'43"E - 186.25'

129.40'

15.00'

N 12°50'47"W - 300.09'

129.40'

N 49°00'34.18" E 87°00'49.71"

129.40'

129.40'

N 42°54'13"W - 1056.00'

1056.00'

N 49°01'59.23" E 87°04'19.50"

1056.00'

1056.00'

1056.00'

1056.00'

1056.00'

1056.00'

1056.00'

1056.00'

1056.00'

1056.00'

1056.00'

1056.00'

1056.00'

1056.00'

1056.00'

1056.00'

1056.00'

1056.00'

1056.00'

1056.00'

1056.00'

1056.00'

1056.00'

1056.00'

1056.00'

1056.00'

1056.00'

1056.00'

1056.00'

1056.00'

1056.00'

1056.00'

1056.00'

1056.00'

1056.00'

1056.00'

1056.00'

1056.00'

1056.00'

1056.00'

1056.00'

1056.00'

1056.00'

1056.00'

1056.00'

1056.00'

1056.00'

1056.00'

1056.00'

1056.00'

1056.00'

1056.00'

1056.00'

1056.00'

1056.00'

1056.00'

1056.00'

1056.00'

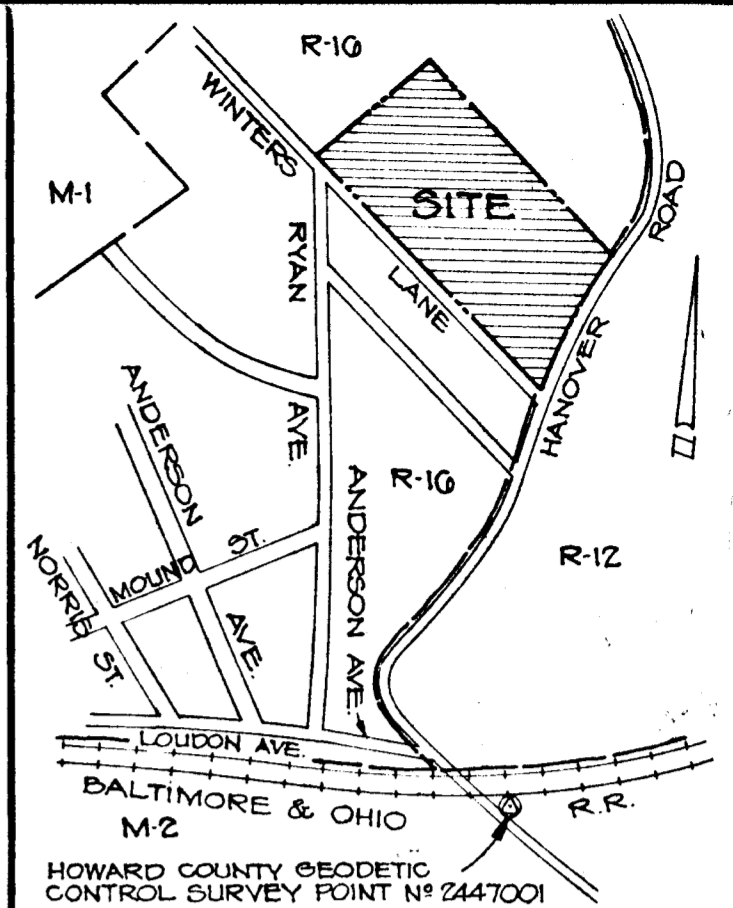

VICINITY MAP
SCALE: 1"=600'

RECEIVED

JAN 13 1976

BUREAU OF ENGINEERING

Note:
Land Dedicated To Howard County For The Purpose Of Public Road Widening.

RECEIVED

JAN 14 1976

BUREAU OF ENGINEERING INSPECTION SECTION

TABULATIONS

- Total area of subdivision..... 9.938 Ac.±
- Total number of lots..... 3 lots
- Total area of lot 1..... 2.298 Ac.±
100114.032 Sq. ft.
- lot 2..... 3.727 Ac.±
162411.940 Sq. ft.
- lot 3..... 2.938 Ac.±
127871.599 Sq. ft.
- Area of Road Widening..... 0.417 Ac.±
18152.128 Sq. ft.

* Lots 1 and 2 - Public Water & Private Sewer. Public Sewer Facilities Do Not Exist As of The Date of This Recording, But Will Be Made Available Upon Completion of Capital Project S-4-G036 Contract 649-5.
Lot 3 - Private Water and Private sewer.

RECORDED ON
* 3342-12-2-75

APPROVED: FOR PUBLIC WATER AND PRIVATE SEWERAGE SYSTEMS LOTS 1 & 2 AND FOR PRIVATE WATER & PRIVATE SEWERAGE SYSTEM LOT 3 HOWARD COUNTY HEALTH DEPARTMENT

[Signature] 12/1/75
COUNTY HEALTH OFFICER DATE

APPROVED: HOWARD COUNTY OFFICE OF PLANNING AND ZONING

[Signature] 12-2-75
DIRECTOR DATE

APPROVED *FOR PUBLIC WATER, PUBLIC SEWERAGE AND STORM DRAINAGE SYSTEMS AND ROADS HOWARD COUNTY DEPARTMENT OF PUBLIC WORKS

[Signature] 11-18-75
DIRECTOR DATE

SURVEYOR'S CERTIFICATE

I hereby certify that the Final Plat shown hereon is correct; that it is a subdivision of the lands conveyed. By *ARTHUR R. GROSS & WIFE* to *MORRIS E. POOL* deed dated *12-2-75* and recorded in the Land Records of Howard County, in Liber *454*, of Folio *248*, and that all monuments are in place as shown, in accordance with the annotated Code of Maryland, as amended.

Date: *6-18-76*
[Signature]
Regt. Land Surveyor

OWNERS CERTIFICATE

[Signature]
owners of the property shown and described hereon, hereby adopt this plan of subdivision, and in consideration of the approval of this Final Plat by the Office of Planning and Zoning, establish the minimum building restriction lines; and dedicate the streets, alleys, walkways, and other easements, widening strips and floodplains and open space where applicable, to public use. All easements, or rights-of-way affecting the property are included in this plan of subdivision. Witness my/our hand/s this *21st* day of *June*, 1974.

[Signature]

NORRIS E. POOL
LOTS 1, 2 & 3

PLAT # 3392

WINTERS L.A. & HANOVER RD.

1ST ELECTION DISTRICT
SCALE: 1"=100'

HOWARD CO., MARYLAND
JUNE, 1974

OWNER

NORRIS E. POOL
7351 WASHINGTON BLVD.
ELKRIDGE MD., 21227

SURVEYOR & ENGINEER

EVANS, HAGAN & HOLDEFER, INC.
SURVEYORS & CIVIL ENGINEERS
8013 BELAIR RD. BALTIMORE CO., MD.

K.L.T.

4/85

3006

F-75-10